

REPLACE THE FIXTURE NOT THE POLE

SLP16 Series



200,000+ HOURS



Design is Protected by US Patent D754,385



Alpha Series LED
PROFESSIONAL GRADE

LUMENS: **8,680** WATTS: **75**
LUMENS PER WATT: **121**
CCT: **4500K** CRI: **71**

LUMENS: **11,350** WATTS: **110**
LUMENS PER WATT: **103**
CCT: **4500K** CRI: **72**

LUMENS: **15,400** WATTS: **145**
LUMENS PER WATT: **103**
CCT: **4500K** CRI: **70**

LUMENS: **18,820** WATTS: **175**
LUMENS PER WATT: **111**
CCT: **4500K** CRI: **72**

FEATURES

Construction

- Separate Driver Compartment - For Cooler Operation
- Low Profile
- External Airflow Fins for Greater Heat Dissipation
- 100% Aluminum with Zero Remelt

Electrical

- 120-277V 50/60Hz Standard
- 10-100% Dimming Standard
- -30°C to 40°C Ambient Environments
- 480 60Hz Optional

Mounting (See pages 60-61)

- Change the Fixture Not the Pole
- Fits Any Existing Pole
- Multiple Brackets Available
- Die Cast Arm is Integrated in Housing

Optics

- Optical Grade Acrylic Lenses
- Light Bar Technology with Individual Optics
- High Efficiency - Up to 95%
- Delivers Increased Footcandles
- Less Glare / Less Wasted Light

Energy Data

- Philips Advance Quality LED Driver
- >0.9 Power Factor
- <20% Total Harmonic Distortion
- 120-277V/50 & 60hz, 480V/60hz
- -30°C Minimum Temperature
- 40°C Ambient Temperature Rating

Ordering Information

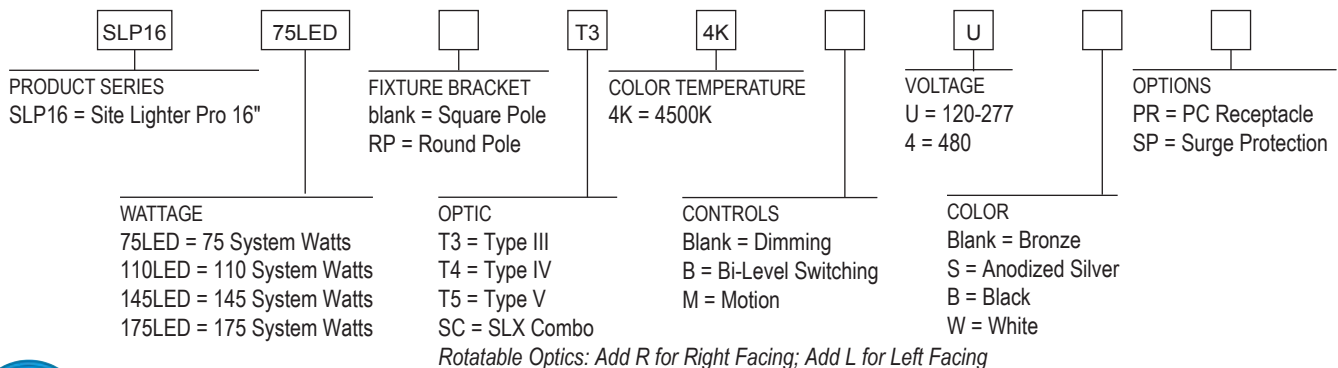

REPLACE THE FIXTURE NOT THE POLE

DIMENSIONS AND SPECIFICATIONS

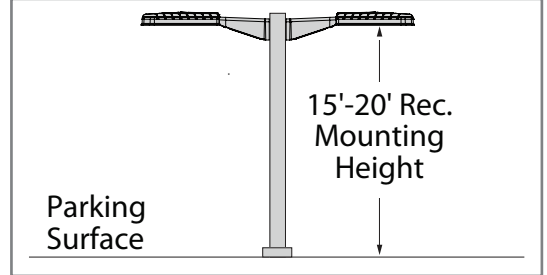
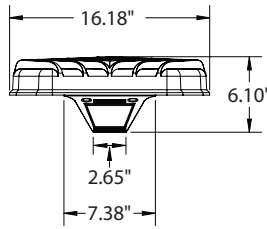
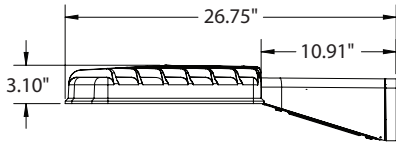

Overall Height: 6.10" (15.494 cm)
Overall Width: 16.18" (41.0972 cm)
Depth: 26.75" (67.945 cm)
Weight: 20 lbs.
EPA: 0.61

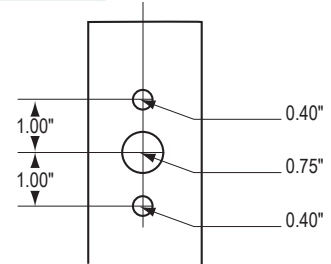

MOUNTING DETAIL



MH vs LED COMPARISON CHART

	400W METAL HALIDE	ATLAS 145W LED
AREA LIGHTS	458 INPUT WATTS 	145 INPUT WATTS 
TOTAL YEARLY COST INC. MAINT.	\$251	\$64
TOTAL YEARLY SAVINGS	-	\$187
POTENTIAL ONE TIME REBATE	\$0	\$100
TOTAL FIRST YEAR SAVINGS	-	\$287
DOLLAR RETURN IN 3 YEARS	-	\$661

Based on 12 hours per day | \$0.10/kWh Utility Rates & Rebates Vary by Location

75% ANNUAL SAVINGS

4 Year Payback

AVERAGE 4 YR ROI **46%**

**PHILIPS
ADVANCE**

Quality LED Drivers



For more information including photometrics, Lighting Facts and DLC visit www.atlasled.com

