

Assembly Sheet - WR316-GAL

1. Installation to be completed in accordance with manufacturer's written specifications and installation instructions.
2. See spec sheet or contact manufacturer for detailed material, finishes, and configuration options.
3. Contact manufacturer for detailed layout.
4. Do not scale drawings.
5. Subject to change without notice.
6. For patent information, visit our [Patent Page](#).

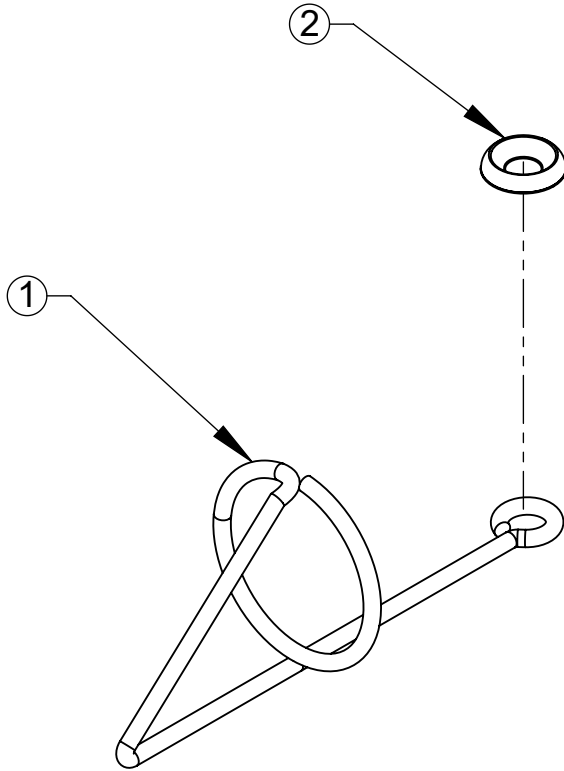

Option 1

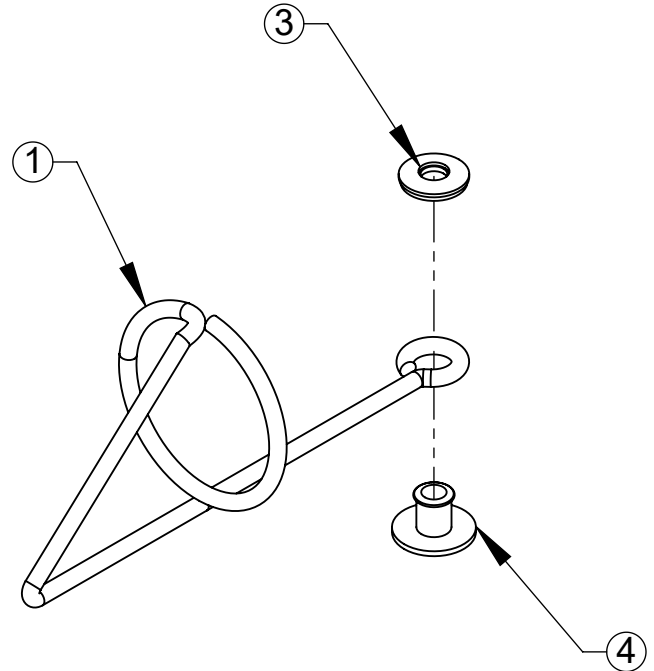

Option 2

ITEM NO.	PART CODE	DESCRIPTION	QTY
1	WR316-GAL	3/16" GALVANIZED STEEL WELDED	1
2	W-CUP SS-#14	SS CUP WASHER #14 (INCLUDED IN POLY KIT CUP WASHER)	1
3	W-NEO SS-.313	SS NEO WASHER .313ID (INCLUDED IN POLY KIT GF NEO WASHERS)	1
4	BUSHING .266X.875	EPDM BUSHING .266X.875 (INCLUDED IN POLY KIT BUSHING .26)	1



289 Harrel Street
Morrisville, VT 05661
Phone: 1.888.766.4273
Fax: 1.888.766.9994
Email: Info@alpinesnowguards.com

Scale: 1:2

11/8/2022