

PD40R and PD400FR-CU Snow Guard Installation Instructions

ROOF TYPES

- Existing Composition (Asphalt) Shingle
- Existing Synthetic Shake or Slate (shown)
(For synthetic materials $\leq 3/8$ " thickness)

INSTALLATION

1. Beginning on 2nd course of roofing material, place the snow guard low enough on the roofing material to leave a minimum gap of $5/8$ ", or at least 3 times the thickness of the roofing material whichever is greater, from the roofing material above (fig. 1).

2. Select option below that best applies to your install (fig. 2):

Option 1: Carefully lift shingle and position snow guard in

place. Attach snow guard using 2 fasteners of a material compatible with snow guard and roof system.

Option 2: Place snow guard in gap between the slates and attach through center of the snow guard strap (vertically), using 2 fasteners of a material compatible with snow guard and roof system.

Option 3: If shingle cannot be lifted or snow guard cannot be slid into place, use 2 fasteners of a material compatible with snow guard and roof system, to attach to the row of shingles below.

3. Caulk fastener heads. Slide sleeve into place to cover fasteners. Top of sleeve must be pushed under the upper course of roofing material by $\geq 1/2$ ".

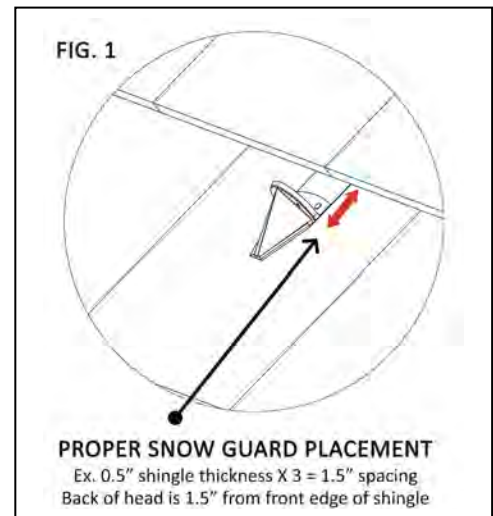
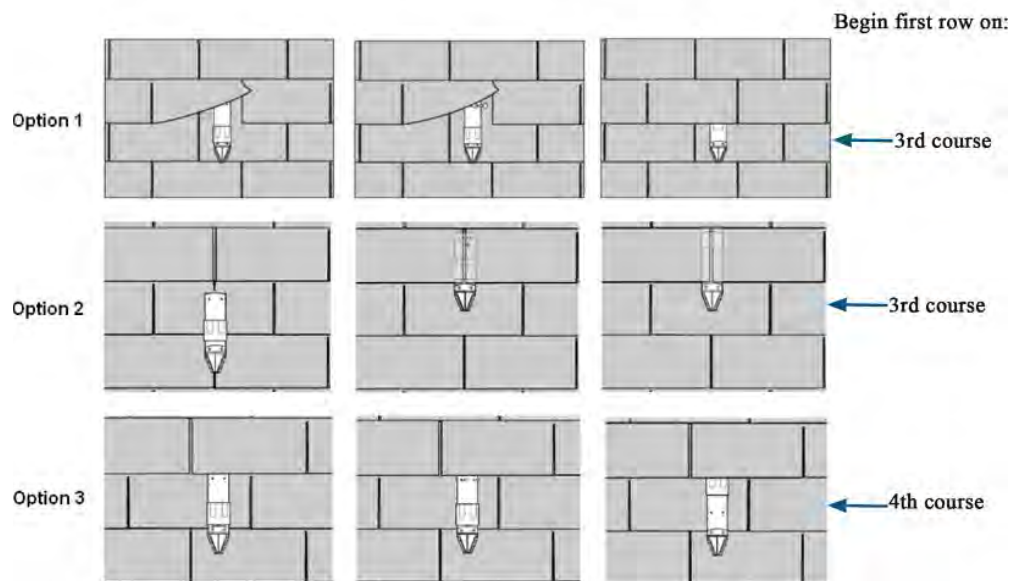

FIG. 2



PD40R and PD400FR-CU Snow Guard Installation Instructions

STANDARD SNOW GUARD LAYOUT OPTIONS

IMPORTANT: All layouts begin with a 3-row pattern. Estimated quantities provided include 3-row pattern. If you have any questions, please contact us at 888-766-4273.

Please use the guidelines below to determine the appropriate layout for your installation.

PROJECT DETAILS				LAYOUT DETAILS		
Roof Type	Rafter Length	Ground Snow Load (PSF)	Roof Pitch		Layout	Est. Snow Guard QTY.
Comp. Shingle	Any	60 psf or Less	6/12 or Less	→	3-Row Pattern	17 per 10' of Eave
	15' or Less	60 psf or Less	7/12 to 16/12	→		
Synthetic Slate	15' or Less	60 psf or Less	16/12 or Less	→		
Comp. Shingle or Synthetic Slate	15' or greater	60 psf or Less	16/12 or Less	→	2 x 4 Pattern	12 per roofing square
	Any	61 - 90 psf	16/12 or Less	→	2 x 3 Pattern	18 per roofing square
	Any	91 - 120 psf	16/12 or Less	→	2 x 2 Pattern	24 per roofing square

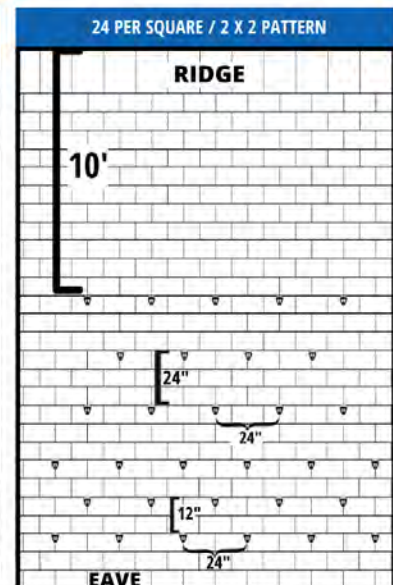
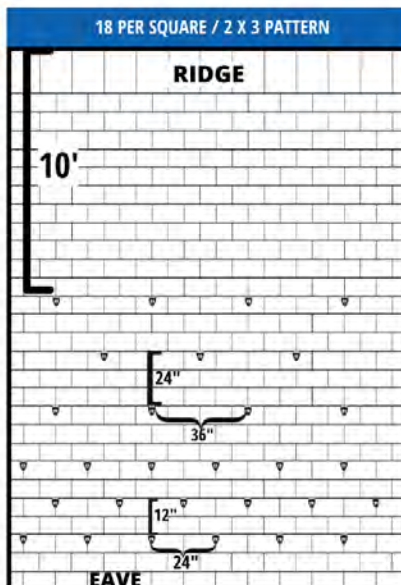
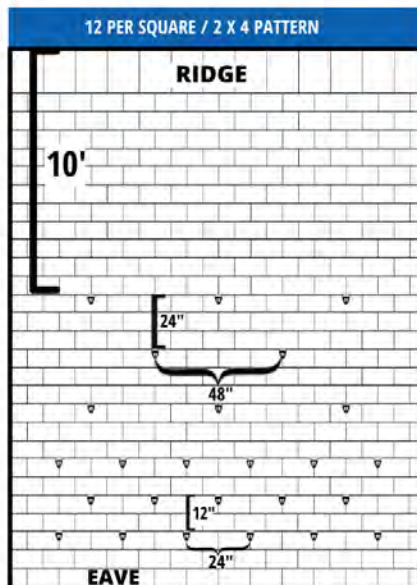
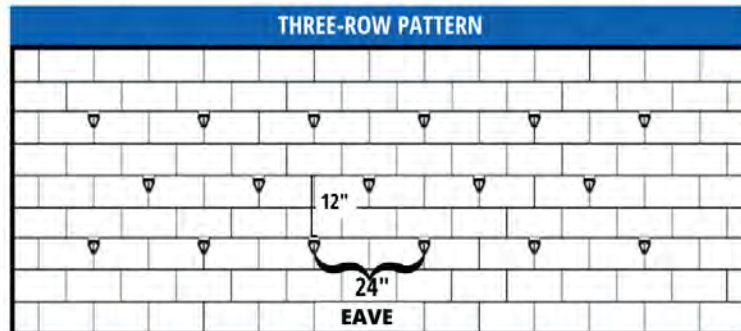

Document Version 03.14.2023
07 72 53 Snow Guards