

Assembly Sheet - ASG33G-T-AL

1. Installation to be completed in accordance with manufacturer's written specifications and installation instructions.
2. See spec sheet or contact manufacturer for detailed material, finishes, and configuration options.
3. Contact manufacturer for detailed layout.
4. Do not scale drawings.
5. Subject to change without notice.
6. For patent information, visit our [Patent Page](#).

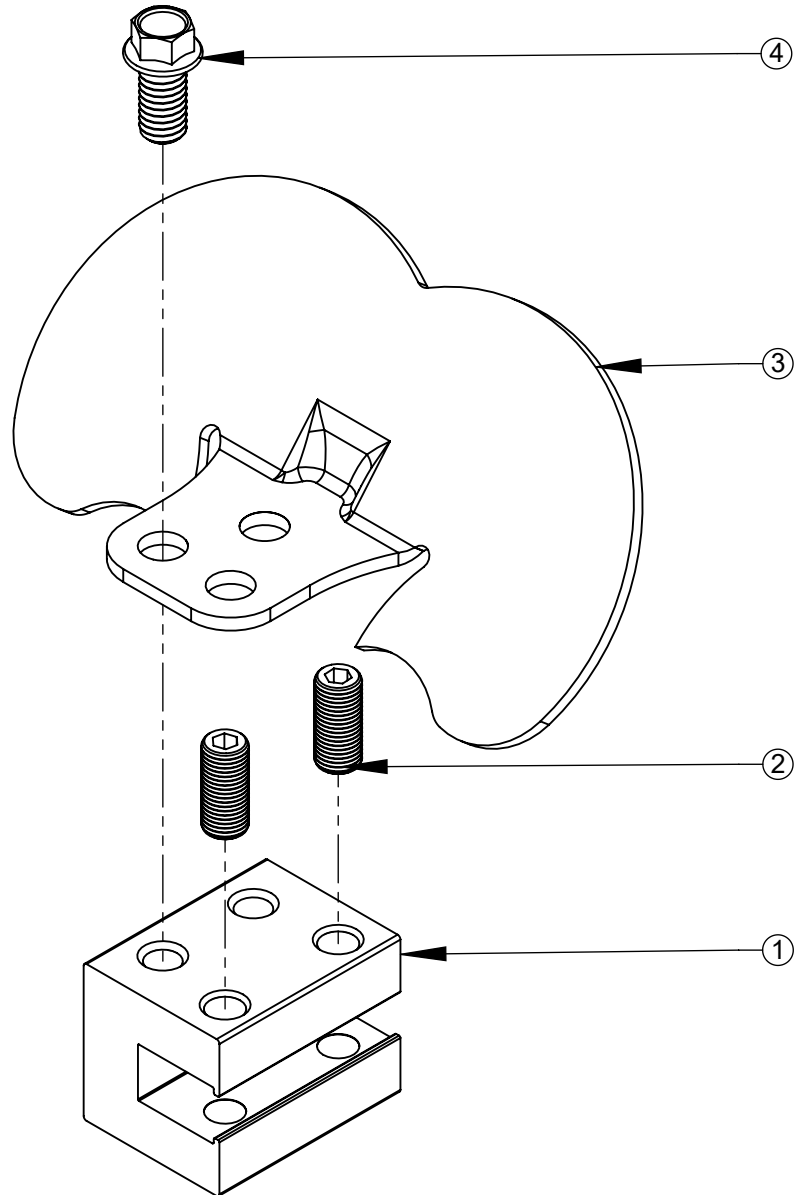

ITEM NO.	PART CODE	DESCRIPTION	QTY
1	ASGU2T-AL	2" UTILITY T BLOCK SSR-AL	1
2	SET-O SS-.375-24X875	SS SET SCREW OP .3750-24X.875 (INCLUDED IN POLY KIT SET SCW.875)	2
3	FLAG-PD33-AL	FLAG-PD33-AL	1
4	B-FL SS-.375-16X.75	SS FLANGE BOLT .3750-16X.75 (INCLUDED IN POLY KIT ASG U2)	1



289 Harrel Street
Morrisville, VT 05661
Phone: 1.888.766.4273
Fax: 1.888.766.9994
Email: Info@alpinesnowguards.com

Scale: 2:3

6/14/2022