

704 & 710 FITZWILLIAM STREET

1125 SQ. FT.

9'-0" CEILING

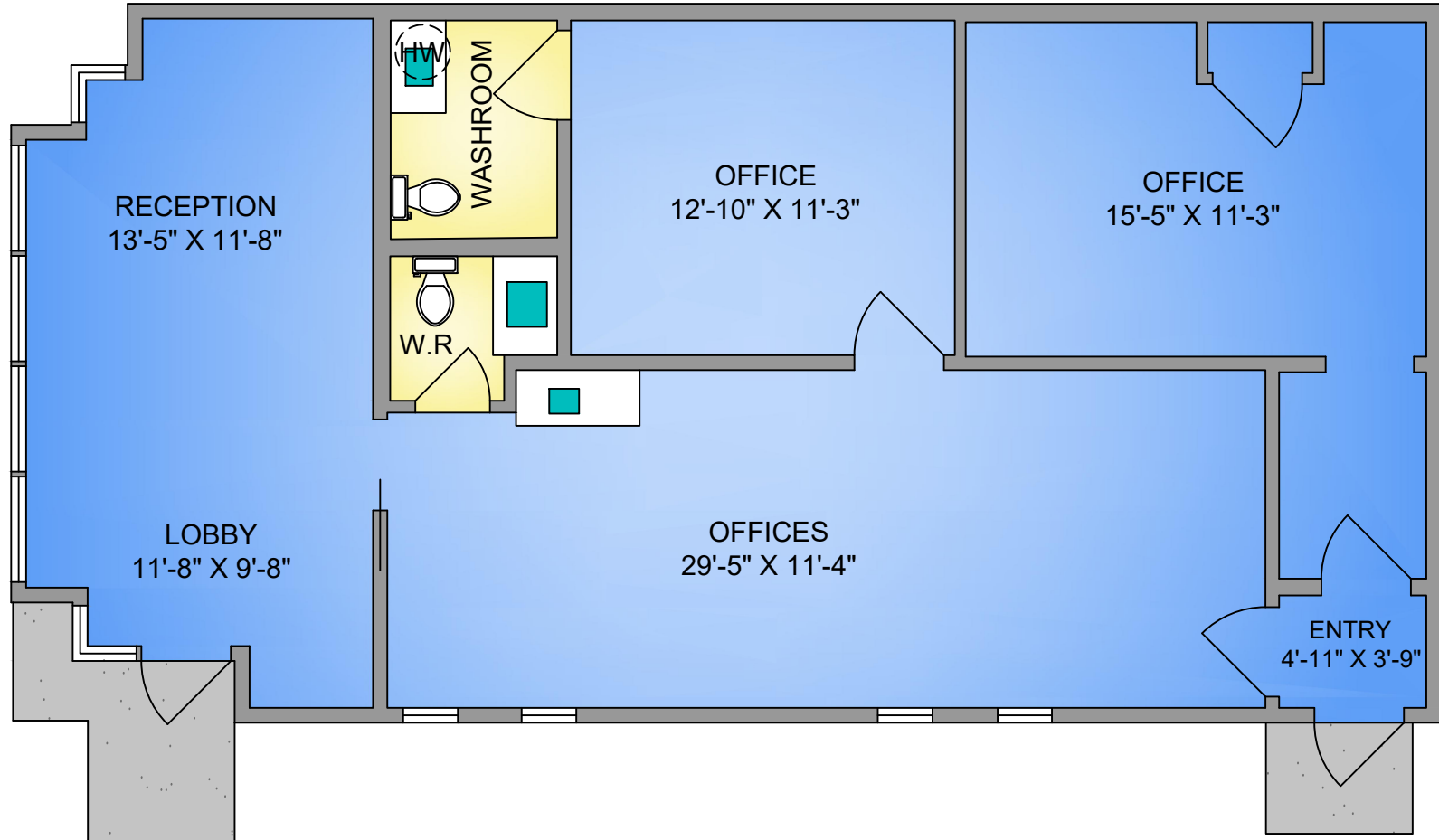

NORTH

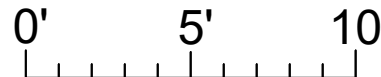
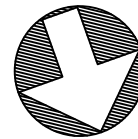

SCALE

704 & 710 FITZWILLIAM STREET
AUGUST 16, 2024

Prepared by PROPER MEASURE MID ISLAND for the exclusive use of LAYZELL DREGER & ASSOCIATES
Plans may not be 100% accurate. Buyer must verify any critical measurement.
Private resale or modification of floor plans to a third party by any individual or entity other than Proper Measure Mid Island is strictly prohibited

FLOOR	AREA (SQ. FT.)
TOTAL	1125