

# CENTER FLIGHT STICK MOUNT

## Assembly Guide

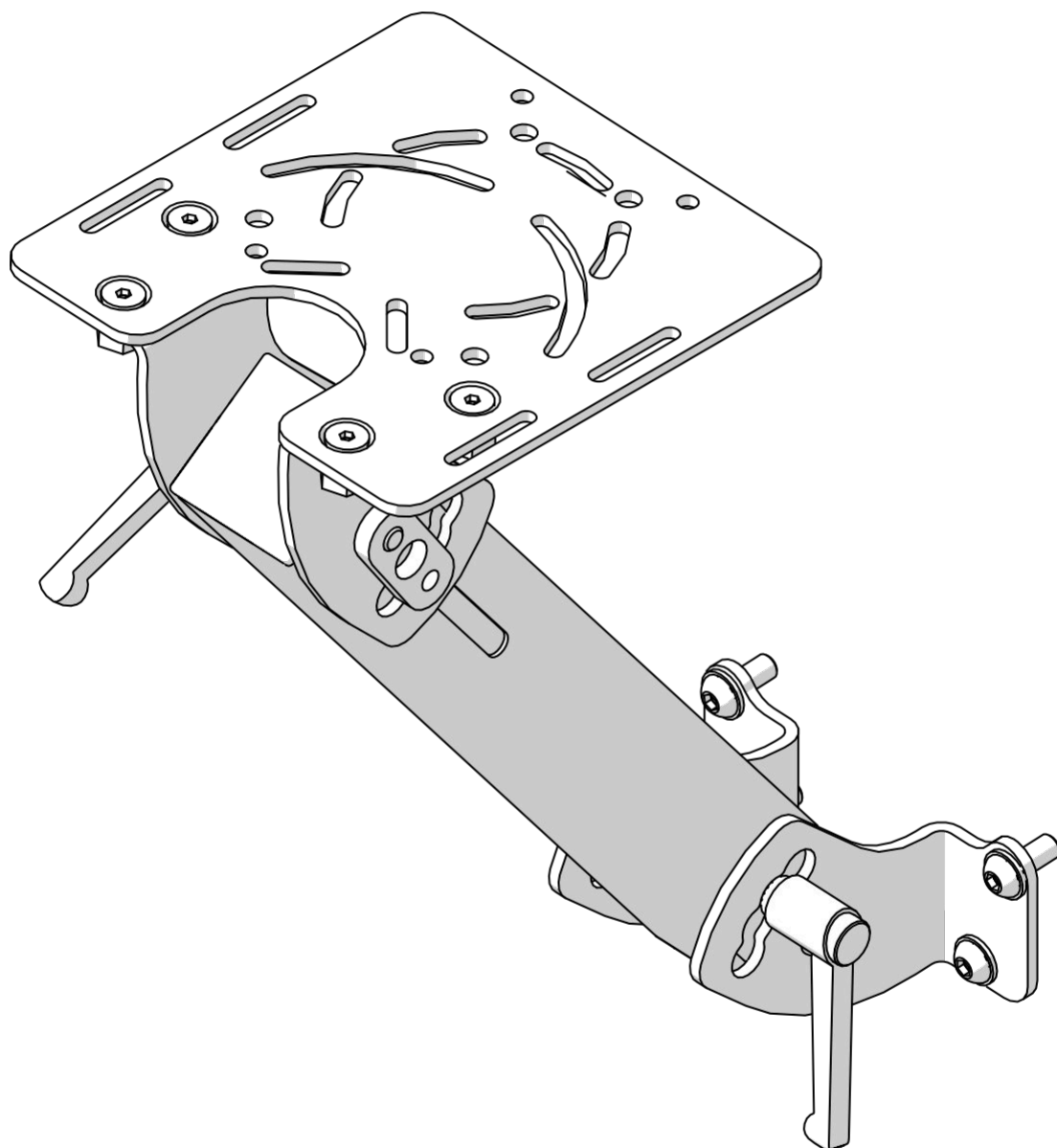

**IMPORTANT:** Different regions may have different models. Please ensure the part number below matches that on your product's box.

**FS-CST**



**TRAK RACER**

Published Apr 15, 2025

# TABLE OF CONTENTS

3 Symbol Legend

---

4 Part List

---

5 Assembly Notes

---

8 Assembly Instructions

---

9 TR-40s

---

11 TR-80s

---

13 TR-120s

---

16 TR-160s S2

---

19 TR-160s



**IMPORTANT:** Since there are different versions of each product based on your region, please make sure you are using the correct set of instructions. The part number below should match the one on your box.



**IMPORTANT:** Due to the nature of cut aluminum profiles, some metal shavings may remain despite our thorough QA cleaning process. We recommend opening boxes and packaging on a hard surface.



**NOTE:** Some screws and washers may be pre-installed. These are included in the parts list and will need to be loosened and reattached according to the instructions.



Recommended: Two people for the task



Tighten the hardware



Keep the hardware loose for adjustments



Make the necessary adjustments



Break the tab off the corner bracket



Safety glasses required



Attention/Priority needed



Reserve for the next step



Mirrored components (same on both sides)

# PART LISTS



Mount Assembly

MLA

x1

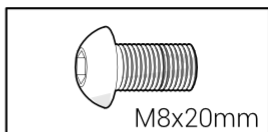

M8x20mm

M8x20 Button Hex Screw

SR-M8-20

x4

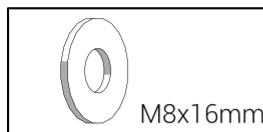

M8x16mm

M8x16 Washer (Flat)

WF-M8-16

x4

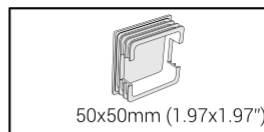

50x50mm (1.97x1.97")

50x50 End Cap

EC-50

x2

## INCLUDED TOOLS

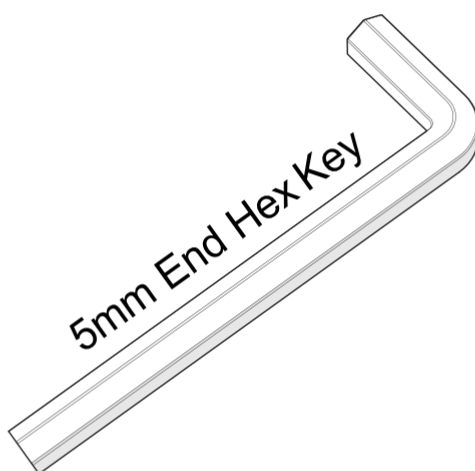

### INSTALLATION ORDER FOR SCREWS & WASHERS

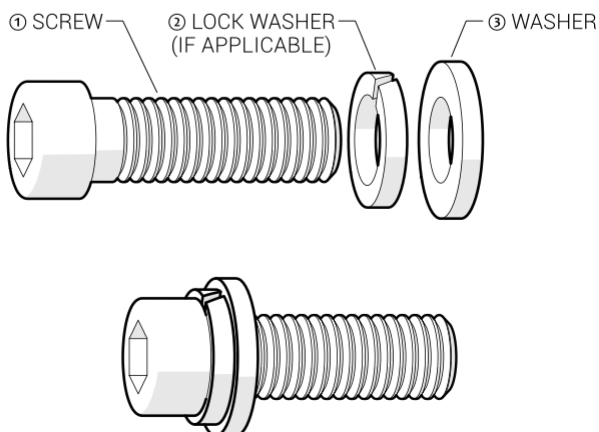

### HOW TO MEASURE SCREWS

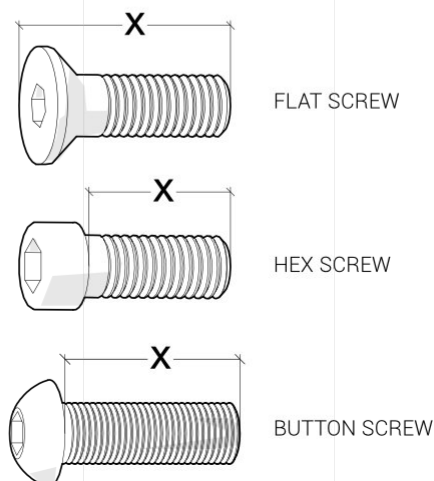

# NOTE

## NS-M8 & NS-M6

Slide T-Nuts into the ends of the profiles. Some must be added early, so follow the steps in this manual carefully.

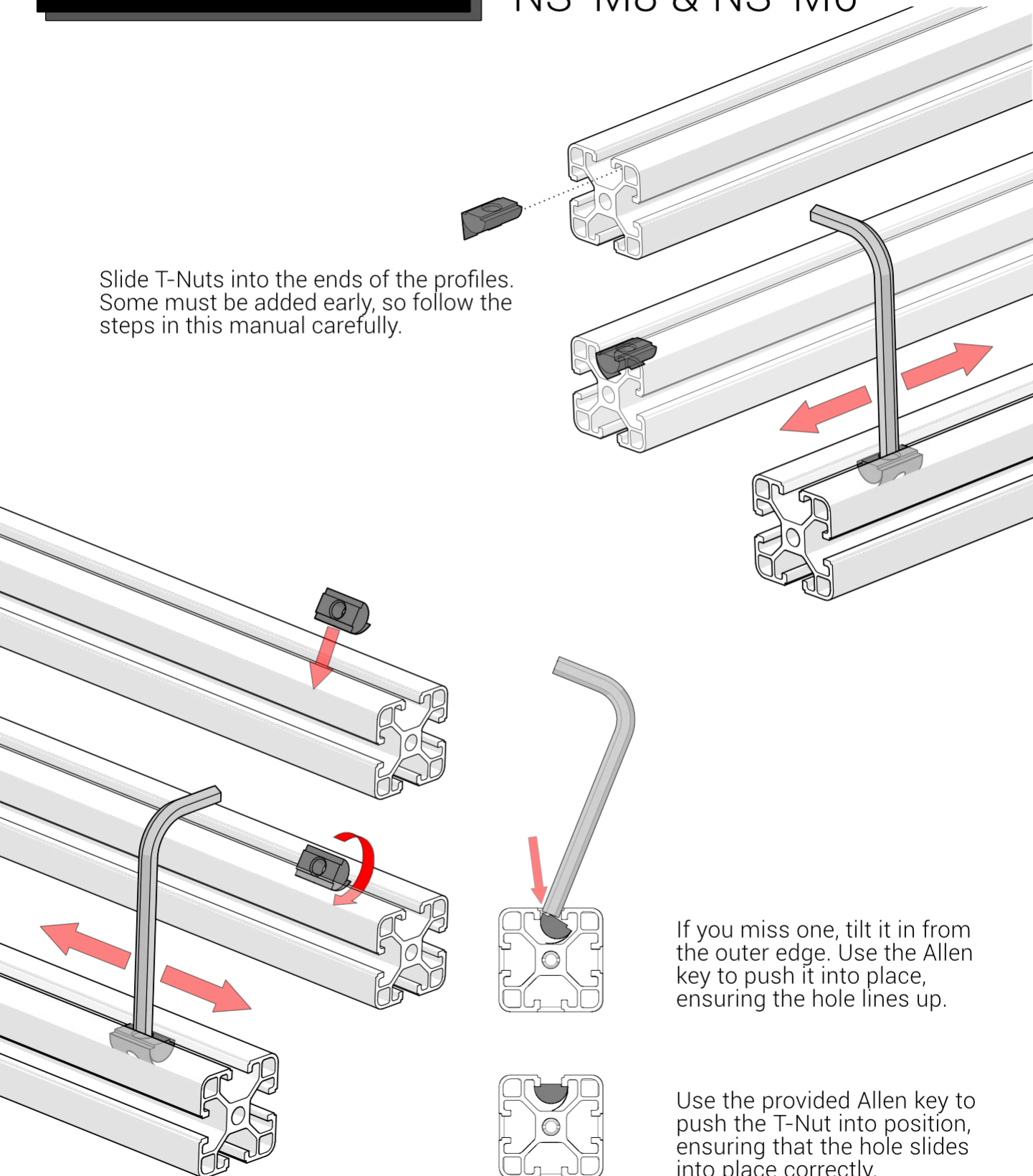

If you miss one, tilt it in from the outer edge. Use the Allen key to push it into place, ensuring the hole lines up.

Use the provided Allen key to push the T-Nut into position, ensuring that the hole slides into place correctly.

# NOTE

*The handle screws (S7 & S27) are ratcheted to allow for tightening and loosening when space for rotation is limited. Simply pull the handle out and turn handle into position and push handle back in to engage thread.*

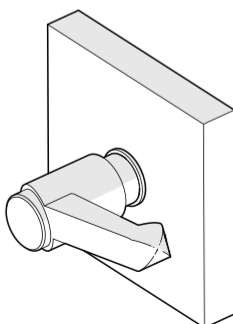
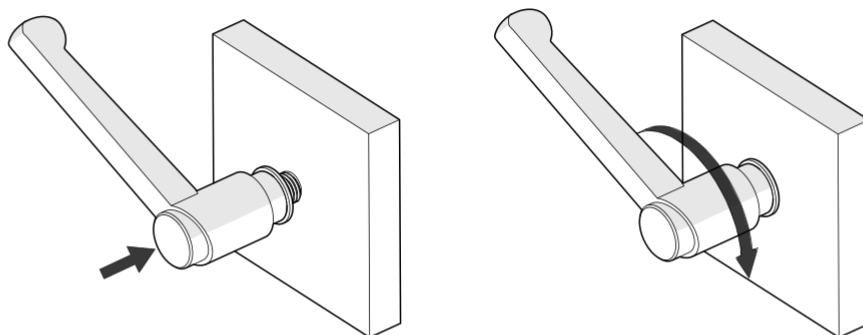
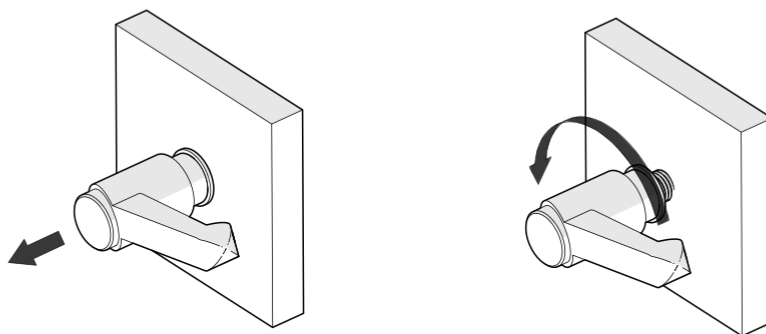
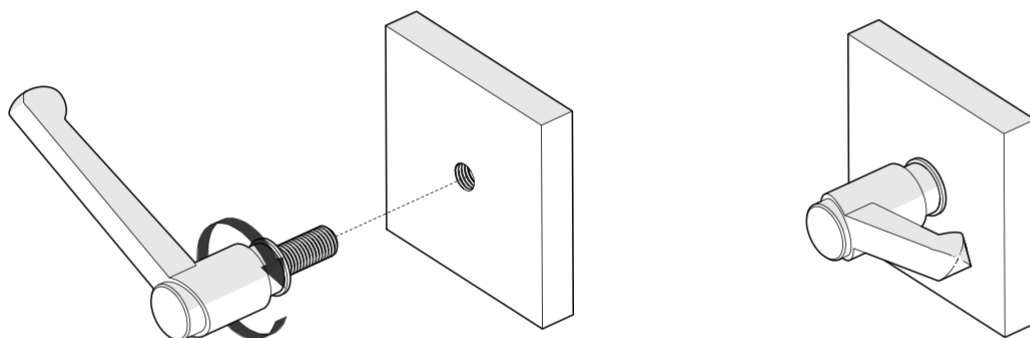

# NOTE

*These parts are adjustable and can be rotated to fit comfortably after installation on the simulator.*

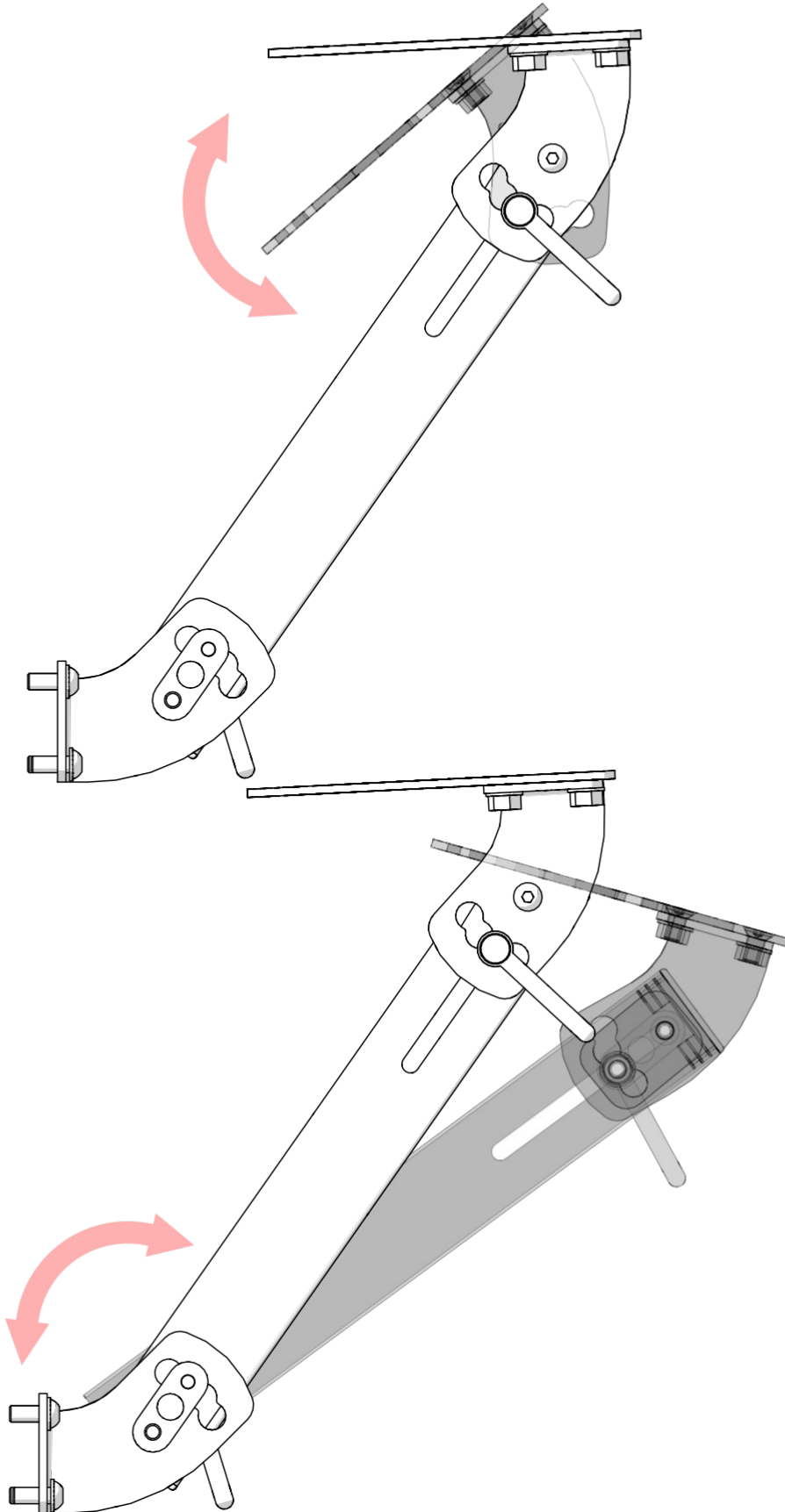

# 1

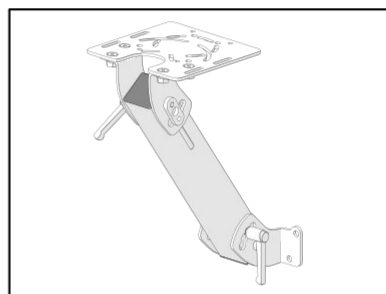
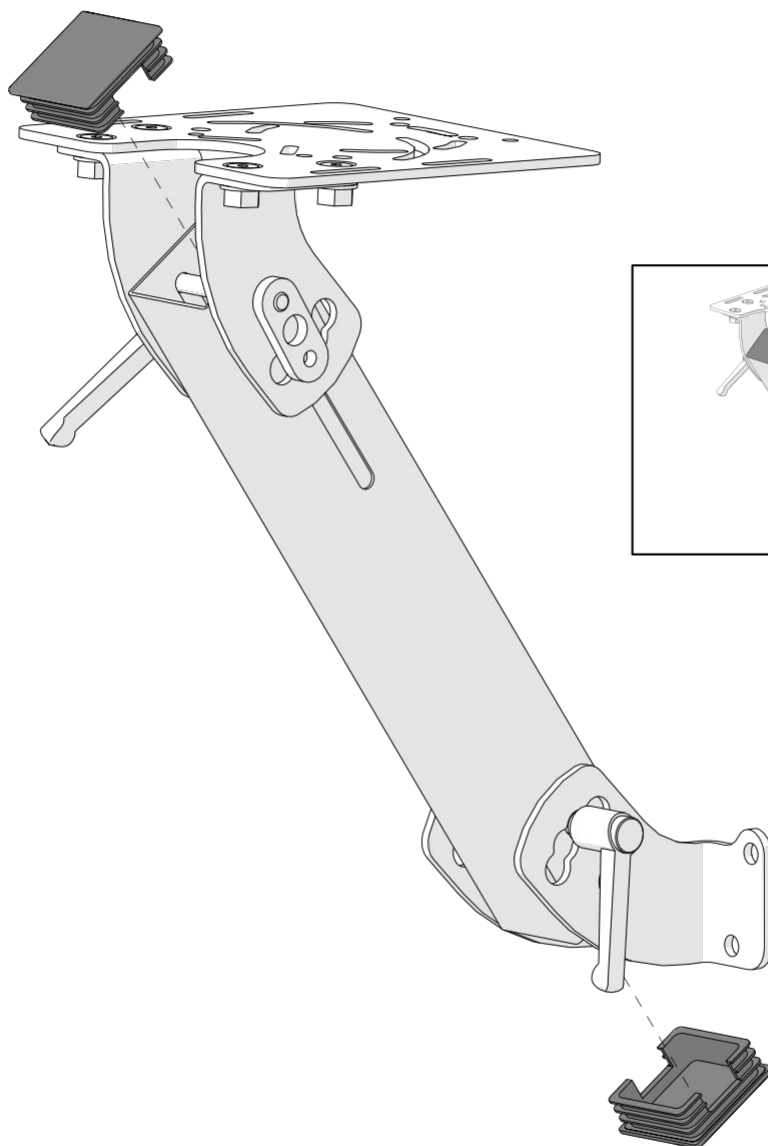
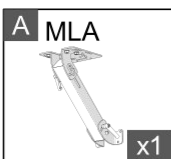



# TR-40s

# 2

**A** NS-M8



M8  
x2

**B** SR-M8-20

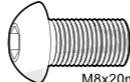

M8x20mm  
x2

**C** WF-M8-16



M8x16mm  
x2

**NOTE:**

- First, slide in the nuts, then install the stick mount using screws and washers.

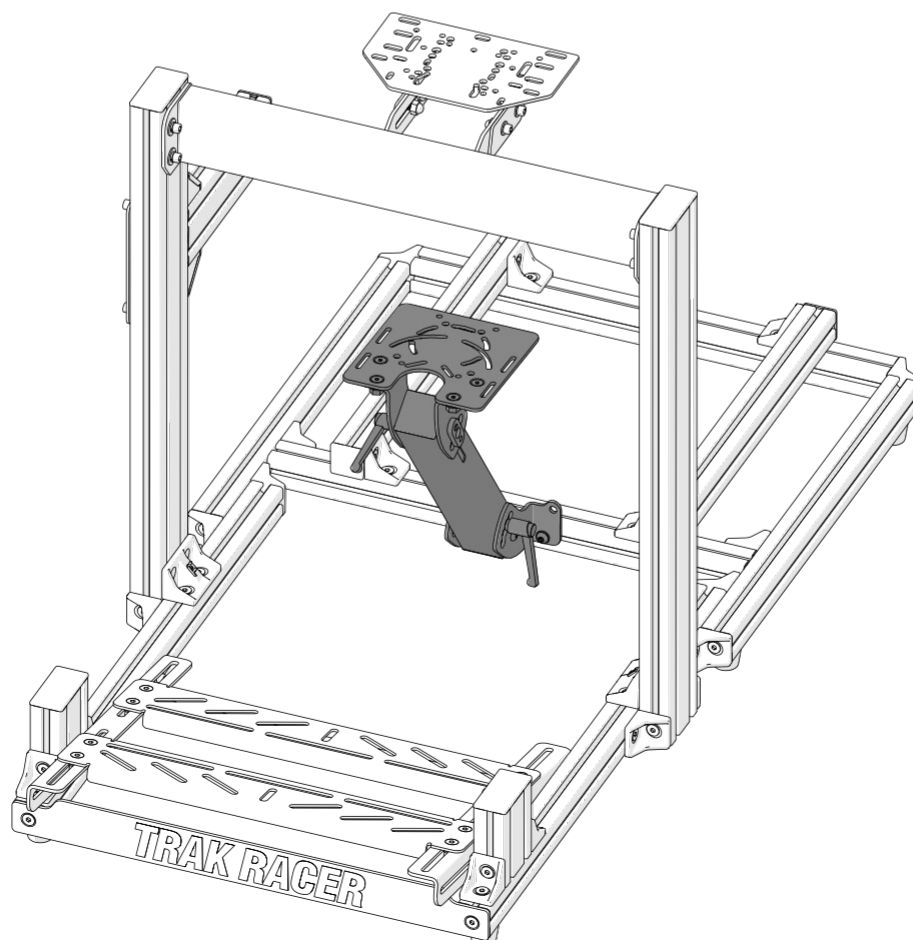
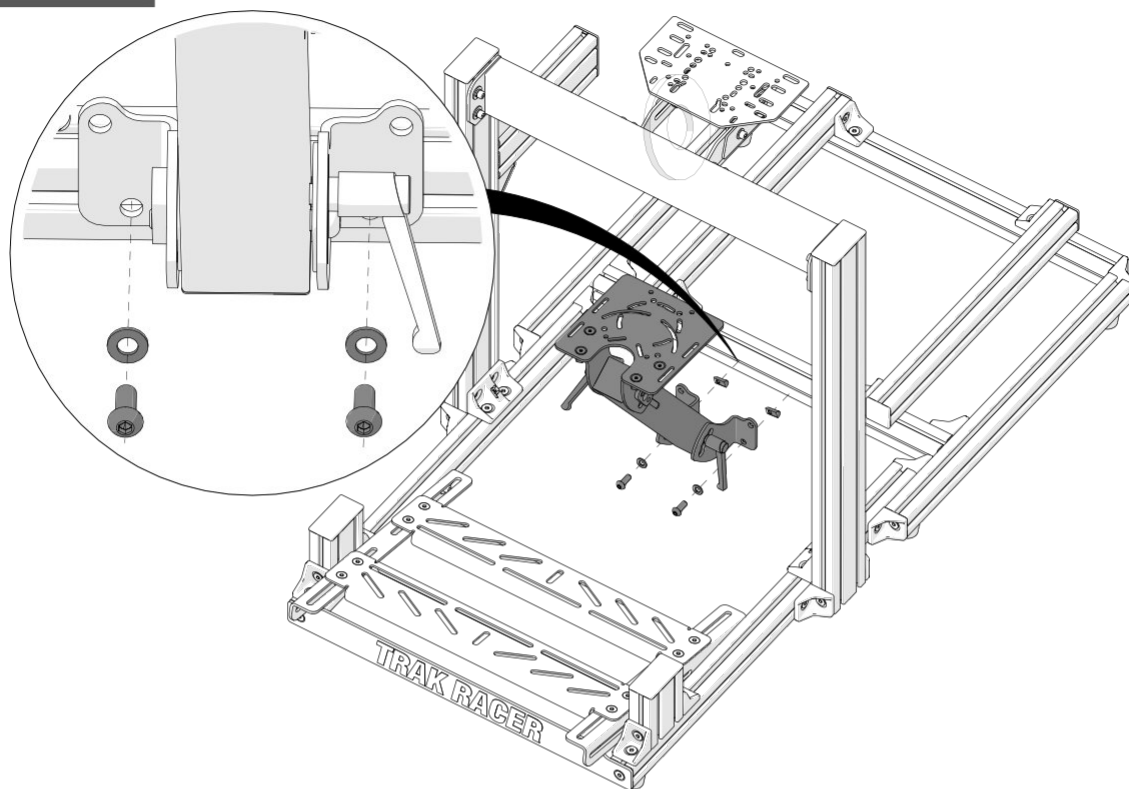

# TR-80s

# 2

**A** NS-M8



M8  
x4

**B** SR-M8-20

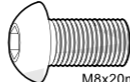

M8x20mm  
x4

**C** WF-M8-16



M8x16mm  
x4

**NOTE:**

- First, slide in the nuts, then install the stick mount using screws and washers.

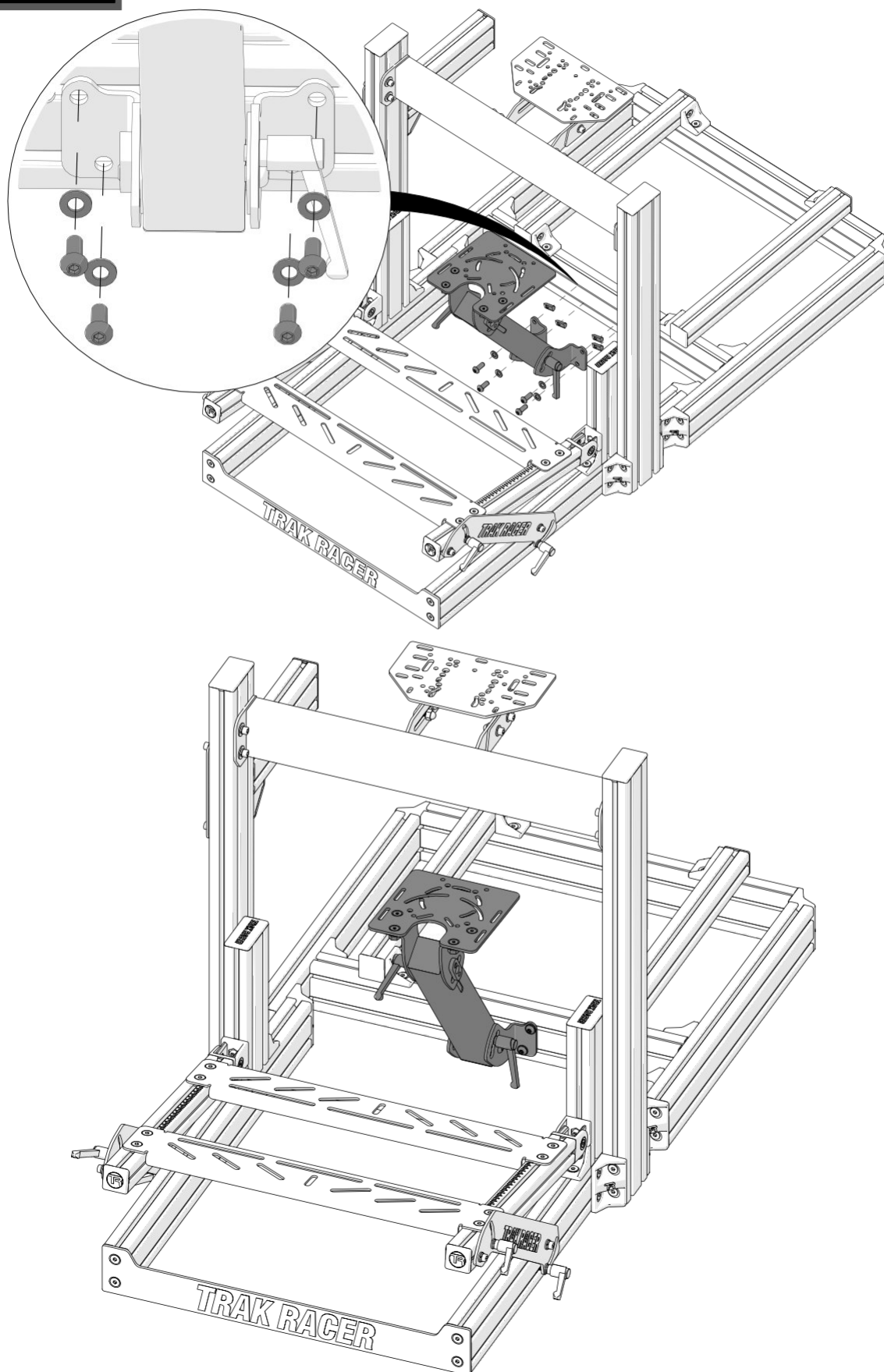

# TR-120s

# 2a

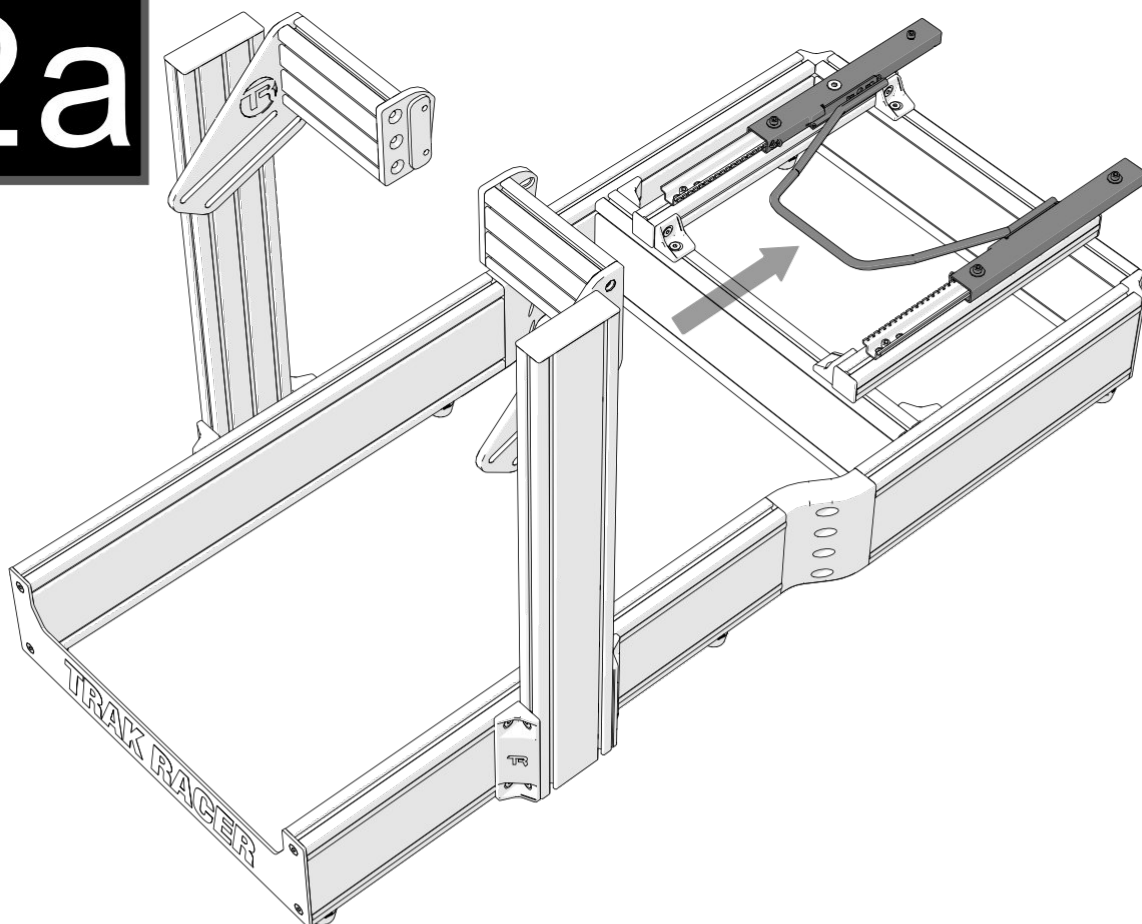

# 2b

**A** NS-M8

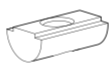

M8  
x2

**B** SR-M8-20

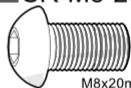

M8x20mm  
x2

**C** WF-M8-16

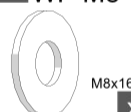

M8x16mm  
x2

**NOTE:**

- First, slide in the nuts, then install the stick mount using screws and washers.

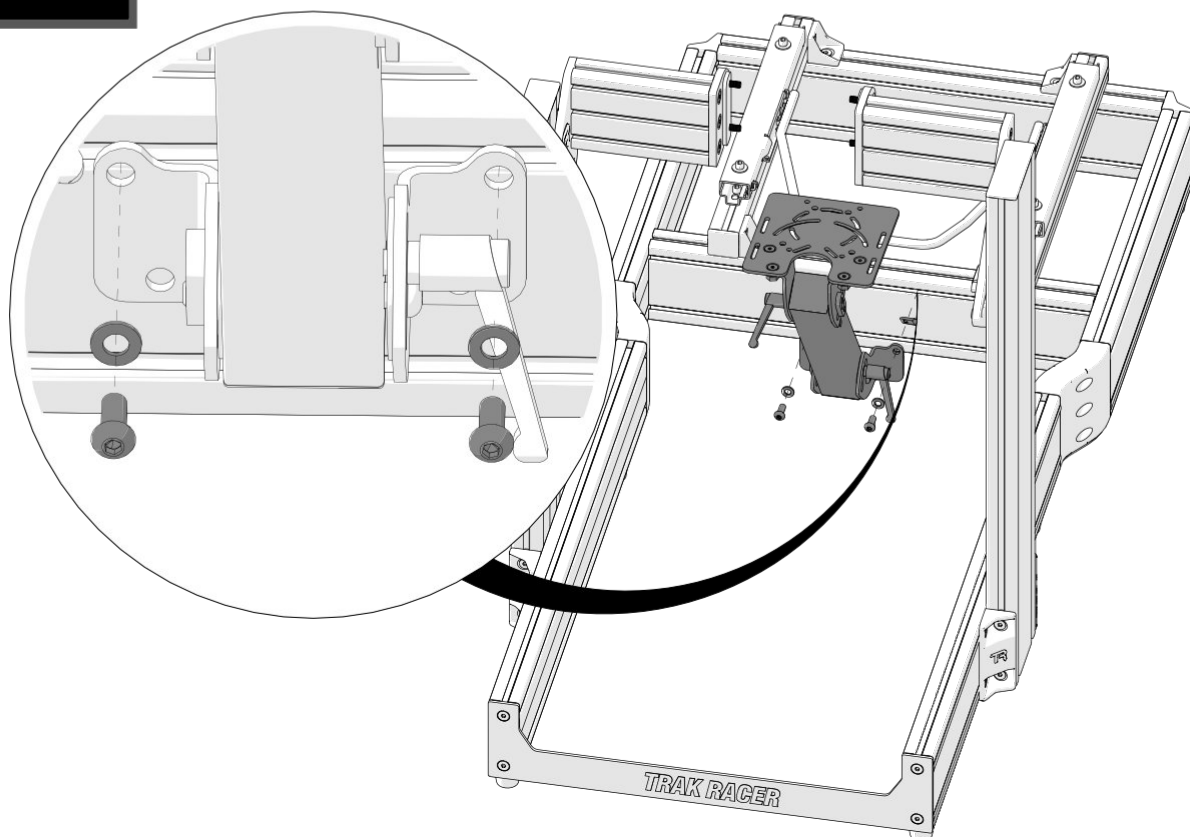

2c

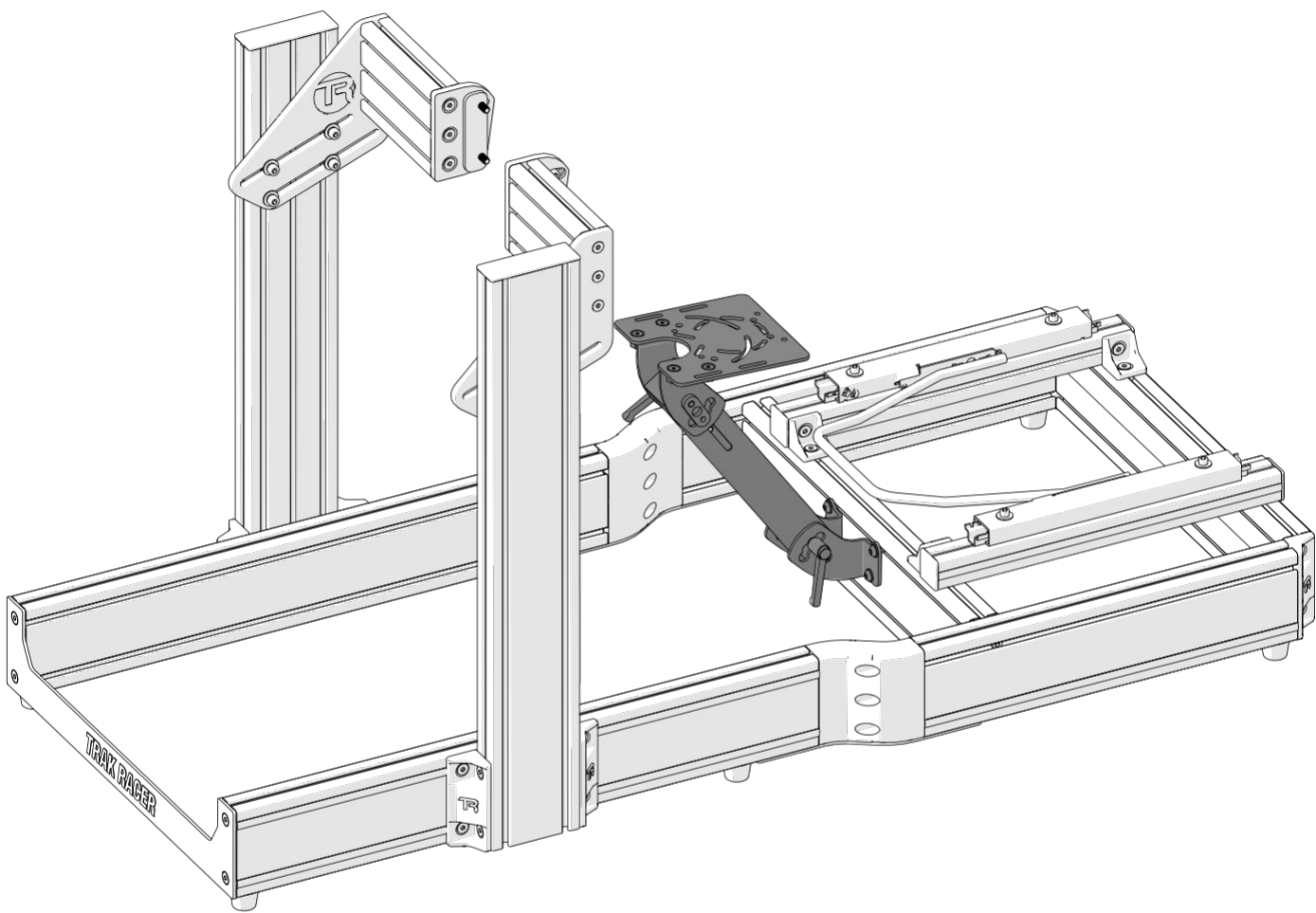

TR-160s  
S2



# 2a

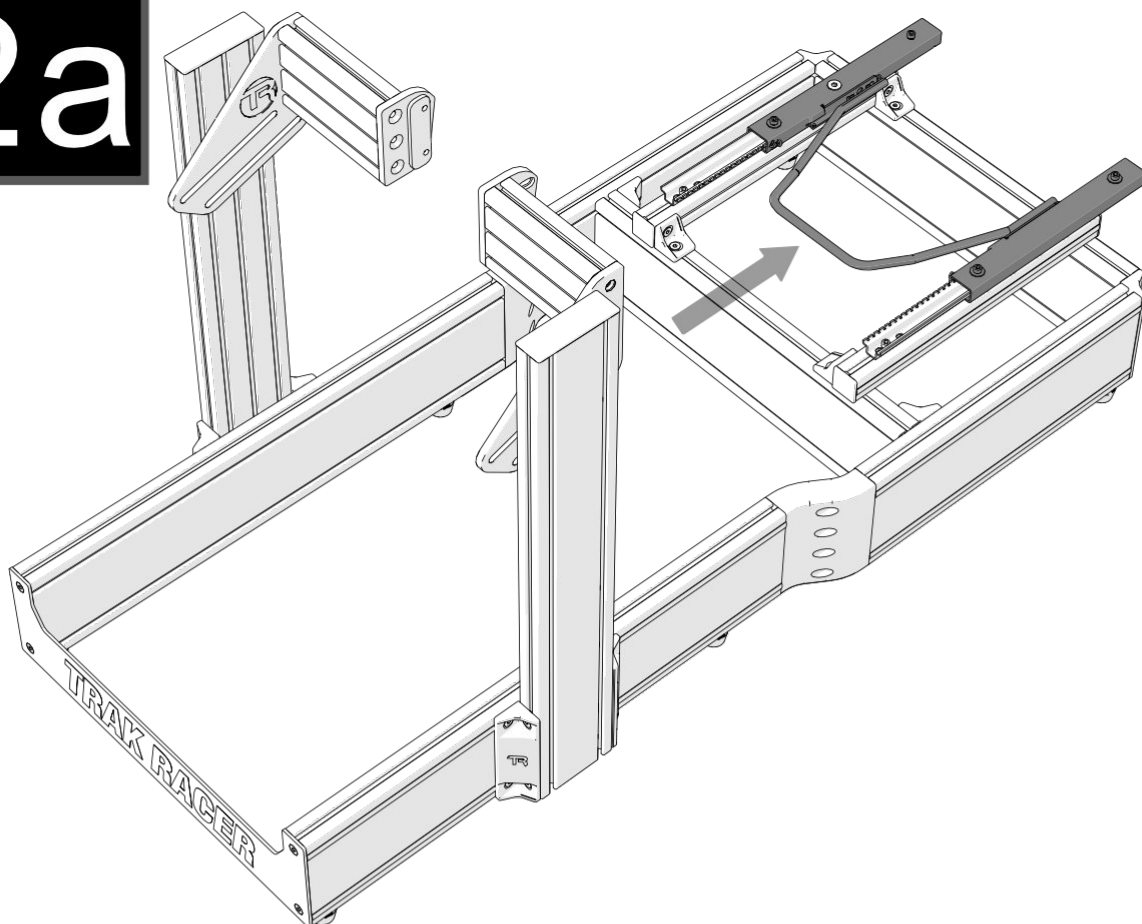

# 2b

**A** NS-M8

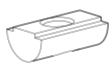

M8  
x2

**B** SR-M8-20

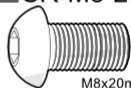

M8x20mm  
x2

**C** WF-M8-16



M8x16mm  
x2

**NOTE:**

- First, slide in the nuts, then install the stick mount using screws and washers.

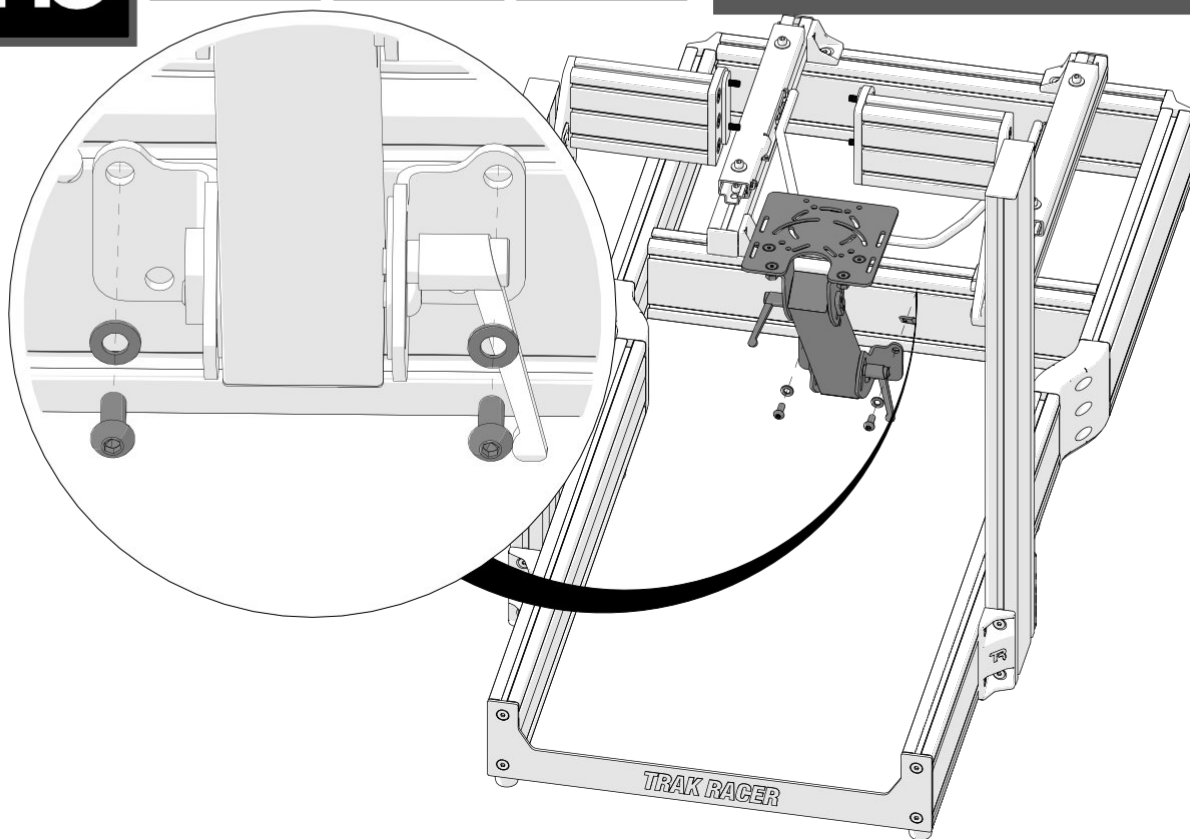

2c

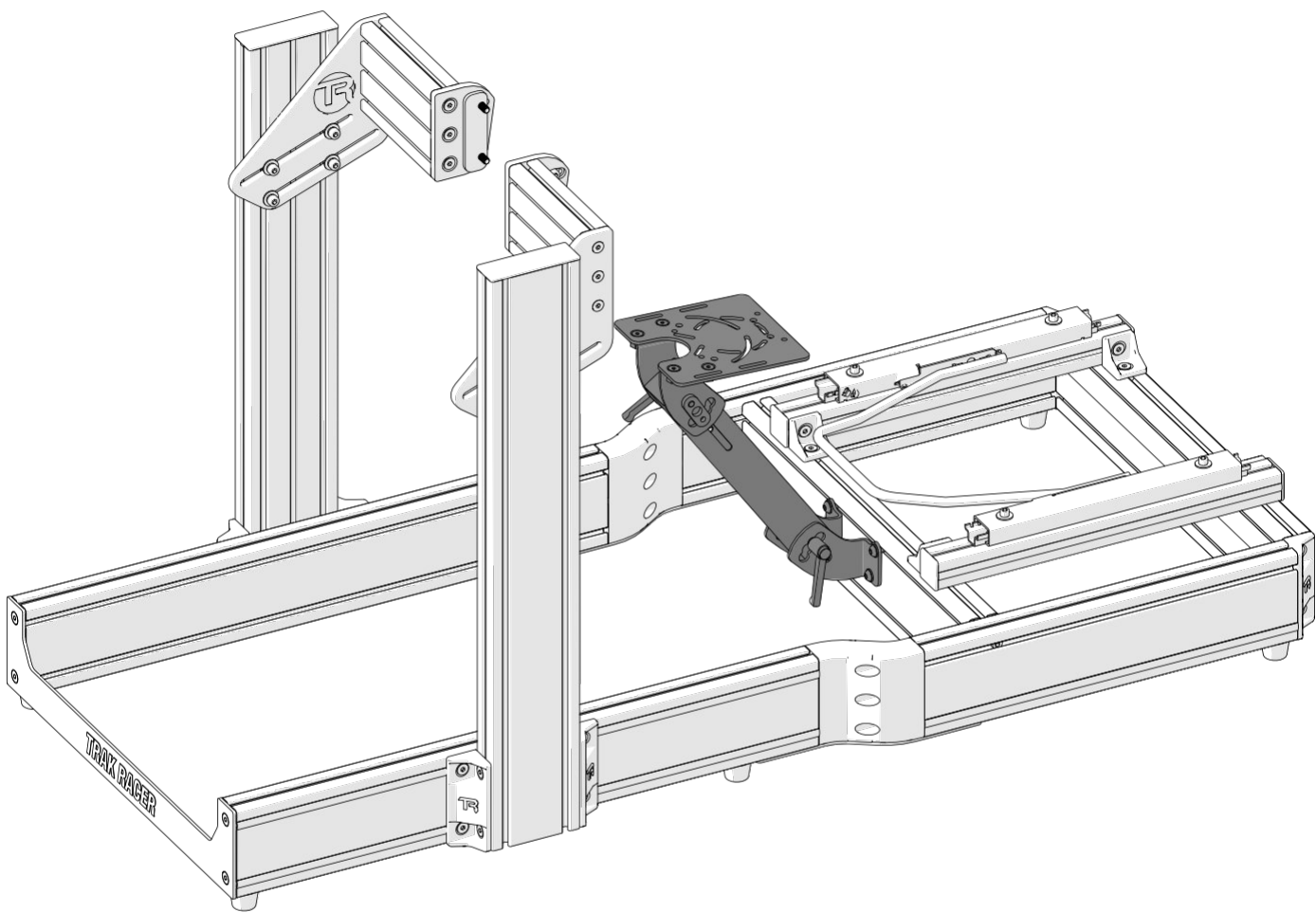

TR-1605

# 2a

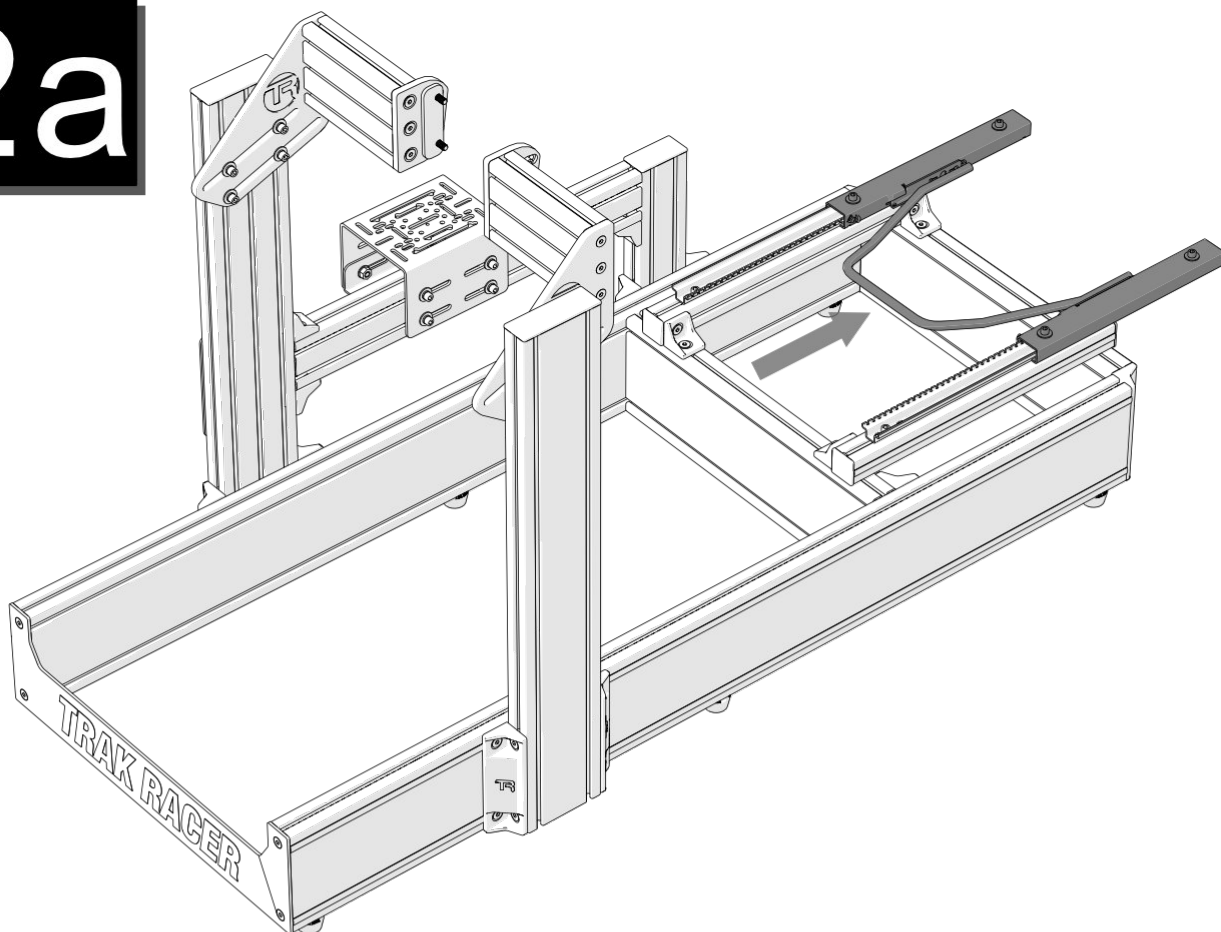

# 2b

A NS-M8

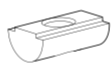

M8  
x2

B SR-M8-20

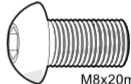

M8x20mm  
x2

C WF-M8-16



M8x16mm  
x2

**NOTE:**

- First, slide in the nuts, then install the stick mount using screws and washers.

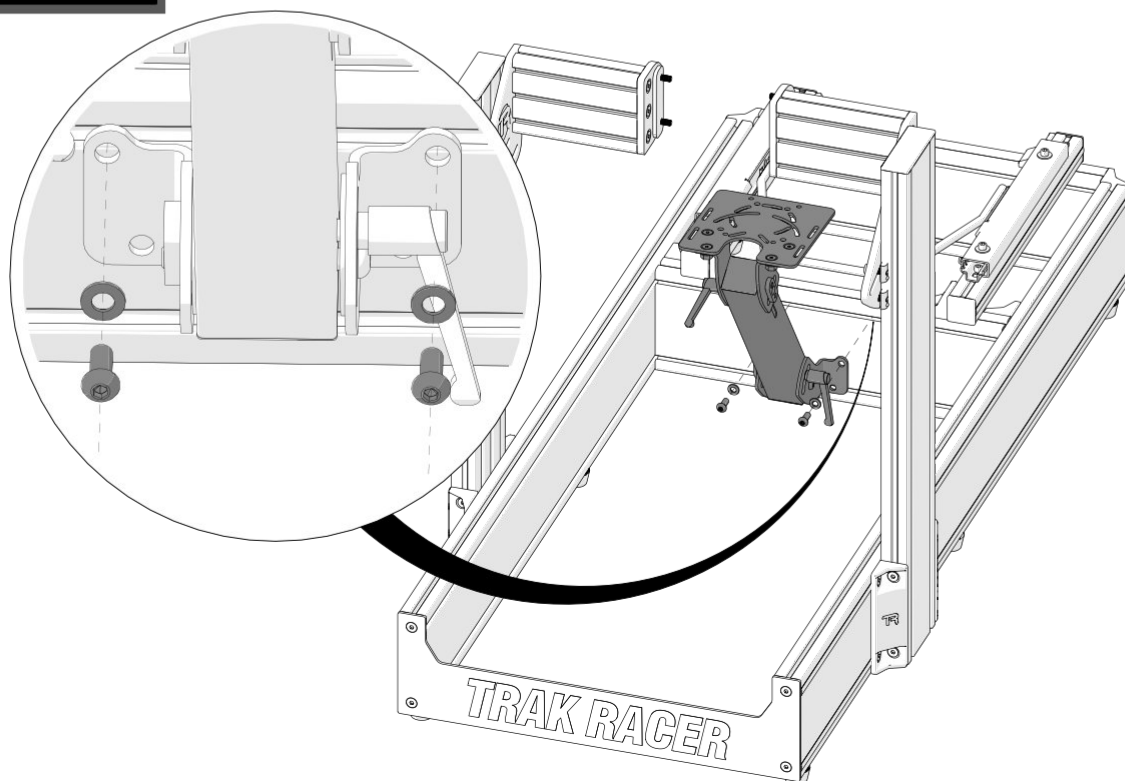

2c

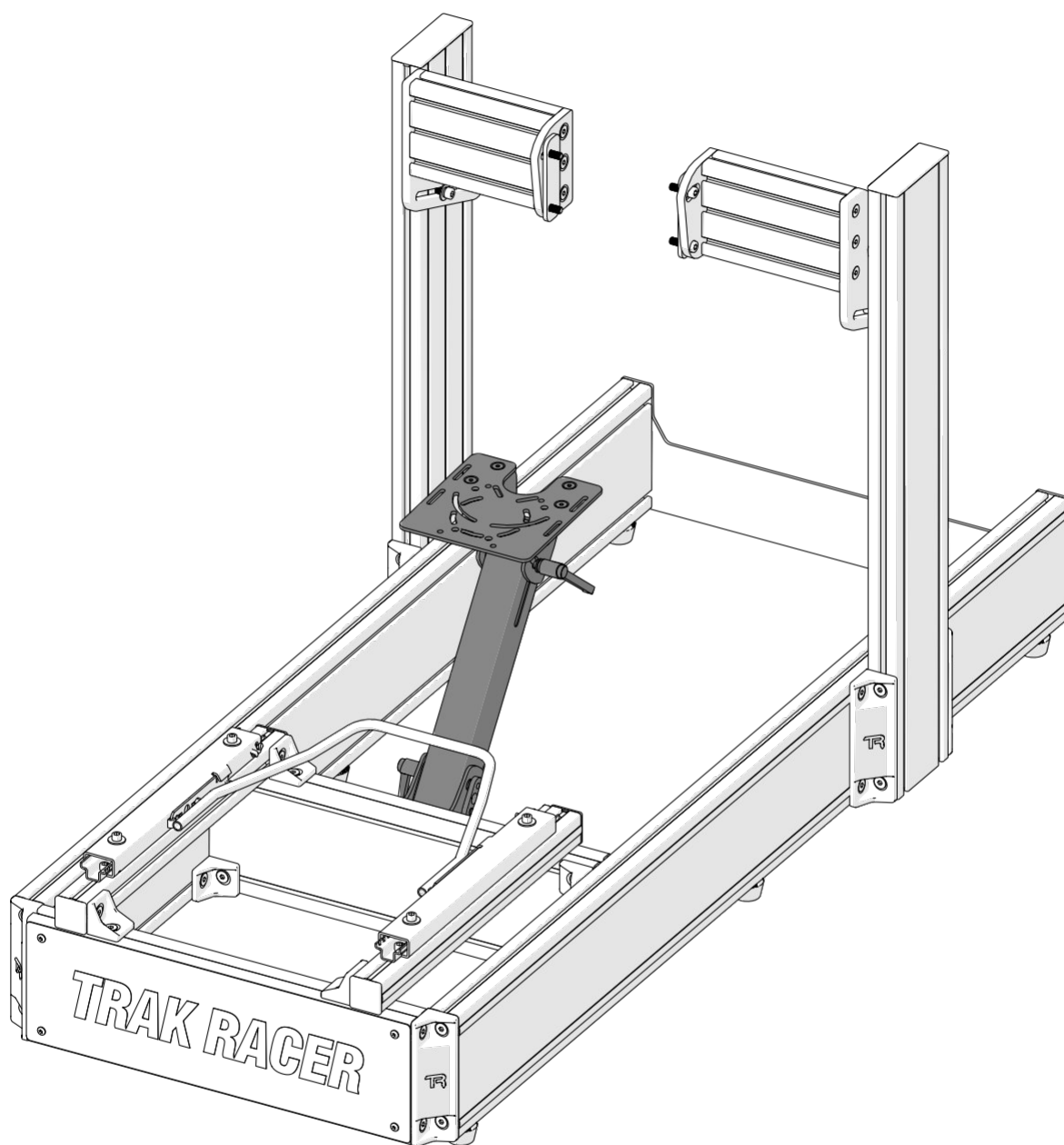

# FINISHED



Share your build online and tag us to be featured!



@trakracer



@trakracer



@trak\_racer