

CENTER FLIGHT STICK MOUNT

Assembly Guide

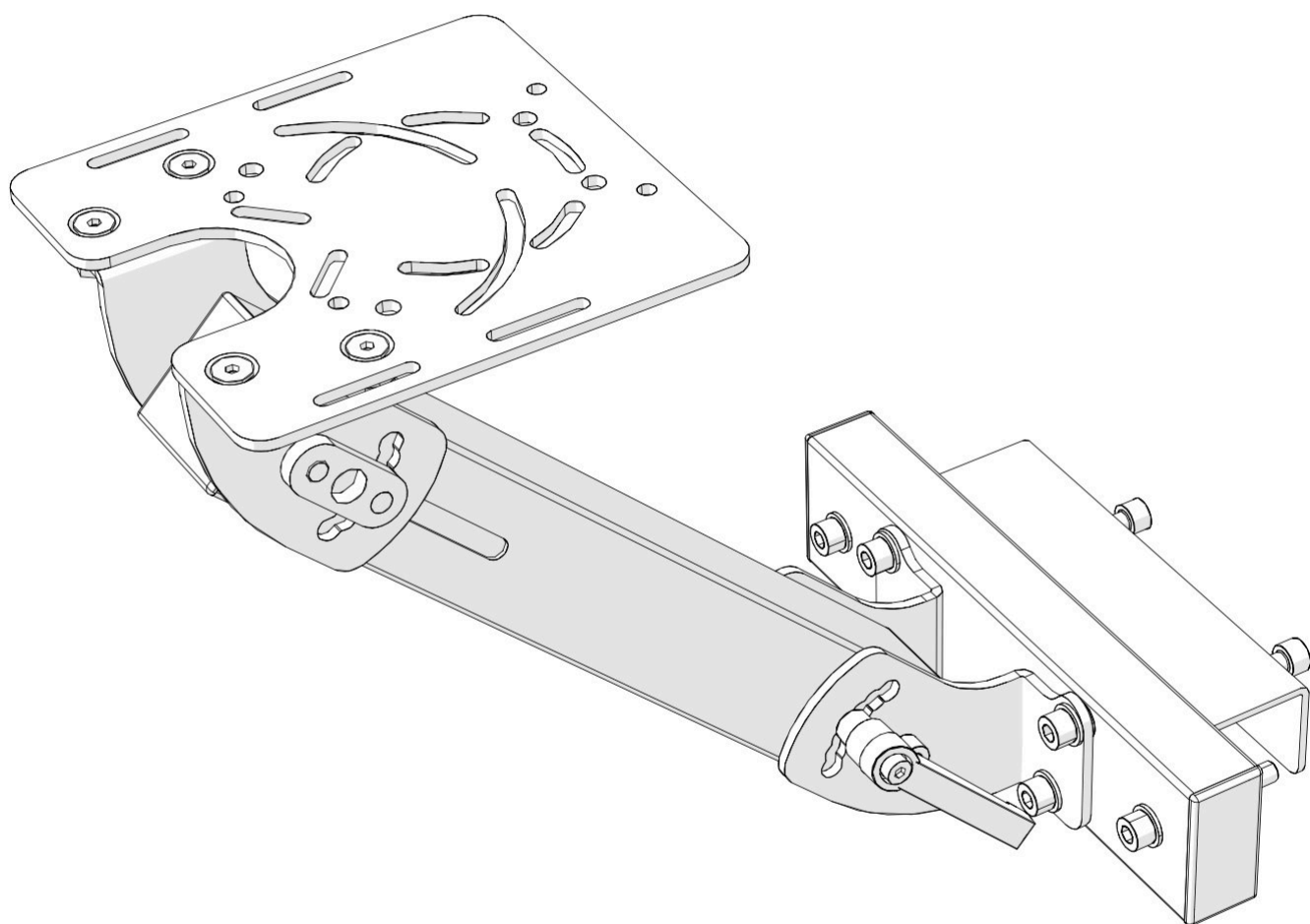

IMPORTANT: Different regions may have different models. Please ensure the part number below matches that on your product's box.

FS-CST2



TRAK RACER

Published Apr 15, 2025

TABLE OF CONTENTS

3 Symbol Legend

4 Part List

5 Assembly Notes

8 Assembly Instructions

9 TR8

12 TRX

15 TR-40s

20 TR-80s

25 TR-120s

32 TR-160s S2

39 TR-1605



IMPORTANT: Since there are different versions of each product based on your region, please make sure you are using the correct set of instructions. The part number below should match the one on your box.



IMPORTANT: Due to the nature of cut aluminum profiles, some metal shavings may remain despite our thorough QA cleaning process. We recommend opening boxes and packaging on a hard surface.



NOTE: Some screws and washers may be pre-installed. These are included in the parts list and will need to be loosened and reattached according to the instructions.



Recommended: Two people for the task



Tighten the hardware



Keep the hardware loose for adjustments



Make the necessary adjustments



Break the tab off the corner bracket



Safety glasses required



Attention/Priority needed



Reserve for the next step



Mirrored components (same on both sides)

PART LISTS

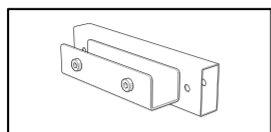

Fixed Welded Mounting

FWM

x1



Mount Assembly

MLA

x1

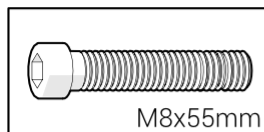

M8x55 Cap Hex Screw

SH-M8-55

x2

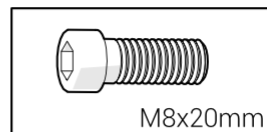

M8x20 Cap Hex Screw

SH-M8-20

x6

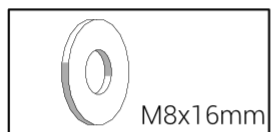

M8x16 Washer (Flat)

WF-M8-16

x6

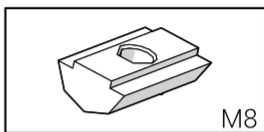

M8 T-Nut

NS-M8

x2

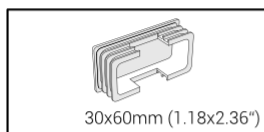

30x60 End Cap

EC-60

x2

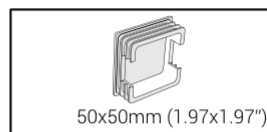

50x50 End Cap

EC-50

x2

INCLUDED TOOLS



INSTALLATION ORDER FOR SCREWS & WASHERS

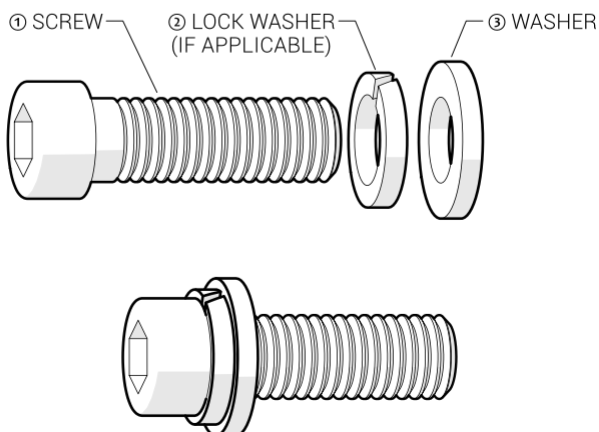

HOW TO MEASURE SCREWS

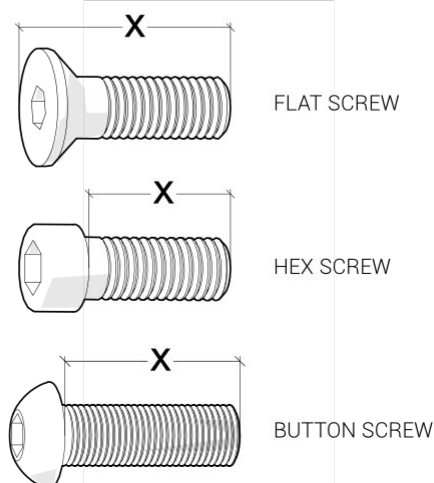

NOTE

NS-M8 & NS-M6

Slide T-Nuts into the ends of the profiles. Some must be added early, so follow the steps in this manual carefully.

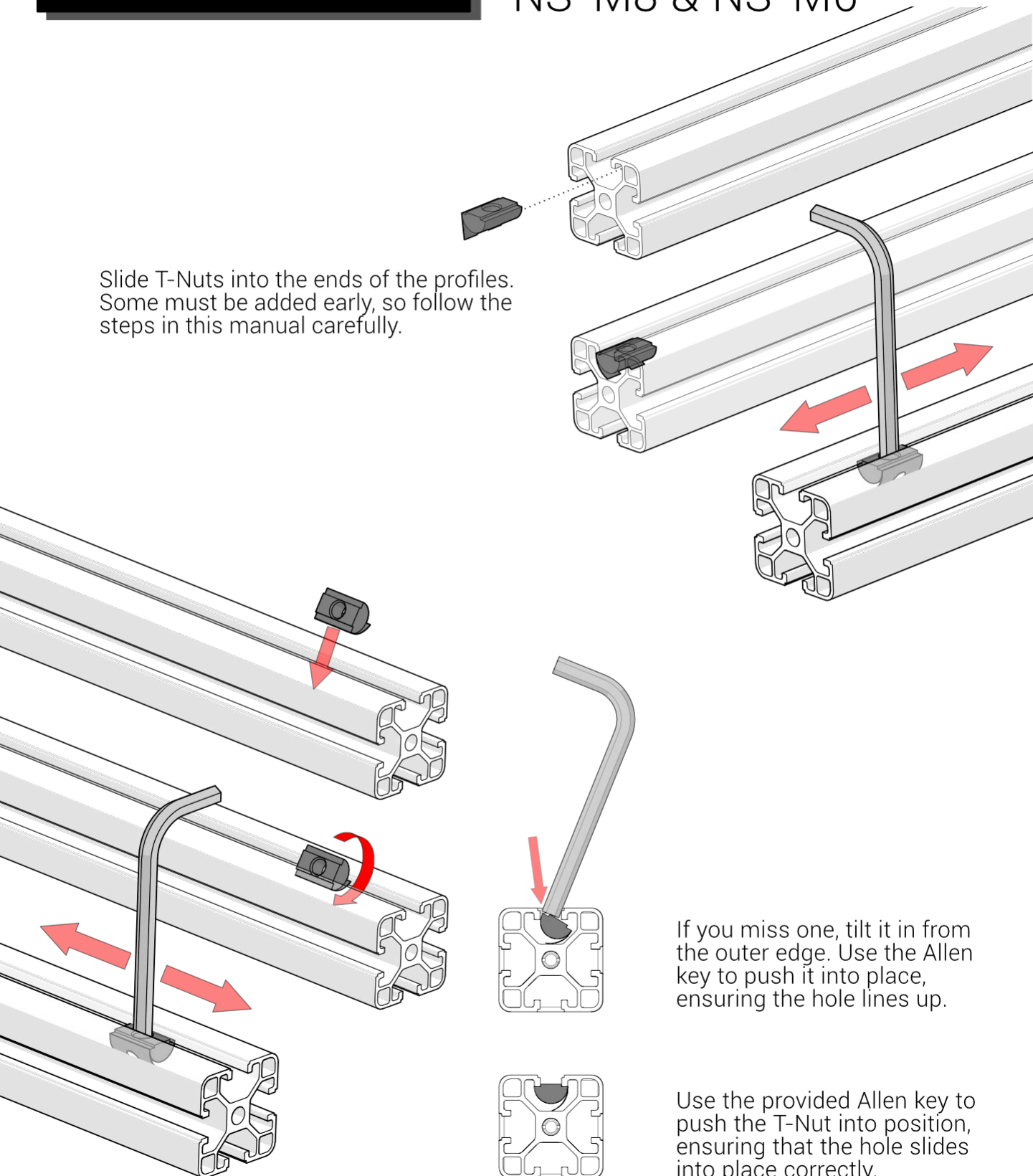

If you miss one, tilt it in from the outer edge. Use the Allen key to push it into place, ensuring the hole lines up.

Use the provided Allen key to push the T-Nut into position, ensuring that the hole slides into place correctly.

NOTE

The handle screws (S7 & S27) are ratcheted to allow for tightening and loosening when space for rotation is limited. Simply pull the handle out and turn handle into position and push handle back in to engage thread.

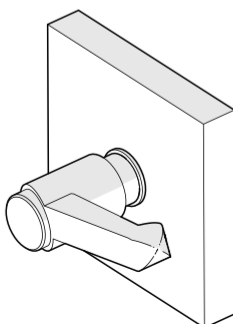
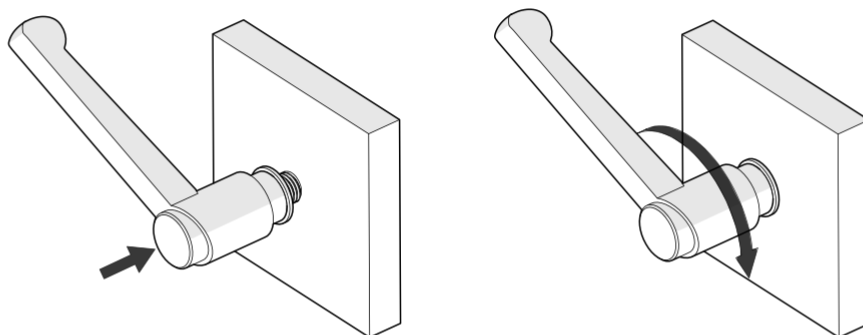
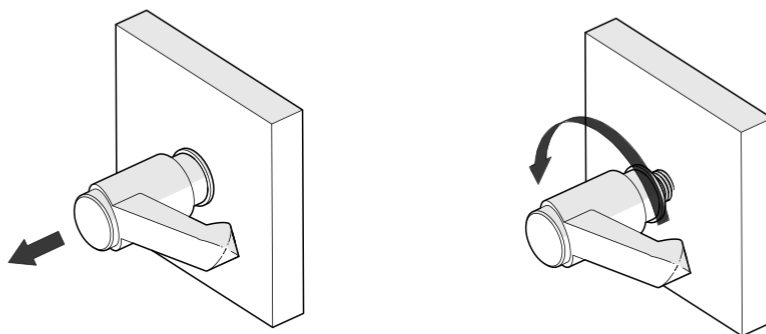
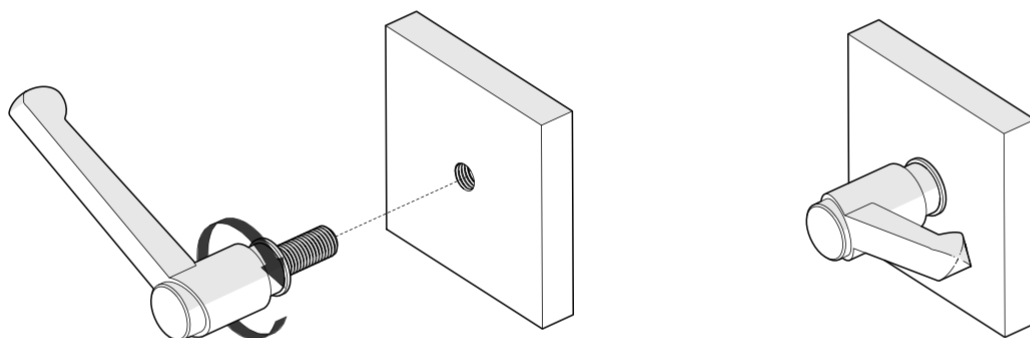

NOTE

These parts are adjustable and can be rotated to fit comfortably after installation on the simulator.

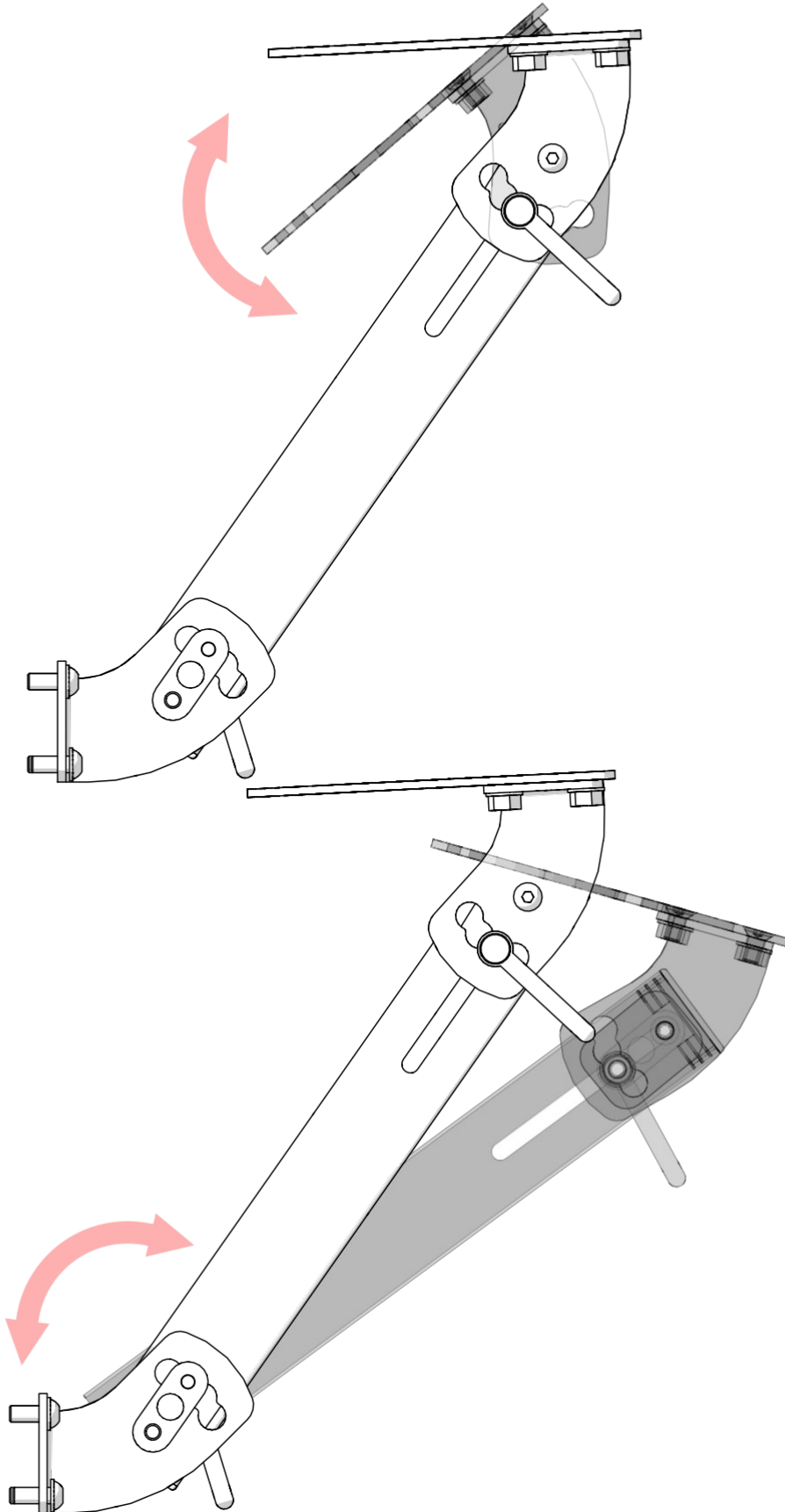

1

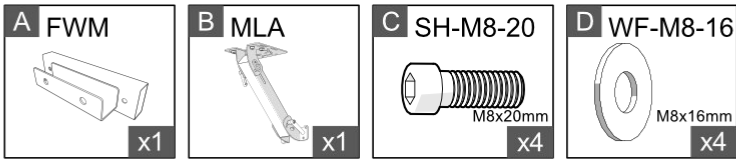

Note:

MLA can be assembled with or without the FWM on TR40s, TR80s, TR120s, and TR160s. Choose your setup. If not using FWM, skip Step 1 and begin at Step 2. Ensure all components are tightly connected.

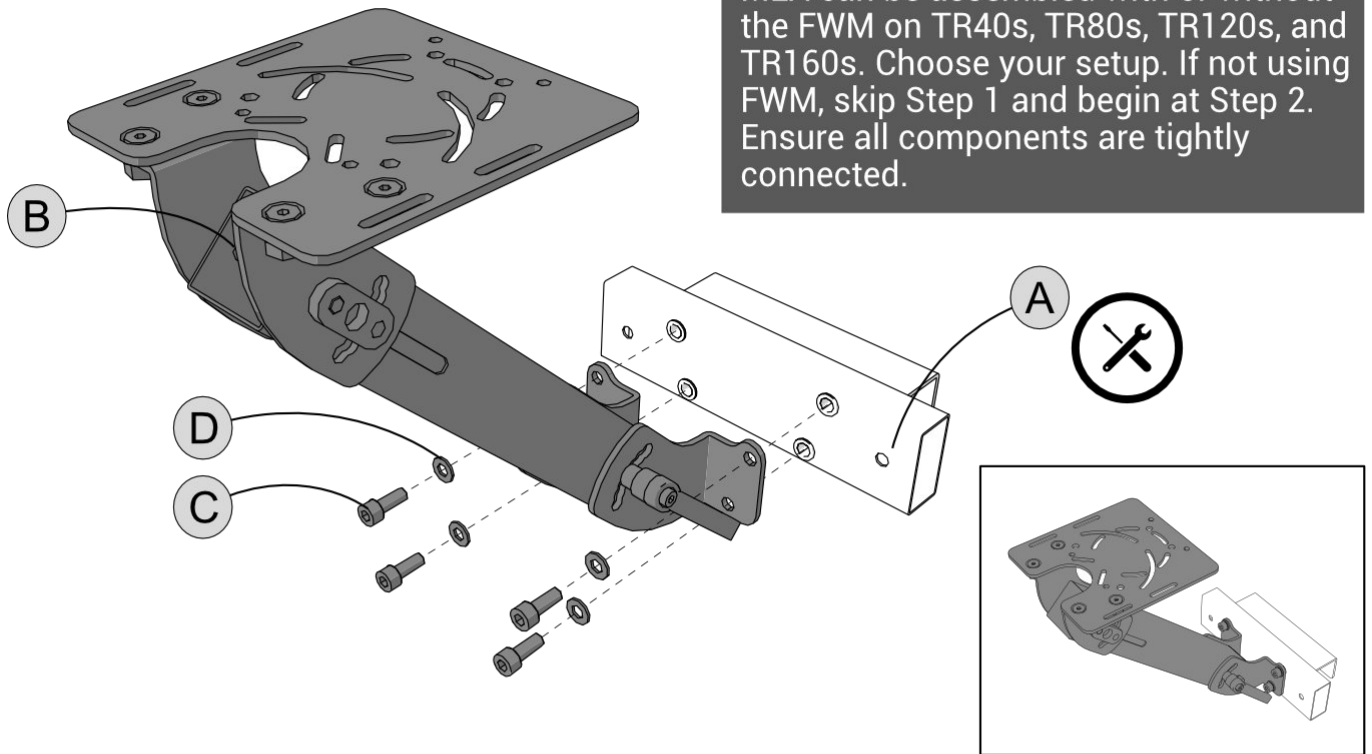

2

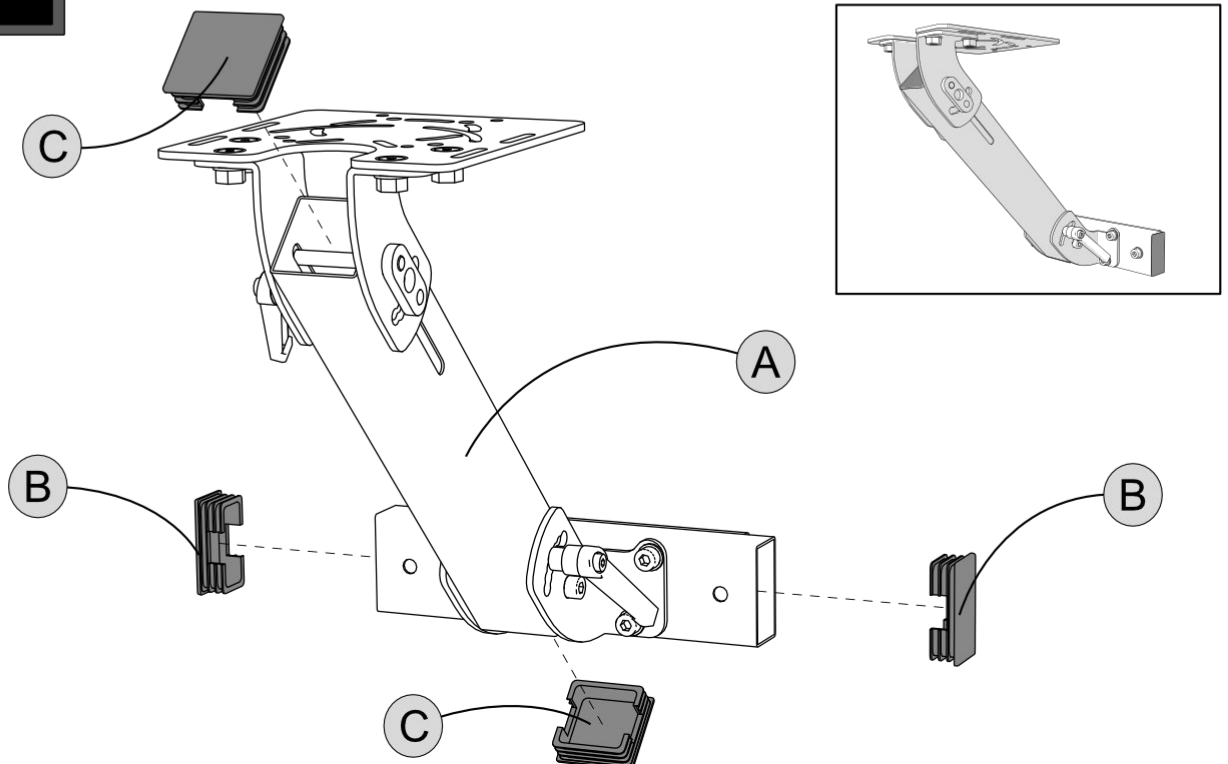

TR8

3a

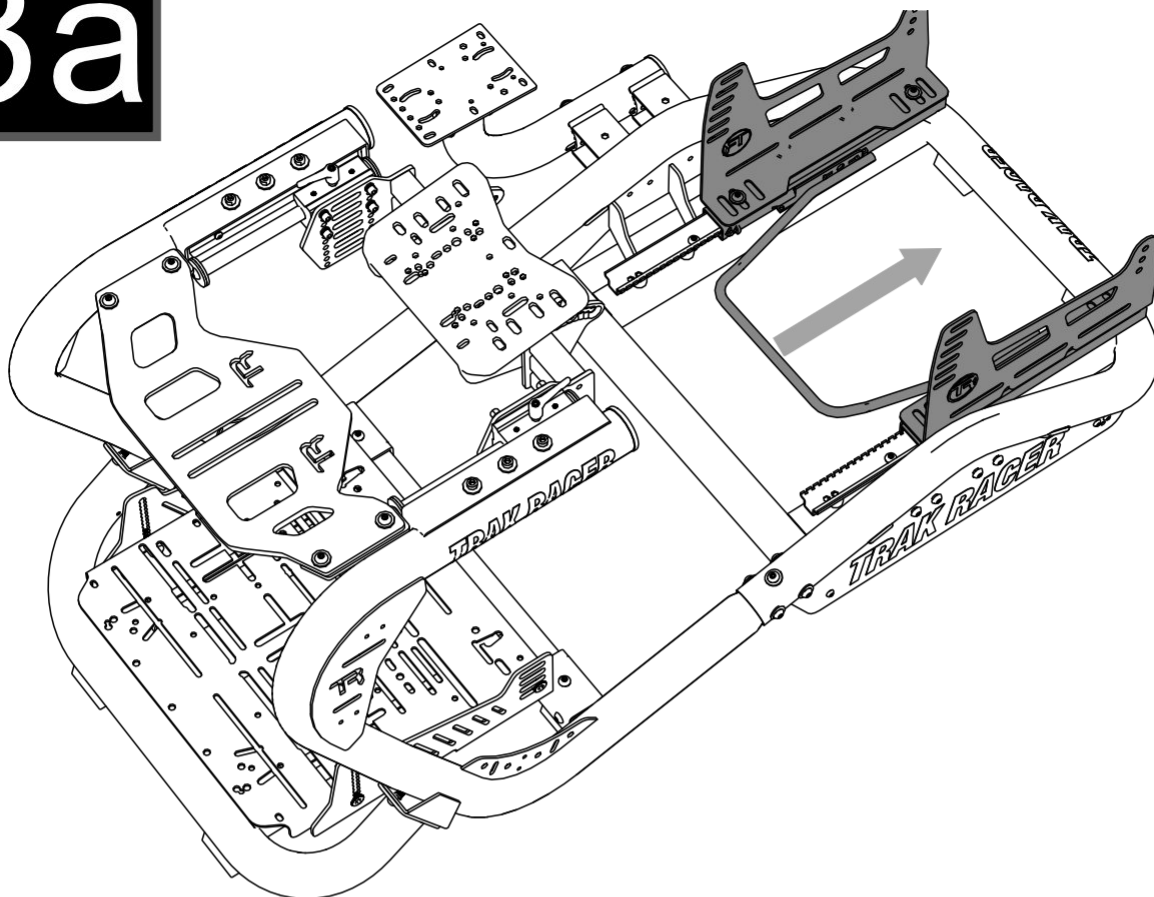

3b

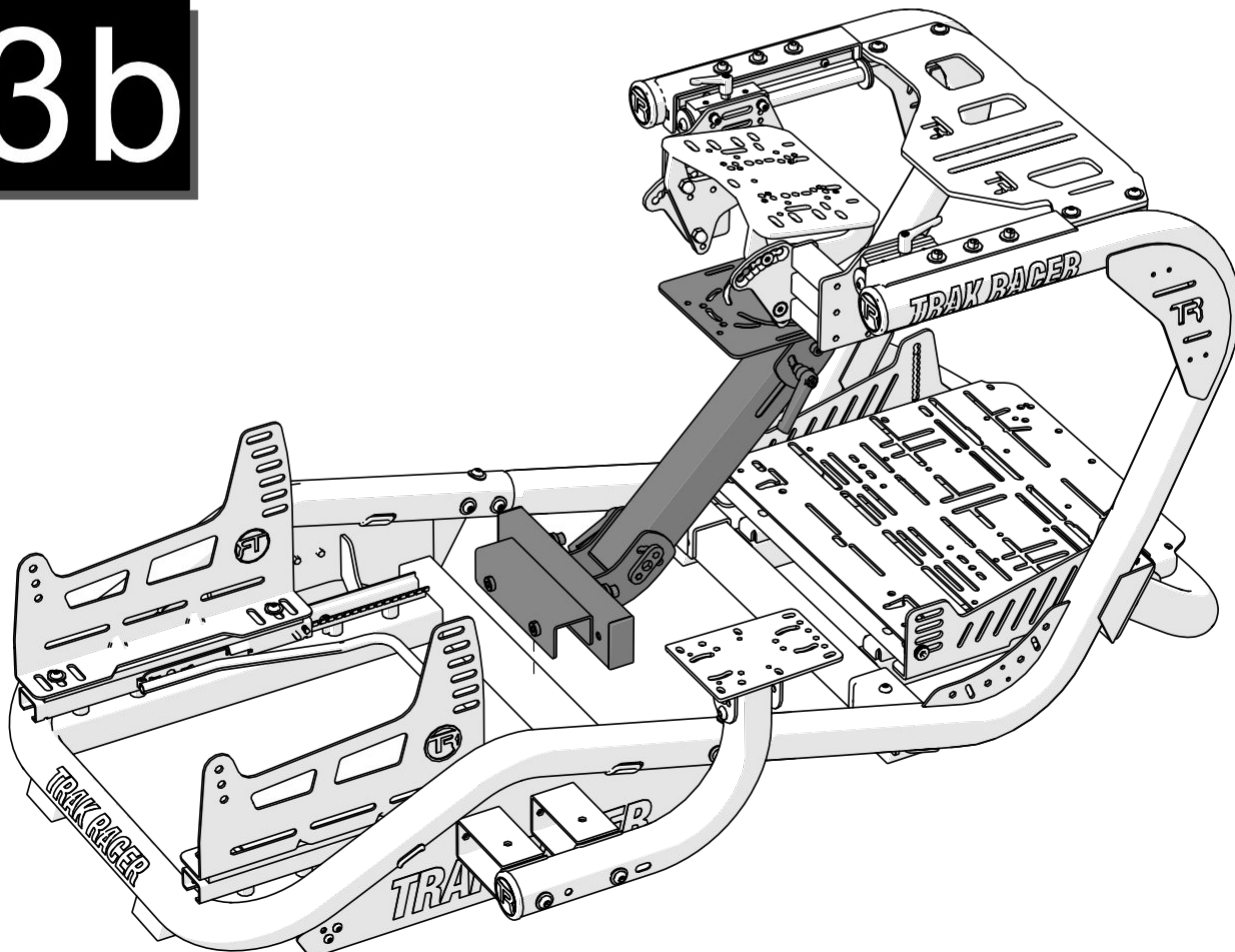

3c

A SH-M8-55
M8x55mm
x2

B WF-M8-16
M8x16mm
x2

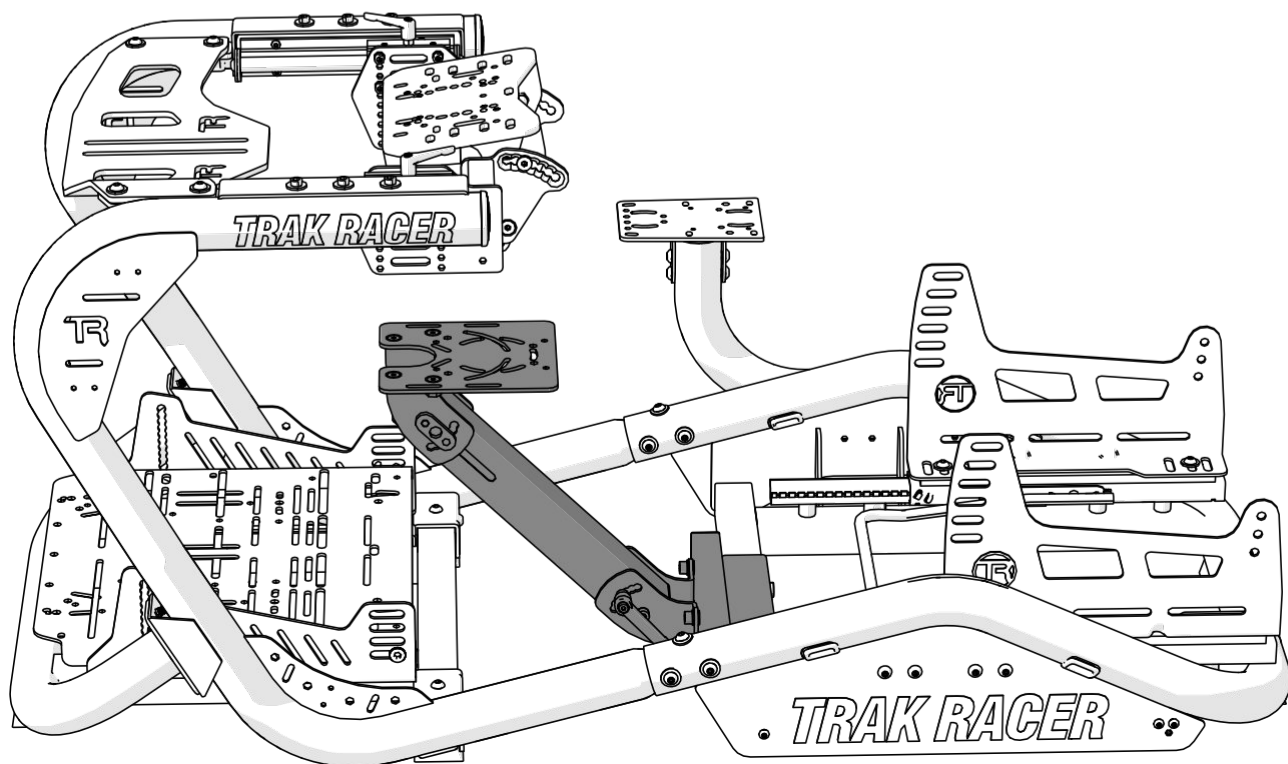
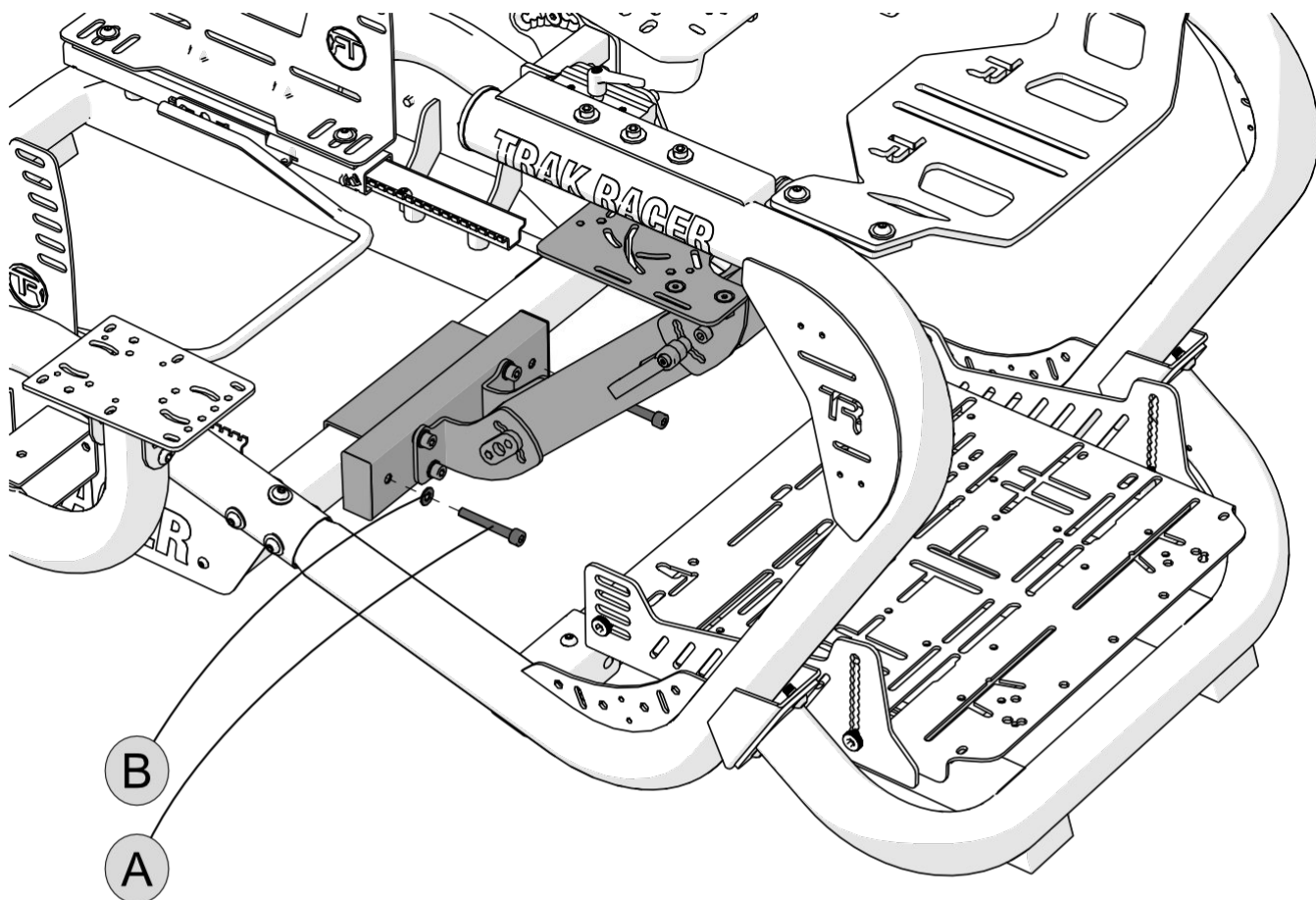

TRX

3a

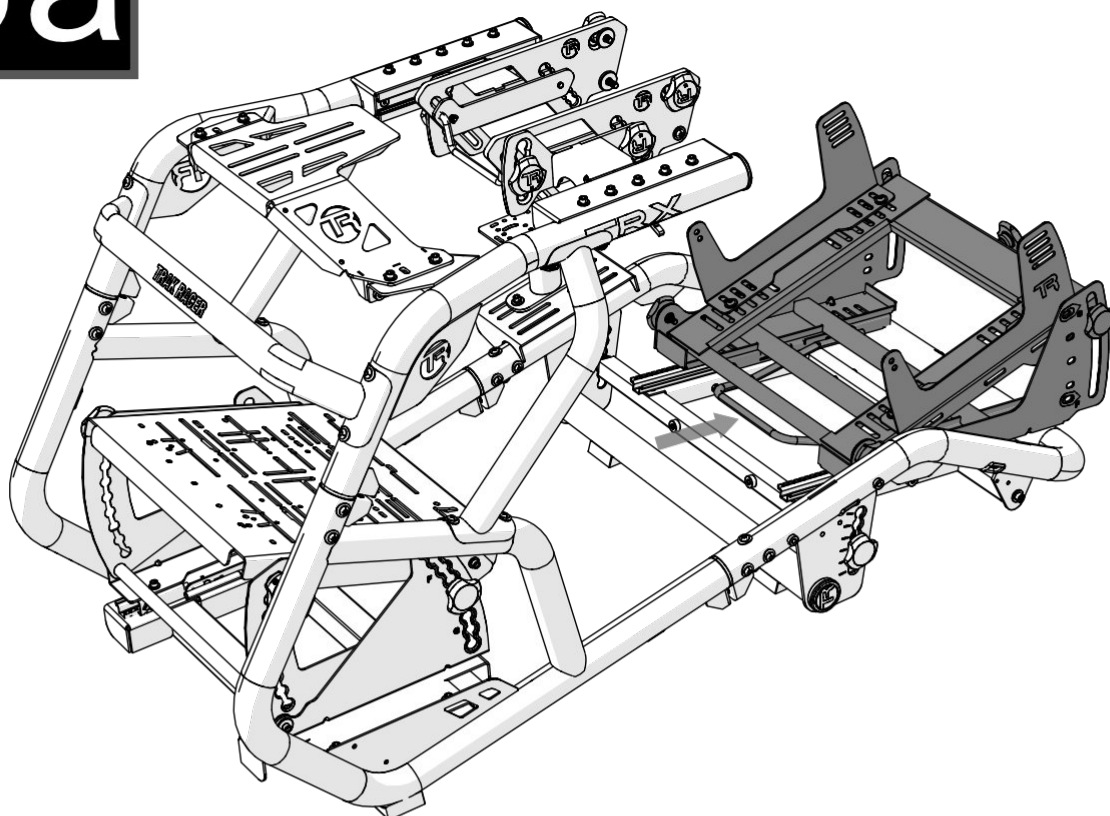

3b

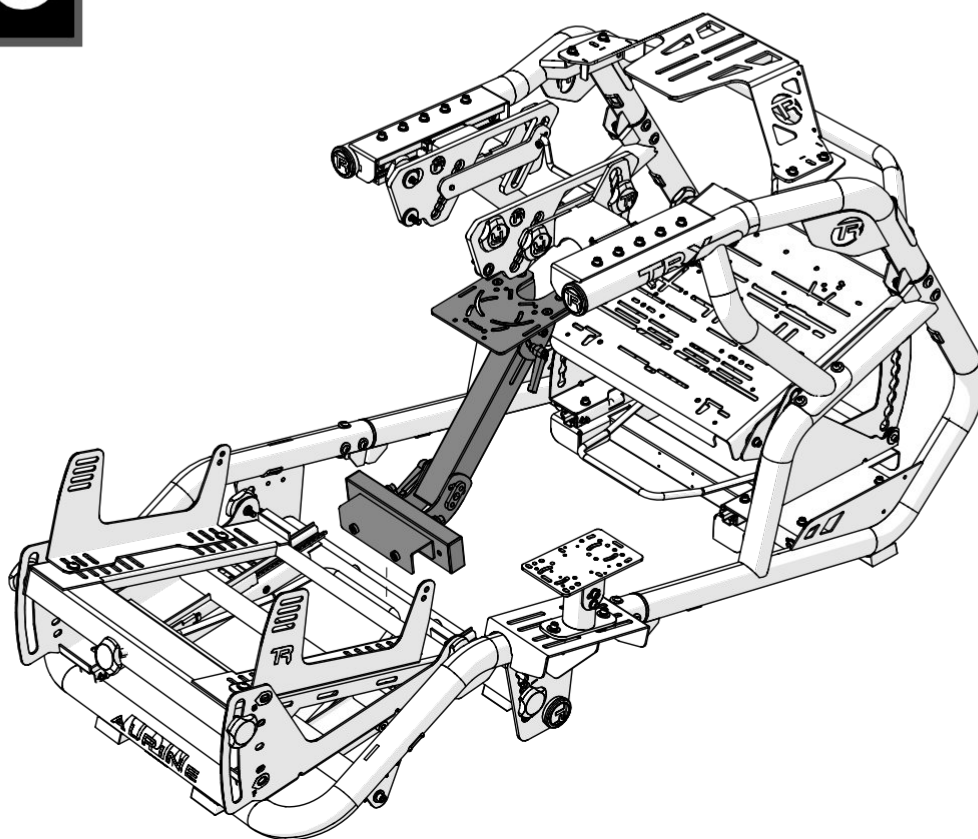

3c

A SH-M8-55
M8x55mm
x2

B WF-M8-16
M8x16mm
x2

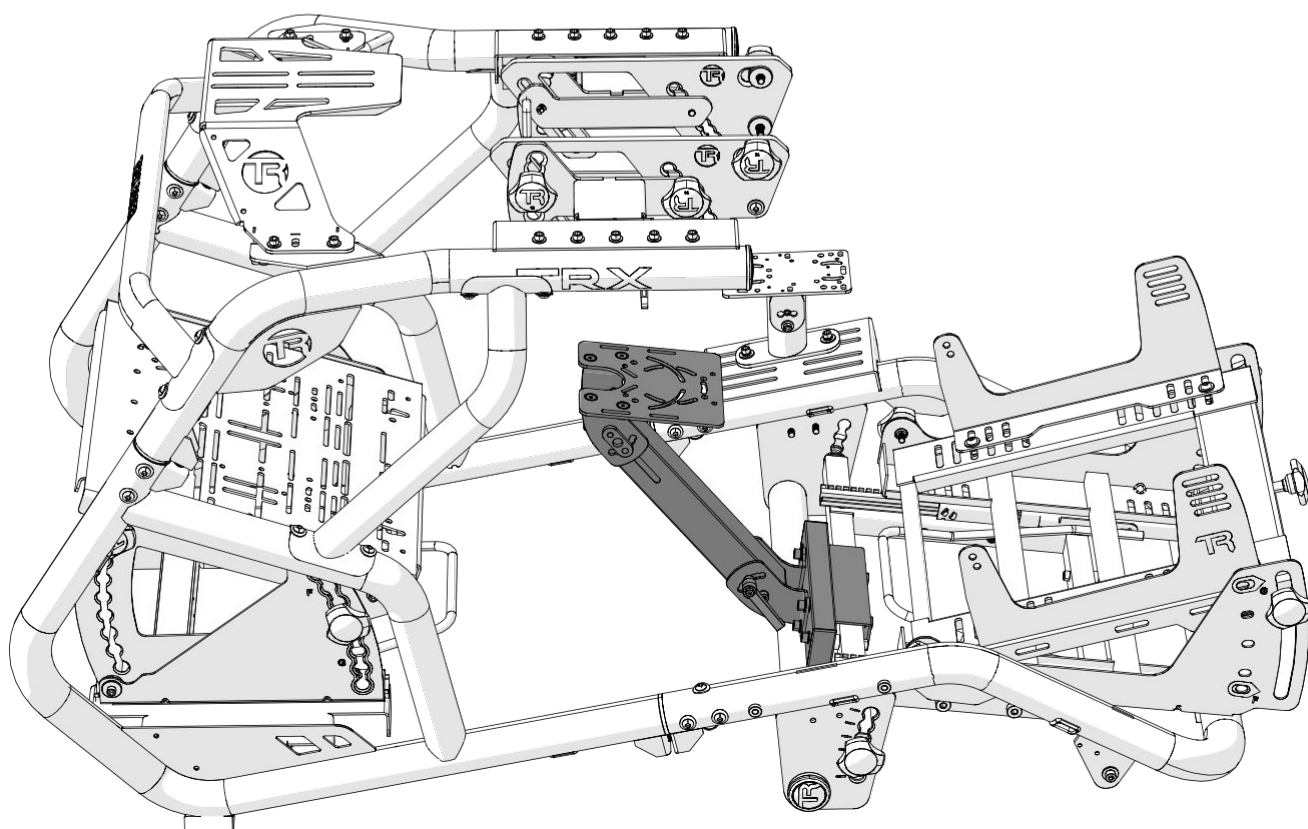
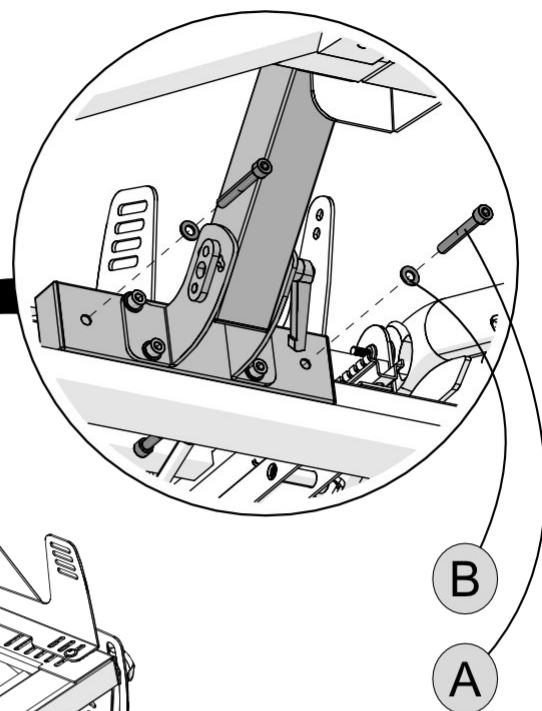
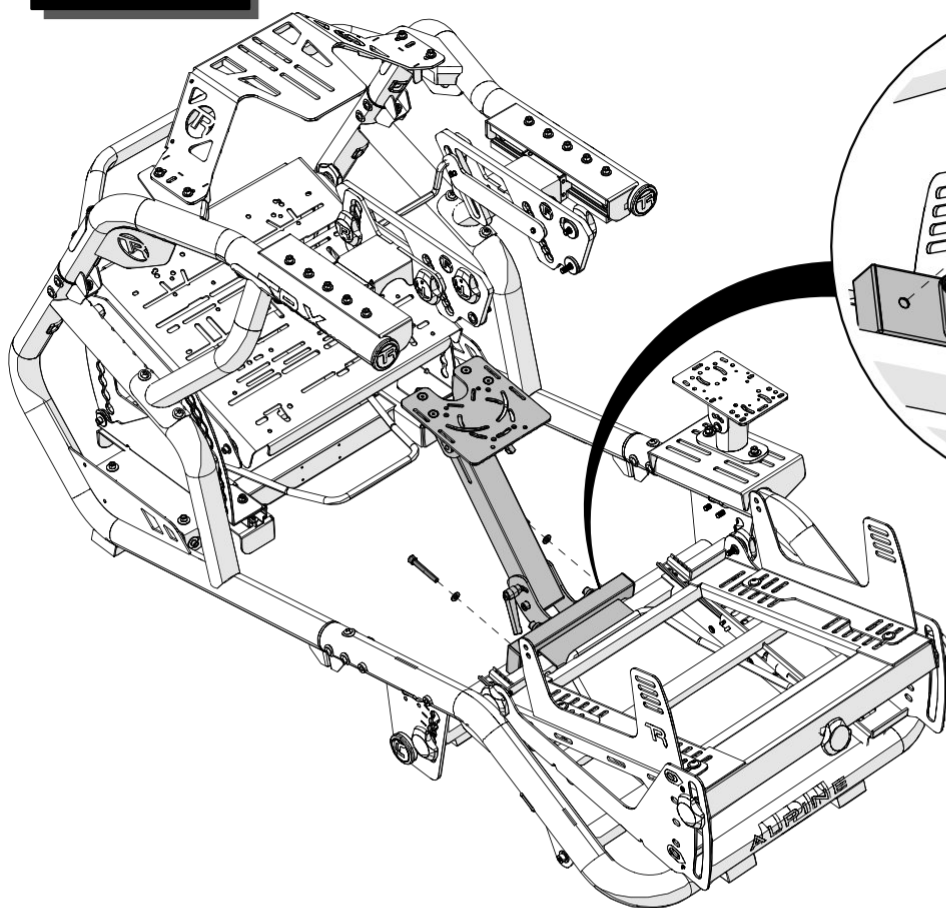

TR-40s

**Without
FWM**

3

A NS-M8



M8
x2

B SR-M8-20

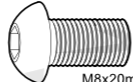

M8x20mm
x2

C WF-M8-16

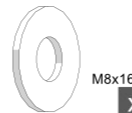

M8x16mm
x2

NOTE:

- First, slide in the nuts, then install the stick mount using screws and washers.

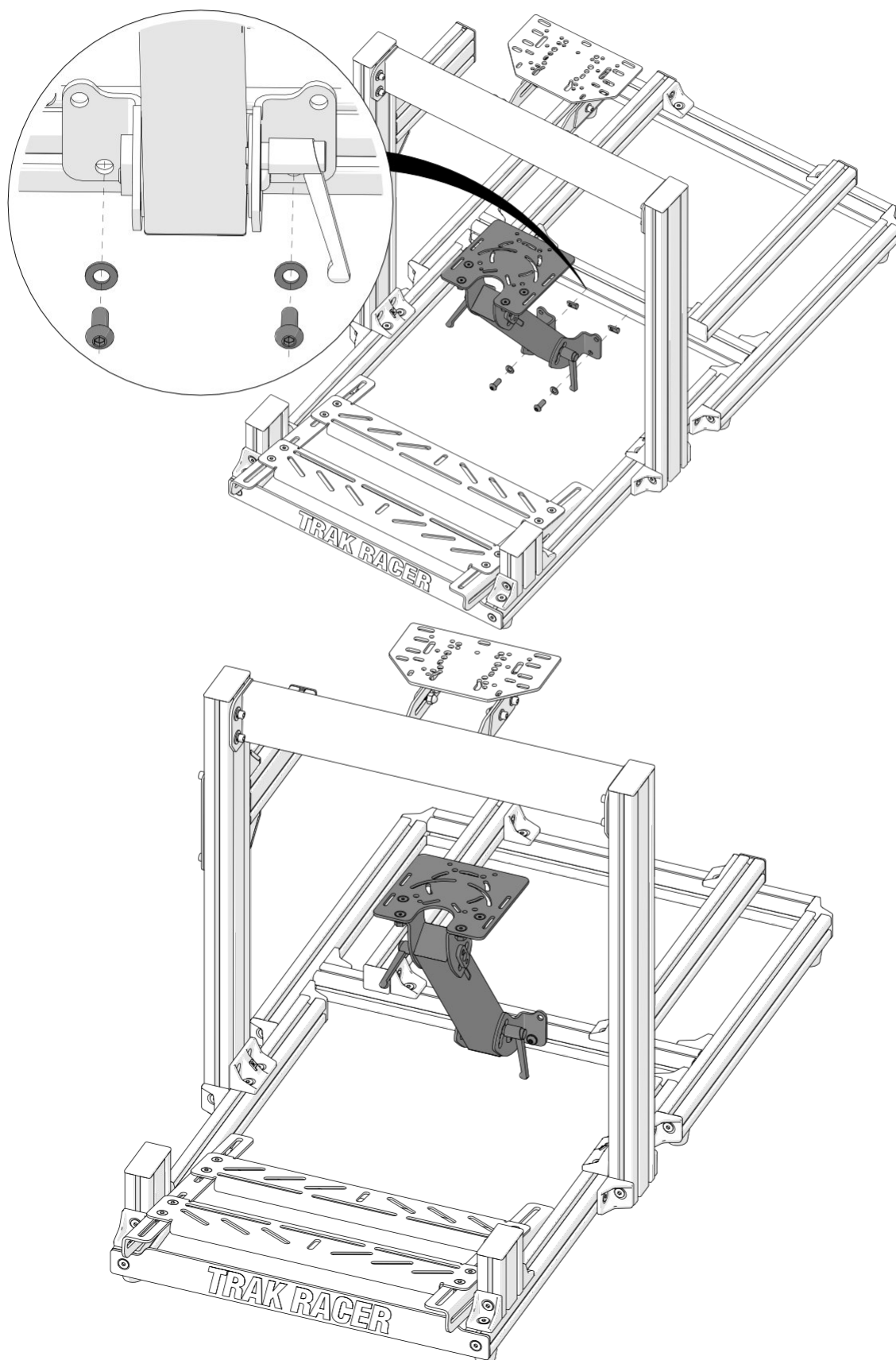

With FWM

3a

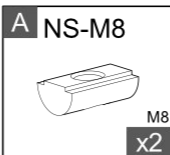

NOTE:

- First, slide in the nuts, then install the stick mount using screws.

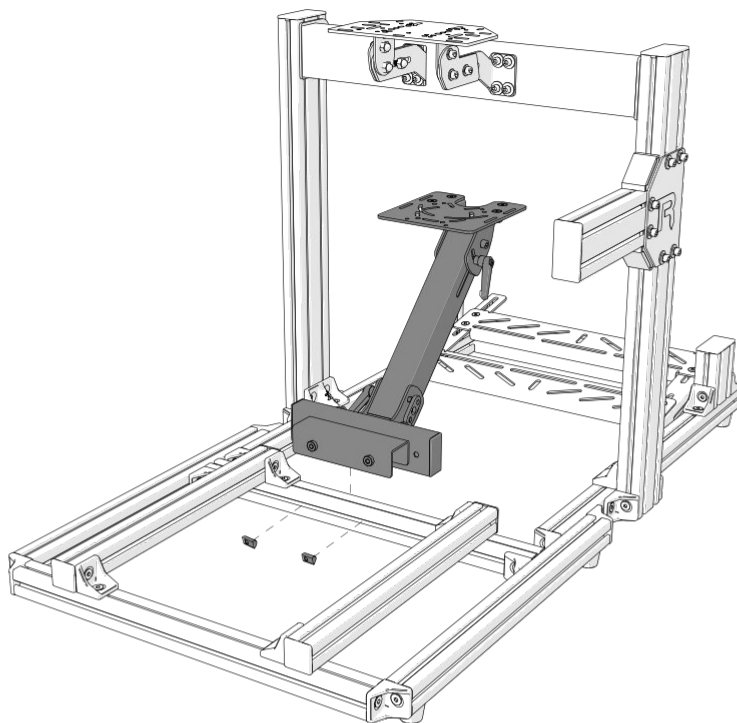

3b

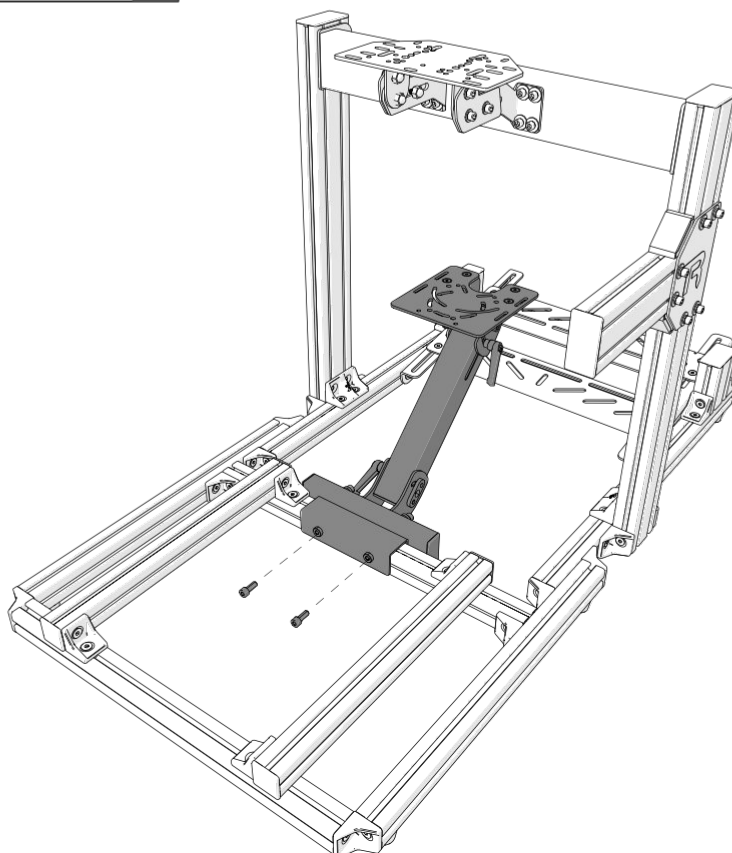
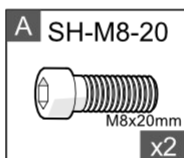

TR-80s

**Without
FWM**

3

A NS-M8



M8
x4

B SR-M8-20

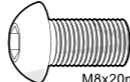

M8x20mm
x4

C WF-M8-16



M8x16mm
x4

NOTE:

- First, slide in the nuts, then install the stick mount using screws and washers.

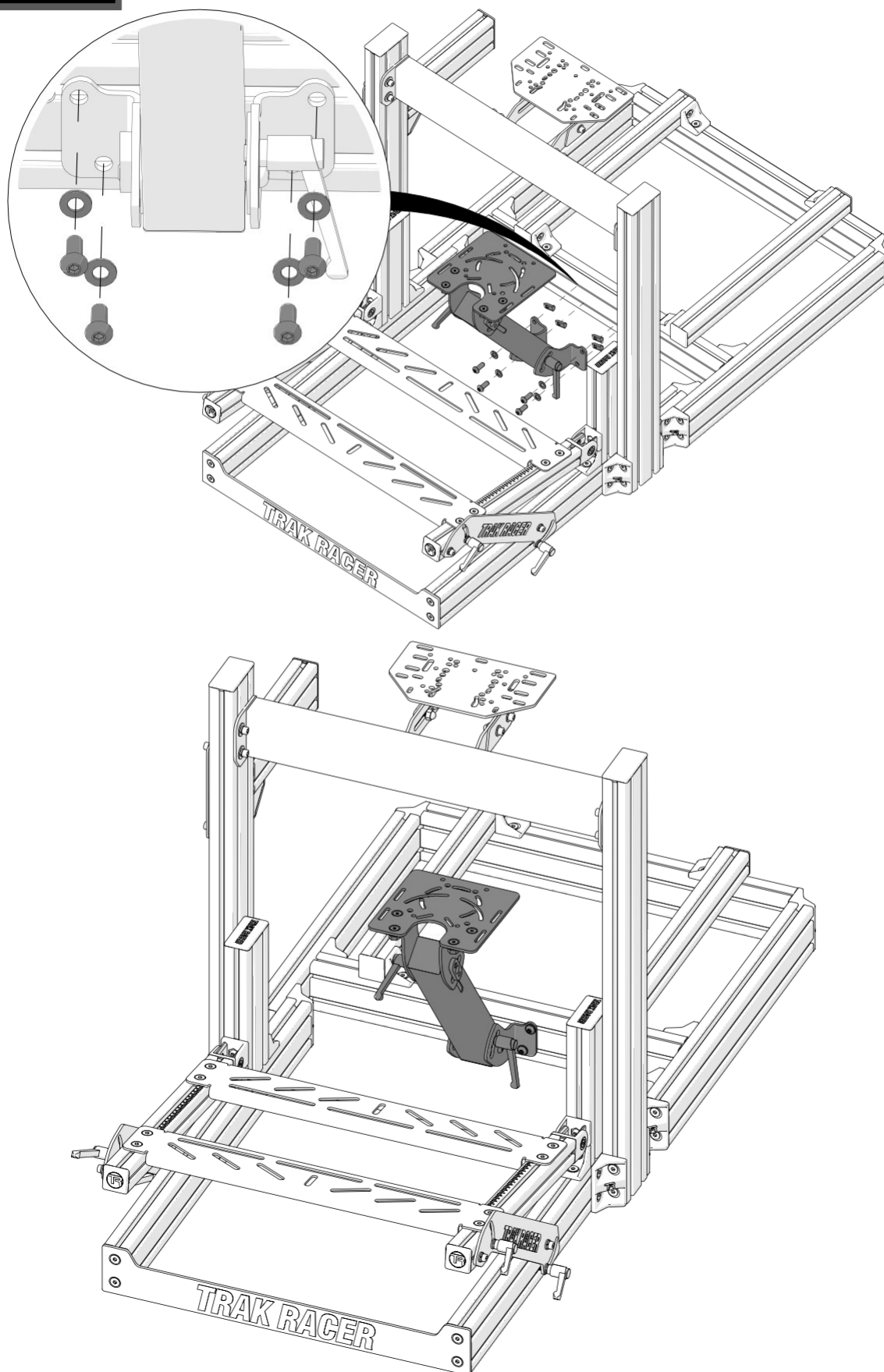

With FWM

3a

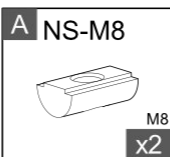

NOTE:

- First, slide in the nuts, then install the stick mount using screws.

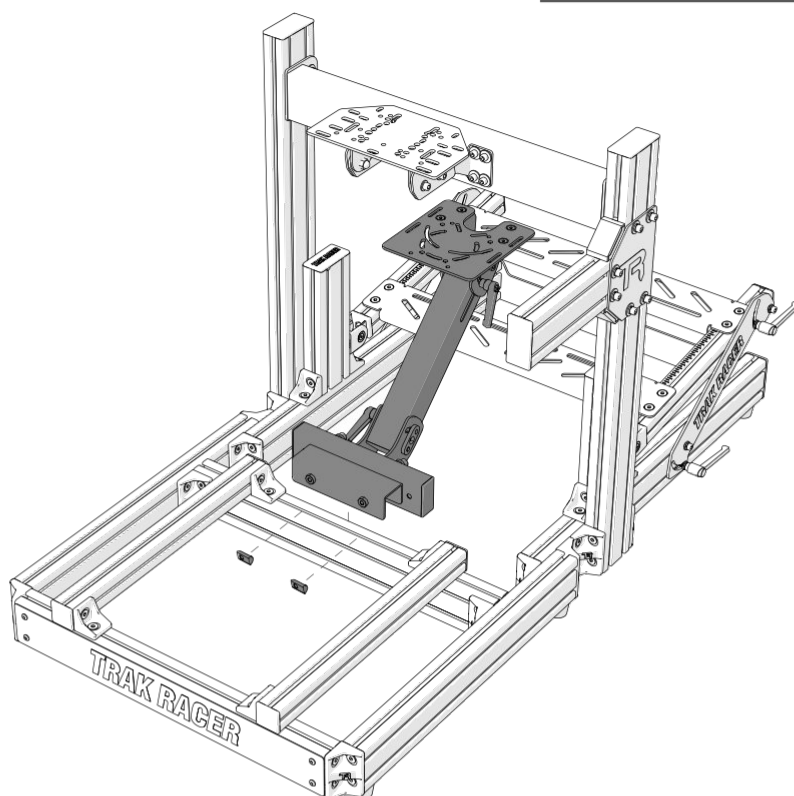

3b

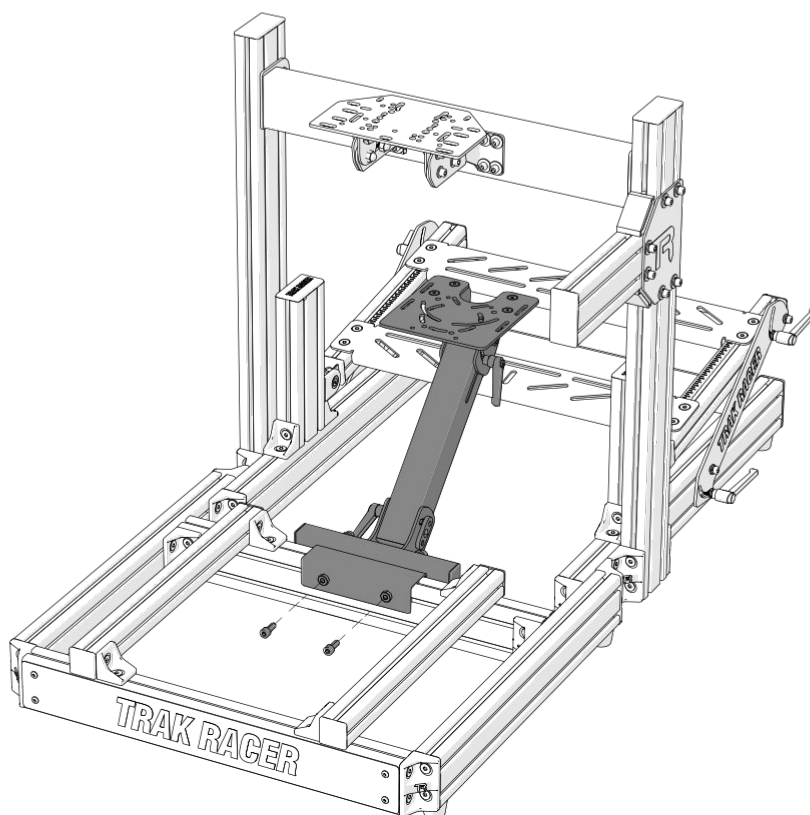
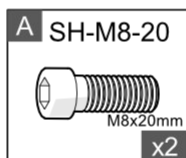

TR-120s

**Without
FWM**

3a

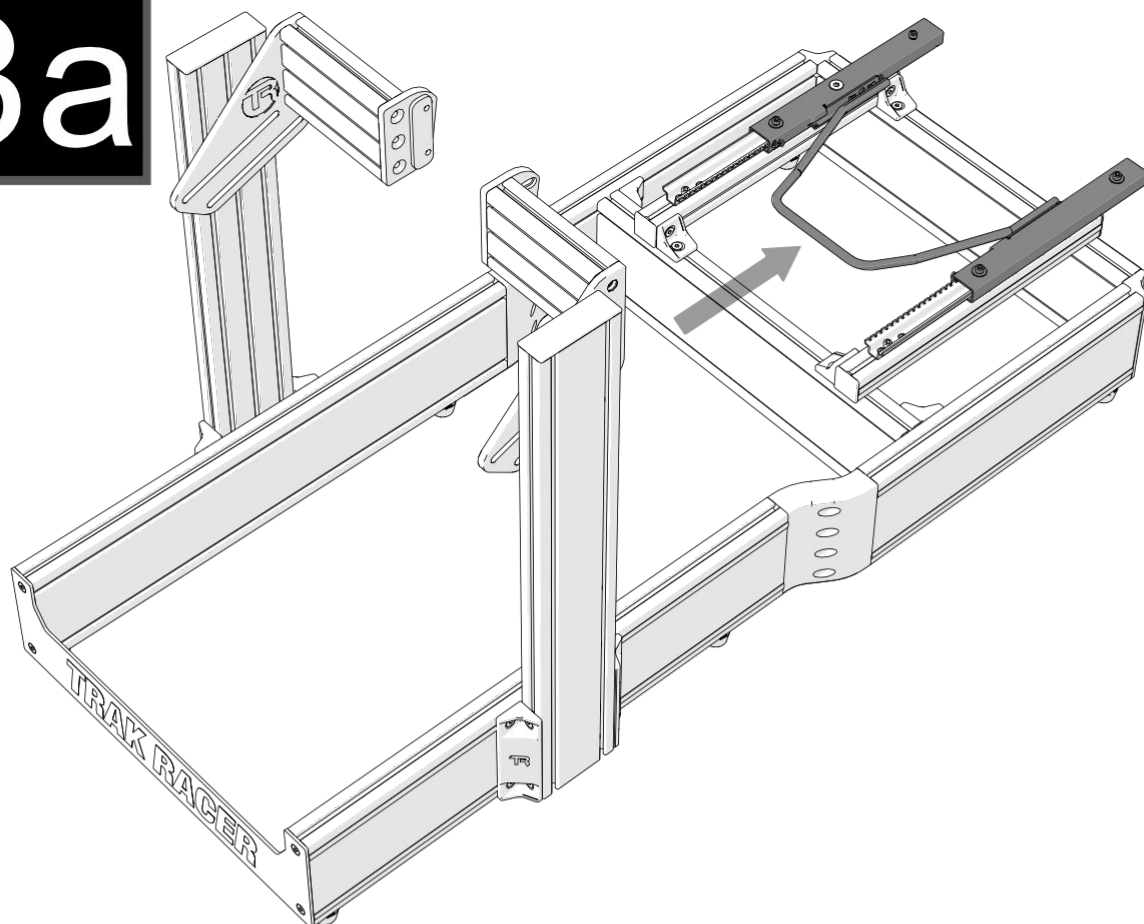

3b

A NS-M8

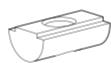

M8
x2

B SR-M8-20

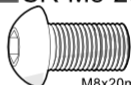

M8x20mm
x2

C WF-M8-16

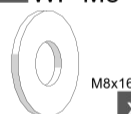

M8x16mm
x2

NOTE:

- First, slide in the nuts, then install the stick mount using screws and washers.

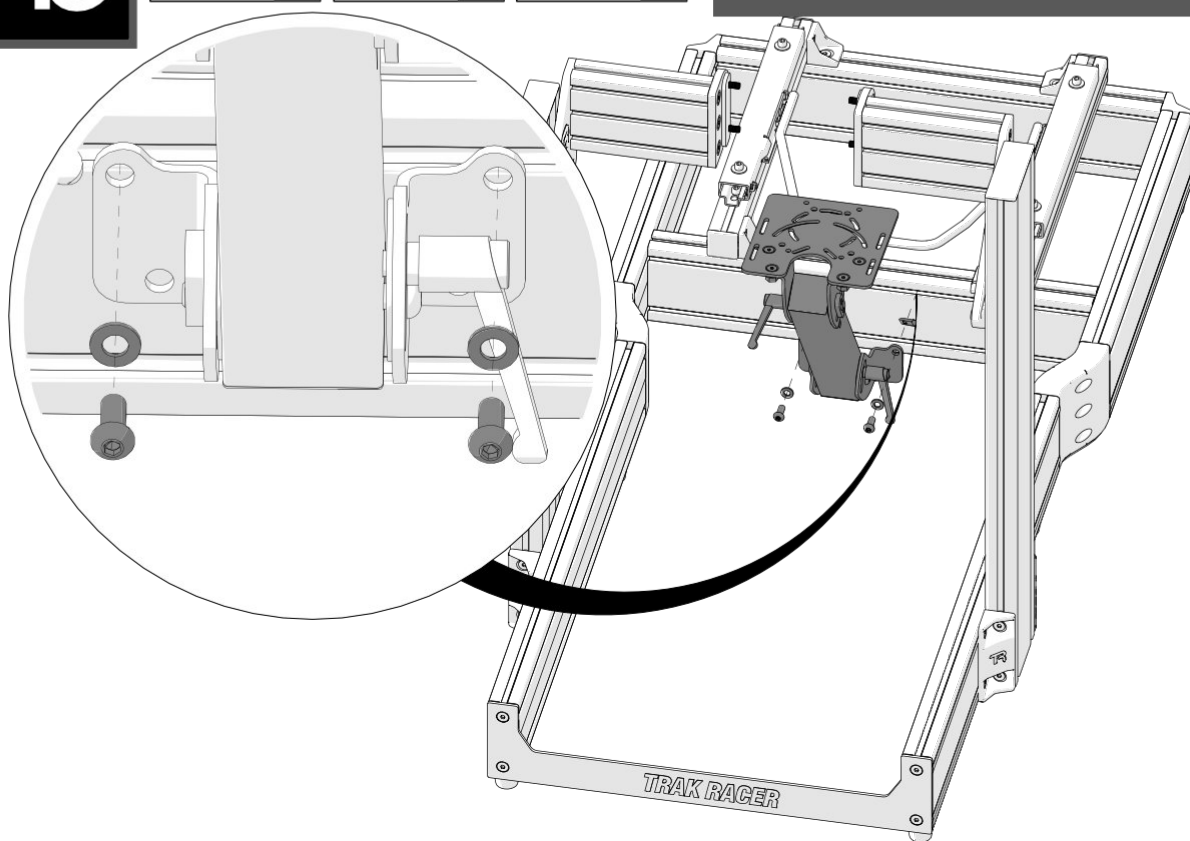

3c

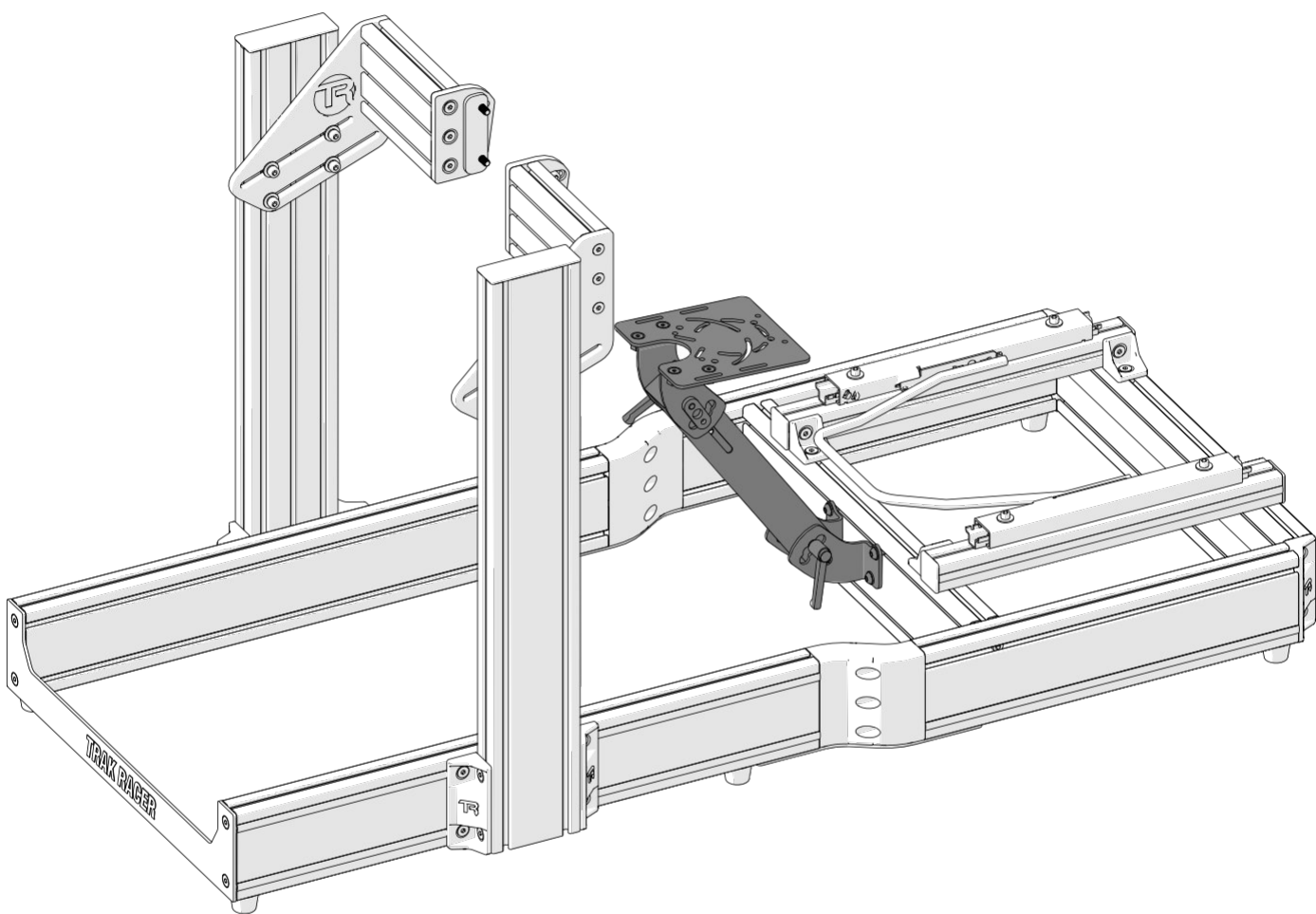

With FWM

3a

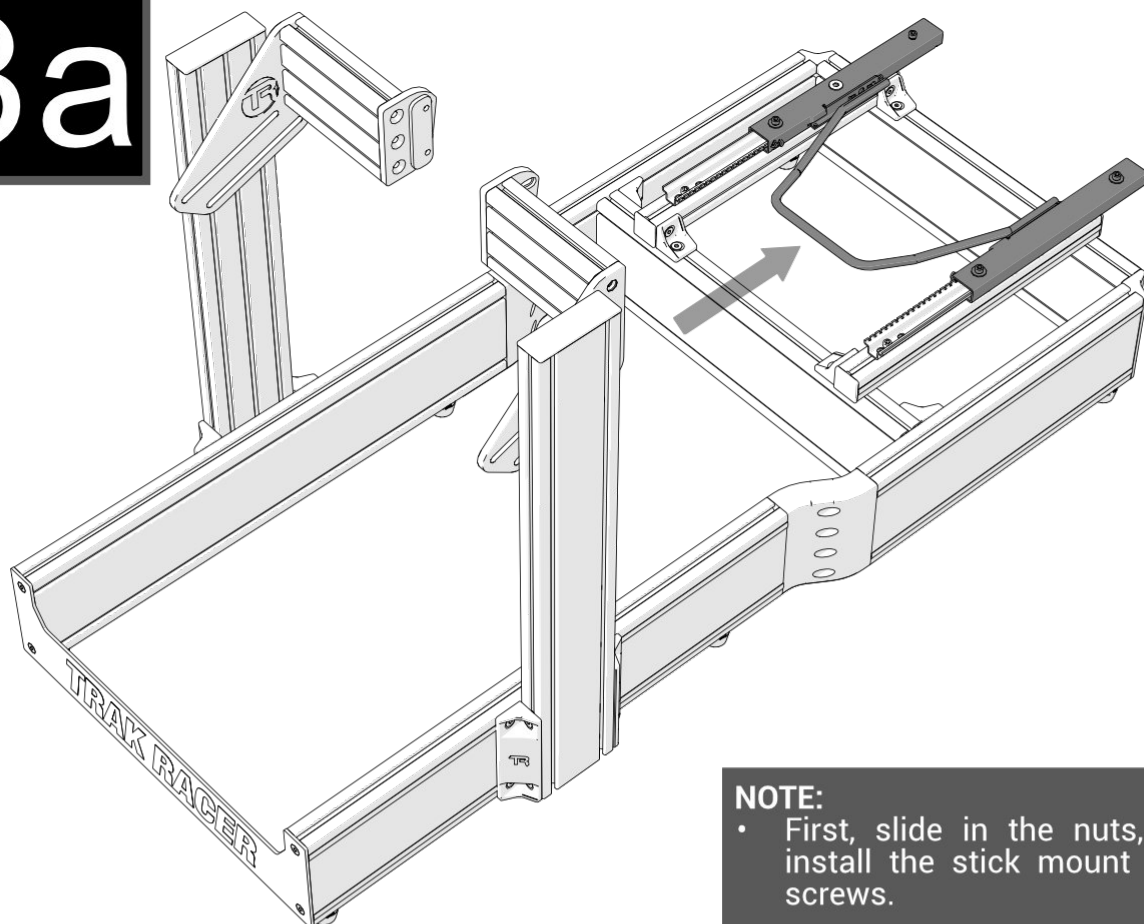

NOTE:

- First, slide in the nuts, then install the stick mount using screws.

3b

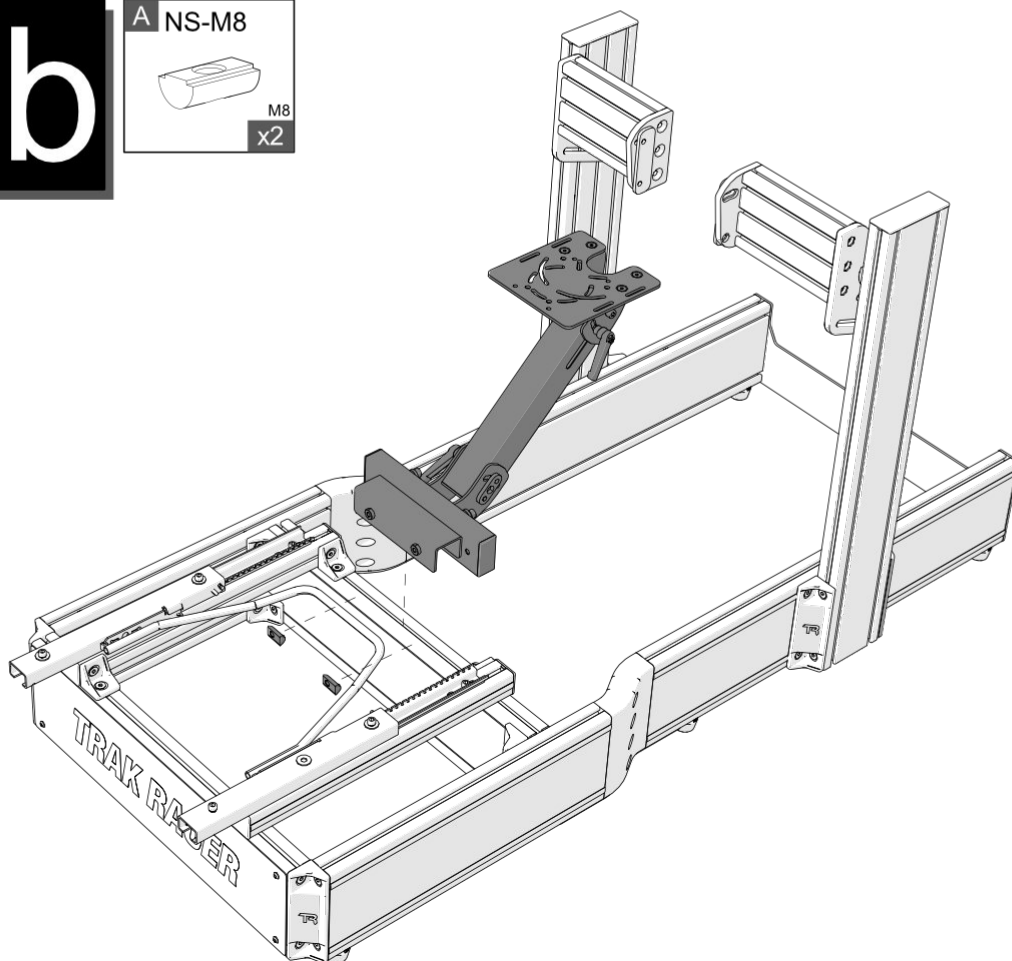
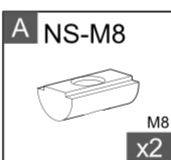

3c

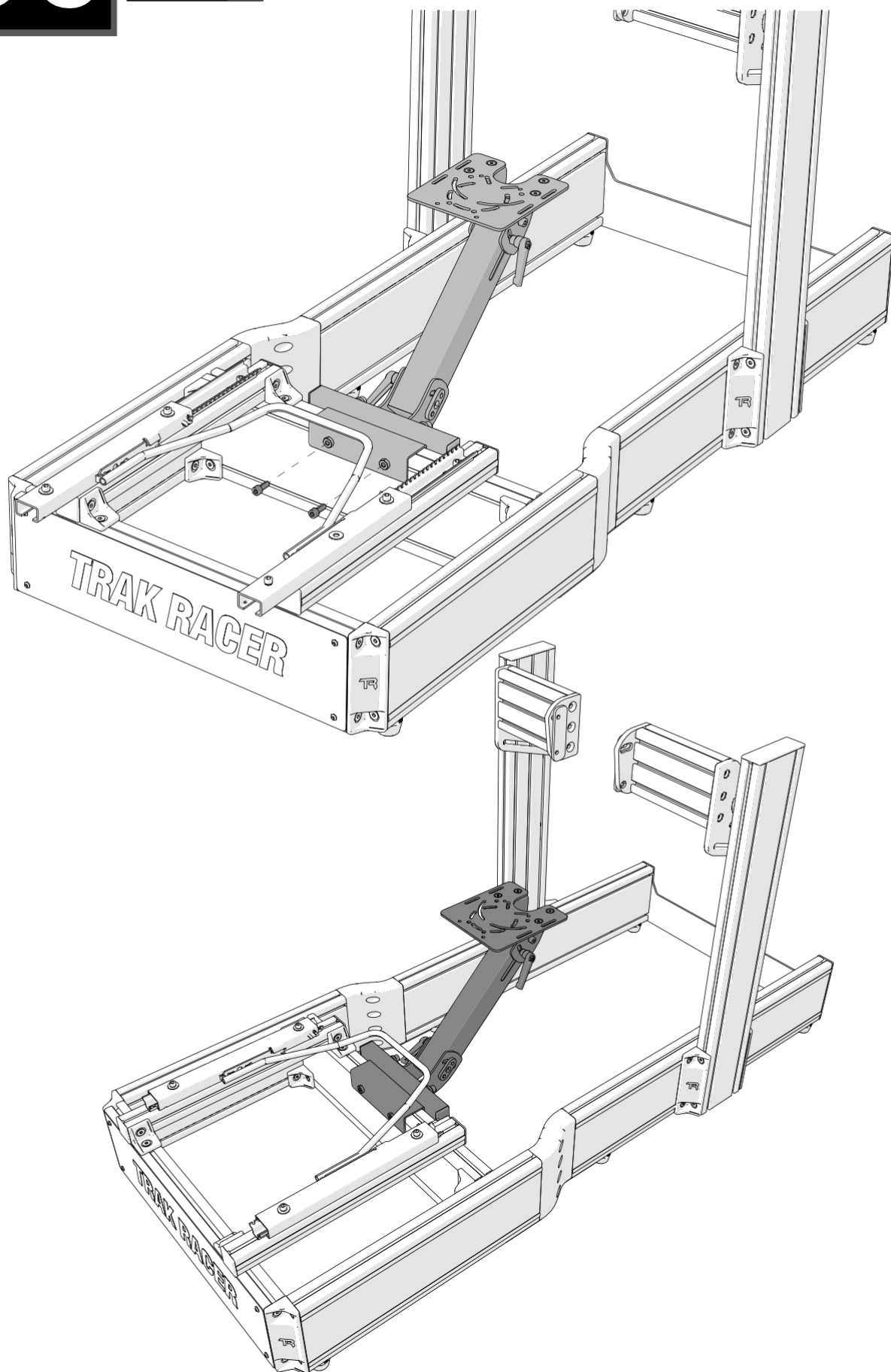
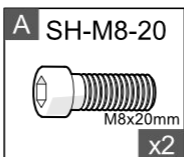

TR-160s
S2

**Without
FWM**

3a

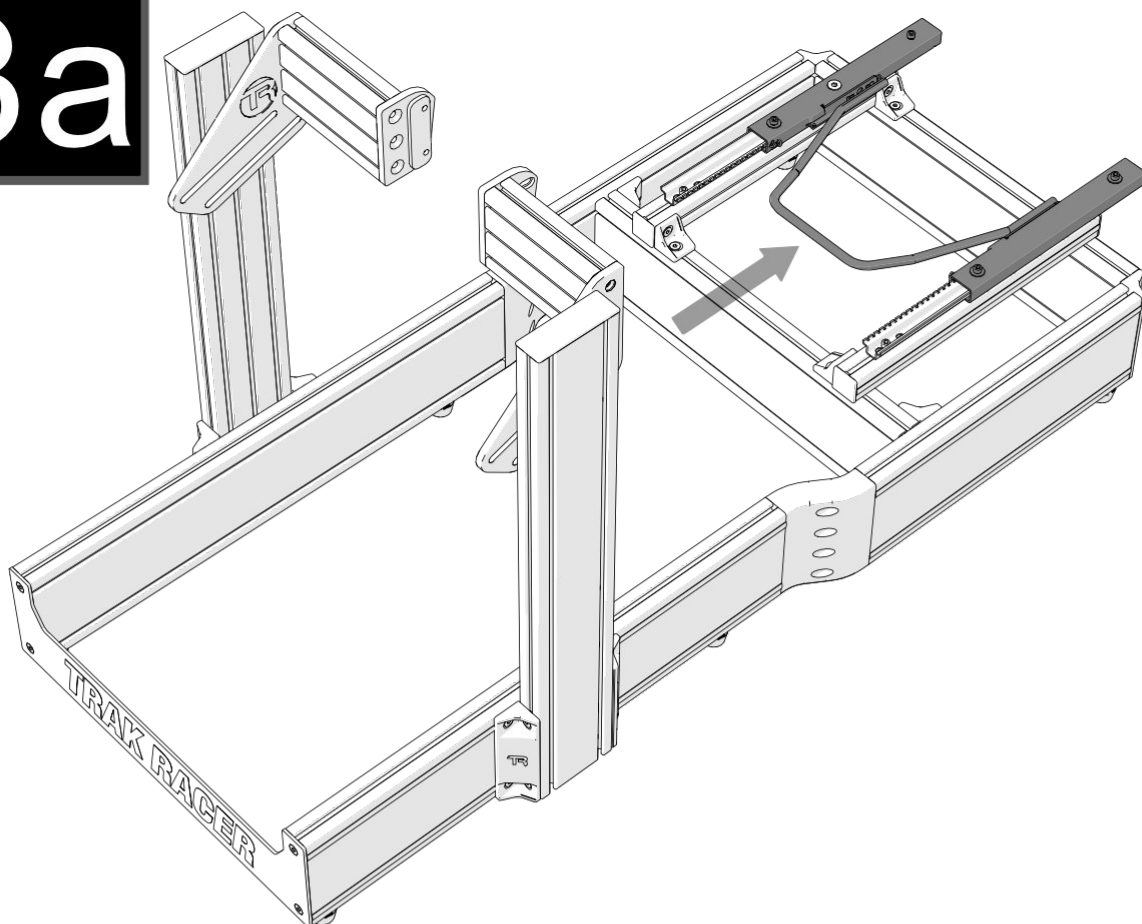

3b

A NS-M8

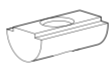

M8
x2

B SR-M8-20

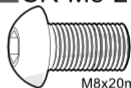

M8x20mm
x2

C WF-M8-16



M8x16mm
x2

NOTE:

- First, slide in the nuts, then install the stick mount using screws and washers.

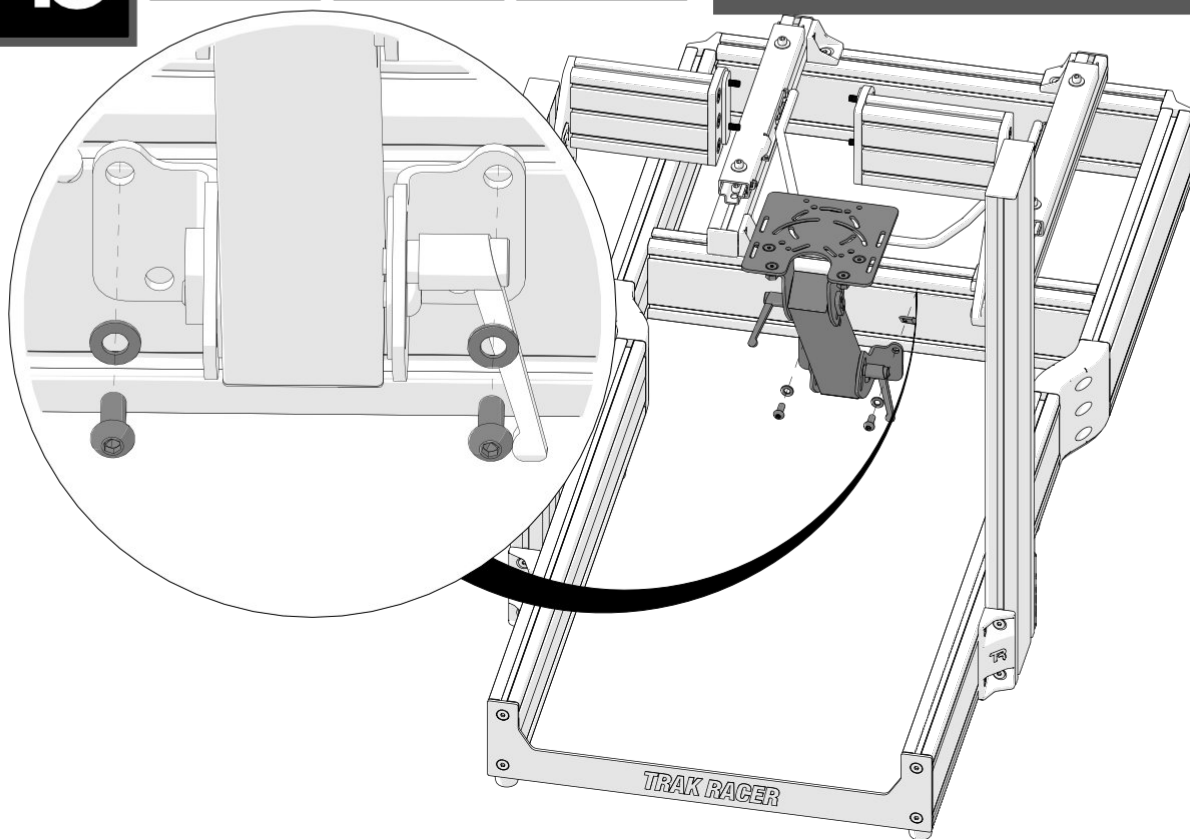

3c

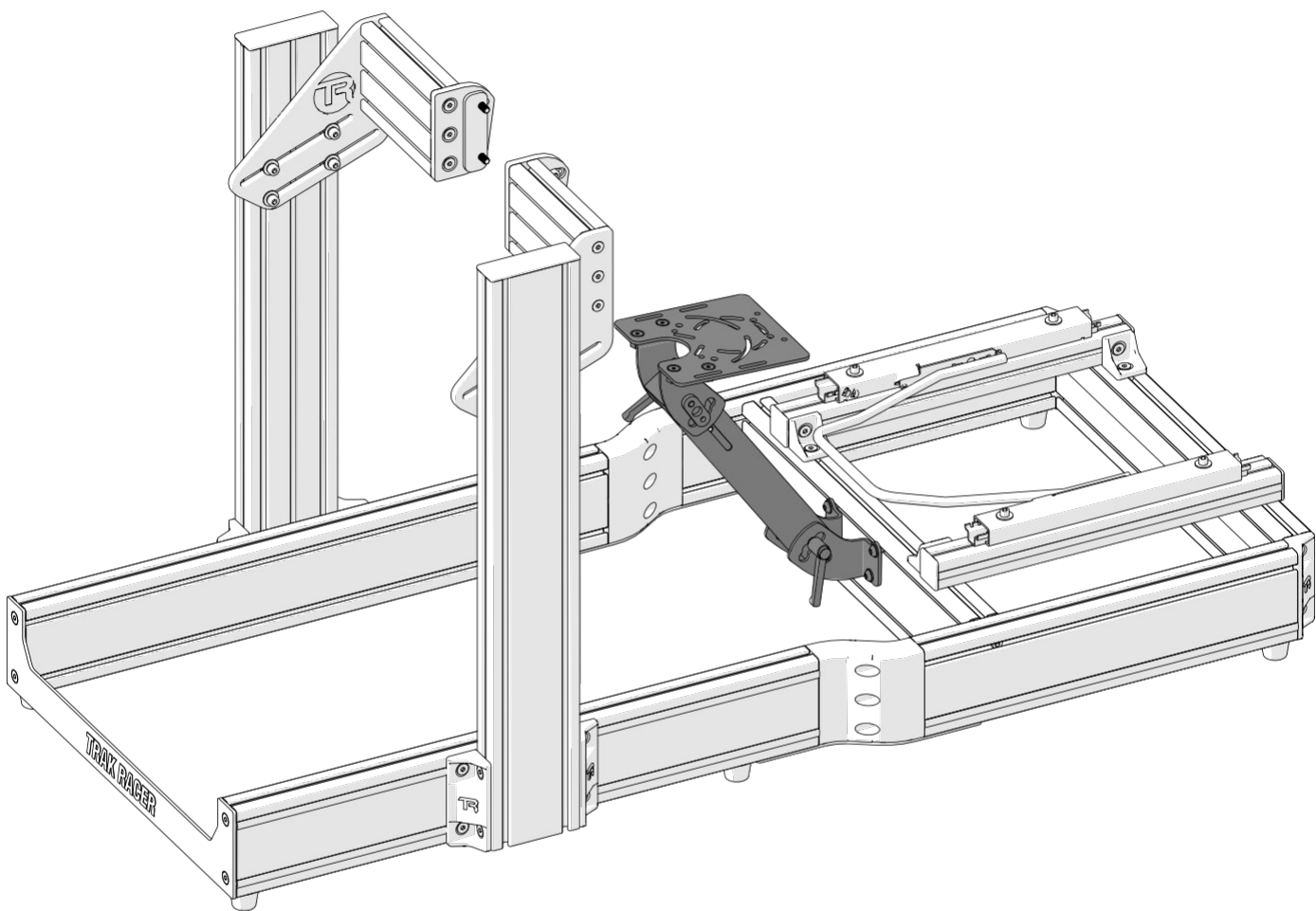

With FWM

3a

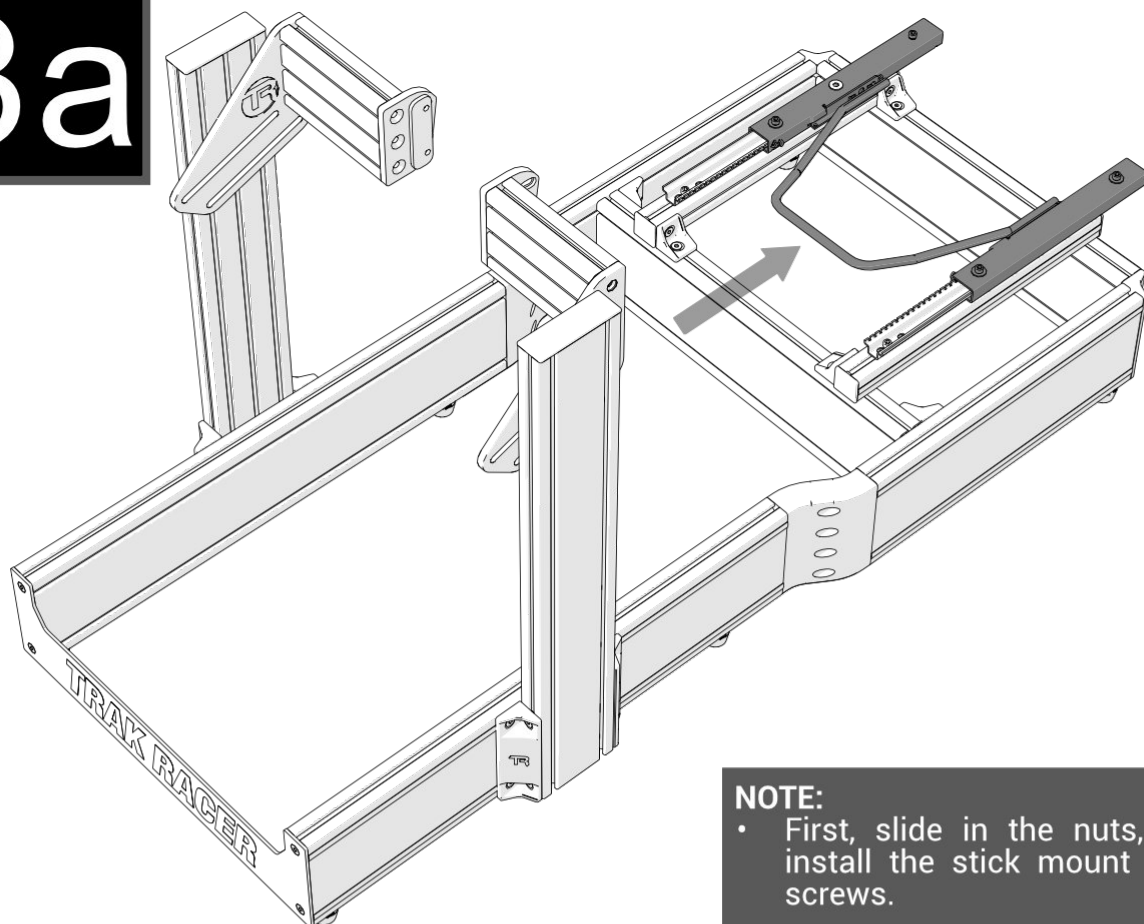

NOTE:

- First, slide in the nuts, then install the stick mount using screws.

3b

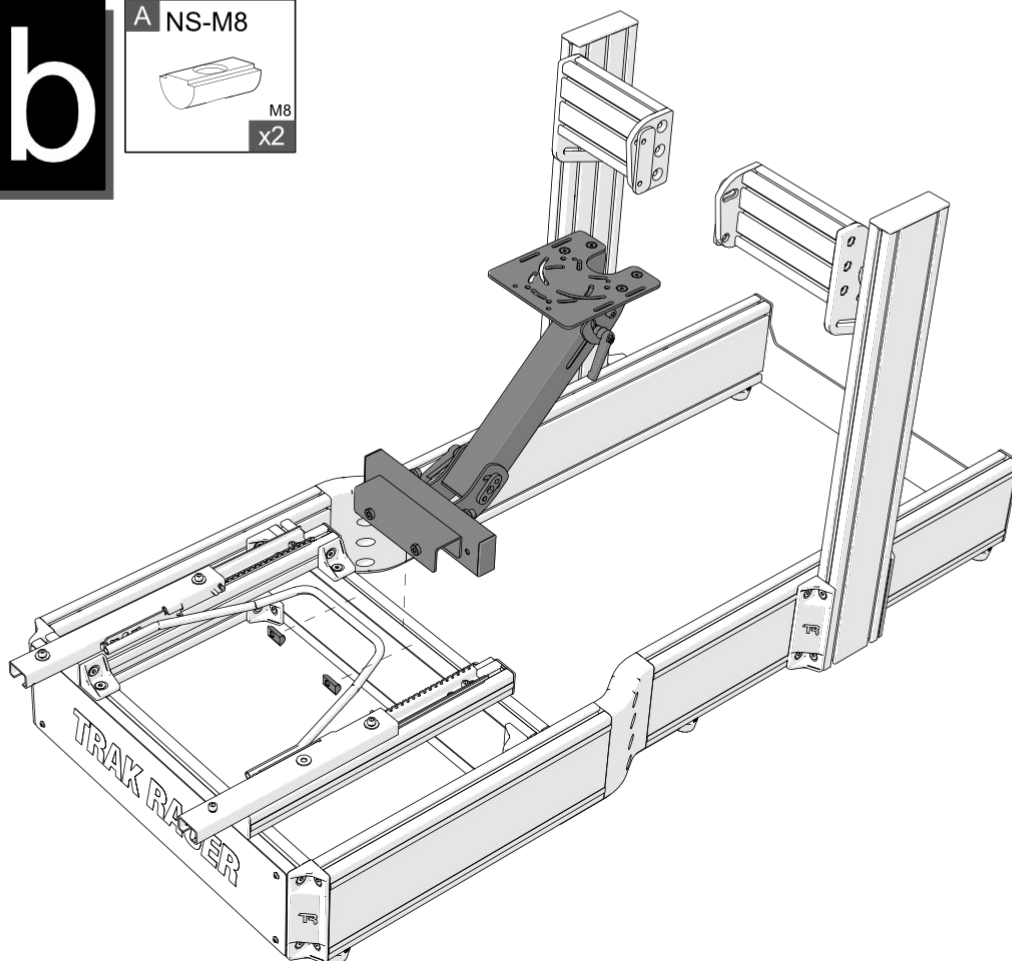
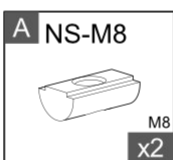

3c

A SH-M8-20

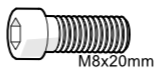

M8x20mm

x2

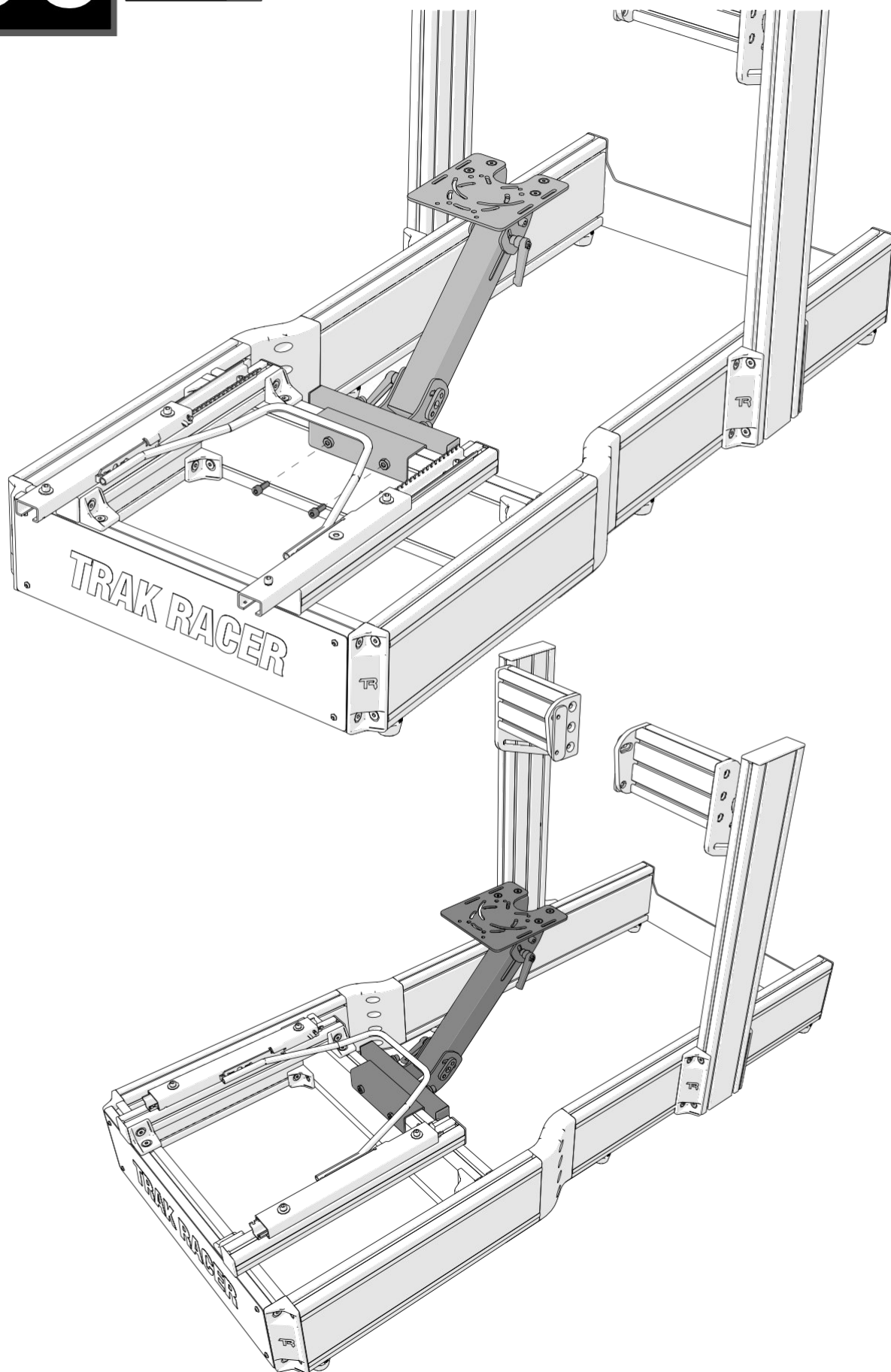

TR-1605

**Without
FWM**

3a

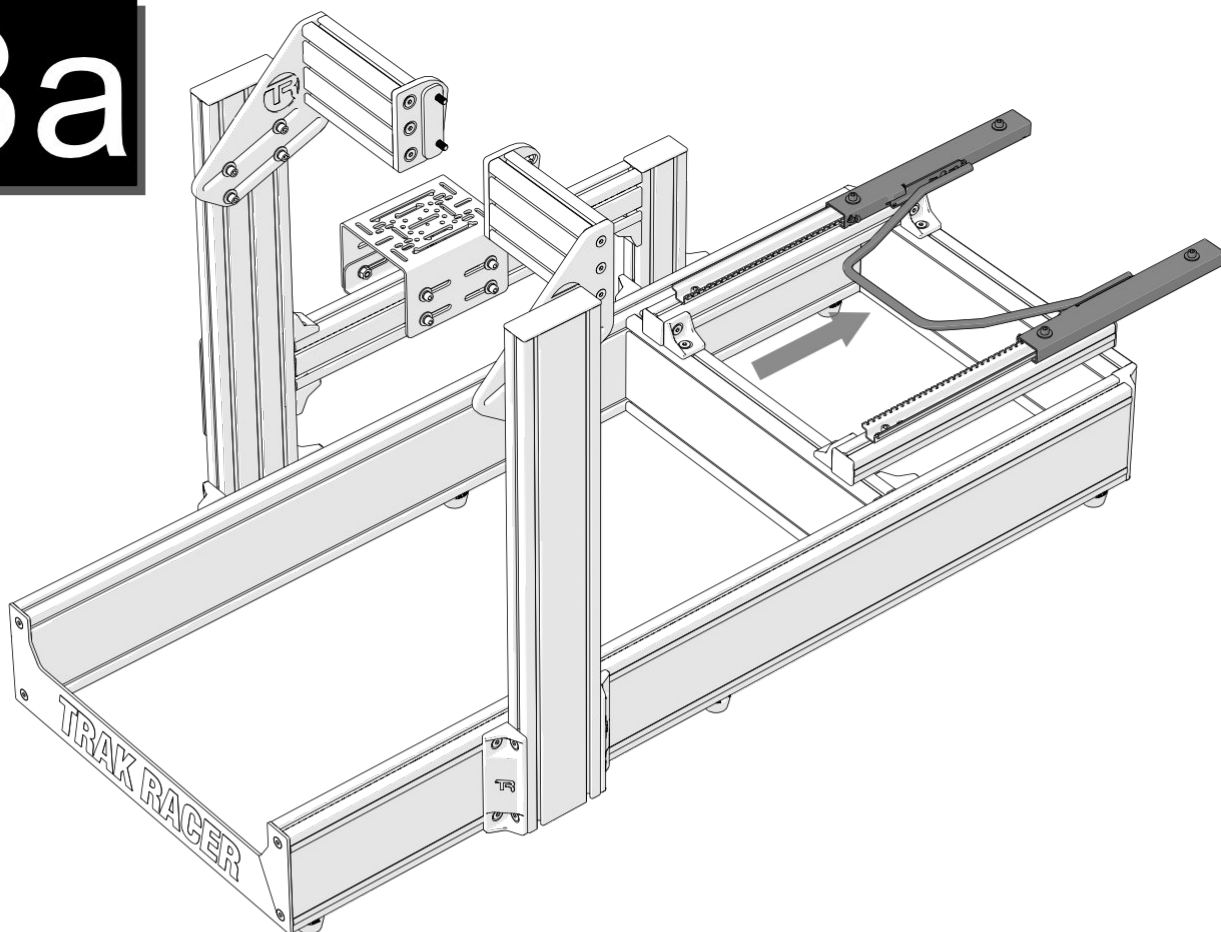

3b

A NS-M8



M8
x2

B SR-M8-20

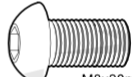

M8x20mm
x2

C WF-M8-16



M8x16mm
x2

NOTE:

- First, slide in the nuts, then install the stick mount using screws and washers.

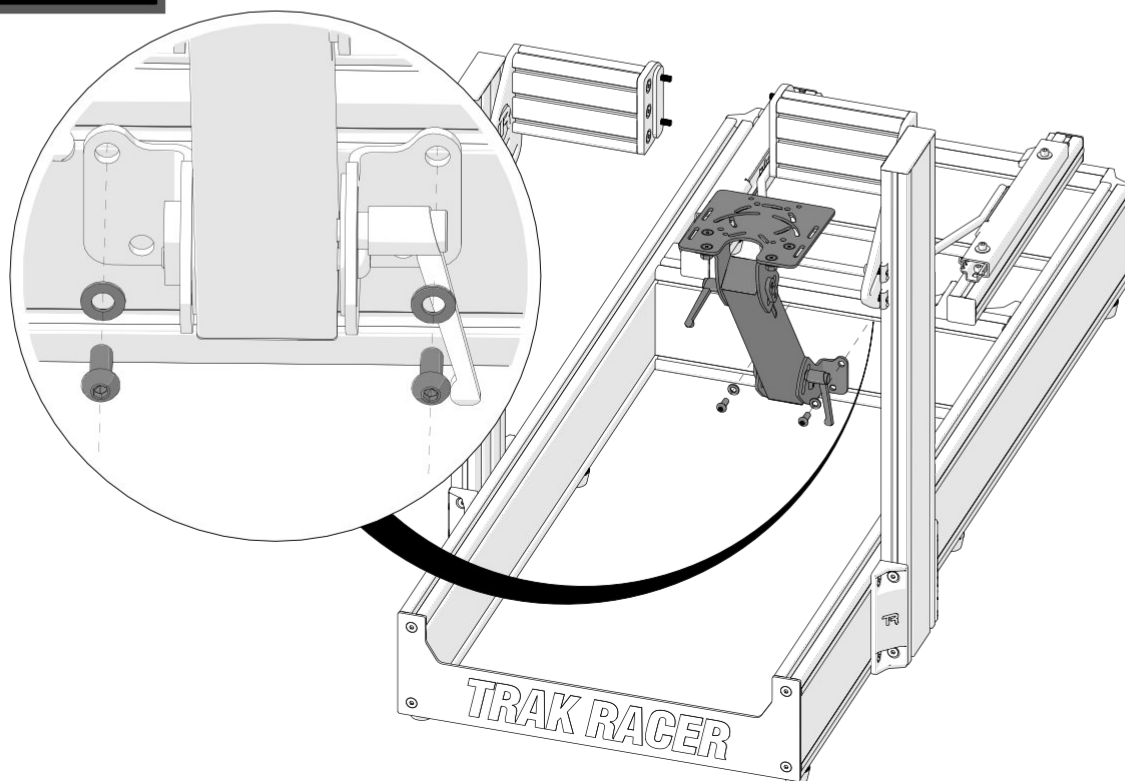

3c

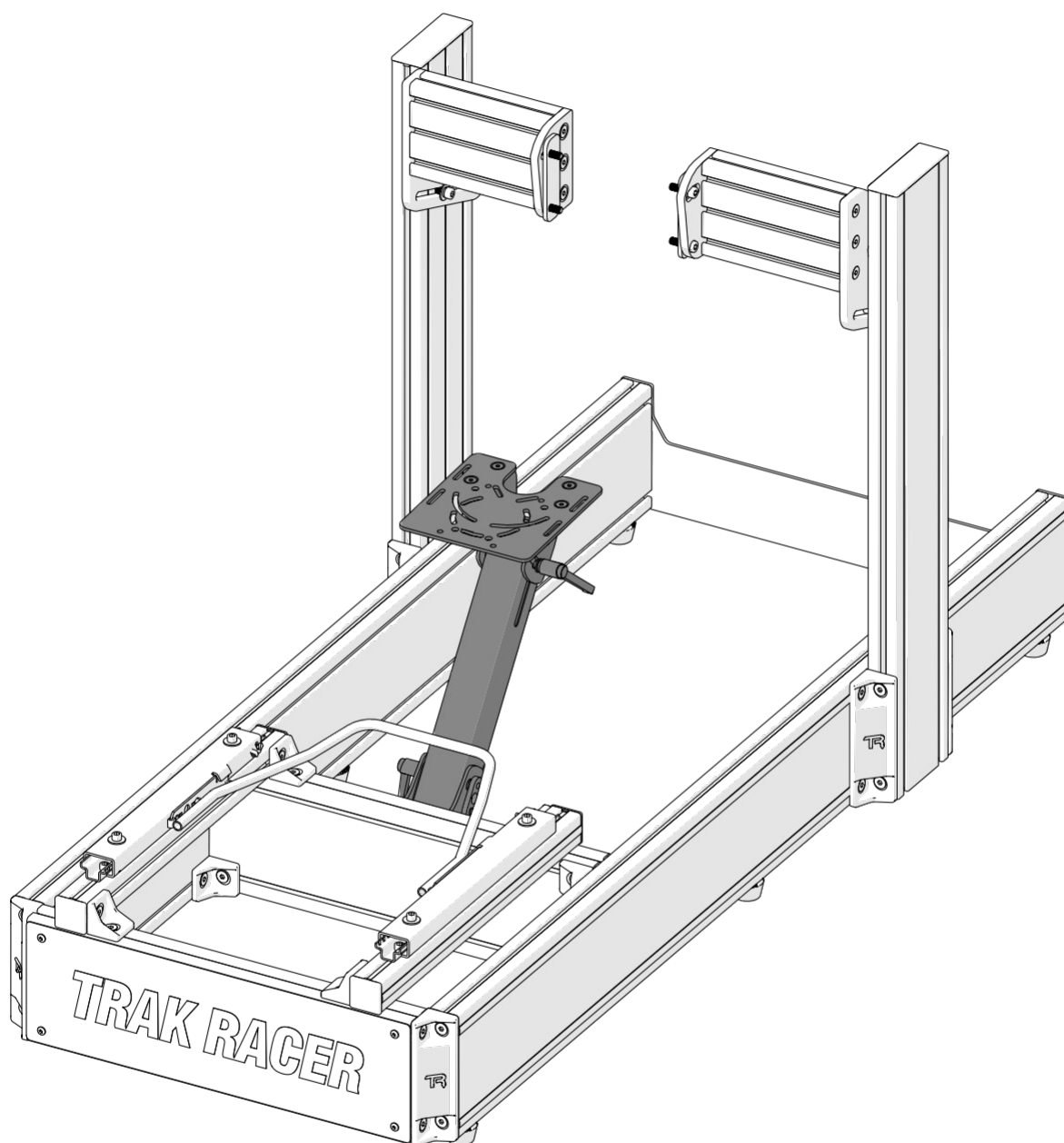

With FWM

3a

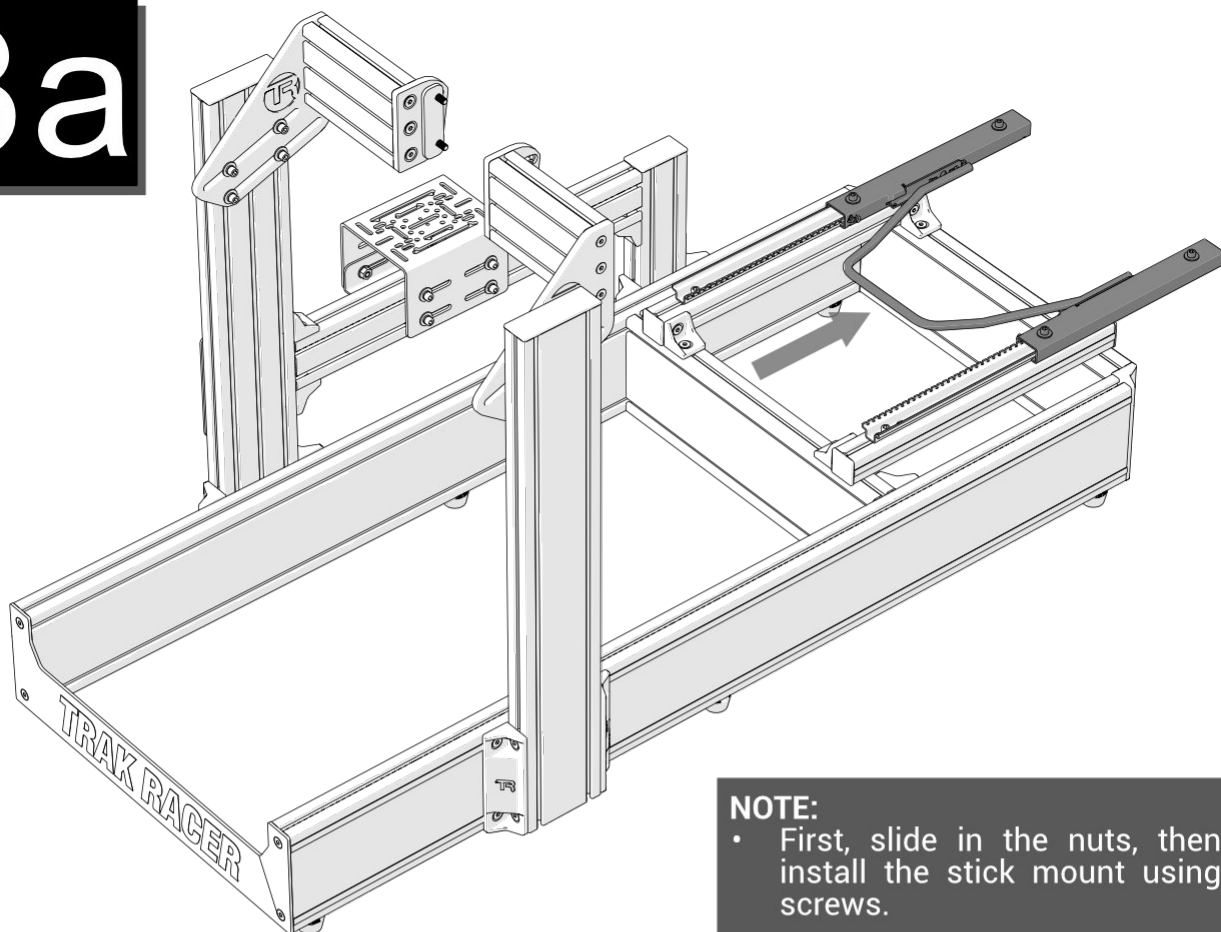

NOTE:

- First, slide in the nuts, then install the stick mount using screws.

3b

A NS-M8

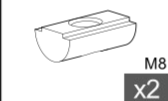

M8
x2

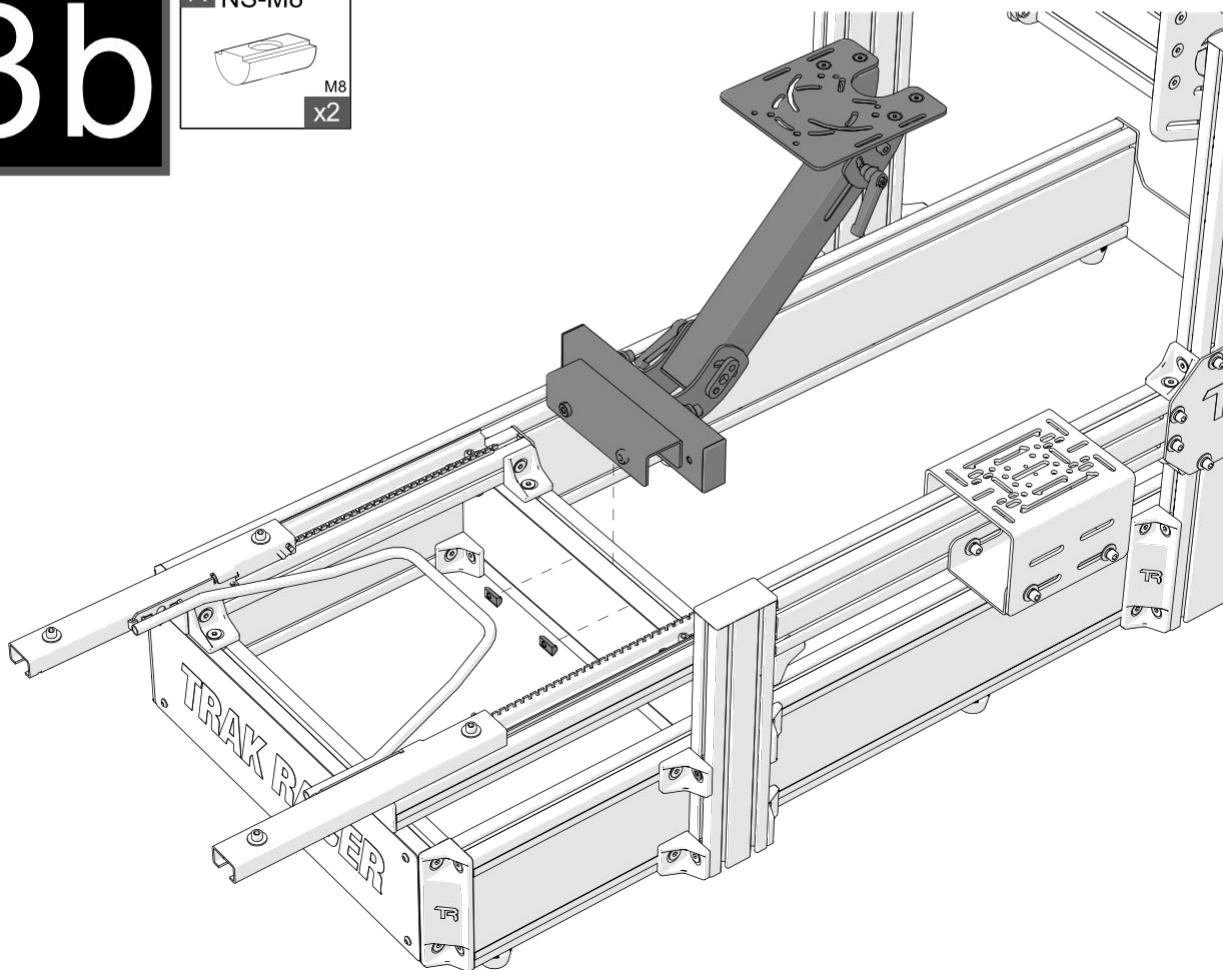

3c

A SH-M8-20

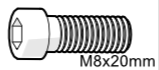

M8x20mm

x2

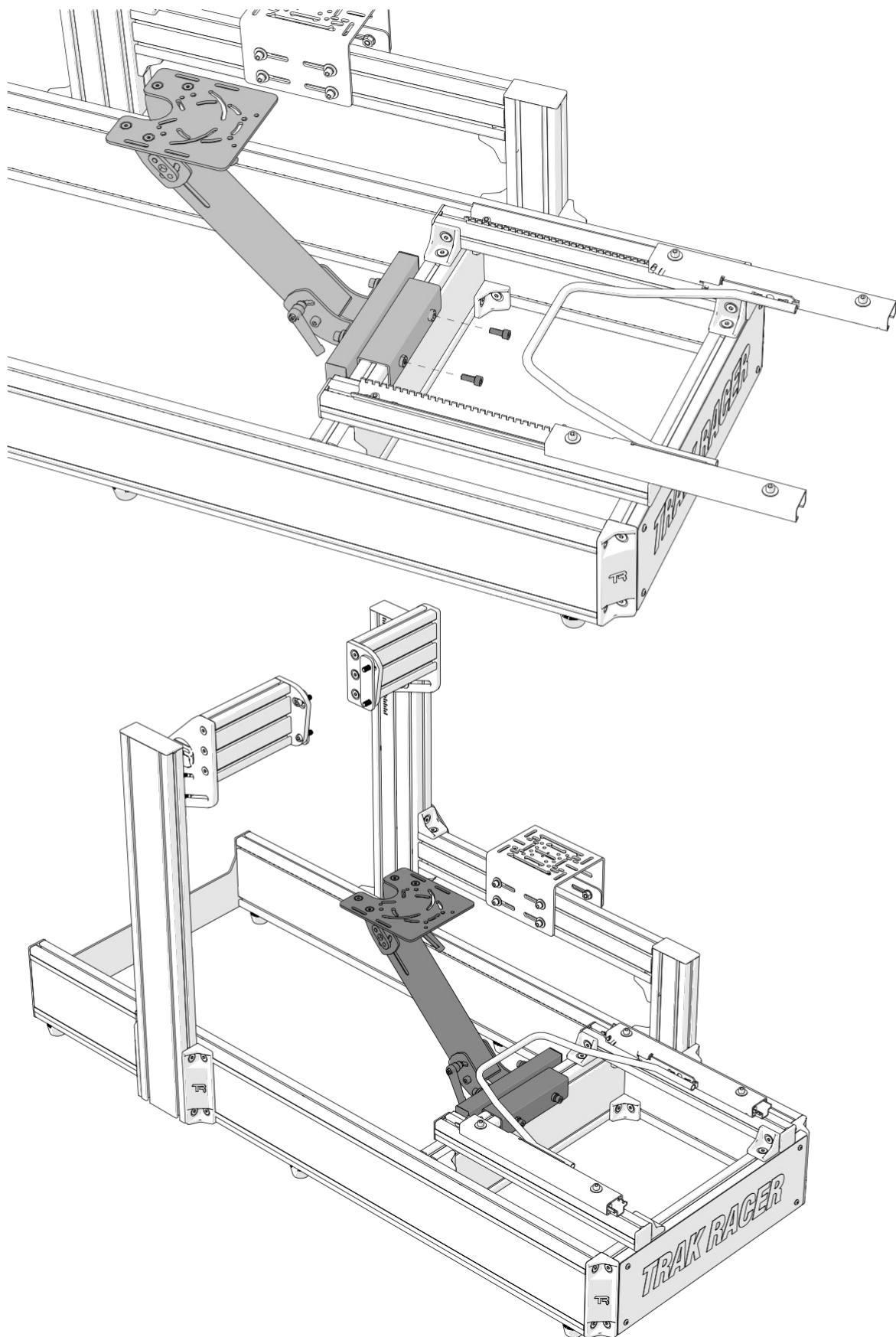

FINISHED



Share your build online and tag us to be featured!



@trakracer



@trakracer



@trak_racer