

# MONITOR STAND

## *Assembly Guide*

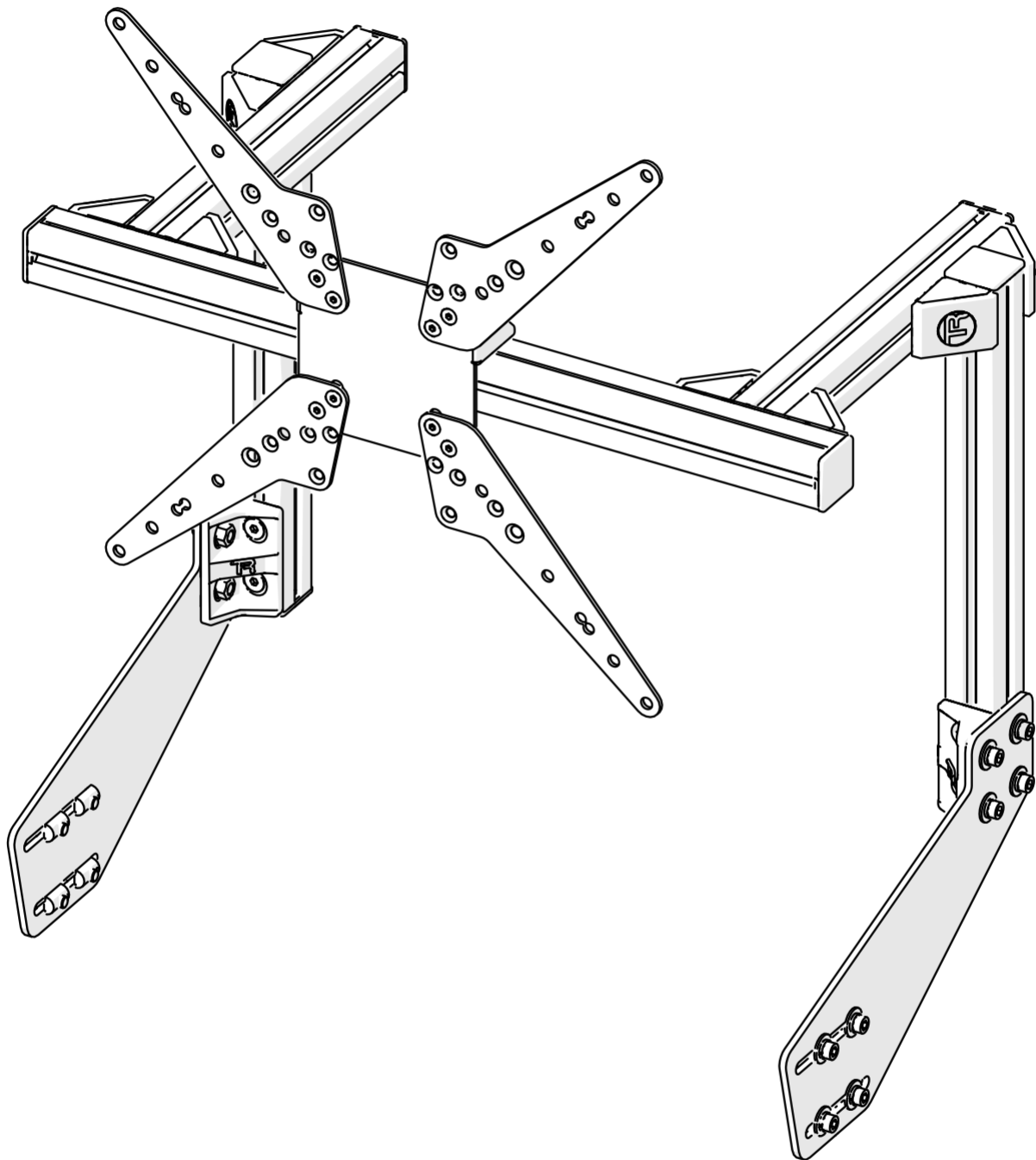

**IMPORTANT:** Different regions may have different models. Please ensure the part number below matches that on your product's box.

**MS-CM-SML2**



**TRAK RACER**

Published Apr 1, 2025

# TABLE OF CONTENTS

3 Symbol Legend

---

4 Part List

---

5 Assembly Notes

---

9 Assembly Instructions



**IMPORTANT:** Since there are different versions of each product based on your region, please make sure you are using the correct set of instructions. The part number below should match the one on your box.



**IMPORTANT:** Due to the nature of cut aluminum profiles, some metal shavings may remain despite our thorough QA cleaning process. We recommend opening boxes and packaging on a hard surface.



**NOTE:** Some screws and washers may be pre-installed. These are included in the parts list and will need to be loosened and reattached according to the instructions.



Recommended: Two people for the task



Tighten the hardware



Keep the hardware loose for adjustments

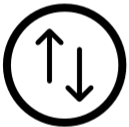

Make the necessary adjustments



Break the tab off the corner bracket



Safety glasses required



Attention/Priority needed



Reserve for the next step



Mirrored components (same on both sides)

# PART LISTS

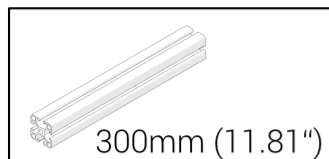

Aluminum Profile

AL-4040-300 x2

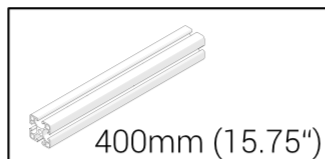

Aluminum Profile

AL-4040-400 x2

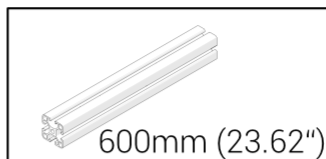

Aluminum Profile

AL-4040-600 x1

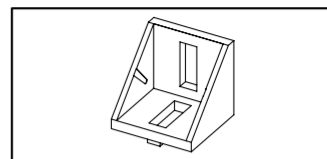

Corner Bracket

BC-40 x8

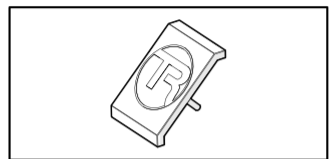

Corner Bracket Cap

BC-40-CAP x8

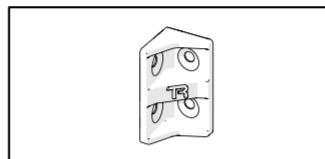

Corner Bracket, 40x80

CB-80 x2

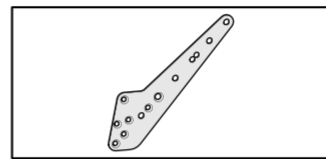

Extended Film

TR-80B x4

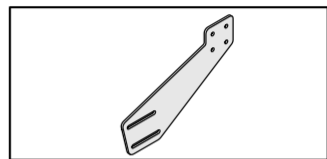

Monitor Side Bracket

CP-3 x2

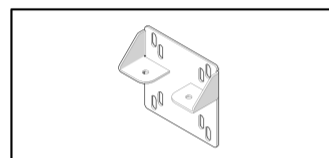

TV Back Panel

TV-B-P x1

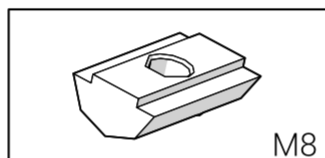

Ball Bearing Nut

NS-M8 x34

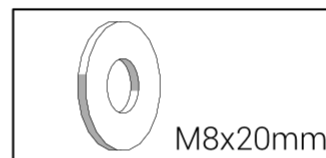

Washer (Flat)

WF-M8-20 x34

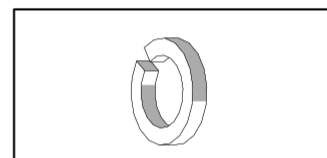

Washer (Lock), M8

WL-M8 x32

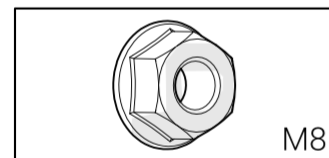

Flange Nut

NF-M8 x4

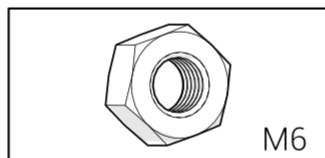

Nut, M6

NL-M6 x8

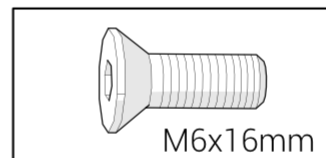

Screw (Flat)

SF-M6-16 x8

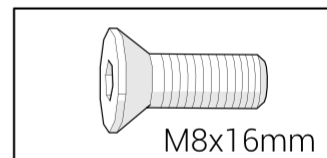

Screw (Flat)

SF-M8-16 x4

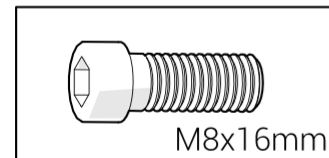

Screw (Hex)

SH-M8-16 x2

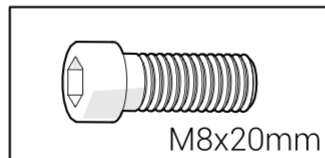

Screw (Hex)

SH-M8-20 x32

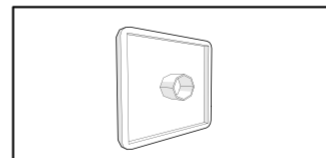

End Cap, 40x40

EC-40 x8



**NOTE:** Some screws and washers may be pre-installed. These are included in the parts list and will need to be loosened and reattached according to the instructions.

# NOTE

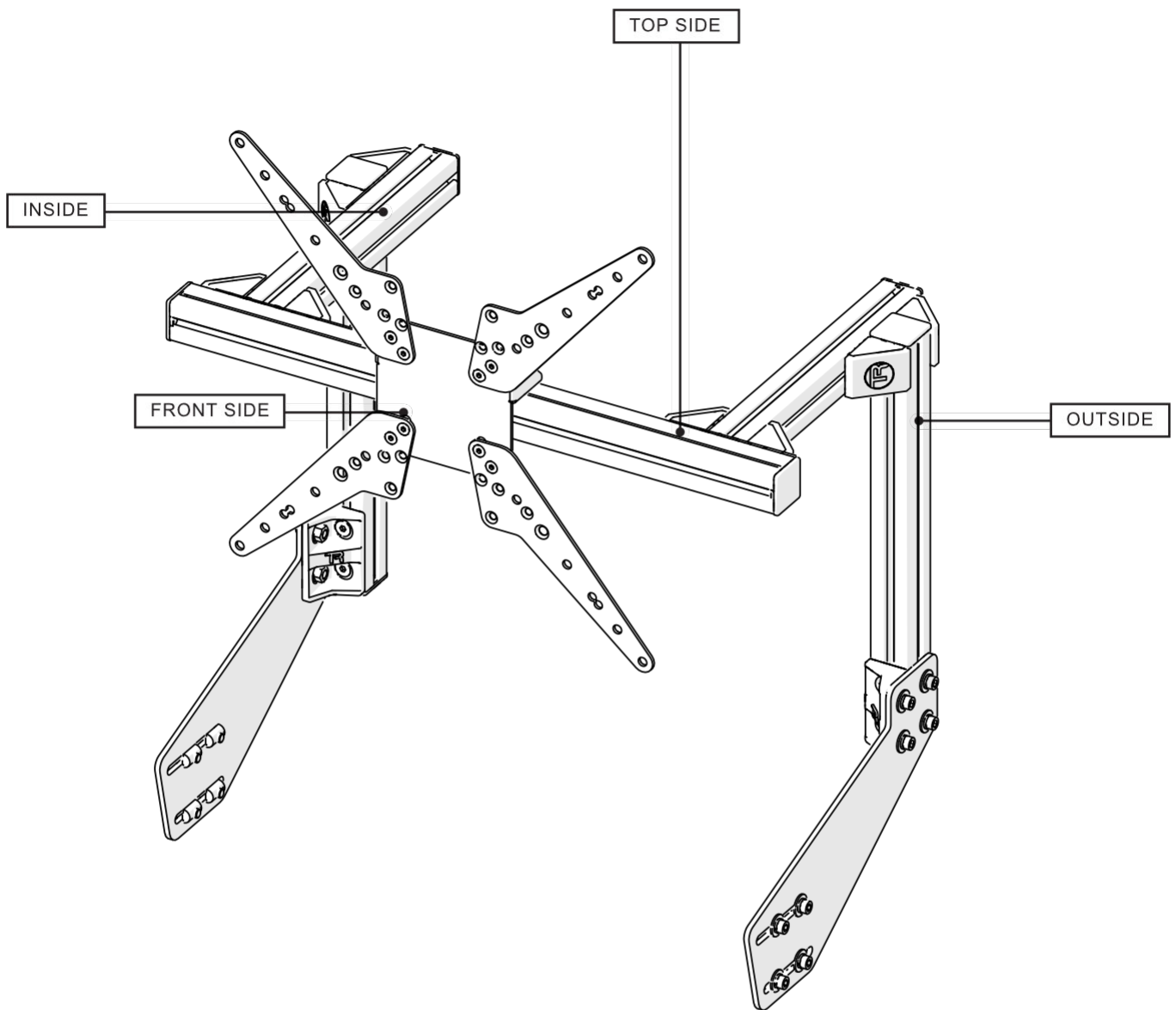

## INSTALLATION ORDER FOR SCREWS & WASHERS

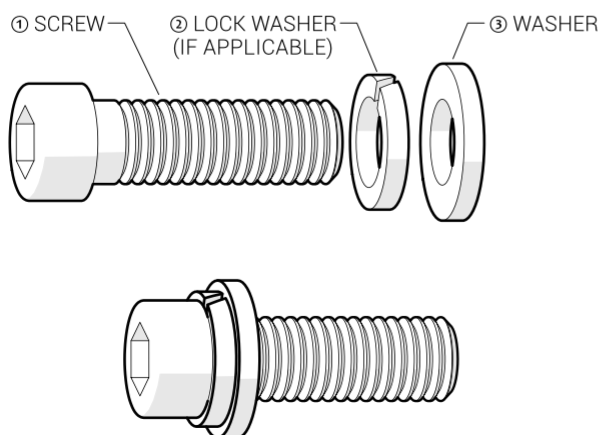

## HOW TO MEASURE SCREWS

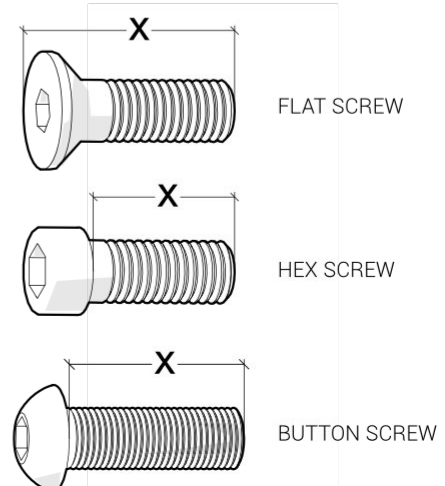

# NOTE

## NS-M8 & NS-M6

Slide T-Nuts into the ends of the profiles. Some must be added early, so follow the steps in this manual carefully.

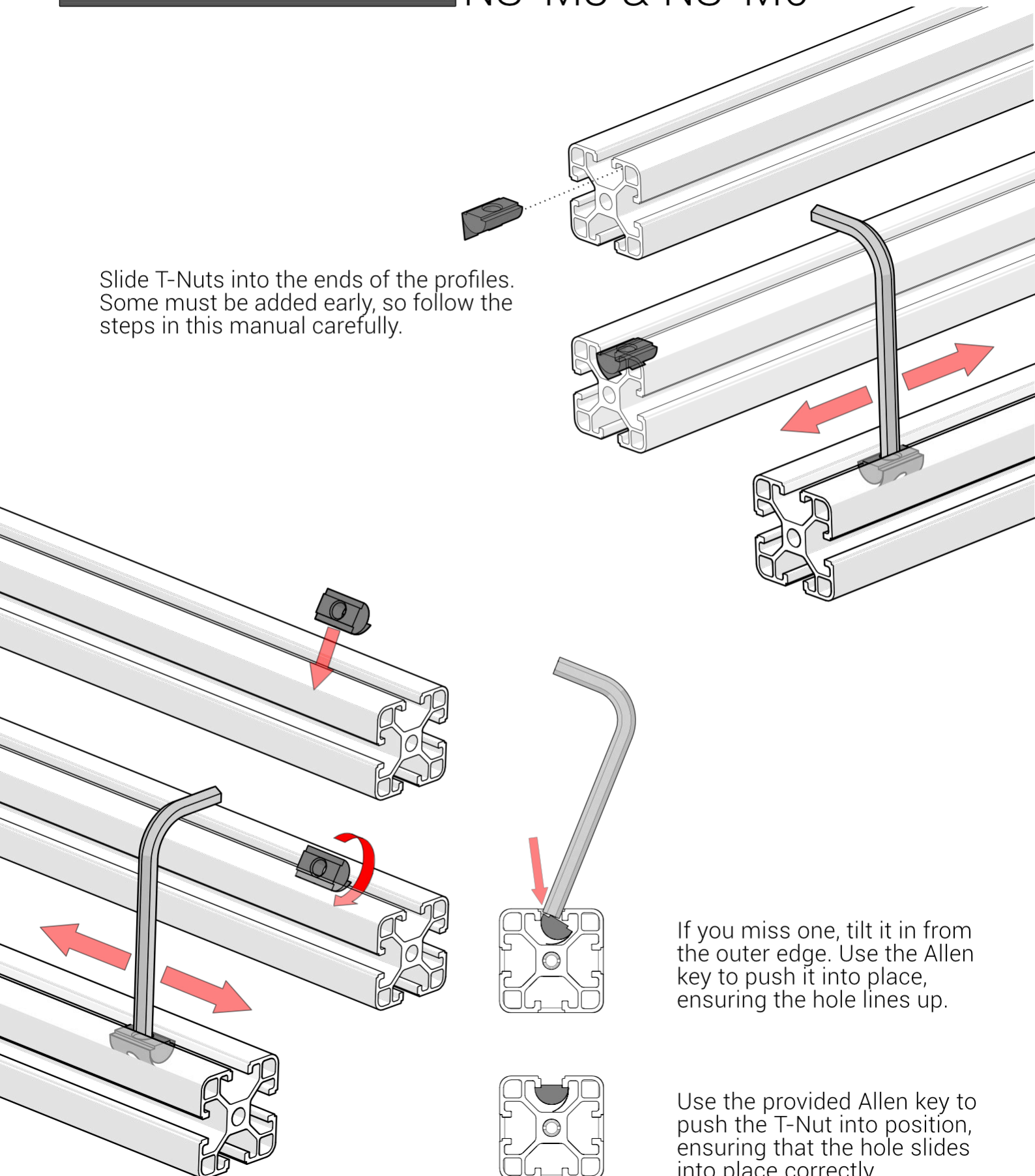

If you miss one, tilt it in from the outer edge. Use the Allen key to push it into place, ensuring the hole lines up.

Use the provided Allen key to push the T-Nut into position, ensuring that the hole slides into place correctly.

# NOTE

## BC-40 & CB-40

These brackets come with guide tabs on the rear. These tabs help align the brackets to the profile when fitted in the same orientation as the profile. When used in the alternate orientation, these tabs are designed to snap off for a flush mount against the profile.

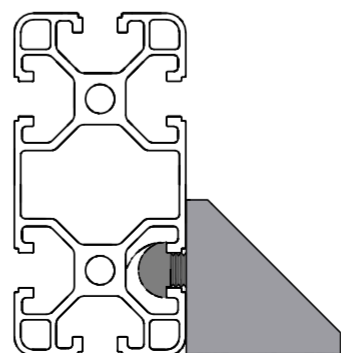
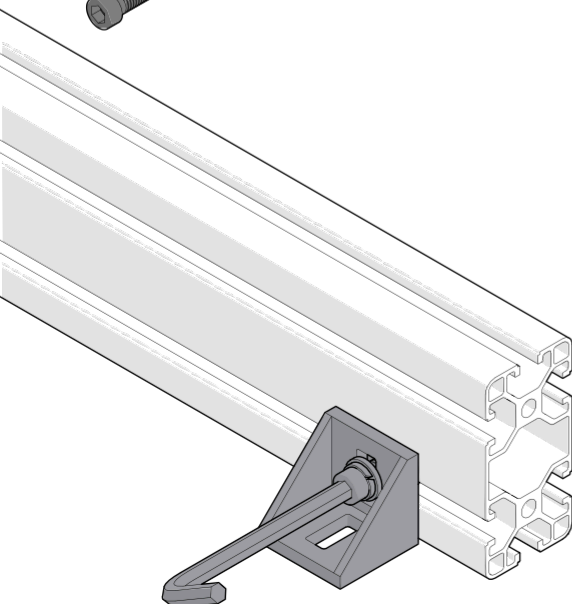
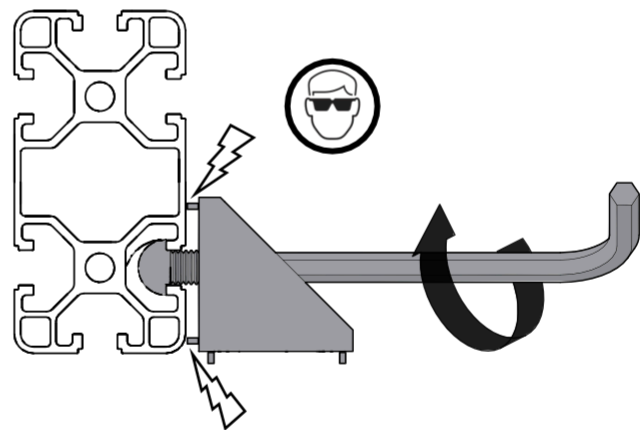
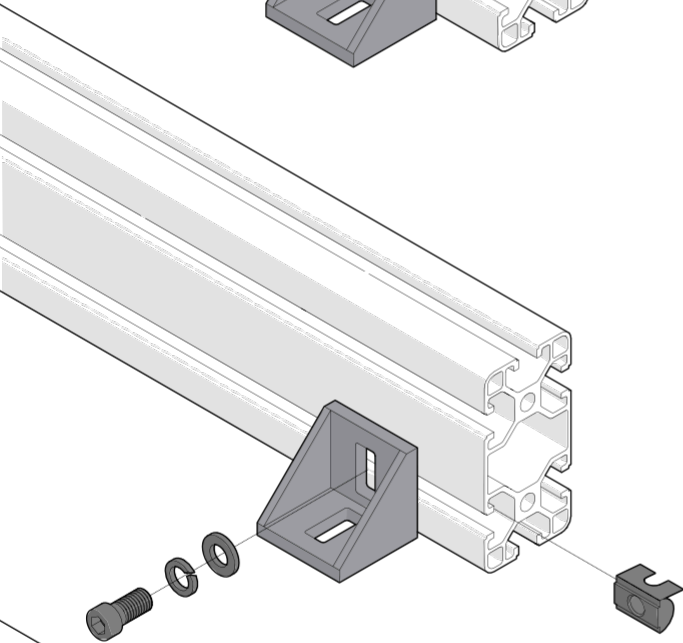
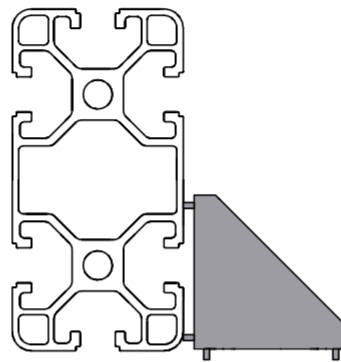
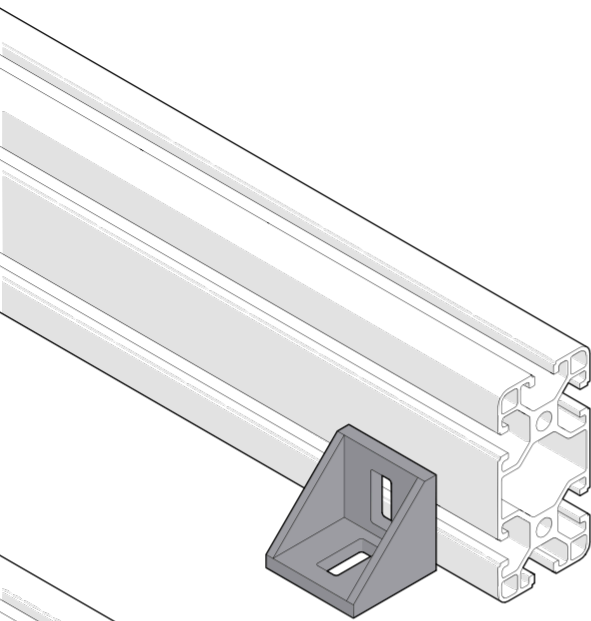



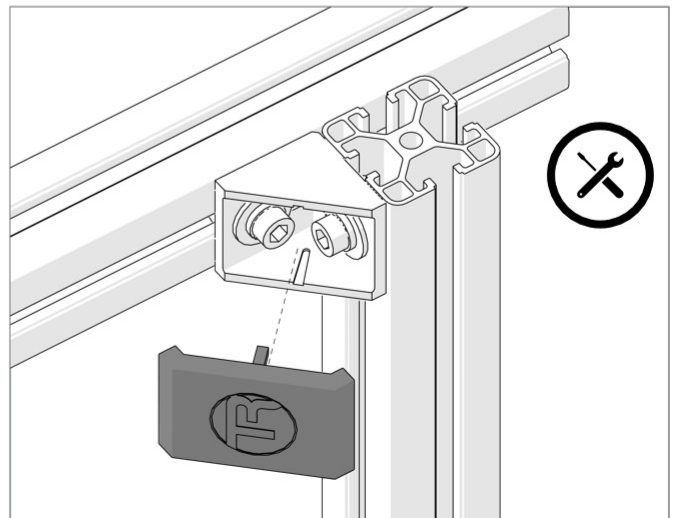
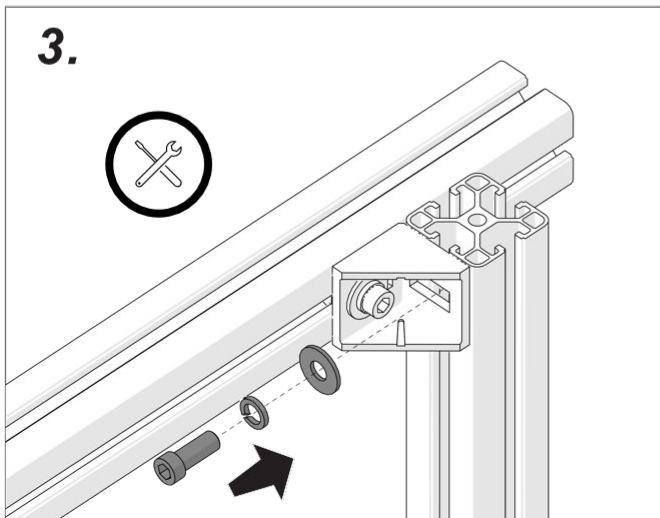
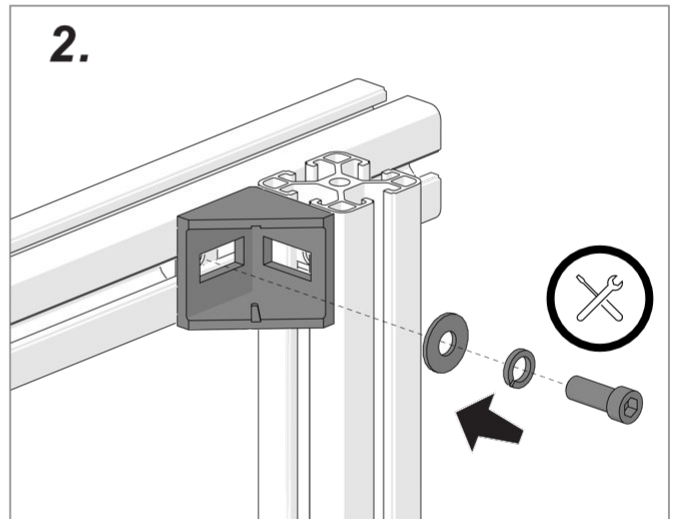
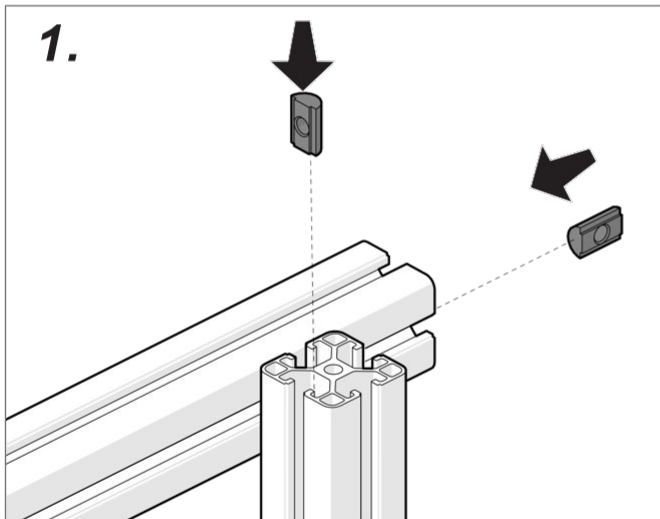
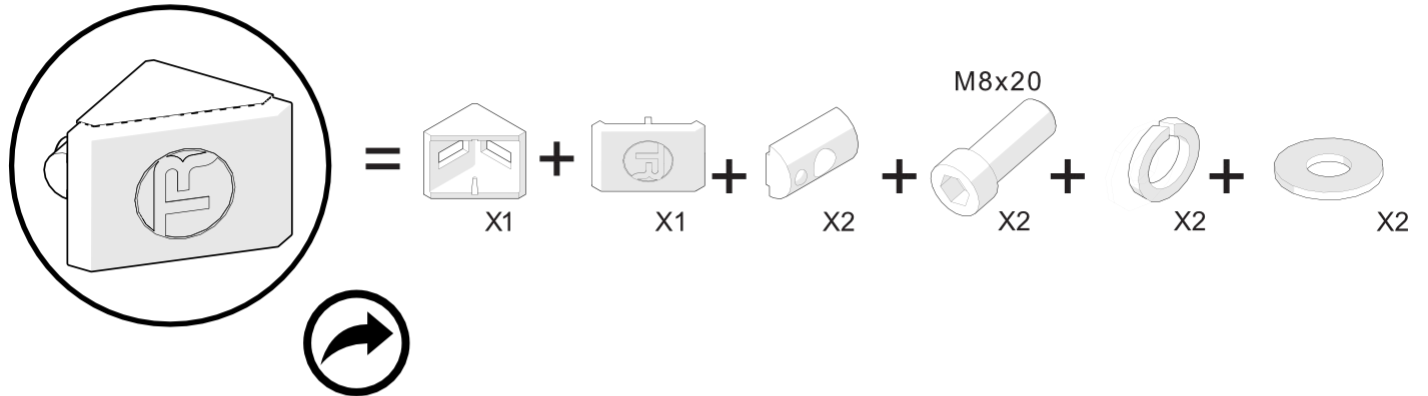
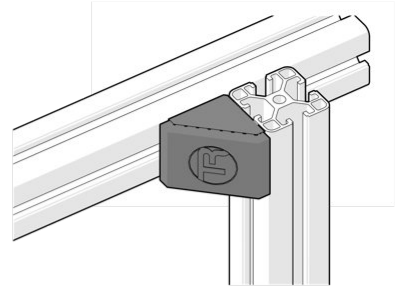

# NOTE

## ALUMINUM PROFILE ASSEMBLY







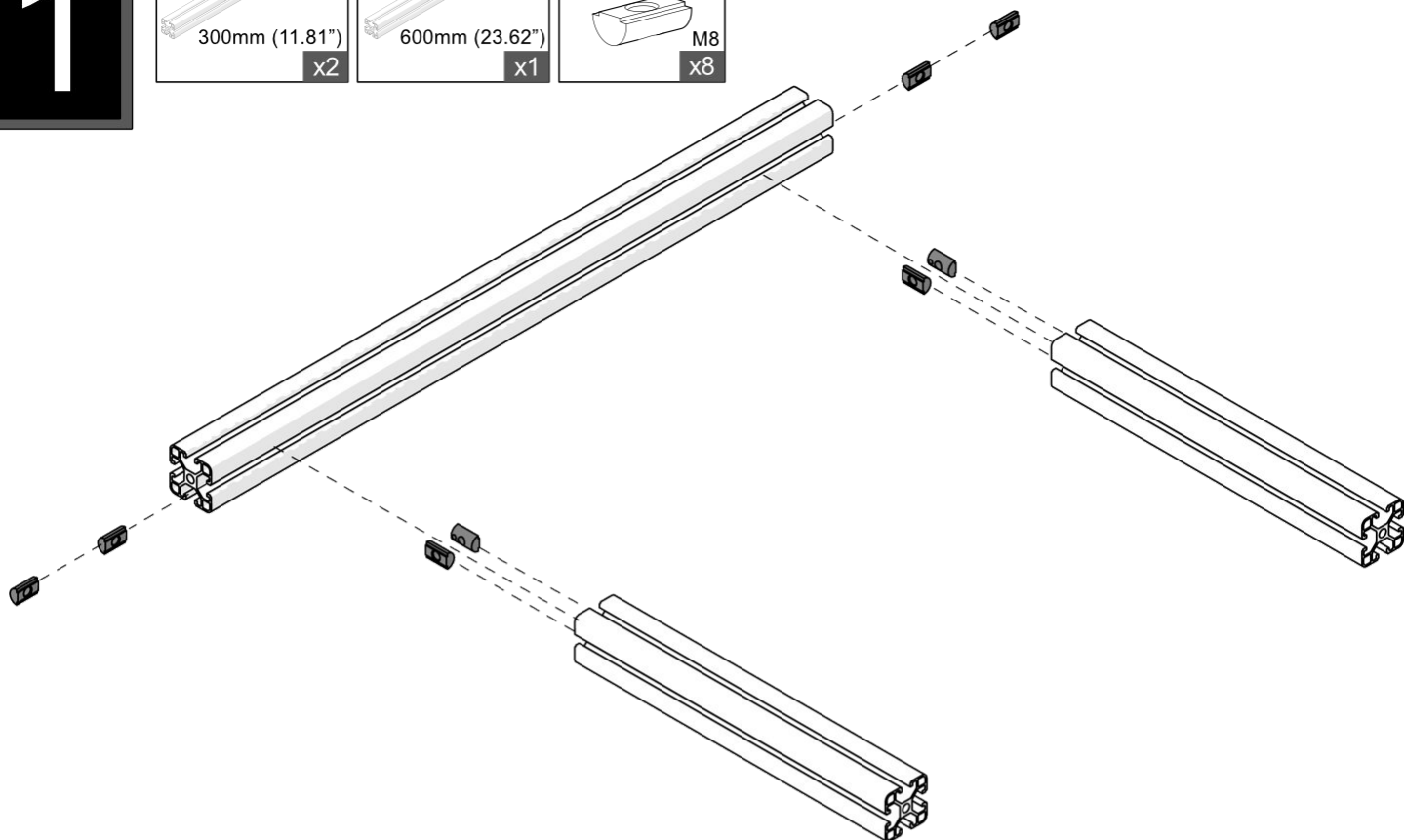

# 1

<b>A</b> TR-4040-300  300mm (11.81") <b>x2</b>	<b>B</b> TR-4040-600  600mm (23.62") <b>x1</b>	<b>C</b> NS-M8  M8 <b>x8</b>
---	---	--

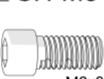

# 2

<b>A</b> WF-M8-20  M8x20mm <b>x8</b>	<b>B</b> WL-M8  <b>x8</b>	<b>C</b> SH-M8-20  M8x20mm <b>x8</b>	<b>D</b> BC-40  <b>x4</b>
--	--	--	--

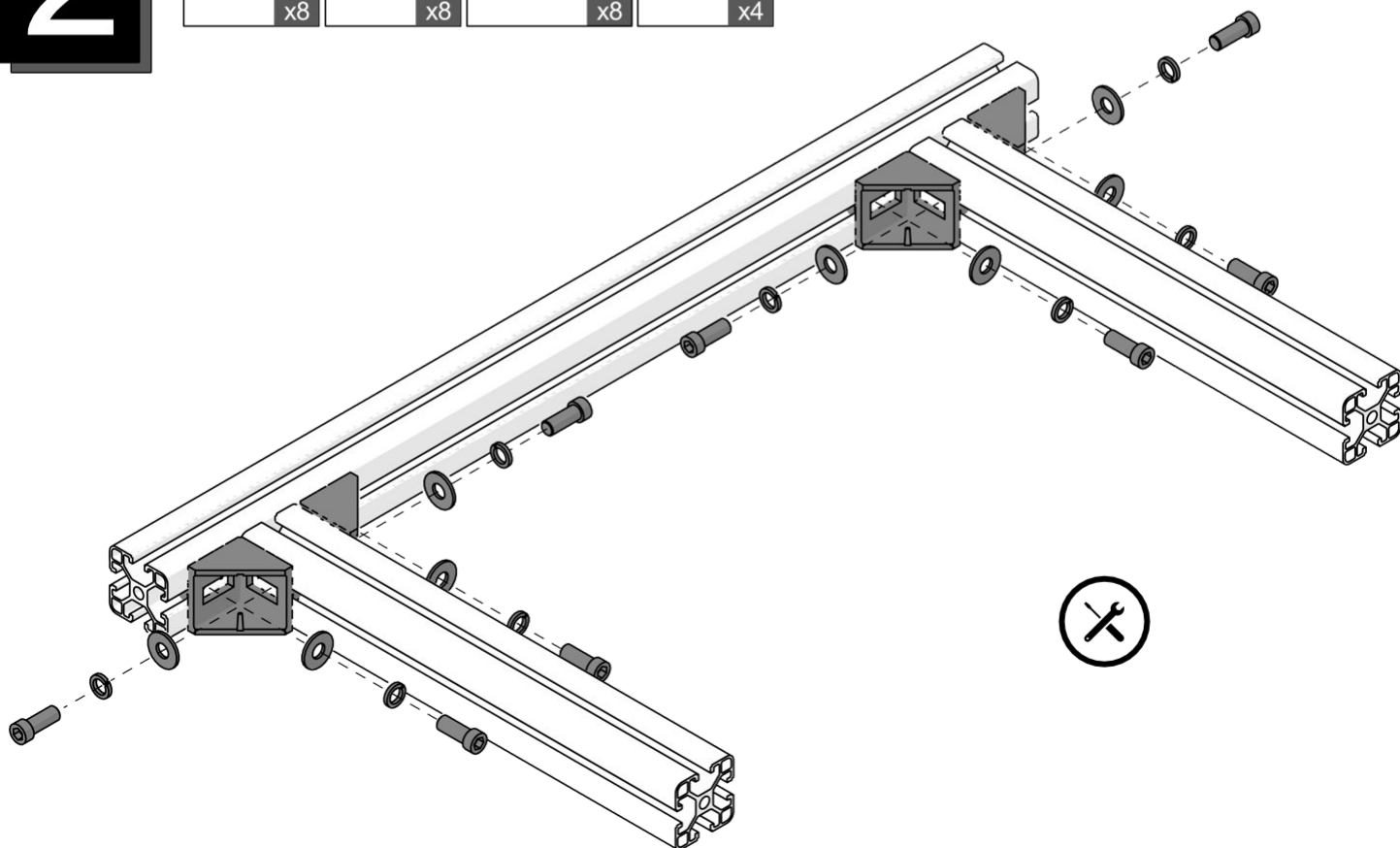

3

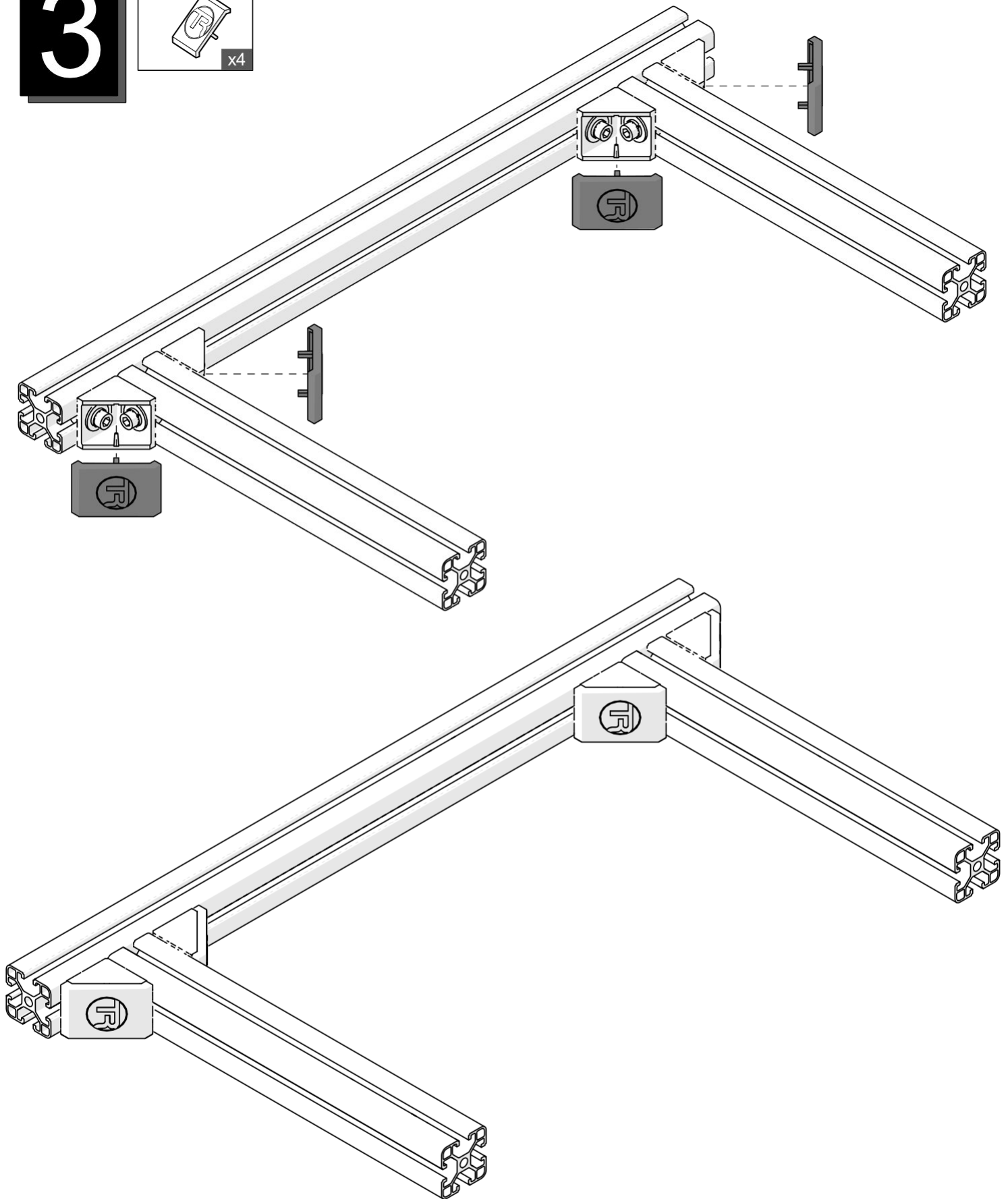
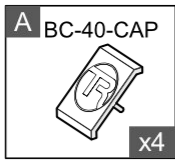

See note ALUMINUM PROFILE ASSEMBLY at page 9

# 4

A TR-4040-400

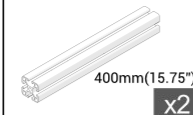



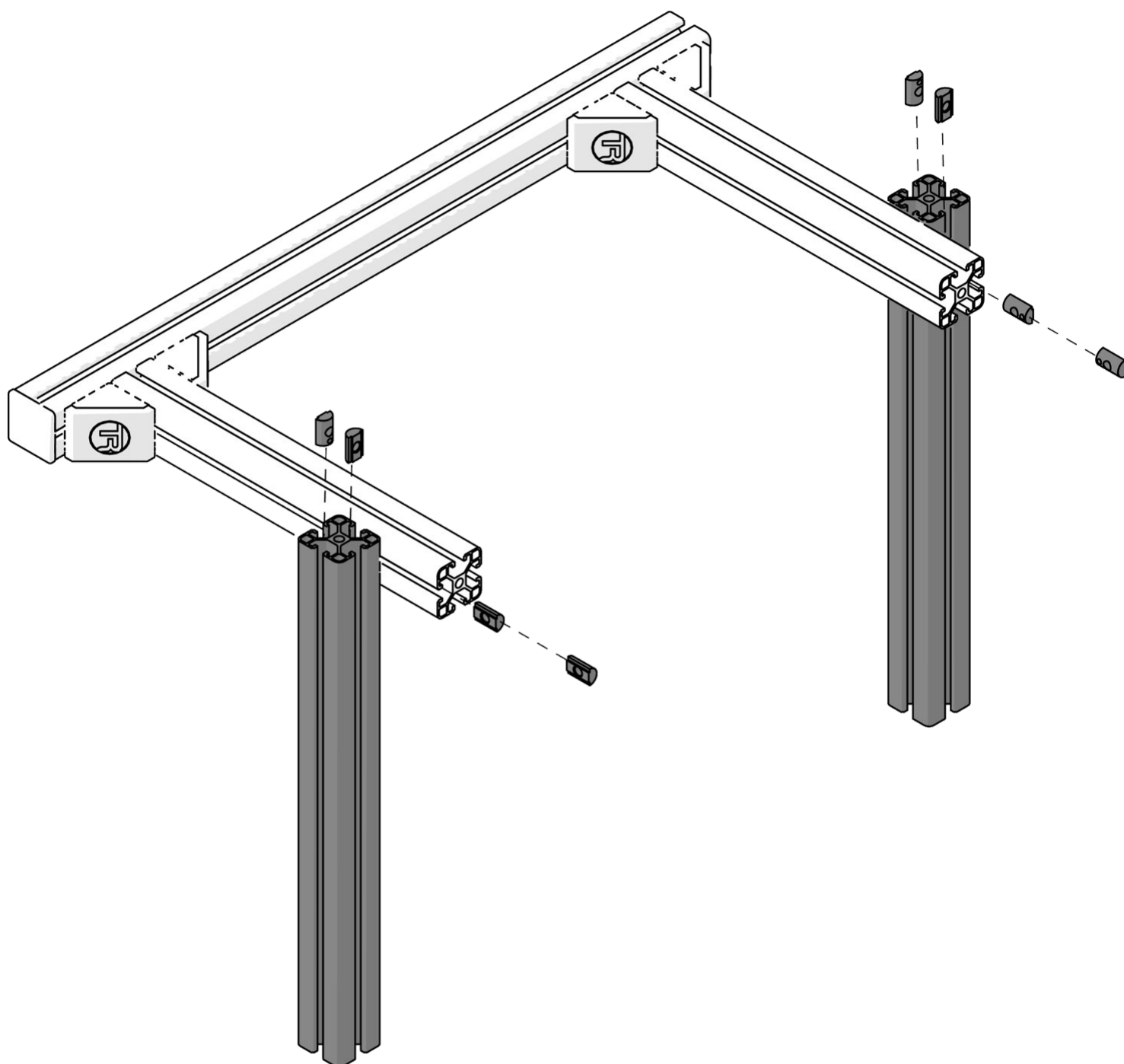
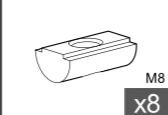

B NS-M8

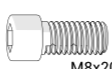

See note ALUMINUM PROFILE ASSEMBLY at page 9

# 5

<b>A</b> WF-M8-20  M8x20mm x8	<b>B</b> WL-M8  x8	<b>C</b> SH-M8-20  M8x20mm x8	<b>D</b> BC-40  x4
--	--	---	---

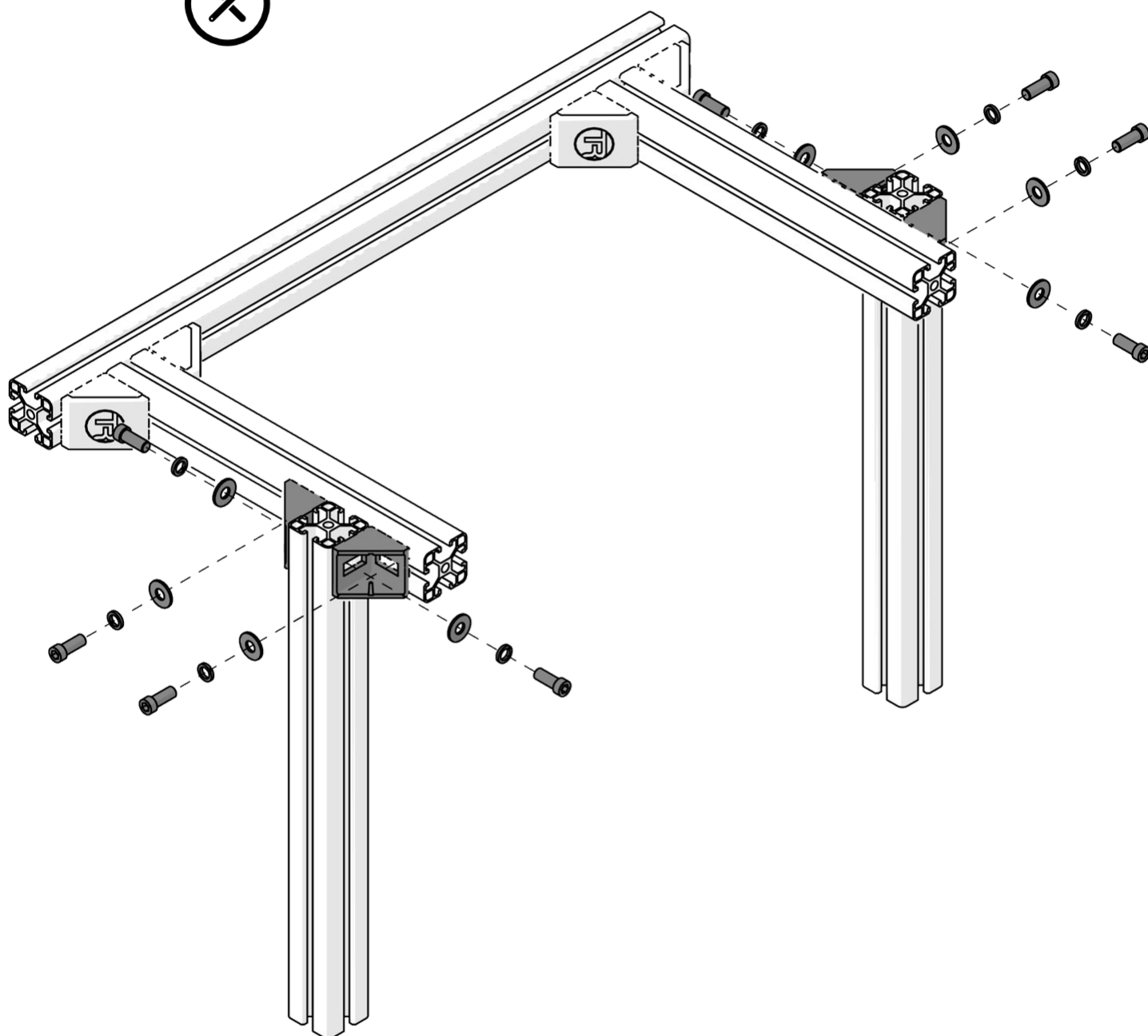

See note ALUMINUM PROFILE ASSEMBLY at page 9

6

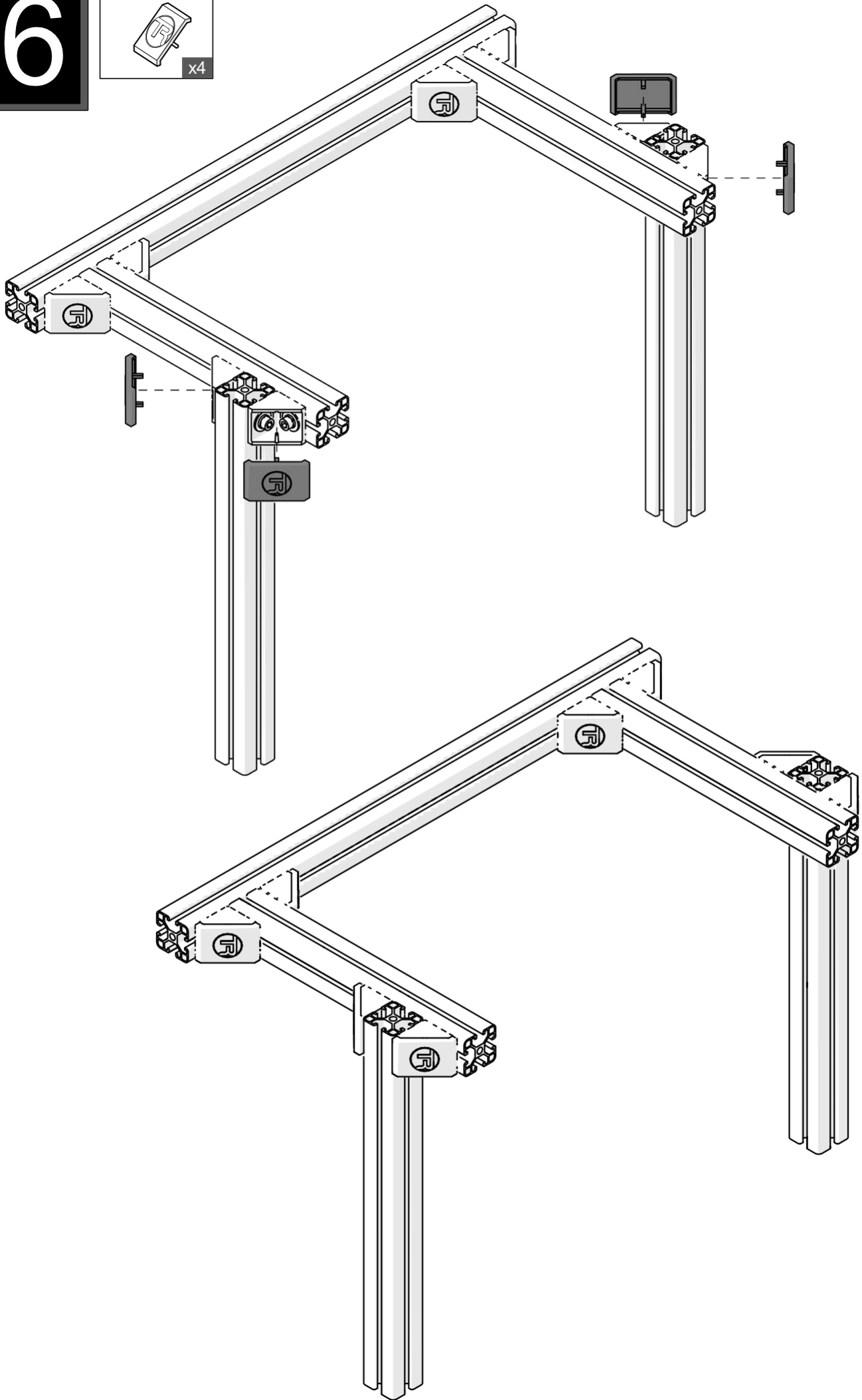
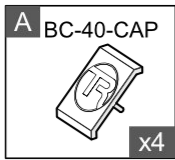

7

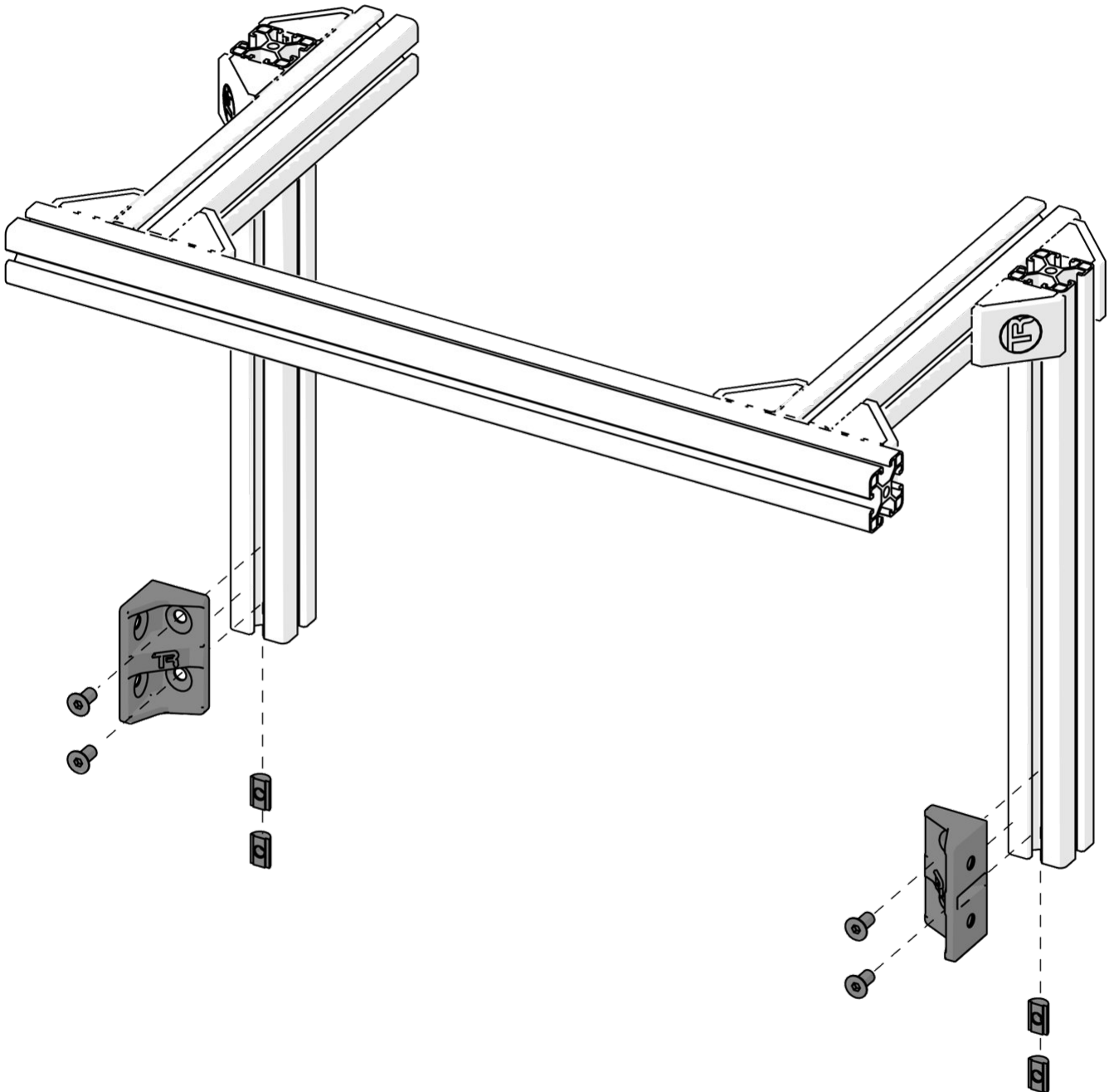
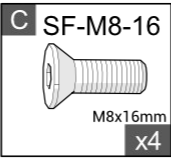
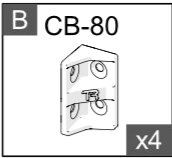
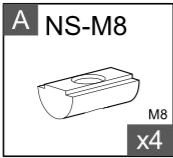

# 8

A CP-3



x2

B SH-M8-20



M8x20mm  
x16

C WF-M8-20



M8x20mm  
x16

D WL-M8



x16

E NF-M8



M8  
x4

F NS-M8



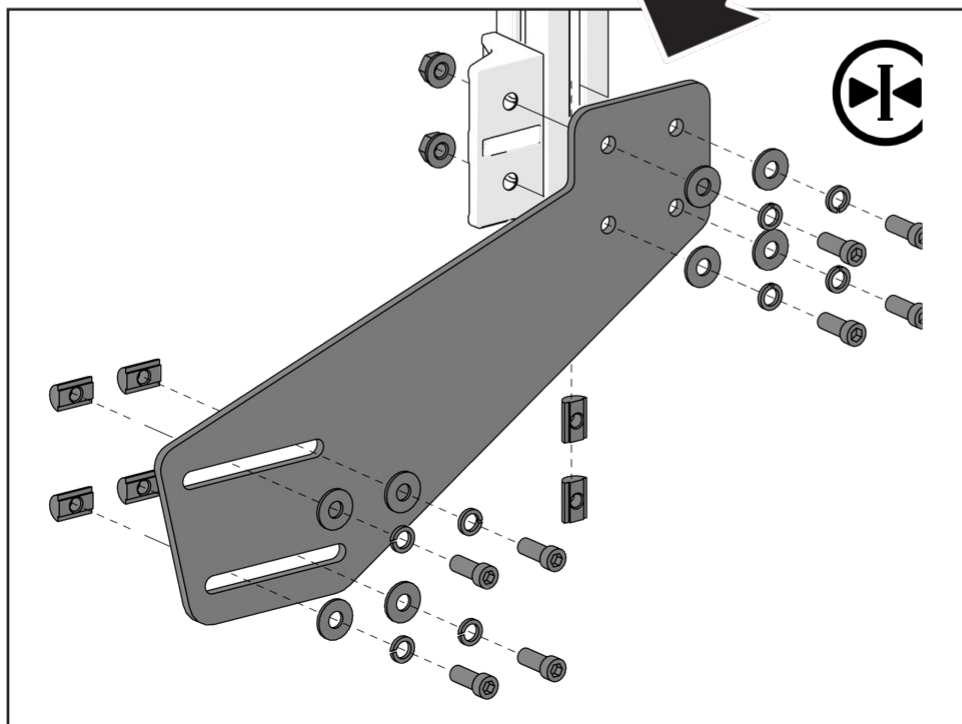
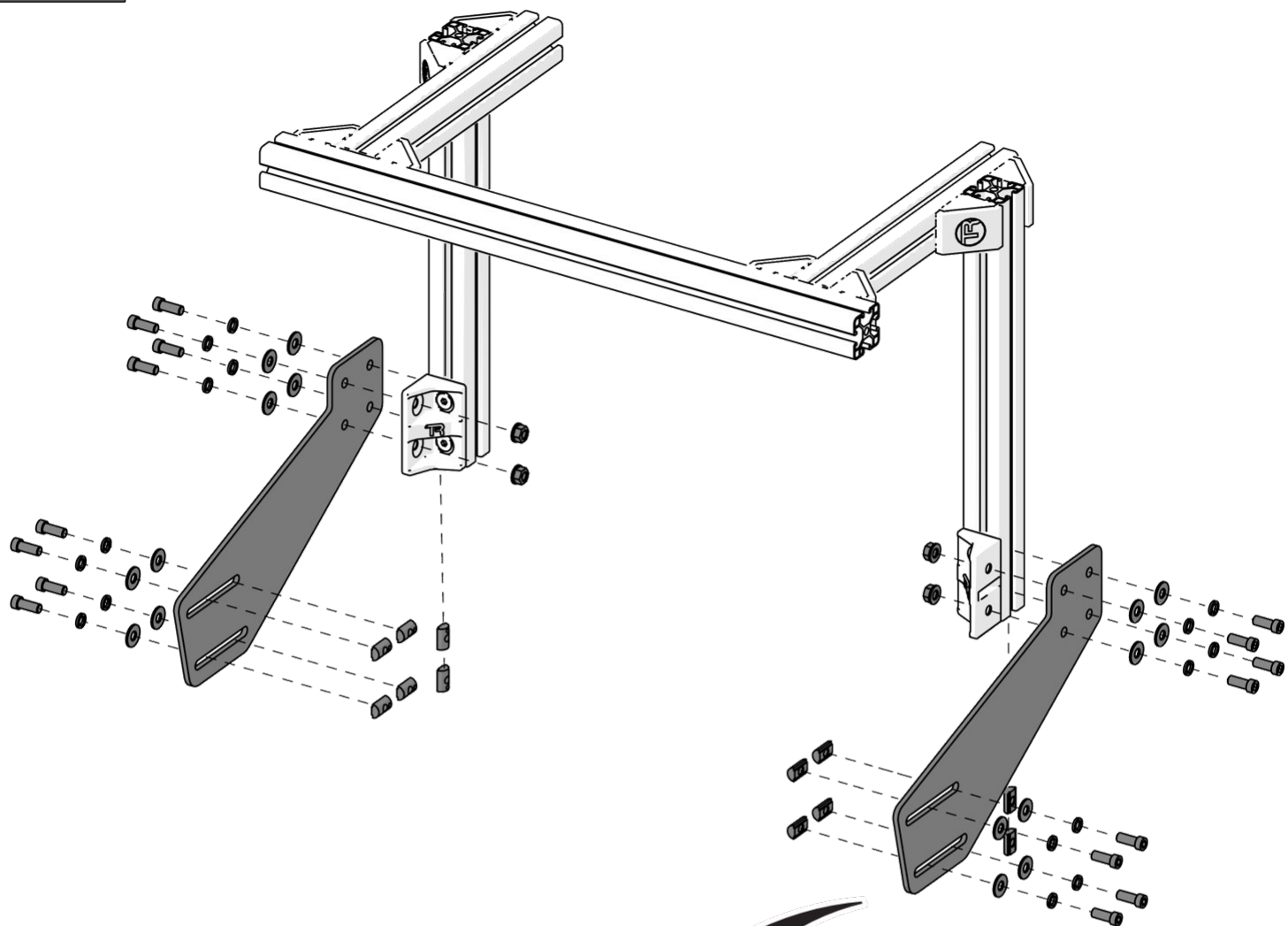

M8  
x12



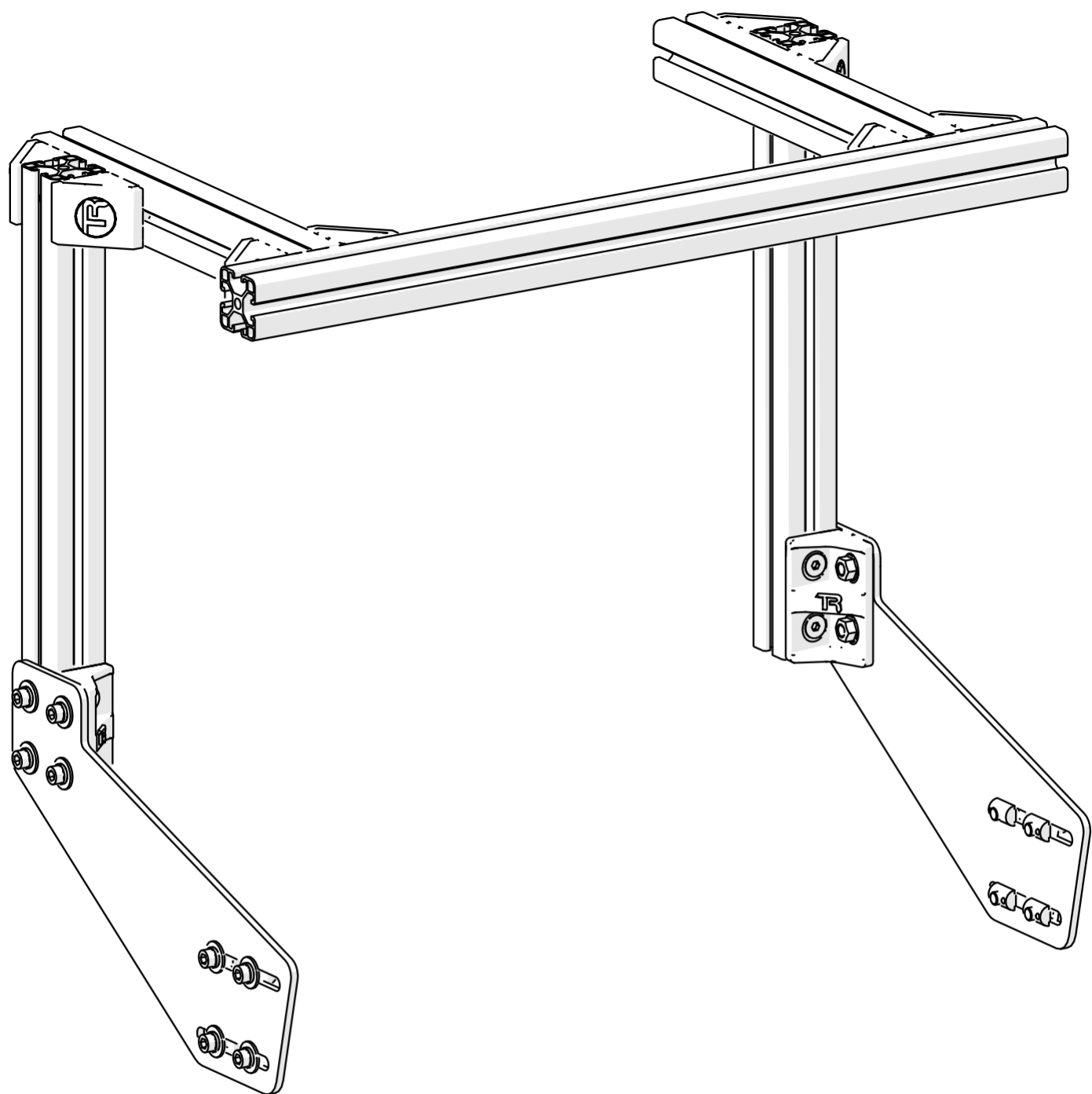

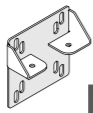
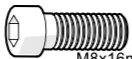

9

<b>A</b> TV-B-P  x1	<b>B</b> SH-M8-16  M8x16mm x2	<b>C</b> WF-M8-20  M8x20mm x2	<b>D</b> NS-M8  M8 x2
---	---	--	---

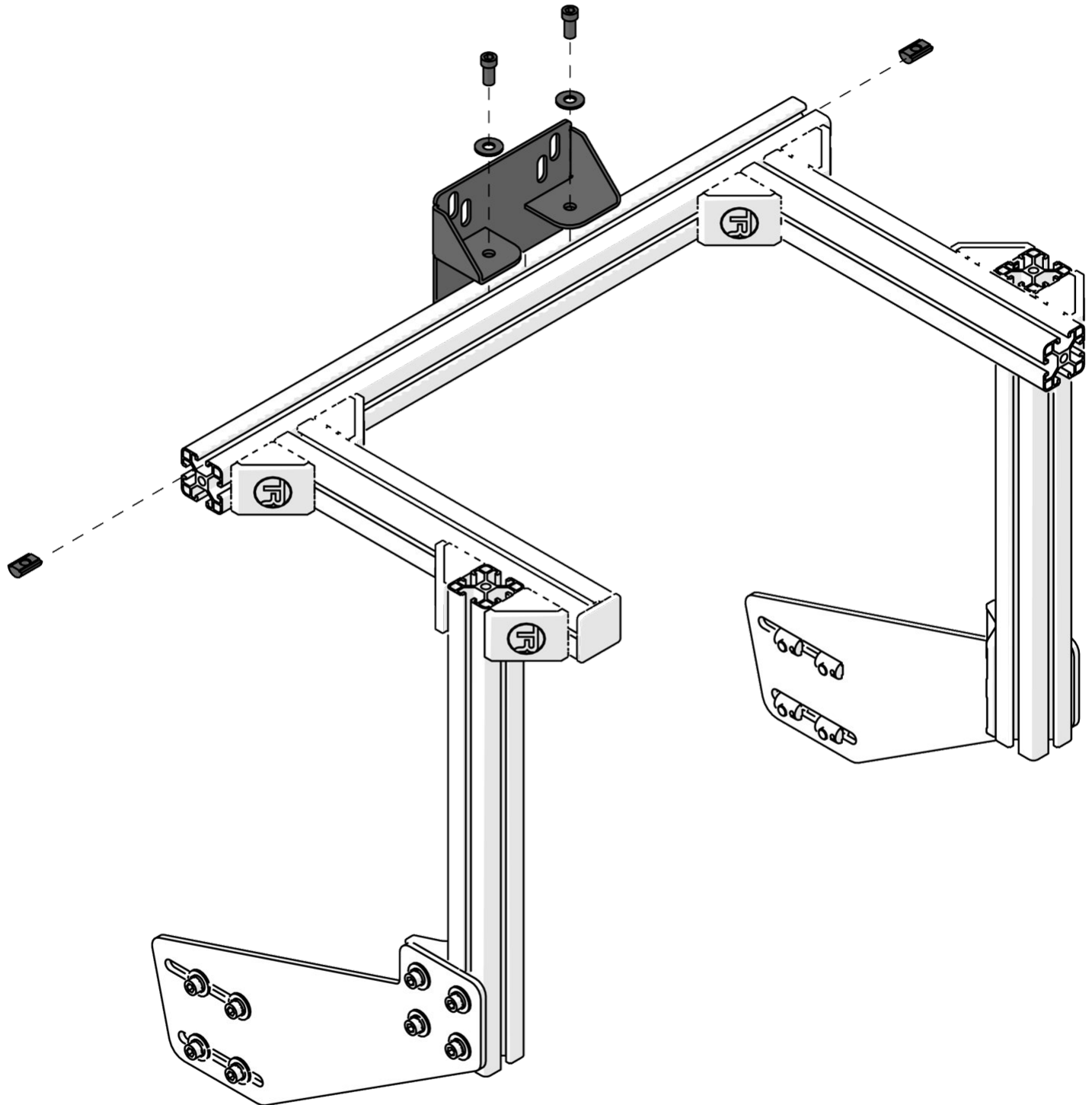

# 10

A TR-80B



B NL-M6



C SF-M6-16

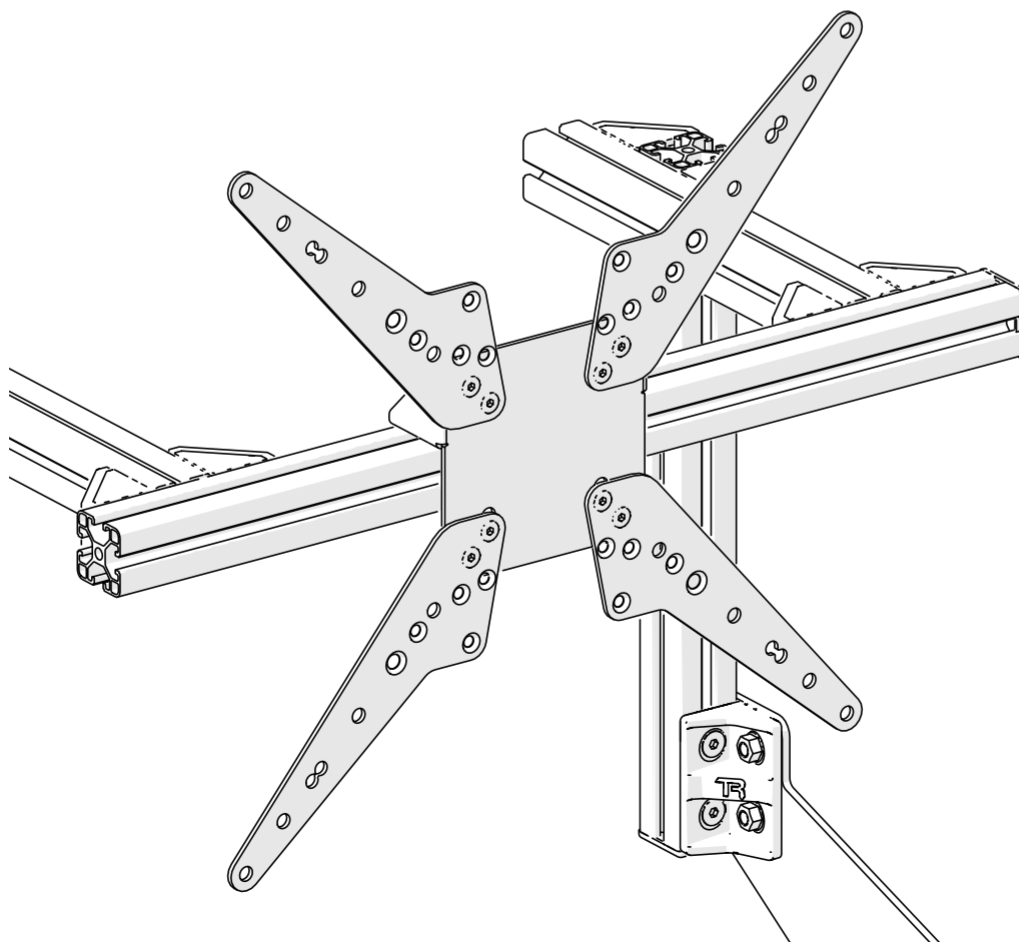
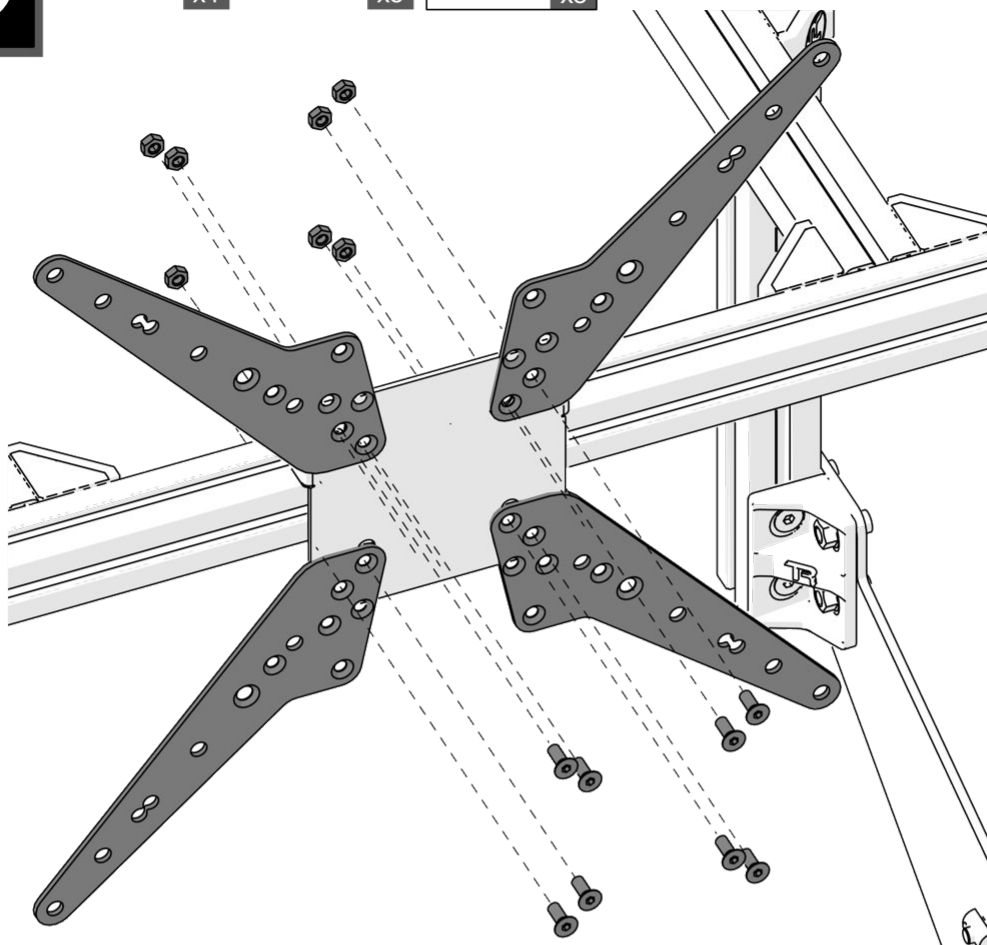
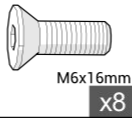

# 11

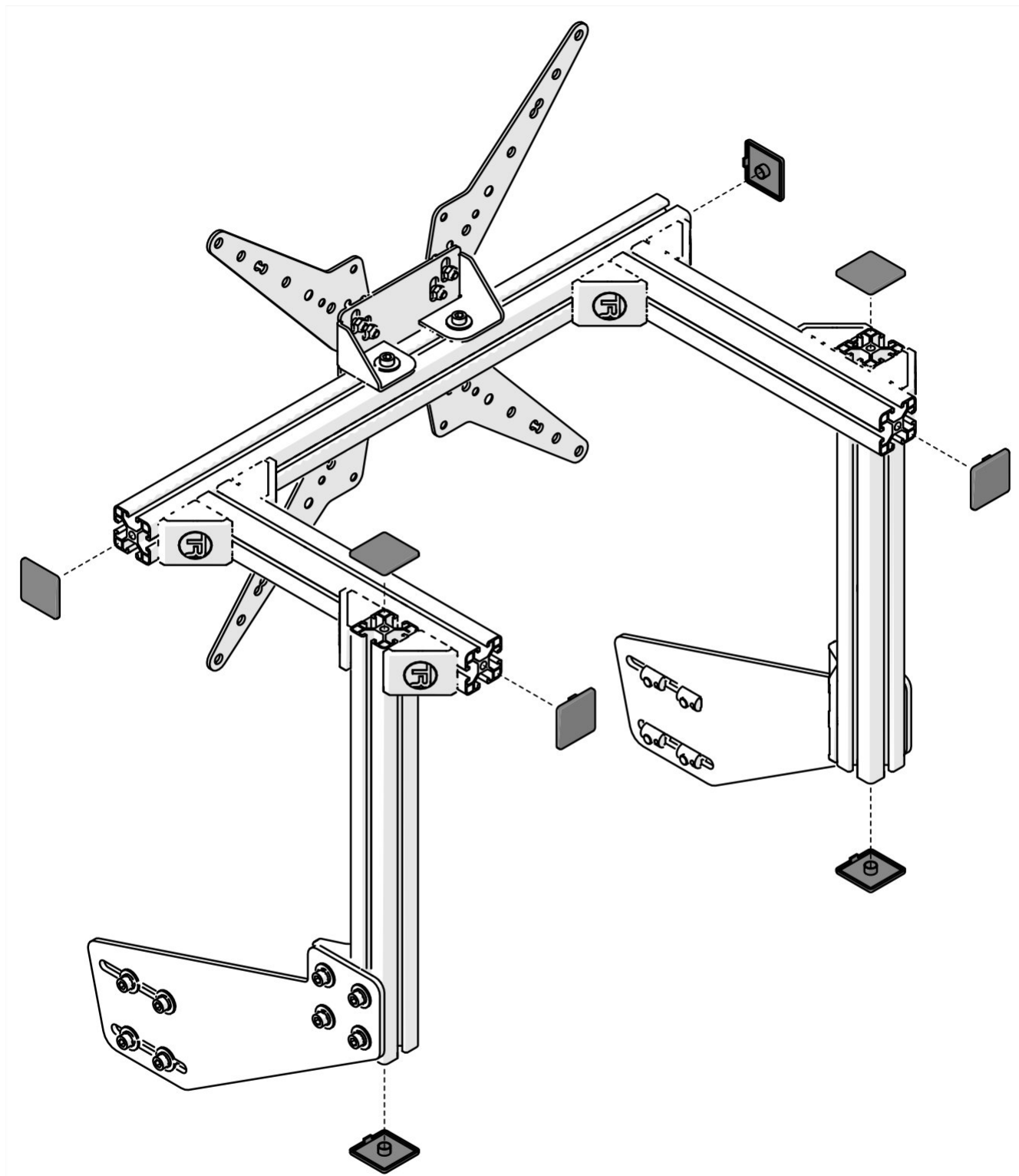
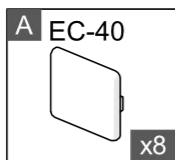

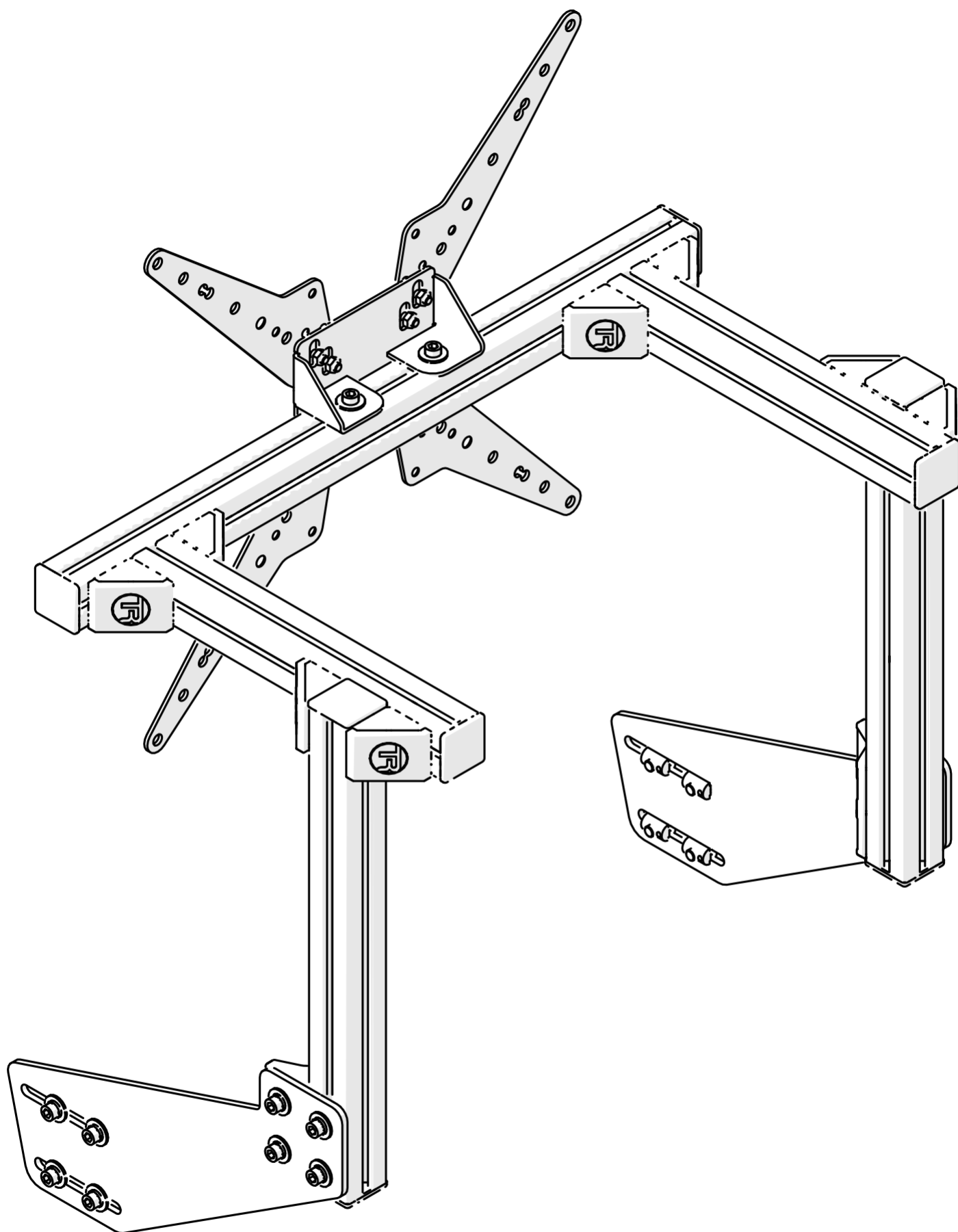

# 12

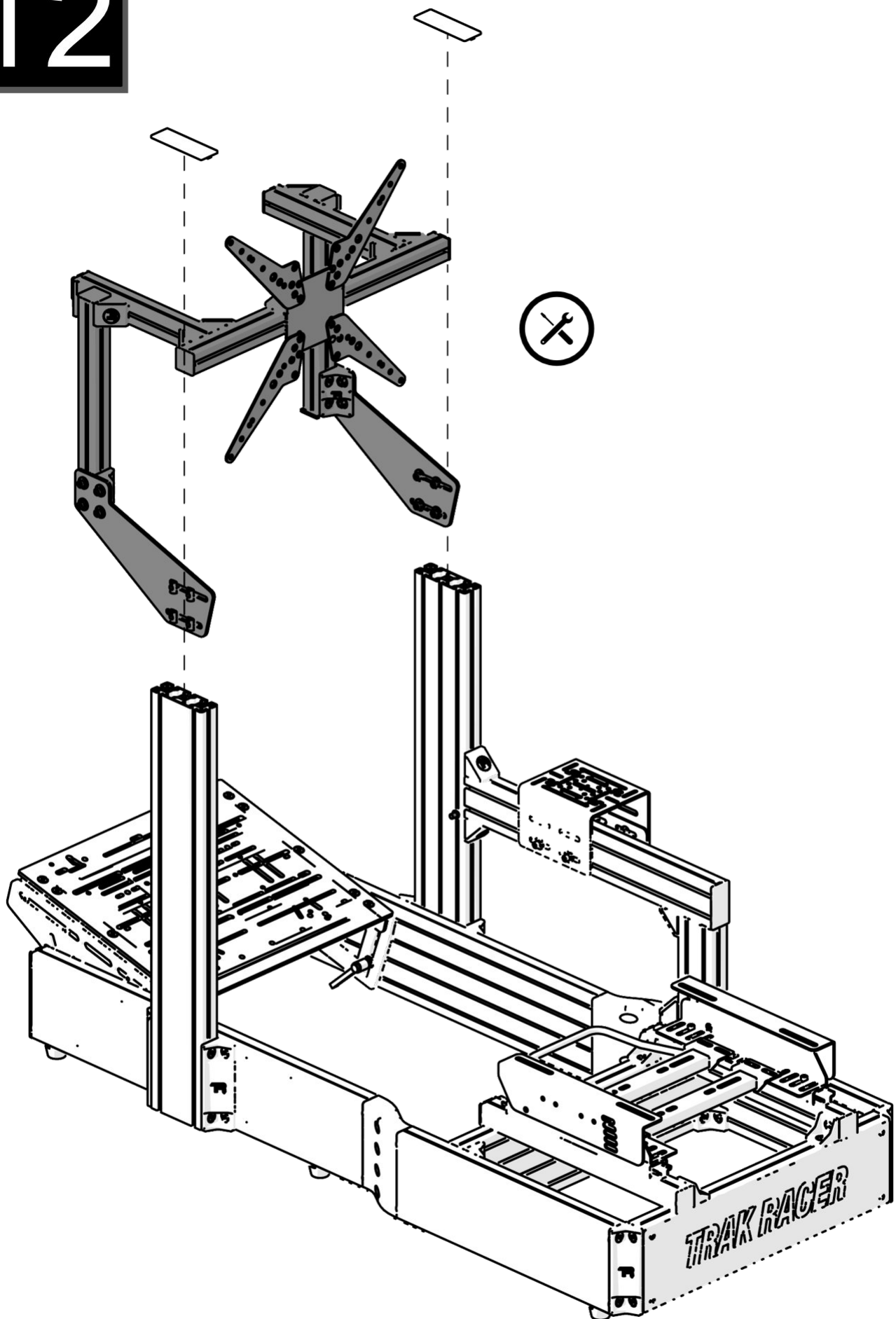

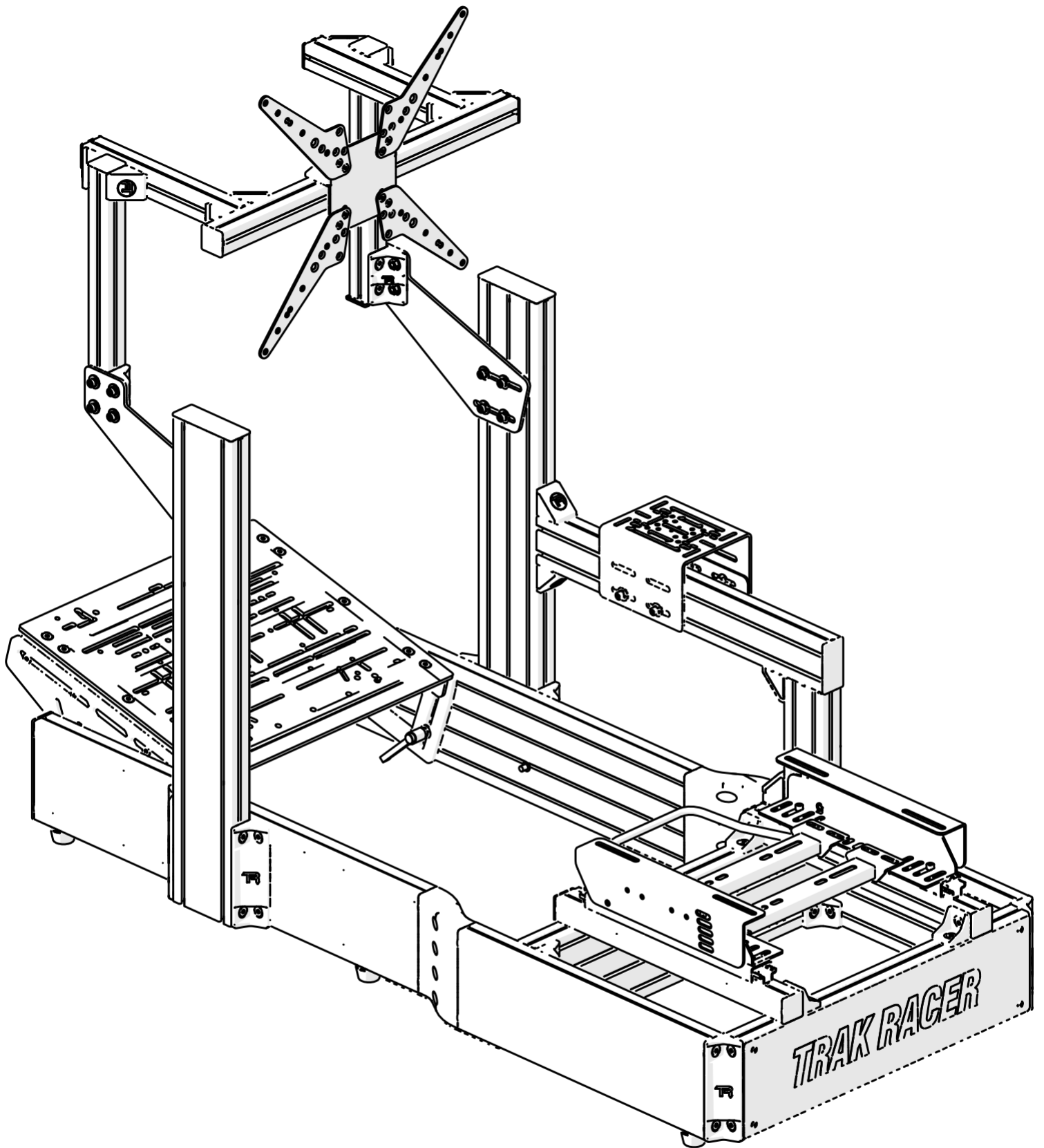



# FINISHED



@trakracer



@trakracer



@trak\_racer