

# Freestanding Triple Monitor Stand

## *Assembly Guide*

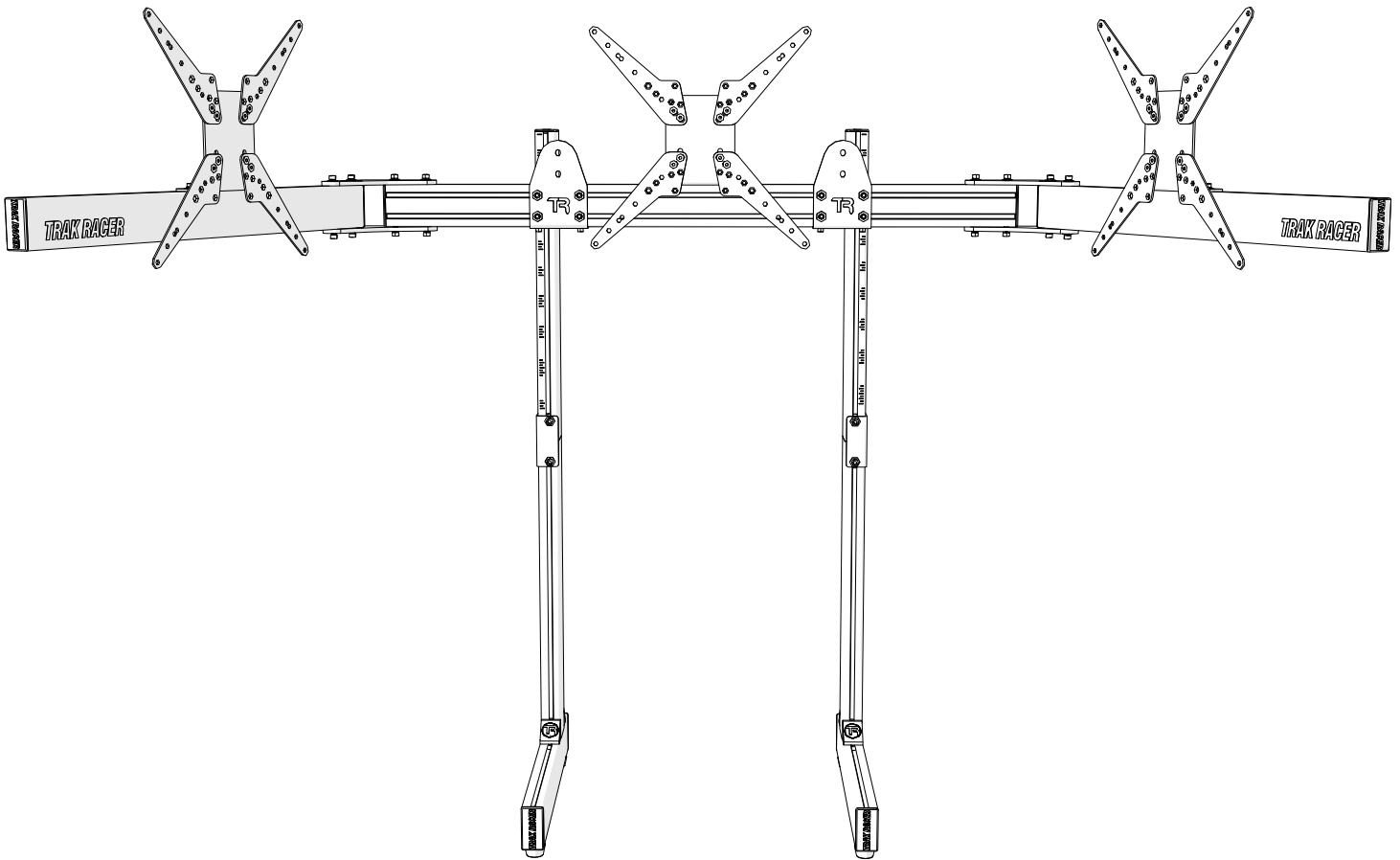

**IMPORTANT:** Different regions may have different models. Please ensure the part number below matches that on your product's box.

**MS-FM-SIN-TR2**



**TRAK RACER**

Published 2024-12-26

# TABLE OF CONTENTS

3	Symbol Legend
4	Assembly Notes
6	MS-FS-SIN6
13	TR80-TMARM5
16	MS-FS-SIN-TR2



**IMPORTANT:** Since there are different versions of each product based on your region, please make sure you are using the correct set of instructions. The part number below should match the one on your box.



**IMPORTANT:** Due to the nature of cut aluminum profiles, some metal shavings may remain despite our thorough QA cleaning process. We recommend opening boxes and packaging on a hard surface.



**NOTE:** Some screws and washers may be pre-installed. These are included in the parts list and will need to be loosened and reattached according to the instructions.



Recommended: Two people for the task



Tighten the hardware



Keep the hardware loose for adjustments

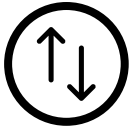

Make the necessary adjustments



Break the tab off the corner bracket



Safety glasses required



Attention/Priority needed



Reserve for the next step

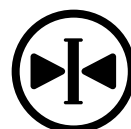

Mirrored components (same on both sides)

# NOTE

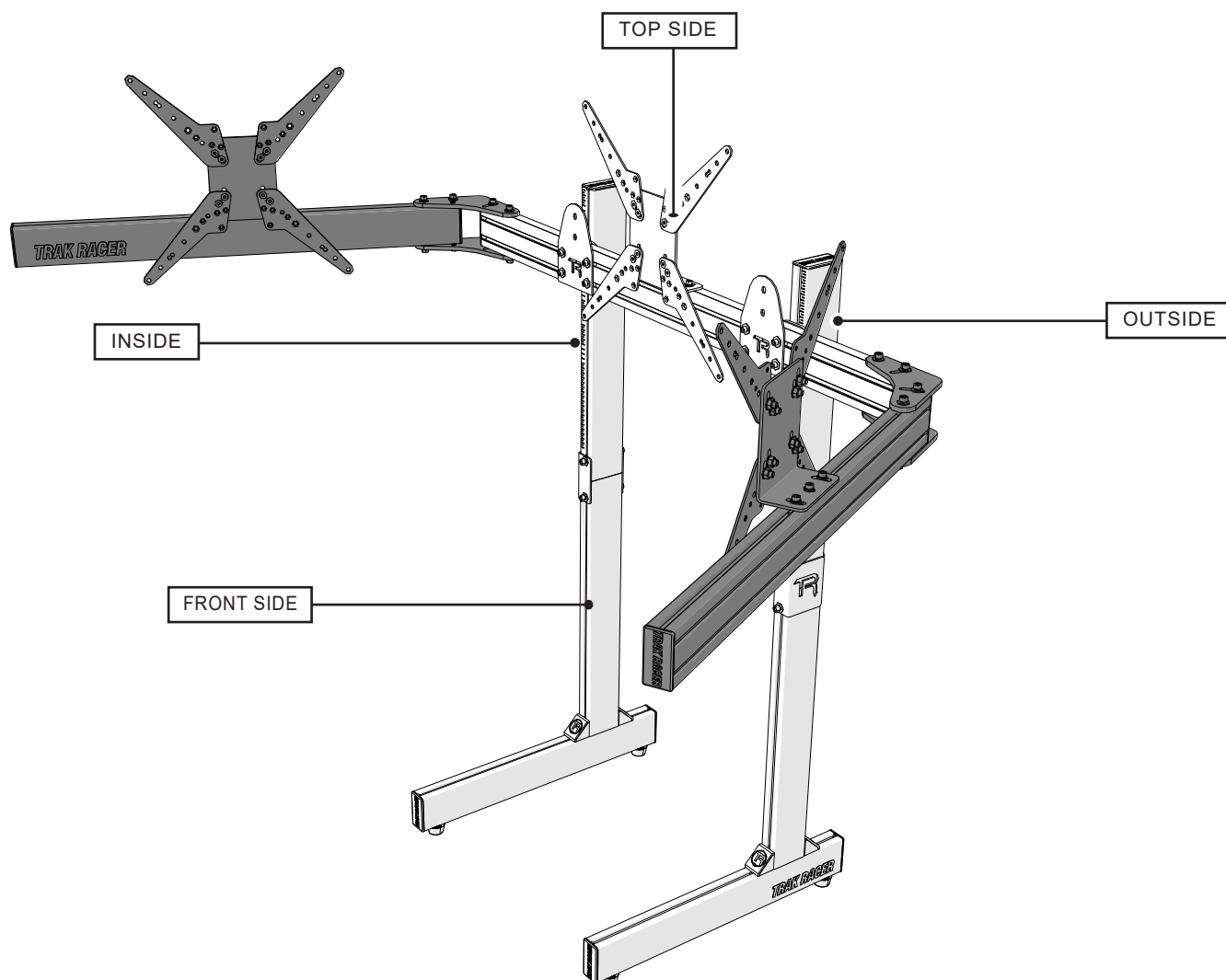

## INSTALLATION ORDER FOR SCREWS & WASHERS

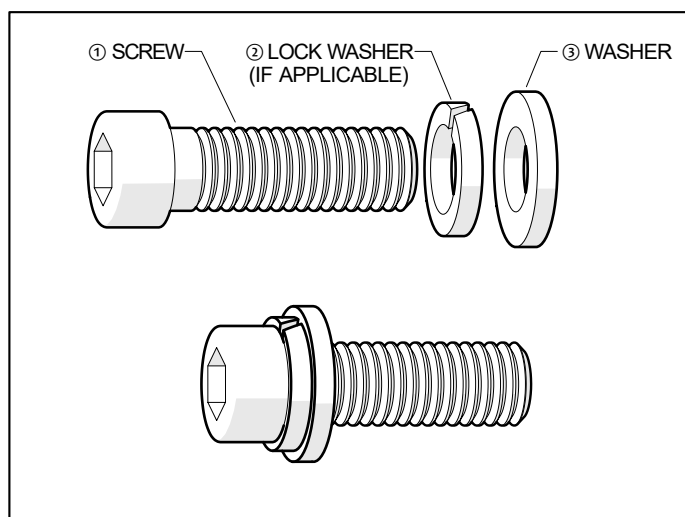

## HOW TO MEASURE SCREWS

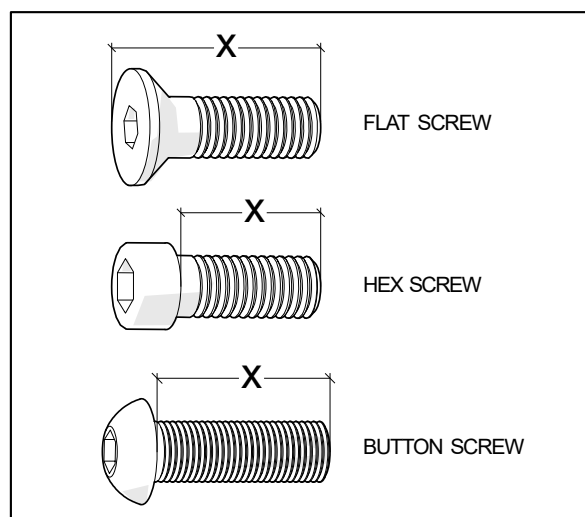

# NOTE

## NS-M8 & NS-M6

Slide T-Nuts into the ends of the profiles. Some must be added early, so follow the steps in this manual carefully.

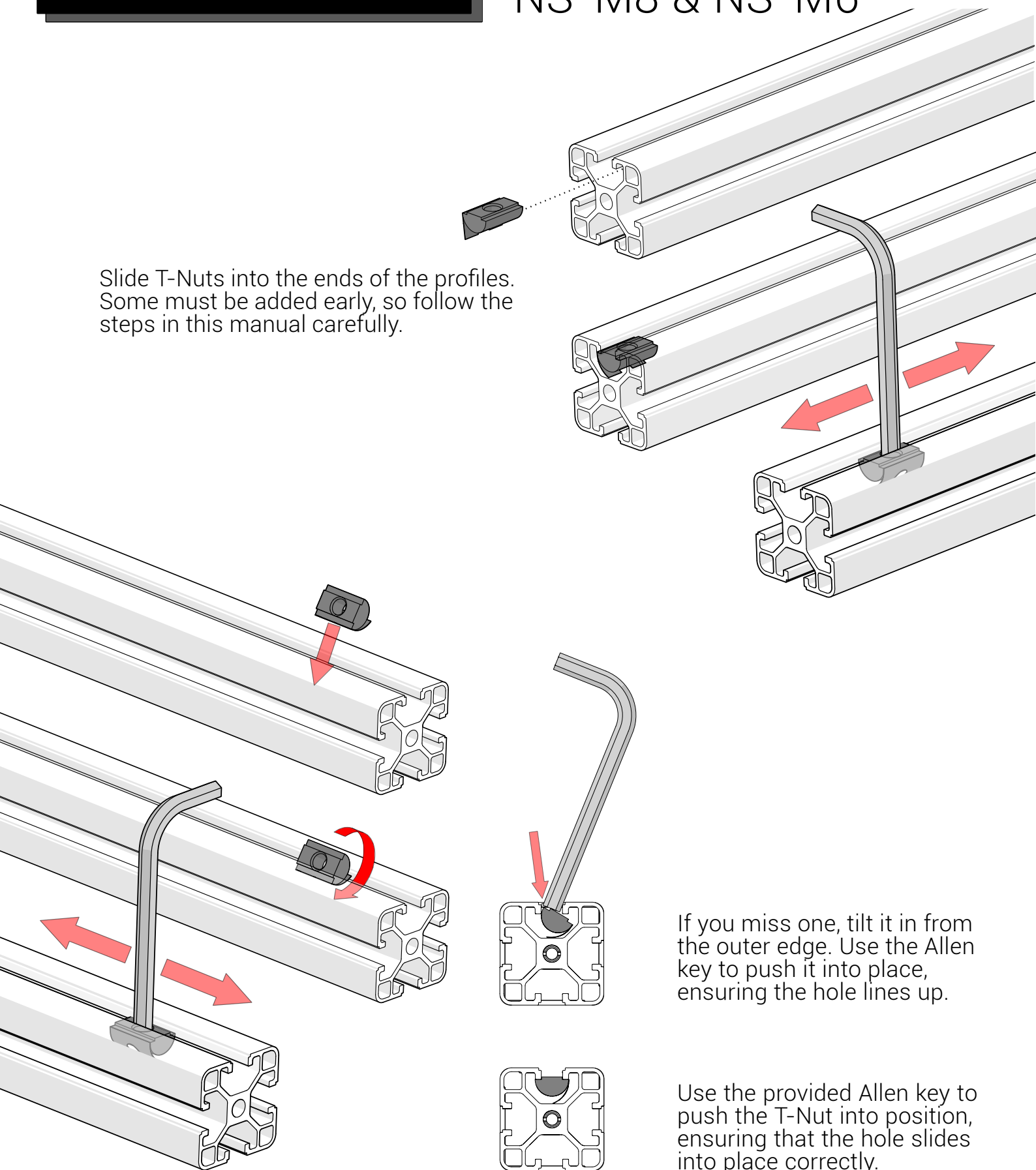

If you miss one, tilt it in from the outer edge. Use the Allen key to push it into place, ensuring the hole lines up.

Use the provided Allen key to push the T-Nut into position, ensuring that the hole slides into place correctly.

# Floor Single Monitor Stand with VESA mount (120mm Crossbar)

## PART LISTS

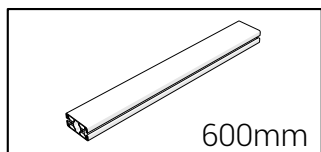
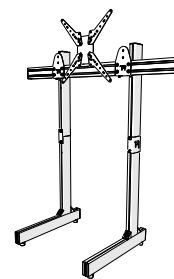

Aluminum Profile

TR-8080-600 x6

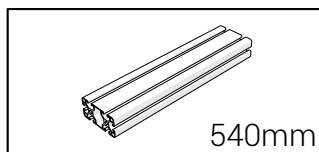

Aluminum Profile

TR-8080-540 x1

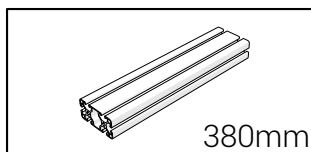

Aluminum Profile

TR-8080-380 x2

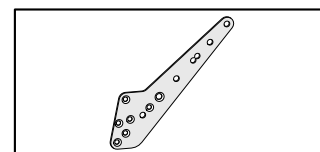

Aluminum Profile

TR-80B x4

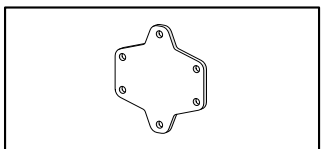

Connecting Part

CP-1 x2

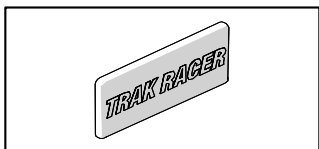

End Cap

EC-80 x8

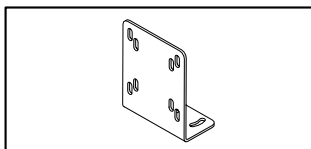

TV Vesa Mount

VM-1 x1

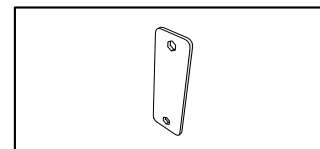

Connector Part

CP-2 x2

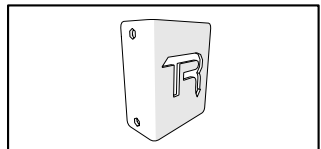

Connector Part 2

CP-3 x2

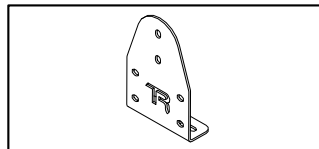

Logo Bracket

LB x1

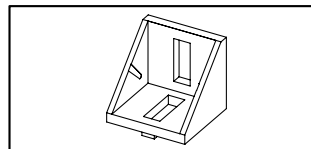

Corner Bracket

BC-40 x4

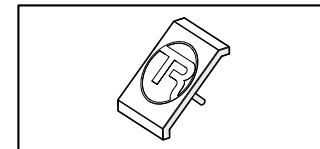

Corner Bracket Cap

BC-40-CAP x4

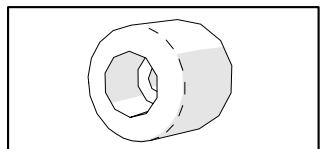

Rubber Feet

FR-01 x4

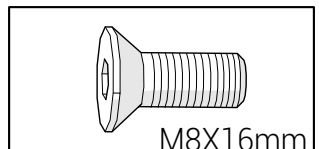

Screw (Flat)

SF-M8-16 x4

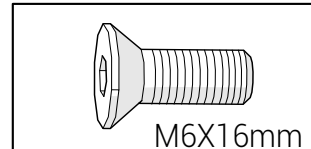

Screw (Flat)

SF-M6-16 x8

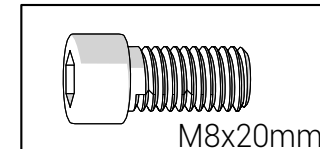

Hex Screw

SH-M8-20 x43

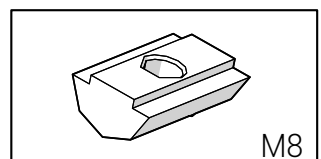

Ball Bearing Nut, M8

NS-M8 x27

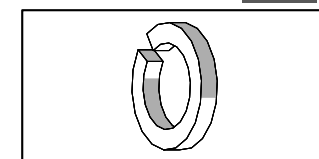

Washer (Lock), M8

WL-M8 x39

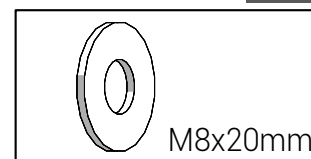

Washer (Flat)

WF-M8-20 x39

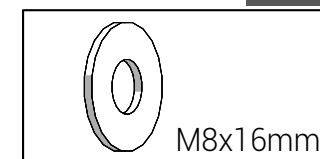

Washer (Flat)

WF-M8-16 x4

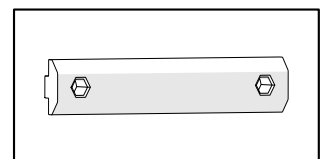

Connector Long Nut

M8-LN x10

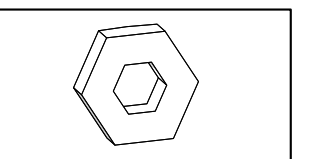

Nut, M6

NL-M6 x8

\* **NOTE:** Extra hardware may be included as spare parts

# MS-FS-SIN6



# 1

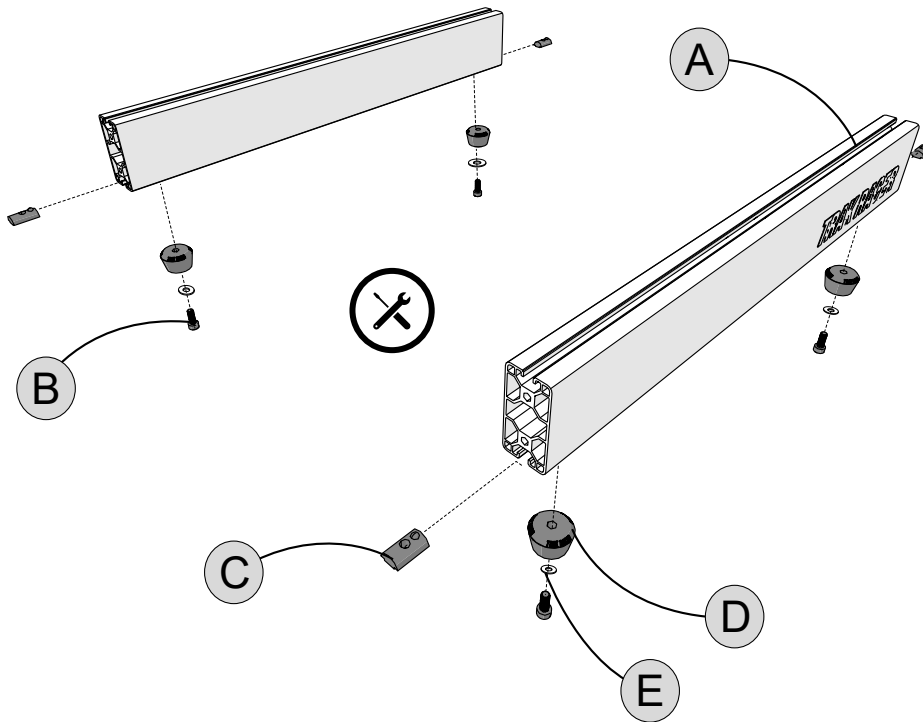
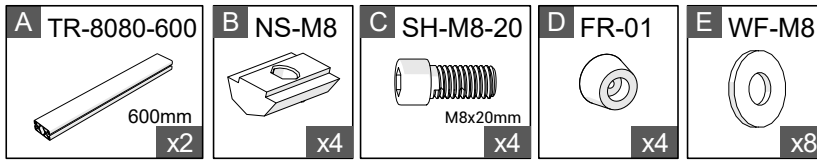

## Warning:

Using the stand without  
The rubber feet may cause  
Damage to your floor

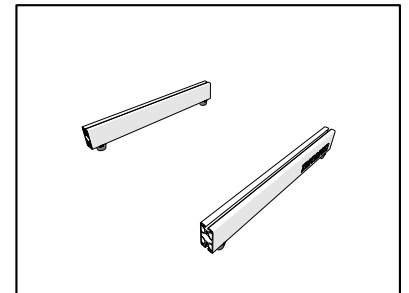

# 2

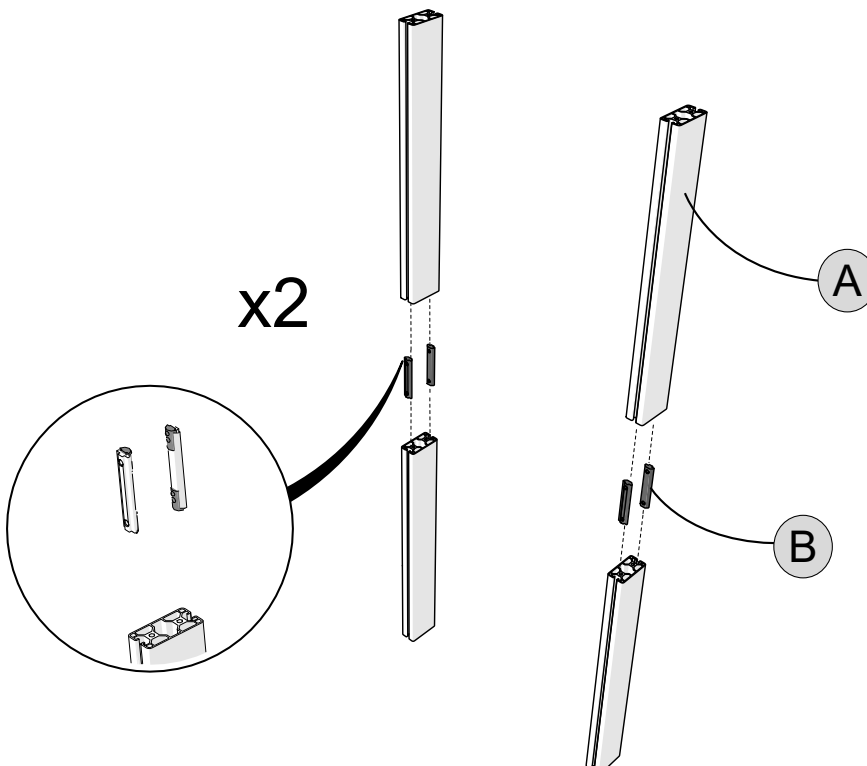
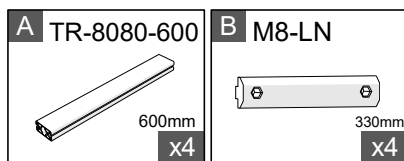

Place the long nuts (M8-LN)  
into the slots of two aluminum  
profiles (AL-8080-600) (front  
and back). Attach these long  
nuts into another set of  
aluminum profiles. Distribute  
the long nuts 50% into each  
profile.

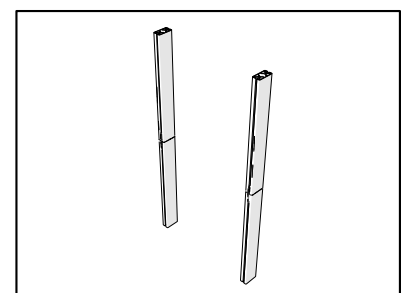

# 3

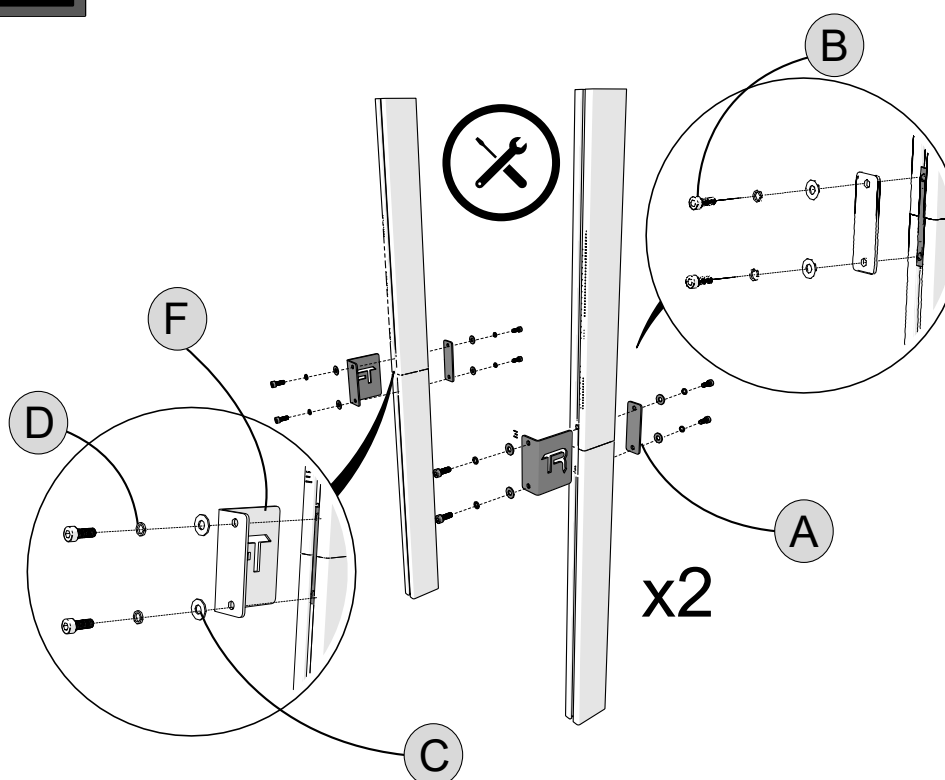
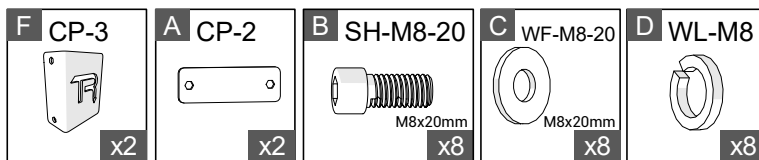

Ensure as you tighten the long nuts (M8-LN) that the aluminum profiles (AL-8040-600) stay flat to one another and in place. It helps if you tighten and hold onto one side of the leg only.

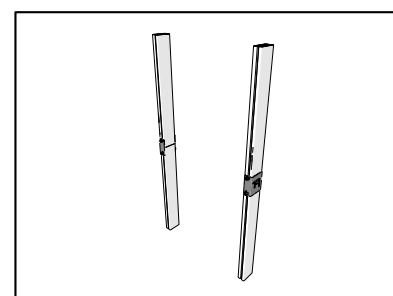

# 4

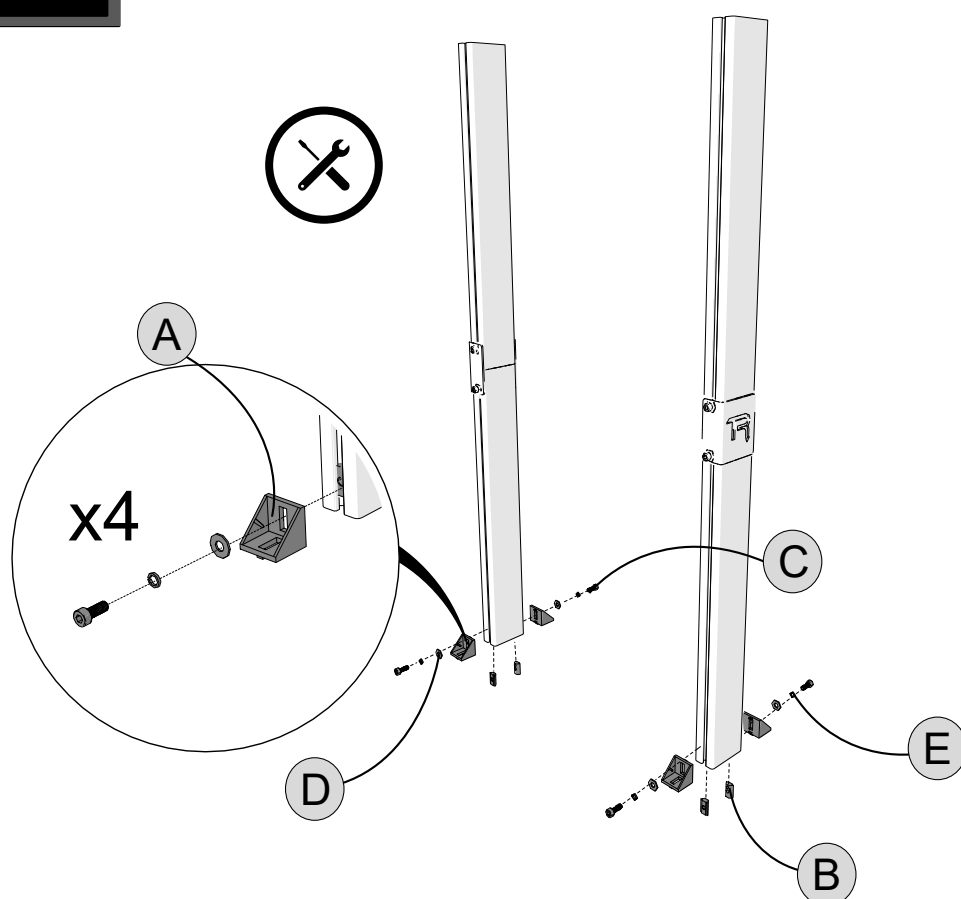
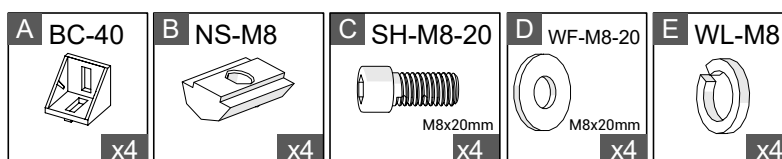

Fix the corner brackets flush/flat to the bottom of the aluminum profiles.

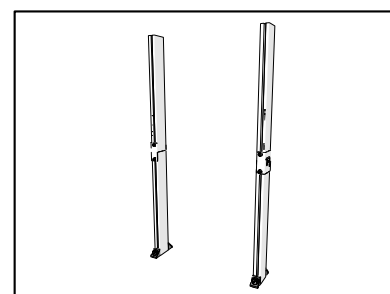



# 5

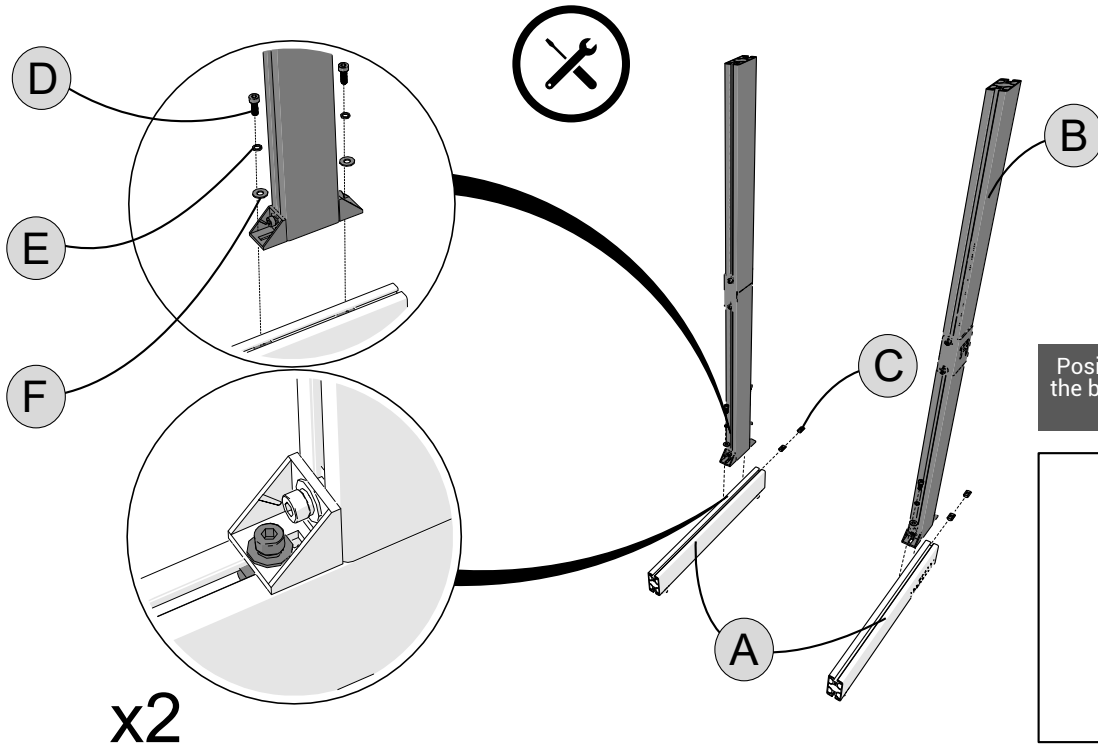
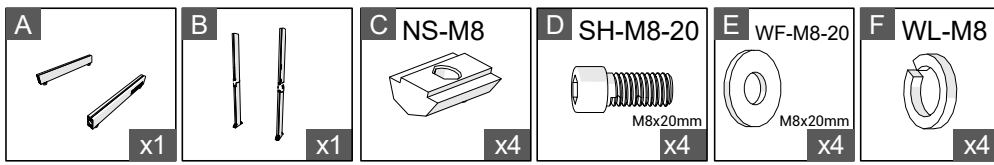

Position the corner bracket toward the back of the 'foot', approximately 1cm or ½" from the end.

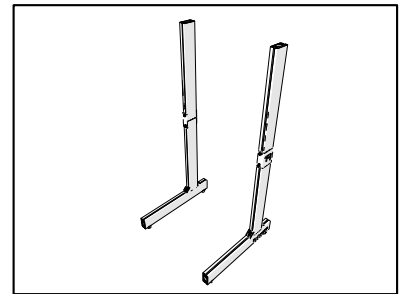

# 6

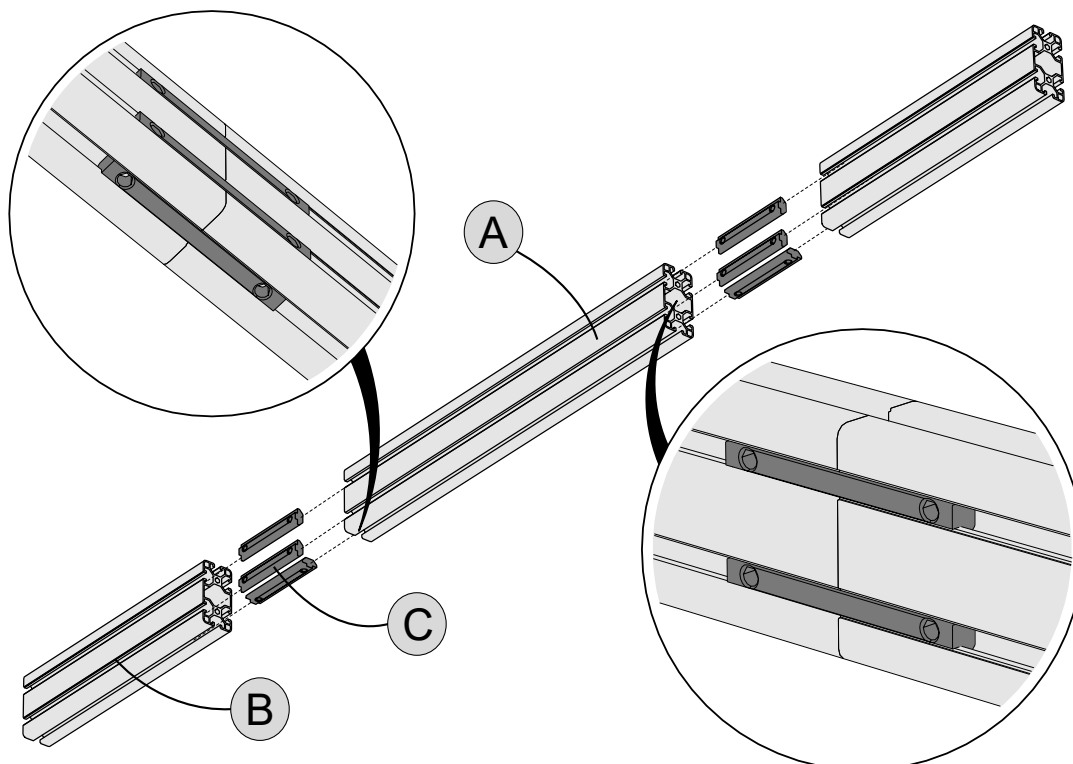

Slide 4 long nuts (M8-LN) into the back, and 2 into the bottom of the aluminum profile (AL-4080-540). Attach these long nuts into aluminum profiles (AL-4080-330) on the left and right side of part A. Distribute the long nut 50% into each profile.

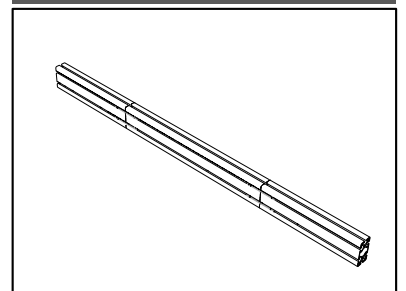

# 7

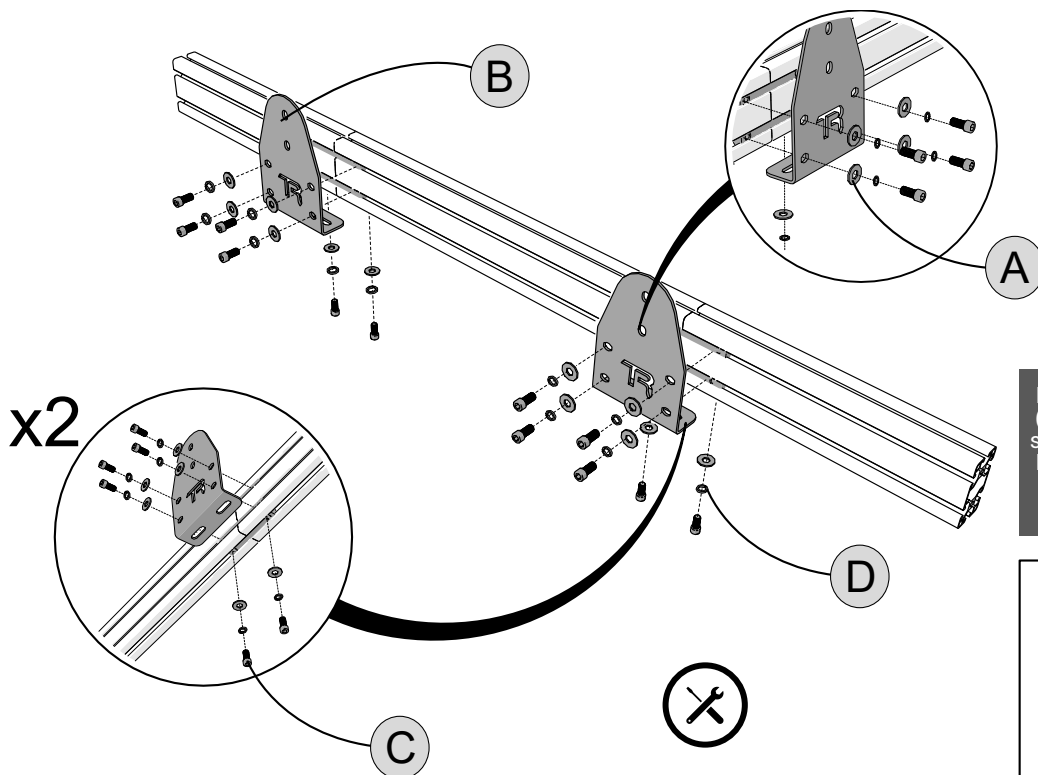
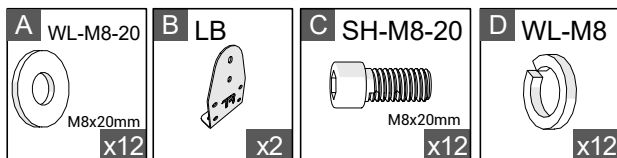

Ensure as you tighten the long nuts (M8-LN) that the aluminum profiles stay flat to one another and in place. It helps if you tighten and hold onto one piece of aluminum profiles at one time as you tighten.

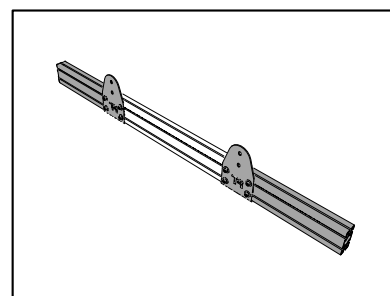

# 8

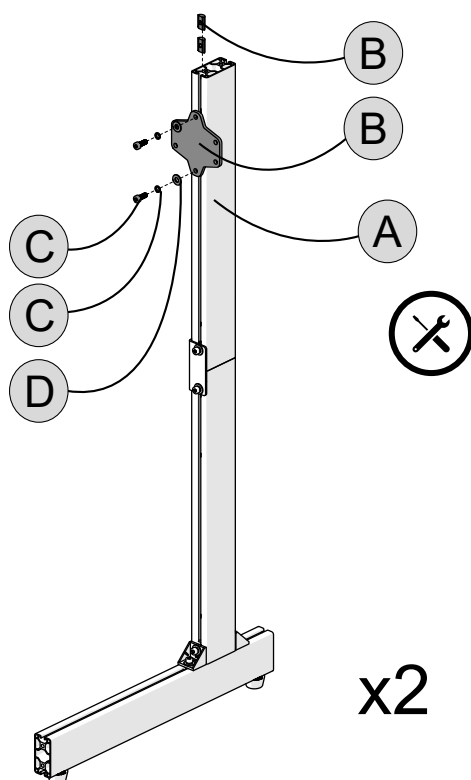
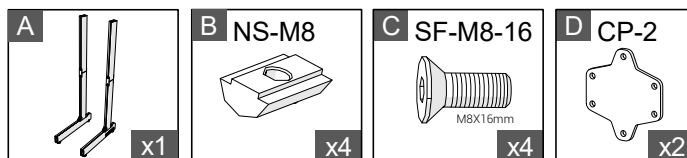

Position the top of the bracket (CP) approximately 20cm or 7 3/4" from the top of each aluminum profile. The height will need to adjust depending on the desired monitor height, but this is a good starting point.

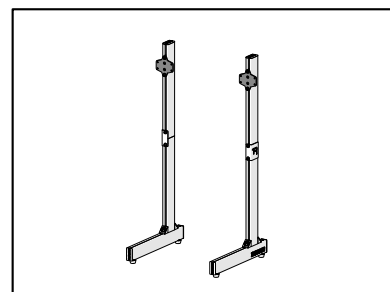

# 9

D NS-M8

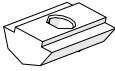

x8

C SH-M8-20

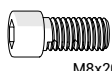

M8x20mm

x8

A WF-M8-20



M8x20mm

x8

B WL-M8



x8

Position the part from step 7 onto the 'legs' from step 5 and secure by tightening. You may decide to adjust the height depending on your monitor height preference.

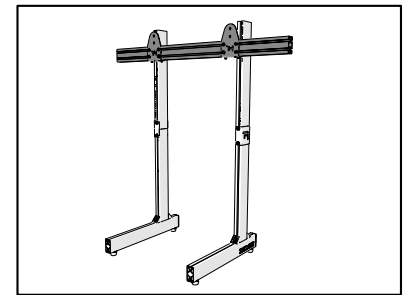
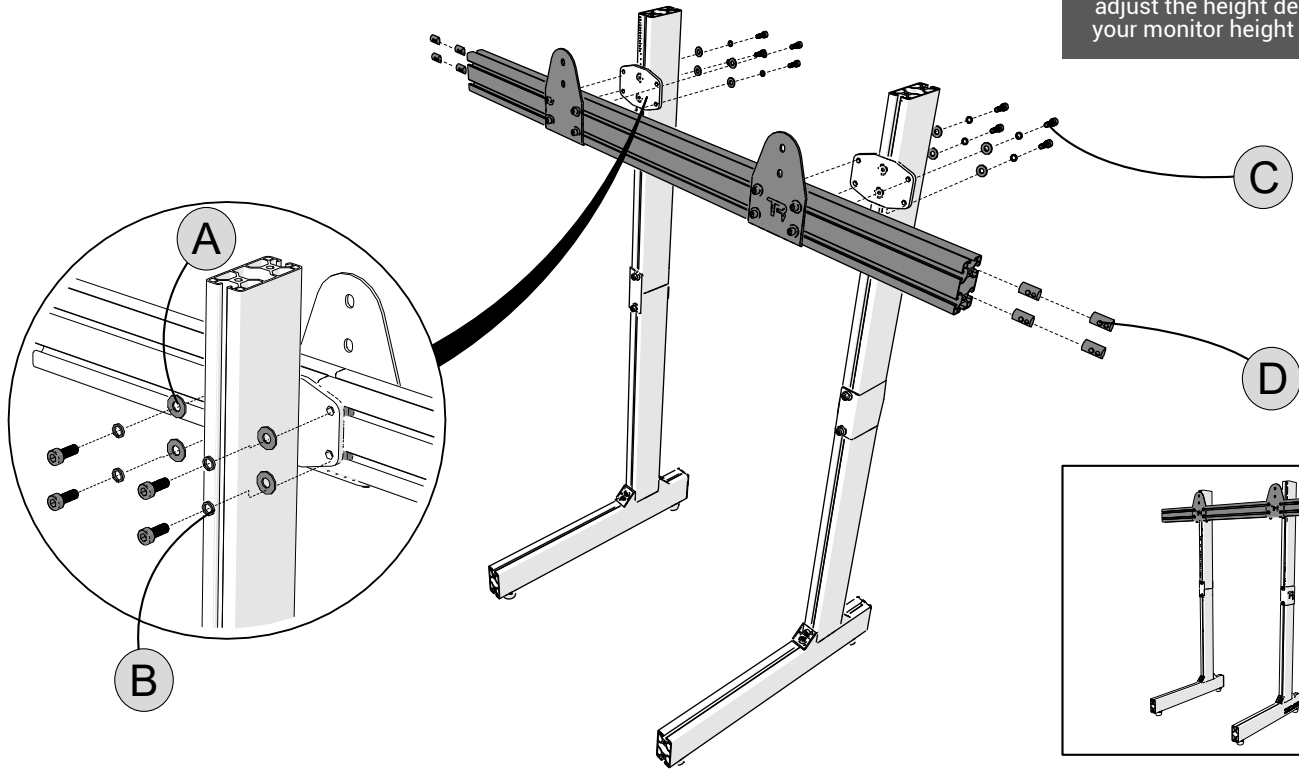

# 10

A M-SB



x4

B TR-80B



x1

C SF-M6-16

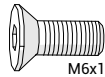

M6x16mm

x8

D NL-M6



x8

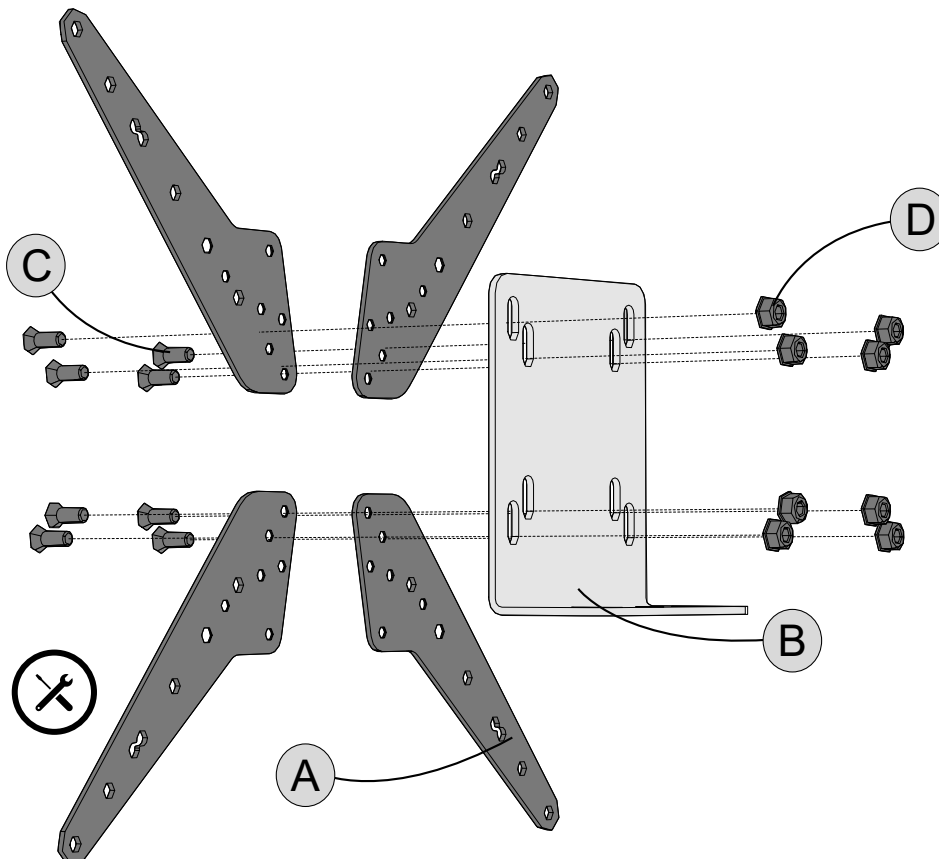

Ignore this step if your monitor does not require these VESA extension plates.

These 4 plates are designed to increase the VESA mounting positions to 200, 300 and 400mm which may not be required for your monitors/TVs.

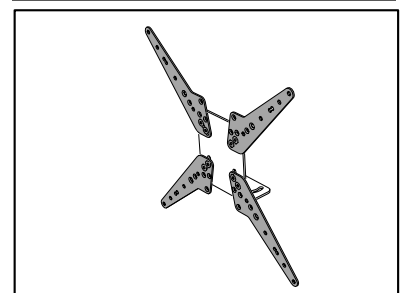

# 11

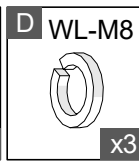
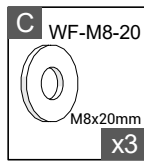
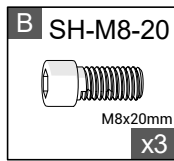
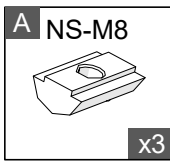

Slide 3 x T Nuts into the top of the horizontal monitor mount then position the parts from Step 10 in the center of the profile and screw down tight.

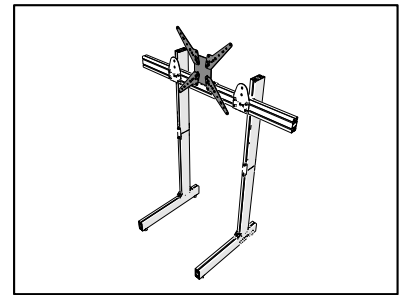
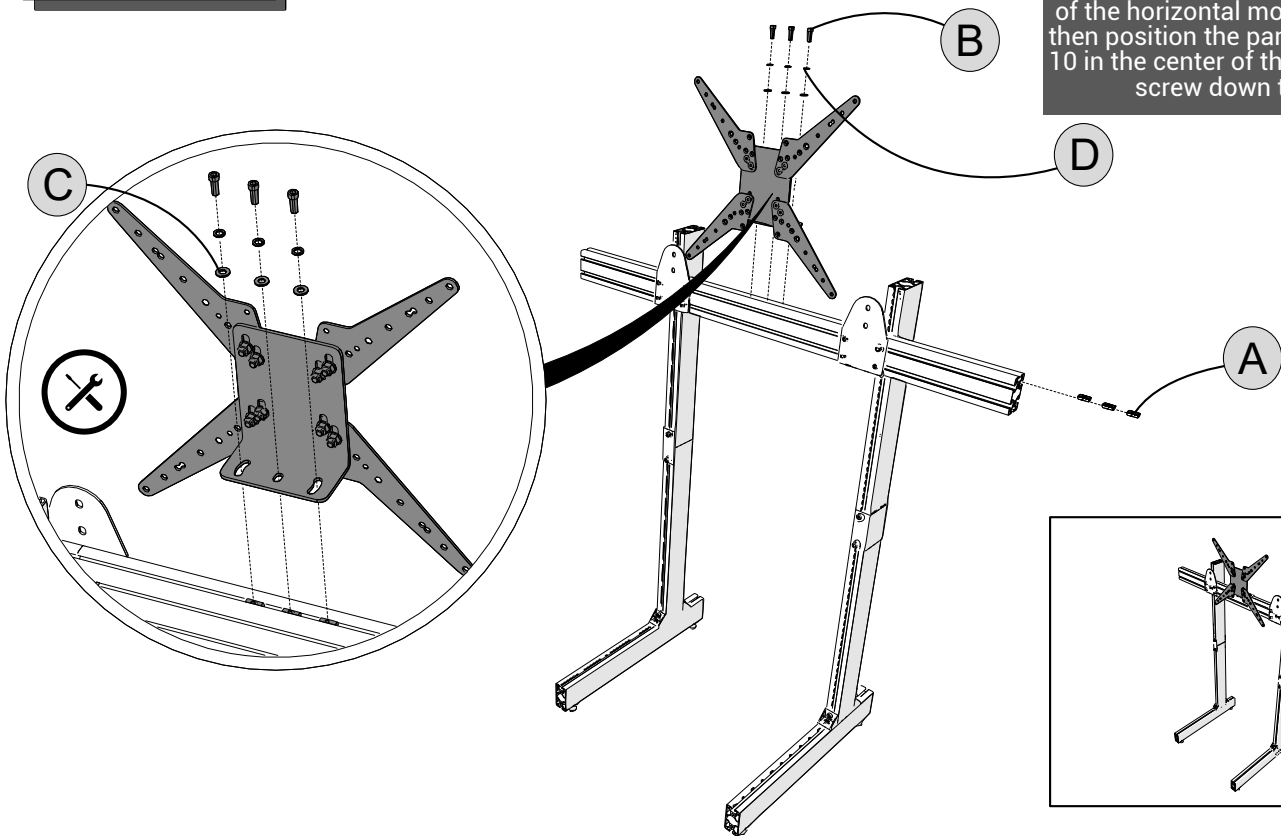

# 12

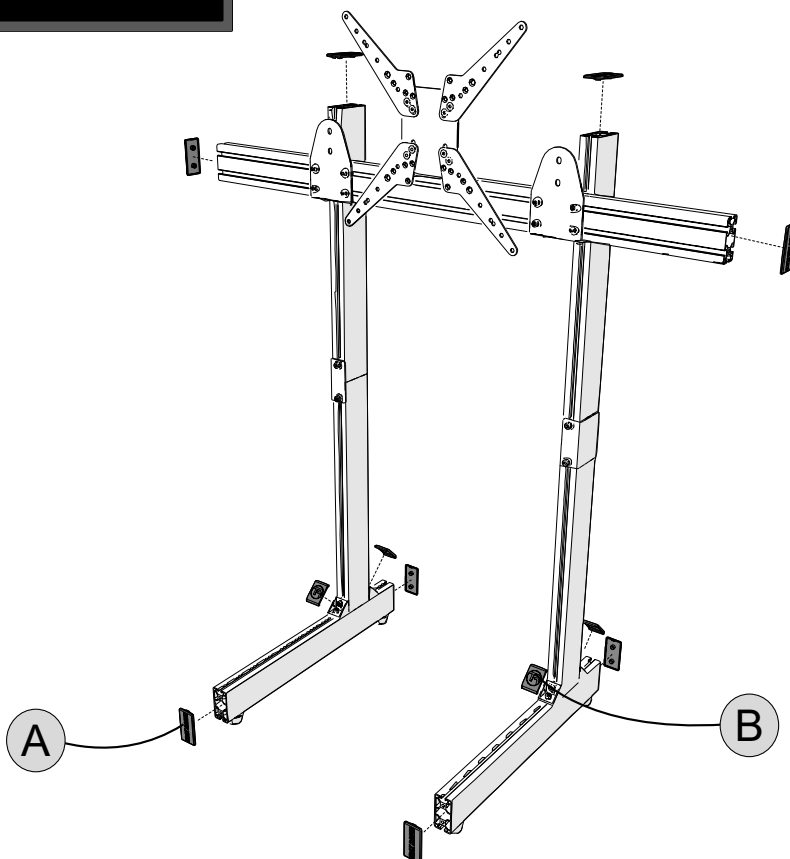
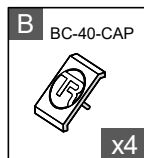
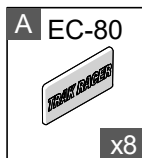

If you have the side arms for triple monitors to install, ignore this step.

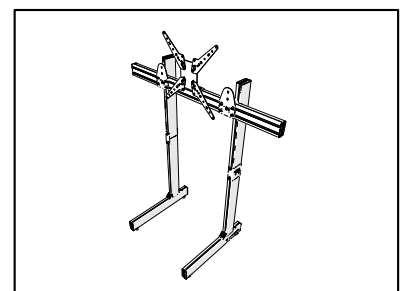

# Arms for Tripple Monitors with VESA mount

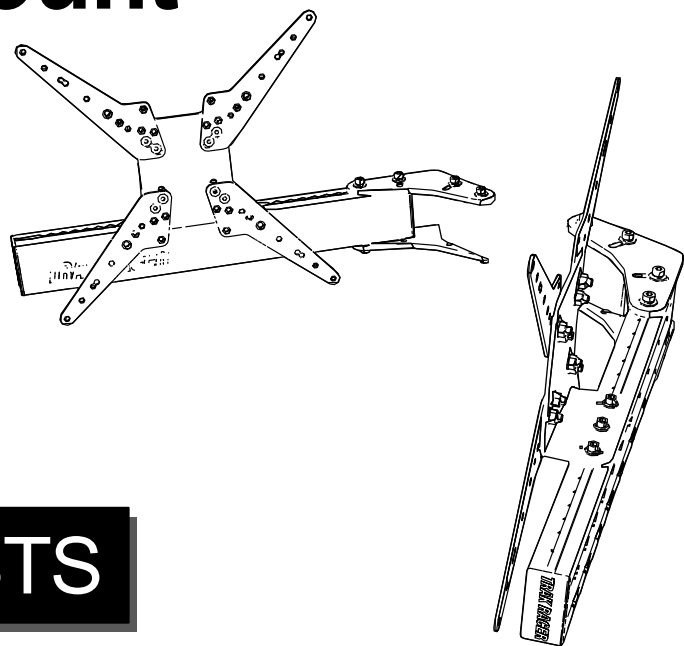

## PART LISTS

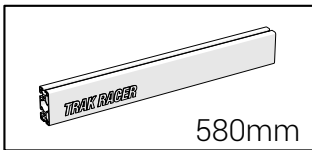

Aluminum Profile  
TR-8040-580 **x2**

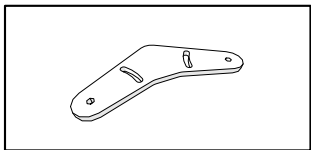

BM-TA  
BM-TA **x4**

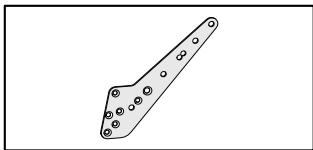

Bracket (Plate)  
BP-IS **x8**

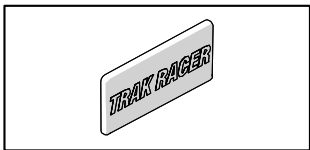

End Cap  
EC-80 **x4**

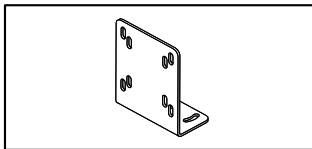

Vesa Mount  
VB-03 **x2**

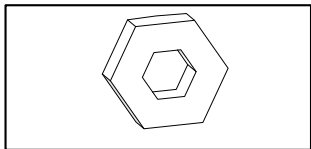

Nut, M6  
NL-M6 **x16**

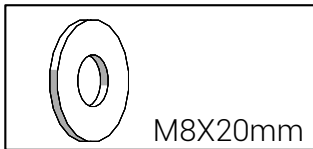

Washer (Flat)  
WF-M8-20 **x16**

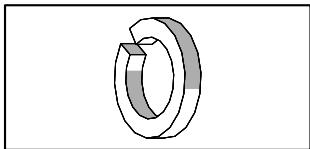

Washer (Lock)  
WL-M8 **x22**

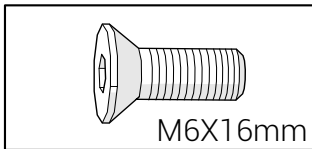

Screw (Flat)  
SH-M6-16 **x16**

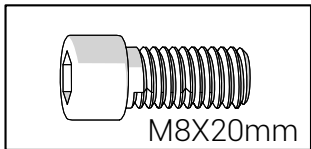

Hex Screw  
SF-M8-20 **x22**

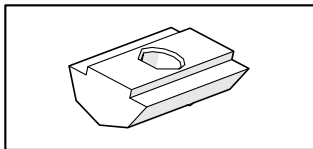

Ball Bearing Nut  
NS-M8 **x22**

**\* NOTE:** Extra hardware may be included as spare parts

# 1

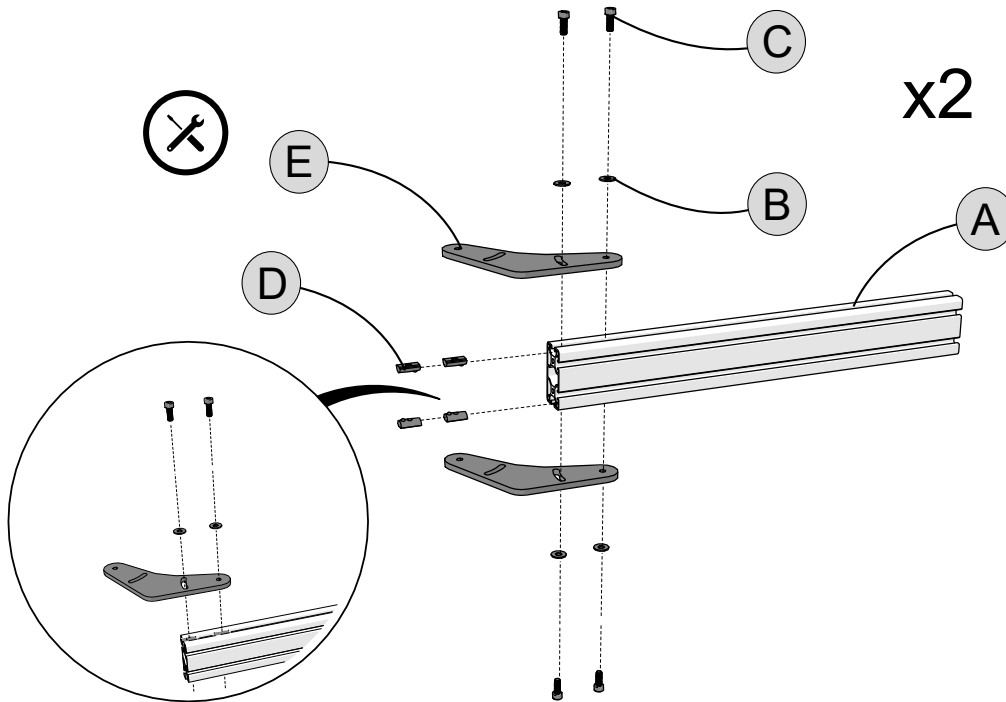
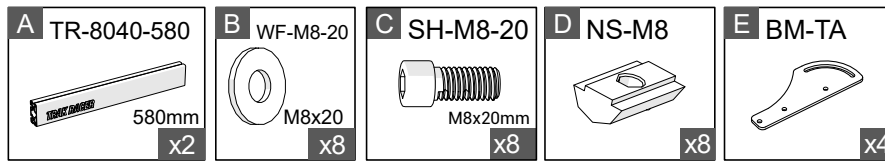

This step can also be done with Step 5

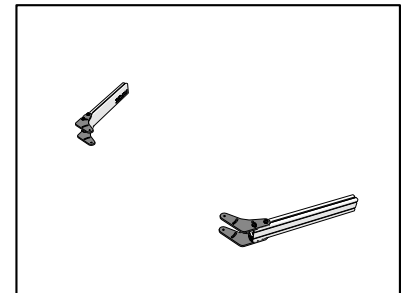

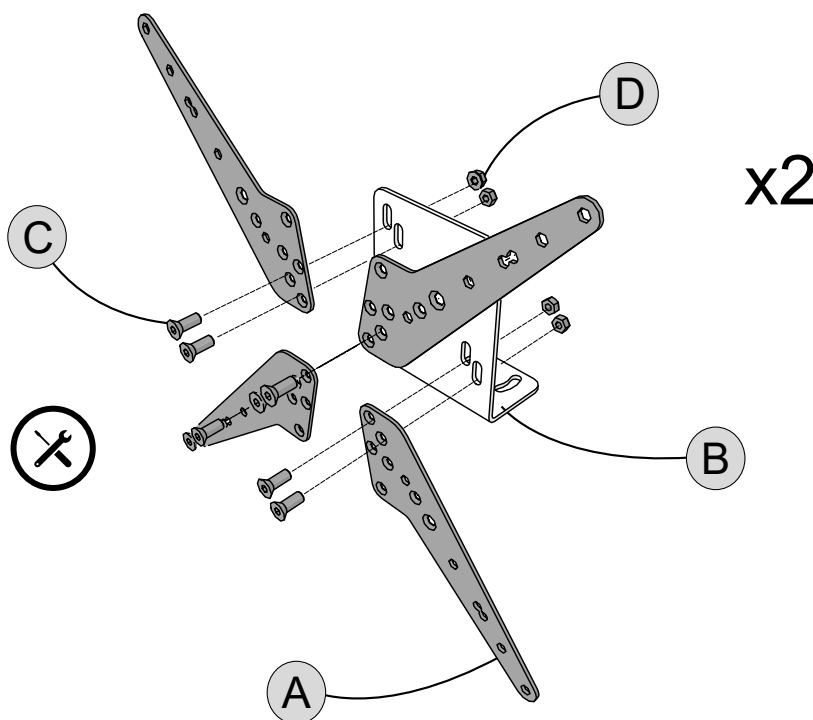
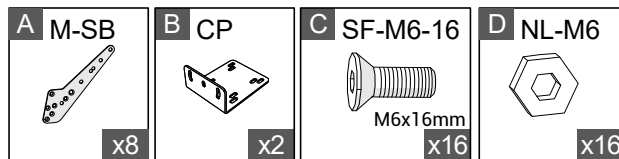

# 2

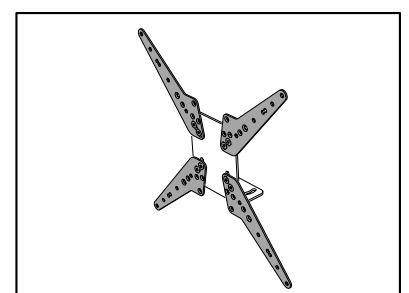

Part 'A' has 2 side variations

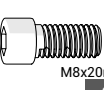
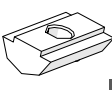

# 3

<b>A</b> WF-M8-20  M8x20mm x8	<b>B</b> WL-M8  x8	<b>C</b> SH-M8-20  M8x20mm x8	<b>D</b> NS-M8  x8
--	--	--	--

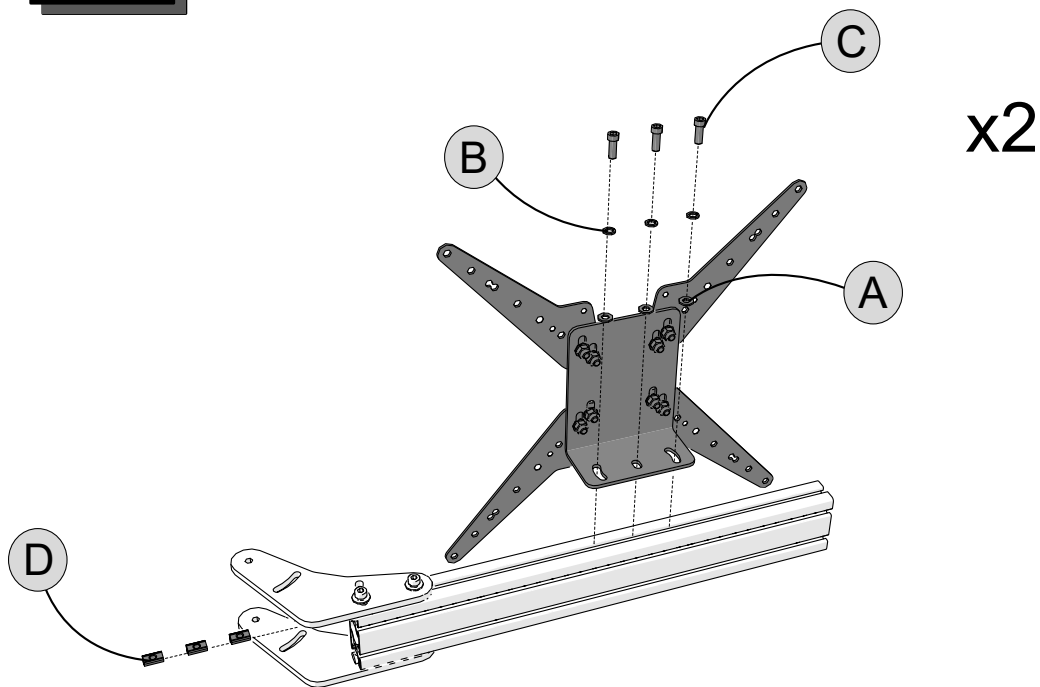

x2

Slide parts 'D' to align it first

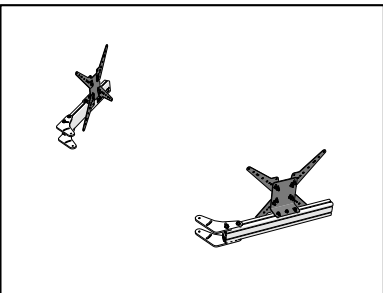

# 4

<b>A</b> EC-80  x4
---

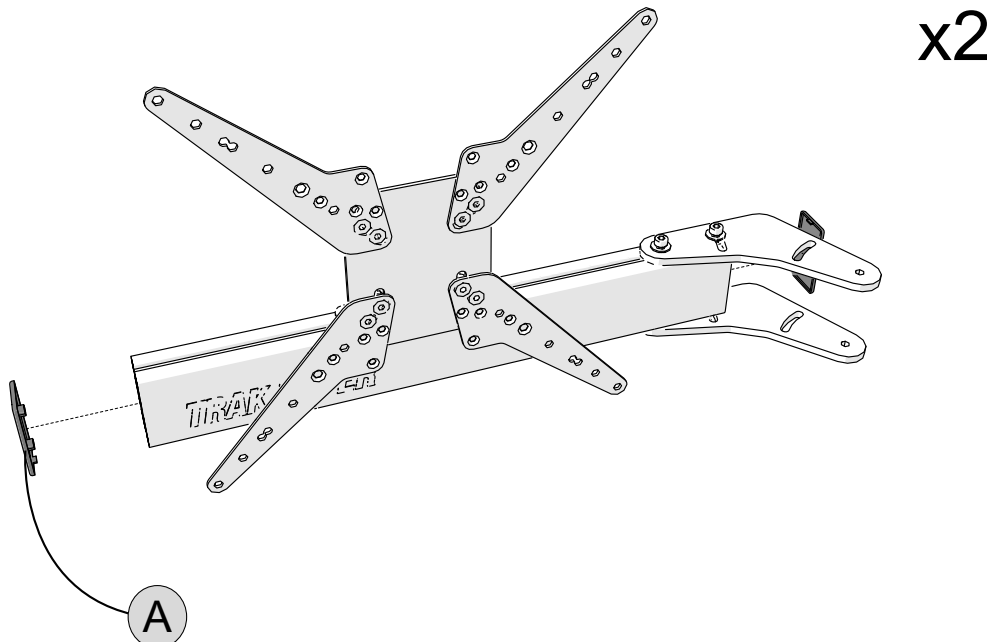

x2

Use part from step 3

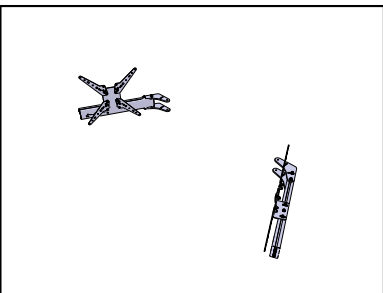

# Freestanding Triple Monitor Stand

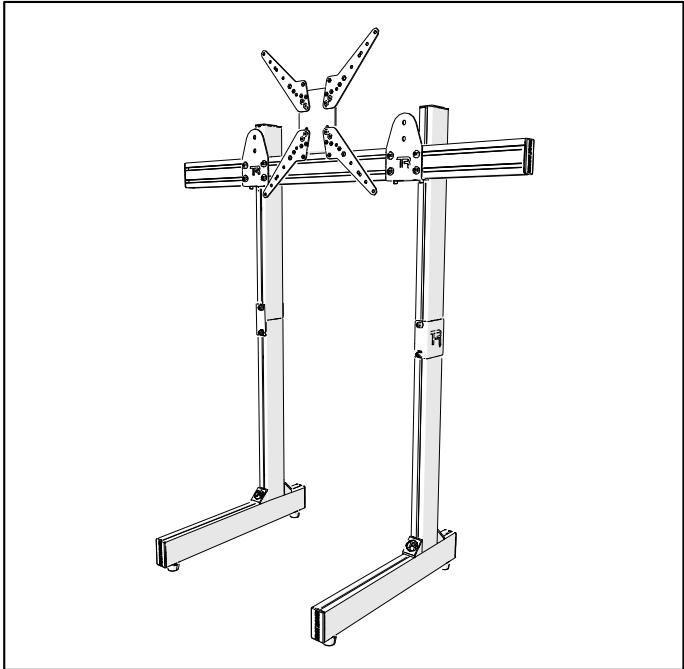

MS-FS-SIN6

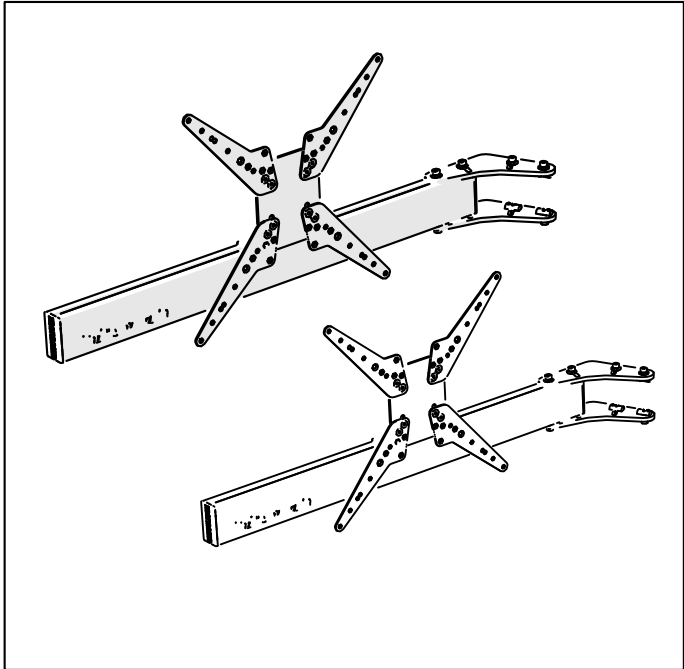

TR80-TMARM5

## PART LISTS

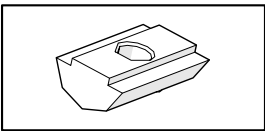

Ball Bearing Nut

NS-M8 x8

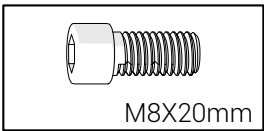

Hex Screw

SH-M8-20 x8

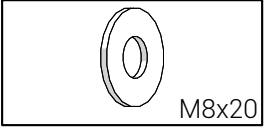

Lock Washer

WL-M8-20 x8

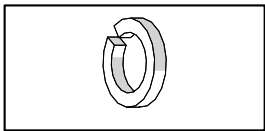

Flat Screw

W-M8-20 x8



**NOTE:** Some screws and washers may be pre-installed. These are included in the parts list and will need to be loosened and reattached according to the instructions.

If you have any issues, please contact us at [support@trakracer.com](mailto:support@trakracer.com)

MS-FS-SIN-TR2





# 1

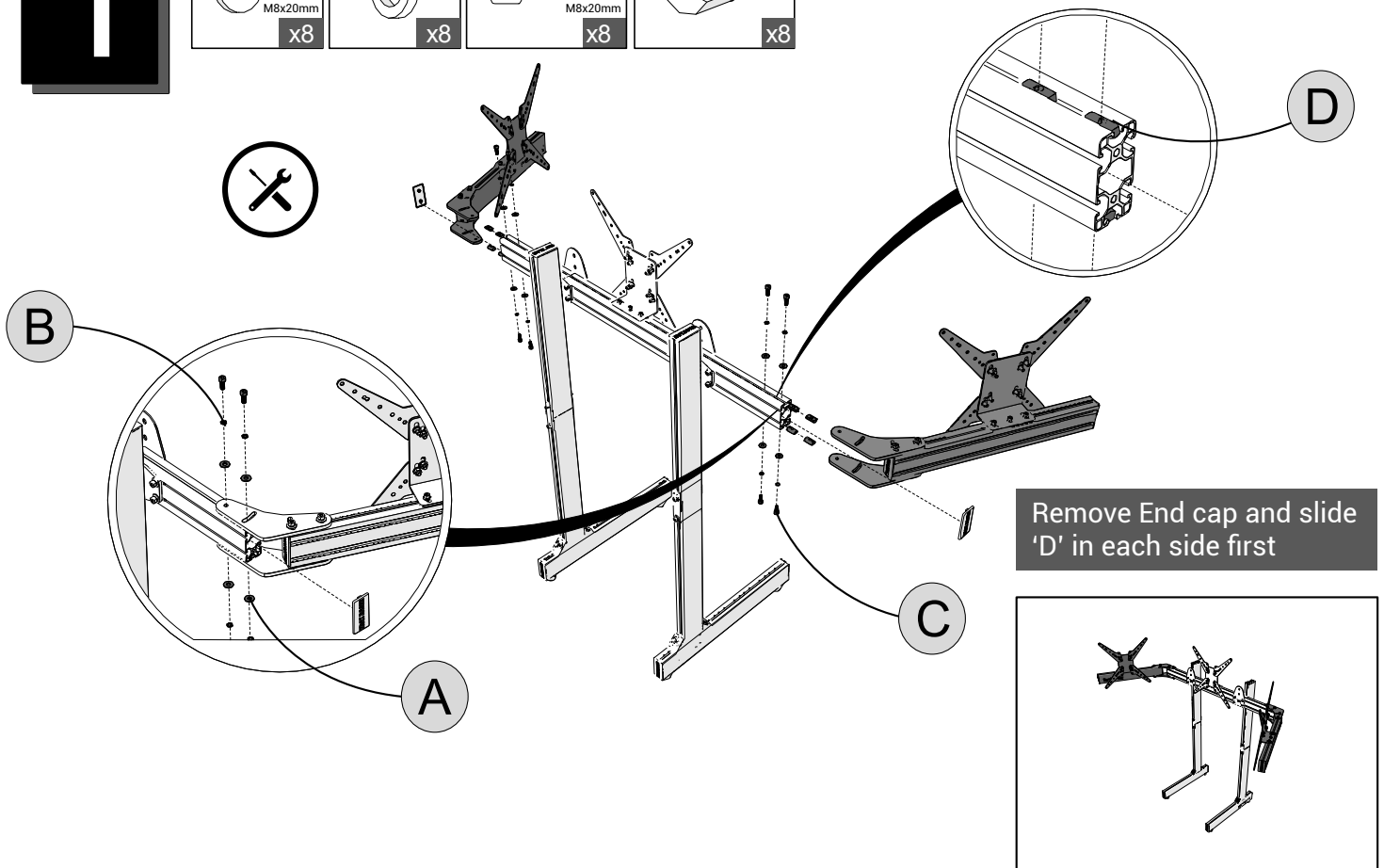
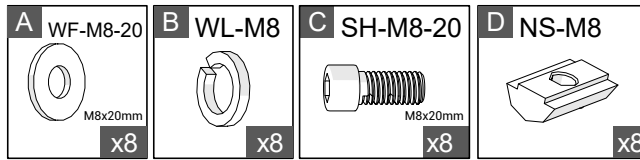

# 2



**IMPORTANT:** If your monitor screws are under 8mm (M8), you will need to use washers (not supplied)

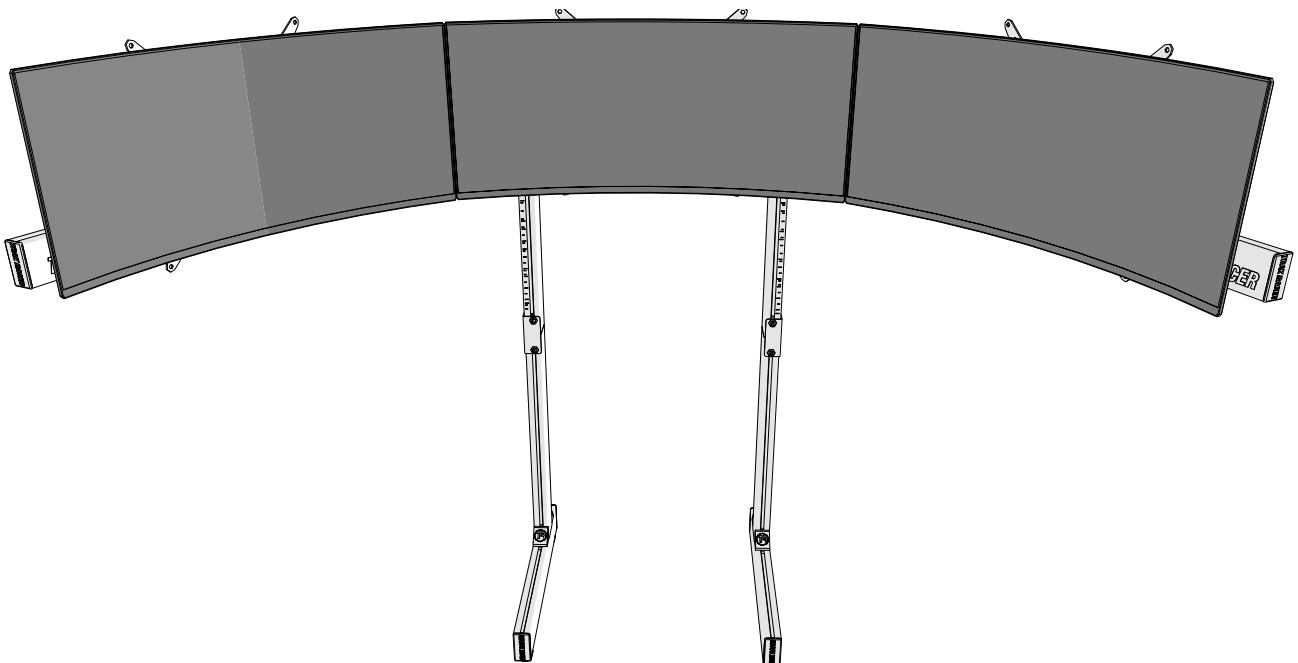

# FINISHED



@trakracer



@trakracer



@trak\_racer