

# TR8 PRO V2

## Assembly Guide

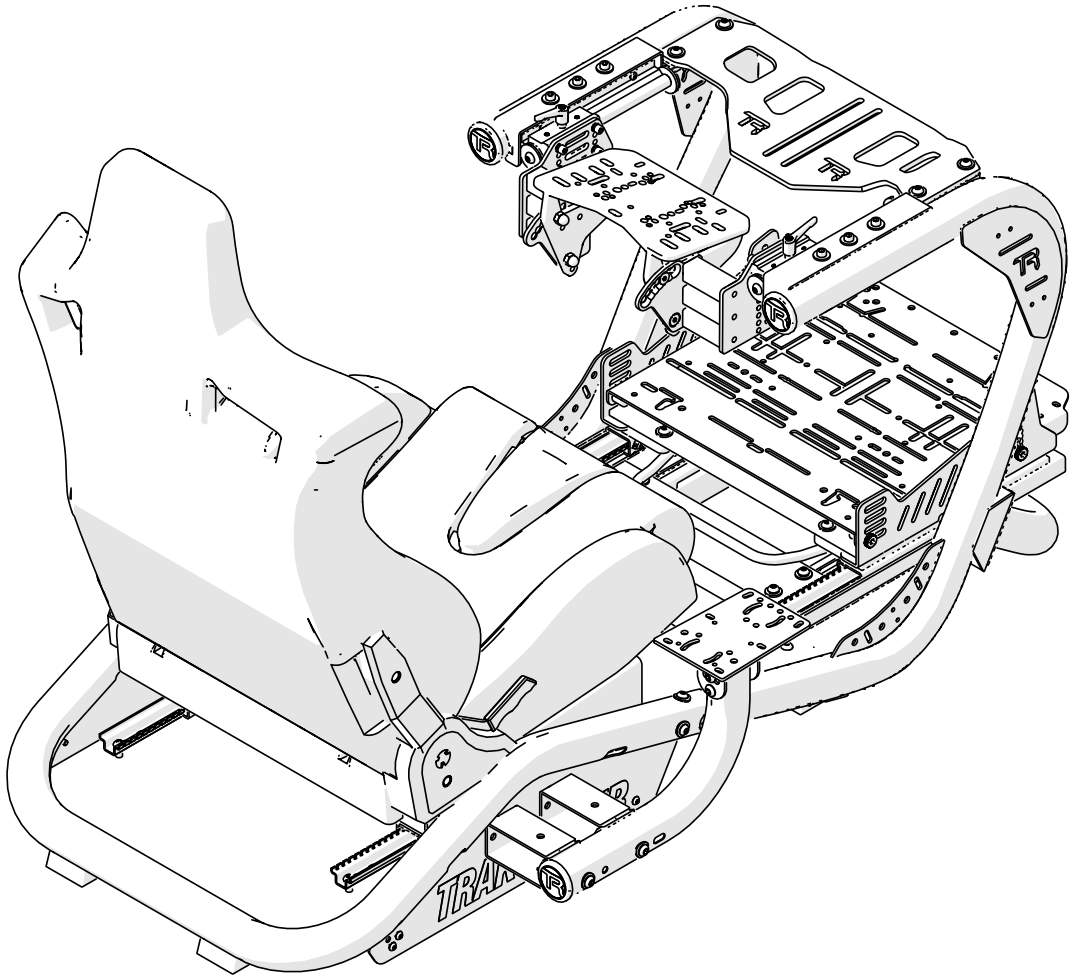

**IMPORTANT:** As there are different versions of each rig depending on your region, please ensure that you are using the correct instruction set. The part number below should match the part number labeled on your box

**TR8-10-B**



**TRAK RACER**

Published 2024-05-06

# TABLE OF CONTENTS

3 Symbol Legend

---

4 Part List

---

5 Assembly Notes

---

7 Assembly Instructions

---

11 GT/Rally seat installation

13 Recliner seat installation

17 DD Wheel Mount



**IMPORTANT:** As there are different versions of each rig depending on your region, please ensure that you are using the correct instruction set. The part number below should match the part number labeled on your box



**IMPORTANT:** Due to the nature of cut aluminium profile, some metal shavings may still be present after our extensive QA cleaning process. We recommend that boxes and packaging is opened on a hard floor.



**NOTE:** Some screws and washers are pre-installed. These will be part of the parts list and will need to be loosened and reattached according to the instructions.



Two people recommended



Tighten hardware



Leave hardware loose for adjustment

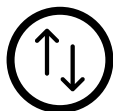

Make adjustment



Break tab off corner bracket



Safety glasses needed



Attention / Priority



Reserve for following step



Mirrored components (Same on both sides)

# TR8 PRO V2 PARTS LIST

Part #	Description	QTY	Check
TF-TR8-F	Tube Frame, TR8, Front Section	1	
TF-TR8-B	Tube Frame, TR8, Back Section	1	
TF-TR8-L	Tube Frame, TR8, Left Section	1	
TF-TR8-R	Tube Frame, TR8, Right Section	1	
SB-M8-15	Screw (Button), M4x15	32	
SH-M8-16	Screw (Hex), M8x16	4	
SH-M6-16	Screw (Hex), M6x16	8	
SH-M8-20	Screw (Hex), M8x20	4	
SB-M8-65	Screw (Button), M8x65	2	
SH-M5-15	Screw (Button), M5x15	8	
SH-M8-12	Screw (Hex), M8x12	6	
TF-TR8-SA	Tube Frame, TR8, Shifter Assembly	1	
TF-SB	Tube Frame, Shifter Block	2	
TF-TR8-MS	Tube Frame, TR8, Monitor Strut	1	
TF-TR8-WM	Tube Frame, TR8, Wheel Mount	1	
SS-01	Seat Slider	0	
WF-M8	Washer (Flat), M8	18	
WL-M8	Washer (Lock), M8	4	
WC-M8	Washer (Curved), M8	12	
WF-M6	Washer (Flat), M6	8	
WL-M6	Washer (Lock), M6	8	
WM-WM4	Wheel Mount, TR80-NWM4 Assembly	1	

\* NOTE: Extra hardware may be included as spare parts

## INCLUDED TOOLS

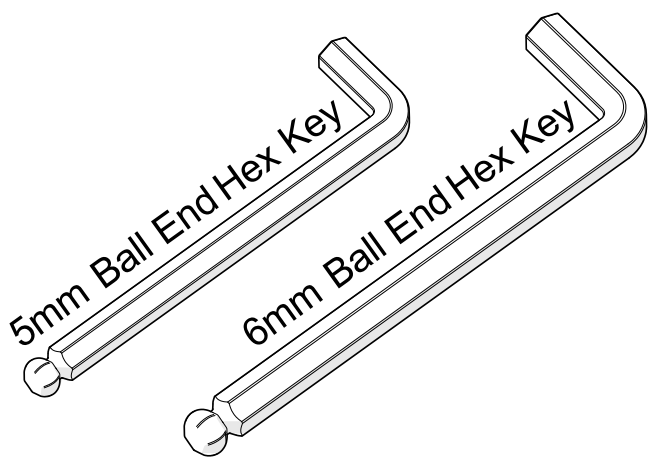

# NOTE

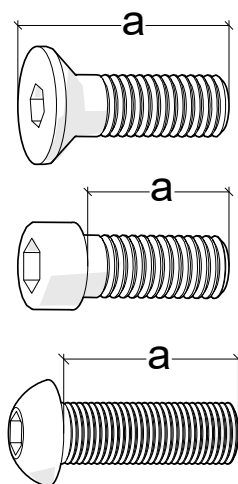
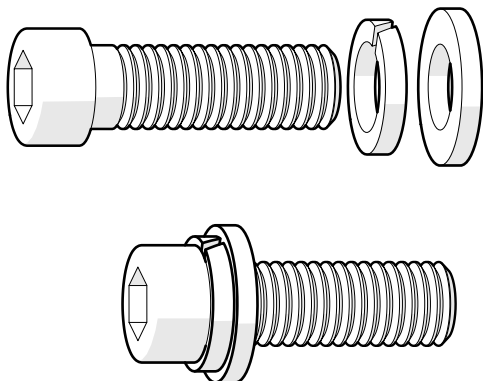
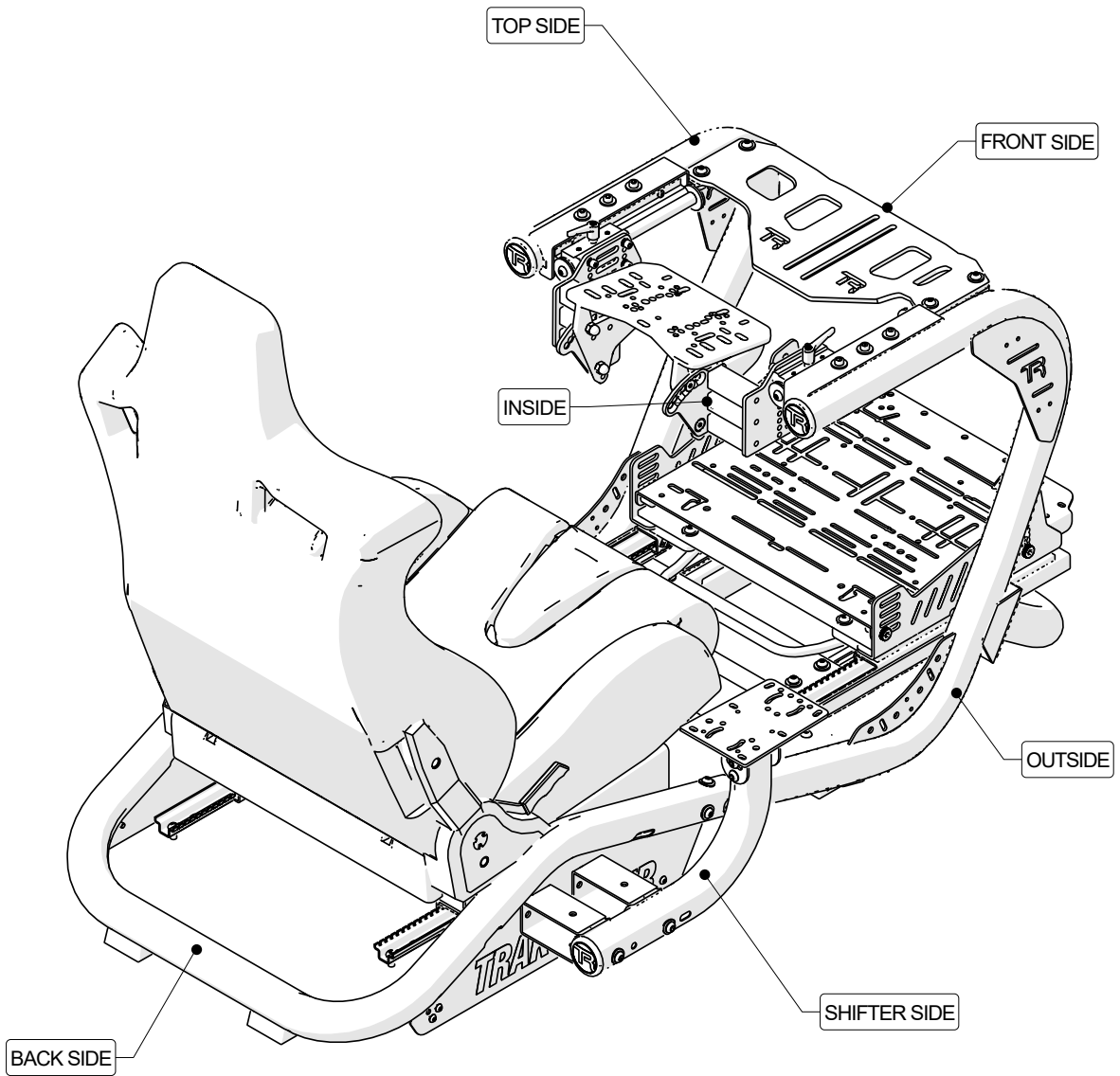

# NOTE

The handle screws (SL-M8-20 & SL-M8-25) are ratcheted to allow for tightening and loosening when space for rotation is limited. Simply pull the handle out and turn handle into position and push handle back in to engage thread.

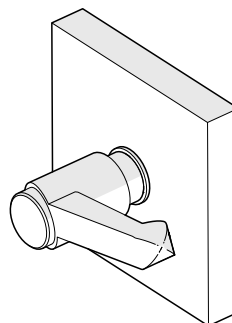
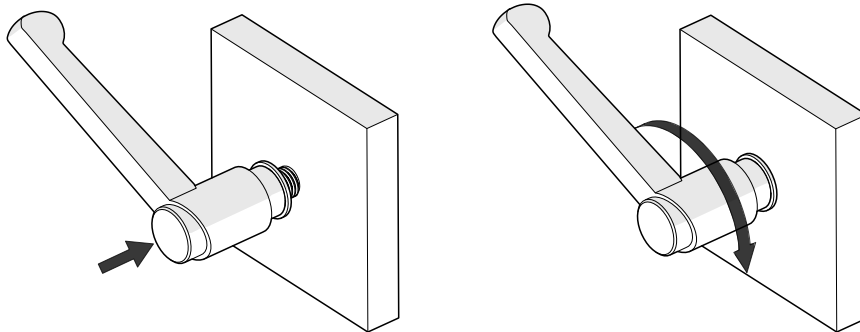
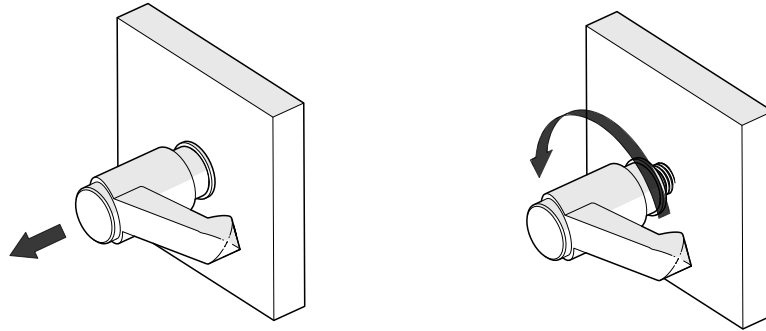
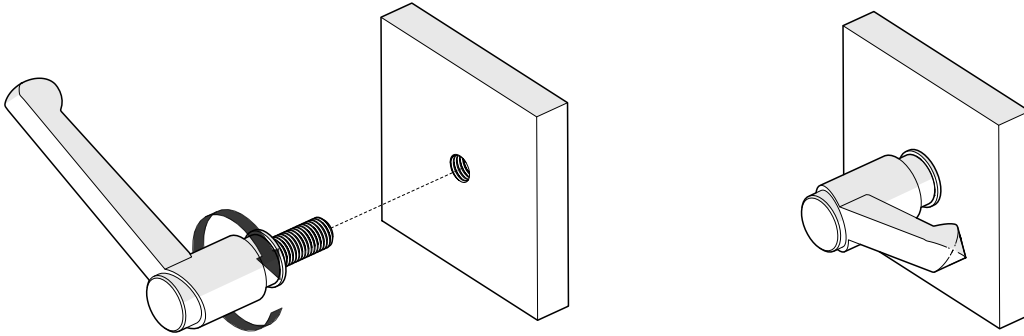

# 1

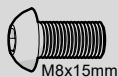

SB-M8-15 x10



TF-TR8-L x1



TF-TR8-R x1

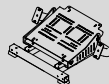

TF-TR8-F x1

NOTE: Some screws and washers come pre-installed. These will be part of the parts list and will need to be loosened and reattached according to the instructions.

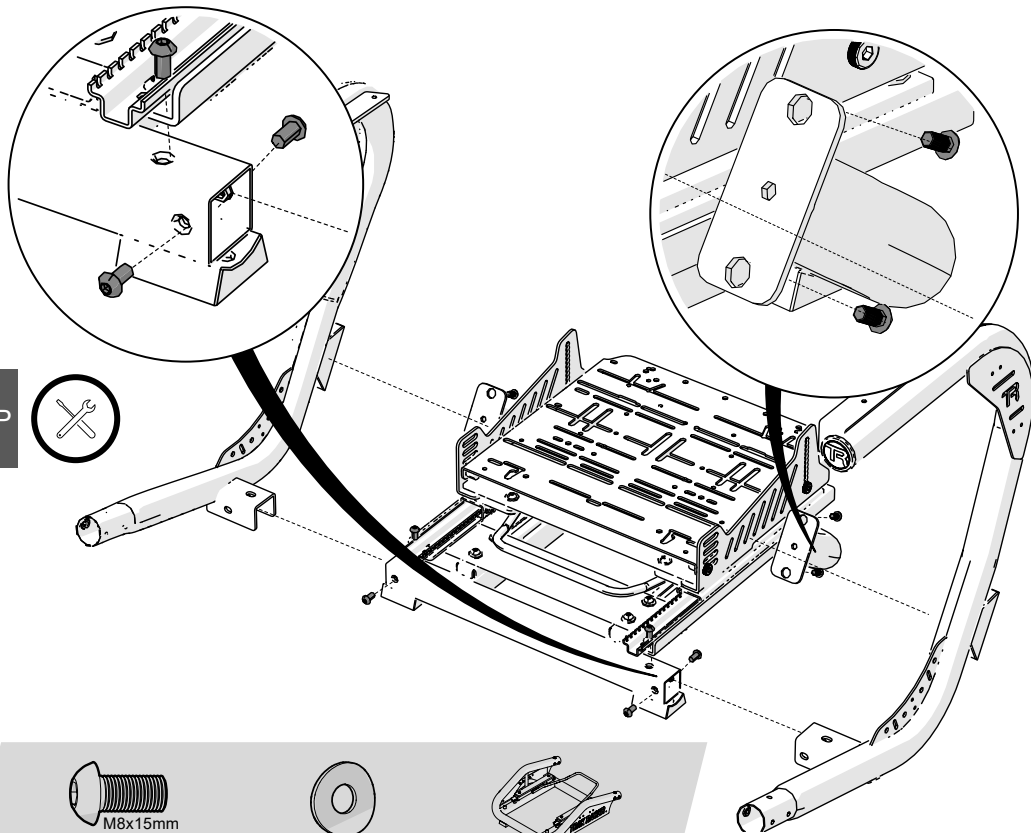

Keep slightly loose until STEP 5 completed



# 2

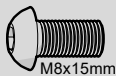

SB-M8-15 x10



WC-M8 x10



TF-TR8-B x1

NOTE: Some screws and washers come pre-installed. These will be part of the parts list and will need to be loosened and reattached according to the instructions.

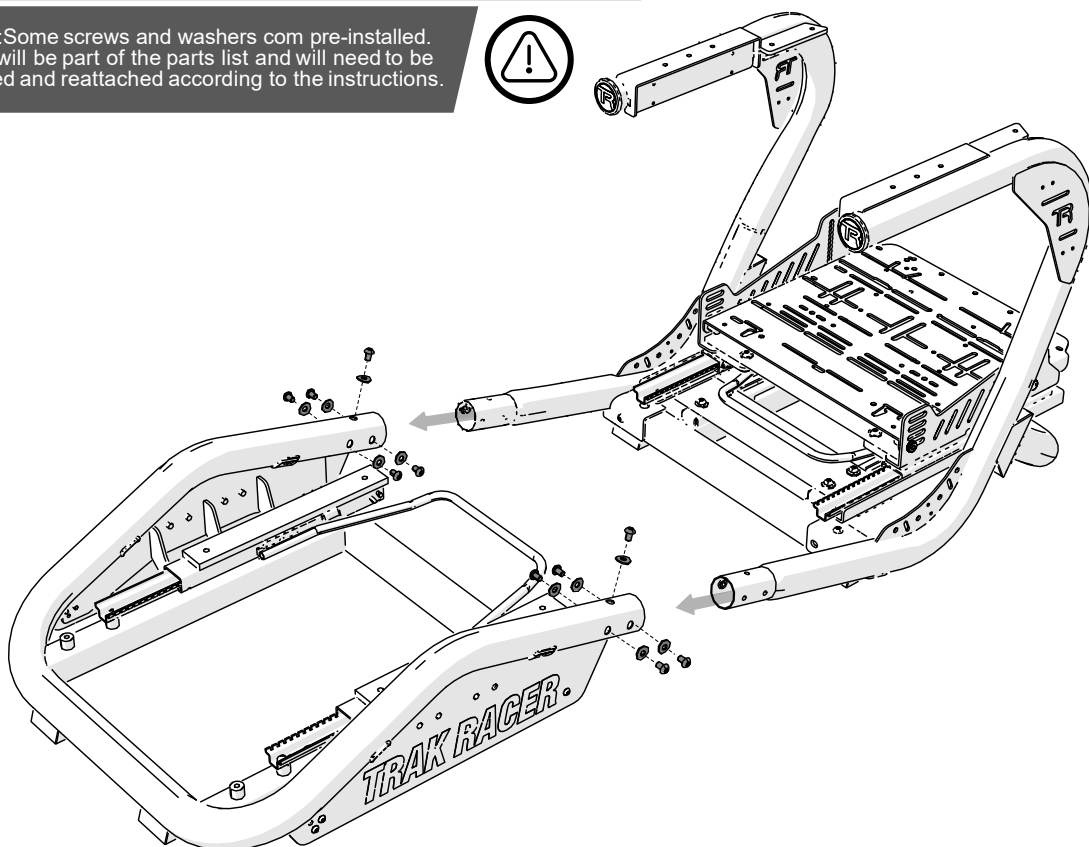

# 3



M8x20mm

SH-M8-20 x4



WF-M8 x4

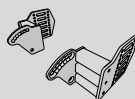

TF-TR8-WM x1



WM-WM4 x1

NOTE: Some screws and washers come pre-installed. These will be part of the parts list and will need to be loosened and reattached according to the instructions.

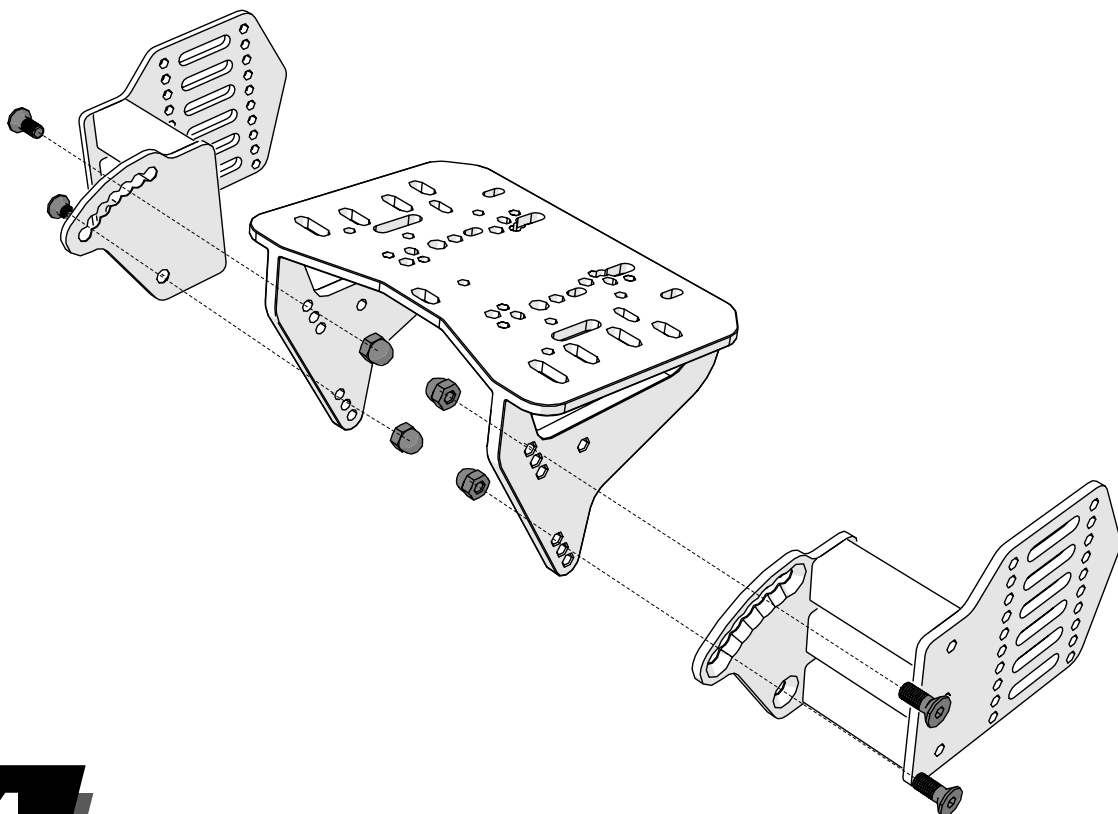

# 4

NOTE: Before proceeding, slightly loosen the L-Shaped Self-Locking Screw Handle. Adjust the mechanism, then slightly tighten the handle before continuing with the installation.

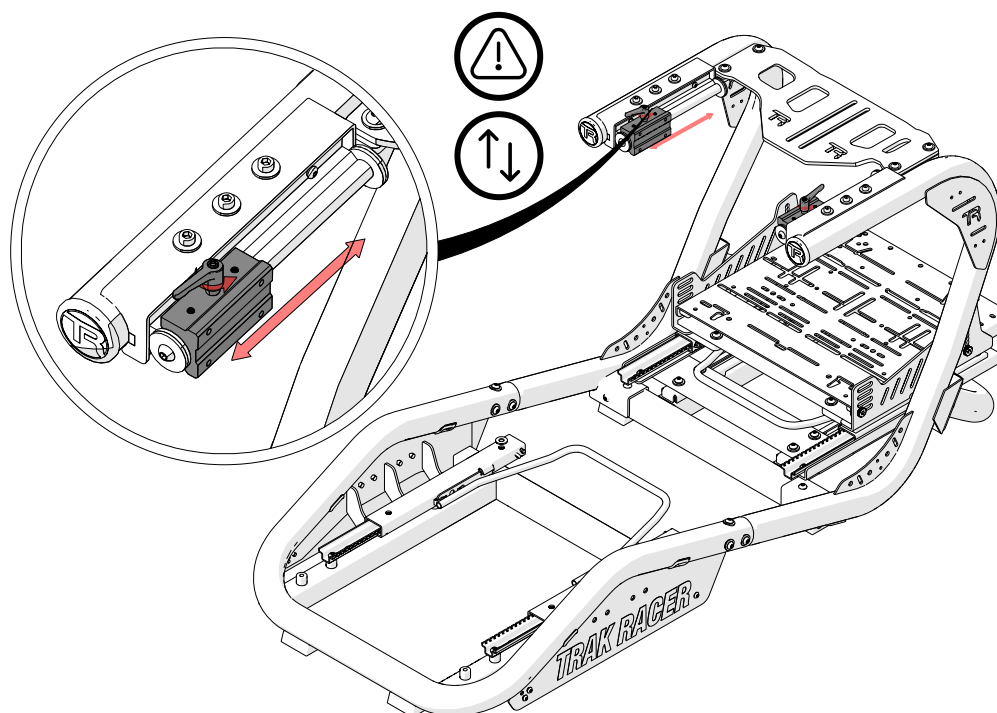



# 5



M6x16mm



SH-M6-16 x8

WL-M6 x8

WF-M6 x8

NOTE: Some screws and washers come pre-installed. These will be part of the parts list and will need to be loosened and reattached according to the instructions.



Use holes to adjust vertical position



a

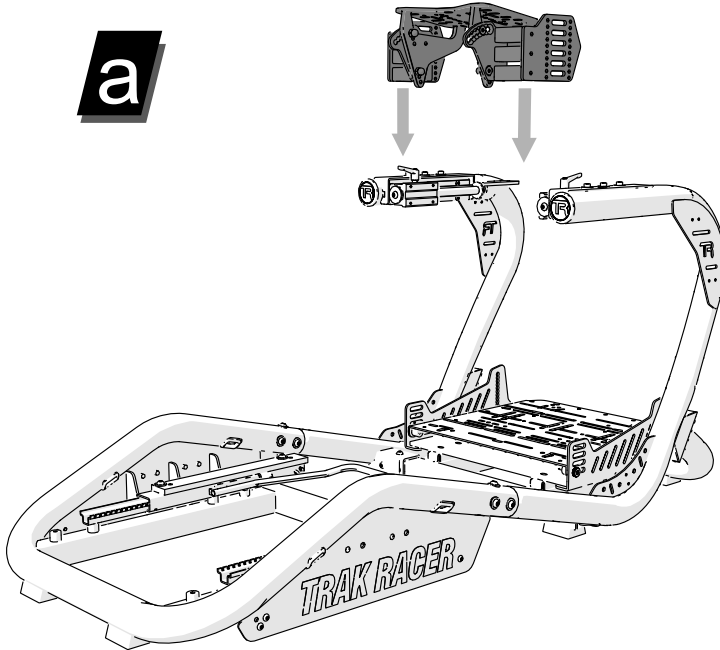

b

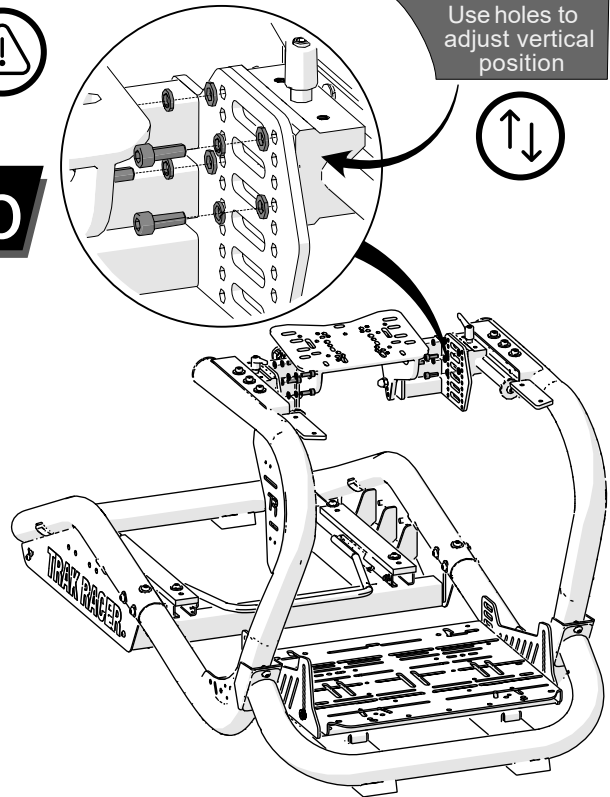

# 6

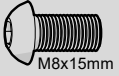

M8x15mm

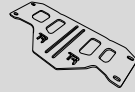

SB-M8-15 x4

WF-M8 x4

TF-TR8-1 x1

NOTE: Some screws and washers come pre-installed. These will be part of the parts list and will need to be loosened and reattached according to the instructions.

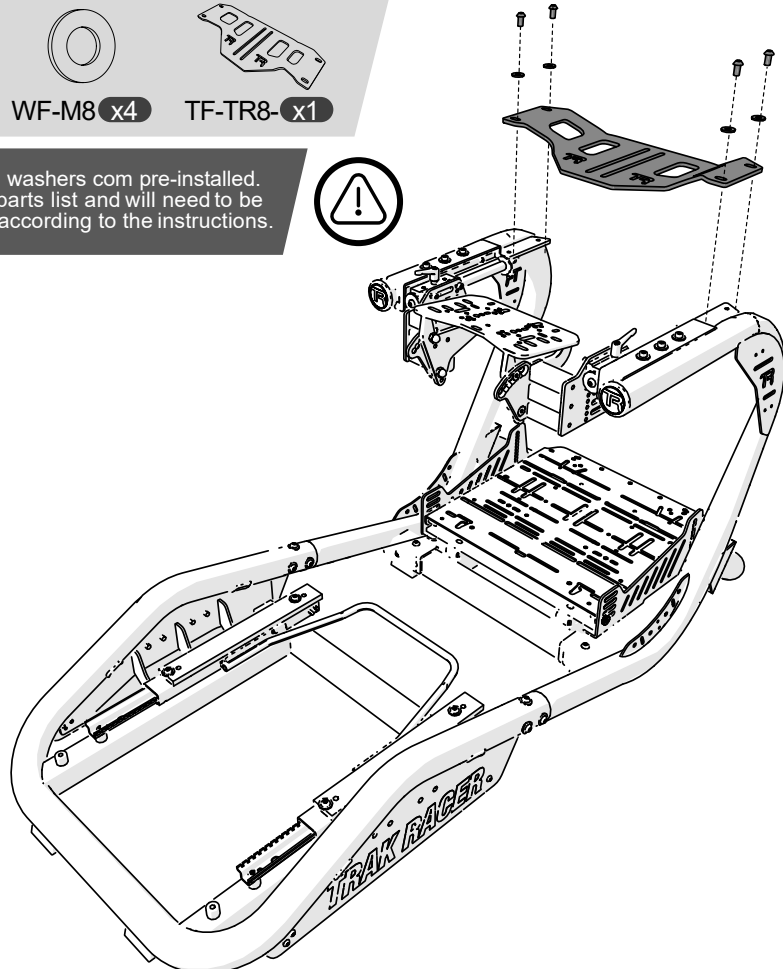

# 7

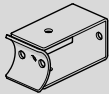

TF-SB x2

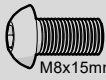

SB-M8-15 x4

M8x15mm

NOTE: Some screws and washers com pre-installed. These will be part of the parts list and will need to be loosened and reattached according to the instructions.

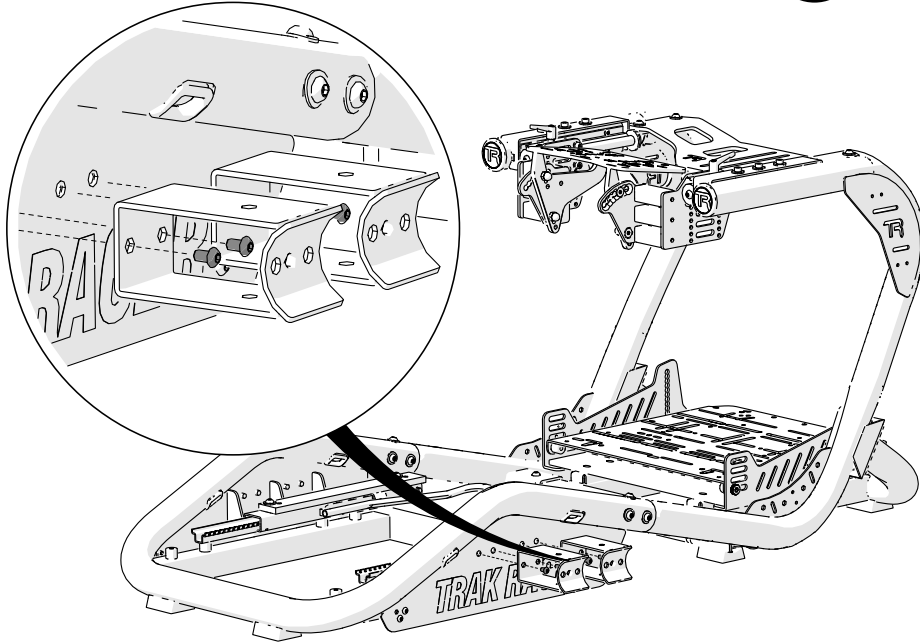

# 8



TF-TR8-SA x1

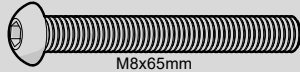

SB-M8-65 x2

M8x65mm



WC-M8 x2

NOTE: Some screws and washers com pre-installed. These will be part of the parts list and will need to be loosened and reattached according to the instructions.

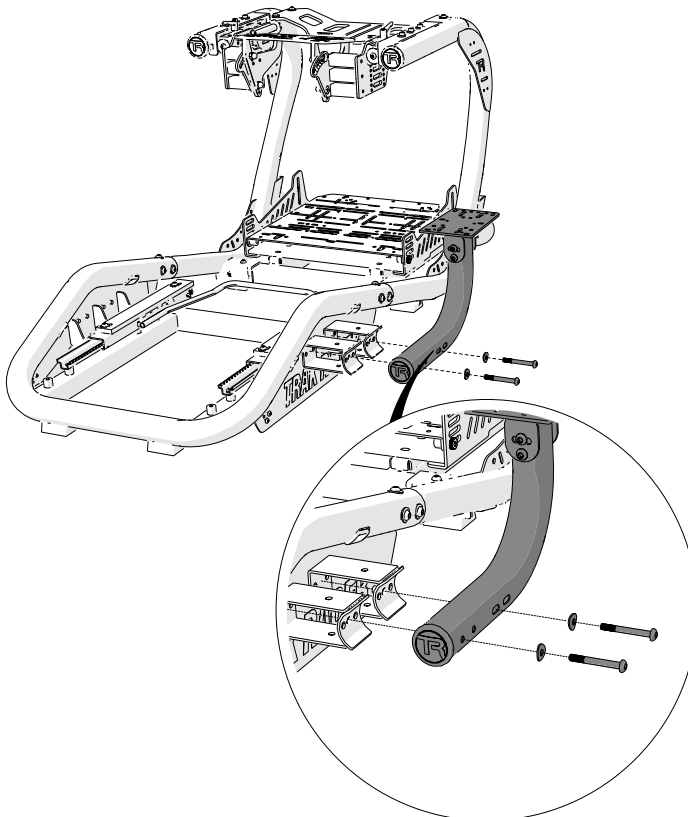

# OPTIONAL: Rally/GT Seat Assembly

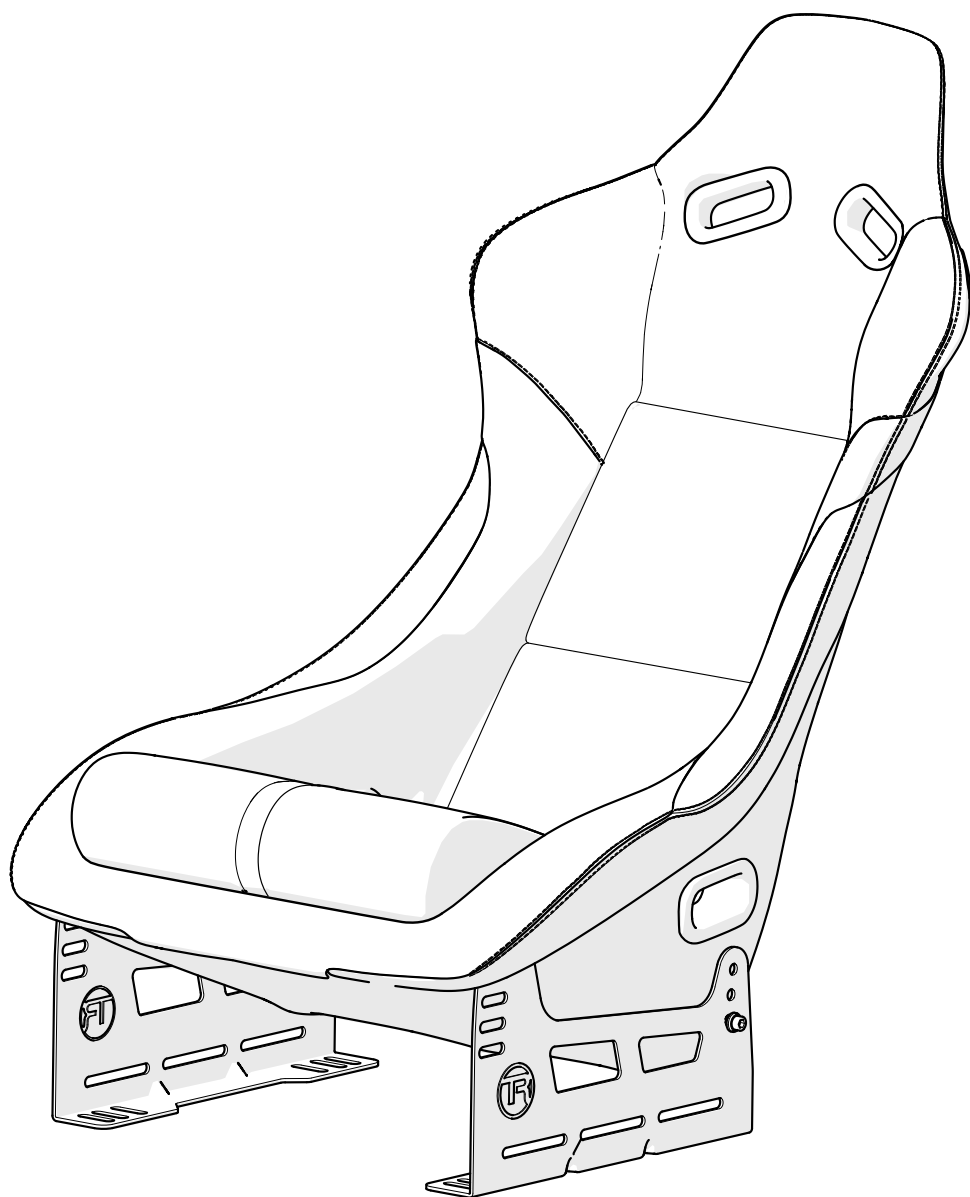

SA-04/SA-05/SA-09/SA-10



**TRAK RACER**

Published 2022-06-04

1



M8x16mm

SH-M8-16 x4



WL-M8 x4



WF-M8 x4

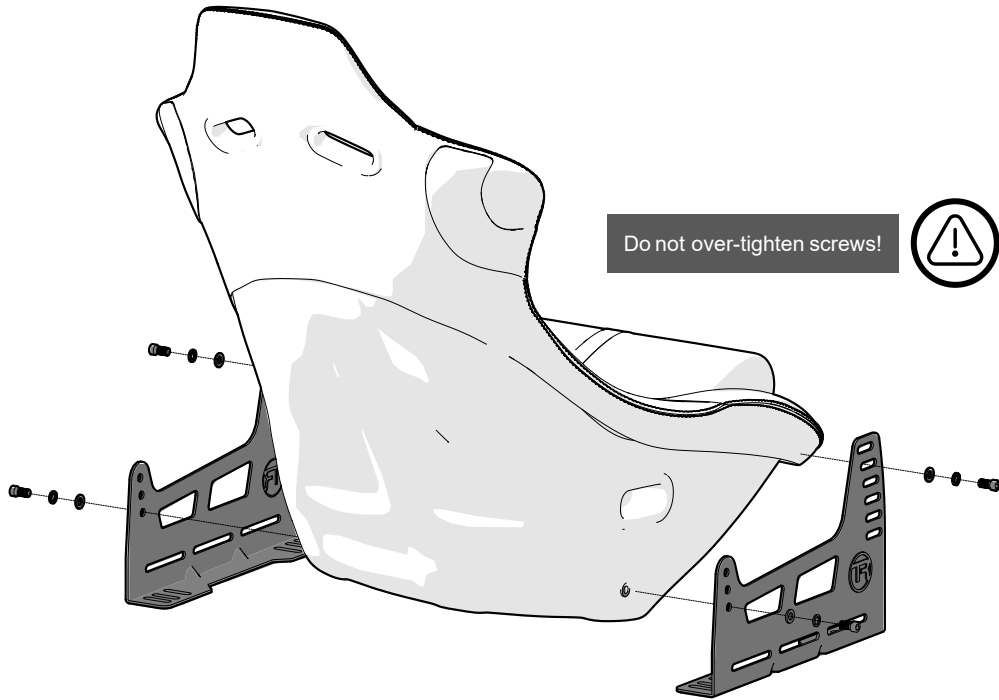

Do not over-tighten screws!



2



M8x16mm

SH-M8-16 x4



WF-M8 x4

Note: Hardware supplied with Seat Slider

NH-M8 Nut may be pre-installed to seat slider



x4

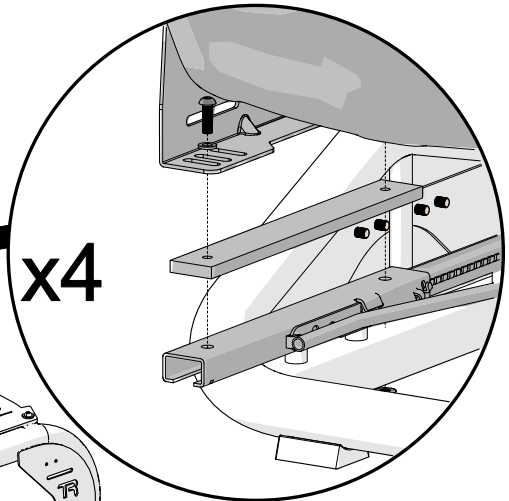
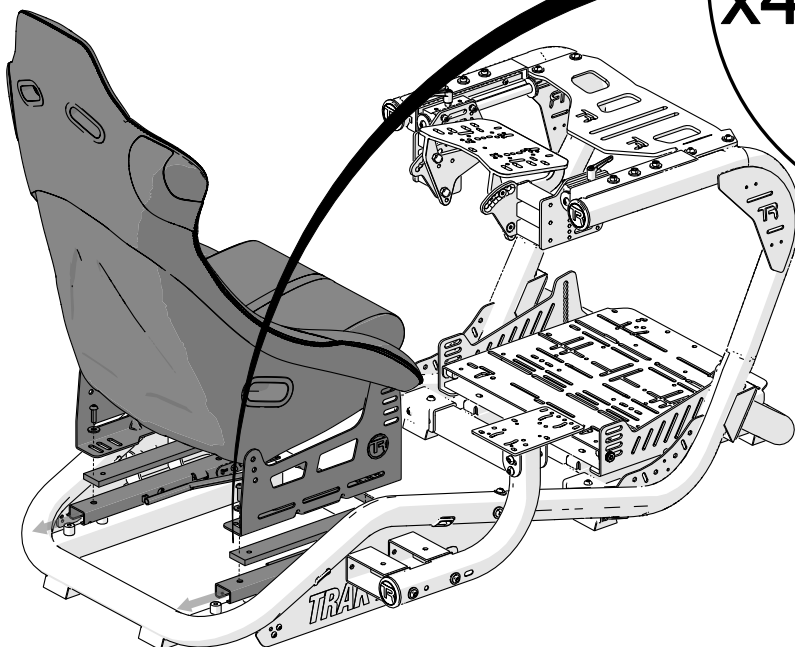

# OPTIONAL: Recliner Seat Assembly

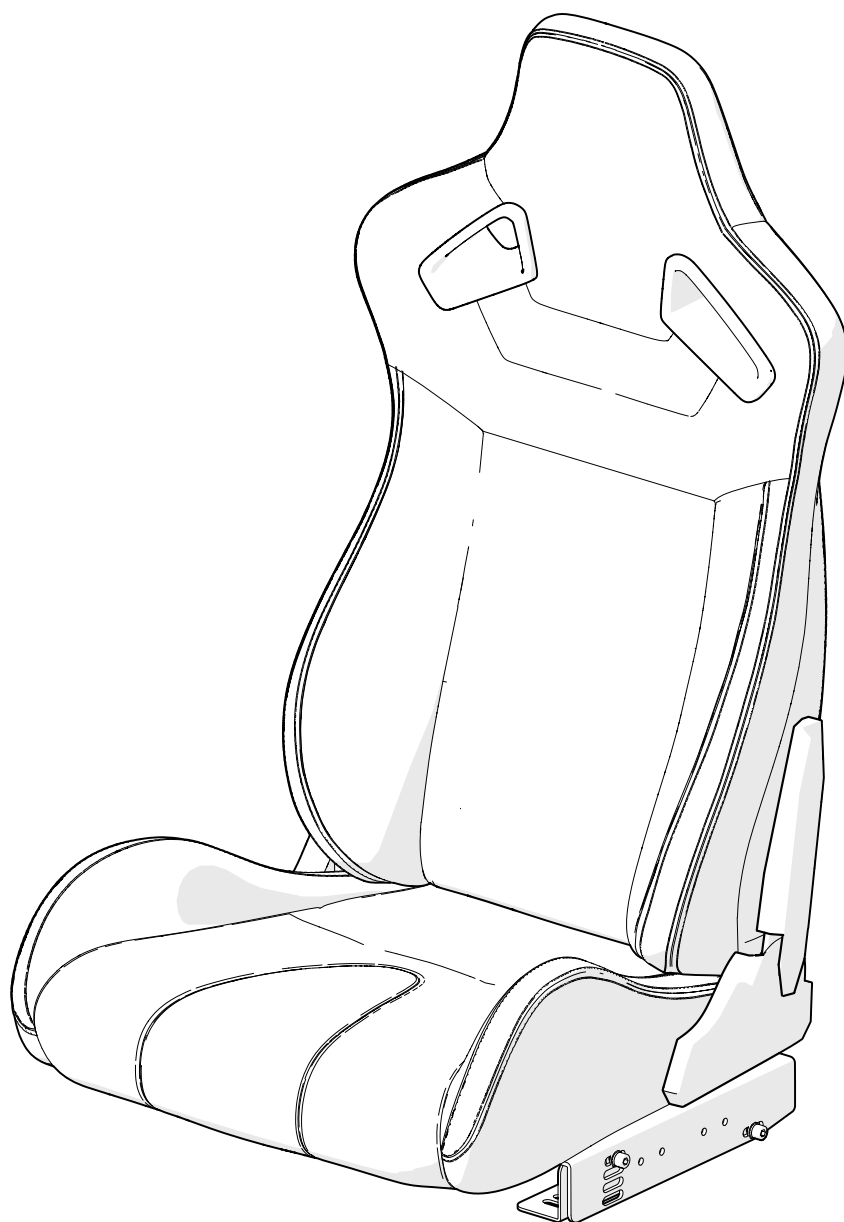

**SA-06/SA-07/SA-08**

1

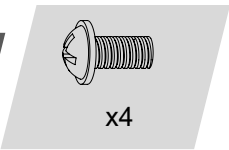

Note: Screws supplied with seat

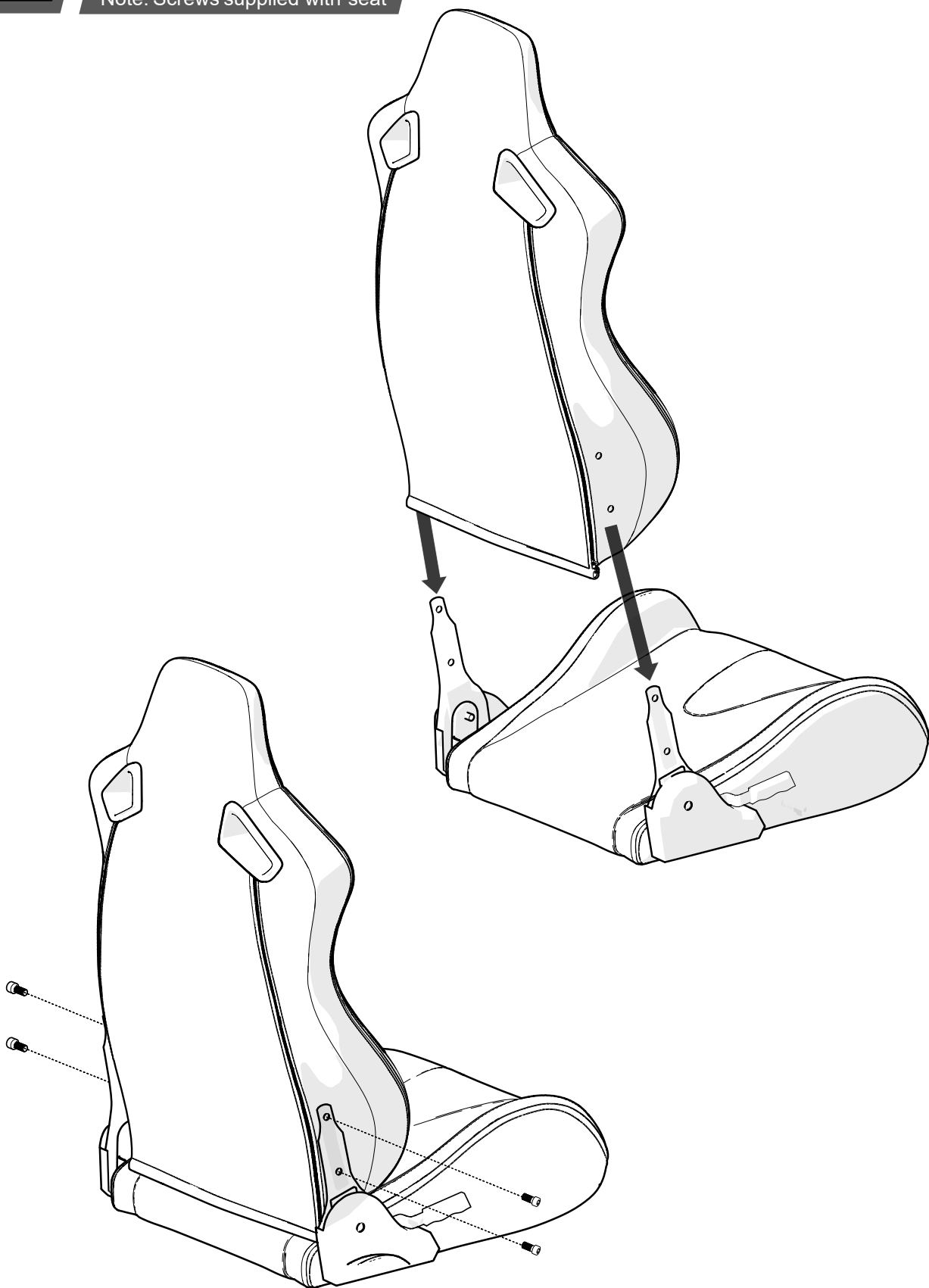

2

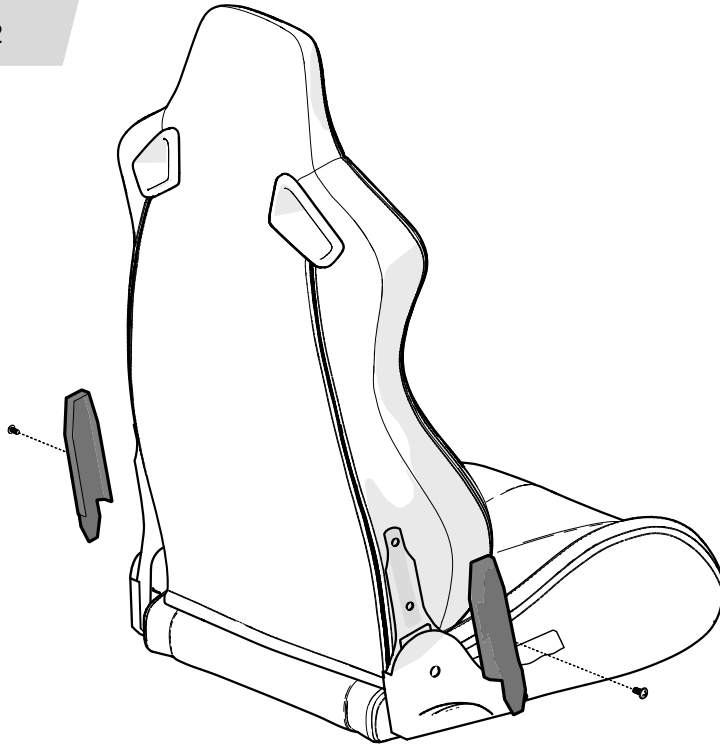
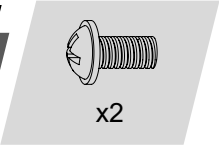

3



Note: Screws supplied with seat & SB-03

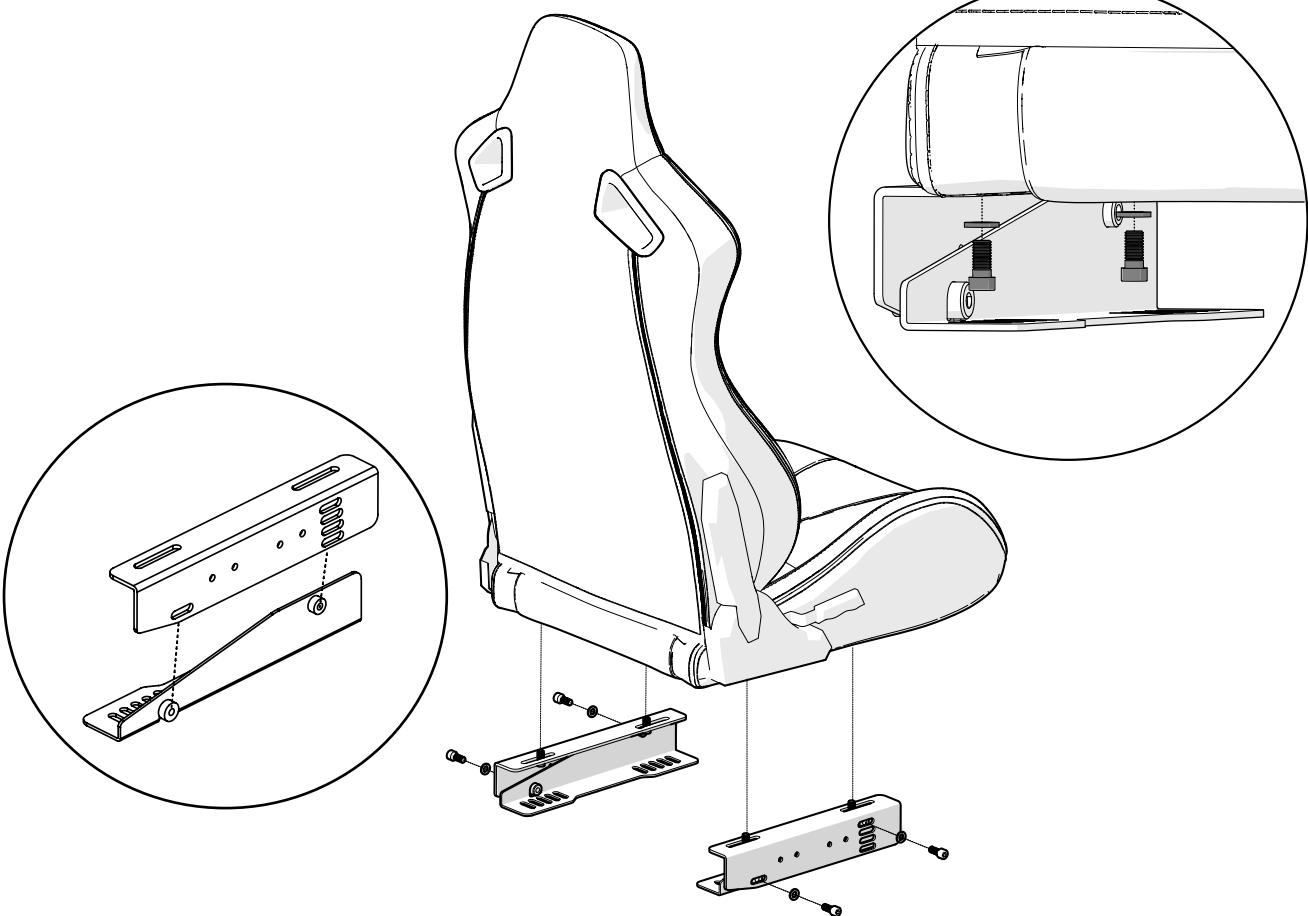

# 4

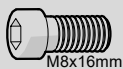

M8x16mm

SH-M8-16 x4



WF-M8 x4

Note: Hardware supplied with Seat Slider

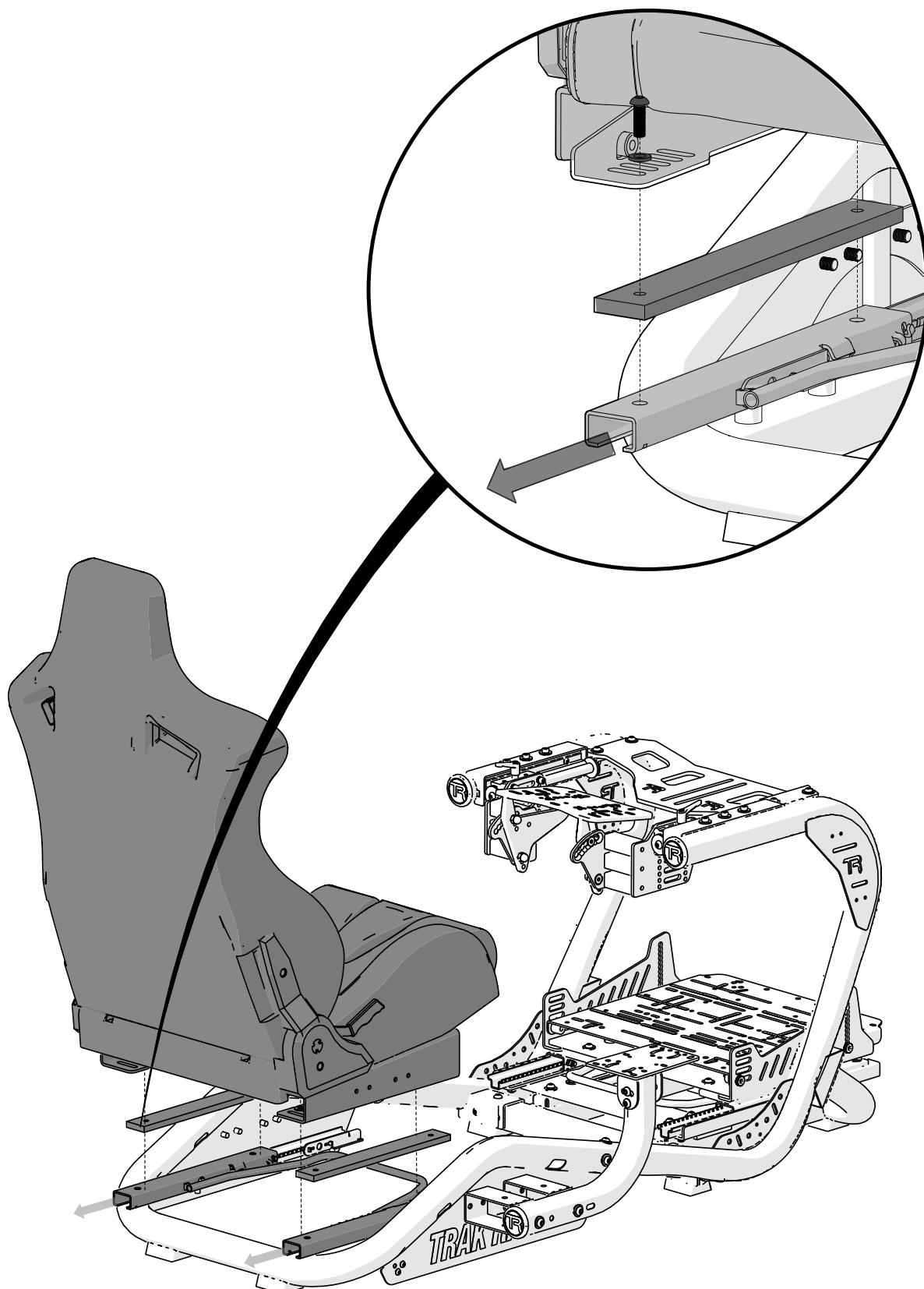



# OPTIONAL:

## Direct Mount for Simucube, Simucube 2, VRS, Simagic, MIGE

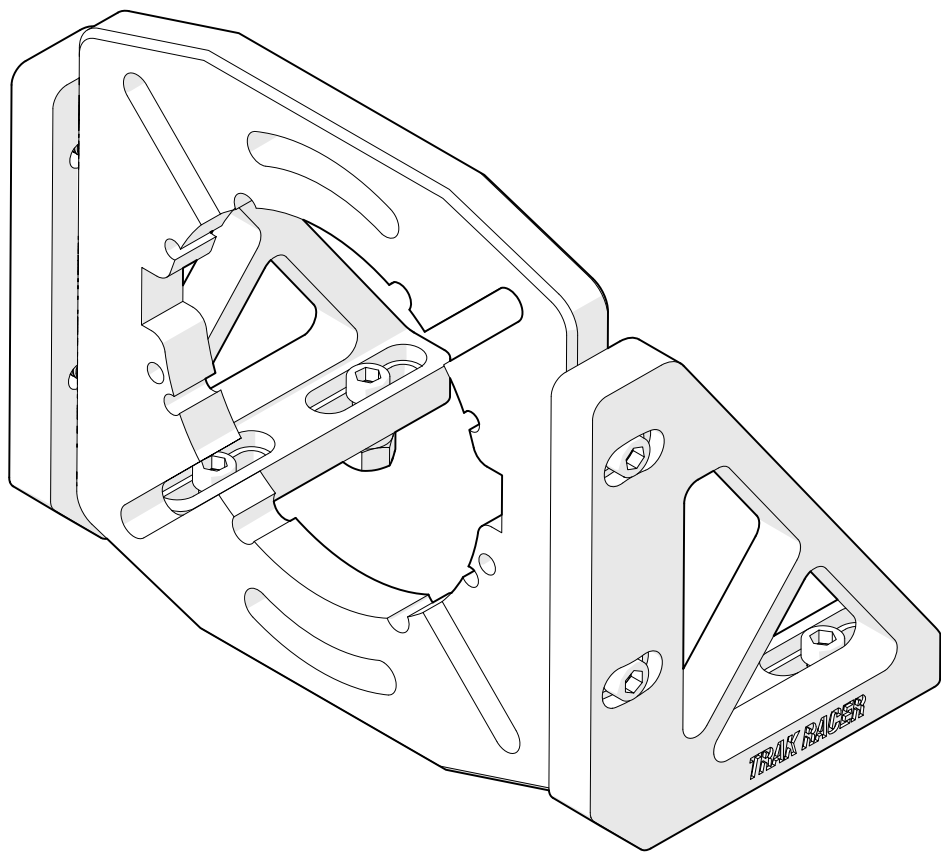

Part #	Description	QTY	Check
BOX #: TR8-DDBR			
SH-M8-25	Screw (Hex), M8x25	4	
WF-M8	Washer (Flat), M8	8	
WL-M8	Washer (Lock), M8	8	
NF-M8	Nut (Flange), M8	4	
WM-DD-BR	Wheel Mount, DD Brackets	2	
SH-M8-16	Screw (Hex), M8x16	4	
BOX #: TR80-NWMDD			
SH-M8-20	Screw (Hex), M8x20	4	
SH-M8-25	Screw (Hex), M8x25	4	
WF-M8	Washer (Flat), M8	4	
SH-M5-10	Screw (Button), M5x10	2	
WF-M5	Washer (Flat), M5	2	
WM-DD	Wheel Mount, Direct Drive	1	

\* NOTE:Extra hardware may be included as spare parts

TR-DDBRDDM

# 1a

FRONT MOUNT

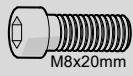

M8x20mm

SH-M8-20 x4



WM-DD-BR x2



WM-DD x1

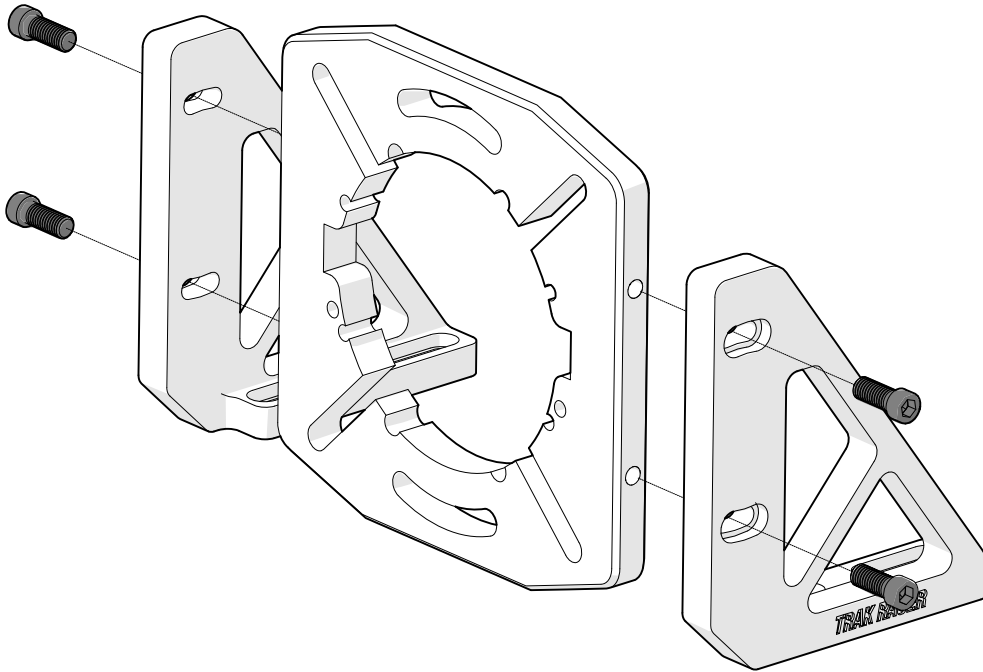

# 2a

FRONT MOUNT



M8x25mm

SH-M8-25 x4



NF-M8 x4

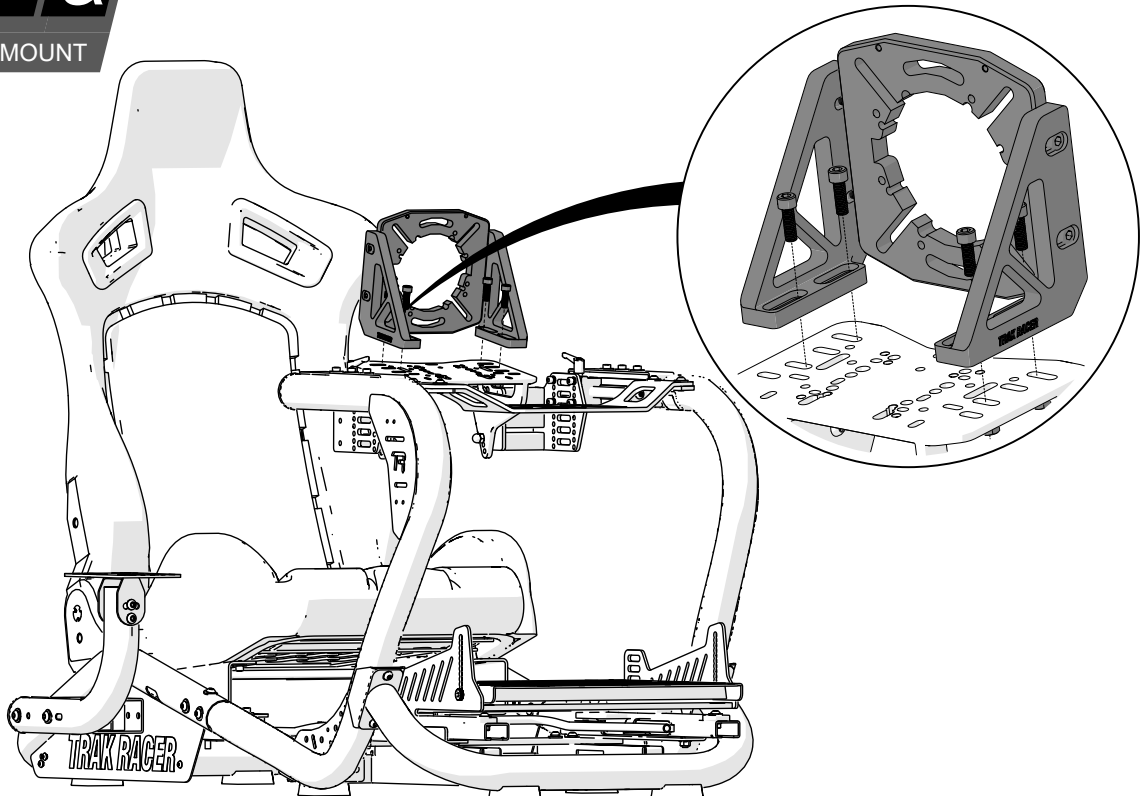

# 3a

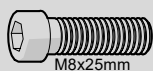

M8x25mm



SH-M8-25 x4

WF-M8 x4

NOTE: Use mounting screws provided with wheelbase if necessary

FRONT MOUNT

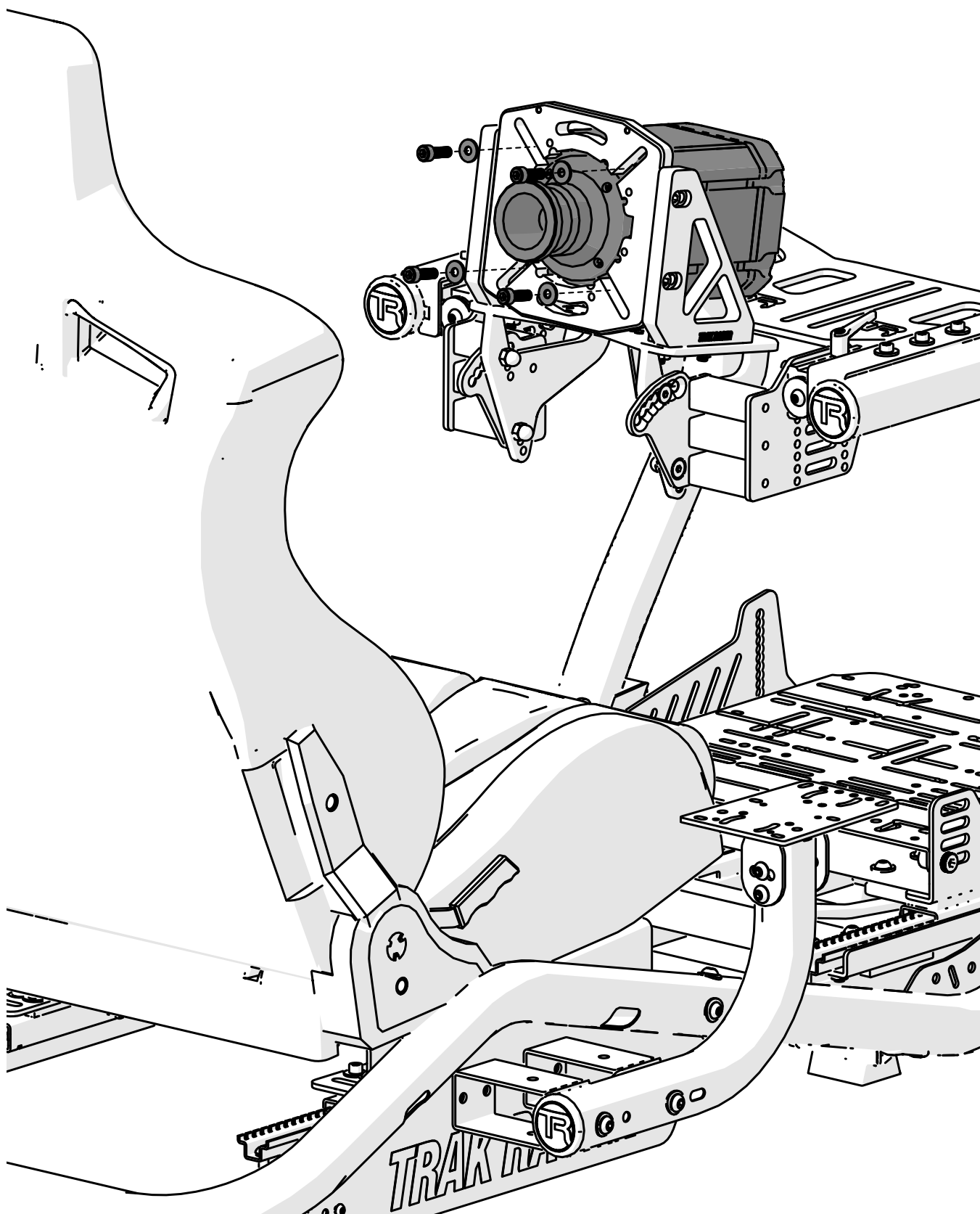

# 1

## b

SIDE MOUNT



M8x20mm

SH-M8-20 x4



WM-DD-BR x2



WM-DD x2

NOTE: Use mounting screws provided with wheelbase if necessary

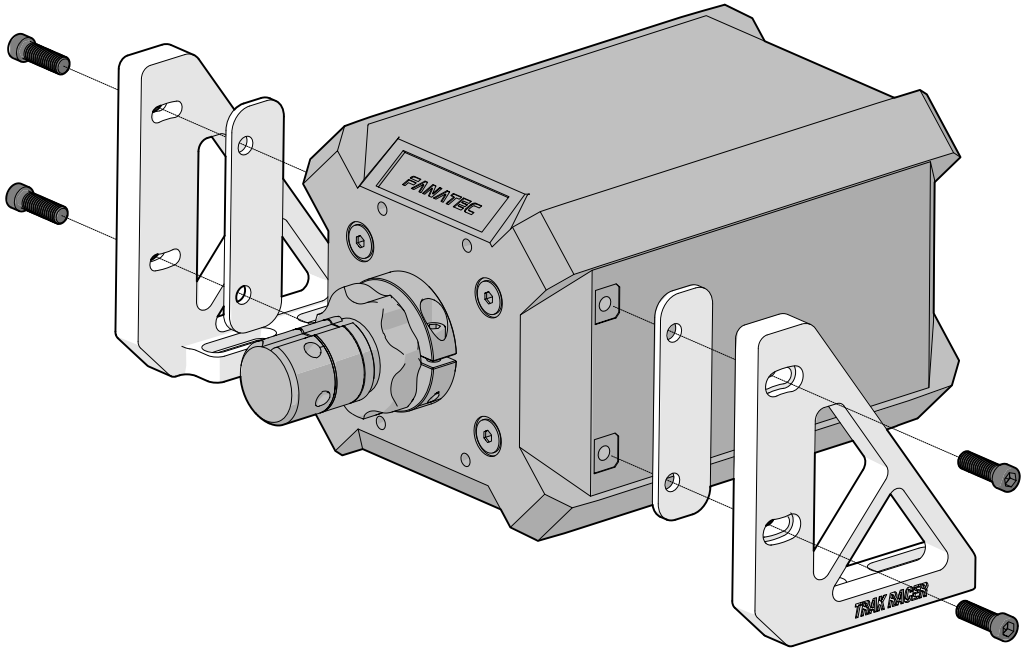

# 2

## b

SIDE MOUNT

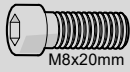

M8x20mm

SH-M8-20 x4



WF-M8 x4

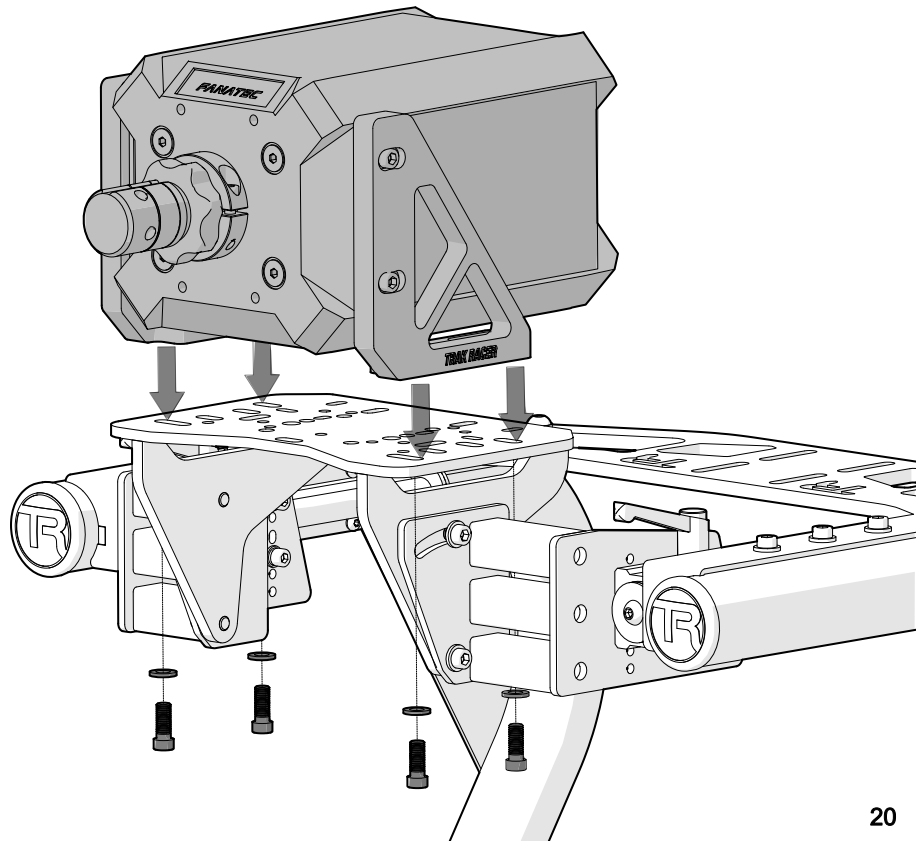

# FINISHED



Share your build online and tag us to be featured!



@trakracer



@trakracer



@trak\_racer