

Overhead Monitor Stand with VESA Mount

Assembly Guide

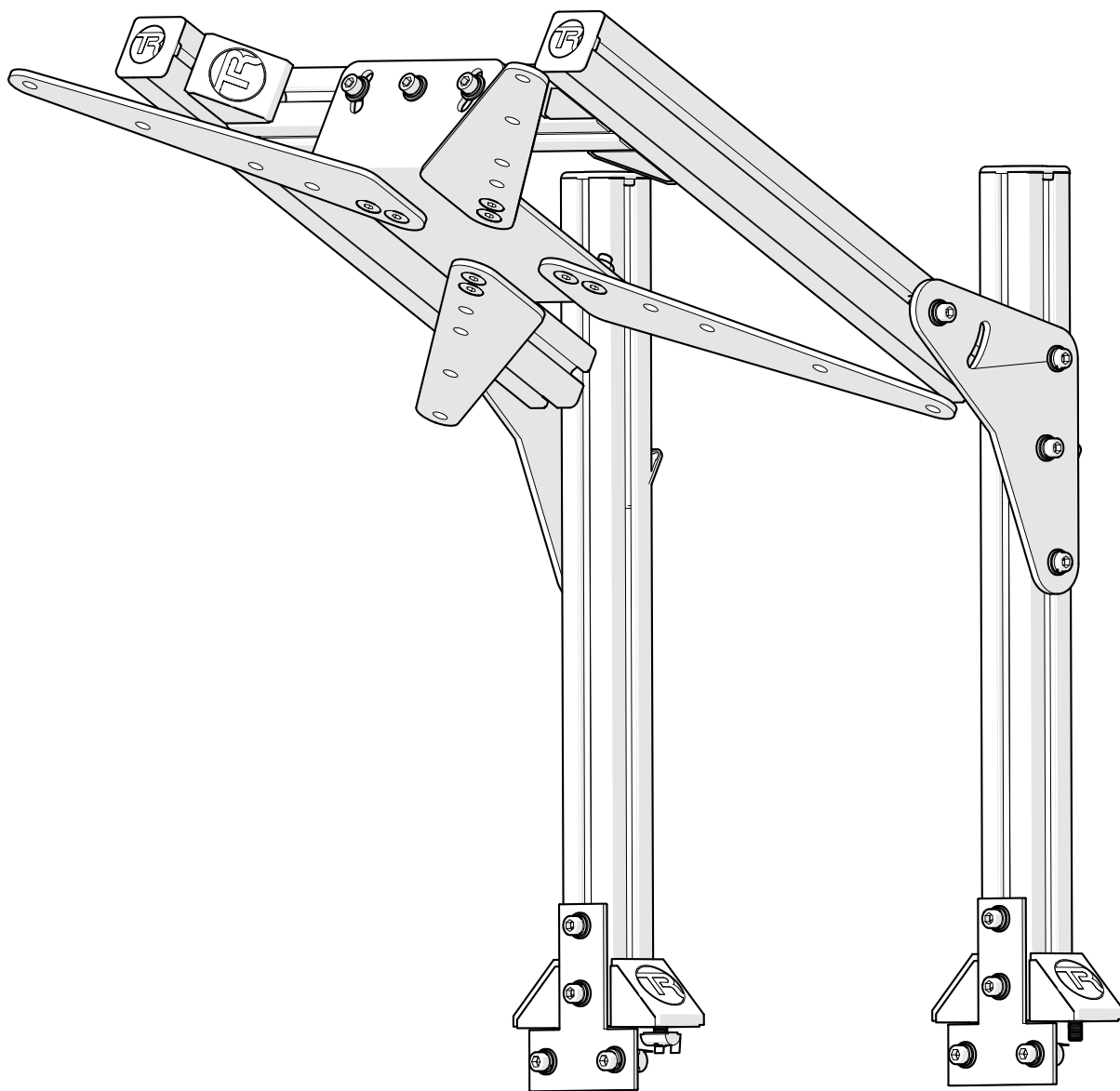

IMPORTANT: As there are different versions of each rig depending on your region, please ensure that you are using the correct instruction set. The part number below should match the part number labeled on your box

TR80-4M4-BLK



TRAK RACER

Published 2023-09-06

TABLE OF CONTENTS

3 Symbol Legend

4 Part list

5 Assembly Notes

9 TR80-4M4-BLK Assembly Instructions



IMPORTANT: As there are different versions of each rig depending on your region, please ensure that you are using the correct instruction set. The part number below should match the part number labeled on your box



IMPORTANT: Due to the nature of cut aluminium profile, some metal shavings may still be present after our extensive QA cleaning process. We recommend that boxes and packaging is opened on a hard floor.



NOTE: Some screws and washers are pre-installed. These will be part of the parts list and will need to be loosened and reattached according to the instructions.



Two people needed



Tighten hardware



Leave hardware loose for adjustment

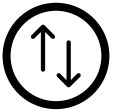

Make Adjustment



Break tab off Corner bracket CB1



Safety glasses needed



Attention / Priority



Reserve for following step



Mirrored Components (Same on both sides)



IMPORTANT: As there are different versions of each rig depending on your region, please ensure that you are using the correct instruction set. The part number below should match the part number labeled on your box

TR80-4M4-BLK PARTS LIST

Part #	Description	QTY	Check
BM-QA	Bracket (Monitor), Quad Adjustable	2	
BC-40	Bracket, Corner with Cap, 40x40	8	
EC-40	End Cap, 40x40	6	
NF-M8	Nut (Flange), M8	8	
NS-M8	T-Nut (Spring), M8	35	
AL-40-500	Aluminum Profile, 40x40x500mm	2	
AL-40-400	Aluminum Profile, 40x40x400mm	2	
AL-40-300	Aluminum Profile, 40x40x300mm	1	
SH-M8-16	Screw (Hex), M8x16	8	
SH-M8-20	Screw (Hex), M8x20	27	
SF-M8-16	Screw (Flat), M8x16	8	
BT-01	Bracket, T Connector	2	
VM-02	VESA new	1	
WF-M8	Washer (Flat), M8	35	
WL-M8	Washer (Lock), M8	35	

* **NOTE:** Extra hardware may be included as spare parts

NOTE

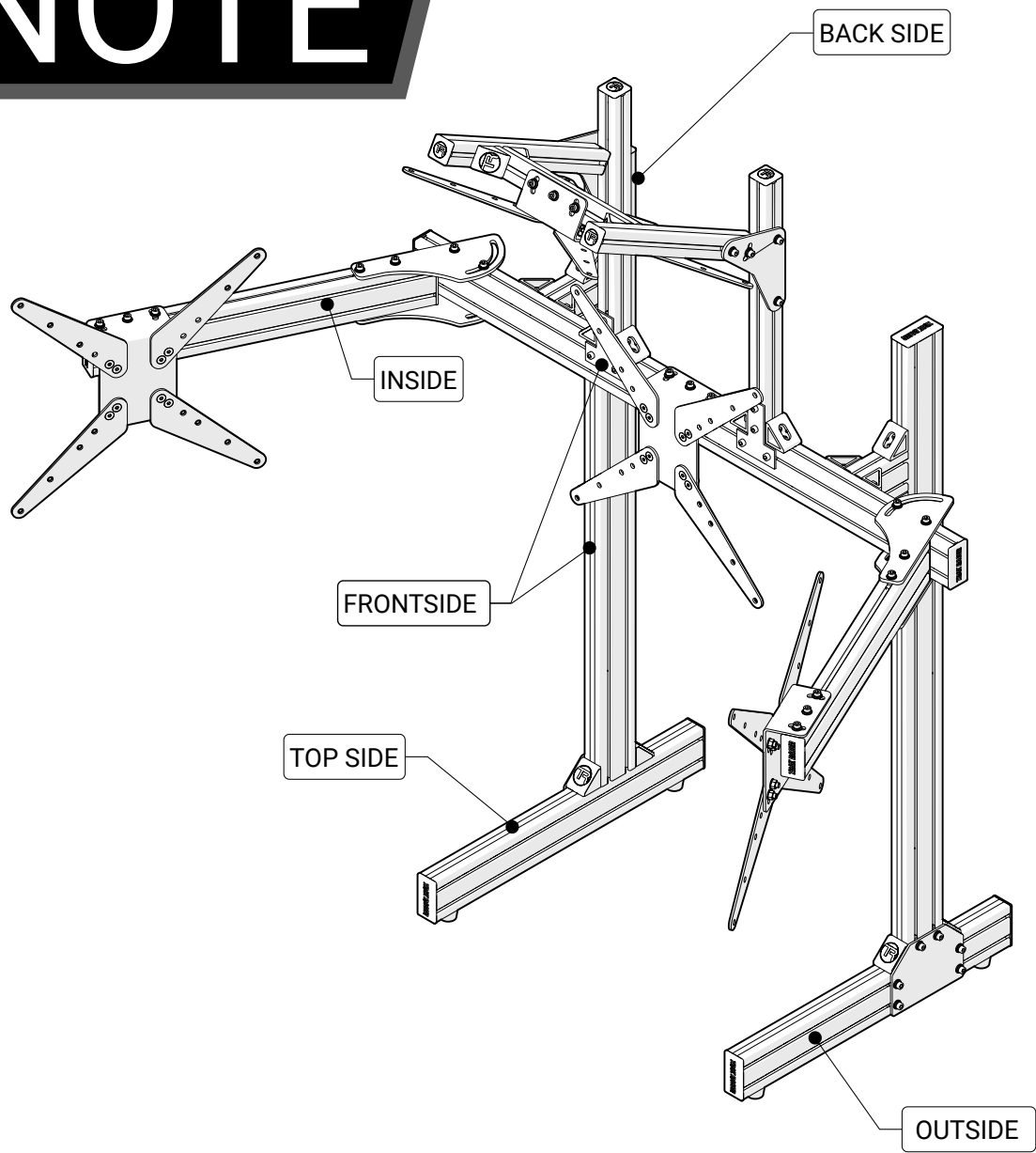

INSTALLATION ORDER FOR SCREWS & WASHERS

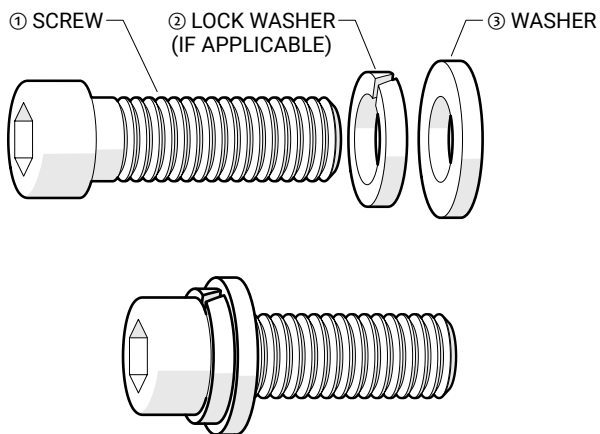

HOW TO MEASURE SCREWS

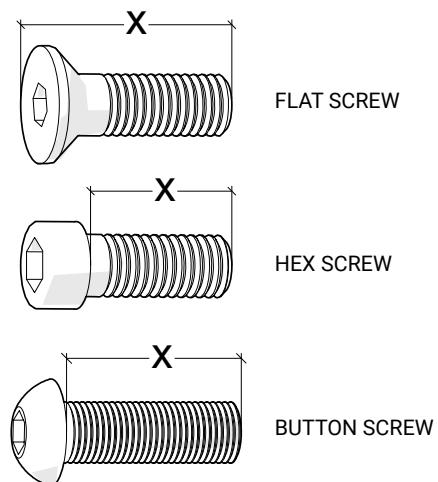

NOTE

The handle screws (SL-M8-20 & SL-M8-25) are ratcheted to allow for tightening and loosening when space for rotation is limited. Simply pull the handle out and turn handle into position and push handle back in to engage thread.

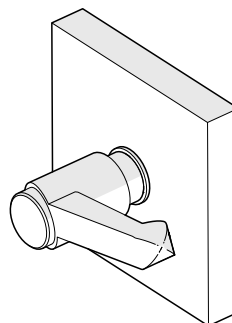
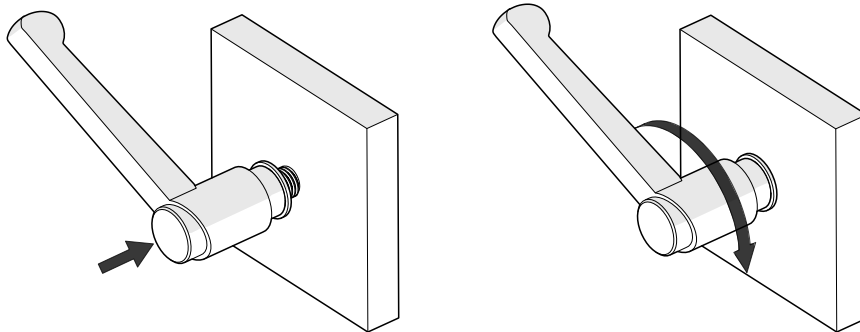
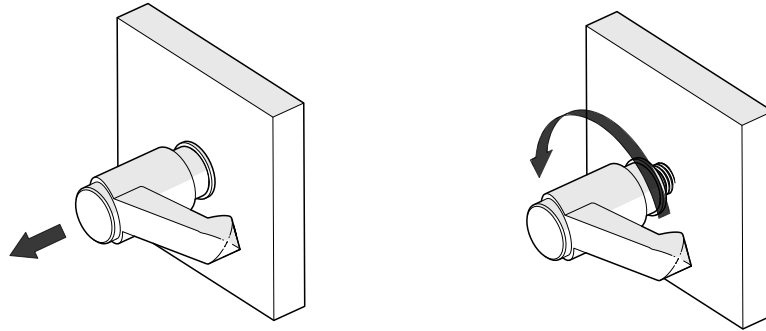
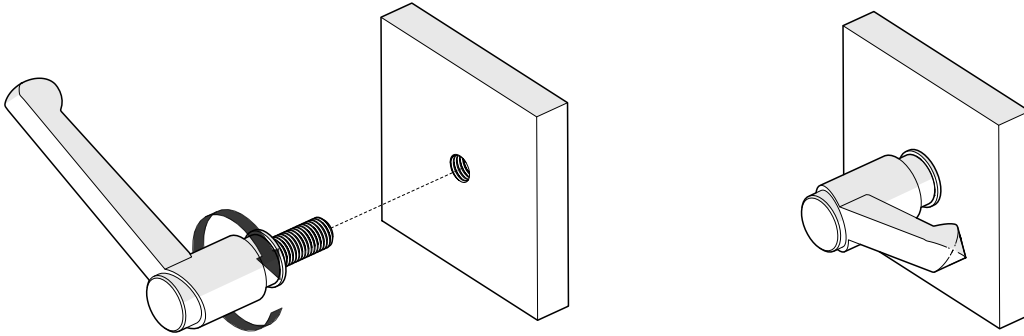

NOTE

NS-M8 & NS-M6

It is strongly advised that spring T-Nuts are inserted by sliding from the ends of profiles. Please take careful note of each step of all T-nuts as some are to be installed in anticipation of future steps.

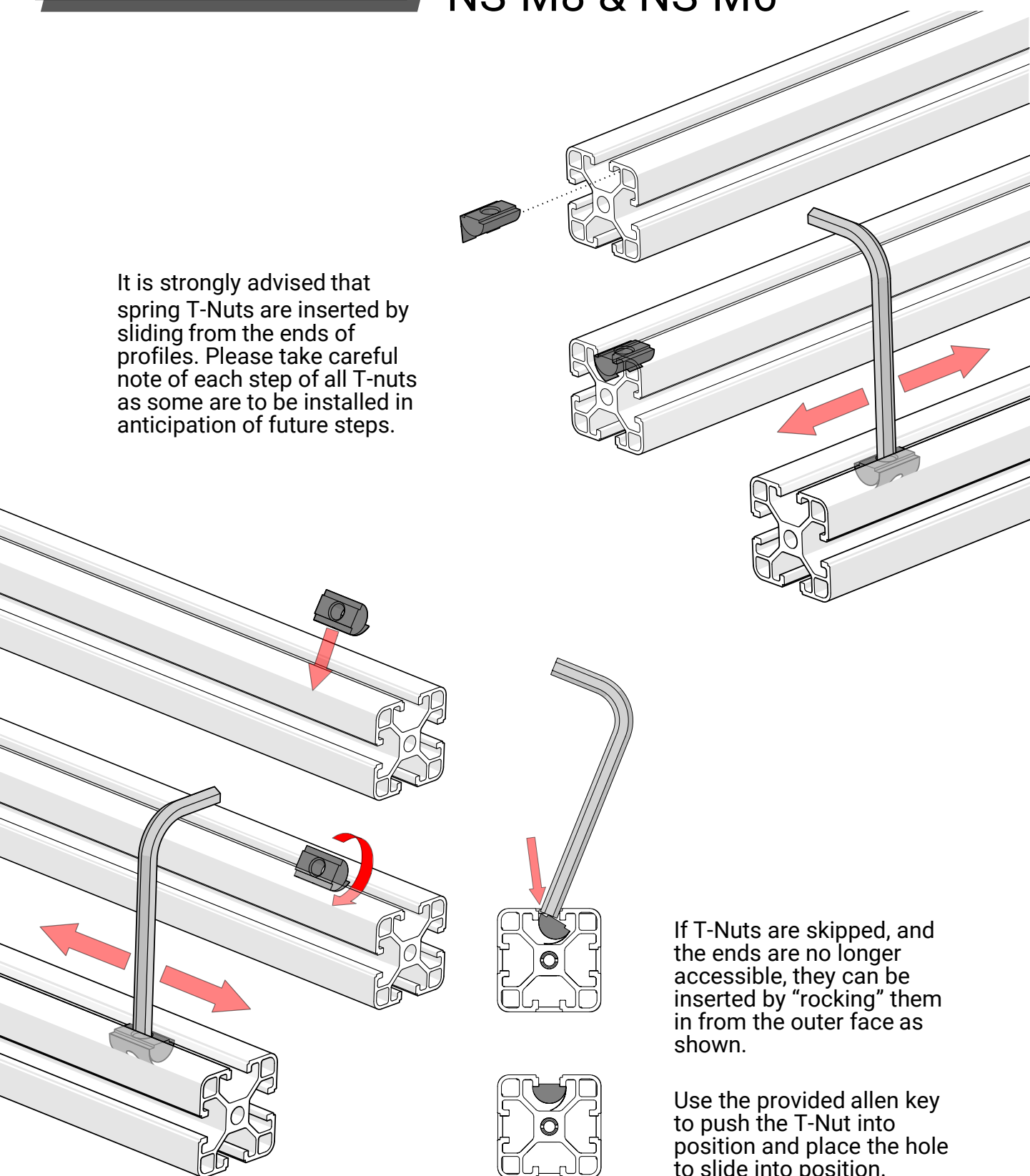

If T-Nuts are skipped, and the ends are no longer accessible, they can be inserted by "rocking" them in from the outer face as shown.

Use the provided allen key to push the T-Nut into position and place the hole to slide into position.

NOTE

BC-40

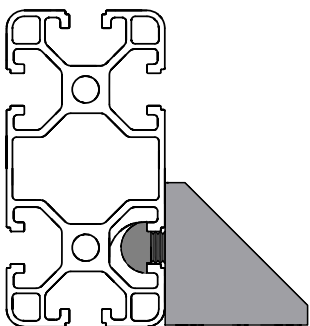
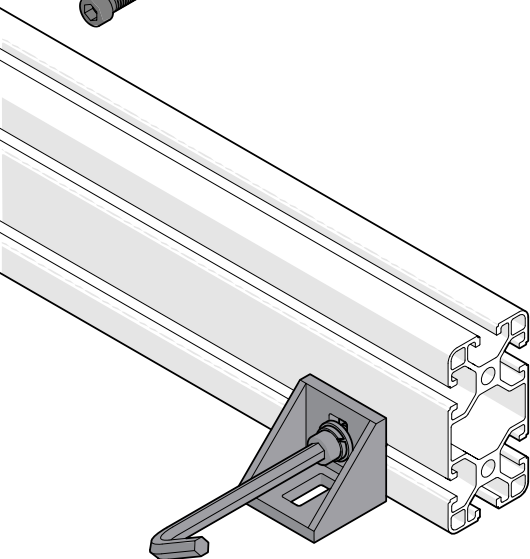
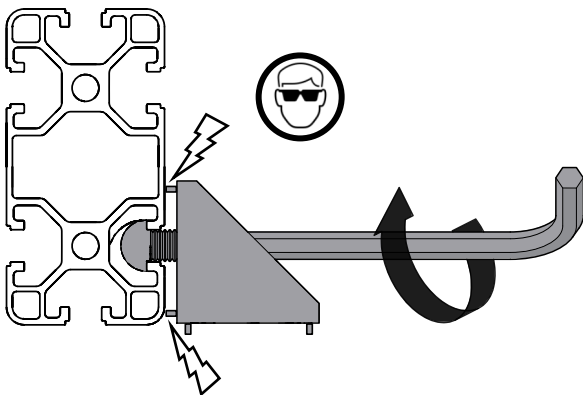
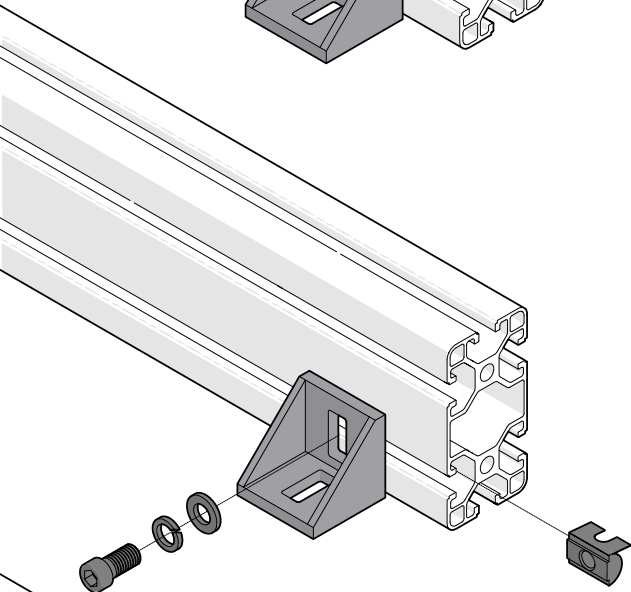
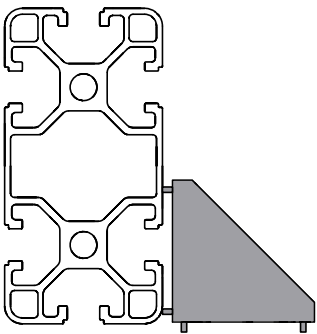
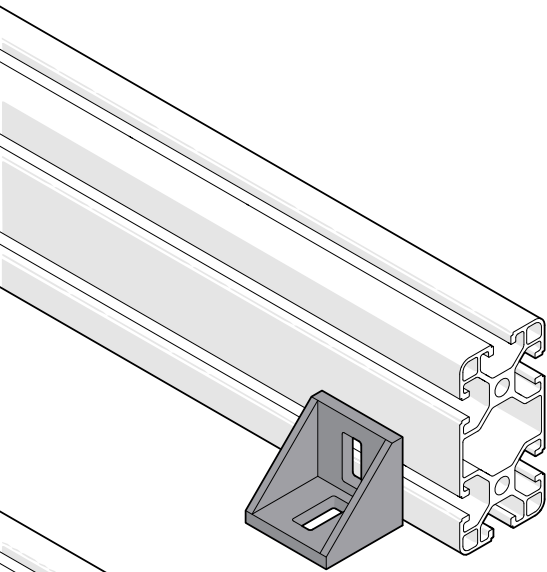

1

a

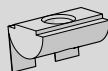

NS-M8 x4



SH-M8-20 x4



WL-M8 x4



WF-M8 x4



BC-40 x4

NOTE: Shown with TRIPLE monitor stand.

MS-FM-SIN-TR
MS-CM-SIN-TR

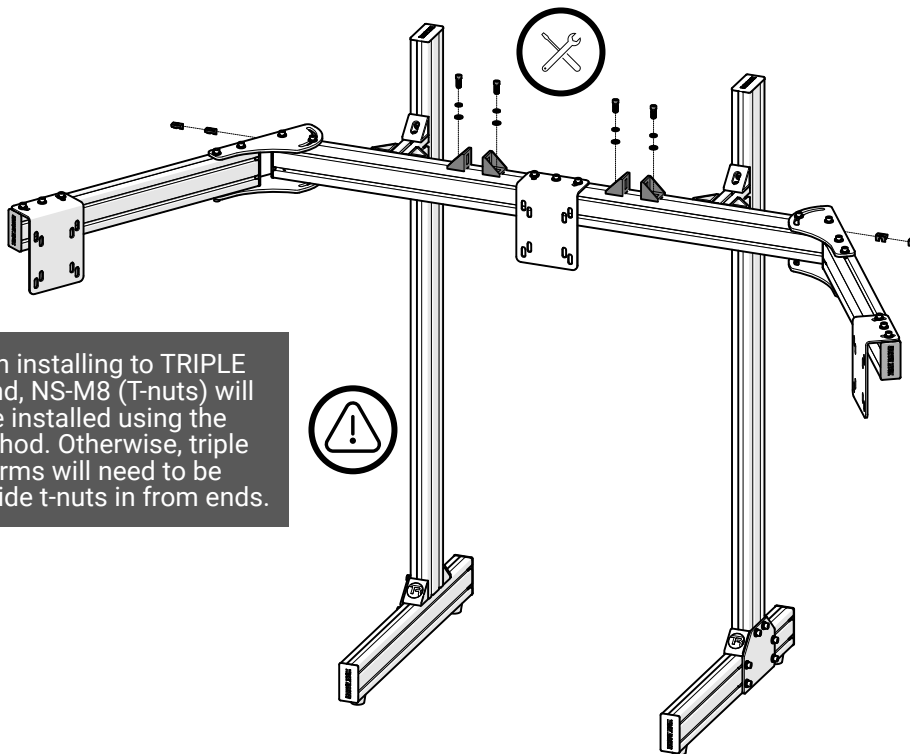

NOTE: When installing to TRIPLE monitor stand, NS-M8 (T-nuts) will need to be installed using the rocking method. Otherwise, triple monitor arms will need to be removed to slide t-nuts in from ends.

2

a

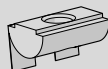

NS-M8 x4



SH-M8-20 x4



WL-M8 x4



WF-M8 x4



BC-40 x4

NOTE: Shown with SINGLE monitor stand.

MS-FM-SIN-TR
MS-CM-SIN-TR

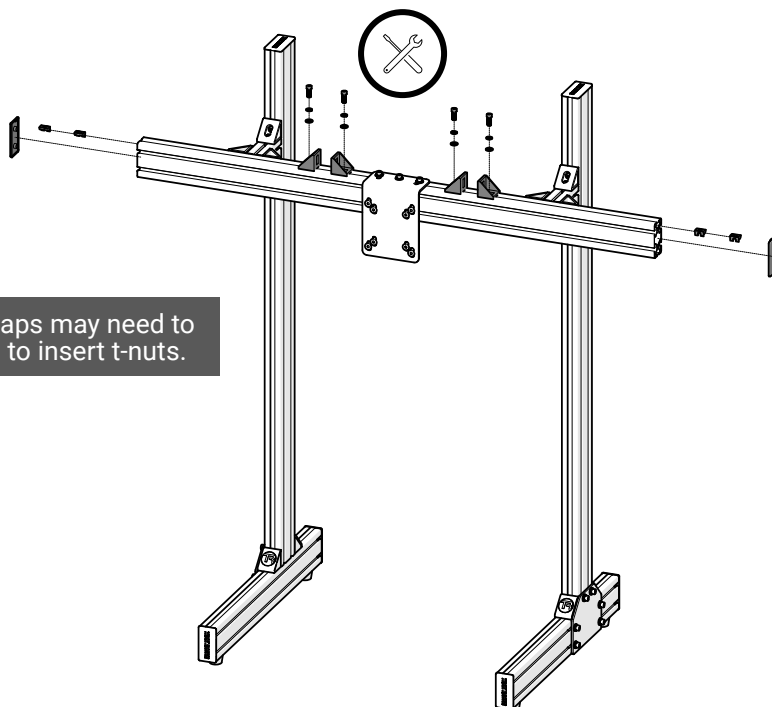

NOTE: End caps may need to be removed to insert t-nuts.

3



AL-40-500 x2

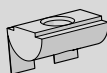

NS-M8 x4



SH-M8-20 x4



WL-M8 x4



WF-M8 x4

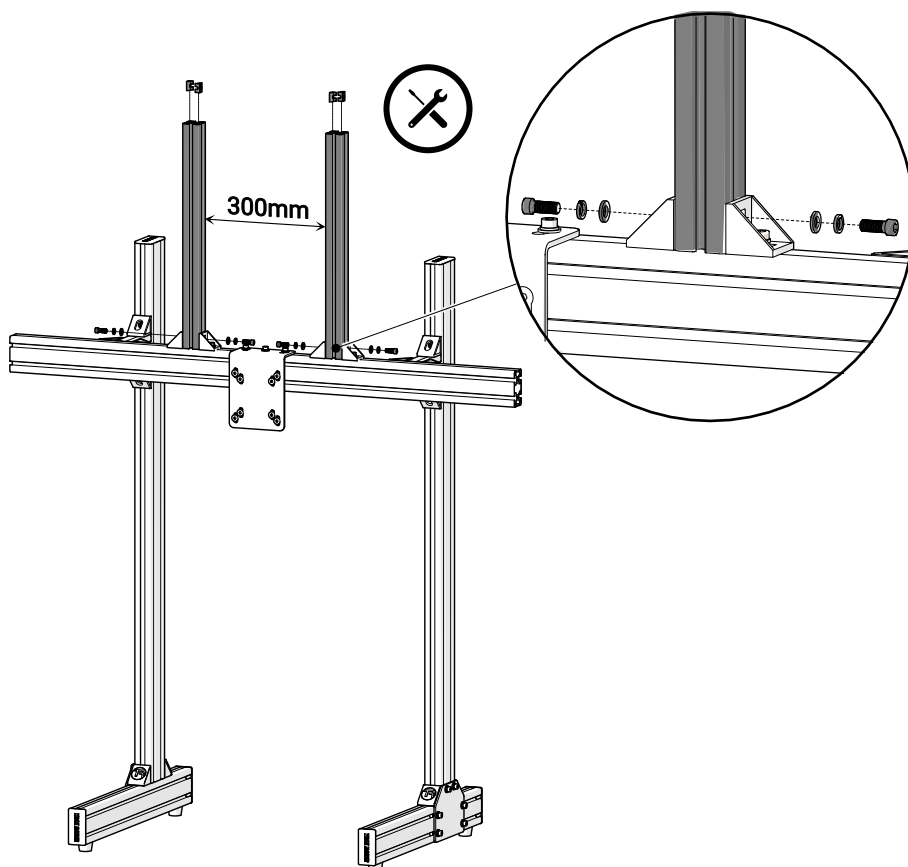

4



BT-01 x2

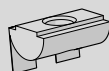

NS-M8 x8



SH-M8-16 x8



WL-M8 x8



WF-M8 x8

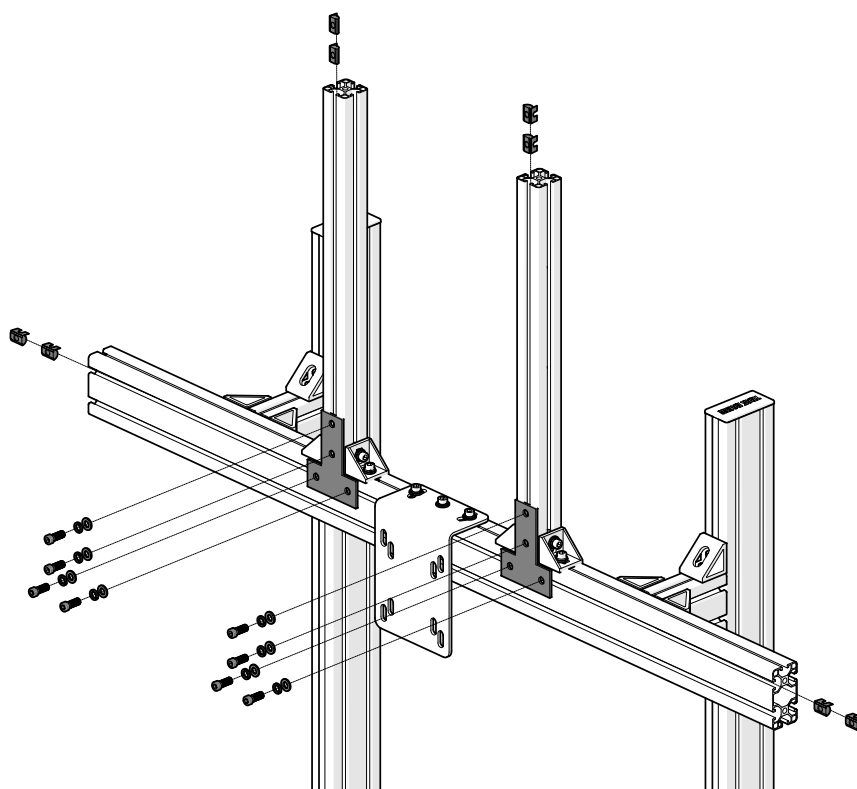

5



BM-QA x4

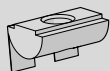

NS-M8 x4



SH-M8-20 x4



WL-M8 x4



WF-M8 x4

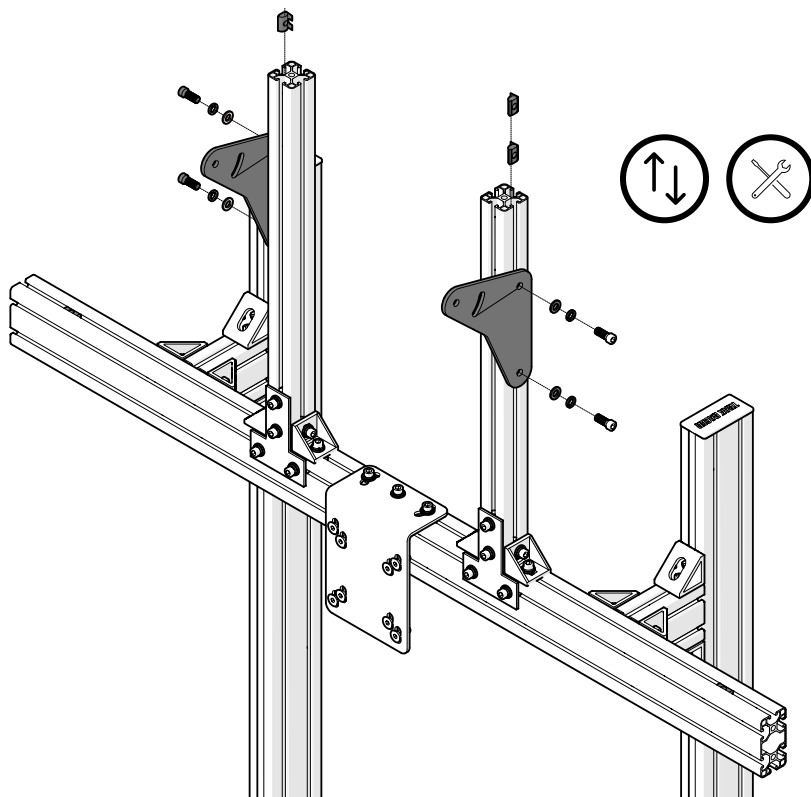

6



AL-40-400 x2

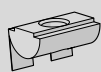

NS-M8 x4

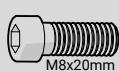

SH-M8-20 x4



WL-M8 x4







WF-M8 x4

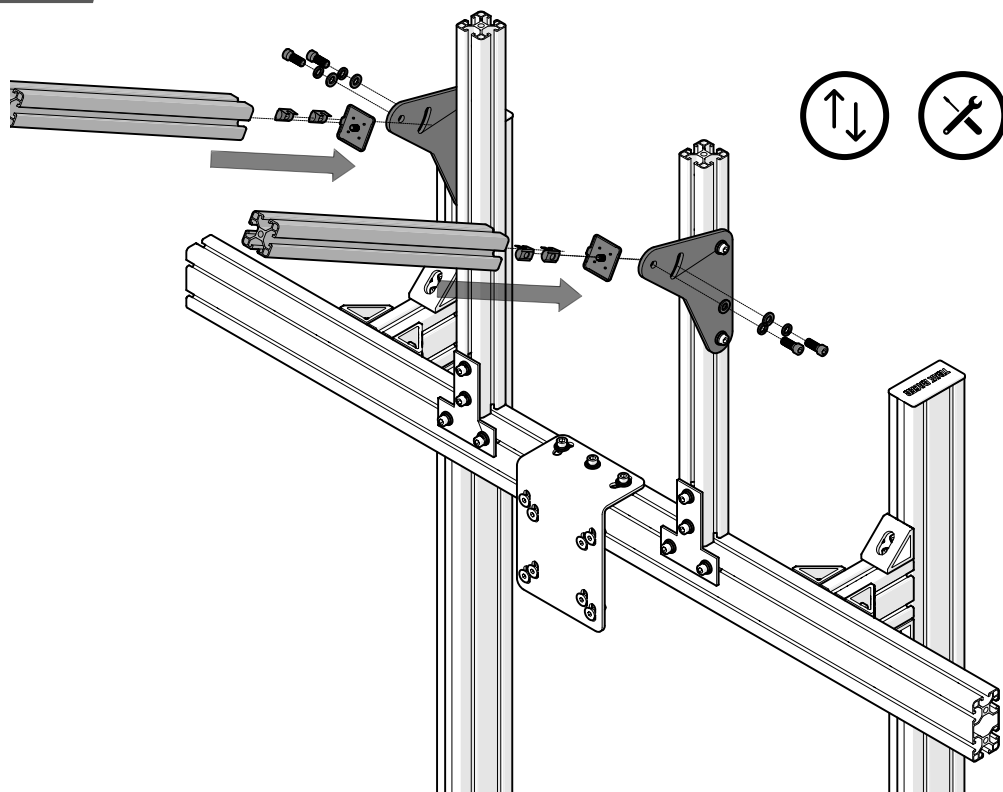

EC-40 x2

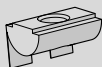
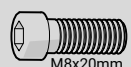

7

 AL-40-300 **x1**
  VM-02 **x1**
  NS-M8 **x7**
  SH-M8-20 **x3**
  WL-M8 **x3**
  WF-M8 **x3**

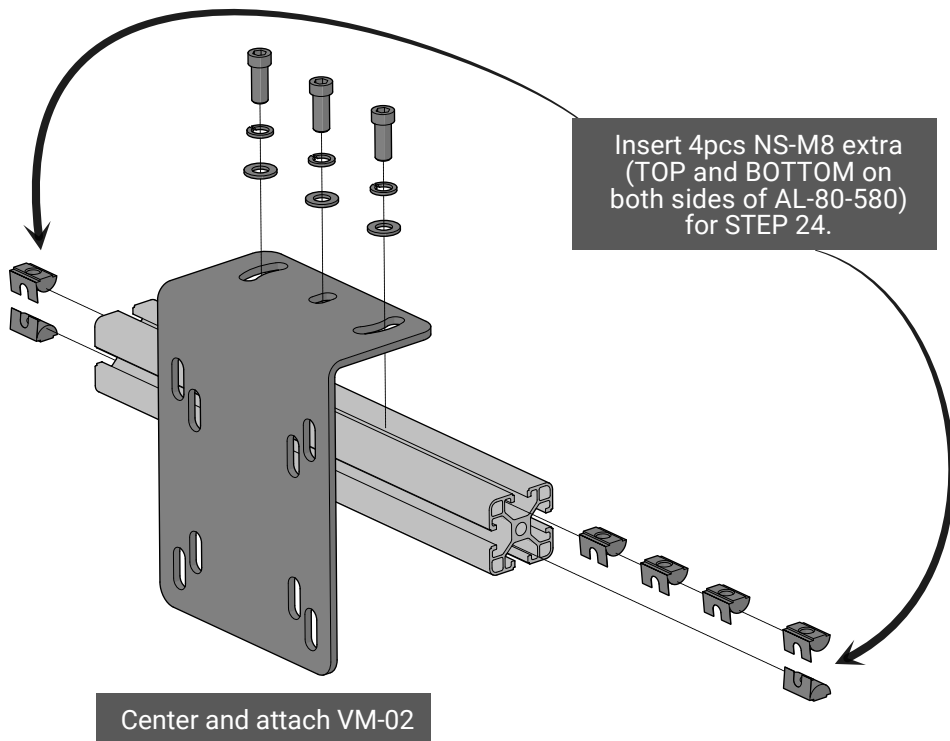

8

 NS-M8 **x4**
  SH-M8-20 **x8**
  WL-M8 **x8**
  WF-M8 **x8**
  BC-40 **x4**

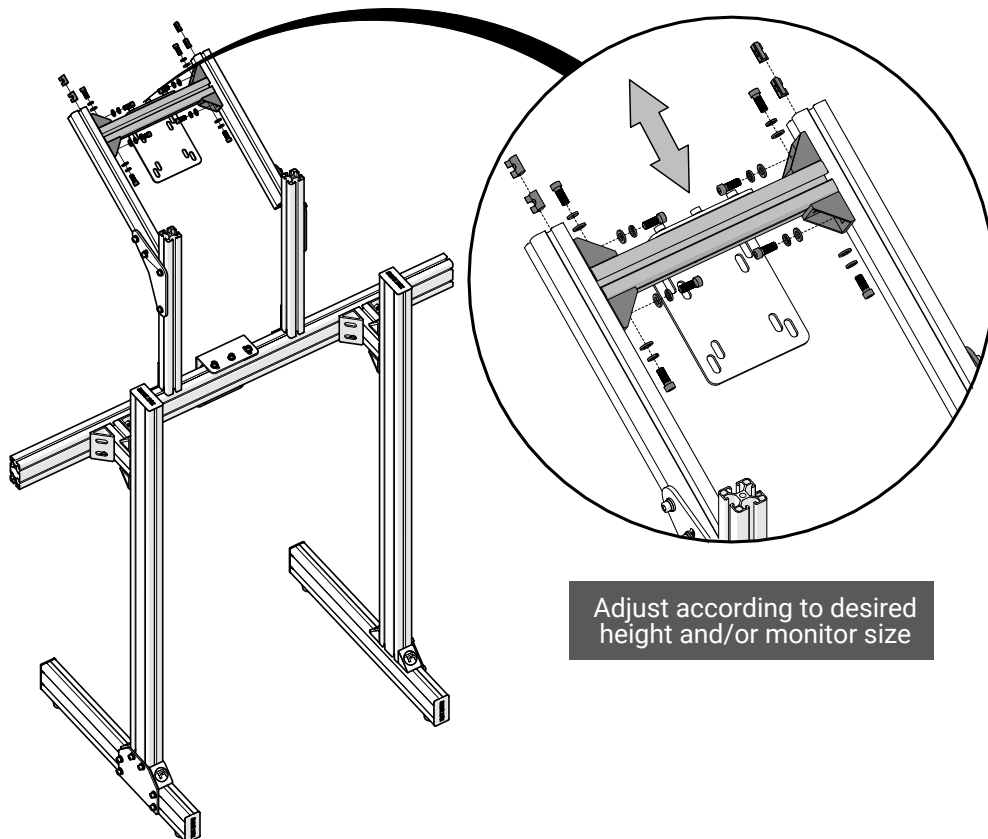

9

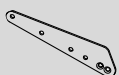

VM-02-A x2

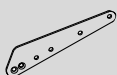

VM-02-B x2

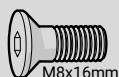

SF-M8-16 x8



NF-M8 x8

NOTE: Optional for larger monitors.

If monitor mounting points are 150mm or 200mm apart, add VESA extensions (VM-02-E)

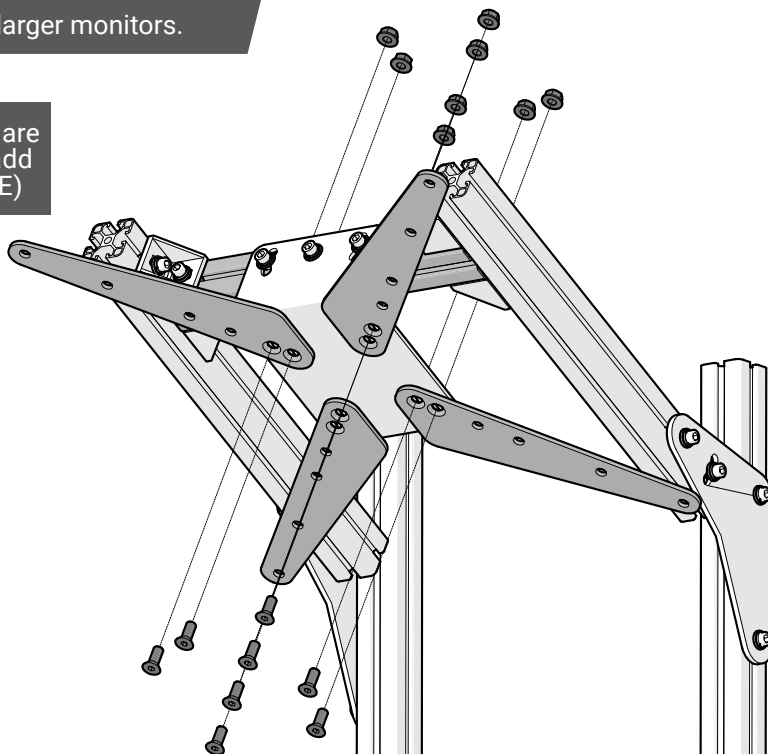

10



EC-40 x4



BC-40 x8

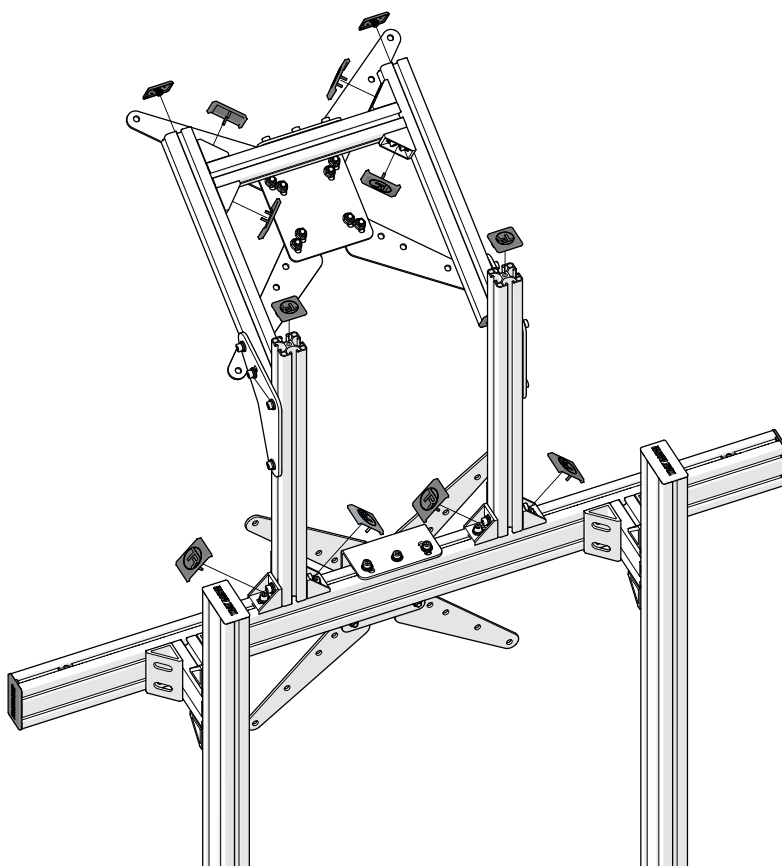

FINISHED



Share your build online and tag us to be featured!



@trakracer



@trakracer



@trak_racer