

# Shifter Option

## Assembly Guide

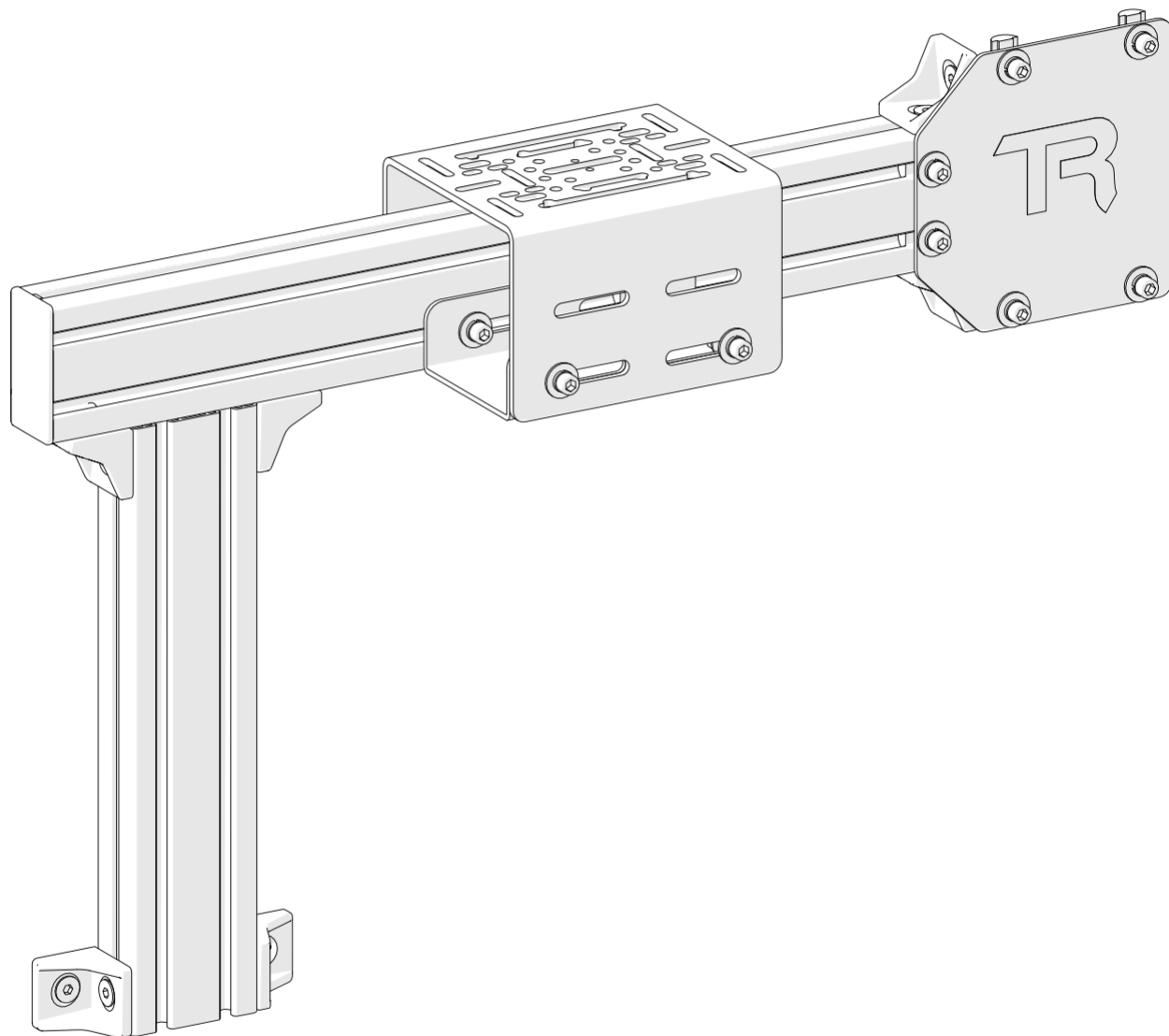

**IMPORTANT:** Different regions may have different models. Please ensure the part number below matches that on your product's box.

# TR80-SMEX4



**TRAK RACER**

Published Apr 15, 2025

# TABLE OF CONTENTS

3 Symbol Legend

---

4 Part List

---

5 Assembly Notes

---

8 Assembly Instructions



**IMPORTANT:** Since there are different versions of each product based on your region, please make sure you are using the correct set of instructions. The part number below should match the one on your box.



**IMPORTANT:** Due to the nature of cut aluminum profiles, some metal shavings may remain despite our thorough QA cleaning process. We recommend opening boxes and packaging on a hard surface.



**NOTE:** Some screws and washers may be pre-installed. These are included in the parts list and will need to be loosened and reattached according to the instructions.



Recommended: Two people for the task



Tighten the hardware



Keep the hardware loose for adjustments



Make the necessary adjustments



Break the tab off the corner bracket



Safety glasses required



Attention/Priority needed



Reserve for the next step



Mirrored components (same on both sides)

# PART LISTS

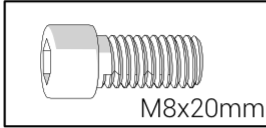

M8x20mm

M8x20 Cap Hex Screw

SH-M8-20 **x22**

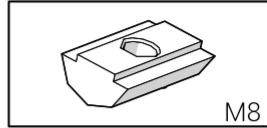

M8

M8 T-Nut

NS-M8 **x20**

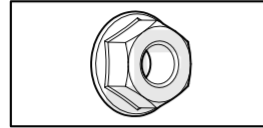

M8 Flange Nut

NF-M8 **x2**

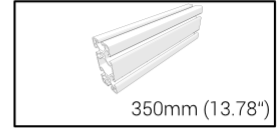

350mm (13.78")

Aluminum Profile

TR-8040-350 **x1**



580mm (22.83")

Aluminum Profile

TR-8040-580 **x1**



40x80 End Cap

EC-80 **x1**

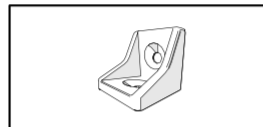

Corner Bracket

CB-40 **x5**

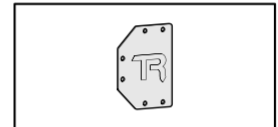

Shifter Side Plate

BP-80-H **x1**



M8x20mm

M8x20 Washer (Flat)

WF-M8-20 **x22**

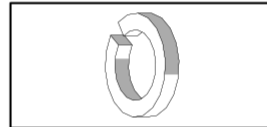

M8 Lock Washer

WL-M8 **x22**

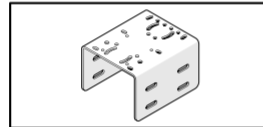

Shifter Plate

SM-01 **x1**

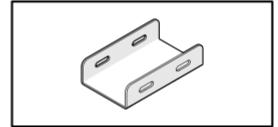

Shifter Support Plate

SM-02 **x1**

\* **NOTE:** Extra hardware may be included as spare parts

# NOTE

## INSTALLATION ORDER FOR SCREWS & WASHERS

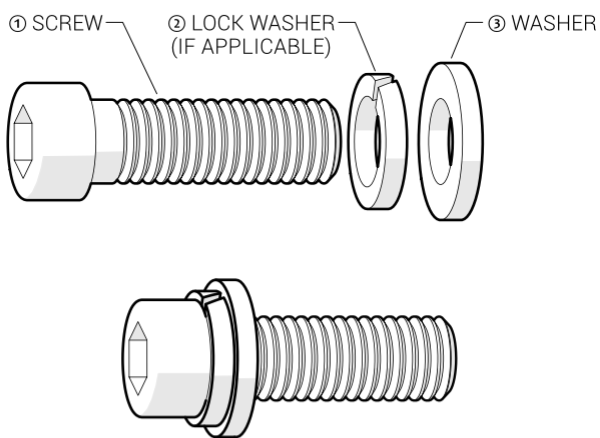

## HOW TO MEASURE SCREWS

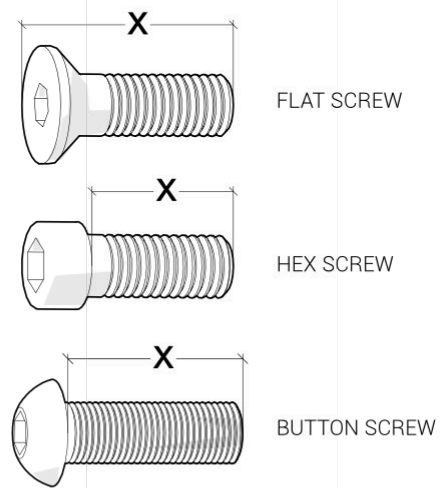

# NOTE

## BC-40 & CB-40

These brackets come with guide tabs on the rear. These tabs help align the brackets to the profile when fitted in the same orientation as the profile. When used in the alternate orientation, these tabs are designed to snap off for a flush mount against the profile.

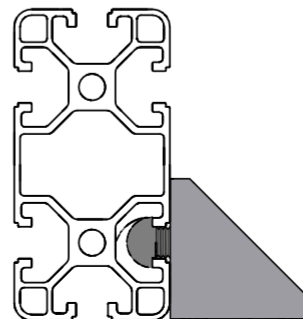
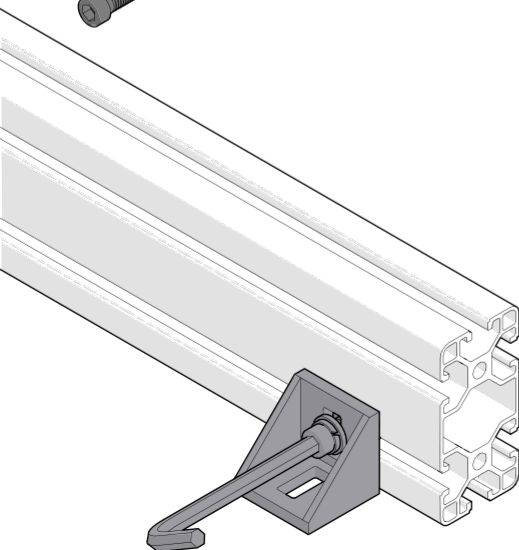
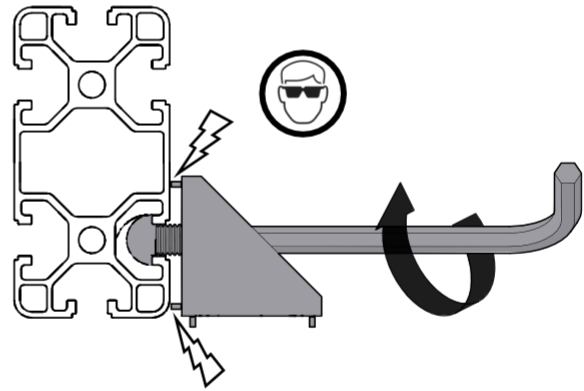
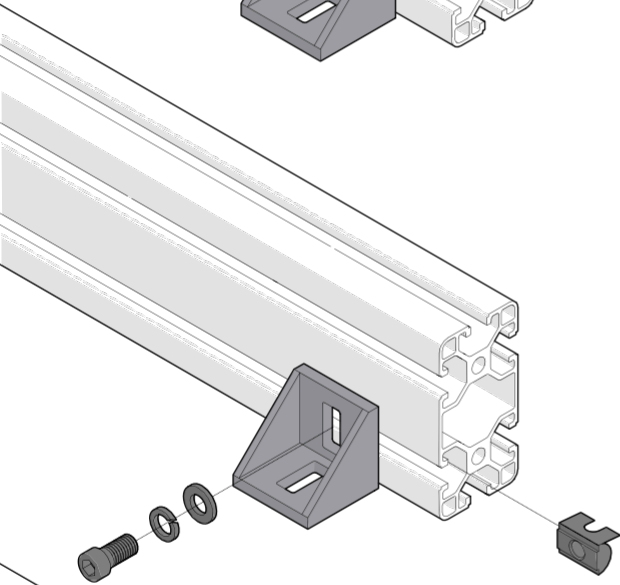
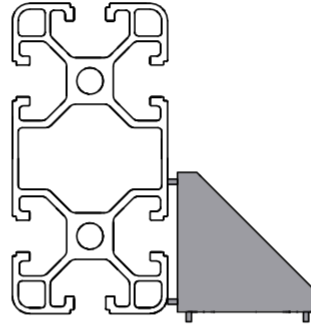
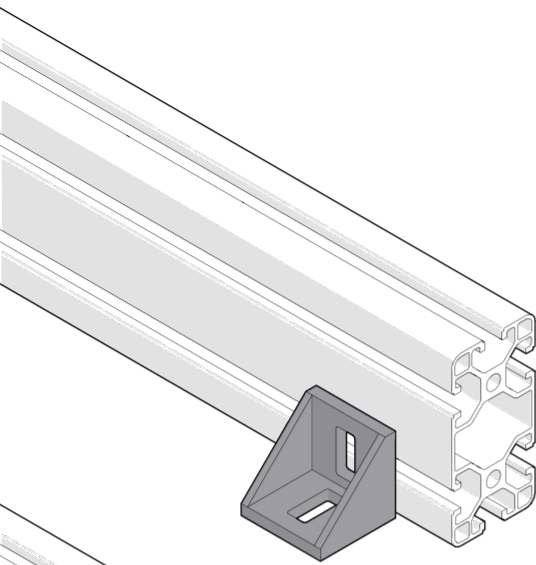

# NOTE

## NS-M8 & NS-M6

Slide T-Nuts into the ends of the profiles. Some must be added early, so follow the steps in this manual carefully.

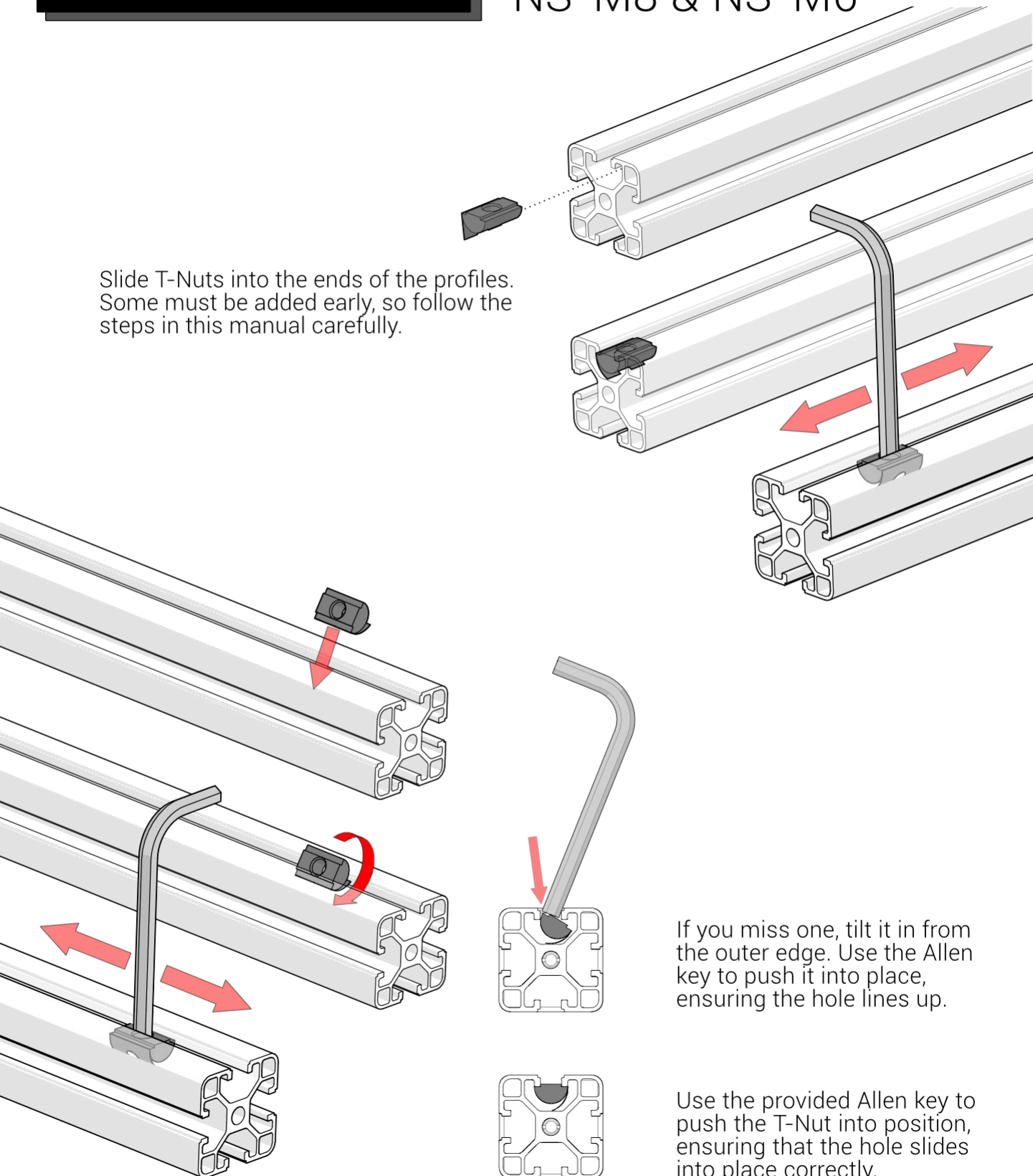

If you miss one, tilt it in from the outer edge. Use the Allen key to push it into place, ensuring the hole lines up.

Use the provided Allen key to push the T-Nut into position, ensuring that the hole slides into place correctly.

# 1

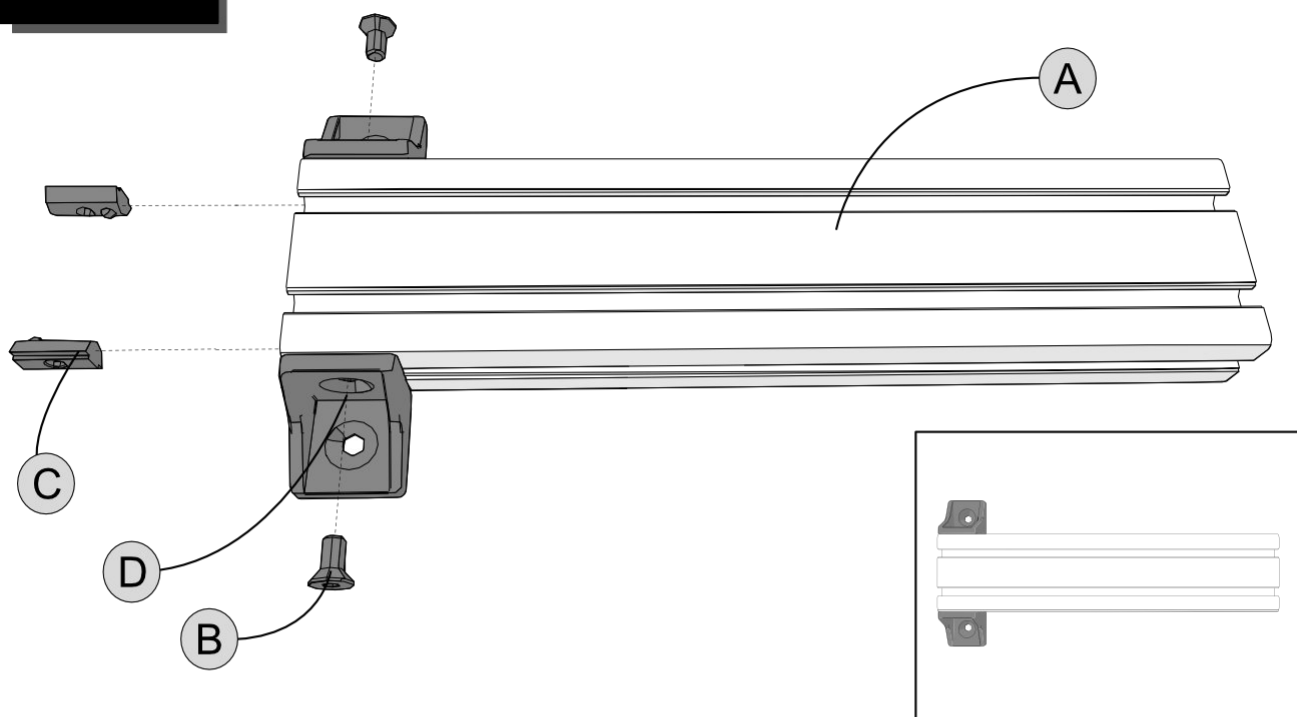
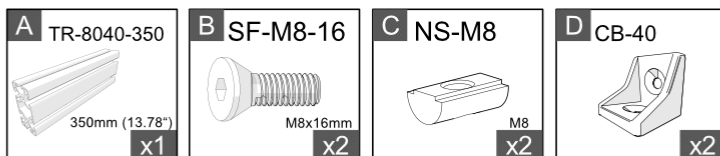

# 2

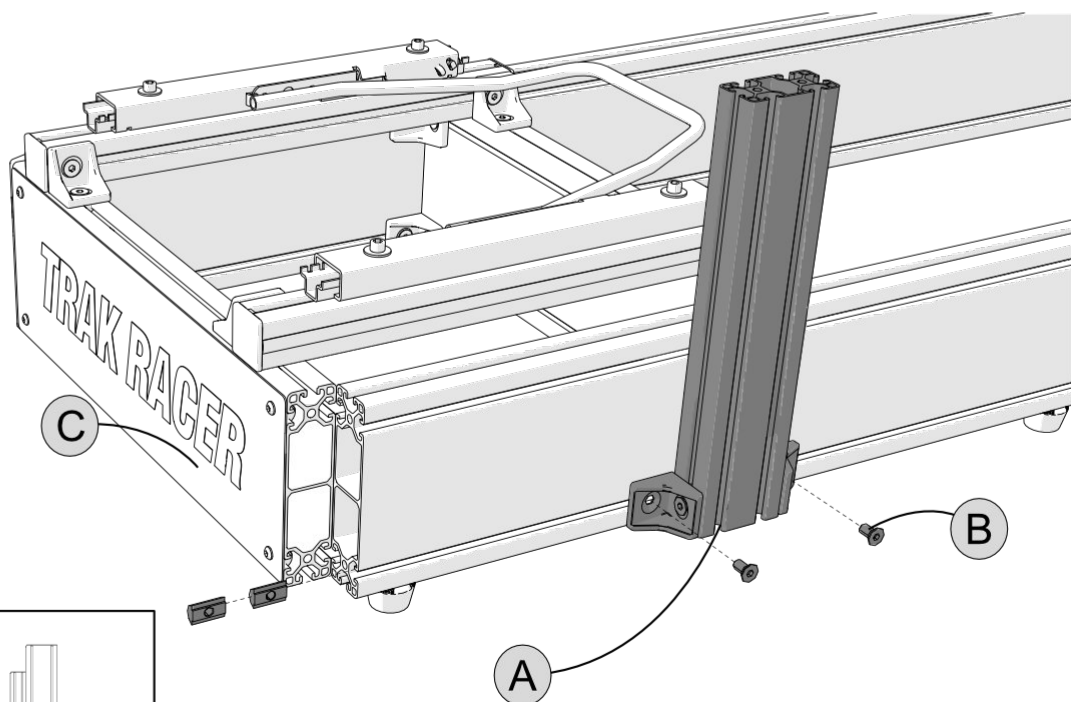
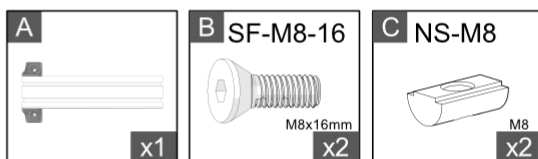



# 3

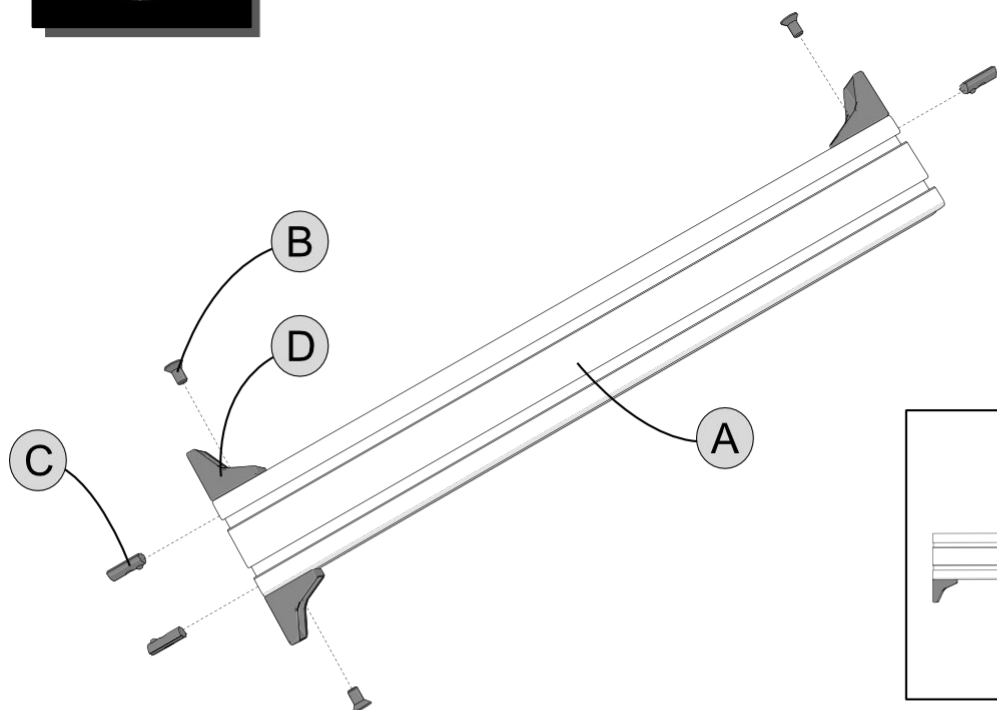
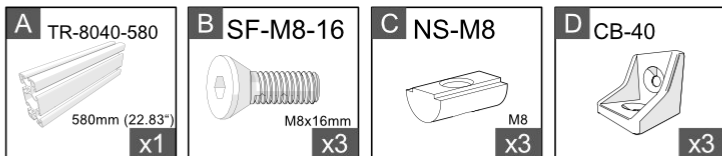

# 4

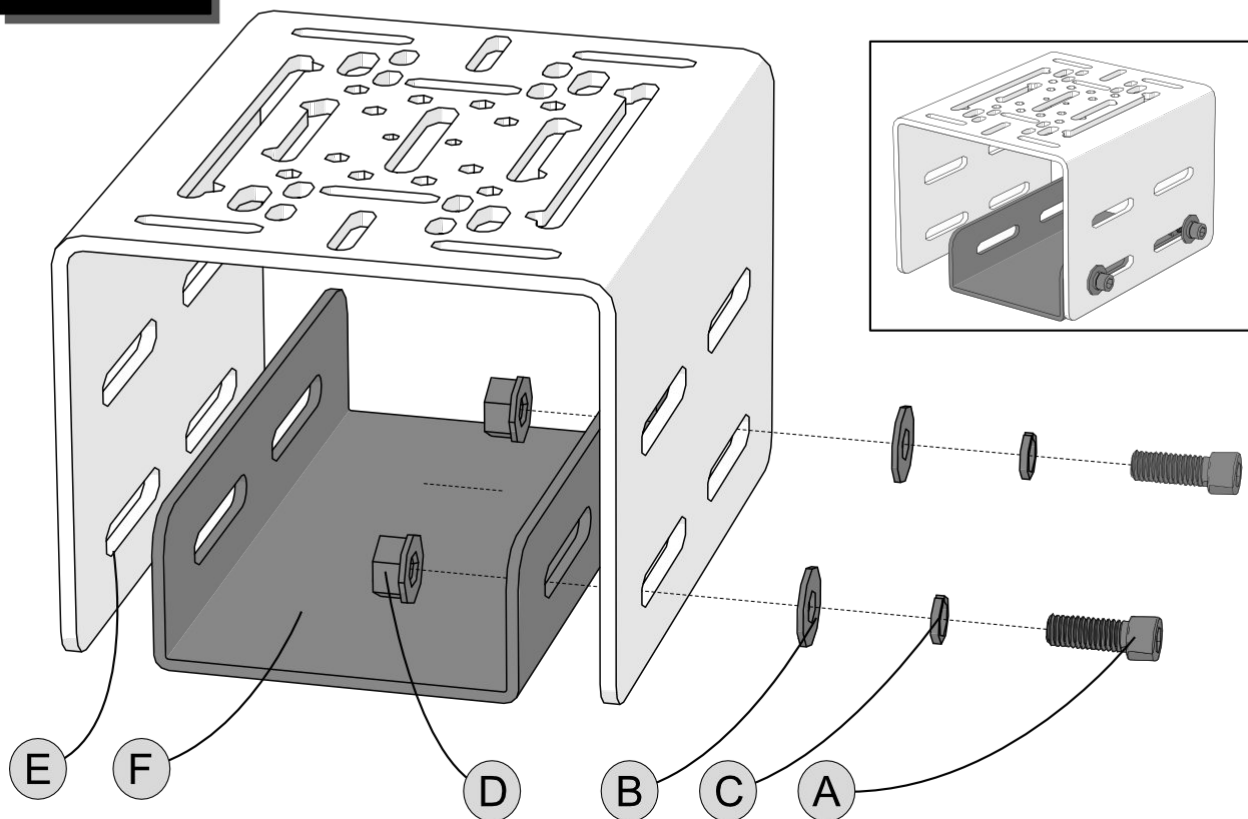
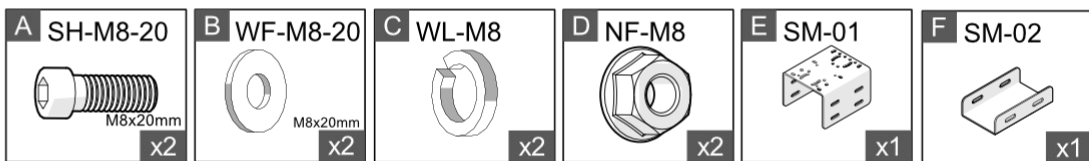

# 5

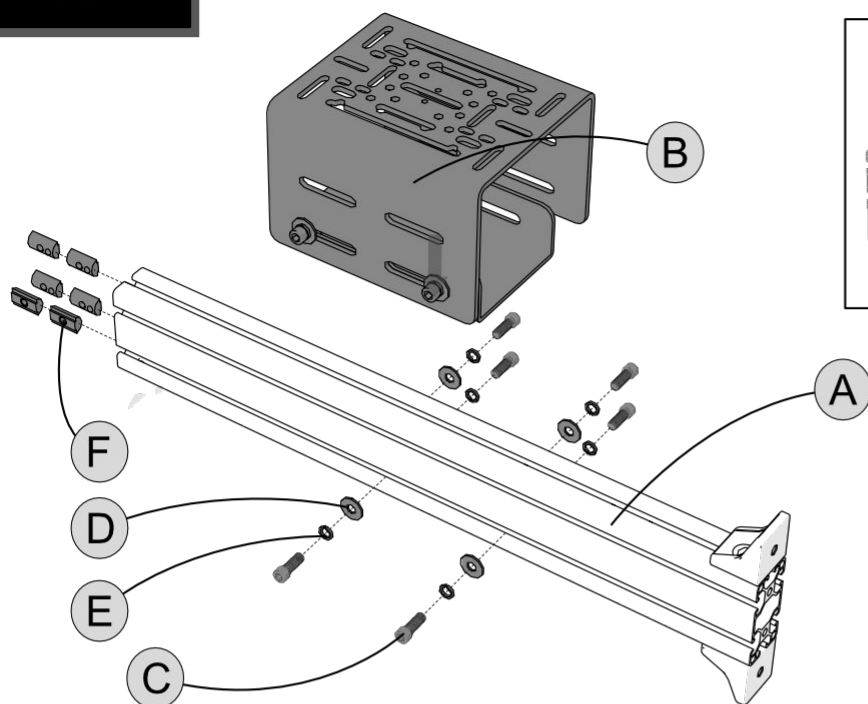
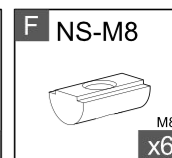
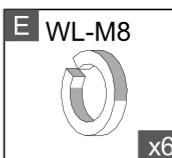
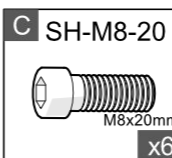
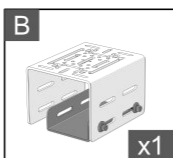
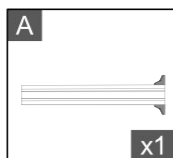

# 6

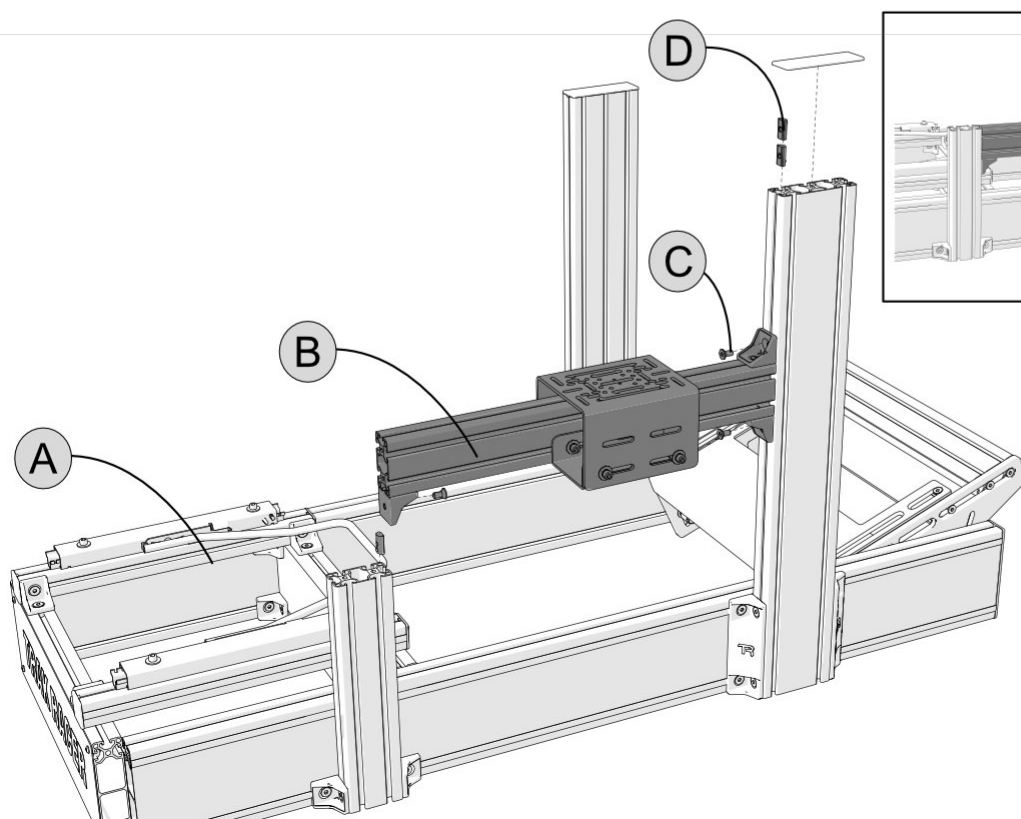
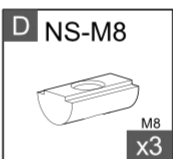
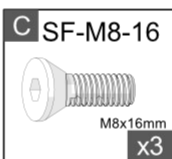
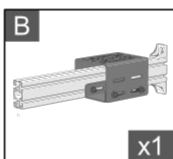
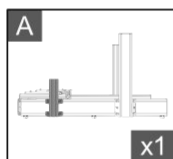

# 7

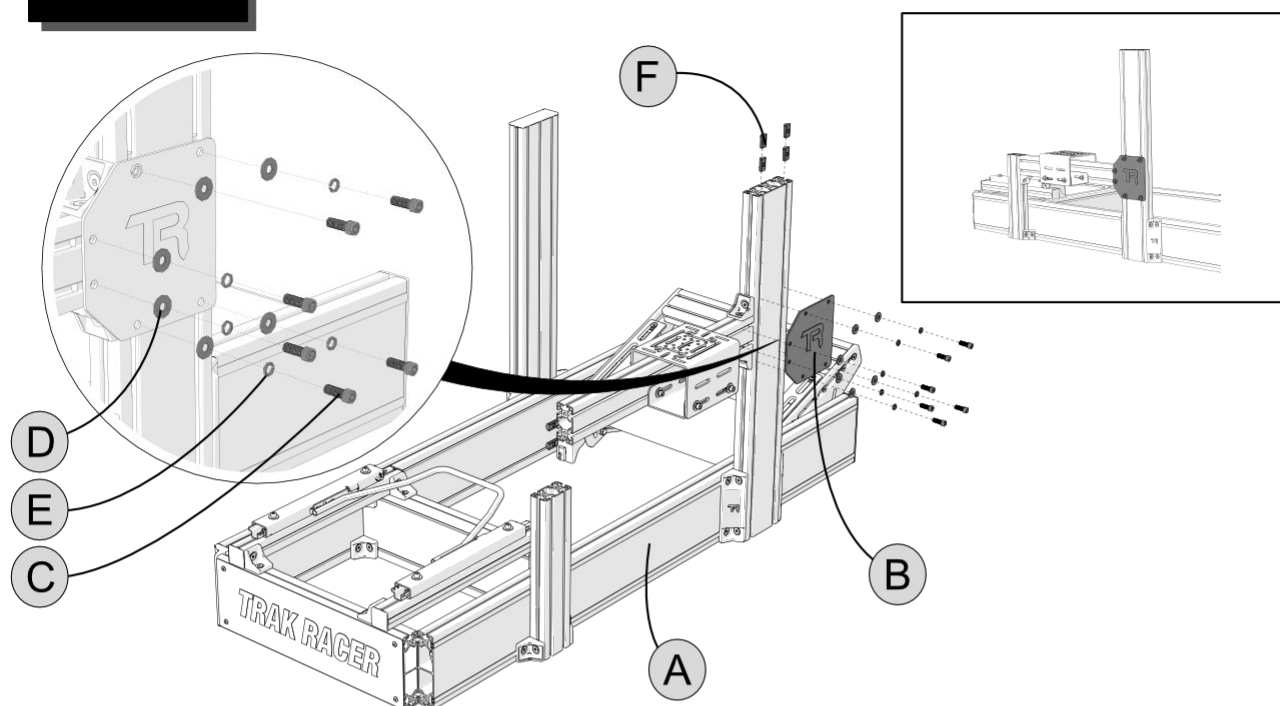
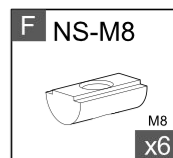
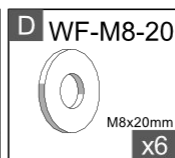
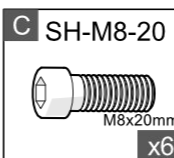
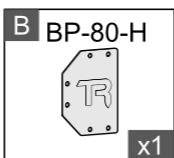
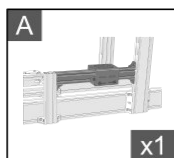

# 8

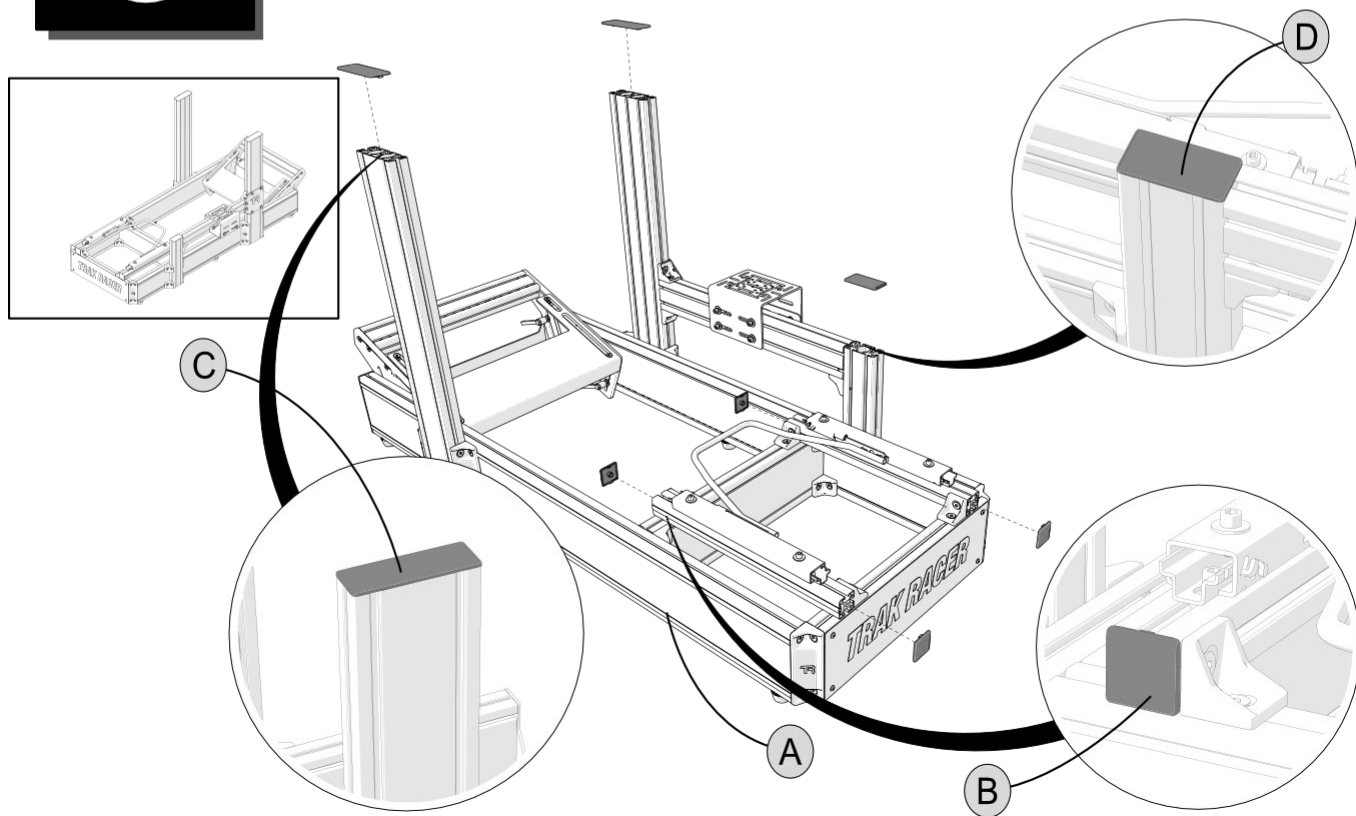
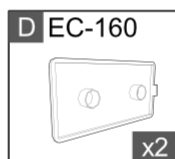
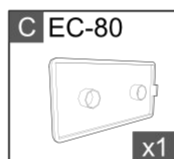
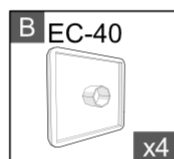
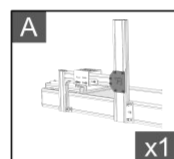

# FINISHED



**Share your build online and tag us to be featured!**



@trakracer



@trakracer



@trak\_racer