

RS6, TRX, TR8 TR40 & TR80 -MOTION

Assembly Guide

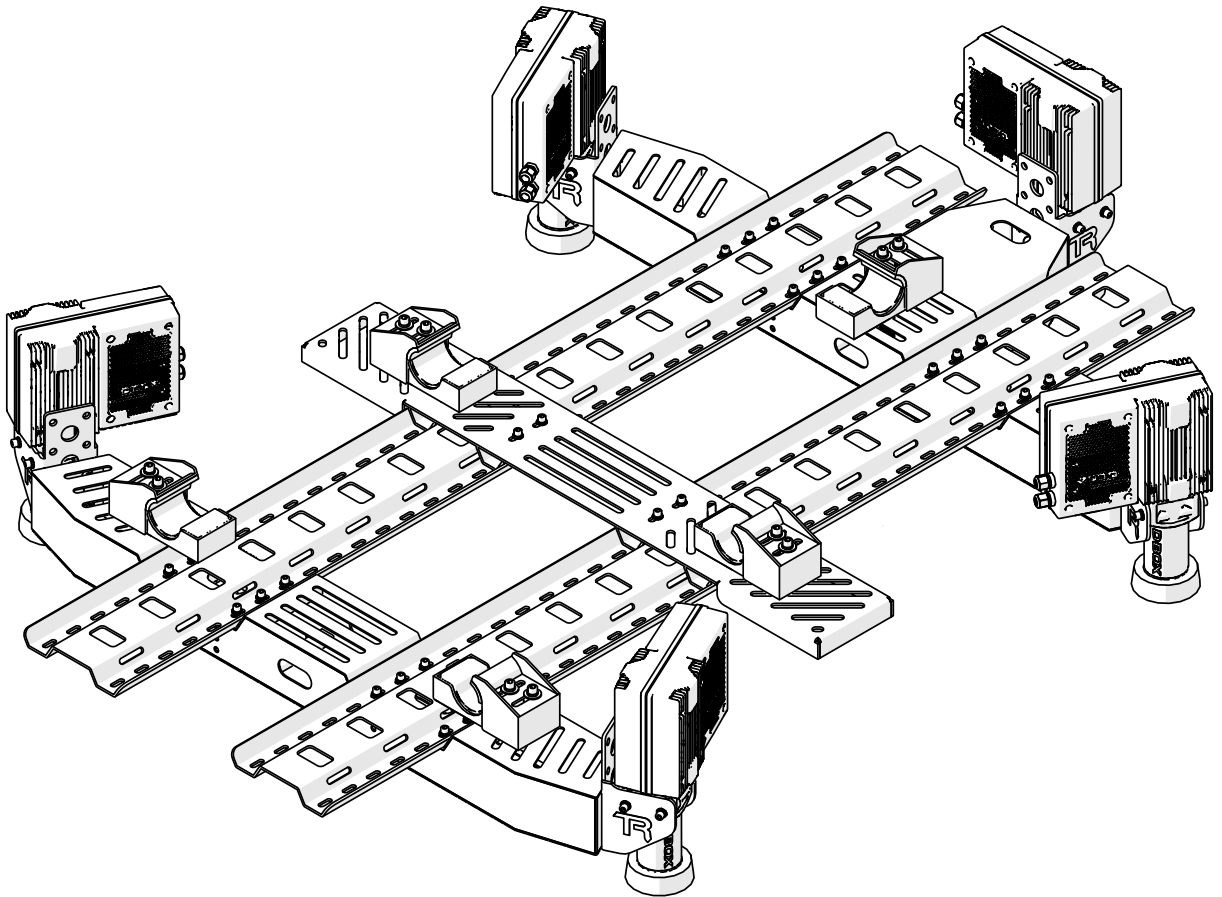

IMPORTANT: As there are different versions of each rig depending on your region, please ensure that you are using the correct instruction set. The part number below should match the part number labeled on your box

TRMOVE-TRXP



TRAK RACER

Published 2024-04-20

TABLE OF CONTENTS

3 Symbol Legend

4 Part list

8 Compatibilities and Options

9 Configurations

10 Mounting Bracket Assembly Instructions

13 Main Chassis For 4 Motion Motors

15 Main Chassis For 3 Motion Motors

18 Main Chassis For 2 Motion Motors

22 Simulator Assembly Instruction

22 RS6 Simulator

27 TRX Simulator

31 TR8 Simulator

36 TR80 Simulator

39 TR40 Simulator



IMPORTANT: As there are different versions of each rig depending on your region, please ensure that you are using the correct instruction set. The part number below should match the part number labeled on your box



IMPORTANT: Due to the nature of cut aluminium profile, some metal shavings may still be present after our extensive QA cleaning process. We recommend that boxes and packaging is opened on a hard floor.



NOTE: Some screws and washers are pre-installed. These will be part of the parts list and will need to be loosened and reattached according to the instructions.



Two people needed



Tighten hardware



Leave hardware loose for adjustment

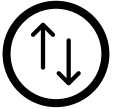

Make Adjustment



Break tab off Corner bracket CB1



Safety glasses needed



Attention / Priority



Reserve for following step



Mirrored Components (Same on both sides)

PART LISTS

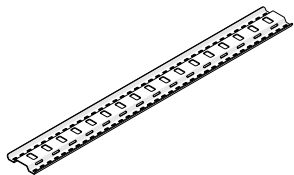

Main A x2

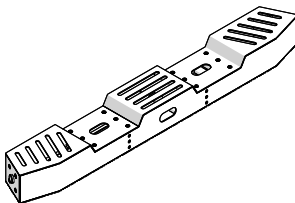

Main B x2

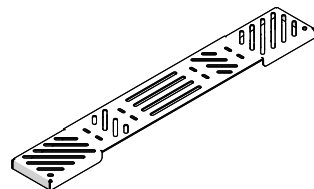

Main C x1

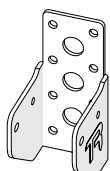

Motor Bracket x4

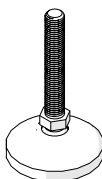

Ball Joint x1

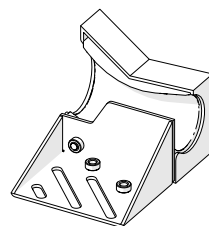

Bracket B1 x2

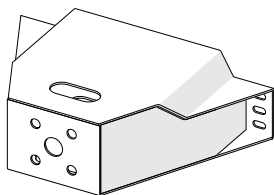

Third Motor Frame x1
(Optional)

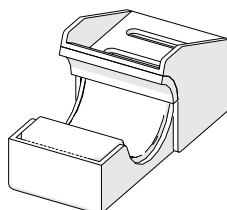

Bracket A1 x3

PART LISTS



NOTE: Some screws and washers are pre-installed. These will be part of the parts list and will need to be loosened and reattached according to the instructions.

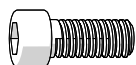

M6-16 x40
Screw (Hex), M8x16mm

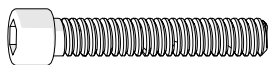

M6-35 x8
Screw (Hex), M8x16mm

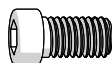

M8-12 x8
Screw (Hex), M8x12mm

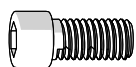

M8-16 x7
Screw (Hex), M8x16mm

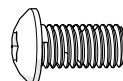

M8-15 x16
Screw (Round), M8x15mm

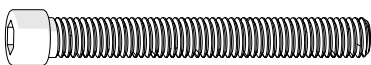

M8-65 x12
Screw (Hex), M8x65mm

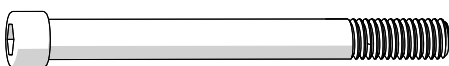

M8-80 x4
Screw (Hex), M8x80mm

INCLUDED TOOLS

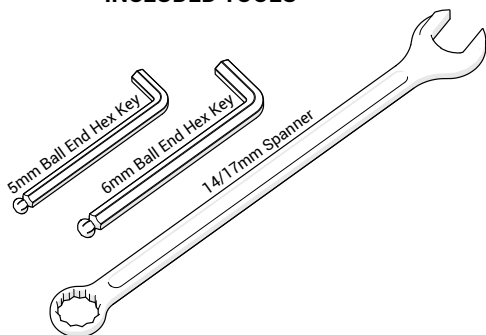

INSTALLATION ORDER FOR SCREWS

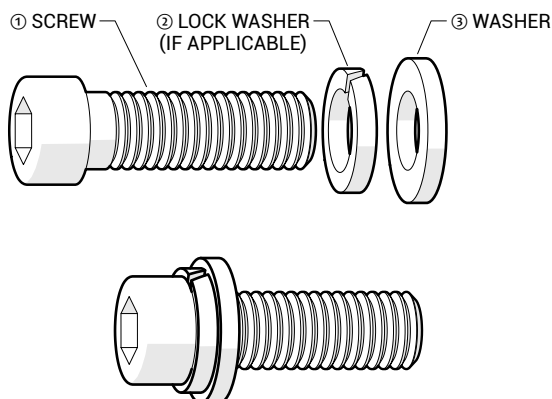

HOW TO MEASURE SCREWS

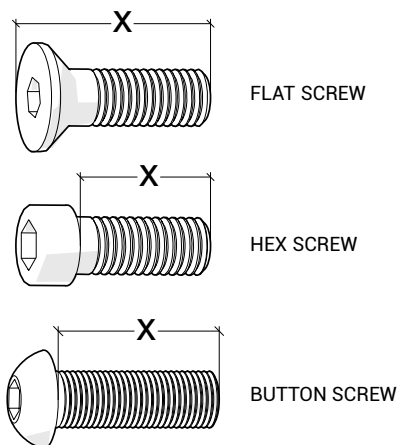

FW-M6 x6
Nut, M6



FW-M8 x8
Nut, M8



FW-M8 x16
Nut (Flange), M8



FW-M16 x1
Nut (Flange), M16

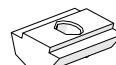

NS-M8 x16



WF-M6 x48
Washer (Lock), M6



W-M6-12 x48
Washer (FLAT), M6x12



WF-M8 x46
Washer (Lock), M8



W-M8-20 x30
Washer (FLAT), M8x20



WC-M8 x16
Washer, M8x16

PART LISTS

Trak Racer RSX Mounting Bracket

Bracket A

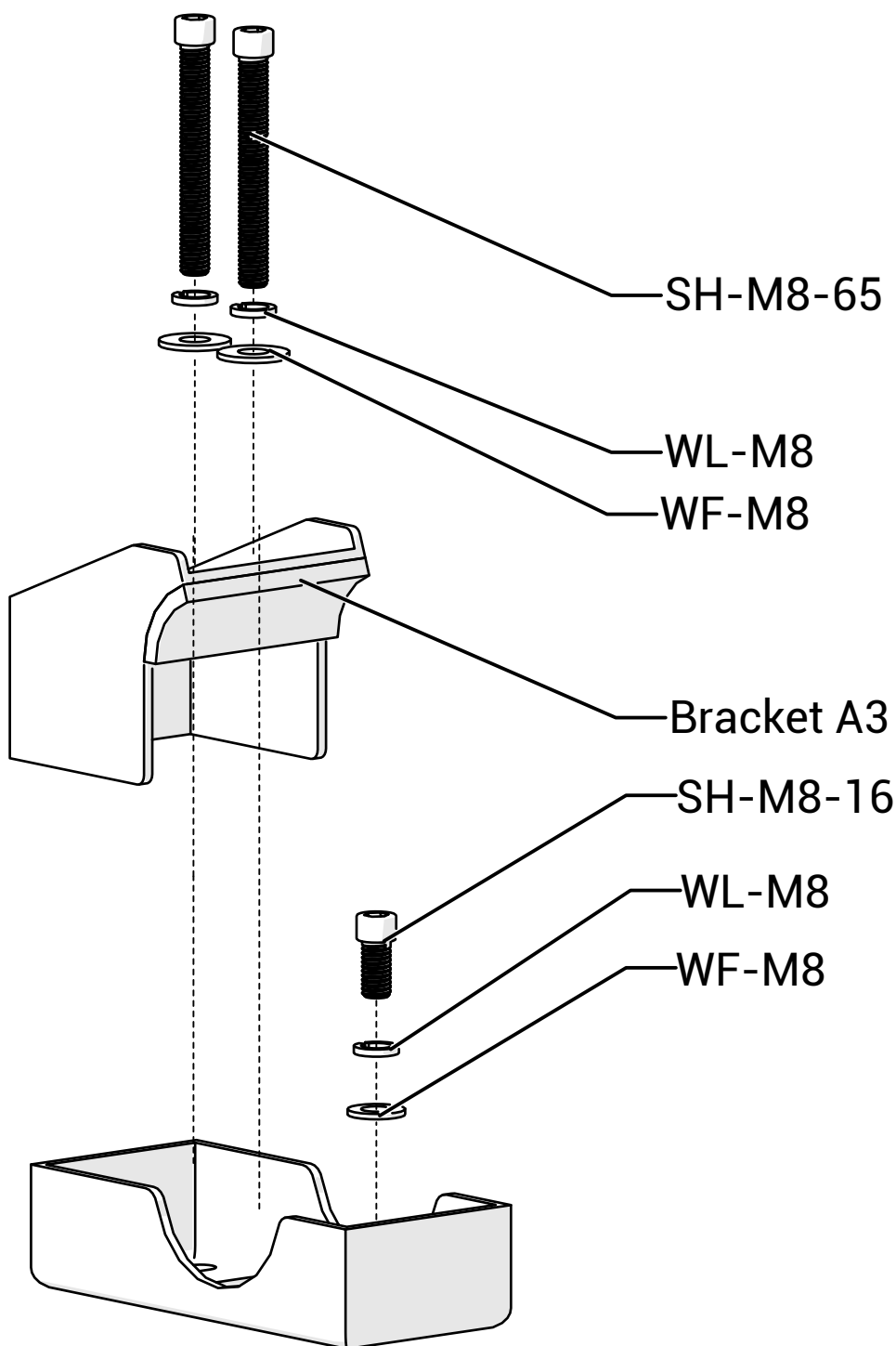

PART LISTS

Bracket B

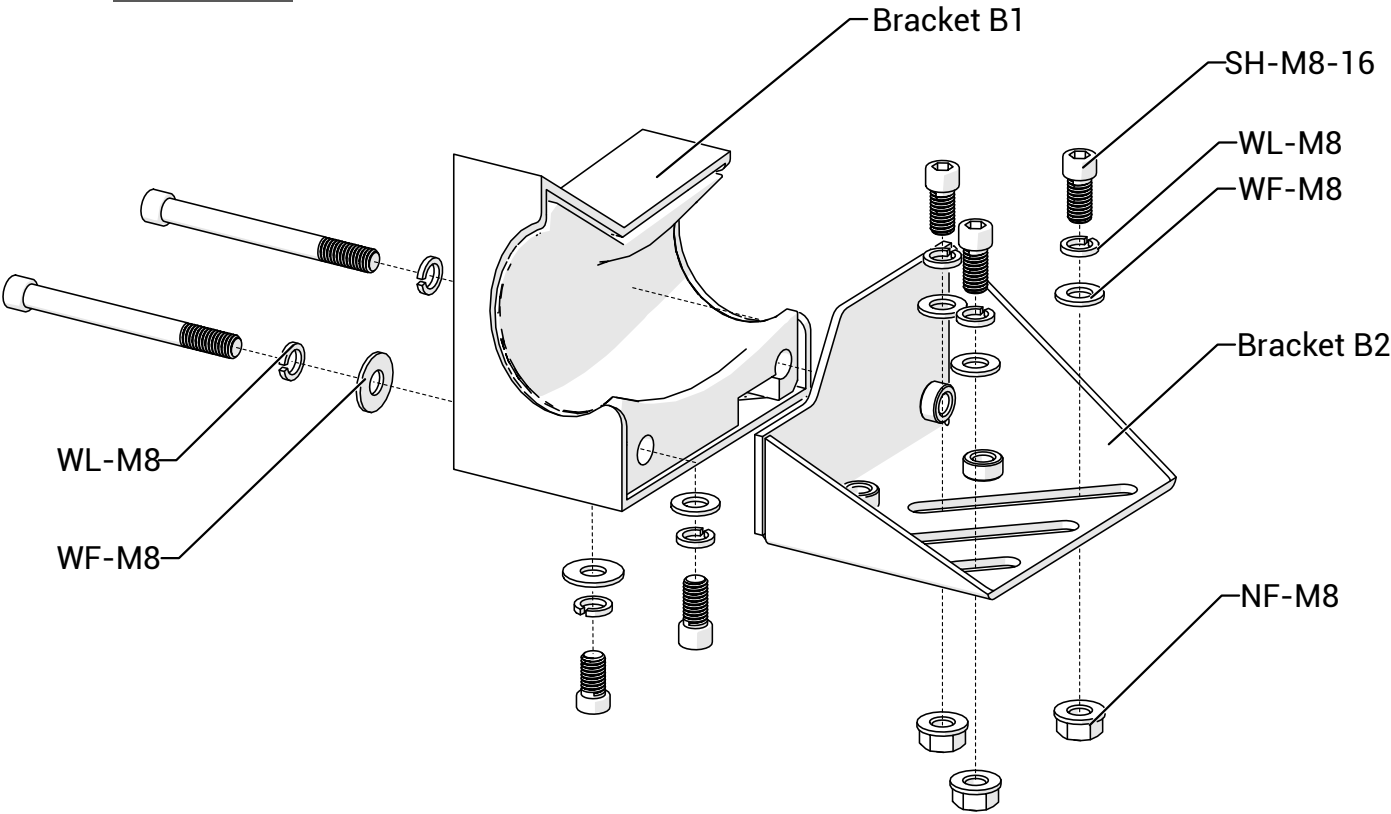

Capabilities & Options

The TR Move motion platform has been designed to fit all of Trak Racers frames including the TRX, TR8, TR8 Pro, RS6 as a large range of other brandes rigs. Please contact out support for compability questions.

Note:

For extruded aluminium framse, it's recommended that the motion Motor isi attached directly to your frame with the high-quality brackets from Trak Racer or others.

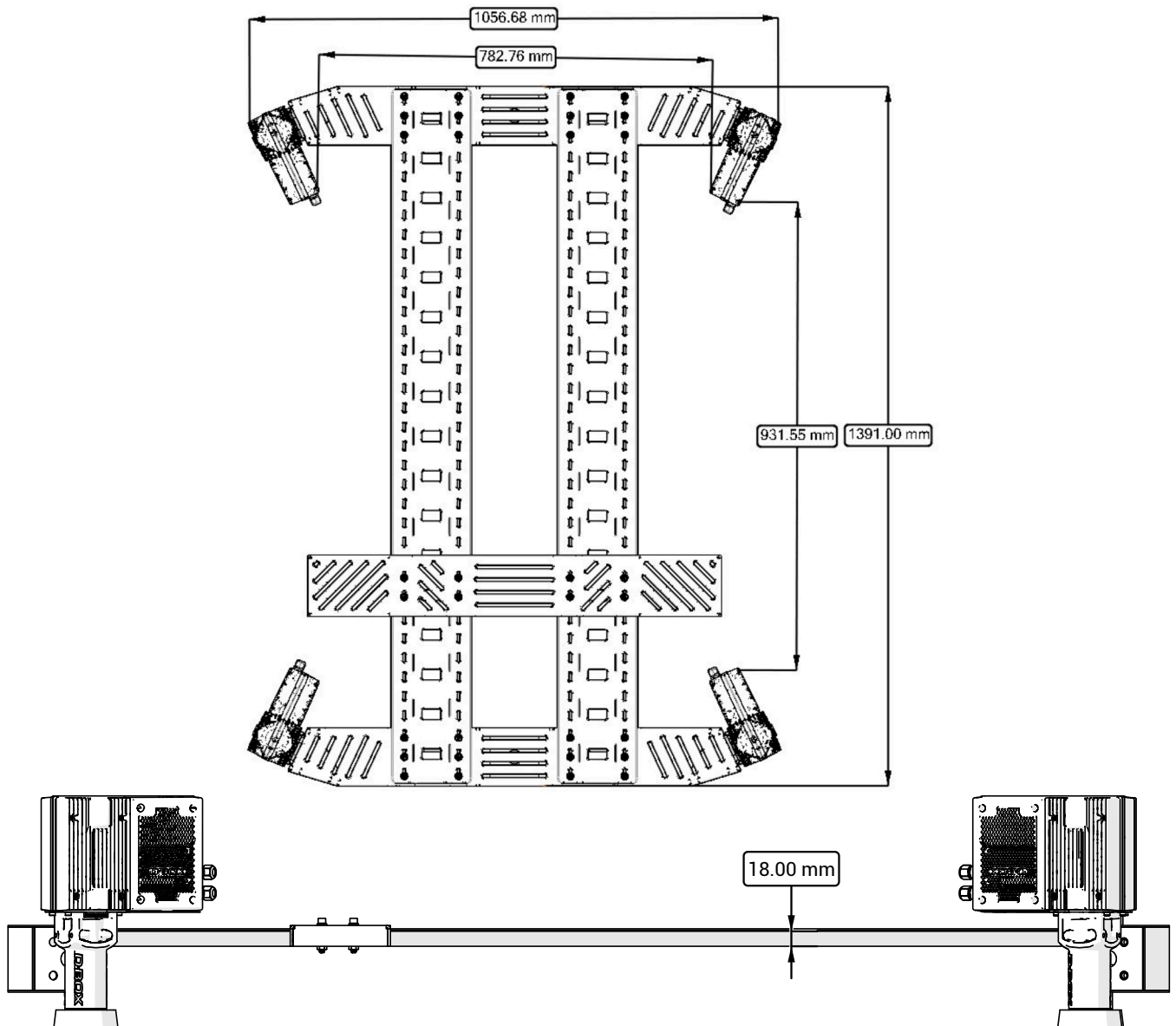

Configurations

The TR Move Motion platform is available for 2, 3 and 4 motion motors.
SKU TRMOVE-TRXP is ready for 2 and 4 motors while 3 motors requires SKU TRMOVE-3.

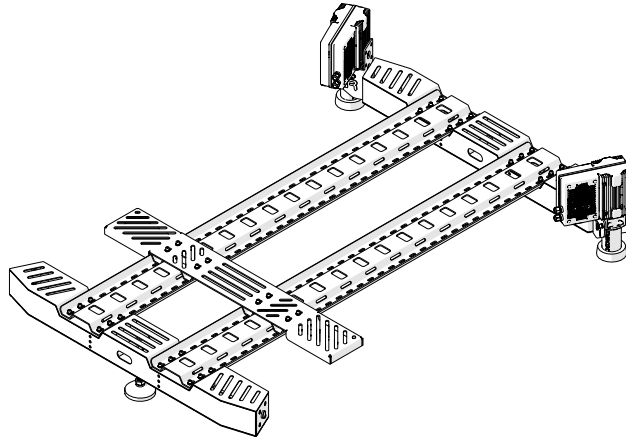

x2 Motors

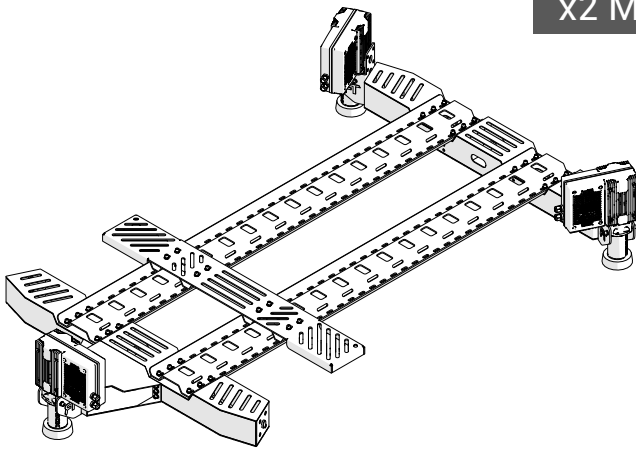

x3 Motors

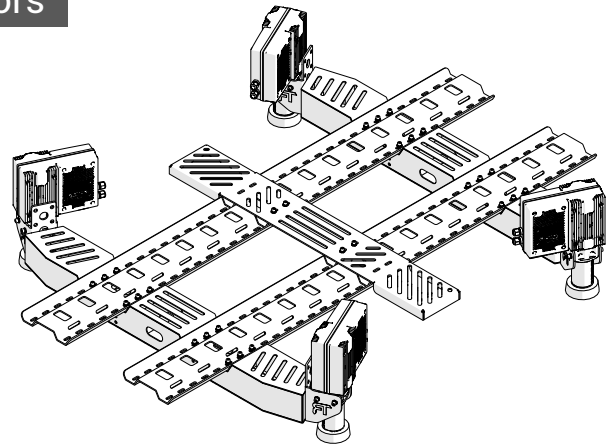

x4 Motors

Mounting Bracket

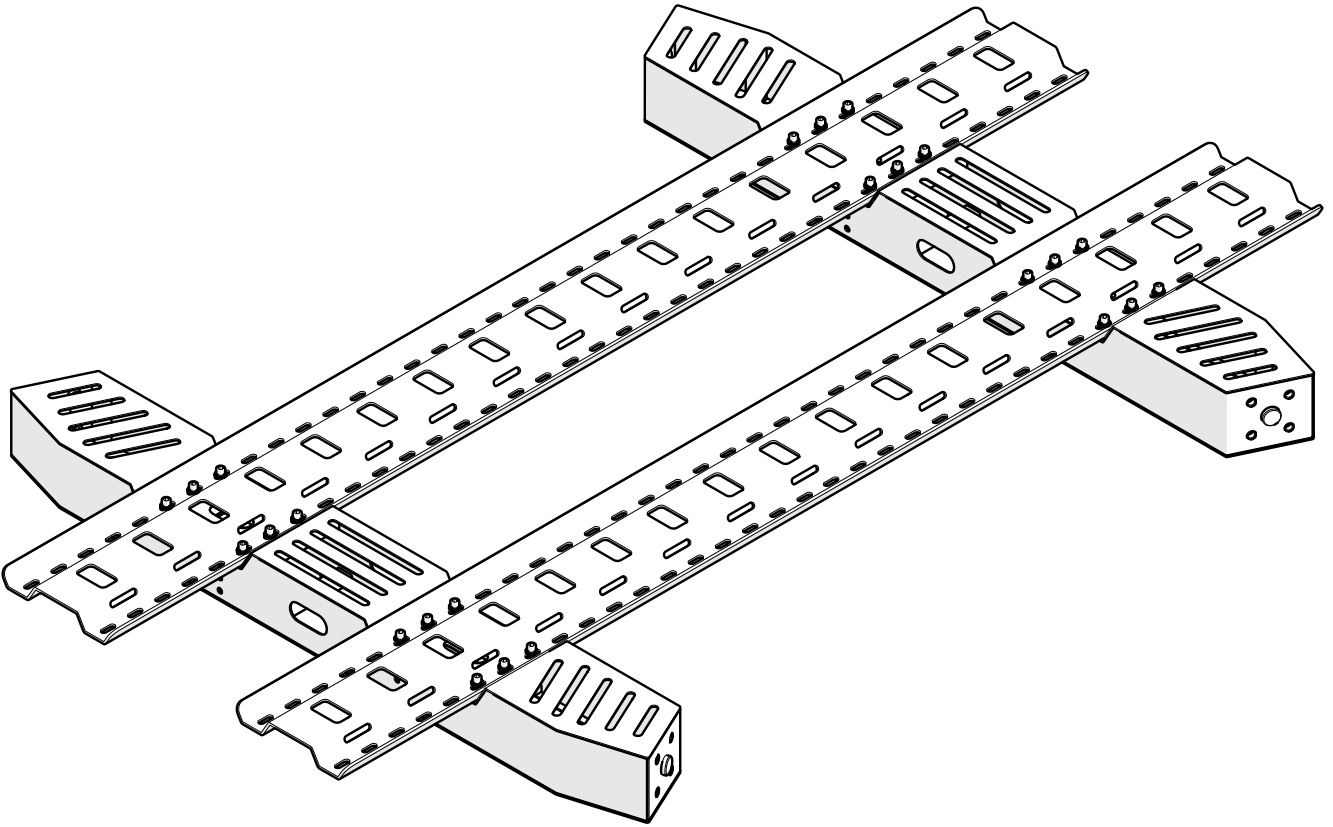

TR8



TRAK RACER

Published 2024-04-20

1



Main A x2

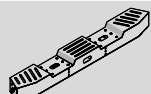

Main B x2

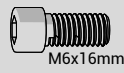

SH-M6-16 x24



WL-M6 x24



WF-M6 x24

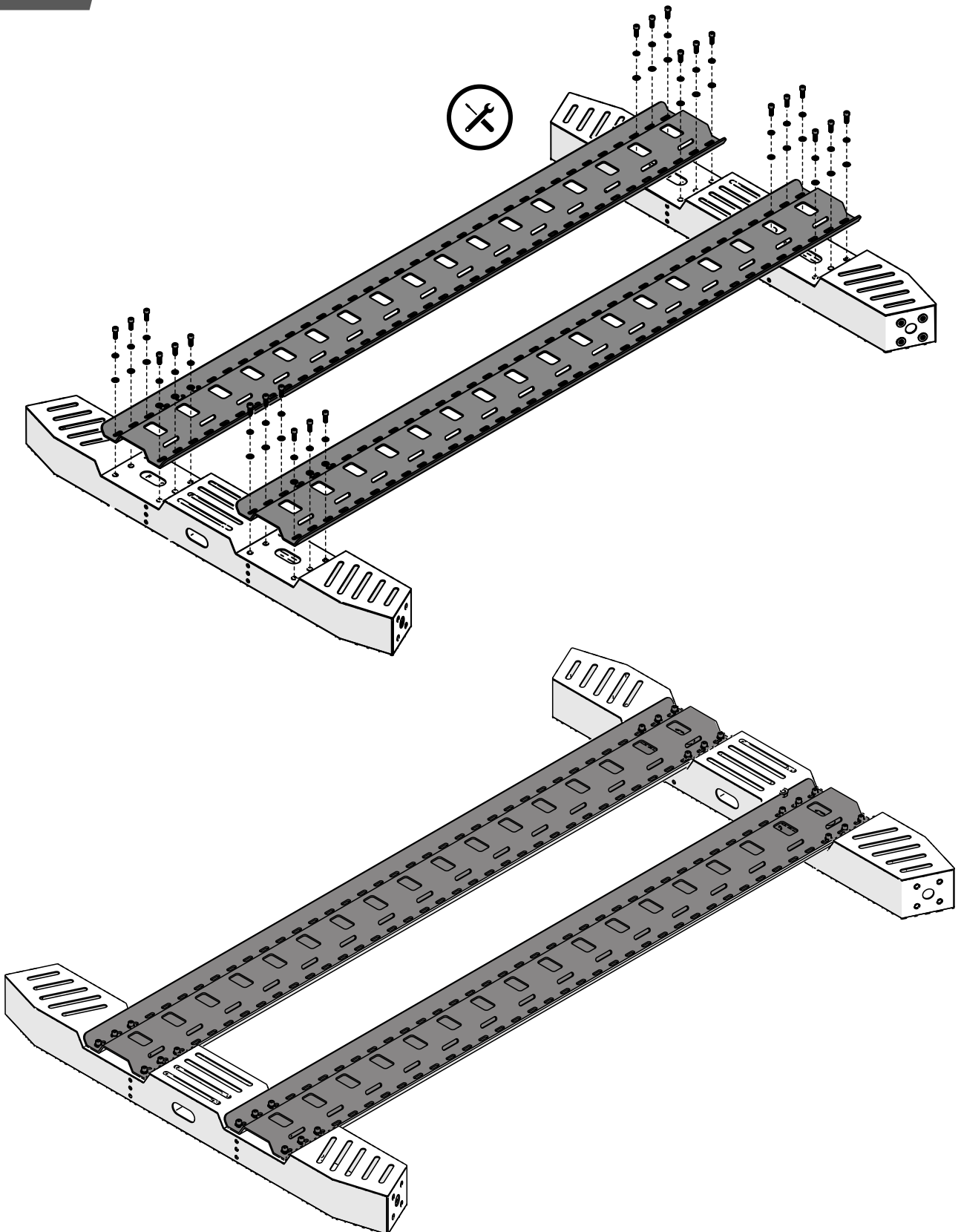

2



Main C x1



M6x35mm

SH-M6-35 x8



WL-M6 x8



WF-M6 x8



NL-M6 x8

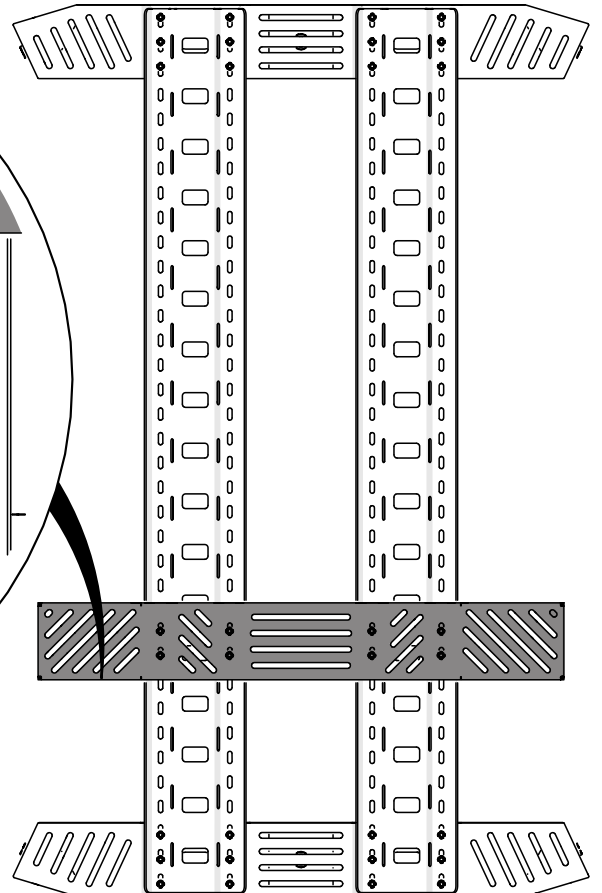
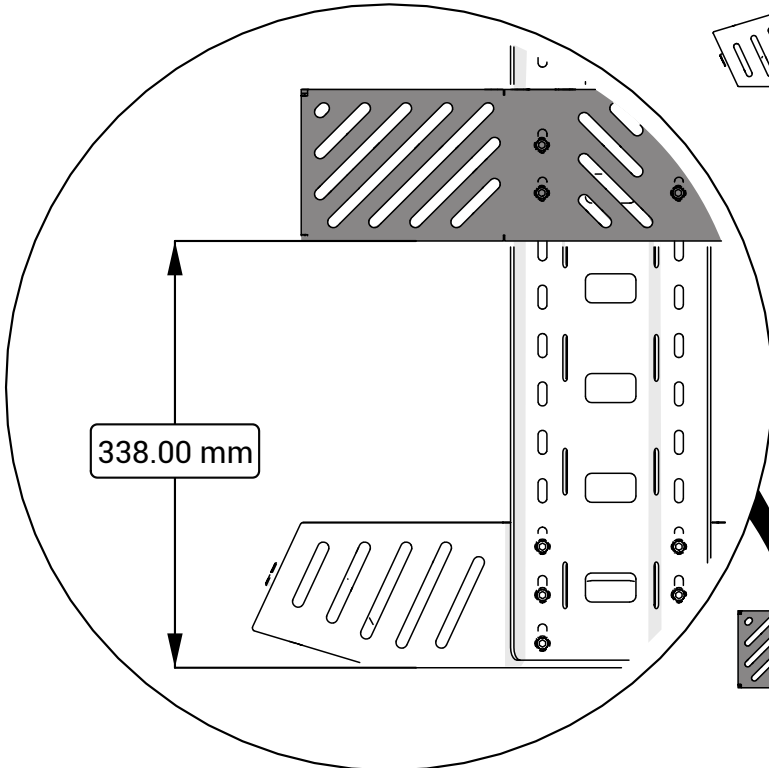
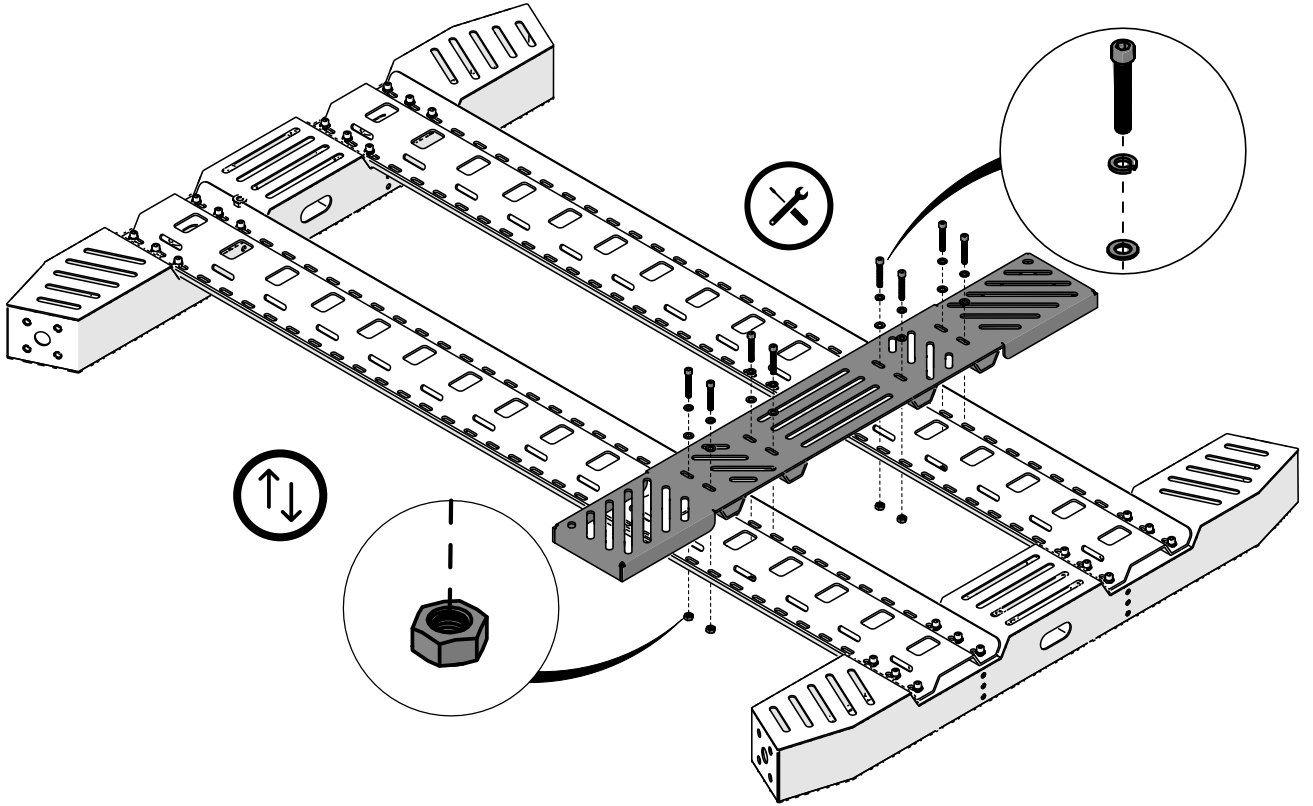

Main Chassis For 4 Motion Motors

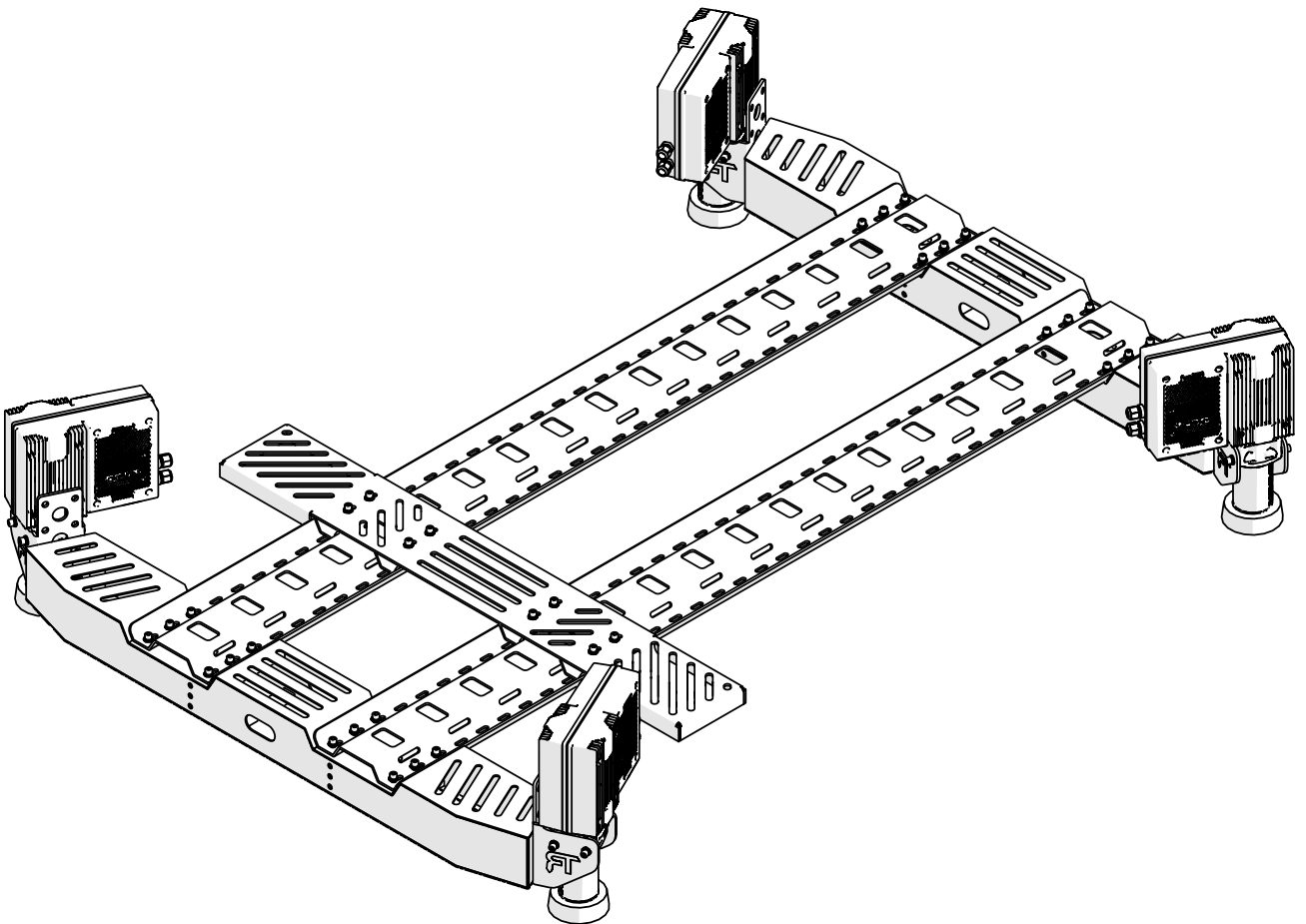

4-Motion Motors



TRAK RACER

Published 2024-04-20

1



Motor Bracket x4

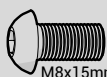

M8x15mm

Screw (Round) M8-15 x12



W-M8-16 x12

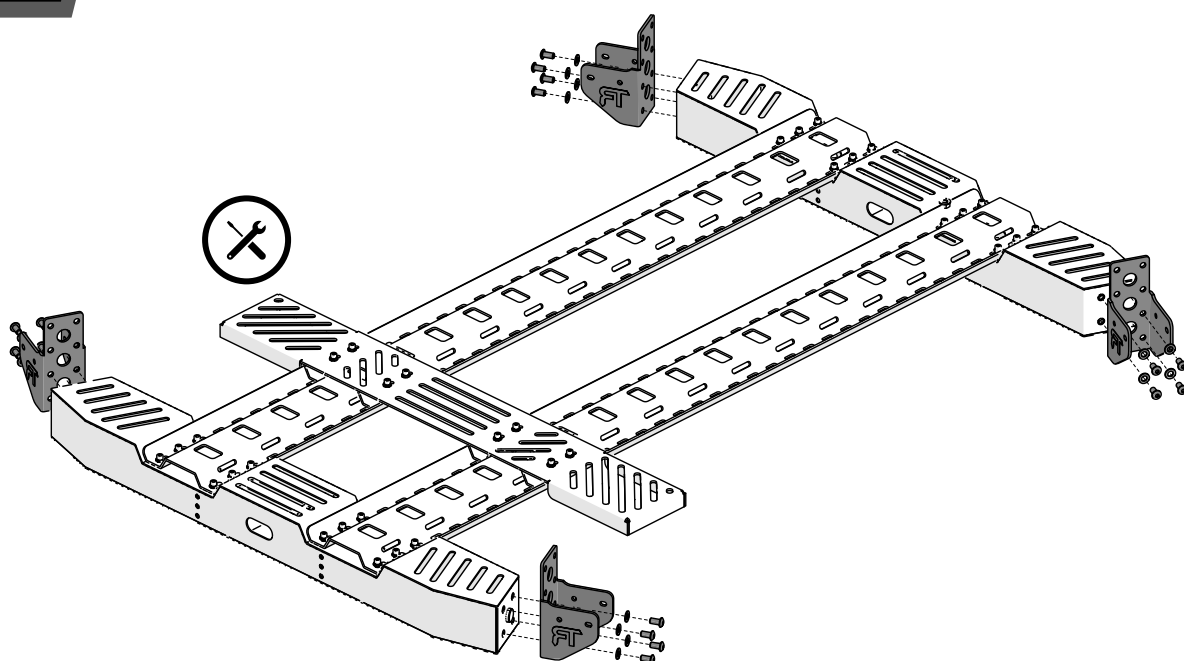

2

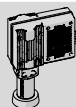

Motor Bracket x4

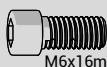

M6x16mm

SH-M6-16 x16



WL-M6 x16



WF-M6 x16

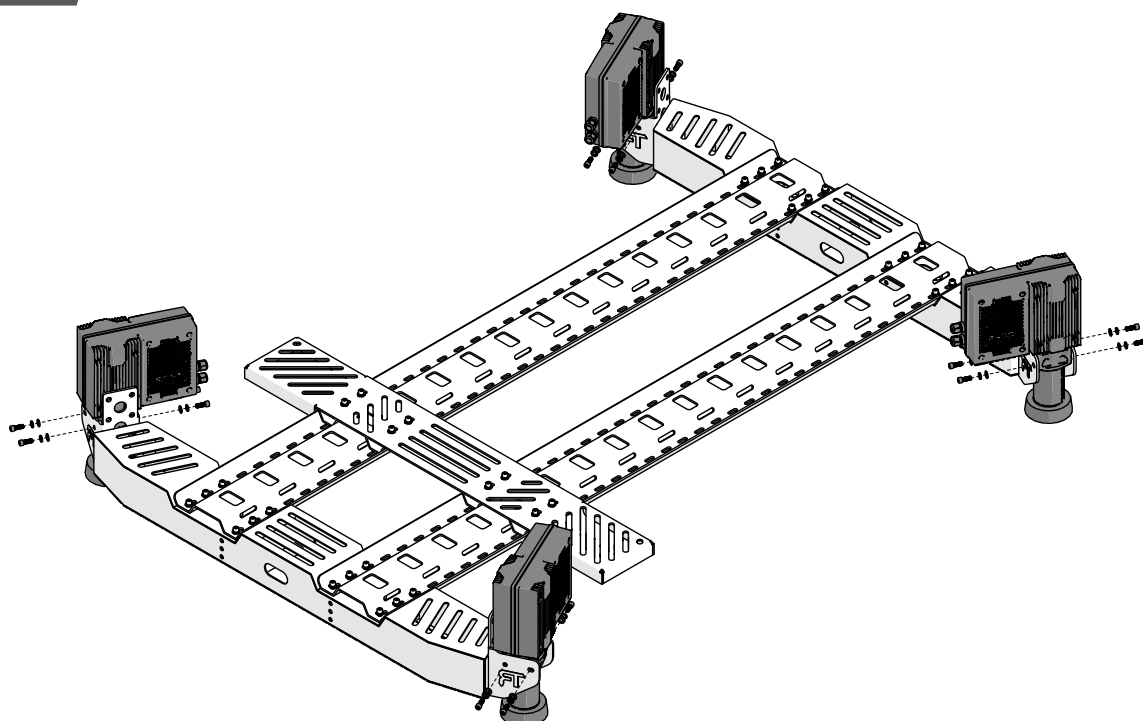

Main Chassis For 3 Motion Motors

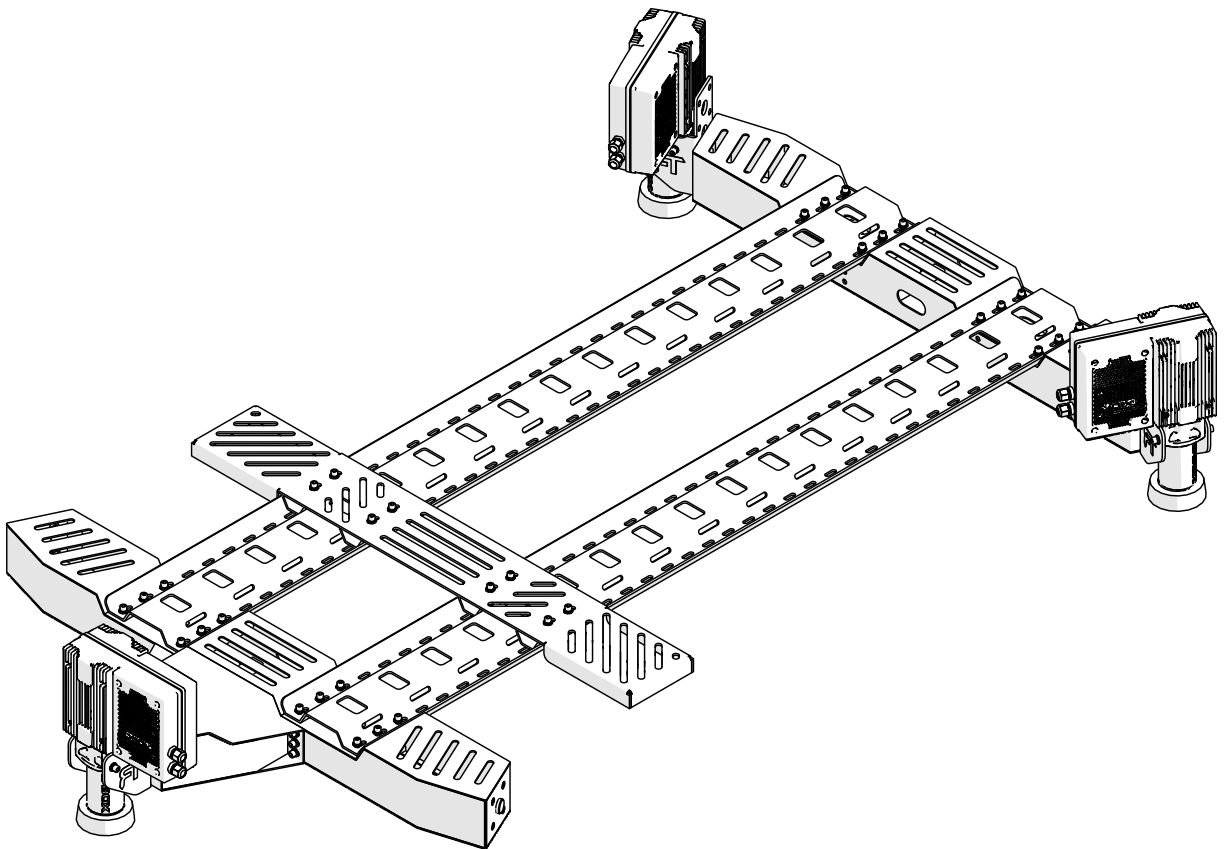

3 Motion Motors



TRAK RACER

Published 2024-04-20

1



Motor Bracket **x2**



M8x15mm

Screw (Round) M8-15 **x08**



W-M8-16 **x08**

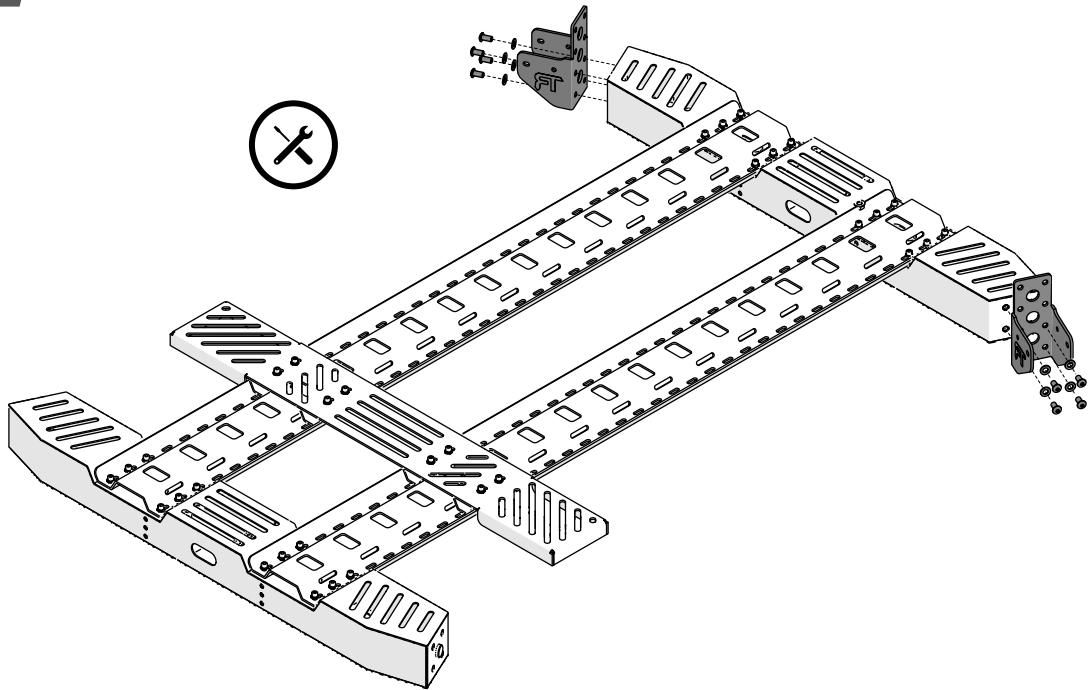

2

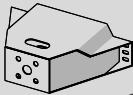

Motor Bracket **x1**

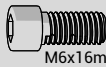

M6x16mm

SH-M6-16 **x6**



WL-M6 **x6**



WF-M6 **x6**



FW-M6 **x6**

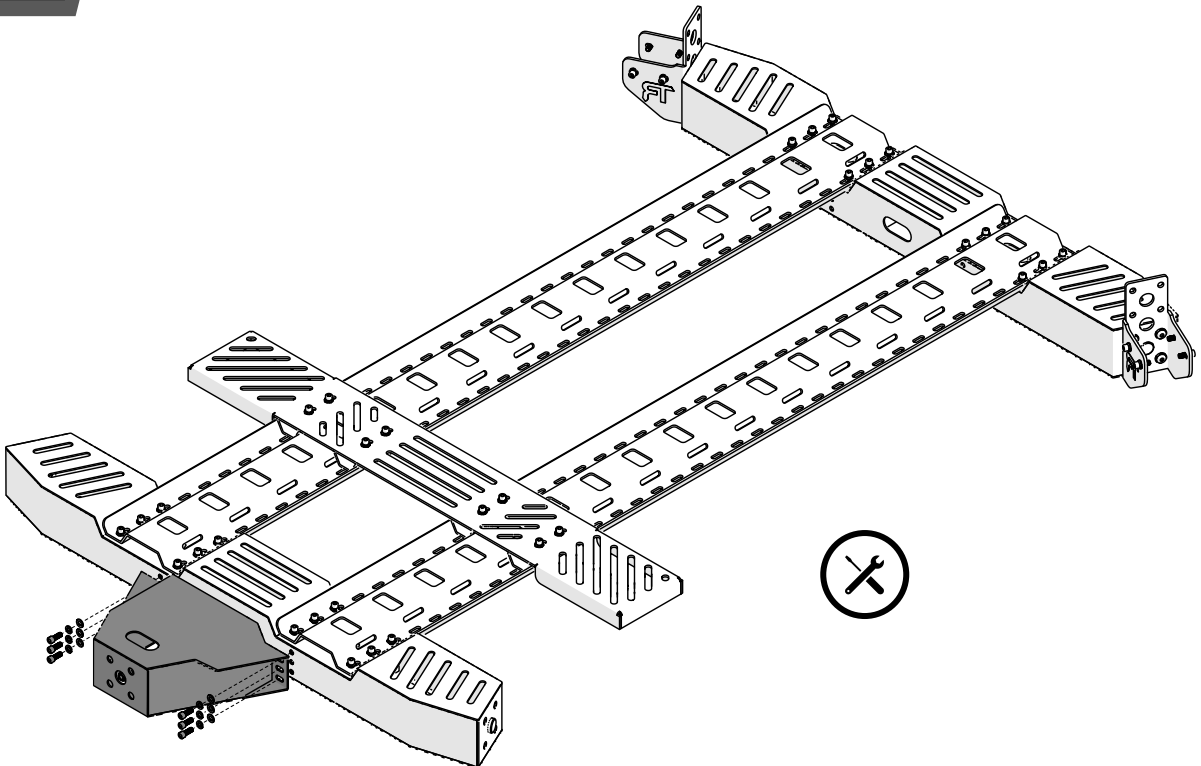

3



Motor Bracket **x1**

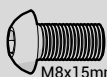

M8x15mm

Screw (Round) M8-15 **x04**



W-M8-16 **x04**

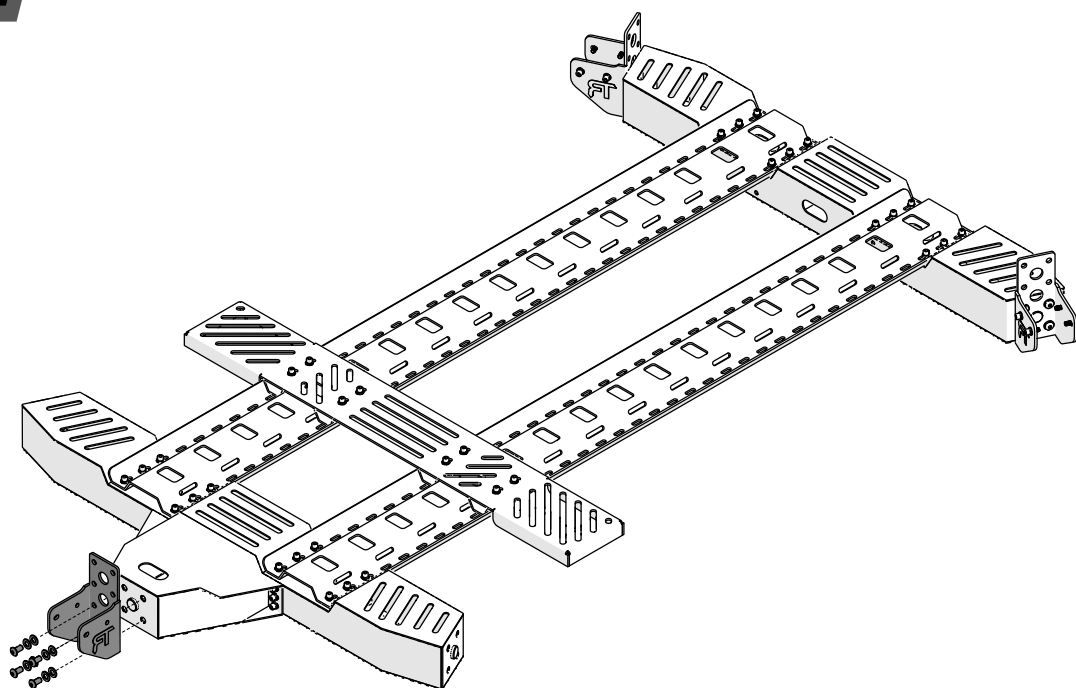

4

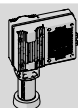

Motor Bracket **x3**

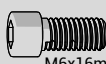

M6x16mm

SH-M6-16 **x12**



WL-M6 **x12**



WF-M6 **x12**

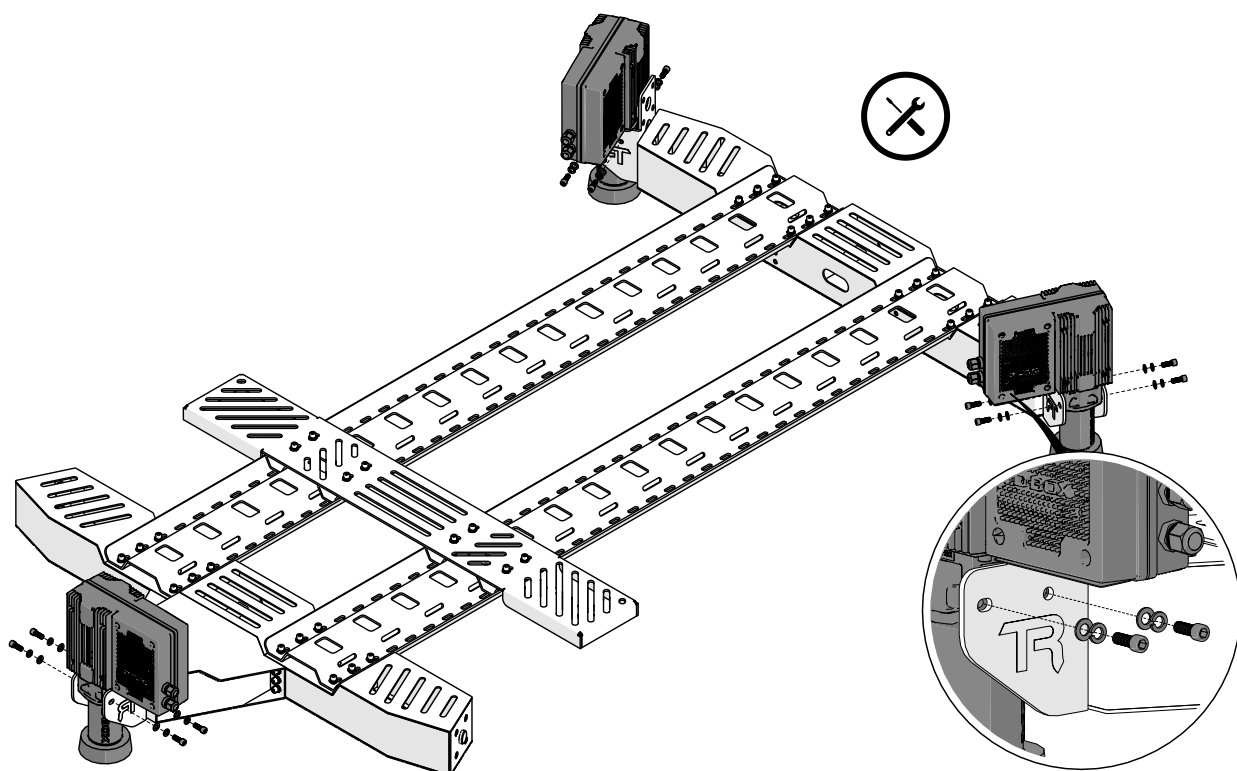

Main Chassis For 2 Motion Motors

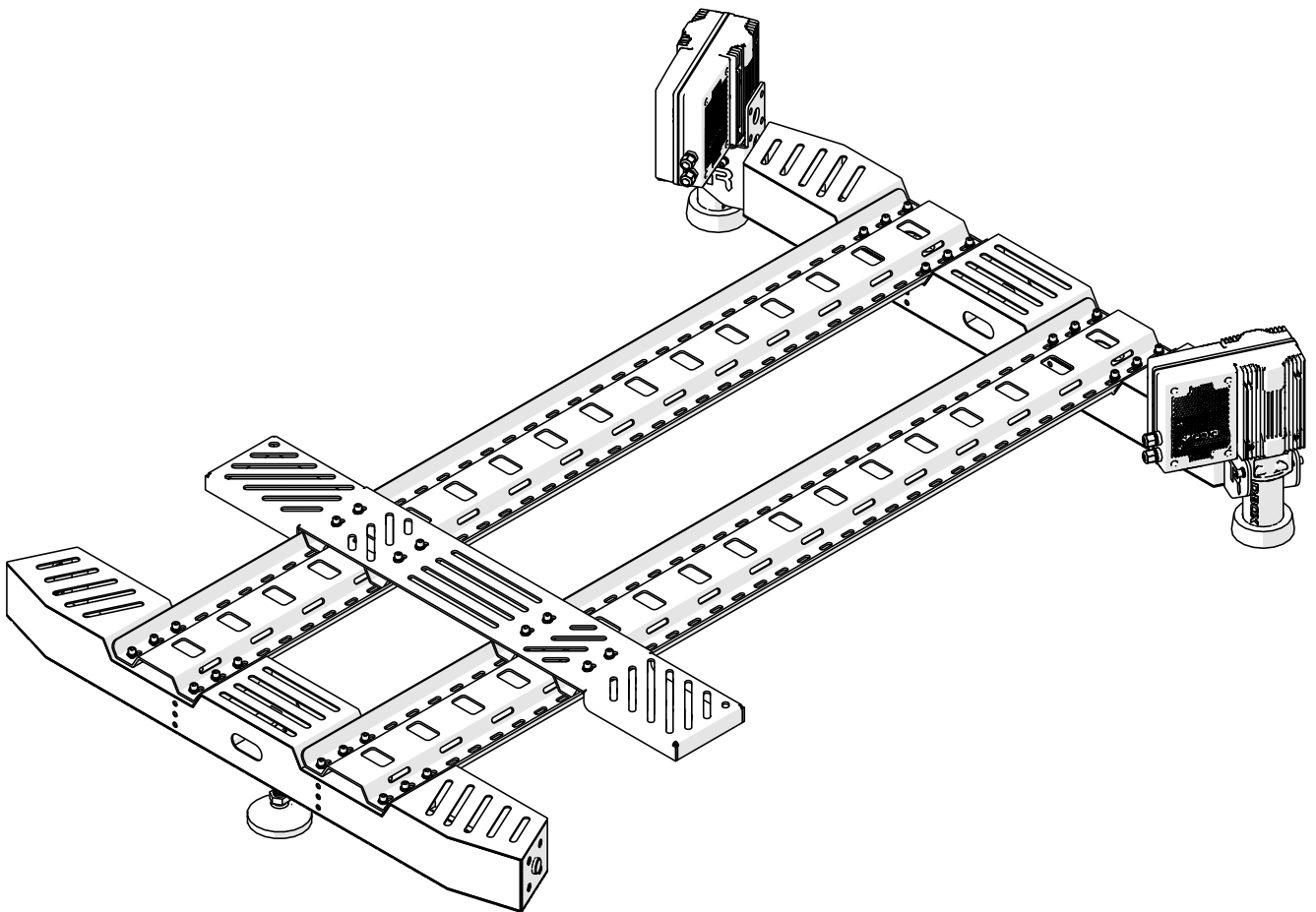

2 Motion Motors



TRAK RACER

Published 2024-04-20

1



Motor Bracket x2

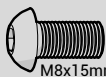

Screw (Round) M8-15 x08



W-M8-16 x08

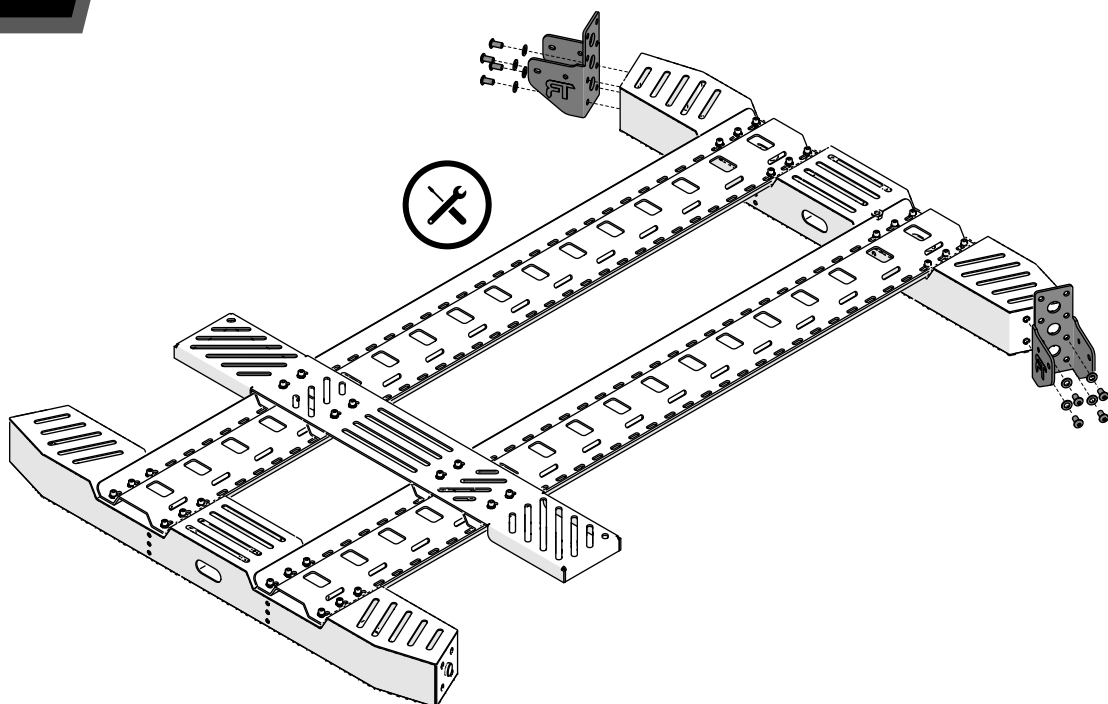

2

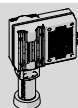

Motor Bracket x2

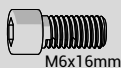

SH-M6-16 x8



WL-M6 x8



WF-M6 x8

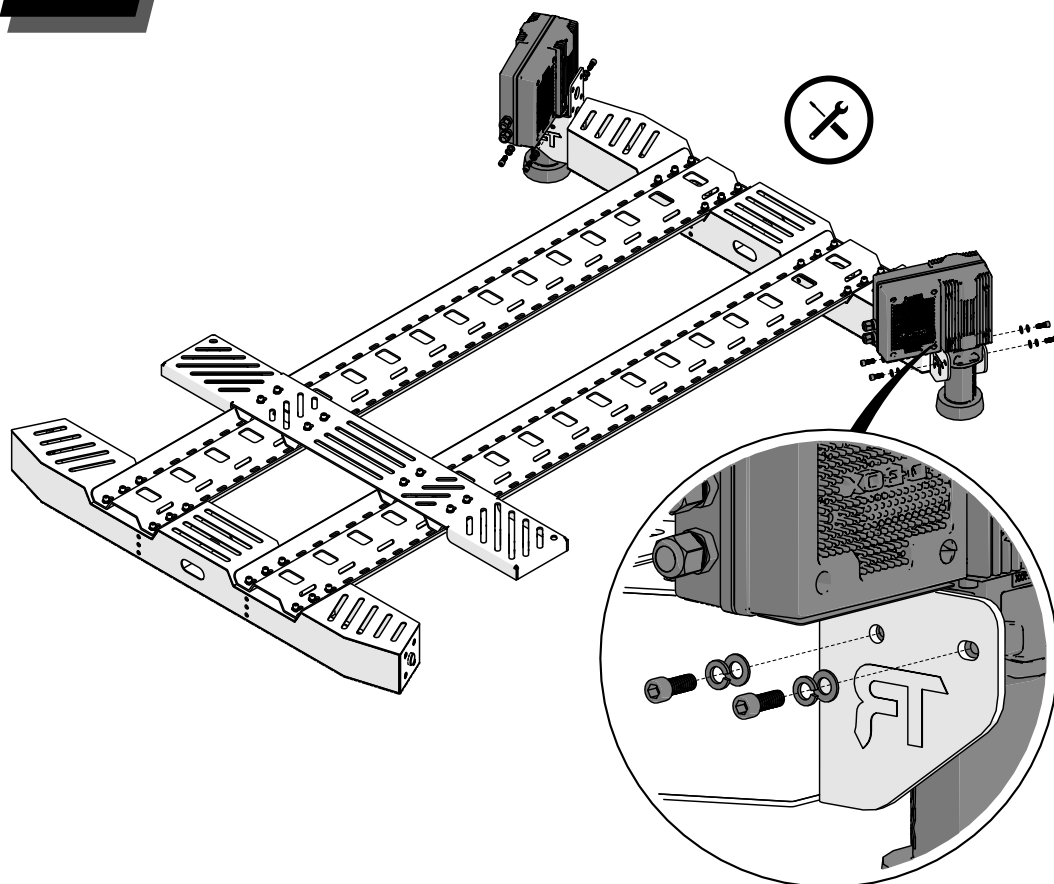

3



Ball Joint **x1** NF-M16 **x1**

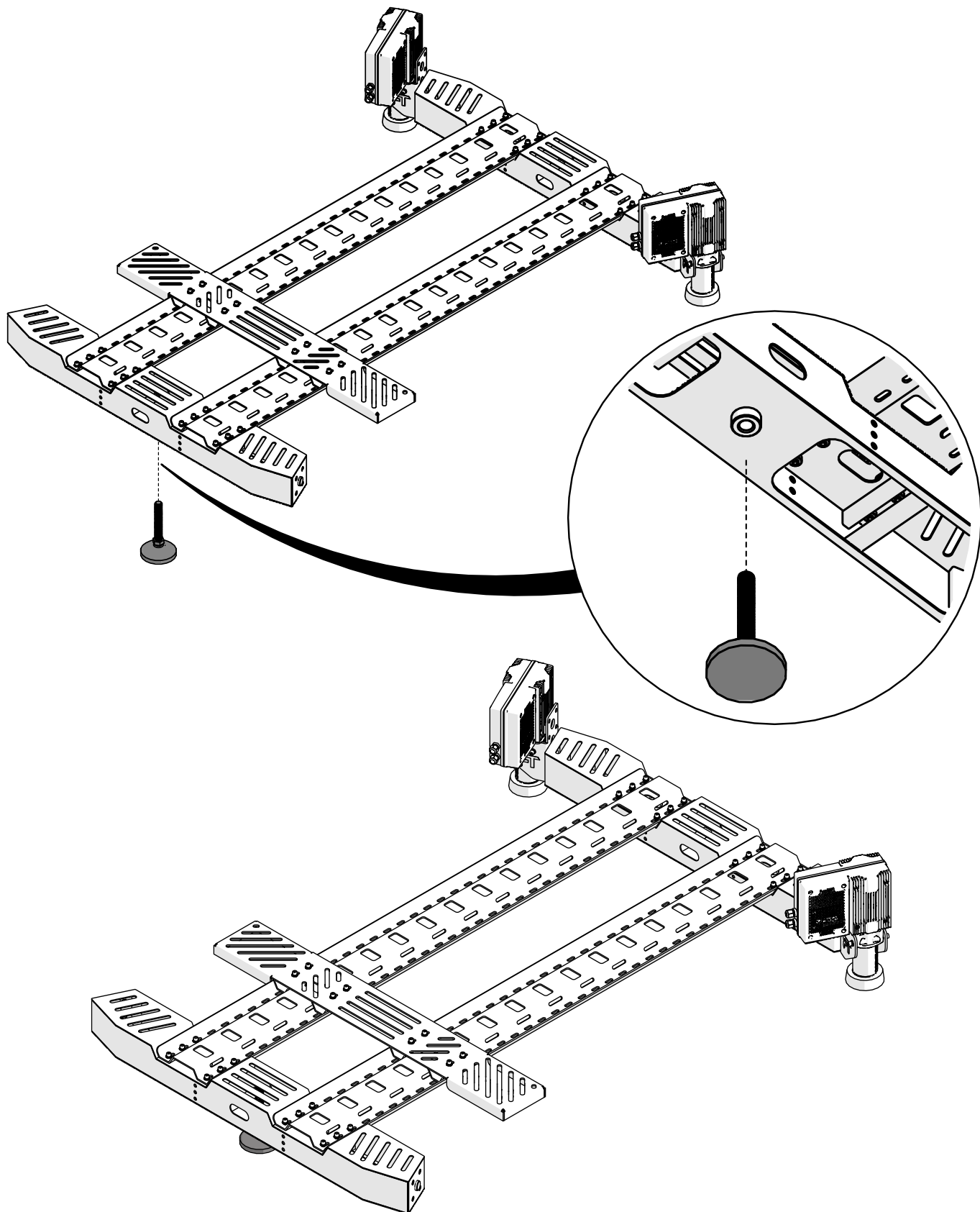

NOTE:

- Turn on the D-BOX Motor so it move to the neutral position.
- Adjust the ball joint by rotating the lower nut unit the chassis is parallel to the ground.
- Secure the ball joint using the lock nut.

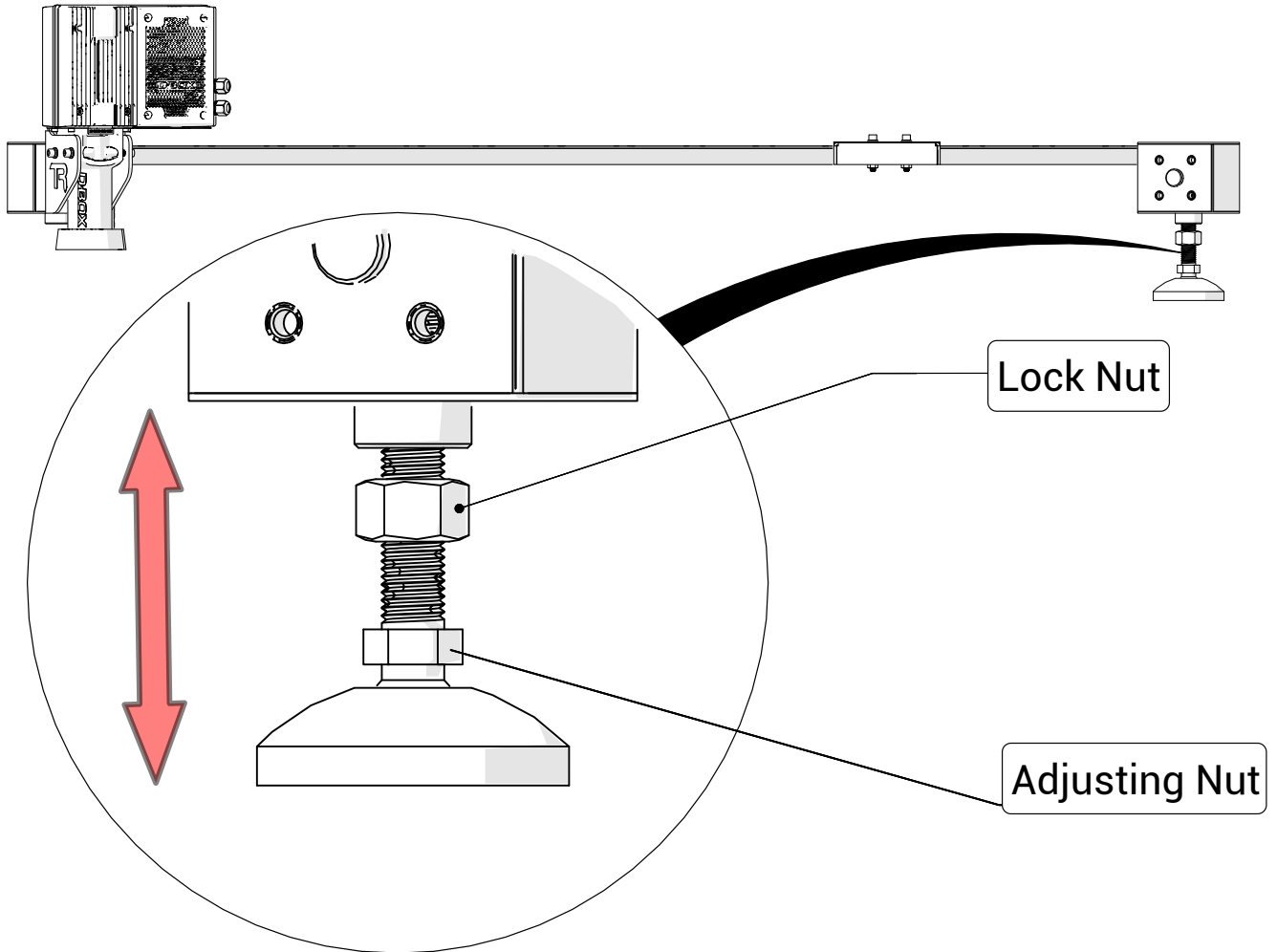

RS6 Simulator

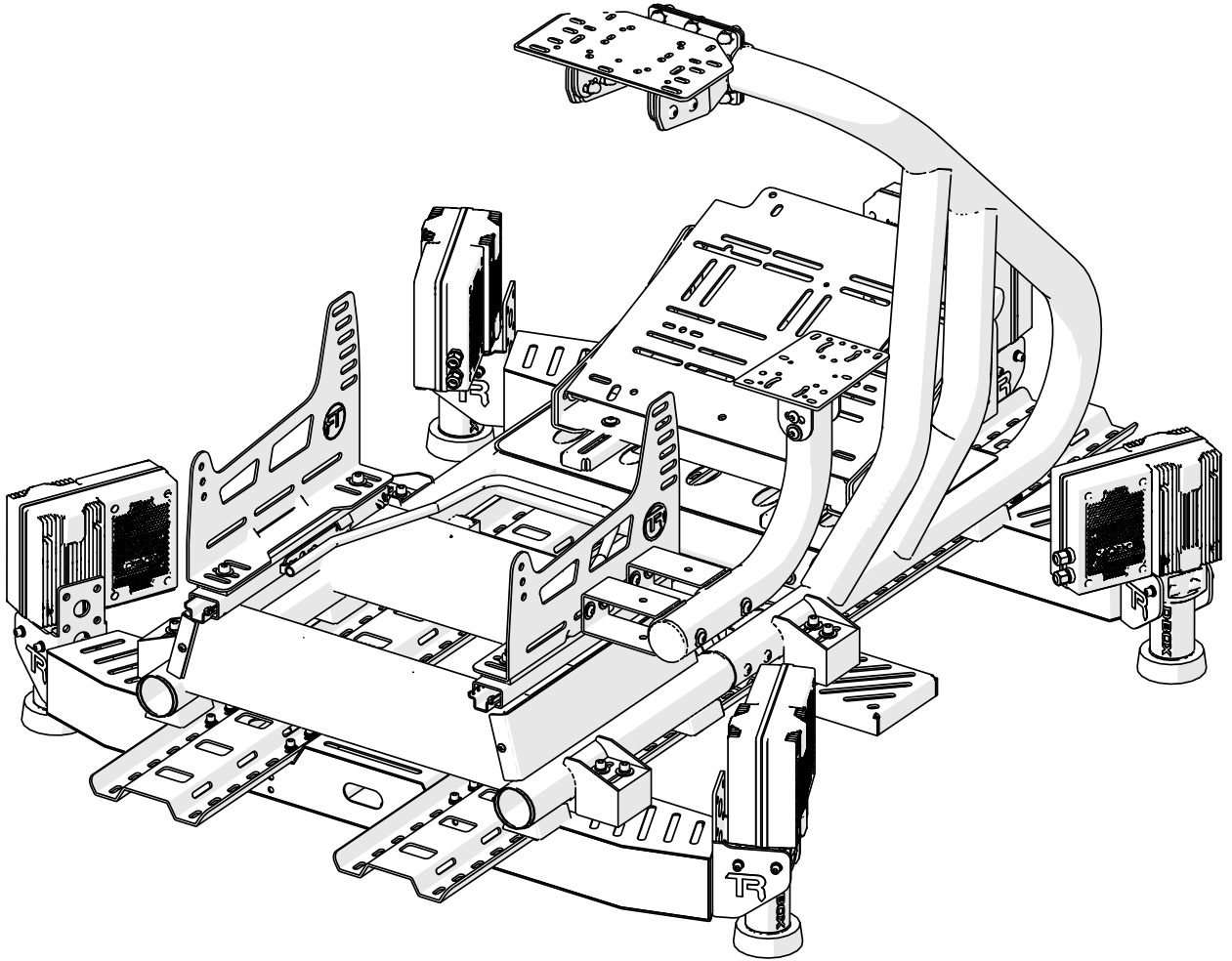

RS6 with Motion



TRAK RACER

Published 2024-04-20

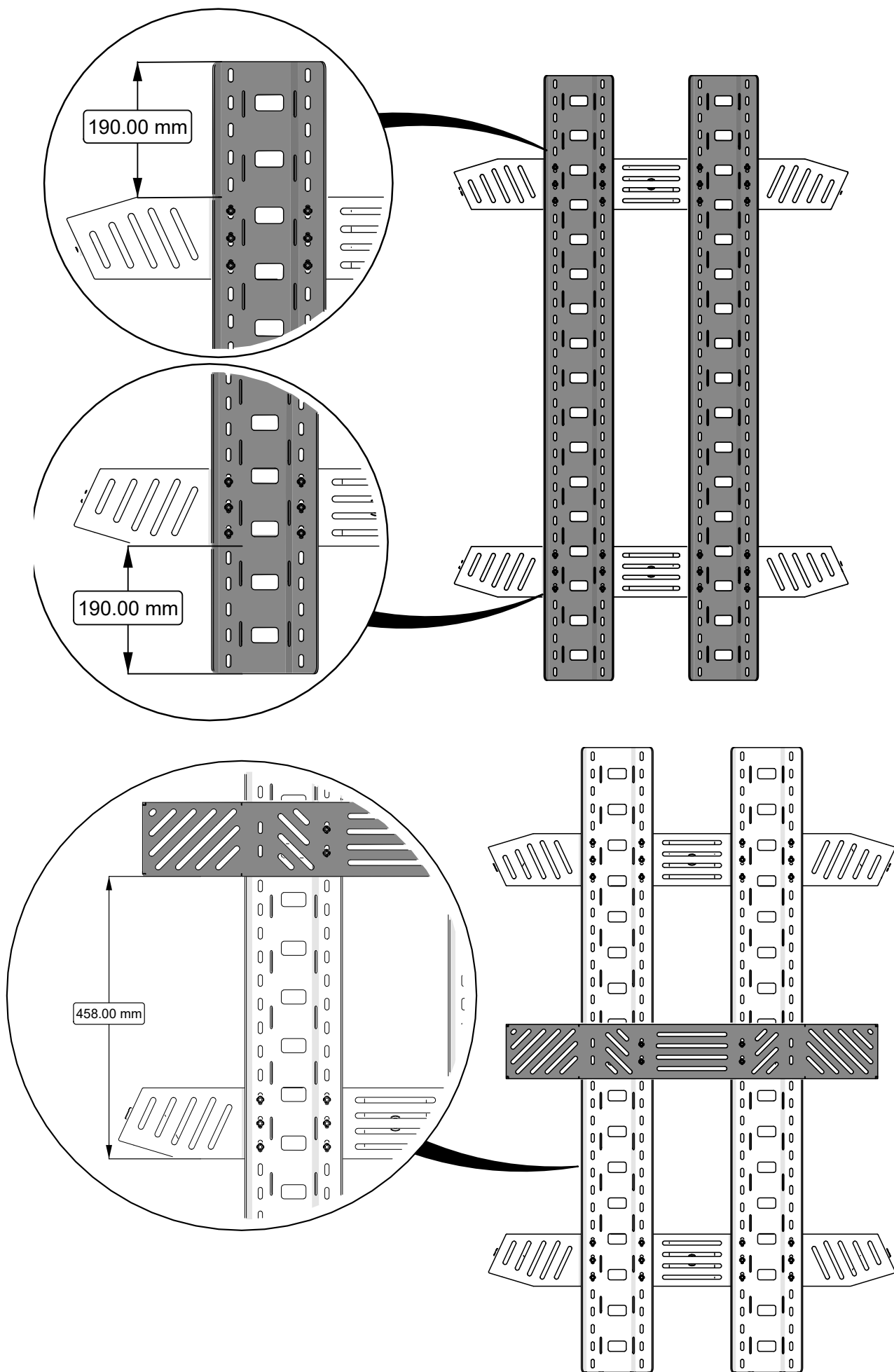

1



Bracket A1 x1



Bracket A2 x1

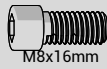

SH-M8-16 x2



WL-M8 x2



WF-M8 x2



NF-M16 x2

NOTE:

Loosely Secure Bracket A1 in the middle so it can be adjusted to fit the position of the cockpit.

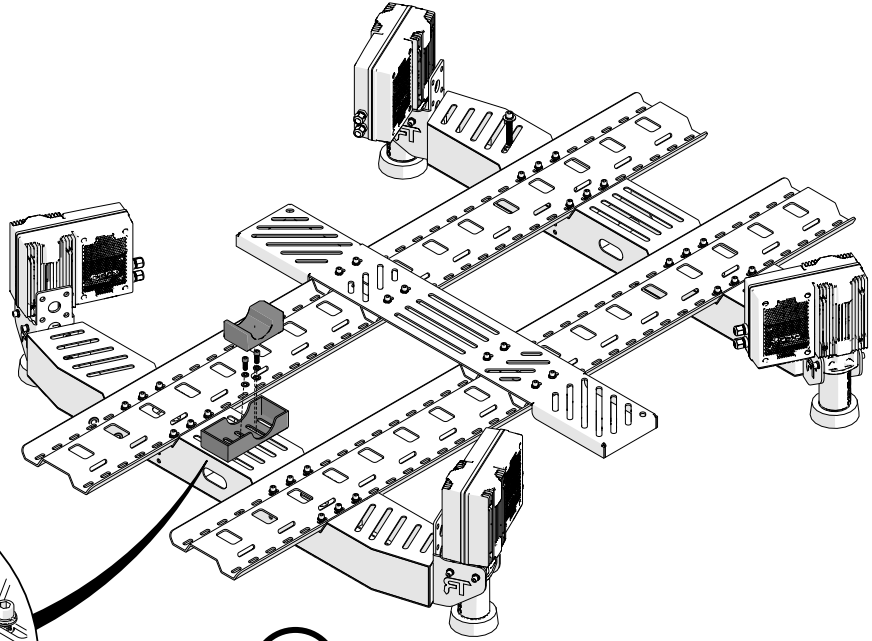
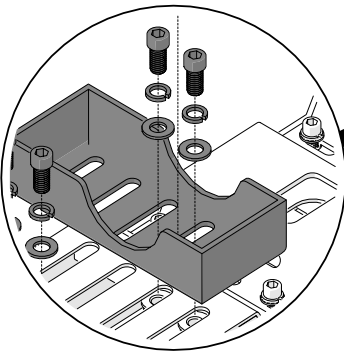

2



Bracket A1 x2



Bracket A2 x2

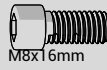

SH-M8-16 x4



WL-M8 x4



WF-M8 x4



NF-M16 x4

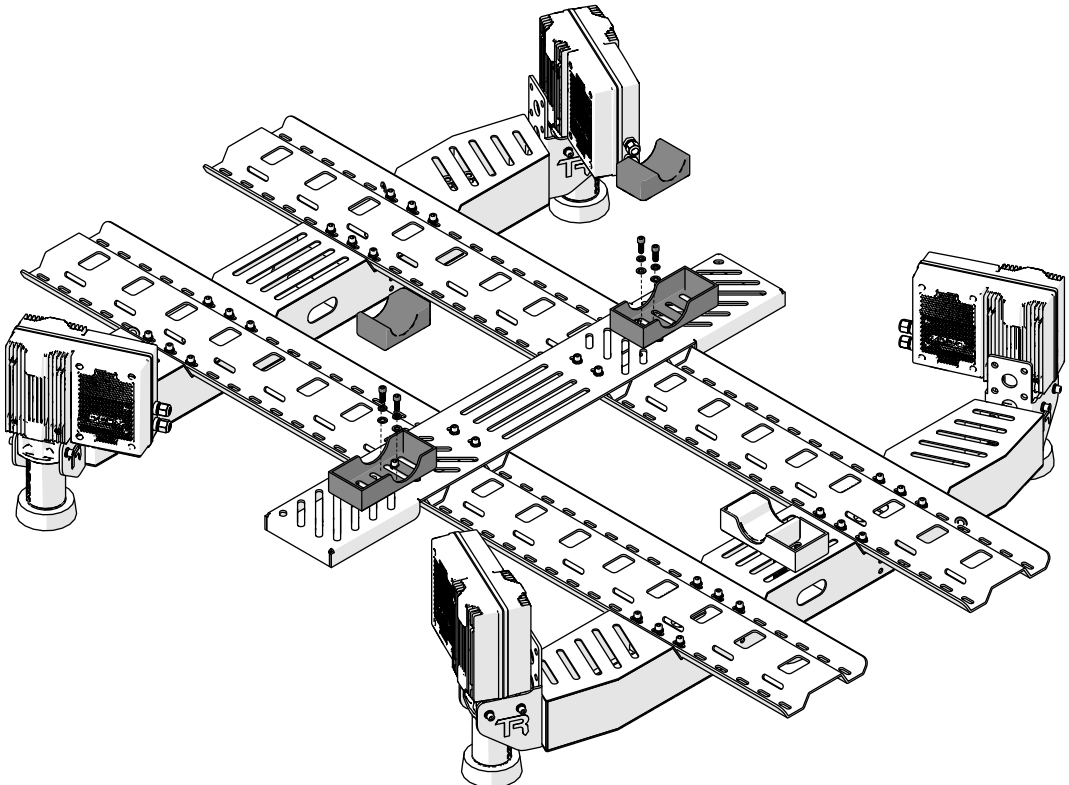

3



Bracket A1 x2



Bracket A2 x2

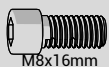

M8x16mm

SH-M8-16 x4



WL-M8 x4



WF-M8 x4



NF-M16 x4

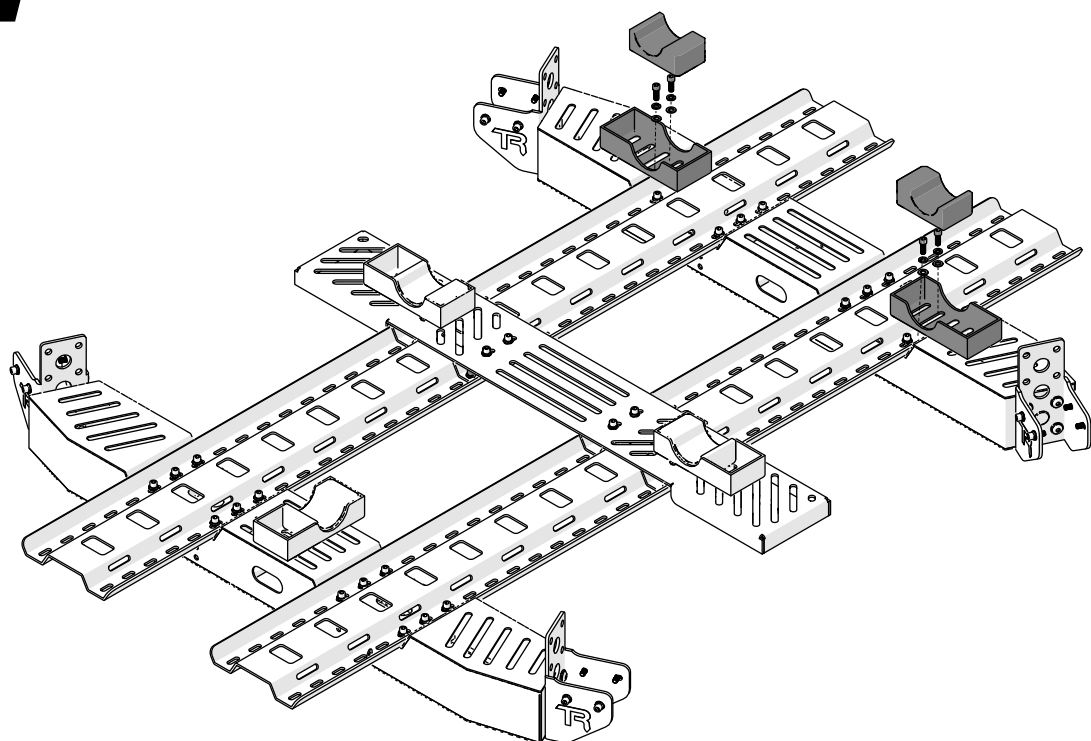

4

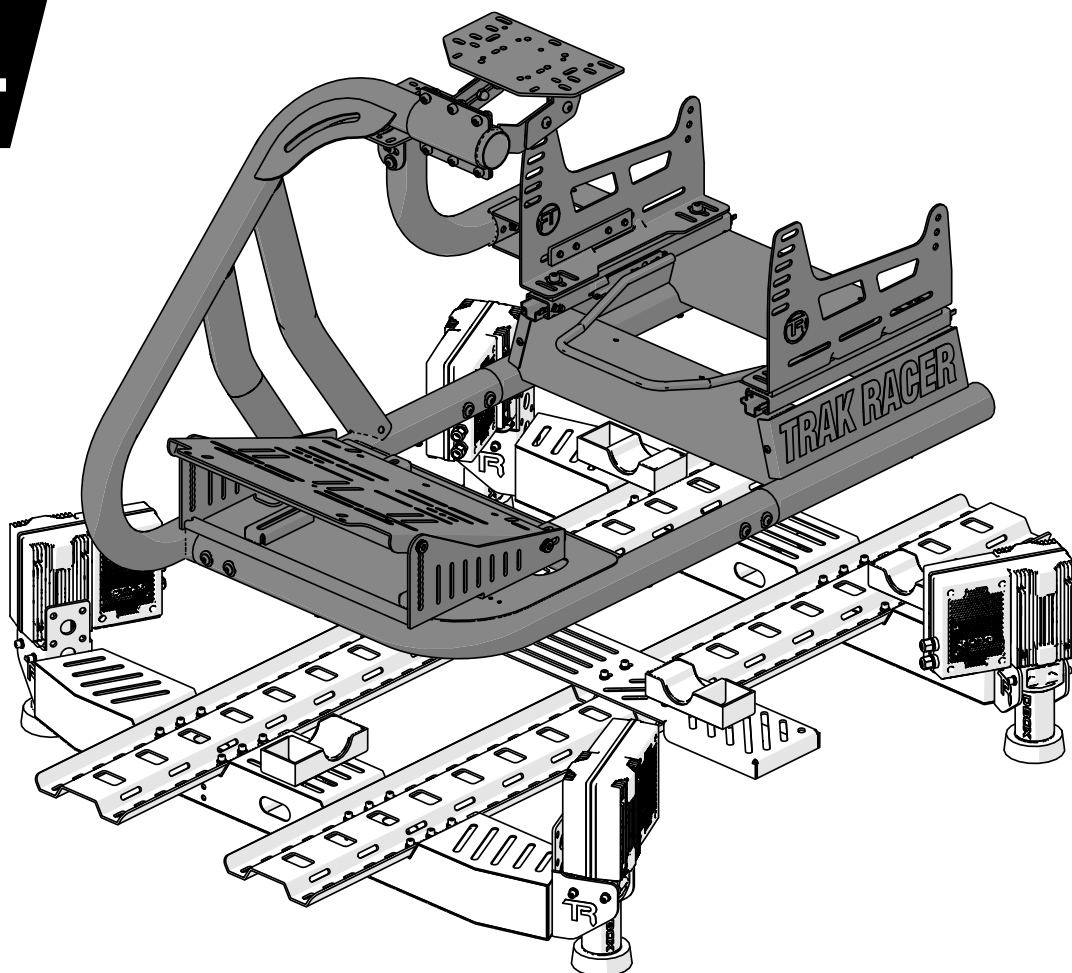

5



Bracket A3 x5



M8x65mm

SH-M8-65 x10



WL-M8 x10



WF-M8 x10



NF-M16 x10

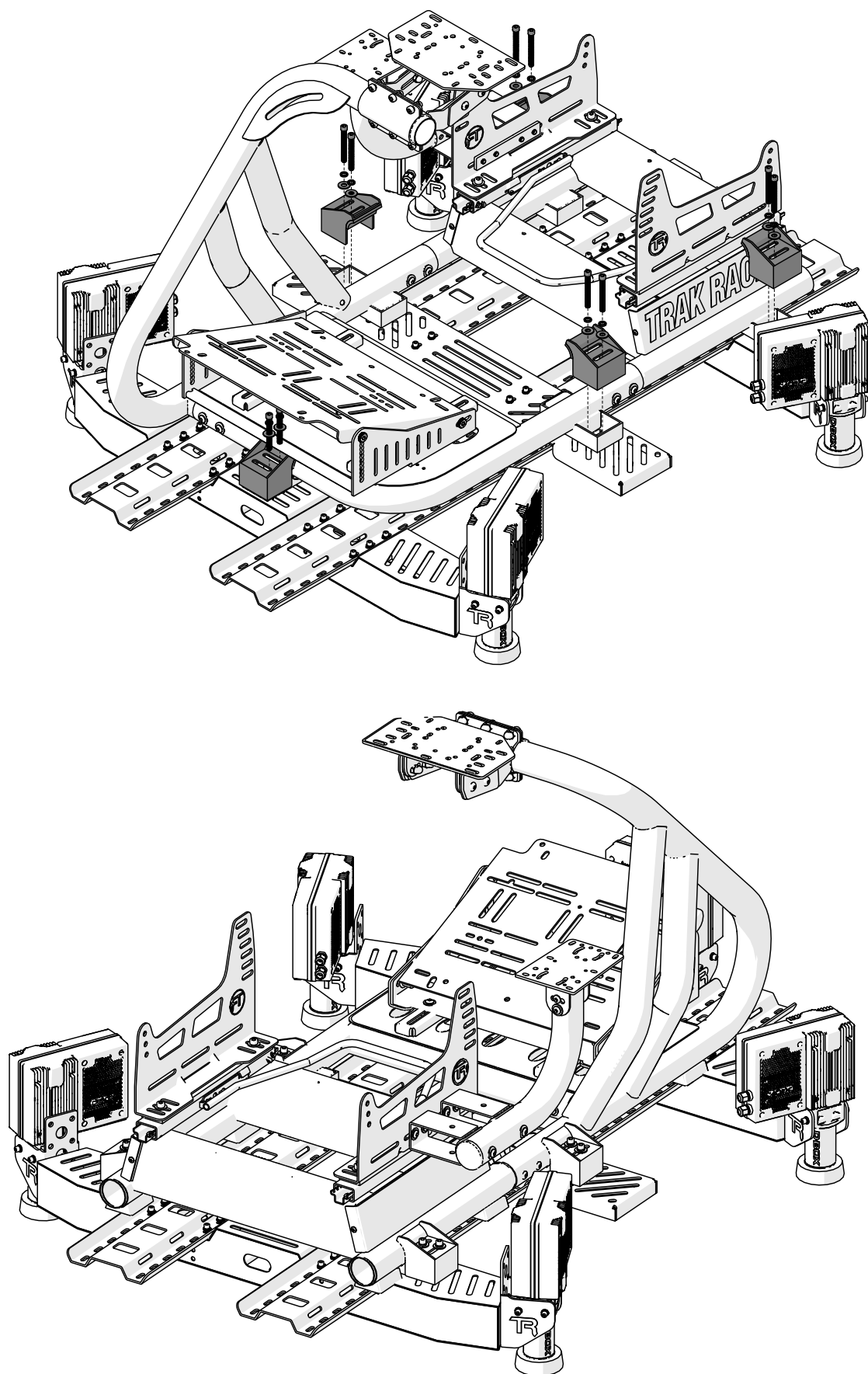

TRX Simulator

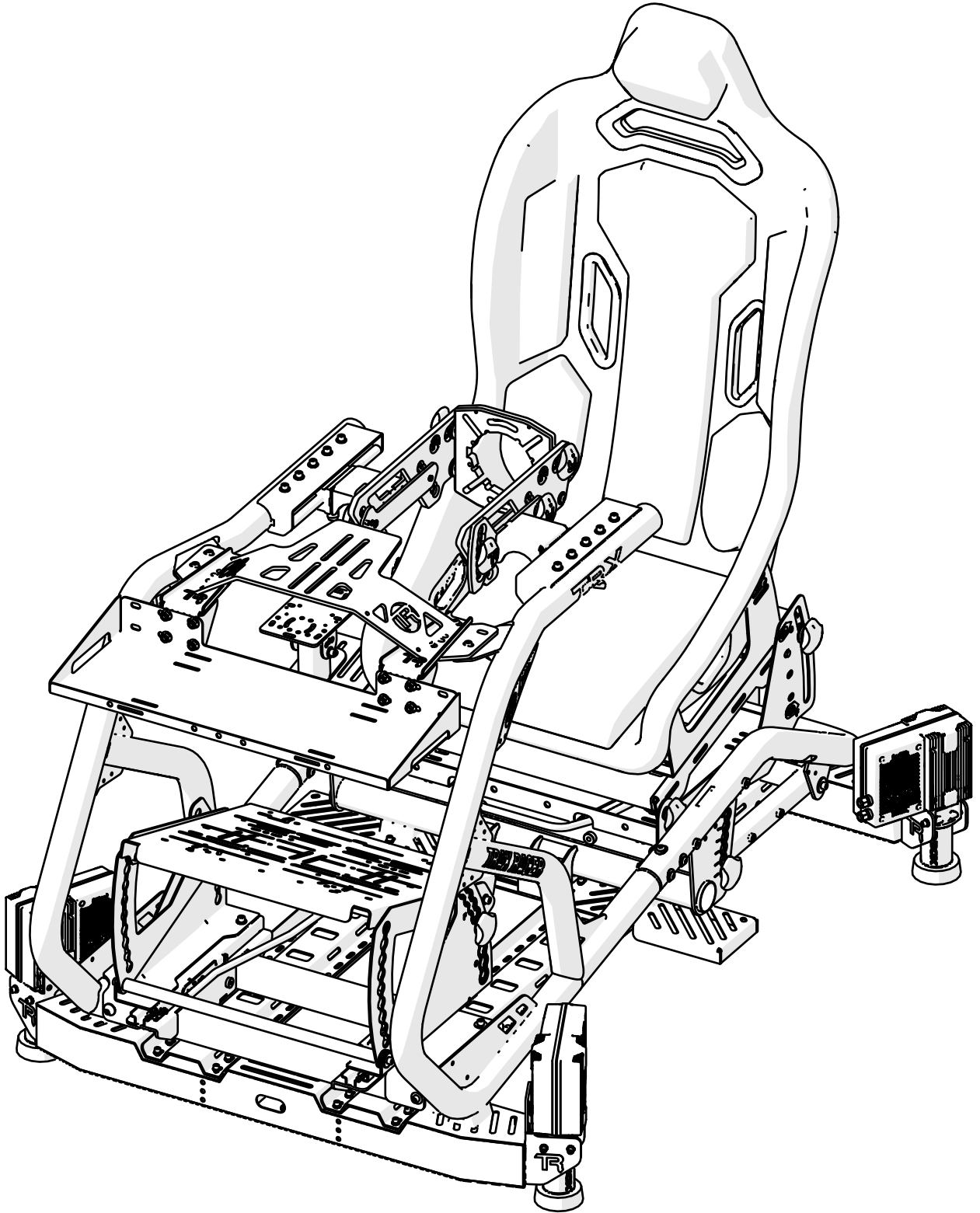

TRX with Motion



TRAK RACER

Published 2024-04-20

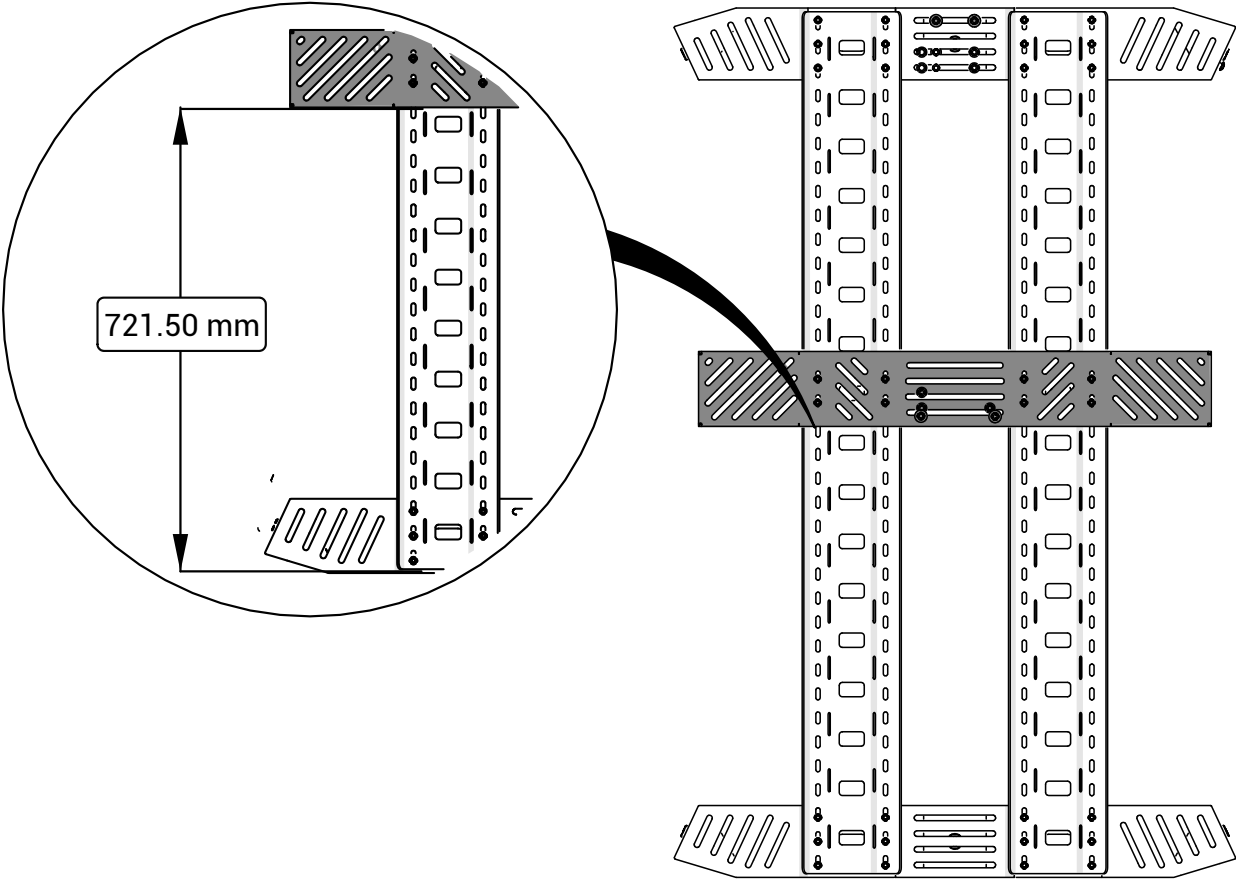

1

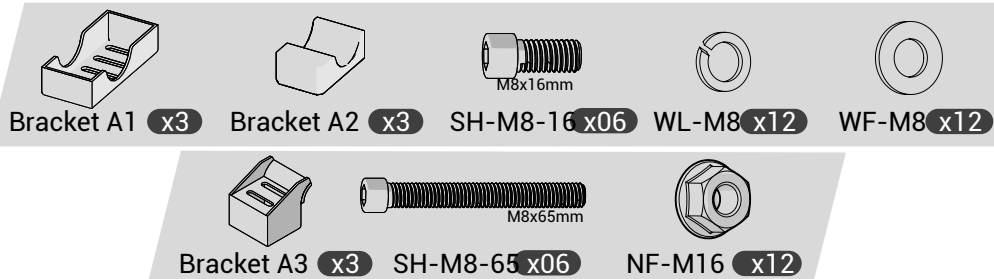

NOTE:

- Follow the steps on the RS6 mounting page, but adhere to the part list mentioned above.
- Untighten the screws and remove Bracket A3, along with the screws and rings.

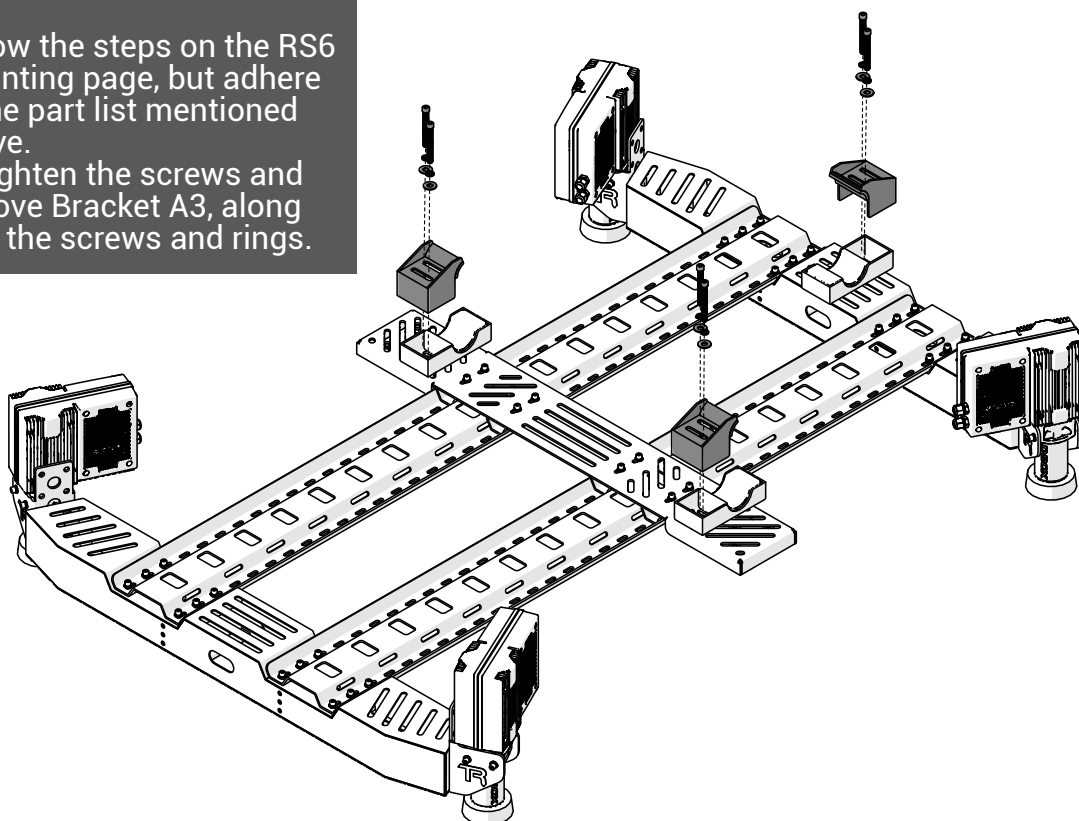

2

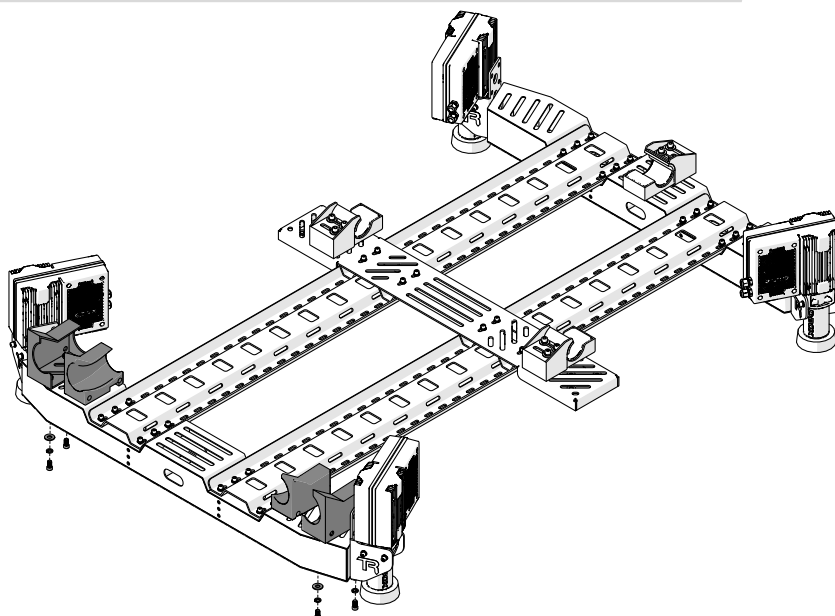
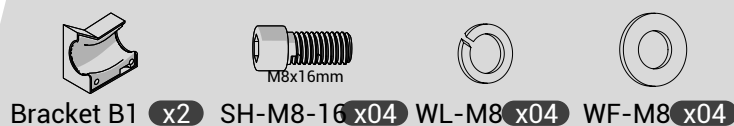

3



Bracket B2

x2



M8x65mm

SH-M8-65

x4



M8x16mm

SH-M8-16

x6



WL-M8

x06



WF-M8

x06



NF-M8

x6

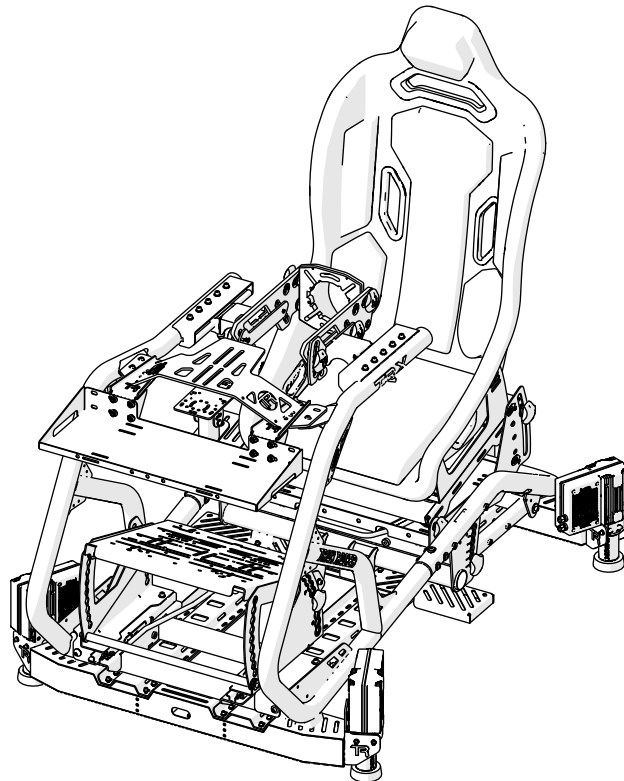
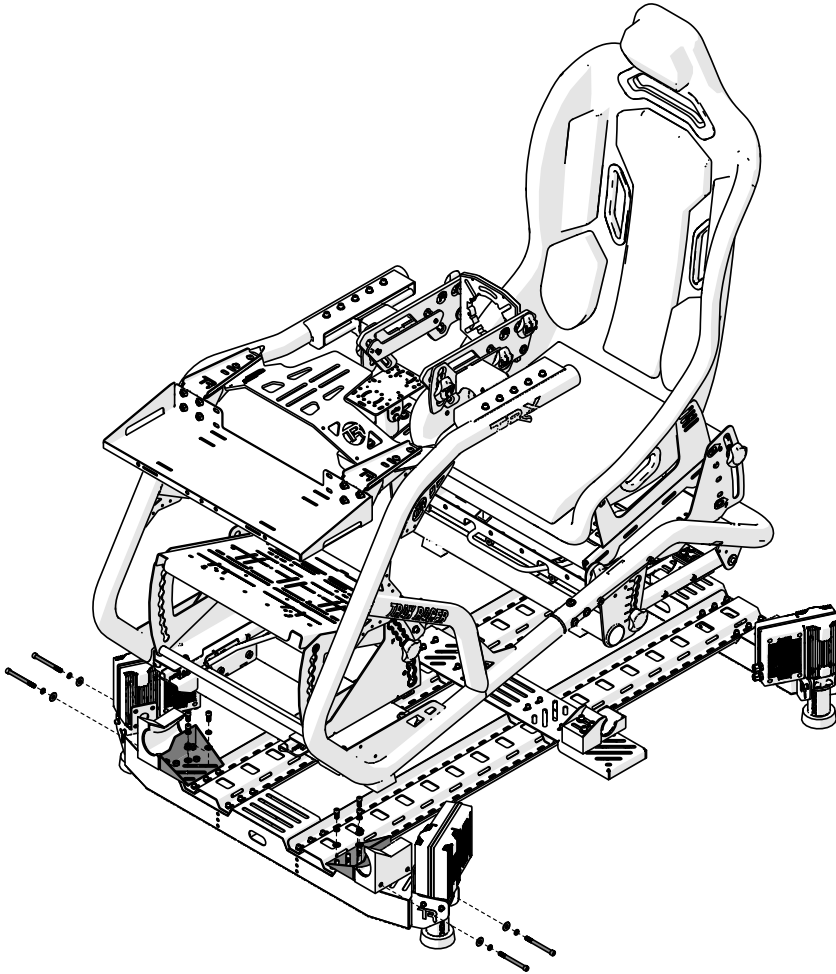

TR8 Simulator

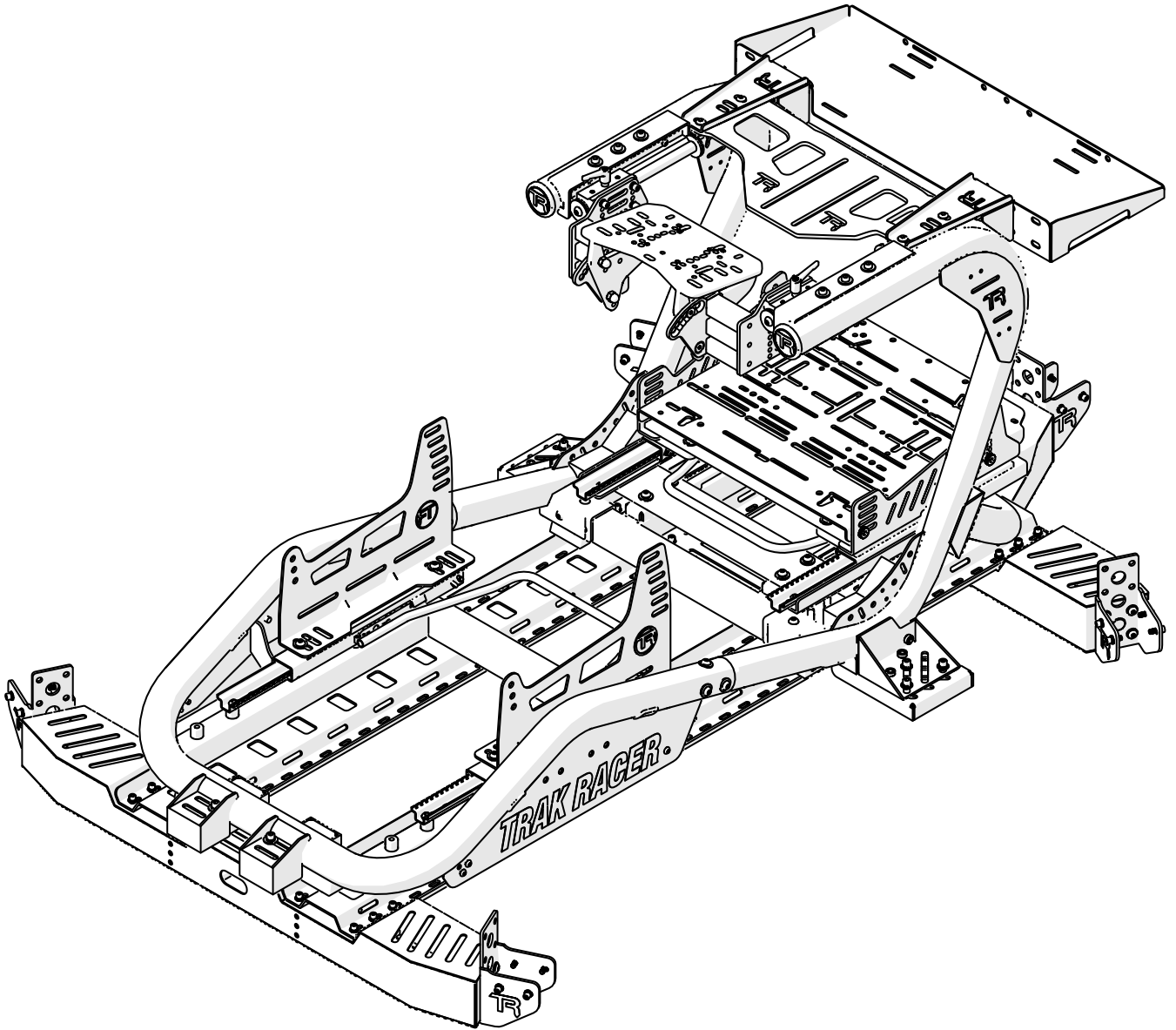

TR8 with Motion



TRAK RACER

Published 2024-04-20

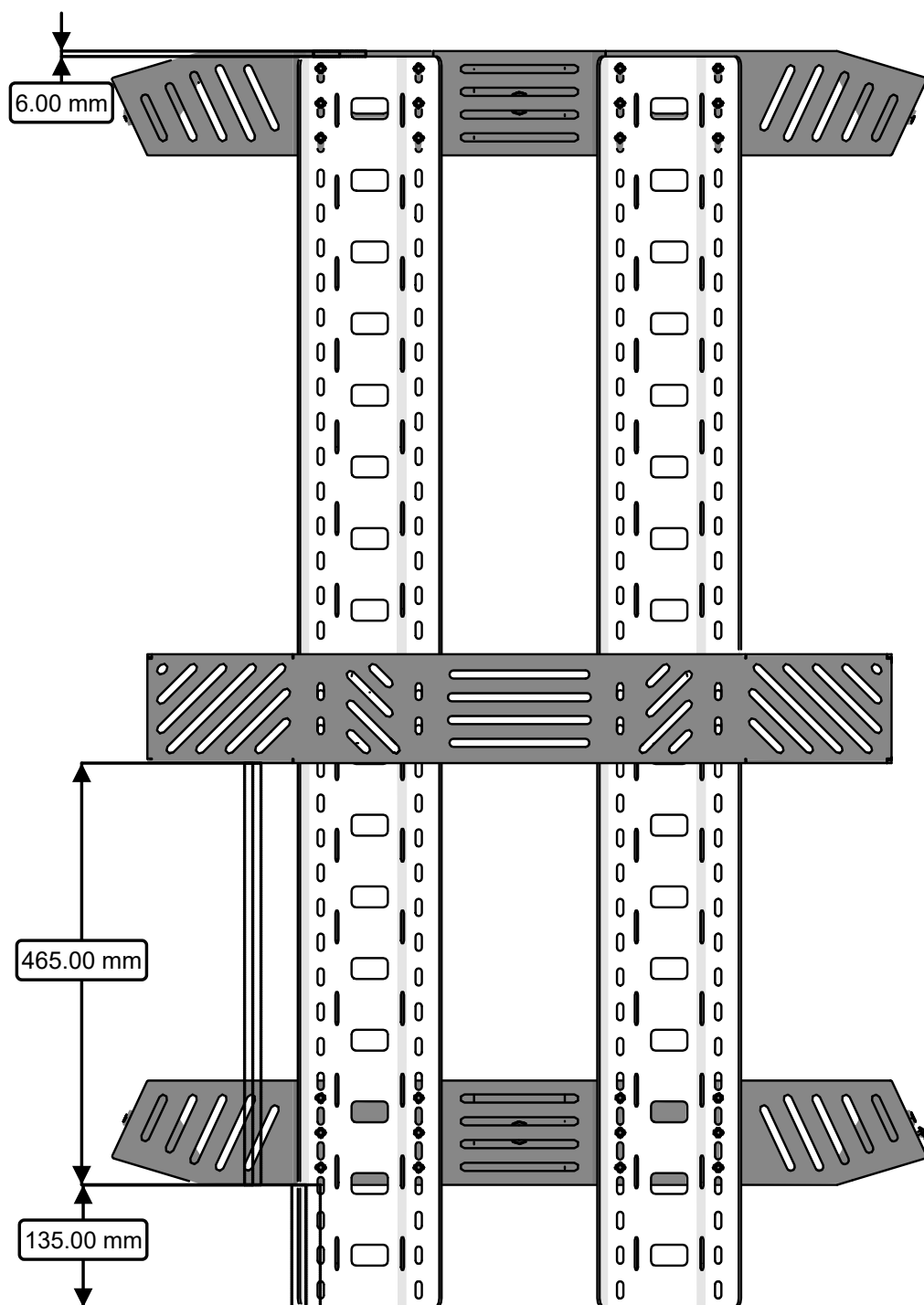

1



Bracket A1 x4



Bracket A2 x4

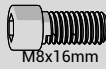

M8x16mm

SH-M8-16 x6



WL-M8 x6



WF-M8 x6



NF-M16 x6

NOTE:

Loosely Secure Bracket A1 in the middle so it can be adjusted to fit the position of the cockpit.

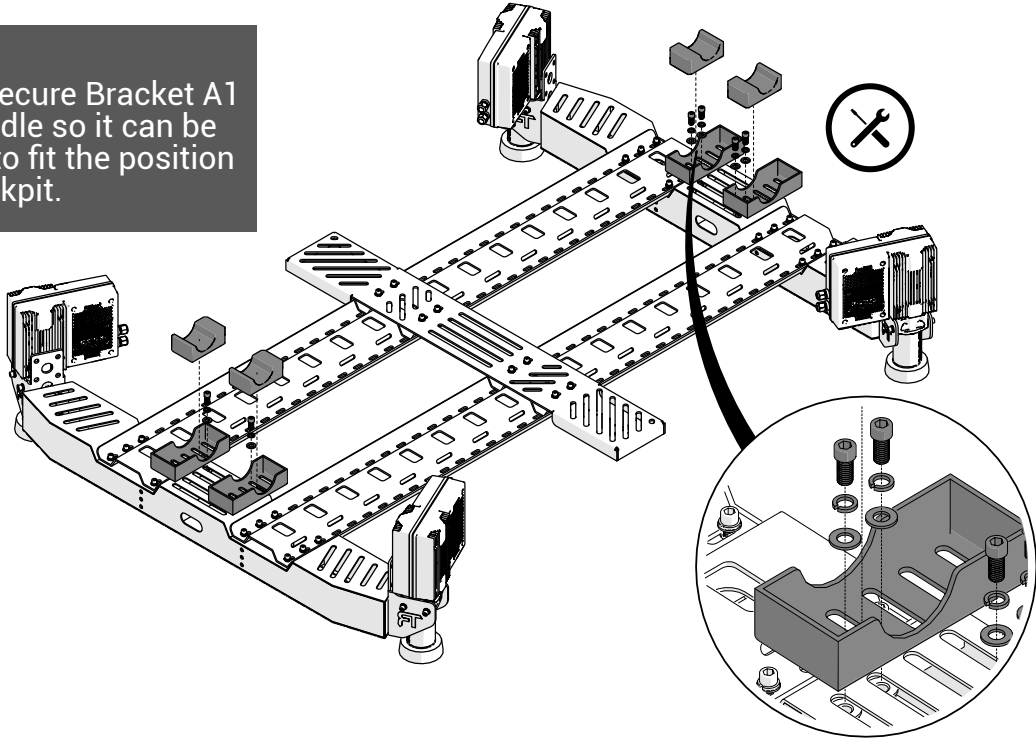

2



Bracket B2 x2



M8x65mm



M8x16mm

SH-M8-65 x4

SH-M8-16 x6



WL-M8 x06



WF-M8 x06



NF-M8 x6

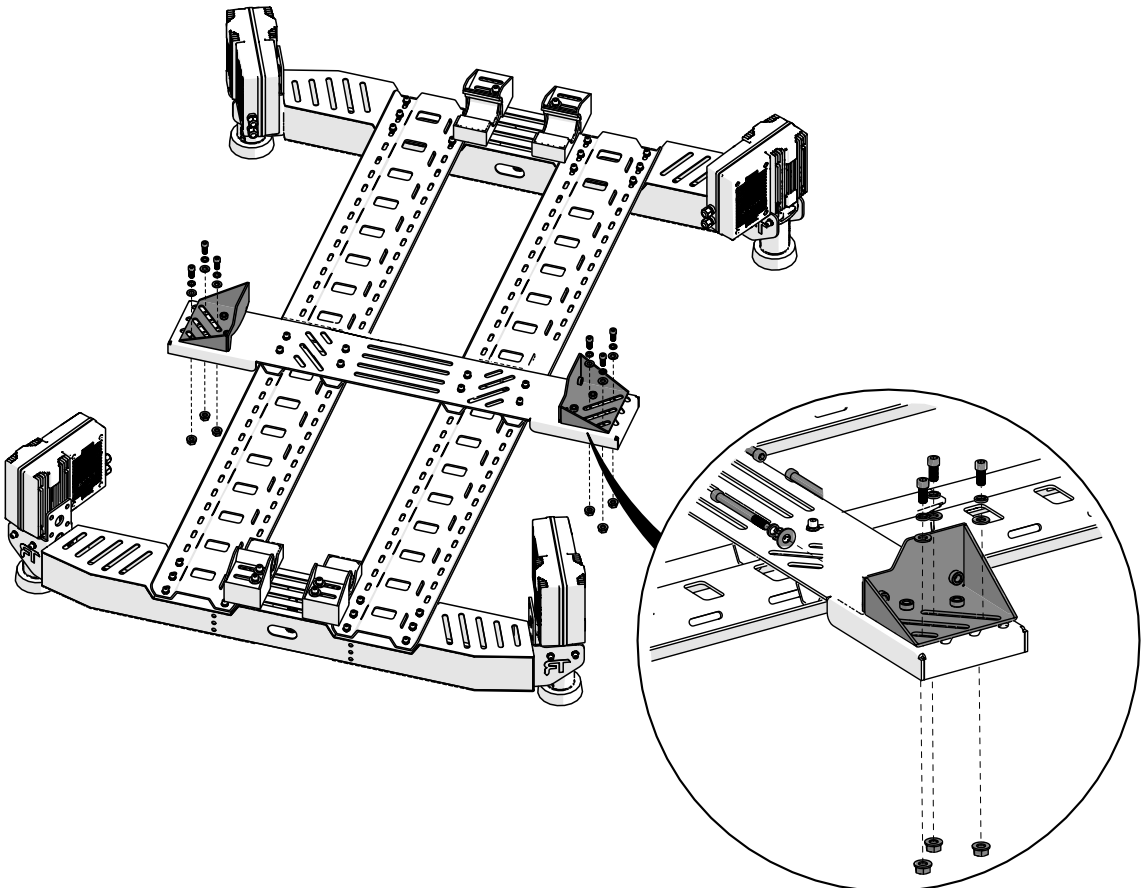

3

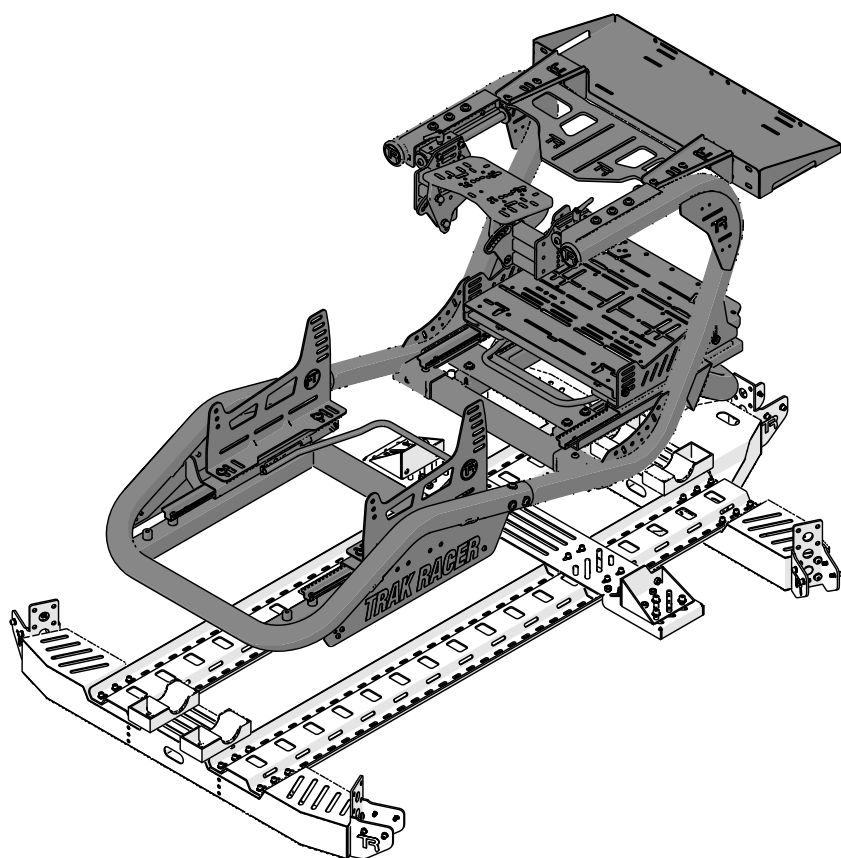

4



Bracket B1 x2



Bracket A3 x4



SH-M8-65 x06



WL-M8 x10



WF-M8 x10



NF-M16 x4

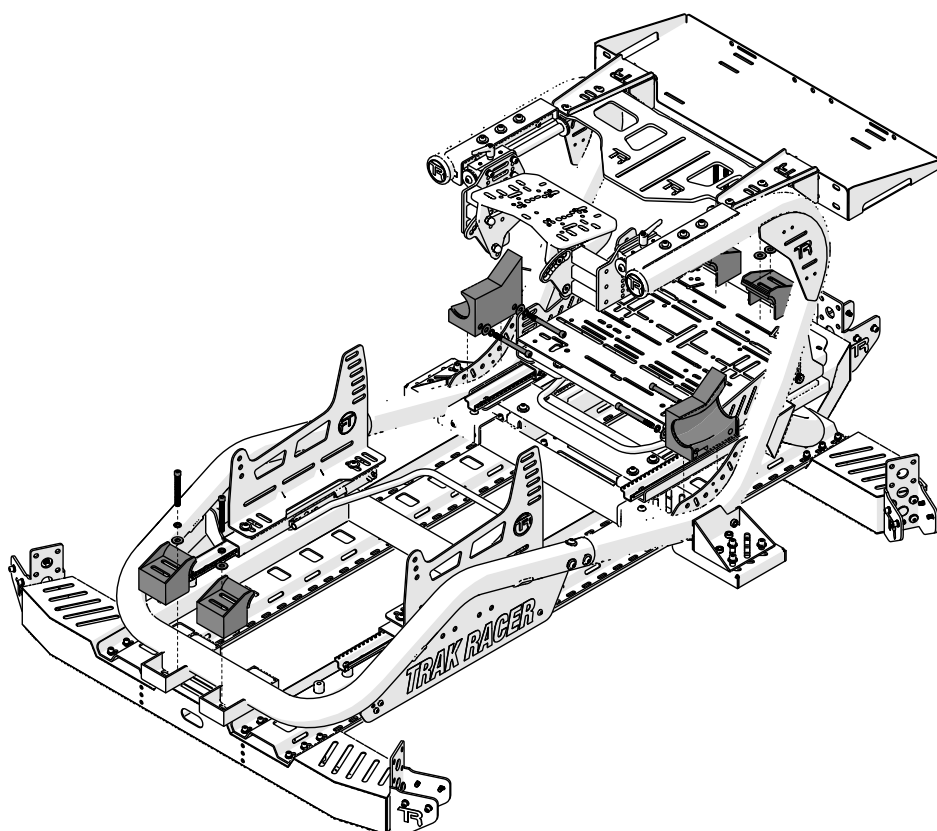

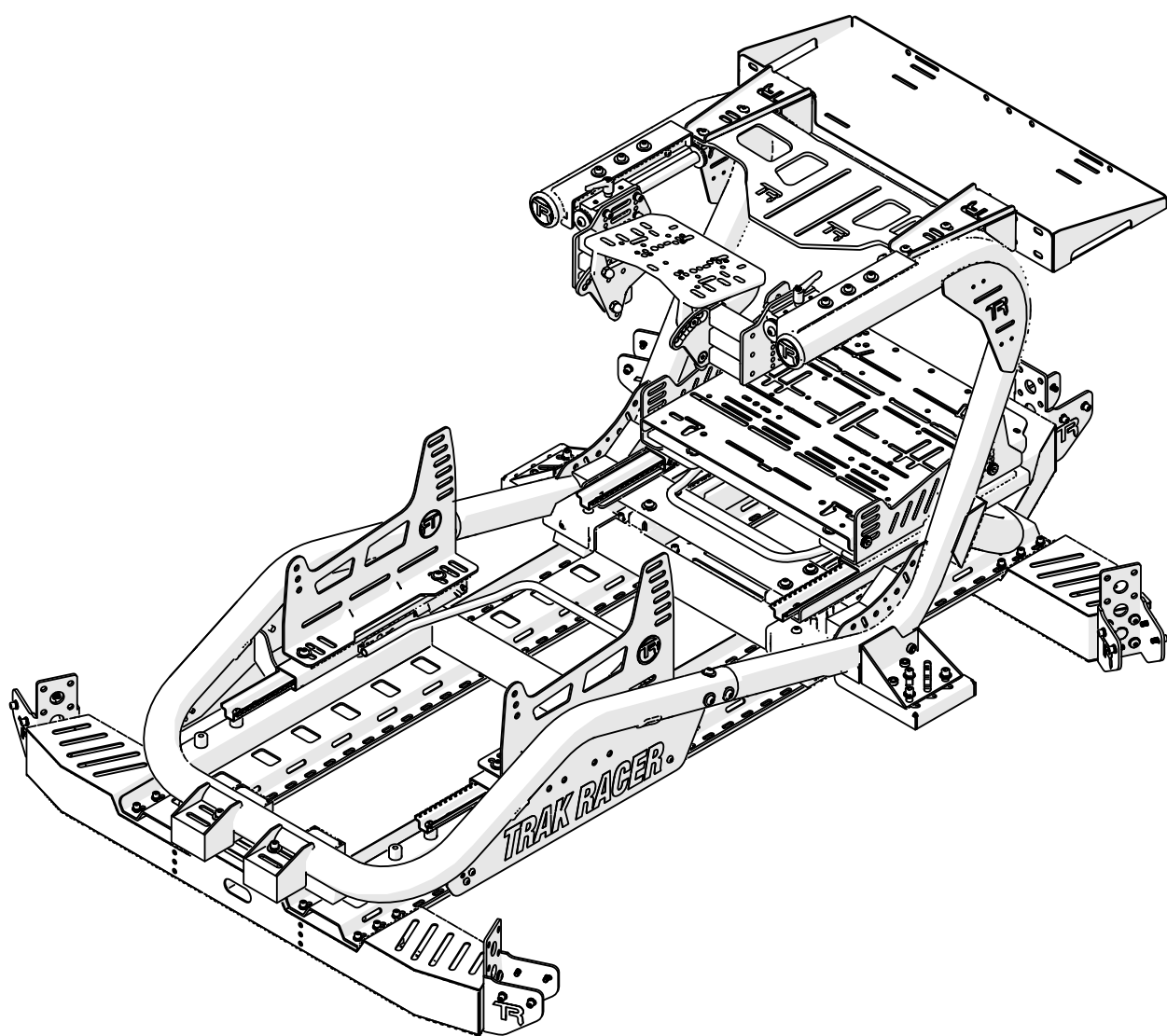

TR80 Simulator

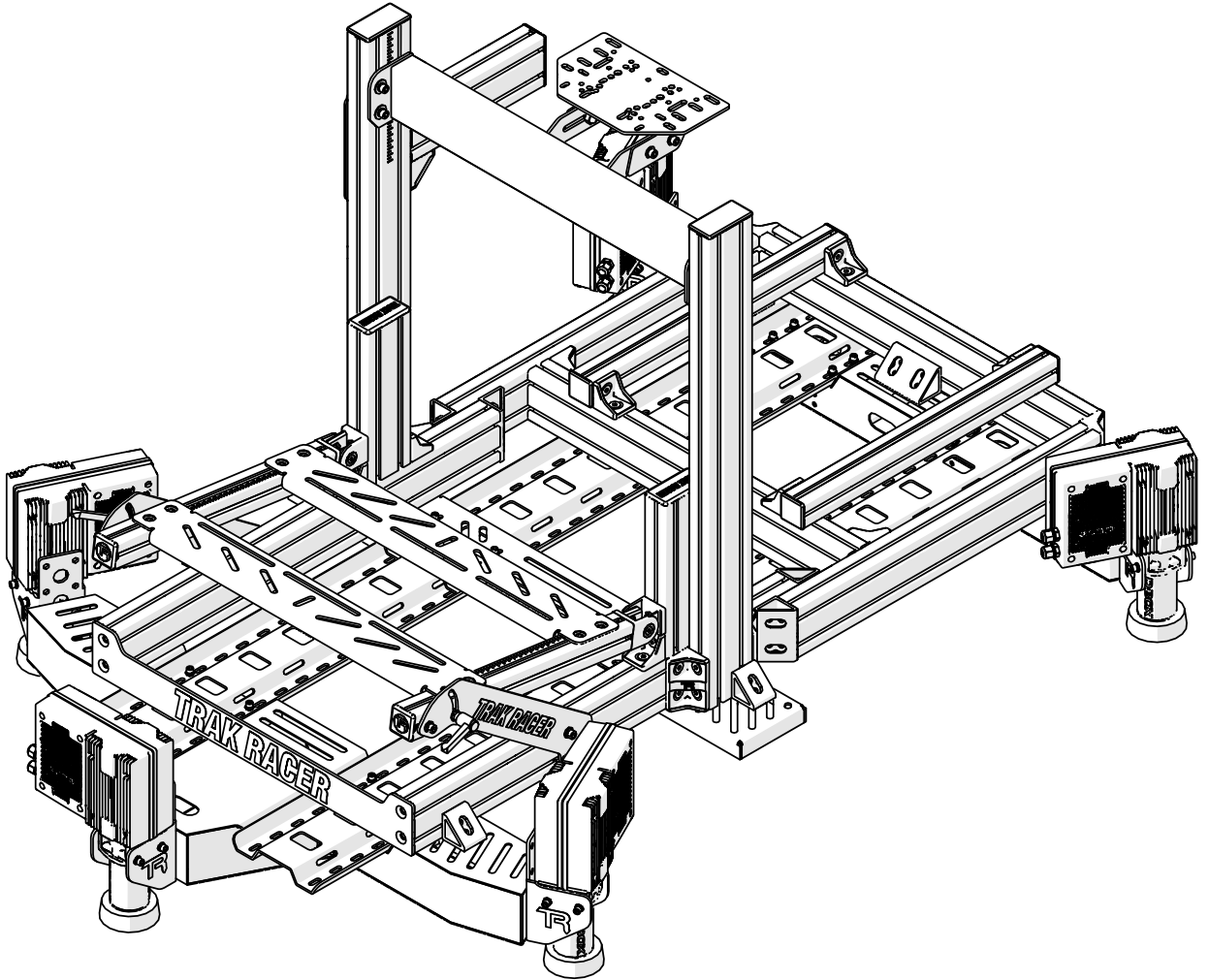

TR80 with Motion



TRAK RACER

Published 2024-04-20

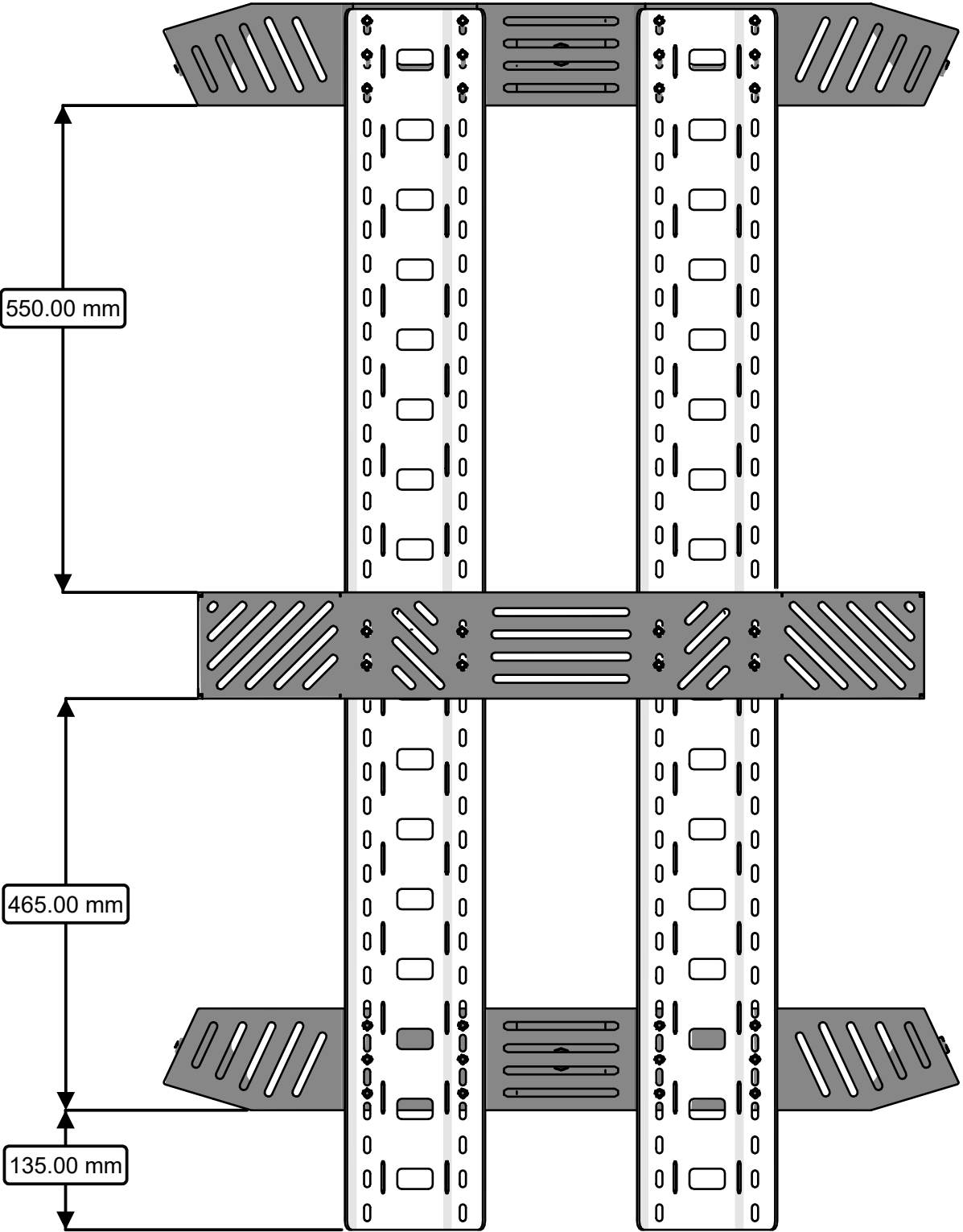

1

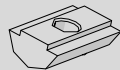

NS-M8 x08



NF-M16 x8

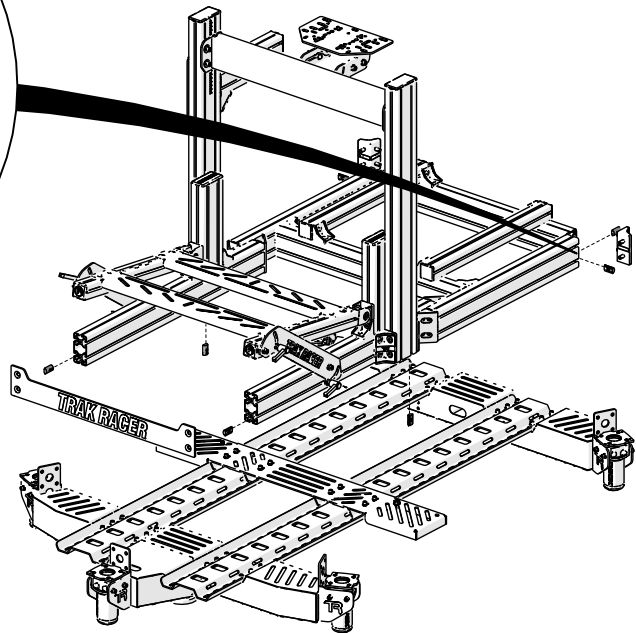
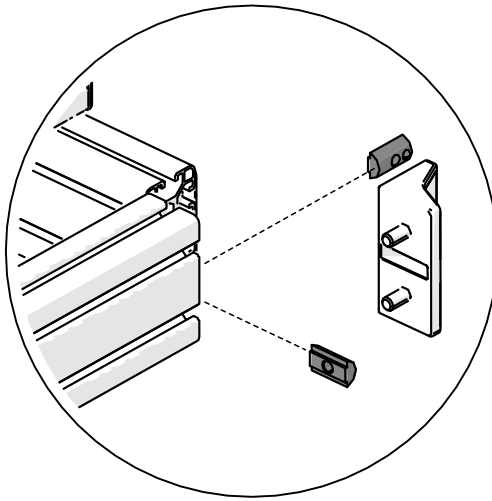

2



Corner A1 x6



Corner A2 x1

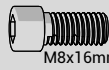

SH-M8-16 x16

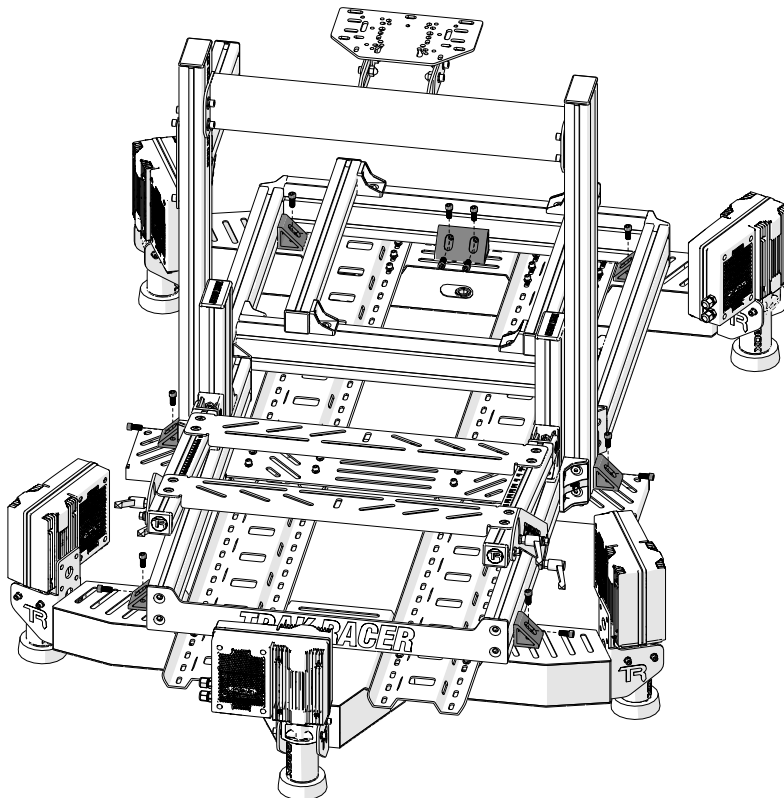

TR40 Simulator

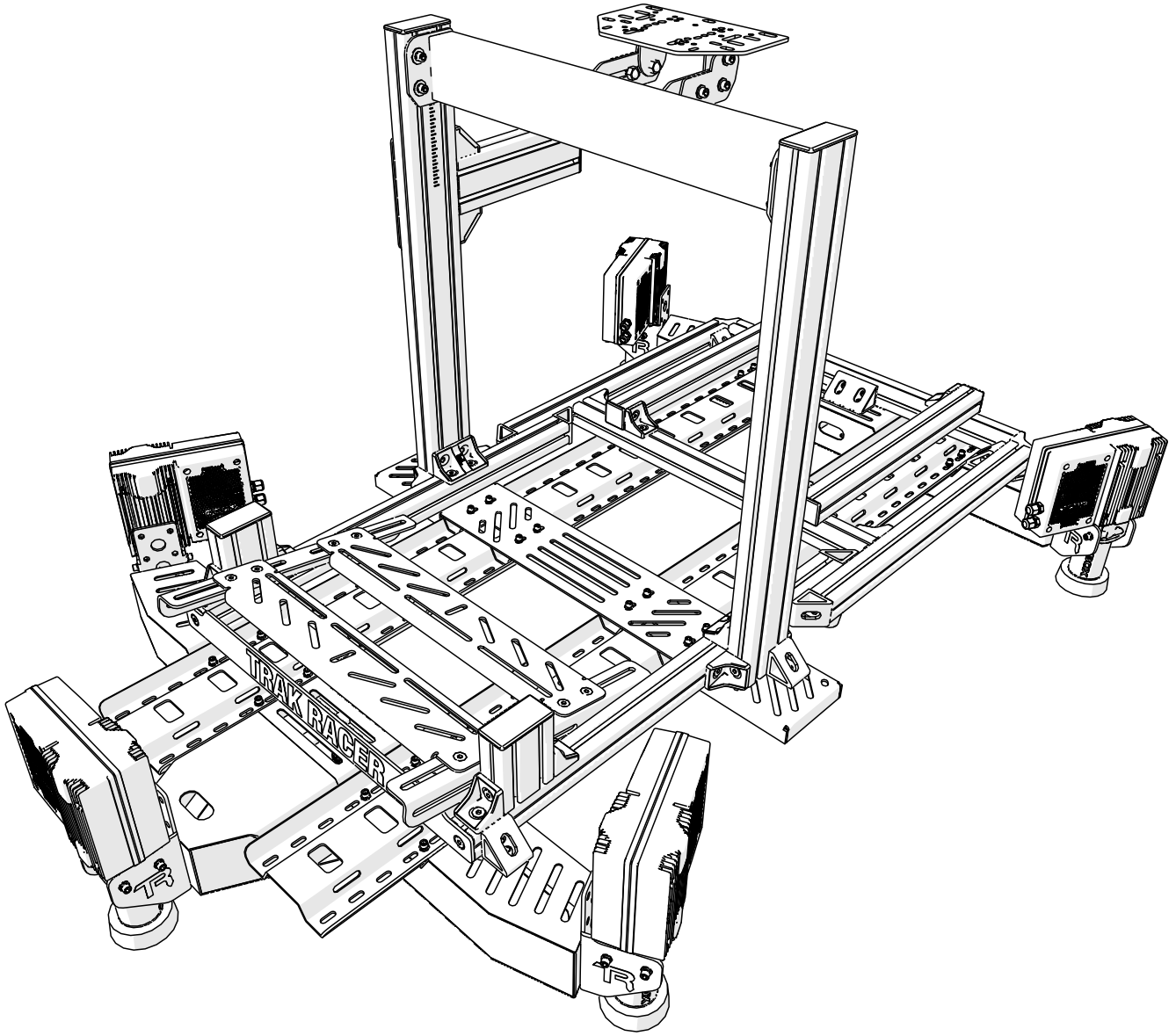

TR40 with Motion



TRAK RACER

Published 2024-04-20

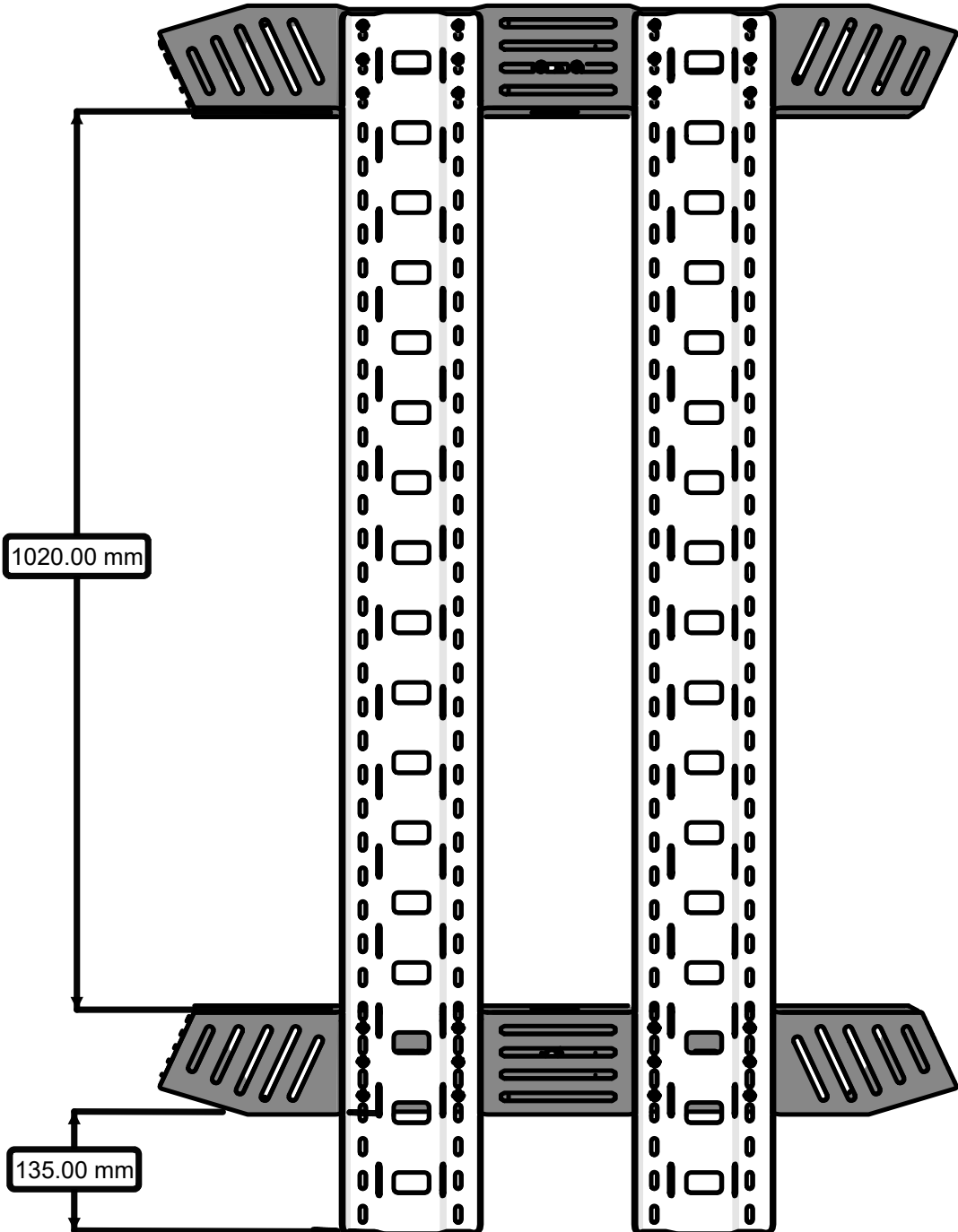

1

NS-M8 x08 NF-M16 x8

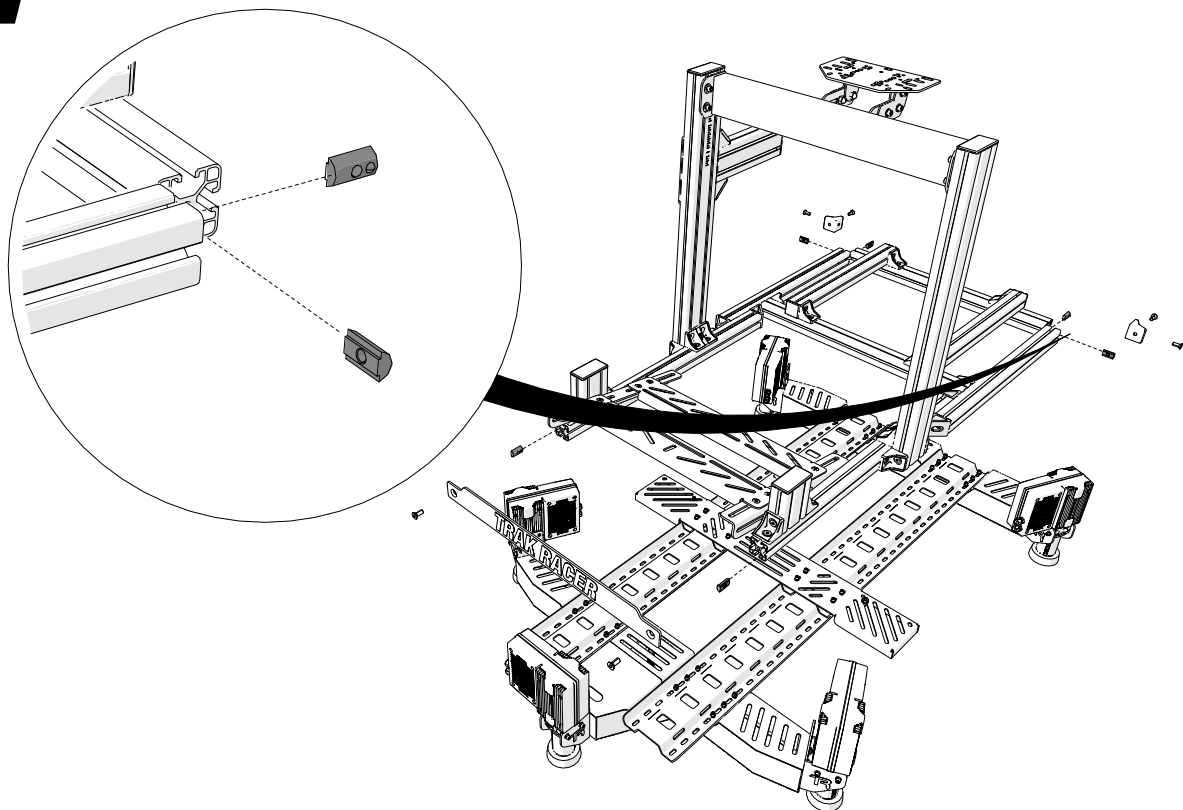

2

Corner A1 x6 Corner A2 x1 M8x16mm SH-M8-16 x16

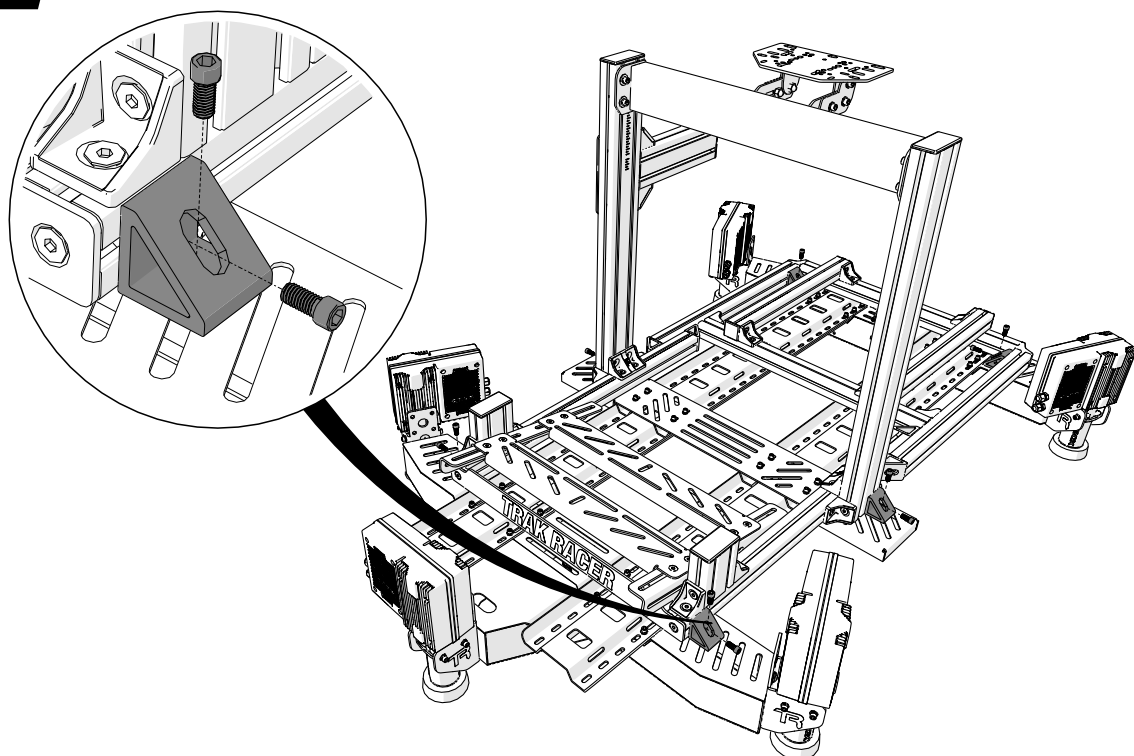

FINISHED

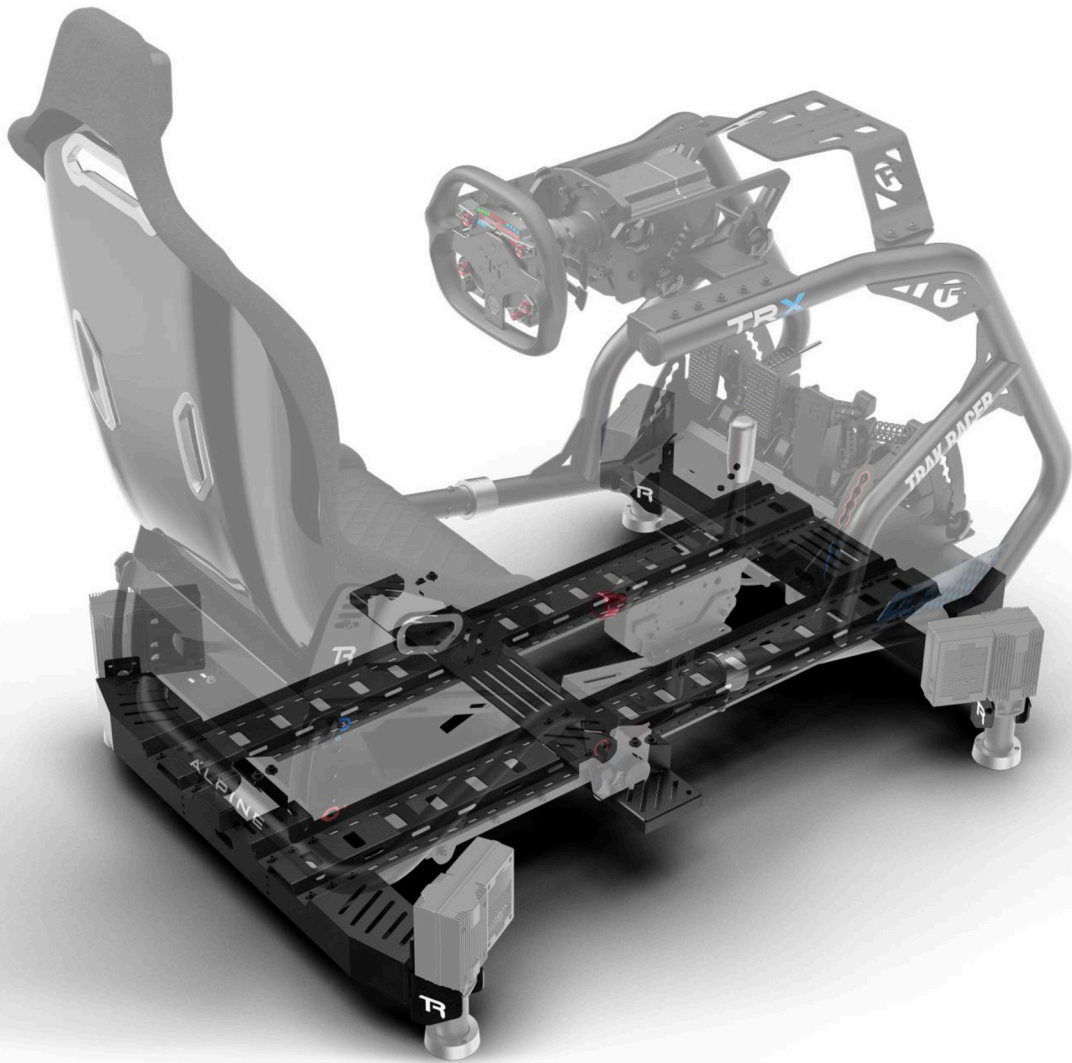

Share your build online and tag us to be featured!



@trakracer



@trakracer



@trak_racer