

# RS6, TRX, TR8 TR40 & TR80 -MOTION

## *Assembly Guide*

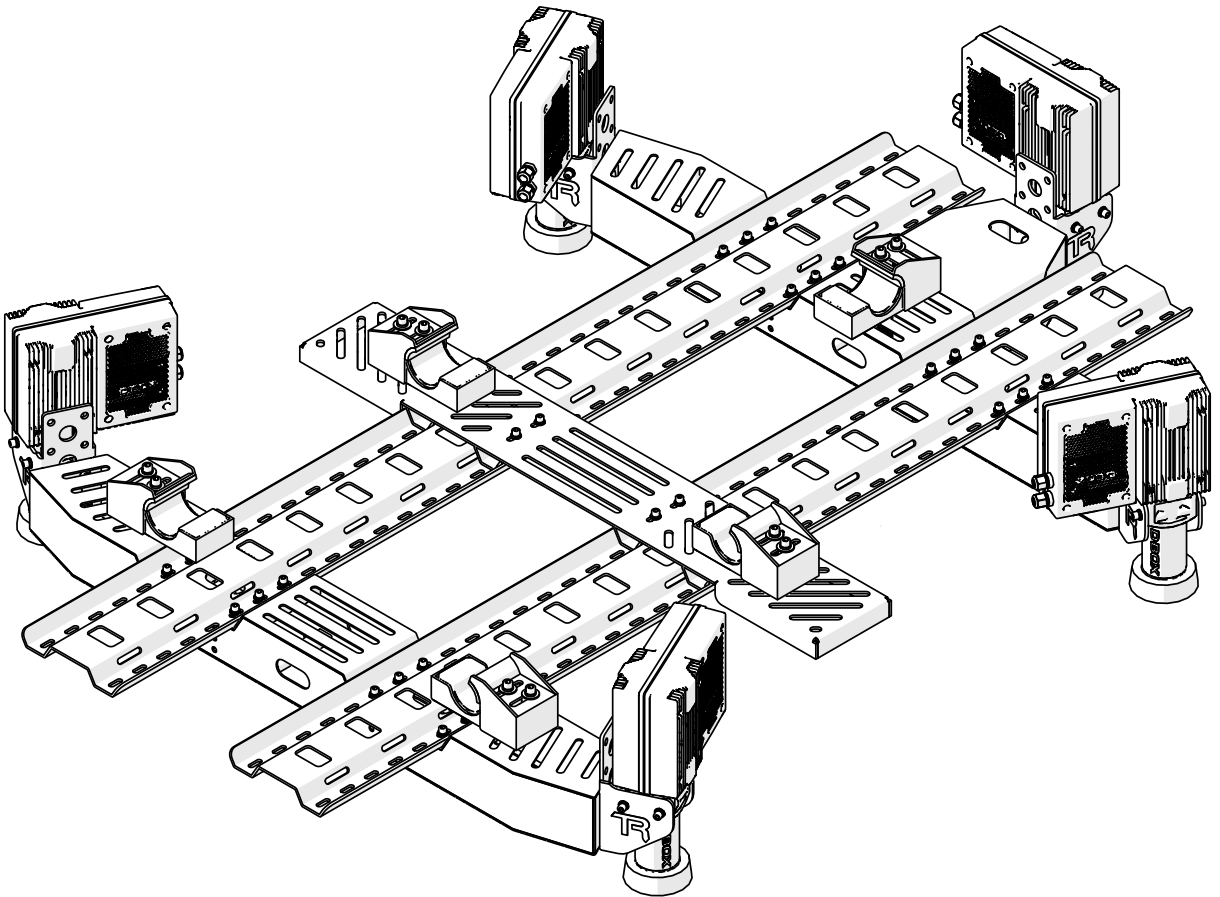

**IMPORTANT:** As there are different versions of each rig depending on your region, please ensure that you are using the correct instruction set. The part number below should match the part number labeled on your box

**TR-MOVE**



**TRAK RACER**

Published 2024-04-20

# TABLE OF CONTENTS

3 Symbol Legend

---

4 Part list

---

8 Compatibilities and Options

---

9 Configurations

---

10 Mounting Bracket Assembly Instructions

---

13 Main Chassis For 4 Motion Motors

---

15 Main Chassis For 3 Motion Motors

---

18 Main Chassis For 2 Motion Motors

---

22 Simulator Assembly Instruction

---

22 RS6 Simulator

27 TRX Simulator

31 TR8 Simulator

36 TR80 Simulator

39 TR40 Simulator



**IMPORTANT:** As there are different versions of each rig depending on your region, please ensure that you are using the correct instruction set. The part number below should match the part number labeled on your box



**IMPORTANT:** Due to the nature of cut aluminium profile, some metal shavings may still be present after our extensive QA cleaning process. We recommend that boxes and packaging is opened on a hard floor.



**NOTE:** Some screws and washers are pre-installed. These will be part of the parts list and will need to be loosened and reattached according to the instructions.



Two people needed



Tighten hardware



Leave hardware loose for adjustment

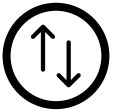

Make Adjustment



Break tab off Corner bracket CB1



Safety glasses needed



Attention / Priority



Reserve for following step



Mirrored Components (Same on both sides)

# PART LISTS

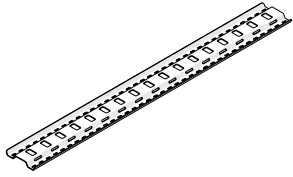

Main A x2

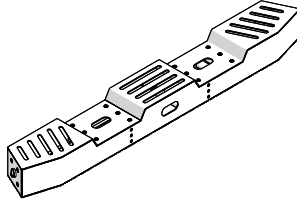

Main B x2

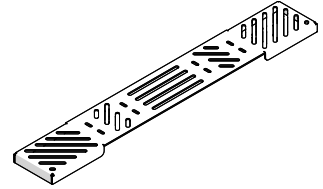

Main C x1

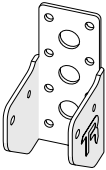

Motor Bracket x4

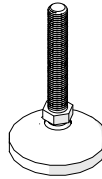

Ball Joint x1

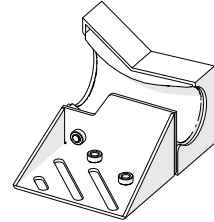

Bracket B1 x2

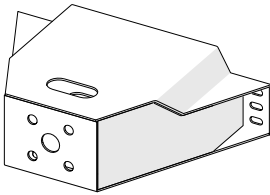

Third Motor Frame x1  
(Optional)

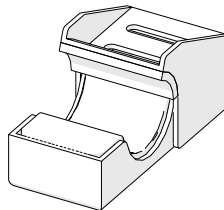

Bracket A1 x3



# PART LISTS



**NOTE:** Some screws and washers are pre-installed. These will be part of the parts list and will need to be loosened and reattached according to the instructions.

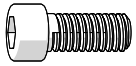

**M6-16 x40**  
Screw (Hex), M8x16mm

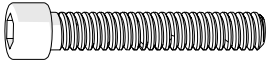

**M6-35 x8**  
Screw (Hex), M8x16mm

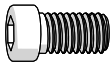

**M8-12 x8**  
Screw (Hex), M8x12mm

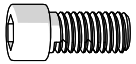

**M8-16 x7**  
Screw (Hex), M8x16mm

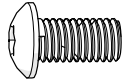

**M8-15 x16**  
Screw (Round), M8x15mm

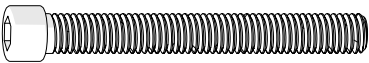

**M8-65 x12**  
Screw (Hex), M8x65mm

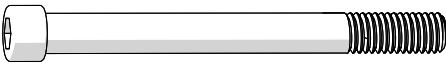

**M8-80 x4**  
Screw (Hex), M8x80mm

## INCLUDED TOOLS

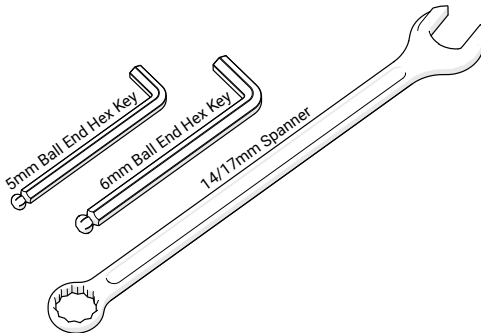

## INSTALLATION ORDER FOR SCREWS

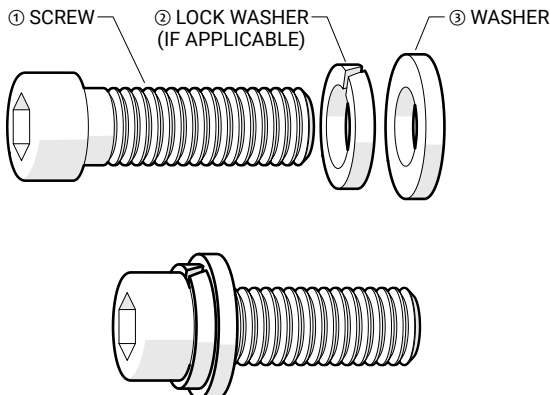

**FW-M6 x6**  
Nut, M6



**FW-M8 x8**  
Nut, M8



**FW-M8 x16**  
Nut (Flange), M8



**FW-M16 x1**  
Nut (Flange), M16

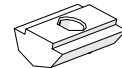

**NS-M8 x16**



**WF-M6 x48**  
Washer (Lock), M6



**W-M6-12 x48**  
Washer (FLAT), M6x12



**WF-M8 x46**  
Washer (Lock), M8



**W-M8-20 x30**  
Washer (FLAT), M8x20



**WC-M8 x16**  
Washer, M8x16

## HOW TO MEASURE SCREWS

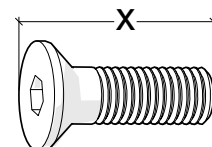

FLAT SCREW

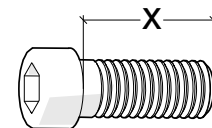

HEX SCREW

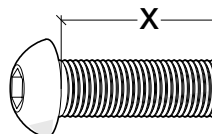

BUTTON SCREW

# PART LISTS

## Trak Racer RSX Mounting Bracket

### Bracket A

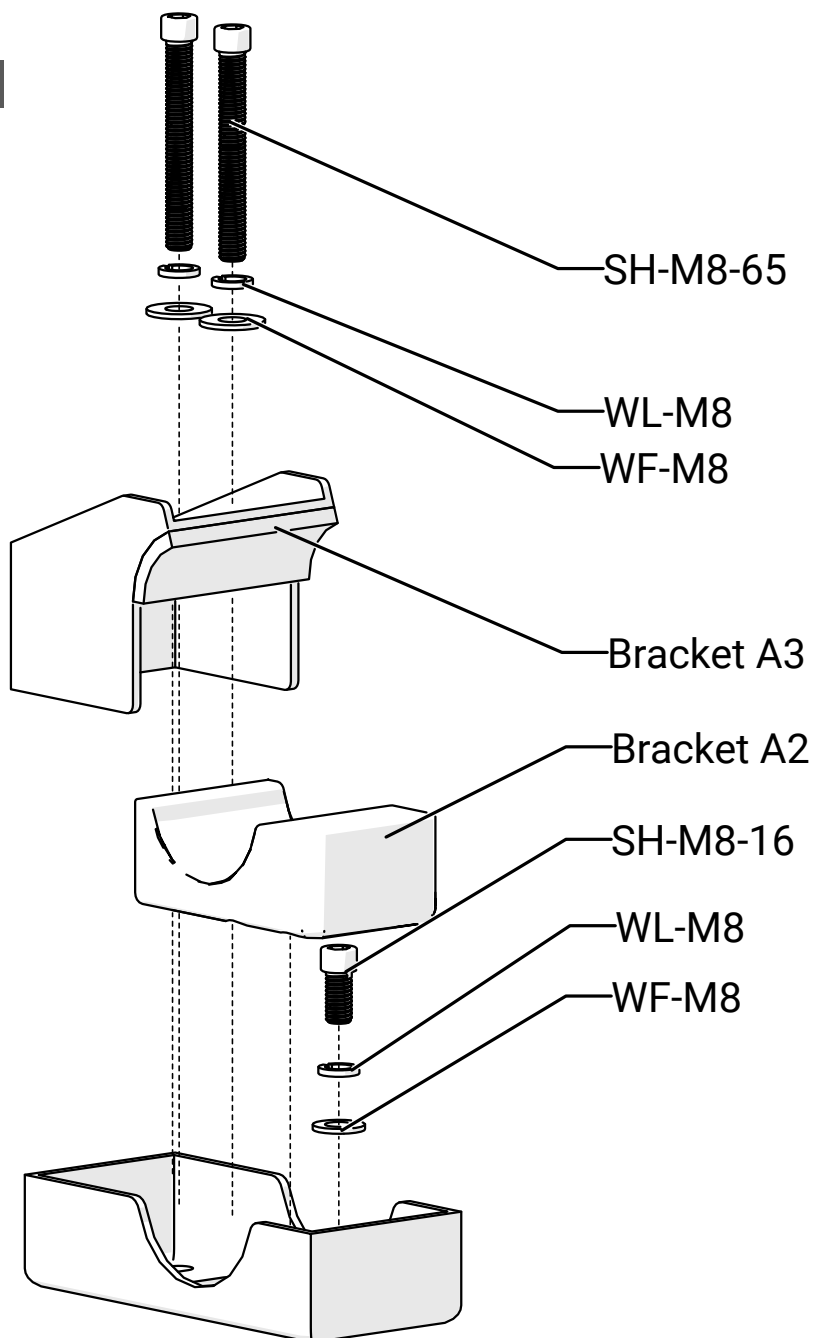

# PART LISTS

## Bracket B

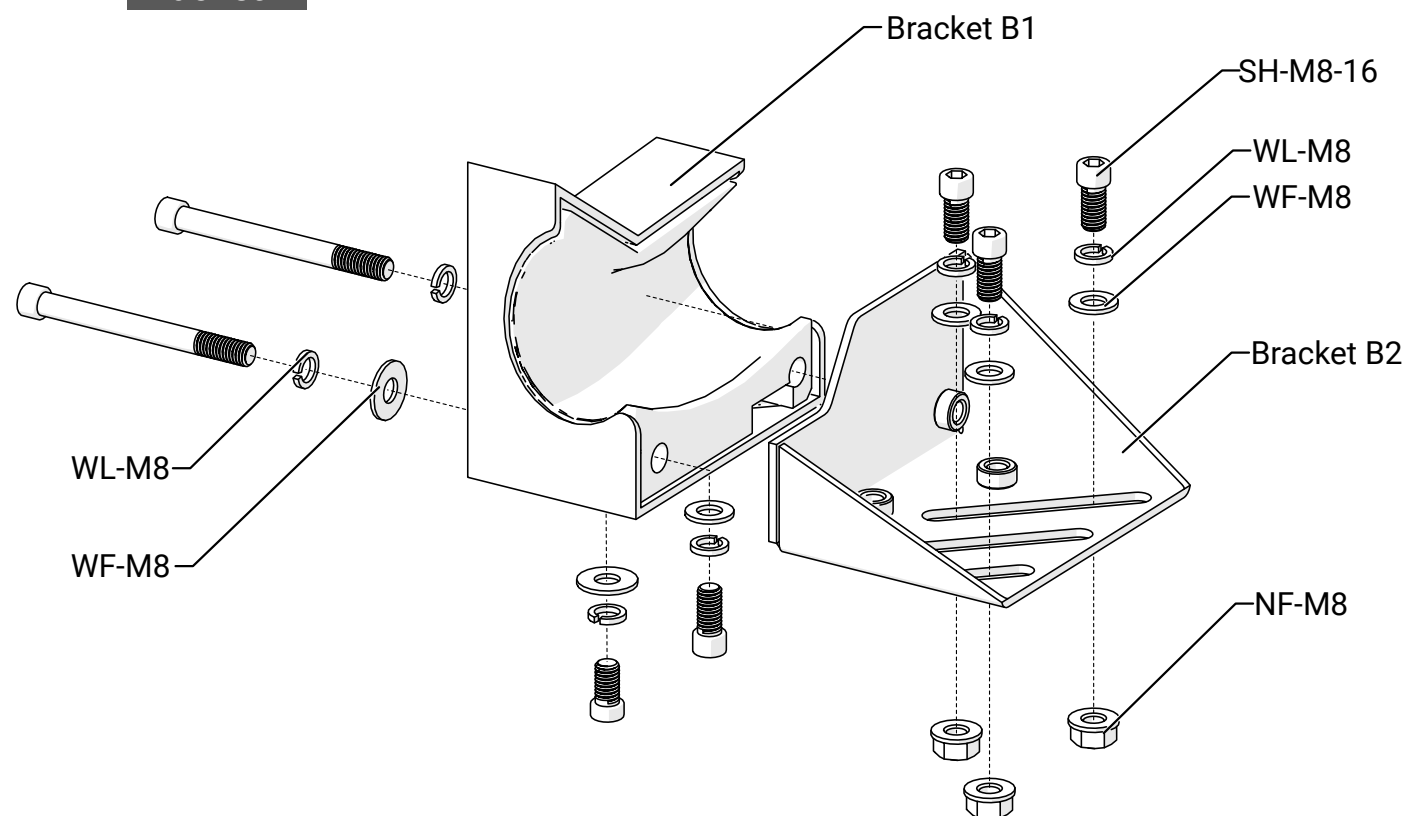

# Capabilities & Options

The TR Move motion platform has been designed to fit all of Trak Racers frames including the TRX, TR8, TR8 Pro, RS6 as a large range of other brandes rigs. Please contact out support for compability questions.

**Note:**

For extruded aluminium framse, it's recommended that the motion Motor isi attached directly to your frame with the high-quality brackets from Trak Racer or others.

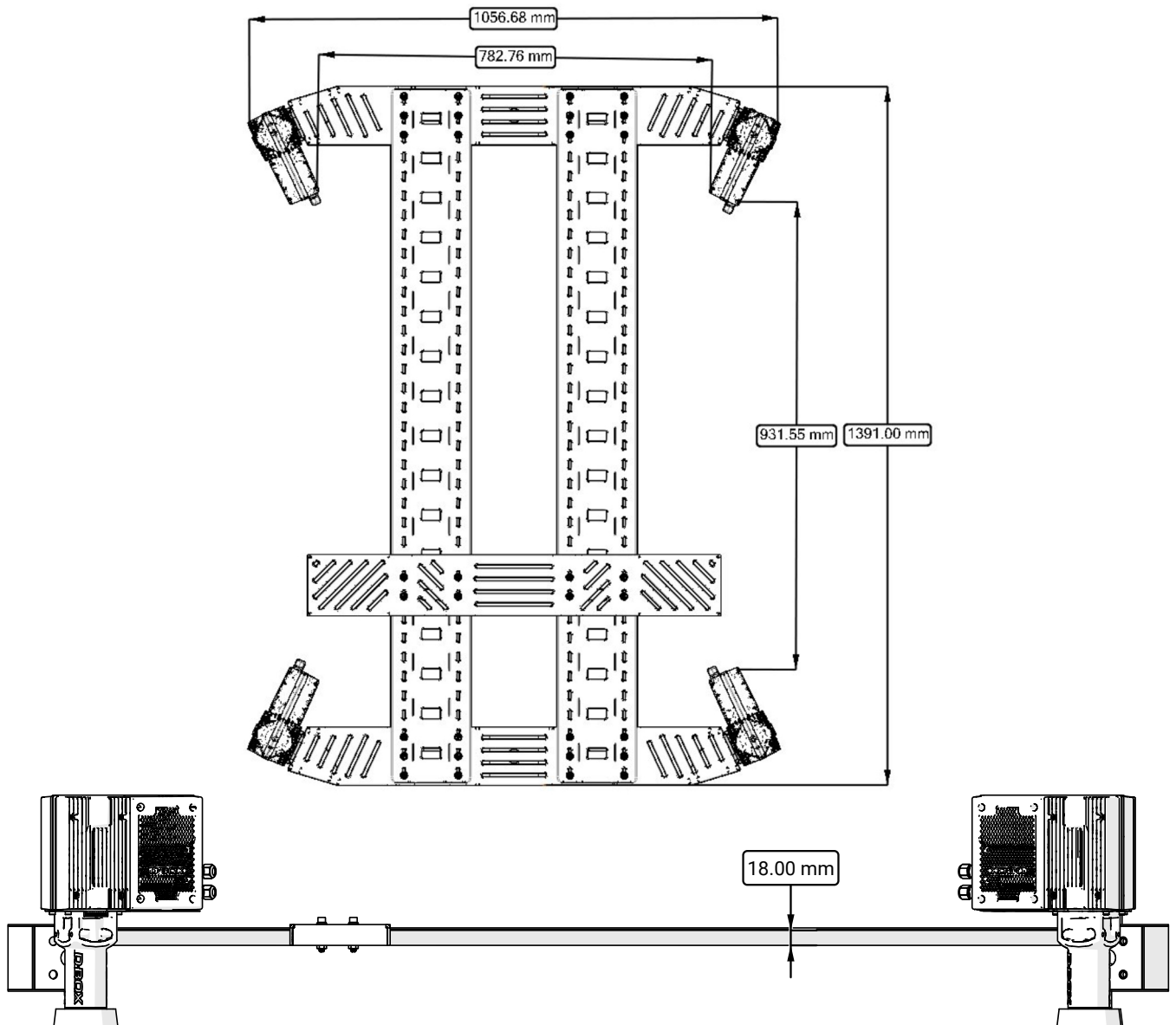

# Configurations

The TR Move Motion platform is available for 2, 3 and 4 motion motors.  
SKU TRMOVE-TRXP is ready for 2 and 4 motors while 3 motors requires SKU TRMOVE-3.

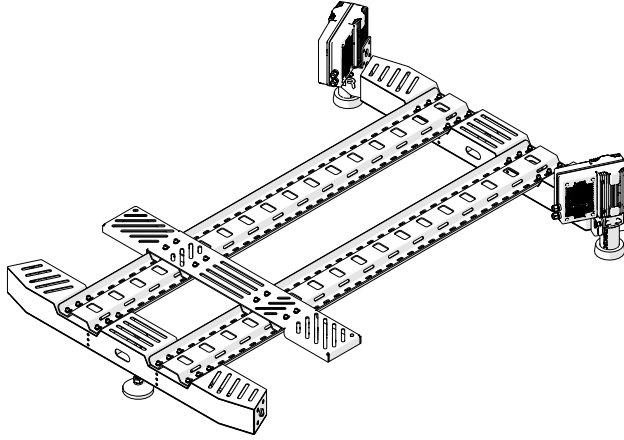

x2 Motors

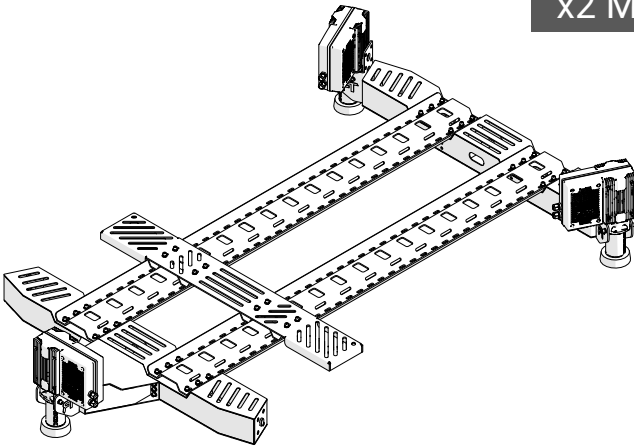

x3 Motors

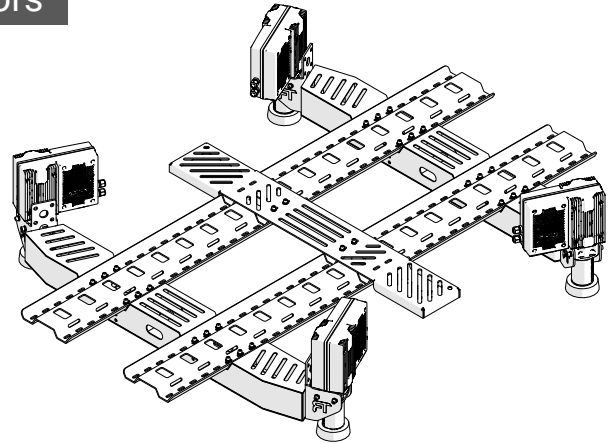

x4 Motors

# Mounting Bracket

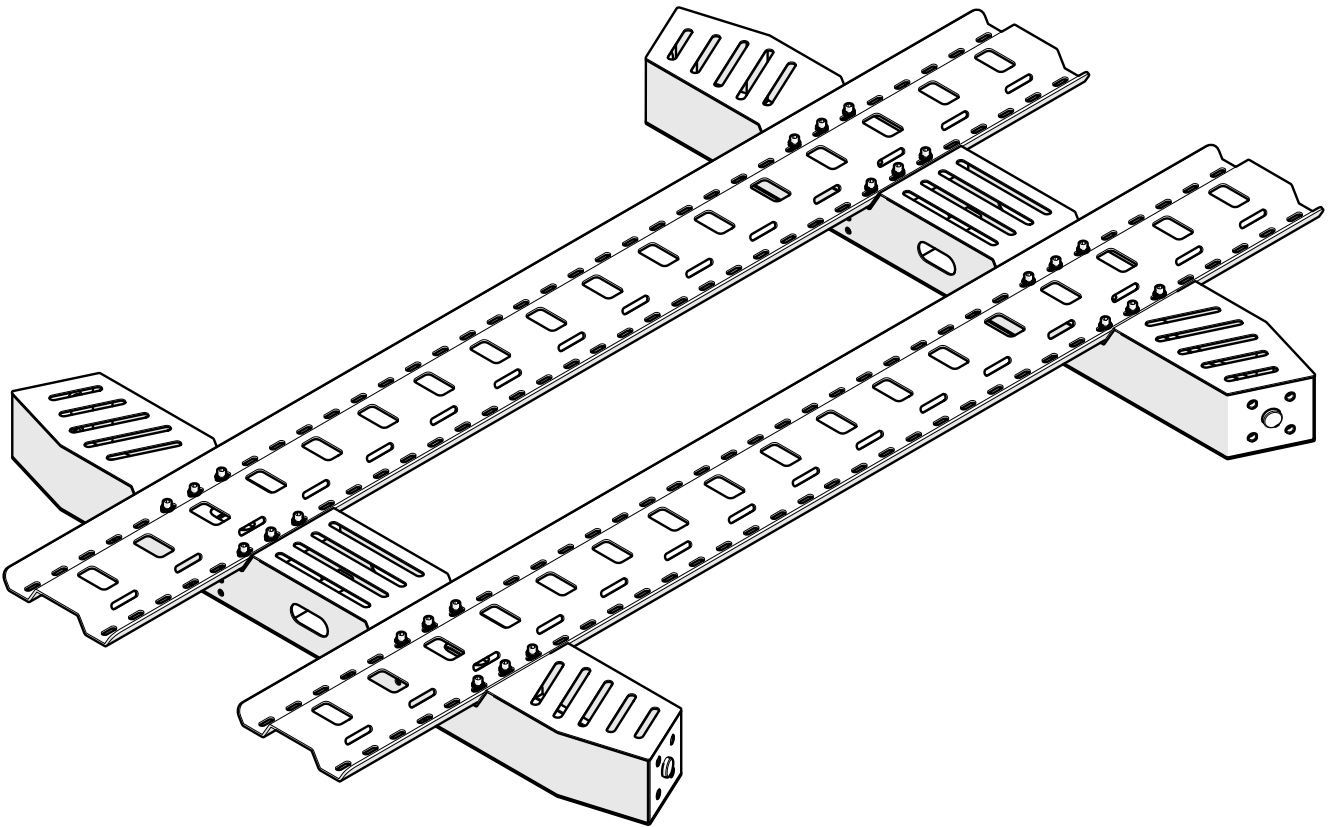

TR8



**TRAK RACER**

Published 2024-04-20

1



Main A x2

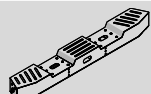

Main B x2

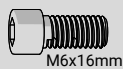

M6x16mm

SH-M6-16 x24



WL-M6 x24



WF-M6 x24

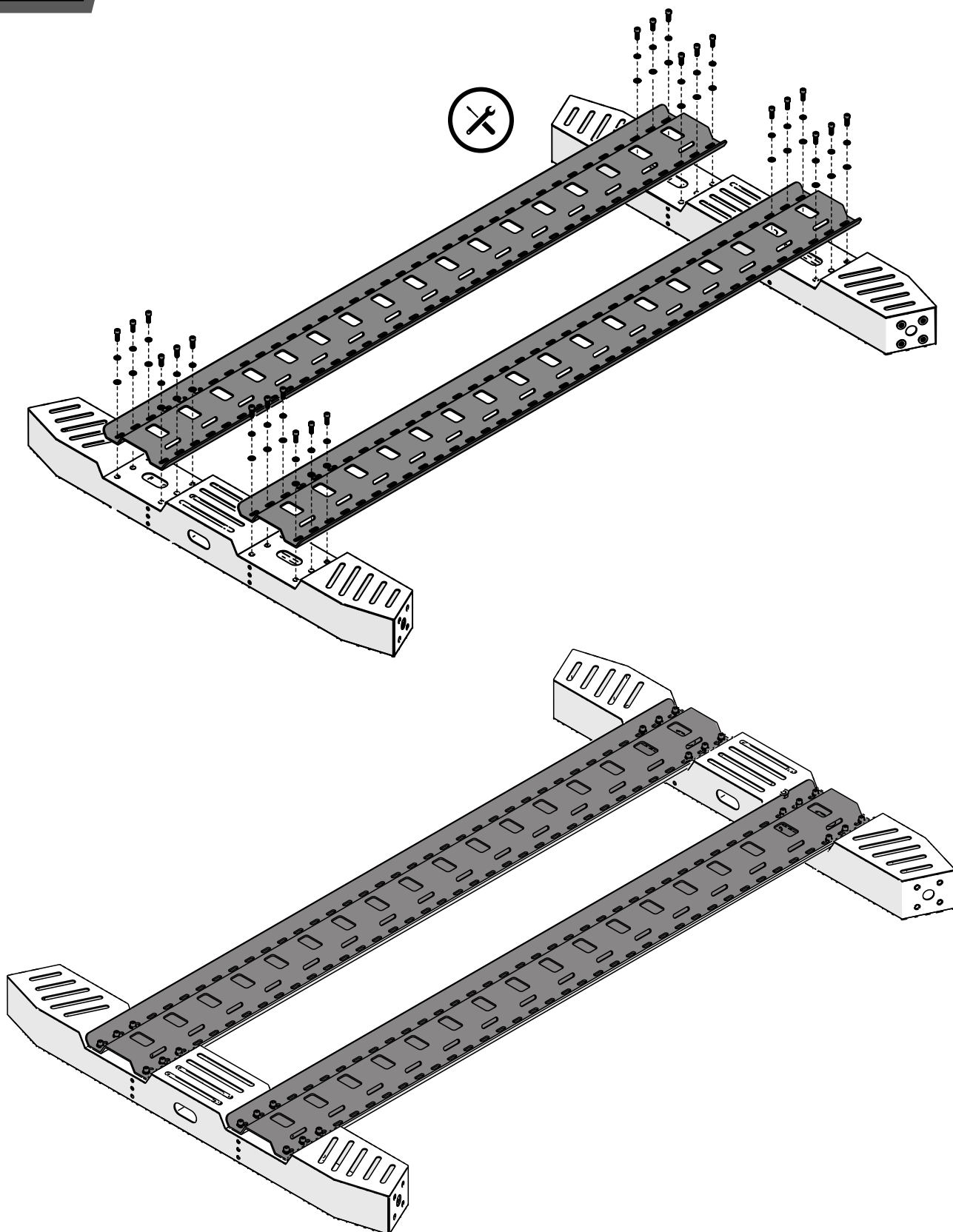

# 2

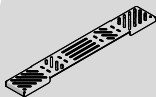

Main C x1

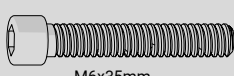

M6x35mm

SH-M6-35 x8



WL-M6 x8



WF-M6 x8



NL-M6 x8

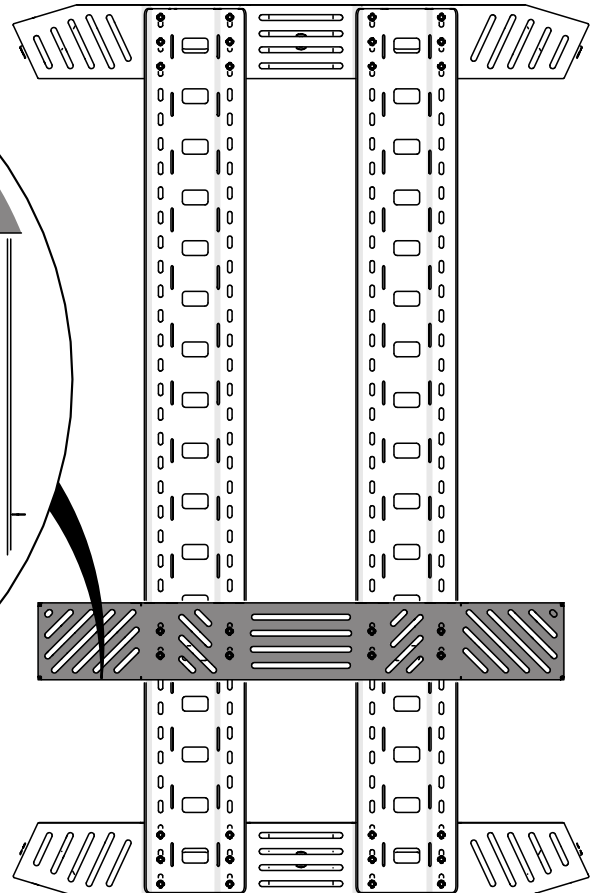
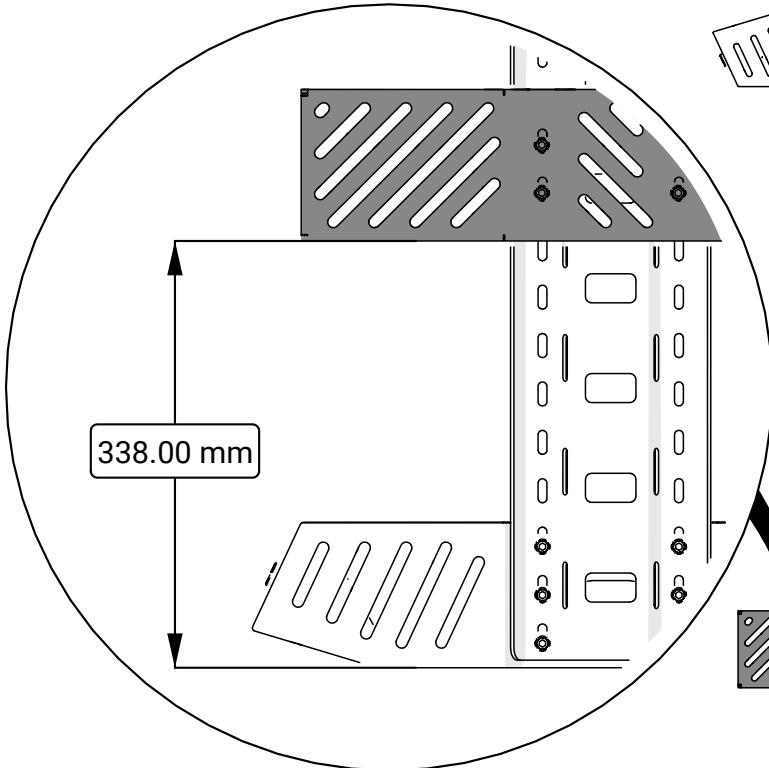
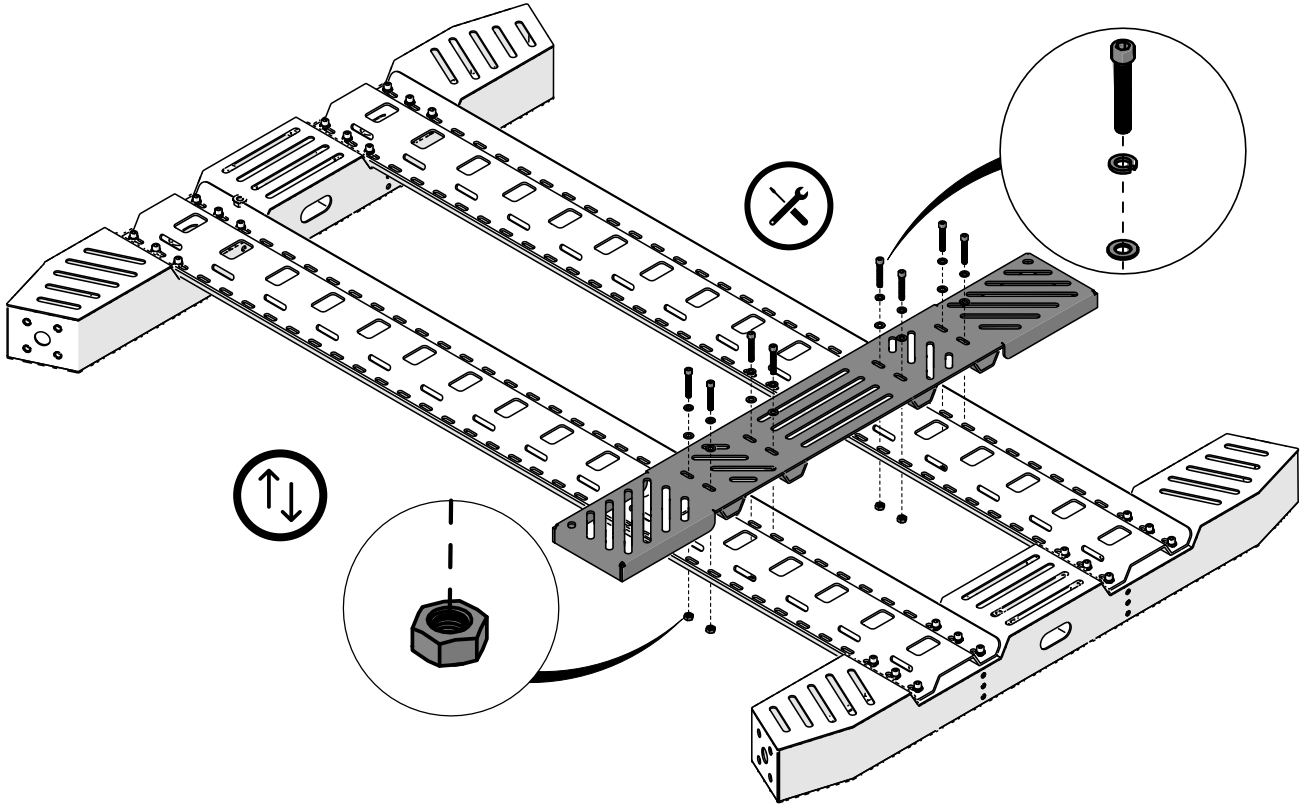



# Main Chassis For 4 Motion Motors

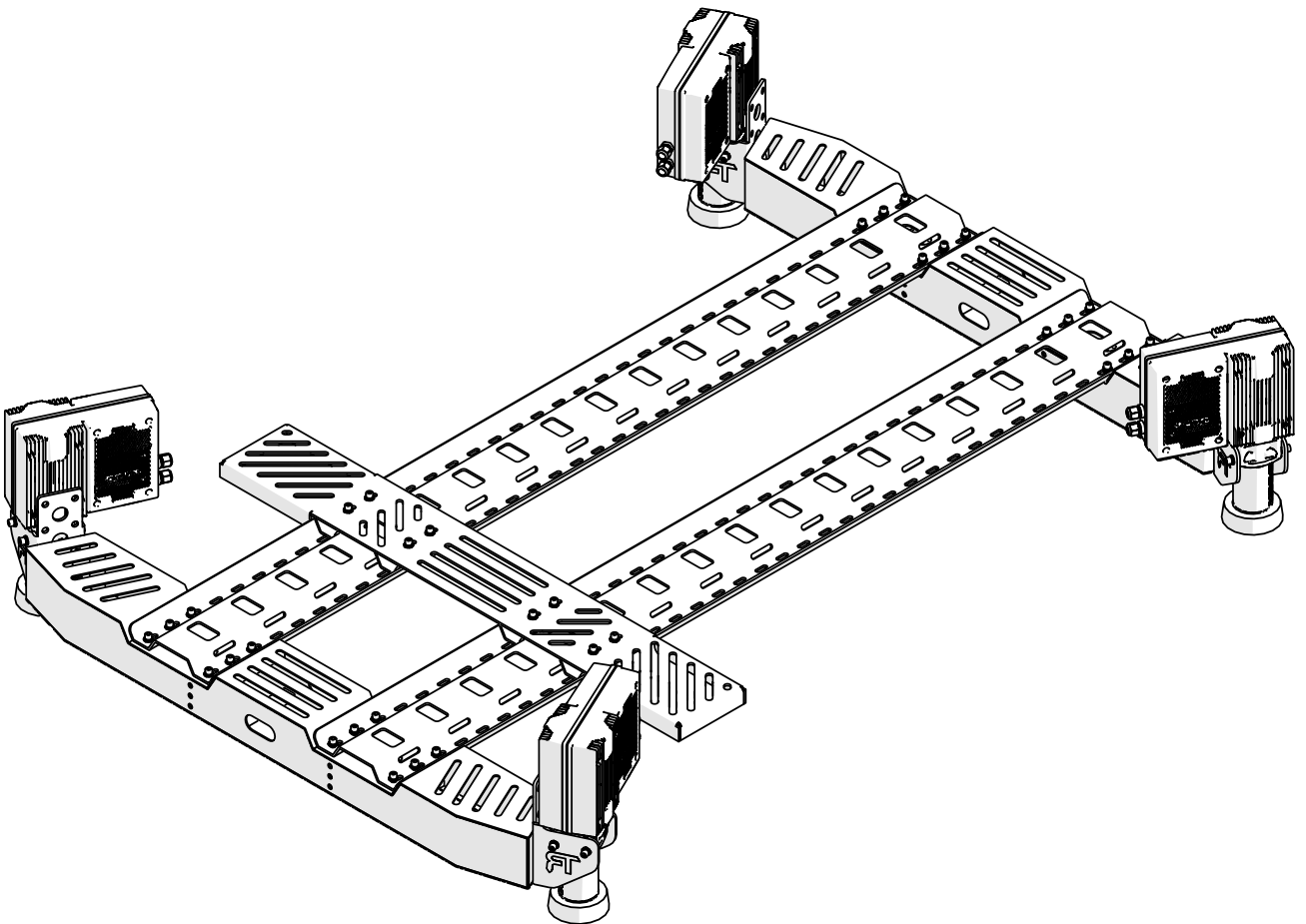

4-Motion Motors



**TRAK RACER**

Published 2024-04-20

# 1



Motor Bracket x4

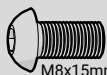

M8x15mm

Screw (Round) M8-15 x12



W-M8-16 x12

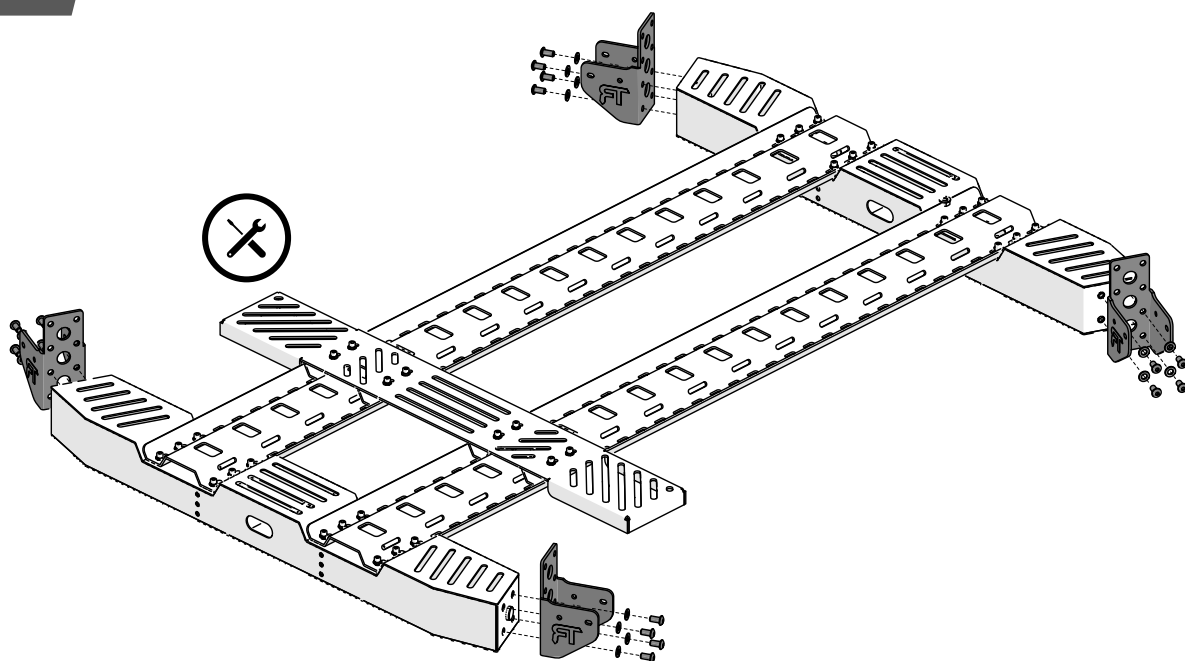

# 2

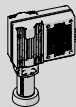

Motor Bracket x4

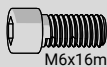

M6x16mm

SH-M6-16 x16



WL-M6 x16



WF-M6 x16

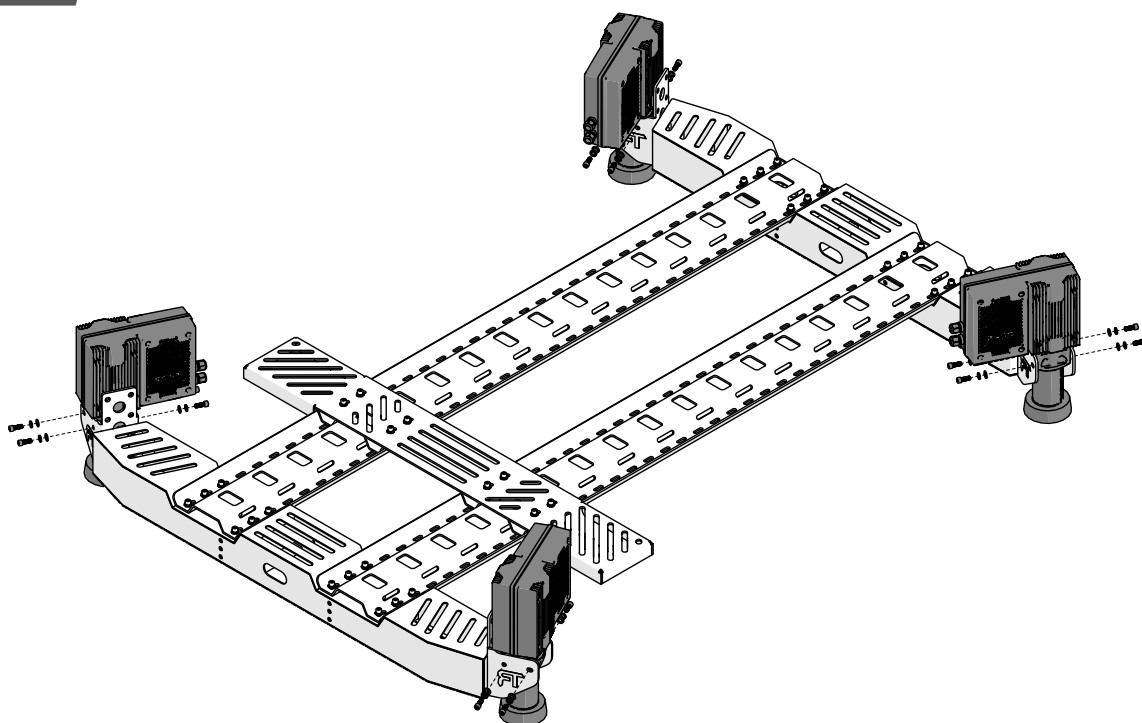

# Main Chassis For 3 Motion Motors

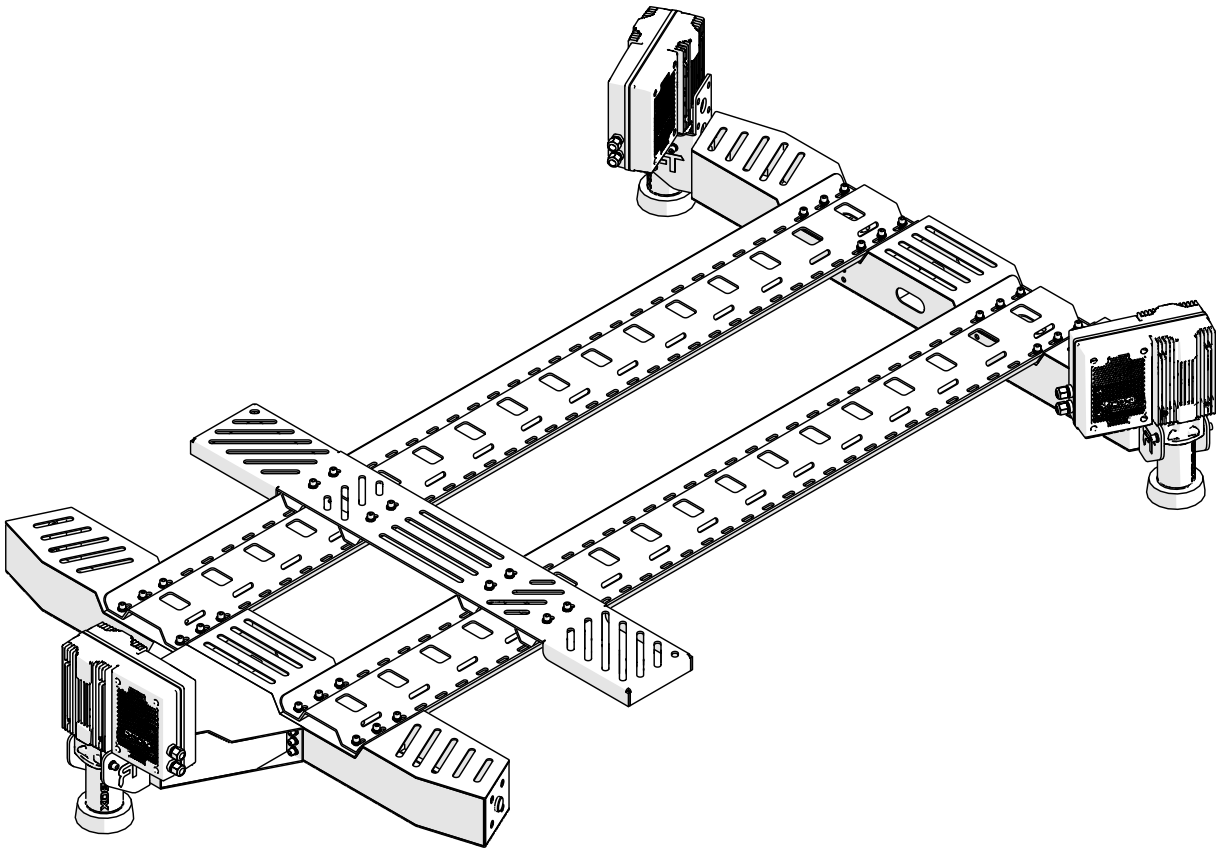

3 Motion Motors



**TRAK RACER**

Published 2024-04-20

1



Motor Bracket x2

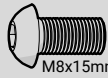

M8x15mm

Screw (Round) M8-15 x08



W-M8-16 x08

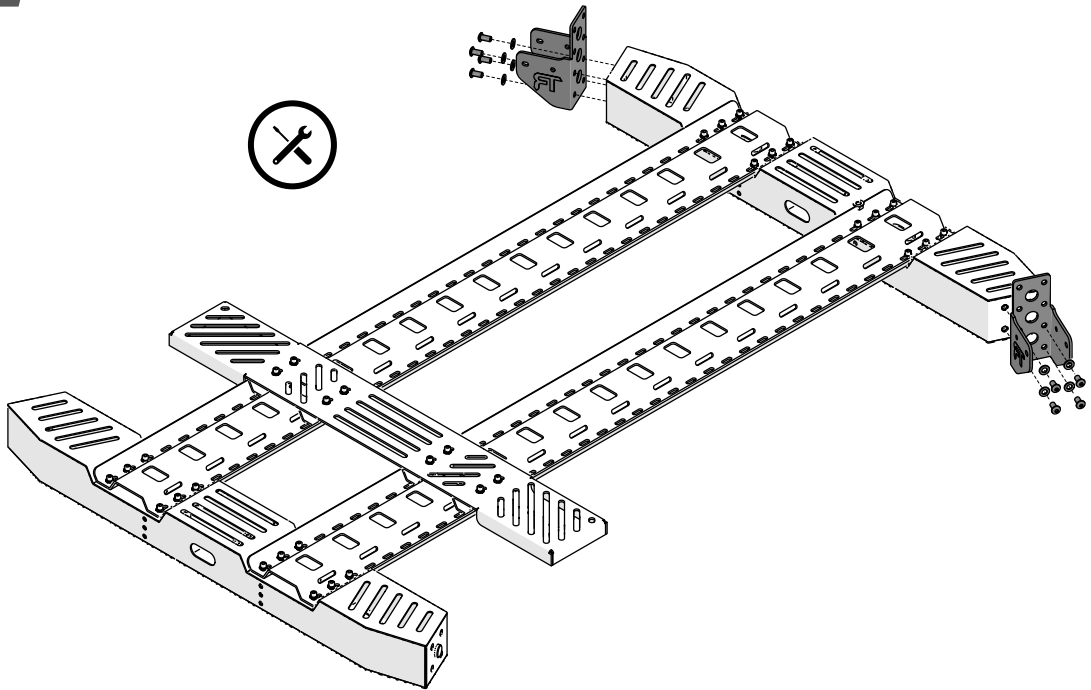

2

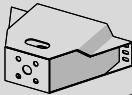

Motor Bracket x1



M6x16mm

SH-M6-16 x6



WL-M6 x6



WF-M6 x6



FW-M6 x6

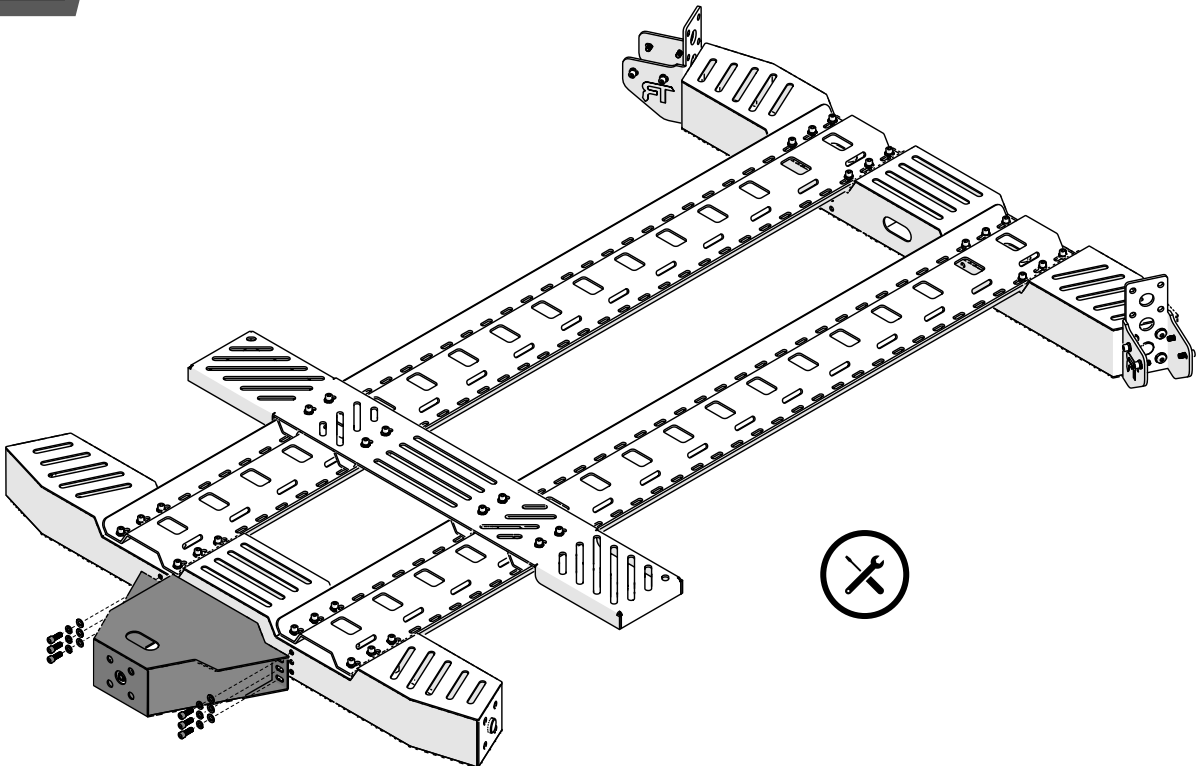

# 3



Motor Bracket x1

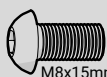

M8x15mm

Screw (Round) M8-15 x04



W-M8-16 x04

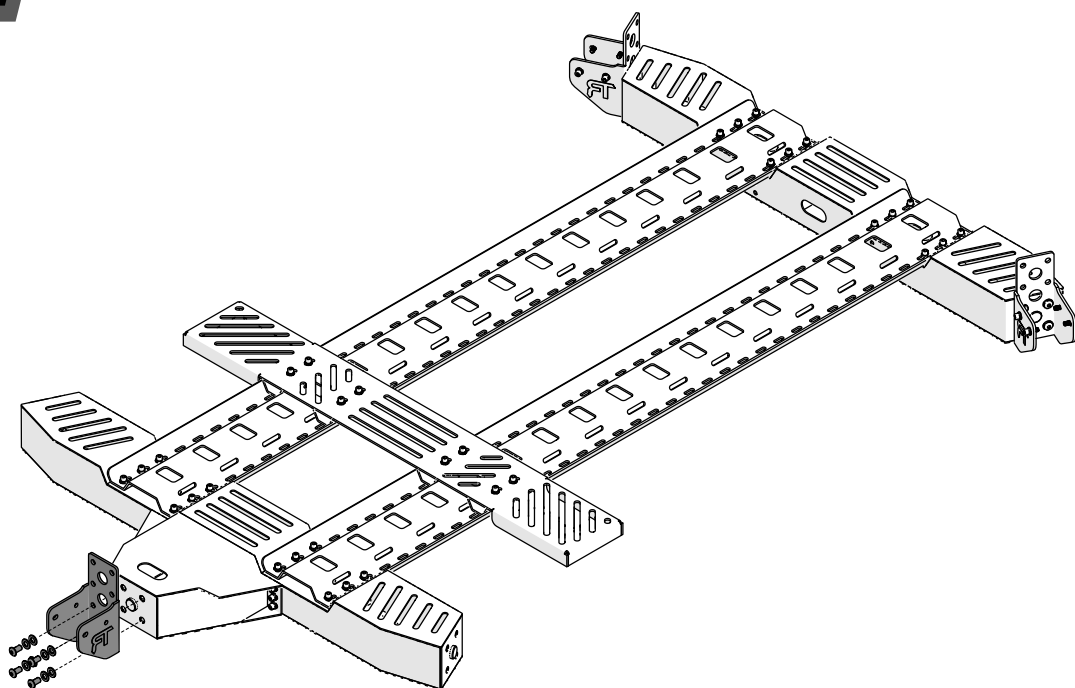

# 4

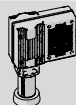

Motor Bracket x3

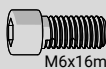

M6x16mm

SH-M6-16 x12



WL-M6 x12



WF-M6 x12

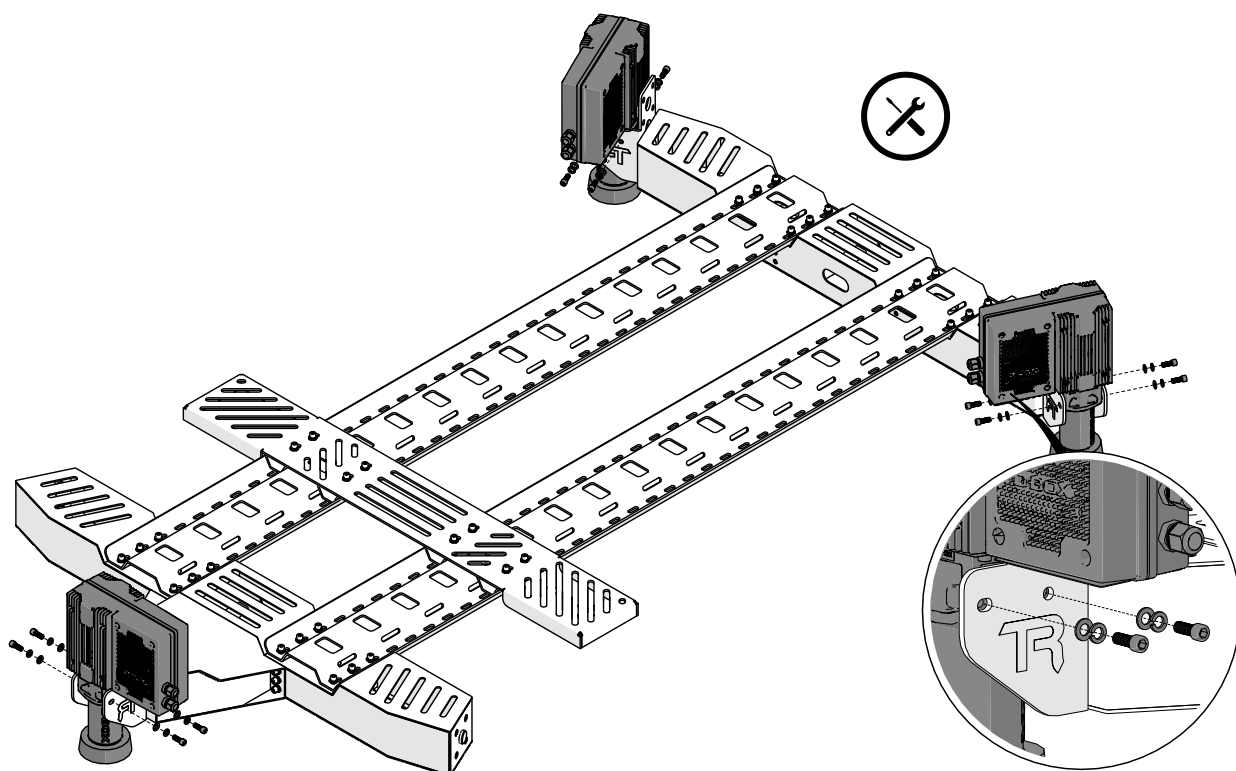

# Main Chassis For 2 Motion Motors

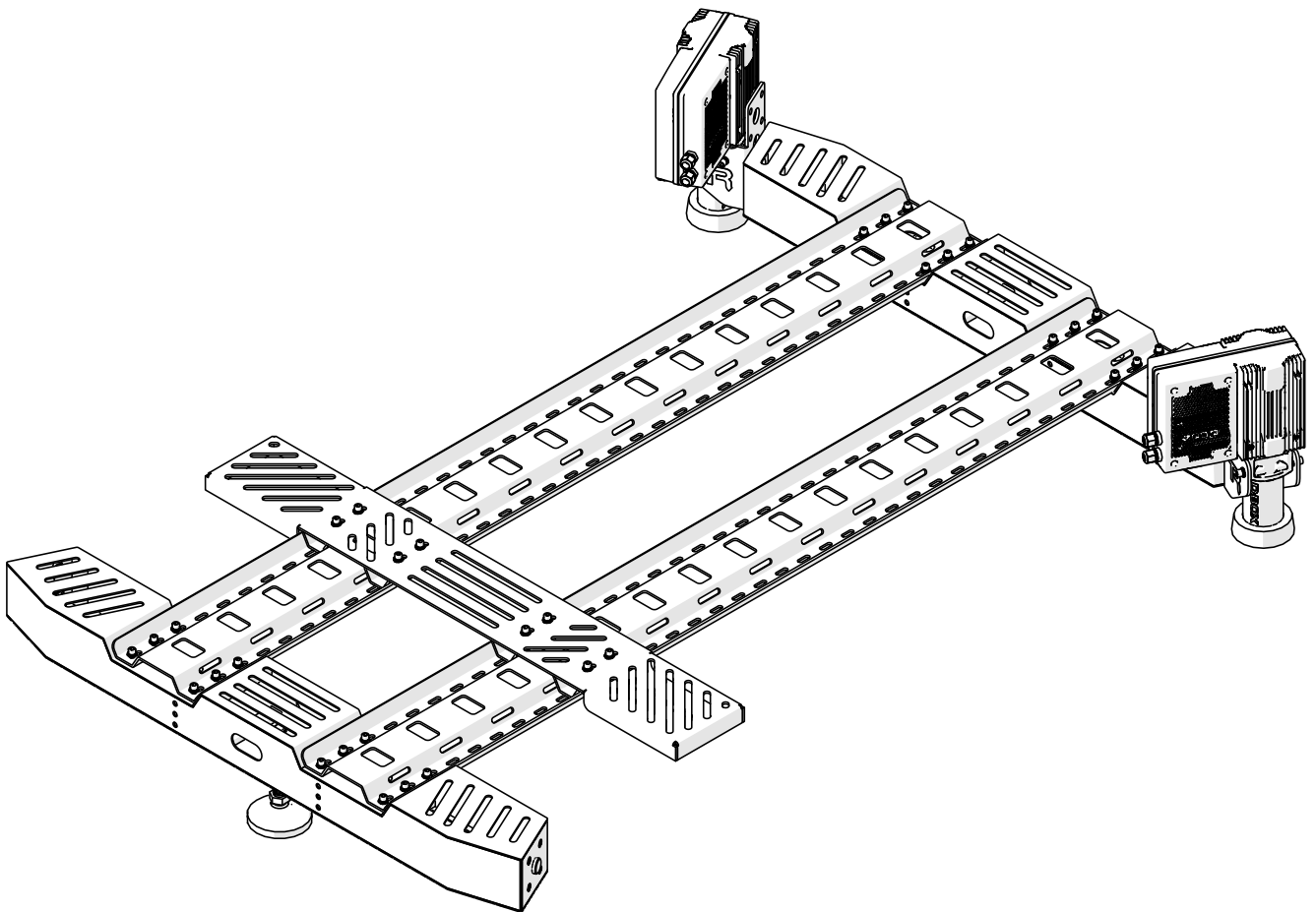

2 Motion Motors



**TRAK RACER**

Published 2024-04-20

# 1

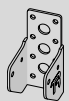

Motor Bracket x2

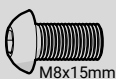

Screw (Round) M8-15 x08



W-M8-16 x08

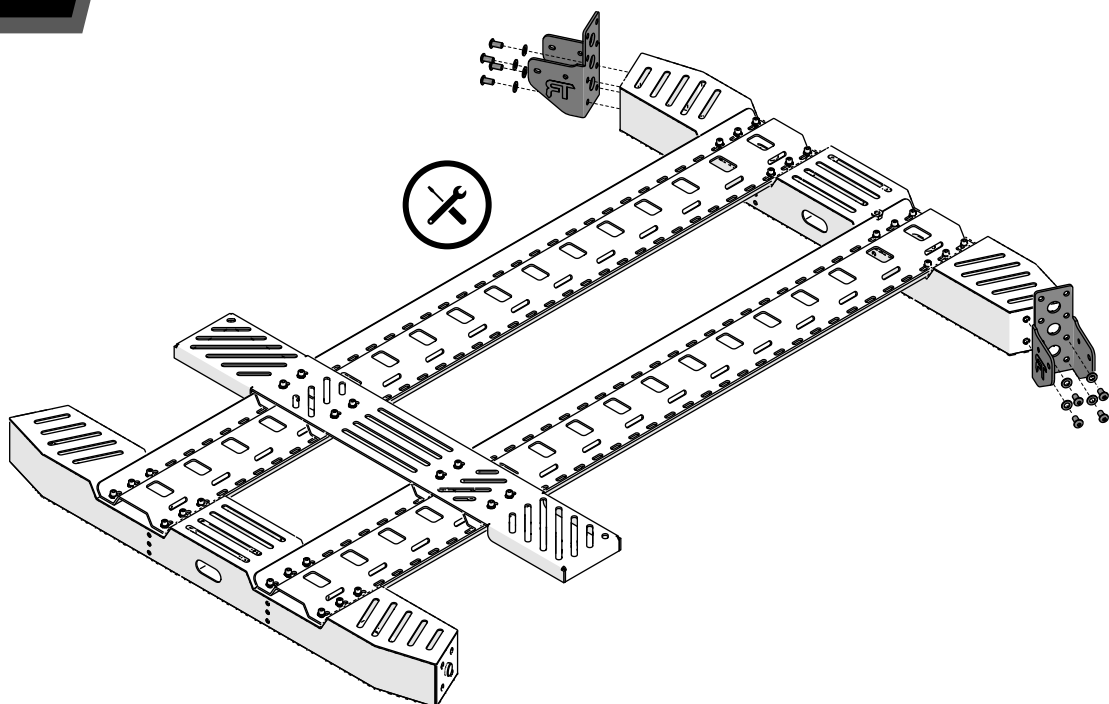

# 2

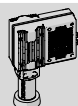

Motor Bracket x2



SH-M6-16 x8



WL-M6 x8



WF-M6 x8

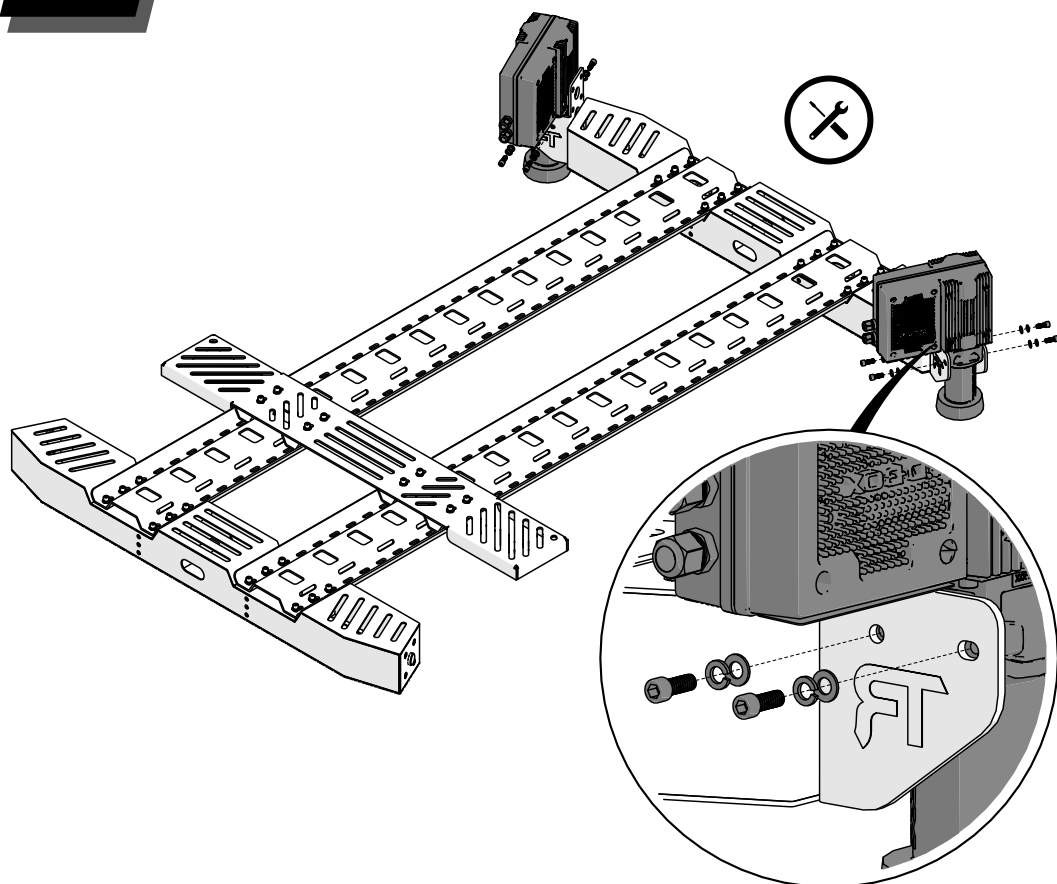

# 3



Ball Joint x1



NF-M16 x1

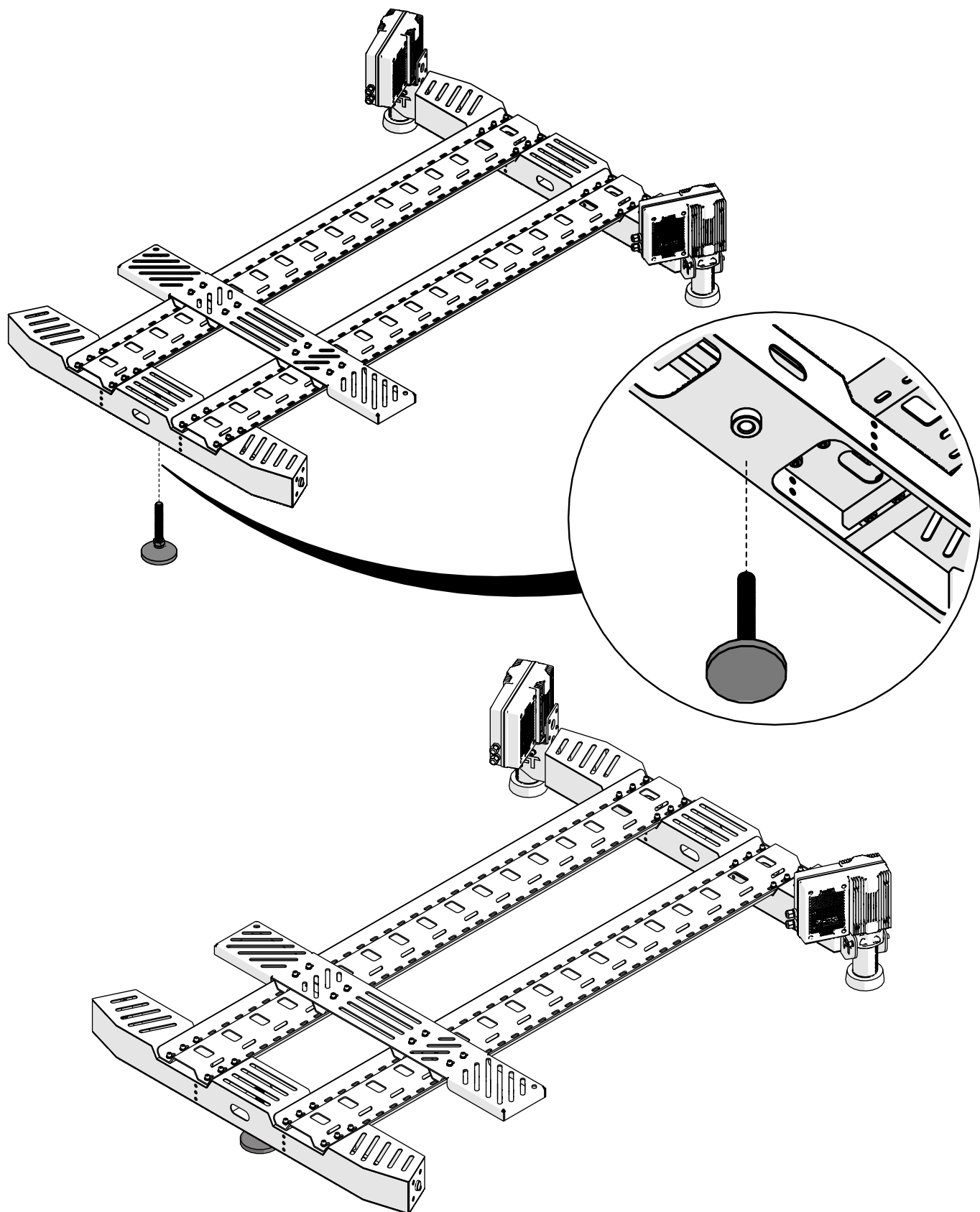



**NOTE:**

- Turn on the D-BOX Motor so it move to the neutral position.
- Adjust the ball joint by rotating the lower nut unit the chassis is parallel to the ground.
- Secure the ball joint using the lock nut.

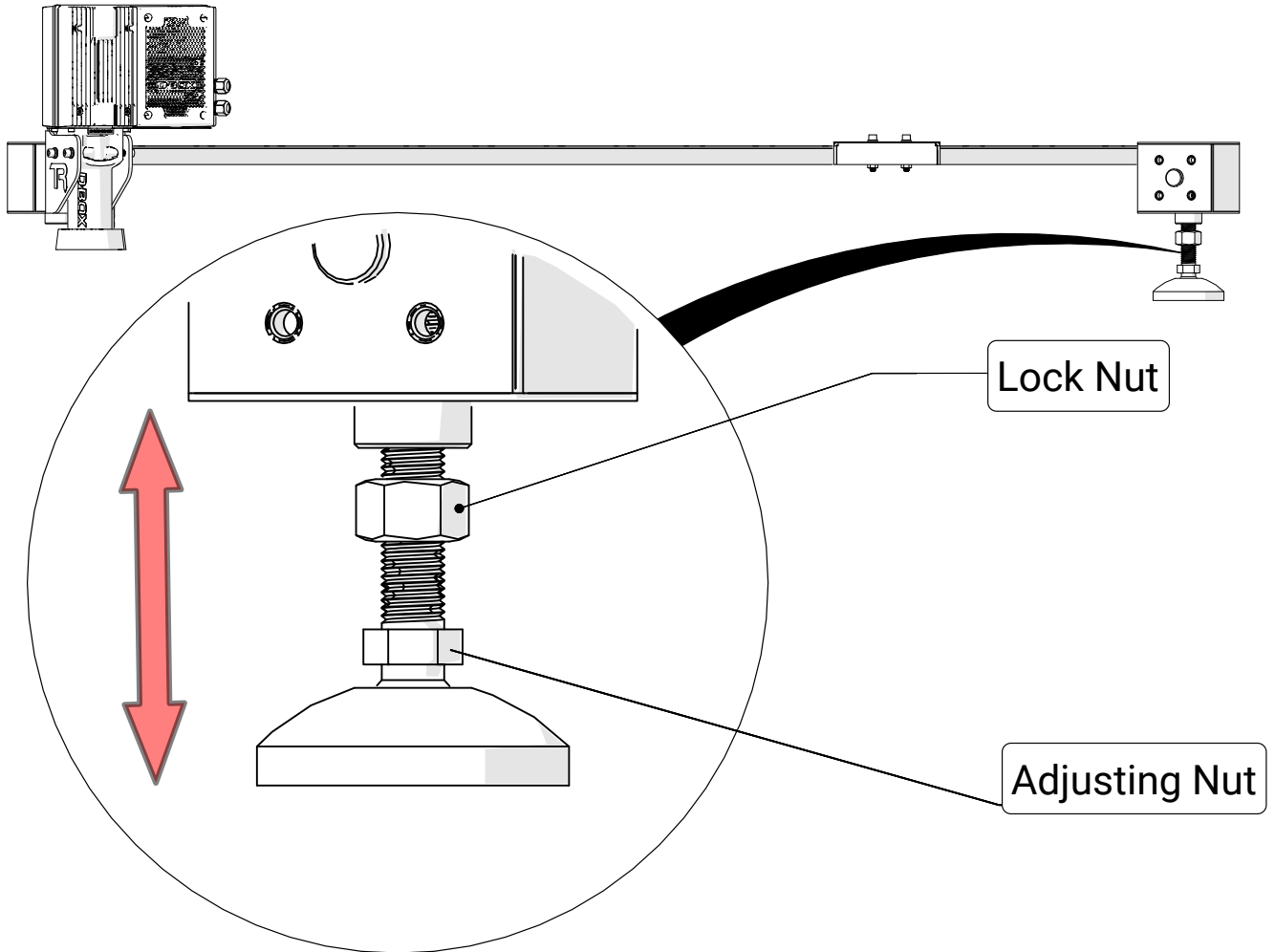

# RS6 Simulator

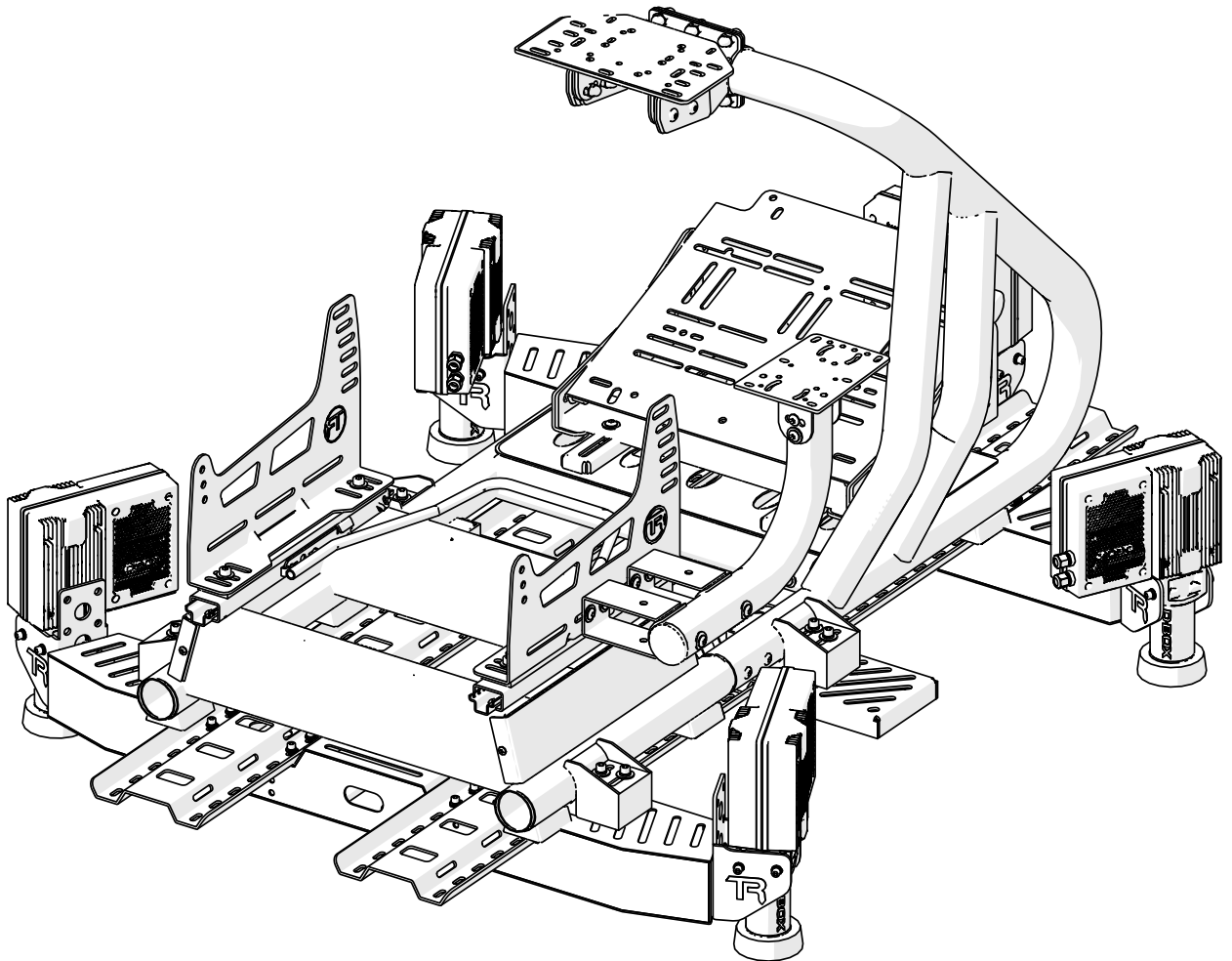

RS6 with Motion



**TRAK RACER**

Published 2024-04-20

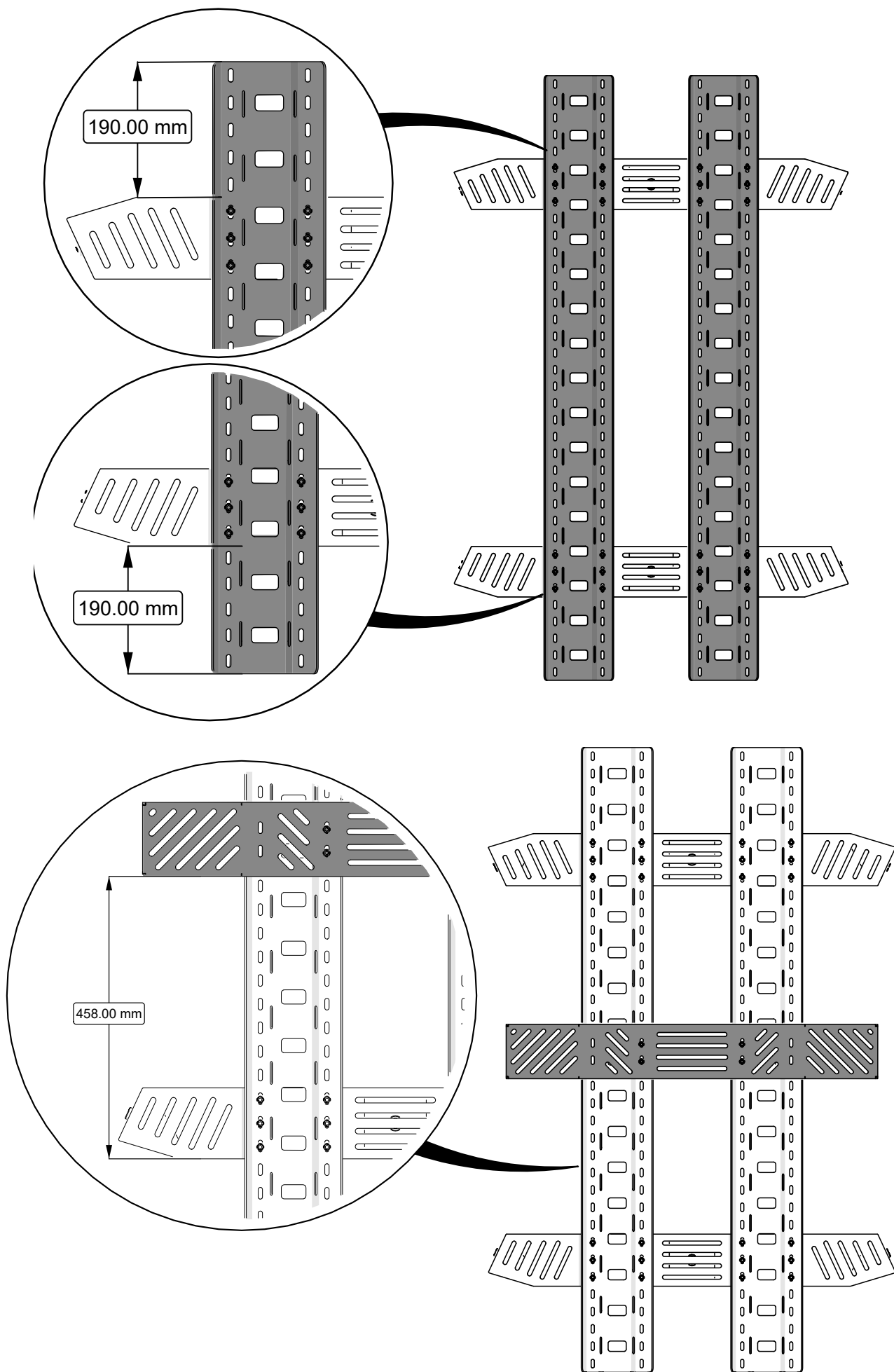

# 1



Bracket A1

x1



Bracket A2

x1

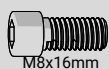

M8x16mm

SH-M8-16

x2



WL-M8

x2



WF-M8

x2



NF-M16

x2

## NOTE:

Loosely Secure Bracket A1 in the middle so it can be adjusted to fit the position of the cockpit.

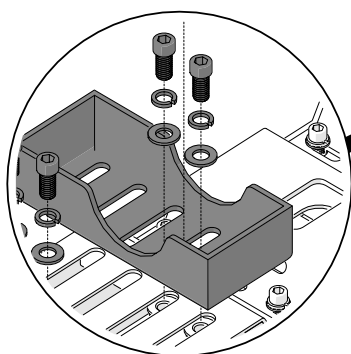

# 2



Bracket A1

x2



Bracket A2

x2

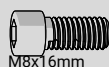

M8x16mm

SH-M8-16

x4



WL-M8

x4



WF-M8

x4



NF-M16

x4

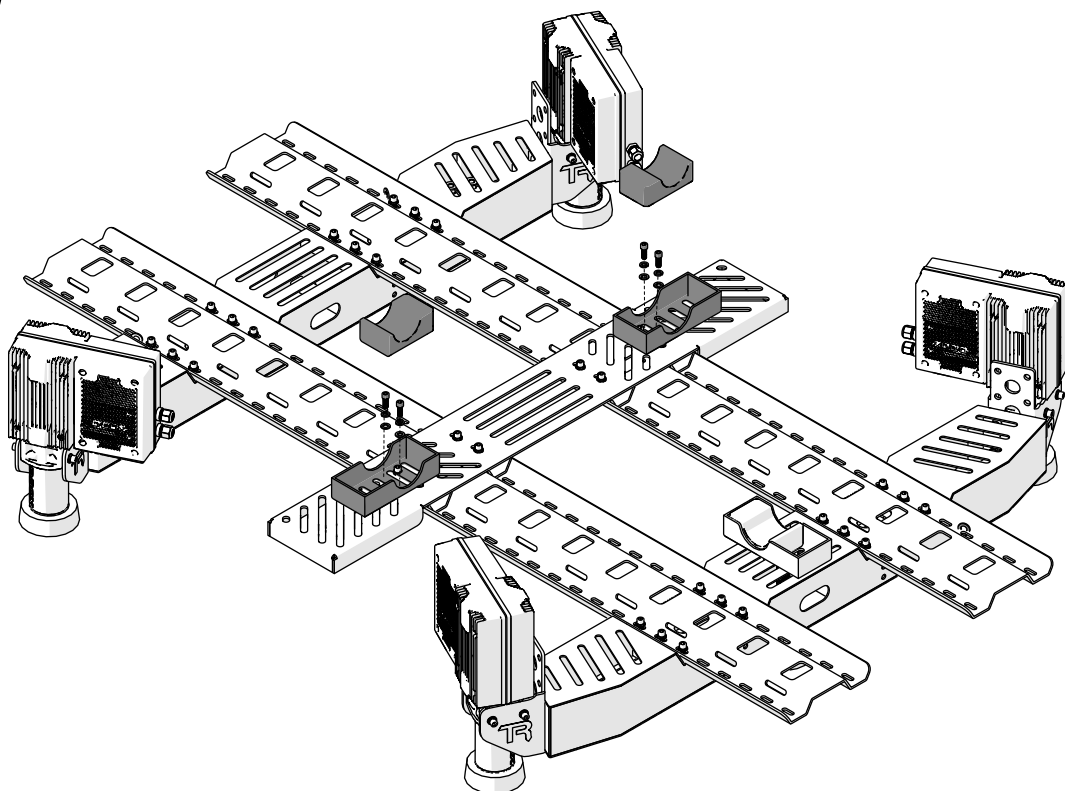

# 3

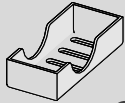

Bracket A1 x2



Bracket A2 x2

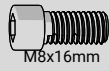

SH-M8-16 x4



WL-M8 x4



WF-M8 x4



NF-M16 x4

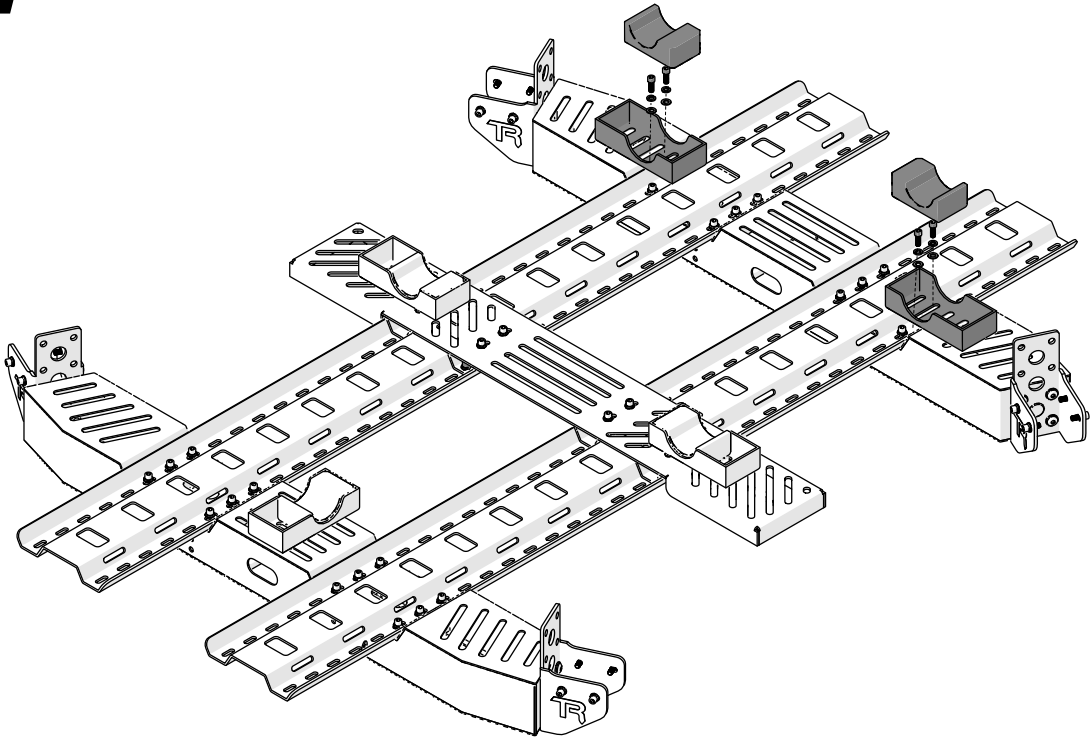

# 4

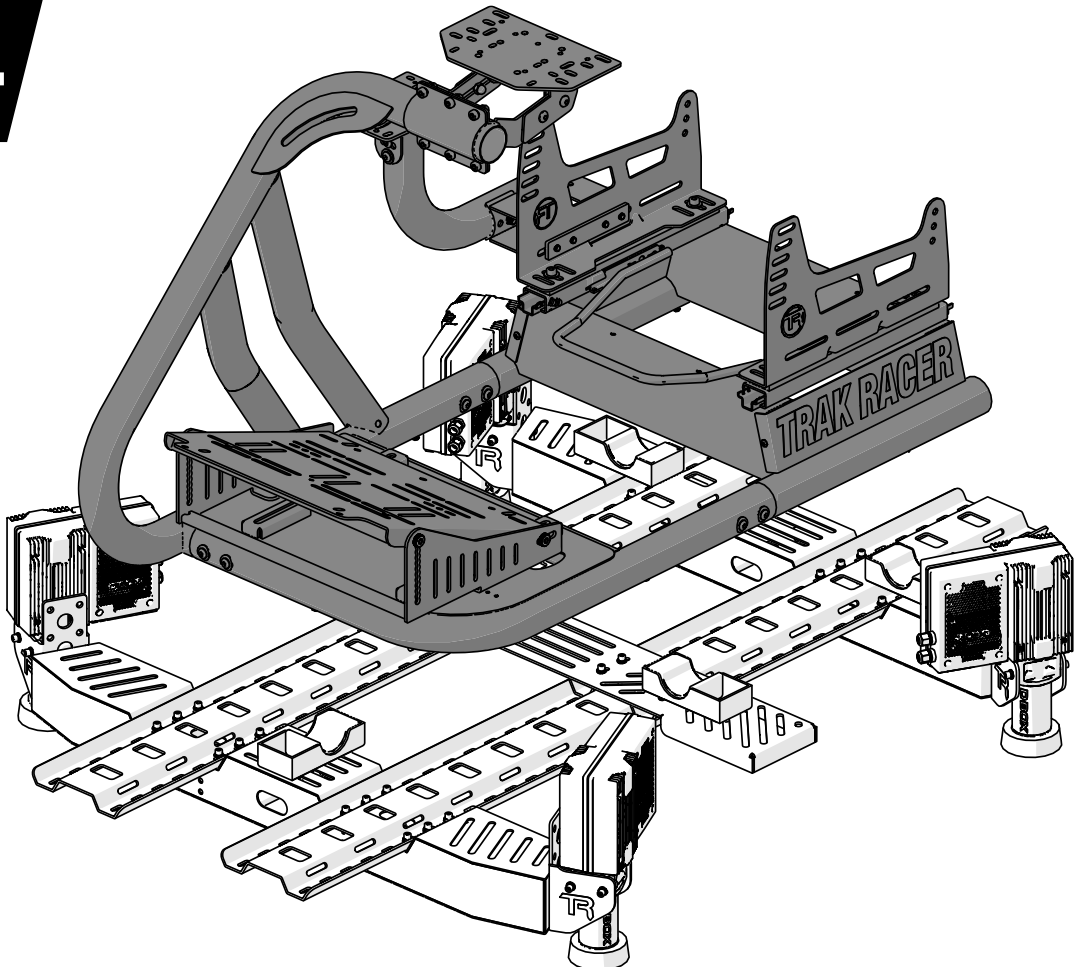

# 5



Bracket A3 x5



M8x65mm

SH-M8-65 x10



WL-M8 x10



WF-M8 x10



NF-M16 x10

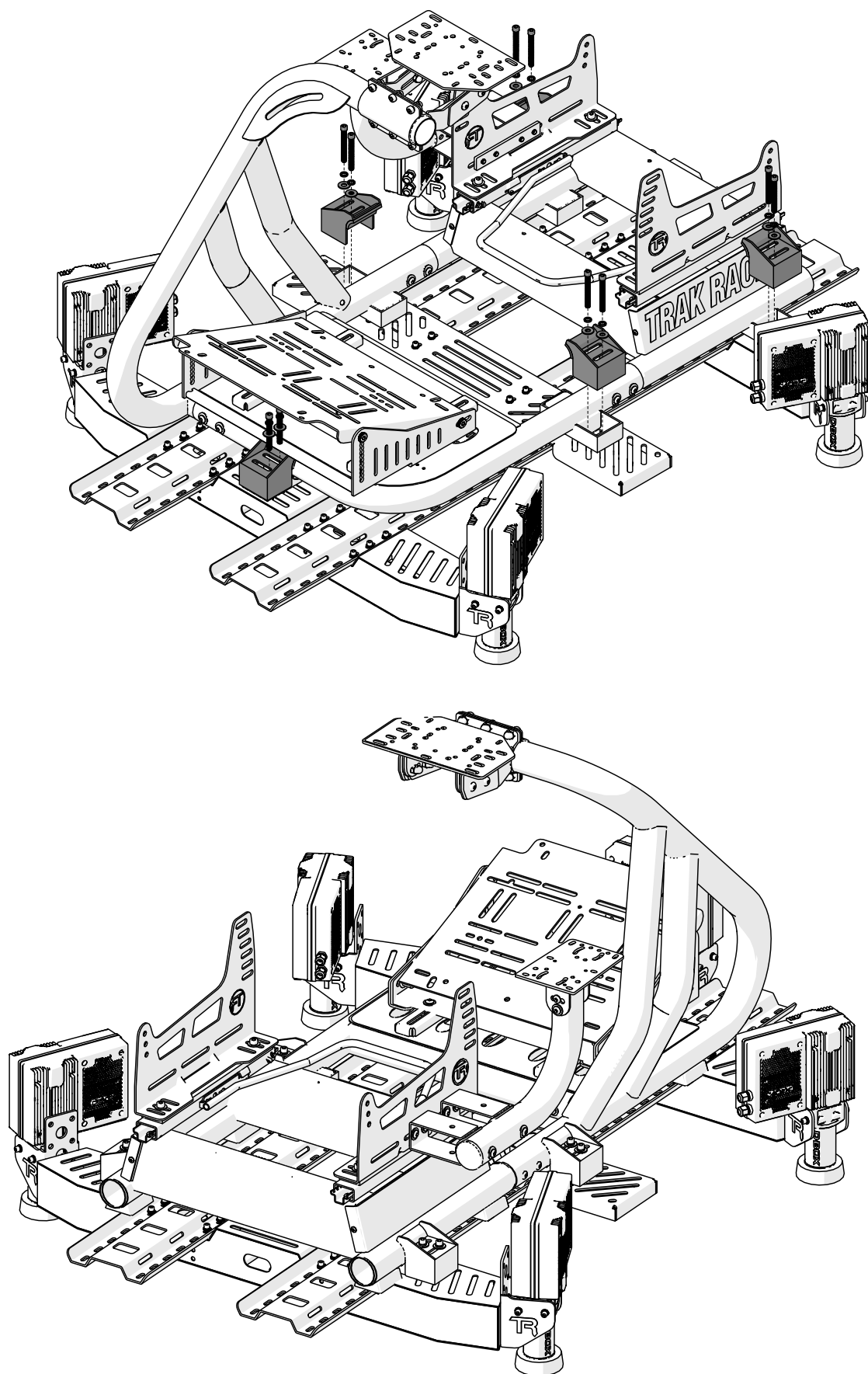

# TRX Simulator

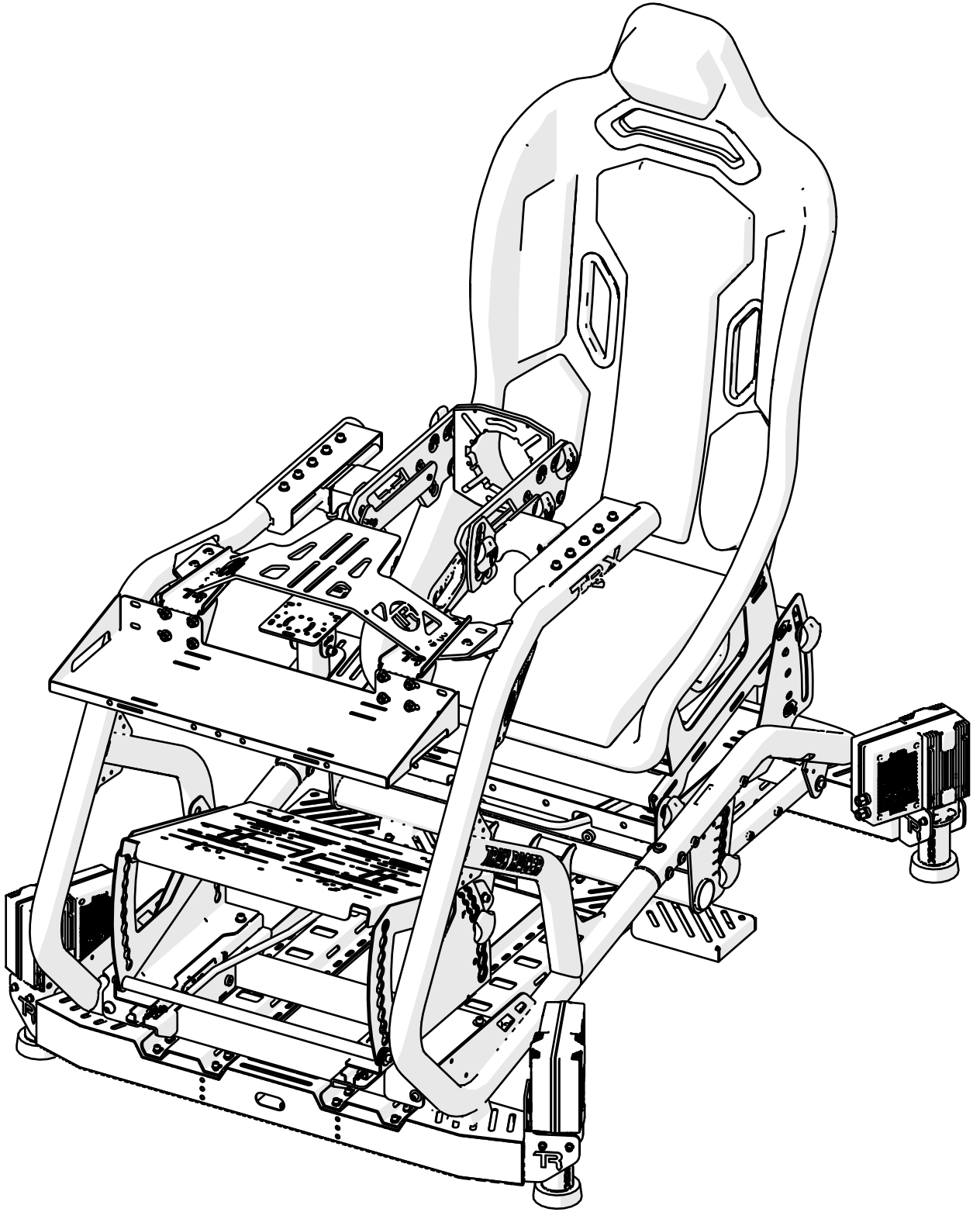

TRX with Motion



**TRAK RACER**

Published 2024-04-20

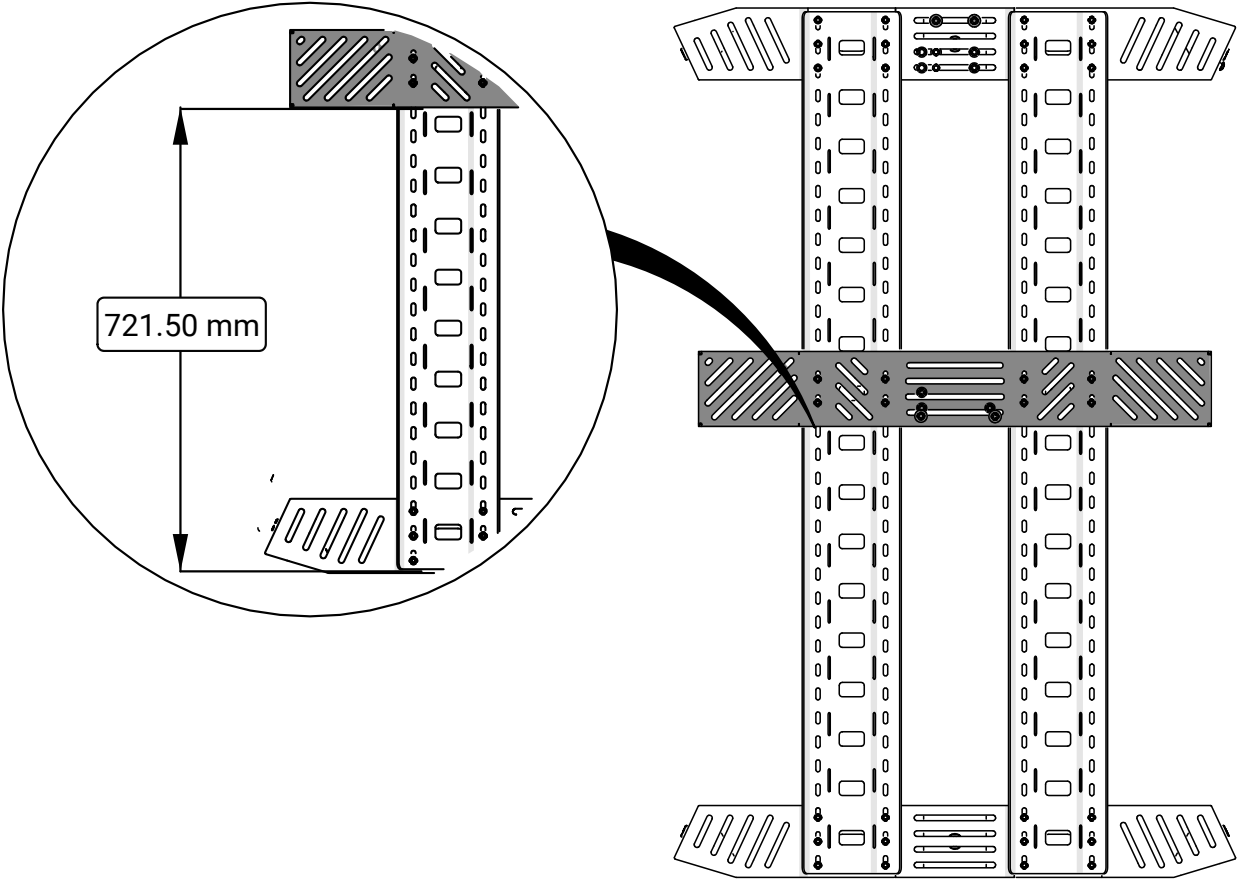



# 1

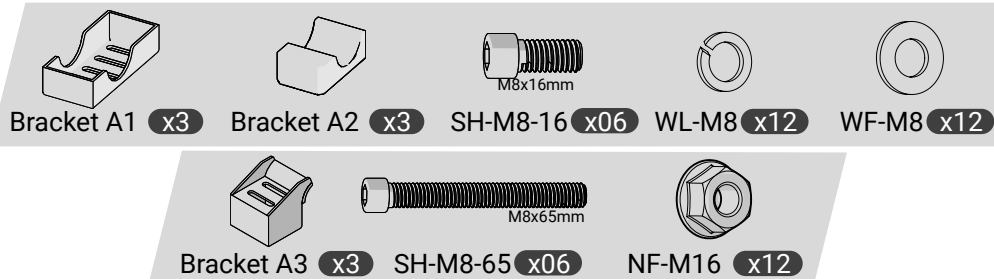

## NOTE:

- Follow the steps on the RS6 mounting page, but adhere to the part list mentioned above.
- Untighten the screws and remove Bracket A3, along with the screws and rings.

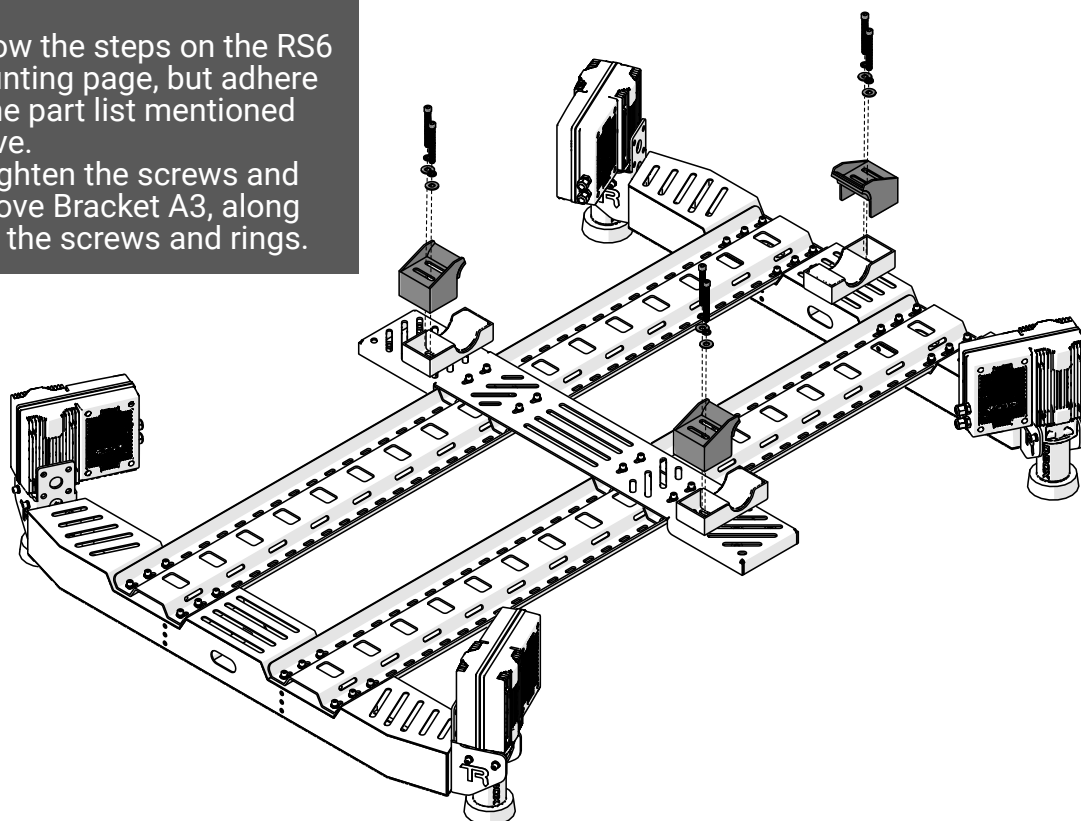

# 2

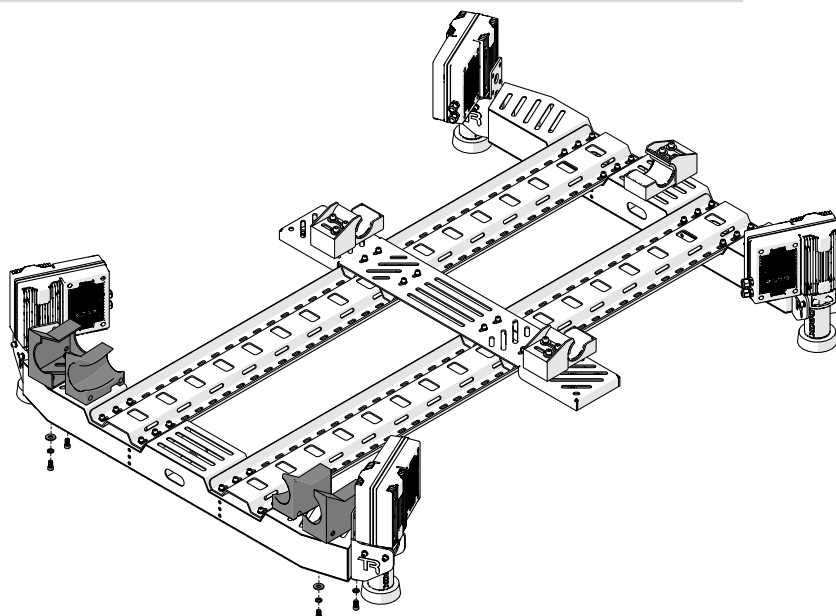

# 3



Bracket B2

x2



M8x65mm

SH-M8-65

x4



M8x16mm

SH-M8-16

x6



WL-M8

x06



WF-M8

x06



NF-M8

x6

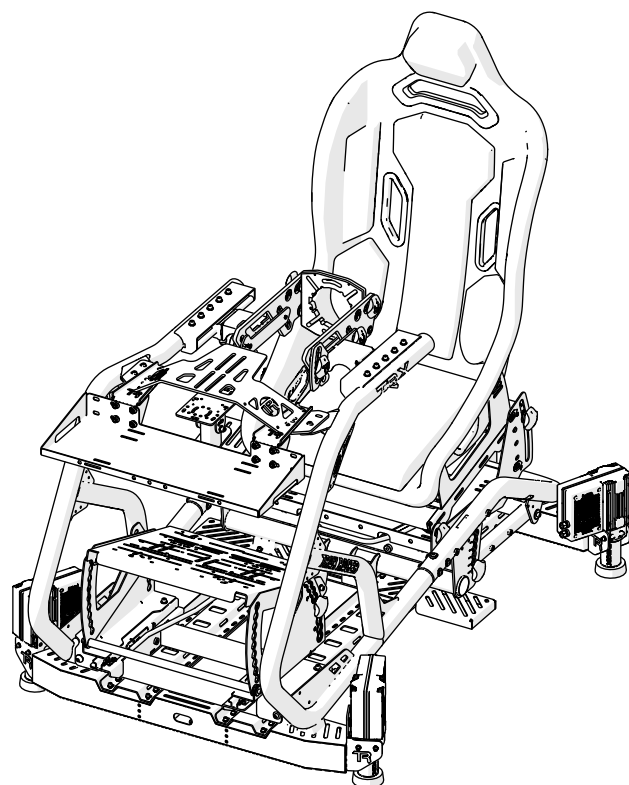
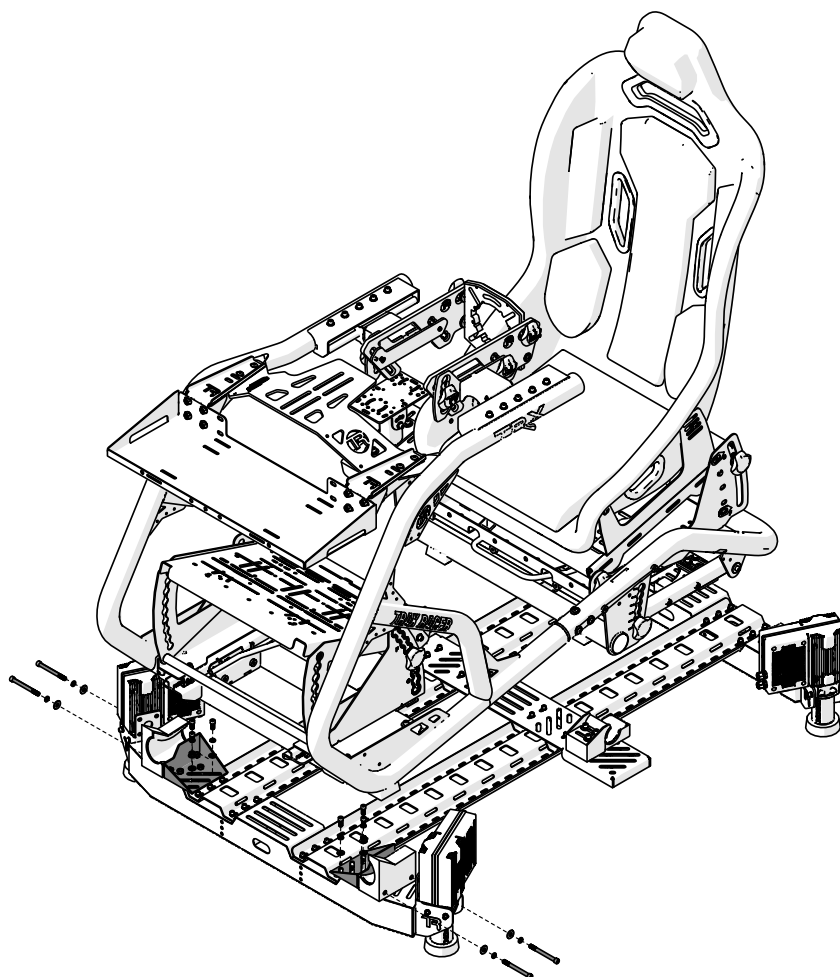

# TR8 Simulator

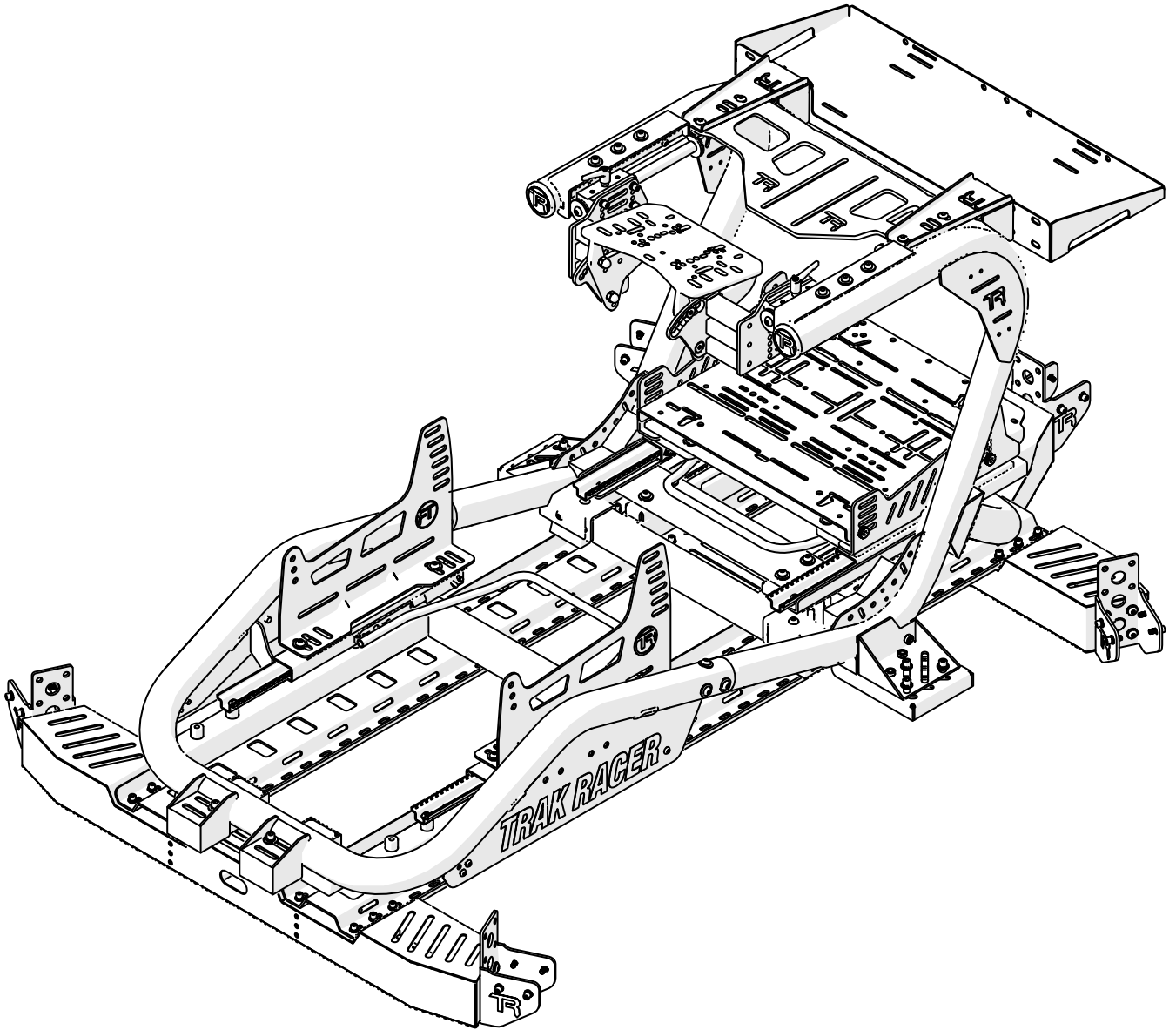

TR8 with Motion



**TRAK RACER**

Published 2024-04-20

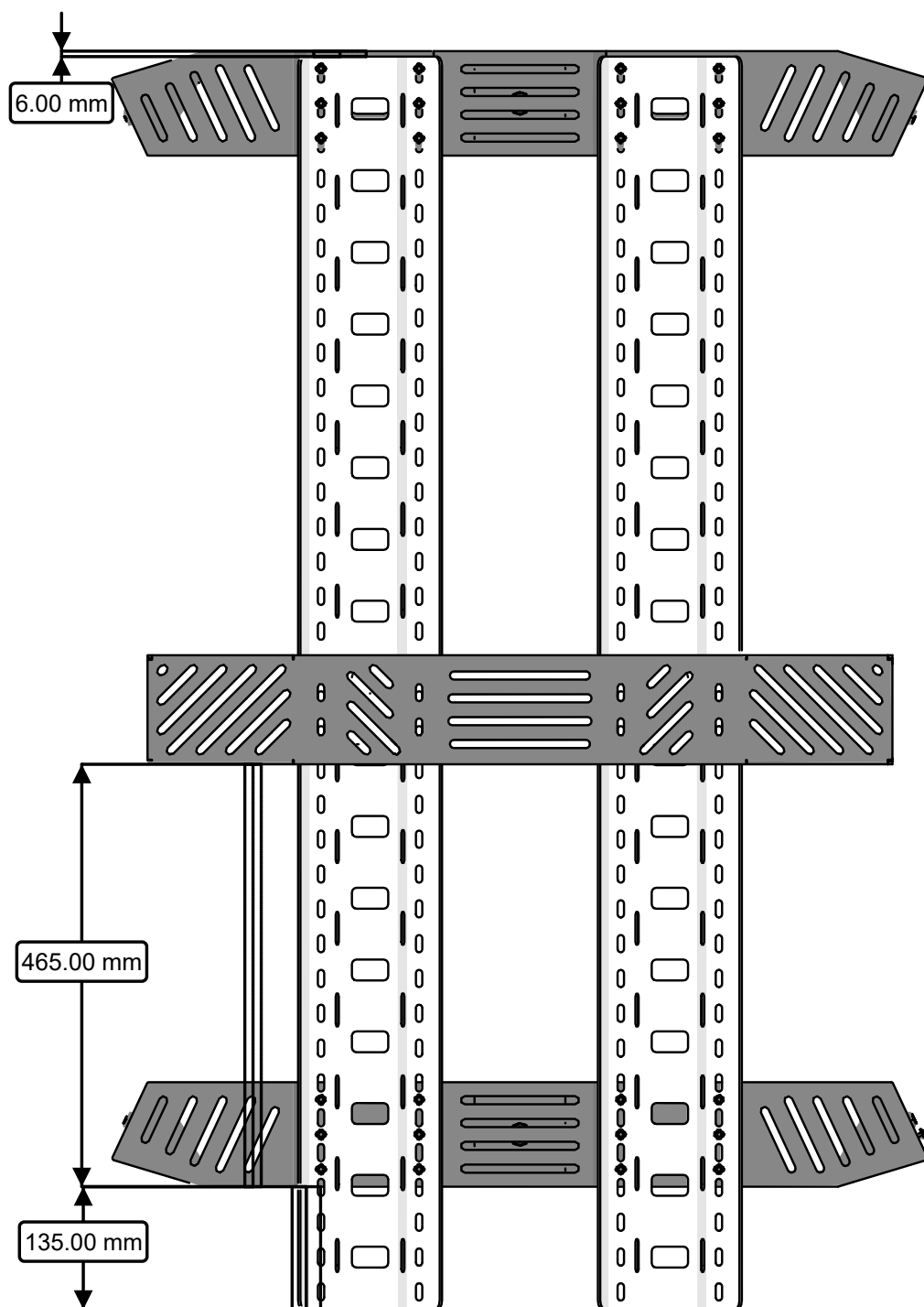

# 1

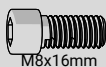
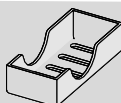

M8x16mm



Bracket A1 x4 Bracket A2 x4 SH-M8-16 x6 WL-M8 x6 WF-M8 x6 NF-M16 x6

## NOTE:

Loosely Secure Bracket A1 in the middle so it can be adjusted to fit the position of the cockpit.

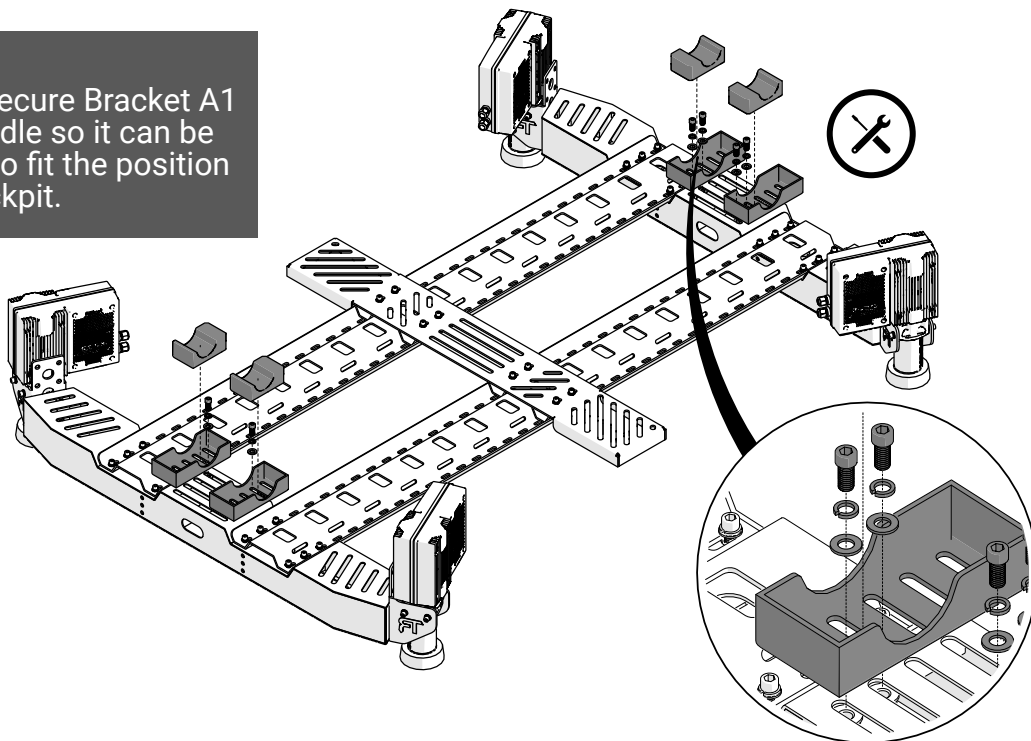

# 2



M8x65mm

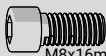

M8x16mm



Bracket B2 x2 SH-M8-65 x4 SH-M8-16 x6 WL-M8 x06 WF-M8 x06 NF-M8 x6

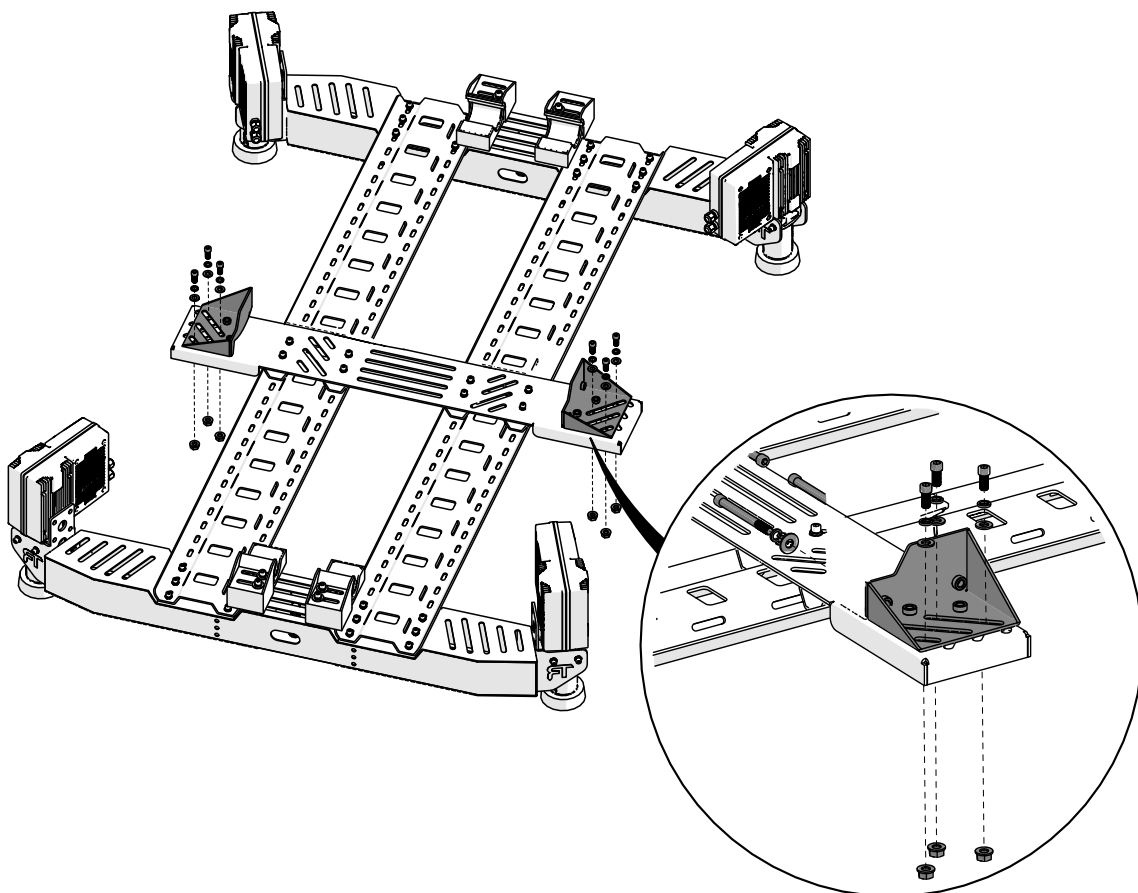

# 3

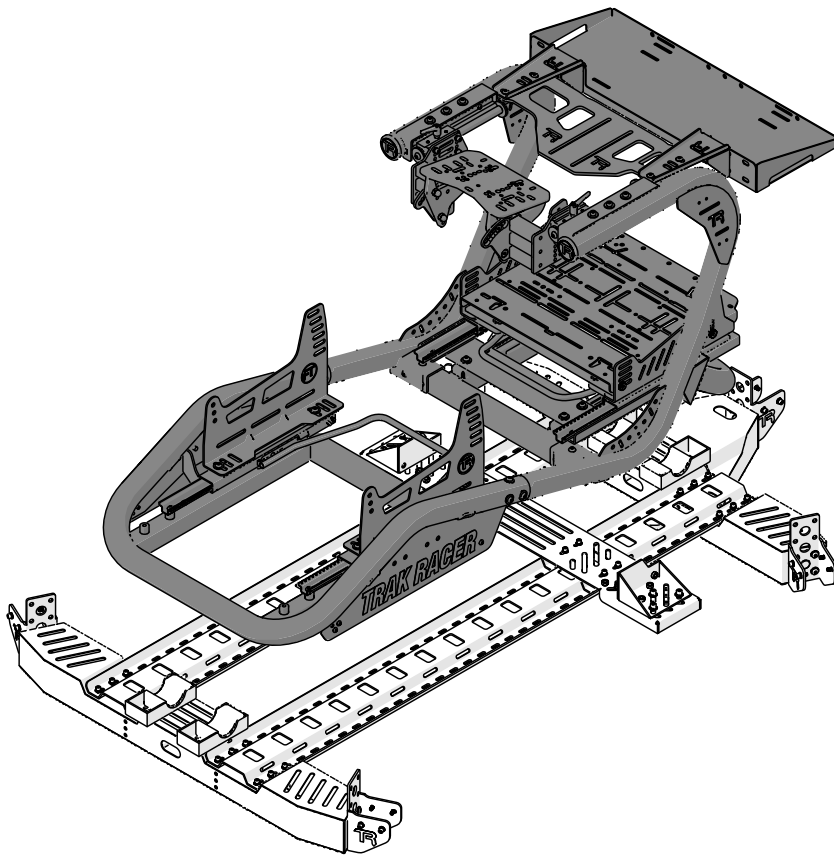

# 4



Bracket B1 x2



Bracket A3 x4



M8x65mm

SH-M8-65 x06



WL-M8 x10



WF-M8 x10



NF-M16 x4

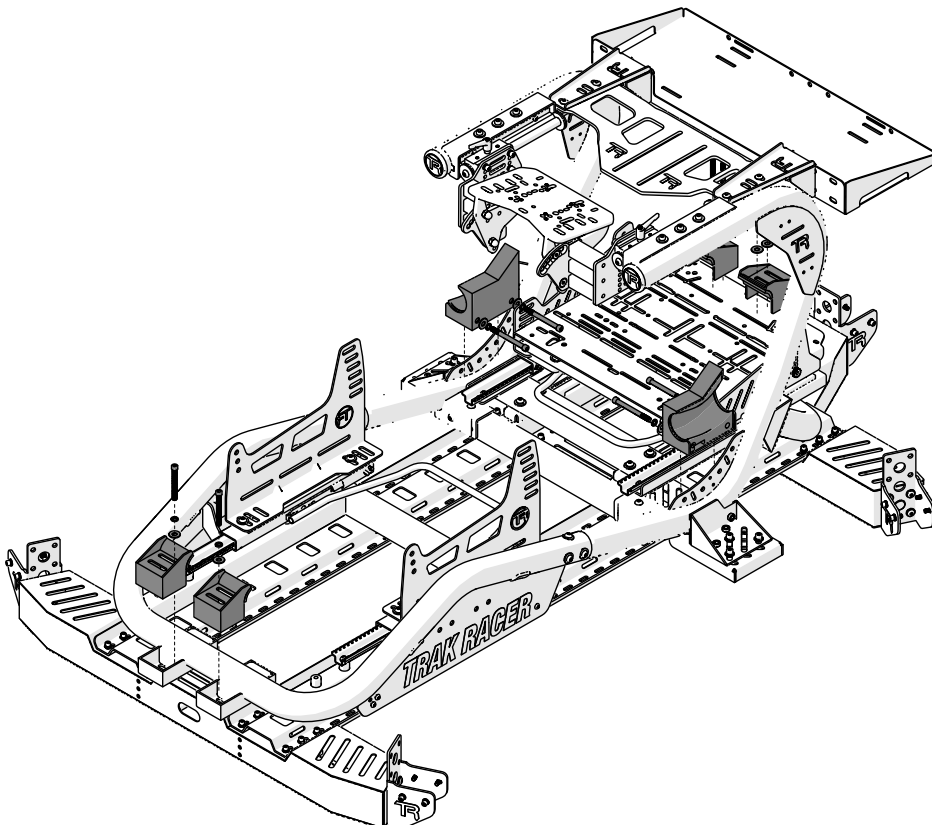

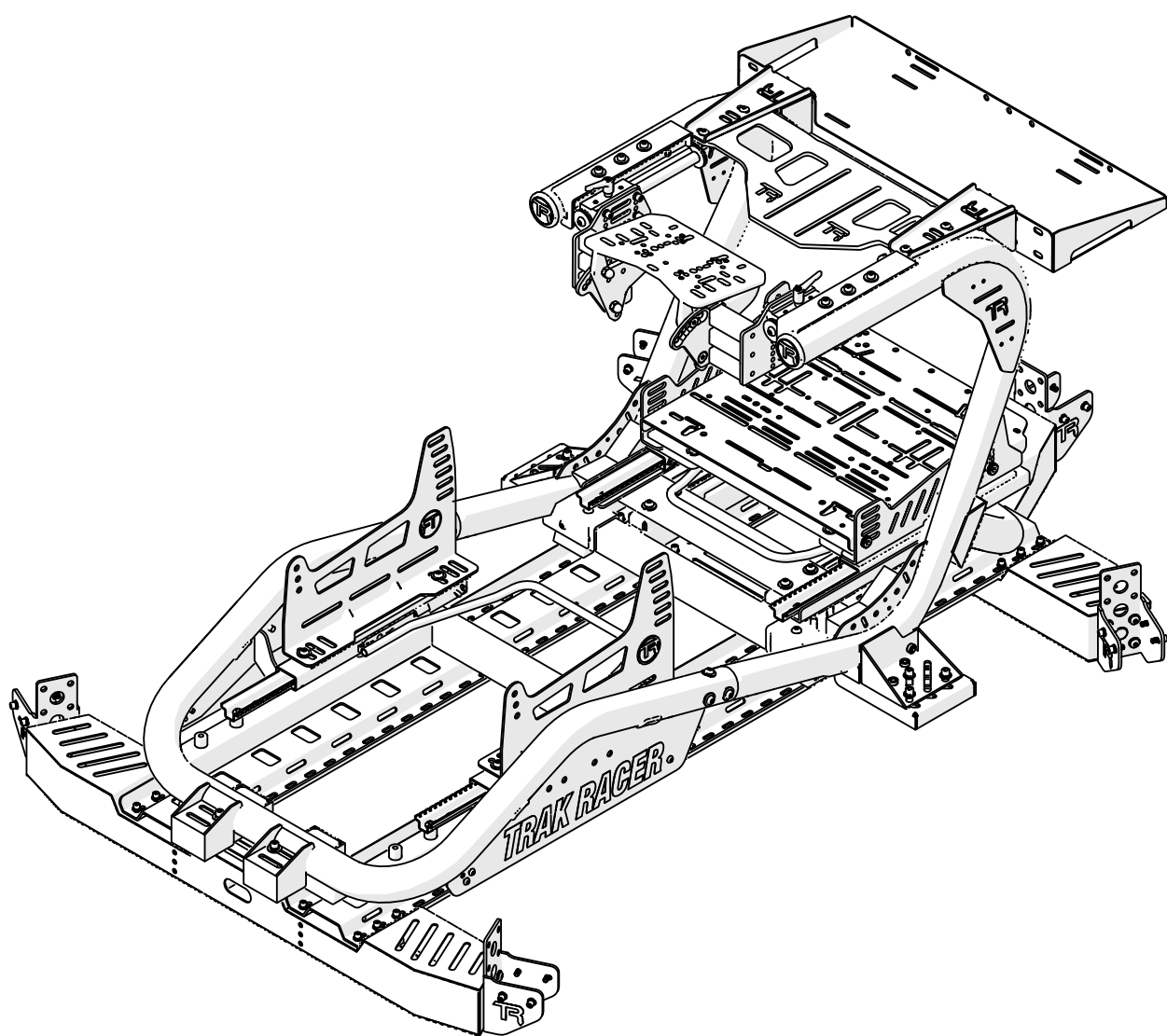

# TR80 Simulator

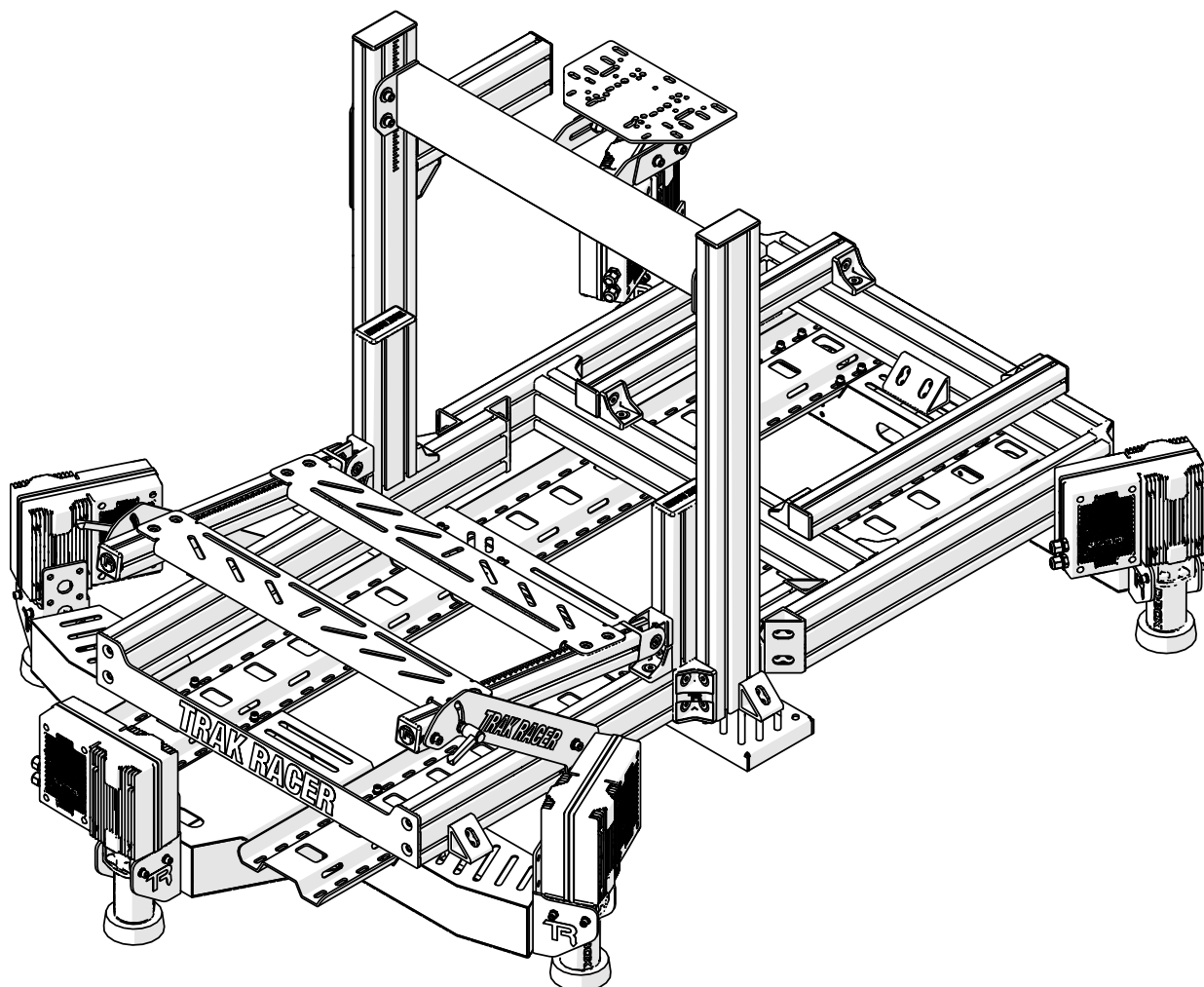

TR80 with Motion



**TRAK RACER**

Published 2024-04-20



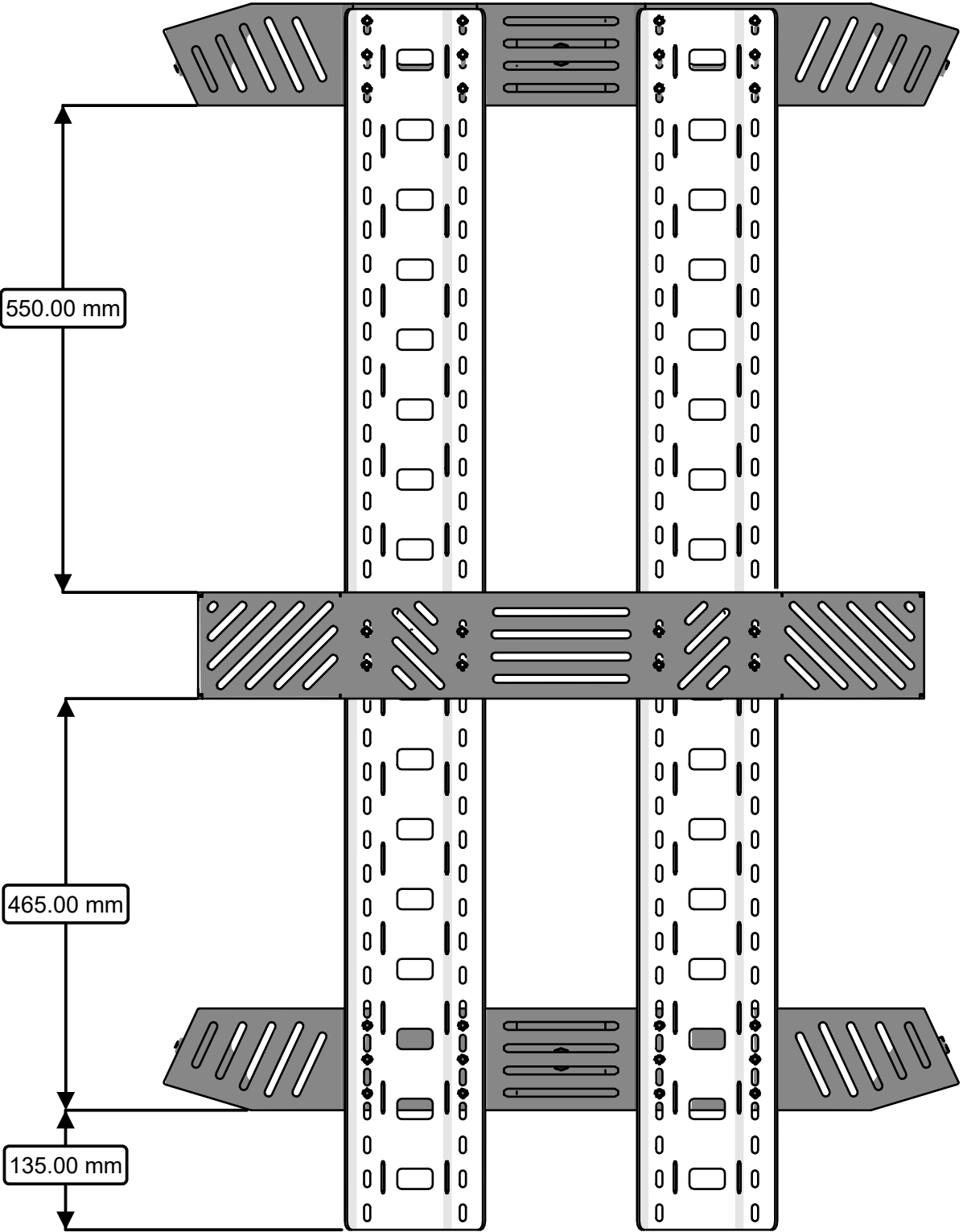

# 1

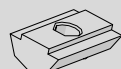

NS-M8 x08



NF-M16 x8

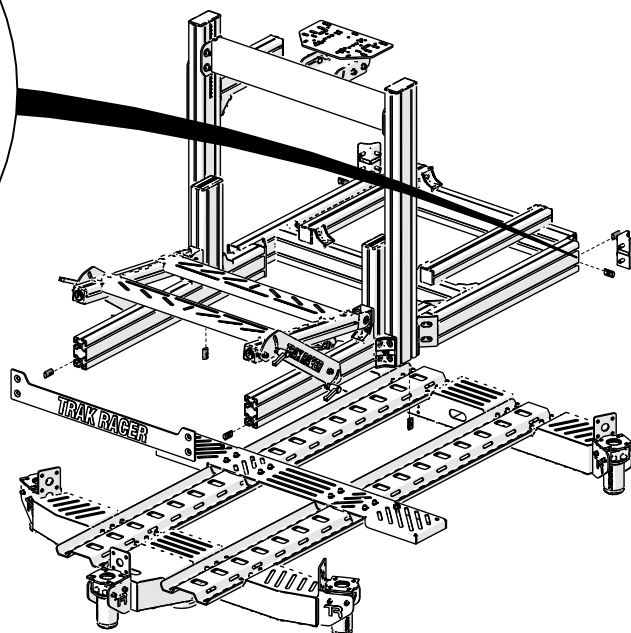
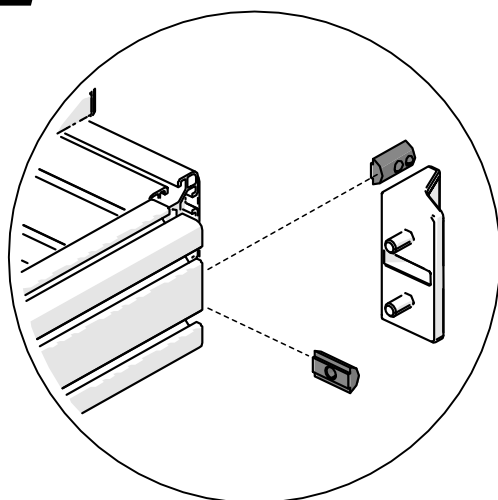

# 2



Corner A1 x6



Corner A2 x1

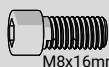

M8x16mm

SH-M8-16 x16

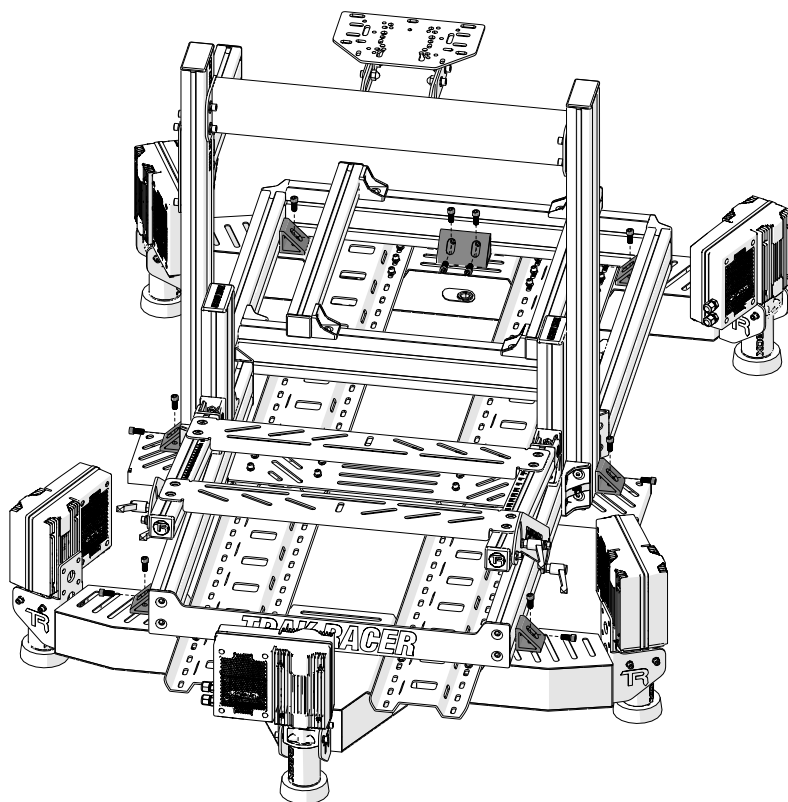

# TR40 Simulator

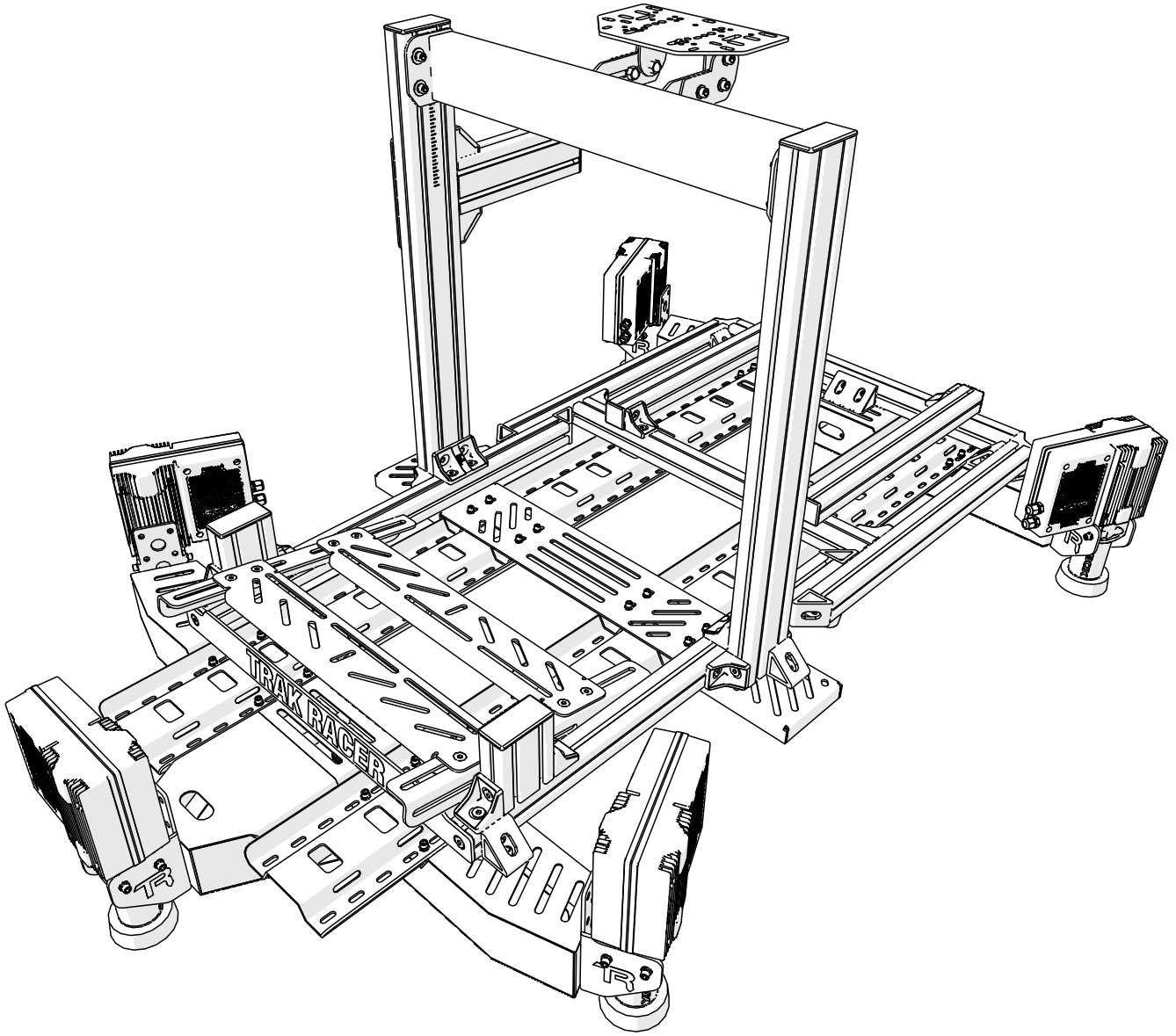

TR40 with Motion



**TRAK RACER**

Published 2024-04-20

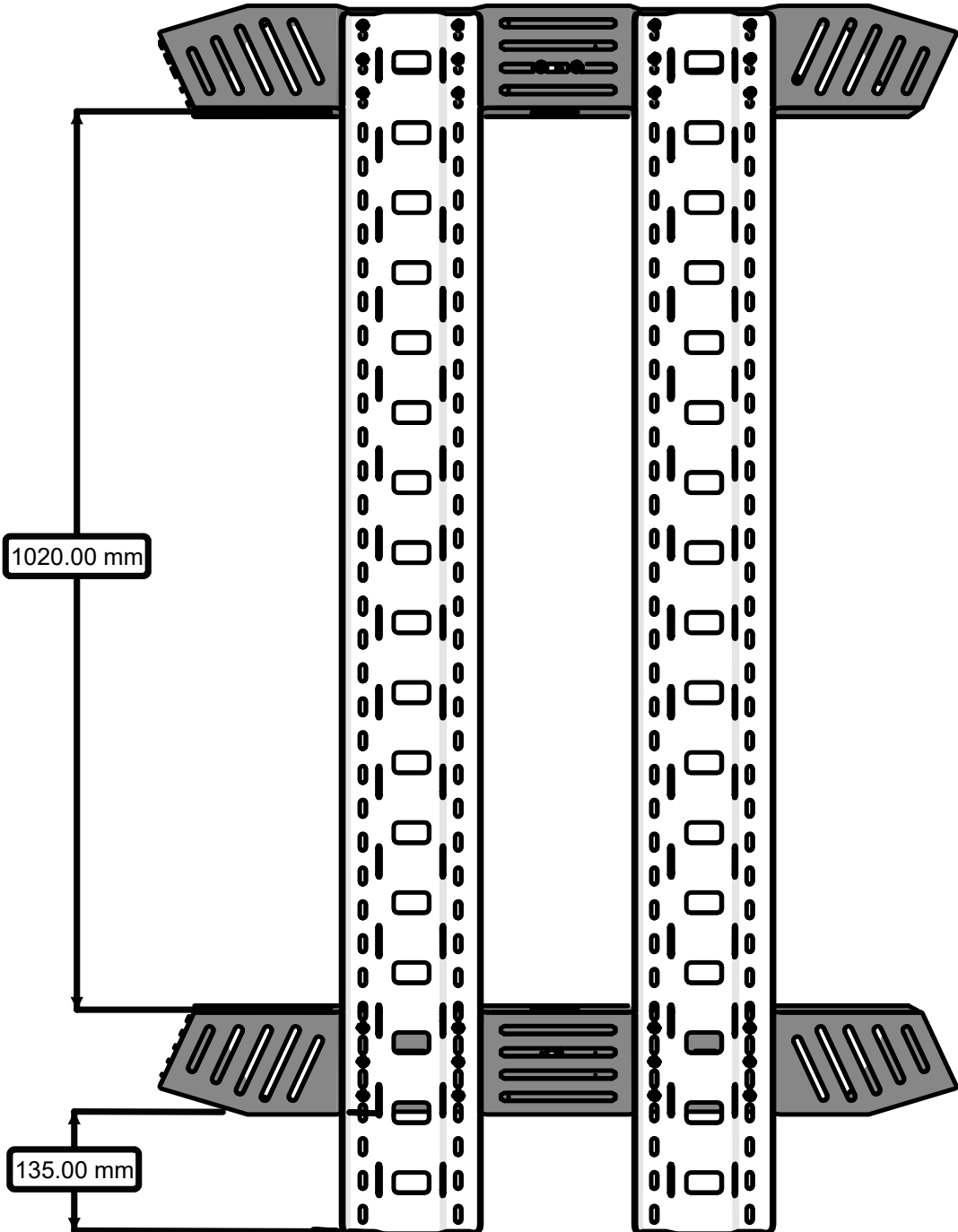

1

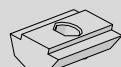

NS-M8 x08



NF-M16 x8

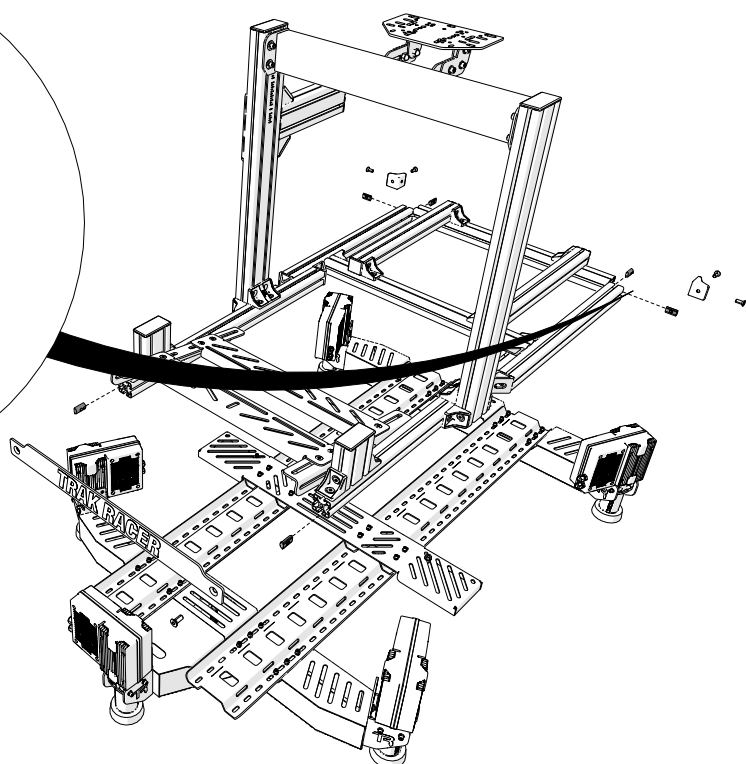
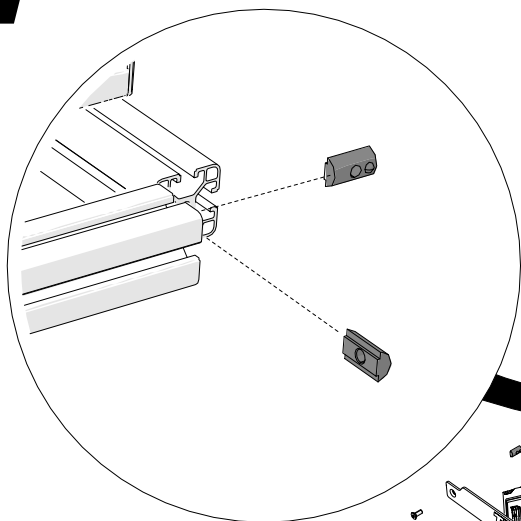

2



Corner A1 x6



Corner A2 x1

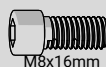

SH-M8-16 x16

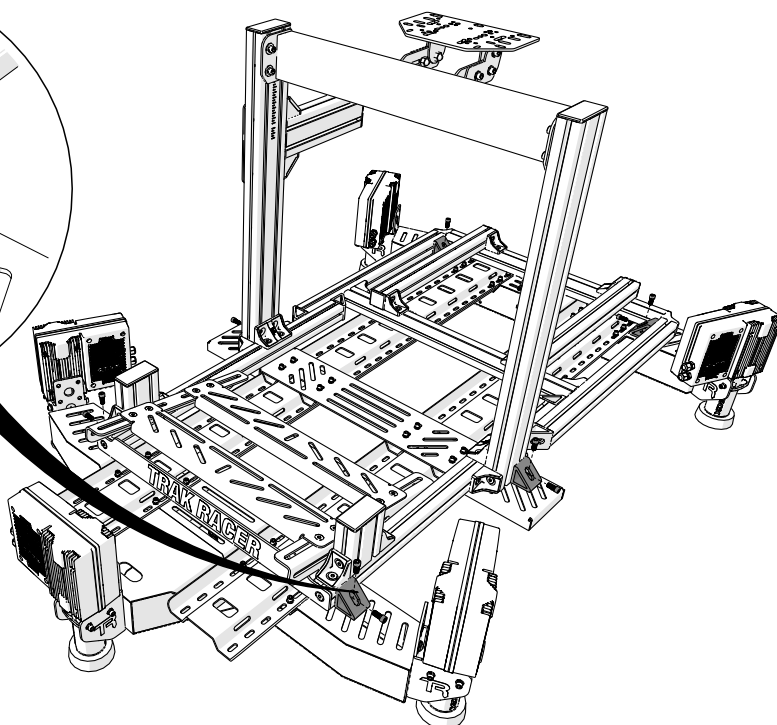
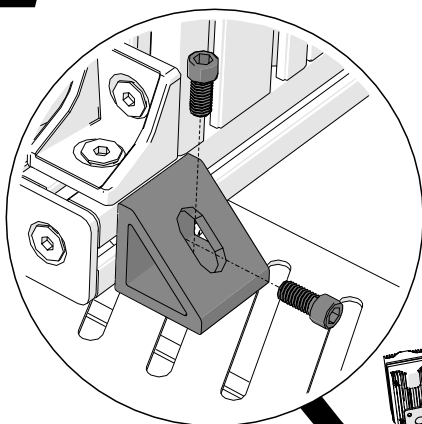

# FINISHED

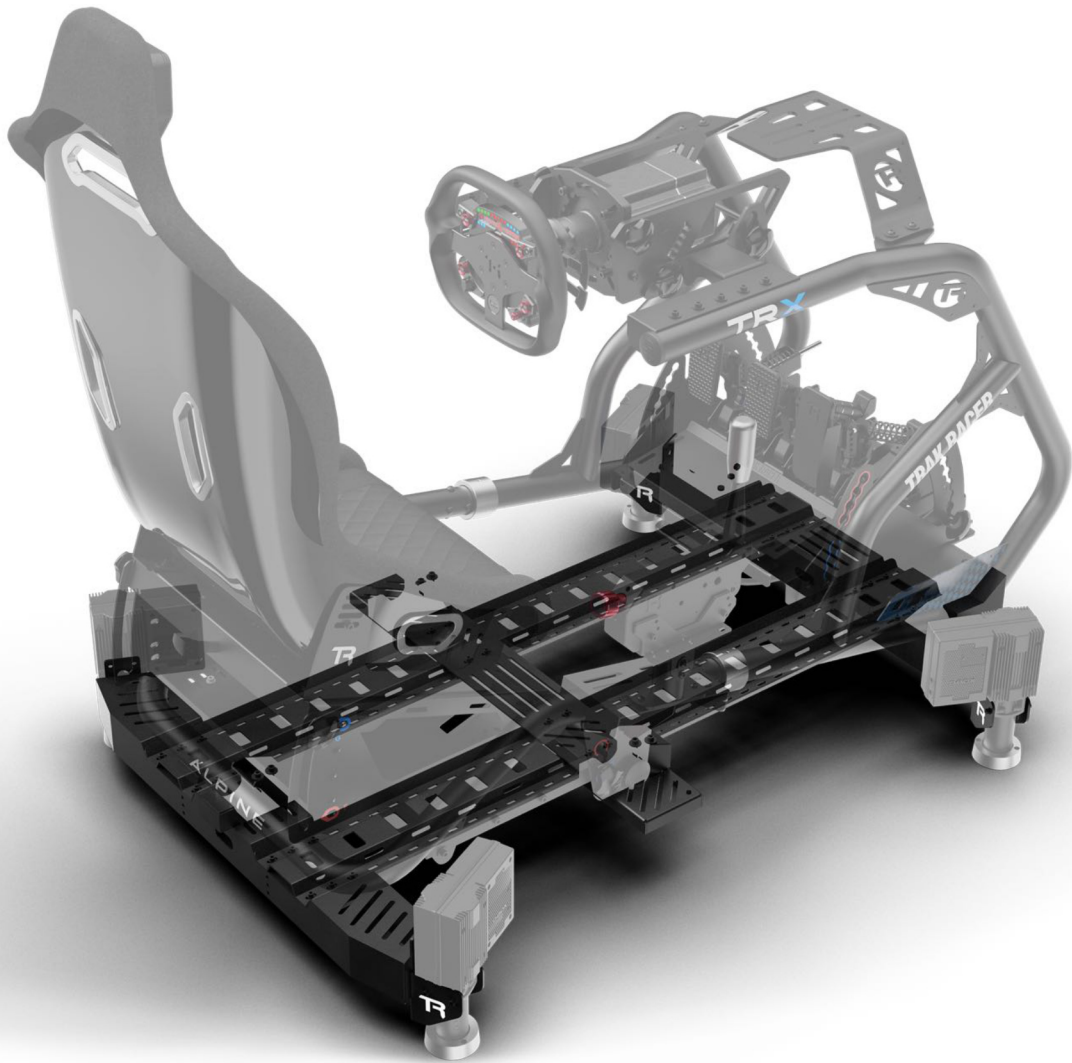

**Share your build online and tag us to be featured!**



@trakracer



@trakracer



@trak\_racer