

# MAIN MENU

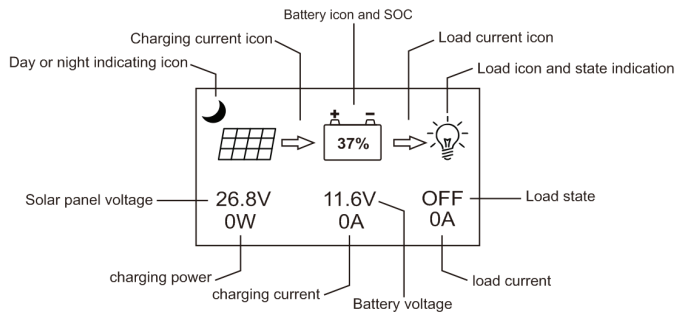

# ICON DESCRIPTION

ICON	STATE	DESCRIPTION	COMMENTS
	Steady on	Nighttime	Related to charging
	Steady on	Daytime	
	Steady on	A dynamic arrow indicates charging is in process, while a static one indicates otherwise.	Related to battery
	"0 to 100%"	Current battery capacity	
	"0%" in slow	Battery over-discharged	
	flashing "100%" in quick flashing	Battery over-voltage	
	Steady on	A bulb shown as left and a dynamic arrow indicate the load is switched on.	Related to load
	Steady on	A bulb shown as left and a static arrow indicate the load is switched off.	
	Quick flashing	Overload or short-circuit protection	

TO SET BATTERY TYPE, VIEW HISTORICAL DATA, AND USE OTHER FUNCTIONS, REFER TO THE USER MANUAL FOR AT [GPELECTRIC.COM/MPPT-PRO](http://GPELECTRIC.COM/MPPT-PRO).



# GP-MPPT-PRO-40/60-R SOLAR CONTROLLER REMOTE Quick Start Guide

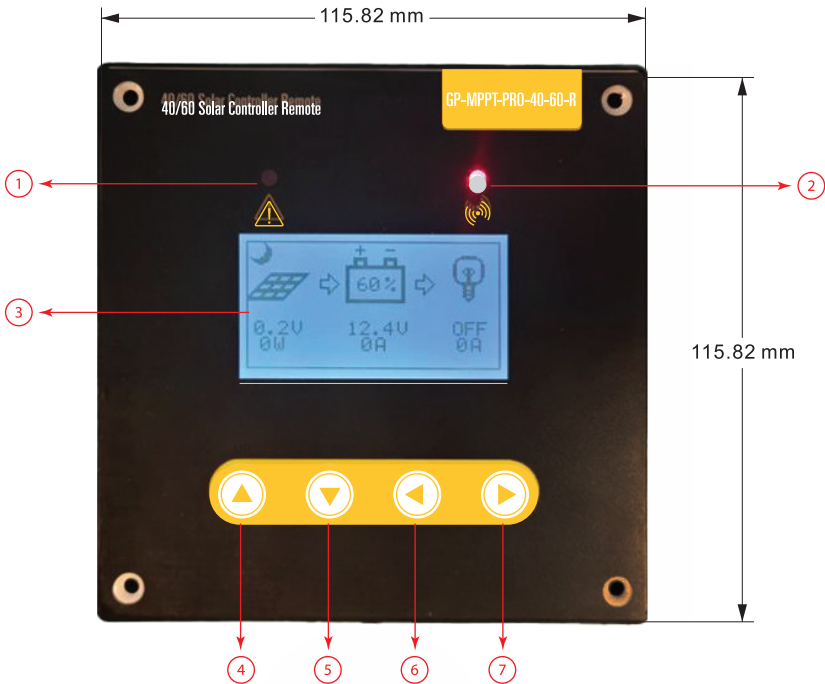

NO.	DESCRIPTION	NO.	DESCRIPTION
1	Communication Fault Indicator	5	Down Button
2	Communication Connection Indicator	6	Escape Button
3	LCD Screen	7	OK Button
4	Up Button		

## INSTALLATION

The GP-MPPT-PRO-40-60-R installation on a controller case or panel.

External dimensions: 115.82×115.82mm

Installation dimensions: 96mm or 103.82x103.82mm

Installation hole diameter:  $\varnothing$  3.5 (mm)

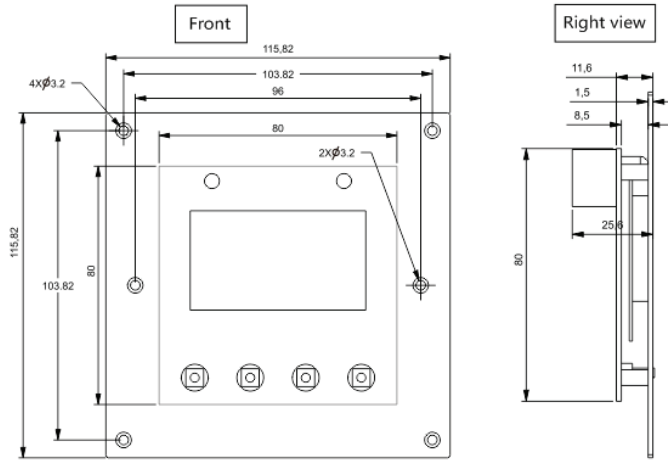

The GP-MPPT-PRO-40-60-R installation on a Wall.

External dimensions: 118.5×118.5x48mm

Installation dimensions: 50x50mm or 70x70mm

Installation hole diameter:  $\varnothing$  5 (mm)

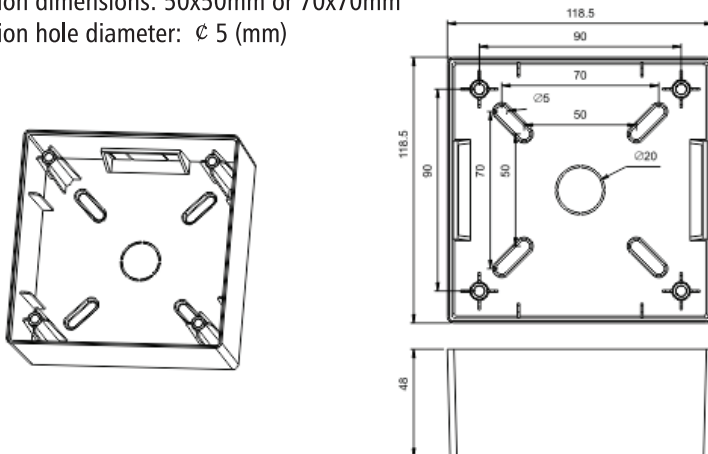

## USAGE OF NAVIGATION KEYS

The product design features 4 keys which, from left to right, are:

"▲", "▼", "◀", "▶"

They equal to ("Up", "Down", "ESC", "OK")

KEY	OPERATION	DESCRIPTION
▲	Tap, press and hold	1) When browsing a menu , tap the key for a page up; 2) In parameter setting, tap the key to increase the value by a minimum unit; 3) Press and hold the key for quick page -up movement or value increasing.
▼	Tap, press and hold	1) When browsing a menu , tap the key for a page down; 2) In parameter setting, tap the key to decrease the value by a minimum unit; 3) Press and hold the key for quick page-down movement or value decreasing.
◀	Tap	1) When browsing a menu, tap the key to return to the previous level, until the main menu is reached; 2) In the setting mode, a tap on this key can cancel the data modification in process and exit the setting mode.
	Press and hold	In any menu, press and hold the key to immediately skip to the "error code page for convenient checkup.
▶	Tap	1) In a menu which contains submenus, tap the key to enter into a submenu; 2) In a menu with settable or adjustable parameters, tap the key to enter into or confirm parameter setting.
	Press and hold	If "manual mode" is selected as the load mode, a press-and-hold on the key to switch on/ off the load. If it's not in the manual mode, a press-and-hold will cause the display to skip to the load mode setting interface as a reminder. (Note: if no load is connected to the controller, this function and related load parameters will become inoperative.)

## PACKING LIST

ITEM	QTY	REMARKS
LCD Display Unit	1	-
Data Cable (25ft)	1	6 cores, RJ12 at both ends
KA3 * 12_Black Countersunk Machine Screws	4	For installation on a panel
KA4 * 25mm Tapping Screws	4	For installation on a wall
M6 * 25mm Plastic Expansion Bolts	4	

Find tech tips, manuals and support at [gpelectric.com](http://gpelectric.com)