

REV	ECN NO	REVISIONS	DRN	CKD	APP	DATE
A	—	NEW RELEASE	BP	—	NO	9-7-17

RoHS Compliant 515-1221F LIGHTPIPE

Part Numbers with the "F" suffix ending are RoHS Compliant.
Packaging is marked with "RoHS Compliant" label or equivalent markings.

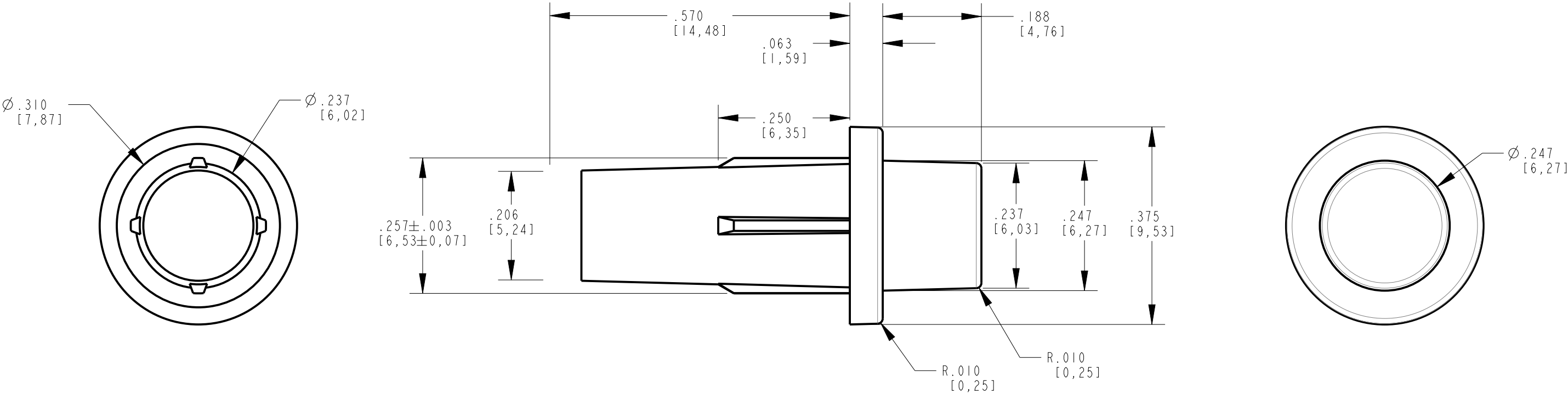

NOTES:

- DIALIGHT PART NUMBER: 515-1221F
- LIGHT PIPE TO BE MOUNTED IN $.250" \pm .002"$ MOUNTING HOLE
- MOUNTING HOLE RECOMMENDED TO BE DEBURRED TO BREAK ALL SHARP EDGES, $45^\circ \times .005"$ CHAMFER
- MATERIAL TO BE CLEAR POLYCARBONATE WITH FLAMMABILITY RATING UL94-V0

THIS DRAWING AND THE CONTENTS HEREIN ARE CONFIDENTIAL AND THE SOLE PROPERTY OF DIALIGHT CORP. REPRODUCTION OF THIS DRAWING OR CONSTRUCTION OF ANY PARTS WITHIN THIS DRAWING ARE FORBIDDEN WITHOUT THE WRITTEN CONSENT OF DIALIGHT CORP.		
SCALE: 5.000	DRAWING NUMBER	REV
ALL DIM'S: INCH (mm)	C-18156	A
TOLERANCES: UNLESS OTHERWISE SPECIFIED	TITLE VERTICAL LIGHT PIPE W/ FLANGE, .250" MTG HOLE	
FRACTIONS: $\pm 1/64$ DECIMALS (.XX): $\pm .01$ DECIMALS (.XXX): $\pm .005$ DECIMALS (.XXXX): $\pm .0005$ ANGLES: $\pm 1^\circ$	MATERIAL	
FINISH	Dialight 1501 ROUTE 34 SOUTH FARMINGDALE, NJ 07727 (732) 919-3119 www.dialight.com	
FSCM 83330	SHEET 1 OF 1	FAMILY TABLE: