

PART NUMBER	LED COLOR (nm)
597C3008202F	RED (630)
597C3008207F	
597C3208202F	ORANGE (606)
597C3208207F	
597C3408202F	YELLOW (588)
597C3408207F	
597C3608202F	ICE BLUE
597C3608207F	
597C3908202F	WHITE
597C3908207F	

REV	REVISIONS	DRN	APP	DATE
A	NEW RELEASE	LD	NO	1-9-19
B	ADDED CHROMACITY COORDINATE AND VIEWING ANGLE	LD	NO	4-25-19
C	REVISED PART NUMBERS ADDED ESD, JUNCTION TEMP & THERMAL RESISTANCE VALUE	LD	NO	5-17-19

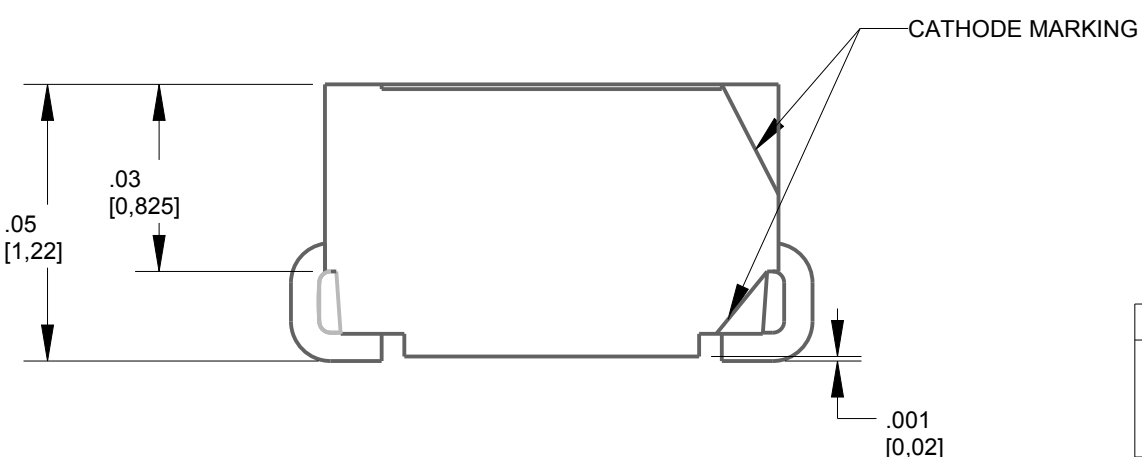
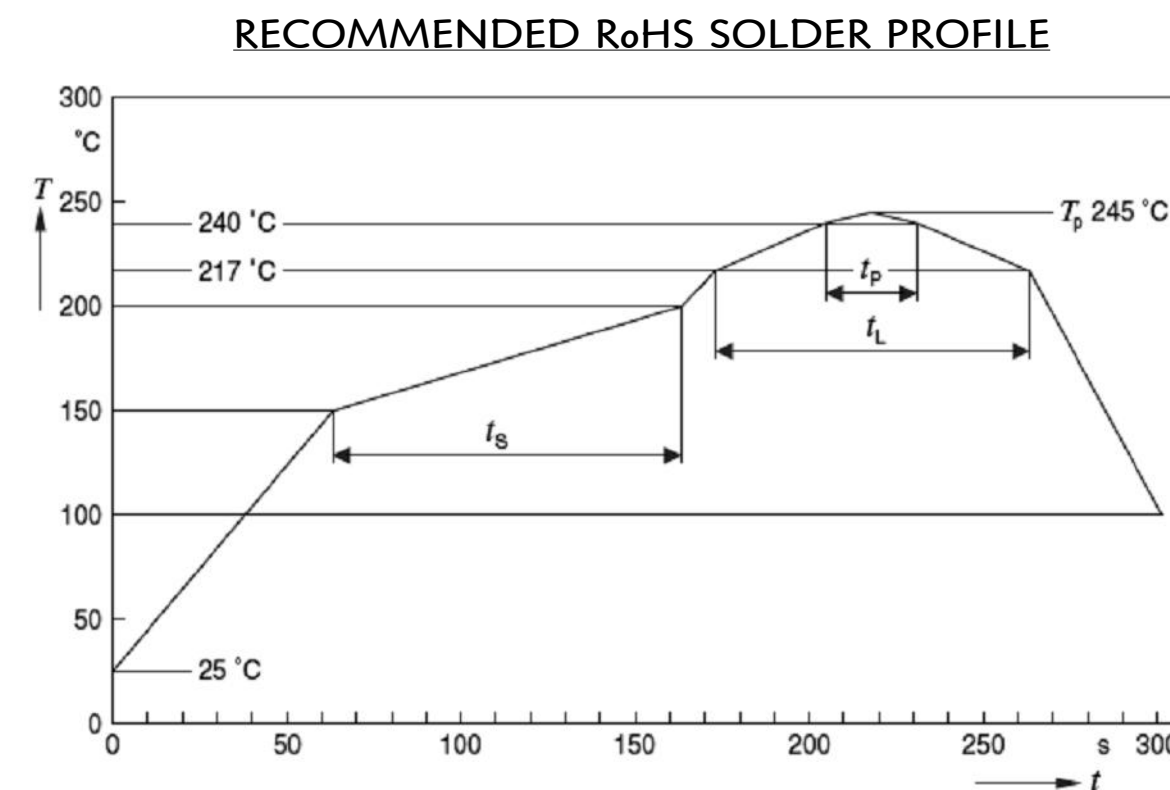
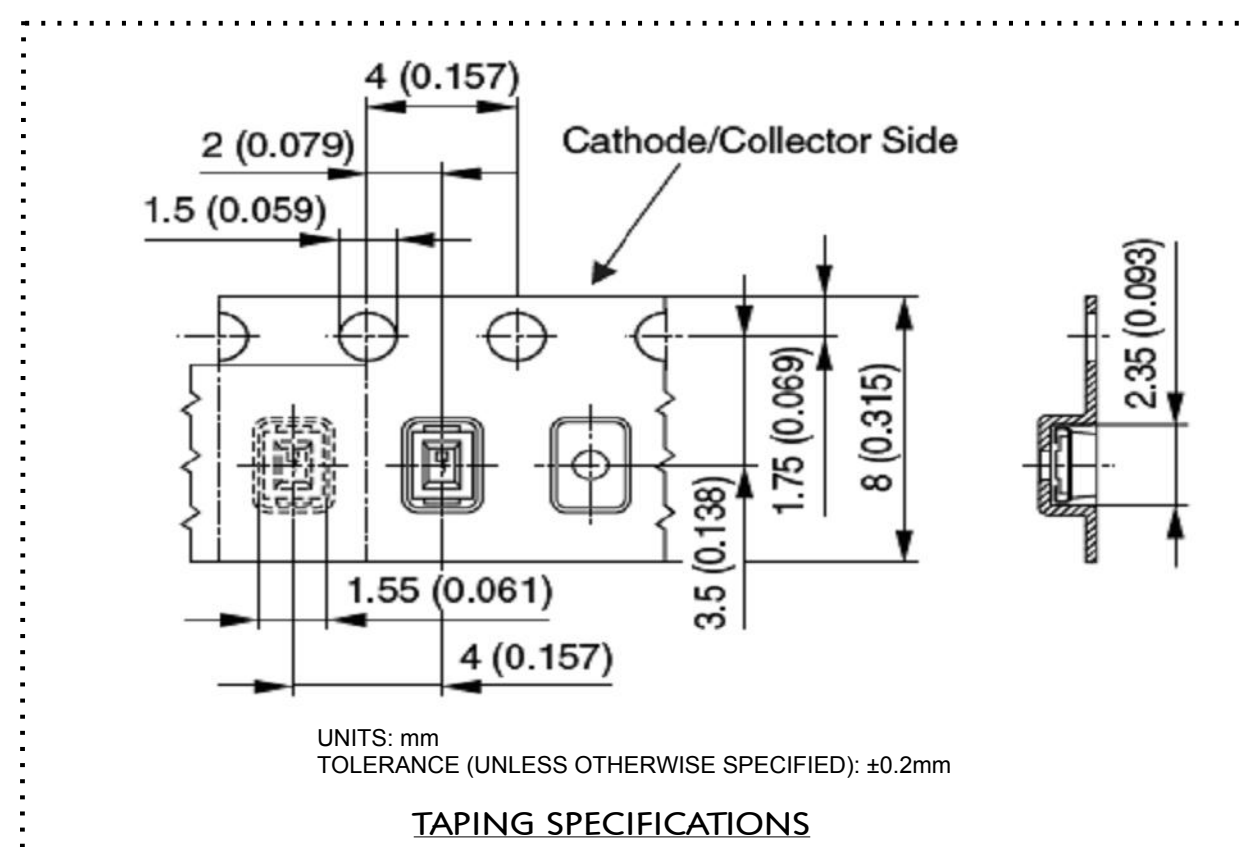
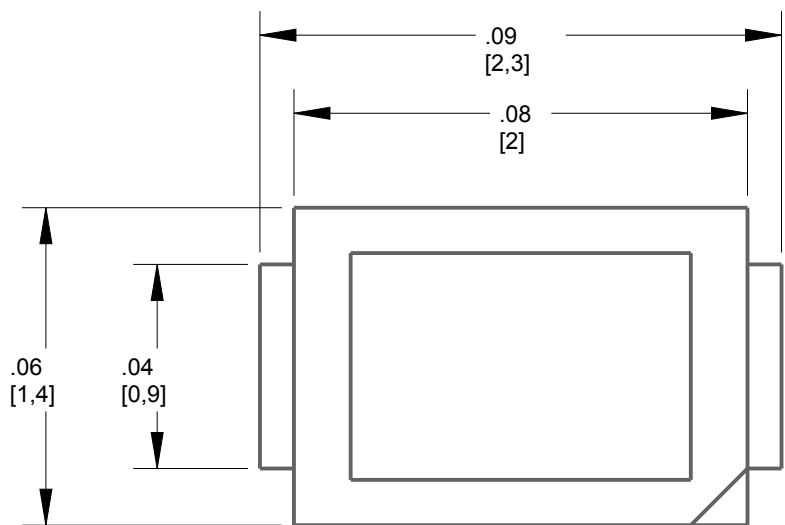

ABSOLUTE MAXIMUM RATINGS AT 25 °C							
LED COLOR (nm)	FORWARD CURRENT (mA)	SURGE CURRENT (mA) t<10µs; D=.005	REVERSE VOLTAGE (V)	ELECTROSTATIC DISCHARGE (ESD)	OPERATING TEMPERATURE (°C)	STORAGE TEMPERATURE (°C)	JUNCTION TEMPERATURE (°C)
RED (630)	20	100	12	2000	-40 TO +100	-40 TO +100	100
ORANGE (606)	20	100					
YELLOW (588)	20	100	5				
ICE BLUE	15	150					
WHITE	20	200					

MARK	DEFINITION	CONDITION
TS _{max}	Maximum of pre-heating temperature	260 °C
TS _{min}	Minimum of pre-heating temperature	150 °C
T _s	Time form Tsmin to Tsmax	60-120 sec
T _L	Reference temperature	217 °C
t _L	Retention time for TL	within 80s
T _P	Peak Temperature	245 °C
t _P	Time for peak temperature	within 20s
DTr/Dt	Temperature rising rate	under 3 °C/sec
DTd/Dt	Temperature decreasing rate	under -3 °C/sec

OPERATING CHARACTERISTICS AT 25 °C															
LED COLOR (nm)	TEST CONDITION	CHROMACITY COORDINATE		LUMINOUS INTENSITY (mcd)			DOMINANT WAVELENGTH (nm)			REVERSE CURRENT (MAX)	FORWARD VOLTAGE IF=20mA			THERMAL RESISTANCE K/W (MAX)	VIEWING ANGLE (DEG) @ 50% IV
		Cx	Cy	MIN	TYP	MAX	MIN	TYP	MAX		MIN	TYP	MAX		
RED (630)	2	0.2	0.3	3.55	9	14	624	630	636	10 uA @VR=12V	1.7	1.8	2.2	280	120
ORANGE (606)				5.6	14	22.4	600	606	609		1.7	1.8	2.2		
YELLOW (588)				4.5	11	18	580	587	595		1.7	1.8	2.2		
ICE BLUE				9	15.7	22.4					2.5	2.75	3.1	230	
WHITE				.33	.33	9	23	36					2.5		

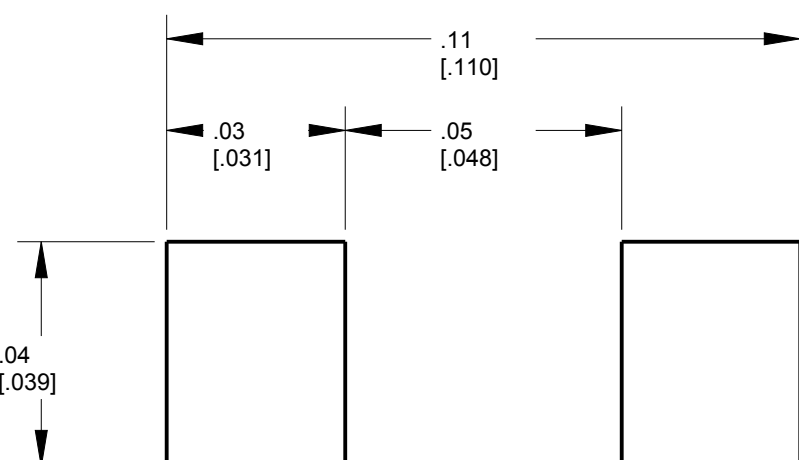
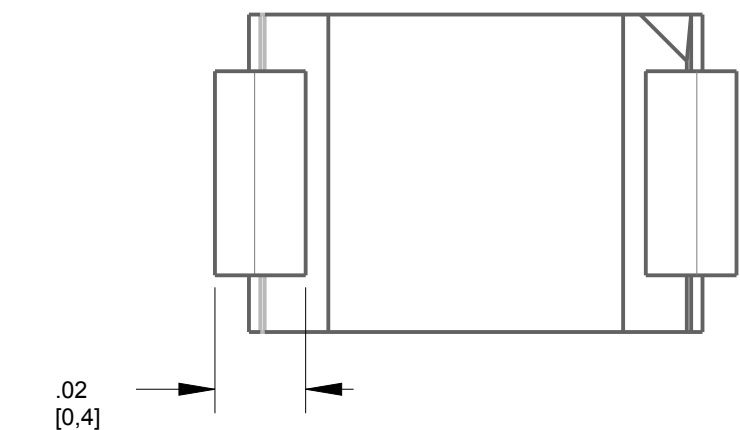

RECOMMENDED SOLDER PAD LAYOUT

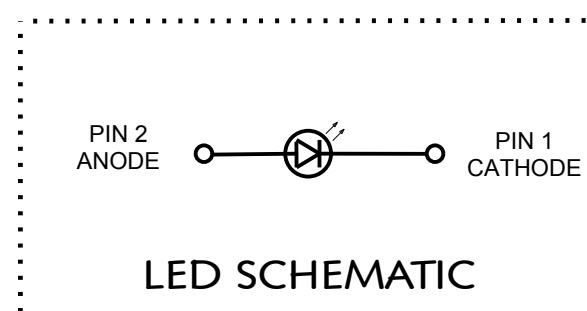

ATTENTION:
OBSERVE PRECAUTIONS FOR
HANDLING ELECTROSTATIC
SENSITIVE DEVICES

THIS DRAWING AND THE CONTENTS HEREIN ARE CONFIDENTIAL AND THE SOLE PROPERTY OF DIALIGHT CORP. REPRODUCTION OF THIS DRAWING OR CONSTRUCTION OF ANY PARTS WITHIN THIS DRAWING ARE FORBIDDEN WITHOUT THE WRITTEN CONSENT OF DIALIGHT CORP.		
DIALIGHT CORP. INTERNAL REFERENCE ONLY = 3D MODEL: 450021848X15-A-1		
SCALE: 30.00	DRAWING NUMBER	REV
ALL DIMS IN: INCHES (MM)	C-18410	C
TOLERANCES: UNLESS OTHERWISE SPECIFIED	TITLE	
FRACTIONS: ±1/64	MINI-PLCC2 PACKAGE	
DECIMALS (.XX): ±.01	MATERIAL	
DECIMALS (.XXX): ±.005	Dialight	
DECIMALS (.XXXX): ±.0005	1501 ROUTE 34 SOUTH FARMINGDALE, NJ 07727 (732) 919-3119 www.dialight.com	
ANGLES: ±1°	FINISH	
FSCM 83330	SHEET 1 OF 1 FAMILY TABLE:	