



Certifications & Ratings

- RoHS compliant
- NEMA 4X
- IP67

Application

The 657 Series LED Panel Mount Indicators are designed with a highly durable watertight housing. These indicators are designed for a variety of applications such as:

- Electrical control panels
- Wastewater treatment controls
- Buses and transit vehicles dashboards
- Agricultural and construction equipment dashboards
- Aircraft and military vehicles dashboards
- Status Indication on industrial equipment

... and many more!

Dimensions

inches [mm]

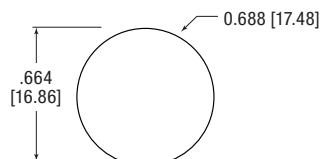
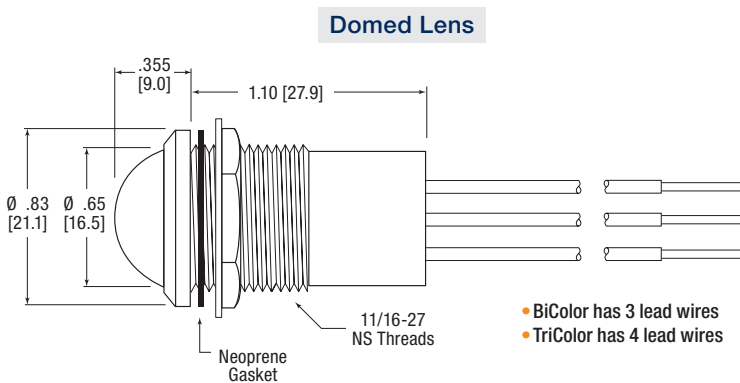
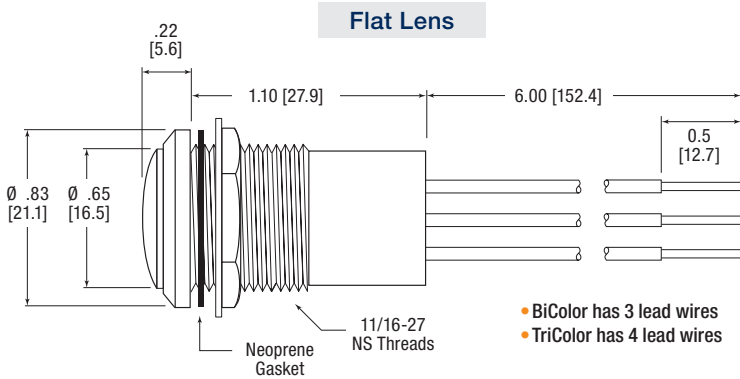

Recommended Mounting Hole

Mechanical Information

Mounting Hole Size: 0.687" (17.46mm)

Max Panel Thickness: 0.350" (8.89mm)

Mounting Torque: 15 in-lbs

Specifications

Voltage Options: 8-30 VCD (no resistor required)

Operating Temp: -40°C to +85°C
(-40°F to +185°F)

Storage Temp: -40°C to +100°C
(-40°F to +212°F)

Electrical Connection: 18 AWG anti-capillary wire

Housing: Polycarbonate (UL 94V-0)

Lens Material: Polycarbonate (UL 94V-0)

Wire Leads: 6" — Wire color is the same color as LED color; Black wire is common ground

Lock Washer: White Nickel Plated Bronze

Nut: White Nickel Plated Brass

Ordering Information 657 Series

Flat

| Part Number | LED Color | Lens Color | Typ. IF (mA) | Typ. VF (VDC) | Typical Intensity (mcd) |
|---------------|-----------|----------------|--------------|---------------|-------------------------|
| 657-1415-303F | Red | White Diffused | 20 | 8-30 | 270 |
| | Green | | | | 515 |
| 657-1425-303F | Red | | | | 270 |
| | Blue | | | | 90 |
| 657-1435-303F | Green | | | | 515 |
| | Yellow | | | | 310 |
| 657-1455-303F | Red | | | | 270 |
| | Yellow | | | | 310 |
| 657-1465-303F | Green | | | | 515 |
| | Blue | | | | 90 |
| 657-1485-303F | Red | | | | 270 |
| | Green | | | | 515 |
| | Blue | 90 | | | |
| 657-1495-303F | Red | 270 | | | |
| | Green | 515 | | | |
| | Yellow | 310 | | | |

Domed

| Part Number | LED Color | Lens Color | Typ. IF (mA) | Typ. VF (VDC) | Typical Intensity (mcd) |
|---------------|-----------|----------------|--------------|---------------|-------------------------|
| 657-2415-303F | Red | White Diffused | 20 | 8-30 | 255 |
| | Green | | | | 500 |
| 657-2425-303F | Red | | | | 255 |
| | Blue | | | | 90 |
| 657-2435-303F | Green | | | | 500 |
| | Yellow | | | | 260 |
| 657-2455-303F | Red | | | | 255 |
| | Yellow | | | | 260 |
| 657-2465-303F | Green | | | | 500 |
| | Blue | | | | 90 |
| 657-2485-303F | Red | | | | 255 |
| | Green | | | | 500 |
| | Blue | 90 | | | |
| 657-2495-303F | Red | 255 | | | |
| | Green | 500 | | | |
| | Yellow | 260 | | | |

Part Number Guide

| Part Number Guide | | | | | | | | | | RoHS Compliant | |
|-------------------|---|-----------|---|---------|---|------------|---|----------------|---|----------------|---|
| 6 | 5 | 7 | - | X | X | X | - | 3 | 0 | 3 | F |
| Lens Style | | LED Color | | Voltage | | Lens Color | | | | | |
| Flat | 1 | Red | 4 | 1 | 5 | 5-30 VDC | 3 | White Diffused | | | |
| Domed | 2 | Red | 4 | 2 | | | | | | | |
| | | Blue | 4 | 2 | | | | | | | |
| | | Green | 4 | 3 | | | | | | | |
| | | Yellow | 4 | 3 | | | | | | | |
| | | Red | 4 | 5 | | | | | | | |
| | | Yellow | 4 | 5 | | | | | | | |
| | | Green | 4 | 6 | | | | | | | |
| | | Blue | 4 | 6 | | | | | | | |
| | | Red | 4 | 8 | | | | | | | |
| Green | 4 | 8 | | | | | | | | | |
| Blue | 4 | 8 | | | | | | | | | |
| Red | 4 | 9 | | | | | | | | | |
| Green | 4 | 9 | | | | | | | | | |
| Yellow | 4 | 9 | | | | | | | | | |

Dialight reserves the right to make changes at any time in order to supply the best product possible. The most current version of this document will always be available at: www.dialightsignalsandcomponents.com

Warranty Statement: Except for the warranty expressly provided for [herein/above/below], Dialight disclaims any and all other warranties, express or implied, including, without limitation, any warranties of merchantability, fitness for a particular purpose, title, and noninfringement.