

OPT SERIES 21.3mm TIR Optic

10°, 25°, 40°, 60°, 80° and 10 x 45°

MECHANICAL / SPECIFICATIONS

NOMINAL OUTPUT ANGLE*:

OPT-0010-014F 10 degrees

OPT-0025-014F 25 degrees

OPT-0040-014F 40 degrees

OPT-0060-014F 60 degrees

OPT-0080-014F 80 degrees

OPT-1045-014F 10 x 45 degrees

LENS SHAPE:

Round

LENS DIMENSIONS - OPTICS:

21.3 mm dia. x 12.45mm high

LIGHT TRANSMISSION:

400nm to 900nm >90%

LENS MATERIAL:

PMMA 8N

UL FLAMMABILITY:

HB

UV RATING:

AMECA Listed

OPERATING TEMPERATURE:

-40°C to +70°C (-40°F to +158°F)

*output can vary based on specific LED used with the optic

CERTIFICATIONS & RATINGS

RoHS

FEATURES & BENEFITS

- High transmissivity
- UL rated optic material
- Optic pre-installed in housing with tape for mounting

APPLICATION

Dialight OPT Series of TIR optics are designed for optical efficiency with a wide variety of today's common high power LEDs.



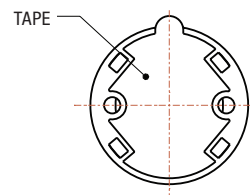
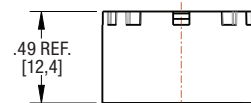
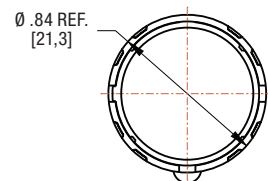

- Down light
- Wall wash
- Illumination
- Spot light
- Architectural
- ...and many more

DIMENSIONS inches [mm]

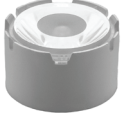
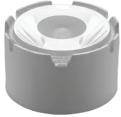

ORDERING INFORMATION

OPTIC FWHM FOR SPECIFIC LEDS

	Part Number	Description	LED	FWHM*
	OPT-0010-014F	10 degree optic in holder with tape	Cree XPE	9°
			Cree XPE2	9°
			Cree XP-G3	13°
			Nichia NVSL219C	17°
	OPT-0025-014F	25 degree optic in holder with tape	Cree XPE	21°
			Cree XPE2	20°
			Cree XP-G3	24°
			Nichia NVSL219C	24°
	OPT-0040-014F	40 degree optic in holder with tape	Cree XPE	41°
			Cree XPE2	40°
			Cree XP-G3	43°
			Nichia NVSL219C	40°
	OPT-0060-014F	60 degree optic in holder with tape	Cree XPE	66°
			Cree XPE2	60°
			Cree XP-G3	65°
			Nichia NVSL219C	72°
	OPT-0080-014F	80 degree optic in holder with tape	Cree XPE	82°
			Cree XPE2	80°
			Cree XP-G3	83°
			Nichia NVSL219C	81°
	OPT-1045-014F	10 x 45 degree optic in holder with tape	Cree XPE	11° x 43°
			Cree XPE2	11° x 44°
			Cree XP-G3	19° x 40°
			Nichia NVSL219C	8°x 42°

*FWHM equals full width of the optic output to half the maximum (peak) output

PRECAUTIONS

- Handle and Install optics wearing gloves. Skin oils may damage or alter the optical performance of the product
- If needed, clean product with mild soap, water and a soft cloth
- Avoid the use of commercial cleaning solvents, including alcohol on the products.



Dialight reserves the right to make changes at any time in order to supply the best product possible. The most current version of this document will always be available at: www.dialightsignalsandcomponents.com

Warranty Statement: Except for the warranty expressly provided for at: www.dialight.com/resources/warranties/, Dialight disclaims any and all other warranties, express or implied, including, without limitation, any warranties of merchantability, fitness for a particular purpose, title, and noninfringement.