

Product description

MAIN FEATURES

The Eokit is a subrack with side panels of aluminum. It is a cost-effective solution for Eurocards systems with depths of 160, 220 or 280 mm

The special shapes on the side wall make it possible to securely fasten the front extrusions with only half as many screws.

- › Side walls are of 2 mm aluminum
- › 19" height extrusions with 3 mm overlay (standard only)
- › With cover plates suitable for use with vibrations exposure
- › Side wall with integrated 19" mounting bracket

PRODUCT VARIETY

- Standard: 19" mounting brackets with height extrusions
- Integrated: 19" mounting brackets integrated in side panel

ECOKIT 11

TYPICAL APPLICATIONS

- Simple electronics
- Applications in 19" cabinets

Executions

SIZES

- Height: 3 or 6 U
- Width: 42 or 84 HP
- Depth: 216 or 336 mm

COLOR

- Aluminum clear anodized

Product structure

CONFIGURATION

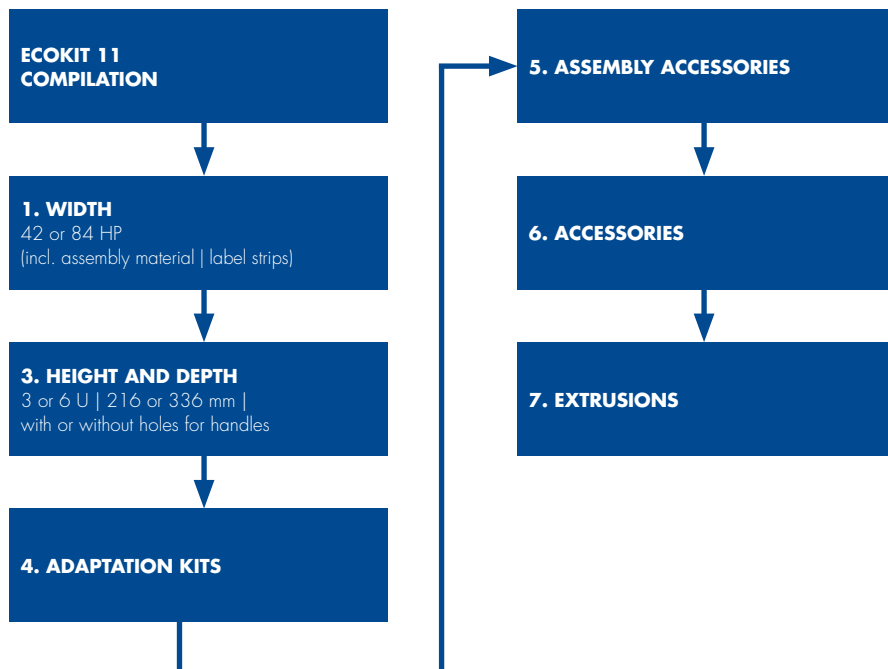

CONSTRUCTION EXAMPLES

ECOKIT 11 STANDARD

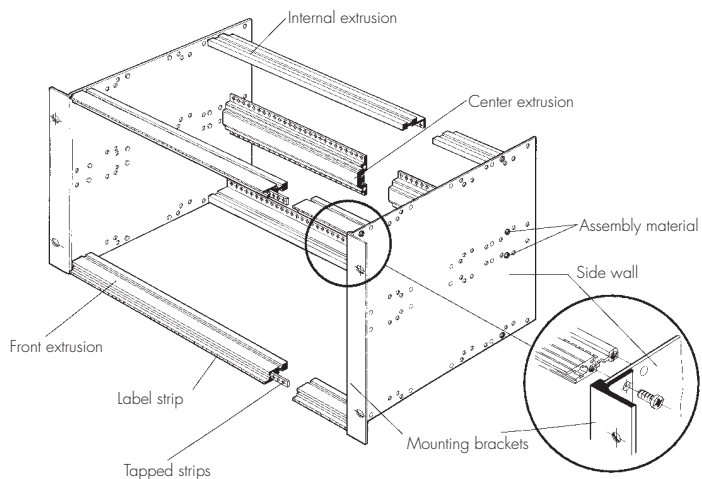

ECOKIT 11 INTEGRATED

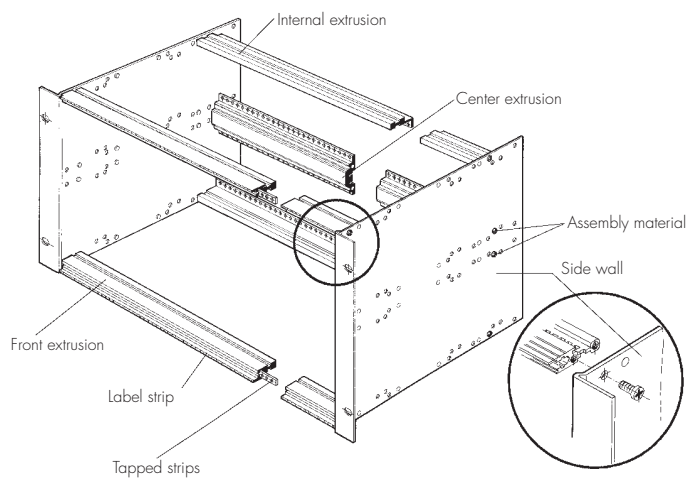

Product structure

WIDTH

- Width: 42 or 84 HP
- Other widths on request
- Set with or without center extrusion

Scope of delivery:

- 2 front extrusions, aluminum, clear anodized
- 4 tapped strips M2.5 (6 for version with center extrusion)
- 2 internal extrusions
- 1 center extrusion (version with center extrusion only)
- Insulating strips (for backplane mounting only)
- Assembly material (torx screws)



Description	42 HP	84 HP
Standard set without center extrusion	11E101	11E103
Set insulated backplane mounting without center extrusion	11E104	11E106
Standard set with center extrusion	11E107	11E109
Set insulated backplane mounting with centre extrusion	11E110	11E112

Label strip:

- 1 label strip consisting of 4 single tapes

Scope of delivery	42 HP (01-42 / 42-01)	84 HP (01-84 / 84-01)
2 pieces each (upper and lower)	63-142	63-046

HEIGHT AND DEPTH

- Standard: 19" height extrusions separately
- Integrated: 19" mounting brackets integrated in side panel
- Other heights and depths on request

Scope of delivery:

- 2 side walls, 2 mm aluminum, raw (integrated: Clear anodized)
- 2 height extrusions, aluminum, clear anodized (standard version only)

Height	Description	Depth	
		216 mm 8.50"	336 mm 13.22"
3 U	Standard without holes for handles	11E201	11E203
	Standard with holes for handles	11E204	11E206
	Integrated without holes for handles	11E207	-
6 U	Standard without holes for handles	11E209	11E211
	Standard with holes for handles	11E212	11E214
	Integrated without holes for handles	11E215	-

Product structure

HANDLES

U-HANDLE OF ALUMINUM

- Aluminum, anodized
- Width: 9 mm

Scope of delivery:

- 1 aluminum handle
- 2 countersunk screw torx T20 (M4 x 10)

Height	A		Part No.
	mm	inch	
3 U	88.9	3.5	60-573
6 U	222.3	8.75	60-576

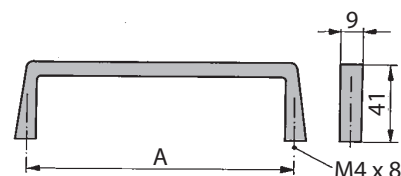

DIE CAST ALUMINUM HANDLE

- Universal handle
- White aluminum, wet painted (RAL 9006)

Scope of delivery:

- 1 aluminum handle
- 2 countersunk screws torx T20 (M4 x 10)

Height	A		Part No.
	mm	inch	
3 U	88.9	3.5	60-563
6 U	222.3	8.75	60-566

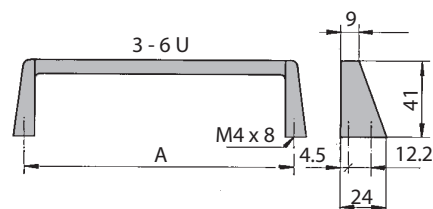

Drawings and dimensions

LINE DRAWING

FRONT VIEW

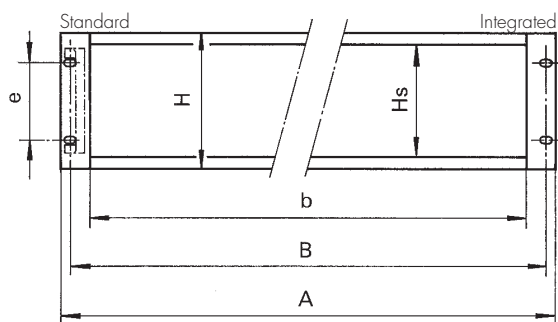

VIEW FROM ABOVE

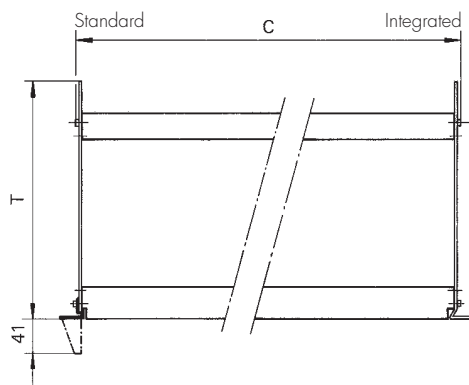

Height			Depth		Width			
U	H	Hs	T	HP	A	B	b	C
3	132.5 mm 5.21"	112.5 mm 4.43"	216 336 mm 8.5 13.22"	42	269.2 mm 10.60"	252.5 mm 9.94"	213.3 mm 8.40"	226.8 mm 8.93"
6	265.85 mm 10.47"	245.85 mm 9.68"	216 336 mm 8.5 13.22"	84	482.6 mm 19.00"	465.9 mm 18.34"	426.7 mm 16.80"	440.2 mm 17.33"

Adaptation kits

RECESSED CARD INSTALLATION KIT

- For recessed mounting of Eurocards (without front panels)

Scope of delivery:

- 2 internal extrusions
- 2 tapped strips M2.5
- Assembly material (8 cylinder head screws with torx T20 (M4 x 10))

Description	Width	Part No.
Mounting for recessed Eurocards (without front panels)	84 HP	11E530

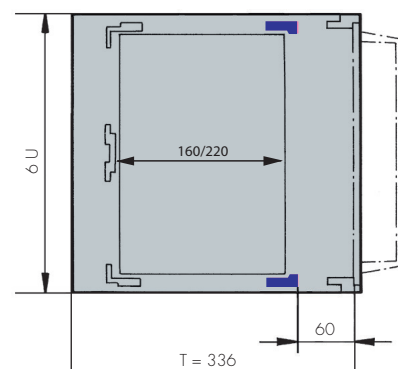
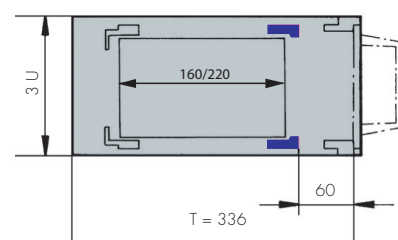
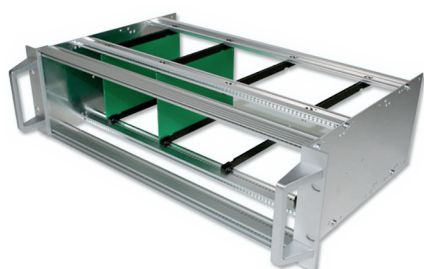

Adaptation kits

FRONT SUB DIVISION HORIZONTAL IEC FOR CARD GUIDES

- For sub division of front
- Possibility to mount card guides
- Built on a special extrusion
- Easy and quick assembly
- Cost effective solution
- Delivered in set form
- Usable width 84 HP
- Other widths on request

Scope of delivery:

- 1 piece passivated front sub division extrusion
- 2 pieces tapped strips M2.5
- 4 pieces cylinder head screws torx T20 (M4 x 10)

Description	Part No.
EMC front sub division horizontal IEC for card guides	63K837-24

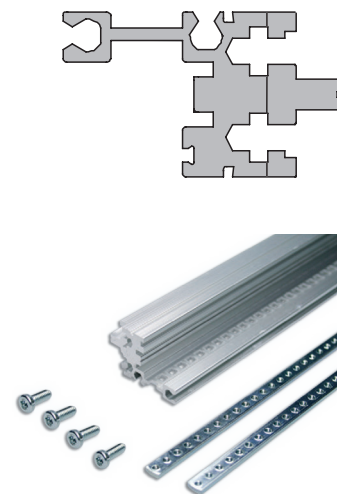

FRONT SUB DIVISION HORIZONTAL IEC

- For sub division of front
- Without possibility of using card guides
- Built on a special extrusion
- Easy and quick assembly
- Cost effective solution
- Delivered in set form
- Usable width 84 HP
- Other widths on request

Scope of delivery:

- 1 piece passivated front sub division extrusion
- 2 pieces tapped strips M2.5
- 4 pieces cylinder head screws torx T20 (M4 x 10)

Description	Part No.
EMC front sub division horizontal IEC	63K837-22

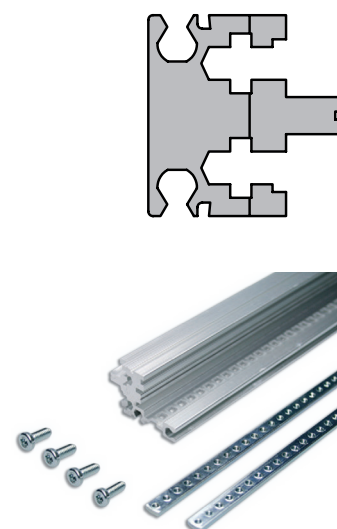

Adaptation kits

EDGE CONNECTOR EXTRUSION

- Suitable for standard extrusion 66-144
- Edge connector extrusion without assembly material

Length			Part No.	
HP	mm	inch	clear passivated*	raw
8	40.6	1.59	66-145-40	
18	91.4	3.59	66-145-41	
28	142.2	5.6	66-145-42	
42	213.4	8.4	66-145-63	
63	320	12.6	66-145-65	
81	411.5	16.2	66-145-22	
84	426.7	16.8	66-145-52	
	1350	53.14		66-145-19

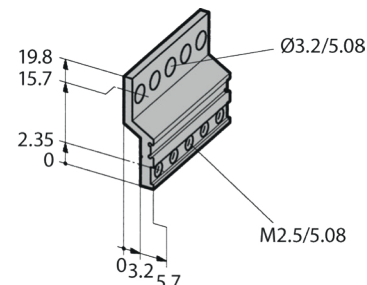
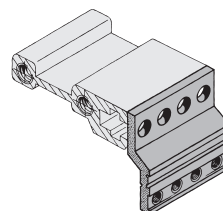

*electrically conductive

Assembly material:

Description	Part No.
Assembly material M2.5 (for 2 supplementary extrusions)	63-214

EDGE CONNECTOR EXTRUSION

- For use with a backplane mounting extrusion 66-193
- Edge connector extrusion without assembly material

Length			Part No.	
HP	mm	inch	clear passivated*	raw
8	40.6	1.59	66-147-40	
18	91.4	3.59	66-147-41	
28	142.2	5.6	66-147-42	
42	213.4	8.4	66-147-63	
63	320	12.6	66-147-65	
81	411.5	16.2	66-147-22	
84	426.7	16.8	66-147-52	
	1350	53.14		66-147-19

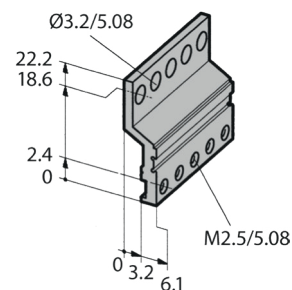
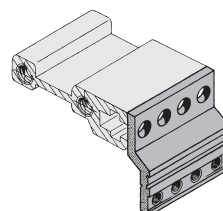

*electrically conductive

Assembly material:

Description	Part No.
Assembly material M2.5 (for 2 supplementary extrusions)	63-214

Assembly accessories

FRONT SUB DIVISION VERTICAL 6 | 3 U

- Single and double Eurocards (6 U)

Scope of delivery:

- 1 divider extrusion front
- 1 divider extrusion rear
- 2 front extrusions
- 2 internal extrusions
- 1 set assembly material (cross recessed)

Front sub division vertical 6 | 3 U:

- Other versions on request

Width a	Width b		Part No.
	42 HP	84 HP	
32 HP	c = 8 HP	c = 50 HP	11-959-2

Tapped strips for front extrusion:

Scope of delivery	Description	Part No.
1 piece tapped strip	Tappes stripe M2.5, 32 HP	61-463

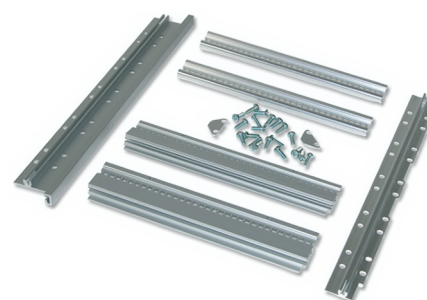
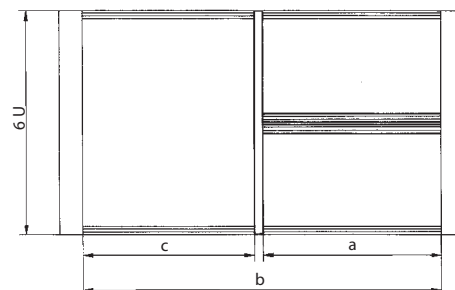

HORIZONTAL CARD MOUNTING KIT

- Double Eurocards (6 U)
- Independent of card depth
- Top and bottom cover plate when no overall fan front panel is used (has to be ordered separately)

Scope of delivery:

- 4 distance plates (2 in front | 2 rear)
- 4 front extrusion (2 in front | 2 rear)
- 1 center extrusion
- 6 tapped strips M2.5
- 1 set assembly material (torx)

Mounting height	Usable height	Backplane	Cover plate top	Cover plate bottom
3 U	20 HP	14K971-60	21N602-90	21N602-90
6 U	48 HP	14K991-60	21N606-90	21N607-90

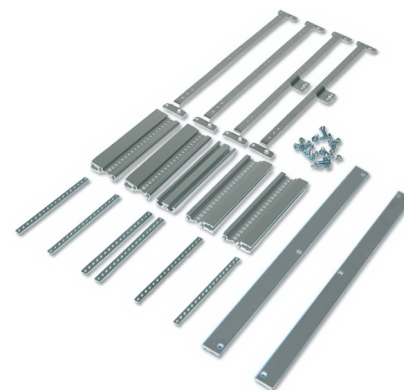
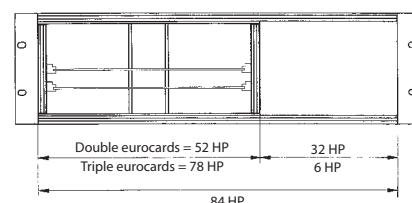

Accessories

PERFORATED COVER PLATES

- 1 mm sheet aluminum, perforated
- Fastening on longitudinal and internal extrusion
- Thread in front and internal extrusion available
- Mechanical protection for the card area
- Cover plates for card depths 300 and 400 mm on request

Scope of delivery:

- 1 perforated cover plates

Enclosure width	Enclosure depth	A	B	C	D	Part No.
42 HP	160 mm 6.30"	217.64 mm 8.56"	149 mm 5.86"	207.5 mm 8.16"	107.25 mm 4.22"	11-701
	220 mm 8.66"	217.64 mm 8.56"	209 mm 8.22"	207.5 mm 8.16"	159.75 mm 6.28"	11-702
84 HP	160 mm 6.30"	431 mm 16.96"	149 mm 5.86"	415.5 mm 16.35"	107.25 mm 4.22"	11-706
	220 mm 8.66"	431 mm 16.96"	209 mm 8.22"	415.5 mm 16.35"	159.75 mm 6.28"	11-707
	280 mm 11.02"	431 mm 16.96"	269 mm 10.59"	415.5 mm 16.35"	212.25 mm 8.35"	11-708

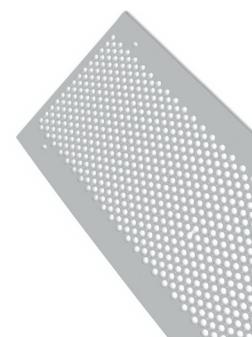
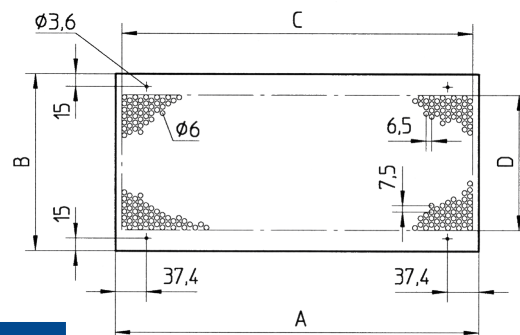

Other widths and depths on request

Assembly material:

Description	Scope of delivery	Part No.
Cross recessed screw M3 x 6	8 pieces / pack	63-195
	1 piece	61-283
Cylinder head earthing screw torx T10 (M3 x 6)	1 piece	5443-04

GROUNDING SET

- Enables enclosures to be grounding in conformance with EN / VDE / NIV

Scope of delivery:

- 1 threaded bolt M4 x 8
- 1 sealing ring
- 1 lock washer
- 1 hexagonal nut M4

Description	Part No.
Earthing set according to EN / VDE / SEV	63-127

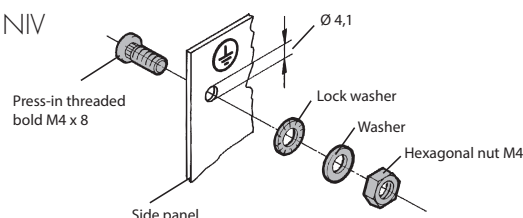

Further general accessories can be found in the brochure "General accessories" or on request.

©Copyright 2018 by Elma Electronic AG, CH-8620 Wetzikon. Subject to technical modifications, all data supplied without liability.

Please contact our sales team for more details.

China: +86 21 5866 5908
France: +33 388 56 72 50

Germany: +49 7231 97 34 0
Israel: +972 3 930 50 25

Singapore: +65 6479 8552
Switzerland: +41 44 933 41 11

United Kingdom: +44 1234 838 822
United States: +1 510 656 3400