

# LED Surface Mount

## LD2-SM08W10

INSTALLATION SHEET

### START FROM HERE

- Make sure **POWER** is **COMPLETELY OFF** at the fuse box
- Have your fixture installed by a qualified licensed electrician
- Prepare everything in a clear area
- Wear gloves at all time during this installation
- Read instructions carefully before you start assembly
- Keep this installation sheet for future reference

#### Please Note:

- This Kuzco LED fixture comes with pre-wired LED module(s).
- Unless instructed to do so, please do not touch any part of the LED module(s) as any unnecessary contact with the module could cause permanent damage.
- For dimming, an ELV (Electronic Low Voltage), TRIAC or 0-10V type of dimmer is required.
- 120-277V input

Technical Support: 1-855-855-8926

1. Remove fixture from its original package
2. Attach mounting plate (1c) to electrical junction box (1a) using junction box screws provided (1e) in hardware package
3. Make proper electrical connections (**black to hot "L"**, **white to neutral "N"**, **ground to "GND"**) with connectors (1b) provided in hardware package. Connect 0-10V dimming wire, DIM+ to purple, DIM- to gray, with connectors provided and place driver (4a) inside electrical junction box (1a). Use connectors to cap the 0-10V wires if not used
4. Attach canopy (2a) to mounting plate (1c), followed by bracket (2c) and secure with screws (2b)
5. Twist fixture (3a) onto bracket (2c) and secure with fixture screw (3b) (See Illustration 1)

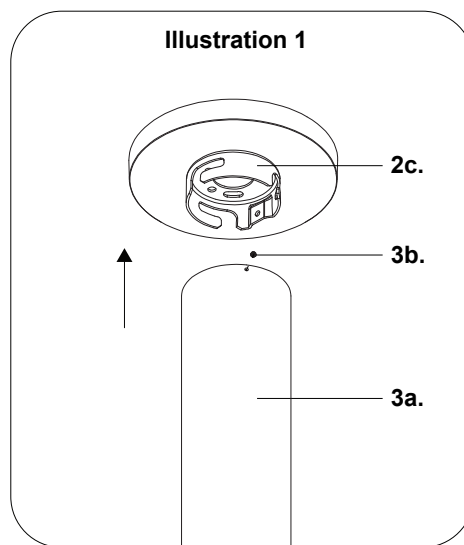
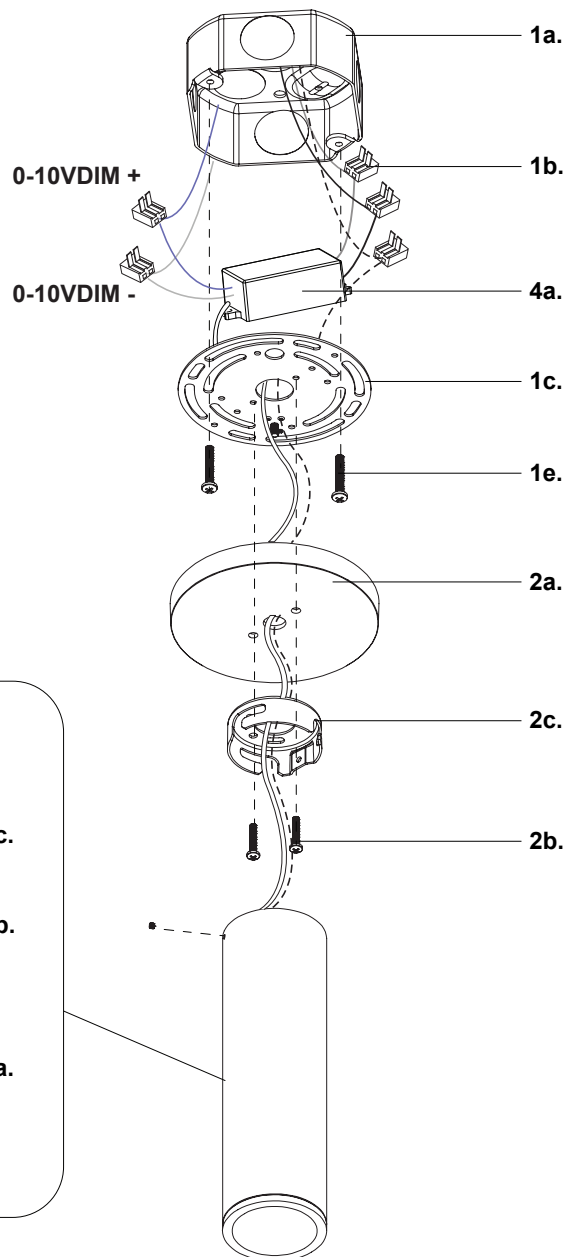

# KUZCO

19054 28th Avenue Surrey, BC Canada V3Z 6M3  
T: 604 538 7162 TF: 1-855 85 KUZCO F: 604 538 7196  
W: kuzcolighting.com  
20250331