

# LED Pendant

# LD3-PD12W18

INSTALLATION SHEET

## START FROM HERE

- Make sure **POWER** is **COMPLETELY OFF** at the fuse box
- Have your fixture installed by a qualified licensed electrician
- Prepare everything in a clear area
- Wear gloves at all times during this installation
- Read instructions carefully before you start assembly
- Keep this installation sheet for future reference

Technical Support: 1-855-855-8926

## Please Note:

- This Kuzco LED fixture comes with pre-wired LED module(s).
- Unless instructed to do so, please do not touch any part of the LED module(s) as any unnecessary contact with the module could cause permanent damage.
- For dimming, an ELV (Electronic Low Voltage), TRIAC or 0-10V type of dimmer is required.
- 120-277V input

## PREPARING FIXTURE

1. Remove LD3-FM12W18 from original packaging
2. Identify the following parts to be discarded from LD3-FM12W18 package (**See Illustration 1**)
3. Disconnect the power lead wire and dimming wires by disengaging the quick connector. Discard the power lead wire and dimming wire (**6a**). A longer power lead wire and dimming wire is provided in the X-LD3-PD-5Cord-120 package
4. Connect the power lead wires included in the X-LD3-PD-5Cord-120 package using the quick connector provided (**3e**). Connect the dimming wires using the quick connector provided
5. Run the power lead wires (**7a**) and dimming wires through the pendant adaptor plate (**4a**)
6. Secure fixture (**3a**) to pendant adaptor plate (**4a**) with screws (**4b**)

ILLUSTRATION 1

Discard the following parts from LD3-FM12W18 package

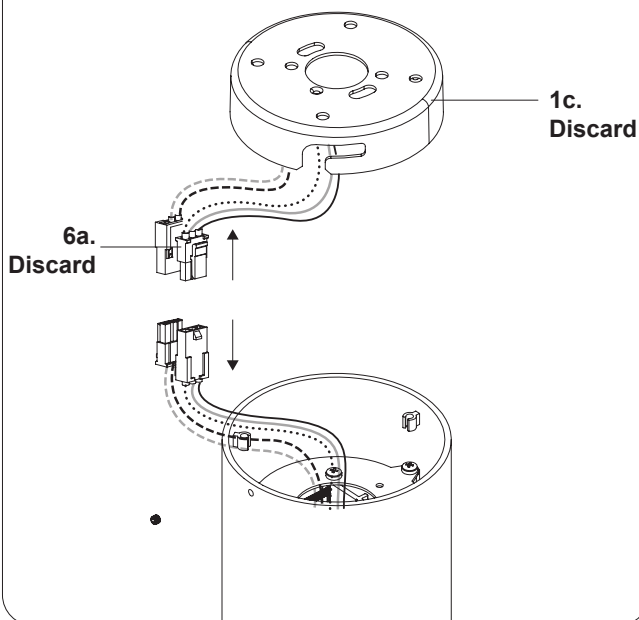

### Power Lead Wires

Hot (Black)	———
Neutral (White)	———
Ground (Green)	.....

### Dimming Wires

Dim - (Gray):	-----
Dim + (Purple):	-----

ILLUSTRATION 2

Assembling fixture parts

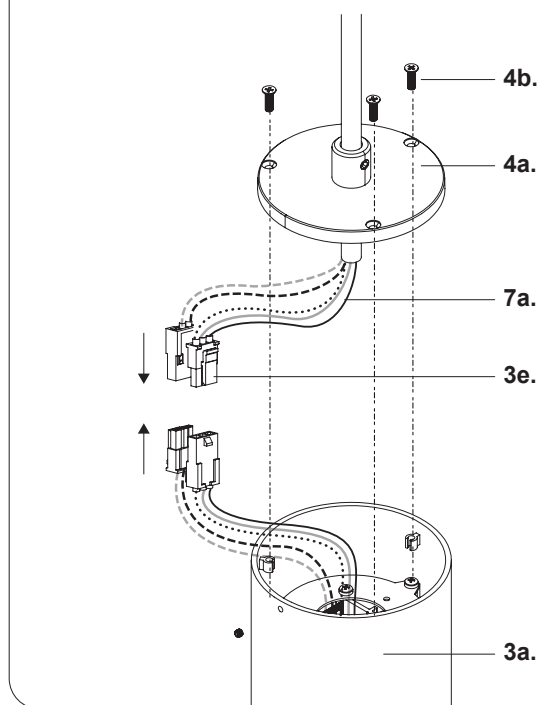

# KUZCO

19054 28th Avenue Surrey, BC Canada V3Z 6M3  
T: 604 538 7162 TF: 1-855 85 KUZCO F: 604 538 7196  
W: kuzcolighting.com  
20250819

# LED Pendant

# LD3-PD12W18

INSTALLATION SHEET

## START FROM HERE

- Make sure **POWER** is **COMPLETELY OFF** at the fuse box
- Have your fixture installed by a qualified licensed electrician
- Prepare everything in a clear area
- Wear gloves at all times during this installation
- Read instructions carefully before you start assembly
- Keep this installation sheet for future reference

Technical Support: 1-855-855-8926

## Please Note:

- This Kuzco LED fixture comes with pre-wired LED module(s).
- Unless instructed to do so, please do not touch any part of the LED module(s) as any unnecessary contact with the module could cause permanent damage.
- For dimming, an ELV (Electronic Low Voltage), TRIAC or 0-10V type of dimmer is required.
- 120-277V input

## INSTALLING FIXTURE

1. Remove fixture parts from pendant cord package
2. Separate mounting plate (1c) from canopy (2a) by removing decorative nuts (2c)
3. Align mounting plate screws (1d) to desired orientation, and then attach mounting plate (1c) to electrical junction box (1a) using junction box screws provided (1e) in hardware package
4. To change fixture height, shorten or lengthen wire by removing screw (2b) from canopy (2a) and push or pull wire to your desired length. Secure screw (2b) in canopy (2a) to lock wire in place
5. Make proper electrical connections (**black to hot "L"**, **white to neutral "N"**, **ground to "GND"**) with wire nuts (1b) provided in hardware package. Connect 0-10V dimming wire, DIM+ to purple, DIM- to gray, with wire nuts provided. Use wire nuts to cap the 0-10V wires if not used
6. Align and insert mounting plate screws (1d) through holes on canopy (2a), secure with decorative nuts (2c)

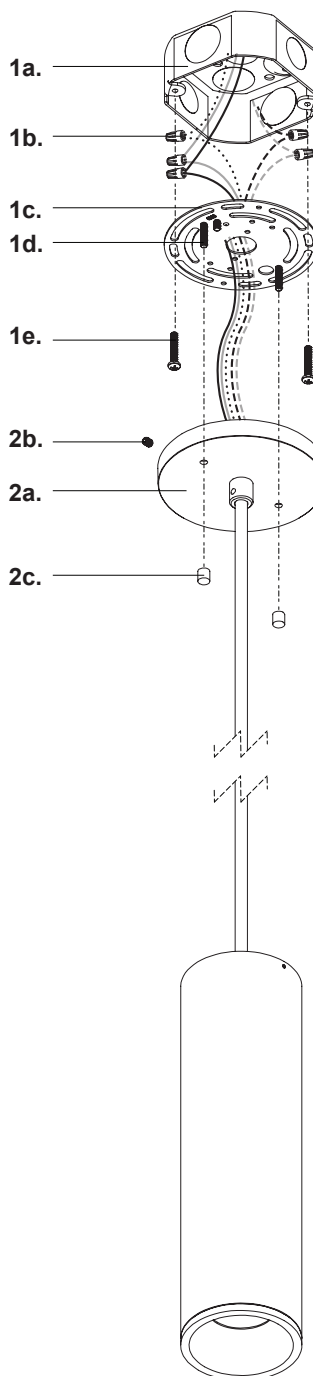

Power Lead Wires	
Hot (Black)	_____
Neutral (White)	_____
Ground (Green)	.....
Dimming Wires	
Dim - (Gray):	-----
Dim + (Purple):	-----

# KUZCO

19054 28th Avenue Surrey, BC Canada V3Z 6M3  
T: 604 538 7162 TF: 1-855 85 KUZCO F: 604 538 7196  
W: kuzcolighting.com  
20250819