

AURORALIGHT

PROJECT: _____

SKU #: _____

TYPE: _____

QUBE

PTA775103

The Qube is among the most versatile fixtures in Auroralight's pathlights. The Qube can be configured pointing to the side on a wall, down on a path, or up to illuminate a tree.

- Storm Drain™ system to expel dirt, dust & water
- Cree LED™ XP-L® High Density
- Thermally Integrated® field serviceable LED module
- Ideal for pathways, wall-washing and gardens

CONFIGURATOR:

PTA775103	LED	FINISH
	<input type="text"/>	<input type="text"/>
() = Most common configuration	(2703) 2700K 3W (3003) 3000K 3W	(NAT) Natural Brass (BLP) Bronze Living Patina (BLPX) Extra Dark BLP (NI) Nickel PVD

AVAILABLE FINISHES:



FIXTURE DIMENSIONS	W3-1/4" x H18" x L2-7/8"
LIGHT SOURCE	Integrated LED
COLOR TEMPERATURES	2700K, 3000K
WATTAGES	3W
CRI (RA)	80 CRI
VOLTAGE	12V
DELIVERED LUMENS	170lm (3000K)
DIMMABLE	Yes, Dim to <10% via Transformer
DRIVER	Yes, 12V Integral Constant Current
TRANSFORMER	12V AC/DC (Supplied by others)
MOUNT	Yes, Included 1/2" NPS Adapter
GROUND STAKE	Yes, Included MGS001109
ACCESSORIES	Yes, Not Included
FINISH	Included Natural Brass
MATERIAL	Brass
WIRE LENGTH	24"
LOCATION	Exterior Wet
CERTIFICATIONS	UL, IP66, IP67

*For complete warranty terms, please visit: www.auroralight.com/warranty/

P. 760.931.2910

O. 2742 Loker Ave. W Carlsbad CA 92010

W. www.auroralight.com

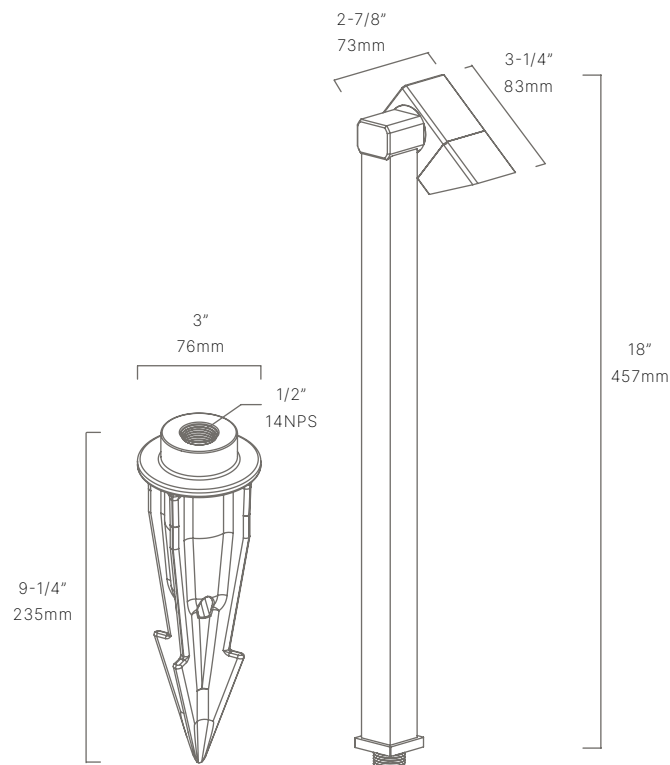

MADE IN USA
WITH DOMESTIC & IMPORTED MATERIALS



ADD-ONS

ACCESSORIES

GS006	90° Glare Shield
-------	------------------

MOUNTS

MGS001510	Ground Stake w/ 2" Brass Cap
MGS001612	Ground Stake w/ 3" Brass Cap
MGS001712	Ground Stake w/ 3-1/4" Brass Cap
MGS005109	9" Deluxe Spike
MGS005212	12" Trident Spike
MJB002303	3" Junction Box w/ PVC Stake
MPM003104	Concrete Pedestal Mount
MSM189102	2" Surface Mount
MSM189203	3" Surface Mount

*For complete details, please visit auroralight.com/mounts/

