

C-Vent Kits and Accessories

APPLICATION

DiversiTech® concentric termination kit simplifies installation for high efficiency furnaces by only requiring one hole through the wall or roof where the pipes terminate. Without using the kit the installation would require cutting two holes through the home (one for each pipe). The kit includes combustion air inlet cap, air inlet pipe, vent pipe and intake/vent concentric Y.

ADVANTAGES

- Using these vents requires only one installation hole in the roof or wall versus two
- Allows the intake for combustion air and the exhaust vent to pass through a standard roof or sidewall
- Available in 2-inch, 3-inch, or 4-inch intake vent sizes
- Made of SDR 26PVC Material

PURPOSE

Three Concentric Vent products are available: CVENT-2 is for use with 2" intake/vent systems, CVENT-3 is for use with 3" intake/vent systems and CVENT-4 is for use with 4" intake/vent systems. Refer to the Category IV appliance installation instructions for intake/vent pipe sizing information.

NOTE: The Concentric Vent reduces the allowable intake/vent piping length by 5 feet from that listed in the basic Category IV appliance installation instructions.

WARNING

Do not use the Concentric Vent kit for anything other than a Category IV heating appliance. Failure to follow this warning could result in re, personal injury or death.

WARNING

Do not operate the furnace until the installation and assembly of the Concentric Vent and all piping are completed. Failure to follow this warning could result

GENERAL SPECIFICATIONS

Each concentric vent kit contains the following items:

- (1) Combustion Air Inlet Cap
- (1) Air Inlet Pipe
- (1) Vent Pipe
- (1) Intake/Vent Concentric "Y"
- (1) Installation Instructions on box

Pipe and fittings are required to complete installation (user supplied). The combustion air and vent pipe fittings must conform ANSI and ASTM standards D1785, F891, D2665, D2241, D2661, or F628. Pipe cement and primer must conform to ASTM standards D2564 or D2235. In Canada, construct all combustion air and vent pipes for this unit of CSA or ULC certified Schedule 40 PVC, PVC-DWV, or ABS-DWV pipe and pipe cement.

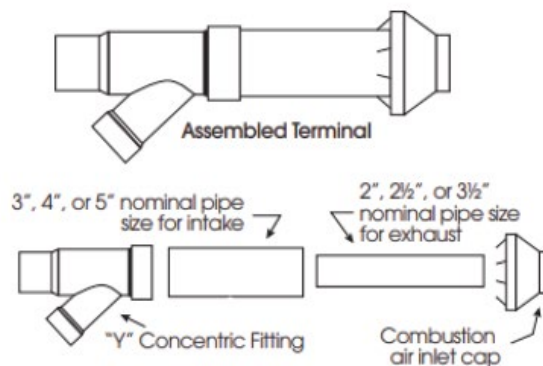

Model	Intake / Vent Nominal Pipe Size	Overall Assembled Length 1	Intake Pipe Diameter	Air Inlet Pipe Length 2
CVENT-2	2in.	34 3/4 in.	3 1/2 in.	19 1/2 in.
CVENT-3	3in.	39 1/8 in.	4 1/2 in.	24 in.
CVENT-4	4in.	57 1/4 in.	5 9/16 in.	41 in.

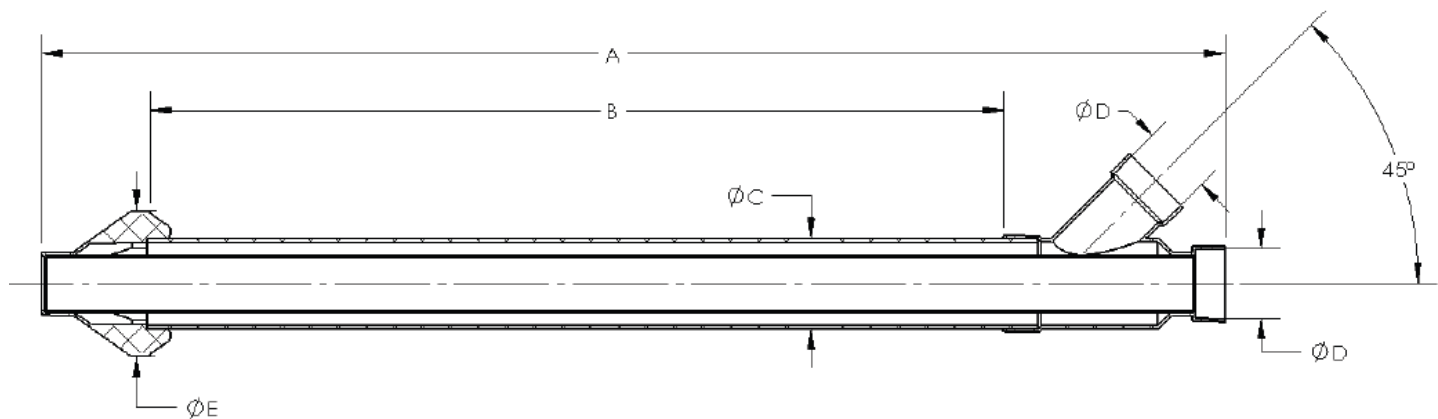

		Dimensions (inches)				
ITEM #	Material	A			Nominal Pipe Size	E
			B	C	D	
CVENT-4	SDR-26-PVC	34.8	18	3.5	2.0	6.4
CVENT-2-EXT	SDR-26-PVC	60	44	3.5	2.0	6.4
CVENT-3-EXT	SDR-26-PVC	39.1	22	4.5	3.0	7.3
CVS-2	SDR-26-PVC	60	43	4.5	3.0	7.3
CVS-3	SDR-26-PVC	57.3	39	5.6	4.0	8.1

ITEM #	Description	UPC Code	Order Multiple
CVENT-2	2in. Concentric Vent	095247107407	1
CVENT-3	3in. Concentric Vent	095247107414	1
CVENT-4	4in. Concentric Vent	095247156658	1
CVENT-2-EXT	2in Concentric Vent, Extended Length	095247171217	1
CVENT-3-EXT	3in Concentric Vent, Extended Length	095247171224	1
CVS-2	Vent Screen - 2in for Concentric Vents	020140057856	5
CVS-3	Vent Screen - 3in for Concentric Vents	025085057862	5
CVENTCAP2	Cap for 2 in. CVENT	095247154531	1
CVENTCAP3	Cap for 3 in. CVENT	095247154548	1
CVENTCAP4	Cap for 4 in. CVENT	095247160990	1
CVENT-2AB	2in. Concentric Vent Accel Bushing	095247154494	1