

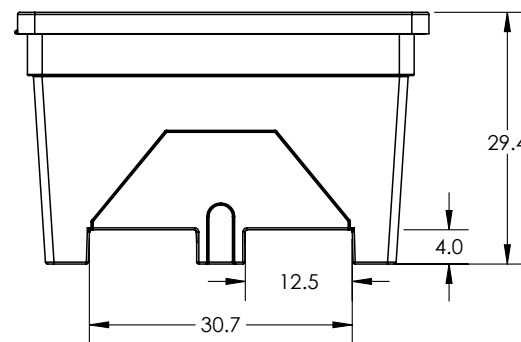

if it flows,
we go with it

1.800.665.4499
barrplastics.com

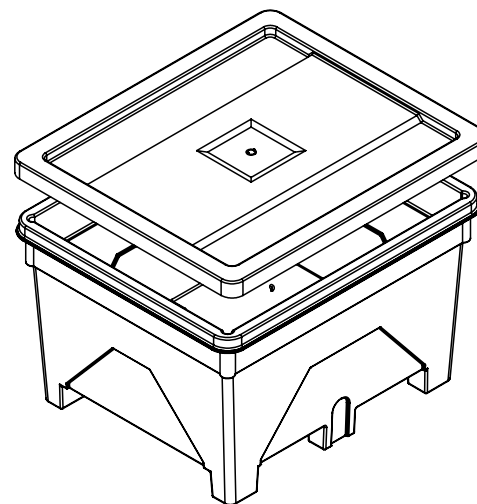
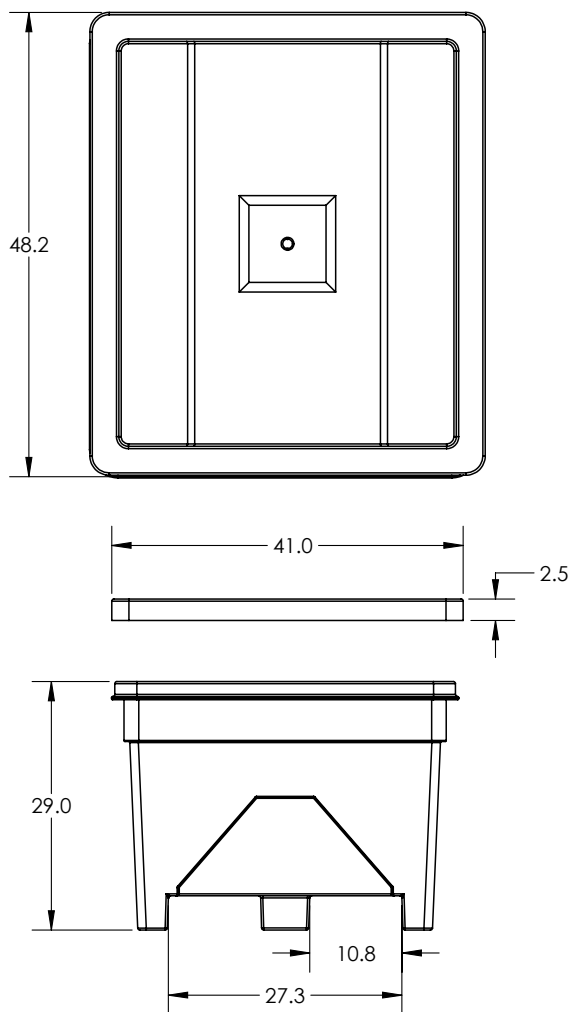

ALL DIMENSIONS ARE IN INCHES, NOMINAL, & SUBJECT TO CHANGE WITHOUT NOTICE.
ALL DIMENSIONS ON ROTATIONAL MOLDED PARTS ARE SUBJECT TO A \pm 3% TOLERANCE.

DO NOT SCALE	DRAWN BY	DATE	BONAR PLASTICS	TITLE:	REVISION
STATUS: Released	KB	10/25/2013	www.bonarpastics.com	BIN VT1200 W/LID	A
© SNYDER INDUSTRIES INC., 2013			1005 Atlantic Drive West Chicago, IL 60185 (630)293-0303	PART NO.	SHEET
ALL DIMENSIONS, DESIGNS, AND INFORMATION ON THIS PRINT MUST BE CONSIDERED PROPRIETARY TO SNYDER INDUSTRIES, INC. AND MAY NOT BE USED, COPIED, OR DISTRIBUTED WITHOUT WRITTEN PERMISSION OF AN OFFICER (OR HIS AGENT) OF THE FIRM.			www.bonarpastics.com	10233XXM	1 OF 1
				ENG. ID.	D001240