



if it flows,
we go with it

1.800.665.4499
barrplastics.com

Outside Corner Male (H-OCM)

The outside corner male has one $\frac{5}{8}$ " tab with a hole that will fit a $\frac{3}{4}$ " bolt or pin, and would be used with a outside corner female (H-OCF) or a single "t" female (H-SF).

All hardware is $\frac{1}{4}$ " thick steel that is hot-dipped galvanized, unless otherwise noted.

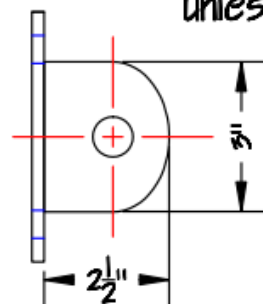
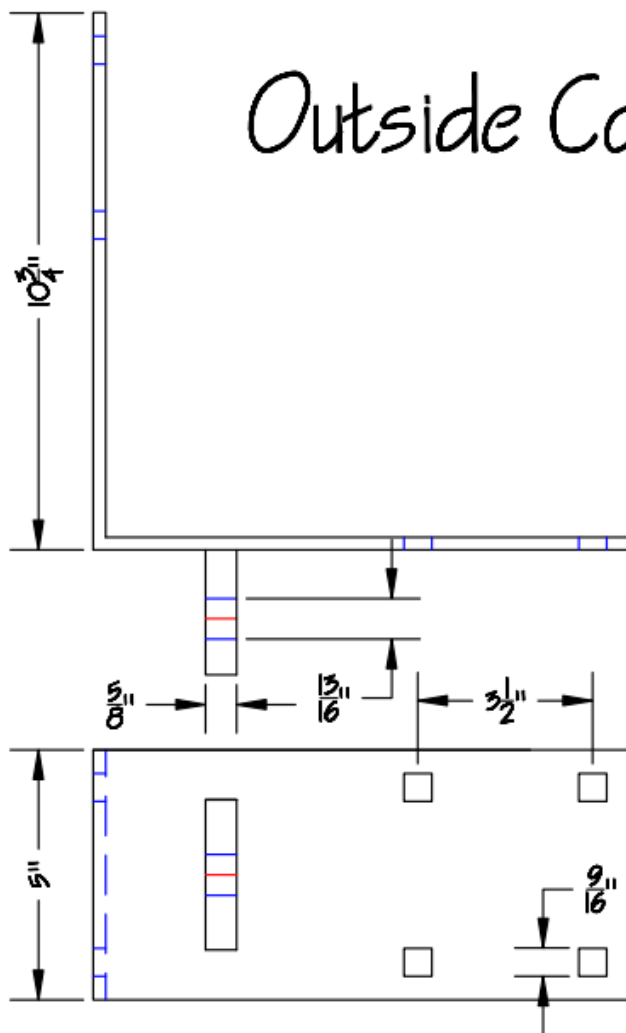

Outside Corner Male (H-OCM)

Hardware Detail