

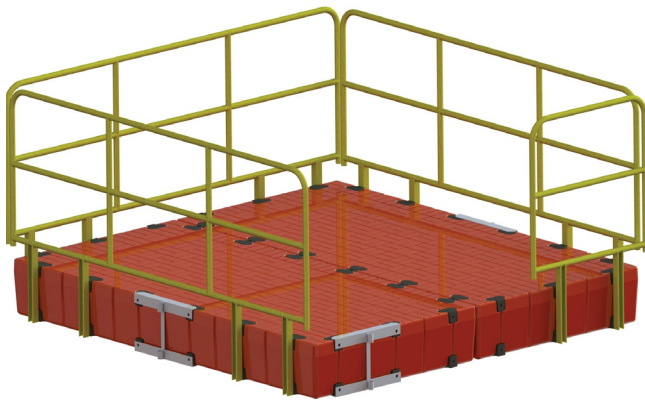

Industrial Docks

Industrial Modular Floating Platform



****FLOAT MODULES CAN BE DOUBLE STACKED FOR ADDITIONAL BUOYANCY**

Tech Specs:

- Buoyancy (per platform, 1 module):
5,832 lbs / 2,645 kg at full submersion
- Weight:
516 lbs / 235 kg without handrails
- Dimensions:
120 x 120 x 15" per platform
- Colours Available:
Tan or orange are standard; custom colour by request

DIMENSIONS
120" x 120" x 15"

- **Easy Installation:** the modular platforms are designed so that one person can install them with the use of a forklift and a wrench or an impact gun
- **Stackable:** sections stack on top of one another for reduced storage footprint and shipping costs.
- **Modular:** the above surface float is designed to add or subtract buoyancy modules based on your specific project requirements. This allows you to have a customized solution at a cost effective price point.

Other Great Features:

- Tough, crack resistant, UV inhibiting polymer resin ensures a long life
- Slip resistant surface
- Optional handrails and grating for a safe walking surface in icy conditions
- Anchor points
- Optional dock cleats to tie up a boat
- 20 stainless connection points molded into the float surface