

**1806 225 11 Ave SE - 06.01.2021**  
**Main - 571.38 sq.ft/ 53.08 m<sup>2</sup>**  
**RMS Area - 571.38 sq.ft/ 53.08 m<sup>2</sup>**

**Ceiling Heights:**

Living Room/Primary - 9'0" / 2.74  
Kitchen - 8'0" / 2.44  
Bathroom - 7'5" / 2.26

**Christina Hagerty - Realtor**  
RE/MAX Realty Professionals  
Tel: 403-815-8185  
christina@christinahagerty.ca  
www.christinahagerty.ca

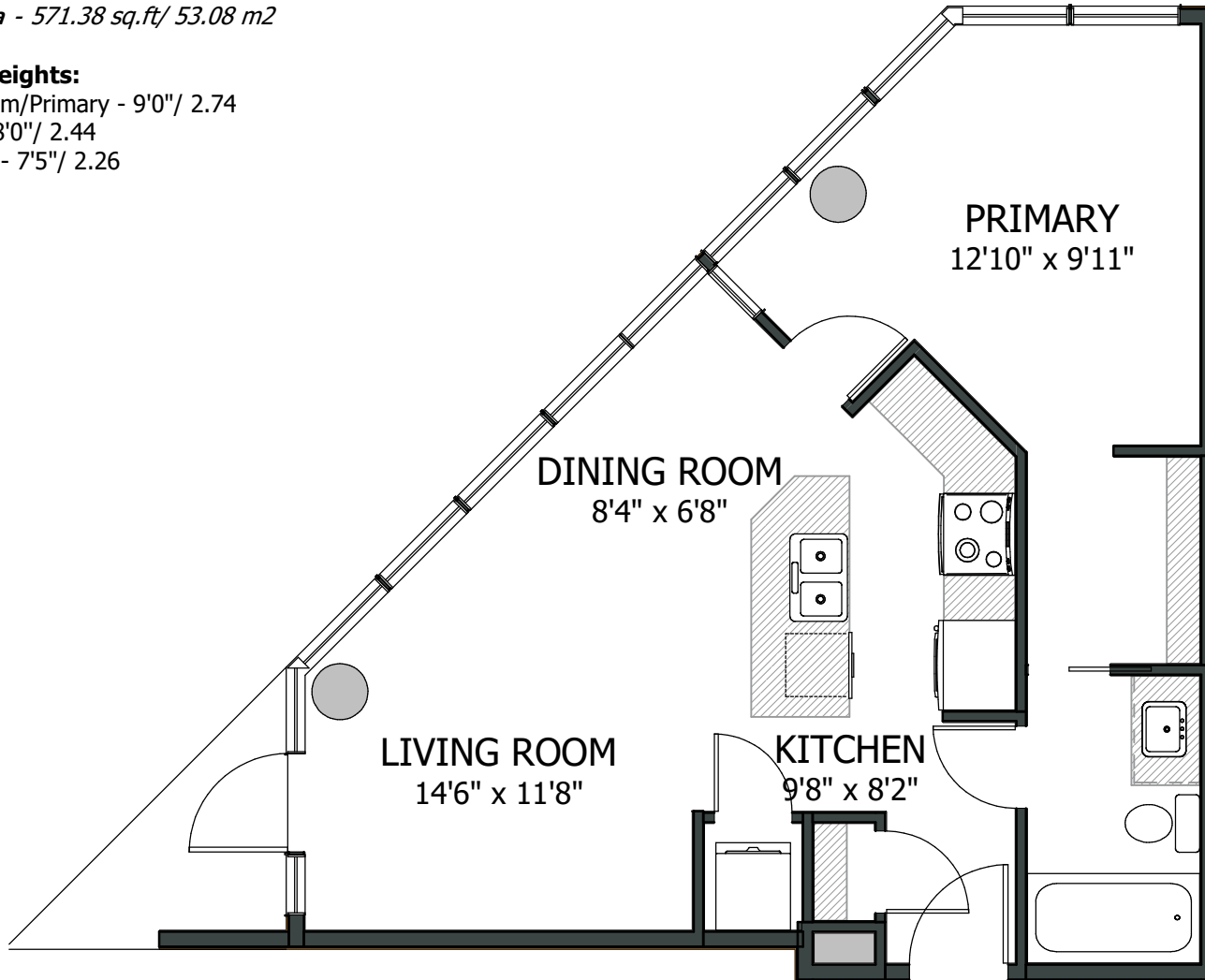

Measurements are insured and are based on local guidelines.  
This floor plan is an illustration based on the measurements taken and existing structures of the property.  
It is intended to be used only by the purchaser of the transaction.