

Main Floor:	454 sq.ft.	42.18 sq.m.
Upper Floor:	211 sq.ft.	19.60 sq.m.
RMS Total:	665 sq.ft.	61.78 sq.m.

Auxiliary Area

Balcony:	36 sq.ft.	3.34 sq.m.
Open To Below:	242 sq.ft.	22.48 sq.m.

SCALE
0' 5'

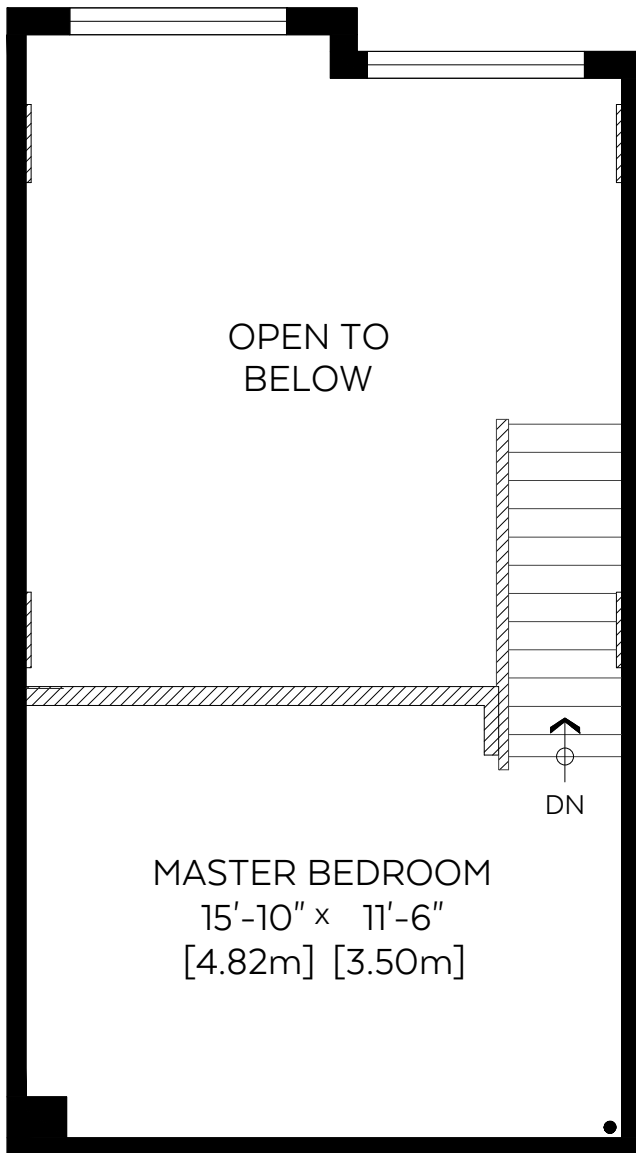

Upper Floor Plan(Above Grd.)
Floor Area: 211 sq.ft./19.60 sq.m.

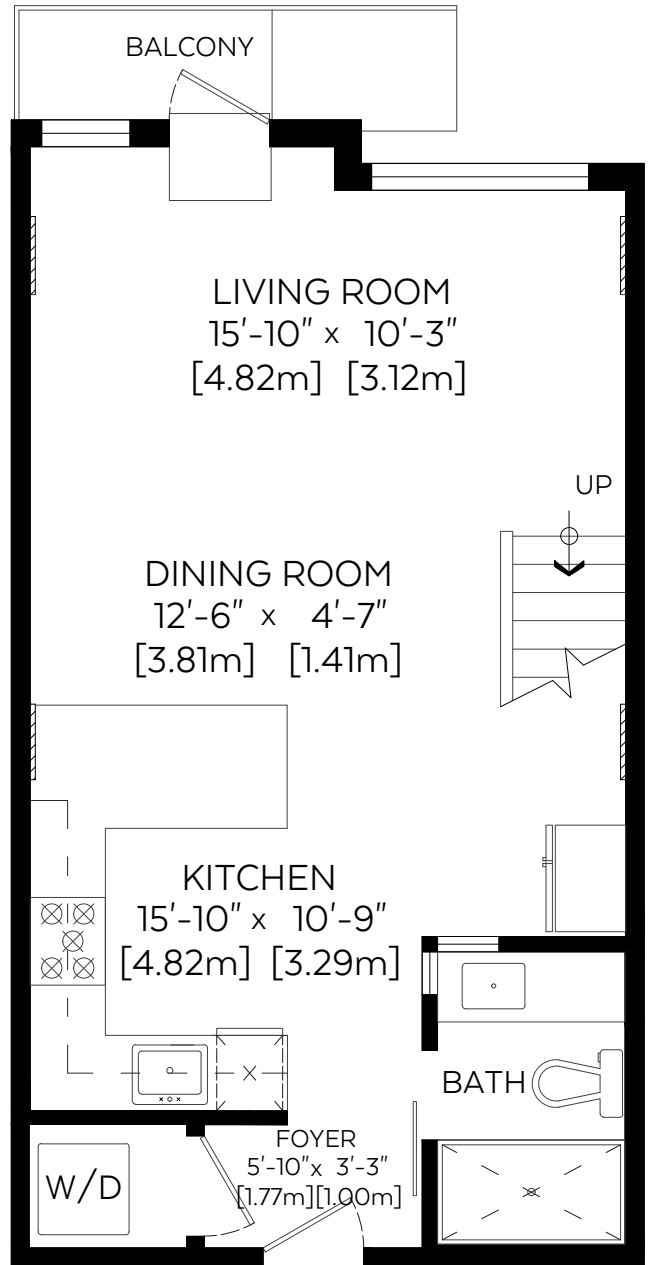

Main Floor Plan(Above Grd.)
Floor Area: 454 sq.ft./42.18 sq.m.

Measured on: June 27, 2017

