

Main Floor:	502 sq.ft.	46.64 sq.m.
Upper Floor:	331 sq.ft.	30.75 sq.m.
RMS Total (Above Grd.):	833 sq.ft.	77.39 sq.m.
Open To Below:	258 sq.ft.	23.97 sq.m.

SCALE

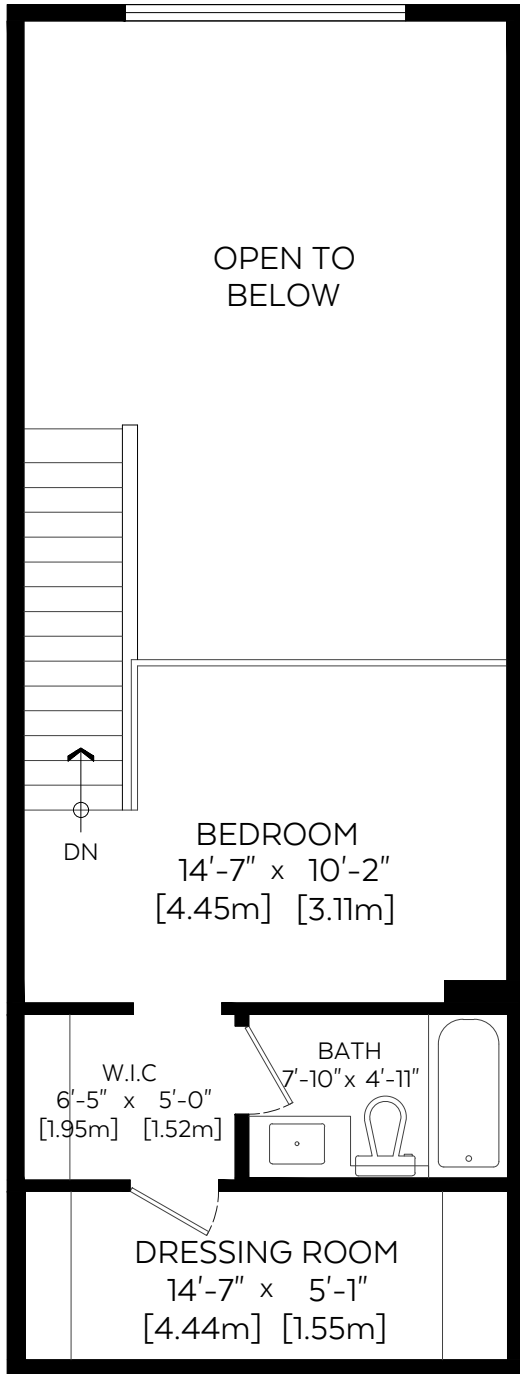

Upper Floor Plan(Above Grd.)

Floor Area: 331 sq.ft./30.75 sq.m.
Ceiling Height : 9'-4"

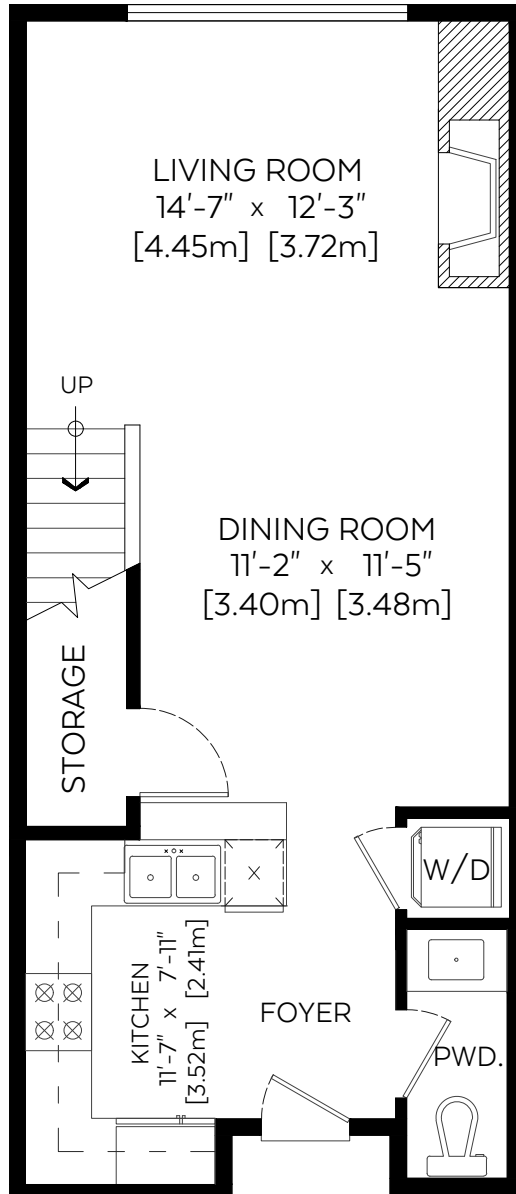

Main Floor Plan(Above Grd.)

Floor Area: 502 sq.ft./46.64 sq.m.
Ceiling Height : 8'-5"



Measured on: April 30, 2018

The floor plan is not suitable for architectural/construction, square footage-method RMS standards used & is covered under E&O. © Excelsior Measuring Inc. 2018. All rights reserved for Excelsior Measuring Inc. Users shall not publish and distribute such material (in whole or in part) and/or incorporate it in other works in any form. *RMS area calculated using interior perimeter walls(point to point) in accordance with RMS principle 4.



NORTH