

Main Floor Plan(Above Grd.)

Floor Area: 517 sq.ft./48.03 sq.m.
Ceiling Height: 8'

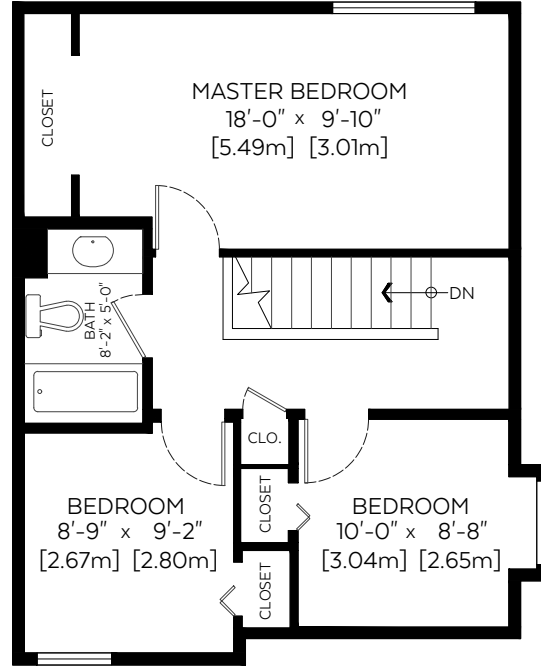

Upper Floor Plan(Above Grd.)

Floor Area: 532 sq.ft./49.42 sq.m.
Ceiling Height: 8'

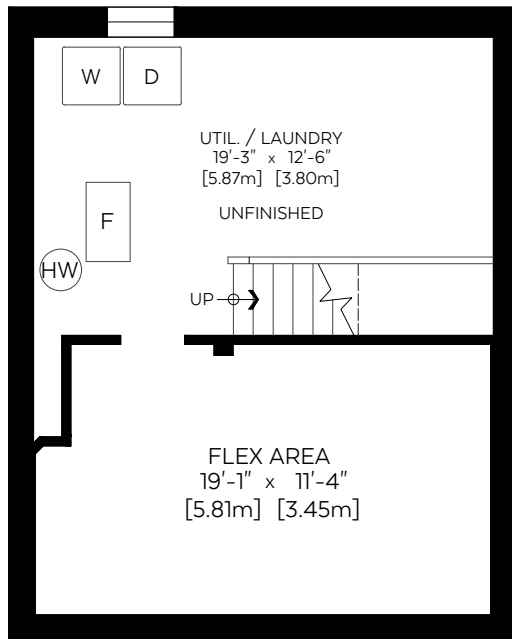

Lower Floor Plan(Below Grd.)

Fin. Floor Area: 218 sq.ft./20.25 sq.m.
Unfin. Floor Area: 245 sq.ft./22.76 sq.m.
Ceiling Height: 7'-8"

Main Floor:	517 sq.ft.	48.03 sq.m.
Upper Floor:	532 sq.ft.	49.42 sq.m.

RMS Total (Above Grd.): 1,049 sq.ft. 97.45 sq.m.

Fin. Lower Floor (Below Grd.):	218 sq.ft.	20.25 sq.m.
Unfin. Lower Floor (Below Grd.):	245 sq.ft.	22.76 sq.m.

Auxiliary Area

Deck:	26 sq.ft.	2.42 sq.m.
-------	-----------	------------

Measured on: April 16, 2018

The floor plan is not suitable for architectural/construction, square footage-method RMS standards used & is covered under E&O. © Excelsior Measuring Inc. 2017. All rights reserved for Excelsior Measuring Inc. Users shall not publish and distribute such material (in whole or in part) and/or incorporate it in other works in any form. *RMS area calculated using interior perimeter walls(point to point) in accordance with RMS principle 4.



NORTH