

# › Connecting Climate FieldView™ and Agrian

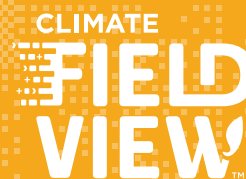

## + Data Integration Partnerships

By working with our partners through API agreements, we're able to provide you a seamless experience while in the field. Moving data between platforms is no longer a manual process. Through our partnerships, you can export data from one platform into the Climate FieldView™ platform. Your field data will be available in just minutes — getting you back out in the field quickly and easily.

### Connecting Agrian to Climate FieldView Applications

Login to [www.agrian.com](http://www.agrian.com)

1 Select the sidebar menu, then “Integrations”.

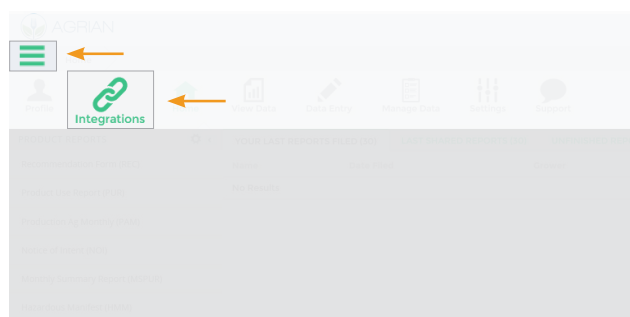

2 Select “New Integration”, then “Climate FieldView”.

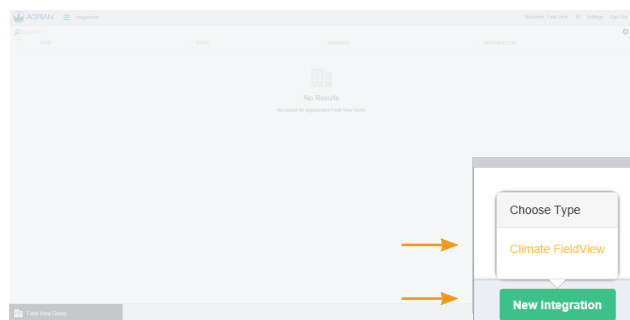

3 Select a “Grower.” Insert the Climate FieldView email account you want to import data into, then select “Save”.

Note: Submitting a sharing key is optional. Your data from Agrian will be transferred to the Data Inbox in your [www.climate.com](http://www.climate.com) account within an hour.

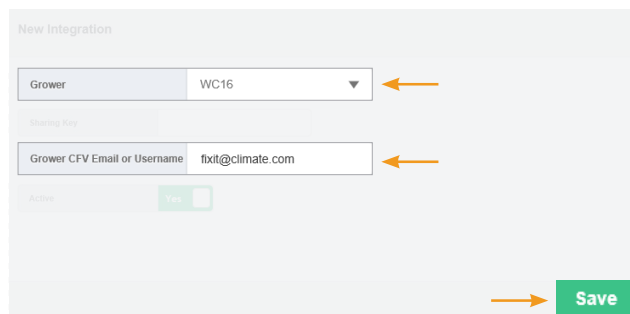

### Transferring Field Boundaries from Agrian to Climate FieldView

Login to [www.agrian.com](http://www.agrian.com)

1 Select the sidebar menu, then “Integrations”.

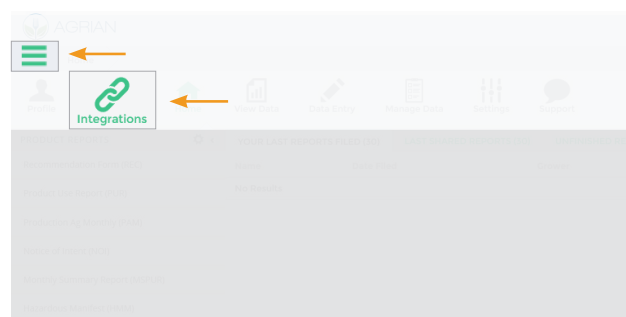

2 Left click on an integration. Select “View This Integration”.

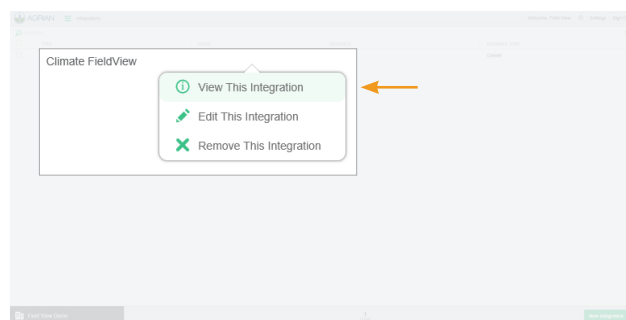

3 Select “Send Boundaries”.

Your data from Agrian will now be transferred to the Data Inbox in your [www.climate.com](http://www.climate.com) account within an hour.

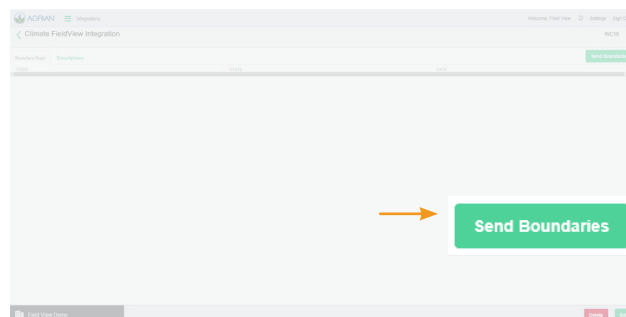

# + Connecting Climate FieldView and Agrian

## Importing Field Boundaries from the Data Inbox

Login to [www.climate.com](http://www.climate.com)

1 Select "Add/Edit Fields".

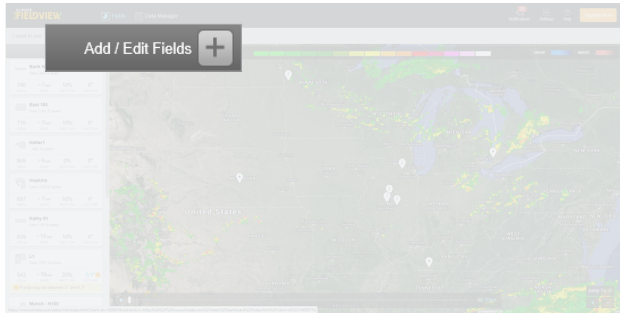

2 Select "Data Inbox".

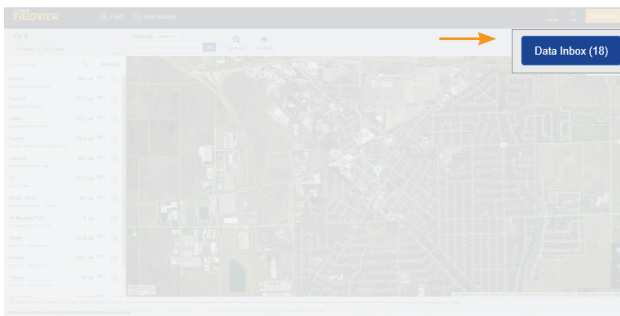

3 Select the fields you want to import into Climate FieldView by clicking on the selection boxes, then "Import".

Planting Data is now imported from the Data Inbox to your Climate FieldView Applications

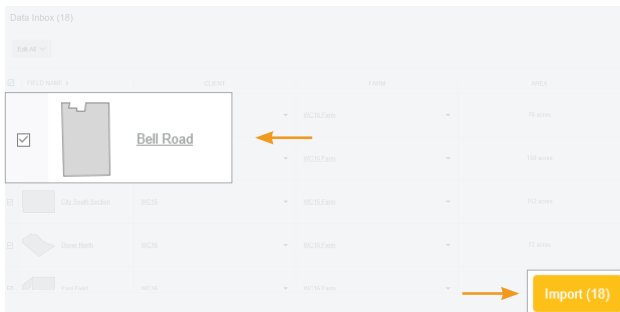

## Sales & Support

1.888.924.7475 • [support@climate.com](mailto:support@climate.com)

Our services provide estimates or recommendations based on models. These do not guarantee results. Consult your agronomist, commodities broker and other service professionals before making financial, risk management, and farming decisions. Information and recommendations we provide do not modify your rights under insurance policies purchased through our affiliates. More information at <http://www.climate.com/disclaimers>. iPad® is a registered mark of Apple, Inc. Climate FieldView™ is a trademark of The Climate Corporation. ©2016 The Climate Corporation. All Rights Reserved.

## Transferring Seeding Prescriptions (Rx) from Agrian to Climate FieldView™ Plus

Login to [www.agrian.com](http://www.agrian.com)

1 Select the sidebar menu, then "Integrations".

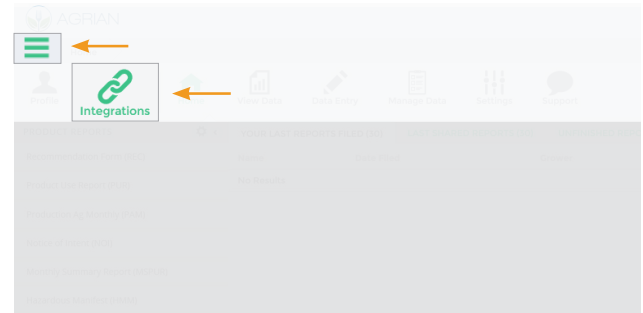

2 Left click on an integration. Select "View This Integration".

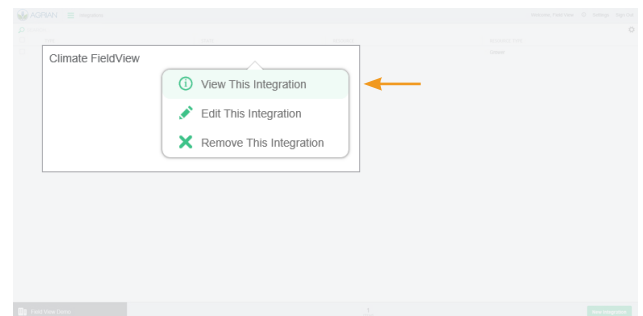

3 Select the "Prescriptions" tab. Then select the "Upload a Prescription" button.

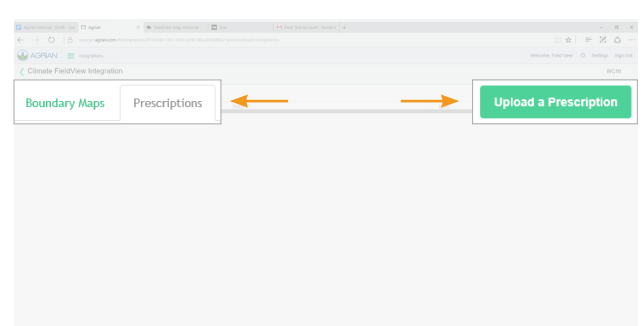

4 Select the zip file containing your seeding prescription on your computer, then "Open".

Your seeding prescription will now be transferred to Data-Import at [www.fieldviewplus.com](http://www.fieldviewplus.com) with an hour.