

# MSL16 SUMATRA



60-BLP

The **MSL16** accent light represents the finest in Auroralight engineering to date. Our **Storm Drain™** lens drainage system prevents water from collecting on the lens to reduce cleaning and stop hard-water deposits.

**Features include:**

- 8 LED Options at 7.5 Watts
- 4 Beam Spread Options
- **Storm Drain™** Lens Drainage System
- 120 VAC
- Solid Brass Construction

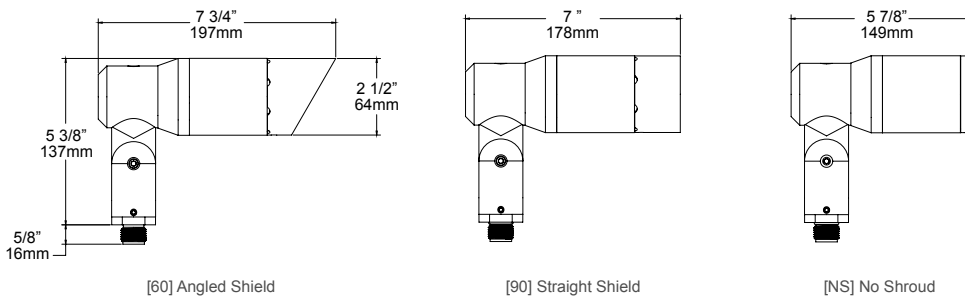

**ORDERING GUIDE:** MSL16 M (METAL HALIDE) SL (SPOT LIGHT) 16 (MR16 GU10)

□ INDICATES REQUIRED FIELD    ▭ INDICATES OPTIONAL FIELD

<b>SHROUD</b>	<b>LED</b>	<b>ACCESSORIES</b>	<b>MOUNT (1/2" NPS)</b>	<b>FINISH</b>
[60] 60° Angled [90] 90° Straight [NS] No Shroud	[7N27] 7.5W Narrow 2700K [7M27] 7.5W Medium 2700K [7W27] 7.5W Wide 2700K [7WF27] 7.5W Wide Flood 2700K [7N30] 7.5W Narrow 3000K [7M30] 7.5W Medium 3000K [7W30] 7.5W Wide 3000K [7WF30] 7.5W Wide Flood 3000K	SELECT TWO: [H] Hex Baffle [HD] Deep Cutoff Hex Baffle [L] Linear Spread [F] Frost Diffusion [ARW] Accessory Retainer*	[PM] Pedestal Mount [JB3-S] J-Box Mount w/ PVC Stake [CP35] 3x5" Machined Cover Plate [CP4] 4" Cover Plate* [CP45] 4 1/2" Cover Plate* [MC45-1] 4 1/2" Cover Plate, 1 Hole* [SMJB-1] Surface Mount J-Box, 1 Hole	[NAT] Natural [BLP] Bronze Living Patina [BLP-XD] BLP Extra Dark [NI] Nickel PVD
		*Required when using accessories	<b>GROUND MOUNT ACCESSORIES:</b> [8x12] HD Riser w/ Ground Stake [11x19] HD Riser w/ Ground Stake	

**LED LAMP FACTS**

**Brightness** .....390-455 lumens

**Energy Used** ..... 7.5 watts

**CRI** ..... 95

**Dimmable** .....Yes

**Voltage** ..... 120V

**Warranty** ..... 3yrs or 25,000hrs



\*Brass Escutcheon is standard. Add "C" for Copper

120V Fixture Requires Junction Box Connection

