

PARTS GUIDE

Please remove all parts from the package and review them.
Contact your service representative if there are any missing parts.

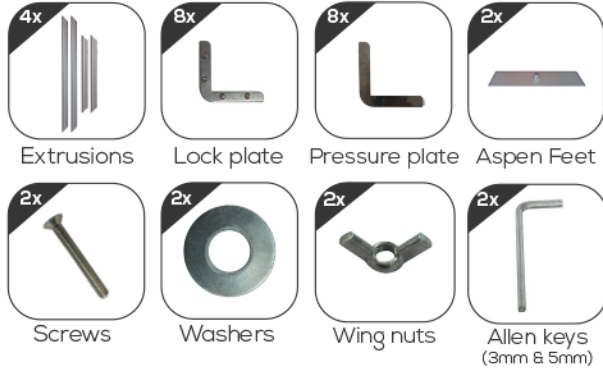

GRAPHIC MOUNTING GUIDE

Step 1

- Locate the silicone edge beading on the back of the graphic, which is sewn to the back perimeter.
- In each corner, insert the silicone edge beading into the groove.

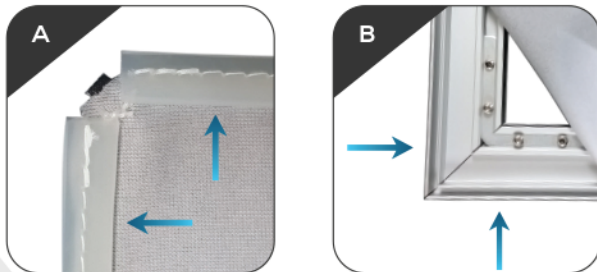

Step 2

- On each side, insert the remainder of the beading.
- The graphic should appear flush and completely tucked into the frame. Repeat the process on the back side if using a 2nd graphic.

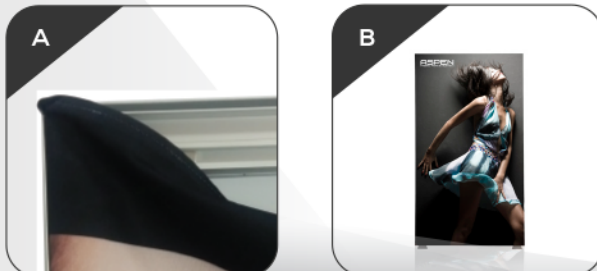

ADDITIONAL RESORT EXTRUSION STYLES



ASPEN
T-Leg



ASPEN
Fabric Frame Backwall



VAILS



ASPEN
Onyx



BIG SKY
Towers & Counters

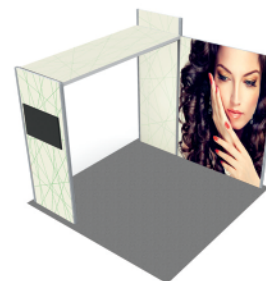

ALPINE BOOTHS

ASPEN

FABRIC FRAME SYSTEMS

SET UP INSTRUCTIONS

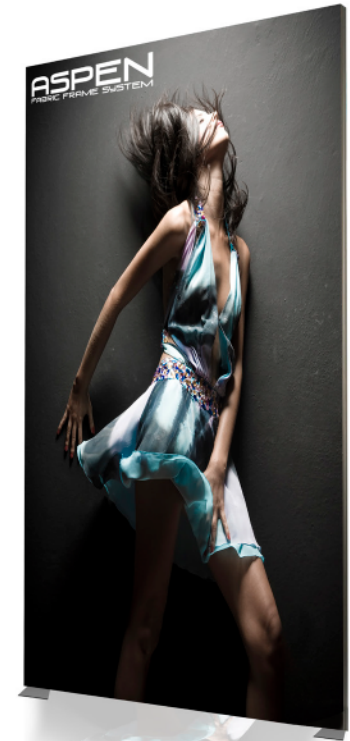

DOUBLE-SIDED
SELF -STANDING FRAME

INSTALLATION STEPS

Step 1

Gather all 4 of the extrusions and lay them out on a flat surface. The extrusions will be linked together using the lock and pressure plates.



Step 4

Repeat step 3 on the back side of the extrusion. Then repeat the same step on the opposite end.

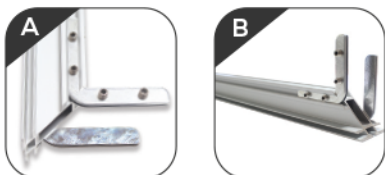

Step 7

Repeat steps 2-5 for the last remaining extrusion. Tighten all socket screws with the 3mm allen key.

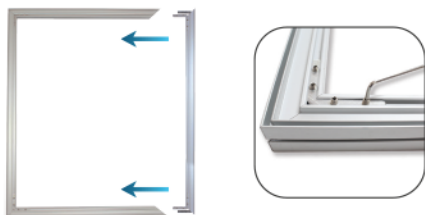

Step 10

Insert the 2.5" socket screws from the bottom, through the Aspen feet. It is recommended to work off the edge of a table.

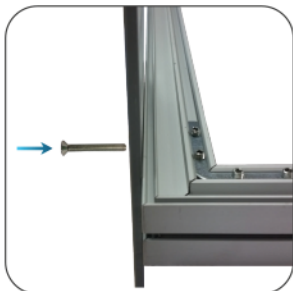

Step 2

Align the lock plate and pressure plate together. Make sure that the socket screws are recessed enough so the two pieces sit flush together.

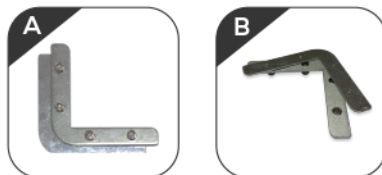

Step 5

Slide in both adjacent extrusions. These extrusions should match as a pair in length.



Step 8

The frame is complete and the feet are ready to be installed.



Step 11

From the top, slide on a washer and then screw on a wing nut until it is flush with the washer. Take the 5mm allen key that is provided and tighten the socket screw while holding the wing nut. Repeat the process for the other foot.



Step 3

Insert the aligned pieces completely into the slot. Insertion begins at either end of the extrusion. DO NOT TIGHTEN the socket screws.

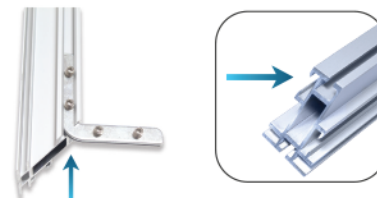

Step 6

Make sure the corners of the extrusions are flush.

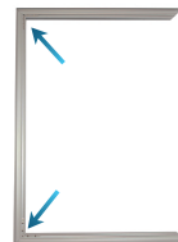

Step 9

Locate the (2) pre-fabricated holes on the bottom extrusion.



Step 12

The Aspen feet should sit parallel to each other and the frame should be self standing. The frame is ready to be fitted with the graphic(s).



(2nd FOLD HERE)

(1st FOLD HERE)