

TAHOE 10FT A

QUICK SETUP INSTRUCTIONS

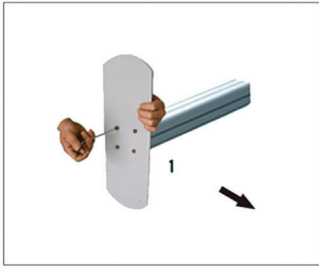

SETUP1

Install both bottom half pole with threads to feet.

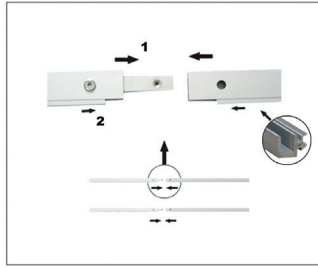

SETUP2

Connect flat bars together.

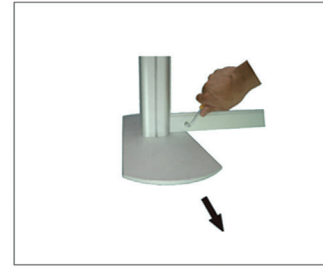

SETUP3

Lock the bottom flat bars onto bottom half poles.

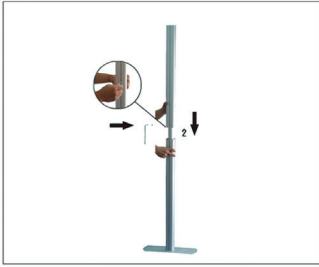

SETUP4

Install top half pole without threads to bottom half pole.

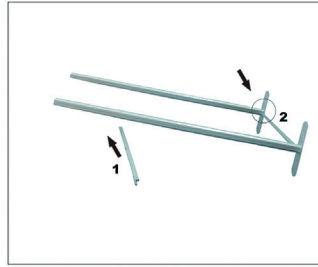

SETUP5

Insert acrylic panel screws to top flat bar.

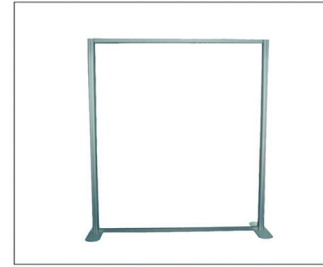

SETUP6

Lock top flat bars onto top half poles. Insert bracket holders and attachment bracket to main poles. Insert acrylic panel screws to main poles. Finish the main profile.

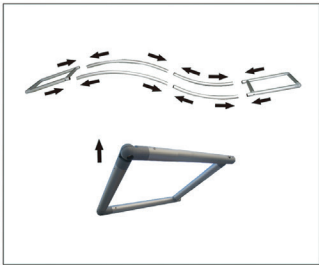

SETUP7

Connect canopy & insert fabric.

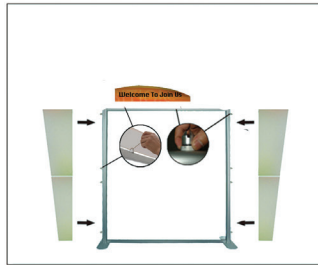

SETUP8

Insert acrylic panels to panel screws.

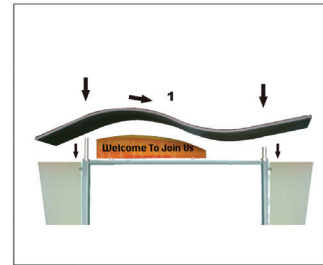

SETUP9

Insert connector poles on top of main poles. Place canopy on top of connector poles and screw into place.



SETUP10

Insert printing fabric and the table shelves.



SETUP11

Set up table accessories then connect them to main poles with bracket.



SETUP12

Insert the "T" shaped screws and pot on the nut. Push the "T" into the profile making sure the "T" screw is in the locking position.

