

Portable Rollup —QUICK START INSTRUCTIONS

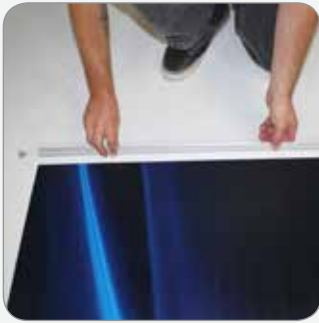

1. Lay top bar out with arrow pointing towards you and away from graphic.



2. Remove end pieces and place to sides. Slide graphic into top bar.

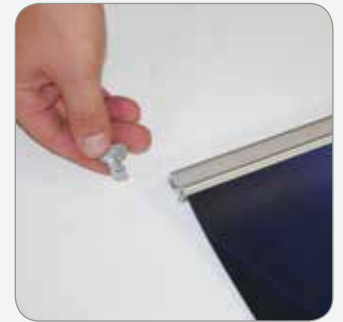

3. Close top bar by inserting end pieces.



4. Remove tape cover from base.



5. Slide graphic bleed edge to match the line below the base adhesive tape.



6. Press graphic on firmly. Remove pin on side of base and slowly let the graphic slide into base.



7. Slide feet out from base.



8. Insert pole into base.



9. Slide graphic up. Latch onto top of pole and reinsert pin into base to secure graphic.



Make sure to reinsert pin into base to secure graphic or it may cause damage!

