

Contract for the sale and purchase of land 2019 edition

TERM	MEANING OF TERM	NSW DAN:
vendor's agent	JKL Real Estate The Marina Apartments, Shop 4/2 Little Street, Forster, NSW 2428	Phone: 6554 8717 Fax: 6555 8664 Ref: Carlie Basham
co-agent		
vendor	Alison Joan Jones 2/28 Kenrose Street, Forster, NSW 2428	
vendor's solicitor	Brian Hayne Solicitor 2/32 West Street, Forster NSW 2428 PO Box 550, Forster NSW 2428	Phone: (02) 6555 4999 Fax: (02) 6554 5551 Ref: KAT:132193 E: Kirsty@brianhayne.com.au
date for completion land (address, plan details and title reference)	42nd day after the contract date 2/28 Kenrose Street, Forster, New South Wales 2428 Registered Plan: Lot 2 Plan DP 834709 Folio Identifier 2/834709	(clause 15)
improvements	<input type="checkbox"/> VACANT POSSESSION <input type="checkbox"/> subject to existing tenancies <input type="checkbox"/> HOUSE <input type="checkbox"/> garage <input type="checkbox"/> carport <input type="checkbox"/> home unit <input type="checkbox"/> carspace <input type="checkbox"/> storage space <input type="checkbox"/> none <input checked="" type="checkbox"/> other: Villa	
attached copies	<input type="checkbox"/> documents in the List of Documents as marked or as numbered: <input type="checkbox"/> other documents:	

A real estate agent is permitted by legislation to fill up the items in this box in a sale of residential property.

inclusions	<input checked="" type="checkbox"/> blinds	<input checked="" type="checkbox"/> dishwasher	<input checked="" type="checkbox"/> light fittings	<input checked="" type="checkbox"/> stove
	<input checked="" type="checkbox"/> built-in wardrobes	<input checked="" type="checkbox"/> fixed floor coverings	<input checked="" type="checkbox"/> range hood	<input type="checkbox"/> pool equipment
	<input checked="" type="checkbox"/> clothes line	<input checked="" type="checkbox"/> insect screens	<input type="checkbox"/> solar panels	<input checked="" type="checkbox"/> TV antenna
	<input type="checkbox"/> curtains	<input type="checkbox"/> other:		
exclusions				
purchaser				
purchaser's solicitor				
price	\$			E:
deposit	\$			(10% of the price, unless otherwise stated)
balance	\$			
contract date				(if not stated, the date this contract was made)

buyer's agent

vendor

GST AMOUNT (optional)
 The price includes
 GST of: \$

witness

purchaser

JOINT TENANTS tenants in common in unequal shares

witness

Choices

Vendor agrees to accept a **deposit-bond** (clause 3) NO yes

Nominated Electronic Lodgment Network (ELN) (clause 30): _____

Electronic transaction (clause 30)

no YES

(if no, vendor must provide further details, such as the proposed applicable waiver, in the space below, or *serve within 14 days* of the contract date):

Tax information (the parties promise this is correct as far as each party is aware)

Land tax is adjustable

NO yes

GST: Taxable supply

NO yes in full yes to an extent

Margin scheme will be used in making the taxable supply

NO yes

This sale is not a taxable supply because (one or more of the following may apply) the sale is:

- not made in the course or furtherance of an enterprise that the vendor carries on (section 9-5(b))
- by a vendor who is neither registered nor required to be registered for GST (section 9-5(d))
- GST-free because the sale is the supply of a going concern under section 38-325
- GST-free because the sale is subdivided farm land or farm land supplied for farming under Subdivision 38-O
- input taxed because the sale is of eligible residential premises (sections 40-65, 40-75(2) and 195-1)

Purchaser must make a *GSTRW payment* (GST residential withholding payment)

NO yes (if yes, vendor must provide further details)

If the further details below are not fully completed at the contract date, the vendor must provide all these details in a separate notice *within 14 days* of the contract date.

GSTRW payment (GST residential withholding payment) – further details

Frequently the supplier will be the vendor. However, sometimes further information will be required as to which entity is liable for GST, for example, if the supplier is a partnership, a trust, part of a GST group or a participant in a GST joint venture.

Supplier's name:

Supplier's ABN:

Supplier's GST branch address (if applicable):

Supplier's business address:

Supplier's email address:

Supplier's phone number:

Supplier's proportion of *GSTRW payment*:

If more than one supplier, provide the above details for each supplier.

Amount purchaser must pay – price multiplied by the *GSTRW rate* (residential withholding rate):

Amount must be paid: AT COMPLETION at another time (specify):

Is any of the consideration not expressed as an amount in money? NO yes

If "yes", the GST inclusive market value of the non-monetary consideration: \$

Other details (including those required by regulation or the ATO forms):

List of Documents

General	Strata or community title (clause 23 of the contract)
<input checked="" type="checkbox"/> 1 property certificate for the land	<input type="checkbox"/> 32 property certificate for strata common property
<input checked="" type="checkbox"/> 2 plan of the land	<input type="checkbox"/> 33 plan creating strata common property
<input type="checkbox"/> 3 unregistered plan of the land	<input type="checkbox"/> 34 strata by-laws
<input type="checkbox"/> 4 plan of land to be subdivided	<input type="checkbox"/> 35 strata development contract or statement
<input type="checkbox"/> 5 document that is to be lodged with a relevant plan	<input type="checkbox"/> 36 strata management statement
<input checked="" type="checkbox"/> 6 section 10.7(2) planning certificate under Environmental Planning and Assessment Act 1979	<input type="checkbox"/> 37 strata renewal proposal
<input type="checkbox"/> 7 additional information included in that certificate under section 10.7(5)	<input type="checkbox"/> 38 strata renewal plan
<input type="checkbox"/> 8 sewerage infrastructure location diagram (service location diagram)	<input type="checkbox"/> 39 leasehold strata - lease of lot and common property
<input checked="" type="checkbox"/> 9 sewer lines location diagram (sewerage service diagram)	<input type="checkbox"/> 40 property certificate for neighbourhood property
<input type="checkbox"/> 10 document that created or may have created an easement, profit à prendre, restriction on use or positive covenant disclosed in this contract	<input type="checkbox"/> 41 plan creating neighbourhood property
<input type="checkbox"/> 11 <i>planning agreement</i>	<input type="checkbox"/> 42 neighbourhood development contract
<input type="checkbox"/> 12 section 88G certificate (positive covenant)	<input type="checkbox"/> 43 neighbourhood management statement
<input type="checkbox"/> 13 survey report	<input type="checkbox"/> 44 property certificate for precinct property
<input type="checkbox"/> 14 building information certificate or building certificate given under <i>legislation</i>	<input type="checkbox"/> 45 plan creating precinct property
<input type="checkbox"/> 15 lease (with every relevant memorandum or variation)	<input type="checkbox"/> 46 precinct development contract
<input type="checkbox"/> 16 other document relevant to tenancies	<input type="checkbox"/> 47 precinct management statement
<input type="checkbox"/> 17 licence benefiting the land	<input type="checkbox"/> 48 property certificate for community property
<input type="checkbox"/> 18 old system document	<input type="checkbox"/> 49 plan creating community property
<input type="checkbox"/> 19 Crown purchase statement of account	<input type="checkbox"/> 50 community development contract
<input type="checkbox"/> 20 building management statement	<input type="checkbox"/> 51 community management statement
<input type="checkbox"/> 21 form of requisitions	<input type="checkbox"/> 52 document disclosing a change of by-laws
<input type="checkbox"/> 22 <i>clearance certificate</i>	<input type="checkbox"/> 53 document disclosing a change in a development or management contract or statement
<input type="checkbox"/> 23 land tax certificate	<input type="checkbox"/> 54 document disclosing a change in boundaries
Home Building Act 1989	<input type="checkbox"/> 55 information certificate under Strata Schemes Management Act 2015
<input type="checkbox"/> 24 insurance certificate	<input type="checkbox"/> 56 information certificate under Community Land Management Act 1989
<input type="checkbox"/> 25 brochure or warning	<input type="checkbox"/> 57 disclosure statement - off the plan contract
<input type="checkbox"/> 26 evidence of alternative indemnity cover	<input type="checkbox"/> 58 other document relevant to off the plan contract
Swimming Pools Act 1992	Other
<input type="checkbox"/> 27 certificate of compliance	<input type="checkbox"/> 59
<input type="checkbox"/> 28 evidence of registration	
<input type="checkbox"/> 29 relevant occupation certificate	
<input type="checkbox"/> 30 certificate of non-compliance	
<input type="checkbox"/> 31 detailed reasons of non-compliance	

HOLDER OF STRATA OR COMMUNITY TITLE RECORDS – Name, address, email address and telephone number

IMPORTANT NOTICE TO VENDORS AND PURCHASERS

Before signing this contract you should ensure that you understand your rights and obligations, some of which are not written in this contract but are implied by law.

WARNING—SMOKE ALARMS

The owners of certain types of buildings and strata lots must have smoke alarms (or in certain cases heat alarms) installed in the building or lot in accordance with regulations under the *Environmental Planning and Assessment Act 1979*. It is an offence not to comply. It is also an offence to remove or interfere with a smoke alarm or heat alarm. Penalties apply.

WARNING—LOOSE-FILL ASBESTOS INSULATION

Before purchasing land that includes any residential premises (within the meaning of Division 1A of Part 8 of the *Home Building Act 1989*) built before 1985, a purchaser is strongly advised to consider the possibility that the premises may contain loose-fill asbestos insulation (within the meaning of Division 1A of Part 8 of the *Home Building Act 1989*). In particular, a purchaser should:

- (a) search the Register required to be maintained under Division 1A of Part 8 of the *Home Building Act 1989*, and
- (b) ask the relevant local council whether it holds any records showing that the residential premises contain loose-fill asbestos insulation.

For further information about loose-fill asbestos insulation (including areas in which residential premises have been identified as containing loose-fill asbestos insulation), contact NSW Fair Trading.

COOLING OFF PERIOD (PURCHASER'S RIGHTS)

1. This is the statement required by section 66X of the *Conveyancing Act 1919* and applies to a contract for the sale of residential property.
2. **EXCEPT** in the circumstances listed in paragraph 3, the purchaser may rescind the contract at any time before 5 pm on—
 - (a) the tenth business day after the day on which the contract was made—in the case of an off the plan contract, or
 - (b) the fifth business day after the day on which the contract was made—in any other case.
3. There is **NO COOLING OFF PERIOD**:
 - (a) if, at or before the time the contract is made, the purchaser gives to the vendor (or the vendor's solicitor or agent) a certificate that complies with section 66W of the Act, or
 - (b) if the property is sold by public auction, or
 - (c) if the contract is made on the same day as the property was offered for sale by public auction but passed in, or
 - (d) if the contract is made in consequence of the exercise of an option to purchase the property other than an option that is void under section 66ZG of the Act.
4. A purchaser exercising the right to cool off by rescinding the contract will forfeit to the vendor 0.25% of the purchase price of the property. The vendor is entitled to recover the amount forfeited from any amount paid by the purchaser as a deposit under the contract and the purchaser is entitled to a refund of any balance.

DISPUTES

If you get into a dispute with the other party, the Law Society and Real Estate Institute encourage you to use informal procedures such as negotiation, independent expert appraisal, the Law Society Conveyancing Dispute Resolution Scheme or mediation (for example mediation under the Law Society Mediation Program).

AUCTIONS

Regulations made under the Property, Stock and Business Agents Act 2002 prescribe a number of conditions applying to sales by auction.

WARNINGS

1. **Various Acts of Parliament and other matters can affect the rights of the parties to this contract. Some important matters are actions, claims, decisions, licences, notices, orders, proposals or rights of way involving:**

APA Group Australian Taxation Office Council County Council Department of Planning, Industry and Environment Department of Primary Industries Electricity and gas Land & Housing Corporation Local Land Services	NSW Department of Education NSW Fair Trading Owner of adjoining land Privacy Public Works Advisory Subsidence Advisory NSW Telecommunications Transport for NSW Water, sewerage or drainage authority
---	--

If you think that any of these matters affects the property, tell your solicitor.
2. **A lease may be affected by the Agricultural Tenancies Act 1990, the Residential Tenancies Act 2010 or the Retail Leases Act 1994.**
3. **If any purchase money is owing to the Crown, it will become payable before obtaining consent, or if no consent is needed, when the transfer is registered.**
4. **If a consent to transfer is required under legislation, see clause 27 as to the obligations of the parties.**
5. **The vendor should continue the vendor's insurance until completion. If the vendor wants to give the purchaser possession before completion, the vendor should first ask the insurer to confirm this will not affect the insurance.**
6. **The purchaser will usually have to pay transfer duty (and sometimes surcharge purchaser duty) on this contract. If duty is not paid on time, a purchaser may incur penalties.**
7. **If the purchaser agrees to the release of deposit, the purchaser's right to recover the deposit may stand behind the rights of others (for example the vendor's mortgagee).**
8. **The purchaser should arrange insurance as appropriate.**
9. **Some transactions involving personal property may be affected by the Personal Property Securities Act 2009.**
10. **A purchaser should be satisfied that finance will be available at the time of completing the purchase.**
11. **Where the market value of the property is at or above a legislated amount, the purchaser may have to comply with a foreign resident capital gains withholding payment obligation (even if the vendor is not a foreign resident). If so, this will affect the amount available to the vendor on completion.**
12. **Purchasers of some residential properties may have to withhold part of the purchase price to be credited towards the GST liability of the vendor. If so, this will also affect the amount available to the vendor. More information is available from the ATO.**

The vendor sells and the purchaser buys the *property* for the price under these provisions instead of Schedule 3 Conveyancing Act 1919, subject to any *legislation* that cannot be excluded.

1 Definitions (a term in italics is a defined term)

In this contract, these terms (in any form) mean –

<i>adjustment date</i>	the earlier of the giving of possession to the purchaser or completion;
<i>bank</i>	the Reserve Bank of Australia or an authorised deposit-taking institution which is a bank, a building society or a credit union;
<i>business day</i>	any day except a bank or public holiday throughout NSW or a Saturday or Sunday;
<i>cheque</i>	a cheque that is not postdated or stale;
<i>clearance certificate</i>	a certificate within the meaning of s14-220 of Schedule 1 to the <i>TA Act</i> , that covers one or more days falling within the period from and including the contract date to completion;
<i>deposit-bond</i>	a deposit bond or guarantee from an issuer, with an expiry date and for an amount each approved by the vendor;
<i>depositholder</i>	vendor's agent (or if no vendor's agent is named in this contract, the vendor's <i>solicitor</i> , or if no vendor's <i>solicitor</i> is named in this contract, the buyer's agent);
<i>document of title</i>	document relevant to the title or the passing of title;
<i>FRCGW percentage</i>	the percentage mentioned in s14-200(3)(a) of Schedule 1 to the <i>TA Act</i> (12.5% as at 1 July 2017);
<i>FRCGW remittance</i>	a remittance which the purchaser must make under s14-200 of Schedule 1 to the <i>TA Act</i> , being the lesser of the <i>FRCGW percentage</i> of the price (inclusive of GST, if any) and the amount specified in a <i>variation served by a party</i> ;
<i>GST Act</i>	A New Tax System (Goods and Services Tax) Act 1999;
<i>GST rate</i>	the rate mentioned in s4 of A New Tax System (Goods and Services Tax Imposition - General) Act 1999 (10% as at 1 July 2000);
<i>GSTRW payment</i>	a payment which the purchaser must make under s14-250 of Schedule 1 to the <i>TA Act</i> (the price multiplied by the <i>GSTRW rate</i>);
<i>GSTRW rate</i>	the rate determined under s14-250(6), (8) or (9) of Schedule 1 to the <i>TA Act</i> (as at 1 July 2018, usually 7% of the price if the margin scheme applies, 1/11 th if not);
<i>legislation</i>	an Act or a by-law, ordinance, regulation or rule made under an Act;
<i>normally</i>	subject to any other provision of this contract;
<i>party</i>	each of the vendor and the purchaser;
<i>property</i>	the land, the improvements, all fixtures and the inclusions, but not the exclusions;
<i>planning agreement</i>	a valid voluntary agreement within the meaning of s7.4 of the Environmental Planning and Assessment Act 1979 entered into in relation to the <i>property</i> ;
<i>requisition</i>	an objection, question or requisition (but the term does not include a claim);
<i>rescind</i>	rescind this contract from the beginning;
<i>serve</i>	serve in writing on the other <i>party</i> ;
<i>settlement cheque</i>	an unendorsed <i>cheque</i> made payable to the person to be paid and – <ul style="list-style-type: none"> • issued by a <i>bank</i> and drawn on itself; or • if authorised in writing by the vendor or the vendor's <i>solicitor</i>, some other <i>cheque</i>;
<i>solicitor</i>	in relation to a <i>party</i> , the <i>party's</i> solicitor or licensed conveyancer named in this contract or in a notice <i>served by the party</i> ;
<i>TA Act</i>	Taxation Administration Act 1953;
<i>terminate</i>	terminate this contract for breach;
<i>variation</i>	a variation made under s14-235 of Schedule 1 to the <i>TA Act</i> ;
<i>within</i>	in relation to a period, at any time before or during the period; and
<i>work order</i>	a valid direction, notice or order that requires work to be done or money to be spent on or in relation to the <i>property</i> or any adjoining footpath or road (but the term does not include a notice under s22E of the Swimming Pools Act 1992 or clause 22 of the Swimming Pools Regulation 2018).

2 Deposit and other payments before completion

- 2.1 The purchaser must pay the deposit to the *depositholder* as stakeholder.
- 2.2 *Normally*, the purchaser must pay the deposit on the making of this contract, and this time is essential.
- 2.3 If this contract requires the purchaser to pay any of the deposit by a later time, that time is also essential.
- 2.4 The purchaser can pay any of the deposit by giving cash (up to \$2,000) or by unconditionally giving a *cheque* to the *depositholder* or to the vendor, vendor's agent or vendor's *solicitor* for sending to the *depositholder* or by payment by electronic funds transfer to the *depositholder*.

- 2.5 If any of the deposit is not paid on time or a *cheque* for any of the deposit is not honoured on presentation, the vendor can *terminate*. This right to *terminate* is lost as soon as the deposit is paid in full.
- 2.6 If the vendor accepts a bond or guarantee for the deposit, clauses 2.1 to 2.5 do not apply.
- 2.7 If the vendor accepts a bond or guarantee for part of the deposit, clauses 2.1 to 2.5 apply only to the balance.
- 2.8 If any of the deposit or of the balance of the price is paid before completion to the vendor or as the vendor directs, it is a charge on the land in favour of the purchaser until *termination* by the vendor or completion, subject to any existing right.
- 2.9 If each *party* tells the *depositholder* that the deposit is to be invested, the *depositholder* is to invest the deposit (at the risk of the *party* who becomes entitled to it) with a *bank*, in an interest-bearing account in NSW, payable at call, with interest to be reinvested, and pay the interest to the *parties* equally, after deduction of all proper government taxes and financial institution charges and other charges.

3 Deposit-bond

- 3.1 This clause applies only if this contract says the vendor has agreed to accept a *deposit-bond* for the deposit (or part of it).
- 3.2 The purchaser must provide the original *deposit-bond* to the vendor's *solicitor* (or if no *solicitor* the *depositholder*) at or before the making of this contract and this time is essential.
- 3.3 If the *deposit-bond* has an expiry date and completion does not occur by the date which is 14 days before the expiry date, the purchaser must *serve* a replacement *deposit-bond* at least 7 days before the expiry date. The time for service is essential.
- 3.4 The vendor must approve a replacement *deposit-bond* if –
- 3.4.1 it is from the same issuer and for the same amount as the earlier *deposit-bond*; and
- 3.4.2 it has an expiry date at least three months after its date of issue.
- 3.5 A breach of clauses 3.2 or 3.3 entitles the vendor to *terminate*. The right to *terminate* is lost as soon as –
- 3.5.1 the purchaser *serves* a replacement *deposit-bond*; or
- 3.5.2 the deposit is paid in full under clause 2.
- 3.6 Clauses 3.3 and 3.4 can operate more than once.
- 3.7 If the purchaser *serves* a replacement *deposit-bond*, the vendor must *serve* the earlier *deposit-bond*.
- 3.8 The amount of any *deposit-bond* does not form part of the price for the purposes of clause 16.7.
- 3.9 The vendor must give the purchaser the *deposit-bond* –
- 3.9.1 on completion; or
- 3.9.2 if this contract is *rescinded*.
- 3.10 If this contract is *terminated* by the vendor –
- 3.10.1 *normally*, the vendor can immediately demand payment from the issuer of the *deposit-bond*; or
- 3.10.2 if the purchaser *serves* prior to *termination* a notice disputing the vendor's right to *terminate*, the vendor must forward the *deposit-bond* (or its proceeds if called up) to the *depositholder* as stakeholder.
- 3.11 If this contract is *terminated* by the purchaser –
- 3.11.1 *normally*, the vendor must give the purchaser the *deposit-bond*; or
- 3.11.2 if the vendor *serves* prior to *termination* a notice disputing the purchaser's right to *terminate*, the vendor must forward the *deposit-bond* (or its proceeds if called up) to the *depositholder* as stakeholder.

4 Transfer

- 4.1 *Normally*, the purchaser must *serve* at least 14 days before the date for completion –
- 4.1.1 the form of transfer; and
- 4.1.2 particulars required to register any mortgage or other dealing to be lodged with the transfer by the purchaser or the purchaser's mortgagee.
- 4.2 If any information needed for the form of transfer is not disclosed in this contract, the vendor must *serve* it.
- 4.3 If the purchaser *serves* a form of transfer and the transferee is not the purchaser, the purchaser must give the vendor a direction signed by the purchaser personally for this form of transfer.
- 4.4 The vendor can require the purchaser to include a form of covenant or easement in the transfer only if this contract contains the wording of the proposed covenant or easement, and a description of the land benefited.

5 Requisitions

- 5.1 If a form of *requisitions* is attached to this contract, the purchaser is taken to have made those *requisitions*.
- 5.2 If the purchaser is or becomes entitled to make any other *requisition*, the purchaser can make it only by *serving* it –
- 5.2.1 if it arises out of this contract or it is a general question about the *property* or title - *within* 21 days after the contract date;
- 5.2.2 if it arises out of anything *served* by the vendor - *within* 21 days after the later of the contract date and that *service*; and
- 5.2.3 in any other case - *within* a reasonable time.

6 Error or misdescription

- 6.1 *Normally*, the purchaser can (but only before completion) claim compensation for an error or misdescription in this contract (as to the *property*, the title or anything else and whether substantial or not).
- 6.2 This clause applies even if the purchaser did not take notice of or rely on anything in this contract containing or giving rise to the error or misdescription.
- 6.3 However, this clause does not apply to the extent the purchaser knows the true position.

7 Claims by purchaser

- Normally*, the purchaser can make a claim (including a claim under clause 6) before completion only by *servicing* it with a statement of the amount claimed, and if the purchaser makes one or more claims before completion –
- 7.1 the vendor can *rescind* if in the case of claims that are not claims for delay –
- 7.1.1 the total amount claimed exceeds 5% of the price;
- 7.1.2 the vendor *serves* notice of intention to *rescind*; and
- 7.1.3 the purchaser does not *serve* notice waiving the claims *within* 14 days after that *service*; and
- 7.2 if the vendor does not *rescind*, the *parties* must complete and if this contract is completed –
- 7.2.1 the lesser of the total amount claimed and 10% of the price must be paid out of the price to and held by the *depositholder* until the claims are finalised or lapse;
- 7.2.2 the amount held is to be invested in accordance with clause 2.9;
- 7.2.3 the claims must be finalised by an arbitrator appointed by the *parties* or, if an appointment is not made *within* 1 month of completion, by an arbitrator appointed by the President of the Law Society at the request of a *party* (in the latter case the *parties* are bound by the terms of the Conveyancing Arbitration Rules approved by the Law Society as at the date of the appointment);
- 7.2.4 the purchaser is not entitled, in respect of the claims, to more than the total amount claimed and the costs of the purchaser;
- 7.2.5 net interest on the amount held must be paid to the *parties* in the same proportion as the amount held is paid; and
- 7.2.6 if the *parties* do not appoint an arbitrator and neither *party* requests the President to appoint an arbitrator *within* 3 months after completion, the claims lapse and the amount belongs to the vendor.

8 Vendor's rights and obligations

- 8.1 The vendor can *rescind* if –
- 8.1.1 the vendor is, on reasonable grounds, unable or unwilling to comply with a *requisition*;
- 8.1.2 the vendor *serves* a notice of intention to *rescind* that specifies the *requisition* and those grounds; and
- 8.1.3 the purchaser does not *serve* a notice waiving the *requisition within* 14 days after that *service*.
- 8.2 If the vendor does not comply with this contract (or a notice under or relating to it) in an essential respect, the purchaser can *terminate* by *servicing* a notice. After the *termination* –
- 8.2.1 the purchaser can recover the deposit and any other money paid by the purchaser under this contract;
- 8.2.2 the purchaser can sue the vendor to recover damages for breach of contract; and
- 8.2.3 if the purchaser has been in possession a *party* can claim for a reasonable adjustment.

9 Purchaser's default

- If the purchaser does not comply with this contract (or a notice under or relating to it) in an essential respect, the vendor can *terminate* by *servicing* a notice. After the *termination* the vendor can –
- 9.1 hold or recover the deposit (to a maximum of 10% of the price);
- 9.2 hold any other money paid by the purchaser under this contract as security for anything recoverable under this clause –
- 9.2.1 for 12 months after the *termination*; or
- 9.2.2 if the vendor commences proceedings under this clause *within* 12 months, until those proceedings are concluded; and
- 9.3 sue the purchaser either –
- 9.3.1 where the vendor has resold the *property* under a contract made *within* 12 months after the *termination*, to recover –
- the deficiency on resale (with credit for any of the deposit kept or recovered and after allowance for any capital gains tax or goods and services tax payable on anything recovered under this clause); and
 - the reasonable costs and expenses arising out of the purchaser's non-compliance with this contract or the notice and of resale and any attempted resale; or
- 9.3.2 to recover damages for breach of contract.

10 Restrictions on rights of purchaser

- 10.1 The purchaser cannot make a claim or *requisition* or *rescind* or *terminate* in respect of –

- 10.1.1 the ownership or location of any fence as defined in the Dividing Fences Act 1991;
- 10.1.2 a service for the *property* being a joint service or passing through another property, or any service for another property passing through the *property* ('service' includes air, communication, drainage, electricity, garbage, gas, oil, radio, sewerage, telephone, television or water service);
- 10.1.3 a wall being or not being a party wall in any sense of that term or the *property* being affected by an easement for support or not having the benefit of an easement for support;
- 10.1.4 any change in the *property* due to fair wear and tear before completion;
- 10.1.5 a promise, representation or statement about this contract, the *property* or the title, not set out or referred to in this contract;
- 10.1.6 a condition, exception, reservation or restriction in a Crown grant;
- 10.1.7 the existence of any authority or licence to explore or prospect for gas, minerals or petroleum;
- 10.1.8 any easement or restriction on use the substance of either of which is disclosed in this contract or any non-compliance with the easement or restriction on use; or
- 10.1.9 anything the substance of which is disclosed in this contract (except a caveat, charge, mortgage, priority notice or writ).
- 10.2 The purchaser cannot *rescind* or *terminate* only because of a defect in title to or quality of the inclusions.
- 10.3 *Normally*, the purchaser cannot make a claim or *requisition* or *rescind* or *terminate* or require the vendor to change the nature of the title disclosed in this contract (for example, to remove a caution evidencing qualified title, or to lodge a plan of survey as regards limited title).
- 11 Compliance with work orders**
- 11.1 *Normally*, the vendor must by completion comply with a *work order* made on or before the contract date and if this contract is completed the purchaser must comply with any other *work order*.
- 11.2 If the purchaser complies with a *work order*, and this contract is *rescinded* or *terminated*, the vendor must pay the expense of compliance to the purchaser.
- 12 Certificates and inspections**
- The vendor must do everything reasonable to enable the purchaser, subject to the rights of any tenant –
- 12.1 to have the *property* inspected to obtain any certificate or report reasonably required;
- 12.2 to apply (if necessary in the name of the vendor) for –
- 12.2.1 any certificate that can be given in respect of the *property* under *legislation*; or
- 12.2.2 a copy of any approval, certificate, consent, direction, notice or order in respect of the *property* given under *legislation*, even if given after the contract date; and
- 12.3 to make 1 inspection of the *property* in the 3 days before a time appointed for completion.
- 13 Goods and services tax (GST)**
- 13.1 Terms used in this clause which are not defined elsewhere in this contract and have a defined meaning in the *GST Act* have the same meaning in this clause.
- 13.2 *Normally*, if a *party* must pay the price or any other amount to the other *party* under this contract, GST is not to be added to the price or amount.
- 13.3 If under this contract a *party* must make an adjustment or payment for an expense of another party or pay an expense payable by or to a third party (for example, under clauses 14 or 20.7) –
- 13.3.1 the *party* must adjust or pay on completion any GST added to or included in the expense; but
- 13.3.2 the amount of the expense must be reduced to the extent the party receiving the adjustment or payment (or the representative member of a GST group of which that party is a member) is entitled to an input tax credit for the expense; and
- 13.3.3 if the adjustment or payment under this contract is consideration for a taxable supply, an amount for GST must be added at the *GST rate*.
- 13.4 If this contract says this sale is the supply of a going concern –
- 13.4.1 the *parties* agree the supply of the *property* is a supply of a going concern;
- 13.4.2 the vendor must, between the contract date and completion, carry on the enterprise conducted on the land in a proper and business-like way;
- 13.4.3 if the purchaser is not registered by the date for completion, the *parties* must complete and the purchaser must pay on completion, in addition to the price, an amount being the price multiplied by the *GST rate* ("the retention sum"). The retention sum is to be held by the *depositholder* and dealt with as follows –
- if *within* 3 months of completion the purchaser serves a letter from the Australian Taxation Office stating the purchaser is registered with a date of effect of registration on or before completion, the *depositholder* is to pay the retention sum to the purchaser; but
 - if the purchaser does not serve that letter *within* 3 months of completion, the *depositholder* is to pay the retention sum to the vendor; and
- 13.4.4 if the vendor, despite clause 13.4.1, serves a letter from the Australian Taxation Office stating the vendor has to pay GST on the supply, the purchaser must pay to the vendor on demand the amount of GST assessed.
- 13.5 *Normally*, the vendor promises the margin scheme will not apply to the supply of the *property*.

- 13.6 If this contract says the margin scheme is to apply in making the taxable supply, the *parties* agree that the margin scheme is to apply to the sale of the *property*.
- 13.7 If this contract says the sale is not a taxable supply –
- 13.7.1 the purchaser promises that the *property* will not be used and represents that the purchaser does not intend the *property* (or any part of the *property*) to be used in a way that could make the sale a taxable supply to any extent; and
- 13.7.2 the purchaser must pay the vendor on completion in addition to the price an amount calculated by multiplying the price by the *GST rate* if this sale is a taxable supply to any extent because of –
- a breach of clause 13.7.1; or
 - something else known to the purchaser but not the vendor.
- 13.8 If this contract says this sale is a taxable supply in full and does not say the margin scheme applies to the *property*, the vendor must pay the purchaser on completion an amount of one-eleventh of the price if –
- 13.8.1 this sale is not a taxable supply in full; or
- 13.8.2 the margin scheme applies to the *property* (or any part of the *property*).
- 13.9 If this contract says this sale is a taxable supply to an extent –
- 13.9.1 clause 13.7.1 does not apply to any part of the *property* which is identified as being a taxable supply; and
- 13.9.2 the payments mentioned in clauses 13.7 and 13.8 are to be recalculated by multiplying the relevant payment by the proportion of the price which represents the value of that part of the *property* to which the clause applies (the proportion to be expressed as a number between 0 and 1). Any evidence of value must be obtained at the expense of the vendor.
- 13.10 *Normally*, on completion the vendor must give the recipient of the supply a tax invoice for any taxable supply by the vendor by or under this contract.
- 13.11 The vendor does not have to give the purchaser a tax invoice if the margin scheme applies to a taxable supply.
- 13.12 If the vendor is liable for GST on rents or profits due to issuing an invoice or receiving consideration before completion, any adjustment of those amounts must exclude an amount equal to the vendor's GST liability.
- 13.13 If the purchaser must make a *GSTRW payment* the purchaser must –
- 13.13.1 at least 5 days before the date for completion, *serve* evidence of submission of a *GSTRW payment* notification form to the Australian Taxation Office by the purchaser or, if a direction under clause 4.3 has been *served*, by the transferee named in the transfer *served* with that direction;
- 13.13.2 produce on completion a *settlement cheque* for the *GSTRW payment* payable to the Deputy Commissioner of Taxation;
- 13.13.3 forward the *settlement cheque* to the payee immediately after completion; and
- 13.13.4 *serve* evidence of receipt of payment of the *GSTRW payment* and a copy of the settlement date confirmation form submitted to the Australian Taxation Office.
- 14 Adjustments**
- 14.1 *Normally*, the vendor is entitled to the rents and profits and will be liable for all rates, water, sewerage and drainage service and usage charges, land tax, levies and all other periodic outgoings up to and including the *adjustment date* after which the purchaser will be entitled and liable.
- 14.2 The *parties* must make any necessary adjustment on completion.
- 14.3 If an amount that is adjustable under this contract has been reduced under *legislation*, the *parties* must on completion adjust the reduced amount.
- 14.4 The *parties* must not adjust surcharge land tax (as defined in the Land Tax Act 1956) but must adjust any other land tax for the year current at the *adjustment date* –
- 14.4.1 only if land tax has been paid or is payable for the year (whether by the vendor or by a predecessor in title) and this contract says that land tax is adjustable;
- 14.4.2 by adjusting the amount that would have been payable if at the start of the year –
- the person who owned the land owned no other land;
 - the land was not subject to a special trust or owned by a non-concessional company; and
 - if the land (or part of it) had no separate taxable value, by calculating its separate taxable value on a proportional area basis.
- 14.5 If any other amount that is adjustable under this contract relates partly to the land and partly to other land, the *parties* must adjust it on a proportional area basis.
- 14.6 *Normally*, the vendor can direct the purchaser to produce a *settlement cheque* on completion to pay an amount adjustable under this contract and if so –
- 14.6.1 the amount is to be treated as if it were paid; and
- 14.6.2 the *cheque* must be forwarded to the payee immediately after completion (by the purchaser if the *cheque* relates only to the *property* or by the vendor in any other case).
- 14.7 If on completion the last bill for a water, sewerage or drainage usage charge is for a period ending before the *adjustment date*, the vendor is liable for an amount calculated by dividing the bill by the number of days in the period then multiplying by the number of unbilled days up to and including the *adjustment date*.

14.8 The vendor is liable for any amount recoverable for work started on or before the contract date on the *property* or any adjoining footpath or road.

15 Date for completion

The *parties* must complete by the date for completion and, if they do not, a *party* can serve a notice to complete if that *party* is otherwise entitled to do so.

16 Completion

• Vendor

- 16.1 On completion the vendor must give the purchaser any *document of title* that relates only to the *property*.
- 16.2 If on completion the vendor has possession or control of a *document of title* that relates also to other property, the vendor must produce it as and where necessary.
- 16.3 *Normally*, on completion the vendor must cause the legal title to the *property* (being an estate in fee simple) to pass to the purchaser free of any mortgage or other interest, subject to any necessary registration.
- 16.4 The legal title to the *property* does not pass before completion.
- 16.5 If the vendor gives the purchaser a document (other than the transfer) that needs to be lodged for registration, the vendor must pay the lodgment fee to the purchaser.
- 16.6 If a *party* serves a land tax certificate showing a charge on any of the land, by completion the vendor must do all things and pay all money required so that the charge is no longer effective against the land.

• Purchaser

- 16.7 On completion the purchaser must pay to the vendor, by cash (up to \$2,000) or *settlement cheque* –
- 16.7.1 the price less any:
- deposit paid;
 - *FRCGW remittance* payable;
 - *GSTRW payment*; and
 - amount payable by the vendor to the purchaser under this contract; and
- 16.7.2 any other amount payable by the purchaser under this contract.
- 16.8 If the vendor requires more than 5 *settlement cheques*, the vendor must pay \$10 for each extra *cheque*.
- 16.9 If any of the deposit is not covered by a bond or guarantee on completion the purchaser must give the vendor an order signed by the purchaser authorising the *deposit order* to account to the vendor for the deposit.
- 16.10 On completion the deposit belongs to the vendor.
- ### • Place for completion
- 16.11 *Normally*, the *parties* must complete at the completion address, which is –
- 16.11.1 if a special completion address is stated in this contract - that address; or
- 16.11.2 if none is stated, but a first mortgagee is disclosed in this contract and the mortgagee would usually discharge the mortgage at a particular place - that place; or
- 16.11.3 in any other case - the vendor's *solicitor's* address stated in this contract.
- 16.12 The vendor by reasonable notice can require completion at another place, if it is in NSW, but the vendor must pay the purchaser's additional expenses, including any agency or mortgagee fee.
- 16.13 If the purchaser requests completion at a place that is not the completion address, and the vendor agrees, the purchaser must pay the vendor's additional expenses, including any agency or mortgagee fee.

17 Possession

- 17.1 *Normally*, the vendor must give the purchaser vacant possession of the *property* on completion.
- 17.2 The vendor does not have to give vacant possession if –
- 17.2.1 this contract says that the sale is subject to existing tenancies; and
- 17.2.2 the contract discloses the provisions of the tenancy (for example, by attaching a copy of the lease and any relevant memorandum or variation).
- 17.3 *Normally*, the purchaser can claim compensation (before or after completion) or *rescind* if any of the land is affected by a protected tenancy (a tenancy affected by Schedule 2, Part 7 of the Residential Tenancies Act 2010).

18 Possession before completion

- 18.1 This clause applies only if the vendor gives the purchaser possession of the *property* before completion.
- 18.2 The purchaser must not before completion –
- 18.2.1 let or part with possession of any of the *property*;
- 18.2.2 make any change or structural alteration or addition to the *property*; or
- 18.2.3 contravene any agreement between the *parties* or any direction, document, *legislation*, notice or order affecting the *property*.
- 18.3 The purchaser must until completion –
- 18.3.1 keep the *property* in good condition and repair having regard to its condition at the giving of possession; and
- 18.3.2 allow the vendor or the vendor's authorised representative to enter and inspect it at all reasonable times.

- 18.4 The risk as to damage to the *property* passes to the purchaser immediately after the purchaser enters into possession.
- 18.5 If the purchaser does not comply with this clause, then without affecting any other right of the vendor –
- 18.5.1 the vendor can before completion, without notice, remedy the non-compliance; and
- 18.5.2 if the vendor pays the expense of doing this, the purchaser must pay it to the vendor with interest at the rate prescribed under s101 Civil Procedure Act 2005.
- 18.6 If this contract is *rescinded* or *terminated* the purchaser must immediately vacate the *property*.
- 18.7 If the *parties* or their *solicitors* on their behalf do not agree in writing to a fee or rent, none is payable.

19 Rescission of contract

- 19.1 If this contract expressly gives a *party* a right to *rescind*, the *party* can exercise the right –
- 19.1.1 only by *servicing* a notice before completion; and
- 19.1.2 in spite of any making of a claim or *requisition*, any attempt to satisfy a claim or *requisition*, any arbitration, litigation, mediation or negotiation or any giving or taking of possession.
- 19.2 *Normally*, if a *party* exercises a right to *rescind* expressly given by this contract or any *legislation* –
- 19.2.1 the deposit and any other money paid by the purchaser under this contract must be refunded;
- 19.2.2 a *party* can claim for a reasonable adjustment if the purchaser has been in possession;
- 19.2.3 a *party* can claim for damages, costs or expenses arising out of a breach of this contract; and
- 19.2.4 a *party* will not otherwise be liable to pay the other *party* any damages, costs or expenses.

20 Miscellaneous

- 20.1 The *parties* acknowledge that anything stated in this contract to be attached was attached to this contract by the vendor before the purchaser signed it and is part of this contract.
- 20.2 Anything attached to this contract is part of this contract.
- 20.3 An area, bearing or dimension in this contract is only approximate.
- 20.4 If a *party* consists of 2 or more persons, this contract benefits and binds them separately and together.
- 20.5 A *party's solicitor* can receive any amount payable to the *party* under this contract or direct in writing that it is to be paid to another person.
- 20.6 A document under or relating to this contract is –
- 20.6.1 signed by a *party* if it is signed by the *party* or the *party's solicitor* (apart from a direction under clause 4.3);
- 20.6.2 served if it is served by the *party* or the *party's solicitor*;
- 20.6.3 served if it is served on the *party's solicitor*, even if the *party* has died or any of them has died;
- 20.6.4 served if it is served in any manner provided in s170 of the Conveyancing Act 1919;
- 20.6.5 served if it is sent by email or fax to the *party's solicitor*, unless in either case it is not received;
- 20.6.6 served on a person if it (or a copy of it) comes into the possession of the person; and
- 20.6.7 served at the earliest time it is served, if it is served more than once.
- 20.7 An obligation to pay an expense of another *party* of doing something is an obligation to pay –
- 20.7.1 if the *party* does the thing personally - the reasonable cost of getting someone else to do it; or
- 20.7.2 if the *party* pays someone else to do the thing - the amount paid, to the extent it is reasonable.
- 20.8 Rights under clauses 11, 13, 14, 17, 24, 30 and 31 continue after completion, whether or not other rights continue.
- 20.9 The vendor does not promise, represent or state that the purchaser has any cooling off rights.
- 20.10 The vendor does not promise, represent or state that any attached survey report is accurate or current.
- 20.11 A reference to any *legislation* (including any percentage or rate specified in *legislation*) is also a reference to any corresponding later *legislation*.
- 20.12 Each *party* must do whatever is necessary after completion to carry out the *party's* obligations under this contract.
- 20.13 Neither taking possession nor *servicing* a transfer of itself implies acceptance of the *property* or the title.
- 20.14 The details and information provided in this contract (for example, on pages 1 - 3) are, to the extent of each *party's* knowledge, true, and are part of this contract.
- 20.15 Where this contract provides for choices, a choice in BLOCK CAPITALS applies unless a different choice is marked.

21 Time limits in these provisions

- 21.1 If the time for something to be done or to happen is not stated in these provisions, it is a reasonable time.
- 21.2 If there are conflicting times for something to be done or to happen, the latest of those times applies.
- 21.3 The time for one thing to be done or to happen does not extend the time for another thing to be done or to happen.
- 21.4 If the time for something to be done or to happen is the 29th, 30th or 31st day of a month, and the day does not exist, the time is instead the last day of the month.
- 21.5 If the time for something to be done or to happen is a day that is not a *business day*, the time is extended to the next *business day*, except in the case of clauses 2 and 3.2.
- 21.6 *Normally*, the time by which something must be done is fixed but not essential.

22 Foreign Acquisitions and Takeovers Act 1975

- 22.1 The purchaser promises that the Commonwealth Treasurer cannot prohibit and has not prohibited the transfer under the Foreign Acquisitions and Takeovers Act 1975.
- 22.2 This promise is essential and a breach of it entitles the vendor to *terminate*.

23 Strata or community title**• Definitions and modifications**

- 23.1 This clause applies only if the land (or part of it) is a lot in a strata, neighbourhood, precinct or community scheme (or on completion is to be a lot in a scheme of that kind).
- 23.2 In this contract –
- 23.2.1 'change', in relation to a scheme, means –
- a registered or registrable change from by-laws set out in this contract;
 - a change from a development or management contract or statement set out in this contract; or
 - a change in the boundaries of common property;
- 23.2.2 'common property' includes association property for the scheme or any higher scheme;
- 23.2.3 'contribution' includes an amount payable under a by-law;
- 23.2.4 'information certificate' includes a certificate under s184 Strata Schemes Management Act 2015 and s26 Community Land Management Act 1989;
- 23.2.5 'information notice' includes a strata information notice under s22 Strata Schemes Management Act 2015 and a notice under s47 Community Land Management Act 1989;
- 23.2.6 'normal expenses', in relation to an owners corporation for a scheme, means normal operating expenses usually payable from the administrative fund of an owners corporation for a scheme of the same kind;
- 23.2.7 'owners corporation' means the owners corporation or the association for the scheme or any higher scheme;
- 23.2.8 'the *property*' includes any interest in common property for the scheme associated with the lot; and
- 23.2.9 'special expenses', in relation to an owners corporation, means its actual, contingent or expected expenses, except to the extent they are –
- normal expenses;
 - due to fair wear and tear;
 - disclosed in this contract; or
 - covered by moneys held in the capital works fund.
- 23.3 Clauses 11, 14.8 and 18.4 do not apply to an obligation of the owners corporation, or to property insurable by it.
- 23.4 Clauses 14.4.2 and 14.5 apply but on a unit entitlement basis instead of an area basis.
- Adjustments and liability for expenses**
- 23.5 The *parties* must adjust under clause 14.1 –
- 23.5.1 a regular periodic contribution;
- 23.5.2 a contribution which is not a regular periodic contribution but is disclosed in this contract; and
- 23.5.3 on a unit entitlement basis, any amount paid by the vendor for a normal expense of the owners corporation to the extent the owners corporation has not paid the amount to the vendor.
- 23.6 If a contribution is not a regular periodic contribution and is not disclosed in this contract –
- 23.6.1 the vendor is liable for it if it was determined on or before the contract date, even if it is payable by instalments; and
- 23.6.2 the purchaser is liable for all contributions determined after the contract date.
- 23.7 The vendor must pay or allow to the purchaser on completion the amount of any unpaid contributions for which the vendor is liable under clause 23.6.1.
- 23.8 *Normally*, the purchaser cannot make a claim or *requisition* or *rescind* or *terminate* in respect of –
- 23.8.1 an existing or future actual, contingent or expected expense of the owners corporation;
- 23.8.2 a proportional unit entitlement of the lot or a relevant lot or former lot, apart from a claim under clause 6; or
- 23.8.3 a past or future change in the scheme or a higher scheme.
- 23.9 However, the purchaser can *rescind* if –
- 23.9.1 the special expenses of the owners corporation at the later of the contract date and the creation of the owners corporation when calculated on a unit entitlement basis (and, if more than one lot or a higher scheme is involved, added together), less any contribution paid by the vendor, are more than 1% of the price;
- 23.9.2 in the case of the lot or a relevant lot or former lot in a higher scheme, a proportional unit entitlement for the lot is disclosed in this contract but the lot has a different proportional unit entitlement at the contract date or at any time before completion;
- 23.9.3 a change before the contract date or before completion in the scheme or a higher scheme materially prejudices the purchaser and is not disclosed in this contract; or

23.9.4 a resolution is passed by the owners corporation before the contract date or before completion to give to the owners in the scheme for their consideration a strata renewal plan that has not lapsed at the contract date and there is not attached to this contract a strata renewal proposal or the strata renewal plan.

• **Notices, certificates and inspections**

- 23.10 The purchaser must give the vendor 2 copies of an information notice addressed to the owners corporation and signed by the purchaser.
- 23.11 The vendor must complete and sign 1 copy of the notice and give it to the purchaser on completion.
- 23.12 Each *party* can sign and give the notice as agent for the other.
- 23.13 The vendor must *serve* an information certificate issued after the contract date in relation to the lot, the scheme or any higher scheme at least 7 days before the date for completion.
- 23.14 The purchaser does not have to complete earlier than 7 days after *service* of the certificate and clause 21.3 does not apply to this provision. On completion the purchaser must pay the vendor the prescribed fee for the certificate.
- 23.15 The vendor authorises the purchaser to apply for the purchaser's own certificate.
- 23.16 The vendor authorises the purchaser to apply for and make an inspection of any record or other document in the custody or control of the owners corporation or relating to the scheme or any higher scheme.

• **Meetings of the owners corporation**

- 23.17 If a general meeting of the owners corporation is convened before completion –
- 23.17.1 if the vendor receives notice of it, the vendor must immediately notify the purchaser of it; and
- 23.17.2 after the expiry of any cooling off period, the purchaser can require the vendor to appoint the purchaser (or the purchaser's nominee) to exercise any voting rights of the vendor in respect of the lot at the meeting.

24 Tenancies

- 24.1 If a tenant has not made a payment for a period preceding or current at the *adjustment date* –
- 24.1.1 for the purposes of clause 14.2, the amount is to be treated as if it were paid; and
- 24.1.2 the purchaser assigns the debt to the vendor on completion and will if required give a further assignment at the vendor's expense.
- 24.2 If a tenant has paid in advance of the *adjustment date* any periodic payment in addition to rent, it must be adjusted as if it were rent for the period to which it relates.
- 24.3 If the *property* is to be subject to a tenancy on completion or is subject to a tenancy on completion –
- 24.3.1 the vendor authorises the purchaser to have any accounting records relating to the tenancy inspected and audited and to have any other document relating to the tenancy inspected;
- 24.3.2 the vendor must *serve* any information about the tenancy reasonably requested by the purchaser before or after completion; and
- 24.3.3 *normally*, the purchaser can claim compensation (before or after completion) if –
- a disclosure statement required by the Retail Leases Act 1994 was not given when required;
 - such a statement contained information that was materially false or misleading;
 - a provision of the lease is not enforceable because of a non-disclosure in such a statement; or
 - the lease was entered into in contravention of the Retail Leases Act 1994.
- 24.4 If the *property* is subject to a tenancy on completion –
- 24.4.1 the vendor must allow or transfer –
- any remaining bond money or any other security against the tenant's default (to the extent the security is transferable);
 - any money in a fund established under the lease for a purpose and compensation for any money in the fund or interest earned by the fund that has been applied for any other purpose; and
 - any money paid by the tenant for a purpose that has not been applied for that purpose and compensation for any of the money that has been applied for any other purpose;
- 24.4.2 if the security is not transferable, each *party* must do everything reasonable to cause a replacement security to issue for the benefit of the purchaser and the vendor must hold the original security on trust for the benefit of the purchaser until the replacement security issues;
- 24.4.3 the vendor must give to the purchaser –
- a proper notice of the transfer (an attornment notice) addressed to the tenant;
 - any certificate given under the Retail Leases Act 1994 in relation to the tenancy;
 - a copy of any disclosure statement given under the Retail Leases Act 1994;
 - a copy of any document served on the tenant under the lease and written details of its service, if the document concerns the rights of the landlord or the tenant after completion; and
 - any document served by the tenant under the lease and written details of its service, if the document concerns the rights of the landlord or the tenant after completion;
- 24.4.4 the vendor must comply with any obligation to the tenant under the lease, to the extent it is to be complied with by completion; and

24.4.5 the purchaser must comply with any obligation to the tenant under the lease, to the extent that the obligation is disclosed in this contract and is to be complied with after completion.

25 Qualified title, limited title and old system title

- 25.1 This clause applies only if the land (or part of it) –
- 25.1.1 is under qualified, limited or old system title; or
 - 25.1.2 on completion is to be under one of those titles.
- 25.2 The vendor must *serve* a proper abstract of title *within 7 days* after the contract date.
- 25.3 If an abstract of title or part of an abstract of title is attached to this contract or has been lent by the vendor to the purchaser before the contract date, the abstract or part is *served* on the contract date.
- 25.4 An abstract of title can be or include a list of documents, events and facts arranged (apart from a will or codicil) in date order, if the list in respect of each document –
- 25.4.1 shows its date, general nature, names of parties and any registration number; and
 - 25.4.2 has attached a legible photocopy of it or of an official or registration copy of it.
- 25.5 An abstract of title –
- 25.5.1 must start with a good root of title (if the good root of title must be at least 30 years old, this means 30 years old at the contract date);
 - 25.5.2 in the case of a leasehold interest, must include an abstract of the lease and any higher lease;
 - 25.5.3 *normally*, need not include a Crown grant; and
 - 25.5.4 need not include anything evidenced by the Register kept under the Real Property Act 1900.
- 25.6 In the case of land under old system title –
- 25.6.1 in this contract 'transfer' means conveyance;
 - 25.6.2 the purchaser does not have to *serve* the form of transfer until after the vendor has *served* a proper abstract of title; and
 - 25.6.3 each vendor must give proper covenants for title as regards that vendor's interest.
- 25.7 In the case of land under limited title but not under qualified title –
- 25.7.1 *normally*, the abstract of title need not include any document which does not show the location, area or dimensions of the land (for example, by including a metes and bounds description or a plan of the land);
 - 25.7.2 clause 25.7.1 does not apply to a document which is the good root of title; and
 - 25.7.3 the vendor does not have to provide an abstract if this contract contains a delimitation plan (whether in registrable form or not).
- 25.8 The vendor must give a proper covenant to produce where relevant.
- 25.9 The vendor does not have to produce or covenant to produce a document that is not in the possession of the vendor or a mortgagee.
- 25.10 If the vendor is unable to produce an original document in the chain of title, the purchaser will accept a photocopy from the Registrar-General of the registration copy of that document.

26 Crown purchase money

- 26.1 This clause applies only if purchase money is payable to the Crown, whether or not due for payment.
- 26.2 The vendor is liable for the money, except to the extent this contract says the purchaser is liable for it.
- 26.3 To the extent the vendor is liable for it, the vendor is liable for any interest until completion.
- 26.4 To the extent the purchaser is liable for it, the *parties* must adjust any interest under clause 14.1.

27 Consent to transfer

- 27.1 This clause applies only if the land (or part of it) cannot be transferred without consent under *legislation* or a *planning agreement*.
- 27.2 The purchaser must properly complete and then *serve* the purchaser's part of an application for consent to transfer of the land (or part of it) *within 7 days* after the contract date.
- 27.3 The vendor must apply for consent *within 7 days* after *service* of the purchaser's part.
- 27.4 If consent is refused, either *party* can *rescind*.
- 27.5 If consent is given subject to one or more conditions that will substantially disadvantage a *party*, then that *party* can *rescind within 7 days* after receipt by or *service* upon the *party* of written notice of the conditions.
- 27.6 If consent is not given or refused –
- 27.6.1 *within 42 days* after the purchaser *serves* the purchaser's part of the application, the purchaser can *rescind*; or
 - 27.6.2 *within 30 days* after the application is made, either *party* can *rescind*.
- 27.7 Each period in clause 27.6 becomes 90 days if the land (or part of it) is –
- 27.7.1 under a *planning agreement*; or
 - 27.7.2 in the Western Division.
- 27.8 If the land (or part of it) is described as a lot in an unregistered plan, each time in clause 27.6 becomes the later of the time and 35 days after creation of a separate folio for the lot.
- 27.9 The date for completion becomes the later of the date for completion and 14 days after *service* of the notice granting consent to transfer.

28 Unregistered plan

- 28.1 This clause applies only if some of the land is described as a lot in an unregistered plan.
- 28.2 The vendor must do everything reasonable to have the plan registered *within* 6 months after the contract date, with or without any minor alteration to the plan or any document to be lodged with the plan validly required or made under *legislation*.
- 28.3 If the plan is not registered *within* that time and in that manner –
- 28.3.1 the purchaser can *rescind*; and
- 28.3.2 the vendor can *rescind*, but only if the vendor has complied with clause 28.2 and with any *legislation* governing the rescission.
- 28.4 Either *party* can *serve* notice of the registration of the plan and every relevant lot and plan number.
- 28.5 The date for completion becomes the later of the date for completion and 21 days after *service* of the notice.
- 28.6 Clauses 28.2 and 28.3 apply to another plan that is to be registered before the plan is registered.

29 Conditional contract

- 29.1 This clause applies only if a provision says this contract or completion is conditional on an event.
- 29.2 If the time for the event to happen is not stated, the time is 42 days after the contract date.
- 29.3 If this contract says the provision is for the benefit of a *party*, then it benefits only that *party*.
- 29.4 If anything is necessary to make the event happen, each *party* must do whatever is reasonably necessary to cause the event to happen.
- 29.5 A *party* can *rescind* under this clause only if the *party* has substantially complied with clause 29.4.
- 29.6 If the event involves an approval and the approval is given subject to a condition that will substantially disadvantage a *party* who has the benefit of the provision, the *party* can *rescind* *within* 7 days after either *party* *serves* notice of the condition.
- 29.7 If the *parties* can lawfully complete without the event happening –
- 29.7.1 if the event does not happen *within* the time for it to happen, a *party* who has the benefit of the provision can *rescind* *within* 7 days after the end of that time;
- 29.7.2 if the event involves an approval and an application for the approval is refused, a *party* who has the benefit of the provision can *rescind* *within* 7 days after either *party* *serves* notice of the refusal; and
- 29.7.3 the date for completion becomes the later of the date for completion and 21 days after the earliest of –
- either *party* *serving* notice of the event happening;
 - every *party* who has the benefit of the provision *serving* notice waiving the provision; or
 - the end of the time for the event to happen.
- 29.8 If the *parties* cannot lawfully complete without the event happening –
- 29.8.1 if the event does not happen *within* the time for it to happen, either *party* can *rescind*;
- 29.8.2 if the event involves an approval and an application for the approval is refused, either *party* can *rescind*;
- 29.8.3 the date for completion becomes the later of the date for completion and 21 days after either *party* *serves* notice of the event happening.
- 29.9 A *party* cannot *rescind* under clauses 29.7 or 29.8 after the event happens.

30 Electronic transaction

- 30.1 This *Conveyancing Transaction* is to be conducted as an *electronic transaction* if –
- 30.1.1 this contract says that it is an *electronic transaction*;
- 30.1.2 the *parties* otherwise agree that it is to be conducted as an *electronic transaction*; or
- 30.1.3 the *conveyancing rules* require it to be conducted as an *electronic transaction*.
- 30.2 However, this *Conveyancing Transaction* is not to be conducted as an *electronic transaction* –
- 30.2.1 if the land is not *electronically tradeable* or the transfer is not eligible to be lodged electronically; or
- 30.2.2 if, at any time after the *effective date*, but at least 14 days before the date for completion, a *party* *serves* a notice stating a valid reason why it cannot be conducted as an *electronic transaction*.
- 30.3 If, because of clause 30.2.2, this *Conveyancing Transaction* is not to be conducted as an *electronic transaction* –
- 30.3.1 each *party* must –
- bear equally any disbursements or fees; and
 - otherwise bear that *party's* own costs;
- incurred because this *Conveyancing Transaction* was to be conducted as an *electronic transaction*; and
- 30.3.2 if a *party* has paid all of a disbursement or fee which, by reason of this clause, is to be borne equally by the *parties*, that amount must be adjusted under clause 14.2.
- 30.4 If this *Conveyancing Transaction* is to be conducted as an *electronic transaction* –
- 30.4.1 to the extent that any other provision of this contract is inconsistent with this clause, the provisions of this clause prevail;

- 30.4.2 normally, words and phrases used in this clause 30 (italicised and in Title Case, such as *Electronic Workspace* and *Lodgment Case*) have the same meaning which they have in the *participation rules*;
- 30.4.3 the *parties* must conduct the *electronic transaction* –
- in accordance with the *participation rules* and the *ECNL*; and
 - using the nominated *ELN*, unless the *parties* otherwise agree;
- 30.4.4 a *party* must pay the fees and charges payable by that *party* to the *ELNO* and the *Land Registry* as a result of this transaction being an *electronic transaction*;
- 30.4.5 any communication from one *party* to another *party* in the *Electronic Workspace* made –
- after the *effective date*; and
 - before the receipt of a notice given under clause 30.2.2;
- is taken to have been received by that *party* at the time determined by s13A of the *Electronic Transactions Act 2000*; and
- 30.4.6 a document which is an *electronic document* is *served* as soon as it is first *Digitally Signed* in the *Electronic Workspace* on behalf of the *party* required to *serve* it.
- 30.5 Normally, the vendor must *within 7 days* of the *effective date* –
- 30.5.1 create an *Electronic Workspace*;
- 30.5.2 populate the *Electronic Workspace* with *title data*, the date for completion and, if applicable, *mortgagee details*; and
- 30.5.3 invite the purchaser and any *discharging mortgagee* to the *Electronic Workspace*.
- 30.6 If the vendor has not created an *Electronic Workspace* in accordance with clause 30.5, the purchaser may create an *Electronic Workspace*. If the purchaser creates the *Electronic Workspace* the purchaser must –
- 30.6.1 populate the *Electronic Workspace* with *title data*;
- 30.6.2 create and populate an *electronic transfer*;
- 30.6.3 populate the *Electronic Workspace* with the date for completion and a nominated *completion time*; and
- 30.6.4 invite the vendor and any *incoming mortgagee* to join the *Electronic Workspace*.
- 30.7 Normally, *within 7 days* of receiving an invitation from the vendor to join the *Electronic Workspace*, the purchaser must –
- 30.7.1 join the *Electronic Workspace*;
- 30.7.2 create and populate an *electronic transfer*;
- 30.7.3 invite any *incoming mortgagee* to join the *Electronic Workspace*; and
- 30.7.4 populate the *Electronic Workspace* with a nominated *completion time*.
- 30.8 If the purchaser has created the *Electronic Workspace* the vendor must *within 7 days* of being invited to the *Electronic Workspace* –
- 30.8.1 join the *Electronic Workspace*;
- 30.8.2 populate the *Electronic Workspace* with *mortgagee details*, if applicable; and
- 30.8.3 invite any *discharging mortgagee* to join the *Electronic Workspace*.
- 30.9 To complete the financial settlement schedule in the *Electronic Workspace* –
- 30.9.1 the purchaser must provide the vendor with *adjustment figures* at least *2 business days* before the date for completion;
- 30.9.2 the vendor must confirm the *adjustment figures* at least *1 business day* before the date for completion; and
- 30.9.3 if the purchaser must make a *GSTRW payment* or an *FRCGW remittance*, the purchaser must populate the *Electronic Workspace* with the payment details for the *GSTRW payment* or *FRCGW remittance* payable to the Deputy Commissioner of Taxation at least *2 business days* before the date for completion.
- 30.10 Before completion, the *parties* must ensure that –
- 30.10.1 all *electronic documents* which a *party* must *Digitally Sign* to complete the *electronic transaction* are *populated* and *Digitally Signed*;
- 30.10.2 all certifications required by the *ECNL* are properly given; and
- 30.10.3 they do everything else in the *Electronic Workspace* which that *party* must do to enable the *electronic transaction* to proceed to completion.
- 30.11 If completion takes place in the *Electronic Workspace* –
- 30.11.1 payment electronically on completion of the price in accordance with clause 16.7 is taken to be payment by a single *settlement cheque*;
- 30.11.2 the completion address in clause 16.11 is the *Electronic Workspace*; and
- 30.11.3 clauses 13.13.2 to 13.13.4, 16.8, 16.12, 16.13 and 31.2.2 to 31.2.4 do not apply.
- 30.12 If the computer systems of any of the *Land Registry*, the *ELNO* or the Reserve Bank of Australia are inoperative for any reason at the *completion time* agreed by the *parties*, a failure to complete this contract for that reason is not a default under this contract on the part of either *party*.

- 30.13 If the computer systems of the *Land Registry* are inoperative for any reason at the *completion time* agreed by the *parties*, and the *parties* choose that financial settlement is to occur despite this, then on financial settlement occurring –
- 30.13.1 all *electronic documents Digitally Signed* by the vendor, the *certificate of title* and any discharge of mortgage, withdrawal of caveat or other *electronic document* forming part of the *Lodgment Case* for the *electronic transaction* shall be taken to have been unconditionally and irrevocably delivered to the purchaser or the purchaser's mortgagee at the time of financial settlement together with the right to deal with the land comprised in the *certificate of title*; and
- 30.13.2 the vendor shall be taken to have no legal or equitable interest in the *property*.
- 30.14 A *party* who holds a *certificate of title* must act in accordance with any *Prescribed Requirement* in relation to the *certificate of title* but if there is no *Prescribed Requirement*, the vendor must serve the *certificate of title* after completion.
- 30.15 If the *parties* do not agree about the delivery before completion of one or more documents or things that cannot be delivered through the *Electronic Workspace*, the *party* required to deliver the documents or things –
- 30.15.1 holds them on completion in escrow for the benefit of; and
- 30.15.2 must immediately after completion deliver the documents or things to, or as directed by; the *party* entitled to them.
- 30.16 In this clause 30, these terms (in any form) mean –
- | | |
|---------------------------------|---|
| <i>adjustment figures</i> | details of the adjustments to be made to the price under clause 14; |
| <i>certificate of title</i> | the paper duplicate of the folio of the register for the land which exists immediately prior to completion and, if more than one, refers to each such paper duplicate; |
| <i>completion time</i> | the time of day on the date for completion when the <i>electronic transaction</i> is to be settled; |
| <i>conveyancing rules</i> | the rules made under s12E of the Real Property Act 1900; |
| <i>discharging mortgagee</i> | any discharging mortgagee, chargee, covenant chargee or caveator whose provision of a <i>Digitally Signed</i> discharge of mortgage, discharge of charge or withdrawal of caveat is required in order for unencumbered title to the <i>property</i> to be transferred to the purchaser; |
| <i>ECNL</i> | the Electronic Conveyancing National Law (NSW); |
| <i>effective date</i> | the date on which the <i>Conveyancing Transaction</i> is agreed to be an <i>electronic transaction</i> under clause 30.1.2 or, if clauses 30.1.1 or 30.1.3 apply, the contract date; |
| <i>electronic document</i> | a dealing as defined in the Real Property Act 1900 which may be created and <i>Digitally Signed</i> in an <i>Electronic Workspace</i> ; |
| <i>electronic transfer</i> | a transfer of land under the Real Property Act 1900 for the <i>property</i> to be prepared and <i>Digitally Signed</i> in the <i>Electronic Workspace</i> established for the purposes of the <i>parties' Conveyancing Transaction</i> ; |
| <i>electronic transaction</i> | a <i>Conveyancing Transaction</i> to be conducted for the <i>parties</i> by their legal representatives as <i>Subscribers</i> using an <i>ELN</i> and in accordance with the <i>ECNL</i> and the <i>participation rules</i> ; |
| <i>electronically tradeable</i> | a land title that is Electronically Tradeable as that term is defined in the <i>conveyancing rules</i> ; |
| <i>incoming mortgagee</i> | any mortgagee who is to provide finance to the purchaser on the security of the <i>property</i> and to enable the purchaser to pay the whole or part of the price; |
| <i>mortgagee details</i> | the details which a <i>party</i> to the <i>electronic transaction</i> must provide about any <i>discharging mortgagee</i> of the <i>property</i> as at completion; |
| <i>participation rules</i> | the participation rules as determined by the <i>ECNL</i> ; |
| <i>populate</i> | to complete data fields in the <i>Electronic Workspace</i> ; and |
| <i>title data</i> | the details of the title to the <i>property</i> made available to the <i>Electronic Workspace</i> by the <i>Land Registry</i> . |
- 31 Foreign Resident Capital Gains Withholding**
- 31.1 This clause applies only if –
- 31.1.1 the sale is not an excluded transaction within the meaning of s14-215 of Schedule 1 to the *TA Act*; and
- 31.1.2 a *clearance certificate* in respect of every vendor is not attached to this contract.
- 31.2 The purchaser must –
- 31.2.1 at least 5 days before the date for completion, serve evidence of submission of a purchaser payment notification to the Australian Taxation Office by the purchaser or, if a direction under clause 4.3 has been served, by the transferee named in the transfer served with that direction;
- 31.2.2 produce on completion a *settlement cheque* for the *FRCGW remittance* payable to the Deputy Commissioner of Taxation;
- 31.2.3 forward the *settlement cheque* to the payee immediately after completion; and
- 31.2.4 serve evidence of receipt of payment of the *FRCGW remittance*.

- 31.3 The vendor cannot refuse to complete if the purchaser complies with clauses 31.2.1 and 31.2.2.
- 31.4 If the vendor *serves any clearance certificate or variation*, the purchaser does not have to complete earlier than 7 days after that *service* and clause 21.3 does not apply to this provision.
- 31.5 If the vendor *serves* in respect of every vendor either a *clearance certificate* or a *variation* to 0.00 percent, clauses 31.2 and 31.3 do not apply.
- 32 Residential off the plan contract**
- 32.1 This clause applies if this contract is an off the plan contract within the meaning of Division 10 of Part 4 of the Conveyancing Act 1919 (the Division).
- 32.2 No provision of this contract has the effect of excluding, modifying or restricting the operation of the Division.
- 32.3 If the purchaser makes a claim for compensation under the terms prescribed by clause 6A of the Conveyancing (Sale of Land) Regulation 2017 –
- 32.3.1 the purchaser cannot make a claim under this contract about the same subject matter, including a claim under clauses 6 or 7; and
- 32.3.2 the claim for compensation is not a claim under this contract.
- 32.4 This clause does not apply to a contract made before the commencement of the amendments to the Division under the Conveyancing Legislation Amendment Act 2018.

2/28 Kenrose Street FORSTER NSW 2428

SPECIAL CONDITIONS

These are the special conditions to the contract for the sale of land

BETWEEN Alison Joan Jones

of 2/28 Kenrose Street, Forster, New South Wales **(Vendor)**

AND

of **(Purchaser)**

1. Notice to complete

In the event of either party failing to complete this contract within the time specified herein, then the other shall be entitled at any time thereafter to serve a notice to complete, requiring the other to complete within 14 days from the date of service of the notice, and this time period is considered reasonable by both parties. For the purpose of this contract, such notice to complete shall be deemed both at law and in equity sufficient to make time of the essence of this contract.

2. Death or incapacity

Notwithstanding any rule of law or equity to the contrary, should either party, or if more than one any one of them, prior to completion die or become mentally ill, as defined in the Mental Health Act, or become bankrupt, or if a company go into liquidation, then either party may rescind this contract by notice in writing forwarded to the other party and thereupon this contract shall be at an end and the provisions of clause 19 hereof shall apply.

3. Purchaser acknowledgements

The purchaser acknowledges that they are purchasing the property:

- (a) In its present condition and state of repair;
- (b) Subject to all defects latent and patent;
- (c) Subject to any infestations and dilapidation;
- (d) Subject to all existing water, sewerage, drainage and plumbing services and connections in respect of the property; and
- (e) Subject to any non-compliance, that is disclosed herein, with the Local Government Act or any Ordinance under that Act, The Environmental Planning and Assessment Act 1979 or The Swimming Pool Act 1992 or any regulations thereunder in respect of any building on the land.

The purchaser agrees not to seek to terminate rescind or make any objection requisition or claim for compensation arising out of any of the matters covered by this clause.

4. Late completion

In the event that completion is not effected on the nominated day for settlement, or if the vendor cannot settle on that day then the third day after written notice from the vendor that the vendor is able to settle, then the

purchaser shall pay to the vendor interest on the balance of the purchase price at the rate of 10% per annum from the date nominated for completion until and including the actual day of completion.

5. Agent

The purchaser warrants that they were not introduced to the vendor or the property by or through the medium of any real estate agent or any employee of any real estate agent or any person having any connection with a real estate agent who may be entitled to claim commission as a result of this sale other than the vendors agent, if any, referred to in this contract, and it is hereby agreed and declared that this clause shall not merge in the transfer upon completion, or be extinguished by completion of this contract, and shall continue in full force, and effect, notwithstanding completion.

6. Smoke alarms

The property has smoke alarms installed.



FOLIO: 2/834709

SEARCH DATE	TIME	EDITION NO	DATE
27/2/2020	2:11 PM	7	7/5/2019

LAND

LOT 2 IN DEPOSITED PLAN 834709
AT FORSTER
LOCAL GOVERNMENT AREA MID-COAST
PARISH OF FORSTER COUNTY OF GLOUCESTER
TITLE DIAGRAM DP834709

FIRST SCHEDULE

ERIC ARTHUR JONES
ALISON JOAN JONES
AS JOINT TENANTS

(T AK611963)

SECOND SCHEDULE (6 NOTIFICATIONS)

- 1 LAND EXCLUDES MINERALS AND IS SUBJECT TO RESERVATIONS AND CONDITIONS IN FAVOUR OF THE CROWN - SEE CROWN GRANT(S)
- 2 DP827072 RESTRICTION(S) ON THE USE OF LAND
- 3 DP834709 EASEMENT FOR SUPPORT OVER 0.23 WIDE BRICK COMMON DIVIDING WALL AND ASSOCIATED FOOTINGS AFFECTING THE PART(S) SHOWN SO BURDENED IN THE TITLE DIAGRAM
- 4 DP834709 EASEMENT FOR SUPPORT OVER 0.23 WIDE BRICK COMMON DIVIDING WALL AND ASSOCIATED FOOTINGS APPURTENANT TO THE LAND ABOVE DESCRIBED
- 5 DP834709 EASEMENT TO DRAIN SEWAGE 3 WIDE AFFECTING THE PART(S) SHOWN SO BURDENED IN THE TITLE DIAGRAM
AG173523 EASEMENT NOW VESTED IN MIDCOAST COUNTY COUNCIL
- 6 AP235933 MORTGAGE TO ASF CUSTODIANS PTY LTD

NOTATIONS

UNREGISTERED DEALINGS: NIL

*** END OF SEARCH ***

132193 Jones

PRINTED ON 27/2/2020

* Any entries preceded by an asterisk do not appear on the current edition of the Certificate of Title. Warning: the information appearing under notations has not been formally recorded in the Register. InfoTrack an approved NSW Information Broker hereby certifies that the information contained in this document has been provided electronically by the Registrar General in accordance with Section 96B(2) of the Real Property Act 1900.

PLAN FORM 1

Plan Drawing only to appear in this space

OFFICE USE ONLY

SIGNATURES, SEALS AND STATEMENTS of intention to indicate public roads or to create public reserves, easements, covenants, encumbrances, restrictions on the use of land or otherwise. Intending to create:
1. EASEMENT FOR SUPPORT OVER
2. EASEMENT TO DRAIN SEWAGE
3. EASEMENT TO DRAIN SEWAGE
3 WIDE APPROXIMATE
Council Clerk

Crown Lands Office Approval
Land District: Administrative Office
Paper No.:
File No.: pages

Council Clerk's Certificate
I hereby certify that:
(a) The proponent of the Local Government Act, 1959 (under which this plan is prepared) is duly qualified to propose and execute the plan, and the necessary approval has been obtained from the Council of the Local Government.
(b) The plan has been prepared in accordance with the provisions of the Local Government Act, 1959, and the necessary approval has been obtained from the Council of the Local Government.
(c) The plan has been prepared in accordance with the provisions of the Local Government Act, 1959, and the necessary approval has been obtained from the Council of the Local Government.
Signature: [Signature]
Date: 28.10.1993
Council File No.: D.A. 5731

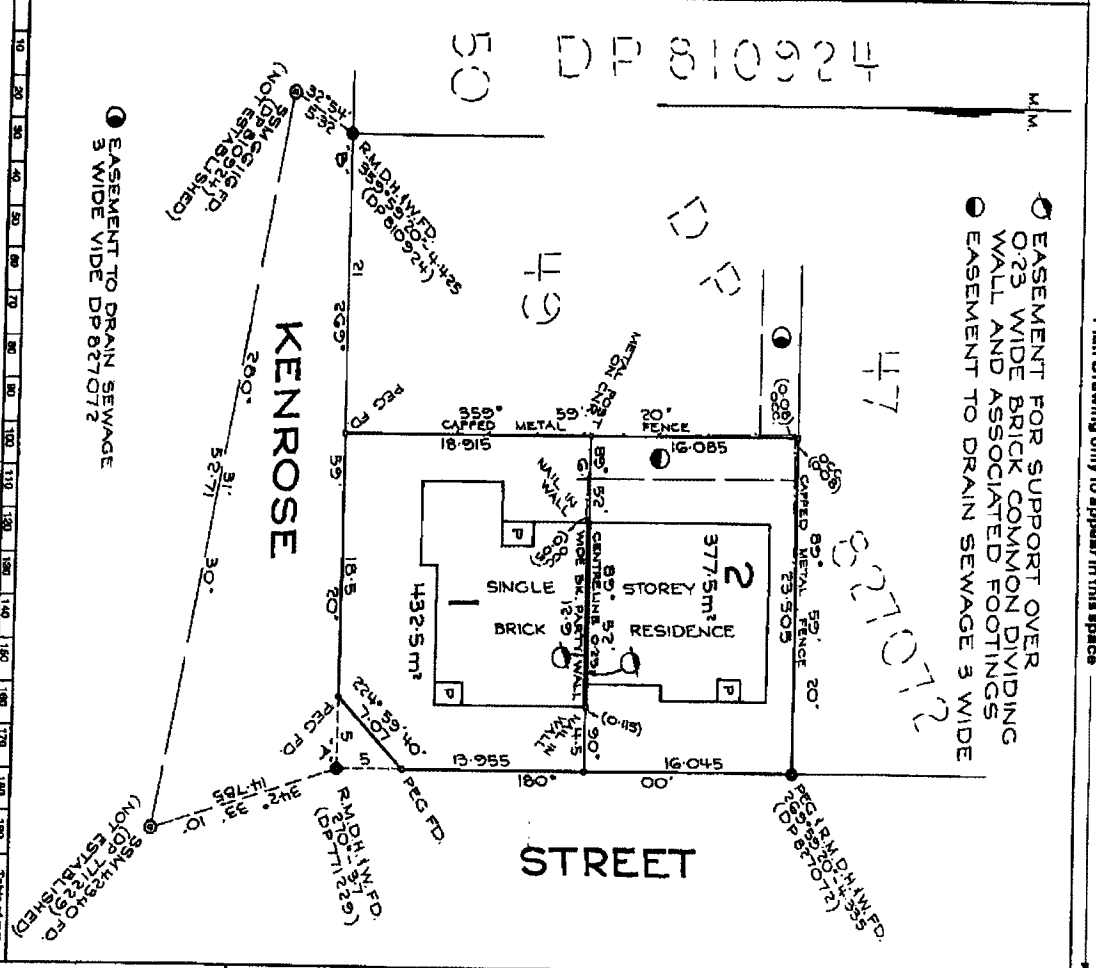

DP 834709	Registered: 28.11.1993
CA 115/1993 OF 28-10-1993	Title System: TORRENS
Purpose: SUBDIVISION	Ref. Map: Z 4632 - 92 #
Leaf Plan: D.P. 827072	
PLAN OF SUBDIVISION OF LOT 48 DP 827072	
Lengths are in metres. Reduction Ratio: 1:300	
Area/Shape: GREAT LAKES 2099	Locality: FORSTER
Purpose: FORSTER	County: GLOUCESTER
Plans used in preparation of survey/compilation, DP 771262, DP 810924, DP 827072.	
I, BRIAN ALBERT HADBURY, Registered Surveyor (Northern Territory), do hereby certify that the survey was made by me or under my supervision in accordance with the Survey Act, 1959, as amended, and that the plan is a true and correct copy of the survey made by me or under my supervision.	
Signature: [Signature] Date: 28.10.1993	
Signature of Registrar: [Signature] Date: 28.10.1993	

WARNING: CREASING OR FOLDING WILL LEAD TO REFLECTION SOUTH ASCERTAINED SCALING AS NOT ESTABLISHED

INSTRUMENT SETTING OUT TERMS OF EASEMENTS AND RESTRICTIONS AS TO USES INTENDED TO BE CREATED PURSUANT TO SECTION 89B OF THE CONVEYANCING ACT, 1919

PART 1 (Sheet 1 of 2 Sheets)

Plan: DP 834709

Subdivision covered by Council Clerk's Certificate No. 1511992

Full Name and address of Proprietor of the land

John Gwara Treasure and Powena Margaret Treasure of 19 Becker Road, Forster

1. Identity of easement or restriction firstly referred to in the abovementioned Plan:

Easement for support over 0.23 wide brick common dividing wall and associated footings

Schedule of Lots, etc. affected

Lots Burdened

Lots, name of road or authority benefited

Lot 1 and 2

Lot 2 and 1

2. Identity of easement or restriction firstly referred to in the abovementioned Plan:

Easement to drain sewage 3 wide

Schedule of Lots, etc. affected

Lots Burdened

Lots, name of road or authority benefited

Lot 2

Lot Land Great Lakes Shire Council

Bonnie M Gwara
John Gwara

REGISTERED
 15/11/93

DP 834709

PART 2 (Sheet 2 of 2 Sheets)

Terms of Easement for support referred to in the abovementioned plan:

Full and free right and liberty for the Registered Proprietor and every person who is at any time entitled to an estate or interest in possession in the land herein indicated as the lot benefited or any part thereof with which the rights shall be capable of enjoyment and every person authorised by him from time to time and at all times to use the land herein indicated as the Easement for Support over 0.23 Metre Brick Common Dividing Wall and associated footings within the lot benefited for the purpose that any structure supported or to be supported over the lot or in part thereof shall have the support of the whole of such Common Dividing Wall and the footings thereof and for the purpose of placing thereon all such materials as shall be necessary or desirable for the purpose of maintaining such wall provided that the said Registered Proprietor and other persons authorised by him will take all reasonable precautions to ensure as little disturbance as possible to the Easement for Support over the 0.23 Metre Brick Common Dividing Wall and Associated Footings within the lot benefited and to an estate or interest in possession in the land herein indicated as the Easement for Support over 0.23 Metre Brick Common Dividing Wall and Associated Footings within the lot benefited agrees that he will not use or permit purpose which may affect or have a tendency to affect the stability of the said wall and will not do or suffer to be done any act or thing which may injure or damage the said wall or in any way impair its efficiency and if he should do or suffer to be done any act or thing which may injure or damage the said wall he will at his own expense properly and substantially repair and make good all such injury and damage.

This easement is to remain in force only during the life of the said wall.

SIGNED SEALED AND DELIVERED by the said JOHN GWARNE TREASURE in the presence of:

John Gwara
Powena Margaret

SIGNED SEALED AND DELIVERED by the said POWENA MARGARET TREASURE in the presence of:

Bonnie M Gwara
John Gwara

Easement to drain sewage Surfer approved.

John Gwara
 Council Clerk.

REGISTERED
 15/11/93

PLAN FORM 2
DRAWING AND SCALE ONLY

PLAN DRAWING ONLY TO APPEAR IN THIS SPACE

DP 827072
8/22/92
C/L: HULLS/1992 OF 14/11/92
C/O: STALEY TORRENS
SUBDIVISION
Lot: 148 Z 14632-924
Laid Down: DP 810924
PLAN OF SUBDIVISION OF
LOT 148 DP 810924

PROPERTY: GREAT LAKES
OWNER: FORSTER
NAME: FORSTER
CITY: GLOUCESTER

PROJECT: GREAT LAKES SUBDIVISION
D.P. 810924
D.P. 827072

Prepared by: J. R. GUNDEL
Checked by: J. R. GUNDEL
Approved by: J. R. GUNDEL

Notes: THIS DRAWING IS A PLAN OF SUBDIVISION OF LOT 148 OF THE GREAT LAKES SUBDIVISION AS SHOWN ON DP 810924. THE SEPARATION OF THE LOTS IS SHOWN BY THE DOTTED LINES. THE LOT LINES ARE SET OUT IN CONFORMITY WITH THE PLAN OF SUBDIVISION OF LOT 148 OF THE GREAT LAKES SUBDIVISION AS SHOWN ON DP 810924.

PROVIDE FOR THE SUBDIVISION OF LOT 148 OF THE GREAT LAKES SUBDIVISION AS SHOWN ON DP 810924 INTO LOTS 148A, 148B, 148C, 148D AND 148E. THE SEPARATION OF THE LOTS IS SHOWN BY THE DOTTED LINES. THE LOT LINES ARE SET OUT IN CONFORMITY WITH THE PLAN OF SUBDIVISION OF LOT 148 OF THE GREAT LAKES SUBDIVISION AS SHOWN ON DP 810924.

APPROVED BY THE COUNCIL ON THE 15th DAY OF December 1992.

Forster

WALLIS LAKE
CROWN RESERVE
PUBLIC RESERVE
KENROSE (20 WIDE)
KENROSE (20 WIDE)
STREET
THE LAKES WAY

D P 753168
148

D P 810924
51
50
51
50
51
50
51
50
51
50

148
149
148
149
148
149
148
149

D P 810924
KENROSE
STREET
DIAGRAM

EASEMENT TO DRAIN SEWAGE 3 WIDE
EASEMENT TO DRAIN SEWAGE 3 WIDE VIDE DP 810924

SEE ABOVE
47

KENROSE

This negative is a photograph made as a permanent record of a document in the custody of the Registrar-General on this day, 15th December 1992.

WARNING: CHEASING OR POLISHING WILL LEAD TO REJECTION



**INSTRUMENT SETTING OUT TERMS OF EASEMENTS AND RESTRICTIONS
 AS TO USER INTENDED TO BE CREATED PURSUANT TO SECTION 388
 OF THE CONVEYANCING ACT, 1919**

(Sheet 1 of 3 Sheets)

PART 1

Plan: **DP827072**

Subdivision covered by Council
 Clerk's Certificate No. 108/1992

Full name and address of
 Proprietor of the land:
 Lampo Pty, Limited of 33 The
 Lakes Way, Forster
 A/CN 000 820 931

Full name and address of First
 Mortgagee:

National Australia Bank Limited
 Beach Street, Forster

1. Identity of Easement or
 Restriction firstly referred
 to in the above-mentioned Plan:
 Easement to Drain sewage 3 wide

Schedule of lots, etc. affected

lots burdened

lots, name of road or authority
 benefited

lots 49
 The Council of the Shire of Great
 Lakes

2. Identity of Easement or
 Restriction secondly referred
 to in the above-mentioned Plan:
 Restrictions as to User

Schedule of lots, etc. affected

lots burdened
 Every other lot except Lot 47

lots, name of road or authority
 benefited

REGISTERED 8-12-92

**INSTRUMENT SETTING OUT TERMS OF EASEMENTS AND RESTRICTIONS
 AS TO USER INTENDED TO BE CREATED PURSUANT TO SECTION 388
 OF THE CONVEYANCING ACT, 1919**

(Sheet 2 of 3 Sheets)

PART 2

Plan: **DP827072**

Terms of restrictions on the use of land secondly referred to in
 above-mentioned Plan:

- (a) No main building erected or permitted to remain on any lot
 burdened shall have a minimum living area excluding any
 attached garage or carport under the main roof of less than one
 hundred (100) square metres provided that this restriction
 shall not apply to any building erected upon this land if at
 any time it shall become the subject of Strata Title.
- (b) No building structure or object shall be erected or permitted
 to remain on the land with materials other than new and first
 quality materials.
- (c) No building which was previously erected shall be re-erected or
 permitted to remain on the land.
- (d) That except where otherwise required by any public body or
 authority no sanitary convenience erected or permitted to
 remain on the land shall be detached or separate from any main
 building erected thereon.
- (e) That no fence shall be erected or permitted to remain along the
 street frontage of any lot burdened or along the side boundary
 in front of the building alignment and otherwise no boundary
 fence shall be piling or staked 1.528 metres in height. For
 the purpose of this covenant "street frontage" shall mean the
 street frontage to which the lot has a permitted vehicular
 access.
- (f) That for the benefit of any adjoining land owned by Lampo Pty.
 Limited but only during the ownership thereof by its successors
 and assigns other than purchasers on sale no fence shall be
 erected on the land to divide the same from such adjoining land
 without the consent of Lampo Pty, Limited but such consent
 shall not be withheld if such fence is erected without expense
 to Lampo Pty, Limited and in favour of any person dealing with
 the transferee such consent shall be deemed to have been given
 in respect of every such fence for the time being erected.
- (g) That the expression "the land" herein used shall be
 deemed to refer separately and severally to each lot hereby
 burdened.

REGISTERED 8-12-92

10	20	30	40	50	60	70	Table of min	110	120	130	140
----	----	----	----	----	----	----	--------------	-----	-----	-----	-----

This negative is a photograph made as a permanent
 record of a document in the custody of the
 Registrar General this day 15th December 1992



INSTRUMENT SETTING OUT TERMS OF EASEMENTS AND RESTRICTIONS
AS TO USER INTENDED TO BE CREATED PURSUANT TO SECTION 89B
OF THE CONVEYANCING ACT, 1919

Plan: DP827072

(Sheet 3 of 3 Sheets)

(4) Any release, variation or modification of these restrictions shall be made and done in all respects at the cost and expense of the person or persons requesting the same. The persons or persons having the right to release vary or modify these restrictions is Lampo Pty. Limited or such or other persons company or companies nominated by it under its common seal for that purpose and it Lampo Pty. Limited shall no longer be in existence or shall not be the registered proprietor of any of the land comprised in the Plan of Subdivision and there shall be no such person or persons company or companies so nominated then the person or persons having the right to release vary or modify these restrictions shall be the persons or companies for the time being registered as the proprietors of the land in the Plan of Subdivision having common boundaries with the lot burdened.

THE COMMON SEAL OF LAMPO PTY. LIMITED was heretofore affixed by authority of a resolution of the Board of Directors in the presence of:



[Signature]
.....
[Signature]
.....

Easement to drain sewage Sunde approved.

[Signature]
Council Clerk.

FORMED AT SYDNEY THIS 29TH DAY OF NOVEMBER 1980. FOR
WITNESSES:
MURRAY ALLENBANK BANK LIMITED BY
DEPUTY CHIEF EXECUTIVE OFFICER
AND
ATTORNEY IN SYDNEY BOOK 3854

ASSISTANT MANAGER
[Signature]
Geraldine Wainwright
Solicitors and Conveyancers
George St, Sydney

Bank Clerk

04450/31-33

REGISTERED 87292

10	20	30	40	50	60	70	Table of mm	110	120	130	140
----	----	----	----	----	----	----	-------------	-----	-----	-----	-----

This f
REGOR
Regis



Form: OITY
 Release: 1.2
 www.fpma.nsw.gov.au

**TRANSFER OF
 EASEMENT IN GROSS!**
 New South Wales
 Section 88A Conveyancing Act 1919



AG173523U

PRIVACY NOTE: Section 31B of the Real Property Act 1900 (RP Act) authorises the Registrar General to collect the information required by this form for the establishment and maintenance of the Real Property Act Register. Section 96B RP Act requires that the Register is made available to any person for search upon payment of a fee, if any.

STAMP DUTY

Office of State Revenue use only J	NEW SOUTH WALES DUTY 29-03-2011 0006211657-008 SECTION 277-ORIGINAL NO DUTY PAYABLE
---------------------------------------	--

(A) TORRENS TITLE

2/834709

(B) EASEMENT IN GROSS

Number	Description
DP834709	EASEMENT TO DRAIN SEWAGE 3 WIDE

(C) LODGED BY

Document Collection Box	Name, Address or DX, Telephone, and Customer Account Number if any	CODE
392 C	SYDNEY LEGAL AGENTS LLP : 128005 Y Reference: <u>Midcoast/Water</u>	TY

(D) TRANSFEROR

GREAT LAKES SHIRE COUNCIL

(E) TRANSFEREE

MIDCOAST COUNTY COUNCIL

(F) The transferor acknowledges receipt of the consideration of \$ _____ and transfers to the transferee the abovementioned easement in gross.

DATE 21.03.2011

(G) I certify that the person signing opposite, with whom I am personally acquainted or as to whose identity I am otherwise satisfied, signed this transfer in my presence.

Signature of witness:

Full name of witness:

Address of witness:

[Signature]
JOHN DOUGHERTY
BREESE PARADE, FORSTER

I certify that the person signing opposite, with whom I am personally acquainted or as to whose identity I am otherwise satisfied, signed this transfer in my presence.

Signature of witness:

Full name of witness:

Address of witness:

[Signature]
JESSICA PARROTT
16 BREESE PDE
FORSTER NSW 2428

Certified correct for the purposes of the Real Property Act 1900 by an authorised officer of the transferor.

[Signature]
 Signature of authorised officer:
Glenn Jeffrey Handford
 Full name of authorised officer:
General Manager
Great Lakes Council
 Position of authorised officer:

Certified correct for the purposes of the Real Property Act 1900 by an authorised officer of the transferee.

[Signature]
 Signature of authorised officer:
 Full name of authorised officer:
ANTHONY JOHN SUMMERS
 Position of authorised officer:
PROBATION & LEGAL MANAGER

[Handwritten mark]

PLANNING CERTIFICATE

Section 149
Environmental Planning & Assessment Act 1979

Cert No.	1862 / 2016
-----------------	--------------------

Applicant

KEY2 CONVEYANCING
PO Box 697
FORSTER NSW 2428

Receipt No. : 1646170
Date of issue : 9 March 2016
Ref : K5466

Property Key : 22101

Property Description

2/28 Kenrose Street, FORSTER NSW 2428
Lot 2 DP 834709

Owner (as recorded by Council):

Mr R J Cashman and Mrs C T Cashman
2/28 Kenrose St
FORSTER NSW 2428

A — Advice provided in accordance with Section 149(2)

1. Names of relevant planning instruments and DCPs

Great Lakes Local Environment Plan 2014

Great Lakes Development Control Plan

The land is subject to the following planning proposal(s)

Short-term Holiday Rental of Dwellings

The proposal seeks to introduce a new local clause to allow the use of dwellings for short term holiday accommodation. It is proposed to allow dwellings that have up to 4 bedrooms to be used for short term holiday rentals without development consent, and to require those with 5 or more bedrooms to be permitted with development consent.

Great Lakes Local Environmental Plan 2014 - Grouped Amendments No.1

The planning proposal intends to insert new clauses into Great Lakes LEP 2014 relating to boundary realignments; minimum subdivision lot sizes for certain split zones; amend the existing ecological protection subdivision clause; and amend clause 4.1A - Exception to minimum lot size for certain residential development, within the Zone RU5 Village of Smiths Lake.

The name of each State Environmental Planning Policy which may apply to the carrying out of development on the land

SEPP NO. 71	COASTAL PROTECTION
SEPP	SENIORS HOUSING etc.
SEPP NO. 4	DEVELOPMENT WITHOUT CONSENT AND MISCELLANEOUS EXEMPT AND COMPLYING DEVELOPMENT
SEPP NO. 6	NUMBER OF STOREYS IN A BUILDING
SEPP NO. 15	RURAL LANDSHARING COMMUNITIES
SEPP NO. 21	CARAVAN PARKS
SEPP NO. 22	SHOPS AND COMMERCIAL PREMISES
SEPP NO. 30	INTENSIVE AGRICULTURE

SEPP NO. 33	HAZARDOUS & OFFENSIVE DEVELOPMENT
SEPP NO. 36	MANUFACTURED HOME ESTATES
SEPP NO. 44	KOALA HABITAT PROTECTION
SEPP NO. 50	CANAL ESTATE DEVELOPMENT
SEPP NO. 55	REMEDICATION OF LAND
SEPP NO. 62	SUSTAINABLE AQUACULTURE
SEPP NO. 64	ADVERTISING AND SIGNAGE
SEPP NO. 65	DESIGN QUALITY OF RESIDENTIAL FLAT DEVELOPMENT
SEPP BASIX	(BUILDING SUSTAINABILITY INDEX: BASIX) 2004
SEPP-MD	(MAJOR DEVELOPMENT) 2005
SEPP-MPP&EI	(Mining, Petroleum Production and Extractive Industries) 2007
SEPP-S&RD	(STATE & REGIONAL DEVELOPMENT) 2011
SEPP	(Infrastructure) 2007
SEPP	(Rural Lands) 2008.
SEPP	(Temporary Structures) 2007.
SEPP	(Exempt and Complying Development Codes) 2008.
SEPP	(Affordable Rental Housing) 2009
DRAFT SEPP	(APPLICATION OF DEVELOPMENT STANDARDS) 2004
DRAFT SEPP 65	(Amendment) DESIGN QUALITY OF RESIDENTIAL FLAT DEVELOPMENT

2. Zoning and land use under relevant LEPs

Great Lakes Local Environment Plan 2014

Zone R2 Low Density Residential

1 Objectives of zone

- To provide for the housing needs of the community within a low density residential environment.
- To enable other land uses that provide facilities or services to meet the day to day needs of residents.

2 Permitted without consent

Home occupations.

3 Permitted with consent

Attached dwellings; Bed and breakfast accommodation; Boarding houses; Boat launching ramps; Building identification signs; Business identification signs; Camping grounds; Car parks; Caravan parks; Child care centres; Community facilities; Dual occupancies; Dwelling houses; Educational establishments; Emergency services facilities; Environmental protection works; Exhibition homes; Flood mitigation works; Group homes; Health consulting rooms; Helipads; Home-based child care; Home businesses; Hostels; Hotel or motel accommodation; Information and education facilities; Jetties; Medical centre; Moorings; Multi dwelling housing; Neighbourhood shops; Places of public worship; Recreation areas; Recreation facilities (indoor); Respite day care centres; Roads; Secondary dwellings; Seniors housing; Sewerage systems; Shop top housing; Water recreation structures; Water supply systems; Wharf or boating facilities.

4 Prohibited

Any development not specified in item 2 or 3.

3. Complying development

General Housing Code Complying development under this code CAN NOT be undertaken on the land subject to the following land based exclusions:

- Acid Sulphate Soil Class 1 or 2

Rural Housing Code Complying development under this code CAN NOT be undertaken on the land subject to the following land based exclusions:

- Acid Sulphate Soil Class 1 or 2

Demolition Code Complying development under this code CAN NOT be undertaken on the land subject to the following land based exclusions:

- Acid Sulphate Soil Class 1 or 2

Commercial and Industrial (Alterations) Code Complying development under this code CAN NOT be undertaken on the land subject to the following land based exclusions:

- Acid Sulphate Soil Class 1 or 2

Commercial and Industrial (New Buildings and Additions) Code Complying development under this code CAN NOT be undertaken on the land subject to the following land based exclusions:

- Acid Sulphate Soil Class 1 or 2

General Development Code Complying development under this code CAN NOT be undertaken on the land subject to the following land based exclusions:

- Acid Sulphate Soil Class 1 or 2

Housing Alterations Code Complying development under this code CAN NOT be undertaken on the land subject to the following land based exclusions:

- Acid Sulphate Soil Class 1 or 2

Subdivisions Code Complying development under this code CAN NOT be undertaken on the land subject to the following land based exclusions:

- Acid Sulphate Soil Class 1 or 2

4. Coastal protection

Section 38 or 39 of the Coastal Protection Act 1979 are not applicable. This information is provided to the extent that council has been notified by a relevant government authority.

4A Certain information relating to beaches and coasts

The land is not affected

4B Annual charges under Local Government Act 1993 for coastal protection services that relate to existing coastal protection works

No annual charges apply to the land

5. Mine subsidence

The land is not proclaimed as a mine subsidence district

6. Road widening and road realignment

The land is not affected by plans for road widening or realignment

7. Council and other public authority policies on hazard risk restrictions

No adopted hazard policies affect the land

The information provided in item 7 is based on the data and information presently available to the Council and on adopted policies and development controls in force as at the date of this certificate

7A. Flood related development controls information

Yes - Adopted Council Policy(s)

LEP2014 - 2100 Flood Planning Area

Yes - the land is subject to clause 7.3 (Flood Planning) of Great Lakes Local Environment Plan 2014 and clause 4.2 (Flooding) of Great Lakes Development Control Plan 2014 due to the likelihood of future and/or current flooding.

Details relating to flood risk and flood planning levels may be provided on a Flood Level Certificate. This can be obtained from Council's flood investigation engineer

The information provided in item 7A is based on the data and information presently available to the Council and on adopted policies and development controls in force as at the date of this certificate

8. Land reserved for acquisition

The land is not reserved for acquisition

9. Contributions plans that apply to the land

- S94-Forster District Contributions Plan 2015
- S94-Great Lakes Wide Contributions Plan 2015

9A. Biodiversity certified land

The land is not Biodiversity certified

10. Biobanking agreements

No biobanking agreements apply to the land

11. Bush fire prone land

The land is not bushfire prone land

12. Property vegetation plans

No property vegetation plans apply to the subject land

13. Orders under Trees (Disputes Between Neighbours) Act 2006

Council has not received any such order

14. Directions under Part 3A

Not applicable. Part 3A of the EP&A act has been repealed

15. Site compatibility certificates and conditions for seniors housing

No Site Compatibility Certificate for Seniors Housing applies to the land

16. Site compatibility certificates for infrastructure

No Site Compatibility Certificate for Infrastructure applies to the land

17. Site compatibility certificates for affordable rental housing

No Site Compatibility Certificate for Affordable Rental Housing applies to the land

18. Paper subdivision information

No development plan applies to the land

19. Site verification certificates

No site verification certificate applies to the land

Note. The following matters are prescribed by section 59 (2) of the Contaminated Land Management Act 1997 as additional matters to be specified in a planning certificate:

No additional matters under the Contaminated Land Management Act 1997

For further information, please contact
Planning & Environmental Services on (02) 6591 7222

GLENN HANDFORD
GENERAL MANAGER

Per:

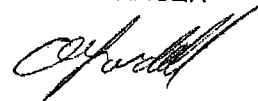



MidCoast Water Customer Service Centres:
26 Muldoon St, Taree
16 Breese Pde, Forster

All Correspondence to:
PO Box 671
TAREE NSW 2430
Phone enquiries: 1300 133 455

Your Ref: K5466
Our Ref.: ENG2016/0388

Key2 Conveyancing
Po Box 697
FORSTER NSW 2428

OWNER DETAILS

Colleen T Cashman & Robert J Cashman

PROPERTY DETAILS

Lot 2 DP 834709

ADDRESS

Unit 2/28 Kenrose St FORSTER NSW 2428

SEWERED AREAS

As requested the Plan of House Drainage for the above property is attached. These notes are intended to provide information relating to this property. Applicants are requested to ensure that intending purchasers are made fully aware of all aspects of both these notes and the attached Plan. Please note the following Important points:-

1. MidCoast Water's policy "Building over or adjacent to Watermains, Sewers or Sewerage Rising Mains" basically prohibits any new buildings to be erected closer than 1.5 meters to a Council pipe. This policy also requires special footings to be used when a building is within the 'Zone of Influence' of a sewer.

Residents, builders, developers etc. should note that the existence of a sewer, watermain or sewerage rising main can, and will, prohibit the extent of a development that will be permitted on a block. In the case of sewers, this also applies to a sewer located close to the boundary even if it is within an adjacent block. These restrictions apply to all types of building including houses, garages, sheds, carports etc.

Please contact MidCoast Water if you need any clarification on the implication of this policy. Full details are available upon request.

2. This Plan indicates the approximate location of existing buildings and pipelines. The issue of the diagram does not imply that the existing plumbing has been inspected by MidCoast Water nor that it complies with any standard or code.
3. Where there are existing buildings on the site, the issue of this Plan does not imply that they have been erected in accordance with the requirements of a Structural Engineer in relation to any 'Zone of Influence' effects.
4. The information on this Plan has been supplied by other parties and MidCoast Water will not be held responsible for the accuracy of any details shown. We do, however, endeavour to ensure that drainage diagrams are as accurate as practical when issued.
5. The attached Plan indicates the approximate location of Council's sewers only in relation to the abovementioned land.
6. It is an offence under the Local Government Act to discharge any rain water or surface water into Council's sewers.
7. Development charges will be applied if any new development on this land has a capacity of more than 1 equivalent tenement (e.g. Development charges will apply for the erection of 2 or more villas, flats, etc. as opposed to one house).
8. In the case of non-domestic premises, both new and existing developments may require a Liquid Trade Waste approval. The issue of this Plan does not imply that any such Liquid Trade Waste approval currently exists. Further information should be obtained from MidCoast Water. It is an offence to discharge sewage, other than of a domestic nature, into a Council sewer without approval.

9. This Plan is issued in accordance with section 17, 18 and 19 of the Local Government (Water Services) Regulations 1999. These notes form part of the Plan and must remain attached it. Any Plan of House Drainage without these notes should not be considered as a true copy.

If you have any enquiries regarding this letter please telephone 1300 133 455

This letter was issued on: 14/03/2016

General Manager



SEWER DRAINAGE DIAGRAM 47493

Lot 2 Sec. D.P. DP834709

Address KENROSE ST 28 Town FORSTER

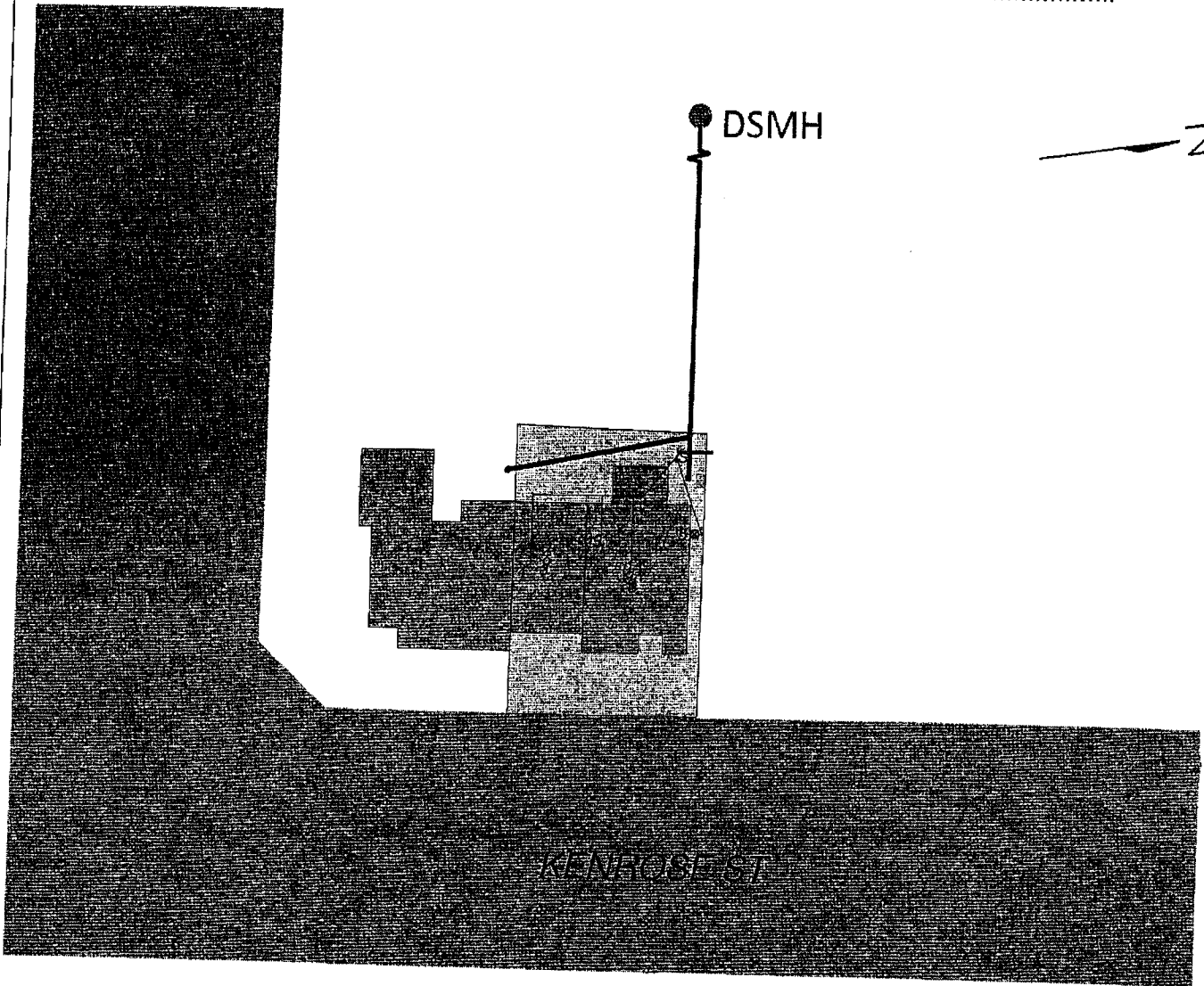

This plan is a schematic representation of data produced by a Geographical Information System (GIS) exclusively for MidCoast Water, but may also be used by clients/customers to assist with the identification and provision of services subject to terms and conditions. No responsibility is accepted for the accuracy of the map or the data that it contains.

Any person relying on this map must read and fully comprehend the terms, conditions and legal obligations, available at www.midcoastwater.com.au

LEGEND

Scale: 1:500

JUNCTION LOCATION

- W.C..... 1
- Bath..... 2
- Basin..... 3
- Shower..... 4
- K.Sink..... 5
- Tubs..... 6
- Gully..... 7
- Vent..... 8
- Floor Waste.... 9
- Soil Vent Pipe...SVP
- Waste Stack.....WS
- Inspect. Shaft...IS
- Reflux Valve.....RV
- Tap Over.....TO
- Grease Arrestor..GA
- Urinal.....UR
- Low Level Vent..LLV
- Sewer Direction.. >

-Manhole
- Inspection opening
- Assumed location of existing sewer
- ☒Surcharge Gully

Sewer Junction..... 303802
 existing at..... 21.10metres
 from D.S.M.H.....(d=.....m)
 Depth of Junction approx.....m
 Depth of Riser approx.....m