

reyproperties.com.au

 02 8750 8609

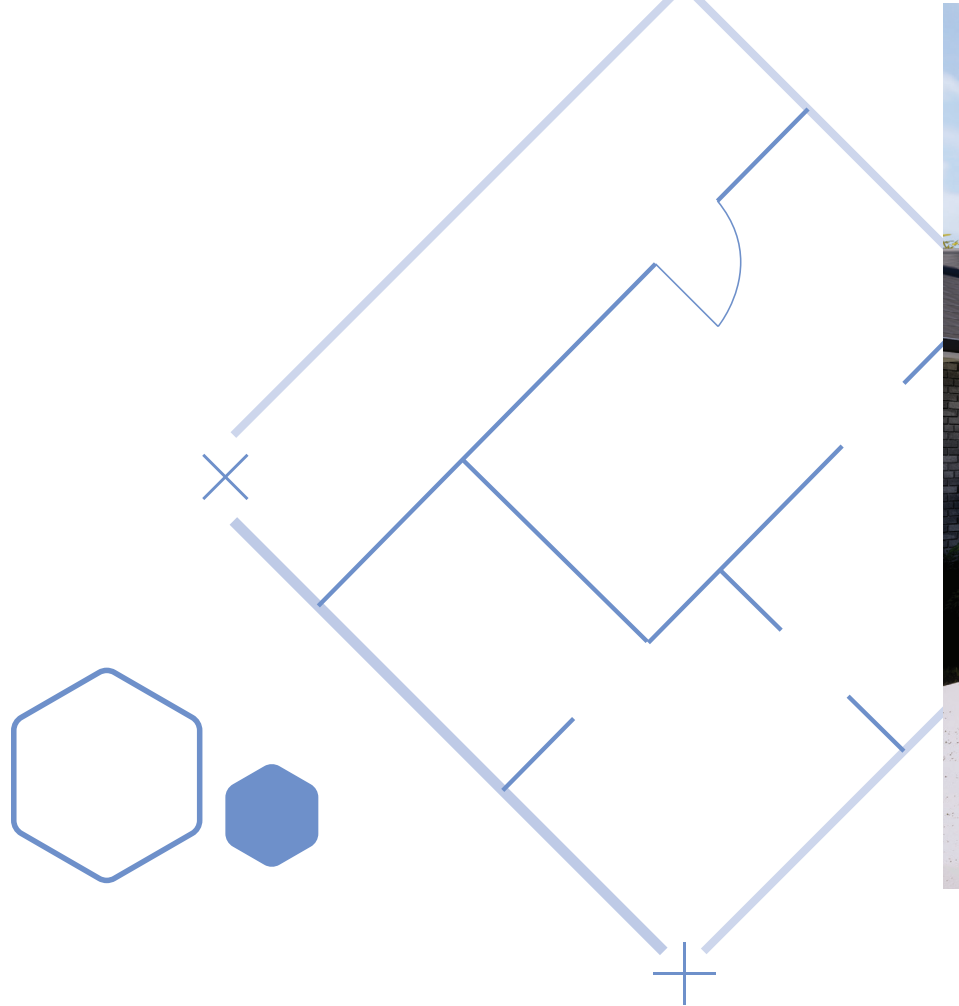

Rey Properties Turnkey Inclusions Packages is upgraded inclusions that is custom made by our special team for the customer satisfactions. We provide everything you need to convert your house into a beautiful home that's ready for you to move in and enjoy.



PRELIMINARY BUILDING ITEMS

- Drafting of house plans
- Energy efficiency report BASIX
- Soil test report by developer
- Engineer designed slab and footing
- Complying development approval
- Retaining walls (where specified)
- Home warranty insurance
- Builder's public liability insurance
- Professional cleaning prior to occupation

SITE PREPARATION AND CONSTRUCTION

- Excavation work
- Footings and piers where applicable- piers up to 80 L/M
- Concrete slab- H1 slab
- 1m slope / drop edge beam where required

TERMITE PROTECTION

- Exposed slab edge for visual perimeter inspection
- Collars fitted to slab penetrations
- All works compliant with Australian Standards





EXTERNAL

ENTRANCE

- ① 1200mm Width x 2400mm Height featured molded entrance door
- ② Floor tiles with skirting tiles to porch
- ③ Light in portico ceiling
- ④ Two coat satin enamel paint finish to front entrance door

LANDSCAPING

- ⑤ Turf laid to front and rear of house
- ⑥ Coloured seal concrete driveway
- ⑥ Floor tiles with skirting tiles to alfresco
- ⑦ Letterbox with numerals in accordance with council guidelines
- ⑧ Wall mounted clothes line

KITCHEN

RANGEHOOD
Westinghouse 900mm
Canopy Rangehood



OVEN
Westinghouse Electric
fan forced/ Gas
900mm



COOKTOP
Westinghouse
Electric/Gas 900mm

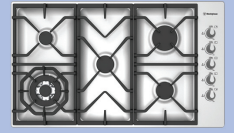

DISHWASHER
Westinghouse Stainless
steel



TAP WARE
Chrome mixer tap
builder range



- ① 40mm stone benchtop with waterfall
- ② Polyurethane/ Laminated kitchen doors with/without handles
(Choice of colour available)
- ③ Seamless Overhead Cabinets
- ④ Tile/glass splash back as per client's choice

- Stainless steel undermount kitchen sink
- Cold water and electrical provisions for dishwasher / Refrigerator



BEDROOMS

- ✓ Carpet/Laminated timber to all bedrooms, from builder's range
- ✓ Vinyl/Mirror sliding doors to robes
- ✓ Hanging rail to all robes
- ✓ One fixed robe shelf at 1800mm AFFL/ walking robe in master bedroom
- ✓ Oyster light to all bedrooms/ ducted air conditioning outlet in each bedroom

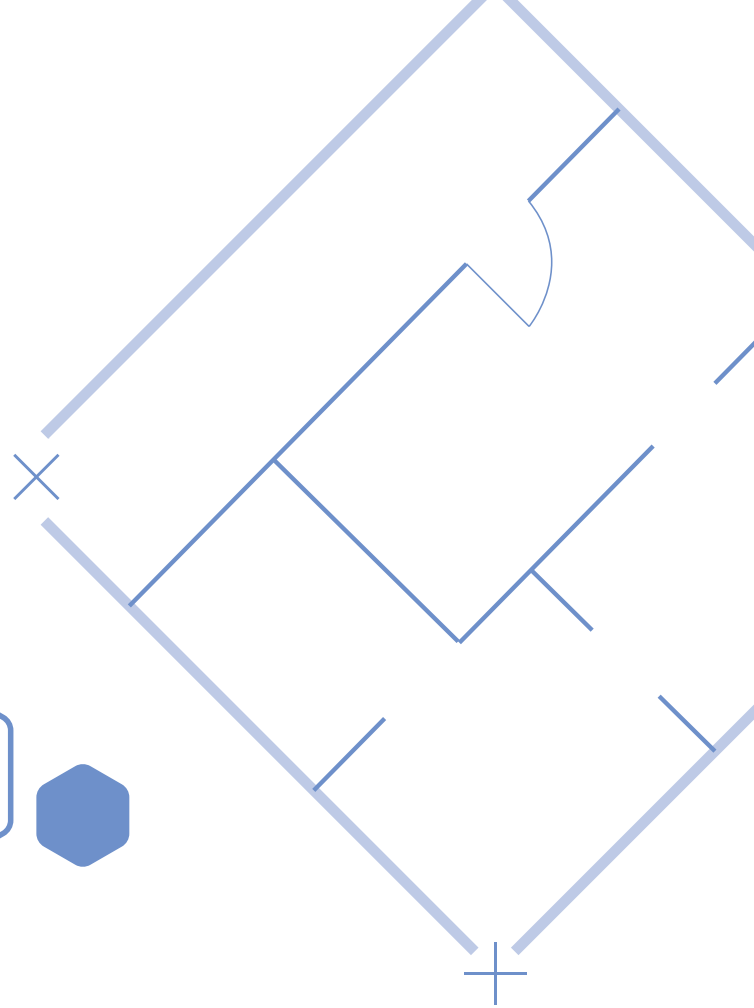
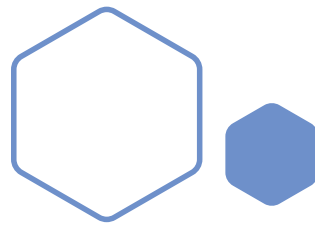

WC

- ✓ Tiled floor and skirting tile from builder's range
- ✓ Ceramic dual flush toilet suite
- ✓ Toilet roll holder from builder's range
- ✓ Smart Chrome over brass
- ✓ Hand washing basin subject to design

LAUNDRY

- ✓ Washing machine taps
- ✓ Laundry cabinet with stone benchtop
- ✓ Overhead cupboard (subject to design)
- ✓ Tub mixer tap
- ✓ Tiled floor and skirting tile
- ✓ Tiling behind tub from builder's range, up to 400mm high
- ✓ Smart Chrome floor waste
- ✓ 45L stainless steel laundry tub with cabinet underneath. ▼



BATHROOM



- ① Tiled floor and skirting tile from client's choice from builder's range
- ② 20mm stone benchtop on top of vanity
- ③ Up to 1200mm vanity as per plan
- ④ Shower and bath tap ware set
- ⑤ Semi frameless / Frameless shower screens with clear safety glass
- ⑥ Tiled shower floor
- ⑦ Ceiling height tile to entire bathroom

- ☑ White acrylic bathtub (upto 1700mm subject to design)
- ☑ Upto 2 shower niche subject to design
- ☑ Framed / Frameless mirror above vanity (width of vanity)
- ☑ Basin tap ware set
- ☑ Waste grate – Smart chrome over brass
- ☑ Double towel rail from builder's range
- ☑ Combined fan, light & heater unit to bathroom

ENSUITE

- ① Tiled floor and skirting tile from client's choice from builder's range
- ② 20mm stone benchtop on top of vanity
- ③ Up to 1200mm vanity with melamine doors and panel; handles from builder's range
- ④ Shower and bath tap ware set
- ⑤ Semi frameless / Frameless shower screens with clear safety glass
- ⑥ Tiled shower floor
- ⑦ Ceiling height tile to entire bathroom
Bath tiled to side and around top edge

- ☑ Frame/ Frameless mirror above vanity (width of vanity)
- ☑ Waste grate- Smart chrome over brass
- ☑ Towel rail from builder's range
- ☑ Combined fan, light & heater unit to ensuite
- ☑ Ceramic dual flush toilet suite
- ☑ Video intercom
- ☑ Toilet roll holder

GENERAL INTERNAL CONSTRUCTION

- ① MDF Pine HandRail with metal balustrade
 - ② 2.7 Ceiling heights on both floors
 - ③ Tiles / Floating timber floor to hallway, living areas and kitchen
- ✓ Upto 4 zone ducted air conditioning with two controllers for double story
 - ✓ Sliding powder coated aluminium windows with clear glass (obscured glass in bathroom, ensuite and WC)
 - ✓ Sliding powder coated aluminium doors, if applicable, with clear safety glass
 - ✓ Standard fly screens on all windows
 - ✓ Ceiling and wall insulations as per BASIX
 - ✓ Slim finish switch plates
 - ✓ Separate safety switches for lights and power in meter board
 - ✓ Earth leakage protection
 - ✓ Underground three-phase mains power supply from service point to meter box
 - ✓ Underground telephone line from service point to house
 - ✓ 3X double power points/4 down lights - Master bedroom
 - ✓ 2X double power point - all other bedrooms
 - ✓ 2X television point
 - ✓ 2X telephone point
 - ✓ 1X NBN access point (if applicable)
 - ✓ Vertical blinds to front windows
 - ✓ Linen cupboard with four fixed shelves and sliding doors
 - ✓ Door furniture to be selected from builder's range
 - ✓ Flush redicote internal doors
 - ✓ Privacy sets to bathroom, ensuite and WC
 - ✓ 30 downlights for double story and 20 downlights for single story
 - ✓ Passage sets to remainder of internal doors
 - ✓ Smoke detectors as required
 - ✓ Manhole into roof space
 - ✓ Up to 13mm plasterboard to wall and ceiling
 - ✓ Up to 13mm wet area plasterboard to laundry, bathroom, ensuite and WC walls
 - ✓ Up to 3 layer cornice to all open area
 - Featured wall in Master bedroom and living room (one wall each)
 - ✓ 67mm x 12mm single bevel skirting's
 - ✓ 42mm x 12mm single bevel architraves
 - ✓ Internal paint finishes: three coats low sheen to walls (one colour throughout); two coats to ceilings and cornices (white); three coats semi-gloss enamel to doors, skirting's and architraves (one colour throughout)



GENERAL EXTERNAL CONSTRUCTION

- Brick veneer construction (face bricks, from builder's range)
- Brick on edge sills
- Fibre cement linings to eaves (450mm overhang where applicable)
- Fibre cement ceiling to portico and alfresco areas
- Colour Bond/Tiles roof at required pitch
- Sarking installed to underside of roof sheets
- Colour Bond fascia and guttering
- Rainwater tank as per council requirements
- 90mm PVC downpipes painted to match house
- Sewer drains connected to mains
- Storm water drains connected to rainwater tank / kerb as applicable
- Mains water supply connection
- Hot water system - gas instantaneous
- External paint finishes: two coats acrylic to all exposed timbers, gable cladding, posts and shoes, eaves and timber windows (where applicable)
- 1x External gas point and 1 all weather power point in alfresco
- Digital ready TV aerial
- Remote control Panel Lift garage doors with two remote controllers
- Up to 2 external tap per residence

