

reyproperties.com.au

 02 8750 8609



Rey Properties Turnkey Inclusions Packages is upgraded inclusions that is custom made by our special team for the customer satisfactions. We provide everything you need to convert your house into a beautiful home that's ready for you to move in and enjoy.

LUXURY SPECIFICATIONS AND INCLUSIONS FOR TURNKEY PROJECT

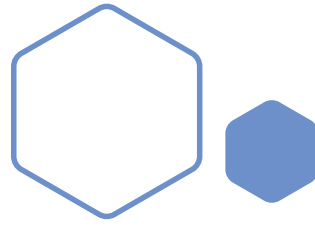

PRELIMINARY BUILDING ITEMS

- Drafting of house plans
- Energy efficiency report BASIX
- Soil test report by developer
- Engineer designed slab and footing
- Complying development approval
- Home warranty insurance
- Builders public liability insurance
- Professional cleaning prior to occupation

SITE PREPARATION AND CONSTRUCTION

- Excavation work
- Footings and piers where applicable- piers up to 80 L/M
- Concrete slab- H1 slab
- 1m slope / drop edge beam where required

TERMITE PROTECTION

- Exposed slab edge for visual perimeter inspection
- Collars fitted to slab penetrations
- All works compliant with Australian Standards





EXTERNAL

ENTRANCE

- ① 1200mm Width x 2400mm Height featured moulded entrance door
- ② Floor tiles with skirting tiles to porch
- ③ Light in portico ceiling
- Two coat satin enamel paint finish to front entrance door

HOME SYSTEM

- ④ Video Intercom
- Bosch Alarm System (upto 4 sensors)



LANDSCAPING

- ⑤ Turf laid to front and rear of the house
- ⑥ Coloured seal concrete driveway
- ⑦ Letterbox with numerals in accordance with council guidelines

KITCHEN

RANGEHOOD
Westinghouse 900mm
Canopy Rangehood



OVEN
Westinghouse Electric
fan forced/Gas 900mm



COOKTOP
Westinghouse
Electric/Gas 900mm



DISHWASHER
Westinghouse Stainless
steel



TAP WARE
Chrome mixer top
builder range



- ① 40mm stone benchtop with waterfall
- ② Polyurethane / Laminated kitchen doors with/without handles
(Choice of colour available)
- ③ Seamless Overhead Cabinets
- ④ Stainless steel undermount kitchen sink
- ⑤ Walk-in pantry as per plan
- ⑥ Tile/glass splash back as per client's choice
- Cold water and electrical provisions for dishwasher / Refrigerator



BATHROOM



- ① Tiled floor and skirting tile from builders range
- ② Ceiling height tile to entire bathroom
- ③ Up to 1200mm vanity with melamine doors and panel; handles from builders range
- ④ 20mm stone benchtop on top of vanity
- ⑤ Framed / Frameless mirror above vanity (width of vanity)
- ⑥ Semi frameless / frameless shower screens with clear safety glass
- ⑦ Waste grate - Smart chrome over brass
- ⑧ White acrylic bathtub (up to 1700mm subject to design)

- Upto 2 shower niche subject to design
- Combined fan, light & heater unit to bathroom
- Shower and bath tap ware set
- Basin tap ware set
- Double towel rail from builders range
- Toilet roll holder
- Ceramic dual flush toilet suite / soft close seat



ENSUITE



- ① Tiled floor and skirting tile from builder's range
- ② Ceiling height tile to entire bathroom
- ③ Up to 1200mm vanity with melamine doors and panel; handles from builders range
- ④ 20mm stone benchtop on top of vanity
- ⑤ Framed / Frameless mirror above vanity (width of vanity)
- ⑥ Semi frameless / frameless shower screens with clear safety glass
- ⑦ Waste grate - Smart chrome over brass
- ⑧ Combined fan, light & heater unit to bathroom

- Shower and bath tap ware set
- Basin tap ware set
- Double towel rail from builder's range
- Toilet roll holder
- Ceramic dual flush toilet suite / soft close seat



BEDROOMS

- ✓ Carpet/Laminated timber to all bedrooms, from builder's range
- ✓ Vinyl/Mirror sliding doors to robes
- ✓ Hanging rail to all robes
- ✓ One fixed robe shelf at 1800mm AFFL/ walking robe in master bedroom
- ✓ Oyster light to all bedrooms/ ducted air conditioning outlet in each bedroom

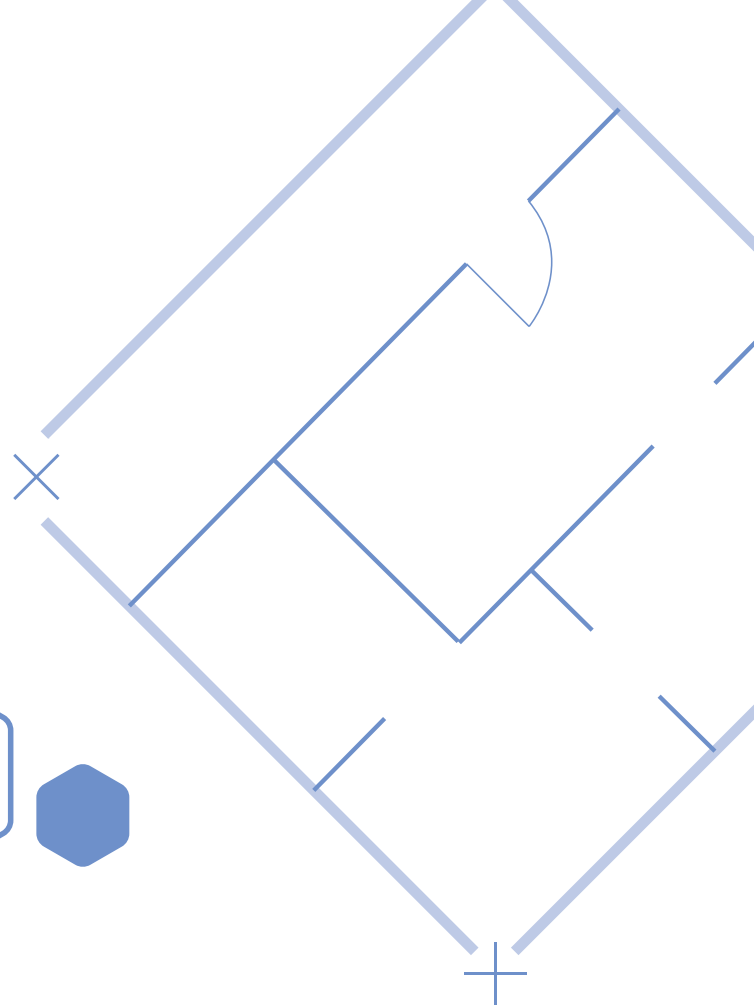
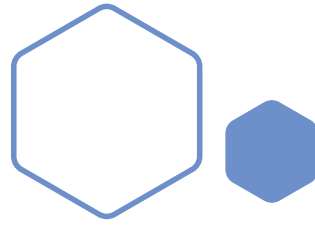

WC

- ✓ Tiled floor and skirting tile from builder's range
- ✓ Ceramic dual flush toilet suite
- ✓ Toilet roll holder from builder's range
- ✓ Hand washing basin subject to design

LAUNDRY

- ✓ Washing machine taps
- ✓ Laundry cabinet with stone benchtop
- ✓ Overhead cupboard (subject to design)
- ✓ Tub mixer tap
- ✓ Tiled floor and skirting tile
- ✓ Tiling behind tub from builder's range, up to 400mm high
- ✓ Smart Chrome floor waste



GENERAL INTERNAL CONSTRUCTION

- ① Up to 4 zone ducted air conditioning with two controllers for double story
 - ② MDF Pine HandRail with metal balustrade
 - ③ 2.7 Ceiling heights on both floors
 - ④ Tiles / Floating timber floor to hallway, living areas and kitchen
- ☑ Sliding powder coated aluminium windows with clear glass (obscured glass in bathroom, ensuite and WC)
 - ☑ Sliding powder coated aluminium doors, if applicable, with clear safety glass
 - ☑ Standard fly screens on all windows
 - ☑ Slim finish switch plates
 - ☑ Separate safety switches for lights and power in meter board
 - ☑ Earth leakage protection
 - ☑ Underground three-phase mains power supply from service point to meter box
 - ☑ Underground telephone line from service point to house
 - ☑ 3X double power points - main bedroom
 - ☑ 2X double power point - all other bedrooms
 - ☑ 2X television point
 - ☑ 2X telephone point
 - ☑ 1X NBN access point (if applicable)
 - ☑ Tiles / Floating timber floor to hallway, living areas and kitchen
 - ☑ Vertical blinds to front windows
 - ☑ Linen cupboard with four fixed shelves and sliding doors
 - ☑ Door furniture to be selected from builder's range
 - ☑ Flush redicote internal doors
 - ☑ Privacy sets to bathroom, ensuite and WC
 - ☑ 30 downlights for double story and 20 downlights for single story
 - ☑ Passage sets to remainder of internal doors
 - ☑ Smoke detectors as required
 - ☑ Manhole into roof space
 - ☑ Up to 13mm plasterboard to wall and ceiling
 - ☑ Up to 13mm wet area plasterboard to laundry, bathroom, ensuite and WC walls
 - ☑ Up to 3 layer cornice to all open area
 - ☑ Featured wall in Master bedroom and living room (one wall each)
 - ☑ 67mm x 12mm single bevel skirting
 - ☑ 42mm x 12mm single bevel architraves
 - ☑ Internal paint finishes: three coats low sheen to walls (one colour throughout); two coats to ceilings and cornices (white); three coats semi-gloss enamel to doors, skirting's and architraves (one colour throughout)



GENERAL EXTERNAL CONSTRUCTION



- ☑ Brick veneer construction (face bricks, from builder's range)
- ☑ Brick on edge sills
- ☑ Fibre cement linings to eaves (450mm overhang where applicable)
- ☑ Fibre cement ceiling to portico and alfresco areas
- ☑ Colorbond/Tiles roof at required pitch
- ☑ Sarking installed to underside of roof sheets
- ☑ Colorbond fascia and guttering
- ☑ Rainwater tank as per council requirements
- ☑ 90mm PVC downpipes painted to match house
- ☑ Sewer drains connected to mains
- ☑ Storm water drains connected to rainwater tank / kerb as applicable
- ☑ Mains water supply connection
- ☑ Hot water system - gas instantaneous
- ☑ External paint finishes: two coats acrylic to all exposed timbers, gable cladding, posts and shoes, eaves and timber windows (where applicable)
- ☑ 1 External gas point and 1 all weather power point in alfresco
- ☑ Remote control Panel Lift garage doors with two remote controllers
- ☑ Up to 2 external tap per residence
- ☑ Wall mounted clothesline

