

FORM 1

STRATA PLAN 32229

HELD BY LANDGATE
IN DIGITAL FORM ONLY.

STRATA/SURVEY STRATA PLAN

LIMITED TO A DEPTH OF 12.19 METRES, BUT SUBJECT TO CERTAIN
MINERAL AND OTHER RESERVATIONS AS SET OUT IN TRANSFER D850304



LOCATION PLAN

(SCALE 1:300)

PT LOC 5297



A44362
12570

STRATA/SURVEY	
STRATA PLAN	3 2 2 2 9
SHEET	1 OF 1 SHEETS
MANAGEMENT STATEMENT	<input type="checkbox"/> YES <input checked="" type="checkbox"/> NO
Logged	12.12.96 146630
Examined	12.12.96 JTH
Registered	12.12.96 App G.349030
 REGISTRAR OF TITLES WESTERN AUSTRALIAN PLANNING COMMISSION Certificate of Approval of W.A.P.C. under Section 25(1) or 25B(2) of Strata Titles Act 1985.	
FOR CHAIRMAN	DATE 26-11-96
PLAN OF PT OF SWAN LOCATION 5297 AND BEING LOT 301 ON DIAGRAM 90250.	
CERT OF TITLE	VOL: 2064 FOL: 285
LOCAL GOVERNMENT	TOWN OF EAST FREMANTLE.
INDEX PLAN	B634 (2) 07.16, 08.16
FIELD BOOK NUMBER	
SCALE	1:300
NAME OF SCHEME	LEEWIN COVE
ADDRESS OF PARCEL	97 PRESTON POINT ROAD, EAST FREMANTLE, W.A. 6157.
 DOLA Department of LAND ADMINISTRATION	

WARNING: CREASING OR FOLDING WILL LEAD TO REJECTION

STRATA SURVEY

STRATA PLAN 32229

SHEET 4 OF 4 SHEETS

FLOOR PLAN - LEVEL 4

(SCALE 1:300)

SEE SHEETS 2 AND 3 OF 4 FOR REMAINDER OF LOTS 1-4 INCL.

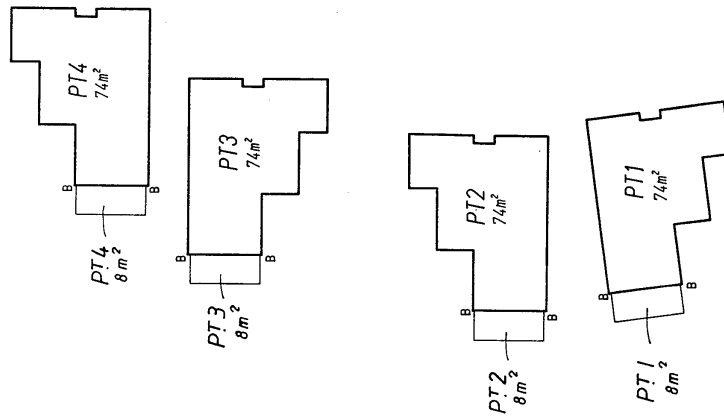

BOUNDARIES B-B ARE DEFINED BY THE EXTERNAL SURFACE OF THE TILED EDGE OF THE CONCRETE BALCONY.

EXTERNAL SURFACES OF THE BUILDINGS ARE THE BOUNDARIES OF THE PART LOTS COMPRISING THE BUILDINGS.

THE STRATA OF THE PART LOTS COMPRISING THE BALCONIES ON THIS SHEET ARE LIMITED TO BETWEEN THE UNDER SURFACE OF THE RESPECTIVE CONCRETE BALCONY FLOOR AND THE EXTERNAL SURFACE OF THE ROOF ABOVE IT.

WARNING: CREASING OR FOLDING WILL LEAD TO REJECTION

Cor 2258 / 1992 Vol 9 p 32

STRATA SURVEY
 STRATA PLAN 32229
 SHEET 3 OF 4 SHEETS

FLOOR PLAN - LEVEL 3

(SCALE 1:300)

SEE SHEETS 2 AND 3 OF 4 FOR REMAINDER OF LOTS 1-4 INCL.

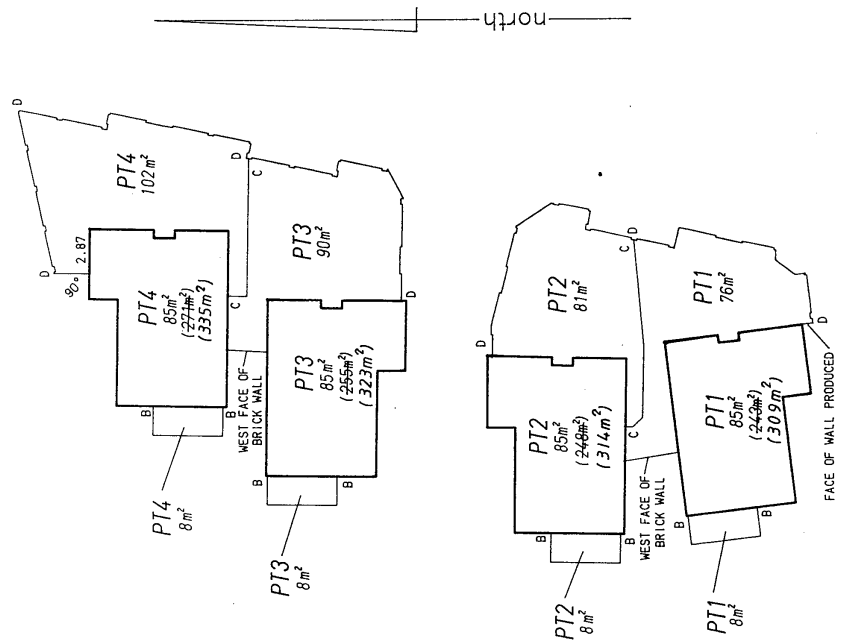

BOUNDARIES B-B ARE DEFINED BY THE EXTERNAL SURFACE OF THE TILED EDGE OF THE CONCRETE BALCONY.
 BOUNDARIES C-C ARE DEFINED BY THE CENTRE OF THE DIVIDING BRICK WALLS.
 BOUNDARIES D-D ARE DEFINED BY THE INTERNAL SURFACE OF THE PERIMETER BRICK WALLS.

EXTERNAL SURFACES OF THE BUILDINGS ARE THE BOUNDARIES OF THE PART LOTS COMPRISING THE BUILDINGS.

THE STRATA OF THE PART LOTS COMPRISING THE BALCONIES ON THIS SHEET ARE LIMITED TO BETWEEN THE UNDER SURFACE OF THE RESPECTIVE CONCRETE BALCONY FLOOR AND THE UNDER SURFACE OF THE CONCRETE BALCONY ABOVE.

THE STRATA OF THE REMAINING PART LOTS ON THIS SHEET EXTERNAL TO THE BUILDINGS ARE LIMITED TO BETWEEN 3 METRES BELOW AND 4 METRES ABOVE THE UPPER SURFACE OF THE FLOOR OF THE RESPECTIVE ADJOINING PART LOT COMPRISING THE BUILDING.

WARNING: CREASING OR FOLDING WILL LEAD TO REJECTION

Cor 2258/1992 Vol 9 p 32

STRATA SURVEY —
 STRATA PLAN 32229
 SHEET 2 OF 4 SHEETS

FLOOR PLAN — LEVEL 2

(SCALE 1:300)

SEE SHEET 1 OF 4 FOR REMAINDER OF LOTS 5, 6 AND 7.
SEE SHEETS 3 AND 4 OF 4 FOR REMAINDER OF LOTS 1-4 INCL.

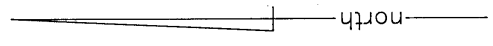
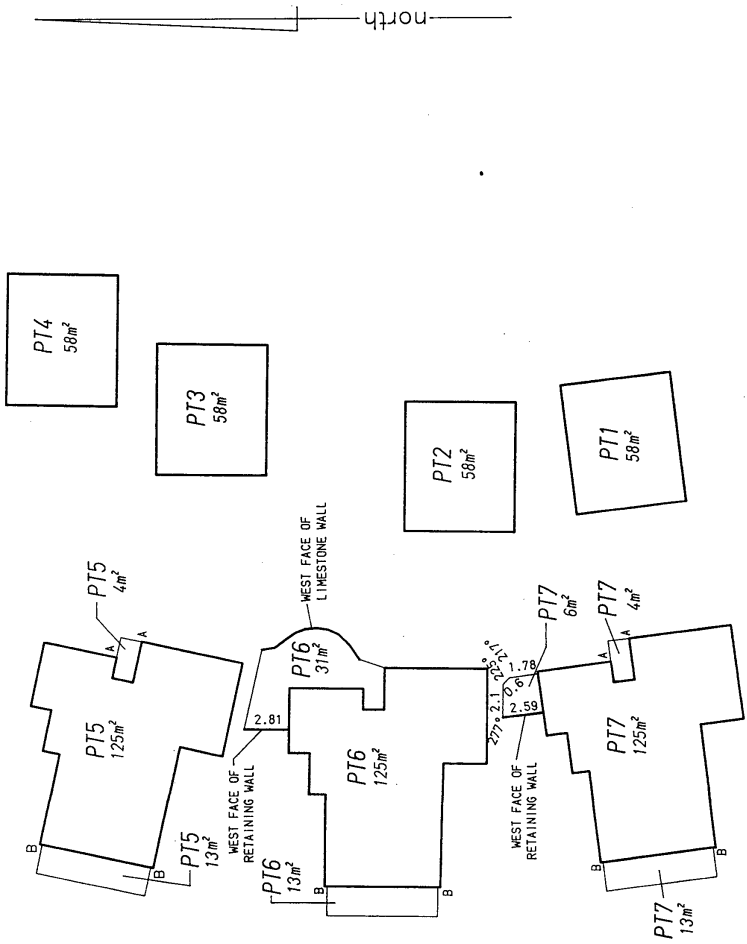

BOUNDARIES A-A ARE DEFINED BY THE PRODUCTION OF THE BUILDING WALLS TO A POINT OF INTERSECTION.

BOUNDARIES B-B ARE DEFINED BY THE EXTERNAL SURFACE OF THE TILED EDGE OF THE CONCRETE BALCONY.

EXTERNAL SURFACES OF THE BUILDINGS ARE THE BOUNDARIES OF THE PART LOTS COMPRISING THE BUILDINGS.

THE STRATA OF THE PART LOTS COMPRISING THE BALCONIES ON THIS SHEET ARE LIMITED TO BETWEEN THE UNDER SURFACE OF THE RESPECTIVE CONCRETE BALCONY FLOOR AND THE EXTERNAL SURFACE OF THE ROOF ABOVE IT.

THE STRATA OF THE REMAINING PART LOTS ON THIS SHEET EXTERNAL TO THE BUILDINGS ARE LIMITED TO BETWEEN 3 METRES BELOW AND 4 METRES ABOVE THE UPPER SURFACE OF THE FLOOR OF THE RESPECTIVE ADJOINING PART LOT COMPRISING THE BUILDING.

WARNING: CREASING OR FOLDING WILL LEAD TO REJECTION

STRATA SURVEY
STRATA PLAN 32229
 SHEET 1 OF 4 SHEETS

FLOOR PLAN - LEVEL 1

(SCALE 1:300)

SEE SHEET 2 FOR REMAINDER OF LOTS 5, 6 AND 7.

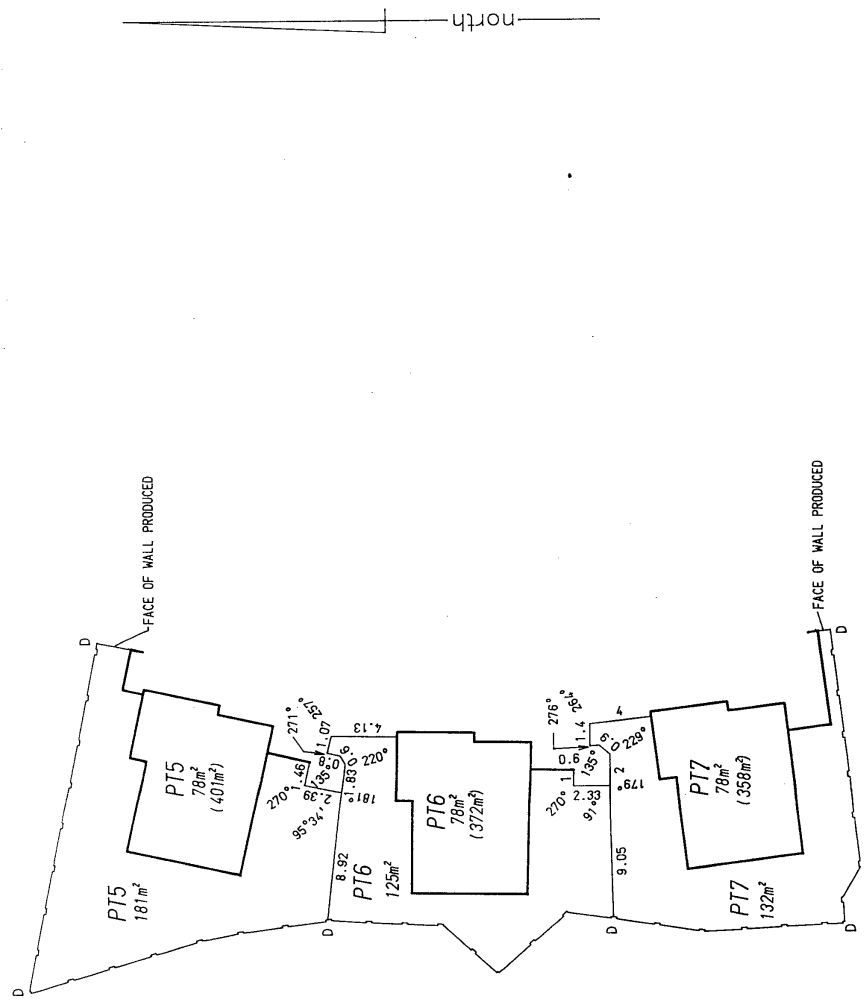

BOUNDARIES D-D ARE DEFINED BY THE INTERNAL SURFACE OF THE PERIMETER BRICK WALLS.

EXTERNAL SURFACES OF THE BUILDINGS ARE THE BOUNDARIES OF THE PART LOTS COMPRISING THE BUILDINGS.

THE STRATA OF THE PART LOTS ON THIS SHEET EXTERNAL TO BUILDINGS ARE LIMITED TO BETWEEN 3 METRES BELOW AND 7 METRES ABOVE THE UPPER SURFACE OF THE FLOOR OF THE RESPECTIVE ADJOINING PART LOT COMPRISING THE BUILDING.

WARNING: CREASING OR FOLDING WILL LEAD TO REJECTION

FORM 5

STRATA PLAN No. 32229

DESCRIPTION OF PARCEL & BUILDING

PARCEL: PT SWAN LOC 5297 AND BEING LOT 301 ON DIAGRAM 90250
BUILDING: 7 MULTI STOREY DOUBLE BRICK AND TILE RESIDENTIAL HOME UNITS.

CERTIFICATE OF SURVEYOR

I, PAUL ROBERT LENGKEEK, being a licensed surveyor registered under the Licensed Surveyors Act 1909, certify that in respect of the strata plan which relates to the parcel and building described above (in this certificate called "the plan"):-

- (a) each lot that is not wholly within a building shown on the plan is within the external surface boundaries of the parcel; and either
(b) each building shown on the plan is within the external surface boundaries of the parcel; or
(c) in a case where a part of a wall or building, or material attached to a wall or building, encroaches beyond the external surface boundaries of the parcel -
(i) all lots shown on the plan are within the external surface boundaries of the parcel;
(ii) the plan clearly indicates the existence of the encroachment and it's nature and extent; and
(iii) where the encroachment is not on to a public road, street or way, that an appropriate easement has been granted and will be lodged with the Registrar of Titles to enable it to be registered as an appurtenance of the parcel; and
*(d) if the plan is a plan of re-subdivision, it complies with Schedule 1 by-law(s) No(s) on Strata Plan No registered in respect of (name of scheme) or sufficiently complies with that/those by-law(s) in a way that is allowed by regulation 36 of the Strata Titles General Regulations 1996.

9.8.96
Date

Paul Robert Lengkeek
Licensed Surveyor

* Delete if inapplicable

FORM 7

STRATA PLAN No. 32229

DESCRIPTION OF PARCEL & BUILDING

PARCEL: PT SWAN LOC 5297 AND BEING LOT 301 ON DIAGRAM 90250
BUILDING: 7 MULTI STOREY DOUBLE BRICK AND TILE RESIDENTIAL HOME UNITS.

CERTIFICATE OF LOCAL GOVERNMENT

..... TOWN OF EAST FREMANTLE, the local government hereby certifies that in respect of the strata plan which relates to the parcel and building described above (in this certificate called "the plan"):-

- (1) (a) the building and the parcel shown on the plan have been inspected and that it is consistent with the approved building plans and specifications in respect of the building; or
- (b) the building has been inspected and the modification is consistent with the approved building plans and specifications relating to the modification;
- (2) the building, in the opinion of the local government, is of sufficient standard to be brought under the *Strata Titles Act 1985*;
- ~~(3) where a part of a wall or building or material attached to a wall or building, encroaches beyond the external surface boundaries of the parcel on to a public road, street or way the local government is of the opinion that retention of the encroachment in its existing state will not endanger public safety or unreasonably interfere with the amenity of the neighbourhood and the local government does not object to the encroachment; and~~
- (4) (a) any conditions imposed by the Western Australian Planning Commission have been complied with; or
- ~~(b) the within strata scheme is exempt from the requirement of approval by the Western Australian Planning Commission.~~

..... 23 October, 1996

Date

.....
Chair/Town Clerk

Delete if inapplicable

