

SECTION 66W CERTIFICATE

I,
of _____,
certify as follows:

1. I am a _____ currently admitted to
practise in New South Wales.
2. I am giving this Certificate in accordance with Section 66W of the Conveyancing Act 1919 with
reference to a contract for the sale of property at 5/22 Hercules Road, Brighton Le Sands NSW
2216, from **Kerrie Anne Doyle**
to _____
in order that there is no cooling off period in
relation to that Contract.
3. I do not act for **Kerrie Anne Doyle** and am not employed in the legal practice of a solicitor acting
for **Kerrie Anne Doyle** nor am I a member or employee of a firm of which a Solicitor acting for
Kerrie Anne Doyle is a member or employee.
4. I have explained
to _____ :
 - (a) The effect of the Contract for the purchase of that property;
 - (b) The nature of this Certificate; and
 - (c) The effect of giving this Certificate to the vendor, i.e. that there is no cooling off period
in relation to the Contract.

Dated: _____

IMPORTANT NOTICE TO VENDORS AND PURCHASERS

Before signing this contract you should ensure that you understand your rights and obligations, some of which are not written in this contract but are implied by law.

WARNING—SMOKE ALARMS

The owners of certain types of buildings and strata lots must have smoke alarms (or in certain cases heat alarms) installed in the building or lot in accordance with regulations under the *Environmental Planning and Assessment Act 1979*. It is an offence not to comply. It is also an offence to remove or interfere with a smoke alarm or heat alarm. Penalties apply.

WARNING—LOOSE-FILL ASBESTOS INSULATION

Before purchasing land that includes any residential premises (within the meaning of Division 1A of Part 8 of the *Home Building Act 1989*) built before 1985, a purchaser is strongly advised to consider the possibility that the premises may contain loose-fill asbestos insulation (within the meaning of Division 1A of Part 8 of the *Home Building Act 1989*). In particular, a purchaser should:

- (a) search the Register required to be maintained under Division 1A of Part 8 of the *Home Building Act 1989*, and
- (b) ask the relevant local council whether it holds any records showing that the residential premises contain loose-fill asbestos insulation.

For further information about loose-fill asbestos insulation (including areas in which residential premises have been identified as containing loose-fill asbestos insulation), contact NSW Fair Trading.

COOLING OFF PERIOD (PURCHASER'S RIGHTS)

1. This is the statement required by section 66X of the *Conveyancing Act 1919* and applies to a contract for the sale of residential property.
2. **EXCEPT** in the circumstances listed in paragraph 3, the purchaser may rescind the contract at any time before 5 pm on—
 - (a) the tenth business day after the day on which the contract was made—in the case of an off the plan contract, or
 - (b) the fifth business day after the day on which the contract was made—in any other case.
3. **There is NO COOLING OFF PERIOD:**
 - (a) if, at or before the time the contract is made, the purchaser gives to the vendor (or the vendor's solicitor or agent) a certificate that complies with section 66W of the Act, or
 - (b) if the property is sold by public auction, or
 - (c) if the contract is made on the same day as the property was offered for sale by public auction but passed in, or
 - (d) if the contract is made in consequence of the exercise of an option to purchase the property, other than an option that is void under section 66ZG of the Act.
4. A purchaser exercising the right to cool off by rescinding the contract will forfeit to the vendor 0.25% of the purchase price of the property. The vendor is entitled to recover the amount forfeited from any amount paid by the purchaser as a deposit under the contract and the purchaser is entitled to a refund of any balance.

DISPUTES

If you get into a dispute with the other party, the Law Society and Real Estate Institute encourage you to use informal procedures such as negotiation, independent expert appraisal, the Law Society Conveyancing Dispute Resolution Scheme or mediation (for example mediation under the Law Society Mediation Program).

AUCTIONS

Regulations made under the Property, Stock and Business Agents Act 2002 prescribe a number of conditions applying to sales by auction.

WARNINGS

1. Various Acts of Parliament and other matters can affect the rights of the parties to this contract. Some important matters are actions, claims, decisions, licences, notices, orders, proposals or rights of way involving:

APA Group Australian Taxation Office Council County Council Department of Planning, Industry and Environment Department of Primary Industries Electricity and gas Land & Housing Corporation Local Land Services	NSW Department of Education NSW Fair Trading Owner of adjoining land Privacy Public Works Advisory Subsidence Advisory NSW Telecommunications Transport for NSW Water, sewerage or drainage authority
---	--

If you think that any of these matters affects the property, tell your solicitor.
2. A lease may be affected by the Agricultural Tenancies Act 1990, the Residential Tenancies Act 2010 or the Retail Leases Act 1994.
3. If any purchase money is owing to the Crown, it will become payable before obtaining consent, or if no consent is needed, when the transfer is registered.
4. If a consent to transfer is required under legislation, see clause 27 as to the obligations of the parties.
5. The vendor should continue the vendor's insurance until completion. If the vendor wants to give the purchaser possession before completion, the vendor should first ask the insurer to confirm this will not affect the insurance.
6. The purchaser will usually have to pay transfer duty (and sometimes surcharge purchaser duty) on this contract. If duty is not paid on time, a purchaser may incur penalties.
7. If the purchaser agrees to the release of deposit, the purchaser's right to recover the deposit may stand behind the rights of others (for example the vendor's mortgagee).
8. The purchaser should arrange insurance as appropriate.
9. Some transactions involving personal property may be affected by the Personal Property Securities Act 2009.
10. A purchaser should be satisfied that finance will be available at the time of completing the purchase.
11. Where the market value of the property is at or above a legislated amount, the purchaser may have to comply with a foreign resident capital gains withholding payment obligation (even if the vendor is not a foreign resident). If so, this will affect the amount available to the vendor on completion.
12. Purchasers of some residential properties may have to withhold part of the purchase price to be credited towards the GST liability of the vendor. If so, this will also affect the amount available to the vendor. More information is available from the ATO.

The vendor sells and the purchaser buys the *property* for the price under these provisions instead of Schedule 3 Conveyancing Act 1919, subject to any *legislation* that cannot be excluded.

1 Definitions (a term in *italics* is a defined term)

In this contract, these terms (in any form) mean –

<i>adjustment date</i>	the earlier of the giving of possession to the purchaser or completion;
<i>bank</i>	the Reserve Bank of Australia or an authorised deposit-taking institution which is a bank, a building society or a credit union;
<i>business day</i>	any day except a bank or public holiday throughout NSW or a Saturday or Sunday;
<i>cheque</i>	a cheque that is not postdated or stale;
<i>clearance certificate</i>	a certificate within the meaning of s14-220 of Schedule 1 to the <i>TA Act</i> , that covers one or more days falling within the period from and including the contract date to completion;
<i>deposit-bond</i>	a deposit bond or guarantee from an issuer, with an expiry date and for an amount each approved by the vendor;
<i>depositholder</i>	vendor's agent (or if no vendor's agent is named in this contract, the vendor's <i>solicitor</i> , or if no vendor's <i>solicitor</i> is named in this contract, the buyer's agent);
<i>document of title</i>	document relevant to the title or the passing of title;
<i>FRCGW percentage</i>	the percentage mentioned in s14-200(3)(a) of Schedule 1 to the <i>TA Act</i> (12.5% as at 1 July 2017);
<i>FRCGW remittance</i>	a remittance which the purchaser must make under s14-200 of Schedule 1 to the <i>TA Act</i> , being the lesser of the <i>FRCGW percentage</i> of the price (inclusive of GST, if any) and the amount specified in a <i>variation served by a party</i> ;
<i>GST Act</i>	A New Tax System (Goods and Services Tax) Act 1999;
<i>GST rate</i>	the rate mentioned in s4 of A New Tax System (Goods and Services Tax Imposition - General) Act 1999 (10% as at 1 July 2000);
<i>GSTRW payment</i>	a payment which the purchaser must make under s14-250 of Schedule 1 to the <i>TA Act</i> (the price multiplied by the <i>GSTRW rate</i>);
<i>GSTRW rate</i>	the rate determined under ss14-250(6), (8) or (9) of Schedule 1 to the <i>TA Act</i> (as at 1 July 2018, usually 7% of the price if the margin scheme applies, 1/11 th if not);
<i>legislation</i>	an Act or a by-law, ordinance, regulation or rule made under an Act;
<i>normally</i>	subject to any other provision of this contract;
<i>party</i>	each of the vendor and the purchaser;
<i>property</i>	the land, the improvements, all fixtures and the inclusions, but not the exclusions;
<i>planning agreement</i>	a valid voluntary agreement within the meaning of s7.4 of the Environmental Planning and Assessment Act 1979 entered into in relation to the <i>property</i> ;
<i>requisition</i>	an objection, question or requisition (but the term does not include a claim);
<i>rescind</i>	rescind this contract from the beginning;
<i>serve</i>	serve in writing on the other <i>party</i> ;
<i>settlement cheque</i>	an unendorsed <i>cheque</i> made payable to the person to be paid and – <ul style="list-style-type: none"> • issued by a <i>bank</i> and drawn on itself; or • if authorised in writing by the vendor or the vendor's <i>solicitor</i>, some other <i>cheque</i>;
<i>solicitor</i>	in relation to a <i>party</i> , the <i>party's</i> solicitor or licensed conveyancer named in this contract or in a notice <i>served by the party</i> ;
<i>TA Act</i>	Taxation Administration Act 1953;
<i>terminate</i>	terminate this contract for breach;
<i>variation</i>	a variation made under s14-235 of Schedule 1 to the <i>TA Act</i> ;
<i>within</i>	in relation to a period, at any time before or during the period; and
<i>work order</i>	a valid direction, notice or order that requires work to be done or money to be spent on or in relation to the <i>property</i> or any adjoining footpath or road (but the term does not include a notice under s22E of the Swimming Pools Act 1992 or clause 22 of the Swimming Pools Regulation 2018).

2 Deposit and other payments before completion

- 2.1 The purchaser must pay the deposit to the *depositholder* as stakeholder.
- 2.2 *Normally*, the purchaser must pay the deposit on the making of this contract, and this time is essential.
- 2.3 If this contract requires the purchaser to pay any of the deposit by a later time, that time is also essential.
- 2.4 The purchaser can pay any of the deposit by giving cash (up to \$2,000) or by unconditionally giving a *cheque* to the *depositholder* or to the vendor, vendor's agent or vendor's *solicitor* for sending to the *depositholder* or by payment by electronic funds transfer to the *depositholder*.
- 2.5 If any of the deposit is not paid on time or a *cheque* for any of the deposit is not honoured on presentation, the vendor can *terminate*. This right to *terminate* is lost as soon as the deposit is paid in full.

- 2.6 If the vendor accepts a bond or guarantee for the deposit, clauses 2.1 to 2.5 do not apply.
- 2.7 If the vendor accepts a bond or guarantee for part of the deposit, clauses 2.1 to 2.5 apply only to the balance.
- 2.8 If any of the deposit or of the balance of the price is paid before completion to the vendor or as the vendor directs, it is a charge on the land in favour of the purchaser until *termination* by the vendor or completion, subject to any existing right.
- 2.9 If each *party* tells the *depositholder* that the deposit is to be invested, the *depositholder* is to invest the deposit (at the risk of the *party* who becomes entitled to it) with a *bank*, in an interest-bearing account in NSW, payable at call, with interest to be reinvested, and pay the interest to the *parties* equally, after deduction of all proper government taxes and financial institution charges and other charges.

3 Deposit-bond

- 3.1 This clause applies only if this contract says the vendor has agreed to accept a *deposit-bond* for the deposit (or part of it).
- 3.2 The purchaser must provide the original *deposit-bond* to the vendor's *solicitor* (or if no *solicitor* the *depositholder*) at or before the making of this contract and this time is essential.
- 3.3 If the *deposit-bond* has an expiry date and completion does not occur by the date which is 14 days before the expiry date, the purchaser must *serve* a replacement *deposit-bond* at least 7 days before the expiry date. The time for service is essential.
- 3.4 The vendor must approve a replacement *deposit-bond* if –
 - 3.4.1 it is from the same issuer and for the same amount as the earlier *deposit-bond*; and
 - 3.4.2 it has an expiry date at least three months after its date of issue.
- 3.5 A breach of clauses 3.2 or 3.3 entitles the vendor to *terminate*. The right to *terminate* is lost as soon as –
 - 3.5.1 the purchaser *serves* a replacement *deposit-bond*; or
 - 3.5.2 the deposit is paid in full under clause 2.
- 3.6 Clauses 3.3 and 3.4 can operate more than once.
- 3.7 If the purchaser *serves* a replacement *deposit-bond*, the vendor must *serve* the earlier *deposit-bond*.
- 3.8 The amount of any *deposit-bond* does not form part of the price for the purposes of clause 16.7.
- 3.9 The vendor must give the purchaser the *deposit-bond* –
 - 3.9.1 on completion; or
 - 3.9.2 if this contract is *rescinded*.
- 3.10 If this contract is *terminated* by the vendor –
 - 3.10.1 *normally*, the vendor can immediately demand payment from the issuer of the *deposit-bond*; or
 - 3.10.2 if the purchaser *serves* prior to *termination* a notice disputing the vendor's right to *terminate*, the vendor must forward the *deposit-bond* (or its proceeds if called up) to the *depositholder* as stakeholder.
- 3.11 If this contract is *terminated* by the purchaser –
 - 3.11.1 *normally*, the vendor must give the purchaser the *deposit-bond*; or
 - 3.11.2 if the vendor *serves* prior to *termination* a notice disputing the purchaser's right to *terminate*, the vendor must forward the *deposit-bond* (or its proceeds if called up) to the *depositholder* as stakeholder.

4 Transfer

- 4.1 *Normally*, the purchaser must *serve* at least 14 days before the date for completion –
 - 4.1.1 the form of transfer; and
 - 4.1.2 particulars required to register any mortgage or other dealing to be lodged with the transfer by the purchaser or the purchaser's mortgagee.
- 4.2 If any information needed for the form of transfer is not disclosed in this contract, the vendor must *serve* it.
- 4.3 If the purchaser *serves* a form of transfer and the transferee is not the purchaser, the purchaser must give the vendor a direction signed by the purchaser personally for this form of transfer.
- 4.4 The vendor can require the purchaser to include a form of covenant or easement in the transfer only if this contract contains the wording of the proposed covenant or easement, and a description of the land benefited.

5 Requisitions

- 5.1 If a form of *requisitions* is attached to this contract, the purchaser is taken to have made those *requisitions*.
- 5.2 If the purchaser is or becomes entitled to make any other *requisition*, the purchaser can make it only by *serving* it –
 - 5.2.1 if it arises out of this contract or it is a general question about the *property* or title - *within* 21 days after the contract date;
 - 5.2.2 if it arises out of anything *served* by the vendor - *within* 21 days after the later of the contract date and that *service*; and
 - 5.2.3 in any other case - *within* a reasonable time.

6 Error or misdescription

- 6.1 *Normally*, the purchaser can (but only before completion) claim compensation for an error or misdescription in this contract (as to the *property*, the title or anything else and whether substantial or not).

- 6.2 This clause applies even if the purchaser did not take notice of or rely on anything in this contract containing or giving rise to the error or misdescription.
- 6.3 However, this clause does not apply to the extent the purchaser knows the true position.

7 Claims by purchaser

Normally, the purchaser can make a claim (including a claim under clause 6) before completion only by *serving* it with a statement of the amount claimed, and if the purchaser makes one or more claims before completion –

- 7.1 the vendor can *rescind* if in the case of claims that are not claims for delay –
- 7.1.1 the total amount claimed exceeds 5% of the price;
 - 7.1.2 the vendor *serves* notice of intention to *rescind*; and
 - 7.1.3 the purchaser does not *serve* notice waiving the claims *within* 14 days after that *service*; and
- 7.2 if the vendor does not *rescind*, the *parties* must complete and if this contract is completed –
- 7.2.1 the lesser of the total amount claimed and 10% of the price must be paid out of the price to and held by the *depositholder* until the claims are finalised or lapse;
 - 7.2.2 the amount held is to be invested in accordance with clause 2.9;
 - 7.2.3 the claims must be finalised by an arbitrator appointed by the *parties* or, if an appointment is not made *within* 1 month of completion, by an arbitrator appointed by the President of the Law Society at the request of a *party* (in the latter case the *parties* are bound by the terms of the Conveyancing Arbitration Rules approved by the Law Society as at the date of the appointment);
 - 7.2.4 the purchaser is not entitled, in respect of the claims, to more than the total amount claimed and the costs of the purchaser;
 - 7.2.5 net interest on the amount held must be paid to the *parties* in the same proportion as the amount held is paid; and
 - 7.2.6 if the *parties* do not appoint an arbitrator and neither *party* requests the President to appoint an arbitrator *within* 3 months after completion, the claims lapse and the amount belongs to the vendor.

8 Vendor's rights and obligations

- 8.1 The vendor can *rescind* if –
- 8.1.1 the vendor is, on reasonable grounds, unable or unwilling to comply with a *requisition*;
 - 8.1.2 the vendor *serves* a notice of intention to *rescind* that specifies the *requisition* and those grounds; and
 - 8.1.3 the purchaser does not *serve* a notice waiving the *requisition* *within* 14 days after that *service*.
- 8.2 If the vendor does not comply with this contract (or a notice under or relating to it) in an essential respect, the purchaser can *terminate* by *serving* a notice. After the *termination* –
- 8.2.1 the purchaser can recover the deposit and any other money paid by the purchaser under this contract;
 - 8.2.2 the purchaser can sue the vendor to recover damages for breach of contract; and
 - 8.2.3 if the purchaser has been in possession a *party* can claim for a reasonable adjustment.

9 Purchaser's default

If the purchaser does not comply with this contract (or a notice under or relating to it) in an essential respect, the vendor can *terminate* by *serving* a notice. After the *termination* the vendor can –

- 9.1 keep or recover the deposit (to a maximum of 10% of the price);
- 9.2 hold any other money paid by the purchaser under this contract as security for anything recoverable under this clause –
- 9.2.1 for 12 months after the *termination*; or
 - 9.2.2 if the vendor commences proceedings under this clause *within* 12 months, until those proceedings are concluded; and
- 9.3 sue the purchaser either –
- 9.3.1 where the vendor has resold the *property* under a contract made *within* 12 months after the *termination*, to recover –
 - the deficiency on resale (with credit for any of the deposit kept or recovered and after allowance for any capital gains tax or goods and services tax payable on anything recovered under this clause); and
 - the reasonable costs and expenses arising out of the purchaser's non-compliance with this contract or the notice and of resale and any attempted resale; or
 - 9.3.2 to recover damages for breach of contract.

10 Restrictions on rights of purchaser

- 10.1 The purchaser cannot make a claim or *requisition* or *rescind* or *terminate* in respect of –
- 10.1.1 the ownership or location of any fence as defined in the Dividing Fences Act 1991;
 - 10.1.2 a service for the *property* being a joint service or passing through another property, or any service for another property passing through the *property* ('service' includes air, communication, drainage, electricity, garbage, gas, oil, radio, sewerage, telephone, television or water service);

- 10.1.3 a wall being or not being a party wall in any sense of that term or the *property* being affected by an easement for support or not having the benefit of an easement for support;
- 10.1.4 any change in the *property* due to fair wear and tear before completion;
- 10.1.5 a promise, representation or statement about this contract, the *property* or the title, not set out or referred to in this contract;
- 10.1.6 a condition, exception, reservation or restriction in a Crown grant;
- 10.1.7 the existence of any authority or licence to explore or prospect for gas, minerals or petroleum;
- 10.1.8 any easement or restriction on use the substance of either of which is disclosed in this contract or any non-compliance with the easement or restriction on use; or
- 10.1.9 anything the substance of which is disclosed in this contract (except a caveat, charge, mortgage, priority notice or writ).
- 10.2 The purchaser cannot *rescind* or *terminate* only because of a defect in title to or quality of the inclusions.
- 10.3 *Normally*, the purchaser cannot make a claim or *requisition* or *rescind* or *terminate* or require the vendor to change the nature of the title disclosed in this contract (for example, to remove a caution evidencing qualified title, or to lodge a plan of survey as regards limited title).
- 11 Compliance with work orders**
- 11.1 *Normally*, the vendor must by completion comply with a *work order* made on or before the contract date and if this contract is completed the purchaser must comply with any other *work order*.
- 11.2 If the purchaser complies with a *work order*, and this contract is *rescinded* or *terminated*, the vendor must pay the expense of compliance to the purchaser.
- 12 Certificates and inspections**
- The vendor must do everything reasonable to enable the purchaser, subject to the rights of any tenant –
- 12.1 to have the *property* inspected to obtain any certificate or report reasonably required;
- 12.2 to apply (if necessary in the name of the vendor) for –
- 12.2.1 any certificate that can be given in respect of the *property* under *legislation*; or
- 12.2.2 a copy of any approval, certificate, consent, direction, notice or order in respect of the *property* given under *legislation*, even if given after the contract date; and
- 12.3 to make 1 inspection of the *property* in the 3 days before a time appointed for completion.
- 13 Goods and services tax (GST)**
- 13.1 Terms used in this clause which are not defined elsewhere in this contract and have a defined meaning in the *GST Act* have the same meaning in this clause.
- 13.2 *Normally*, if a *party* must pay the price or any other amount to the other *party* under this contract, GST is not to be added to the price or amount.
- 13.3 If under this contract a *party* must make an adjustment or payment for an expense of another party or pay an expense payable by or to a third party (for example, under clauses 14 or 20.7) –
- 13.3.1 the *party* must adjust or pay on completion any GST added to or included in the expense; but
- 13.3.2 the amount of the expense must be reduced to the extent the party receiving the adjustment or payment (or the representative member of a GST group of which that party is a member) is entitled to an input tax credit for the expense; and
- 13.3.3 if the adjustment or payment under this contract is consideration for a taxable supply, an amount for GST must be added at the *GST rate*.
- 13.4 If this contract says this sale is the supply of a going concern –
- 13.4.1 the *parties* agree the supply of the *property* is a supply of a going concern;
- 13.4.2 the vendor must, between the contract date and completion, carry on the enterprise conducted on the land in a proper and business-like way;
- 13.4.3 if the purchaser is not registered by the date for completion, the *parties* must complete and the purchaser must pay on completion, in addition to the price, an amount being the price multiplied by the *GST rate* ("the retention sum"). The retention sum is to be held by the *depositholder* and dealt with as follows –
- if *within* 3 months of completion the purchaser serves a letter from the Australian Taxation Office stating the purchaser is registered with a date of effect of registration on or before completion, the *depositholder* is to pay the retention sum to the purchaser; but
 - if the purchaser does not serve that letter *within* 3 months of completion, the *depositholder* is to pay the retention sum to the vendor; and
- 13.4.4 if the vendor, despite clause 13.4.1, serves a letter from the Australian Taxation Office stating the vendor has to pay GST on the supply, the purchaser must pay to the vendor on demand the amount of GST assessed.
- 13.5 *Normally*, the vendor promises the margin scheme will not apply to the supply of the *property*.
- 13.6 If this contract says the margin scheme is to apply in making the taxable supply, the *parties* agree that the margin scheme is to apply to the sale of the *property*.
- 13.7 If this contract says the sale is not a taxable supply –

- 13.7.1 the purchaser promises that the *property* will not be used and represents that the purchaser does not intend the *property* (or any part of the *property*) to be used in a way that could make the sale a taxable supply to any extent; and
- 13.7.2 the purchaser must pay the vendor on completion in addition to the price an amount calculated by multiplying the price by the *GST rate* if this sale is a taxable supply to any extent because of –
- a breach of clause 13.7.1; or
 - something else known to the purchaser but not the vendor.
- 13.8 If this contract says this sale is a taxable supply in full and does not say the margin scheme applies to the *property*, the vendor must pay the purchaser on completion an amount of one-eleventh of the price if –
- 13.8.1 this sale is not a taxable supply in full; or
- 13.8.2 the margin scheme applies to the *property* (or any part of the *property*).
- 13.9 If this contract says this sale is a taxable supply to an extent –
- 13.9.1 clause 13.7.1 does not apply to any part of the *property* which is identified as being a taxable supply; and
- 13.9.2 the payments mentioned in clauses 13.7 and 13.8 are to be recalculated by multiplying the relevant payment by the proportion of the price which represents the value of that part of the *property* to which the clause applies (the proportion to be expressed as a number between 0 and 1). Any evidence of value must be obtained at the expense of the vendor.
- 13.10 *Normally*, on completion the vendor must give the recipient of the supply a tax invoice for any taxable supply by the vendor by or under this contract.
- 13.11 The vendor does not have to give the purchaser a tax invoice if the margin scheme applies to a taxable supply.
- 13.12 If the vendor is liable for GST on rents or profits due to issuing an invoice or receiving consideration before completion, any adjustment of those amounts must exclude an amount equal to the vendor's GST liability.
- 13.13 If the purchaser must make a *GSTRW payment* the purchaser must –
- 13.13.1 at least 5 days before the date for completion, *serve* evidence of submission of a *GSTRW payment* notification form to the Australian Taxation Office by the purchaser or, if a direction under clause 4.3 has been *served*, by the transferee named in the transfer *served* with that direction;
- 13.13.2 produce on completion a *settlement cheque* for the *GSTRW payment* payable to the Deputy Commissioner of Taxation;
- 13.13.3 forward the *settlement cheque* to the payee immediately after completion; and
- 13.13.4 *serve* evidence of receipt of payment of the *GSTRW payment* and a copy of the settlement date confirmation form submitted to the Australian Taxation Office.
- 14 Adjustments**
- 14.1 *Normally*, the vendor is entitled to the rents and profits and will be liable for all rates, water, sewerage and drainage service and usage charges, land tax, levies and all other periodic outgoings up to and including the *adjustment date* after which the purchaser will be entitled and liable.
- 14.2 The *parties* must make any necessary adjustment on completion.
- 14.3 If an amount that is adjustable under this contract has been reduced under *legislation*, the *parties* must on completion adjust the reduced amount.
- 14.4 The *parties* must not adjust surcharge land tax (as defined in the Land Tax Act 1956) but must adjust any other land tax for the year current at the *adjustment date* –
- 14.4.1 only if land tax has been paid or is payable for the year (whether by the vendor or by a predecessor in title) and this contract says that land tax is adjustable;
- 14.4.2 by adjusting the amount that would have been payable if at the start of the year –
- the person who owned the land owned no other land;
 - the land was not subject to a special trust or owned by a non-concessional company; and
 - if the land (or part of it) had no separate taxable value, by calculating its separate taxable value on a proportional area basis.
- 14.5 If any other amount that is adjustable under this contract relates partly to the land and partly to other land, the *parties* must adjust it on a proportional area basis.
- 14.6 *Normally*, the vendor can direct the purchaser to produce a *settlement cheque* on completion to pay an amount adjustable under this contract and if so –
- 14.6.1 the amount is to be treated as if it were paid; and
- 14.6.2 the *cheque* must be forwarded to the payee immediately after completion (by the purchaser if the *cheque* relates only to the *property* or by the vendor in any other case).
- 14.7 If on completion the last bill for a water, sewerage or drainage usage charge is for a period ending before the *adjustment date*, the vendor is liable for an amount calculated by dividing the bill by the number of days in the period then multiplying by the number of unbilled days up to and including the *adjustment date*.
- 14.8 The vendor is liable for any amount recoverable for work started on or before the contract date on the *property* or any adjoining footpath or road.

15 Date for completion

The *parties* must complete by the date for completion and, if they do not, a *party* can serve a notice to complete if that *party* is otherwise entitled to do so.

16 Completion**• Vendor**

- 16.1 On completion the vendor must give the purchaser any *document of title* that relates only to the *property*.
- 16.2 If on completion the vendor has possession or control of a *document of title* that relates also to other property, the vendor must produce it as and where necessary.
- 16.3 *Normally*, on completion the vendor must cause the legal title to the *property* (being an estate in fee simple) to pass to the purchaser free of any mortgage or other interest, subject to any necessary registration.
- 16.4 The legal title to the *property* does not pass before completion.
- 16.5 If the vendor gives the purchaser a document (other than the transfer) that needs to be lodged for registration, the vendor must pay the lodgment fee to the purchaser.
- 16.6 If a *party* serves a land tax certificate showing a charge on any of the land, by completion the vendor must do all things and pay all money required so that the charge is no longer effective against the land.

• Purchaser

- 16.7 On completion the purchaser must pay to the vendor, by cash (up to \$2,000) or *settlement cheque* –
 - 16.7.1 the price less any:
 - deposit paid;
 - *FRCGW remittance* payable;
 - *GSTRW payment*; and
 - amount payable by the vendor to the purchaser under this contract; and
 - 16.7.2 any other amount payable by the purchaser under this contract.
- 16.8 If the vendor requires more than 5 *settlement cheques*, the vendor must pay \$10 for each extra *cheque*.
- 16.9 If any of the deposit is not covered by a bond or guarantee, on completion the purchaser must give the vendor an order signed by the purchaser authorising the *depositholder* to account to the vendor for the deposit.
- 16.10 On completion the deposit belongs to the vendor.

• Place for completion

- 16.11 *Normally*, the *parties* must complete at the completion address, which is –
 - 16.11.1 if a special completion address is stated in this contract - that address; or
 - 16.11.2 if none is stated, but a first mortgagee is disclosed in this contract and the mortgagee would usually discharge the mortgage at a particular place - that place; or
 - 16.11.3 in any other case - the vendor's *solicitor's* address stated in this contract.
- 16.12 The vendor by reasonable notice can require completion at another place, if it is in NSW, but the vendor must pay the purchaser's additional expenses, including any agency or mortgagee fee.
- 16.13 If the purchaser requests completion at a place that is not the completion address, and the vendor agrees, the purchaser must pay the vendor's additional expenses, including any agency or mortgagee fee.

17 Possession

- 17.1 *Normally*, the vendor must give the purchaser vacant possession of the *property* on completion.
- 17.2 The vendor does not have to give vacant possession if –
 - 17.2.1 this contract says that the sale is subject to existing tenancies; and
 - 17.2.2 the contract discloses the provisions of the tenancy (for example, by attaching a copy of the lease and any relevant memorandum or variation).
- 17.3 *Normally*, the purchaser can claim compensation (before or after completion) or *rescind* if any of the land is affected by a protected tenancy (a tenancy affected by Schedule 2, Part 7 of the Residential Tenancies Act 2010).

18 Possession before completion

- 18.1 This clause applies only if the vendor gives the purchaser possession of the *property* before completion.
- 18.2 The purchaser must not before completion –
 - 18.2.1 let or part with possession of any of the *property*;
 - 18.2.2 make any change or structural alteration or addition to the *property*; or
 - 18.2.3 contravene any agreement between the *parties* or any direction, document, *legislation*, notice or order affecting the *property*.
- 18.3 The purchaser must until completion –
 - 18.3.1 keep the *property* in good condition and repair having regard to its condition at the giving of possession; and
 - 18.3.2 allow the vendor or the vendor's authorised representative to enter and inspect it at all reasonable times.
- 18.4 The risk as to damage to the *property* passes to the purchaser immediately after the purchaser enters into possession.
- 18.5 If the purchaser does not comply with this clause, then without affecting any other right of the vendor –
 - 18.5.1 the vendor can before completion, without notice, remedy the non-compliance; and

18.5.2 if the vendor pays the expense of doing this, the purchaser must pay it to the vendor with interest at the rate prescribed under s101 Civil Procedure Act 2005.

18.6 If this contract is *rescinded* or *terminated* the purchaser must immediately vacate the *property*.

18.7 If the *parties* or their *solicitors* on their behalf do not agree in writing to a fee or rent, none is payable.

19 Rescission of contract

19.1 If this contract expressly gives a *party* a right to *rescind*, the *party* can exercise the right –

19.1.1 only by *serving* a notice before completion; and

19.1.2 in spite of any making of a claim or *requisition*, any attempt to satisfy a claim or *requisition*, any arbitration, litigation, mediation or negotiation or any giving or taking of possession.

19.2 *Normally*, if a *party* exercises a right to *rescind* expressly given by this contract or any *legislation* –

19.2.1 the deposit and any other money paid by the purchaser under this contract must be refunded;

19.2.2 a *party* can claim for a reasonable adjustment if the purchaser has been in possession;

19.2.3 a *party* can claim for damages, costs or expenses arising out of a breach of this contract; and

19.2.4 a *party* will not otherwise be liable to pay the other *party* any damages, costs or expenses.

20 Miscellaneous

20.1 The *parties* acknowledge that anything stated in this contract to be attached was attached to this contract by the vendor before the purchaser signed it and is part of this contract.

20.2 Anything attached to this contract is part of this contract.

20.3 An area, bearing or dimension in this contract is only approximate.

20.4 If a *party* consists of 2 or more persons, this contract benefits and binds them separately and together.

20.5 A *party's solicitor* can receive any amount payable to the *party* under this contract or direct in writing that it is to be paid to another person.

20.6 A document under or relating to this contract is –

20.6.1 signed by a *party* if it is signed by the *party* or the *party's solicitor* (apart from a direction under clause 4.3);

20.6.2 served if it is served by the *party* or the *party's solicitor*;

20.6.3 served if it is served on the *party's solicitor*, even if the *party* has died or any of them has died;

20.6.4 served if it is served in any manner provided in s170 of the Conveyancing Act 1919;

20.6.5 served if it is sent by email or fax to the *party's solicitor*, unless in either case it is not received;

20.6.6 served on a person if it (or a copy of it) comes into the possession of the person; and

20.6.7 served at the earliest time it is served, if it is served more than once.

20.7 An obligation to pay an expense of another *party* of doing something is an obligation to pay –

20.7.1 if the *party* does the thing personally - the reasonable cost of getting someone else to do it; or

20.7.2 if the *party* pays someone else to do the thing - the amount paid, to the extent it is reasonable.

20.8 Rights under clauses 11, 13, 14, 17, 24, 30 and 31 continue after completion, whether or not other rights continue.

20.9 The vendor does not promise, represent or state that the purchaser has any cooling off rights.

20.10 The vendor does not promise, represent or state that any attached survey report is accurate or current.

20.11 A reference to any *legislation* (including any percentage or rate specified in *legislation*) is also a reference to any corresponding later *legislation*.

20.12 Each *party* must do whatever is necessary after completion to carry out the *party's* obligations under this contract.

20.13 Neither taking possession nor *serving* a transfer of itself implies acceptance of the *property* or the title.

20.14 The details and information provided in this contract (for example, on pages 1 - 3) are, to the extent of each *party's* knowledge, true, and are part of this contract.

20.15 Where this contract provides for choices, a choice in BLOCK CAPITALS applies unless a different choice is marked.

21 Time limits in these provisions

21.1 If the time for something to be done or to happen is not stated in these provisions, it is a reasonable time.

21.2 If there are conflicting times for something to be done or to happen, the latest of those times applies.

21.3 The time for one thing to be done or to happen does not extend the time for another thing to be done or to happen.

21.4 If the time for something to be done or to happen is the 29th, 30th or 31st day of a month, and the day does not exist, the time is instead the last day of the month.

21.5 If the time for something to be done or to happen is a day that is not a *business day*, the time is extended to the next *business day*, except in the case of clauses 2 and 3.2.

21.6 *Normally*, the time by which something must be done is fixed but not essential.

22 Foreign Acquisitions and Takeovers Act 1975

22.1 The purchaser promises that the Commonwealth Treasurer cannot prohibit and has not prohibited the transfer under the Foreign Acquisitions and Takeovers Act 1975.

22.2 This promise is essential and a breach of it entitles the vendor to *terminate*.

23 Strata or community title

• Definitions and modifications

- 23.1 This clause applies only if the land (or part of it) is a lot in a strata, neighbourhood, precinct or community scheme (or on completion is to be a lot in a scheme of that kind).
- 23.2 In this contract –
- 23.2.1 'change', in relation to a scheme, means –
- a registered or registrable change from by-laws set out in this contract;
 - a change from a development or management contract or statement set out in this contract; or
 - a change in the boundaries of common property;
- 23.2.2 'common property' includes association property for the scheme or any higher scheme;
- 23.2.3 'contribution' includes an amount payable under a by-law;
- 23.2.4 'information certificate' includes a certificate under s184 Strata Schemes Management Act 2015 and s26 Community Land Management Act 1989;
- 23.2.5 'information notice' includes a strata information notice under s22 Strata Schemes Management Act 2015 and a notice under s47 Community Land Management Act 1989;
- 23.2.6 'normal expenses', in relation to an owners corporation for a scheme, means normal operating expenses usually payable from the administrative fund of an owners corporation for a scheme of the same kind;
- 23.2.7 'owners corporation' means the owners corporation or the association for the scheme or any higher scheme;
- 23.2.8 'the *property*' includes any interest in common property for the scheme associated with the lot; and
- 23.2.9 'special expenses', in relation to an owners corporation, means its actual, contingent or expected expenses, except to the extent they are –
- normal expenses;
 - due to fair wear and tear;
 - disclosed in this contract; or
 - covered by moneys held in the capital works fund.
- 23.3 Clauses 11, 14.8 and 18.4 do not apply to an obligation of the owners corporation, or to property insurable by it.
- 23.4 Clauses 14.4.2 and 14.5 apply but on a unit entitlement basis instead of an area basis.
- ### • Adjustments and liability for expenses
- 23.5 The *parties* must adjust under clause 14.1 –
- 23.5.1 a regular periodic contribution;
- 23.5.2 a contribution which is not a regular periodic contribution but is disclosed in this contract; and
- 23.5.3 on a unit entitlement basis, any amount paid by the vendor for a normal expense of the owners corporation to the extent the owners corporation has not paid the amount to the vendor.
- 23.6 If a contribution is not a regular periodic contribution and is not disclosed in this contract –
- 23.6.1 the vendor is liable for it if it was determined on or before the contract date, even if it is payable by instalments; and
- 23.6.2 the purchaser is liable for all contributions determined after the contract date.
- 23.7 The vendor must pay or allow to the purchaser on completion the amount of any unpaid contributions for which the vendor is liable under clause 23.6.1.
- 23.8 *Normally*, the purchaser cannot make a claim or *requisition* or *rescind* or *terminate* in respect of –
- 23.8.1 an existing or future actual, contingent or expected expense of the owners corporation;
- 23.8.2 a proportional unit entitlement of the lot or a relevant lot or former lot, apart from a claim under clause 6; or
- 23.8.3 a past or future change in the scheme or a higher scheme.
- 23.9 However, the purchaser can *rescind* if –
- 23.9.1 the special expenses of the owners corporation at the later of the contract date and the creation of the owners corporation when calculated on a unit entitlement basis (and, if more than one lot or a higher scheme is involved, added together), less any contribution paid by the vendor, are more than 1% of the price;
- 23.9.2 in the case of the lot or a relevant lot or former lot in a higher scheme, a proportional unit entitlement for the lot is disclosed in this contract but the lot has a different proportional unit entitlement at the contract date or at any time before completion;
- 23.9.3 a change before the contract date or before completion in the scheme or a higher scheme materially prejudices the purchaser and is not disclosed in this contract; or
- 23.9.4 a resolution is passed by the owners corporation before the contract date or before completion to give to the owners in the scheme for their consideration a strata renewal plan that has not lapsed at the contract date and there is not attached to this contract a strata renewal proposal or the strata renewal plan.
- ### • Notices, certificates and inspections
- 23.10 The purchaser must give the vendor 2 copies of an information notice addressed to the owners corporation and signed by the purchaser.

- 23.11 The vendor must complete and sign 1 copy of the notice and give it to the purchaser on completion.
- 23.12 Each *party* can sign and give the notice as agent for the other.
- 23.13 The vendor must serve an information certificate issued after the contract date in relation to the lot, the scheme or any higher scheme at least 7 days before the date for completion.
- 23.14 The purchaser does not have to complete earlier than 7 days after *service* of the certificate and clause 21.3 does not apply to this provision. On completion the purchaser must pay the vendor the prescribed fee for the certificate.
- 23.15 The vendor authorises the purchaser to apply for the purchaser's own certificate.
- 23.16 The vendor authorises the purchaser to apply for and make an inspection of any record or other document in the custody or control of the owners corporation or relating to the scheme or any higher scheme.
- **Meetings of the owners corporation**
- 23.17 If a general meeting of the owners corporation is convened before completion –
- 23.17.1 if the vendor receives notice of it, the vendor must immediately notify the purchaser of it; and
- 23.17.2 after the expiry of any cooling off period, the purchaser can require the vendor to appoint the purchaser (or the purchaser's nominee) to exercise any voting rights of the vendor in respect of the lot at the meeting.

24 Tenancies

- 24.1 If a tenant has not made a payment for a period preceding or current at the *adjustment date* –
- 24.1.1 for the purposes of clause 14.2, the amount is to be treated as if it were paid; and
- 24.1.2 the purchaser assigns the debt to the vendor on completion and will if required give a further assignment at the vendor's expense.
- 24.2 If a tenant has paid in advance of the *adjustment date* any periodic payment in addition to rent, it must be adjusted as if it were rent for the period to which it relates.
- 24.3 If the *property* is to be subject to a tenancy on completion or is subject to a tenancy on completion –
- 24.3.1 the vendor authorises the purchaser to have any accounting records relating to the tenancy inspected and audited and to have any other document relating to the tenancy inspected;
- 24.3.2 the vendor must serve any information about the tenancy reasonably requested by the purchaser before or after completion; and
- 24.3.3 *normally*, the purchaser can claim compensation (before or after completion) if –
- a disclosure statement required by the Retail Leases Act 1994 was not given when required;
 - such a statement contained information that was materially false or misleading;
 - a provision of the lease is not enforceable because of a non-disclosure in such a statement; or
 - the lease was entered into in contravention of the Retail Leases Act 1994.
- 24.4 If the *property* is subject to a tenancy on completion –
- 24.4.1 the vendor must allow or transfer –
- any remaining bond money or any other security against the tenant's default (to the extent the security is transferable);
 - any money in a fund established under the lease for a purpose and compensation for any money in the fund or interest earned by the fund that has been applied for any other purpose; and
 - any money paid by the tenant for a purpose that has not been applied for that purpose and compensation for any of the money that has been applied for any other purpose;
- 24.4.2 if the security is not transferable, each *party* must do everything reasonable to cause a replacement security to issue for the benefit of the purchaser and the vendor must hold the original security on trust for the benefit of the purchaser until the replacement security issues;
- 24.4.3 the vendor must give to the purchaser –
- a proper notice of the transfer (an attornment notice) addressed to the tenant;
 - any certificate given under the Retail Leases Act 1994 in relation to the tenancy;
 - a copy of any disclosure statement given under the Retail Leases Act 1994;
 - a copy of any document served on the tenant under the lease and written details of its service, if the document concerns the rights of the landlord or the tenant after completion; and
 - any document served by the tenant under the lease and written details of its service, if the document concerns the rights of the landlord or the tenant after completion;
- 24.4.4 the vendor must comply with any obligation to the tenant under the lease, to the extent it is to be complied with by completion; and
- 24.4.5 the purchaser must comply with any obligation to the tenant under the lease, to the extent that the obligation is disclosed in this contract and is to be complied with after completion.

25 Qualified title, limited title and old system title

- 25.1 This clause applies only if the land (or part of it) –
- 25.1.1 is under qualified, limited or old system title; or
- 25.1.2 on completion is to be under one of those titles.
- 25.2 The vendor must serve a proper abstract of title *within* 7 days after the contract date.
- 25.3 If an abstract of title or part of an abstract of title is attached to this contract or has been lent by the vendor to the purchaser before the contract date, the abstract or part is *served* on the contract date.

- 25.4 An abstract of title can be or include a list of documents, events and facts arranged (apart from a will or codicil) in date order, if the list in respect of each document –
- 25.4.1 shows its date, general nature, names of parties and any registration number; and
 - 25.4.2 has attached a legible photocopy of it or of an official or registration copy of it.
- 25.5 An abstract of title –
- 25.5.1 must start with a good root of title (if the good root of title must be at least 30 years old, this means 30 years old at the contract date);
 - 25.5.2 in the case of a leasehold interest, must include an abstract of the lease and any higher lease;
 - 25.5.3 *normally*, need not include a Crown grant; and
 - 25.5.4 need not include anything evidenced by the Register kept under the Real Property Act 1900.
- 25.6 In the case of land under old system title –
- 25.6.1 in this contract 'transfer' means conveyance;
 - 25.6.2 the purchaser does not have to *serve* the form of transfer until after the vendor has *served* a proper abstract of title; and
 - 25.6.3 each vendor must give proper covenants for title as regards that vendor's interest.
- 25.7 In the case of land under limited title but not under qualified title –
- 25.7.1 *normally*, the abstract of title need not include any document which does not show the location, area or dimensions of the land (for example, by including a metes and bounds description or a plan of the land);
 - 25.7.2 clause 25.7.1 does not apply to a document which is the good root of title; and
 - 25.7.3 the vendor does not have to provide an abstract if this contract contains a delimitation plan (whether in registrable form or not).
- 25.8 The vendor must give a proper covenant to produce where relevant.
- 25.9 The vendor does not have to produce or covenant to produce a document that is not in the possession of the vendor or a mortgagee.
- 25.10 If the vendor is unable to produce an original document in the chain of title, the purchaser will accept a photocopy from the Registrar-General of the registration copy of that document.

26 Crown purchase money

- 26.1 This clause applies only if purchase money is payable to the Crown, whether or not due for payment.
- 26.2 The vendor is liable for the money, except to the extent this contract says the purchaser is liable for it.
- 26.3 To the extent the vendor is liable for it, the vendor is liable for any interest until completion.
- 26.4 To the extent the purchaser is liable for it, the *parties* must adjust any interest under clause 14.1.

27 Consent to transfer

- 27.1 This clause applies only if the land (or part of it) cannot be transferred without consent under *legislation* or a *planning agreement*.
- 27.2 The purchaser must properly complete and then *serve* the purchaser's part of an application for consent to transfer of the land (or part of it) *within 7 days* after the contract date.
- 27.3 The vendor must apply for consent *within 7 days* after *service* of the purchaser's part.
- 27.4 If consent is refused, either *party* can *rescind*.
- 27.5 If consent is given subject to one or more conditions that will substantially disadvantage a *party*, then that *party* can *rescind within 7 days* after receipt by or *service* upon the *party* of written notice of the conditions.
- 27.6 If consent is not given or refused –
 - 27.6.1 *within 42 days* after the purchaser *serves* the purchaser's part of the application, the purchaser can *rescind*; or
 - 27.6.2 *within 30 days* after the application is made, either *party* can *rescind*.
- 27.7 Each period in clause 27.6 becomes 90 days if the land (or part of it) is –
 - 27.7.1 under a *planning agreement*; or
 - 27.7.2 in the Western Division.
- 27.8 If the land (or part of it) is described as a lot in an unregistered plan, each time in clause 27.6 becomes the later of the time and 35 days after creation of a separate folio for the lot.
- 27.9 The date for completion becomes the later of the date for completion and 14 days after *service* of the notice granting consent to transfer.

28 Unregistered plan

- 28.1 This clause applies only if some of the land is described as a lot in an unregistered plan.
- 28.2 The vendor must do everything reasonable to have the plan registered *within 6 months* after the contract date, with or without any minor alteration to the plan or any document to be lodged with the plan validly required or made under *legislation*.
- 28.3 If the plan is not registered *within* that time and in that manner –
 - 28.3.1 the purchaser can *rescind*; and
 - 28.3.2 the vendor can *rescind*, but only if the vendor has complied with clause 28.2 and with any *legislation* governing the rescission.
- 28.4 Either *party* can *serve* notice of the registration of the plan and every relevant lot and plan number.
- 28.5 The date for completion becomes the later of the date for completion and 21 days after *service* of the notice.

28.6 Clauses 28.2 and 28.3 apply to another plan that is to be registered before the plan is registered.

29 Conditional contract

29.1 This clause applies only if a provision says this contract or completion is conditional on an event.

29.2 If the time for the event to happen is not stated, the time is 42 days after the contract date.

29.3 If this contract says the provision is for the benefit of a *party*, then it benefits only that *party*.

29.4 If anything is necessary to make the event happen, each *party* must do whatever is reasonably necessary to cause the event to happen.

29.5 A *party* can *rescind* under this clause only if the *party* has substantially complied with clause 29.4.

29.6 If the event involves an approval and the approval is given subject to a condition that will substantially disadvantage a *party* who has the benefit of the provision, the *party* can *rescind* within 7 days after either *party* serves notice of the condition.

29.7 If the *parties* can lawfully complete without the event happening –

29.7.1 if the event does not happen within the time for it to happen, a *party* who has the benefit of the provision can *rescind* within 7 days after the end of that time;

29.7.2 if the event involves an approval and an application for the approval is refused, a *party* who has the benefit of the provision can *rescind* within 7 days after either *party* serves notice of the refusal; and

29.7.3 the date for completion becomes the later of the date for completion and 21 days after the earliest of –

- either *party* serving notice of the event happening;
- every *party* who has the benefit of the provision serving notice waiving the provision; or
- the end of the time for the event to happen.

29.8 If the *parties* cannot lawfully complete without the event happening –

29.8.1 if the event does not happen within the time for it to happen, either *party* can *rescind*;

29.8.2 if the event involves an approval and an application for the approval is refused, either *party* can *rescind*;

29.8.3 the date for completion becomes the later of the date for completion and 21 days after either *party* serves notice of the event happening.

29.9 A *party* cannot *rescind* under clauses 29.7 or 29.8 after the event happens.

30 Electronic transaction

30.1 This *Conveyancing Transaction* is to be conducted as an *electronic transaction* if –

30.1.1 this contract says that it is an *electronic transaction*;

30.1.2 the *parties* otherwise agree that it is to be conducted as an *electronic transaction*; or

30.1.3 the *conveyancing rules* require it to be conducted as an *electronic transaction*.

30.2 However, this *Conveyancing Transaction* is not to be conducted as an *electronic transaction* –

30.2.1 if the land is not *electronically tradeable* or the transfer is not eligible to be lodged electronically; or

30.2.2 if, at any time after the *effective date*, but at least 14 days before the date for completion, a *party* serves a notice stating a valid reason why it cannot be conducted as an *electronic transaction*.

30.3 If, because of clause 30.2.2, this *Conveyancing Transaction* is not to be conducted as an *electronic transaction* –

30.3.1 each *party* must –

- bear equally any disbursements or fees; and
- otherwise bear that *party's* own costs;

incurred because this *Conveyancing Transaction* was to be conducted as an *electronic transaction*; and

30.3.2 if a *party* has paid all of a disbursement or fee which, by reason of this clause, is to be borne equally by the *parties*, that amount must be adjusted under clause 14.2.

30.4 If this *Conveyancing Transaction* is to be conducted as an *electronic transaction* –

30.4.1 to the extent that any other provision of this contract is inconsistent with this clause, the provisions of this clause prevail;

30.4.2 normally, words and phrases used in this clause 30 (italicised and in Title Case, such as *Electronic Workspace* and *Lodgment Case*) have the same meaning which they have in the *participation rules*;

30.4.3 the *parties* must conduct the *electronic transaction* –

- in accordance with the *participation rules* and the *ECNL*; and
- using the nominated *ELN*, unless the *parties* otherwise agree;

30.4.4 a *party* must pay the fees and charges payable by that *party* to the *ELNO* and the *Land Registry* as a result of this transaction being an *electronic transaction*;

30.4.5 any communication from one *party* to another *party* in the *Electronic Workspace* made –

- after the *effective date*; and
- before the receipt of a notice given under clause 30.2.2;

is taken to have been received by that *party* at the time determined by s13A of the *Electronic Transactions Act 2000*; and

30.4.6 a document which is an *electronic document* is served as soon as it is first *Digitally Signed* in the *Electronic Workspace* on behalf of the *party* required to serve it.

- 30.5 Normally, the vendor must *within 7 days of the effective date* –
- 30.5.1 create an *Electronic Workspace*;
 - 30.5.2 populate the *Electronic Workspace* with *title data*, the date for completion and, if applicable, *mortgagee details*; and
 - 30.5.3 invite the purchaser and any *discharging mortgagee* to the *Electronic Workspace*.
- 30.6 If the vendor has not created an *Electronic Workspace* in accordance with clause 30.5, the purchaser may create an *Electronic Workspace*. If the purchaser creates the *Electronic Workspace* the purchaser must –
- 30.6.1 populate the *Electronic Workspace* with *title data*;
 - 30.6.2 create and populate an *electronic transfer*;
 - 30.6.3 populate the *Electronic Workspace* with the date for completion and a nominated *completion time*; and
 - 30.6.4 invite the vendor and any *incoming mortgagee* to join the *Electronic Workspace*.
- 30.7 Normally, *within 7 days of receiving an invitation from the vendor to join the Electronic Workspace*, the purchaser must –
- 30.7.1 join the *Electronic Workspace*;
 - 30.7.2 create and populate an *electronic transfer*;
 - 30.7.3 invite any *incoming mortgagee* to join the *Electronic Workspace*; and
 - 30.7.4 populate the *Electronic Workspace* with a nominated *completion time*.
- 30.8 If the purchaser has created the *Electronic Workspace* the vendor must *within 7 days of being invited to the Electronic Workspace* –
- 30.8.1 join the *Electronic Workspace*;
 - 30.8.2 populate the *Electronic Workspace* with *mortgagee details*, if applicable; and
 - 30.8.3 invite any *discharging mortgagee* to join the *Electronic Workspace*.
- 30.9 To complete the financial settlement schedule in the *Electronic Workspace* –
- 30.9.1 the purchaser must provide the vendor with *adjustment figures* at least *2 business days* before the date for completion;
 - 30.9.2 the vendor must confirm the *adjustment figures* at least *1 business day* before the date for completion; and
 - 30.9.3 if the purchaser must make a *GSTRW payment* or an *FRCGW remittance*, the purchaser must populate the *Electronic Workspace* with the payment details for the *GSTRW payment* or *FRCGW remittance* payable to the Deputy Commissioner of Taxation at least *2 business days* before the date for completion.
- 30.10 Before completion, the *parties* must ensure that –
- 30.10.1 all *electronic documents* which a *party* must *Digitally Sign* to complete the *electronic transaction* are populated and *Digitally Signed*;
 - 30.10.2 all certifications required by the *ECNL* are properly given; and
 - 30.10.3 they do everything else in the *Electronic Workspace* which that *party* must do to enable the *electronic transaction* to proceed to completion.
- 30.11 If completion takes place in the *Electronic Workspace* –
- 30.11.1 payment electronically on completion of the price in accordance with clause 16.7 is taken to be payment by a single *settlement cheque*;
 - 30.11.2 the completion address in clause 16.11 is the *Electronic Workspace*; and
 - 30.11.3 clauses 13.13.2 to 13.13.4, 16.8, 16.12, 16.13 and 31.2.2 to 31.2.4 do not apply.
- 30.12 If the computer systems of any of the *Land Registry*, the *ELNO* or the Reserve Bank of Australia are inoperative for any reason at the *completion time* agreed by the *parties*, a failure to complete this contract for that reason is not a default under this contract on the part of either *party*.
- 30.13 If the computer systems of the *Land Registry* are inoperative for any reason at the *completion time* agreed by the *parties*, and the *parties* choose that financial settlement is to occur despite this, then on financial settlement occurring –
- 30.13.1 all *electronic documents Digitally Signed* by the vendor, the *certificate of title* and any discharge of mortgage, withdrawal of caveat or other *electronic document* forming part of the *Lodgment Case* for the *electronic transaction* shall be taken to have been unconditionally and irrevocably delivered to the purchaser or the purchaser's mortgagee at the time of financial settlement together with the right to deal with the land comprised in the *certificate of title*; and
 - 30.13.2 the vendor shall be taken to have no legal or equitable interest in the *property*.
- 30.14 A *party* who holds a *certificate of title* must act in accordance with any *Prescribed Requirement* in relation to the *certificate of title* but if there is no *Prescribed Requirement*, the vendor must serve the *certificate of title* after completion.
- 30.15 If the *parties* do not agree about the delivery before completion of one or more documents or things that cannot be delivered through the *Electronic Workspace*, the *party* required to deliver the documents or things –
- 30.15.1 holds them on completion in escrow for the benefit of; and
 - 30.15.2 must immediately after completion deliver the documents or things to, or as directed by; the *party* entitled to them.
- 30.16 In this clause 30, these terms (in any form) mean –
- adjustment figures* details of the adjustments to be made to the price under clause 14;

<i>certificate of title</i>	the paper duplicate of the folio of the register for the land which exists immediately prior to completion and, if more than one, refers to each such paper duplicate;
<i>completion time</i>	the time of day on the date for completion when the <i>electronic transaction</i> is to be settled;
<i>conveyancing rules</i>	the rules made under s12E of the Real Property Act 1900;
<i>discharging mortgagee</i>	any discharging mortgagee, chargee, covenant chargee or caveator whose provision of a <i>Digitally Signed</i> discharge of mortgage, discharge of charge or withdrawal of caveat is required in order for unencumbered title to the <i>property</i> to be transferred to the purchaser;
<i>ECNL</i>	the Electronic Conveyancing National Law (NSW);
<i>effective date</i>	the date on which the <i>Conveyancing Transaction</i> is agreed to be an <i>electronic transaction</i> under clause 30.1.2 or, if clauses 30.1.1 or 30.1.3 apply, the contract date;
<i>electronic document</i>	a dealing as defined in the Real Property Act 1900 which may be created and <i>Digitally Signed</i> in an <i>Electronic Workspace</i> ;
<i>electronic transfer</i>	a transfer of land under the Real Property Act 1900 for the <i>property</i> to be prepared and <i>Digitally Signed</i> in the <i>Electronic Workspace</i> established for the purposes of the <i>parties' Conveyancing Transaction</i> ;
<i>electronic transaction</i>	a <i>Conveyancing Transaction</i> to be conducted for the <i>parties</i> by their legal representatives as <i>Subscribers</i> using an <i>ELN</i> and in accordance with the <i>ECNL</i> and the <i>participation rules</i> ;
<i>electronically tradeable</i>	a land title that is Electronically Tradeable as that term is defined in the <i>conveyancing rules</i> ;
<i>incoming mortgagee</i>	any mortgagee who is to provide finance to the purchaser on the security of the <i>property</i> and to enable the purchaser to pay the whole or part of the price;
<i>mortgagee details</i>	the details which a <i>party</i> to the <i>electronic transaction</i> must provide about any <i>discharging mortgagee</i> of the <i>property</i> as at completion;
<i>participation rules</i>	the participation rules as determined by the <i>ECNL</i> ;
<i>populate</i>	to complete data fields in the <i>Electronic Workspace</i> ; and
<i>title data</i>	the details of the title to the <i>property</i> made available to the <i>Electronic Workspace</i> by the <i>Land Registry</i> .

31 Foreign Resident Capital Gains Withholding

- 31.1 This clause applies only if –
- 31.1.1 the sale is not an excluded transaction within the meaning of s14-215 of Schedule 1 to the *TA Act*; and
 - 31.1.2 a *clearance certificate* in respect of every vendor is not attached to this contract.
- 31.2 The purchaser must –
- 31.2.1 at least 5 days before the date for completion, serve evidence of submission of a purchaser payment notification to the Australian Taxation Office by the purchaser or, if a direction under clause 4.3 has been served, by the transferee named in the transfer served with that direction;
 - 31.2.2 produce on completion a *settlement cheque* for the *FRCGW remittance* payable to the Deputy Commissioner of Taxation;
 - 31.2.3 forward the *settlement cheque* to the payee immediately after completion; and
 - 31.2.4 serve evidence of receipt of payment of the *FRCGW remittance*.
- 31.3 The vendor cannot refuse to complete if the purchaser complies with clauses 31.2.1 and 31.2.2.
- 31.4 If the vendor serves any *clearance certificate* or *variation*, the purchaser does not have to complete earlier than 7 days after that service and clause 21.3 does not apply to this provision.
- 31.5 If the vendor serves in respect of every vendor either a *clearance certificate* or a *variation* to 0.00 percent, clauses 31.2 and 31.3 do not apply.

32 Residential off the plan contract

- 32.1 This clause applies if this contract is an off the plan contract within the meaning of Division 10 of Part 4 of the Conveyancing Act 1919 (the Division).
- 32.2 No provision of this contract has the effect of excluding, modifying or restricting the operation of the Division.
- 32.3 If the purchaser makes a claim for compensation under the terms prescribed by clause 6A of the Conveyancing (Sale of Land) Regulation 2017 –
- 32.3.1 the purchaser cannot make a claim under this contract about the same subject matter, including a claim under clauses 6 or 7; and
 - 32.3.2 the claim for compensation is not a claim under this contract.
- 32.4 This clause does not apply to a contract made before the commencement of the amendments to the Division under the Conveyancing Legislation Amendment Act 2018.

ANNEXURE TO CONTRACT FOR SALE OF LAND

VENDOR:	Kerrie Anne Doyle
PURCHASER:	
PROPERTY:	5/22 Hercules Road, Brighton Le Sands NSW 2216

32. AMENDMENTS TO PRINTED FORM OF THE CONTRACT:

32.1 Deposits and other payments before completion.

Clause 2.9 is amended as follows:

32.1.1 After the word “deposit” in the first line the words “or any other moneys” are to be inserted.

32.1.2 Add to the end of clause 2.9 the words “Provided that the deposit holder shall only be required to invest the deposit if the parties supply to the deposit holder their tax file numbers”

32.1.3 Add in clause 3.2 after “Deposit Bond” with an expiry date no earlier than 42 days after the date for completion shown on the front page of this Contract.

32.2 Add additional clause 4.5 as follows:

“4.5 If the Purchaser fails to serve the Transfer as required by clause 4.1 the Purchaser shall pay on completion the Vendor’s additional costs of \$110.00 (inclusive of GST) as a genuine pre-estimate of the Vendor’s additional expenses in relation to the Purchaser’s failure”. (this is only applicable for a paper settlement)

32.3 Claims by Purchaser - delete clause 7.1.1.

32.4 Restrictions on rights of Purchaser – clause 10 is amended as follows:

32.4.1 Add to the first line of clause 10.1 the words “or delay completion” after the word “terminate”

32.4.2 In Clause 10.1.2 add “or the Common Property” after “property” in the second line.

32.4.3 Delete from clause 10.1.8 the words “substance” and disclosed” and insert in lieu respectively “existence” and “noted”.

32.4.4 Delete from clause 10.1.9 the words “substance” and disclosed” and insert in lieu respectively “existence” and “noted”.

32.4.5 Add to clause 10.2 after the word “rescind” the words “requisition, claim”.

32.5 Delete clause 14.4.2.

32.6 Completion – Clause 16 is amended as follows:

32.6.1 Add to clause 16.6 the words “not less than 7 days prior to the completion date” after the word “If”.

32.6.2 Clause 16.8 is deleted.

32.7 Clause 20.6.5 is deleted and the following inserted in its place:

"20.6.5 served if it is served by fax to the party's solicitor/conveyancer at the time of sending unless it is not received but production of a report produced by the sender's fax machine of an error-free transmission shall be prima facie evidence of the receipt of such fax and the time of such receipt and served by email to the party's solicitor/conveyancer at the time of sending as long as the party's solicitor or conveyancer can produce a email delivery or read receipt.

32.8 Clause 23.13 & 23.14 is deleted. The vendor authorises the purchaser to apply for their own S184 Certificate.

33. ALTERATIONS TO CONTRACT

Each party hereof authorises his, her or their Solicitor/Conveyancer or any employee of that Solicitor/Conveyancer to make alterations to this Contract including the addition of annexures after execution up until the date of this Contract and any such alterations shall be binding upon the party deemed hereby to have authorised the same and any annexure so added shall form part of this Contract as if same was annexed prior to the Contract being executed.

34. CLAIM FOR COMPENSATION

Notwithstanding the provisions clause 7, any claim for compensation made by the Purchaser shall be deemed to be an objection or requisition for the purposes of clause 8.

35. STATE OF REPAIR

The Purchaser relies upon the Purchaser's own enquiry regarding the present state of repair of the property or improvements to the property. No objection, requisition or claim for compensation may be made regarding the state or repair or condition (including patent or latent defects) of the property or improvements

36. AGENT INDEMNITY

The Purchaser warrants to the Vendor that the Purchaser has not been introduced to the Property by any estate agent or agency (other than the agent or agency [if any] nominated in this Contract) and hereby agrees to indemnify the Vendor against any claim by any estate agent or agency due to the Purchaser's breach of this warranty to the intent that all damages, costs and expenses on a Solicitor and client basis which may be incurred by the Vendor in respect of any such claim shall be paid by the Purchaser to the Vendor. The Vendor warrants to the Purchaser that the Vendor has not given any estate agent or agency (other than the agent or agency [if any] nominated in this Contract) a sole or exclusive agency for the sale of the Property. It is hereby agreed that this clause shall not merge on completion.

37. F I R B APPROVAL

The Purchaser warrants to the Vendor that if it is a "foreign corporation" or a "foreign person" as defined in the Foreign Acquisition & Takeovers Act 1975 ("the Act"), it has obtained the consent of the Foreign Investment Review Board in accordance with the provisions of the Act to its purchase of the Property. The Purchaser hereby indemnifies and holds indemnified the Vendor against all liability, loss, damage and expenses which the Vendor may suffer or incur as a direct or indirect consequence of a breach of this warranty.

38. INTEREST FOR LATE COMPLETION

(a) If the Purchaser does not complete this Contract by the later of the completion date and the date the Vendor is ready, willing and able to complete ("the effective date") the Purchaser must:

- (i) in addition to the balance of the purchase price payable on completion, pay interest on the balance of the purchase price at a rate of eight per centum (8%) per annum calculated on a daily basis from the effective date up to and including the actual date of completion

this special condition does not affect any other right, privilege, obligation or liability acquired, or accrued under this Contract.

- (b) If settlement arrangements have been made for any date being the completion date or any other earlier date as mutually agreed, and the settlement is cancelled or rescheduled due to the purchaser not been ready to complete, the purchaser must pay the sum of \$350.00 plus GST to cover extra costs and expenses incurred as a consequence of the delay, as a genuine pre- estimate of those additional expenses, to be allowed by the Purchaser, as an adjustment on completion; and
- (c) Despite sub clause (a), if the Vendor is unable or unwilling to complete by the completion date then the effective date for this Clause will be two business days after the Vendor gives written Notice to the Purchaser that he is ready, willing and able to complete.

39. NOTICE TO COMPLETE

If either party is unable or unwilling to complete by the completion date, the other party shall be entitled at any time after the completion date to serve a Notice to Complete making the time for completion essential. Such a Notice shall give not less than fourteen days notice and may nominate a specified hour on the last day as the time for completion. A Notice to Complete of such duration is considered by the parties to be reasonable and sufficient to render the time for completion essential. A party which issues a Notice to Complete is also entitled to withdraw such notice and such withdrawal shall not prejudice its right to issue a subsequent Notice.

40. RELEASE OF DEPOSIT

Notwithstanding anything else in this Contract, the Purchaser agrees to release the whole or that part of the deposit as the Vendor requires at such time as the Vendor may require to be used by the Vendor for the payment of the whole or part of a deposit payable by the Vendor on another property or payment of part of an Ingoing Contribution/Accommodation Bond payable by the vendor or the vendor's entry into a Retirement Village/Aged Care Facility or stamp duty in respect of the purchase of another property. If such release is required at the time of making this Contract, then the deposit shall be paid in the manner directed by the Solicitor for the Vendor otherwise the deposit of part thereof shall be released by the Depositholder as directed in writing by the Vendor's Solicitor without the need for any further direction or authority being given by the Purchaser or their Solicitor. The Purchaser shall not be entitled to make any claim for loss of interest which would otherwise be payable pursuant to Clause 3.

41. DEPOSIT PAYABLE WHERE RIGHT TO "COOL OFF"

If the Contract is made and the Purchaser has the right to "Cool Off" by rescinding this Contract, pursuant to Sections 66S and 66U of the Conveyancing Act 1919, as amended, the deposit may be paid as to 0.25% of the purchase price on the date of this Contract is made and as to the balance of the deposit (or the balance of the first instalment of the deposit if it is agreed that the deposit shall be paid by instalments) by 5pm on the fifth business day after the day on which this Contract is made, or if the "cooling off" period is extended, by 5 pm on the day to which the "cooling off" period is extended.

42. PURCHASER BEING A PROPRIETARY COMPANY

If the Purchaser is a corporation then this Contract has been entered into by the Vendor at the request of the Guarantors, and, as evidenced by their execution hereof, the Guarantors do hereby jointly and severally guarantee the due observance and performance by the Purchaser of all obligations on the part of the Purchaser to be observed and performed under the Contract and that the Guarantors will upon demand pay to the Vendor all monies which may become due, owing or payable by the Purchaser to the Vendor pursuant to the Contract and will be responsible for the due compliance, observance and performance of all of the obligations on the part of the Purchaser to be observed and performed to the same extent as if they were a party to the contract and this guarantee shall be a continuing joint and several guarantee and shall bind each Guarantor, and their heirs, executors, administrators and assigns and shall not be released, varied or negated by the giving of any time or the granting of any concession or waiver of any requirement or condition by the Vendor. The Guarantors do hereby jointly and severally indemnify and agree to hold indemnified the vendor against all losses, damages and expenses incurred by the Vendor as a result of any breach or default on the part of the Purchaser of any of the obligations on the part of the Purchaser to be observed and performed under the Contract.

43. INTENTIONALLY DELETED

44. LESS THAN 10% DEPOSIT ON EXCHANGE

Despite any other provision of this agreement, if the deposit agreed to be paid (or actually paid) is less than ten percent (10%) of the purchase price and the vendor becomes entitled to forfeit the deposit actually paid, the purchaser will immediately upon demand pay to the vendor the difference between the amount actually paid and the ten percent (10%) deposit.

45. REQUISITIONS ON TITLE

For the purpose of clause 5 of the standard terms, any requisitions about the property or title must be in the form of the attached Requisitions on Title. No other form of requisitions may be served by the purchasers.

46. RIGHTS OF PARTIES UPON DEATH OR MENTAL ILLNESS

Without in any manner negating limiting or restricting any rights or remedies which would have been available to either party at law or in equity had this clause not been included herein, should either party (if more than one person comprises that party, then any one of them) prior to completion;

46.1 die or become mentally ill; or

46.2 being a company, resolve to go into liquidation, have a winding up petition presented against it, enter into any scheme of arrangement with its creditors or have a liquidator, receiver or official manager appointed;

Then the other party may at any time thereafter rescind this contract by notice in writing, whereupon the provisions of clause 19 shall apply.

47. LODGEMENT OF CAVEATS AND/OR PRIORITY NOTICES

The Purchaser agrees not to lodge a caveat or priority notice in respect of their interest under this Contract pending completion thereof. A breach of this clause constitutes a breach of an essential term of the Contract entitling the Vendor to terminate the contract in accordance with clause 9.

48. SETTLEMENT ADJUSTMENT SHEET

The Purchaser shall serve the settlement adjustment statement to the Vendor at least four (4) full business days before completion. If the settlement adjustment statement and supporting certificates are not received by this date, the purchaser must pay to the Vendor's solicitor on completion the sum of \$220 to cover additional expenses involved in late execution.

GUARANTEE ANNEXURE TO CONTRACT FOR SALE OF LAND – (2018)
AS PER SPECIAL CONDITION 42

VENDOR:	Kerrie Anne Doyle
PURCHASER:	
PROPERTY:	5/22 Hercules Road, Brighton Le Sands NSW 2216

Executed by the Guarantor/s
who is/are personally known to me:

.....

Signature of Witness

.....

Signature of Guarantor

.....

Name of Witness

.....

Name of Guarantor (Printed)

.....

Address of Witness

.....

Address of Guarantor

.....

Signature of Witness

.....

Signature of Guarantor

.....

Name of Witness

.....

Name of Guarantor (Printed)

.....

Address of Witness

.....

Address of Guarantor

Conditions of Sale by Auction

Part 3, Clause 15 of the Property and Stock Agents Regulation 2014

- (1) The following conditions are prescribed as applicable to and in respect of the sale by auction of land or livestock—
 - (a) The vendor's reserve price must be given in writing to the auctioneer before the auction commences (but not if the auction relates solely to livestock).
 - (b) A bid for the vendor cannot be made unless the auctioneer has, before the commencement of the auction, announced clearly and precisely the number of bids that may be made by or on behalf of the vendor.
 - (c) The highest bidder is the purchaser, subject to any reserve price.
 - (d) In the event of a disputed bid, the auctioneer is the sole arbitrator and the auctioneer's decision is final.
 - (e) The auctioneer may refuse to accept any bid that, in the auctioneer's opinion, is not in the best interests of the vendor.
 - (f) A bidder is taken to be bidding on the bidder's own behalf unless, before bidding, the bidder has given to the auctioneer a copy of a written authority to bid for or on behalf of another person.
 - (g) A bid cannot be made or accepted after the fall of the hammer.
 - (h) As soon as practicable after the fall of the hammer the purchaser is to sign the agreement (if any) for sale.
- (2) The following conditions, in addition to those prescribed by subclause (1), are prescribed as applicable to and in respect of the sale by auction of residential property or rural land—
 - (a) All bidders must be registered in the Bidders Record and display an identifying number when making a bid.
 - (b) Subject to subclause (3), the auctioneer may make only one vendor bid at an auction for the sale of residential property or rural land and no other vendor bid may be made by the auctioneer or any other person.
 - (c) Immediately before making a vendor bid the auctioneer must announce that the bid is made on behalf of the seller or announce "vendor bid".
- (3) The following conditions, in addition to those prescribed by subclauses (1) and (2), are prescribed as applicable to and in respect of the sale by auction of co-owned residential property or rural land or the sale of such land by a seller as executor or administrator—
 - (a) More than one vendor bid may be made to purchase the interest of a co-owner.
 - (b) A bid by or on behalf of an executor or administrator may be made to purchase in that capacity.
 - (c) Before the commencement of the auction, the auctioneer must announce that bids to purchase the interest of another co-owner or to purchase as executor or administrator may be made by or on behalf of the seller.
 - (d) Before the commencement of the auction, the auctioneer must announce the bidder registration number of any co-owner, executor or administrator or any person registered to bid on behalf of any co-owner, executor or administrator.

(4) The following condition, in addition to those prescribed by subclause (1), is prescribed as applicable to and in respect of the sale by auction of livestock—The purchaser of livestock must pay the stock and station agent who conducted the auction (or under whose immediate and direct supervision the auction was conducted) or the vendor the full amount of the purchase price—

- (a) if that amount can reasonably be determined immediately after the fall of the hammer—before the close of the next business day following the auction, or
- (b) if that amount cannot reasonably be determined immediately after the fall of the hammer—before the close of the next business day following determination of that amount,

unless some other time for payment is specified in a written agreement between the purchaser and the agent or the purchaser and the vendor made before the fall of the hammer.

STRATA TITLE (RESIDENTIAL) PROPERTY REQUISITIONS ON TITLE

Vendor:
Purchaser:
Property: **Unit**
Dated:

Possession and tenancies

1. Vacant possession of the Property must be given on completion unless the Contract provides otherwise.
2. Is anyone in adverse possession of the Property or any part of it?
3.
 - (a) What are the nature and provisions of any tenancy or occupancy?
 - (b) If they are in writing, all relevant documentation should be produced, found in order and handed over on completion with notices of attornment.
 - (c) Please specify any existing breaches.
 - (d) All rent should be paid up to or beyond the date of completion.
 - (e) Please provide details of any bond together with the Rental Bond Board's reference number.
 - (f) If any bond money is held by the Rental Bond Board, the appropriate transfer documentation duly signed should be handed over on completion.
4. Is the Property affected by a protected tenancy (tenancy affected by Parts 2, 3, 4 or 5 of the *Landlord and Tenant (Amendment) Act 1948 (NSW)*)? If so, please provide details.
5. If the tenancy is subject to the *Residential Tenancies Act 2010 (NSW)*:
 - (a) has either the vendor or any predecessor or the tenant applied to the NSW Civil and Administrative Tribunal for an order?
 - (b) have any orders been made by the NSW Civil and Administrative Tribunal? If so, please provide details.

Title

6. Subject to the Contract, on completion the vendor should be registered as proprietor in fee simple of the Property free from all encumbrances and notations and recorded as the owner of the Property on the strata roll, free from all other interests.
7. On or before completion, any mortgage, caveat, writ or priority notice must be discharged, withdrawn, cancelled or removed as the case may be or, in the case of a mortgage, caveat or priority notice, an executed discharge or withdrawal or removal handed over on completion together with a notice under Section 22 of the *Strata Schemes Management Act 2015 (NSW) (Act)*.
8. Are there any proceedings pending or concluded that could result in the recording of any writ on the title to the Property or in the General Register of Deeds? If so, full details should be provided at least 14 days prior to completion.
9. When and where may the title documents be inspected?
10. Are any chattels or fixtures subject to any hiring or leasing agreement or charge or to any security interest under the *Personal Properties Securities Act 2009 (Cth)*? If so, details must be given and all indebtedness cleared and title transferred unencumbered to the vendor prior to completion.

Adjustments

11. All outgoings referred to in clause 14.1 of the Contract must be paid up to and including the date of completion.
12. Is the vendor liable to pay land tax or is the Property otherwise charged or liable to be charged with land tax? If so:
 - (a) to what year has a return been made?
 - (b) what is the taxable value of the Property for land tax purposes for the current year?
13. The vendor must serve on the purchaser a current land tax certificate (issued under Section 47 of the *Land Tax Management Act 1956 (NSW)*) at least 14 days before completion.

Survey and building

14. Subject to the Contract, survey should be satisfactory and show that the whole of the Property and the common property is available, that there are no encroachments by or upon the Property or the common property.
15. Is the vendor in possession of a survey report? If so, please produce a copy for inspection prior to completion. The original should be handed over on completion.
16. In respect of the Property and the common property:
 - (a) Have the provisions of the *Local Government Act (NSW)*, the *Environmental Planning and Assessment Act 1979 (NSW)* and their regulations been complied with?
 - (b) Is there any matter that could justify the making of an upgrading or demolition order in respect of any building or structure?
 - (c) Has the vendor a Building Information Certificate of a Building Certificate which relates to all current buildings or structures on the Property? If so, it should be handed over on completion. Please provide a copy in advance.

- (d) Has the vendor a Final Occupation Certificate (as referred to in the former s109C of the Environmental Planning and Assessment Act) or an Occupation Certificate as referred to in s6.4 of that Act for all current buildings or structures? If so, it should be handed over on completion. Please provide a copy in advance.
 - (e) In respect of any residential building work carried out in the last 7 years:
 - (i) please identify the building work carried out;
 - (ii) when was the building work completed?
 - (iii) please state the builder's name and licence number;
 - (iv) please provide details of insurance or any alternative indemnity product under the *Home Building Act 1989 (NSW)*.
 - (f) Are there any proposals by the Owners Corporation or an owner of a lot to make any additions or alterations or to erect any new structures on the common property? If so, please provide details.
 - (g) Has any work been carried out by the vendor on the Property or the common property? If so:
 - (i) has the work been carried out in accordance with the by-laws and all necessary approvals and consents?
 - (ii) does the vendor have any continuing obligations in relation to the common property affected?
17. Is the vendor aware of any proposals to:
- (a) resume the whole or any part of the Property or the common property?
 - (b) carry out building alterations to an adjoining lot which may affect the boundary of that lot or the Property?
 - (c) deal with, acquire, transfer, lease or dedicate any of the common property?
 - (d) dispose of or otherwise deal with any lot vested in the Owners Corporation?
 - (e) create, vary or extinguish any easements, restrictions or positive covenants over the Property or the common property?
 - (f) subdivide or consolidate any lots and/or any common property or to convert any lots into common property?
 - (g) grant any licence to any person, entity or authority (including the Council) to use the whole or any part of the common property?
- 18.
- (a) Has the vendor (or any predecessor) or the Owners Corporation entered into any agreement with or granted any indemnity to the Council or any other authority concerning any development on the Property or the common property?
 - (b) Is there any planning agreement or other arrangement referred to in s7.4 of the Environmental Planning and Assessment Act, (registered or unregistered) affecting the Property or the common property? If so please provide details and indicate if there are any proposals for amendment or revocation?
19. In relation to any swimming pool on the Property or the common property:
- (a) did its installation or construction commence before or after 1 August 1990?
 - (b) has the swimming pool been installed or constructed in accordance with approvals under the *Local Government Act 1919 (NSW)* and *Local Government Act 1993 (NSW)*?
 - (c) does it comply with the provisions of the *Swimming Pools Act 1992 (NSW)* and regulations relating to access? If not, please provide details or the exemptions claimed;
 - (d) have any notices or orders issued or been threatened under the *Swimming Pools Act 1992 (NSW)* or regulations?
 - (e) if a certificate of non-compliance has issued, please provide reasons for its issue if not disclosed in the contract;
 - (f) originals of certificate of compliance or non-compliance and occupation certificate should be handed over on settlement.
- 20.
- (a) Is the vendor aware of any dispute regarding boundary or dividing fences in the strata scheme?
 - (b) Is the vendor aware of any notice, claim or proceedings under the *Dividing Fences Act 1991 (NSW)* or the *Encroachment of Buildings Act 1922 (NSW)* affecting the strata scheme?

Affectations, notices and claims

21. In respect of the Property and the common property:
- (a) Is the vendor aware of any rights, licences, easements, covenants or restrictions as to use of them other than those disclosed in the Contract?
 - (b) Has any claim been made by any person to close, obstruct or limit access to or from them or to prevent the enjoyment of any easement appurtenant to them?
 - (c) Is the vendor aware of:
 - (i) any road, drain, sewer or storm water channel which intersects or runs through them?
 - (ii) any dedication to or use by the public of any right of way or other easement over any part of them?
 - (iii) any latent defects in them?
 - (d) Has the vendor any notice or knowledge of them being affected by the following:
 - (i) any notice requiring work to be done or money to be spent on them or any footpath or road adjoining? If so, such notice must be complied with prior to completion.
 - (ii) any work done or intended to be done on them or the adjacent street which may create a charge on them or the cost of which might be or become recoverable from the purchaser?
 - (iii) any sum due to any local or public authority recoverable from the purchaser? If so, it must be paid prior to completion.
 - (iv) any realignment or proposed realignment of any road adjoining them?

- (v) the existence of any contamination including, but not limited to, materials or substances dangerous to health such as asbestos and fibreglass or polyethylene or other flammable or combustible material such as cladding?
- 22.
- (a) If a licence benefits the Property please provide a copy and indicate:
 - (i) whether there are any existing breaches by any party to it;
 - (ii) whether there are any matters in dispute; and
 - (ii) whether the licensor holds any deposit, bond or guarantee.
 - (b) In relation to such licence:
 - (i) All licence fees and other moneys payable should be paid up to and beyond the date of completion;
 - (ii) The vendor must comply with all requirements to allow the benefit to pass to the purchaser.
- Applications, Orders etc**
23. Are there any applications made, proposed or threatened, whether by an owner of a lot or the Owners Corporation, to the NSW Civil and Administrative Tribunal, any Court or to the Registrar General for orders relating to the strata scheme, the Property or the common property (including orders to vary the strata scheme consequent upon damage or destruction or to terminate the strata scheme) which are yet to be determined? If so, please provide particulars.
24. Are there any mediations currently being conducted by the Commissioner of Fair Trading, Department of Finance Services and Innovation in relation to the Property or the common property which involve the vendor or the Owners Corporation? If so, please provide particulars.
25. Are there any:
- (a) orders of the Tribunal;
 - (b) notices of or investigations by the Owners Corporation;
 - (c) notices or orders issued by any Court; or
 - (d) notices or orders issued by the Council or any public authority or water authority,
- affecting the Property or the common property not yet complied with? In so far as they impose an obligation on the vendor they should be complied with by the vendor before completion.
26. Have any orders been made by any Court or Tribunal that money (including costs) payable by the Owners Corporation be paid from contributions levied in relation to the Property? If so, please provide particulars.
27. Has the vendor made any complaints or been the subject of any complaints arising out of noise affecting the Property or emanating from the Property?
28. Has any proposal been given by any person or entity to the Owners Corporation or to the Vendor for:
- (a) a collective sale of the strata scheme; or
 - (b) a redevelopment of the strata scheme (including a strata renewal proposal)?
- If so, please provide particulars of the proposal and the steps taken and decisions made in relation to the proposal to the present time.
- Owners Corporation management**
29. Has the initial period expired?
30. Are any actions proposed to be taken or have any been taken by the Owners Corporation in the initial period which would be in breach of its powers without an order authorising them?
31. If the Property includes a utility lot, please specify the restrictions.
32. Do any special expenses (as defined in clause 23.2 of the Contract, including any liabilities of the Owners Corporation) exceed 1% of the price?
33. Has an appointment of a strata managing agent and/or a building manager been made? If so:
- (a) who has been appointed to each role;
 - (b) when does the term of each appointment expire; and
 - (c) what functions have been delegated to the strata managing agent and/or the building manager.
34. Has the Owners Corporation entered into any agreement to provide amenities or services to the Property? If so, please provide particulars.
35. Has a resolution been passed for the distribution of surplus money from the administrative fund or the capital works fund? If so, please provide particulars.
36. Have the by-laws adopted a common property memorandum as prescribed by the regulations for the purposes of Section 107 of the Act? If so, has the memorandum been modified? Please provide particulars.
37. Is there a registered building management statement pursuant to Section 108 of the *Strata Schemes Development Act 2015 (NSW)*? If so, are there any proposals to amend the registered building management statement?
38. If the strata scheme was in existence at 30 November 2016, has the Owners Corporation taken steps to review the by-laws that were current at that date and have they been consolidated? If so, please provide particulars.
39. Are there any pending proposals to amend or repeal the current by-laws or to add to them?
40. Are there any proposals, policies or by-laws in relation to the conferral of common property rights or which deal with short term licences and/or holiday lettings?
41. If not attached to the Contract, a strata information certificate under Section 184 of the Act should be served on the purchaser at least 7 days prior to completion.
42. Has the Owners Corporation met all of its obligations under the Act relating to:
- (a) insurances;
 - (b) fire safety;
 - (c) occupational health and safety;
 - (d) building defects and rectification in relation to any applicable warranties under the *Home Building Act 1989 (NSW)*;

- (e) the preparation and review of the 10 year plan for the capital works fund; and
(f) repair and maintenance.
43. Is the secretary of the Owners Corporation in receipt of a building bond for any building work on a building that is part of the Property or the common property?
44. Has an internal dispute resolution process been established? If so, what are its terms?
45. Has the Owners Corporation complied with its obligation to lodge tax returns with the Australian Taxation Office and has all tax liability been paid?

Capacity

46. If the Contract discloses that the vendor is a trustee, evidence should be produced to establish the trustee's power of sale.

Requisitions and transfer

47. If not attached to the Contract and the transaction is not an excluded transaction, any *clearance certificate* under Section 14-220 of Schedule 1 of the *Taxation Administration Act 1953 (Cth)* should be served on the purchaser at least 7 days prior to completion.
48. The vendor should furnish completed details within the time specified in the contract, sufficient to enable the purchaser to make any RW payment.
49. If the transfer or any other document to be handed over on completion is executed pursuant to a power of attorney, then at least 7 days prior to completion a copy of the registered power of attorney should be produced and found in order.
50. If the vendor has or is entitled to have possession of the title deeds the Certificate Authentication Code must be provided 7 days prior to settlement.
51. Searches, surveys, enquiries and inspection of title deeds must prove satisfactory.
52. The purchaser reserves the right to make further requisitions prior to completion.
53. Unless we are advised by you to the contrary prior to completion, it will be assumed that your replies to these requisitions remain unchanged as at the completion date.

Replies to Requisitions

Possession and Tenancies

1. Refer to Contract. Vacant possession will not be provided
2. Not so far as the vendor is aware
3. (a) Refer to Contract
(b) Refer to Contract
(c) Vendor is not aware of any existing breaches.
(d) Refer to Contract
(e) Refer to managing agent
(f) refer to managing agent
4. No
5. (a) Not as far as the vendor is aware
(b) Not as far as the vendor is aware.

Title

6. Noted.
7. Noted.
8. Not as far as the vendor is aware.
9. The certificate of Title has been converted electronically and can be viewed through PEXA.
10. No.

Adjustments

11. Noted.
12. See the contract as to adjustments and the s47 certificate.
13. Noted.

Survey and Building

14. Noted.
15. No.
16. (a) – (g) This is a matter for search. Authority to inspect the Strata Records can be provided if required.
17. (a) – (g) - This is a matter for search. Authority to inspect the Strata Records can be provided if required.
18. (a) – (b) This is a matter for search. Authority to inspect the Strata Records can be provided if required.
19. (a) – (f) There is no swimming pool.
20. (a) No.
(b) No.

Affections, notices and claims

21. (a) – (d) Other than disclosed in the contract, no. Purchasers to make and rely on their own enquiries.
22. (a)-(b) Not applicable.

Applications, Orders etc

23. Not so far as the Vendor is aware.
24. Not that the Vendor is aware.
25. (a) – (d) Not so far as the Vendor is aware.

Sydney Office

P: 1300 120 087 | F: (02) 4367 5319
M: 0405 084 423 | E: kylie@wconveyancing.com.au
A: Level 8, 25 Restwell Street, Bankstown
Post: PO Box 3756, Erina NSW 2250

Central Coast Office

P: 1300 120 087 | F: (02) 4367 5319
E: info@wconveyancing.com.au
A: Platinum Building, West Wing, 3.31/4 Ilya Avenue, Erina
Post: PO Box 3756, Erina NSW 2250

Miranda Office

By Appointment Only

- 26. This is a matter for search.
- 27. No.
- 28. (a) – (b) This is a matter for search.

Owners Corporation management

- 29. Yes.
- 30. Not so far as the Vendor is aware.
- 31. Not applicable.
- 32. This is a matter for search.
- 33. (a) – (c) Refer to Contract
- 34. This is a matter for search. Purchaser to make and rely on own enquiries.
- 35. This is a matter for search. Purchaser to make and rely on own enquiries.
- 36. Refer to Contract
- 37. This is a matter for search. Purchaser to make and rely on own enquiries.
- 38. This is a matter for search. Purchaser to make and rely on own enquiries.
- 39. This is a matter for search. Purchaser to make and rely on own enquiries.
- 40. This is a matter for search. Purchaser to make and rely on own enquiries.
- 41. Refer to the Special Conditions of the Contract. Purchaser to order S184 Certificate.
- 42. (a) – (f) This is a matter for search. Purchaser to make and rely on own enquiries.
- 43. The Vendor is not aware. Purchaser to make and rely on own enquiries.
- 44. The Vendor is not aware.
- 45. The Vendor is not aware.

Capacity

- 46. The Vendor is not a Trustee.

Requisitions and Transfer

- 47. Vendor relies on Contract.
- 48. Not applicable.
- 49. Not applicable.
- 50. Not agreed.
- 51. Noted subject to Contract.
- 52. Right not admitted.
- 53. Not agreed.



LAND
REGISTRY
SERVICES
NEW SOUTH WALES LAND REGISTRY SERVICES - TITLE SEARCH

Title Search

Information Provided Through
Triconvey (Reseller)
Ph. 1300 064 452 Fax.

FOLIO: 5/SP11967

SEARCH DATE -----	TIME -----	EDITION NO -----	DATE -----
16/6/2022	9:12 AM	8	1/3/2022

LAND

LOT 5 IN STRATA PLAN 11967
AT BRIGHTON
LOCAL GOVERNMENT AREA BAYSIDE

FIRST SCHEDULE

KERRIE ANNE DOYLE

(T AG274819)

SECOND SCHEDULE (2 NOTIFICATIONS)

1 INTERESTS RECORDED ON REGISTER FOLIO CP/SP11967
2 AR926902 MORTGAGE TO SUNCORP-METWAY LIMITED

NOTATIONS

UNREGISTERED DEALINGS: NIL

*** END OF SEARCH ***

22:0268

PRINTED ON 16/6/2022

* Any entries preceded by an asterisk do not appear on the current edition of the Certificate of Title. Warning: the information appearing under notations has not been formally recorded in the Register. InfoTrack an approved NSW Information Broker hereby certifies that the information contained in this document has been provided electronically by the Registrar General in accordance with Section 96B(2) of the Real Property Act 1900.

Copyright © Office of the Registrar-General 2022

Received: 16/06/2022 09:12:07



FOLIO: CP/SP11967

SEARCH DATE	TIME	EDITION NO	DATE
-----	----	-----	----
16/6/2022	9:12 AM	8	2/5/2022

LAND

THE COMMON PROPERTY IN THE STRATA SCHEME BASED ON STRATA PLAN 11967
WITHIN THE PARCEL SHOWN IN THE TITLE DIAGRAM

AT BRIGHTON
LOCAL GOVERNMENT AREA BAYSIDE
PARISH OF ST GEORGE COUNTY OF CUMBERLAND
TITLE DIAGRAM SHEET 1 SP11967

FIRST SCHEDULE

THE OWNERS - STRATA PLAN NO. 11967
ADDRESS FOR SERVICE OF DOCUMENTS:
THE OWNERS - STRATA PLAN 11967
C/- STRATA MANAGEMENT SERVICES NSW
SUITE 9/29-31 CROYDON STREET
CRONULLA NSW 2230

SECOND SCHEDULE (3 NOTIFICATIONS)

1 RESERVATIONS AND CONDITIONS IN THE CROWN GRANT(S)
2 AM707769 INITIAL PERIOD EXPIRED
3 AQ166739 CONSOLIDATION OF REGISTERED BY-LAWS

SCHEDULE OF UNIT ENTITLEMENT (AGGREGATE: 1000)

STRATA PLAN 11967

LOT	ENT	LOT	ENT	LOT	ENT	LOT	ENT
1	- 56	2	- 55	3	- 56	4	- 56
5	- 55	6	- 56	7	- 56	8	- 55
9	- 56	10	- 55	11	- 55	12	- 55
13	- 56	14	- 55	15	- 56	16	- 56
17	- 55	18	- 56				

NOTATIONS

UNREGISTERED DEALINGS: NIL

*** END OF SEARCH ***

22:0268

PRINTED ON 16/6/2022

* Any entries preceded by an asterisk do not appear on the current edition of the Certificate of Title. Warning: the information appearing under notations has not been formally recorded in the Register. InfoTrack an approved NSW Information Broker hereby certifies that the information contained in this document has been provided electronically by the Registrar General in accordance with Section 96B(2) of the Real Property Act 1900.

Copyright © Office of the Registrar-General 2022

Received: 16/06/2022 09:12:08

FORM 1

WARNING: CREASING OR FOLDING WILL LEAD TO REJECTION

COUNCIL'S CERTIFICATE

The Council of the City of **ROCKDALE** has examined the plans and documents submitted in support of the application for a Certificate of Title for the land shown in the plans and documents and has been satisfied that the application complies with the provisions of the proposed legislation and has accordingly resolved to issue a Certificate of Title for the land shown in the plans and documents.

On **22-09-1975**
Signature No. **54715**
Council Clerk

SURVEYOR'S CERTIFICATE

GARRY REGINALD FULLER
32 PRESIDENT AVE CARINGBAH
I, the undersigned, being a duly qualified and registered Surveyor under the Surveyors Act, 1923, hereby certify that:-

(1) any well, the inner surface of any part of which containing water is a boundary of a proposed lot, is shown in the accompanying plan as a boundary of a proposed lot, and

(2) any fence or wall, the upper or outer surface of any part of which forms a boundary of a proposed lot, is shown in the accompanying plan, and

(3) any well, floor, ceiling or structural ceiling space, by reference to any plan, is shown in the accompanying plan as a boundary of a proposed lot, and

(4) any building containing proposed lots shown on the land shown on the accompanying plan, and each proposed lot is shown on the accompanying plan as a boundary of a proposed lot, and

(5) the area of the land shown on the accompanying plan is as shown in the accompanying plan.

This is sheet 1 of my Plan in 2 sheets.

PLAN OF

SUBDIVISION OF LOT 1 D.P. 577143

Municipality: **ROCKDALE**

Locality: **BRIGHTON**

Parish: **ST. GEORGE**

County: **CUMBERLAND**

Reduction Ratio 1: 400

Lengths are in metres

STRATA PLAN 11967

Registered
C.A. NOSH/75 OF 22.9.1975
Purpose: STRATA PLAN
Ref. Map: ROCKDALE SH.11
Last Plan: DP577143 (DP5190#)

Name of and *address for service of notices on, the body corporate
*Address required on original strata plan only.

THE REGISTERED PROPRIETORS STRATA PLAN NO 11967
NO22 HERCULES ROAD, BRIGHTON. 2216

The Official Seal for New South Wales
THE UNION FIDELITY TRUSTEE
COMPANY OF AUSTRALIA LIMITED
was, hereon, issued by order of the Directors
and in the presence of:-

MANAGER
2089

PROGRESSIVE FINANCE CO. PTY. LIMITED
COMMON SEAL

RAV. LEH. NO. 3 PTY. LIMITED
COMMON SEAL

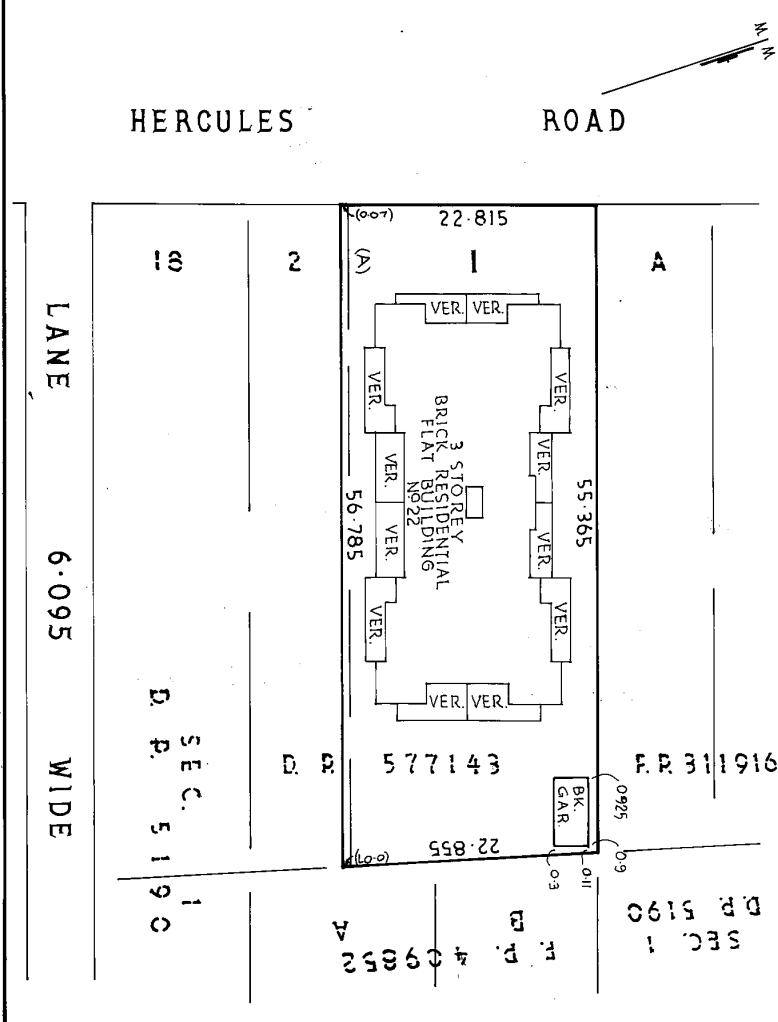

MPD

SURVEYOR'S REFERENCE: 11240

Plan Drawing only to appear in this space

Plan Drawing only to appear in this space

FORM 2

WARNING: CREASING OR FOLDING WILL LEAD TO REJECTION

Sheet No. 2 of 2 Sheets

STRATA PLAN 11967

SECOND FLOOR

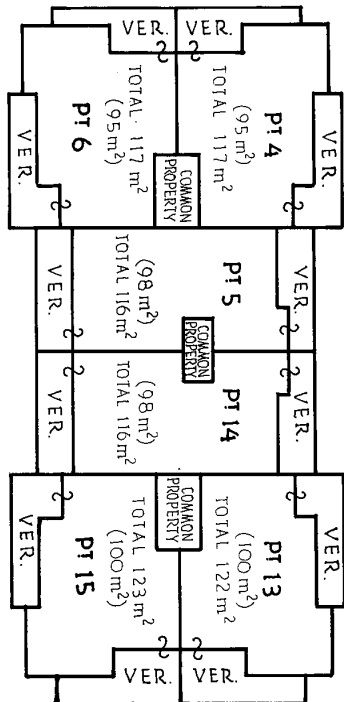

THIRD FLOOR

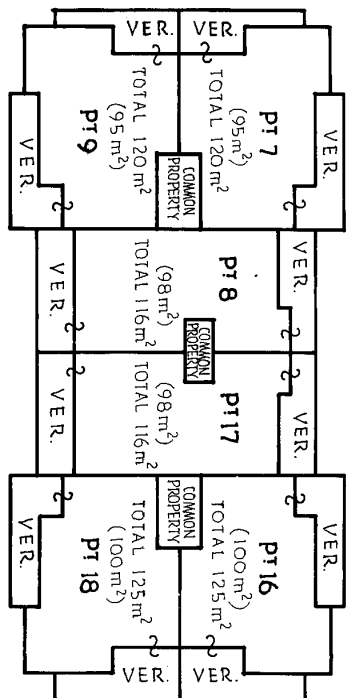

FIRST FLOOR

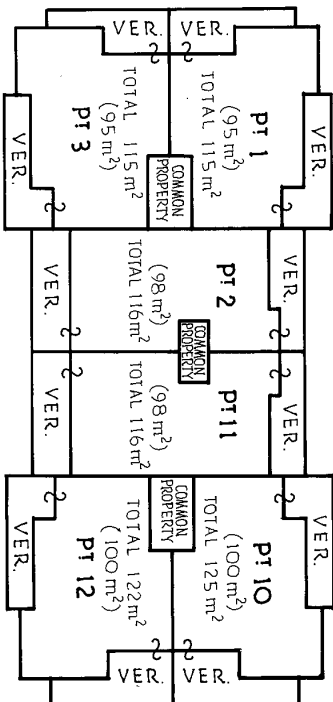

GROUND FLOOR

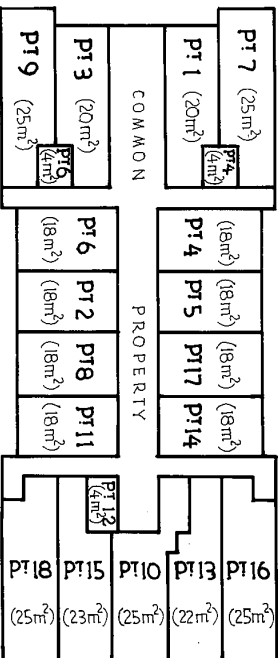

AREAS INCLUDE VERANDAHS
VERANDAHS ARE TO A HEIGHT
OF 2.745 ABOVE UPPER SURFACE
OF VERANDAH FLOOR EXCEPT
WHERE COVERED
GARAGES ARE BOUNDED BY
BRICK WALLS

PI12 (18m²)

SCHEDULE OF UNIT ENTITLEMENT

LOT NO	UNIT ENTITLEMENT
1	56
2	55
3	56
4	56
5	55
6	56
7	56
8	55
9	56
10	55
11	55
12	55
13	56
14	55
15	56
16	56
17	55
18	56
AGGREGATE	1000

Reduction Ratio 1: 250

Lengths are in metres



SURVEYOR'S REFERENCE: 11240

Registered Surveyor

Surveyor

Form: 15CH
Release: 1d

**CONSOLIDATION/
CHANGE OF BY-LAWS**

New South Wales
Strata Schemes Management Act 20
Real Property Act 1900



AM707769N

PRIVACY NOTE: Section 31B of the Real Property Act 1900 (RP Act) authorises the Registrar General to collect the information required by this form for the establishment and maintenance of the Real Property Act Register. Section 96B RP Act requires that the Register is made available to any person for search upon payment of a fee, if any.

- (A) **TORRENS TITLE** For the common property
CP11967
- (B) **LODGED BY**
- | | | |
|---|--|-------------------|
| Document
Collection
Box 377X
38121 | Name, Address or DX, Telephone, and Customer Account Number if any
Strata Management Center Pty Ltd ABN 28 002 824
P.O.Box 166
Caringbah NSW 2229
Reference: Gary Adamson (02) 9523 0466 | CODE
CH |
|---|--|-------------------|
- (C) The Owners-Strata Plan No. 11967 certify that pursuant to a resolution passed on 8/3/2017 and
- (D) in accordance with the provisions of Section 141 of the Strata Scheme Management Act 2015
the by-laws are changed as follows—
- (E) Repealed by-law No. Strata Scheme Management Act 1996
Added by-law No. 1-19 and Special By Law 1-3
Amended by-law No. NOT APPLICABLE
as fully set out below:
See Annexure A attached hereto

- (F) A consolidated list of by-laws affecting the above mentioned strata scheme and incorporating the change referred to at Note (E) is annexed hereto and marked as Annexure
- (G) The seal of The Owners-Strata Plan No. 11967 was affixed on 8/3/2017 in the presence of the following person(s) authorised by section 273 Strata Management Act 2015 to attest the affixing of the seal:

Signature: [Signature]

Name: GARY ADAMSON

Authority: STRATA MANAGER

Signature: _____

Name: _____

Authority: _____



on COBL
df COBL
AM69567
df Ci
AM69567
on Ci

N

Strata Plan 11967

Annexure "A"

SCHEDULE 2 – By-laws for pre-1996 strata schemes

(Clause 35)

1 Noise

An owner or occupier of a lot must not create any noise on the parcel likely to interfere with the peaceful enjoyment of the owner or occupier of another lot or of any person lawfully using common property.

2 Vehicles

An owner or occupier of a lot must not park or stand any motor or other vehicle on common property except with the written approval of the owners corporation.

3 Obstruction of common property

An owner or occupier of a lot must not obstruct lawful use of common property by any person.

4 Damage to lawns and plants on common property

An owner or occupier of a lot must not:

(a) damage any lawn, garden, tree, shrub, plant or flower being part of or situated on common property, or

(b) use for his or her own purposes as a garden any portion of the common property.

5 Damage to common property

(1) An owner or occupier of a lot must not mark, paint, drive nails or screws or the like into, or otherwise damage or deface, any structure that forms part of the common property without the approval in writing of the owners corporation.

(2) An approval given by the owners corporation under clause (1) cannot authorise any additions to the common property.

(3) This by-law does not prevent an owner or person authorised by an owner from installing:

(a) any locking or other safety device for protection of the owner's lot against intruders, or

(b) any screen or other device to prevent entry of animals or insects on the lot, or

(c) any structure or device to prevent harm to children.

(4) Any such locking or safety device, screen, other device or structure must be installed in a competent and proper manner and must have an appearance, after it has been installed, in keeping with the appearance of the rest of the building.



(5) Despite section 106 of the Strata Schemes Management Act 2015 , the owner of a lot must maintain and keep in a state of good and serviceable repair any installation or structure referred to in clause (3) that forms part of the common property and that services the lot.

6 Behaviour of owners and occupiers

An owner or occupier of a lot when on common property must be adequately clothed and must not use language or behave in a manner likely to cause offence or embarrassment to the owner or occupier of another lot or to any person lawfully using common property.

7 Children playing on common property in building

An owner or occupier of a lot must not permit any child of whom the owner or occupier has control to play on common property within the building or, unless accompanied by an adult exercising effective control, to be or to remain on common property comprising a laundry, car parking area or other area of possible danger or hazard to children.

8 Behaviour of invitees

An owner or occupier of a lot must take all reasonable steps to ensure that invitees of the owner or occupier do not behave in a manner likely to interfere with the peaceful enjoyment of the owner or occupier of another lot or any person lawfully using common property.

9 Depositing rubbish and other material on common property

An owner or occupier of a lot must not deposit or throw on the common property any rubbish, dirt, dust or other material likely to interfere with the peaceful enjoyment of the owner or occupier of another lot or of any person lawfully using the common property.

10 Drying of laundry items

An owner or occupier of a lot must not, except with the consent in writing of the owners corporation, hang any washing, towel, bedding, clothing or other article on any part of the parcel in such a way as to be visible from outside the building other than on any lines provided by the owners corporation for the purpose and there only for a reasonable period.

11 Cleaning windows and doors

An owner or occupier of a lot must keep clean all glass in windows and all doors on the boundary of the lot, including so much as is common property.

12 Storage of inflammable liquids and other substances and materials

(1) An owner or occupier of a lot must not, except with the approval in writing of the owners corporation, use or store on the lot or on the common property any inflammable chemical, liquid or gas or other inflammable material.

(2) This by-law does not apply to chemicals, liquids, gases or other material used or intended to be used for domestic purposes, or any chemical, liquid, gas or other material in a fuel tank of a motor vehicle or internal combustion engine.

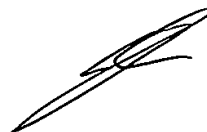

13 Moving furniture and other objects on or through common property

An owner or occupier of a lot must not transport any furniture or large object through or on common property within the building unless sufficient notice has first been given to the strata committee so as to enable the strata committee to arrange for its nominee to be present at the time when the owner or occupier does so.

14 Floor coverings

(1) An owner of a lot must ensure that all floor space within the lot is covered or otherwise treated to an extent sufficient to prevent the transmission from the floor space of noise likely to disturb the peaceful enjoyment of the owner or occupier of another lot.

(2) This by-law does not apply to floor space comprising a kitchen, laundry, lavatory or bathroom.

15 Garbage disposal

An owner or occupier of a lot:

(a) must maintain within the lot, or on such part of the common property as may be authorised by the owners corporation, in clean and dry condition and adequately covered a receptacle for garbage, and

(b) must ensure that before refuse is placed in the receptacle it is securely wrapped or, in the case of tins or other containers, completely drained, and

(c) for the purpose of having the garbage collected, must place the receptacle within an area designated for that purpose by the owners corporation and at a time not more than 12 hours before the time at which garbage is normally collected, and

(d) when the garbage has been collected, must promptly return the receptacle to the lot or other area referred to in paragraph (a), and

(e) must not place any thing in the receptacle of the owner or occupier of any other lot except with the permission of that owner or occupier, and

(f) must promptly remove any thing which the owner, occupier or garbage collector may have spilled from the receptacle and must take such action as may be necessary to clean the area within which that thing was spilled.

16 Keeping of animals

(1) Subject to section 157 of the Strata Schemes Management Act 2015, an owner or occupier of a lot must not, without the approval in writing of the owners corporation, keep any animal on the lot or the common property.

(2) The owners corporation must not unreasonably withhold its approval of the keeping of an animal on a lot or the common property.



17 Appearance of lot

(1) The owner or occupier of a lot must not, without the written consent of the owners corporation, maintain within the lot anything visible from outside the lot that, viewed from outside the lot, is not in keeping with the rest of the building.

(2) This by-law does not apply to the hanging of any washing, towel, bedding, clothing or other article as referred to in by-law 10.

18 Notice board

An owners corporation must cause a notice board to be affixed to some part of the common property.

19 Change in use of lot to be notified

An occupier of a lot must notify the owners corporation if the occupier changes the existing use of the lot in a way that may affect the insurance premiums for the strata scheme (for example, if the change of use results in a hazardous activity being carried out on the lot, or results in the lot being used for commercial or industrial purposes rather than residential purposes).



Special By-Law 1 – Occupiers Damage

- (1) An owner of a lot (called "the Owner") must do the following on each occasion that the occupancy (whether pursuant to a lease or oral or written license agreement to occupy the lot) of the lot changes:
 - (a) notify the Owners Corporation of the full names of all the occupants of the lot (called "the Occupants"); and
 - (b) pay the Owners Corporation the sum of \$200 within 7 days of the Occupants taking occupation of the lot;
- (2) The Owners Corporation must do the following:
 - (a) keep a record of the notices received from Owners pursuant to this bylaw;
 - (b) keep a record of the amounts of money received from Owners pursuant to this bylaw;
 - (c) apply the amounts of money received from Owners pursuant to this bylaw towards:
 - (i) the repair of damage caused from time to time to the common property that has occurred:
 - (A) during the removal and delivery of goods and furniture at the time of such changes of occupancy of lots;
 - (B) through carelessness, maliciously or otherwise by any Occupants or any of the Occupants' invitees or visitors or guests;

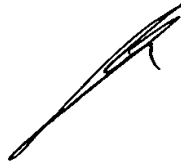

Special By-Law 2 – Enclosure of Verandahs

1. Introduction

- 1.1 This by-law authorises Works to be conducted on Common Property by the Owner.
- 1.2 This by-law further grants to the Owner exclusive use of so much of the Works as comprise part of the Common Property so that the Owner may use and enjoy the benefit of the Works on certain terms and conditions.

2. Definitions & Interpretation

1.3 In this by-law:

"Building" means the building to which the Works are attached.

"Common Property" means the common property for the Strata Scheme.

"Development Act" means the Strata Schemes (Freehold Development) Act 1973.

"Executive Committee" means the executive committee of the Owners Corporation.

"Lot" means all lots within the Strata Scheme and "Lots" means two or more of those lots.

"Management Act" means the Strata Schemes Management Act 1996.

"Occupier" means an Occupier of a lot within the Strata Scheme and includes, without limiting the generality of the foregoing, lessees and licensees.

"Owner" means the owner of a Lot and that owner's successors in title. Any obligation on or reference to an Owner in respect of any Works relates only to Works which benefit that Owner's Lot or enclose that Owner's Verandah, having been carried out by that Owner or a previous owner of that Owner's Lot.

"Owners Corporation" means the owners corporation for the Strata Scheme.

"Strata Managing Agent" means a strata managing agent appointed to the Strata Scheme pursuant to the Management Act.

"Strata Plan" means the strata plan for the Strata Scheme.

"Strata Scheme" means the Strata Scheme in respect of this by-law applies.

"Strata Legislation" means the Development Act and the Management Act.

"Verandah" means that part of a lot marked "VER" on the strata plan and denoted as "VERANDAHS" on the Strata Plan, provided that this by-law only applies to Works on a south or north facing Verandah.

"Works" means the enclosure of an Owner's Verandah (but only a south or north facing Verandah), with glass or such other material as approved by the Owners Corporation, including such ancillary works as are reasonably required.

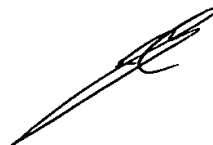

abundant clarity, this by-law does not give an owner the right to do Works in relation to, or enclose, any verandah or balcony that faces east or west, such as a verandah fronting Hercules Road or one facing the back of the strata scheme.

2.1 In this by-law:

- 2.2.1 headings have been inserted for guidance only and do not affect the interpretation of this by-law,
- 2.2.2 references to any statutory or like provisions include any statutory or like provisions amending, consolidating or replacing the same, and all by-laws, ordinances, proclamations, regulations, rules and other authorities made under them,
- 2.2.3 words importing the singular number include the plural and vice versa,
- 2.2.4 words importing the masculine, feminine or neuter gender include both of the other two genders,
- 2.2.5 where any word or phrase is given a definite meaning any part of speech or other grammatical form in respect of that word or phrase has a corresponding meaning,
- 2.2.6 where any decision needs to be made by the Owners Corporation that decision may be made by the Executive Committee unless the decision would constitute a decision on any matter or type of matter that the Owners Corporation has determined in general meeting is to be decided only by the Owners Corporation in general meeting or is a decision which can only be made by the Owners Corporation in general meeting pursuant to the Strata Legislation,
- 2.2.7 any expression used in this by-law and which is defined in the Strata Legislation will have the same meaning as that expression has in that legislation unless a contrary intention is expressed in this by-law, and
- 2.2.8 if there is any inconsistency between this by-law and any other by-law applicable to the Strata Scheme, then the provisions of this by-law will prevail to the extent of that inconsistency.

3. Authorisation and Right of Exclusive Use

3.1 Authorisation

- 3.1.1 For the purpose of improving or enhancing the Common Property the Owner may (at that Owner's sole cost) conduct the Works on the Common Property. The owners corporation consents to any application for development approval or a construction certificate in relation to those Works and must within 7 days of request from an Owner seal, and authorises its strata managing agent to seal on its behalf, any such application (for development approval or a construction certificate).



3.2 The Grant of Exclusive Use

- 3.2.1 The Owner will have a right of exclusive use and enjoyment of so much of the Works as comprise part of the Common Property on the terms and conditions set out in this by-law.

3.3 Rights of the Owners Corporation

- 3.3.1 The right of exclusive use and enjoyment granted to the Owner is subject to the Owners Corporation being able to obtain access to and the use of any part of that Common Property required for the purposes of fulfilling any obligation which the Owners Corporation may have under the Strata Legislation or any other law.

3.4 Responsibility for Maintenance and Upkeep

- 3.4.1 The Owner is responsible at all times for the proper maintenance of, and keeping in a state of good and serviceable repair, the Works and, when necessary, renewing or

4. Terms & Conditions

4.1 Before Commencement of the Works

- 4.1.1.1 give the Owners Corporation at least 30 days' notice of the commencement of the Works;
- 4.1.1.2 if approval is required, obtain and provide to the Owners Corporation a copy of any certificates issued under the *Environmental Planning and Assessment Act 1979* which are required to permit the Works to commence, such as a construction certificate and a development approval,
- 4.1.1.3 if the Works on a Lot are for the prescribed amount:
- (a) enter into a contract in conformity with and meeting the requirements of the *Home Building Act 1989* with a contractor licensed to perform residential building work; and
 - (b) obtain and provide to the Owners Corporation a certificate of insurance evidencing any contract of Home Warranty Insurance required under Part 6 of the *Home Building Act 1989* for the Works,
- 4.1.1.4 obtain and provide to the Owners Corporation a copy of a certificate of insurance evidencing a contractors all risk insurance policy which is current and which includes public liability cover of not less than \$10 million in respect of any claim noting the interests of the Owners Corporation on the policy
- 4.1.1.5 if not already provided by an Owner or an Owner's predecessor in title, provide his written consent to this by-law, and
- 4.1.1.6 if requested by the Owners Corporation (acting reasonably), provide to the Owners Corporation a certificate from a qualified engineer addressed to the Owners Corporation certifying that the Works will not affect the structural integrity of the Building.

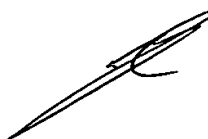

4.1.2 If the Owner does not comply with the conditions set out in clause 4.1.1 the Owner must not carry out the Works and, if already commenced, the Works must be stopped immediately. If the Owner does not comply with the conditions set out in clause 4.1.1 within 90 days of stopping the Works, then the Owner must (in a proper and workmanlike manner) within a further 30 days reinstate the Common Property to its former condition.

4.1.3 The Works must not be conducted until this by-law is registered.

4.2 During the Conduct of the Works

4.2.1 During the Works the Owner must:

4.2.1.1 Standard of Workmanship

ensure the Works are carried out in a proper and workmanlike manner by appropriately qualified and licensed tradespersons utilising only first quality materials which are good and suitable for the purpose for which they are used,

4.2.1.2 Time for Completion of Works

make sure the Works are carried out with due diligence and are completed within 60 days of commencement,

4.2.1.3 Appearance of the Works

ensure the Works are carried out and completed in a manner which is in keeping with the rest of the Strata Scheme or any manner designated by the Owners Corporation, so that the Works on all Lots are consistent in appearance,

4.2.1.4 Quality of the Works

make certain the Works are in accordance with any specification,

4.2.1.5 Variation to Works

not vary the Works without obtaining the prior written approval of the Owners Corporation,

4.2.1.6 Supervision of the Works

ensure that the Works are adequately supervised and that the Common Property is inspected on a daily basis to ensure that the conditions of this by-law are complied with,

4.2.1.7 Noise During Works

ensure the Works and tradespersons carrying out the Works do not create any excessive noise within the Strata Scheme that is likely to interfere with the peaceful enjoyment of the occupier of another lot or of any person lawfully using the Common Property,

4.2.1.8 Transportation of Construction Equipment

ensure that all construction materials and equipment are transported in accordance with any manner reasonably



directed by the Owners Corporation,

4.2.1.9 Debris

ensure that any debris is removed from the Common Property daily and strictly in accordance with the reasonable directions of the Owners Corporation,

4.2.1.10 Storage of Building Materials on Common Property

make sure that no building materials are stored on Common Property,

4.2.1.11 Protection of Common Property

- (i) protect all areas of the Common Property which are affected by the works from damage, the entry of water and from dirt, dust and debris relating to the Works and ensure that all Common Property is protected from damage throughout the course of the works.
- (ii) keep all parts of the Common Property affected by the Works.

4.2.1.12 Daily Cleaning

clean any part of the Common Property affected by the Works on a daily basis and keep all parts of the Common Property clean, neat and tidy during the Works,

4.2.1.13 Times for Renovations

ensure that the Works are only carried out between the hours of 8.00 am - 4.30 pm on Monday - Friday and are not performed on weekends or public holidays,

4.2.1.14 Times for Operation of Noisy Equipment

make sure that percussion tools and noisy equipment such as jack hammers and tile cutters are only used between 10:00 am – 3:00 pm,

4.2.1.15 Interruption to Services

give the occupiers of other lots at least 48 hours prior notice of any planned interruption to the services in the Strata Scheme such as water, electricity, television, cable television,

4.2.1.16 Vehicles

ensure that no tradesperson's vehicles obstruct the Common Property other than on a temporary and non-recurring basis when delivering or removing materials or equipment and then only for such time as is reasonably necessary,

4.2.1.17 Costs of All Works

pay all costs associated with the Works,

4.2.1.18 Comply with All Laws

comply with all statutes, by-laws, regulations, rules and other laws for the time being in force and which are applicable to the Works, and

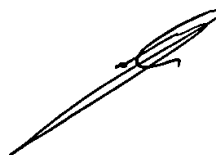

4.2.1.19 Right of Access

give the Owners Corporation's nominated representative(s) access to inspect the Works within 48 hours of any requests from the Owners Corporation.

4.3 After the Conduct of the Works

After the Works are complete the Owner must

4.3.1.1 promptly notify the Owners Corporation that the Works are complete,

4.3.1.2 obtain and give the Owners Corporation a copy of all requisite certificates issued under Part 4A of the *Environmental Planning and Assessment Act 1979* approving the Works and the occupation of the Lot (where required), for example, any necessary compliance certificate or occupation certificate,

4.3.1.3 restore all Common Property damaged or affected by the Works as nearly as possible to the state which they were in immediately prior to commencement of the Works,

4.3.1.4 provide the Owners Corporation's nominated representative(s) access to inspect the Works within 48 hours of any request from the Owners Corporation, in order to ascertain compliance with this by-law (the Owners Corporation's right to inspect the Works will expire once it is reasonably satisfied that the conditions of this by-law have been complied with),

4.3.1.5 if requested by the Owners Corporation (acting reasonably), provide the Owners corporation with a certificate from a duly qualified engineer addressed to the Owners Corporation certifying that the Works have been completed in a manner that will not affect the structural integrity of the Building.

4.4 Enduring Obligations The Owner must:

4.4.1 make good any damage to another lot or the Common Property caused by the Works no matter when such damage may become evident,

4.4.2 notify the Owners Corporation that any damage to another lot or the Common Property caused by the Works has been repaired, and

4.4.3 comply with all statutes, by-laws, regulations, rules and other laws for the time being in force and which are applicable to the Works (for example, the conditions of the Local Council's approval for the Works), and

4.4.4 ensure that the Works do not create any excessive noise or otherwise intervene with the peaceful enjoyment of the occupier of another lot or of any person

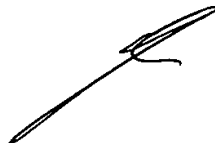

4.5 Indemnity

The Owner indemnifies and keeps indemnified the Owners Corporation against all actions, proceedings, claims, demands, costs, damages and expenses which may be incurred by or brought or made against the Owners Corporation arising out of the Works or the altered state or use of the Common Property arising therefrom.

4.6 Access

The Owners Corporation must give the Owner and the Owner's tradespersons reasonable access through the Common Property for the purpose of carrying out the Works and enabling the Owner to comply with any condition imposed by this by-law.

5.0 Breach of this By-Law

5.1 If the Owner breaches any condition of this by-law and fails to rectify that breach within 30 days of service of a written notice from the Owners Corporation requiring rectification of that breach, then the Owners Corporation may:

- 5.1.1 rectify any such breach,
- 5.1.2 enter on any part of the Common Property or the Lot, by its agents, employees or contractors for the purpose of rectifying any such breach, and
- 5.1.3 recover as a debt due from the Owner the costs of the rectification together with the expenses of the Owners Corporation incurred in recovering those costs including legal costs on an indemnity basis.

5.2 Nothing in this clause restricts the rights of or the remedies available to the



Special By-Law 3 – Smoking

Resolved by Special Resolution and pursuant to Section 136 of the *Strata Schemes Management Act 2015*, that the Owners Corporation register an additional by law on the following terms and conditions:

1. An owner or occupier, and any invitee of the owner or occupier, must not smoke tobacco or any other substance on the common property or on the balcony of a lot in the strata scheme; and
2. An owner or occupier of a lot must ensure that smoke caused by the smoking of tobacco or any other substance by the owner or occupier, or any invitee of the owner or occupier, on the lot does not penetrate to the common property or any other lot.

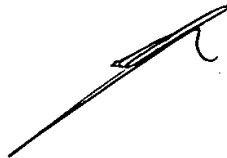

Approved Form 10

Certificate re Initial Period

The owners corporation certifies that in respect of the strata scheme:

*that the initial period has expired.

~~*the original proprietor owns all of the lots in the strata scheme and any purchaser under an
exchanged contract for the purchase of a lot in the scheme has consented to any plan or dealing
being lodged with this certificate.~~

The seal of The Owners - Strata Plan No 11967 was affixed on ^ 4/9/2017 in the
presence of the following person(s) authorised by section 273 *Strata Schemes Management Act 2015* to
attest the affixing of the seal.

Signature:  Name: GARY ADAMSON Authority: STRATA MANAGER

Signature: Name: Authority:

^ Insert appropriate date

* Strike through if inapplicable.

Text below this line is part of the instructions and should not be reproduced as part of a final document.

1. This form must be provided in its entirety as shown above.
2. Any inapplicable parts should be struck through.
3. This certificate is required to accompany any document which proposes action not permitted during
the initial period and when the common property title does not have a notification indicating the initial
period has been expired.



Form: 15CH
Release: 201

**CONSOLIDATION/
CHANGE OF BY-LAWS**

New South Wales
Strata Schemes Management Act 2015
Real Property Act 1900



AQ166739K

PRIVACY NOTE: Section 31B of the Real Property Act 1900 (RP Act) authorises the Registrar General to collect the information required by this form for the establishment and maintenance of the Real Property Act Register. Section 96B RP Act requires that the Register is made available to any person for search upon payment of a fee, if any.

(A) TORRENS TITLE	For the common property CP/SP 11967	
(B) LODGED BY	Document Collection Box 377X	Name, Address or DX, Telephone, and Customer Account Number if any Strata Management Centre Pty Ltd ABN 28 002 824 339 P.O Box 166 CARINGBAH NSW 2229 A/C -132508W Reference: GARY ADAMSON (02) 95230466
	CODE CH	

- (C) The Owners-Strata Plan No. 11967 certify that a special resolution was passed on 27/2/2020
- (D) pursuant to the requirements of section 141 of the Strata Schemes Management Act 2015, by which the by-laws were changed as follows—
- (E) Repealed by-law No. NOT APPLICABLE
Added by-law No. Special By-law 4 Cost Recovery
Amended by-law No. NOT APPLICABLE
as fully set out below:
See attached consolidated by-laws.

- (F) A consolidated list of by-laws affecting the above mentioned strata scheme and incorporating the change referred to at Note (E) is annexed hereto and marked as Annexure A
- (G) The seal of The Owners-Strata Plan No. 11967 was affixed on 9/3/2020 in the presence of the following person(s) authorised by section 273 Strata Schemes Management Act 2015 to attest the affixing of the seal:

Signature: 
Name: GARY ADAMSON
Authority: STRATA MANAGER

Signature:
Name:
Authority:



Strata Plan 11967

Annexure "A"



SCHEDULE 2 – By-laws for pre-1996 strata schemes

(Clause 35)

1 Noise

An owner or occupier of a lot must not create any noise on the parcel likely to interfere with the peaceful enjoyment of the owner or occupier of another lot or of any person lawfully using common property.

2 Vehicles

An owner or occupier of a lot must not park or stand any motor or other vehicle on common property except with the written approval of the owners corporation.

3 Obstruction of common property

An owner or occupier of a lot must not obstruct lawful use of common property by any person.

4 Damage to lawns and plants on common property

An owner or occupier of a lot must not:

- (a) damage any lawn, garden, tree, shrub, plant or flower being part of or situated on common property, or
- (b) use for his or her own purposes as a garden any portion of the common property.

5 Damage to common property

- (1) An owner or occupier of a lot must not mark, paint, drive nails or screws or the like into, or otherwise damage or deface, any structure that forms part of the common property without the approval in writing of the owners corporation.
- (2) An approval given by the owners corporation under clause (1) cannot authorise any additions to the common property.
- (3) This by-law does not prevent an owner or person authorised by an owner from installing:
 - (a) any locking or other safety device for protection of the owner's lot against intruders, or
 - (b) any screen or other device to prevent entry of animals or insects on the lot, or
 - (c) any structure or device to prevent harm to children.
- (4) Any such locking or safety device, screen, other device or structure must be installed in a competent and proper manner and must have an appearance, after it has been installed, in keeping with the appearance of the rest of the building.
- (5) Despite section 106 of the Strata Schemes Management Act 2015, the owner of a lot must maintain and keep in a state of good and serviceable repair any installation or structure referred to in clause (3) that forms part of the common property and that services the lot.

6 Behaviour of owners and occupiers

An owner or occupier of a lot when on common property must be adequately clothed and must not use language or behave in a manner likely to cause offence or embarrassment to the owner or occupier of another lot or to any person lawfully using common property.

7 Children playing on common property in building

An owner or occupier of a lot must not permit any child of whom the owner or occupier has control to play on common property within the building or, unless accompanied by an adult exercising effective control, to be or to remain on common property comprising a laundry, car parking area or other area of possible danger or hazard to children.

8 Behaviour of invitees

An owner or occupier of a lot must take all reasonable steps to ensure that invitees of the owner or occupier do not behave in a manner likely to interfere with the peaceful enjoyment of the owner or occupier of another lot or any person lawfully using common property.

9 Depositing rubbish and other material on common property

An owner or occupier of a lot must not deposit or throw on the common property any rubbish, dirt, dust or other material likely to interfere with the peaceful enjoyment of the owner or occupier of another lot or of any person lawfully using the common property.

10 Drying of laundry items

An owner or occupier of a lot must not, except with the consent in writing of the owners corporation, hang any washing, towel, bedding, clothing or other article on any part of the parcel in such a way as to be visible from outside the building other than on any lines provided by the owners corporation for the purpose and there only for a reasonable period.

11 Cleaning windows and doors

An owner or occupier of a lot must keep clean all glass in windows and all doors on the boundary of the lot, including so much as is common property.

12 Storage of inflammable liquids and other substances and materials

(1) An owner or occupier of a lot must not, except with the approval in writing of the owners corporation, use or store on the lot or on the common property any inflammable chemical, liquid or gas or other inflammable material.

(2) This by-law does not apply to chemicals, liquids, gases or other material used or intended to be used for domestic purposes, or any chemical, liquid, gas or other material in a fuel tank of a motor vehicle or internal combustion engine.

13 Moving furniture and other objects on or through common property

An owner or occupier of a lot must not transport any furniture or large object through or on common property within the building unless sufficient notice has first been given to the strata committee so as to enable the strata committee to arrange for its nominee to be present at the time when the owner or occupier does so.



14 Floor coverings

(1) An owner of a lot must ensure that all floor space within the lot is covered or otherwise treated to an extent sufficient to prevent the transmission from the floor space of noise likely to disturb the peaceful enjoyment of the owner or occupier of another lot.

(2) This by-law does not apply to floor space comprising a kitchen, laundry, lavatory or bathroom.

15 Garbage disposal

An owner or occupier of a lot:

(a) must maintain within the lot, or on such part of the common property as may be authorised by the owners corporation, in clean and dry condition and adequately covered a receptacle for garbage, and

(b) must ensure that before refuse is placed in the receptacle it is securely wrapped or, in the case of tins or other containers, completely drained, and

(c) for the purpose of having the garbage collected, must place the receptacle within an area designated for that purpose by the owners corporation and at a time not more than 12 hours before the time at which garbage is normally collected, and

(d) when the garbage has been collected, must promptly return the receptacle to the lot or other area referred to in paragraph (a), and

(e) must not place any thing in the receptacle of the owner or occupier of any other lot except with the permission of that owner or occupier, and

(f) must promptly remove any thing which the owner, occupier or garbage collector may have spilled from the receptacle and must take such action as may be necessary to clean the area within which that thing was spilled.

16 Keeping of animals

Subject to section 49 (4) of the Act, an owner or occupier of a residential lot must not keep any animal on the lot or the common property.

17 Appearance of lot

(1) The owner or occupier of a lot must not, without the written consent of the owners corporation, maintain within the lot anything visible from outside the lot that, viewed from outside the lot, is not in keeping with the rest of the building.

(2) This by-law does not apply to the hanging of any washing, towel, bedding, clothing or other article as referred to in by-law 10.

18 Notice board

An owners corporation must cause a notice board to be affixed to some part of the common property.

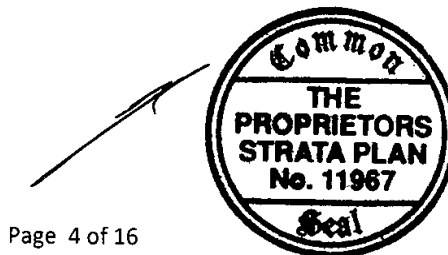

19 Change in use of lot to be notified

An occupier of a lot must notify the owners corporation if the occupier changes the existing use of the lot in a way that may affect the insurance premiums for the strata scheme (for example, if the change of use results in a hazardous activity being carried out on the lot, or results in the lot being used for commercial or industrial purposes rather than residential purposes).

Special By-Law 1 – Occupiers Damage

- (1) An owner of a lot (called "the Owner") must do the following on each occasion that the occupancy (whether pursuant to a lease or oral or written license agreement to occupy the lot) of the lot changes:
 - (a) notify the Owners Corporation of the full names of all the occupants of the lot (called "the Occupants"); and
 - (b) pay the Owners Corporation the sum of \$200 within 7 days of the Occupants taking occupation of the lot;
- (2) The Owners Corporation must do the following:
 - (a) keep a record of the notices received from Owners pursuant to this bylaw;
 - (b) keep a record of the amounts of money received from Owners pursuant to this bylaw;
 - (c) apply the amounts of money received from Owners pursuant to this bylaw towards:
 - (i) the repair of damage caused from time to time to the common property that has occurred:
 - (A) during the removal and delivery of goods and furniture at the time of such changes of occupancy of lots;
 - (B) through carelessness, maliciously or otherwise by any Occupants or any of the Occupants' invitees or visitors or guests;

Special By-Law 2 – Enclosure of Verandahs

1. Introduction

- 1.1 This by-law authorises Works to be conducted on Common Property by the Owner.
- 1.2 This by-law further grants to the Owner exclusive use of so much of the Works as comprise part of the Common Property so that the Owner may use and enjoy the benefit of the Works on certain terms and conditions.



2. Definitions & Interpretation

1.3 In this by-law:

"Building" means the building to which the Works are attached.

"Common Property" means the common property for the Strata Scheme.

"Development Act" means the Strata Schemes (Freehold Development) Act 1973.

"Executive Committee" means the executive committee of the Owners Corporation.

"Lot" means all lots within the Strata Scheme and "Lots" means two or more of those lots.

"Management Act" means the Strata Schemes Management Act 1996.

"Occupier" means an Occupier of a lot within the Strata Scheme and includes, without limiting the generality of the foregoing, lessees and licensees.

"Owner" means the owner of a Lot and that owner's successors in title. Any obligation on or reference to an Owner in respect of any Works relates only to Works which benefit that Owner's Lot or enclose that Owner's Verandah, having been carried out by that Owner or a previous owner of that Owner's Lot.

"Owners Corporation" means the owners corporation for the Strata Scheme.

"Strata Managing Agent" means a strata managing agent appointed to the Strata Scheme pursuant to the Management Act.

"Strata Plan" means the strata plan for the Strata Scheme,

"Strata Scheme" means the Strata Scheme in respect of this by-law applies.

"Strata Legislation" means the Development Act and the Management Act.

"Verandah" means that part of a lot marked "VER" on the strata plan and denoted as "VERANDAHS" on the Strata Plan, provided that this by-law only applies to Works on a south or north facing Verandah.

"Works" means the enclosure of an Owner's Verandah (but only a south or north-facing Verandah), with glass or such other material as approved by the Owners Corporation, including such ancillary works as are reasonably required. For abundant clarity, this by-law does not give an owner the right to do Works in relation to, or enclose, any verandah or balcony that faces east or west, such as a verandah fronting Hercules Road or one facing the back of the strata scheme.



2.1 In this by-law:

- 2.2.1 headings have been inserted for guidance only and do not affect the interpretation of this by-law,
- 2.2.2 references to any statutory or like provisions include any statutory or like provisions amending, consolidating or replacing the same, and all by-laws, ordinances, proclamations, regulations, rules and other authorities made under them,
- 2.2.3 words importing the singular number include the plural and vice versa,
- 2.2.4 words importing the masculine, feminine or neuter gender include both of the other two genders,
- 2.2.5 where any word or phrase is given a definite meaning any part of speech or other grammatical form in respect of that word or phrase has a corresponding meaning,
- 2.2.6 where any decision needs to be made by the Owners Corporation that decision may be made by the Executive Committee unless the decision would constitute a decision on any matter or type of matter that the Owners Corporation has determined in general meeting is to be decided only by the Owners Corporation in general meeting or is a decision which can only be made by the Owners Corporation in general meeting pursuant to the Strata Legislation,
- 2.2.7 any expression used in this by-law and which is defined in the Strata Legislation will have the same meaning as that expression has in that legislation unless a contrary intention is expressed in this by-law, and
- 2.2.8 if there is any inconsistency between this by-law and any other by-law applicable to the Strata Scheme, then the provisions of this by-law will prevail to the extent of that inconsistency.

3. Authorisation and Right of Exclusive Use

3.1 Authorisation

- 3.1.1 For the purpose of improving or enhancing the Common Property the Owner may (at that Owner's sole cost) conduct the Works on the Common Property. The owners corporation consents to any application for development approval or a construction certificate in relation to those Works and must within 7 days of request from an Owner seal, and authorises its strata managing agent to seal on its behalf, any such application (for development approval or a construction certificate).



3.2 The Grant of Exclusive Use

- 3.2.1 The Owner will have a right of exclusive use and enjoyment of so much of the Works as comprise part of the Common Property on the terms and conditions set out in this by-law.

3.3 Rights of the Owners Corporation

- 3.3.1 The right of exclusive use and enjoyment granted to the Owner is subject to the Owners Corporation being able to obtain access to and the use of any part of that Common Property required for the purposes of fulfilling any obligation which the Owners Corporation may have under the Strata Legislation or any other law.

3.4 Responsibility for Maintenance and Upkeep

- 3.4.1 The Owner is responsible at all times for the proper maintenance of, and keeping in a state of good and serviceable repair, the Works and, when necessary, renewing or

4. Terms & Conditions

4.1 Before Commencement of the Works

- 4.1.1.1 give the Owners Corporation at least 30 days' notice of the commencement of the Works;
- 4.1.1.2 if approval is required, obtain and provide to the Owners Corporation a copy of any certificates issued under the *Environmental Planning and Assessment Act 1979* which are required to permit the Works to commence, such as a construction certificate and a development approval,
- 4.1.1.3 if the Works on a Lot are for the prescribed amount:
- (a) enter into a contract in conformity with and meeting the requirements of the *Home Building Act 1989* with a contractor licensed to perform residential building work; and
 - (b) obtain and provide to the Owners Corporation a certificate of insurance evidencing any contract of Home Warranty Insurance required under Part 6 of the *Home Building Act 1989* for the Works,
- 4.1.1.4 obtain and provide to the Owners Corporation a copy of a certificate of insurance evidencing a contractors all risk insurance policy which is current and which includes public liability cover of not less than \$10 million in respect of any claim noting the interests of the Owners Corporation on the policy
- 4.1.1.5 if not already provided by an Owner or an Owner's predecessor in title, provide his written consent to this by-law, and
- 4.1.1.6 if requested by the Owners Corporation (acting reasonably), provide to the Owners Corporation a certificate from a qualified engineer addressed to the Owners Corporation certifying that the Works will not affect the structural integrity of the Building.



4.1.2 If the Owner does not comply with the conditions set out in clause 4.1.1 the Owner must not carry out the Works and, if already commenced, the Works must be stopped immediately. If the Owner does not comply with the conditions set out in clause 4.1.1 within 90 days of stopping the Works, then the Owner must (in a proper and workmanlike manner) within a further 30 days reinstate the Common Property to its former condition.

4.1.3 The Works must not be conducted until this by-law is registered.

4.2 During the Conduct of the Works

4.2.1 During the Works the Owner must:

4.2.1.1 Standard of Workmanship

ensure the Works are carried out in a proper and workmanlike manner by appropriately qualified and licensed tradespersons utilising only first quality materials which are good and suitable for the purpose for which they are used,

4.2.1.2 Time for Completion of Works

make sure the Works are carried out with due diligence and are completed within 60 days of commencement,

4.2.1.3 Appearance of the Works

ensure the Works are carried out and completed in a manner which is in keeping with the rest of the Strata Scheme or any manner designated by the Owners Corporation, so that the Works on all Lots are consistent in appearance,

4.2.1.4 Quality of the Works

make certain the Works are in accordance with any specification,

4.2.1.5 Variation to Works

not vary the Works without obtaining the prior written approval of the Owners Corporation,

4.2.1.6 Supervision of the Works

ensure that the Works are adequately supervised and that the Common Property is inspected on a daily basis to ensure that the conditions of this by-law are complied with,

4.2.1.7 Noise During Works

ensure the Works and tradespersons carrying out the Works do not create any excessive noise within the Strata Scheme that is likely to interfere with the peaceful enjoyment of the occupier of another lot or of any person lawfully using the Common Property,



4.2.1.8 Transportation of Construction Equipment

ensure that all construction materials and equipment are transported in accordance with any manner reasonably directed by the Owners Corporation,

4.2.1.9 Debris

ensure that any debris is removed from the Common Property daily and strictly in accordance with the reasonable directions of the Owners Corporation,

4.2.1.10 Storage of Building Materials on Common Property

make sure that no building materials are stored on Common Property,

4.2.1.11 Protection of Common Property

(i) protect all areas of the Common Property which are affected by the works from damage, the entry of water and from dirt, dust and debris relating to the Works and ensure that all Common Property is protected from damage throughout the course of the works.

(ii) keep all parts of the Common Property affected by the Works.

4.2.1.12 Daily Cleaning

clean any part of the Common Property affected by the Works on a daily basis and keep all parts of the Common Property clean, neat and tidy during the Works,

4.2.1.13 Times for Renovations

ensure that the Works are only carried out between the hours of 8.00 am - 4.30 pm on Monday - Friday and are not performed on weekends or public holidays,

4.2.1.14 Times for Operation of Noisy Equipment

make sure that percussion tools and noisy equipment such as jack hammers and tile cutters are only used between 10:00 am – 3:00 pm,

4.2.1.15 Interruption to Services

give the occupiers of other lots at least 48 hours prior notice of any planned interruption to the services in the Strata Scheme such as water, electricity, television, cable television,

4.2.1.16 Vehicles

ensure that no tradesperson's vehicles obstruct the Common Property other than on a temporary and non-recurring basis when delivering or removing materials or equipment and then only for such time as is reasonably necessary,

4.2.1.17 Costs of All Works

pay all costs associated with the Works,



4.2.1.18 Comply with All Laws

comply with all statutes, by-laws, regulations, rules and other laws for the time being in force and which are applicable to the Works, and

4.2.1.19 Right of Access

give the Owners Corporation's nominated representative(s) access to inspect the Works within 48 hours of any requests from the Owners Corporation.

4.3 After the Conduct of the Works

After the Works are complete the Owner must

4.3.1.1 promptly notify the Owners Corporation that the Works are complete,

4.3.1.2 obtain and give the Owners Corporation a copy of all requisite certificates issued under Part 4A of the *Environmental Planning and Assessment Act 1979* approving the Works and the occupation of the Lot (where required), for example, any necessary compliance certificate or occupation certificate,

4.3.1.3 restore all Common Property damaged or affected by the Works as nearly as possible to the state which they were in immediately prior to commencement of the Works,

4.3.1.4 provide the Owners Corporation's nominated representative(s) access to inspect the Works within 48 hours of any request from the Owners Corporation, in order to ascertain compliance with this by-law (the Owners Corporation's right to inspect the Works will expire once it is reasonably satisfied that the conditions of this by-law have been complied with),

4.1.3.5 if requested by the Owners Corporation (acting reasonably), provide the Owners corporation with a certificate from a duly qualified engineer addressed to the Owners Corporation certifying that the Works have been completed in a manner that will not affect the structural integrity of the Building.

4.4 Enduring Obligations
The Owner must:

4.4.1 make good any damage to another lot or the Common Property caused by the Works no matter when such damage may become evident,

4.4.2 notify the Owners Corporation that any damage to another lot or the Common Property caused by the Works has been repaired, and

4.4.3 comply with all statutes, by-laws, regulations, rules and other laws for the time being in force and which are applicable to the Works (for example, the conditions of the Local Council's approval for the Works), and



- 4.4.4 ensure that the Works do not create any excessive noise or otherwise intervene with the peaceful enjoyment of the occupier of another lot or of any person

4.5 **Indemnity**

The Owner indemnifies and keeps indemnified the Owners Corporation against all actions, proceedings, claims, demands, costs, damages and expenses which may be incurred by or brought or made against the Owners Corporation arising out of the Works or the altered state or use of the Common Property arising therefrom.

4.6 **Access**

The Owners Corporation must give the Owner and the Owner's tradespersons reasonable access through the Common Property for the purpose of carrying out the Works and enabling the Owner to comply with any condition imposed by this by-law.

5.0 **Breach of this By-Law**

- 5.1 If the Owner breaches any condition of this by-law and fails to rectify that breach within 30 days of service of a written notice from the Owners Corporation requiring rectification of that breach, then the Owners Corporation may:

- 5.1.1 rectify any such breach,
- 5.1.2 enter on any part of the Common Property or the Lot, by its agents, employees or contractors for the purpose of rectifying any such breach, and
- 5.1.3 recover as a debt due from the Owner the costs of the rectification together with the expenses of the Owners Corporation incurred in recovering those costs including legal costs on an indemnity basis.

- 5.2 Nothing in this clause restricts the rights of or the remedies available to the

Special By-Law 3 – Smoking

Resolved by Special Resolution and pursuant to Section 136 of the Strata Schemes Management Act 2015, that the Owners Corporation register an additional by law on the following terms and conditions:

1. An owner or occupier, and any invitee of the owner or occupier, must not smoke tobacco or any other substance on the common property or on the balcony of a lot in the strata scheme; and
2. An owner or occupier of a lot must ensure that smoke caused by the smoking of tobacco or any other substance by the owner or occupier, or any invitee of the owner or occupier, on the lot does not penetrate to the common property or any other lot.



Special By-Law 4 – Cost Recovery

1. Definitions:

In this by-law headings have been inserted as a guidance only and have no effect on the interpretation of this by-law unless otherwise designated and the following definitions shall prevail:

- (a) **the Act** means the Strata Schemes Management Act, 2015 and the Strata Schemes Management Act Regulations 2016
- (b) **Building** shall mean **22 Hercules Street ,Brighton Le Sands**
- (c) **Council** shall mean **Georges River Council**
- (d) **Lot** shall mean the subject lot in strata plan **11967**
- (e) **Owner** means the registered proprietor of the subject lot in strata plan **11967**
- (f) **Authority** means any Government or semi Government instrumentality which has any jurisdiction over the lot or the development
- (g) **Insurance** shall mean any insurance required under the Act and the NSW Workers Compensation Act 1987.
- (h) **Owners Corporation** shall refer to "the proprietors of 11967"
- (k) Any term referred to in this by-law shall be deemed to have the same meaning as "the Act".
- (l) **Works** means the work to be undertaken whether by way of visual or physical inspection, repair maintenance or replacement work required or proposed to be undertaken by the Owners Corporation upon common property for the purpose of ensuring compliance with Section 106 of the Act.
- (m) **Strata Committee** shall mean the strata committee of the Owners Corporation.

2. Cost Recovery for Services and Private Maintenance

In accordance with Section 136 of the Strata Schemes Management Act, 2015 the following requirements shall apply to all owners, occupiers and duly authorised representatives or agents of the proprietor:

(a) Provision of Requested Services

A proprietor, occupier or authorised agent of the proprietor of a lot shall be entitled to request the provision of services to be provided by the Owners Corporation through the strata committee or the strata manager on the condition that if there is a fee, charge or out of pocket expense incurred by the Owners Corporation the levy account of the benefitting proprietor(s) shall be debited with the fee, charge or out of pocket expense for the full amount of any cost whatsoever incurred by the Owners Corporation including any administrative fees or interest.



Notwithstanding the above, if the proprietor fails to reimburse the Owners Corporation within fourteen (14) days for the amount of any expense incurred by the Owners Corporation being debited to the levy account of the subject lot the Owners Corporation may, at its absolute discretion, file a claim for recovery of the costs incurred by the Owners Corporation to the strata manager or any other service contractor in any Court of competent jurisdiction.

In the event that recovery action is necessary the Owners Corporation may recover all costs whatsoever incurred by the Owners Corporation including but not limited to interest and out of pocket expenses together with any third party provider fees and such services shall include but not be limited to the following:

- (i) Obtaining and providing a copy of a certificate of currency of insurance to assist in financing or refinancing of a mortgages or any other purpose;
- (ii) The provision of Certificates under Section 184 of the Act;
- (iii) Attending to a real estate agents or solicitors general requests relating to the subject lot where the lot is being leased or sold;
- (iv) Attending to queries and requests relating to the Owners By-Laws or proposed by-laws conferring or intended to confer exclusive rights of usage of the common property for the private benefit of a proprietor of a lot;
- (v) Processing requests for approval of the installation of "For Sale" and "For lease" or similarly described or other signage on common property;
- (vi) Provision of a copy of the registered by-laws to facilitate compliance with the strata Schemes and Residential Tenancies Legislation and the preparation of sales contracts;
- (vii) Telephone requests relating to the Owners Corporations by-laws;
- (viii) Attending to a proprietors, a real estate agents, solicitors or lot occupiers request to investigate and/or undertake building repairs or maintenance to the common property when the repair / maintenance which prima facie appears to be a common property matter and upon investigation is found to be the responsibility of the proprietor of the lot;
- (ix) Queries relating to the keeping of pets by landlords, agents solicitors and tenants;
- (x) Attending to insurance claims and queries that are claims for private matters on the Owners Corporations insurance policy (eg proprietors fixtures) for which the proprietor of a lot is entitled to insist under the Act for the Owners Corporation to lodge a claim with the Owners Corporations insurer;
- (xi) Obtaining from the Land Registry Service and providing a copy of the registered strata plan or a copy of the Owners Corporations registered by-laws to facilitate identification of lots;
- (xii) Additional administrative or other expenses or fines incurred by the Owners Corporation as a result of a proprietor, occupier or authorised agents failure to provide access to a lot on a pre-arranged and notified date to undertake an inspection or to effect repairs or maintenance to the common property;
- (xiii) Liaising and/or mediating between proprietors, occupiers and agents in respect of by-law breaches.
- (xiv) Processing notices under Section 22 of the Act.



(b) Private Maintenance

Where the proprietor or occupier of a lot fails to properly maintain the lot and the lack of maintenance adversely physically or visually affects common property the Owners Corporation may provide a seven (7) day notice for the lot owner/occupier to effect any necessary maintenance to the lot to rectify the visual or physical problem.

In the event that the proprietor/occupier fails to attend the matter of concern notified in writing within seven (7) days the Owners Corporation issuing a notice to comply the Owners Corporation may, at its absolute discretion, arrange for an appropriate service provider to attend to rectification of the matter and will debit the proprietors levy account for all costs whatsoever incurred in attending to rectification of the matter of concern.

Such matters would include but not be limited to:

- (i) Storage of goods upon the common property;
- (ii) Unauthorised installations that may be a breach of the by-laws;
- (iii) Plant and tree overgrowth into common property air space.

(c) Hindering Access

Where access to a lot is required to be provided for the purpose of undertaking an inspection, repair or maintenance of the common property in accordance with Section 122 or Section 123 of the Act and the proprietor, occupier or agent fails to provide access to the property at the appointed day and time period and, as a result, the owners corporation incurs an additional expense as a result of the proprietor, occupier or agents failure to provide access to the subject lot the owners corporation may debit the proprietors levy account with any additional cost incurred whatsoever which would not otherwise have been incurred by the Owners Corporation had access been provided on the designated day and time period.

The matters that shall be included but not be limited to are as follows:

- (i) Access for the purpose of fire compliance inspections;
- (ii) Access for the purpose of window lock inspections;
- (iii) Access for the purpose of undertaking an inspection of the common property to determine any repairs or maintenance required under Section 106 of the Act;
- (iv) Access for the purpose of preparing quotations or reports such as dilapidation report for any maintenance, proposed maintenance or potential litigation matter;
- (v) Access for the purpose of undertaking inspections to enable a determination of responsibility for repair where responsibility for the disputed matter is in dispute;
- (vi) Access to effect emergency repairs for such matters as burst water pipes, burst washing machine or dishwasher hoses or running taps overflowing from a sink or other installation and affecting the common property or another lot.



EXPLANATION:

Periodically a proprietor, occupier or their authorised representative request the provision of various services or repairs which can only be provided by the Owners Corporation and which and the provision of the requested service or repair necessitates the Owners Corporation incurring expenses on behalf of the requesting party in order to be able to provide the service requested.

Such common place requests include obtaining a certificate of insurance form the insurer, a copy of the strata schemes registered by laws or a copy of the registered strata plan from the Land Registry Service for which a fee is payable to the insurer or the Land Registry Service but the only benefitting party is the requesting lot owner.

Under these circumstances all proprietors initially contribute to the cost incurred when the Owners Corporation pays the applicable fee to enable the provision of this requested service through their levy payments but only the requesting proprietor receives the benefit unless there is a by-law enabling the Owners Corporation to recover those costs.

In addition, Owners Corporations often incur additional expenses arising from the lack of co-operation of proprietors, occupiers or authorised agents as a result of their failure to provide access to a lot for a range of compliance inspection and repair matters and, as a result of the service provider being denied access on the appointed day and time period having to return at a later date to complete the work at an additional cost to the Owners Corporation to which all lot owners contribute through their levies.

In some cases such as annual fire safety compliance inspection there is also a statutory deadline for the lodgement of the statutory Certificate of compliance which, if not complied with, will result in the Owners Corporation incurring statutory fines up to \$12,000.

This by-law is intended to enable any costs incurred by the Owners Corporation under a range of common circumstances to be recovered by the Owners Corporation from the proprietor of the lot which caused the expense and/or fine to be incurred.



16 June 2022

Our Ref: Certificate No. 67901
Contact: Customer Service 1300 581 299

InfoTrack Pty Ltd
GPO BOX 4029
SYDNEY NSW 2001

Dear Sir/Madam

Following is your planning certificate issued under section 10.7 (2) of the Environmental Planning and Assessment Act 1979.

This Section 10.7 Certificate has been issued by Bayside Council. Information contained within this Certificate is based on data from Council's records as they existed at the date of this Certificate.

Should you have any enquiries, please contact the Council's Customer Service Centre on 1300 581 299.

SECTION 10.7 PLANNING CERTIFICATE

(under section 10.7 of the Environmental Planning and Assessment Act 1979)

ISSUED TO:

InfoTrack Pty Ltd
GPO BOX 4029
SYDNEY NSW 2001

Council: Bayside
County: Cumberland
Parish: St George

Fee: 53.00
Receipt No: 5038139
Receipt Date: 16 June 2022
Your Ref: 22:0268:63804

PROPERTY: 5/22 HERCULES ROAD, BRIGHTON LE SANDS NSW 2216

Lot 5 SP 11967

CT

Assessment No: 14420

Date: 16 June 2022



For
Meredith Wallace
General Manager

Rockdale Customer Service Centre
444-446 Princes Highway
Rockdale NSW 2216, Australia
ABN 80 690 785 443

Eastgardens Customer Service Centre
Westfield Eastgardens
152 Bunnerong Road
Eastgardens NSW 2036, Australia
ABN 80 690 785 443

T 1300 581 299 | 02 9562 1666
E council@bayside.nsw.gov.au
W www.bayside.nsw.gov.au

Postal address: PO Box 21, Rockdale NSW 2216



Telephone Interpreter Services - 131 450

Τηλεφωνικές Υπηρεσίες Διερμηνέων

بخدمه الترجمة الهاتفية

電話傳譯服務處

Служба за преведување по телефон

This page is intentionally left blank

Notes: (1) Where this certificate refers to a specific allotment (or allotments) within a strata plan the certificate is issued for the whole of the land within the strata plan, not just the specific allotment or allotments referred to, and any information contained in the certificate may relate to the whole or any part of the strata plan.

1 Names of relevant planning instruments and development control plans

(1) The name of each environmental planning instrument and development control plan that applies to the carrying out of development on the land.

Bayside Local Environmental Plan 2021

State Environmental Planning Policy No 65	Design Quality of Residential Apartment Development
---	---

State Environmental Planning Policy	(Building Sustainability Index: BASIX) 2004
-------------------------------------	---

State Environmental Planning Policy	(Exempt and Complying Development Codes) 2008
-------------------------------------	---

State Environmental Planning Policy	(Housing) 2021
-------------------------------------	----------------

State Environmental Planning Policy	(Biodiversity and Conservation) 2021
-------------------------------------	--------------------------------------

State Environmental Planning Policy	(Resilience and Hazards) 2021
-------------------------------------	-------------------------------

State Environmental Planning Policy	(Transport and Infrastructure) 2021
-------------------------------------	-------------------------------------

State Environmental Planning Policy	(Industry and Employment) 2021
-------------------------------------	--------------------------------

State Environmental Planning Policy	(Resources and Energy) 2021
-------------------------------------	-----------------------------

State Environmental Planning Policy	(Precincts – Eastern Harbour City) 2021
-------------------------------------	---

State Environmental Planning Policy	(Planning Systems) 2021
-------------------------------------	-------------------------

Greater Metropolitan Regional Environmental Plan No. 2 – Georges River Catchment
(only applies to land within the Georges River Catchment, referred to in Clause 2 of the Plan, being, in the Bayside Council area, certain land within the suburbs of Dolls Point, Ramsgate, Sandringham and Sans Souci).

Rockdale Development Control Plan 2011

(2) The name of each proposed environmental planning instrument and draft development control plan, which is or has been subject to community consultation or public exhibition under the Act, that will apply to the carrying out of development on the land.

No Planning Proposal applies to the land.

No draft Development Control Plan applies to the land.

(3) Subsection (2) does not apply in relation to a proposed environmental planning instrument or draft development control plan if— (a) it has been more than 3 years since the end of the public exhibition

- period for the proposed instrument or draft plan, or
(b) for a proposed environmental planning instrument—the Planning Secretary has notified the council that the making of the proposed instrument has been deferred indefinitely or has not been approved.

- (4) In this section—
proposed environmental planning instrument means a draft environmental planning instrument and includes a planning proposal for a local environmental plan.

2 Zoning and land use under relevant planning instruments

The following matters for each environmental planning instrument or draft environmental planning instrument that includes the land in a zone, however described—

- 2(a) the identity of the zone, whether by reference to—
(i) a name, such as “Residential Zone” or “Heritage Area”, or
(ii) a number, such as “Zone No 2 (a)”,
- 2(b) the purposes for which development in the zone—
(i) may be carried out without development consent, and
(ii) may not be carried out except with development consent, and
(iii) is prohibited,

The following zone or zones apply under the environmental planning instrument or draft environmental planning instrument referred to in section 1(1):

Zone R4 High Density Residential

1 Objectives of zone

- To provide for the housing needs of the community within a high density residential environment.
- To provide a variety of housing types within a high density residential environment.
- To enable other land uses that provide facilities or services to meet the day to day needs of residents.
- To ensure land uses are carried out in a context and setting to minimise impact on the character and amenity of the area.
- To enable residential development in accessible locations to maximise public transport patronage and encourage walking and cycling.

2 Permitted without consent

Home-based child care, Home occupations

3 Permitted with consent

Attached dwellings; Bed and Breakfast accommodation; Boarding houses; Building identification signs; Business identification signs; Centre-based child care facilities; Community facilities; Dual occupancies; Dwelling houses; Educational establishments; Environmental protection works; Exhibition homes; Flood mitigation works; Group homes; Health service facilities; Home businesses; Hostels; Multi dwelling housing; Neighbourhood shops; Oyster aquaculture; Places of public worship; Recreation areas; Residential flat buildings; Respite day care centres; Roads; Secondary dwellings; Semi-

detached dwellings; Seniors housing; Sewage reticulation systems; Shop top housing; Water recycling facilities; Water supply systems

4 Prohibited

Pond-based aquaculture; Tank-based aquaculture; Any other development not specified in item 2 or 3

2(c) whether any additional permitted uses apply to the land,

No additional permitted uses apply to the land.

2(d) whether any development standards applying to the land fix minimum land dimensions for the erection of a dwelling house on the land and, if so, the fixed minimum land dimensions,

No development standards apply to the land that fixes minimum land dimensions for the erection of a dwelling house.

Note: The above information does not imply that the erection of a dwelling-house is necessarily permissible on the land to which this certificate applies. Refer to the relevant local environmental plan, deemed environmental planning instrument or draft local environmental plan applying to the land to confirm this.

2(e) whether the land is in an area of outstanding biodiversity value under the *Biodiversity Conservation Act 2016*,

The land **is not** in an area of outstanding biodiversity value.

2(f) whether the land is in a conservation area, however described,

The land **is not** in a conservation area.

2(g) whether an item of environmental heritage, however described, is situated on the land.

There is **no such item** situated on the land.

3 Contributions plans

(1) The name of each contributions plan under the Act, Division 7.1 applying to the land, including draft contributions plan

Rockdale Section 94A Development Contributions Plan 2008
Rockdale Section 94 Contributions Plan 2004

Note: If land is within the former Rockdale City local government area, the *Rockdale Section 94 Contributions Plan (Amendment No 4)* and *Rockdale Section 94 Contributions Plan 1998* will continue to apply to all development applications and applications for complying development certificates made prior

to 1 June 2004.

- (2) If the land is in a special contributions area under the Act, Division 7.1, the name of the area.

A Special Infrastructure Contributions Plan **does not apply** to the land.

4 Complying development

- (1) If the land is land on which complying development may be carried out under each of the complying development codes under *State Environmental Planning Policy (Exempt and Complying Development Codes) 2008*, because of that Policy, clause 1.17A(1)(c)–(e), (2), (3) or (4), 1.18(1)(c3) or 1.19.
- (2) If complying development may not be carried out on the land because of 1 of those clauses, the reasons why it may not be carried out under the clause
- (3) If the council does not have sufficient information to ascertain the extent to which complying development may or may not be carried out on the land, a statement that—
- (a) a restriction applies to the land, but it may not apply to all of the land, and
 - (b) the council does not have sufficient information to ascertain the extent to which complying development may or may not be carried out on the land.
- (4) If the complying development codes are varied, under that Policy, clause 1.12, in relation to the land.

Housing Code

Complying development **may be** carried out on the land under the above code.

Inland Code

Complying development **may be** carried out on the land under the above code.

Low Rise Housing Diversity Code

Complying development **may be** carried out on the land under the above code.

Rural Housing Code

Complying development **may be** carried out on the land under the above code.

Greenfield Housing Code

Complying development **may be** carried out on the land under the above code.

Industrial and Business Buildings Code

Complying development **may be** carried out on the land under the above code.

Housing Alterations Code

Complying development **may be** carried out on the land under the above code.

General Development Code

Complying development **may be** carried out on the land under the above code.

Industrial and Business Alterations Code

Complying development **may be** carried out on the land under the above code.

Container Recycling Facilities Code

Complying development **may be** carried out on the land under the above code.

Subdivisions Code

Complying development **may be** carried out on the land under the above code.

Demolition Code

Complying development **may be** carried out on the land under the above code.

Fire Safety Code

Complying development **may be** carried out on the land under the above code.

Notes:

(1) If a reference is made to “part of the land”, Complying Development **may be** carried out on the portion of the land not subject to such a restriction.

(2) This certificate only addresses matters raised in Clause 1.17A (1) (c) to (e), (2), (3) and (4), 1.18 (1)(c3) and 1.19 of *State Environmental Planning Policy (Exempt and Complying Development Codes) 2008*. It is your responsibility to ensure that you comply with any other general requirements of the *State Environmental Planning Policy (Exempt and Complying Development Codes) 2008*.

5 Exempt development

- (1) If the land is land on which exempt development may be carried out under each of the exempt development codes under *State Environmental Planning Policy (Exempt and Complying Development Codes) 2008*, because of that Policy, clause 1.16(1)(b1)–(d) or 1.16A.
- (2) If exempt development may not be carried out on the land because of 1 of those clauses, the reasons why it may not be carried out under the clause.
- (3) If the council does not have sufficient information to ascertain the extent to which exempt development may or may not be carried out on the land, a statement that—
 - (a) a restriction applies to the land, but it may not apply to all of the land, and
 - (b) the council does not have sufficient information to ascertain the extent to which exempt development may or may not be carried out on the land.
- (4) If the exempt development codes are varied, under that Policy, clause 1.12, in relation to the land.

General Exempt Development Code

Exempt development **may be** carried out on the land under the above code.

Advertising and Signage Exempt Development Code

Exempt development **may be** carried out on the land under the above code.

Temporary Uses and Structures Exempt Development Code

Exempt development **may be** carried out on the land under the above code.

6 Affected building notices and building product rectification orders

- (1) Whether the council is aware that—

- (a) an affected building notice is in force in relation to the land, or
- (b) a building product rectification order is in force in relation to the land that has not been fully complied with, or
- (c) a notice of intention to make a building product rectification order given in relation to the land is outstanding.

- (3) In this section—
affected building notice has the same meaning as in the *Building Products (Safety) Act 2017*, Part 4.

building product rectification order has the same meaning as in the *Building Products (Safety) Act 2017*.

Council **is not aware of an issue** of a notice of intention or order pertaining to building product rectification works (Building Products Safety Act 2017).

7 Land reserved for acquisition

Whether or not any environmental planning instrument or proposed environmental planning instrument referred to in section 1 makes provision in relation to the acquisition of the land by an authority of the State, as referred to in section 3.15.

The land **is not affected** by any provision in an environmental planning instrument, deemed environmental planning instrument or draft environmental planning instrument that provides for the acquisition of the land by a public authority, as referred to in section 3.15 of the Act.

8 Road widening and road realignment

Whether or not the land is affected by any road widening or road realignment under:

- (a) the Roads Act 1993, Part 3, Division 2, or

The land **is not affected by** any road widening or road realignment under Division 2 of Part 3 of the *Roads Act 1993*.

- (b) Any environmental planning instrument, or

The land **is not affected by** any road widening or road realignment under any environmental planning instrument.

- (c) A resolution of the council

The land **is not affected by** any road widening or road realignment under any resolution of the Council.

9 Flood related development controls

- (1) **If the land or part of the land is within the flood planning area and subject to flood related development controls.**

The land or part of the land **is not** within the flood planning area and subject to flood related development controls.

- (2) **If the land or part of the land is between the flood planning area and the probable maximum flood and subject to flood related development controls.**

The land or part of the land **is not** between the flood planning area and the probable maximum flood and subject to flood related development controls.

Note:

- (1) The answers above do not imply that the development referred to is necessarily permissible on the land to which this certificate applies. Refer to the relevant local environmental plan, deemed environmental planning instrument or draft local environmental plan applying to the land to confirm this.
- (2) Council is not in a position to identify whether the information provided under section 9 relates to a current or future hazard as defined in Planning Circular PS 14-003.
-

- (3) **In this clause—
flood planning area has the same meaning as in the Floodplain Development Manual.**

***Floodplain Development Manual* means the Floodplain Development Manual (ISBN 0 7347 5476 0) published by the NSW Government in April 2005.**

***probable maximum flood* has the same meaning as in the Floodplain Development Manual.**

10 Council and other public authority policies on hazard risk restrictions

- (1) **Whether any of the land is affected by an adopted policy that restricts the development of the land because of the likelihood of land slip, bush fire, tidal inundation, subsidence, acid sulfate soils, contamination, aircraft noise, salinity, coastal hazards, sea level rise or another risk, other than flooding.**
- (2) **In this section—
adopted policy means a policy adopted—**
 - (a) by the council, or**
 - (b) by another public authority, if the public authority has notified the council that the policy will be included in a planning certificate issued by the council.**

Clause 6.1 of the Bayside Local Environmental Plan 2021 - Acid Sulfate Soils

Contaminated Land Policy

Former City of Rockdale Council adopted by resolution a policy on contaminated land that may restrict the development of the land. This policy does not specifically identify the subject land (or any other land) as contaminated. The policy does, however, apply to all land in the former City of Rockdale. This policy is implemented when zoning or land use changes are proposed on lands that have previously been used for certain purposes. Consideration of the Council's adopted policy and the application of provisions under relevant State legislation is warranted.

11 Bush fire prone land

- (1) **If any of the land is bush fire prone land, designated by the Commissioner of the NSW Rural Fire Service under the Act, section 10.3, a statement that all or some of the land is bush fire prone land.**

(2) If none of the land is bush fire prone land, a statement to that effect.

The land **is not** bush fire prone land.

12 Loose-fill asbestos insulation

If the land includes residential premises, within the meaning of the *Home Building Act 1989*, Part 8, Division 1A, that are listed on the Register kept under that Division, a statement to that effect.

The land **is not** so listed.

13 Mine subsidence

Whether or not the land is declared to be a mine subsidence district within the meaning the *Coal Mine Subsidence Compensation Act 2017*

The land **is not** so proclaimed.

14 Paper subdivision information

**(1) The name of a development plan adopted by a relevant authority that or that –
(a) applies to the land, or
(b) is proposed to be subject to a ballot.**

(2) The date of a subdivision order that applies to the land.

(3) Words and expressions used in this section have the same meaning as in this Regulation, Part 10 and the Act, Schedule 7.

The land **is not** so affected.

15 Property vegetation plans

If the land is land in relation to which a property vegetation plan is approved and in force under the *Native Vegetation Act 2003*, Part 4, a statement to that effect, but only if the council has been notified of the existence of the plan by the person or body that approved the plan under that Act.

The land **is not** land to which a property vegetation plan applies.

16 Biodiversity stewardship sites

If the land is a biodiversity stewardship site under a biodiversity stewardship agreement under the *Biodiversity Conservation Act 2016*, Part 5, a statement to that effect, but only if the council has been notified of the existence of the agreement by the Biodiversity Conservation Trust.

Note— Biodiversity stewardship agreements include biobanking agreements under the *Threatened Species Conservation Act 1995*, Part 7A that are taken to be biodiversity stewardship agreements under the *Biodiversity Conservation Act 2016*, Part 5.

The land **is not** subject to any such agreement.

17 Biodiversity certified land

If the land is biodiversity certified land under the *Biodiversity Conservation Act 2016*, Part 8, a statement to that effect.

Note: Biodiversity certified land includes land certified under the *Threatened Species Conservation Act 1995*, Part 7AA that is taken to be certified under the *Biodiversity Conservation Act 2016*, Part 8.

The land is **not** biodiversity certified land.

18 Orders under *Trees (Disputes Between Neighbours) Act 2006*

Whether an order has been made under the *Trees (Disputes Between Neighbours) Act 2006* to carry out work in relation to a tree on the land, but only if the council has been notified of the order.

The land is **not** subject to such an order.

19 Annual charges under *Local Government Act 1993* for coastal protection services that relate to existing coastal protection works

(1) **If the *Coastal Management Act 2016* applies to the council, whether the owner, or a previous owner, of the land has given written consent to the land being subject to annual charges under the *Local Government Act 1993*, section 496B, for coastal protection services that relate to existing coastal protection works.**

(2) **In this section—
existing coastal protection works has the same meaning as in the *Local Government Act 1993*, section 553B.**

Note— Existing coastal protection works are works to reduce the impact of coastal hazards on land, such as seawalls, revetments, groynes and beach nourishment, that existed before 1 January 2011.

The land is **not** subject to annual charges.

20 State Environmental Planning Policy (Western Sydney Aerotropolis) 2020

Whether under *State Environmental Planning Policy (Western Sydney Aerotropolis) 2020* the land is—

- (a) **in an ANEF or ANEC contour of 20 or greater, as referred to in that Policy, clause 19, or**
- (b) **shown on the Lighting Intensity and Wind Shear Map, or**
- (c) **shown on the Obstacle Limitation Surface Map, or**
- (d) **in the “public safety area” on the Public Safety Area Map, or**
- (e) **in the “3 kilometre wildlife buffer zone” or the “13 kilometre wildlife buffer zone” on the Wildlife Buffer Zone Map.**

The land is **not** subject to the *State Environmental Planning Policy (Western Sydney Aerotropolis) 2020*.

21 Development consent conditions for seniors housing

If *State Environmental Planning Policy (Housing) 2021*, Chapter 3, Part 5 applies to the land, any conditions of a development consent granted after 11 October 2007 in relation to the land that are of the kind set out in that Policy, clause 88(2).

The land **is not** subject to any such statement.

22 Site compatibility certificates and development consent conditions for affordable rental housing

- (1) Whether there is a current site compatibility certificate under State Environmental Planning Policy (Housing) 2021, or a former site compatibility certificate, of which the council is aware, in relation to proposed development on the land and, if there is a certificate—
- (a) the period for which the certificate is current, and
 - (b) that a copy may be obtained from the Department.

The land **is not** subject to any such certificate.

- (2) If *State Environmental Planning Policy (Housing) 2021*, Chapter 2, Part 2, Division 1 or 5 applies to the land, any conditions of a development consent in relation to the land that are of a kind referred to in that Policy, clause 21(1) or 40(1).

The land **is not** subject to any such statement.

- (3) Any conditions of a development consent in relation to land that are of a kind referred to in *State Environmental Planning Policy (Affordable Rental Housing) 2009*, clause 17(1) or 38(1).

The land **is not** subject to any such statement.

- (a) In this section—
former site compatibility certificate means a site compatibility certificate issued under *State Environmental Planning Policy (Affordable Rental Housing) 2009*.

Section 59(2) Contaminated Land Management Act 1997

Note: The following matters are prescribed by section 59 (2) of *the Contaminated Land Management Act 1997* as additional matters to be specified in a planning certificate:

- (a) that the land to which the certificate relates is significantly contaminated land within the meaning of that Act—if the land (or part of the land) is significantly contaminated land at the date when the certificate is issued;

Not applicable

- (b) that the land to which the certificate relates is subject to a management order within the meaning of that Act—if it is subject to such an order at the date when the certificate is issued;

Not applicable

- (c) that the land to which the certificate relates is the subject of an approved voluntary management proposal within the meaning of that Act—if it is the subject of such an approved proposal at the date when the certificate is issued;

Not applicable

(d) that the land to which the certificate relates is subject to an ongoing maintenance order within the meaning of that Act—if it is subject to such an order at the date when the certificate is issued; and

Not applicable

(e) that the land to which the certificate relates is the subject of a site audit statement within the meaning of that Act—if a copy of such a statement has been provided at any time to the local authority issuing the certificate.

Not applicable

[End of information under section 10.7 (2)]

IMPORTANT NOTICE TO PURCHASERS

ALTERATIONS AND ADDITIONS TO BUILDINGS

Purchasers are reminded that it is necessary to obtain development consent from the Council prior to carrying out any building alterations or additions, including brick reskinning, replacing windows or internal alterations, or for the demolition of any building, unless the proposed work is specifically exempted by *Bayside Local Environmental Plan 2021* or *State Environmental Planning Policy (Exempt and Complying Development Codes) 2008*. All other building work does require the Council's approval.

Should you require any information or advice for any building work that you propose to undertake please contact the Council's Customer Service Centre on 1800 581 299.

LIST OF MATTERS ON WHICH ADVICE WILL BE PROVIDED BY THE COUNCIL UNDER SECTION 10.7 (5)

The Council will provide advice on the following additional matters not included in this Planning Certificate under section 10.7 (2) upon application for a full certificate and payment of the \$133 fee. The Council cannot issue advice under section 10.7 (5) separately.

- A Whether or not the Council has information which would indicate that the land is subject to the risk of flooding or tidal inundation for a 1% annual exceedance probability (AEP) (1 in 100 year) event.
- B Whether or not the Council has information which would indicate that the land is subject to slip or subsidence.
- C Whether or not the land is in the vicinity of a heritage item or heritage conservation area identified in an environmental planning instrument or a proposed heritage item or proposed heritage conservation area identified in a draft Local Environmental Plan.
- D Whether or not a planning agreement entered into under Subdivision 2 of Division 7.1 of Part 7 of the Environmental Planning and Assessment Act 1979 currently applies to the land (but only if, where the Council is not a party to the agreement, information about the agreement has been provided to the Council)
- E Details of the Annual Noise Exposure Forecast (ANEF) applying to the land
- F Information that indicates whether or not any additional hazards exist for which no policy of Council exists to restrict development
- G Restrictions of the use of groundwater contained within the Botany Sands Aquifer
- H Other policies that may be applicable to the land

Service Location Print

Application Number: 8001734722

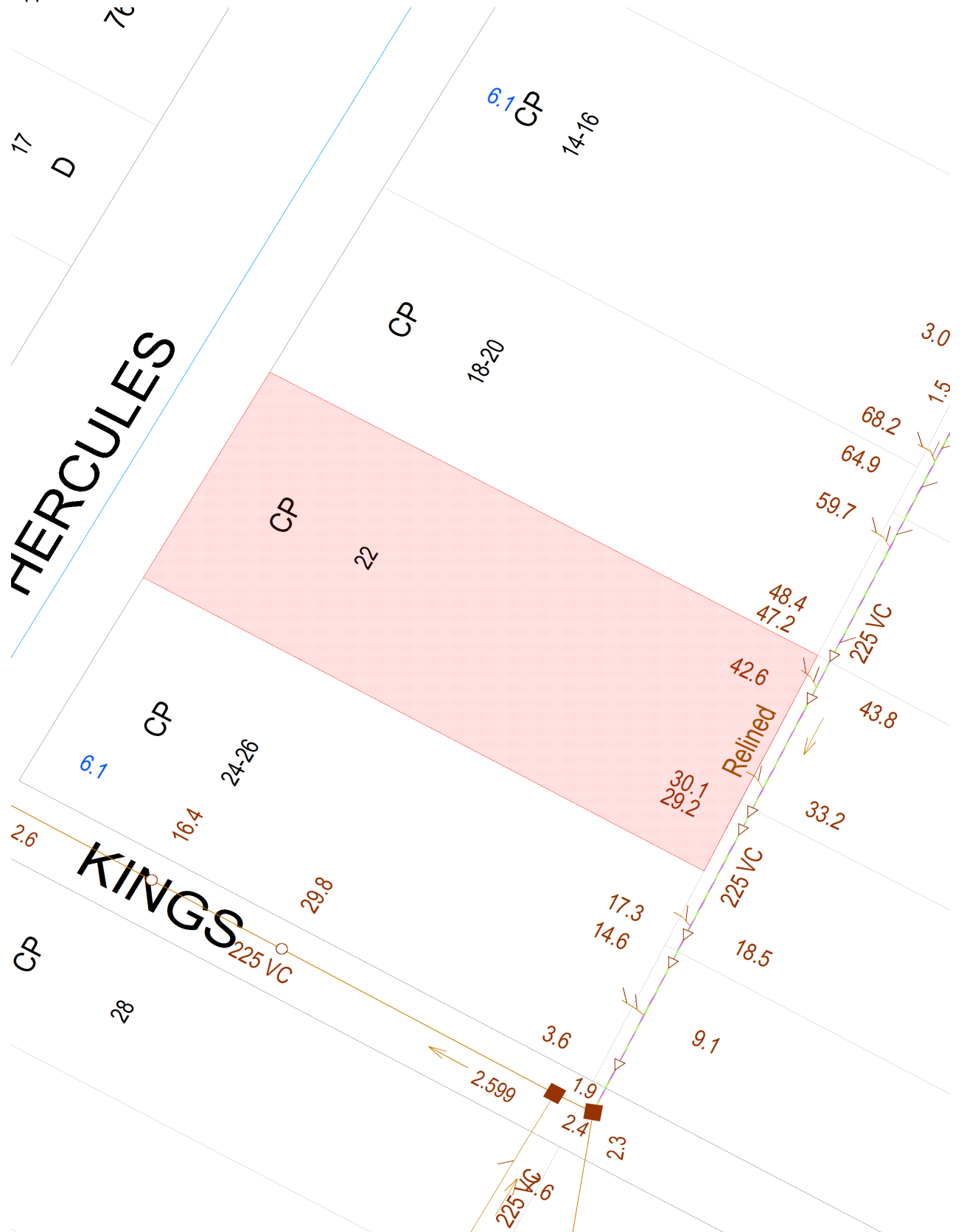

Document generated at 16-06-2022 09:20:33 AM

Disclaimer

The information on this print shows if we provide any water, wastewater or stormwater services to this property. It may not be accurate or to scale. If you'd like to see the location of private wastewater pipes on the property, please buy a **Sewer service diagram**.

Asset Information

Legend

Sewer		Property Details	
Sewer Main (with flow arrow & size type text)		Boundary Line	
Disused Main		Easement Line	
Rising Main		House Number	
Maintenance Hole (with upstream depth to invert)		Lot Number	
Sub-surface chamber		Proposed Land	
Maintenance Hole with Overflow chamber		Sydney Water Heritage Site (please call 132 092 and ask for the Heritage Unit)	
Ventshaft EDUCT			
Ventshaft INDUCT			
Property Connection Point (with chainage to downstream MH)			
Concrete Encased Section			
Terminal Maintenance Shaft			
Maintenance Shaft			
Rodding Point			
Lamphole			
Vertical			
Pumping Station			
Sewer Rehabilitation			
Pressure Sewer		Water	
Pressure Sewer Main		WaterMain - Potable (with size type text)	
Pump Unit (Alarm, Electrical Cable, Pump Unit)		Disconnected Main - Potable	
Property Valve Boundary Assembly		Proposed Main - Potable	
Stop Valve		Water Main - Recycled	
Reducer / Taper		Special Supply Conditions - Potable	
Flushing Point		Special Supply Conditions - Recycled	
		Restrained Joints - Potable	
		Restrained Joints - Recycled	
		Hydrant	
		Maintenance Hole	
		Stop Valve	
		Stop Valve with By-pass	
		Stop Valve with Tapers	
		Closed Stop Valve	
		Air Valve	
		Valve	
		Scour	
		Reducer / Taper	
		Vertical Bends	
		Reservoir	
		Recycled Water is shown as per Potable above. Colour as indicated	
Vacuum Sewer		Private Mains	
Pressure Sewer Main		Potable Water Main	
Division Valve		Recycled Water Main	
Vacuum Chamber		Sewer Main	
Clean Out Point		Symbols for Private Mains shown grey	
Stormwater			
Stormwater Pipe			
Stormwater Channel			
Stormwater Gully			
Stormwater Maintenance Hole			

Disclaimer

The information on this print shows if we provide any water, wastewater or stormwater services to this property. It may not be accurate or to scale. If you'd like to see the location of private wastewater pipes on the property, please buy a **Sewer service diagram**.

Pipe Types

ABS	Acrylonitrile Butadiene Styrene	AC	Asbestos Cement
BRICK	Brick	CI	Cast Iron
CICL	Cast Iron Cement Lined	CONC	Concrete
COPPER	Copper	DI	Ductile Iron
DICL	Ductile Iron Cement (mortar) Lined	DIPL	Ductile Iron Polymeric Lined
EW	Earthenware	FIBG	Fibreglass
FL BAR	Forged Locking Bar	GI	Galvanised Iron
GRP	Glass Reinforced Plastics	HDPE	High Density Polyethylene
MS	Mild Steel	MSCL	Mild Steel Cement Lined
PE	Polyethylene	PC	Polymer Concrete
PP	Polypropylene	PVC	Polyvinylchloride
PVC - M	Polyvinylchloride, Modified	PVC - O	Polyvinylchloride, Oriented
PVC - U	Polyvinylchloride, Unplasticised	RC	Reinforced Concrete
RC-PL	Reinforced Concrete Plastics Lined	S	Steel
SCL	Steel Cement (mortar) Lined	SCL IBL	Steel Cement Lined Internal Bitumen Lined
SGW	Salt Glazed Ware	SPL	Steel Polymeric Lined
SS	Stainless Steel	STONE	Stone
VC	Vitrified Clay	WI	Wrought Iron
WS	Woodstave		

Further Information

Please consult the Dial Before You Dig enquiries page on the Sydney Water website.

For general enquiries please call the Customer Contact Centre on 132 092

In an emergency, or to notify Sydney Water of damage or threats to its structures, call 13 20 90 (24 hours, 7 days)

Disclaimer

The information on this print shows if we provide any water, wastewater or stormwater services to this property. It may not be accurate or to scale. If you'd like to see the location of private wastewater pipes on the property, please buy a **Sewer service diagram**.

Sewer Service Diagram

Application Number: 8001734723

METROPOLITAN WATER SEWERAGE AND DRAINAGE BOARD
SEWERAGE SERVICE DIAGRAM

No. 342796

Municipality of Rockdale

- Boundary Trap
- ⊕ Inspection Shaft
- Pit
- GI Grease Interceptor
- ⊗ Gully
- PT P Trap

- RV Reflux Valve
- CE Cleaning Eye
- VERT Vertical Pipe
- VP Vent Pipe
- SVP Soil Vent Pipe
- DCC Down Cast Cowl
- IP Induct Pipe
- MF Mica Flap
- T Tubs
- KS Kitchen Sink
- WC Water Closet
- BW Bath Waste

- Bsn Basin
- Shr Shower
- WIP Wrought Iron Pipe
- CIP Cast Iron Pipe
- FW Floor Waste
- WM Washing Machine

SEWER AVAILABLE

Where the sewer is not available and a special inspection is involved the Board accepts no responsibility for the suitability of the drainage in relation to the eventual position of the Board's Sewer.

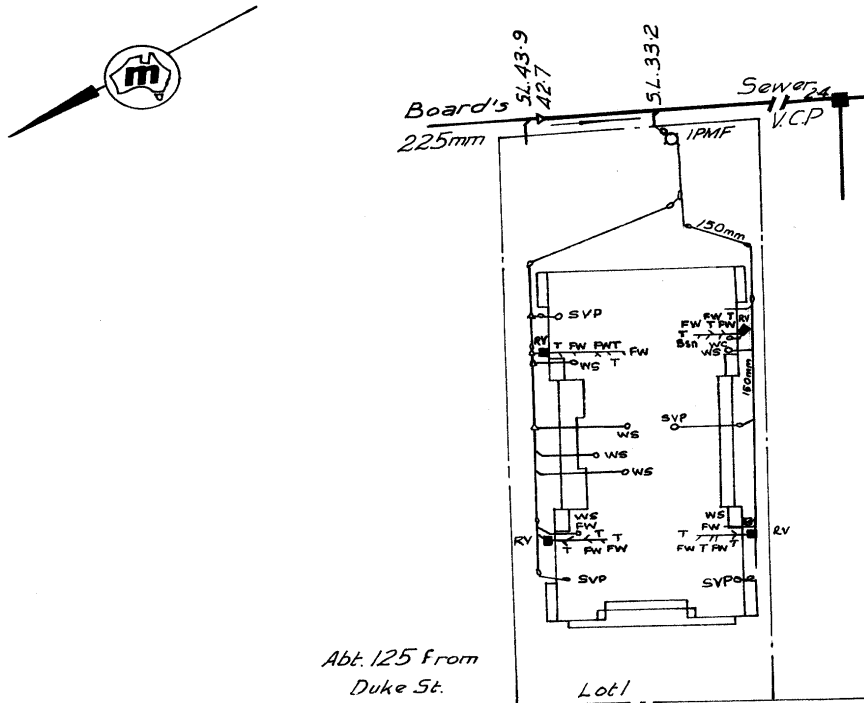

RATE No. W.C.s		Scale 1 : 500		For House Services Engineer	
SHEET No. 3065		U.C.s			
DRAINAGE		BRANCH OFFICE		PLUMBING	
Supervised by	Date	Date	Supervised by	Date	
Inspector		Outfall	Inspector		
Examined by		Drainer			
Chief Inspector		Plumber			
Tracing Checked		Boundary Trap			
		is/ required			

Disclaimer

The information in this diagram shows the private wastewater pipes on this property. It may not be accurate or to scale and may not show our pipes, structures or all property boundaries. If you'd like to see these, please buy a **Service location print**.