

DATED

2023

STEPHEN FRANCIS MCGUIRE

to

CONTRACT OF SALE OF REAL ESTATE

Property: 182 Christies Road, Leopold VIC 3224



**GEEELONG PROPERTY
CONVEYANCING**

Always here for you.

Geelong Property Conveyancing

163D Malop Street
GEEELONG VIC 3220
Tel: 0499 813 462
Ref: MVB:GPC-23/2703

Contract of Sale of Real Estate*

Part 1 of the form of contract published by the Law Institute of Victoria Limited and The Real Estate Institute of Victoria Ltd

Property address **182 Christies Road, Leopold VIC 3224**

The vendor agrees to sell and the purchaser agrees to buy the property, being the land and the goods, for the price and on the terms set out in this contract.

The terms of this contract are contained in the -

- particulars of sale; and
- special conditions, if any; and
- general conditions

in that order of priority.

SIGNING OF THIS CONTRACT

WARNING: THIS IS A LEGALLY BINDING AGREEMENT. YOU SHOULD READ THIS CONTRACT BEFORE SIGNING IT.

Purchasers should ensure that, prior to signing this contract, they have received -

- a copy of the section 32 statement required to be given by a vendor under section 32 of the *Sale of Land Act* 1962 in accordance with Division 2 of Part II of that Act; and
- a copy of the full terms of this contract.

The authority of a person signing -

- under power of attorney; or
- as director of a corporation; or
- as agent authorised in writing by one of the parties - must be noted beneath the signature.

Any person whose signature is secured by an estate agent acknowledges being given by the agent at the time of signing a copy of the terms of this contract.

SIGNED BY THE PURCHASER:

..... on/...../2023

Print names(s) of person(s) signing:

State nature of authority, if applicable:

This offer will lapse unless accepted within [] clear business days (3 clear business days if none specified)

SIGNED BY THE VENDOR:

..... on/...../2023

Print name(s) of person(s) signing: STEPHEN FRANCIS MCGUIRE

State nature of authority, if applicable:

The **DAY OF SALE** is the date by which both parties have signed this contract.

IMPORTANT NOTICE TO PURCHASERS

Cooling-off period (Section 31 of the *Sale of Land Act* 1962)

You may end this contract within 3 clear business days of the day that you sign the contract if none of the exceptions listed below applies to you.

You must either give the vendor or the vendor's agent **written** notice that you are ending the contract or leave the notice at the address of the vendor or the vendor's agent to end this contract within this time in accordance with this cooling-off provision.

You are entitled to a refund of all the money you paid EXCEPT for \$100 or 0.2% of the purchase price (whichever is more) if you end the contract in this way.

EXCEPTIONS: The 3-day cooling-off period does not apply if:

- you bought the property at or within 3 clear business days **before or after** a publicly advertised auction;
- the property is used primarily for industrial or commercial purposes; or
- the property is more than 20 hectares in size and is used primarily for farming; or
- you and the vendor have previously signed a contract for the sale of the same land in substantially the same terms; or
- you are an estate agent or a corporate body.

*This contract is approved by the Law Institute of Victoria Limited, a professional association within the meaning of the *Legal Profession Act* 2004, under section 53A of the *Estate Agents Act* 1980.

NOTICE TO PURCHASERS OF PROPERTY OFF-THE-PLAN

Off-the-plan sales (Section 9AA(1A) of the *Sale of Land Act 1962*)

You may negotiate with the vendor about the amount of the deposit moneys payable under the contract of sale, up to 10 per cent of the purchase price.

A substantial period of time may elapse between the day on which you sign

the contract of sale and the day on which you become the registered proprietor of the lot.

The value of the lot may change between the day on which you sign the contract of sale of that lot and the day on which you become the registered proprietor.

Particulars of sale

Vendor's estate agent

Name:	Wes Thornton Geelong Real Estate		
Address:	52 NORTH VALLEY RD, HIGHTON, VIC 3216		
Email:	wes@realestate-geelong.com.au		
Tel:		Mob: 0419 315 727	Fax: Ref: Wes Thornton

Vendor

Name:	Stephen Francis McGuire
Address:	9 Dovier Place, Leopold VIC 3224
ABN/ACN:	
Email:	wiresafe@gmail.com

Vendor's legal practitioner or conveyancer

Name:	Geelong Property Conveyancing		
Address:	163D Malop Street Geelong Victoria 3220		
Email:	matthew@gpconveyancing.com.au		
Tel:	0499 813 462	Fax:	DX: Ref: MVB:GPC-23/2703

Purchaser

Name:	
Address:	
ABN/ACN:	
Email:	

Purchaser's legal practitioner or conveyancer

Name:			
Address:			
Email:			
Tel:		Fax:	DX: Ref:

Land (general conditions 3 and 9)

The land is described in the table below –

Certificate of Title reference				being lot	on plan
Volume	10987	Folio	892	53	PS 536898F

OR

described in the copy of the Register Search Statement and the document or part document referred to as the diagram location in the Register Search Statement, as attached to the section 32 statement if no title or plan references are recorded in the table above or as described in the section 32 statement if the land is general law land.

The land includes all improvements and fixtures.

Property address

The address of the land is: 182 Christies Road, Leopold VIC 3224

Goods sold with the land (general condition 2.3(f)) (list or attach schedule)**Payment** (general condition 11)

Price \$

Deposit \$ By (of which \$ has been paid)

Balance \$ payable at settlement

GST (general condition 13)

The price includes GST (if any) unless the words '**plus GST**' appear in this box

If this sale is a sale of land on which a 'farming business' is carried on which the parties consider meets requirements of section 38-480 of the GST Act or of a 'going concern' then add the words '**farming business**' or '**going concern**' in this box

If the margin scheme will be used to calculate GST then add the words '**margin scheme**' in this box

Settlement (general condition 10)**is due on**

unless the land is a lot on an unregistered plan of subdivision, in which case settlement is due on the later of:

- the above date; or
- 14 days after the vendor gives notice in writing to the purchaser of registration of the plan of subdivision.

Lease (general condition 1.1)

At settlement the purchaser is entitled to vacant possession of the property unless the words '**subject to lease**' appear in this box in which case refer to general condition 1.1.

If '**subject to lease**' then particulars of the lease are*:

(*only complete the one that applies. Check tenancy agreement/lease **before** completing details)

☐ *residential tenancy agreement for a fixed term ending on

OR

☐ *periodic residential tenancy agreement determinable by notice

OR

☐ *lease for a term ending on with options to renew, each of years.

Terms contract (general condition 23)

If this contract is intended to be a terms contract within the meaning of the *Sale of Land Act* 1962 then add the words '**terms contract**' in this box and refer to general condition 23 and add any further provisions by way of special conditions.

Loan (general condition 14)

The following details apply if this contract is subject to a loan being approved.

Lender:

Loan amount:

Approval date:

This contract does not include any special conditions unless the words '**special conditions**' appear in this box

special conditions

Special Conditions

A SPECIAL CONDITION OPERATES IF THE BOX NEXT TO IT IS CHECKED OR THE PARTIES OTHERWISE AGREE IN WRITING.

Instructions: *It is recommended that when adding further special conditions:*

- *each special condition is numbered;*
 - *the parties initial each page containing special conditions;*
 - *a line is drawn through any blank space remaining on this page; and*
 - *attach additional pages if there is not enough space.*
-



Special condition 1 – Payment

General condition 11 is replaced with the following:

11. PAYMENT

- 11.1 The purchaser must pay the deposit:
- (a) to the vendor's licensed estate agent; or
 - (b) if there is no estate agent, to the vendor's legal practitioner or conveyancer; or
 - (c) if the vendor directs, into a special purpose account in an authorised deposit-taking institution in Victoria specified by the vendor in the joint names of the purchaser and the vendor.
- 11.2 If the land sold is a lot on an unregistered plan of subdivision, the deposit:
- (a) must not exceed 10% of the price; and
 - (b) must be paid to the vendor's estate agent, legal practitioner or conveyancer and held by the estate agent, legal practitioner or conveyancer on trust for the purchaser until the registration of the plan of subdivision.
- 11.3 The purchaser must pay all money other than the deposit:
- (a) to the vendor, or the vendor's legal practitioner or conveyancer; or
 - (b) in accordance with a written direction of the vendor or the vendor's legal practitioner or conveyancer.
- 11.4 Payments may be made or tendered:
- (a) up to \$1,000 in cash; or
 - (b) by cheque drawn on an authorised deposit-taking institution; or
 - (c) by electronic funds transfer to a recipient having the appropriate facilities for receipt.
- However, unless otherwise agreed:
- (d) payment may not be made by credit card, debit card or any other financial transfer system that allows for any chargeback or funds reversal other than for fraud or mistaken payment, and
 - (e) any financial transfer or similar fees or deductions from the funds transferred, other than any fees charged by the recipient's authorised deposit-taking institution, must be paid by the remitter.
- 11.5 At settlement, the purchaser must pay the fees on up to three cheques drawn on an authorised deposit-taking institution. If the vendor requests that any additional cheques be drawn on an authorised deposit-taking institution, the vendor must reimburse the purchaser for the fees incurred.
- 11.6 Payment by electronic funds transfer is made when cleared funds are received in the recipient's bank account.
- 11.7 Before the funds are electronically transferred the intended recipient must be notified in writing and given sufficient particulars to readily identify the relevant transaction.
- 11.8 As soon as the funds have been electronically transferred the intended recipient must be provided with the relevant transaction number or reference details.
- 11.9 Each party must do everything reasonably necessary to assist the other party to trace and identify the recipient of any missing or mistaken payment and to recover the missing or mistaken payment.
- 11.10 For the purpose of this general condition 'authorised deposit-taking institution' means a body corporate for which an authority under section 9(3) of the *Banking Act 1959 (Cth)* is in force.



Special condition 2 – Acceptance of title

General condition 12.4 is added:

- 12.4 Where the purchaser is deemed by section 27(7) of the *Sale of Land Act 1962* to have given the deposit release authorisation referred to in section 27(1), the purchaser is also deemed to have accepted title in the absence of any prior express objection to title.



Special condition 3 – Tax invoice

General condition 13.3 is replaced with the following:

- 13.3 If the vendor makes a taxable supply under this contract (that is not a margin scheme supply) and:
- (a) the price includes GST; or
 - (b) the purchaser is obliged to pay an amount for GST in addition to the price (because the price is "plus

GST" or under general condition 13.1(a), (b) or (c)),
the purchaser is not obliged to pay the GST included in the price, or the additional amount payable for GST,
until a tax invoice has been provided.

☒ **Special condition 4 – Adjustments**

General condition 15.3 is added:

- 15.3 The Purchaser must provide copies of all certificates, searches, and other information obtained by the Purchaser used to calculate the adjustments under general condition 15, if requested by the Vendor. Should the Purchaser fail to obtain and provide certificates, then the adjustments will be calculated as having been paid in full by the Vendor and the relevant adjustments recorded. The Purchaser acknowledges that in such instance they forfeit any right and/or ability to adjust at or after settlement.

☒ **Special condition 5 - Foreign resident capital gains withholding**

General condition 15A is added:

15A. FOREIGN RESIDENT CAPITAL GAINS WITHHOLDING

- 15A.1 Words defined or used in Subdivision 14-D of Schedule 1 to the *Taxation Administration Act 1953 (Cth)* have the same meaning in this general condition unless the context requires otherwise.
- 15A.2 Every vendor under this contract is a foreign resident for the purposes of this general condition unless the vendor gives the purchaser a clearance certificate issued by the Commissioner under section 14-220 (1) of Schedule 1 to the *Taxation Administration Act 1953 (Cth)*. The specified period in the clearance certificate must include the actual date of settlement.
- 15A.3 This general condition only applies if the purchaser is required to pay the Commissioner an amount in accordance with section 14-200(3) or section 14-235 of Schedule 1 to the *Taxation Administration Act 1953 (Cth)* ("the amount") because one or more of the vendors is a foreign resident, the property has or will have a market value not less than the amount set out in section 14-215 of the legislation just after the transaction, and the transaction is not excluded under section 14-215(1) of the legislation.
- 15A.4 The amount is to be deducted from the vendor's entitlement to the contract consideration. The vendor must pay to the purchaser at settlement such part of the amount as is represented by non-monetary consideration.
- 15A.5 The purchaser must:
- (a) engage a legal practitioner or conveyancer ("representative") to conduct all the legal aspects of settlement, including the performance of the purchaser's obligations under the legislation and this general condition; and
 - (b) ensure that the representative does so.
- 15A.6 The terms of the representative's engagement are taken to include instructions to have regard to the vendor's interests and instructions that the representative must:
- (a) pay, or ensure payment of, the amount to the Commissioner in the manner required by the Commissioner and as soon as reasonably and practicably possible, from moneys under the control or direction of the representative in accordance with this general condition if the sale of the property settles;
 - (b) promptly provide the vendor with proof of payment; and
 - (c) otherwise comply, or ensure compliance, with this general condition;
- despite:
- (d) any contrary instructions, other than from both the purchaser and the vendor; and
 - (e) any other provision in this contract to the contrary.
- 15A.7 The representative is taken to have complied with the requirements of general condition 15A.6 if:
- (a) the settlement is conducted through the electronic conveyancing system operated by Property Exchange Australia Ltd or any other electronic conveyancing system agreed by the parties; and
 - (b) the amount is included in the settlement statement requiring payment to the Commissioner in respect of this transaction.
- 15A.8 Any clearance certificate or document evidencing variation of the amount in accordance with section 14-235(2) of Schedule 1 to the *Taxation Administration Act 1953 (Cth)* must be given to the purchaser at least 5 business days before the due date for settlement.
- 15A.9 The vendor must provide the purchaser with such information as the purchaser requires to comply with the purchaser's obligation to pay the amount in accordance with section 14-200 of Schedule 1 to the *Taxation Administration Act 1953 (Cth)*. The information must be provided within 5 business days of request by the purchaser. The vendor warrants that the information the vendor provides is true and correct.
- 15A.10 The purchaser is responsible for any penalties or interest payable to the Commissioner on account of late payment of the amount.

☐ **Special condition 5A – GST withholding**

[Note: the box should be checked if the property sold is or may be new residential premises or potential residential land, whether or not falling within the parameters of section 14-250 of Schedule 1 of the *Taxation Administration Act 1953 (Cth)*]

General condition 15B is added:

15B. GST WITHHOLDING

- 15B.1 Words and expressions defined or used in Subdivision 14-E of Schedule 1 to the *Taxation Administration Act 1953 (Cth)* or in *A New Tax System (Goods and Services Tax) Act 1999 (Cth)* have the same meaning in this general condition unless the context requires otherwise. Words and expressions first used in this general condition and shown in italics and marked with an asterisk are defined or described in at least one of those Acts.
- 15B.2 This general condition 15B applies if the purchaser is required to pay the Commissioner an *amount in accordance with section 14-250 of Schedule 1 to the *Taxation Administration Act 1953 (Cth)* because the property is *new residential premises or *potential residential land in either case falling within the parameters of that section, and also if the sale attracts the operation of section 14-255 of the legislation. Nothing in this general condition 15B is to be taken as relieving the vendor from compliance with section 14-255.
- 15B.3 The amount is to be deducted from the vendor's entitlement to the contract *consideration and is then taken to be paid to the vendor, whether or not the vendor provides the purchaser with a GST withholding notice in accordance with section 14-255 of Schedule 1 to the *Taxation Administration Act 1953 (Cth)*. The vendor must pay to the purchaser at settlement such part of the amount as is represented by non-monetary consideration.
- 15B.4 The purchaser must:
- (a) engage a legal practitioner or conveyancer ("representative") to conduct all the legal aspects of settlement, including the performance of the purchaser's obligations under the legislation and this general condition; and
 - (b) ensure that the representative does so.
- 15B.5 The terms of the representative's engagement are taken to include instructions to have regard to the vendor's interests relating to the payment of the amount to the Commissioner and instructions that the representative must:
- (a) pay, or ensure payment of, the amount to the Commissioner in the manner required by the Commissioner and as soon as reasonably and practicably possible, from moneys under the control or direction of the representative in accordance with this general condition on settlement of the sale of the property;
 - (b) promptly provide the vendor with evidence of payment, including any notification or other document provided by the purchaser to the Commissioner relating to payment; and
 - (c) otherwise comply, or ensure compliance, with this general condition;
- despite:
- (d) any contrary instructions, other than from both the purchaser and the vendor; and
 - (e) any other provision in this contract to the contrary.
- 15B.6 The representative is taken to have complied with requirements of general condition 15B.5 if:
- (a) settlement is conducted through the electronic conveyancing system operated by Property Exchange Australia Ltd or any other electronic conveyancing system agreed by the parties; and
 - (b) the amount is included in the settlement statement requiring payment to the Commissioner in respect of this transaction.
- 15B.7 The purchaser may at settlement give the vendor a bank cheque for the amount in accordance with section 16-30 (3) of Schedule 1 to the *Taxation Administration Act 1953 (Cth)*, but only if:
- (a) so agreed by the vendor in writing; and
 - (b) the settlement is not conducted through an electronic settlement system described in general condition 15B.6.
- However, if the purchaser gives the bank cheque in accordance with this general condition 15B.7, the vendor must:
- (c) immediately after settlement provide the bank cheque to the Commissioner to pay the amount in relation to the supply; and
 - (d) give the purchaser a receipt for the bank cheque which identifies the transaction and includes particulars of the bank cheque, at the same time the purchaser gives the vendor the bank cheque.
- 15B.8 The vendor must provide the purchaser with a GST withholding notice in accordance with section 14-255 of Schedule 1 to the *Taxation Administration Act 1953 (Cth)* at least 14 days before the due date for settlement.
- 15B.9 A party must provide the other party with such information as the other party requires to:
- (a) decide if an amount is required to be paid or the quantum of it, or
 - (b) comply with the purchaser's obligation to pay the amount,
- in accordance with section 14-250 of Schedule 1 to the *Taxation Administration Act 1953 (Cth)*. The information must be provided within 5 business days of a written request. The party providing the information warrants that it is true and correct.
- 15B.10 The vendor warrants that:
- (a) at settlement, the property is not new residential premises or potential residential land in either case falling within the parameters of section 14-250 of Schedule 1 to the *Taxation Administration Act 1953 (Cth)* if the vendor gives the purchaser a written notice under section 14-255 to the effect that the purchaser will not be required to make a payment under section 14-250 in respect of the supply, or fails to give a written notice as required by and within the time specified in section 14-255; and
 - (b) the amount described in a written notice given by the vendor to the purchaser under section 14-255 of Schedule 1 to the *Taxation Administration Act 1953 (Cth)* is the correct amount required to be paid under section 14-250 of the legislation.
- 15B.11 The purchaser is responsible for any penalties or interest payable to the Commissioner on account of non-payment or late payment of the amount, except to the extent that:

- (a) the penalties or interest arise from the vendor's failure, including breach of a warranty in general condition 15B.10; or
 - (b) the purchaser's reasonable belief that the property is neither new residential premises nor potential residential land requiring the purchaser to pay an amount to the Commissioner in accordance with section 14-250 (1) of Schedule 1 to the *Taxation Administration Act 1953 (Cth)*.
- The vendor is responsible for any penalties or interest payable to the Commissioner on account of non-payment or late payment of the amount if either exception applies.

15B.12 This general condition will not merge on settlement.



Special condition 6 – Service

General condition 17 is replaced with the following:

17. SERVICE

- 17.1 Any document required to be served by or on any party may be served by or on the legal practitioner or conveyancer for that party.
- 17.2 A document being a cooling off notice under section 31 of the *Sale of Land Act 1962* or a notice under general condition 14.2 (ending the contract if the loan is not approved) may be served on the vendor's legal practitioner, conveyancer or estate agent even if the estate agent's authority has formally expired at the time of service.
- 17.3 A document is sufficiently served:
 - (a) personally, or
 - (b) by pre-paid post, or
 - (c) in any manner authorized by law or by the Supreme Court for service of documents, including any manner authorised for service on or by a legal practitioner, whether or not the person serving or receiving the document is a legal practitioner, or
 - (d) by email.
- 17.4 Any document properly sent by:
 - (a) express post is taken to have been served on the next business day after posting, unless proved otherwise;
 - (b) priority post is taken to have been served on the fourth business day after posting, unless proved otherwise;
 - (c) regular post is taken to have been served on the sixth business day after posting, unless proved otherwise;
 - (d) email is taken to have been served at the time of receipt within the meaning of section 13A of the *Electronic Transactions (Victoria) Act 2000*.
- 17.5 The expression 'document' includes 'demand' and 'notice', and 'service' includes 'give' in this contract.



Special condition 7 – Notices

General condition 21 is replaced with the following:

21. NOTICES

- 21.1 The vendor is responsible for any notice, order, demand or levy imposing liability on the property that is issued or made before the day of sale, and does not relate to periodic outgoings.
- 21.2 The purchaser is responsible for any notice, order, demand or levy imposing liability on the property that is issued or made on or after the day of sale, and does not relate to periodic outgoings.
- 21.3 The purchaser may enter the property to comply with that responsibility where action is required before settlement.



Special condition 8 – Electronic conveyancing

- 8.1 Settlement and lodgement of the instruments necessary to record the purchaser as registered proprietor of the land will be conducted electronically in accordance with the *Electronic Conveyancing National Law*. The parties may subsequently agree in writing that this special condition 8 applies even if the box next to it is not checked. This special condition 8 has priority over any other provision to the extent of any inconsistency.
- 8.2 A party must immediately give written notice if that party reasonably believes that settlement and lodgement can no longer be conducted electronically. Special condition 8 ceases to apply from when such a notice is given.
- 8.3 Each party must:
 - (a) be, or engage a representative who is, a subscriber for the purposes of the *Electronic Conveyancing National Law*,
 - (b) ensure that all other persons for whom that party is responsible and who are associated with this transaction are, or engage, a subscriber for the purposes of the *Electronic Conveyancing National Law*, and
 - (c) conduct the transaction in accordance with the *Electronic Conveyancing National Law*.
- 8.4 The vendor must open the Electronic Workspace ("workspace") as soon as reasonably practicable. The inclusion of a specific date for settlement in a workspace is not of itself a promise to settle on that date. The workspace is an electronic address for the service of notices and for written communications for the purposes of any electronic transactions legislation.

- 8.5 The vendor must nominate a time of the day for locking of the workspace at least 7 days before the due date for settlement.
- 8.6 Settlement occurs when the workspace records that:
- (a) the exchange of funds or value between financial institutions in accordance with the instructions of the parties has occurred; or
 - (b) if there is no exchange of funds or value, the documents necessary to enable the purchaser to become registered proprietor of the land have been accepted for electronic lodgement.
- 8.7 The parties must do everything reasonably necessary to effect settlement:
- (a) electronically on the next business day, or
 - (b) at the option of either party, otherwise than electronically as soon as possible –
- if, after the locking of the workspace at the nominated settlement time, settlement in accordance with special condition 8.6 has not occurred by 4.00 pm, or 6.00 pm if the nominated time for settlement is after 4.00 pm.
- 8.8 Each party must do everything reasonably necessary to assist the other party to trace and identify the recipient of any missing or mistaken payment and to recover the missing or mistaken payment.
- 8.9 The vendor must before settlement:
- (a) deliver any keys, security devices and codes ("keys") to the estate agent named in the contract,
 - (b) direct the estate agent to give the keys to the purchaser or the purchaser's nominee on notification of settlement by the vendor, the vendor's subscriber or the Electronic Network Operator;
 - (c) deliver all other physical documents and items (other than the goods sold by the contract) to which the purchaser is entitled at settlement, and any keys if not delivered to the estate agent, to the vendor's subscriber or, if there is no vendor's subscriber, confirm in writing to the purchaser that the vendor holds those documents, items and keys at the vendor's address set out in the contract, and
- give, or direct its subscriber to give, all those documents and items and any such keys to the purchaser or the purchaser's nominee on notification by the Electronic Network Operator of settlement.
- 8.10 The vendor must, at least 7 days before the due date for settlement, provide the original of any document required to be prepared by the vendor in accordance with general condition 6.



Special condition 9 – Deposit bond

- 9.1 In this special condition:
- (a) "deposit bond" means an irrevocable undertaking by an issuer in a form satisfactory to the vendor to pay on demand an amount equal to the deposit or any unpaid part of the deposit. The deposit bond must have an expiry date at least 30 days after the agreed date for settlement.
 - (b) "issuer" means an entity regulated by the Australian Prudential Regulatory Authority or the Reserve Bank of New Zealand;
- 9.2 The purchaser may deliver a deposit bond to the vendor's estate agent, legal practitioner or conveyancer within 7 days after the day of sale.
- 9.3 The purchaser may at least 30 days before a current deposit bond expires deliver a replacement deposit bond on the same terms and conditions.
- 9.4 Where a deposit bond is delivered, the purchaser must pay the deposit to the vendor's legal practitioner or conveyancer on the first to occur of:
- (a) settlement;
 - (b) the date that is 30 days before the deposit bond expires;
 - (c) the date on which this contract ends in accordance with general condition 28.2 following breach by the purchaser; and
 - (d) the date on which the vendor ends this contract by accepting repudiation of it by the purchaser.
- 9.5 The vendor may claim on the deposit bond without prior notice if the purchaser defaults under this contract or repudiates this contract and the contract is ended. The amount paid by the issuer satisfies the obligations of the purchaser under special condition 9.4 to the extent of the payment.
- 9.6 Nothing in this special condition limits the rights of the vendor if the purchaser defaults under this contract or repudiates this contract, except as provided in special condition 9.5.
- 9.7 This special condition is subject to general condition 11.2.



Special condition 10 – Bank guarantee

- 10.1 In this special condition:
- (a) "bank guarantee" means an unconditional and irrevocable guarantee or undertaking by a bank in a form satisfactory to the vendor to pay on demand any amount under this contract agreed in writing, and
 - (b) "bank" means an authorised deposit-taking institution under the *Banking Act 1959 (Cth)*.
- 10.2 The purchaser may deliver a bank guarantee to the vendor's legal practitioner or conveyancer.
- 10.3 The purchaser must pay the amount secured by the bank guarantee to the vendor's legal practitioner or conveyancer on the first to occur of:
- (a) settlement;
 - (b) the date that is 30 days before the bank guarantee expires;

- (c) the date on which this contract ends in accordance with general condition 28.2 following breach by the purchaser; and
 - (d) the date on which the vendor ends this contract by accepting repudiation of it by the purchaser.
- 10.4 The vendor must return the bank guarantee document to the purchaser when the purchaser pays the amount secured by the bank guarantee in accordance with special condition 10.3.
- 10.5 The vendor may claim on the bank guarantee without prior notice if the purchaser defaults under this contract or repudiates this contract and the contract is ended. The amount paid by the bank satisfies the obligations of the purchaser under special condition 10.3 to the extent of the payment.
- 10.6 Nothing in this special condition limits the rights of the vendor if the purchaser defaults under this contract or repudiates this contract except as provided in special condition 10.5.
- 10.7 This special condition is subject to general condition 11.2.



Special condition 11 – Building report

- 11.1 The purchaser may end this contract within 14 days from the day of sale if the purchaser:
- (a) obtains a written report from a registered building practitioner which discloses a current defect in a structure on the land and designates it as a major building defect;
 - (b) gives the vendor a copy of the report and a written notice ending this contract; and
 - (c) is not then in default.
- 11.2 All money paid must be immediately refunded to the purchaser if the contract ends in accordance with this special condition.
- 11.3 A notice under this special condition may be served on the vendor's legal practitioner, conveyancer or estate agent even if the estate agent's authority has formally expired at the time of service.
- 11.4 The registered building practitioner may inspect the property at any reasonable time for the purpose of preparing the report.



Special condition 12 – Pest report

- 12.1 The purchaser may end this contract within 14 days from the day of sale if the purchaser:
- (a) obtains a written report from a pest control operator licensed under Victorian law which discloses a current pest infestation on the land and designates it as a major infestation;
 - (b) gives the vendor a copy of the report and a written notice ending this contract; and
 - (c) is not then in default.
- 12.2 All money paid must be immediately refunded to the purchaser if the contract ends in accordance with this special condition.
- 12.3 A notice under this special condition may be served on the vendor's legal practitioner, conveyancer or estate agent even if the estate agent's authority has formally expired at the time of service.
- 12.4 The pest control operator may inspect the property at any reasonable time for the purpose of preparing the report.



Special condition 13 – Swimming Pool (if Applicable)

- 13.1 If the Land includes a swimming pool, spa or pond ("Pool"), the Purchaser acknowledges and agrees that:
- (a) the Purchaser, as the new owner of the Property, has made their own enquiries regarding the obligations with respect to the Pool and any existing or required safety barriers located at the Property;
 - (b) from signing the Purchaser will be responsible to comply with the Building Act 1993 (Vic) and its Regulations (including any amendments to the Building Act 1993) in relation to a Pool and the required safety barriers;
 - (c) the Purchaser shall not make any claim against the Vendor in relation to the Pool or any existing or required safety barriers;
 - (d) the Purchaser shall indemnify the Vendor against all costs associated with the Pool including any existing safety barriers; and
 - (e) Neither the Vendor nor the Vendor's Estate Agent has made any representations or warranties in relation to the Pool or any safety barriers.



Special condition 14 – Solar Panels (if Applicable)

- 14.1 If there are any solar panels on the Land, the Purchaser acknowledges and agrees that:
- (a) whether or not any benefits currently provided to the Vendor by Agreement with the current energy service provider (including feed in tariffs) pass to the Purchaser on the sale of the Land is a matter for enquiry and confirmation by the Purchaser, and the Vendor makes no warranty or representation in this regard;
 - (b) the Purchaser will make his own negotiations with the current energy supplier or an energy supplier of the Purchaser's choice with regard to feed in tariffs for any electricity generated or any benefit provided by the solar panels;
 - (c) the Vendor nor the Vendor's Estate Agent have made any representations or warranties with respect to the solar panels or their state of repair or purpose which they were installed.



Special condition 15 – Public Auction (if Applicable)

- 15.1 The property is offered for sale by public auction subject to the vendor's reserve price. The rules for the conduct of the auction

shall be as set out in the schedules to the Sale of Land (Public Auctions) Regulations 2014 or any rules prescribed by regulation which modify or replace those rules.



Special condition 16 – Dwelling

- 16.1 Any improvements on the property, including but not limited to, any buildings, alterations or additions, swimming pool or spa, are sold hereby and inspected by the purchaser, are sold on the basis of existing improvements thereon, and the purchaser shall not make any requisition or claim any compensation for any deficiency or defect in the said improvements as to their suitability for occupation, or in relation to compliance with the Building Act 1993, Victorian Building Regulations, municipal bylaws, relevant statutes, or any regulation thereunder or any repealed laws under which the improvements were constructed, including the issue or non-issue of Building Permits, Builders Warranty Insurance, in respect of building works and/or compensation of inspections by the relevant authorities.
- 16.2 In respect to any improvements in accordance with Special Condition 16.1, any failure to comply with any one or more of those laws (of their statutory successors) shall not, and shall be deemed not to constitute a defect in the Vendors Title and the Purchaser shall not may any requisition or claim any compensation from the Vendor on that ground.
- 16.3 It is the Purchasers responsibility to measure the property prior to purchase to ensure that the measurements correspond with the measurements on the Title as a Purchaser cannot claim any compensation from a vendor for any discrepancy in measurements discovered after signing of the Contract.



Special condition 17

- 17.1 General Conditions 8 and 24.3 – 24.6 do not apply to this Contract.



Special condition 18

- 18.1 General condition 14.2 (c) herein shall be deleted and substituted to read as follows: -(c) serves written notice ending the contract, together with written evidence of rejection or non-approval of the loan from approved lending institution, (a letter from the broker is not deemed acceptable under this contract), on the vendor within 2 clear business days after the approval date or any later date allowed by the vendor. Such notice must be on a formal letter head from the approved lending institution which the loan application was applied to.
-

General Conditions

Part 2 being Form 2 prescribed by the former *Estate Agents (Contracts) Regulations 2008*

Title

1. ENCUMBRANCES

- 1.1 The purchaser buys the property subject to:
 - (a) any encumbrance shown in the section 32 statement other than mortgages or caveats; and
 - (b) any reservations in the crown grant; and
 - (c) any lease referred to in the particulars of sale.
- 1.2 The purchaser indemnifies the vendor against all obligations under any lease that are to be performed by the landlord after settlement.
- 1.3 In this general condition 'section 32 statement' means a statement required to be given by a vendor under section 32 of the *Sale of Land Act 1962* in accordance with Division 2 of Part II of that Act.

2. VENDOR WARRANTIES

- 2.1 The vendor warrants that these general conditions 1 to 28 are identical to the general conditions 1 to 28 in the standard form of contract of sale of real estate prescribed by the former Estate Agents (Contracts) Regulations 2008 for the purposes of section 53A of the *Estate Agents Act 1980*.
- 2.2 The warranties in general conditions 2.3 and 2.4 replace the purchaser's right to make requisitions and inquiries.
- 2.3 The vendor warrants that the vendor:
 - (a) has, or by the due date for settlement will have, the right to sell the land; and
 - (b) is under no legal disability; and
 - (c) is in possession of the land, either personally or through a tenant; and
 - (d) has not previously sold or granted any option to purchase, agreed to a lease or granted a pre-emptive right which is current over the land and which gives another party rights which have priority over the interest of the purchaser; and
 - (e) will at settlement be the holder of an unencumbered estate in fee simple in the land; and
 - (f) will at settlement be the unencumbered owner of any improvements, fixtures, fittings and goods sold with the land.
- 2.4 The vendor further warrants that the vendor has no knowledge of any of the following:
 - (a) public rights of way over the land;
 - (b) easements over the land;
 - (c) lease or other possessory agreement affecting the land;
 - (d) notice or order affecting the land which will not be dealt with at settlement, other than the usual rate notices and any land tax notices;
 - (e) legal proceedings which would render the sale of the land void or voidable or capable of being set aside.
- 2.5 The warranties in general conditions 2.3 and 2.4 are subject to any contrary provisions in this contract and disclosures in the section 32 statement required to be given by the vendor under section 32 of the *Sale of Land Act 1962* in accordance with Division 2 of Part II of that Act.
- 2.6 If sections 137B and 137C of the *Building Act 1993* apply to this contract, the vendor warrants that:
 - (a) all domestic building work carried out in relation to the construction by or on behalf of the vendor of the home was carried out in a proper and workmanlike manner; and
 - (b) all materials used in that domestic building work were good and suitable for the purpose for which they were used and that, unless otherwise stated in the contract, those materials were new; and
 - (c) domestic building work was carried out in accordance with all laws and legal requirements, including, without limiting the generality of this warranty, the *Building Act 1993* and regulations made under the *Building Act 1993*.
- 2.7 Words and phrases used in general condition 2.6 which are defined in the *Building Act 1993* have the same meaning in general condition 2.6.

3. IDENTITY OF THE LAND

- 3.1 An omission or mistake in the description of the property or any deficiency in the area, description or measurements of the land does not invalidate the sale.
- 3.2 The purchaser may not:
 - (a) make any objection or claim for compensation for any alleged misdescription of the property or any deficiency in its area or measurements; or
 - (b) require the vendor to amend title or pay any cost of amending title.

4. SERVICES

- 4.1 The vendor does not represent that the services are adequate for the purchaser's proposed use of the property and the vendor advises the purchaser to make appropriate inquiries. The condition of the services may change between the day of sale and settlement and the vendor does not promise that the services will be in the same condition at settlement as they were on the day of sale.
- 4.2 The purchaser is responsible for the connection of all services to the property after settlement and the payment of any associated cost.

5. CONSENTS

The vendor must obtain any necessary consent or licence required for the sale. The contract will be at an end and all money paid must be refunded if any necessary consent or licence is not obtained by settlement.

6. TRANSFER

The transfer of land document must be prepared by the purchaser and delivered to the vendor at least 10 days before settlement. The delivery of the transfer of land document is not acceptance of title. The vendor must prepare any document required for assessment of duty on this transaction relating to matters that are or should be within the knowledge of the vendor and, if requested by the purchaser, must provide a copy of that document at least 3 days before settlement.

7. RELEASE OF SECURITY INTEREST

- 7.1 This general condition applies if any part of the property is subject to a security interest to which the *Personal Property Securities Act 2009* (Cth) applies.
- 7.2 For the purposes of enabling the purchaser to search the Personal Property Securities Register for any security interests affecting any personal property for which the purchaser may be entitled to a release, statement, approval or correction in accordance with general condition 7.4, the purchaser may request the vendor to provide the vendor's date of birth to the purchaser. The vendor must comply with a request made by the purchaser under this condition if the purchaser makes the request at least 21 days before the due date for settlement.
- 7.3 If the purchaser is given the details of the vendor's date of birth under condition 7.2, the purchaser must
- (a) only use the vendor's date of birth for the purposes specified in condition 7.2; and
 - (b) keep the date of birth of the vendor secure and confidential.
- 7.4 The vendor must ensure that at or before settlement, the purchaser receives—
- (a) a release from the secured party releasing the property from the security interest; or
 - (b) a statement in writing in accordance with section 275(1)(b) of the *Personal Property Securities Act 2009* (Cth) setting out that the amount or obligation that is secured is nil at settlement; or
 - (c) a written approval or correction in accordance with section 275(1)(c) of the *Personal Property Securities Act 2009* (Cth) indicating that, on settlement, the personal property included in the contract is not or will not be property in which the security interest is granted.
- 7.5 Subject to general condition 7.6, the vendor is not obliged to ensure that the purchaser receives a release, statement, approval or correction in respect of personal property—
- (a) that—
 - (i) the purchaser intends to use predominantly for personal, domestic or household purposes; and
 - (ii) has a market value of not more than \$5000 or, if a greater amount has been prescribed for the purposes of section 47(1) of the *Personal Property Securities Act 2009* (Cth), not more than that prescribed amount; or
 - (b) that is sold in the ordinary course of the vendor's business of selling personal property of that kind.
- 7.6 The vendor is obliged to ensure that the purchaser receives a release, statement, approval or correction in respect of personal property described in general condition 7.5 if—
- (a) the personal property is of a kind that may or must be described by serial number in the Personal Property Securities Register; or
 - (b) the purchaser has actual or constructive knowledge that the sale constitutes a breach of the security agreement that provides for the security interest.
- 7.7 A release for the purposes of general condition 7.4(a) must be in writing.
- 7.8 A release for the purposes of general condition 7.4(a) must be effective in releasing the goods from the security interest and be in a form which allows the purchaser to take title to the goods free of that security interest.
- 7.9 If the purchaser receives a release under general condition 7.4(a) the purchaser must provide the vendor with a copy of the release at or as soon as practicable after settlement.
- 7.10 In addition to ensuring that a release is received under general condition 7.4(a), the vendor must ensure that at or before settlement the purchaser receives a written undertaking from a secured party to register a financing change statement to reflect that release if the property being released includes goods of a kind that are described by serial number in the Personal Property Securities Register.

- 7.11 The purchaser must advise the vendor of any security interest that is registered on or before the day of sale on the Personal Property Securities Register, which the purchaser reasonably requires to be released, at least 21 days before the due date for settlement.
- 7.12 The vendor may delay settlement until 21 days after the purchaser advises the vendor of the security interests that the purchaser reasonably requires to be released if the purchaser does not provide an advice under general condition 7.11.
- 7.13 If settlement is delayed under general condition 7.12 the purchaser must pay the vendor—
- (a) interest from the due date for settlement until the date on which settlement occurs or 21 days after the vendor receives the advice, whichever is the earlier; and
 - (b) any reasonable costs incurred by the vendor as a result of the delay—
- as though the purchaser was in default.
- 7.14 The vendor is not required to ensure that the purchaser receives a release in respect of the land. This general condition 7.14 applies despite general condition 7.1.
- 7.15 Words and phrases which are defined in the *Personal Property Securities Act 2009* (Cth) have the same meaning in general condition 7 unless the context requires otherwise.

8. BUILDER WARRANTY INSURANCE

The vendor warrants that the vendor will provide at settlement details of any current builder warranty insurance in the vendor's possession relating to the property if requested in writing to do so at least 21 days before settlement.

9. GENERAL LAW LAND

- 9.1 This general condition only applies if any part of the land is not under the operation of the *Transfer of Land Act 1958*.
- 9.2 The vendor is taken to be the holder of an unencumbered estate in fee simple in the land if there is an unbroken chain of title starting at least 30 years before the day of sale proving on the face of the documents the ownership of the entire legal and equitable estate without the aid of other evidence.
- 9.3 The purchaser is entitled to inspect the vendor's chain of title on request at such place in Victoria as the vendor nominates.
- 9.4 The purchaser is taken to have accepted the vendor's title if:
- (a) 21 days have elapsed since the day of sale; and
 - (b) the purchaser has not reasonably objected to the title or reasonably required the vendor to remedy a defect in the title.
- 9.5 The contract will be at an end if:
- (a) the vendor gives the purchaser a notice that the vendor is unable or unwilling to satisfy the purchaser's objection or requirement and that the contract will end if the objection or requirement is not withdrawn within 14 days of the giving of the notice; and
 - (b) the objection or requirement is not withdrawn in that time.
- 9.6 If the contract ends in accordance with general condition 9.5, the deposit must be returned to the purchaser and neither party has a claim against the other in damages.
- 9.7 General condition 10.1 should be read, in respect of that part of the land which is not under the operation of the *Transfer of Land Act 1958*, as if the reference to 'registered proprietor' is a reference to 'owner'.

Money

10. SETTLEMENT

- 10.1 At settlement:
- (a) the purchaser must pay the balance; and
 - (b) the vendor must:
 - (i) do all things necessary to enable the purchaser to become the registered proprietor of the land; and
 - (ii) give either vacant possession or receipt of rents and profits in accordance with the particulars of sale.
- 10.2 The vendor's obligations under this general condition continue after settlement.
- 10.3 Settlement must be conducted between the hours of 10.00a.m. and 4.00p.m. unless the parties agree otherwise.

11. PAYMENT

- 11.1 The purchaser must pay the deposit:
- (a) to the vendor's licensed estate agent; or
 - (b) if there is no estate agent, to the vendor's legal practitioner or conveyancer; or

- (c) if the vendor directs, into a special purpose account in an authorised deposit-taking institution in Victoria specified by the vendor in the joint names of the purchaser and the vendor.
- 11.2 If the land sold is a lot on an unregistered plan of subdivision, the deposit:
 - (a) must not exceed 10% of the price; and
 - (b) must be paid to the vendor's estate agent, legal practitioner or conveyancer and held by the estate agent, legal practitioner or conveyancer on trust for the purchaser until the registration of the plan of subdivision.
- 11.3 The purchaser must pay all money other than the deposit:
 - (a) to the vendor, or the vendor's legal practitioner or conveyancer; or
 - (b) in accordance with a written direction of the vendor or the vendor's legal practitioner or conveyancer.
- 11.4 At settlement, payments may be made or tendered:
 - (a) in cash; or
 - (b) by cheque drawn on an authorised deposit-taking institution; or
 - (c) if the parties agree, by electronically transferring the payment in the form of cleared funds.
- 11.5 For the purpose of this general condition 'authorised deposit-taking institution' means a body corporate in relation to which an authority under section 9(3) of the *Banking Act 1959* (Cth) is in force.
- 11.6 At settlement, the purchaser must pay the fees on up to three cheques drawn on authorised deposit-taking institution. If the vendor requests that any additional cheques be drawn on an authorised deposit-taking institution, the vendor must reimburse the purchaser for the fees incurred.

12. STAKEHOLDING

- 12.1 The deposit must be released to the vendor if:
 - (a) the vendor provides particulars, to the satisfaction of the purchaser, that either-
 - (i) there are no debts secured against the property; or
 - (ii) if there are any debts, the total amount of those debts does not exceed 80% of the sale price; and
 - (b) at least 28 days have elapsed since the particulars were given to the purchaser under paragraph (a); and
 - (c) all conditions of section 27 of the *Sale of Land Act 1962* have been satisfied.
- 12.2 The stakeholder must pay the deposit and any interest to the party entitled when the deposit is released, the contract is settled, or the contract is ended.
- 12.3 The stakeholder may pay the deposit and any interest into court if it is reasonable to do so.

13. GST

- 13.1 The purchaser does not have to pay the vendor any GST payable by the vendor in respect of a taxable supply made under this contract in addition to the price unless the particulars of sale specify that the price is 'plus GST'. However the purchaser must pay to the vendor any GST payable by the vendor:
 - (a) solely as a result of any action taken or intended to be taken by the purchaser after the day of sale, including a change of use; or
 - (b) if the particulars of sale specify that the supply made under this contract is of land on which a 'farming business' is carried on and the supply (or part of it) does not satisfy the requirements of section 38-480 of the GST Act; or
 - (c) if the particulars of sale specify that the supply made under this contract is of a going concern and the supply (or a part of it) does not satisfy the requirements of section 38-325 of the GST Act.
- 13.2 The purchaser must pay to the vendor any GST payable by the vendor in respect of a taxable supply made under this contract in addition to the price if the particulars of sale specify that the price is 'plus GST'.
- 13.3 If the purchaser is liable to pay GST, the purchaser is not required to make payment until provided with a tax invoice, unless the margin scheme applies.
- 13.4 If the particulars of sale specify that the supply made under this contract is of land on which a 'farming business' is carried on:
 - (a) the vendor warrants that the property is land on which a farming business has been carried on for the period of 5 years preceding the date of supply; and
 - (b) the purchaser warrants that the purchaser intends that a farming business will be carried on after settlement on the property.
- 13.5 If the particulars of sale specify that the supply made under this contract is a 'going concern':
 - (a) the parties agree that this contract is for the supply of a going concern; and
 - (b) the purchaser warrants that the purchaser is, or prior to settlement will be, registered for GST; and
 - (c) the vendor warrants that the vendor will carry on the going concern until the date of supply.
- 13.6 If the particulars of sale specify that the supply made under this contract is a 'margin scheme' supply, the parties agree that the margin scheme applies to this contract.
- 13.7 This general condition will not merge on either settlement or registration.

13.8 In this general condition:

- (a) 'GST Act' means *A New Tax System (Goods and Services Tax) Act 1999* (Cth); and
- (b) 'GST' includes penalties and interest.

14. LOAN

14.1 If the particulars of sale specify that this contract is subject to a loan being approved, this contract is subject to the lender approving the loan on the security of the property by the approval date or any later date allowed by the vendor.

14.2 The purchaser may end the contract if the loan is not approved by the approval date, but only if the purchaser:

- (a) immediately applied for the loan; and
- (b) did everything reasonably required to obtain approval of the loan; and
- (c) serves written notice ending the contract on the vendor within 2 clear business days after the approval date or any later date allowed by the vendor; and
- (d) is not in default under any other condition of this contract when the notice is given.

14.3 All money must be immediately refunded to the purchaser if the contract is ended.

15. ADJUSTMENTS

15.1 All periodic outgoings payable by the vendor, and any rent and other income received in respect of the property must be apportioned between the parties on the settlement date and any adjustments paid and received as appropriate.

15.2 The periodic outgoings and rent and other income must be apportioned on the following basis:

- (a) the vendor is liable for the periodic outgoings and entitled to the rent and other income up to and including the day of settlement; and
- (b) the land is treated as the only land of which the vendor is owner (as defined in the *Land Tax Act 2005*); and
- (c) the vendor is taken to own the land as a resident Australian beneficial owner; and
- (d) any personal statutory benefit available to each party is disregarded in calculating apportionment.

Transactional

16. TIME

16.1 Time is of the essence of this contract.

16.2 Time is extended until the next business day if the time for performing any action falls on a Saturday, Sunday or bank holiday.

17. SERVICE

17.1 Any document sent by—

- (a) post is taken to have been served on the next business day after posting, unless proved otherwise;
- (b) email is taken to have been served at the time of receipt within the meaning of section 13A of the *Electronic Transactions (Victoria) Act 2000*.

17.2 Any demand, notice, or document required to be served by or on any party may be served by or on the legal practitioner or conveyancer for that party. It is sufficiently served if served on the party or on the legal practitioner or conveyancer:

- (a) personally; or
- (b) by pre-paid post; or
- (c) in any manner authorised by law or the Supreme Court for service of documents, including any manner authorised for service on or by a legal practitioner; or
- (d) by email.

17.3 This general condition applies to the service of any demand, notice or document by or on any party, whether the expression 'give' or 'serve' or any other expression is used.

18. NOMINEE

The purchaser may nominate a substitute or additional transferee, but the named purchaser remains personally liable for the due performance of all the purchaser's obligations under this contract.

19. LIABILITY OF SIGNATORY

Any signatory for a proprietary limited company purchaser is personally liable for the due performance of the purchaser's obligations as if the signatory were the purchaser in the case of a default by a proprietary limited company purchaser.

20. GUARANTEE

The vendor may require one or more directors of the purchaser to guarantee the purchaser's performance of this contract if the purchaser is a proprietary limited company.

21. NOTICES

The purchaser is responsible for any notice, order, demand or levy imposing liability on the property that is issued or made on or after the day of sale that does not relate to periodic outgoings. The purchaser may enter the property to comply with that

responsibility where action is required before settlement.

22. INSPECTION

The purchaser and/or another person authorised by the purchaser may inspect the property at any reasonable time during the 7 days preceding and including the settlement day.

23. TERMS CONTRACT

23.1 If this is a 'terms contract' as defined in the *Sale of Land Act 1962*:

- (a) any mortgage affecting the land sold must be discharged as to that land before the purchaser becomes entitled to possession or to the receipt of rents and profits unless the vendor satisfies section 29M of the *Sale of Land Act 1962*; and
- (b) the deposit and all other money payable under the contract (other than any money payable in excess of the amount required to so discharge the mortgage) must be paid to a legal practitioner or conveyancer or a licensed estate agent to be applied in or towards discharging the mortgage.

23.2 While any money remains owing each of the following applies:

- (a) the purchaser must maintain full damage and destruction insurance of the property and public risk insurance noting all parties having an insurable interest with an insurer approved in writing by the vendor;
- (b) the purchaser must deliver copies of the signed insurance application forms, the policies and the insurance receipts to the vendor not less than 10 days before taking possession of the property or becoming entitled to receipt of the rents and profits;
- (c) the purchaser must deliver copies of any amendments to the policies and the insurance receipts on each amendment or renewal as evidence of the status of the policies from time to time;
- (d) the vendor may pay any renewal premiums or take out the insurance if the purchaser fails to meet these obligations;
- (e) insurance costs paid by the vendor under paragraph (d) must be refunded by the purchaser on demand without affecting the vendor's other rights under this contract;
- (f) the purchaser must maintain and operate the property in good repair (fair wear and tear excepted) and keep the property safe, lawful, structurally sound, weatherproof and free from contaminations and dangerous substances;
- (g) the property must not be altered in any way without the written consent of the vendor which must not be unreasonably refused or delayed;
- (h) the purchaser must observe all obligations that affect owners or occupiers of land;
- (i) the vendor and/or other person authorised by the vendor may enter the property at any reasonable time to inspect it on giving 7 days written notice, but not more than twice in a year.

24. LOSS OR DAMAGE BEFORE SETTLEMENT

24.1 The vendor carries the risk of loss or damage to the property until settlement.

24.2 The vendor must deliver the property to the purchaser at settlement in the same condition it was in on the day of sale, except for fair wear and tear.

24.3 The purchaser must not delay settlement because one or more of the goods is not in the condition required by general condition 24.2, but may claim compensation from the vendor after settlement.

24.4 The purchaser may nominate an amount not exceeding \$5,000 to be held by a stakeholder to be appointed by the parties if the property is not in the condition required by general condition 24.2 at settlement.

24.5 The nominated amount may be deducted from the amount due to the vendor at settlement and paid to the stakeholder, but only if the purchaser also pays an amount equal to the nominated amount to the stakeholder.

24.6 The stakeholder must pay the amounts referred to in general condition 24.5 in accordance with the determination of the dispute, including any order for payment of the costs of the resolution of the dispute.

25. BREACH

A party who breaches this contract must pay to the other party on demand:

- (a) compensation for any reasonably foreseeable loss to the other party resulting from the breach; and
- (b) any interest due under this contract as a result of the breach.

Default

26. INTEREST

Interest at a rate of 2% per annum plus the rate for the time being fixed by section 2 of the *Penalty Interest Rates Act 1983* is payable on any money owing under the contract during the period of default, without affecting any other rights of the offended party.

27. DEFAULT NOTICE

27.1 A party is not entitled to exercise any rights arising from the other party's default, other than the right to receive interest and the right to sue for money owing, until the other party is given and fails to comply with a written default notice.

27.2 The default notice must:

- (a) specify the particulars of the default; and
- (b) state that it is the offended party's intention to exercise the rights arising from the default unless, within 14 days of the notice being given -
 - (i) the default is remedied; and
 - (ii) the reasonable costs incurred as a result of the default and any interest payable are paid.

28. DEFAULT NOT REMEDIED

28.1 All unpaid money under the contract becomes immediately payable to the vendor if the default has been made by the purchaser and is not remedied and the costs and interest are not paid.

28.2 The contract immediately ends if:

- (a) the default notice also states that unless the default is remedied and the reasonable costs and interest are paid, the contract will be ended in accordance with this general condition; and
- (b) the default is not remedied and the reasonable costs and interest are not paid by the end of the period of the default notice.

28.3 If the contract ends by a default notice given by the purchaser:

- (a) the purchaser must be repaid any money paid under the contract and be paid any interest and reasonable costs payable under the contract; and
- (b) all those amounts are a charge on the land until payment; and
- (c) the purchaser may also recover any loss otherwise recoverable.

28.4 If the contract ends by a default notice given by the vendor:

- (a) the deposit up to 10% of the price is forfeited to the vendor as the vendor's absolute property, whether the deposit has been paid or not; and
- (b) the vendor is entitled to possession of the property; and
- (c) in addition to any other remedy, the vendor may within one year of the contract ending either:
 - (i) retain the property and sue for damages for breach of contract; or
 - (ii) resell the property in any manner and recover any deficiency in the price on the resale and any resulting expenses by way of liquidated damages; and
- (d) the vendor may retain any part of the price paid until the vendor's damages have been determined and may apply that money towards those damages; and
- (e) any determination of the vendor's damages must take into account the amount forfeited to the vendor.

28.5 The ending of the contract does not affect the rights of the offended party as a consequence of the default.

GUARANTEE and INDEMNITY

I/We, of
.....

and..... of
.....

being the **Sole Director / Directors** of of
..... (called the "Guarantors") IN
CONSIDERATION of the Vendor selling to the Purchaser at our request the Land
described in this Contract of Sale for the price and upon the terms and conditions contained
therein **DO** for ourselves and our respective executors and administrators **JOINTLY AND
SEVERALLY COVENANT** with the said Vendor and their assigns that if at any time default
shall be made in payment of the Deposit Money or residue of Purchase Money or interest
or any other moneys payable by the Purchaser to the Vendor under this Contract or in the
performance or observance of any term or condition of this Contract to be performed or
observed by the Purchaser I/we will immediately on demand by the Vendor pay to the
Vendor the whole of the Deposit Money, residue of Purchase Money, interest or other
moneys which shall then be due and payable to the Vendor and indemnify and agree to
keep the Vendor indemnified against all loss of Deposit Money, residue of Purchase
Money, interest and other moneys payable under the within Contract and all losses, costs,
charges and expenses whatsoever which the Vendor may incur by reason of any default
on the part of the Purchaser. This Guarantee shall be a continuing Guarantee and
Indemnity and shall not be released by: -

- (f) any neglect or forbearance on the part of the Vendor in enforcing payment of any of
the moneys payable under the within Contract;
- (g) the performance or observance of any of the agreements, obligations or conditions
under the within Contract;
- (h) by time given to the Purchaser for any such payment performance or observance;
- (i) by reason of the Vendor assigning his, her or their rights under the said Contract; and
- (j) by any other thing which under the law relating to sureties would but for this provision
have the effect of releasing me/us, my/our executors or administrators.

IN WITNESS whereof the parties hereto have set their hands and seals

this day of 2023

SIGNED by the said)

)

Print Name:)

)

.....

.....
Director (Sign)

in the presence of:)

)

Witness:)

)

Vendor Statement

The vendor makes this statement in respect of the land in accordance with section 32 of the *Sale of Land Act 1962*.

This statement must be signed by the vendor and given to the purchaser before the purchaser signs the contract.
The vendor may sign by electronic signature.

The purchaser acknowledges being given this statement signed by the vendor with the attached documents before the purchaser signed any contract.

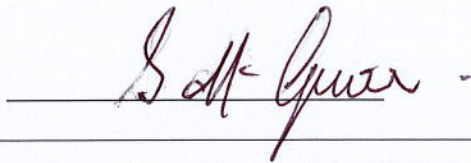
Land	
Vendor's name	Stephen Francis McGuire
Vendor's signature	Date 30/6/23
	
Purchaser's name	Date / /
Purchaser's signature	
<hr/>	
Purchaser's name	Date / /
Purchaser's signature	
<hr/>	



GEELONG PROPERTY
CONVEYANCING

Always here for you.

SECTION 32

Vendor: Stephen Francis McGuire
Property: 182 Christies Road, Leopold VIC 3224

GEELONG PROPERTY CONVEYANCING
163D Malop Street
GEELONG VIC 3220
P. 0499 813 462
E. matthew@gpconveyancing.com.au

1. FINANCIAL MATTERS

1.1 Particulars of any Rates, Taxes, Charges or Other Similar Outgoings (and any interest on them)

(a) ☒ Their total does not exceed: \$5,000.00

1.2 Particulars of any Charge (whether registered or not) imposed by or under any Act to secure an amount due under that Act, including the amount owing under the charge

\$0.00	To	
Other particulars (including dates and times of payments):		

1.3 Terms Contract

This section 1.3 only applies if this vendor statement is in respect of a terms contract where the purchaser is obliged to make 2 or more payments (other than a deposit or final payment) to the vendor after the execution of the contract and before the purchaser is entitled to a conveyance or transfer of the land.

Not Applicable

1.4 Sale Subject to Mortgage

This section 1.4 only applies if this vendor statement is in respect of a contract which provides that any mortgage (whether registered or unregistered), is NOT to be discharged before the purchaser becomes entitled to possession or receipts of rents and profits.

Not Applicable

2. INSURANCE

2.1 Damage and Destruction

This section 2.1 only applies if this vendor statement is in respect of a contract which does NOT provide for the land to remain at the risk of the vendor until the purchaser becomes entitled to possession or receipt of rents and profits.

Not Applicable

2.2 Owner Builder

This section 2.2 only applies where there is a residence on the land that was constructed by an owner-builder within the preceding 6 years and section 137B of the Building Act 1993 applies to the residence.

Not Applicable

3. LAND USE

3.1 Easements, Covenants or Other Similar Restrictions

(a) A description of any easement, covenant or other similar restriction affecting the land (whether registered or unregistered):

☒ Is in the attached copies of title document/s

(b) Particulars of any existing failure to comply with that easement, covenant or other similar restriction are:

Not Applicable

3.2 Road Access

There is NO access to the property by road if the square box is marked with an 'X'

☐

3.3 Designated Bushfire Prone Area

The land is in a designated bushfire prone area within the meaning of regulations made under the *Building Act 1993* if the square box is marked with an 'X'

☐

3.4 Planning Scheme

☒ Attached is a certificate with the required specified information.

4. NOTICES

4.1 Notice, Order, Declaration, Report or Recommendation

Particulars of any notice, order, declaration, report or recommendation of a public authority or government department or approved proposal directly and currently affecting the land, being a notice, order, declaration, report, recommendation or approved proposal of which the vendor might reasonably be expected to have knowledge:

Not Applicable

4.2 Agricultural Chemicals

There are NO notices, property management plans, reports or orders in respect of the land issued by a government department or public authority in relation to livestock disease or contamination by agricultural chemicals affecting the ongoing use of the land for agricultural purposes. However, if this is not the case, the details of any such notices, property management plans, reports or orders, are as follows:

NIL

4.3 Compulsory Acquisition

The particulars of any notices of intention to acquire that have been served under section 6 of the *Land Acquisition and Compensation Act 1986* are as follows:

NIL

5. BUILDING PERMITS

Particulars of any building permit issued under the *Building Act 1993* in the preceding 7 years (required only where there is a residence on the land):

Not Applicable

6. OWNERS CORPORATION

This section 6 only applies if the land is affected by an owners corporation within the meaning of the *Owners Corporations Act 2006*.

Not Applicable

7. GROWTH AREAS INFRASTRUCTURE CONTRIBUTION ("GAIC")

Words and expressions in this section 7 have the same meaning as in Part 9B of the *Planning and Environment Act 1987*.

Not Applicable

The services which are marked with an 'X' in the accompanying square box are NOT connected to the land:

Electricity supply <input type="checkbox"/>	Gas supply <input type="checkbox"/>	Water supply <input type="checkbox"/>	Sewerage <input type="checkbox"/>	Telephone services <input checked="" type="checkbox"/>
---	-------------------------------------	---------------------------------------	-----------------------------------	--

9. TITLE

Attached are copies of the following documents:

9.1 ☒ (a) Registered Title

A Register Search Statement and the document, or part of a document, referred to as the 'diagram location' in that statement which identifies the land and its location.

10. SUBDIVISION

10.1 Unregistered Subdivision

This section 10.1 only applies if the land is subject to a subdivision which is not registered.

Not Applicable

10.2 Staged Subdivision

This section 10.2 only applies if the land is part of a staged subdivision within the meaning of section 37 of the *Subdivision Act 1988*.

- (a) Attached is a copy of the plan for the first stage if the land is in the second or subsequent stage.
- (b) The requirements in a statement of compliance relating to the stage in which the land is included that have Not been complied With are As follows:
NIL
- (c) The proposals relating to subsequent stages that are known to the vendor are as follows:
NIL
- (d) The contents of any permit under the Planning and Environment Act 1987 authorising the staged subdivision are:
NIL

10.3 Further Plan of Subdivision

This section 10.3 only applies if the land is subject to a subdivision in respect of which a further plan within the meaning of the *Subdivision Act* 1988 is proposed.

Not Applicable

11. DISCLOSURE OF ENERGY INFORMATION

(Disclosure of this information is not required under section 32 of the Sale of Land Act 1962 but may be included in this vendor statement for convenience.)

Details of any energy efficiency information required to be disclosed regarding a disclosure affected building or disclosure area affected area of a building as defined by the *Building Energy Efficiency Disclosure Act* 2010 (Cth)

- (a) to be a building or part of a building used or capable of being used as an office for administrative, clerical, professional or similar based activities including any support facilities; and
- (b) which has a net lettable area of at least 2000m²; (but does not include a building under a strata title system or if an occupancy permit was issued less than 2 years before the relevant date):

Not Applicable

12. DUE DILIGENCE CHECKLIST

(The Sale of Land Act 1962 provides that the vendor or the vendor's licensed estate agent must make a prescribed due diligence checklist available to purchasers before offering land for sale that is vacant residential land or land on which there is a residence. The due diligence checklist is NOT required to be provided with, or attached to, this vendor statement but the checklist may be attached as a matter of convenience.)

As attached

13. ATTACHMENTS

(Any certificates, documents and other attachments may be annexed to this section 13)

(Additional information may be added to this section 13 where there is insufficient space in any of the earlier sections)

(Attached is an "Additional Vendor Statement" if section 1.3 (Terms Contract) or section 1.4 (Sale Subject to Mortgage) applies)

--

Copyright State of Victoria. No part of this publication may be reproduced except as permitted by the Copyright Act 1968 (Cth), to comply with a statutory requirement or pursuant to a written agreement. The information is only valid at the time and in the form obtained from the LANDATA REGD TM System. None of the State of Victoria, its agents or contractors, accepts responsibility for any subsequent publication or reproduction of the information.

The Victorian Government acknowledges the Traditional Owners of Victoria and pays respects to their ongoing connection to their Country, History and Culture. The Victorian Government extends this respect to their Elders, past, present and emerging.

REGISTER SEARCH STATEMENT (Title Search) Transfer of Land Act 1958

VOLUME 10987 FOLIO 892

Security no : 124107004990G

Produced 20/06/2023 02:33 PM

LAND DESCRIPTION

Lot 53 on Plan of Subdivision 536898F.

PARENT TITLES :

Volume 08156 Folio 661 Volume 08208 Folio 601

Created by instrument PS536898F 10/01/2007

REGISTERED PROPRIETOR

Estate Fee Simple

Sole Proprietor

STEPHEN FRANCIS MCGUIRE of 9 DOVIER PLACE LEOPOLD VIC 3224

AH265189N 01/06/2010

ENCUMBRANCES, CAVEATS AND NOTICES

MORTGAGE AH265190E 01/06/2010

BENDIGO AND ADELAIDE BANK LTD

COVENANT PS536898F 10/01/2007

COVENANT AF025855K 24/04/2007

Any encumbrances created by Section 98 Transfer of Land Act 1958 or Section 24 Subdivision Act 1988 and any other encumbrances shown or entered on the plan set out under DIAGRAM LOCATION below.

DIAGRAM LOCATION

SEE PS536898F FOR FURTHER DETAILS AND BOUNDARIES

ACTIVITY IN THE LAST 125 DAYS

NIL

-----END OF REGISTER SEARCH STATEMENT-----

Additional information: (not part of the Register Search Statement)

Street Address: 182 CHRISTIES ROAD LEOPOLD VIC 3224

ADMINISTRATIVE NOTICES

NIL



eCT Control 03500L BENDIGO AND ADELAIDE BANK LTD - SAFE CUSTODY

Effective from 21/07/2017

DOCUMENT END

Delivered from the LANDATA® System by InfoTrack Pty Ltd.

The information supplied by Triconvey (Reseller) has been obtained from InfoTrack Pty Limited by agreement between them. The information supplied has been obtained by InfoTrack Pty Limited who is licensed by the State of Victoria to provide this information via LANDATA® System.

PLAN OF SUBDIVISION	STAGE No <div style="border: 1px solid black; width: 40px; height: 40px; margin: 0 auto; display: flex; align-items: center; justify-content: center;">X</div>	LR EDITION 1	PLAN NUMBER PS536898F															
LOCATION OF LAND PARISH: MOOLAP TOWNSHIP: - SECTION: - CROWN ALLOTMENT: - CROWN PORTION: 7 (PART) BLOCK I TITLE REFERENCES: VOL.8156 FOL.661 VOL.8208 FOL.601 LAST PLAN REFERENCE/S: LP.40480 (LOTS 1 & 2) POSTAL ADDRESS: CNR. CHRISTIES RD & PORTARLINGTON RD (At time of subdivision) LEOPOLD 3224 AMG Co-ordinates E 278 940 (of approx centre of land in plan) N 5 771 270 ZONE: 55		COUNCIL CERTIFICATION AND ENDORSEMENT COUNCIL NAME: CITY OF GREATER GEELONG REF: 7214 1. This plan is certified under Section 6 of the Subdivision Act 1988 2. This plan is certified under Section 11(7) of the Subdivision Act 1988 Date of original certification under Section 6 / / 3. This is a statement of compliance issued under Section 21 of the Subdivision Act 1988 OPEN SPACE (i) A requirement for public open space under Section 18 of the Subdivision Act 1988 has has not been made (ii) The requirement has been satisfied (iii) The requirement is to be satisfied in Stage Council Delegate Council Seal Date 7 / 1 / 06 Re-certified under Section 11(7) of the Subdivision Act 1988 Council Delegate Council Seal Date / /																
VESTING OF ROADS AND/OR RESERVES <table border="1" style="width: 100%; border-collapse: collapse;"> <tr> <th style="width: 50%;">IDENTIFIER</th> <th style="width: 50%;">COUNCIL/BODY/PERSON</th> </tr> <tr> <td>ROADS RI RESERVE No.1</td> <td>CITY OF GREATER GEELONG CITY OF GREATER GEELONG</td> </tr> </table>		IDENTIFIER	COUNCIL/BODY/PERSON	ROADS RI RESERVE No.1	CITY OF GREATER GEELONG CITY OF GREATER GEELONG	NOTATIONS STAGING This is/ is not a staged subdivision Planning permit No. DEPTH LIMITATION DOES NOT APPLY THE LAND BEING SUBDIVIDED IS ENCLOSED WITHIN THICK CONTINUOUS LINES. LOTS 1-27, 33-43 & 56-66 HAVE BEEN OMITTED FROM THIS PLAN.												
IDENTIFIER	COUNCIL/BODY/PERSON																	
ROADS RI RESERVE No.1	CITY OF GREATER GEELONG CITY OF GREATER GEELONG																	
Creation of Restriction: Upon registration of this plan the following restriction is to be created. Land to benefit : Lots 28-32,44-55 & 67-71 Land to be burdened : Lots 28-32,44, 45, 47-55 & 67-69 & 71 Description of Restriction : The development of multi-dwellings & subdivision of lots 28-32,44, 45, 47-55 & 67-69 & 71 is prohibited.																		
SURVEY THIS PLAN IS / IS NOT BASED ON SURVEY SEE PS524888B THIS SURVEY HAS BEEN CONNECTED TO PERMANENT MARKS No(s) PM97, PM114, PM180, PM264 IN PROCLAIMED SURVEY AREA No																		
Legend: E - Encumbering Easement, Condition in Crown Grant in the Nature of an Easement or Other Encumbrance A - Appurtenant Easement		LR STATEMENT OF COMPLIANCE EXEMPTION STATEMENT RECEIVED <input checked="" type="checkbox"/> DATE 8/1/07																
EASEMENT INFORMATION <table border="1" style="width: 100%; border-collapse: collapse;"> <thead> <tr> <th style="width: 15%;">Subject Land</th> <th style="width: 25%;">Purpose</th> <th style="width: 15%;">Width (Metres)</th> <th style="width: 15%;">Origin</th> <th style="width: 30%;">Land Benefited/In Favour Of</th> </tr> </thead> <tbody> <tr> <td>E-1</td> <td>DRAINAGE</td> <td>SEE PLAN</td> <td>THIS PLAN</td> <td>CITY OF GREATER GEELONG</td> </tr> <tr> <td>E-1</td> <td>SEWERAGE</td> <td>SEE PLAN</td> <td>THIS PLAN</td> <td>BARWON REGION WATER AUTHORITY</td> </tr> </tbody> </table>		Subject Land	Purpose	Width (Metres)	Origin	Land Benefited/In Favour Of	E-1	DRAINAGE	SEE PLAN	THIS PLAN	CITY OF GREATER GEELONG	E-1	SEWERAGE	SEE PLAN	THIS PLAN	BARWON REGION WATER AUTHORITY	LR PLAN REGISTERED TIME 2.38 PM DATE 10/1/2007 <div style="text-align: center;">  Assistant Registrar of Titles </div> SHEET 1 OF 3 SHEETS	
Subject Land	Purpose	Width (Metres)	Origin	Land Benefited/In Favour Of														
E-1	DRAINAGE	SEE PLAN	THIS PLAN	CITY OF GREATER GEELONG														
E-1	SEWERAGE	SEE PLAN	THIS PLAN	BARWON REGION WATER AUTHORITY														
<div style="text-align: center;">  ST. QUENTIN <small>Surveyors - Town Planners - Development Consultants</small> 54 CORIO STREET, P.O. BOX 919, GEELONG 3220 TELEPHONE (03) 5229 2011 FAX (03) 5229 2909 </div>		LICENSED SURVEYOR (PRINT) IAN A. BENT SIGNATURE DATE 10/10/05 REF 7317-52/04 VERSION 04																
DATE 7/2/06 COUNCIL DELEGATE SIGNATURE ORIGINAL SHEET SIZE A3																		

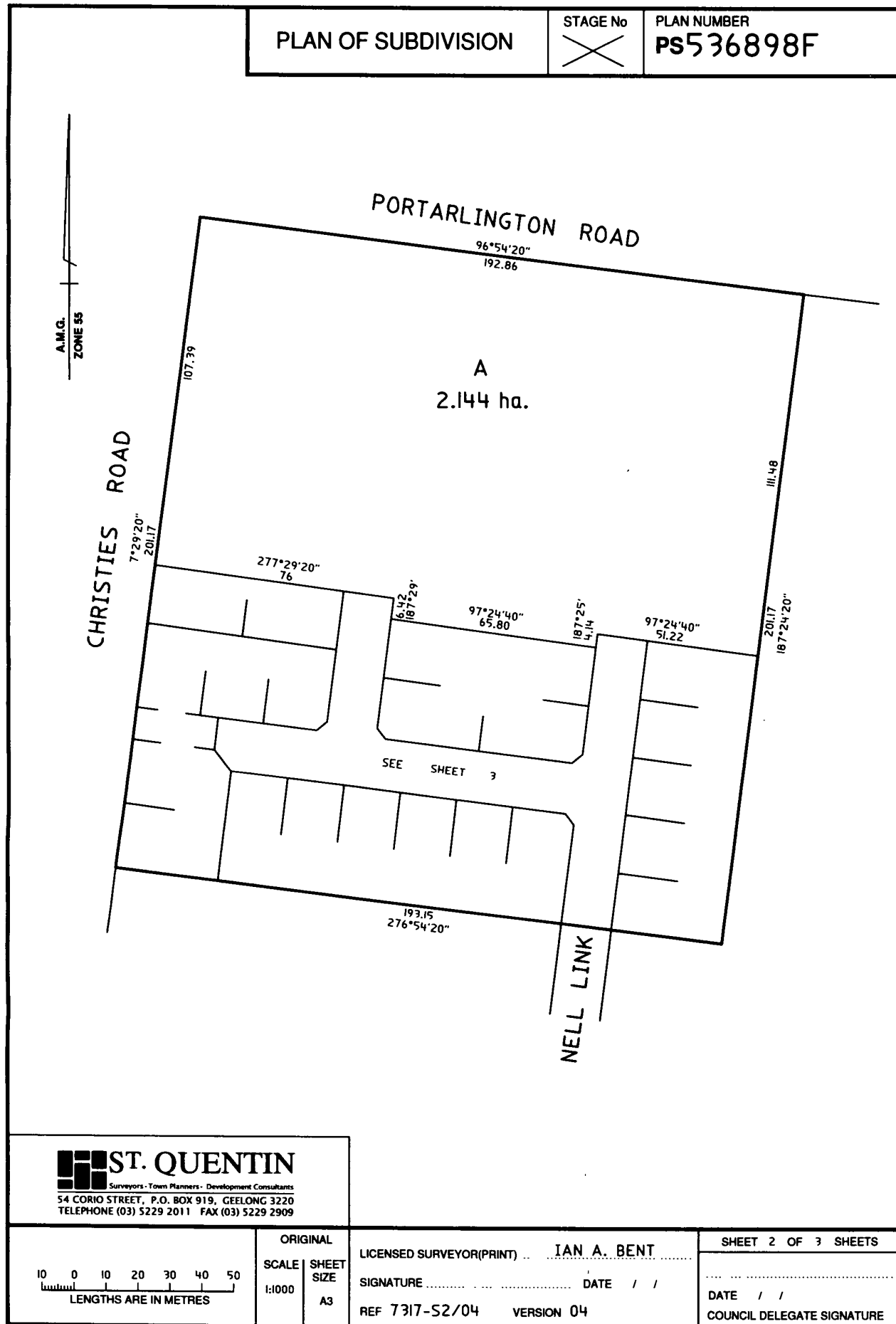

ST. QUENTIN
 Surveyors - Town Planners - Development Consultants
 54 CORIO STREET, P.O. BOX 919, GEELONG 3220
 TELEPHONE (03) 5229 2011 FAX (03) 5229 2909

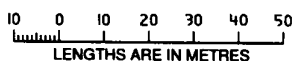

ORIGINAL
 SCALE 1:1000
 SHEET SIZE A3

LICENSED SURVEYOR(PRINT) **IAN A. BENT**
 SIGNATURE _____ DATE / /
 REF 7317-S2/04 VERSION 04

SHEET 2 OF 3 SHEETS
 DATE / /
 COUNCIL DELEGATE SIGNATURE _____

Transfer of Land

Section 45 Transfer of Land Act 1958

AH265189N

01/06/2010 \$1121 45

Name: Conuter Roache
 Phone:
 Address:

 Reference:
 Customer Code: 112935

The transferor at the direction of the directing party (if any) transfers to the transferee the estate and interest specified in the land described for the consideration expressed and subject to the encumbrances affecting the land including any created by dealings lodged for registration before the lodging of this transfer.

Land: (volume and folio)

Volume 10987 Folio 892

Estate and Interest: (e.g. "all my estate in fee simple")

All my estate in fee simple

Consideration:

\$407,500.00

Transferor: (full name)

POH LEONG LOW

Transferee: (full name and address including postcode)

STEPHEN FRANCIS MCGUIRE of 9 Dovier Place, Leopold, VIC 3224

Directing Party: (full name)

Dated: 28/5/10

Execution and attestation:

SIGNED by POH LEONG LOW in the presence of:

Signature of witness

SIGNED by STEPHEN FRANCIS MCGUIRE in the presence of:

Signature of witness

2190079A

Order to Register

Duty Use Only

T1

Please register and issue Certificate of Title to

Original Land Transfer
 Stamped with \$19,520.00
 Doc ID 2589345, 01 Jun 2010
 SRO Victoria Duty, RAK2

Page 1 of 1

Signed

Customer Code:

THE BACK OF THIS FORM MUST NOT BE USED

Land Victoria, 570 Bourke Street, Melbourne, 3000, Phone 8636-2010

© State of Victoria. This publication is copyright. No part may be reproduced by any process except in accordance with the provisions of the Copyright Act 1968 (Cth) and for the purposes of Section 32 of the Sale of Land Act 1962 or pursuant to a written agreement. The information is only valid at the time and in the form obtained from the LANDATA® System. None of the State of Victoria, LANDATA®, Secure Electronic Registries Victoria Pty Ltd (ABN 86 627 986 396) as trustee for the Secure Electronic Registries Victoria Trust (ABN 83 206 746 897) accept responsibility for any subsequent release, publication or reproduction of the information.

TRANSFER OF LAND

Section 45 Transfer of Land Act 1958

Lodged by:

Name: PEARCE WEBSTER DUGDALES

Phone: 9743 1333

Address: 297 High Street

MELTON

Ref: BE:263450

Customer Code: 1375W



AF025855K

24/04/2007 \$427 45



MADE AVAILABLE / CHANGE CONTROL

Office Use Only

The transferor at the direction of the directing party (if any) transfers to the transferee the estate and interest specified in the land described for the consideration expressed-

- together with any easements created by this transfer;
- subject to the encumbrances affecting the land including any created by dealings lodged for registration before the lodging of this transfer; and
- subject to any easements reserved by this transfer or restrictive covenant contained or covenant created pursuant to statute and included in this transfer.

Land: (volume and folio reference)

Lot 53 on Plan of Subdivision 536898F Volume: Folio: 10987 Folio 892

Estate and Interest: (e.g. "all my estate in fee simple")

all our estate and interest in fee simple

Consideration:

ONE HUNDRED AND THIRTY FIVE THOUSAND DOLLARS (\$135,000.00)

Transferor: (full name)

MONTEGLEN PTY LTD A.C.N 006 155 997 AND COSTA PROPERTY SIX PTY LTD A.C.N 107 709 713

Transferee: (full name and address including postcode)

DENNIS FAMILY HOMES PTY LTD A.C.N 056 254 249 of 211 Waverley Road, East Malvern 3145

Directing Party: (full name)

Creation and/or Reservation and/or Covenant : The Transferees with the intention that the benefit of this covenant will be annexed to and run at law and in equity with the land comprised in Lots 28-32, 44-55, 67-71 inclusive on Plan of Subdivision 536898F other than the land hereby transferred and that the burden of this covenant will be annexed to and run at law and in equity with the land hereby transferred and every part or parts thereof, do hereby for themselves their successor and transferees COVENANT with the transferor its successors and assigns the registered proprietor or proprietors for the time being of all the land comprised in Lots 28-32, 44-55, 67-71 inclusive in Plan of Subdivisions PS 536898F or any part or parts thereof other than the land hereby transferred that without the express written consent of the transferor first had and obtained;

a) the transferees will not build, construct or erect or cause to be built, constructed or erected or allow to remain on the land more than one dwelling and no such dwelling shall be constructed with external walls that and not constructed of brick, brick veneer rendered or coated fibre board, masonry, stone, concrete, glass or timber or any combination of those materials and no such dwelling shall have external walls made of galvanised iron zincalume or aluminium uncoated steel;

Continued on T2 Page 2

Approval No: 10850610A

ORDER TO REGISTER

Please register and issue title to

STAMP DUTY USE ONLY

T2



Signed

Cust. Code:

3760

* Law Perfect Pty Ltd

Original Land Transfer
Stamped with \$3,760.00
Doc ID 2194319, 24 Apr 2007
SRO Victoria Duty, RMK2

THE BACK OF THIS FORM MUST NOT BE USED
Land Registry, 570 Bourke Street, Melbourne, 3000, Phone 8636-2010

- b) there will not be brought on to the land nor allowed to remain on the land any transportable or relocatable dwelling or any dwelling other than one which was constructed on the land;
- c) that no outbuilding shall be erected on the land except for one garden shed of no more than 10 square metres in floor area, provided always that the covenant will not prohibit the erection of additional or other outbuildings that have external walls in accordance with paragraph (a) hereof or such outbuildings that have external walls of coated colourbonded material;
- d) the lot will not be used other than for residential purposes and in particular (but without restricting the generality of this restriction) no part of the lot shall be used for the storage or parking of vehicles save for the extent to which such use is ancillary to the use of the lot for dwelling purposes and shall not cause or permit the lot or any part of it to be used for the purposes of carrying on any noxious or offensive trade or activity.

Dated: 12th April 2007

Execution and attestation

THE COMMON SEAL of MONTEGLEN PTY LTD A.C.N 006 155 997 was affixed in the presence of authorised persons:

Director: 
Full Name: Michael Edward Hayden
Usual Address: 31 Queens Road
NEWTOWN VIC 3220

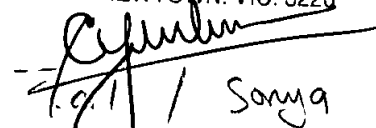

Secretary: 
Full Name: Mark Edward Hayden
Usual Address: 34 Mercer Pde
NEWTOWN VIC. 3220

EXECUTED by COSTA PROPERTY SIX PTY LTD A.C.N 107 709 713 by its attorney
Carl Christopher Schokman

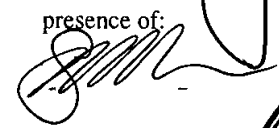
X - 
Under Power of Attorney dated 7 November 2005 in the presence of:

Witness: Y 

THE COMMON SEAL of DENNIS FAMILY HOMES PTY LTD A.C.N 056 254 249 was affixed in the presence of authorised persons:

Director: 
Full Name: Albert George Dennis
Usual Address: 
Usual Address:

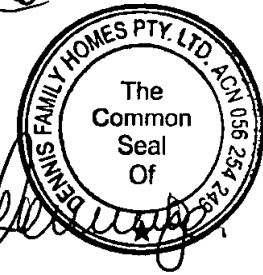
ADELE MAREE LEVINGE (DIRECTOR)
211 Waverley Rd, East Malvern 3145

ALBERT GEORGE DENNIS (DIRECTOR)
211 Waverley Rd, East Malvern 3145

Approval No: 10850610A

T2 Page 2



* Law Perfect Pty Ltd

AF025855K



THE BACK OF THIS FORM MUST NOT BE USED
Land Registry, 570 Bourke Street, Melbourne, 3000, Phone 8636-2010

2022-23 THIRD RATE INSTALMENT NOTICE



ABN 18 374 210 672
All items are GST free.



023-3220 (1585)

S F McGuire
C/- Release Property Management
PO BOX 1642
GEELONG VIC 3220

3rd
Instalment **\$480.65**
Due by
28 February 2023

Rate No. 822719

Property 182 Christies Road, LEOPOLD VIC 3224
626m2 Lot 53 PS 536898

Rates and Charges **3rd Instalment Total Due** **\$480.65**

Please be aware of the following instalment dates:

4th Instalment due by 31 May 2023

INTEREST

The 2022-23 penalty interest rate of 10% is chargeable on all arrears and overdue amounts.

Please be aware that this notice may not include transaction after **30 January 2023**.

HARDSHIP

If you are unable to make payment by the due date or are experiencing hardship, please contact us on 03 5272 5272 or email:

contactus@geelongcity.vic.gov.au

For further details of the City's support package and the financial hardship policy please go to the www.geelongaustralia.com.au website and search for hardship in the search area.

Issued 01 February 2023

PAYMENT METHODS

ONLINE OR BY PHONE



Online: www.geelongaustralia.com.au/rates Phone: 1300 858 058 Ref: **822719**
A payment processing fee of 0.51 per cent applies for payments by Visa and Mastercard.

BPAY



Billers Code: 17475
Ref: **1000 0822 7191**

Payment via internet or phone banking, from your cheque or savings account, Visa and Mastercard. **no processing fee applicable.**

DIRECT DEBIT



Call 5272 5272 for an application form, or go to www.geelongaustralia.com.au

CENTREPAY



Use Centrepay to make regular deductions from your Centrelink payment. Centrepay is a voluntary and easy payment option. Go to servicesaustralia.gov.au/centrepay for more information.

IN PERSON



Pay at any Australia Post outlet or visit us at Wurriki Nyal 137-149 Mercer St, Geelong

3rd Instalment

\$480.65



Post
Billpay



*877 8227191

Council Use



Tax Invoice/Statement



509420-001 001234(4989) D023
SF MCGUIRE
C/- Release Property Management
PO BOX 1642
GEELONG, VIC 3220

Account number
52747875 20459031

Payment due
21 December 2022

Total amount due
\$ 179.86

Your account summary

Service Address: 182 CHRISTIES RD LEOPOLD 3224

Previous balance	\$179.86	DR
Payments/adjustments	\$179.86	CR
Your balance	\$0.00	
New charges	\$179.86	DR
Total	\$179.86	DR

From July 1, 2022, while the Consumer Price Index (CPI) is 5.1%, owner-occupiers using 160kL per year will see an increase of less than CPI of 4% in their annual bill.

This translates on average to an additional \$3.49 per month for owner/occupiers and \$1.27 per month for renters.

The price adjustment will allow us to continue meeting our service commitment, in line with the 2018-2023 Price Submission, approved by the Victorian Essential Services Commission.

If you need help paying your bill, we have many support options available in the leaflet attached.

If you have a Centrelink Pension or Health Care Card, or Department of Veterans Affairs Gold Card, you may be eligible for a discount. Contact us for details.

We're here to help you with your water bill

If you're concerned about being able to pay your water bill, we offer extra support and flexibility to suit your situation. We have a number of customer support options available and can tailor an option to suit your individual needs.

Get in touch, we're here to help.

For more information, please call us on 1300 656 007 between 8 am and 6 pm, Monday to Friday.

We will put you in touch with a specialist who will deal with your enquiry promptly and sensitively.

www.barwonwater.vic.gov.au



Installation Type: Residential House

Bill Details as at 21 NOV 2022

		Value	GST	Price
WATER SERVICE CHARGE	1 OCT 2022 to 31 DEC 2022	33.77	0.00	33.77
SEWERAGE SERVICE CHARGE	1 OCT 2022 to 31 DEC 2022	146.09	0.00	146.09
Total		\$ 179.86	\$ 0.00	\$ 179.86
Balance brought forward				0.00

Please pay

\$ 179.86



Need help paying your bill?

Contact us to set up a payment plan and talk about grants, rebates and concessions.



Residential Tenants and Landlords

Tenants with separate meters pay water volume charges only.



Moving house?

Please let us know at least 2 days before you move in or out so we can arrange a meter reading and update your details.



Communication assistance

Hearing or speech impaired? Contact us via the National Relay Service on 13 36 77. We provide a free interpreter service. Contact the Translation and Interpreter Service on 13 14 50.



Servizio Interpreti
Dolmetschdienst

Služba za usluge tumačenja
Служба за преведување

Услуге тумача
传译服务

Contact Us

☎ 1300 656 007

Email info@barwonwater.vic.gov.au

General enquiries, billing and payment options

Mon - Fri, 9.00am - 5.00pm

Emergencies and faults

24 hours, 7 days

Payment Options



Direct Debit

To arrange a direct debit, please call or visit our website.



Billers Code: 585224

Ref: 5274 7875 2045 9031 3

Contact your financial institution to pay from your cheque, savings or credit account.



Centrelink

Centrelink recipients can arrange automatic payments through Centrepay. Contact us for details.



By Cheque

Post the payment slip with your cheque payable to Barwon Water to: PO Box 14206, Melbourne City MC VIC 8001. Please do not use staples or pins.



Billpay Code: 0803

Ref: 5274 7875 2045 9031 3

- In person at any post office
- Online at www.postbillpay.com.au
- Call 13 18 16 for credit card payments

Account number

52747875 20459031

Payment due

21 December 2022

Total amount due

\$ 179.86

POST billpay®



*803 52747875204590313 \$179.86 1

+00000052747875> +002579+ <0204590313>

<0000017986> +444+

Property Clearance Certificate

Land Tax



INFOTRACK / GEELONG PROPERTY CONVEYANCING

Your Reference:	GPC-23/2703
Certificate No:	65907065
Issue Date:	22 JUN 2023
Enquiries:	ESYSPROD

Land Address:	182 CHRISTIES ROAD LEOPOLD VIC 3224
---------------	-------------------------------------

Land Id	Lot	Plan	Volume	Folio	Tax Payable
34604430	53	536898	10987	892	\$0.00

Vendor: STEPHEN MCGUIRE
Purchaser: FOR INFORMATION PURPOSES

Current Land Tax	Year	Taxable Value	Proportional Tax	Penalty/Interest	Total
MR STEPHEN FRANCIS MCGUIRE	2023	\$390,000	\$1,768.46	\$0.00	\$0.00

Comments: Land Tax of \$1,768.46 has been assessed for 2023, an amount of \$1,768.46 has been paid.

Current Vacant Residential Land Tax	Year	Taxable Value	Proportional Tax	Penalty/Interest	Total
-------------------------------------	------	---------------	------------------	------------------	-------

Comments:

Arrears of Land Tax	Year	Proportional Tax	Penalty/Interest	Total
---------------------	------	------------------	------------------	-------

This certificate is subject to the notes that appear on the reverse. The applicant should read these notes carefully.

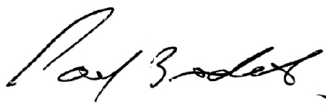
Paul Broderick
Commissioner of State Revenue

CAPITAL IMPROVED VALUE:	\$700,000
SITE VALUE:	\$390,000
CURRENT LAND TAX CHARGE:	\$0.00



Notes to Certificate - Land Tax

Certificate No: 65907065

Power to issue Certificate

1. Pursuant to section 95AA of the *Taxation Administration Act 1997*, the Commissioner of State Revenue must issue a Property Clearance Certificate (Certificate) to an owner, mortgagee or bona fide purchaser of land who makes an application specifying the land for which the Certificate is sought and pays the application fee.

Amount shown on Certificate

2. The Certificate shows any land tax (including Vacant Residential Land Tax, interest and penalty tax) that is due and unpaid on the land described in the Certificate at the date of issue. In addition, it may show:
 - Land tax that has been assessed but is not yet due,
 - Land tax for the current tax year that has not yet been assessed, and
 - Any other information that the Commissioner sees fit to include, such as the amount of land tax applicable to the land on a single holding basis and other debts with respect to the property payable to the Commissioner.

Land tax is a first charge on land

3. Unpaid land tax (including Vacant Residential Land Tax, interest and penalty tax) is a first charge on the land to which it relates. This means it has priority over any other encumbrances on the land, such as a mortgage, and will continue as a charge even if ownership of the land is transferred. Therefore, a purchaser may become liable for any such unpaid land tax.

Information for the purchaser

4. Pursuant to section 96 of the *Land Tax Act 2005*, if a purchaser of the land described in the Certificate has applied for and obtained a certificate, the amount recoverable from the purchaser cannot exceed the amount set out in the certificate, described as the "Current Land Tax Charge" overleaf. A purchaser cannot rely on a Certificate obtained by the vendor.

Information for the vendor

5. Despite the issue of a Certificate, the Commissioner may recover a land tax liability from a vendor, including any amount identified on this Certificate.

General information

6. A Certificate showing no liability for the land does not mean that the land is exempt from land tax. It means that there is nothing to pay at the date of the Certificate.
7. An updated Certificate may be requested free of charge via our website, if:
 - The request is within 90 days of the original Certificate's issue date, and
 - There is no change to the parties involved in the transaction for which the Certificate was originally requested.

For Information Only

LAND TAX CALCULATION BASED ON SINGLE OWNERSHIP

Land Tax = \$555.00

Taxable Value = \$390,000

Calculated as \$375 plus (\$390,000 - \$300,000) multiplied by 0.200 cents.

Land Tax - Payment Options

BPAY



Billers Code: 5249
Ref: 65907065

Telephone & Internet Banking - BPAY®

Contact your bank or financial institution to make this payment from your cheque, savings, debit or transaction account.

www.bpay.com.au

CARD



Ref: 65907065

Visa or Mastercard

Pay via our website or phone 13 21 61.
A card payment fee applies.

sro.vic.gov.au/paylandtax

Property Clearance Certificate

Land Tax



INFOTRACK / GEELONG PROPERTY CONVEYANCING

Your Reference:	GPC-23/2703
Certificate No:	65907065
Issue Date:	22 JUN 2023
Enquiries:	ESYSPROD

Land Address: 182 CHRISTIES ROAD LEOPOLD VIC 3224

Land Id	Lot	Plan	Volume	Folio	Tax Payable
34604430	53	536898	10987	892	\$0.00

Vendor: STEPHEN MCGUIRE
Purchaser: FOR INFORMATION PURPOSES

Current Land Tax	Year	Taxable Value	Proportional Tax	Penalty/Interest	Total
MR STEPHEN FRANCIS MCGUIRE	2023	\$390,000	\$1,768.46	\$0.00	\$0.00

Comments: Land Tax of \$1,768.46 has been assessed for 2023, an amount of \$1,768.46 has been paid.

Current Vacant Residential Land Tax	Year	Taxable Value	Proportional Tax	Penalty/Interest	Total
-------------------------------------	------	---------------	------------------	------------------	-------

Comments:

Arrears of Land Tax	Year	Proportional Tax	Penalty/Interest	Total
---------------------	------	------------------	------------------	-------

This certificate is subject to the notes that appear on the reverse. The applicant should read these notes carefully.

Paul Broderick
Commissioner of State Revenue

CAPITAL IMPROVED VALUE:	\$700,000
SITE VALUE:	\$390,000
CURRENT LAND TAX CHARGE:	\$0.00



Notes to Certificate - Land Tax

Certificate No: 65907065

Power to issue Certificate

1. Pursuant to section 95AA of the *Taxation Administration Act 1997*, the Commissioner of State Revenue must issue a Property Clearance Certificate (Certificate) to an owner, mortgagee or bona fide purchaser of land who makes an application specifying the land for which the Certificate is sought and pays the application fee.

Amount shown on Certificate

2. The Certificate shows any land tax (including Vacant Residential Land Tax, interest and penalty tax) that is due and unpaid on the land described in the Certificate at the date of issue. In addition, it may show:
 - Land tax that has been assessed but is not yet due,
 - Land tax for the current tax year that has not yet been assessed, and
 - Any other information that the Commissioner sees fit to include, such as the amount of land tax applicable to the land on a single holding basis and other debts with respect to the property payable to the Commissioner.

Land tax is a first charge on land

3. Unpaid land tax (including Vacant Residential Land Tax, interest and penalty tax) is a first charge on the land to which it relates. This means it has priority over any other encumbrances on the land, such as a mortgage, and will continue as a charge even if ownership of the land is transferred. Therefore, a purchaser may become liable for any such unpaid land tax.

Information for the purchaser

4. Pursuant to section 96 of the *Land Tax Act 2005*, if a purchaser of the land described in the Certificate has applied for and obtained a certificate, the amount recoverable from the purchaser cannot exceed the amount set out in the certificate, described as the "Current Land Tax Charge" overleaf. A purchaser cannot rely on a Certificate obtained by the vendor.

Information for the vendor

5. Despite the issue of a Certificate, the Commissioner may recover a land tax liability from a vendor, including any amount identified on this Certificate.

General information

6. A Certificate showing no liability for the land does not mean that the land is exempt from land tax. It means that there is nothing to pay at the date of the Certificate.
7. An updated Certificate may be requested free of charge via our website, if:
 - The request is within 90 days of the original Certificate's issue date, and
 - There is no change to the parties involved in the transaction for which the Certificate was originally requested.

For Information Only

LAND TAX CALCULATION BASED ON SINGLE OWNERSHIP

Land Tax = \$555.00

Taxable Value = \$390,000

Calculated as \$375 plus (\$390,000 - \$300,000) multiplied by 0.200 cents.

Land Tax - Payment Options

BPAY



Bill Code: 5249
Ref: 65907065

Telephone & Internet Banking - BPAY®

Contact your bank or financial institution to make this payment from your cheque, savings, debit or transaction account.

www.bpay.com.au

CARD



Ref: 65907065

Visa or Mastercard

Pay via our website or phone 13 21 61.
A card payment fee applies.

sro.vic.gov.au/paylandtax

PROPERTY INFORMATION CERTIFICATE

Building Regulations 2018
Pursuant to Regulation 51(1)



Landata
PO BOX 500
EAST MELBOURNE VIC 8002

28 June 2023
PI: 332505

PIR-2023-3815 Your Ref 69311861-016-4
182 Christies Road, LEOPOLD VIC 3224

PROPERTY FOR WHICH INFORMATION WAS REQUESTED			
Property Address	182 Christies Road, LEOPOLD VIC 3224		
Title Information	626m2 Lot 53 PS 536898	Volume / Folio	CT-10987/892

Regulation 51(1) *Building Regulation 2018*, any person may request the relevant Council to provide in relation to any building or land:

1. Details of any Permit or Certificate of Final Inspection issued in the preceding 10 years:

Nil

2. Details of any current statement issued under Regulation 64 (Combined Allotments) or Regulation 231 (Subdivision of existing buildings)

Nil

3. Details of any current Notice or Order issued by the Relevant Building Surveyor under the Act.

Nil

Please Note:

- While every effort is made to provide full and accurate information, the Council's records may be deficient because of limitations in the period the records have been kept and/or because of their accuracy in recording or failure to record other permits, orders, variations or revocations.
- In addition, the existence of permits or certificates does not indicate whether all construction on a property complies with approvals. Independent inquiries should be made if in any doubt or if any problem is anticipated or encountered.

Yours sincerely

A handwritten signature in blue ink, appearing to read "Wendy Dias".

Wendy Dias
Technical Officer

BUILDING SERVICES
03 5272 4450

WURRIKI NYAL
WADAWURRUNG COUNTRY
137-149 MERCER STREET, GEELONG

TAX INVOICE



ABN 18 374 210 672

Secure Electronic Registries Victoria Pty Ltd
LOCKED BAG 20005
MELBOURNE VIC 3001

Debtor No.	900080
Invoice Date	28-Jun-2023
Enquiries	03 5272 5272
Application No.	PIR-2023-3815
Location	182 Christies Road, LEOPOLD VIC 3224
Your Ref	69311861-016-4

Invoice	Description	GST \$	Fee Amount \$
6311648	Building Information - Regulation 51(1)	0.00	48.80

Payment terms 30 days from date of invoice please

PAYMENT OPTIONS



Bill Code: 17475
Ref: 500009000803

*From your cheque, savings,
MasterCard or Visa accounts.
Please contact your financial
institution*

ONLINE OR BY PHONE

Online: www.geelongaustralia.com.au

Phone: 1300 858 058

Ref: 900080

A payment processing fee of 0.51 per cent
applies for MasterCard and Visa. Please Note If
you pay via BPay you can avoid this fee.

IN PERSON

Pay at any Post Office



*880 500009000803

or visit us at 137-149 Mercer Street,
Geelong.

Amount Due \$48.80

Debtor No. : 900080

Account Name : Secure Electronic Registries
Victoria Pty Ltd

Invoice Date : 28-Jun-2023



Council use barcode



**** Delivered by the LANDATA® System, Department of Environment, Land, Water & Planning ****

ROADS PROPERTY CERTIFICATE

The search results are as follows:

Geelong Property Conveyancing C/- Triconvey (Reseller)
77 Castlereagh Street
SYDNEY 2000
AUSTRALIA

Client Reference: 565701

NO PROPOSALS. As at the 22th June 2023, VicRoads has no approved proposals requiring any part of the property described in your application. You are advised to check your local Council planning scheme regarding land use zoning of the property and surrounding area.

This certificate was prepared solely on the basis of the Applicant-supplied address described below, and electronically delivered by LANDATA®.

182 CHRISTIES ROAD, LEOPOLD 3224
CITY OF GREATER GEELONG

This certificate is issued in respect of a property identified above. VicRoads expressly disclaim liability for any loss or damage incurred by any person as a result of the Applicant incorrectly identifying the property concerned.

Date of issue: 22th June 2023

Telephone enquiries regarding content of certificate: 13 11 71

[Vicroads Certificate] # 69311861 - 69311861095256 '565701'

Vendor GST Withholding Notice

Pursuant to Section 14-255 Schedule 1 Taxation Administration Act 1953 (Cwlth)

To: Purchaser

From: Stephen Francis McGuire, 9 Dovier Place, Leopold VIC 3224

Property Address: 182 Christies Road, Leopold VIC 3224

Lot: 53 Plan of subdivision: 536898F

The Purchaser is not required to make a payment under Section 14-250 of Schedule 1 of the Taxation Administration Act 1953 (Cwlth) in relation to the supply of the above property.

Dated: 22/06/2023

Signed for an on behalf of the Vendor: *Geelong Property Conveyancing*

PROPERTY REPORT



Environment,
Land, Water
and Planning

From www.planning.vic.gov.au at 20 June 2023 02:39 PM

PROPERTY DETAILS

Address: **182 CHRISTIES ROAD LEOPOLD 3224**
Lot and Plan Number: **Lot 53 PS536898**
Standard Parcel Identifier (SPI): **53\PS536898**
Local Government Area (Council): **GREATER GEELONG**
Council Property Number: **332505**
Directory Reference: **Melway 454 H12**

www.geelongaustralia.com.au

SITE DIMENSIONS

All dimensions and areas are approximate. They may not agree with those shown on a title or plan.

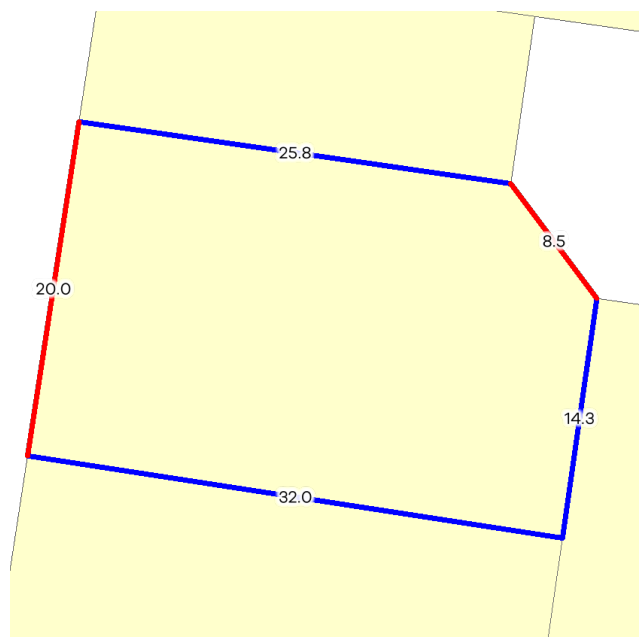

Area: 626 sq. m

Perimeter: 101 m

For this property:

— Site boundaries

— Road frontages

Dimensions for individual parcels require a separate search, but dimensions for individual units are generally not available.

Calculating the area from the dimensions shown may give a different value to the area shown above

For more accurate dimensions get copy of plan at [Title and Property Certificates](#)

UTILITIES

Rural Water Corporation: **Barwon Water**
Urban Water Corporation: **Southern Rural Water**
Melbourne Water: **Outside drainage boundary**
Power Distributor: **POWERCOR**

STATE ELECTORATES

Legislative Council: **WESTERN VICTORIA**
Legislative Assembly: **BELLARINE**

PLANNING INFORMATION

Property Planning details have been removed from the Property Reports to address duplication with the Planning Property Reports which are DELWP's authoritative source for all Property Planning information.

The Planning Property Report for this property can found here - [Planning Property Report](#)

Planning Property Reports can be found via these two links

Vicplan <https://mapshare.vic.gov.au/vicplan/>

Property and parcel search <https://www.land.vic.gov.au/property-and-parcel-search>

Area Map

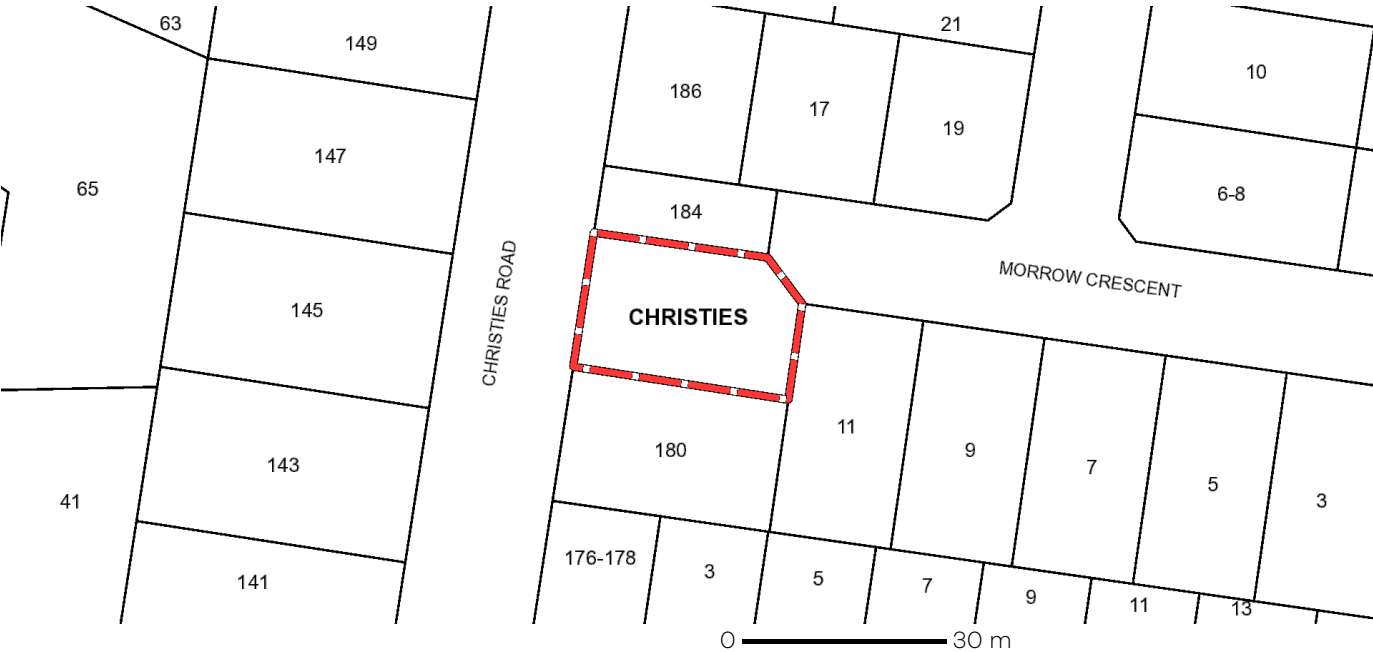

 Selected Property

PLANNING PROPERTY REPORT

From www.planning.vic.gov.au at 19 June 2023 03:04 PM

PROPERTY DETAILS

Address: **182 CHRISTIES ROAD LEOPOLD 3224**
Lot and Plan Number: **Lot 53 PS536898**
Standard Parcel Identifier (SPI): **53\PS536898**
Local Government Area (Council): **GREATER GEELONG**
Council Property Number: **332505**
Planning Scheme: **Greater Geelong**
Directory Reference: **Melway 454 H12**

www.geelongaustralia.com.au

[Planning Scheme - Greater Geelong](#)

UTILITIES

Rural Water Corporation: **Barwon Water**
Urban Water Corporation: **Southern Rural Water**
Melbourne Water: **Outside drainage boundary**
Power Distributor: **POWERCOR**

STATE ELECTORATES

Legislative Council: **WESTERN VICTORIA**
Legislative Assembly: **BELLARINE**

OTHER

Registered Aboriginal Party: **Wadawurrung Traditional Owners
Aboriginal Corporation**

[View location in VicPlan](#)

Planning Zones

[GENERAL RESIDENTIAL ZONE \(GRZ\)](#)

[GENERAL RESIDENTIAL ZONE - SCHEDULE 1 \(GRZ1\)](#)

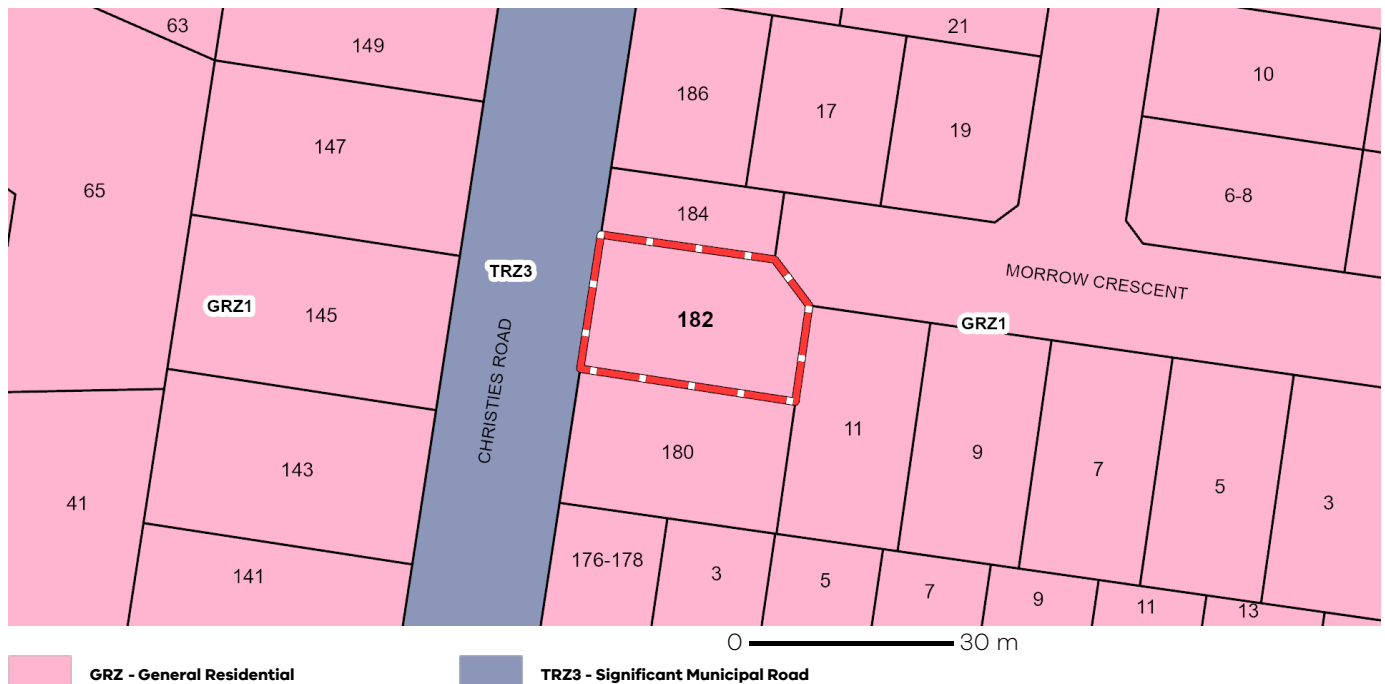

Note: labels for zones may appear outside the actual zone - please compare the labels with the legend.

Planning Overlay

None affecting this land - there are overlays in the vicinity

OTHER OVERLAYS

Other overlays in the vicinity not directly affecting this land

[DESIGN AND DEVELOPMENT OVERLAY \(DDO\)](#)

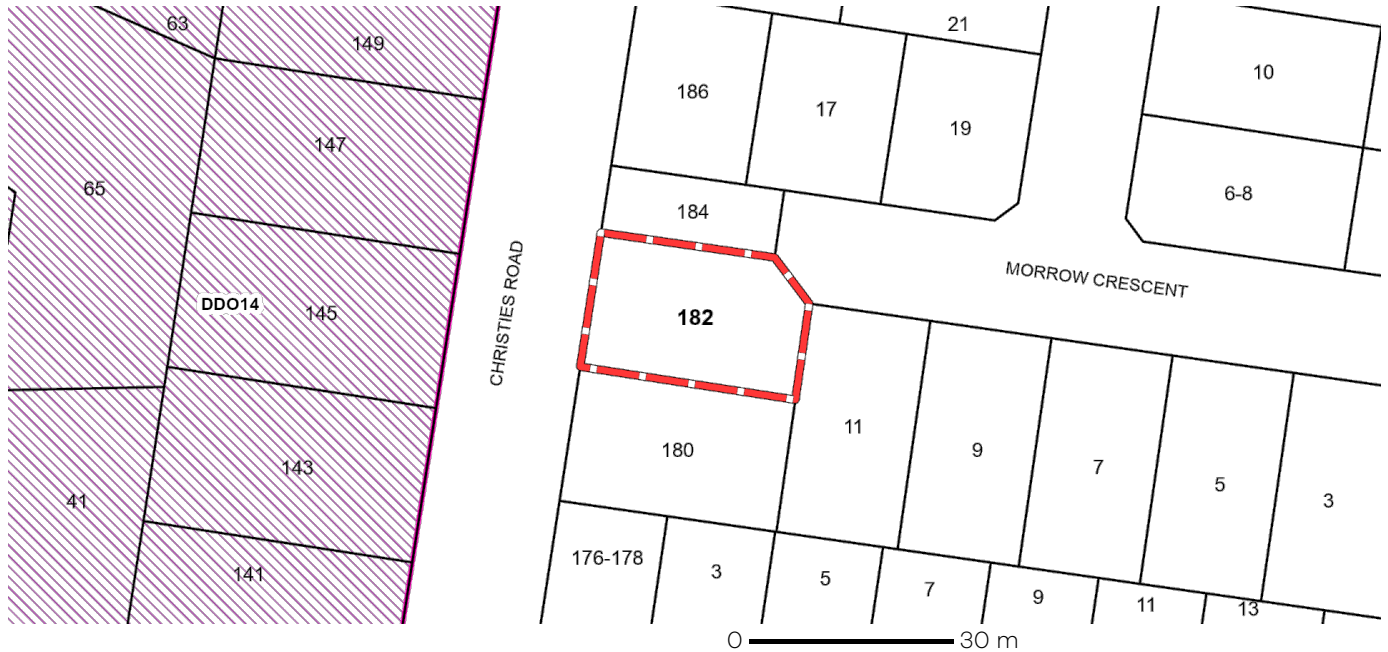

 **DDO - Design and Development Overlay**

Note: due to overlaps, some overlays may not be visible, and some colours may not match those in the legend

Further Planning Information

Planning scheme data last updated on 14 June 2023.

A **planning scheme** sets out policies and requirements for the use, development and protection of land. This report provides information about the zone and overlay provisions that apply to the selected land. Information about the State and local policy, particular, general and operational provisions of the local planning scheme that may affect the use of this land can be obtained by contacting the local council or by visiting <https://www.planning.vic.gov.au>

This report is NOT a **Planning Certificate** issued pursuant to Section 199 of the **Planning and Environment Act 1987**. It does not include information about exhibited planning scheme amendments, or zonings that may affect the land. To obtain a Planning Certificate go to Titles and Property Certificates at Landata - <https://www.landata.vic.gov.au>

For details of surrounding properties, use this service to get the Reports for properties of interest.

To view planning zones, overlay and heritage information in an interactive format visit <https://mapshare.maps.vic.gov.au/vicplan>

For other information about planning in Victoria visit <https://www.planning.vic.gov.au>

Designated Bushfire Prone Areas

This property is not in a designated bushfire prone area.
No special bushfire construction requirements apply. Planning provisions may apply.

Where part of the property is mapped as BPA, if no part of the building envelope or footprint falls within the BPA area, the BPA construction requirements do not apply.

Note: the relevant building surveyor determines the need for compliance with the bushfire construction requirements.

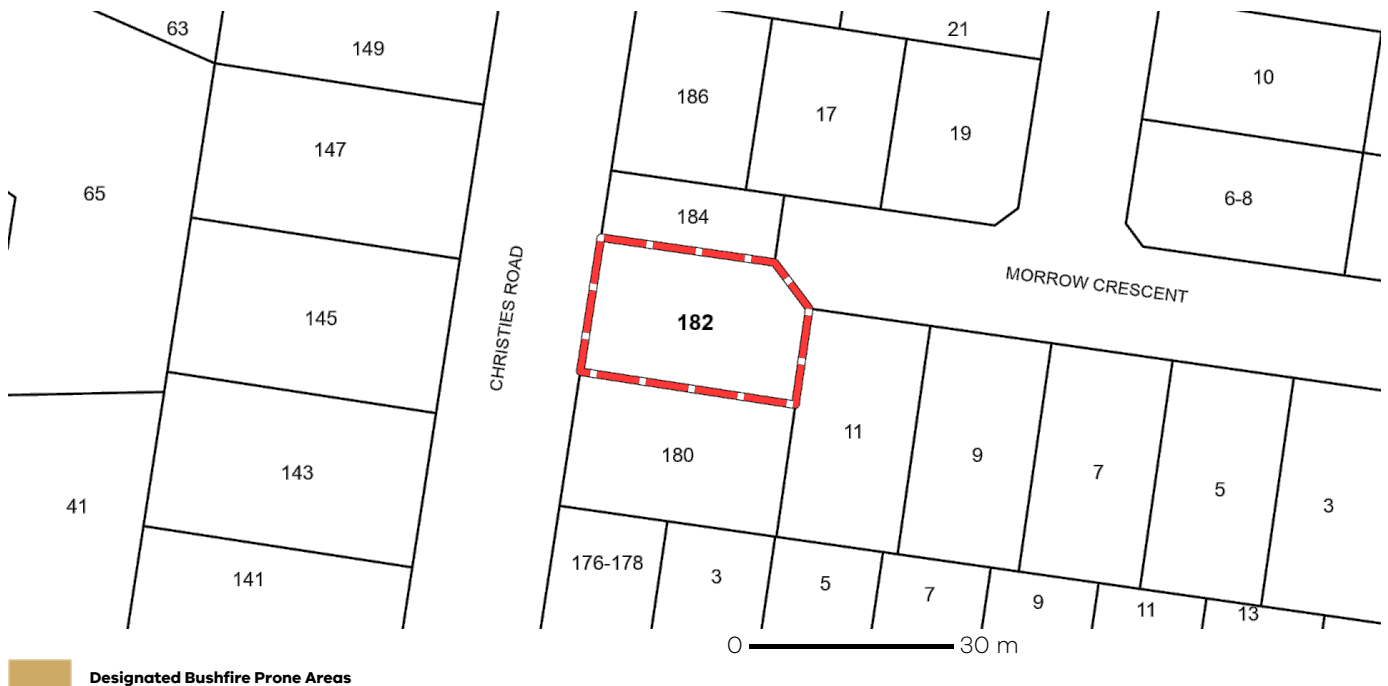

Designated BPA are determined by the Minister for Planning following a detailed review process. The Building Regulations 2018, through adoption of the Building Code of Australia, apply bushfire protection standards for building works in designated BPA.

Designated BPA maps can be viewed on VicPlan at <https://mapshare.vic.gov.au/vicplan/> or at the relevant local council.

Create a BPA definition plan in [VicPlan](#) to measure the BPA.

Information for lot owners building in the BPA is available at <https://www.planning.vic.gov.au>.

Further information about the building control system and building in bushfire prone areas can be found on the Victorian Building Authority website <https://www.vba.vic.gov.au>. Copies of the Building Act and Building Regulations are available from <http://www.legislation.vic.gov.au>. For Planning Scheme Provisions in bushfire areas visit <https://www.planning.vic.gov.au>.

Native Vegetation

Native plants that are indigenous to the region and important for biodiversity might be present on this property. This could include trees, shrubs, herbs, grasses or aquatic plants. There are a range of regulations that may apply including need to obtain a planning permit under Clause 52.17 of the local planning scheme. For more information see [Native Vegetation \(Clause 52.17\)](#) with local variations in [Native Vegetation \(Clause 52.17\) Schedule](#)

To help identify native vegetation on this property and the application of Clause 52.17 please visit the Native Vegetation Information Management system <https://nvim.delwp.vic.gov.au/> and [Native vegetation \(environment.vic.gov.au\)](https://www.environment.vic.gov.au) or please contact your relevant council.

You can find out more about the natural values on your property through NatureKit [NatureKit \(environment.vic.gov.au\)](https://www.environment.vic.gov.au)

Due diligence checklist

What you need to know before buying a residential property

Before you buy a home, you should be aware of a range of issues that may affect that property and impose restrictions or obligations on you, if you buy it. This checklist aims to help you identify whether any of these issues will affect you. The questions are a starting point only and you may need to seek professional advice to answer some of them. You can find links to organisations and web pages that can help you learn more, by visiting the [Due diligence checklist page on the Consumer Affairs Victoria website](https://consumer.vic.gov.au/duediligencechecklist) (consumer.vic.gov.au/duediligencechecklist).

Urban living

Moving to the inner city?

High density areas are attractive for their entertainment and service areas, but these activities create increased traffic as well as noise and odours from businesses and people. Familiarising yourself with the character of the area will give you a balanced understanding of what to expect.

Is the property subject to an owners corporation?

If the property is part of a subdivision with common property such as driveways or grounds, it may be subject to an owners corporation. You may be required to pay fees and follow rules that restrict what you can do on your property, such as a ban on pet ownership.

Growth areas

Are you moving to a growth area?

You should investigate whether you will be required to pay a growth areas infrastructure contribution.

Flood and fire risk

Does this property experience flooding or bushfire?

Properties are sometimes subject to the risk of fire and flooding due to their location. You should properly investigate these risks and consider their implications for land management, buildings and insurance premiums.

Rural properties

Moving to the country?

If you are looking at property in a rural zone, consider:

- Is the surrounding land use compatible with your lifestyle expectations? Farming can create noise or odour that may be at odds with your expectations of a rural lifestyle.
- Are you considering removing native vegetation? There are regulations which affect your ability to remove native vegetation on private property.
- Do you understand your obligations to manage weeds and pest animals?

Can you build new dwellings?

Does the property adjoin crown land, have a water frontage, contain a disused government road, or are there any crown licences associated with the land?

Is there any earth resource activity such as mining in the area?

You may wish to find out more about exploration, mining and quarrying activity on or near the property and consider the issue of petroleum, geothermal and greenhouse gas sequestration permits, leases and licences, extractive industry authorisations and mineral licences.

Soil and groundwater contamination

Has previous land use affected the soil or groundwater?

You should consider whether past activities, including the use of adjacent land, may have caused contamination at the site and whether this may prevent you from doing certain things to or on the land in the future.

(04/10/2016)

Land boundaries

Do you know the exact boundary of the property?

You should compare the measurements shown on the title document with actual fences and buildings on the property, to make sure the boundaries match. If you have concerns about this, you can speak to your lawyer or conveyancer, or commission a site survey to establish property boundaries.

Planning controls

Can you change how the property is used, or the buildings on it?

All land is subject to a planning scheme, run by the local council. How the property is zoned and any overlays that may apply, will determine how the land can be used. This may restrict such things as whether you can build on vacant land or how you can alter or develop the land and its buildings over time.

The local council can give you advice about the planning scheme, as well as details of any other restrictions that may apply, such as design guidelines or bushfire safety design. There may also be restrictions – known as encumbrances – on the property's title, which prevent you from developing the property. You can find out about encumbrances by looking at the section 32 statement.

Are there any proposed or granted planning permits?

The local council can advise you if there are any proposed or issued planning permits for any properties close by. Significant developments in your area may change the local 'character' (predominant style of the area) and may increase noise or traffic near the property.

Safety

Is the building safe to live in?

Building laws are in place to ensure building safety. Professional building inspections can help you assess the property for electrical safety, possible illegal building work, adequate pool or spa fencing and the presence of asbestos, termites, or other potential hazards.

Building permits

Have any buildings or retaining walls on the property been altered, or do you plan to alter them?

There are laws and regulations about how buildings and retaining walls are constructed, which you may wish to investigate to ensure any completed or proposed building work is approved. The local council may be able to give you information about any building permits issued for recent building works done to the property, and what you must do to plan new work. You can also commission a private building surveyor's assessment.

Are any recent building or renovation works covered by insurance?

Ask the vendor if there is any owner-builder insurance or builder's warranty to cover defects in the work done to the property.

Utilities and essential services

Does the property have working connections for water, sewerage, electricity, gas, telephone and internet?

Unconnected services may not be available, or may incur a fee to connect. You may also need to choose from a range of suppliers for these services. This may be particularly important in rural areas where some services are not available.

Buyers' rights

Do you know your rights when buying a property?

The contract of sale and section 32 statement contain important information about the property, so you should request to see these and read them thoroughly. Many people engage a lawyer or conveyancer to help them understand the contracts and ensure the sale goes through correctly. If you intend to hire a professional, you should consider speaking to them before you commit to the sale. There are also important rules about the way private sales and auctions are conducted. These may include a cooling-off period and specific rights associated with 'off the plan' sales. The important thing to remember is that, as the buyer, you have rights.