

Contract of Sale of Real Estate

Part 1 of the form of contract published by the Law Institute of Victoria Limited and The Real Estate Institute of Victoria Ltd

Property address **20 Leicester Street, Balwyn North 3104**

The vendor agrees to sell and the purchaser agrees to buy the property, being the land and the goods, for the price and on the terms set out in this contract.

The terms of this contract are contained in the -

- particulars of sale; and
- special conditions, if any; and
- general conditions

in that order of priority.

SIGNING OF THIS CONTRACT

WARNING: THIS IS A LEGALLY BINDING AGREEMENT. YOU SHOULD READ THIS CONTRACT BEFORE SIGNING IT.

Purchasers should ensure that, prior to signing this contract, they have received –

- a copy of the section 32 statement required to be given by a vendor under section 32 of the *Sale of Land Act 1962* in accordance with Division 2 of Part II of that Act; and
- a copy of the full terms of this contract.

The authority of a person signing -

- under power of attorney; or
- as director of a corporation; or
- as agent authorised in writing by one of the parties - must be noted beneath the signature.

Any person whose signature is secured by an estate agent acknowledges being given by the agent at the time of signing a copy of the terms of this contract.

SIGNED BY THE PURCHASER:

..... on/...../2025

Print name(s) of person(s) signing:

.....

State nature of authority, if applicable:

This offer will lapse unless accepted within [] clear business days (3 clear business days if none specified)

SIGNED BY THE VENDOR:

..... on/...../2025

Print name(s) of person(s) signing: **ANASTASI LOUIS IOANNIDIS and ANDREA IOANNIDIS**

State nature of authority, if applicable:

The **DAY OF SALE** is the date by which both parties have signed this contract.

IMPORTANT NOTICE TO PURCHASERS

Cooling-off period (Section 31 of the *Sale of Land Act 1962*)

You may end this contract within 3 clear business days of the day that you sign the contract if none of the exceptions listed below applies to you.

You must either give the vendor or the vendor's agent **written** notice that you are ending the contract or leave the notice at the address of the vendor or the vendor's agent to end this contract within this time in accordance with this cooling-off provision.

You are entitled to a refund of all the money you paid EXCEPT for \$100 or 0.2% of the purchase price (whichever is more) if you end the contract in this way.

EXCEPTIONS: The 3-day cooling-off period does not apply if:

- you bought the property at or within 3 clear business days **before or after** a publicly advertised auction;
- the property is used primarily for industrial or commercial purposes; or
- the property is more than 20 hectares in size and is used primarily for farming; or
- you and the vendor have previously signed a contract for the sale of the same land in substantially the same terms; or
- you are an estate agent or a corporate body.

*This contract is approved by the Law Institute of Victoria Limited, a professional association within the meaning of the *Legal Profession Act 2004*, under section 53A of the *Estate Agents Act 1980*.

NOTICE TO PURCHASERS OF PROPERTY OFF-THE-PLAN

Off-the-plan sales (Section 9AA(1A) of the *Sale of Land Act 1962*)

You may negotiate with the vendor about the amount of the deposit moneys payable under the contract of sale, up to 10 per cent of the purchase price.

A substantial period of time may elapse between the day on which you sign

the contract of sale and the day on which you become the registered proprietor of the lot.

The value of the lot may change between the day on which you sign the contract of sale of that lot and the day on which you become the registered proprietor.

Particulars of sale

Vendor's estate agent

Langwell Harper

416 High St, Kew VICTORIA 3101

Email: akorf@langwelharper.com.au

Tel: 9276 5900

Mob: 0413 757 353

Fax:

Ref: Arthur Korf

Vendor

ANASTASI LOUIS IOANNIDIS and ANDREA IOANNIDIS

Vendor's legal practitioner or conveyancer

Noble House Lawyers

Chadstone Tower 1 Level 8, 1341 Dandenong, Chadstone VIC 3148

Email: na@nhlawyers.com.au

Tel: 03 9544 2076

Mob:

Fax: 03 9543 8729

Ref: NA:20230100

Purchaser

Name:

.....

Address:

ABN/ACN:

Email:

Purchaser's legal practitioner or conveyancer

Name:

Address:

Email:

Tel:..... Mob: Fax: Ref:

Land (general conditions 3 and 9)

The land is described in the table below –

Certificate of Title reference		being lot	on plan		
Volume	12012	Folio	728	1	805838C
Volume		Folio			

OR

described in the copy of the Register Search Statement and the document or part document referred to as the diagram location in the Register Search Statement, as attached to the section 32 statement if no title or plan references are recorded in the table above or as described in the section 32 statement if the land is general law land.

The land includes all improvements and fixtures.

Property address

The address of the land is: **20 Leicester Street, Balwyn North 3104**

Goods sold with the land (general condition 2.3(f)) (list or attach schedule)

All fixtures and fittings as inspected

Payment (general condition 11)

Price	\$			
Deposit	\$	_____	by	(of which \$ _____ has been paid)
Balance	\$	_____	payable at settlement	

GST (general condition 13)

The price includes GST (if any) unless the words '**plus GST**' appear in this box

If this sale is a sale of land on which a 'farming business' is carried on which the parties consider meets requirements of section 38-480 of the GST Act or of a 'going concern' then add the words '**farming business**' or '**going concern**' in this box

If the margin scheme will be used to calculate GST then add the words '**margin scheme**' in this box

Settlement (general condition 10)

is due on

unless the land is a lot on an unregistered plan of subdivision, in which case settlement is due on the later of:

- the above date; and
- ~~14 days after the vendor gives notice in writing to the purchaser of registration of the plan of subdivision.~~

Lease (general condition 1.1)

At settlement the purchaser is entitled to vacant possession of the property unless the words '**subject to lease**' appear in this box in which case refer to general condition 1.1.

If '**subject to lease**' then particulars of the lease are :

(*only complete the one that applies. Check tenancy agreement/lease **before** completing details)

Terms contract (general condition 23)

If this contract is intended to be a terms contract within the meaning of the *Sale of Land Act* 1962 then add the words '**terms contract**' in this box and refer to general condition 23 and add any further provisions by way of special conditions.

Loan (general condition 14)

The following details apply if this contract is subject to a loan being approved.

Lender:

Loan amount

Approval date:

This contract does not include any special conditions unless the words '**special conditions**' appear in this box

Special conditions

Special Conditions

A SPECIAL CONDITION OPERATES IF THE BOX NEXT TO IT IS CHECKED OR THE PARTIES OTHERWISE AGREE IN WRITING.

Instructions: *It is recommended that when adding further special conditions:*

- each special condition is numbered;
- the parties initial each page containing special conditions;
- a line is drawn through any blank space remaining on the last page; and
- attach additional pages if there is not enough space

Special condition 1 – Payment

General condition 11 is replaced with the following:

11. PAYMENT

- 11.1 The purchaser must pay the deposit:
- (a) to the vendor's licensed estate agent; or
 - (b) if there is no estate agent, to the vendor's legal practitioner or conveyancer; or
 - (c) if the vendor directs, into a special purpose account in an authorised deposit-taking institution in Victoria specified by the vendor in the joint names of the purchaser and the vendor.
- 11.2 If the land sold is a lot on an unregistered plan of subdivision, the deposit:
- (a) must not exceed 10% of the price; and
 - (b) must be paid to the vendor's estate agent, legal practitioner or conveyancer and held by the estate agent, legal practitioner or conveyancer on trust for the purchaser until the registration of the plan of subdivision
- 11.3 The purchaser must pay all money other than the deposit:
- (a) to the vendor, or the vendor's legal practitioner or conveyancer; or
 - (b) in accordance with a written direction of the vendor or the vendor's legal practitioner or conveyancer.
- 11.4 Payments may be made or tendered:
- (a) up to \$1,000 in cash; or
 - (b) by cheque drawn on an authorised deposit taking institution; or
 - (c) by electronic funds transfer to a recipient having the appropriate facilities for receipt.
- However, unless otherwise agreed:
- (d) payment may not be made by credit card, debit card or any other financial transfer system that allows for any chargeback or funds reversal other than for fraud or mistaken payment, and
 - (e) any financial transfer or similar fees or deductions from the funds transferred, other than any fees charged by the recipient's authorised deposit-taking institution, must be paid by the remitter.
- 11.5 At settlement, the purchaser must pay the fees on up to three cheques drawn on an authorised deposit taking institution. If the vendor requests that any additional cheques be drawn on an authorised deposit-taking institution, the vendor must reimburse the purchaser for the fees incurred.
- 11.6 Payment by electronic funds transfer is made when cleared funds are received in the recipient's bank account.
- 11.7 Before the funds are electronically transferred the intended recipient must be notified in writing and given sufficient particulars to readily identify the relevant transaction.
- 11.8 As soon as the funds have been electronically transferred the intended recipient must be provided with the relevant transaction number or reference details.
- 11.9 Each party must do everything reasonably necessary to assist the other party to trace and identify the recipient of any missing or mistaken payment and to recover the missing or mistaken payment.
- 11.10 For the purpose of this general condition 'authorised deposit-taking institution' means a body corporate for which an authority under section 9(3) of the *Banking Act 1959 (Cth)* is in force.

Special condition 2 – Acceptance of title

General condition 12.4 is added:

- 12.4 Where the purchaser is deemed by section 27(7) of the *Sale of Land Act 1962* to have given the deposit release authorisation referred to in section 27(1), the purchaser is also deemed to have accepted title in the absence of any prior express objection to title.

Special condition 3 – Auction Clause

The property is offered for sale by public auction, subject to the vendor's reserve price. The rules for the conduct of the auction shall be as set out in the schedules to the Sale of Land (Public Auctions) Regulations 2014 or any rules prescribed by regulation which modify or replace those rules.

Special condition 4 – Adjustments

General condition 15.3 is added:

- 15.3 The purchaser must provide copies of all certificates and other information used to calculate the adjustments under general condition 15, if requested by the vendor.

Special condition 5 – Foreign resident capital gains withholding

General condition 15A is added:

15A. FOREIGN RESIDENT CAPITAL GAINS WITHHOLDING

- 15A.1 Words defined or used in Subdivision 14-D of Schedule 1 to the *Taxation Administration Act 1953 (Cth)* have the same meaning in this general condition unless the context requires otherwise.
- 15A.2 Every vendor under this contract is a foreign resident for the purposes of this general condition unless the vendor gives the purchaser a clearance certificate issued by the Commissioner under section 14-220 (1) of Schedule 1 to the *Taxation Administration Act 1953 (Cth)*. The specified period in the clearance certificate must include the actual date of settlement.
- 15A.3 This general condition only applies if the purchaser is required to pay the Commissioner an amount in accordance with section 14-200(3) or section 14-235 of Schedule 1 to the *Taxation Administration Act 1953 (Cth)* ("the amount") because one or more of the vendors is a foreign resident, the property has or will have a market value not less than the amount set out in section 14-215 of the legislation just after the transaction, and the transaction is not excluded under section 14-215(1) of the legislation.
- 15A.4 The amount is to be deducted from the vendor's entitlement to the contract consideration. The vendor must pay to the purchaser at settlement such part of the amount as is represented by non-monetary consideration.
- 15A.5 The purchaser must:
- (a) engage a legal practitioner or conveyancer ("representative") to conduct all legal aspects of settlement, including the performance of the purchaser's obligations under the legislation and this general condition; and
 - (b) ensure that the representative does so.
- 15A.6 The terms of the representative's engagement are taken to include instructions to have regard to the vendor's interests and instructions that the representative must:
- (a) pay, or ensure payment of, the amount to the Commissioner in the manner required by the Commissioner as soon as reasonably and practicably possible, from moneys under the control or direction of the representative in accordance with this general condition if the sale of the property settles;
 - (b) promptly provide the vendor with proof of payment; and
 - (c) otherwise comply, or ensure compliance with, this general condition;
- despite:
- (d) any contrary instructions, other than from both the purchaser and the vendor; and
 - (e) any other provision in this contract to the contrary.
- 15A.7 The representative is taken to have complied with the requirements in special condition 15A.6 if:
- (a) the settlement is conducted through the electronic conveyancing system operated by Property Exchange Australia Ltd or any other electronic conveyancing system agreed by the parties; and
 - (b) the amount is included in the settlement statement requiring payment to the Commissioner in respect of this transaction.
- 15A.8 Any clearance certificate or document evidencing variation of the amount in accordance with section 14-235(2) of Schedule 1 to the *Taxation Administration Act 1953 (Cth)* must be given to the purchaser at least 5 business days before the due date for settlement.
- 15A.9 The vendor must provide the purchaser with such information as the purchaser requires to comply with the purchaser's obligation to pay the amount in accordance with section 14-200 of Schedule 1 to the *Taxation Administration Act 1953 (Cth)*. The information must be provided within 5 business days of request by the purchaser. The vendor warrants that the information the vendor provides is true and correct.
- 15A.10 The purchaser is responsible for any penalties or interest payable to the Commissioner on account of late payment of the amount.

Special condition 5A – GST withholding

[Note: the box should be checked if the property sold is or may be new residential premises or potential residential land, whether or not falling within the parameters of section 14-250 of Schedule 1 to the *Taxation Administration Act 1953 (Cth)*]

General condition 15B is added:

15B. GST WITHHOLDING

- 15B.1 Words and expressions defined or used in Subdivision 14-E of Schedule 1 to the *Taxation Administration Act 1953 (Cth)* or in *A New Tax System (Goods and Services Tax) Act 1999 (Cth)* have the same meaning in this general condition unless the context requires otherwise. Words and expressions first used in this general condition and shown in italics and marked with an asterisk are defined or described in at least one of those Acts.

- 15B.2 This general condition 15B applies if the purchaser is required to pay the Commissioner an **amount* in accordance with section 14-250 of Schedule 1 to the *Taxation Administration Act 1953* (Cth) because the property is **new residential premises* or **potential residential land* in either case falling within the parameters of that section, and also if the sale attracts the operation of section 14-255 of the legislation. Nothing in this general condition 15B is to be taken as relieving the vendor from compliance with section 14-255.
- 15B.3 The amount is to be deducted from the vendor's entitlement to the contract **consideration* and is then taken to be paid to the vendor, whether or not the vendor provides the purchaser with a GST withholding notice in accordance with section 14-255 of Schedule 1 to the *Taxation Administration Act 1953* (Cth). The vendor must pay to the purchaser at settlement such part of the amount as is represented by non-monetary consideration.
- 15B.4 The purchaser must:
- (a) engage a legal practitioner or conveyancer ("representative") to conduct all the legal aspects of settlement, including the performance of the purchaser's obligations under the legislation and this general condition; and
 - (b) ensure that the representative does so.
- 15B.5 The terms of the representative's engagement are taken to include instructions to have regard to the vendor's interests relating to the payment of the amount to the commissioner and instructions that the representative must:
- (a) pay, or ensure payment of, the amount to the Commissioner in the manner required by the Commissioner and as soon as reasonably and practicably possible, from moneys under the control or direction of the representative in accordance with this general condition on settlement of the sale of the property;
 - (b) promptly provide the vendor with evidence of payment, including any notification or other document provided by the purchaser to the Commissioner relating to payment; and
 - (c) otherwise comply, or ensure compliance, with this general condition;
- despite:
- (d) any contrary instructions, other than from both the purchaser and the vendor; and
 - (e) any other provision in this contract to the contrary.
- 15B.6 The representative is taken to have complied with the requirements of general condition 15B.5 if:
- (a) settlement is conducted through the electronic conveyancing system operated by Property Exchange Australia Ltd or any other electronic conveyancing system agreed by the parties; and
 - (b) the amount is included in the settlement statement requiring payment to the Commissioner in respect of this transaction.
- 15B.7 The purchaser may at settlement give the vendor a bank cheque for the amount in accordance with section 16-30 (3) of Schedule 1 to the *Taxation Administration Act 1953* (Cth), but only if:
- (a) so agreed by the vendor in writing; and
 - (b) the settlement is not conducted through an electronic settlement system described in general condition 15B.6.
- However, if the purchaser gives the bank cheque in accordance with this general condition 15B.7, the vendor must:
- (c) immediately after settlement provide the bank cheque to the Commissioner to pay the amount in relation to the supply; and
 - (d) give the purchaser a receipt for the bank cheque which identifies the transaction and includes particulars of the bank cheque, at the same time the purchaser gives the vendor the bank cheque.
- 15B.8 The vendor must provide the purchaser with a GST withholding notice in accordance with section 14-255 of Schedule 1 to the *Taxation Administration Act 1953* (Cth) at least 14 days before the due date for settlement.
- 15B.9 A party must provide the other party with such information as the other party requires to:
- (a) decide if an amount is required to be paid or the quantum of it, or
 - (b) comply with the purchaser's obligation to pay the amount,
- in accordance with section 14-250 of Schedule 1 of the *Taxation Administration Act 1953* (Cth). The information must be provided within 5 business days of a written request. The party providing the information warrants that it is true and correct.
- 15B.10 The vendor warrants that:
- (a) at settlement, the property is not new residential premises or potential residential land in either case falling within the parameters of section 14-250 of Schedule 1 to the *Taxation Administration Act 1953* (Cth) if the vendor gives the purchaser a written notice under section 14-255 to the effect that the purchaser will not be required to make a payment under section 14-250 in respect of the supply, or fails to give a written notice as required by and within the time specified in section 14-255; and
 - (b) the amount described in a written notice given by the vendor to the purchaser under section 14-255 of Schedule 1 to the *Taxation Administration Act 1953* (Cth) is the correct amount required to be paid under section 14-250 of the legislation.
- 15B.11 The purchaser is responsible for any penalties or interest payable to the commissioner on account of non-payment or late payment of the amount, except to the extent that:
- (a) the penalties or interest arise from the vendor's failure, including breach of a warranty in general condition 15B.10; or
 - (b) the purchaser's reasonable belief that the property is neither new residential premises nor potential residential land requiring the purchaser to pay an amount to the Commissioner in accordance with section 14-250 (1) of Schedule 1 to the *Taxation Administration Act 1953* (Cth)
- The vendor is responsible for any penalties or interest payable to the commissioner on account of non-payment or late payment of the amount if either exception applies.
- 15B.12 This general condition will not merge on settlement.

Special condition 6 – Service

General condition 17 is replaced with the following:

17. SERVICE

- 17.1 Any document required to be served by or on any party may be served by or on the legal practitioner or conveyancer for that party.
- 17.2 A document being a cooling off notice under section 31 of the *Sale of Land Act* 1962 or a notice under general condition 14.2 (ending the contract if the loan is not approved) may be served on the vendor's legal practitioner, conveyance or estate agent even if the estate agent's authority has formally expired at the time of service.
- 17.3 A document is sufficiently served:
- (a) personally, or
 - (b) by pre-paid post, or
 - (c) in a manner authorised by law or by the Supreme Court for service of documents, including any manner authorised for service on or by a legal practitioner, whether or not the person serving or receiving the document is a legal practitioner, or
 - (d) by email.
- 17.4 Any document properly sent by:
- (a) express post is taken to have been served on the next business day after posting, unless proved otherwise;
 - (b) priority post is taken to have been served on the fourth business day after posting, unless proved otherwise;
 - (c) regular post is taken to have been served on the sixth business day after posting, unless proved otherwise
 - (d) email is taken to have been served at the time of receipt within the meaning of section 13A of the *Electronic Transactions (Victoria) Act 2000*.
- 17.5 The expression 'document' includes 'demand' and 'notice', and 'service' includes 'give' in this contract.

Special condition 7 – Notices

General condition 21 is replaced with the following:

21. NOTICES

- 21.1 The vendor is responsible for any notice, order, demand or levy imposing liability on the property that is issued or made before the day of sale, and does not relate to periodic outgoings.
- 21.2 The purchaser is responsible for any notice, order, demand or levy imposing liability on the property that is issued or made on or after the day of sale, and does not relate to periodic outgoings.
- 21.3 The purchaser may enter the property to comply with that responsibility where action is required before settlement.

Special condition 8 – Electronic conveyancing

- 8.1 Settlement and lodgment of the instruments necessary to record the purchaser as registered proprietor of the land will be conducted electronically in accordance with the *Electronic Conveyancing National Law*. The parties may subsequently agree in writing that this special condition 8 applies even if the box next to it is not checked. This special condition 8 has priority over any other provision to the extent of any inconsistency.
- 8.2 A party must immediately give written notice if that party reasonably believes that settlement and lodgment can no longer be conducted electronically. Special condition 8 ceases to apply from when such a notice is given.
- 8.3 Each party must:
- (a) be, or engage a representative who is, a subscriber for the purposes of the *Electronic Conveyancing National Law*,
 - (b) ensure that all other persons for whom that party is responsible and who are associated with this transaction are, or engage, a subscriber for the purposes of the *Electronic Conveyancing National Law*, and
 - (c) conduct the transaction in accordance with the *Electronic Conveyancing National Law*.
- 8.4 The vendor must open the Electronic Workspace ("workspace") as soon as reasonably practicable. The inclusion of a specific date for settlement in a workspace is not of itself a promise to settle on that date. The workspace is an electronic address for the service of notices and for written communications for the purposes of any electronic transactions legislation.
- 8.5 The vendor must nominate a time of the day for locking of the workspace at least 7 days before the due date for settlement.
- 8.6 Settlement occurs when the workspace records that:
- (a) the exchange of funds or value between financial institutions in accordance with the instructions of the parties has occurred; or
 - (b) if there is no exchange of funds or value, the documents necessary to enable the purchaser to become registered proprietor of the land have been accepted for electronic lodgment.
- 8.7 The parties must do everything reasonably necessary to effect settlement:
- (a) electronically on the next business day; or
 - (b) at the option of either party, otherwise than electronically as soon as possible –
- if, after the locking of the workspace at the nominated settlement time, settlement in accordance with special condition 8.6 has not occurred by 4.00 pm, or 6.00 pm if the nominated time for settlement is after 4.00 pm.

- 8.8 Each party must do everything reasonably necessary to assist the other party to trace and identify the recipient of any missing or mistaken payment and to recover the missing or mistaken payment.
- 8.9 The vendor must before settlement:
- (a) deliver any keys, security devices and codes ("keys") to the estate agent named in the contract,
 - (b) direct the estate agent to give the keys to the purchaser or the purchaser's nominee on notification of settlement by the vendor, the vendor's subscriber or the Electronic Network Operator,
 - (c) deliver all other physical documents and items (other than the goods sold by the contract) to which the purchaser is entitled at settlement, and any keys if not delivered to the estate agent, to the vendor's subscriber or, if there is no vendor's subscriber, confirm in writing to the purchaser that the vendor holds those documents, items and keys at the vendor's address set out in the contract, and give, or direct its subscriber to give, all those documents and items and any such keys to the purchaser or the purchaser's nominee on notification by the Electronic Network Operator of settlement.
- 8.10 The vendor must, at least 7 days before the due date for settlement, provide the original of any document required to be prepared by the vendor in accordance with general condition 6.

Special condition 9 – ACKNOWLEDGEMENTS/CONDITION:

- 9.1 The Purchaser has purchased the property and all improvements, plant equipment, fixtures, fittings or goods ("the improvements") passing with the property on its sale as a result of its own inspection and enquiries. The Vendor makes no warranty as to the condition of the land or improvements on the land; and
- 9.2 The Purchaser may not make any objection or claim any compensation in respect of any non-compliance of any Building Regulations or any other regulations, statutes, rules, local laws of the Building Code of Australia, failure to obtain any Building Permit, certificate of final inspection or approval on final inspection or occupancy permit of any improvement on the land or in respect of the state of repair and condition of the improvements or failure to obtain any planning permit as to the existing use of the property or non-compliance with any existing planning permit (or conditions thereof).

General Conditions

Part 2 being Form 2 prescribed by the former *Estate Agents (Contracts) Regulations 2008*

Title

1. ENCUMBRANCES

- 1.1 The purchaser buys the property subject to:
 - (a) any encumbrance shown in the section 32 statement other than mortgages or caveats; and
 - (b) any reservations in the crown grant; and
 - (c) any lease referred to in the particulars of sale.
- 1.2 The purchaser indemnifies the vendor against all obligations under any lease that are to be performed by the landlord after settlement.
- 1.3 In this general condition 'section 32 statement' means a statement required to be given by a vendor under section 32 of the *Sale of Land Act 1962* in accordance with Division 2 of Part II of that Act.

2. VENDOR WARRANTIES

- 2.1 The vendor warrants that these general conditions 1 to 28 are identical to the general conditions 1 to 28 in the standard form of contract of sale of real estate prescribed by the former Estate Agents (Contracts) Regulations 2008 for the purposes of section 53A of the *Estate Agents Act 1980*.
- 2.2 The warranties in general conditions 2.3 and 2.4 replace the purchaser's right to make requisitions and inquiries.
- 2.3 The vendor warrants that the vendor:
 - (a) has, or by the due date for settlement will have, the right to sell the land; and
 - (b) is under no legal disability; and
 - (c) is in possession of the land, either personally or through a tenant; and
 - (d) has not previously sold or granted any option to purchase, agreed to lease or granted a pre-emptive right which is current over the land and which gives another party rights which have priority over the interest of the purchaser; and
 - (e) will at settlement be the holder of an unencumbered estate in fee simple in the land; and
 - (f) will at settlement be the unencumbered owner of any improvements, fixtures, fittings and goods sold with the land.
- 2.4 The vendor further warrants that the vendor has no knowledge of any of the following:
 - (a) public rights of way over the land;
 - (b) easements over the land;
 - (c) lease or other possessory agreement affecting the land;
 - (d) notice or order affecting the land which will not be dealt with at settlement, other than the usual rate notices and any land tax notices;
 - (e) legal proceedings which would render the sale of the land void or voidable or capable of being set aside.
- 2.5 The warranties in general conditions 2.3 and 2.4 are subject to any contrary provisions in this contract and disclosures in the section 32 statement required to be given by the vendor under section 32 of the *Sale of Land Act 1962* in accordance with Division 2 of Part II of that Act.
- 2.6 If sections 137B and 137C of the *Building Act 1993* apply to this contract, the vendor warrants that:
 - (a) all domestic building work carried out in relation to the construction by or on behalf of the vendor of the home was carried out in a proper and workmanlike manner; and
 - (b) all materials used in that domestic building work were good and suitable for the purpose for which they were used and that, unless otherwise stated in the contract, those materials were new; and
 - (c) domestic building work was carried out in accordance with all laws and legal requirements, including, without limiting the generality of this warranty, the *Building Act 1993* and regulations made under the *Building Act 1993*.
- 2.7 Words and phrases used in general condition 2.6 which are defined in the *Building Act 1993* have the same meaning in general condition 2.6.

3. IDENTITY OF THE LAND

- 3.1 An omission or mistake in the description of the property or any deficiency in the area, description or measurements of the land does not invalidate the sale.
- 3.2 The purchaser may not:

- (a) make any objection or claim for compensation for any alleged misdescription of the property or any deficiency in its area or measurements; or
- (b) require the vendor to amend title or pay any cost of amending title.

4. SERVICES

- 4.1 The vendor does not represent that the services are adequate for the purchaser's proposed use of the property and the vendor advises the purchaser to make appropriate inquiries. The condition of the services may change between the day of sale and settlement and the vendor does not promise that the services will be in the same condition at settlement as they were on the day of sale.
- 4.2 The purchaser is responsible for the connection of all services to the property after settlement and the payment of any associated cost.

5. CONSENTS

The vendor must obtain any necessary consent or licence required for the sale. The contract will be at an end and all money paid must be refunded if any necessary consent or licence is not obtained by settlement.

6. TRANSFER

The transfer of land document must be prepared by the purchaser and delivered to the vendor at least 10 days before settlement. The delivery of the transfer of land document is not acceptance of title. The vendor must prepare any document required for assessment of duty on this transaction relating to matters that are or should be within the knowledge of the vendor and, if requested by the purchaser, must provide a copy of that document at least 3 days before settlement.

7. RELEASE OF SECURITY INTEREST

- 7.1 This general condition applies if any part of the property is subject to a security interest to which the *Personal Property Securities Act 2009 (Cth)* applies.
- 7.2 For the purposes of enabling the purchaser to search the Personal Property Securities Register for any security interests affecting any personal property for which the purchaser may be entitled to a release, statement, approval or correction in accordance with general condition 7.4, the purchaser may request the vendor to provide the vendor's date of birth to the purchaser. The vendor must comply with a request made by the purchaser under this condition if the purchaser makes the request at least 21 days before the due date for settlement.
- 7.3 If the purchaser is given the details of the vendor's date of birth under condition 7.2, the purchaser must
 - (a) only use the vendor's date of birth for the purposes specified in condition 7.2; and
 - (b) keep the date of birth of the vendor secure and confidential.
- 7.4 The vendor must ensure that at or before settlement, the purchaser receives –
 - (a) a release from the secured party releasing the property from the security interest; or
 - (b) a statement in writing in accordance with section 275(1)(b) of the *Personal Property Securities Act 2009 (Cth)* setting out that the amount or obligation that is secured is nil at settlement; or
 - (c) a written approval or correction in accordance with section 275(1)(c) of the *Personal Property Securities Act 2009 (Cth)* indicating that, on settlement, the personal property included in the contract is not or will not be property in which the security interest is granted.
- 7.5 Subject to general condition 7.6, the vendor is not obliged to ensure that the purchaser receives a release, statement, approval or correction in respect of personal property -
 - (a) that -
 - (i) the purchaser intends to use predominately for personal, domestic or household purposes; and
 - (ii) has a market value of not more than \$5000 or, if a greater amount has been prescribed for the purposes of section 47(1) of the *Personal Property Securities Act 2009 (Cth)*, not more than that prescribed amount; or
 - (b) that is sold in the ordinary course of the vendor's business of selling personal property of that kind.
- 7.6 The vendor is obliged to ensure that the purchaser receives a release, statement, approval or correction in respect of personal property described in general condition 7.5 if -
 - (a) the personal property is of a kind that may be described by a serial number in the Personal Property Securities Register; or
 - (b) the purchaser has actual or constructive knowledge that the sale constitutes a breach of the security agreement that provides for the security interest.
- 7.7 A release for the purposes of general condition 7.4(a) must be in writing.
- 7.8 A release for the purposes of general condition 7.4(a) must be effective in releasing the goods from the security interest and be in a form which allows the purchaser to take title to the goods free of that security interest.

- 7.9 If the purchaser receives a release under general condition 7.4(a) the purchaser must provide the vendor with a copy of the release at or as soon as practicable after settlement.
- 7.10 In addition to ensuring a release is received under general condition 7.4(a), the vendor must ensure that at or before settlement the purchaser receives a written undertaking from a secured party to register a financing change statement to reflect that release if the property being released includes goods of a kind that are described by serial number in the Personal Property Securities Register.
- 7.11 The purchaser must advise the vendor of any security interest that is registered on or before the day of sale on the Personal Property Securities Register, which the purchaser reasonably requires to be released, at least 21 days before the due date for settlement.
- 7.12 The vendor may delay settlement until 21 days after the purchaser advises the vendor of the security interests that the purchaser reasonably requires to be released if the purchaser does not provide an advice under general condition 7.11
- 7.13 If settlement is delayed under general condition 7.12, the purchaser must pay the vendor -
- (a) interest from the due date for settlement until the date on which settlement occurs or 21 days after the vendor receives the advice, whichever is the earlier; and
 - (b) any reasonable costs incurred by the vendor as a result of the delay -
- as though the purchaser was in default.
- 7.14 The vendor is not required to ensure that the purchaser receives a release in respect of the land. This general condition 7.14 applies despite general condition 7.1.
- 7.15 Words and phrases which are defined in the *Personal Property Securities Act 2009* (Cth) have the same meaning in general condition 7 unless the context requires otherwise.

8. BUILDING WARRANTY INSURANCE

The vendor warrants that the vendor will provide at settlement details of any current builder warranty insurance in the vendor's possession relating to the property if requested in writing to do so at least 21 days before settlement.

9. GENERAL LAW LAND

- 9.1 This general condition only applies if any part of the land is not under the operation of the *Transfer of Land Act 1958*.
- 9.2 The vendor is taken to be the holder of an unencumbered estate in fee simple in the land if there is an unbroken chain of title starting at least 30 years before the day of sale proving on the face of the documents the ownership of the entire legal and equitable estate without the aid of other evidence.
- 9.3 The purchaser is entitled to inspect the vendor's chain of title on request at such place in Victoria as the vendor nominates.
- 9.4 The purchaser is taken to have accepted the vendor's title if:
- (a) 21 days have elapsed since the day of sale; and
 - (b) the purchaser has not reasonably objected to the title or reasonably required the vendor to remedy a defect in the title.
- 9.5 The contract will be at an end if:
- (a) the vendor gives the purchaser a notice that the vendor is unable or unwilling to satisfy the purchaser's objection or requirement and that the contract will end if the objection or requirement is not withdrawn within 14 days of the giving of the notice; and
 - (b) the objection or requirement is not withdrawn in that time.
- 9.6 If the contract ends in accordance with general condition 9.5, the deposit must be returned to the purchaser and neither party has a claim against the other in damages.
- 9.7 General condition 10.1 should be read, in respect of that part of the land which is not under the operation of the *Transfer of Land Act 1958*, as if the reference to 'registered proprietor' is a reference to 'owner'.

Money

10. SETTLEMENT

- 10.1 At settlement:
- (a) the purchaser must pay the balance; and
 - (b) the vendor must:
 - (i) do all things necessary to enable the purchaser to become the registered proprietor of the land; and

- (ii) give either vacant possession or receipt of rents and profits in accordance with the particulars of sale.
- 10.2 The vendor's obligations under this general condition continue after settlement.
- 10.3 Settlement must be conducted between the hours of 10.00 a.m. and 4.00 p.m. unless the parties agree otherwise.

11. PAYMENT

- 11.1 The purchaser must pay the deposit:
 - (a) to the vendor's licensed estate agent; or
 - (b) if there is no estate agent, to the vendor's legal practitioner or conveyancer; or
 - (c) if the vendor directs, into a special purpose account in an authorised deposit-taking institution in Victoria specified by the vendor in the joint names of the purchaser and the vendor.
- 11.2 If the land is sold on an unregistered plan of subdivision, the deposit:
 - (a) must not exceed 10% of the price; and
 - (b) must be paid to the vendor's estate agent, legal practitioner or conveyancer and held by the estate agent, legal practitioner or conveyancer on trust for the purchaser until registration of the plan of subdivision.
- 11.3 The purchaser must pay all money other than the deposit:
 - (a) to the vendor, or the vendor's legal practitioner or conveyancer; or
 - (b) in accordance with a written direction of the vendor or the vendor's legal practitioner or conveyancer.
- 11.4 At settlement, payments may be made or tendered:
 - (a) in cash; or
 - (b) by cheque drawn on an authorised deposit-taking institution; or
 - (c) if the parties agree, by electronically transferring the payment in the form of cleared funds.
- 11.5 For the purpose of this general condition 'authorised deposit-taking institution' means a body corporate in relation to which an authority under section 9(3) of the *Banking Act 1959 (Cth)* is in force.
- 11.6 At settlement, the purchaser must pay the fees on up to three cheques drawn on authorised deposit-taking institution. If the vendor requests than any additional cheques be drawn on an authorised deposit-taking institution, the vendor must reimburse the purchaser for the fees incurred.

12. STAKEHOLDING

- 12.1 The deposit must be released to the vendor if:
 - (a) the vendor provides particulars, to the satisfaction of the purchaser, that either -
 - (i) there are no debts secured against the property; or
 - (ii) if there are any debts, the total amount of those debts does not exceed 80% of the sale price; and
 - (b) at least 28 days have elapsed since the particulars were given to the purchaser under paragraph (a); and
 - (c) all conditions of section 27 of the *Sale of Land Act 1962* have been satisfied.
- 12.2 The stakeholder must pay the deposit and any interest to the party entitled when the deposit is released, the contract is settled, or the contract is ended.
- 12.3 The stakeholder may pay the deposit and any interest into court if it is reasonable to do so.

13. GST

- 13.1 The purchaser does not have to pay the vendor any GST payable by the vendor in respect of a taxable supply made under this contract in addition to the price unless the particulars of sale specify that the price is 'plus GST'. However the purchaser must pay to the vendor any GST payable by the vendor:
 - (a) solely as a result of any action taken or intended to be taken by the purchaser after the day of sale, including a change of use; or
 - (b) if the particulars of sale specify that the supply made under this contract is of land on which a 'farming business' is carried on and the supply (or a part of it) does not satisfy the requirements of section 38-480 of the GST Act; or
 - (c) if the particulars of sale specify that the supply made under this contract is of a going concern and the supply (or a part of it) does not satisfy the requirements of section 38-325 of the GST Act.
- 13.2 The purchaser must pay to the vendor any GST payable by the vendor in respect of a taxable supply made under this contract in addition to the price if the particulars of sale specify that the price is 'plus GST'.
- 13.3 If the purchaser is liable to pay GST, the purchaser is not required to make payment until provided with a tax invoice, unless the margin scheme applies.
- 13.4 If the particulars of sale specify that the supply made under this contract is of land on which a 'farming business' is carried on:

- (a) the vendor warrants that the property is land on which a farming business has been carried on for the period of 5 years preceding the date of supply; and
 - (b) the purchaser warrants that the purchaser intends that a farming business will be carried on after settlement on the property.
- 13.5 If the particulars of sale specify that the supply made under this contract is a 'going concern':
- (a) the parties agree that this contract is for the supply of a going concern; and
 - (b) the purchaser warrants that the purchaser is, or prior to settlement will be, registered for GST; and
 - (c) the vendor warrants that the vendor will carry on the going concern until the date of supply.
- 13.6 If the particulars of sale specify that the supply made under this contract is a 'margin scheme' supply, the parties agree that the margin scheme applies to this contract.
- 13.7 This general condition will not merge on either settlement or registration.
- 13.8 In this general condition:
- (a) 'GST Act' means *A New Tax System (Goods and Services Tax) Act 1999 (Cth)*; and
 - (b) 'GST' includes penalties and interest.

14. LOAN

- 14.1 If the particulars of sale specify that this contract is subject to a loan being approved, this contract is subject to the lender approving the loan on the security of the property by the approval date or any later date allowed by the vendor.
- 14.2 The purchaser may end the contract if the loan is not approved by the approval date, but only if the purchaser:
- (a) immediately applied for the loan; and
 - (b) did everything reasonably required to obtain approval of the loan; and
 - (c) serves written notice ending the contract on the vendor within 2 clear business days after the approval date or any later date allowed by the vendor; and
 - (d) is not in default under any other condition of this contract when the notice is given.
- 14.3 All money must be immediately refunded to the purchaser if the contract is ended.

15. ADJUSTMENTS

- 15.1 All periodic outgoings payable by the vendor, and any rent and other income received in respect of the property must be apportioned between the parties on the settlement date and any adjustment paid and received as appropriate.
- 15.2 The periodic outgoings and rent and other income must be apportioned on the following basis:
- (a) the vendor is liable for the periodic outgoings and entitled to the rent and other income up to and including the day of settlement; and
 - (b) the land is treated as the only land of which the vendor is owner (as defined in the *Land Tax Act 2005*); and
 - (c) the vendor is taken to own the land as a resident Australian beneficial owner; and
 - (d) any personal statutory benefit available to each party is disregarded in calculating apportionment.

Transactional

16. TIME

- 16.1 Time is of the essence of this contract.
- 16.2 Time is extended until the next business day if the time for performing any action falls on a Saturday, Sunday or bank holiday.

17. SERVICE

- 17.1 Any document sent by –
- (a) post is taken to have been served on the next business day after posting, unless proved otherwise;
 - (b) email is taken to have been served at the time of receipt within the meaning of section 13A of the *Electronic Transactions (Victoria) Act 2000*.
- 17.2 Any demand, notice, or document required to be served by or on any party may be served by or on the legal practitioner or conveyancer for that party. It is sufficiently served if served on the party or on the legal practitioner or conveyancer:
- (a) personally; or
 - (b) by pre-paid post; or
 - (c) in any manner authorised by law or the Supreme Court for service of documents, including any manner authorised for service on or by a legal practitioner; or

(d) by email.

17.3 This general condition applies to the service of any demand, notice or document by or on any party, whether the expression 'give' or 'serve' or any other expression is used.

18. NOMINEE

The purchaser may nominate a substitute or additional transferee, but the named purchaser remains personally liable for the due performance of all the purchaser's obligations under this contract.

19. LIABILITY OF SIGNATORY

Any signatory for a proprietary limited company purchaser is personally liable for the due performance of the purchaser's obligations as if the signatory were the purchaser in the case of a default by a proprietary limited company purchaser.

20. GUARANTEE

The vendor may require one or more directors of the purchaser to guarantee the purchaser's performance of this contract if the purchaser is a proprietary limited company.

21. NOTICES

The purchaser is responsible for any notice, order, demand or levy imposing liability on the property that is issued or made on or after the day of sale that does not relate to periodic outgoings. The purchaser may enter the property to comply with that responsibility where action is required before settlement.

22. INSPECTION

The purchaser and/or another person authorised by the purchaser may inspect the property at any reasonable time during the 7 days preceding and including the settlement day.

23. TERMS CONTRACT

23.1 If this is a 'terms contract' as defined in the *Sale of Land Act 1962*:

- (a) any mortgage affecting the land sold must be discharged as to that land before the purchaser becomes entitled to possession or to the receipt of rents and profits unless the vendor satisfies section 29M of the *Sale of Land Act 1962*; and
- (b) the deposit and all other money payable under the contract (other than any money payable in excess of the amount required to so discharge the mortgage) must be paid to a legal practitioner or conveyancer or a licensed estate agent to be applied in or towards discharging the mortgage.

23.2 While any money remains owing each of the following applies:

- (a) the purchaser must maintain full damage and destruction insurance of the property and public risk insurance noting all parties having an insurable interest with an insurer approved in writing by the vendor;
- (b) the purchaser must deliver copies of the signed insurance application forms, the policies and the insurance receipts to the vendor not less than 10 days before taking possession of the property or becoming entitled to receipt of the rents and profits;
- (c) the purchaser must deliver copies of any amendments to the policies and the insurance receipts on each amendment or renewal as evidence of the status of the policies from time to time;
- (d) the vendor may pay any renewal premiums or take out the insurance if the purchaser fails to meet these obligations;
- (e) insurance costs paid by the vendor under paragraph (d) must be refunded by the purchaser on demand without affecting the vendor's other rights under this contract;
- (f) the purchaser must maintain and operate the property in good repair (fair wear and tear excepted) and keep the property safe, lawful, structurally sound, weatherproof and free from contaminations and dangerous substances;
- (g) the property must not be altered in any way without the written consent of the vendor which must not be unreasonably refused or delayed;
- (h) the purchaser must observe all obligations that affect owners or occupiers of land;
- (i) the vendor and/or other person authorised by the vendor may enter the property at any reasonable time to inspect it on giving 7 days written notice, but not more than twice in a year.

24. LOSS OR DAMAGE BEFORE SETTLEMENT

24.1 The vendor carries the risk of loss or damage to the property until settlement.

24.2 The vendor must deliver the property to the purchaser at settlement in the same condition it was in on the day of sale, except for fair wear and tear.

24.3 The purchaser must not delay settlement because one or more of the goods is not in the condition required by general condition 24.2, but may claim compensation from the vendor after settlement.

24.4 The purchaser may nominate an amount not exceeding \$5,000 to be held by a stakeholder to be appointed by the parties if the property is not in the condition required by general condition 24.2 at settlement.

- 24.5 The nominated amount may be deducted from the amount due to the vendor at settlement and paid to the stakeholder, but only if the purchaser also pays an amount equal to the nominated amount to the stakeholder.
- 24.6 The stakeholder must pay the amounts referred to in general condition 24.5 in accordance with the determination of the dispute, including any order for payment of the costs of the resolution of the dispute.

25. BREACH

A party who breaches this contract must pay to the other party on demand:

- (a) compensation for any reasonably foreseeable loss to the other party resulting from the breach; and
- (b) any interest due under this contract as a result of the breach.

Default

26. INTEREST

Interest at a rate of 2% per annum plus the rate for the time being fixed by section 2 of the *Penalty Interest Rates Act 1983* is payable on any money owing under the contract during the period of default, without affecting any other rights of the offended party.

27. DEFAULT NOTICE

- 27.1 A party is not entitled to exercise any rights arising from the other party's default, other than the right to receive interest and the right to sue for money owing, until the other party is given and fails to comply with a written default notice.
- 27.2 The default notice must:
- (a) specify the particulars of the default; and
 - (b) state that it is the offended party's intention to exercise the rights arising from the default unless, within 14 days of the notice being given-
 - (i) the default is remedied; and
 - (ii) the reasonable costs incurred as a result of the default and any interest payable are paid.

28. DEFAULT NOT REMEDIED

- 28.1 All unpaid money under the contract becomes immediately payable to the vendor if the default has been made by the purchaser and is not remedied and the costs and interest are not paid.
- 28.2 The contract immediately ends if:
- (a) the default notice also states that unless the default is remedied and the reasonable costs and interest are paid, the contract will be ended in accordance with this general condition; and
 - (b) the default is not remedied and the reasonable costs and interest are not paid by the end of the period of the default notice.
- 28.3 If the contract ends by a default notice given by the purchaser:
- (a) the purchaser must be repaid any money paid under the contract and be paid any interest and reasonable costs payable under the contract; and
 - (b) all those amounts are a charge on the land until payment; and
 - (c) the purchaser may also recover any loss otherwise recoverable.
- 28.4 If the contract ends by a default notice given by the vendor:
- (a) the deposit up to 10% of the price is forfeited to the vendor as the vendor's absolute property, whether the deposit has been paid or not; and
 - (b) the vendor is entitled to possession of the property; and
 - (c) in addition to any other remedy, the vendor may within one year of the contract ending either:
 - (i) retain the property and sue for damages for breach of contract; or
 - (ii) resell the property in any manner and recover any deficiency in the price on the resale and any resulting expenses by way of liquidated damages; and
 - (d) the vendor may retain any part of the price paid until the vendor's damages have been determined and may apply that money towards those damages; and
 - (e) any determination of the vendor's damages must take into account the amount forfeited to the vendor.
- 28.5 The ending of the contract does not affect the rights of the offended party as a consequence of the default.

DATED

2025

ANASTASI LOUIS IOANNIDIS AND ANDREA IOANNIDIS

to

CONTRACT OF SALE OF REAL ESTATE

Property: 20 Leicester Street, Balwyn North 3104

NOBLE HOUSE LAWYERS

Lawyers

Chadstone Tower 1
Level 8, 1341 Dandenong
Chadstone Vic 3148

Tel: 03 9544 2076

Fax: 03 9543 8729

Ref: NA:20230100

Vendor Statement

The vendor makes this statement in respect of the land in accordance with section 32 of the *Sale of Land Act* 1962.

This statement must be signed by the vendor and given to the purchaser before the purchaser signs the contract.

The vendor may sign by electronic signature.

The purchaser acknowledges being given this statement signed by the vendor with the attached documents before the purchaser signed any contract.

Land	20 Leicester Street, Balwyn North 3104	
Vendor's name	Anastasi Louis Ioannidis	Date / /
Vendor's signature		
Vendor's name	Andrea Ioannidis	Date / /
Vendor's signature		
Purchaser's name		Date / /
Purchaser's signature		
Purchaser's name		Date / /
Purchaser's signature		

1.

1. FINANCIAL MATTERS

1.1 Particulars of any Rates, Taxes, Charges or Other Similar Outgoings (and any interest on them)

(a) Are contained in the attached certificate/s.

1.2 Particulars of any Charge (whether registered or not) imposed by or under any Act to secure an amount due under that Act, including the amount owing under the charge

	To	
--	----	--

Other particulars (including dates and times of payments):
--

1.3 Terms Contract

This section 1.3 only applies if this vendor statement is in respect of a terms contract where the purchaser is obliged to make 2 or more payments (other than a deposit or final payment) to the vendor after the execution of the contract and before the purchaser is entitled to a conveyance or transfer of the land.

Not Applicable.

1.4 Sale Subject to Mortgage

This section 1.4 only applies if this vendor statement is in respect of a contract which provides that any mortgage (whether registered or unregistered), is NOT to be discharged before the purchaser becomes entitled to possession or receipts of rents and profits.

Not Applicable.

2. INSURANCE

2.1 Damage and Destruction

This section 2.1 only applies if this vendor statement is in respect of a contract which does NOT provide for the land to remain at the risk of the vendor until the purchaser becomes entitled to possession or receipt of rents and profits.

Not Applicable.

2.2 Owner Builder

This section 2.2 only applies where there is a residence on the land that was constructed by an owner-builder within the preceding 6 years and section 137B of the *Building Act* 1993 applies to the residence.

Not Applicable.

3. LAND USE

3.1 Easements, Covenants or Other Similar Restrictions

(a) A description of any easement, covenant or other similar restriction affecting the land (whether registered or unregistered): -

Not Applicable.

3.2 Road Access

There is NO access to the property by road if the square box is marked with an 'X'

3.3 Designated Bushfire Prone Area

The land is in a designated bushfire prone area under section 192A of the *Building Act* 1993 if the square box is marked with an 'X'

3.4 **Planning Scheme**

Attached is a certificate with the required specified information.

4. **NOTICES**

4.1 **Notice, Order, Declaration, Report or Recommendation**

Particulars of any notice, order, declaration, report or recommendation of a public authority or government department or approved proposal directly and currently affecting the land, being a notice, order, declaration, report, recommendation or approved proposal of which the vendor might reasonably be expected to have knowledge:

Not Applicable.

4.2 **Agricultural Chemicals**

There are NO notices, property management plans, reports or orders in respect of the land issued by a government department or public authority in relation to livestock disease or contamination by agricultural chemicals affecting the ongoing use of the land for agricultural purposes. However, if this is not the case, the details of any such notices, property management plans, reports or orders, are as follows:

Nil.

4.3 **Compulsory Acquisition**

The particulars of any notices of intention to acquire that have been served under section 6 of the *Land Acquisition and Compensation Act 1986* are as follows:

Nil.

5. **BUILDING PERMITS**

Particulars of any building permit issued under the *Building Act 1993* in the preceding 7 years (required only where there is a residence on the land):

Not Applicable.

6. **OWNERS CORPORATION**

This section 6 only applies if the land is affected by an owners corporation within the meaning of the *Owners Corporations Act 2006*.

Not Applicable.

7. **GROWTH AREAS INFRASTRUCTURE CONTRIBUTION (“GAIC”)**

Not applicable.

8. **SERVICES**

The services which are marked with an ‘X’ in the accompanying square box are NOT connected to the land:

Electricity supply <input type="checkbox"/>	Gas supply <input type="checkbox"/>	Water supply <input type="checkbox"/>	Sewerage <input type="checkbox"/>	Telephone services <input type="checkbox"/>
---	-------------------------------------	---------------------------------------	-----------------------------------	---

9. **TITLE**

Attached are copies of the following documents:

9.1 (a) **Registered Title**

9.2 A Register Search Statement and the document, or part of a document, referred to as the 'diagram location' in that statement which identifies the land and its location.

10. **SUBDIVISION**

10.1 **Unregistered Subdivision**

This section 10.1 only applies if the land is subject to a subdivision which is not registered.

Not Applicable.

10.2 Staged Subdivision

This section 10.2 only applies if the land is part of a staged subdivision within the meaning of section 37 of the *Subdivision Act 1988*.

Not Applicable.

10.3 Further Plan of Subdivision

This section 10.3 only applies if the land is subject to a subdivision in respect of which a further plan within the meaning of the *Subdivision Act 1988* is proposed.

Not Applicable.

11. DISCLOSURE OF ENERGY INFORMATION

(Disclosure of this information is not required under section 32 of the Sale of Land Act 1962 but may be included in this vendor statement for convenience.)

Details of any energy efficiency information required to be disclosed regarding a disclosure affected building or disclosure area affected area of a building as defined by the *Building Energy Efficiency Disclosure Act 2010* (Cth)

- (a) to be a building or part of a building used or capable of being used as an office for administrative, clerical, professional or similar based activities including any support facilities; and
- (b) which has a net lettable area of at least 1000m²; (but does not include a building under a strata title system or if an occupancy permit was issued less than 2 years before the relevant date):

Not Applicable.

12. DUE DILIGENCE CHECKLIST

(The Sale of Land Act 1962 provides that the vendor or the vendor's licensed estate agent must make a prescribed due diligence checklist available to purchasers before offering land for sale that is vacant residential land or land on which there is a residence. The due diligence checklist is NOT required to be provided with, or attached to, this vendor statement but the checklist may be attached as a matter of convenience.)

- Vacant Residential Land or Land with a Residence
- Attach Due Diligence Checklist (this will be attached if ticked)

13. ATTACHMENTS

(Any certificates, documents and other attachments may be annexed to this section 13)

(Additional information may be added to this section 13 where there is insufficient space in any of the earlier sections)

(Attached is an "Additional Vendor Statement" if section 1.3 (Terms Contract) or section 1.4 (Sale Subject to Mortgage) applies)

**REGISTER SEARCH STATEMENT (Title Search) Transfer of
Land Act 1958**

Page 1 of 1

VOLUME 12012 FOLIO 728

Security no : 124123662476T
Produced 14/04/2025 09:57 AM

LAND DESCRIPTION

Lot 1 on Plan of Subdivision 805838C.
PARENT TITLE Volume 08099 Folio 047
Created by instrument PS805838C 03/09/2018

REGISTERED PROPRIETOR

Estate Fee Simple
Joint Proprietors
ANASTASI LOUIS IOANNIDIS
ANDREA IOANNIDIS both of 20 LEICESTER STREET BALWYN NORTH VIC 3104
AT674335T 08/10/2020

ENCUMBRANCES, CAVEATS AND NOTICES

MORTGAGE AT674336R 08/10/2020
CREDIT UNION AUSTRALIA LTD

Any encumbrances created by Section 98 Transfer of Land Act 1958 or Section 24 Subdivision Act 1988 and any other encumbrances shown or entered on the plan set out under DIAGRAM LOCATION below.

DIAGRAM LOCATION

SEE PS805838C FOR FURTHER DETAILS AND BOUNDARIES

ACTIVITY IN THE LAST 125 DAYS

NIL

-----END OF REGISTER SEARCH STATEMENT-----

Additional information: (not part of the Register Search Statement)

Street Address: 20 LEICESTER STREET BALWYN NORTH VIC 3104

ADMINISTRATIVE NOTICES

NIL

eCT Control 17759N GREAT SOUTHERN BANK
Effective from 08/10/2020

DOCUMENT END

Imaged Document Cover Sheet

The document following this cover sheet is an imaged document supplied by LANDATA®, Secure Electronic Registries Victoria.

Document Type	Plan
Document Identification	PS805838C
Number of Pages (excluding this cover sheet)	2
Document Assembled	14/04/2025 09:57

Copyright and disclaimer notice:

© State of Victoria. This publication is copyright. No part may be reproduced by any process except in accordance with the provisions of the Copyright Act 1968 (Cth) and for the purposes of Section 32 of the Sale of Land Act 1962 or pursuant to a written agreement. The information is only valid at the time and in the form obtained from the LANDATA® System. None of the State of Victoria, LANDATA®, Secure Electronic Registries Victoria Pty Ltd (ABN 86 627 986 396) as trustee for the Secure Electronic Registries Victoria Trust (ABN 83 206 746 897) accept responsibility for any subsequent release, publication or reproduction of the information.

The document is invalid if this cover sheet is removed or altered.

PLAN OF SUBDIVISION		EDITION 1	PS805838C	
<p>LOCATION OF LAND</p> <p>PARISH: BOROONDARA</p> <p>TOWNSHIP:</p> <p>SECTION:</p> <p>PART OF ELGARS CROWN SPECIAL SURVEY</p> <p>CROWN PORTION:</p> <p>TITLE REFERENCE: VOL8099 FOL047</p> <p>LAST PLAN REFERENCE: LOT 1 ON LP18061</p> <p>POSTAL ADDRESS: 20 LEICESTER STREET (at time of subdivision) BALWYN NORTH VIC 3104</p> <p>MGA CO-ORDINATES: E: 332949 ZONE: 55 (of approx centre of land N: 5815715 GDA 94 in plan)</p>		<p>Council Name: Boroondara City Council</p> <p>Council Reference Number: Subcer16/00246 Planning Permit Reference: PP16/01219 SPEAR Reference Number: S094532E</p> <p>Certification</p> <p>This plan is certified under section 6 of the Subdivision Act 1988</p> <p>Public Open Space</p> <p>A requirement for public open space under section 18 of the Subdivision Act 1988 has not been made</p> <p>Digitally signed by: Roxanne Marie Kavanagh for Boroondara City Council on 10/02/2017</p> <p>Statement Of Compliance issued: 20/06/2018</p>		
VESTING OF ROADS AND/OR RESERVES		NOTATIONS		
IDENTIFIER	COUNCIL/BODY/PERSON			
NIL	NIL			
NOTATIONS		<p>Boundaries shown by thick continuous lines are defined by buildings</p> <p>Location of boundaries defined by buildings</p> <p>Exterior: All boundaries</p>		
DEPTH LIMITATION NIL				
<p>SURVEY: This plan is based on survey.</p> <p>STAGING: This is not a staged subdivision.</p>				
EASEMENT INFORMATION				
LEGEND: A - Appurtenant Easement E - Encumbering Easement R - Encumbering Easement (Road)				
EASEMENTS AND RIGHTS IMPLIED UNDER SECTION 12(2) OF THE SUBDIVISION ACT 1988 APPLY TO THE WHOLE OF THE LAND IN THIS PLAN				
Easement Reference	Purpose	Width (Metres)	Origin	Land Benefited/In Favour Of
E-1	OVERHANGING EAVES	0.70	THIS PLAN	LOT 2 ON THIS PLAN
 <p>MAC SURVEYING + MAPPING PO BOX 2481 FITZROY VIC 3065 • M 0422 372 054 • T 03 9419 2561 F 03 9419 8424</p>		<p>SURVEYORS FILE REF: 10-123</p> <p>Digitally signed by: Murray Clayton (MAC Surveying & Mapping), Surveyor's Plan Version (B), 08/02/2017, SPEAR Ref: S094532E</p>	<p>ORIGINAL SHEET SIZE: A3</p> <p>PLAN REGISTERED TIME: 3.49pm DATE: 3 / 9 / 2018 Heath Richards Assistant Registrar of Titles</p>	<p>SHEET 1 OF 2</p>

PS805838C

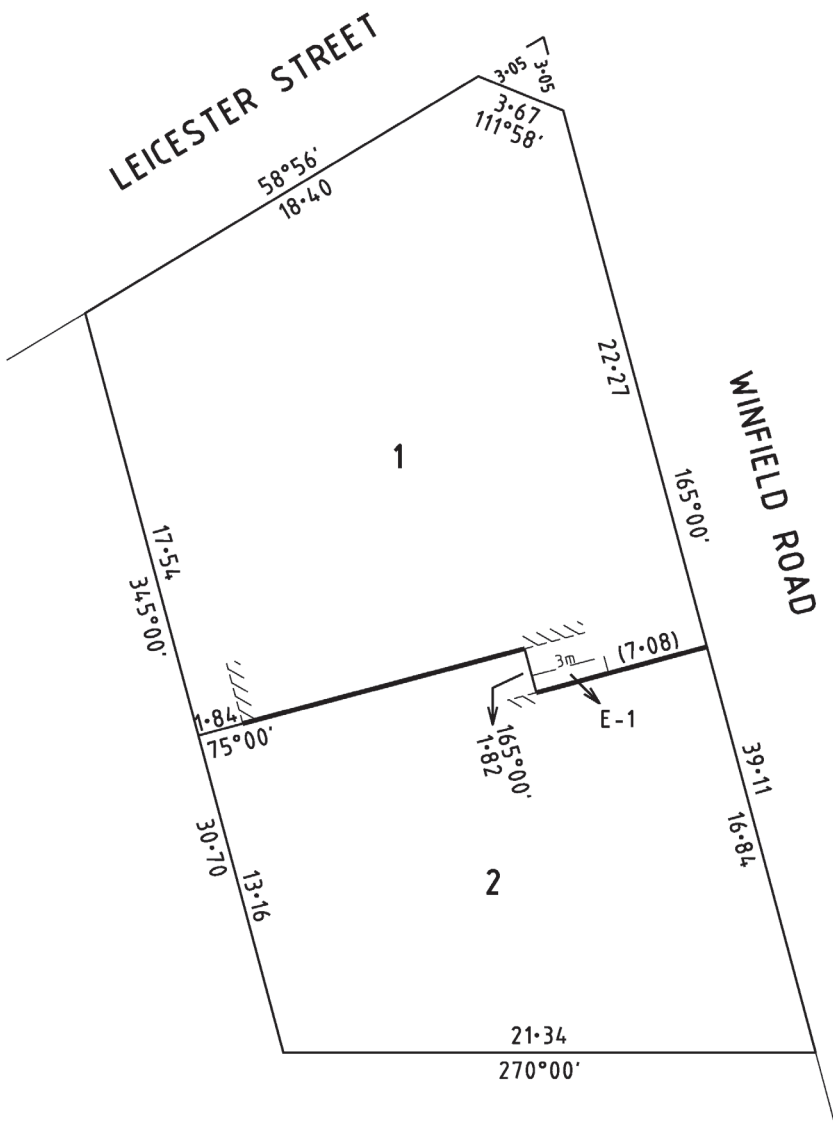

LAND INFORMATION CERTIFICATE

Section 229 of the Local Government Act 1989

Applicant:

Secure Electronic Registries Victoria Pty Ltd
Two Melbourne Quarter
Level 13, 697 Collins Street
DOCKLANDS VIC 3008

Issue Date: **14/04/2025**Your Reference: **357010**Certificate No: **wLIC67593**Property No.: **701040**

This Certificate provides information regarding valuation, rates, charges, other monies owing and any orders and notices made under the Local Government Act 1958, Local Government Act 1989, Local Government Act 2020 or under local law or by-law of the Council, and specified flood level by Council (if any). This Certificate is not required to include information regarding planning, building, health, landfill, land slip, other flooding information or service easements. Information regarding these matters may be available from the Council or relevant authority. A fee may be charged for such information.

Property Location:

20 Leicester Street BALWYN NORTH VIC 3104

Property Description:

Lot 1 PS 805838C Vol 12012 Fol 728Site Value: **975000**Capital Improved Value: **1750000**Net Annual Value: **87500**Level of Value Date: **1/01/2024**Effective Date of Valuation: **1/07/2024**

Rates are levied on the Capital Improved Value.

RATES, CHARGES AND OTHER MONIES

Rates for the year ending 30th June 2025

Details of Rates, Charges, Outstanding Notices and Works for which a charge has been made:

Total Arrears	\$4,921.28
Current Year's Rates & Charges	
General Rates & Charges	\$2,789.55
Fire Services Property Levy	\$284.25
Payment/Adjustments	\$3,500.00-
Current Balance	\$4,495.08

IMPORTANT INFORMATION, if applicable

LAND INFORMATION CERTIFICATE (Cont.)

Property Address: **20 Leicester Street BALWYN NORTH VIC 3104**

Property No.: **701040**

Certificate No.: **wLIC67593**

ADDITIONAL INFORMATION

Street Information

Properties abutting unmade streets may be liable for street construction charges should a private street construction scheme be implemented.

Flood Level Information

Other (If Applicable)

Boroondara values its heritage. Council has a Community Heritage Nomination Process which means that sites may be under investigation for heritage protection (where they do not already have formal Heritage Protection under the Planning Scheme). Sites can be nominated at any time. For further information visit Boroondara's website at <https://www.boroondara.vic.gov.au/planning-building/planning-and-heritage/heritage/nominate-heritage-place>. Alternatively, contact Council's Principal Heritage Planner on (03) 9278 4444 or email Strategic.Planning@boroondara.vic.gov.au.

Important Notes:

1. This certificate may be updated verbally by calling the Revenue and Property Services team on 9278 4325 within a period of **THREE MONTHS** from date of issue. It should be noted that Council would only be held responsible for information given in writing i.e. a new certificate and not information provided or confirmed verbally.
2. Payments not made by the due dates are subject to penalty interest. Interest will continue to accrue at the rate fixed under Section 2 of the Penalty Interest Rates Act 1983 until such time as payment of outstanding rates and charges is made.
3. Payments shown are subject to clearance by the bank.
4. Date for declaring council rates and charges for **01/07/2024 to 30/06/2025 on 24/06/2024**.
5. In accordance with Section 175 of the Local Government Act 1989, after settlement any rates or charges (including interest) that are unpaid are the responsibility of the new owner and are due and payable:
 - Instalments due by: **30/09/2024; 30/11/2024; 28/02/2025; 31/5/2025**. Full payment due by: **15/02/2024**.
 - If in arrears: **Immediately**
 - Please confirm correct amount from Council just prior to settlement especially around due dates or if the account is in arrears.

	Bill Code: 93633 Ref: 07403603
Telephone & Internet Banking – BPAY® Contact your bank or financial institution to make this payment from your cheque, savings, debit, credit card or transaction account. More info: www.bpay.com.au	

For further information, please contact Council's Revenue & Property Services on ☎ (03) 9278 4325

Receipt for the sum of \$29.70 being the fee for this certificate is acknowledged.

I hereby certify at the date of this certificate the information supplied is true and correct for the property described in this certificate.



Michael Hutchison
Head of Strategic Property and Revenue

Camberwell office 8 Inglesby Road Camberwell VIC T 9278 4444 F 9278 4466
Postal address Private Bag 1, Camberwell VIC 3124
Email boroondara@boroondara.vic.gov.au
Website www.boroondara.vic.gov.au

14th April 2025

Madison Branson Lawyers C/- InfoTrack (Smokeball)
LANDATA

Dear Madison Branson Lawyers C/- InfoTrack (Smokeball) ,

RE: Application for Water Information Statement

Property Address:	20 LEICESTER STREET BALWYN NORTH 3104
Applicant	Madison Branson Lawyers C/- InfoTrack (Smokeball) LANDATA
Information Statement	30933086
Conveyancing Account Number	7959580000
Your Reference	357010

Thank you for your recent application for a Water Information Statement (WIS). We are pleased to provide you the WIS for the above property address. This statement includes:

- Yarra Valley Water Property Information Statement
- Melbourne Water Property Information Statement
- Asset Plan
- Rates Certificate

If you have any questions about Yarra Valley Water information provided, please phone us on **1300 304 688** or email us at the address propertyflow@yvw.com.au. For further information you can also refer to the Yarra Valley Water website at www.yvw.com.au.

Yours sincerely,



Lisa Anelli
GENERAL MANAGER
RETAIL SERVICES

Yarra Valley Water Property Information Statement

Property Address	20 LEICESTER STREET BALWYN NORTH 3104
------------------	---------------------------------------

STATEMENT UNDER SECTION 158 WATER ACT 1989

THE FOLLOWING INFORMATION RELATES TO SECTION 158(3)

Existing sewer mains will be shown on the Asset Plan.

Please note: Unless prior consent has been obtained, the Water Act prohibits:

1. The erection and/or placement of any building, wall, bridge, fence, embankment, filling, material, machinery or other structure over or under any sewer or drain.
2. The connection of any drain or sewer to, or interference with, any sewer, drain or watercourse.

Melbourne Water Property Information Statement

Property Address	20 LEICESTER STREET BALWYN NORTH 3104
------------------	---------------------------------------

STATEMENT UNDER SECTION 158 WATER ACT 1989

THE FOLLOWING INFORMATION RELATES TO SECTION 158(4)

Information available at Melbourne Water indicates that this property is not subject to flooding from Melbourne Water's drainage system, based on a flood level that has a probability of occurrence of 1% in any one year.

Please note: Unless prior consent has been obtained, the Water Act prohibits:

1. The erection and/or placement of any building, wall, bridge, fence, embankment, filling, material, machinery or other structure over or under any sewer or drain.
2. The connection of any drain or sewer to, or interference with, any sewer, drain or watercourse.

If you have any questions regarding Melbourne Water encumbrances or advisory information, please contact Melbourne Water on 9679 7517.

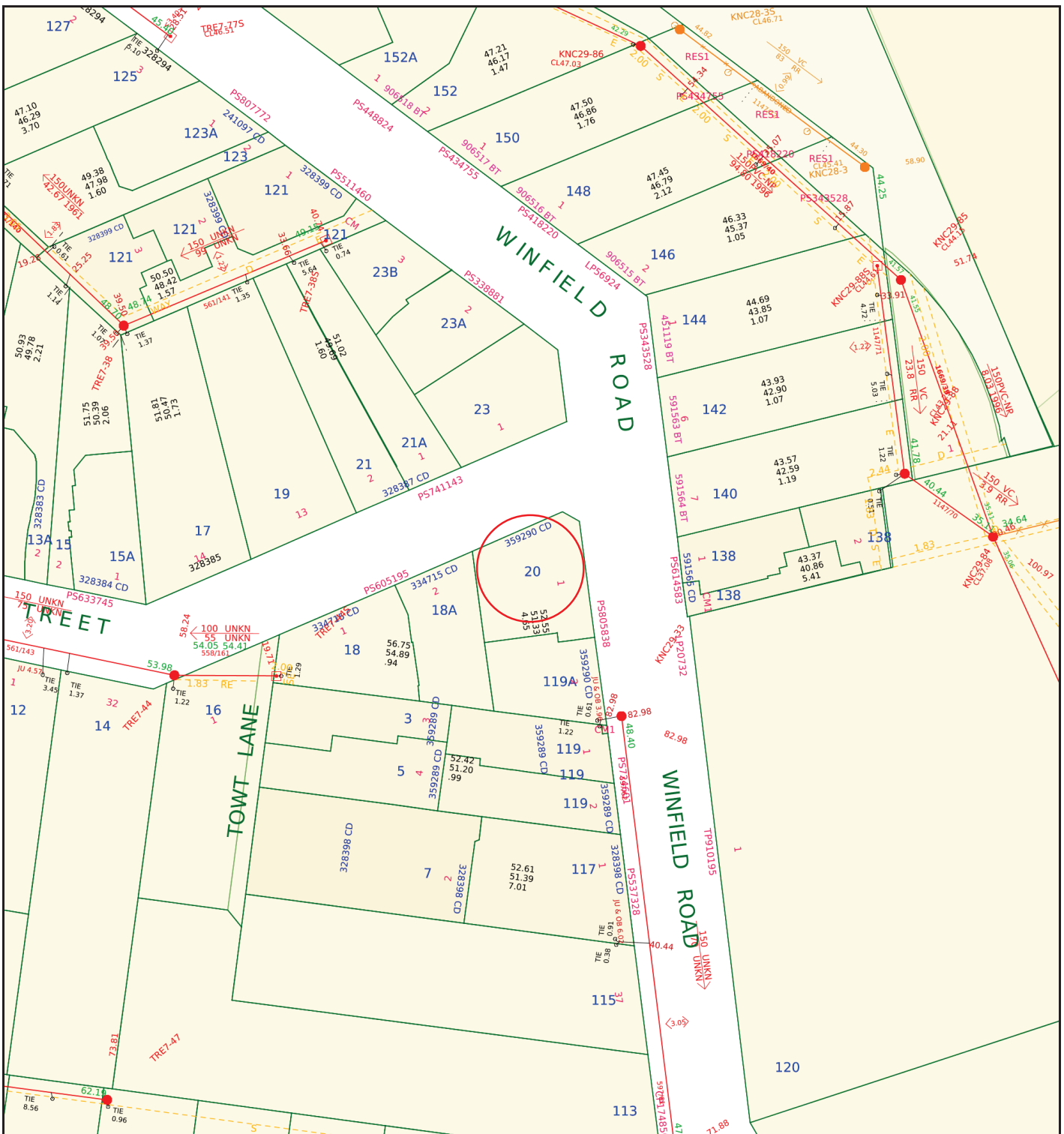













Yarra Valley Water Information Statement Number: 30933086

Address	20 LEICESTER STREET BALWYN NORTH 3104
Date	14/04/2025
Scale	1:1000



**Yarra
Valley
Water**

ABN 93 066 902 501

Existing Title	 Access Point Number	GLV2-42 MW Drainage Channel Centreline	
Proposed Title	 Sewer Manhole	 MW Drainage Underground Centreline	
Easement	 Sewer Pipe Flow	 MW Drainage Manhole	
Existing Sewer	 Sewer Offset	 MW Drainage Natural Waterway	
Abandoned Sewer	 Sewer Branch		

Disclaimer: This information is supplied on the basis Yarra Valley Water Ltd:
 - Does not warrant the accuracy or completeness of the information supplied, including, without limitation, the location of Water and Sewer Assets;
 - Does not accept any liability for loss or damage of any nature, suffered or incurred by the recipient or any other persons relying on this information;
 - Recommends recipients and other persons using this information make their own site investigations and accommodate their works accordingly;



YARRA VALLEY WATER
ABN 93 066 902 501

Lucknow Street
Mitcham Victoria 3132

Private Bag 1
Mitcham Victoria 3132

DX 13204

F (03) 9872 1353

E enquiry@yvw.com.au
yvw.com.au

Madison Branson Lawyers C/- InfoTrack (Smokeball)
LANDATA
certificates@landata.vic.gov.au

RATES CERTIFICATE

Account No: 5633633555
Rate Certificate No: 30933086

Date of Issue: 14/04/2025
Your Ref: 357010

With reference to your request for details regarding:

Property Address	Lot & Plan	Property Number	Property Type
20 LEICESTER ST, BALWYN NORTH VIC 3104	1\PS805838	5076201	Residential

Agreement Type	Period	Charges	Outstanding
Residential Water Service Charge	01-04-2025 to 30-06-2025	\$20.64	\$20.64
Residential Water and Sewer Usage Charge <i>Step 1 – 31.000000kL x \$3.43420000 = \$106.46</i> Estimated Average Daily Usage \$1.21	10-01-2025 to 08-04-2025	\$106.46	\$106.46
Residential Sewer Service Charge	01-04-2025 to 30-06-2025	\$118.19	\$118.19
Parks Fee	01-04-2025 to 30-06-2025	\$21.74	\$21.74
Drainage Fee	01-04-2025 to 30-06-2025	\$30.44	\$30.44
Other Charges:			
Interest	No interest applicable at this time		
No further charges applicable to this property			
Balance Brought Forward			\$0.00
Total for This Property			\$297.47

GENERAL MANAGER
RETAIL SERVICES

Note:

- From 1 July 2023, the Parks Fee has been charged quarterly instead of annually.
- From 1 July 2023, for properties that have water and sewer services, the Residential Water and Sewer Usage charge replaces the Residential Water Usage and Residential Sewer Usage charges.
- This statement details all tariffs, charges, and penalties due and payable to Yarra Valley Water as of the date of this statement and includes tariffs and charges (other than for usage charges yet to be billed) which are due and payable to the end of the current financial quarter.
- All outstanding debts are due to be paid to Yarra Valley Water at settlement. Any debts that are unpaid at

settlement will carry over onto the purchaser's first quarterly account and follow normal credit and collection activities - pursuant to section 275 of the Water Act 1989.

5. If the total due displays a (-\$ cr), this means the account is in credit. Credit amounts will be transferred to the purchaser's account at settlement.

6. Yarra Valley Water provides information in this Rates Certificate relating to waterways and drainage as an agent for Melbourne Water and relating to parks as an agent for Parks Victoria - pursuant to section 158 of the Water Act 1989.

7. The charges on this rates certificate are calculated and valid at the date of issue. To obtain up-to-date financial information, please order a Rates Settlement Statement prior to settlement.

8. From 01/07/2024, Residential Water Usage is billed using the following step pricing system: 256.31 cents per kilolitre for the first 44 kilolitres; 327.60 cents per kilolitre for 44-88 kilolitres and 485.34 cents per kilolitre for anything more than 88 kilolitres. From 1 July 2023, this charge is applicable for properties with water service only.

9. From 01/07/2024, Residential Water and Sewer Usage is billed using the following step pricing system: 343.42 cents per kilolitre for the first 44 kilolitres; 450.59 cents per kilolitre for 44-88 kilolitres and 523.50 cents per kilolitre for anything more than 88 kilolitres. From 1 July 2023, this charge is applicable for residential properties with both water and sewer services.

10. From 01/07/2024, Residential Recycled Water Usage is billed 192.59 cents per kilolitre.

11. From 01/07/2022 up to 30/06/2023, Residential Sewer Usage was calculated using the following equation: Water Usage (kl) x Seasonal Factor x Discharge Factor x Price (/kl) 1.1540 per kilolitre. From 1 July 2023, this charge will no longer be applicable for residential customers with both water and sewer services.

12. The property is a serviced property with respect to all the services, for which charges are listed in the Statement of Fees above.



YARRA VALLEY WATER
ABN 93 066 902 501

Lucknow Street
Mitcham Victoria 3132

Private Bag 1
Mitcham Victoria 3132

DX 13204

F (03) 9872 1353

E enquiry@yvw.com.au
yvw.com.au

To ensure you accurately adjust the settlement amount, we strongly recommend you book a Special Meter Reading:

- Special Meter Readings ensure that actual water use is adjusted for at settlement.
- Without a Special Meter Reading, there is a risk your client's settlement adjustment may not be correct.

Property No: 5076201

Address: 20 LEICESTER ST, BALWYN NORTH VIC 3104

Water Information Statement Number: 30933086

HOW TO PAY



Billor Code: 314567
Ref: 56336335552

Amount
Paid

Date
Paid

Receipt
Number

PLANNING CERTIFICATE

Official certificate issued under Section 199 Planning & Environment Act 1987
and the Planning and Environment Regulations 2005

CERTIFICATE REFERENCE NUMBER

1129500

APPLICANT'S NAME & ADDRESS

MADISON BRANSON LAWYERS C/- INFOTRACK
(SMOKEBALL) C/- LANDATA

DOCKLANDS

VENDOR

IOANNIDIS, ANASTASI LOUIS

PURCHASER

NOT KNOWN, NOT KNOWN

REFERENCE

357010

This certificate is issued for:

LOT 1 PLAN PS805838 ALSO KNOWN AS 20 LEICESTER STREET BALWYN NORTH
BOROONDARA CITY

The land is covered by the:

BOROONDARA PLANNING SCHEME

The Minister for Planning is the responsible authority issuing the Certificate.

The land:

- is included in a NEIGHBOURHOOD RESIDENTIAL ZONE - SCHEDULE 3

A detailed definition of the applicable Planning Scheme is available at :
(<http://planningschemes.dpcd.vic.gov.au/schemes/boroondara>)

Historic buildings and land protected under the Heritage Act 1995 are recorded in the Victorian
Heritage Register at:

<http://vhd.heritage.vic.gov.au/>

14 April 2025

Sonya Kilkenny
Minister for Planning

Additional site-specific controls may apply.
The Planning Scheme Ordinance should be
checked carefully.

The above information includes all
amendments to planning scheme maps
placed on public exhibition up to the date
of issue of this certificate and which are
still the subject of active consideration

Copies of Planning Schemes and
Amendments can be inspected at the
relevant municipal offices.

LANDATA®
T: (03) 9102 0402
E: landata.enquiries@servictoria.com.au

The attached certificate is issued by the Minister for Planning of the State of Victoria and is protected by statute.

The document has been issued based on the property information you provided. You should check the map below - it highlights the property identified from your information.

If this property is different to the one expected, you can phone (03) 9102 0402 or email landata.enquiries@servictoria.com.au

Please note: The map is for reference purposes only and does not form part of the certificate.

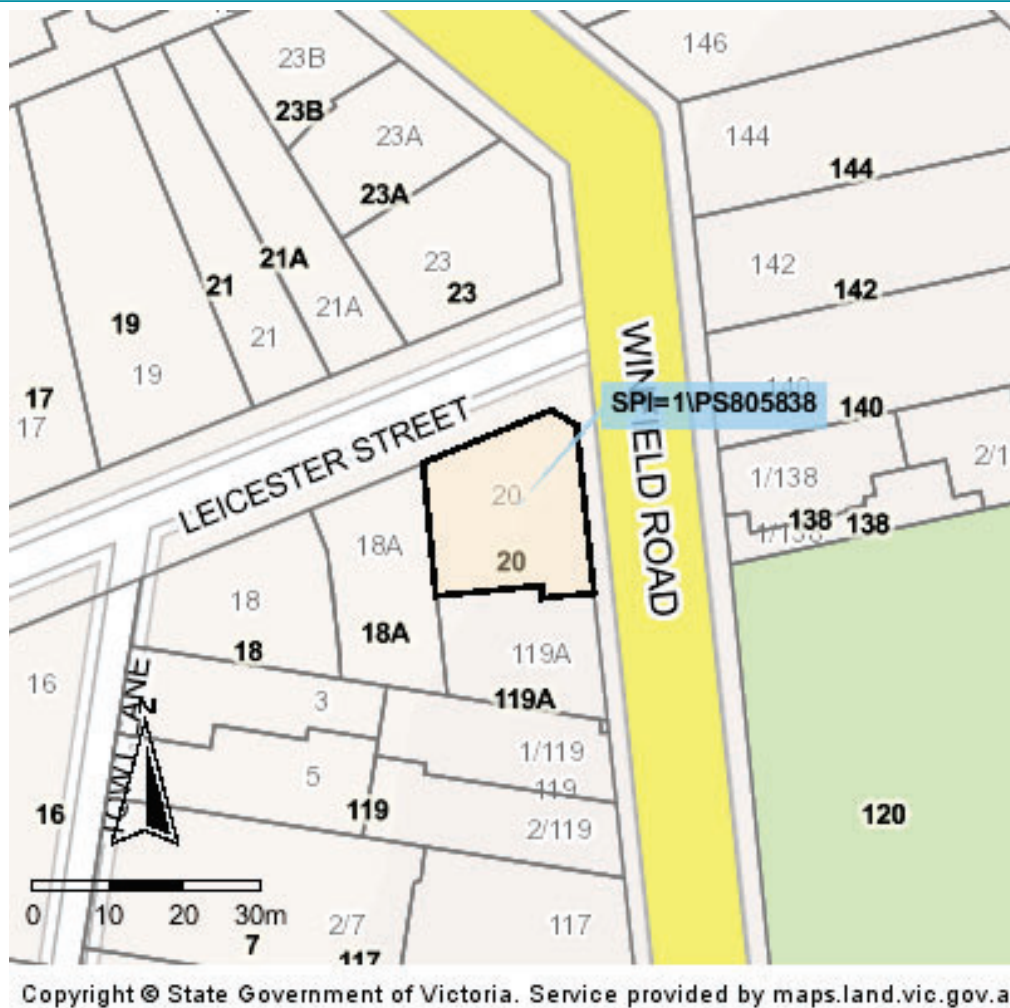

Choose the authoritative Planning Certificate

Why rely on anything less?

As part of your section 32 statement, the authoritative Planning Certificate provides you and / or your customer with the statutory protection of the State of Victoria. Order online before 4pm to receive your authoritative Planning Certificate the same day, in most cases within the hour. Next business day delivery, if further information is required from you.

Privacy Statement

The information obtained from the applicant and used to produce this certificate was collected solely for the purpose of producing this certificate. The personal information on the certificate has been provided by the applicant and has not been verified by LANDATA®. The property information on the certificate has been verified by LANDATA®. The zoning information on the certificate is protected by statute. The information on the certificate will be retained by LANDATA® for auditing purposes and will not be released to any third party except as required by law.

BUILDING PERMIT INFORMATION
Building Regulations 2018



22 June 2023

Secure Electronic Registries Victoria Pty Ltd
(Building Certificates)
Gpo Box 527
MELBOURNE VIC 3001

Dear Sir/Madam

RE: 20 Leicester Street BALWYN NORTH VIC 3104
OUR REF: BInf23/46575
YOUR REF: 69175178-018-3

In response to your request received on 09 Jun 2023 for building approval particulars in accordance with Regulation 51 of the Building Regulations 2018, the following is provided -

Details of any Building Permits/Occupancy Permits and Certificates of Final Inspection issued within the last 10 years as listed on the attached table.

Details of any current Building Notice or Order issued under the Building Act 1993 are listed on the attached table where applicable.

Council is unaware of any current statement(s) issued under regulation 64(1) or 231(2) of the Building Regulation 2018.

The information contained within this letter is based on current council electronic records available as at the date of this letter. An archive search has not been carried out.

For your information I wish to draw your attention to the following safety issues:

- (a) Part 9A of the Building Regulations 2018 requires owners to register their pool and/or spa with Council and have the barrier inspected every 4 years to make sure it is maintained and compliant. If the pool and/or spa has been registered by an owner then when the property changes ownership, the new owner will be notified in writing of when their next

Certificate of pool and spa barrier compliance (Form 23) is due to be lodged with Council. For further details visit <https://www.boroondara.vic.gov.au/register-pool-spa>

- (c) Requirements for smoke alarms in existing residential building pursuant to Regulation 145 of the Building Regulation 2018.

Note: Tree removal and pruning of trees may require a permit under Tree Protection Local Law 1F. Trees that are affected by the Local Law include significant trees and canopy trees as defined under Local Law 1F, and any multi-stemmed tree where the total circumference of all its stems measured at 1.5m from the ground equals or is greater than 110 cm (centimetres).

If you have any further queries, please contact Nyrie ZougaiB on 9278 4863.

Yours sincerely



Asanka Kodikara
MANAGER BUILDING SERVICES
MUNICIPAL BUILDING SURVEYOR

Details of any Building Permits issued in the last 10 years

Building Permits issued by Private Building Surveyors

Permit No	Date Issued	Building Works Authorized	Certificate of Final Inspection issued	Occupancy Permit issued	Relevant Building Surveyor	Building Surveying Company	Contact Phone
BS-U1553-2013-0129-0	18/06/2013	Construction of 2x Dwellings, associated Garages & Front Fence	N/A	Not Received	Con Giazi	BSGM Consulting Building Surveyors	9421 0421

Building Permits issued by City of Boroondara

Permit No	Date Issued	Building Works Authorized	Certificate of Final Inspection issued	Occupancy Permit issued
NIIL				

Please note: building permits for all building and demolition works approved after 1 July 1994 are subject to the issuance of a Certificate of Final Inspection or an Occupancy Permit.

Details of any current Building Notices or Orders issued

Council issued

Type of Notice or Order	Date Issued	Details of Notice or Order
NIL		

Council issued prior to 2009

Type of Notice or Order	Date Issued	Details of Notice or Order
NIL		

Issued by a Private Building Surveyor

Type of Notice or Order	Date Issued	Details of Notice or Order	Relevant Building Surveyor	Building Surveying Company	Contact phone
NIL					



**** Delivered by the LANDATA® System, Department of Environment, Land, Water & Planning ****

ROADS PROPERTY CERTIFICATE

The search results are as follows:

Madison Branson Lawyers C/- InfoTrack (Smokeball)
135 King Street
SYDNEY 2000
AUSTRALIA

Client Reference: 357010

NO PROPOSALS. As at the 14th April 2025, VicRoads has no approved proposals requiring any part of the property described in your application. You are advised to check your local Council planning scheme regarding land use zoning of the property and surrounding area.

This certificate was prepared solely on the basis of the Applicant-supplied address described below, and electronically delivered by LANDATA®.

20 LEICESTER STREET, BALWYN NORTH 3104
CITY OF BOROONDARA

This certificate is issued in respect of a property identified above. VicRoads expressly disclaim liability for any loss or damage incurred by any person as a result of the Applicant incorrectly identifying the property concerned.

Date of issue: 14th April 2025

Telephone enquiries regarding content of certificate: 13 11 71

[Vicroads Certificate] # 76478539 - 76478539095526 '357010'

Property Clearance Certificate

Land Tax



INFOTRACK / MADISON BRANSON LAWYERS

Your Reference:	242988
Certificate No:	89532141
Issue Date:	14 APR 2025
Enquiries:	CXN2

Land Address: 20 LEICESTER STREET BALWYN NORTH VIC 3104

Land Id	Lot	Plan	Volume	Folio	Tax Payable
45432391	1	805838	12012	728	\$3,632.49

Vendor: ANDREA IOANNIDIS & ANASTASI IOANNIDIS

Purchaser: FOR INFORMATION PURPOSES

Current Land Tax	Year Taxable Value (SV)	Proportional Tax	Penalty/Interest	Total
MRS ANDREA IOANNIDIS	2025	\$975,000	\$0.00	\$0.00

Comments: Property is exempt: LTX Principal Place of Residence.

Current Vacant Residential Land Tax	Year Taxable Value (CIV)	Tax Liability	Penalty/Interest	Total
-------------------------------------	--------------------------	---------------	------------------	-------

Comments:

Arrears of Land Tax	Year	Proportional Tax	Penalty/Interest	Total
MRS ANDREA IOANNIDIS	2020	\$1,537.72	\$310.70	\$1,468.36
MRS ANDREA IOANNIDIS	2019	\$2,215.39	\$457.79	\$2,164.13

This certificate is subject to the notes that appear on the reverse. The applicant should read these notes carefully.

Paul Broderick
Commissioner of State Revenue

CAPITAL IMPROVED VALUE (CIV):	\$1,750,000
SITE VALUE (SV):	\$975,000
CURRENT LAND TAX AND VACANT RESIDENTIAL LAND TAX CHARGE:	\$3,632.49

Notes to Certificate - Land Tax

Certificate No: 89532141

Power to issue Certificate

1. Pursuant to section 95AA of the *Taxation Administration Act 1997*, the Commissioner of State Revenue must issue a Property Clearance Certificate (Certificate) to an owner, mortgagee or bona fide purchaser of land who makes an application specifying the land for which the Certificate is sought and pays the application fee.

Amount shown on Certificate

2. The Certificate shows any land tax (including Vacant Residential Land Tax, interest and penalty tax) that is due and unpaid on the land described in the Certificate at the date of issue. In addition, it may show:
 - Land tax that has been assessed but is not yet due,
 - Land tax for the current tax year that has not yet been assessed, and
 - Any other information that the Commissioner sees fit to include, such as the amount of land tax applicable to the land on a single holding basis and other debts with respect to the property payable to the Commissioner.

Land tax is a first charge on land

3. Unpaid land tax (including Vacant Residential Land Tax, interest and penalty tax) is a first charge on the land to which it relates. This means it has priority over any other encumbrances on the land, such as a mortgage, and will continue as a charge even if ownership of the land is transferred. Therefore, a purchaser may become liable for any such unpaid land tax.

Information for the purchaser

4. Pursuant to section 96 of the *Land Tax Act 2005*, if a purchaser of the land described in the Certificate has applied for and obtained a certificate, the amount recoverable from the purchaser by the Commissioner cannot exceed the amount set out in the certificate, described as the "Current Land Tax Charge and Vacant Residential Land Tax Charge" overleaf. A purchaser cannot rely on a Certificate obtained by the vendor.

Information for the vendor

5. Despite the issue of a Certificate, the Commissioner may recover a land tax liability from a vendor, including any amount identified on this Certificate.

Apportioning or passing on land tax to a purchaser

6. A vendor is prohibited from apportioning or passing on land tax including vacant residential land tax, interest and penalty tax to a purchaser under a contract of sale of land entered into on or after 1 January 2024, where the purchase price is less than \$10 million (to be indexed annually from 1 January 2025, as set out on the website for Consumer Affairs Victoria).

General information

7. A Certificate showing no liability for the land does not mean that the land is exempt from land tax. It means that there is nothing to pay at the date of the Certificate.
8. An updated Certificate may be requested free of charge via our website, if:
 - The request is within 90 days of the original Certificate's issue date, and
 - There is no change to the parties involved in the transaction for which the Certificate was originally requested.

For Information Only

LAND TAX CALCULATION BASED ON SINGLE OWNERSHIP

Land Tax = \$4,500.00

Taxable Value = \$975,000

Calculated as \$2,250 plus (\$975,000 - \$600,000) multiplied by 0.600 cents.

VACANT RESIDENTIAL LAND TAX CALCULATION

Vacant Residential Land Tax = \$17,500.00

Taxable Value = \$1,750,000

Calculated as \$1,750,000 multiplied by 1.000%.

Land Tax - Payment Options

BPAY



Billers Code: 5249
Ref: 89532141

Telephone & Internet Banking - BPAY®

Contact your bank or financial institution to make this payment from your cheque, savings, debit or transaction account.

www.bpay.com.au

CARD



Ref: 89532141

Visa or Mastercard

Pay via our website or phone 13 21 61.
A card payment fee applies.

sro.vic.gov.au/paylandtax

Property Clearance Certificate

Commercial and Industrial Property Tax



INFOTRACK / MADISON BRANSON LAWYERS

Your Reference:	242988
Certificate No:	89532141
Issue Date:	14 APR 2025
Enquires:	CXN2

Land Address:	20 LEICESTER STREET BALWYN NORTH VIC 3104				
Land Id	Lot	Plan	Volume	Folio	Tax Payable
45432391	1	805838	12012	728	\$0.00
AVPCC	Date of entry into reform	Entry interest	Date land becomes CIPT taxable land	Comment	
110	N/A	N/A	N/A	The AVPCC allocated to the land is not a qualifying use.	

This certificate is subject to the notes found on the reverse of this page. The applicant should read these notes carefully.

Paul Broderick
Commissioner of State Revenue

CAPITAL IMPROVED VALUE:	
SITE VALUE:	
CURRENT CIPT CHARGE:	\$0.00

Notes to Certificate - Commercial and Industrial Property Tax

Certificate No: 89532141

Power to issue Certificate

1. Pursuant to section 95AA of the *Taxation Administration Act 1997*, the Commissioner of State Revenue must issue a Property Clearance Certificate (Certificate) to an owner, mortgagee or bona fide purchaser of land who makes an application specifying the land for which the Certificate is sought and pays the application fee.

Amount shown on Certificate

2. The Certificate shows any commercial and industrial property tax (including interest and penalty tax) that is due and unpaid on the land described in the Certificate at the date of issue.

Australian Valuation Property Classification Code (AVPCC)

3. The Certificate may show one or more AVPCC in respect of land described in the Certificate. The AVPCC shown on the Certificate is the AVPCC allocated to the land in the most recent of the following valuation(s) of the land under the *Valuation of Land Act 1960*:
 - a general valuation of the land;
 - a supplementary valuation of the land returned after the general valuation.
4. The AVPCC(s) shown in respect of land described on the Certificate can be relevant to determine if the land has a qualifying use, within the meaning given by section 4 of the *Commercial and Industrial Property Tax Reform Act 2024* (CIPT Act). Section 4 of the CIPT Act Land provides that land will have a qualifying use if:
 - the land has been allocated one, or more than one, AVPCC in the latest valuation, all of which are in the range 200-499 and/or 600-699 in the Valuation Best Practice Specifications Guidelines (the requisite range);
 - the land has been allocated more than one AVPCC in the latest valuation, one or more of which are inside the requisite range and one or more of which are outside the requisite range, and the land is used solely or primarily for a use described in an AVPCC in the requisite range; or
 - the land is used solely or primarily as eligible student accommodation, within the meaning of section 3 of the CIPT Act.

Commercial and industrial property tax information

5. If the Commissioner has identified that land described in the Certificate is tax reform scheme land within the meaning given by section 3 of the CIPT Act, the Certificate may show in respect of the land:
 - the date on which the land became tax reform scheme land;
 - whether the entry interest (within the meaning given by section 3 of the Duties Act 2000) in relation to the tax reform scheme land was a 100% interest (a whole interest) or an interest of less than 100% (a partial interest); and
 - the date on which the land will become subject to the commercial and industrial property tax.
6. A Certificate that does not show any of the above information in respect of land described in the Certificate does not mean that the land is not tax reform scheme land. It means that the Commissioner has not identified that the land is tax reform scheme land at the date of issue of the Certificate. The Commissioner may identify that the land is tax reform scheme land after the date of issue of the Certificate.

Change of use of tax reform scheme land

7. Pursuant to section 34 of the CIPT Act, an owner of tax reform scheme land must notify the Commissioner of certain changes of use of tax reform scheme land (or part of the land) including if the actual use of the land changes to a use not described in any AVPCC in the range 200-499 and/or 600-699. The notification

must be given to the Commissioner within 30 days of the change of use.

Commercial and industrial property tax is a first charge on land

8. Commercial and industrial property tax (including any interest and penalty tax) is a first charge on the land to which the commercial and industrial property tax is payable. This means it has priority over any other encumbrances on the land, such as a mortgage, and will continue as a charge even if ownership of the land is transferred. Therefore, a purchaser may become liable for any unpaid commercial and industrial property tax.

Information for the purchaser

9. Pursuant to section 27 of the CIPT Act, if a bona fide purchaser for value of the land described in the Certificate applies for and obtains a Certificate in respect of the land, the maximum amount recoverable from the purchaser is the amount set out in the Certificate. A purchaser cannot rely on a Certificate obtained by the vendor.

Information for the vendor

10. Despite the issue of a Certificate, the Commissioner may recover a commercial and industrial property tax liability from a vendor, including any amount identified on this Certificate.

Passing on commercial and industrial property tax to a purchaser

11. A vendor is prohibited from apportioning or passing on commercial and industrial property tax to a purchaser under a contract of sale of land entered into on or after 1 July 2024 where the purchase price is less than \$10 million (to be indexed annually from 1 January 2025, as set out on the website for Consumer Affairs Victoria).

General information

12. Land enters the tax reform scheme if there is an entry transaction, entry consolidation or entry subdivision in respect of the land (within the meaning given to those terms in the CIPT Act). Land generally enters the reform on the date on which an entry transaction occurs in respect of the land (or the first date on which land from which the subject land was derived (by consolidation or subdivision) entered the reform).
13. The Duties Act includes exemptions from duty, in certain circumstances, for an eligible transaction (such as a transfer) of tax reform scheme land that has a qualifying use on the date of the transaction. The exemptions apply differently based on whether the entry interest in relation to the land was a whole interest or a partial interest. For more information, please refer to www.sro.vic.gov.au/CIPT.
14. A Certificate showing no liability for the land does not mean that the land is exempt from commercial and industrial property tax. It means that there is nothing to pay at the date of the Certificate.
15. An updated Certificate may be requested free of charge via our website, if:
 - the request is within 90 days of the original Certificate's issue date, and
 - there is no change to the parties involved in the transaction for which the Certificate was originally requested.

Property Clearance Certificate

Windfall Gains Tax



INFOTRACK / MADISON BRANSON LAWYERS

Your Reference: 242988

Certificate No: 89532141

Issue Date: 14 APR 2025

Land Address: 20 LEICESTER STREET BALWYN NORTH VIC 3104

Lot	Plan	Volume	Folio
1	805838	12012	728

Vendor: ANDREA IOANNIDIS & ANASTASI IOANNIDIS

Purchaser: FOR INFORMATION PURPOSES

WGT Property Id	Event ID	Windfall Gains Tax	Deferred Interest	Penalty/Interest	Total
		\$0.00	\$0.00	\$0.00	\$0.00

Comments: No windfall gains tax liability identified.

This certificate is subject to the notes that appear on the reverse. The applicant should read these notes carefully.

A handwritten signature in black ink, appearing to read 'Paul Broderick'.

Paul Broderick
Commissioner of State Revenue

CURRENT WINDFALL GAINS TAX CHARGE:

\$0.00

Notes to Certificate - Windfall Gains Tax

Certificate No: 89532141

Power to issue Certificate

1. Pursuant to section 95AA of the *Taxation Administration Act 1997*, the Commissioner of State Revenue must issue a Property Clearance Certificate (Certificate) to an owner, mortgagee or bona fide purchaser of land who makes an application specifying the land for which the Certificate is sought and pays the application fee.

Amount shown on Certificate

2. The Certificate shows in respect of the land described in the Certificate:
 - Windfall gains tax that is due and unpaid, including any penalty tax and interest
 - Windfall gains tax that is deferred, including any accrued deferral interest
 - Windfall gains tax that has been assessed but is not yet due
 - Windfall gains tax that has not yet been assessed (i.e. a WGT event has occurred that rezones the land but any windfall gains tax on the land is yet to be assessed)
 - Any other information that the Commissioner sees fit to include such as the amount of interest accruing per day in relation to any deferred windfall gains tax.

Windfall gains tax is a first charge on land

3. Pursuant to section 42 of the *Windfall Gains Tax Act 2021*, windfall gains tax, including any accrued interest on a deferral, is a first charge on the land to which it relates. This means it has priority over any other encumbrances on the land, such as a mortgage, and will continue as a charge even if ownership of the land is transferred. Therefore, a purchaser may become liable for any unpaid windfall gains tax.

Information for the purchaser

4. Pursuant to section 42 of the *Windfall Gains Tax Act 2021*, if a bona fide purchaser for value of land applies for and obtains a Certificate in respect of the land, the maximum amount recoverable from the purchaser by the Commissioner is the amount set out in the certificate, described as the "Current Windfall Gains Tax Charge" overleaf.
5. If the certificate states that a windfall gains tax is yet to be assessed, note 4 does not apply.
6. A purchaser cannot rely on a Certificate obtained by the vendor.

Information for the vendor

7. Despite the issue of a Certificate, the Commissioner may recover a windfall gains tax liability from a vendor, including any amount identified on this Certificate.

Passing on windfall gains tax to a purchaser

8. A vendor is prohibited from passing on a windfall gains tax liability to a purchaser where the liability has been assessed under a notice of assessment as at the date of the contract of sale of land or option agreement. This prohibition does not apply to a contract of sale entered into before 1 January 2024, or a contract of sale of land entered into on or after 1 January 2024 pursuant to the exercise of an option granted before 1 January 2024.

General information

9. A Certificate showing no liability for the land does not mean that the land is exempt from windfall gains tax. It means that there is nothing to pay at the date of the Certificate.
10. An updated Certificate may be requested free of charge via our website, if:
 - The request is within 90 days of the original Certificate's issue date, and
 - There is no change to the parties involved in the transaction for which the Certificate was originally requested.
11. Where a windfall gains tax liability has been deferred, interest accrues daily on the deferred liability. The deferred interest shown overleaf is the amount of interest accrued to the date of issue of the certificate.

Windfall Gains Tax - Payment Options

BPAY



Billers Code: 416073
Ref: 89532147

Telephone & Internet Banking - BPAY®

Contact your bank or financial institution to make this payment from your cheque, savings, debit or transaction account.

www.bpay.com.au

CARD



Ref: 89532147

Visa or Mastercard

Pay via our website or phone 13 21 61.
A card payment fee applies.

sro.vic.gov.au/payment-options

Important payment information

Windfall gains tax payments must be made using only these specific payment references.

Using the incorrect references for the different tax components listed on this property clearance certificate will result in misallocated payments.

Due diligence checklist

What you need to know before buying a residential property

Before you buy a home, you should be aware of a range of issues that may affect that property and impose restrictions or obligations on you, if you buy it. This checklist aims to help you identify whether any of these issues will affect you. The questions are a starting point only and you may need to seek professional advice to answer some of them. You can find links to organisations and web pages that can help you learn more, by visiting the Due diligence checklist page on the Consumer Affairs Victoria website (consumer.vic.gov.au/duediligencechecklist).

Urban living

Moving to the inner city?

High density areas are attractive for their entertainment and service areas, but these activities create increased traffic as well as noise and odours from businesses and people. Familiarising yourself with the character of the area will give you a balanced understanding of what to expect.

Is the property subject to an owners corporation?

If the property is part of a subdivision with common property such as driveways or grounds, it may be subject to an owners corporation. You may be required to pay fees and follow rules that restrict what you can do on your property, such as a ban on pet ownership.

Growth areas

Are you moving to a growth area?

You should investigate whether you will be required to pay a growth areas infrastructure contribution.

Flood and fire risk

Does this property experience flooding or bushfire?

Properties are sometimes subject to the risk of fire and flooding due to their location. You should properly investigate these risks and consider their implications for land management, buildings and insurance premiums.

Rural properties

Moving to the country?

If you are looking at property in a rural zone, consider:

- Is the surrounding land use compatible with your lifestyle expectations? Farming can create noise or odour that may be at odds with your expectations of a rural lifestyle.
- Are you considering removing native vegetation? There are regulations which affect your ability to remove native vegetation on private property.
- Do you understand your obligations to manage weeds and pest animals?

Can you build new dwellings?

Does the property adjoin crown land, have a water frontage, contain a disused government road, or are there any crown licences associated with the land?

Is there any earth resource activity such as mining in the area?

You may wish to find out more about exploration, mining and quarrying activity on or near the property and consider the issue of petroleum, geothermal and greenhouse gas sequestration permits, leases and licences, extractive industry authorisations and mineral licences.

Soil and groundwater contamination

Has previous land use affected the soil or groundwater?

You should consider whether past activities, including the use of adjacent land, may have caused contamination at the site and whether this may prevent you from doing certain things to or on the land in the future.

(04/10/2016)

Land boundaries

Do you know the exact boundary of the property?

You should compare the measurements shown on the title document with actual fences and buildings on the property, to make sure the boundaries match. If you have concerns about this, you can speak to your lawyer or conveyancer, or commission a site survey to establish property boundaries.

Planning controls

Can you change how the property is used, or the buildings on it?

All land is subject to a planning scheme, run by the local council. How the property is zoned and any overlays that may apply, will determine how the land can be used. This may restrict such things as whether you can build on vacant land or how you can alter or develop the land and its buildings over time.

The local council can give you advice about the planning scheme, as well as details of any other restrictions that may apply, such as design guidelines or bushfire safety design. There may also be restrictions – known as encumbrances – on the property's title, which prevent you from developing the property. You can find out about encumbrances by looking at the section 32 statement.

Are there any proposed or granted planning permits?

The local council can advise you if there are any proposed or issued planning permits for any properties close by. Significant developments in your area may change the local 'character' (predominant style of the area) and may increase noise or traffic near the property.

Safety

Is the building safe to live in?

Building laws are in place to ensure building safety. Professional building inspections can help you assess the property for electrical safety, possible illegal building work, adequate pool or spa fencing and the presence of asbestos, termites, or other potential hazards.

Building permits

Have any buildings or retaining walls on the property been altered, or do you plan to alter them?

There are laws and regulations about how buildings and retaining walls are constructed, which you may wish to investigate to ensure any completed or proposed building work is approved. The local council may be able to give you information about any building permits issued for recent building works done to the property, and what you must do to plan new work. You can also commission a private building surveyor's assessment.

Are any recent building or renovation works covered by insurance?

Ask the vendor if there is any owner-builder insurance or builder's warranty to cover defects in the work done to the property.

Utilities and essential services

Does the property have working connections for water, sewerage, electricity, gas, telephone and internet?

Unconnected services may not be available, or may incur a fee to connect. You may also need to choose from a range of suppliers for these services. This may be particularly important in rural areas where some services are not available.

Buyers' rights

Do you know your rights when buying a property?

The contract of sale and section 32 statement contain important information about the property, so you should request to see these and read them thoroughly. Many people engage a lawyer or conveyancer to help them understand the contracts and ensure the sale goes through correctly. If you intend to hire a professional, you should consider speaking to them before you commit to the sale. There are also important rules about the way private sales and auctions are conducted. These may include a cooling-off period and specific rights associated with 'off the plan' sales. The important thing to remember is that, as the buyer, you have rights.

(04/10/2016)