

LEGEND.

Sewer and Stormwater to join existing Council connections

- Sewer Pipe 56 M
- S/W Pipe 58 M
- Down Pipe D.P.
- Gully Trap G.T.
- Terminal Vent T.V.

071693

FILE COPY

Drainage Schedule		
Kitchen (with AAV)		
Sink:	Ø65mm @1:40 min	(3 discharge units)
Bathrooms		
Vanity:	Ø40mm @ 1:40 min	(1 discharge units per basin)
Shower:	Ø40mm @1:40 min	(2 discharge units)
Bath:	Ø40mm @1:40 min	(4 discharge units)
WC:	Ø100mm @1:40 min	(4 discharge units)
Laundry		
Sink:	Ø40mm @1:40 min	(5 discharge units)
Main Foulwater Drain	Ø100mm @1:120 max	
Stormwater Drain	Ø100mm @1:120 max	
Heatpump	Drain over DP or GT	
Hot water Cylinder	Drain over DP or GT	
Services	To existing connections	

Project Information

Roof: Steel & Tube, Endura 28° 5 Rib
Walls: Insulclad 40mm Cavity 20mm exterior.
Wind Zone: High Snow: 0.5kPa

Resource Consents Issues:

- 1:
- 2:

Drinage Plan

Sheet. 5	Drawn. DH	Date. 08/08/07	QS DP
Std. plan based on. Special	Sales. CB	Plot Date 9/01/2008	Version 02
Scale @ A3	Job Number. 02416		

STONEWOOD HOMES
Christchurch
204 Main North Rd
P.O Box 11 036
Christchurch, New Zealand.
Phone: +64 3 354 2344
Fax: +64 3 354 2342.
Email: info@stonewood.co.nz
Internet: www.stonewood.co.nz

AMENDMENTS.

DRWN CHK

This plan is developed for the purchaser and is copyright to Stonewood Homes Ltd.
Note: All aluminium windows and doors to go up to the u/s of soffits. (Only on houses with soffits) and also full height windows to be the same height as doors.
Note: Soffit and lintel heights can vary. Refer to specific Cross Section to establish soffit and lintel heights for this house
All required timber treatment to comply with NZS 3602 2003

THIS IS ONE OF THE DRAWINGS REFERRED TO IN THE CONTRACT.
DATED: / /
OWNER WITNESS
OWNER WITNESS
OWNER WITNESS

Client : Willams, Beat
Address : Lot45, DP 364100
244 Southfield Drive
Lincoln

Consent Plans

Grade 1:80
Reg# 18538

244 Southfield Dr

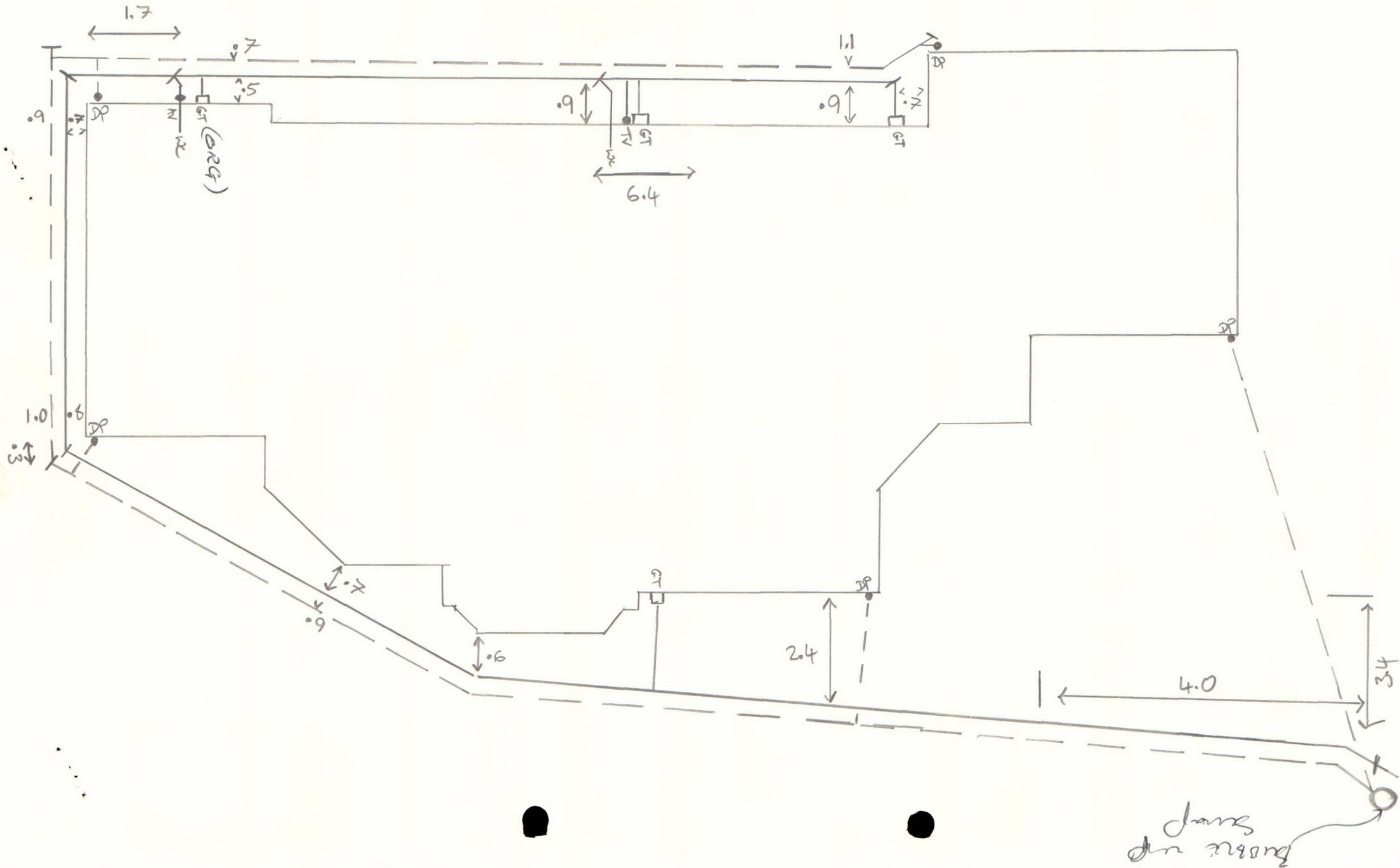

 CHRISTCHURCH <small>CITY COUNCIL · YOUR PEOPLE · YOUR CITY</small>	DRAINAGE PICKUP		CONSENT NUMBER
	Address:	Drainlayer:	
Date:	Inspector:		