

Land Information Memorandum



Property address:

13 Koral Lane

LIM number: H09006552

Page 1

Christchurch City Council

53 Hereford Street, PO Box 73015
Christchurch 8154, New Zealand
Tel 64 3 941 8999
Fax 64 3 941 8984

www.ccc.govt.nz

Application details

Date issued 19 June 2025
Date received 10 June 2025

Property details

Property address 13 Koral Lane, Riccarton Park, Christchurch
Valuation roll number 23415 80775
Valuation information Capital Value: \$680,000
Land Value: \$420,000
Improvements Value: \$260,000
Please note: these values are intended for Rating purposes
Legal description Lot 1 DP 563435
Existing owner Benjamin Andrew Hanna
13 Koral Lane
Christchurch 8042

Council references

Rate account ID 73200875
LIM number H09006552
Property ID 1193496

Property address:

13 Koral Lane

LIM number: H09006552

Document information

This Land Information Memorandum (LIM) has been prepared for the purpose of section 44A of the Local Government Official Information and Meetings Act 1987 (LGOIMA). It is a summary of the information that we hold on the property. Each heading or "clause" in this LIM corresponds to a part of section 44A.

Sections 1 to 10 contain all of the information known to the Christchurch City Council that must be included under section 44A(2) LGOIMA. Any other information concerning the land as the Council considers, at its discretion, to be relevant is included at section 11 of this LIM (section 44A(3) LGOIMA). If there are no comments or information provided in these sections this means that the Council does not hold information on the property that corresponds to that part of section 44A.

The information included in this LIM is based on a search of Council records only and there may be other information relating to the land which is unknown to the Council. Please note that other agencies may also hold information relevant to the property, or administer legislation relevant to the use of the land, for example, the Regional Council (Ecan), Heritage New Zealand Pouhere Taonga, and Land Information New Zealand.

Council records may not show illegal or unauthorised building or works on the property. The applicant is solely responsible for ensuring that the land is suitable for a particular purpose.

A LIM is only valid at the date of issue as information is based only upon information the Council held at the time of that LIM request being made.

Property file service

This Land Information Memorandum does not contain all information held on a property file. Customers may request property files by phoning the Council's Customer Call Centre on (03) 941 8999, or visiting any of the Council Service Centres. For further information please visit www.ccc.govt.nz.

To enable the Council to measure the accuracy of this LIM document based on our current records, we would appreciate your response should you find any information contained therein which may be considered to be incorrect or omitted. Please telephone the Customer Call Centre on (03) 941 8999.

Property address:

13 Koral Lane

LIM number: H09006552

Page 3

Christchurch City Council

53 Hereford Street, PO Box 73015
Christchurch 8154, New Zealand
Tel 64 3 941 8999
Fax 64 3 941 8984

www.ccc.govt.nz

A search of records held by the Council has revealed the following information:

1. Special features and characteristics of the land

Section 44A(2)(a) LGOIMA. This is information known to the Council but not apparent from the district scheme under the Town and Country Planning Act 1977 or a district plan under the Resource Management Act 1991. It identifies each (if any) special feature or characteristic of the land concerned, including but not limited to potential erosion, avulsion, falling debris, subsidence, slippage, alluvion, or inundation, or likely presence of hazardous contaminants.

☎ For enquiries, please phone (03) 941 8999 or visit www.ccc.govt.nz.

- **Fill**

This property is located in an area known to have been filled. The year the fill occurred is 2019. The filling was, according to the Council's records carried out in a controlled manner and comprises Silt.

- **Liquefaction Assessment**

Christchurch City Council holds indicative information on liquefaction hazard for Christchurch. Information on liquefaction, including an interactive web tool, can be found on the Council website at ccc.govt.nz/liquefaction. Depending on the liquefaction potential of the area that the property is in, the Council may require site-specific investigations before granting future subdivision or building consent for the property.

- **Consultant Report Available**

Land Information New Zealand (LINZ) engaged Tonkin and Taylor to provide a Geotechnical Report on Ground Movements that occurred as a result of the Canterbury Earthquake Sequence. The report indicates this property may have been effected by a degree of earthquake induced subsidence. The report obtained by LINZ can be accessed on their website at <https://www.linz.govt.nz> and search Information for Canterbury Surveyors.

Related Information

- The latest soil investigation report for this property is attached for your information

Property address:

13 Koral Lane

LIM number: H09006552

Christchurch City Council

53 Hereford Street, PO Box 73015
Christchurch 8154, New Zealand
Tel 64 3 941 8999
Fax 64 3 941 8984

2. Private and public stormwater and sewerage drains

Section 44A(2)(b) LGOIMA. This is information about private and public stormwater and sewerage drains as shown in the Council's records.

 For stormwater and sewerage enquiries, please phone (03) 941 8999 or visit www.ccc.govt.nz.

Related Information

- This property is shown to be served by Christchurch City Council Sewer and Stormwater.
- Attached are all drainage plans that Council hold for details of private and public drainage. Not all plans provided are verified by Council, and therefore Council cannot be liable for inaccuracies. Site investigation will be required by owners to determine exact layouts.

3. Drinking Water Supply

Section 44A(2)(ba) and (bb) LGOIMA. This is information notified to the Council about whether the land is supplied with drinking water, whether the supplier is the owner of the land or a networked supplier, any conditions that are applicable, and any information the Council has about the supply.

Please note the council does not guarantee a particular water quality to its customers. If you require information on current water quality at this property please contact the Three Waters & Waste Unit.

☎ For water supply queries, please phone (03) 941 8999 or visit www.ccc.govt.nz.

Water supply

Christchurch City Council is the networked supplier of water to this property. This property is connected to the Christchurch City Council Water Supply. The conditions of supply are set out in the Christchurch City Council Water Supply and Wastewater Bylaw (2022), refer to www.ccc.govt.nz.

4. Rates

Section 44A(2)(c) LGOIMA. This is information on any rates owing in relation to the land.

☎ For rates enquiries, please phone (03) 941 8999 or visit www.ccc.govt.nz.

(a) Annual rates

Annual rates to 30/06/2025: \$3,919.07

	Instalment Amount	Date Due
Instalment 1	\$979.72	31/08/2024
Instalment 2	\$979.72	30/11/2024
Instalment 3	\$979.72	28/02/2025
Instalment 4	\$979.91	31/05/2025

Rates owing as at 19/06/2025: \$98.00

(b) Excess Water Rates

For excess water charge enquiries, please phone (03) 941 8999 or visit www.ccc.govt.nz/contact-us.

(c) Final water meter reading required at settlement?

Property settlements must ensure all water usage and outstanding debts are accurately accounted for.

To advise of a property settlement, please complete the request for settlement information form at www.ccc.govt.nz/services/rates-and-valuations/solicitors-request.

A settlement statement of accounts will be provided on the expected settlement date advised.

Property address:

13 Koral Lane

LIM number: H09006552

Page 7

Christchurch City Council

53 Hereford Street, PO Box 73015
Christchurch 8154, New Zealand
Tel 64 3 941 8999
Fax 64 3 941 8984

www.ccc.govt.nz

5. Consents, certificates, notices, orders, or requisitions affecting the land and buildings

Section 44A(2)(d) LGOIMA. This is information concerning any consent, certificate, notice, order, or requisition, affecting the land or any building on the land, previously issued by the Council. The information in this section may also cover building consent and/or code compliance information issued by building certifiers under the Building Act 1991 and building consent authorities that are not the Council under the Building Act 2004.

You can check the property file to identify whether any consent or certificate was issued by a building certifier under the Building Act 1991.

Section 44A(2)(da) LGOIMA. The information required to be provided to a territorial authority under section 362T(2) of the Building Act 2004. There is currently no information required to be provided by a building contractor to a territorial authority under section 362T(2) of the Building Act 2004. The Building (Residential Consumer Rights and Remedies) Regulations 2014 only prescribed the information that must be given to the clients of a building contractor.

☎ For building enquiries, please phone (03) 941 8999, email EPADutyBCO@ccc.govt.nz or visit www.ccc.govt.nz.

(a) Consents

- BCN/2018/8250 Applied: 04/12/2018 Status: Completed
34 Miromiro Street Riccarton Park
Exemption from building consent approved 06/12/2018
To lay water and drainage in private rights-of-way including private wastewater lines in Stage 2 of the Karamu subdivision.
- BCN/2021/1201 Applied: 26/02/2021 Status: Completed
11 Koral Lane Riccarton Park
Accepted for processing 02/03/2021
PIM Granted 16/03/2021
PIM Issued 17/03/2021
Building consent granted 07/04/2021
Building consent issued 13/04/2021
Code Compliance Certificate Issued 25/02/2022
Construction of two attached dwellings with attached garages - Block A

(b) Certificates

Note: Code Compliance Certificates were only issued by the Christchurch City Council since January 1993.

(c) Notices

(d) Orders

(e) Requisitions

Related Information

- Please find an electrical certificate/s attached relating to works that have been carried out on the current building/dwelling at this address.

Property address:

13 Koral Lane

LIM number: H09006552

6. Certificates issued by a building certifier

Section 44A(2)(e) LGOIMA. This is information notified to the Council concerning any certificate issued by a building certifier pursuant to the Building Act 1991 or the Building Act 2004.

☎ For building enquiries, please phone (03) 941 8999, email EPADutyBCO@ccc.govt.nz or visit www.ccc.govt.nz.

Property address:

13 Koral Lane

LIM number: H09006552

Page 9

Christchurch City Council

53 Hereford Street, PO Box 73015
Christchurch 8154, New Zealand
Tel 64 3 941 8999
Fax 64 3 941 8984

www.ccc.govt.nz

7. Weathertightness

Section 44A(2)(ea) LGOIMA. This is information notified to the Council under section 124 of the Weathertight Homes Resolution Services Act 2006.

 For weathertight homes enquiries, please phone (03) 941 8999 or visit www.ccc.govt.nz.

If there is no information below this means Council is unaware of any formal Weathertight Homes Resolution Services claim lodged against this property.

Property address:

13 Koral Lane

LIM number: H09006552

Page 10

Christchurch City Council

53 Hereford Street, PO Box 73015
Christchurch 8154, New Zealand
Tel 64 3 941 8999
Fax 64 3 941 8984

www.ccc.govt.nz

8. Land use and conditions

Section 44A(2)(f) LGOIMA. This is information relating to the use to which the land may be put and conditions attached to that use. The planning information provided below is not exhaustive and reference to the Christchurch District Plan and any notified proposed changes to that plan is recommended: <https://ccc.govt.nz/the-council/plans-strategies-policies-and-bylaws/plans/christchurch-district-plan/>.

There may be some provisions of the Christchurch City Plan or Banks Peninsula District Plan that affect this property that are still operative.

☎ For planning queries, please phone (03) 941 8999, email DutyPlanner@ccc.govt.nz or visit www.ccc.govt.nz.

- **Regional plan or bylaw**

There may be objectives, policies or rules in a regional plan or a regional bylaw that regulate land use and activities on this site. Please direct enquiries to Canterbury Regional Council (Environment Canterbury).

(a)(i) Christchurch City Plan & Banks Peninsula District Plan

(ii) Christchurch District Plan

- **Development Constraint Conditions**

Council records show there is a specific condition on the use of this site: Consent Notice

- **Christchurch International Airport Protection Sfc.**

Property or part of property within the Christchurch International Airport Protection Surfaces overlay, which is operative.

- **Outline Development Plan**

Property or part of property is within an Outline Development Plan area, which is affected by specific provisions that are operative.

- **District Plan Zone**

Property or part of property within the Residential New Neighbourhood Zone, which is operative.

(b) Resource consents

If there are any land use resource consents issued for this property the Council recommends that you check those resource consents on the property file. There may be conditions attached to those resource consents for the property that are still required to be complied with.

- RMA/2017/2099 - Combined subdivision / land use consent
55 Lot Fee Simple Subdivision - Stage 1
Status: Processing complete
Applied 01/09/2017
Conditions changed/cancelled - s127 29/06/2018
Amended decision issued - s133A 19/12/2017
s223 Certificate issued stage 1 13/09/2018
s223 Certificate issued stage 2 18/09/2018
s224 Certificate issued stage 1 13/09/2018

Property address:

13 Koral Lane

LIM number: H09006552

Page 11

Christchurch City Council

53 Hereford Street, PO Box 73015
Christchurch 8154, New Zealand
Tel 64 3 941 8999
Fax 64 3 941 8984

www.ccc.govt.nz

s224 Certificate issued stage 2 13/06/2019
Granted 15/12/2017
Decision issued 15/12/2017

- RMA/2017/2103 - Subdivision Consent
Interim Fee Simple Four Lot Subdivision
Status: Processing complete
Applied 04/09/2017
s224 Certificate issued 07/11/2017
Granted 16/10/2017
Decision issued 13/10/2017
- RMA/2018/1301 - Combined subdivision / land use consent
Thirty four lot Residential Subdivision
Status: s223 Certificate issued
Applied 30/05/2018
Conditions changed/cancelled - s127 20/05/2019
s223 Certificate issued 22/08/2019
Granted 02/10/2018
Decision issued 02/10/2018
- RMA/2019/339 - Subdivision Consent
Fee Simple Subdivision - 16 Lots
Status: Processing complete
Applied 20/02/2019
Conditions changed/cancelled - s127 09/01/2021
s223 Certificate issued stage 1 04/06/2020
s223 Certificate issued stage 2 28/07/2020
s223 Certificate issued stage 3 17/11/2020
s223 Certificate issued stage 4 21/01/2021
s223 Certificate issued stage 5 11/02/2021
s224 Certificate issued stage 1 10/07/2020
s224 Certificate issued stage 2 21/10/2020
s224 Certificate issued stage 3 30/11/2020
s224 Certificate issued stage 4 22/01/2021
s224 Certificate issued stage 5 18/03/2021
Granted 18/05/2020
Decision issued 18/05/2020
- RMA/2021/762 - Combined subdivision / land use consent
34 Miromiro Street Riccarton Park
Subdivision - Fee simple - 16 Lots with land use - Reapplied under 2021-22 DC policy - RMA/2021/3104
Status: Surrendered
Applied 26/03/2021
14/05/2021
Granted 14/05/2021
Decision issued 14/05/2021

Property address:

13 Koral Lane

LIM number: H09006552

Page 12

Christchurch City Council

53 Hereford Street, PO Box 73015
Christchurch 8154, New Zealand
Tel 64 3 941 8999
Fax 64 3 941 8984

www.ccc.govt.nz

- RMA/2021/3104 - Subdivision Consent
34 Miromiro Street Riccarton Park
Re-application for 16 lot fee simple subdivision consent to replace RMA/2021/762 - Reapplied under 2021-22 DC Policy
Status: Processing complete
Applied 17/09/2021
29/09/2021
s223 Certificate issued 19/10/2021
s224 Certificate issued 04/02/2022
Granted 29/09/2021
Decision issued 30/09/2021

Related Information

- The Council system shows a Development Constraint/Ongoing Condition Consent notice for this property. The consent notice should be registered against the record of title for the property and a search of that title and the consent notice will provide details in respect of the constraint / condition. If a search of the title does not record the consent notice or the consent notice is not clear then we suggest you contact the duty planner by either calling 941 8999 or emailing DutyPlanner@ccc.govt.nz. The Consent notice is as follows:
 1. Any residential development or subdivision of Lot 812 shall provide for a minimum of 11 residential dwellings or allotments.
 2. Specific engineering design and shall comply with the relevant requirements set out in the most recent MBIE guidelines for TC1 equivalent land.

Property address:

13 Koral Lane

LIM number: H09006552

Page 13

Christchurch City Council

53 Hereford Street, PO Box 73015
Christchurch 8154, New Zealand
Tel 64 3 941 8999
Fax 64 3 941 8984

www.ccc.govt.nz

9. Other land and building classifications

Section 44A(2)(g) LGOIMA. This is information notified to the Council by any statutory organisation having the power to classify land or buildings for any purpose.

 For land and building enquiries, please phone (03) 941 8999 or visit www.ccc.govt.nz.

Please refer to Section 1 for details

Property address:

13 Koral Lane

LIM number: H09006552

Page 14

Christchurch City Council

53 Hereford Street, PO Box 73015
Christchurch 8154, New Zealand
Tel 64 3 941 8999
Fax 64 3 941 8984

www.ccc.govt.nz

10. Network utility information

Section 44A(2)(h) LGOIMA. This is information notified to the Council by any network utility operator pursuant to the Building Act 1991 or the Building Act 2004.

 For network enquiries, please phone (03) 941 8999 or visit www.ccc.govt.nz.

- **None recorded for this property**

11. Other information

Section 44A(3) LGOIMA. This is information concerning the land that the Council has the discretion to include if it considers it to be relevant.

☎ For any enquiries, please phone (03) 941 8999 or visit www.ccc.govt.nz.

(a) Kerbside waste collection

- Your organics are collected Weekly on Thursday. Please leave your organics at the Kerbside by 6:00 a.m.
- Your recycling is collected Fortnightly on the Week 1 collection cycle on a Thursday. Please leave your recycling at the Kerbside by 6:00 a.m. Your nearest recycling depot is the Parkhouse Road EcoDrop.
- Your refuse is collected Fortnightly on the Week 1 collection cycle on a Thursday. Please leave your rubbish at the Kerbside by 6:00 a.m. Your nearest rubbish depot is the Parkhouse Road EcoDrop.

(b) Other

• Floor Levels Information

Christchurch City Council holds a variety of information relevant to building/property development across the city. This includes minimum finished floor levels that need to be set to meet the surface water requirements in clause E1.3.2 of the building code (where this applies), and the requirements of the Christchurch District Plan (where a property is in the Flood Management Area). Where this information has been processed for your site, it can be viewed at <https://ccc.govt.nz/floorlevelmap/>, otherwise site specific advice can be obtained by emailing floorlevels@ccc.govt.nz

• Guest Accommodation

Guest accommodation (including whole unit listings on Airbnb; BookaBach; etc.) generally requires a resource consent in this zone when the owner is not residing on the site. For more information, please refer to: <https://ccc.govt.nz/providing-guest-accommodation/>.

• Community Board

Property located in Halswell-Hornby-Riccarton Community Board.

• Tsunami Evacuation Zone

This property is not in a tsunami evacuation zone. It is not necessary to evacuate in a long or strong earthquake or during an official Civil Defence tsunami warning. Residents may wish to offer to open their home to family or friends who need to evacuate from a tsunami zone, and should plan with potential guests to do so in advance. More information can be found at <https://ccc.govt.nz/services/civil-defence/hazards/tsunami-evacuation-zones-and-routes/>

• Electoral Ward

Property located in Hornby Electoral Ward

• Listed Land Use Register

Hazardous activities and industries involve the use, storage or disposal of hazardous substances. These substances can sometimes contaminate the soil. Environment Canterbury identifies land that is used or has been used for hazardous activities and industries. This information is held on a publically available database called the Listed Land Use Register (LLUR). The Christchurch City Council may not hold information that is held on the LLUR. Therefore, it is recommended that you check Environment Canterbury's online database at www.llur.ecan.govt.nz

• Spatial Query Report

Property address:

13 Koral Lane

LIM number: H09006552

Page 16

Christchurch City Council

53 Hereford Street, PO Box 73015
Christchurch 8154, New Zealand
Tel 64 3 941 8999
Fax 64 3 941 8984

www.ccc.govt.nz

A copy of the spatial query report is attached at the end of this LIM. The spatial query report lists land use resource consents that have been granted within 100 metres of this property.

Property address:

13 Koral Lane

LIM number: H09006552

Page 17

Christchurch City Council

53 Hereford Street, PO Box 73015
Christchurch 8154, New Zealand
Tel 64 3 941 8999
Fax 64 3 941 8984

www.ccc.govt.nz

20 September 2019

Our Ref: 419750

Ngāi Tahu Property
PO Box 13-0060
Christchurch
New Zealand

Attention: Dean Christie

Geotechnical and Foundation Report: Lot 812 Miromiro Street, Kākāpō Neighbourhood - Karamū Subdivision, Riccarton, Christchurch

1 Introduction

This report provides the geotechnical appraisal and foundation recommendations for Lot 812 (LT 530544), Kākāpō Neighbourhood - Karamū Subdivision, Riccarton, Christchurch.

Lot 812 is a larger site which is likely to be subdivided into smaller lots in the future. Our attached test location plan shows a possible future subdivision layout for Lot 812. We anticipate the buildings will comprise residential dwellings that are designed and constructed within the scope of NZS3604:2011. Buildings outside the scope of NZS3604:2011 require specific engineering design.

This report is intended to be used as technical supporting documentation for foundation design and Building Consent application purposes.

2 Ground Model

Our knowledge of the ground model is based on information from a number of sources, including:

Subdivision investigation¹ including shallow and deep testing. The subdivision report concluded *"Based on our liquefaction assessment, we consider the site to behave similarly to MBIE Technical Category 1 (TC1)"*. The surface geology is Springston Formation alluvium, comprising mixtures of silt, sand and gravel. Groundwater is at approximately 10m depth.

Subdivision earthworks engineering undertaken with Eliot Sinclair as designer and Engineer to Contract, and works constructed by Blakely Construction Limited. All controlled fill placed across the subdivision area was supervised by an Engineer from Eliot Sinclair & Partners, and has been certified to NZS4431 as reported in the Inspecting Engineer's Report². The existing topsoil layer and any unsuitable material was removed down to clean insitu alluvium, followed by placement of controlled fill and finished with topsoil.

Site-specific testing - see details below.

1 Aurecon (2016): "Champions Mile – Geotechnical Investigation Report – Ngāi Tahu Property Limited", dated 23 September 2016; Revision: 1; Reference: 238331.

2 Eliot Sinclair (2019) "Inspecting Engineer's Report (NZS 4431:1989) – Kākāpō - Stage 2, Karamū Subdivision, Riccarton, Christchurch – Prepared for Ngāi Tahu Property Ltd – 419750" and dated 29 August 2019.

3 Site-Specific Testing

Following the completion of the earthworks, we undertook site-specific geotechnical testing across all residential lots within the subdivision. Testing within Lot 812 comprised 6 hand augers, 11 hydraulic penetrometers³ and 6 hand penetrometers.

The typical ground profile at the site is topsoil overlying sand/silt soil with sandy gravel at depth. The sand/silt soil may be the natural insitu subgrade, or controlled fill, or a combination of these across the lot area.

Some lots in the subdivision have no fill, but simply have topsoil placed over insitu subgrade. Where controlled fill is present it was largely sourced from other areas of the site (cut from the subgrade) so the fill has very similar appearance to the insitu soil; essentially being the same material. Some lots may have granular fill.

For foundation engineering purposes it may be assumed that the insitu sand/silt and the sand/silt fill are a single soil unit, so the actual thickness of fill is not relevant. The geotechnical properties (notably penetrometer resistance and, hence, bearing capacity) are the important characteristic to determine, which comes from the investigation logs.

Please refer to the attached site-specific investigation factual records and the test location plans that also include information on the depth of controlled fill placed on the lot.

4 Foundation Recommendations

The TC1 foundation design provisions of the MBIE residential guidelines⁴ apply to the site – refer to MBIE Section 5, Figure 5.1.

Typically, below the topsoil layer the penetrometer test results generally indicate a geotechnical ultimate bearing capacity >300 kPa. Standard foundations for dwellings within the scope of NZS 3604:2011 are suitable. Refer to MBIE Section 5.2 *Overview of new foundations options*.

For a more resilient design the MBIE TC2 foundation options are suitable for the site.

Foundations for dwellings outside the scope of NZS 3604:2011 require specific engineering design.

General foundation design and construction advice is as follows:

- 1 Foundations should be excavated through the topsoil layer and bear onto competent subgrade material.
- 2 Beneath the lightly loaded floor slab area, all turf and topsoil shall be removed to at least 100mm bgl, along with any deeper areas of soft or organic rich topsoil. The depth of the topsoil strip shall be confirmed at the time of inspection (as described in Section 5 below) to confirm a satisfactory surface is achieved. The subgrade will then need to be proof-rolled or compacted to achieve a firm uniform surface. The area can then be backfilled by placing and compacting AP40 sandy gravel in maximum 200mm thick loose layers to achieve a minimum dry density of 2150kg/m³ up to the underside of the floor slab.
- 3 Internal floor slab thickenings and any other pads that are supporting concentrations of weight from roof trusses or columns shall be supported on, or be replaced with, mass concrete filled pads of the same area that are excavated through the topsoil and bear onto competent subgrade material.

3 Hydraulic penetrometer testing was undertaken by Canterbury Geotest Ltd.

4 Ministry of Business, Innovation & Employment "Guidance: Repairing and Rebuilding houses affected by the Canterbury earthquakes".

- 4 Reinforcing in floor slabs shall be a minimum of 2.27kg/m² welded reinforcing mesh sheets (1.14kg/m² in each direction) and the reinforcing is to be Ductility Class E in accordance with NZS 4671.

5 Inspection Requirements

A suitably competent and experienced inspector should validate that the ground conditions exposed in the excavations are consistent with the findings of this report and the foundation design assumptions. Loose material should be removed from excavations. Foundations should bear onto competent subgrade material.

The inspection can be undertaken by Council personnel or a consultant's engineering personnel.

Please contact us with 48 hours' notice if you require Eliot Sinclair & Partners to undertake the inspection work. Following a satisfactory inspection, we will provide a *'Producer Statement - Construction Review'* to validate the exposed ground conditions.

6 Disclaimer

Comments made in this report are based on reporting by others, our earthworks reporting, our soil investigations, and the Ministry of Business Innovation & Employment Guidelines.

Whilst every care was taken during our investigation and interpretation of subsurface conditions, there may well be subsoil strata and features that were not detected. Additionally, on-going seismicity in the general area may lead to deterioration or additional ground movement that could not have been anticipated at time of writing of this report.

The exposure of such conditions, or occurrence of additional strong seismicity, or any future update of MBIE's guidelines or the NZBC, may require a review of our recommendations. Eliot Sinclair & Partners should be contacted to confirm the validity of this report should this occur.

This report has been prepared for the benefit of Ngāi Tahu Property (or purchasers of the site from Ngāi Tahu Property), and the Christchurch City Council. No liability is accepted by this company or any employee of this company with respect to the use of this report by any other party.

Yours sincerely
ELIOT SINCLAIR & PARTNERS LTD

Prepared By:



Jeffrey Fleming
NZDipEng (Civil)
Geotechnical Engineering Technician

Reviewed & Approved for Release By:

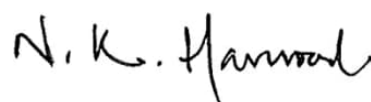

Nick Harwood
BE(Hons) MSc DIC IntPE(NZ) CMEngNZ CPEng (1007273)
Principal
Senior Geotechnical Engineer

Encl.

- Site Investigation Records – 7 pages.
- Eliot Sinclair & Partners drawings: *"Karamū Stage 2 Kākāpō - Geotechnical Test Locations with Controlled Fill Thickness Contours Excluding Topsoil"*, Project No. 419750, Set No. G4, Sheet No. 1 & 2; Rev. B.

SITE INVESTIGATION RECORD

Client **Ngāi Tahu Property**

Site **Stage 2 (Kākāpō), Karamū Subdivision, Riccarton, Christchurch**

Lot **812**
D.P. **530544**

Technical Category
TC1 Equivalent

SCALA PENETROMETER TEST RESULTS

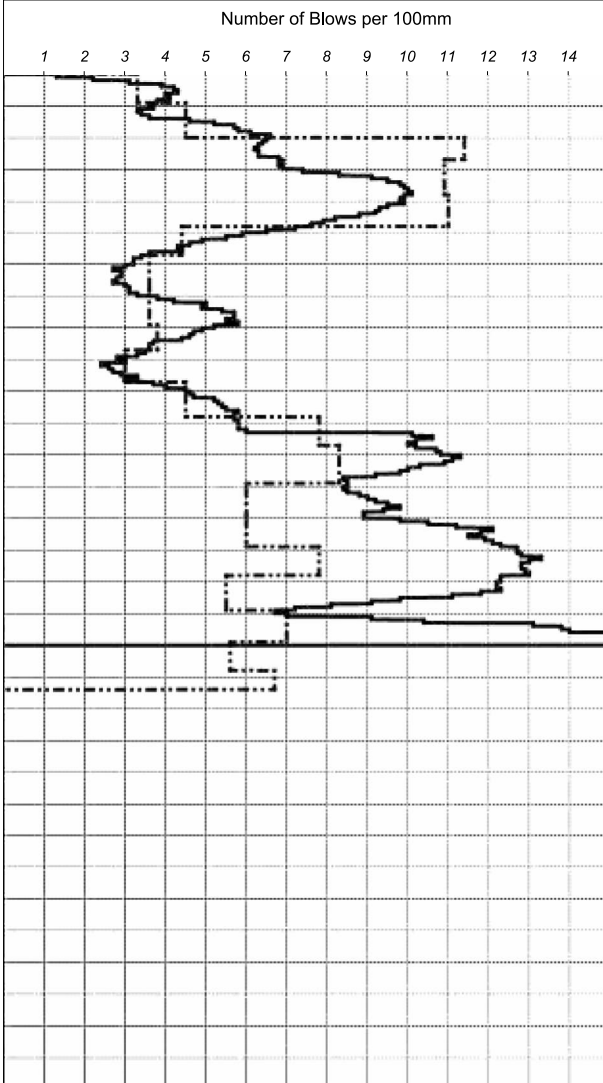

— Lot 812A P03 - - - Lot 812B P04

SOIL PROFILE

Depth (m)	Test Location - Lot 812A A	Water
0.0 - 0.2	FILL: silty TOPSOIL; dark brown. Non-plastic; moist; trace rootlets.	Groundwater Not Encountered
0.2 - 0.4	SILT; greyish brown. Non-plastic; moist.	
0.4 - 0.8	0.80m: Trace iron staining	
0.8 - 1.0	Sandy SILT; greyish. Non-plastic; moist; sand, fine; trace iron staining.	
1.0 - 1.4	Silty fine SAND; greyish brown. Moist; some iron staining.	
1.4 - 1.8	Sandy SILT; greyish brown. Non-plastic; moist to wet; some iron staining.	Groundwater Not Encountered
1.8 - 2.0	EOH: 1.9m - Inferred gravel, unable to auger further.	
2.0 - 2.2		
2.2 - 2.4		
2.4 - 2.6		
2.6 - 2.8		Groundwater Not Encountered
2.8 - 3.0		

COMMENTS

"Lot 812A P03" undertaken by Canterbury Geotest Ltd using their Hydraulic penetrometer rig. Conventional Scala penetrometer "Lot 812B P04" undertaken by Eliot Sinclair.

SITE PLAN (Not to Scale)

Eliot Sinclair & Partners drawings: "Karamu Stage 2 Kakapo - Geotechnical Test Locations with Controlled Fill Thickness Contours Excluding Topsoil", Project No. 419750, Set No. G4, Sheet No. 1 & 2; Rev. B.

Field Staff:

CAO/JSF

Prepared By:

CAO

Investigation Type

☒ Hand Auger

☐ Spade Hole

☐ Test Pit

Job Manager:

MAA

Approved By:

NKH

SITE INVESTIGATION RECORD

Client **Ngāi Tahu Property**

Site **Stage 2 (Kākāpō), Karamū Subdivision, Riccarton, Christchurch**

Lot **812**
D.P. **530544**
Technical Category
TC1 Equivalent

SCALA PENETROMETER TEST RESULTS

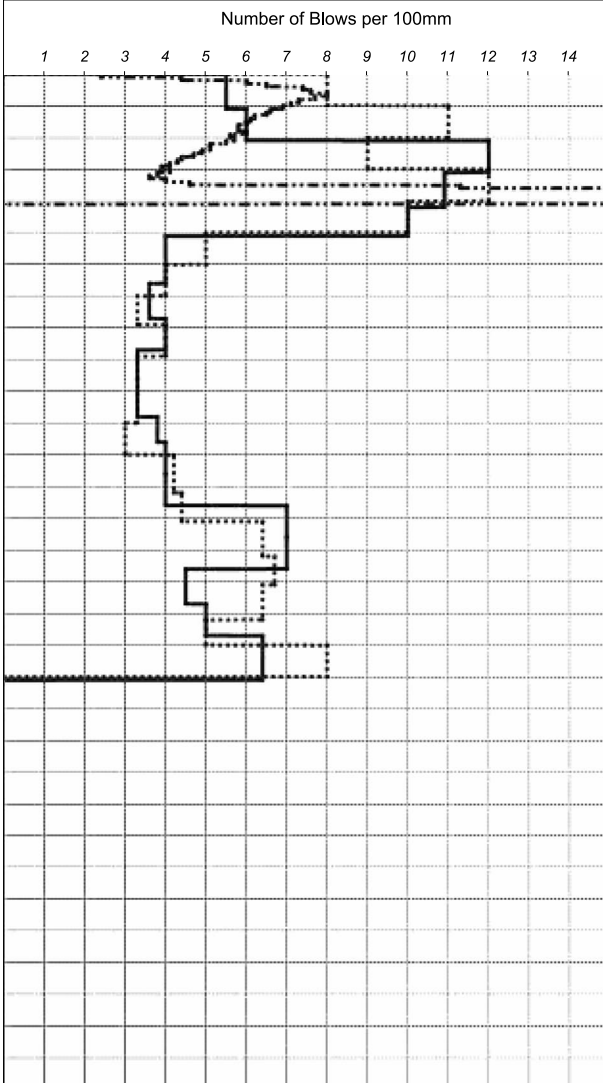

— Lot 812C P05 - - - Lot 812C P16 . . . Lot 812D P06

SOIL PROFILE

Depth (m)	Test Location - Lot 812C B	Water
0.0 - 0.2	FILL: silty TOPSOIL. Trace rootlets.	Groundwater Not Encountered
0.2 - 0.4	SAND; light brown.	
0.4 - 0.6	Sandy SILT; light brown. Damp.	
0.6 - 1.2	Sandy SILT; light brown. Some iron staining.	
1.2 - 2.0	Sandy SILT; light brown. Sand, fine; some iron staining.	
2.0 - 2.2	EOH: 2.2m - Inferred gravel, unable to auger further.	
2.2 - 3.0		

COMMENTS

Conventional Scala penetrometers "Lot 812C P05" and "Lot 812D P06" undertaken by Eliot Sinclair. "Lot 812C P16" undertaken by Canterbury Geotest Ltd using their Hydraulic penetrometer rig

SITE PLAN (Not to Scale)

Eliot Sinclair & Partners drawings: "Karamu Stage 2 Kakapo - Geotechnical Test Locations with Controlled Fill Thickness Contours Excluding Topsoil", Project No. 419750, Set No. G4, Sheet No. 1 & 2; Rev. B.

Field Staff:

CAO/JSF

Prepared By:

CAO

Investigation Type

☒ Hand Auger

☐ Spade Hole

☐ Test Pit

Job Manager:

MAA

Approved By:

NKH

SITE INVESTIGATION RECORD

Client **Ngāi Tahu Property** Site **Stage 2 (Kākāpō), Karamū Subdivision, Riccarton, Christchurch** Lot **812**
D.P. **530544** Technical Category **TC1 Equivalent**

SCALA PENETROMETER TEST RESULTS

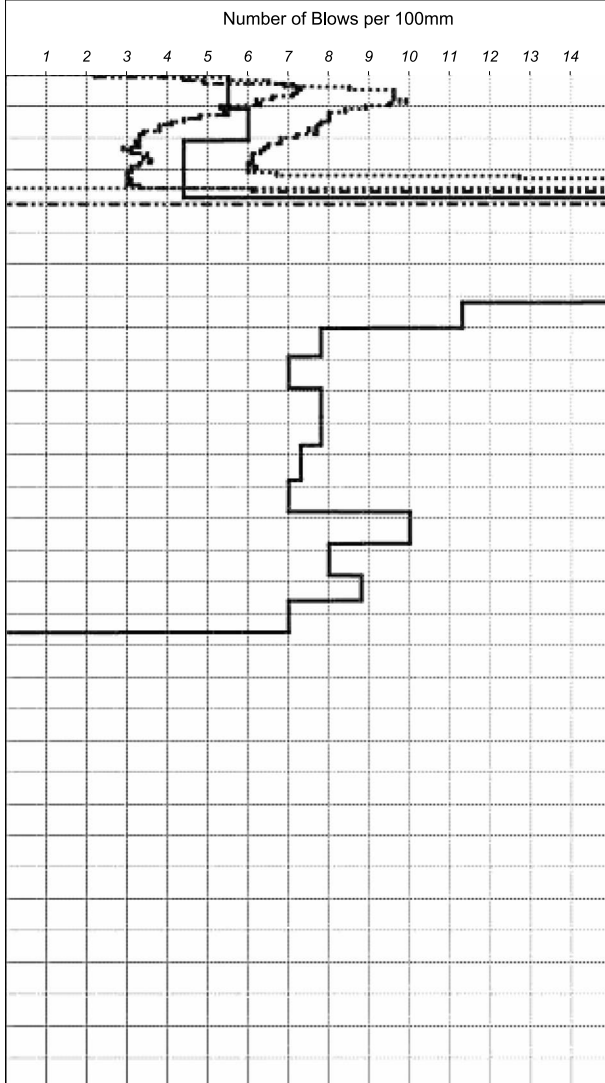

SOIL PROFILE

Depth (m)	Test Location - Lot 812K C	Water
0.0 - 0.2	FILL: silty TOPSOIL; dark brown. Non-plastic; dry; trace rootlets present, some light brown seams.	Groundwater Not Encountered
0.2 - 0.4	SILT; brown. Non-plastic; dry.	
0.4 - 0.6		
0.6 - 0.8		
0.8 - 1.0	1.00m: Some iron staining.	
1.0 - 1.2	Silty fine to medium SAND; greyish brown. Moist; some iron staining present.	
1.2 - 1.4	SILT; greyish brown. Non-plastic; moist; some iron staining present.	
1.4 - 1.6	Fine to medium SAND, with minor silt; greyish brown. Moist; some iron staining present.	
1.6 - 1.8	Sandy SILT; greyish brown. Non-plastic; moist; sand, fine; some iron staining present.	
1.8 - 2.0	Silty fine to medium SAND; greyish brown. Moist; some iron staining present.	
2.0 - 2.2	Sandy SILT; greyish brown. Non-plastic; moist; sand, fine; some iron staining present.	
2.2 - 2.4		
2.4 - 2.6	EOH: 2.5m - Stop - Inferred Gravel - Practical Refusal	
2.6 - 2.8		
2.8 - 3.0		

COMMENTS

Conventional Scala penetrometer "Lot 812K DCP1" undertaken by Eliot Sinclair. "Lot 812K P01" and "Lot 812K P02" undertaken by Canterbury Geotest Ltd using their Hydraulic penetrometer rig.

SITE PLAN (Not to Scale)

Eliot Sinclair & Partners drawings: "Karamu Stage 2 Kakapo - Geotechnical Test Locations with Controlled Fill Thickness Contours Excluding Topsoil", Project No. 419750, Set No. G4, Sheet No. 1 & 2; Rev. B.

Field Staff:

CAO

Prepared By:

CAO

Investigation Type

☒ Hand Auger

☐ Spade Hole

☐ Test Pit

Job Manager:

MAA

Approved By:

NKH

SITE INVESTIGATION RECORD

Client **Ngāi Tahu Property** Site **Stage 2 (Kākāpō), Karamū Subdivision, Riccarton, Christchurch** Technical Category **TC1 Equivalent**

SCALA PENETROMETER TEST RESULTS

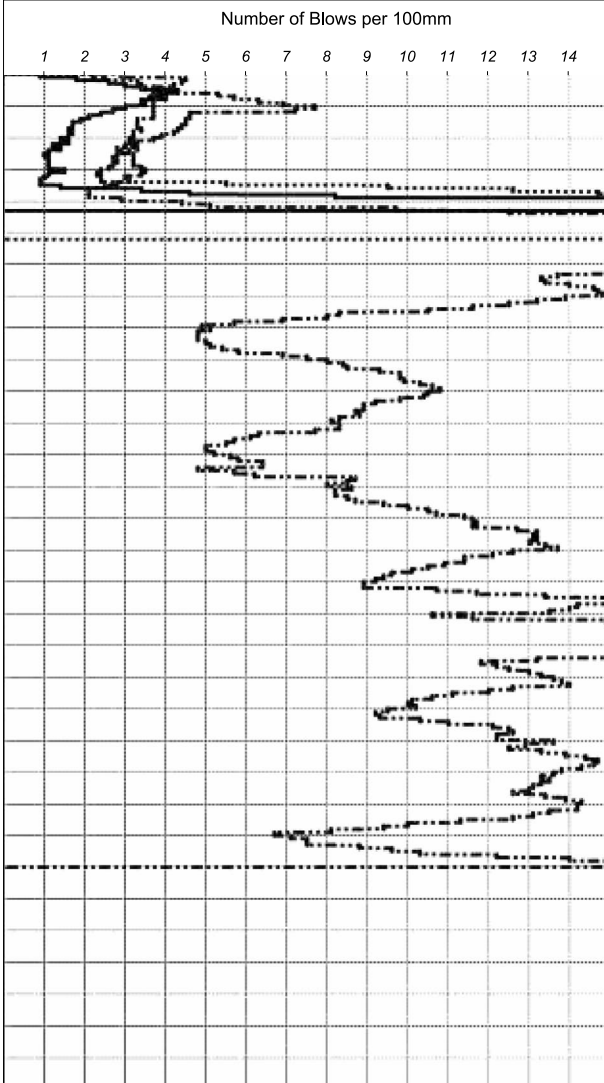

— Lot 812H P13 - - - Lot 812I P14 . . . Lot 812J P15

SITE PLAN (Not to Scale)

Eliot Sinclair & Partners drawings: "Karamu Stage 2 Kakapo - Geotechnical Test Locations with Controlled Fill Thickness Contours Excluding Topsoil", Project No. 419750, Set No. G4, Sheet No. 1 & 2; Rev. B.

SOIL PROFILE

Depth (m)	Test Location - Lot 812I D	Water
0.2	FILL: silty TOPSOIL, with minor gravel, with trace sand; dark brown. Non-plastic; damp; gravel, fine to coarse, round to subround; trace rootlets present.	Groundwater Not Encountered
0.4	FILL: gravelly fine to medium SAND, with minor silt; brownish grey. Moist; gravel, fine to coarse, round to subround.	
0.6		
0.8	SILT, with trace sand; greyish brown. Non-plastic; moist.	
1.0		
1.2		
1.4		Groundwater Not Encountered
1.6	Fine to medium SAND, with minor silt; greyish brown. Wet.	
1.8		
2.0		
2.2		
2.4	Sandy SILT; greyish brown. Non-plastic; wet.	
2.6	EOH: 2.45m - Stop - Inferred Gravel - Practical Refusal.	
2.8		Groundwater Not Encountered
3.0		

COMMENTS

Scala Penetrometers undertaken by Canterbury Geotest Ltd using their Hydraulic penetrometer rig.

Field Staff:

SF

Prepared By:

LBW

Investigation Type

☒ Hand Auger

☐ Spade Hole

☐ Test Pit

Job Manager:

MAA

Approved By:

NKH

SITE INVESTIGATION RECORD

Client **Ngāi Tahu Property**

Site **Stage 2 (Kākāpō), Karamū Subdivision, Riccarton, Christchurch**

Technical Category
TC1 Equivalent

SCALA PENETROMETER TEST RESULTS

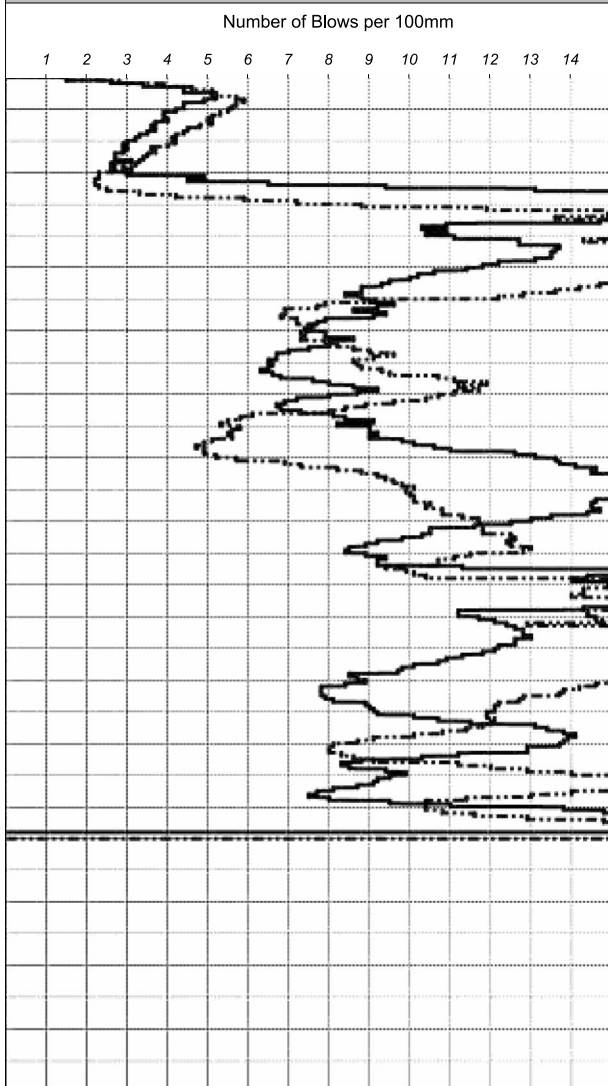

SOIL PROFILE

Depth (m)	Test Location - Lot 812G E	Water
0.2	FILL: silty TOPSOIL; dark brown. Moist; trace light brown silt present, trace rootlets present.	Groundwater Not Encountered
0.4	FILL: sandy gravelly SILT; brownish grey. Moist; well graded.	
0.6	Sandy SILT; brownish grey. Moist to wet; well graded; sand, fine to coarse; trace iron staining present.	
0.8		
1.0		
1.2	1.15m: Becoming moist-wet	
1.4	Sandy SILT; greyish brown. Non-plastic; moist to wet; trace iron staining present.	
1.6	Fine to coarse SAND, with trace silt; brownish grey. Wet; well graded; trace iron staining present.	
1.8	Fine to coarse SAND, with trace silt; brownish grey. Wet; well graded; trace iron staining present.	
2.0	Fine to coarse SAND; brownish grey. Wet; well graded; trace iron staining present.	
2.2	Sandy SILT; greyish brown. Non-plastic; wet; trace iron staining present.	
2.4	EOH: 2.35m - Stop - Inferred Gravel - Practical Refusal	
2.6		
2.8		
3.0		

— Lot 812G P11 - - - Lot 812G P12

COMMENTS

Scala Penetrometers undertaken by Canterbury Geotest Ltd using their Hydraulic penetrometer rig.

SITE PLAN (Not to Scale)

Eliot Sinclair & Partners drawings: "Karamu Stage 2 Kakapo - Geotechnical Test Locations with Controlled Fill Thickness Contours Excluding Topsoil", Project No. 419750, Set No. G4, Sheet No. 1 & 2; Rev. B.

Field Staff:

LBW

Prepared By:

RGO/LBW

Investigation Type

☐ Hand Auger

☐ Spade Hole

☐ Test Pit

Job Manager:

MAA

Approved By:

NKH

SITE INVESTIGATION RECORD

Client **Ngāi Tahu Property**

Site **Stage 2 (Kākāpō), Karamū Subdivision, Riccarton, Christchurch**

Lot **812**
D.P. **530544**
Technical Category
TC1 Equivalent

SCALA PENETROMETER TEST RESULTS

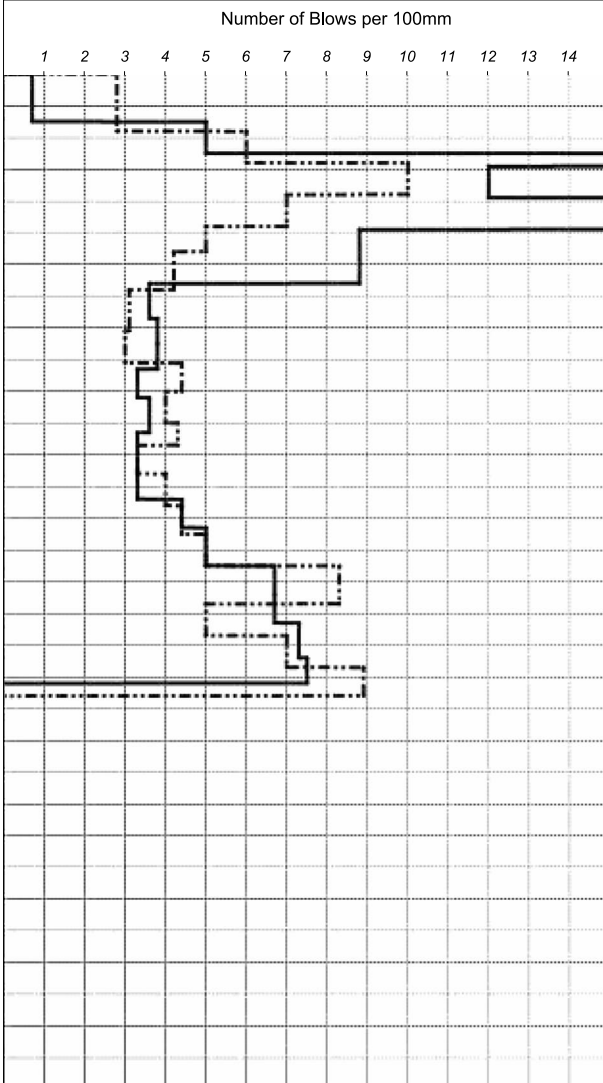

— Lot 812E P07 - - - Lot 812E P08

Depth (m)

SOIL PROFILE

Test Location - Lot 812E F

Water

0.2m: FILL: silty TOPSOIL; dark brown. Non-plastic; moist; trace rootlets.

0.4m: Sandy SILT; light brown. Moist; sand, fine; trace iron staining.

1.2m: Silty fine to medium SAND; greyish brown. Some iron staining.

1.4m: Sandy SILT; greyish brown. Non-plastic; moist; some iron staining.

1.6m: Fine SAND; greyish brown. Moist; mottled iron staining.

2.0m: EOH: 2m - Inferred gravel, unable to auger further.

Groundwater Not Encountered

COMMENTS

Conventional Scala penetrometers "Lot 812E P07" and "Lot 812E P08" undertaken by Eliot Sinclair

SITE PLAN (Not to Scale)

Eliot Sinclair & Partners drawings: "Karamu Stage 2 Kakapo - Geotechnical Test Locations with Controlled Fill Thickness Contours Excluding Topsoil", Project No. 419750, Set No. G4, Sheet No. 1 & 2; Rev. B.

Field Staff:

CAO/JSF

Prepared By:

CAO

Investigation Type

☒ Hand Auger

☐ Spade Hole

☐ Test Pit

Job Manager:

MAA

Approved By:

NKH

SITE INVESTIGATION RECORD

Client **Ngāi Tahu Property** Site **Stage 2 (Kākāpō), Karamū Subdivision, Riccarton, Christchurch** Lot **812**
D.P. **530544** Technical Category **TC1 Equivalent**

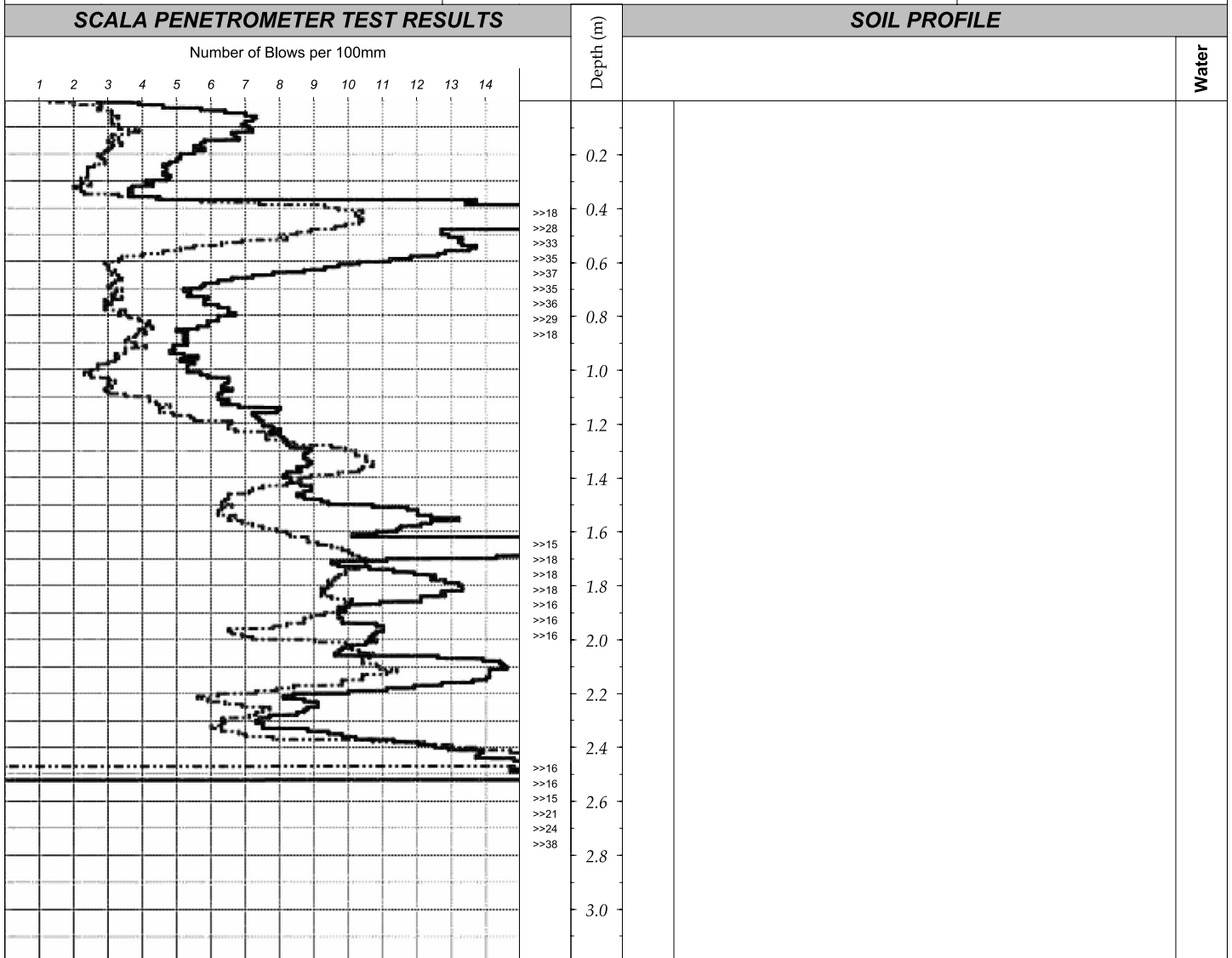

— Lot 812F P09 - - - Lot 812F P10

SITE PLAN (Not to Scale)

Eliot Sinclair & Partners drawings: "Karamu Stage 2 Kakapo - Geotechnical Test Locations with Controlled Fill Thickness Contours Excluding Topsoil", Project No. 419750, Set No. G4, Sheet No. 1 & 2; Rev. B.

COMMENTS

Scala Penetrometers undertaken by Canterbury Geotest Ltd using their Hydraulic penetrometer rig.

Field Staff:

Canterbury Geotest

Prepared By:

RGO/LBW

Investigation Type

☐ Hand Auger

☐ Spade Hole

☐ Test Pit

Job Manager:

MAA

Approved By:

NKH

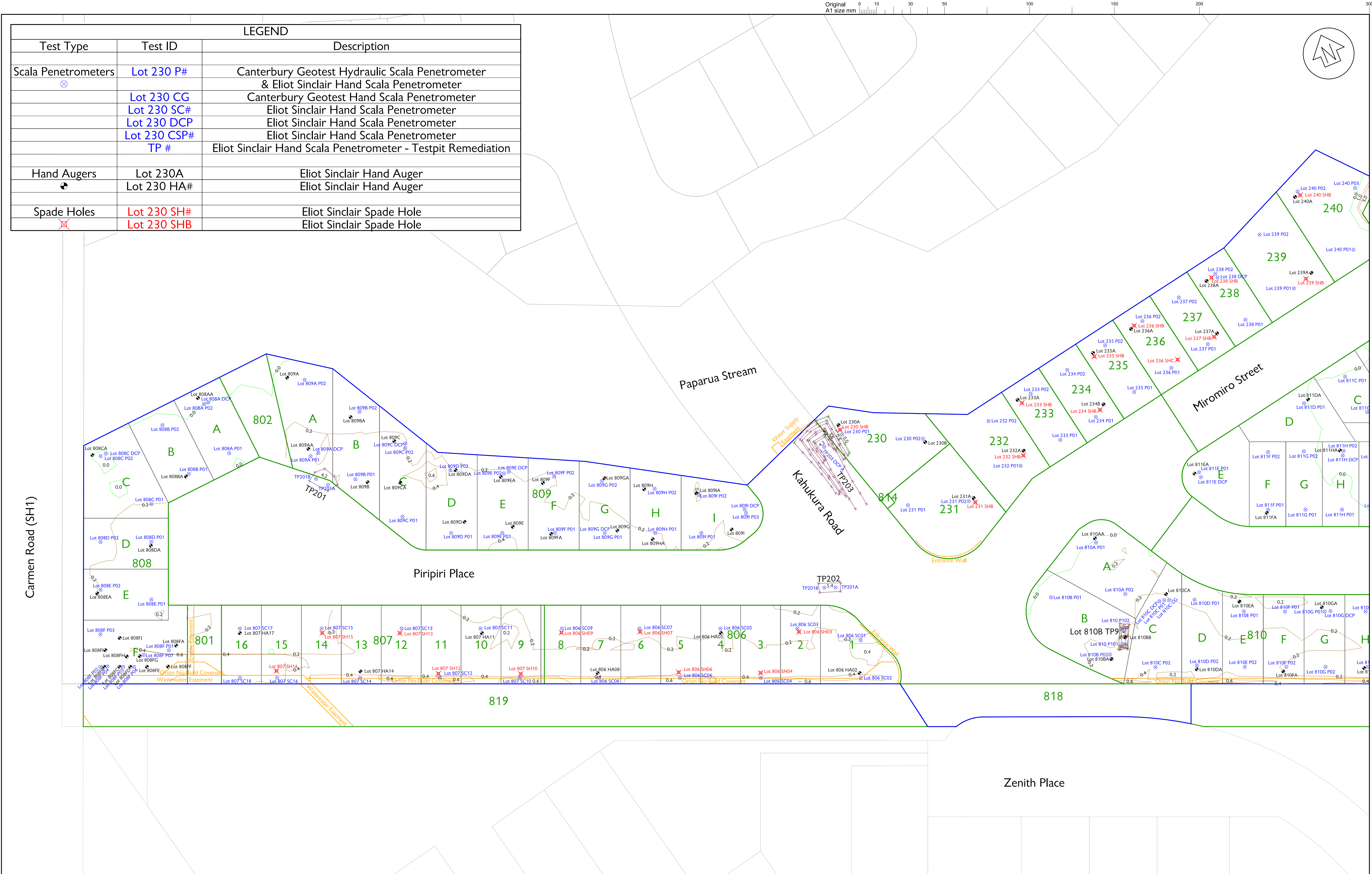

Rev.	Description	Drawn	Date	Surveyed:	Survey Date:	Name	Date	Client	Project Title	Project No.	Set No.	Sht No.	Rev.
A	-	WFP	26.08.2019	R Paulsen	to July 2019	Designed	-	NGĀI TAHU Property	Karamū Stage 2 Kākāpō	419750	G4	1	B
B	Lot 809D, Lot 809G DCP, Lot 810B TP9 amended	WFP	26.08.2019	Coord System: NZGD 2000 Mt Pleasant		Drawn	W Paulsen		Geotechnical Test Locations with Controlled Fill Thickness Contours Excluding Topsoil	<div>Eliot Sinclair</div> <div>surveyors engineers planners</div>			
				Calibration: CDD City 2014		Drig. Chk	J Fleming						
				Origin of Levels: EHCH	Datum: CDD 2014	Proj. Mgr	M A Allan						
				Masonry nail & washer in kerb 148 Yaldhurst Road R.L. 31.287m		Design Review	-						
						Approved	-		Scales 1:400 [A1] 1:800 [A3]				

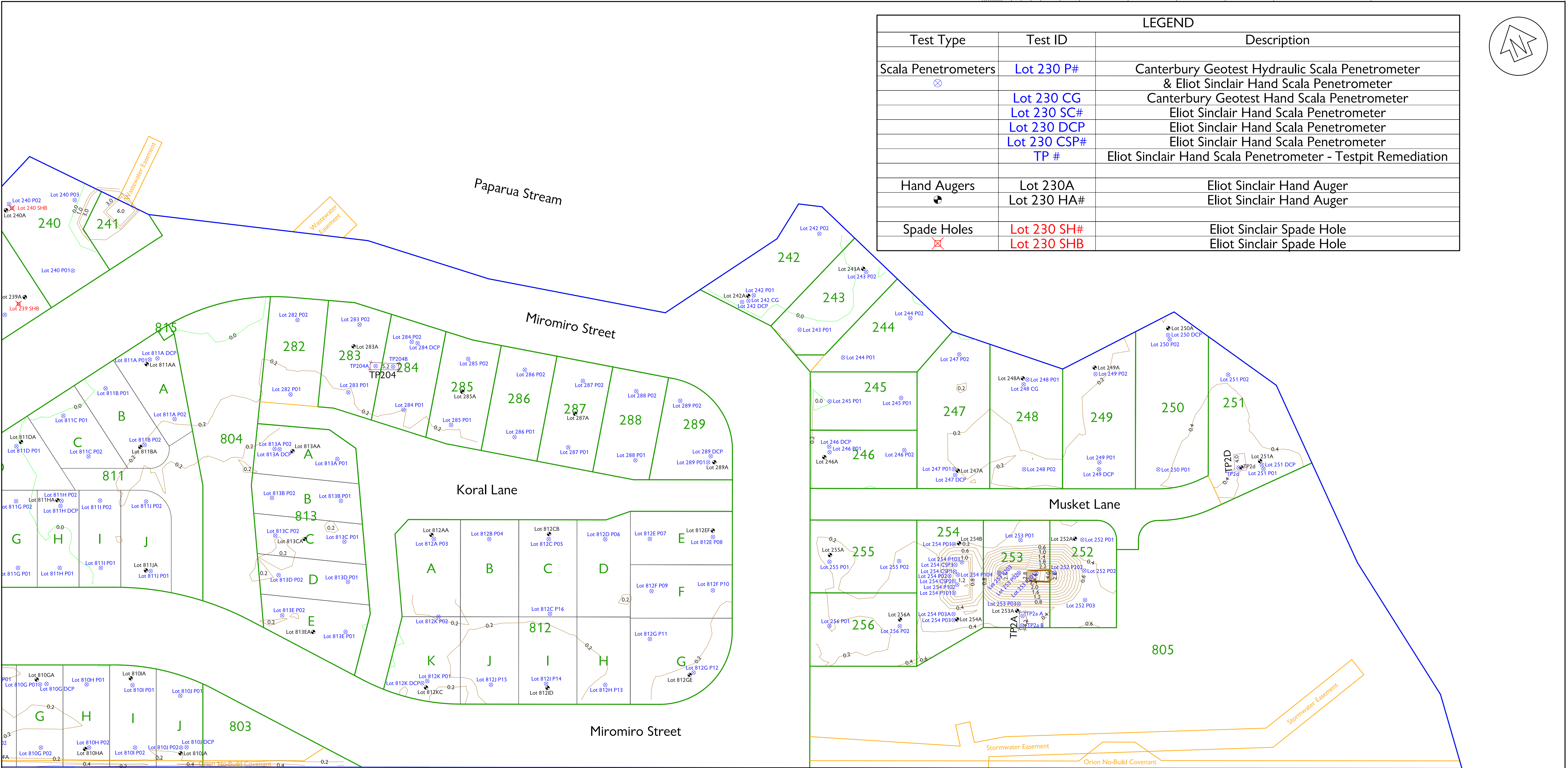

LEGEND		
Test Type	Test ID	Description
Scala Penetrometers ⊗	Lot 230 P#	Canterbury Geotest Hydraulic Scala Penetrometer & Eliot Sinclair Hand Scala Penetrometer
	Lot 230 CG	Canterbury Geotest Hand Scala Penetrometer
	Lot 230 SC#	Eliot Sinclair Hand Scala Penetrometer
	Lot 230 DCP	Eliot Sinclair Hand Scala Penetrometer
	Lot 230 CSP#	Eliot Sinclair Hand Scala Penetrometer
	TP #	Eliot Sinclair Hand Scala Penetrometer - Testpit Remediation
Hand Augers ⊙	Lot 230A	Eliot Sinclair Hand Auger
	Lot 230 HA#	Eliot Sinclair Hand Auger
Spade Holes ⊗	Lot 230 SH#	Eliot Sinclair Spade Hole
	Lot 230 SHB	Eliot Sinclair Spade Hole

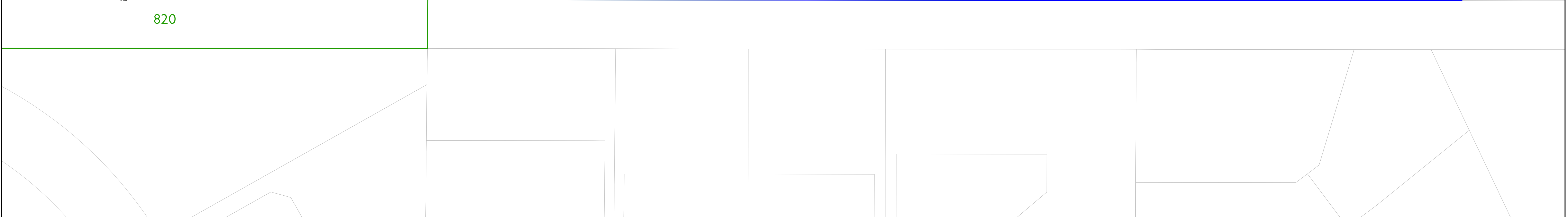
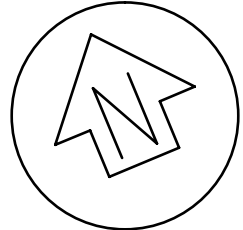

Rev.	Description			Drawn	Date	Surveyed: R Paulsen	Survey Date: to July 2019		Name	Date	Client <div>NGĀI TAHU Property</div>	Project Title Karamū Stage 2 Kākāpō		Project No. 419750	Set No. G4	Sht No. 2	Rev. B
A	-			WFP	26.08.2019	Coord System: NZGD 2000 Mt Pleasant		Designed	-	-		Drawing Title Geotechnical Test Locations with Controlled Fill Thickness Contours Excluding Topsoil	Eliot Sinclair surveyors engineers planners				
B	Lot 809D, Lot 809G DCP, Lot 810B TP9 amended			WFP	26.08.2019			Drawn	W Paulsen	26.08.2019							
								Drng. Chk	J Fleming	26.08.2019							
						Calibration: CDD City 2014	Proj. Mgr	M A Allan	-								
						Origin of Levels: EHCH	Datum: CDD 2014	Design Review	-	Date				-			
						Masonry nail & washer in kerb 148 Yaldhurst Road R.L. 31.287m		Approved	-	Date		-					
													Scales 1:400 [A1] 1:800 [A3]				

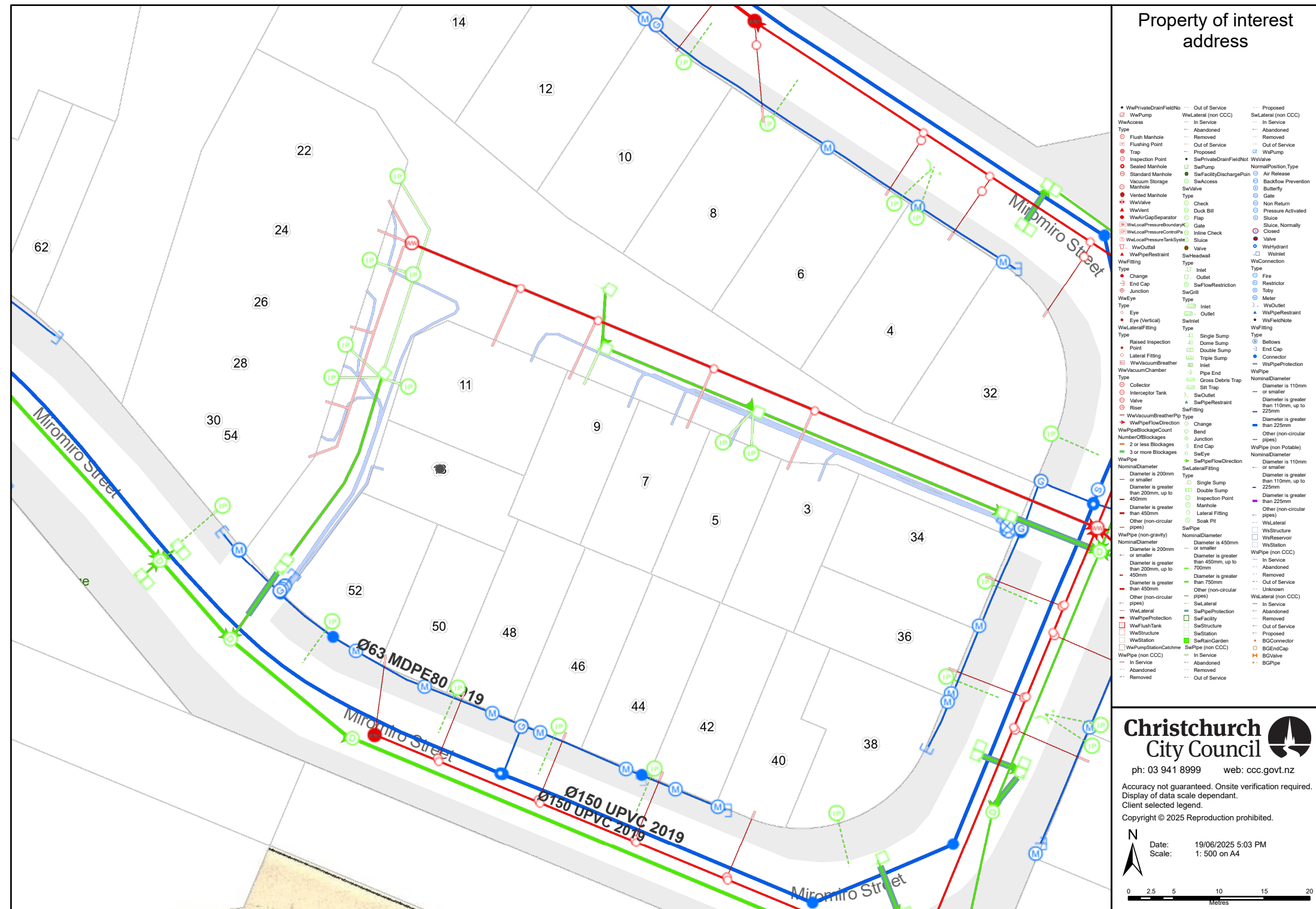

O 6T
x 1P.

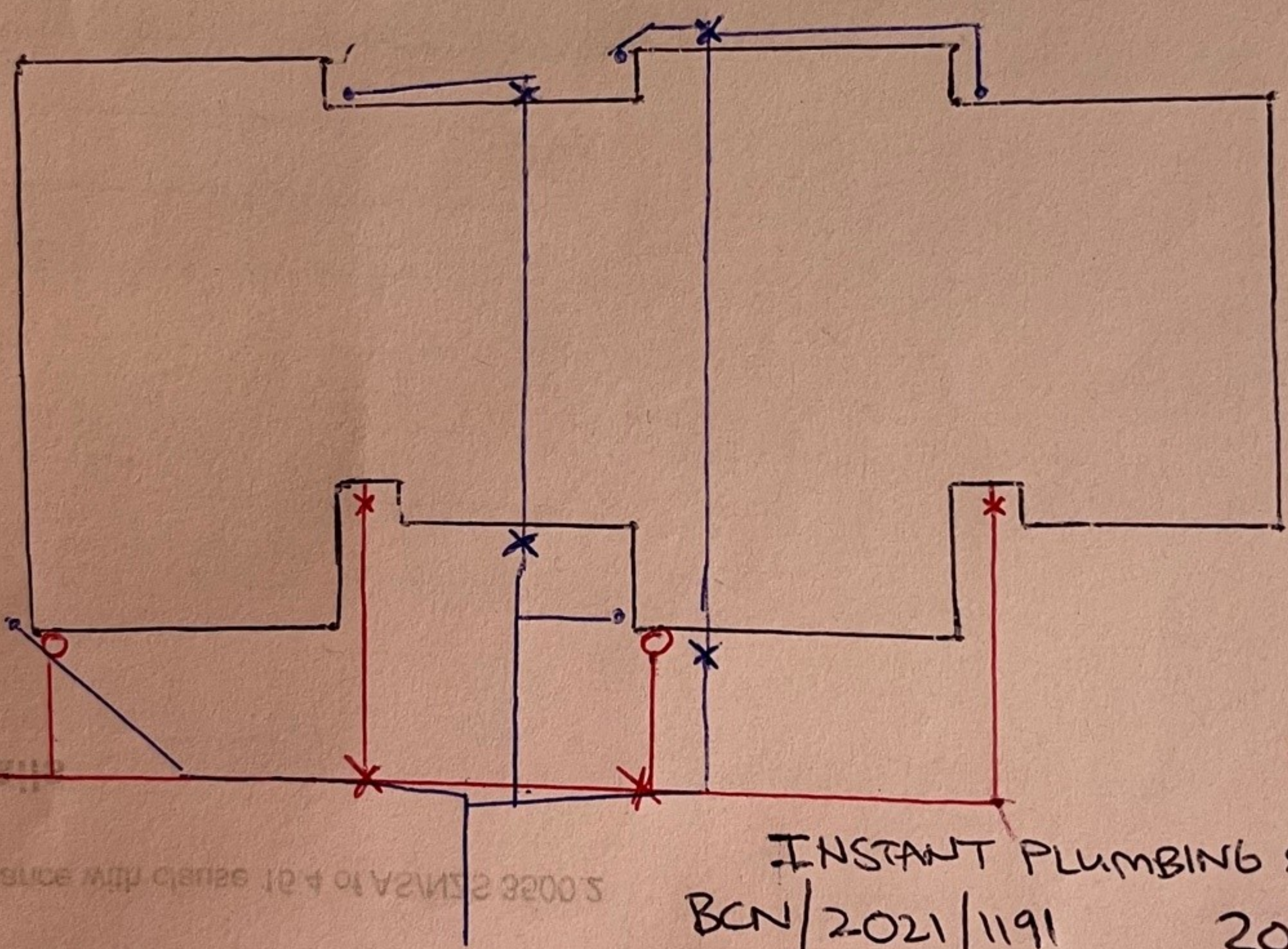

INSTANT PLUMBING & DRAINAGE
BCN/2021/1191 20/05/21
Matt Robinson #26564
Sewer 1:60 Stormwater 1:100.



- X - INSPECTION POINT.
- O - OVERFLOW RELIEF GULLY.
- I - 100mm PVC 1:60
- I - 100mm PVC 1:100

AS/NZ 3500 SYSTEM.

site information		
address miromiro st christchurch	site area:	2613m ²
	building floor area:	1151m ²
legal description lot 812 dp 530544	site coverage:	44%
	impervious area:	1447m ²
	impervious area site coverage:	55%

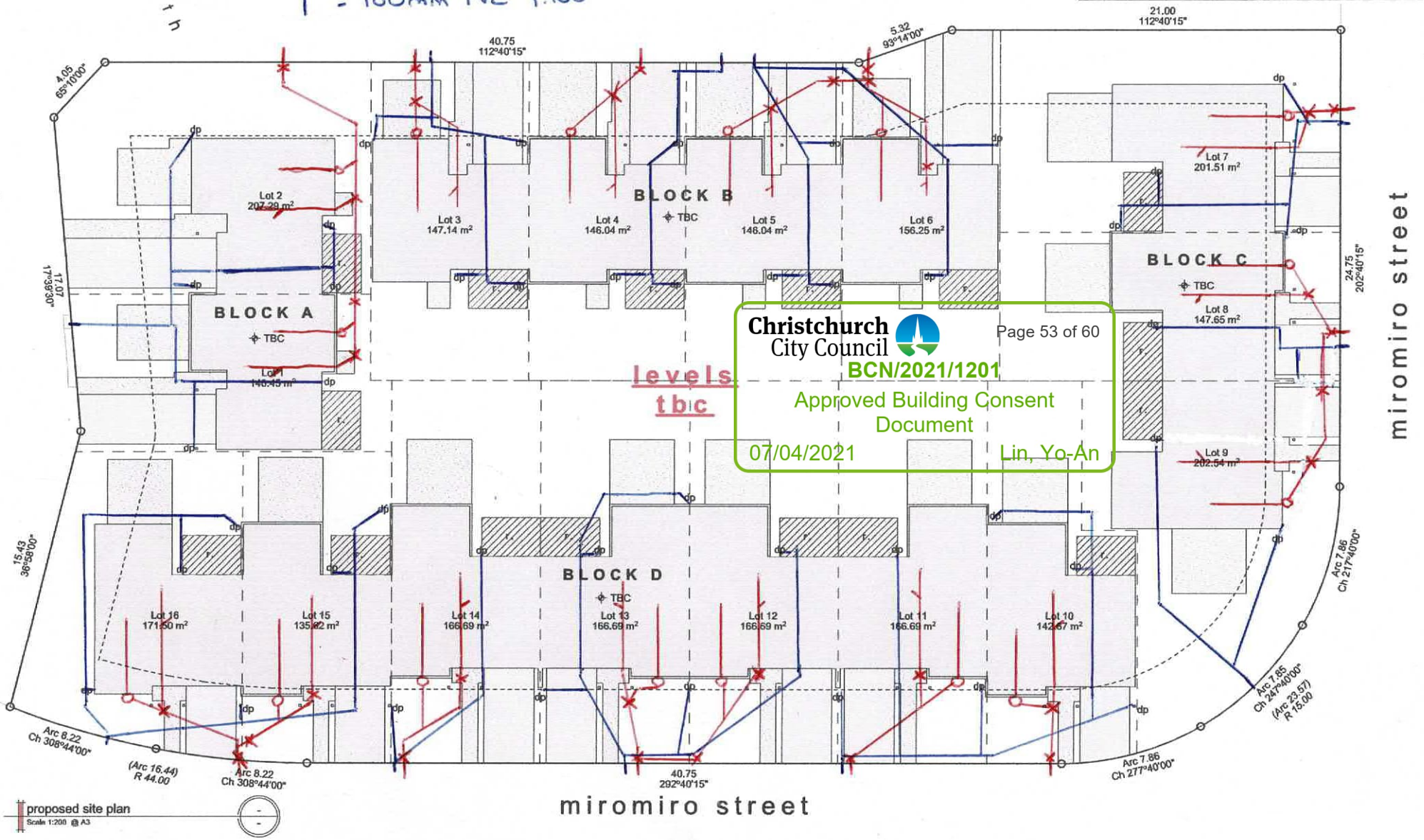

HOT WATER CYLINDER DRAIN TO BE
RUN IN 40mm THERMAL PIPE TO
A SOAK HOLE WITH VERNON FLAP

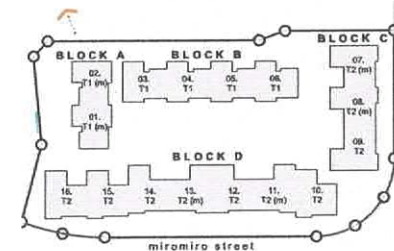
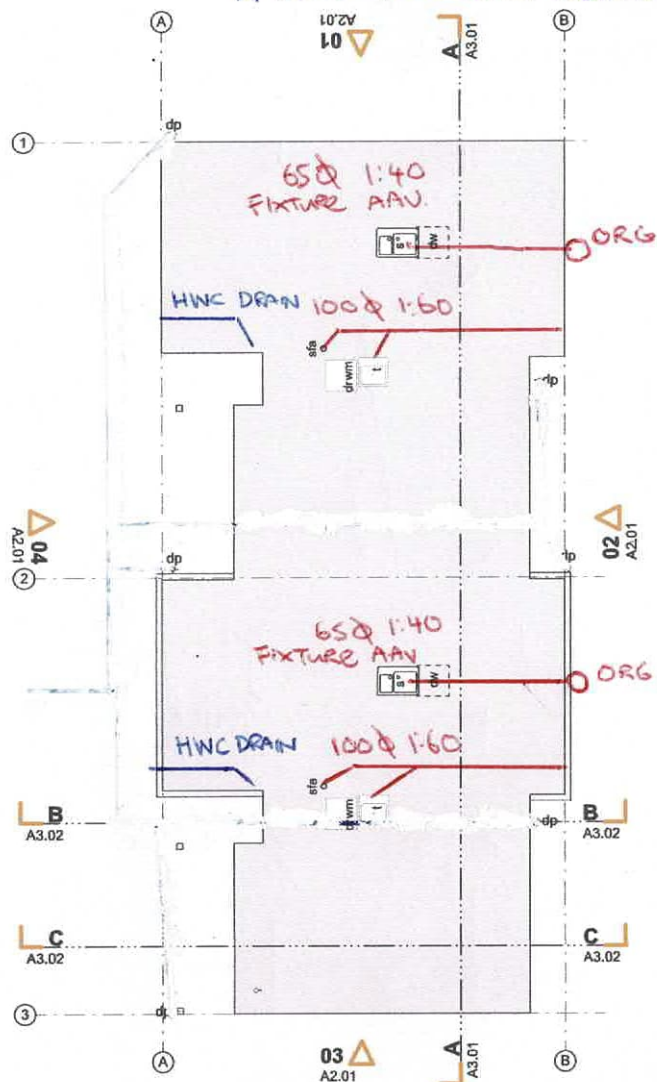

Christchurch
City Council

BCN/2021/1201

Approved Building Consent
Document

07/04/2021

Page 54 of 60

Lin, Yo-An

slab plan: block A
Scale 1:100 @ A3

FOLEY GROUP

home.

KARAMU DEVELOPMENT - LOT 812
for HOME
MIROMIRO STREET, CHRISTCHURCH

rev. date description

1224
A1.01

slab plan: Blocks A & C





**WRIGHT
WIRE
ELECTRICAL**
Right stuff the Wright way

ELECTRICAL CERTIFICATE OF COMPLIANCE AND ELECTRICAL SAFETY CERTIFICATE



Reference / Certificate ID No:

13 KORAL LANE

This form has been designed to be used by licensed electrical workers to certify that installations or part installations under Part 2 of AS/NZS 3000 are safe to be connected to the specified system of electrical supply.

Location Details:

13 KORAL LANE LOT 812 MIT 1

Contact Details:

(Name and Address)

Name of Electrical Worker:

NATHAN POTTS

Registration / Practising License Number:

E273310

Organisation / Company:

WRIGHT WIRE ELECTRICAL LIMITED

Phone:

0800 699 744

Email:

admin@wrightwire.co.nz

Name of Person(s) Supervised:

MATT

COC

Type of work:

☐ Additions

☐ Alterations

☒ New Work

The prescribed electrical work is:

☐ Low Risk

☐ General

☒ High Risk (Specify):

Indicate the number of each item installed or altered:

Lighting Outlets:

☒

Socket Outlets:

☒

Ranges:

☒

Water Heaters:

☒

Description of Work: (including date/s of work and type of supply system)

16mm² NS MAINS

6mm² earth stake

I certify that the completed prescribed electrical work to which this Certificate of Compliance applies has been done lawfully and safely, and the information in the certificate is correct in that installation, or part of the installation:

Select those that apply:

- ☐ Has been installed in accordance with the specified certified design¹
- ☒ Has an earthing system that is correctly rated (where applicable)
- ☒ Contains fittings that are safe to connect to power supply
- ☒ Relies on a supplier Declaration of Conformity¹
- ☒ Relies on a manufacturer's instructions¹
- ☒ Has been satisfactorily tested in accordance with the Electrical (Safety) Regulations 2010
- ☒ Is safe to connect

Electronic/Other Reference:

Certifier's Signature:

Date:

23/11/21

¹ Attach or reference. If it is impractical to attach a copy of a particular manufacturer's instructions, or of any certified design or supplier declaration of conformity, provide a reference to where the documents can be found, in a readily accessible format, by electronic means.

ESC

I certify that the installation, or part of the installation, to which this Electrical Safety Certificate applies is connected to a power supply and is safe to use.

Certifier's Name:

NATHAN POTTS

Registration / Practising License Number:

E273310

Certifier's Signature:

Certificate Issue Date:

23/11/21

Connection Date:

23/11/21

CUSTOMER COPY - THIS IS AN IMPORTANT DOCUMENT AND SHOULD BE RETAINED FOR A MINIMUM OF 7 YEARS

This certificate also confirms that the electrical work complies with the building code for the purposes of Section 19(1)(e) of the Building Act 2004.



**WRIGHT
WIRE
ELECTRICAL**
Right stuff the *Wright* way

ELECTRICAL CERTIFICATE OF COMPLIANCE AND ELECTRICAL SAFETY CERTIFICATE



Reference / Certificate ID No: 812/A/1

This form has been designed to be used by licensed electrical workers to certify that installations or part installations under Part 2 of AS/NZS 3000 are safe to be connected to the specified system of electrical supply.

Location Details:

13 KORAL LANE, BROOMFIELD, CHRISTCHURCH

Contact Details:

(Name and Address)

HOME CONSTRUCTION LIMITED - 38 BIRMINGHAM DRIVE, MIDDLETON, CHRISTCHURCH

Name of Electrical Worker:

NATHAN POTTS

Registration / Practising License Number:

E273310

Organisation / Company:

WRIGHT WIRE ELECTRICAL LIMITED

Phone:

0800 699 744

Email:

admin@wrightwire.co.nz

Name of Person(s) Supervised:

JOSEPH, NICO, IAN, MATT S, ANDREW, IVAN, WALTER

COC

Type of work:

☐ Additions

☐ Alterations

☒ New Work

The prescribed electrical work is:

☐ Low Risk

☒ General

☐ High Risk (Specify):

Indicate the number of each item installed or altered:

Lighting Outlets: 29

Socket Outlets: 23

Ranges: 1

Water Heaters: 1

Description of Work: (including date/s of work and type of supply system)

FIT OFF AS PER PLAN

I certify that the completed prescribed electrical work to which this Certificate of Compliance applies has been done lawfully and safely, and the information in the certificate is correct in that installation, or part of the installation:

Select those that apply:

- ☐ Has been installed in accordance with the specified certified design¹
- ☒ Has an earthing system that is correctly rated (where applicable)
- ☒ Contains fittings that are safe to connect to power supply
- ☒ Relies on a supplier Declaration of Conformity¹
- ☒ Relies on a manufacturer's instructions¹
- ☒ Has been satisfactorily tested in accordance with the Electrical (Safety) Regulations 2010
- ☒ Is safe to connect

Test Results

Polarity (Independent Earth):	<input checked="" type="checkbox"/>
Insulation Resistance:	7999/MΩ
Earth Continuity:	0.025
Bonding:	0.035
Fault Loop Impedance:	0.32 Ω
Other (Specify):	—

Electronic/Other Reference: RADCLIFFE ELECTRICAL

Certifier's Signature:

Date: 20/12/21

¹ Attach or reference. If it is impractical to attach a copy of a particular manufacturer's instructions, or of any certified design or supplier declaration of conformity, provide a reference to where the documents can be found, in a readily accessible format, by electronic means.

ESC

I certify that the installation, or part of the installation, to which this Electrical Safety Certificate applies is connected to a power supply and is safe to use.

Certifier's Name: NATHAN POTTS

Registration / Practising License Number:

E273310

Certifier's Signature:

Certificate Issue Date:

20/12/21

Connection Date:

20/12/21

CUSTOMER COPY - THIS IS AN IMPORTANT DOCUMENT AND SHOULD BE RETAINED FOR A MINIMUM OF 7 YEARS

This certificate also confirms that the electrical work complies with the building code for the purposes of Section 19(1)(e) of the Building Act 2004.



**Record of Inspection
Code of Compliance
Electrical Safety Certificate**

Pursuant to the Electrical (safety) Regulations 2010

Reference: 920

Issuer details

Name: Brodie Mangels

Registration Number: I281933

Email : brodie@safepowerservices.co.nz

Phone: 027 241 0400

Location Details

Address: 13 Koral Lane, Broomfield, Christchurch

Type: Domestic

Contact Details

Electrical worker: N Potts

Registration #: E273310

COC Details: 13 Koral Lane

Certifying Electrical Work and ROI details

What was inspected:

New MEN switchboard, mains and main earth

High Risk Category: Mains Work -6A(2)(b)

What are the results of the inspection:

500M ohms

0.15 Ohms Earth

242 Volts

0.33 Ohms Earth Loop

729A Fault Current

Certificate of Compliance

Type: New Work

Prescribed electrical work is: High Risk

Means of compliance: Part 2, AS/NZS 3000

Additional Standards or electrical code of practice were required: No

Contains fittings that are safe to connect to a power supply? Yes

The installation has an earthing system that is correctly rated (where applicable) Yes

Parts of the installation to which this certificate relates that are safe too connect to a power supply: Electric Meter and Mains only.

Electrical Safety Certificate

By signing this document I certify that the installation up to the main switch only, to which this Electrical Safety Certificate applies is connected to a power supply that is safe to use.

Certifiers name

Brodie Mangels

Registration/Practicing licence

I281933

number

Certifiers signature

Certification Date

24/11/21

Connection Date

24/11/21

13 Koral Lane Land Use Consents

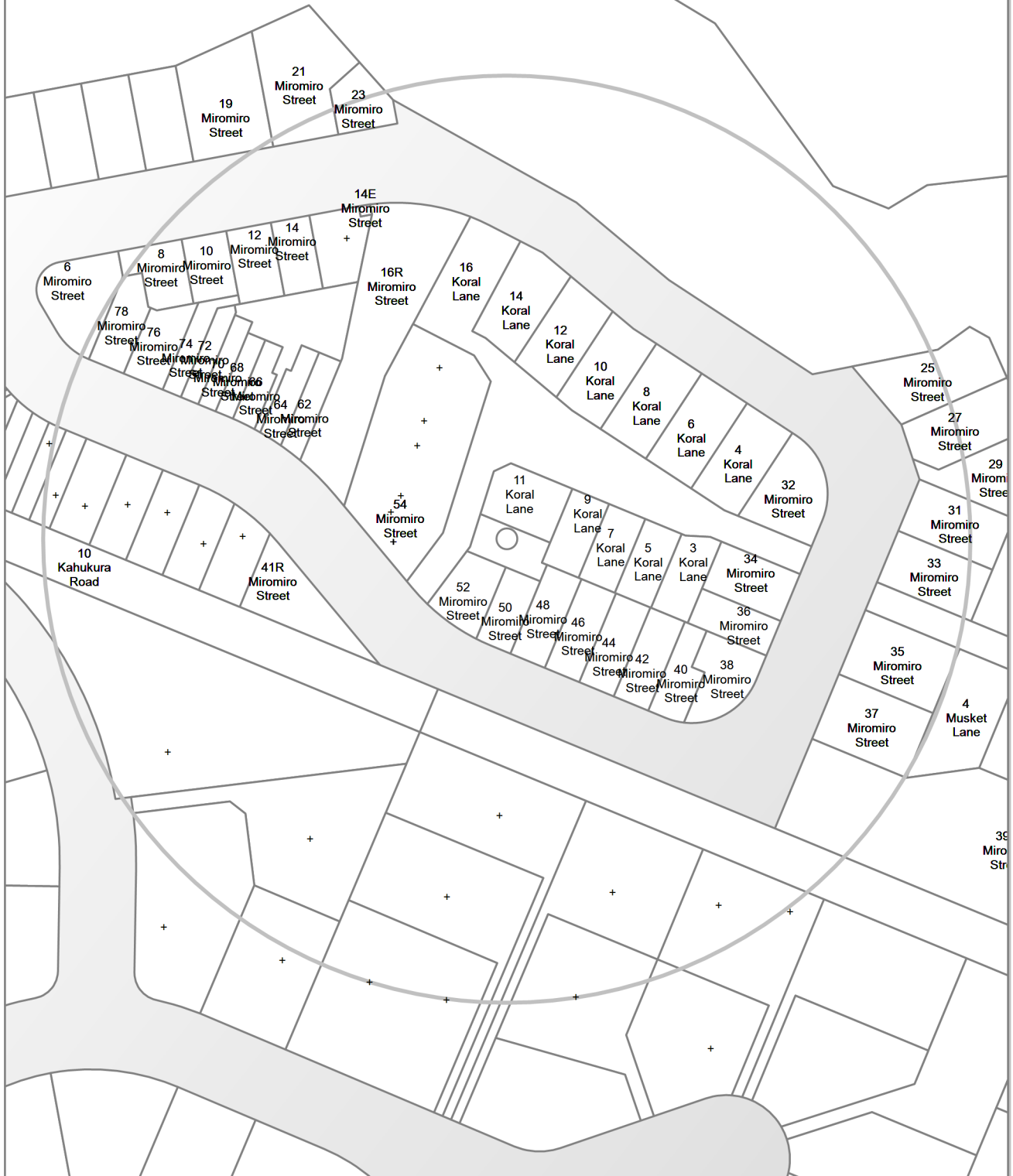

**13 Koral Lane
Subdivision Consents**

Approved

Fee simple
Lots:20
Approved

Fee simple
Lots:16
Approved



Land Use Resource Consents within 100 metres of 13 Koral Lane

Note: This list does not include subdivision Consents and Certificates of Compliance issued under the Resource Management Act.

10 Kahukura Road

RMA/1989/929

Consent to subdivide and develop land for residential purposes on land specifically identified in District scheme for horse training, racing and associated activities. - Historical Reference RES954071

Processing complete

Applied 27/10/1989

Decision issued 18/04/1990

Granted 18/04/1990

RMA/1999/1466

Consent to subdivide land which has been specifically identified within the Operative District Scheme. - Historical Reference RES954074

Processing complete

Applied 01/01/1999

Decision issued 12/05/1988

Granted 12/05/1988

RMA/2019/161

Construct a two storey dwelling with attached garage - Lot 237

Processing complete

Applied 29/01/2019

Decision issued 06/03/2019

Granted 05/03/2019

RMA/2019/2034

To Construct a Dwelling with Attached Garage (Lot 249)

Processing complete

Applied 05/09/2019

Decision issued 18/09/2019

Granted 18/09/2019

RMA/2019/2130

To Construct a Residential Dwelling with Attached Garage - CT5716 - Lot 233 Karamu

Not accepted for processing

Applied 16/09/2019

Not accepted for processing 23/09/2019

RMA/2019/2203

To Construct a Dwelling with Attached Garage - CT5716

Processing complete

Applied 25/09/2019

Decision issued 01/10/2019

Granted 30/09/2019

RMA/2019/2364

Construct dwelling with attached garage - Lot 242

Processing complete

Applied 15/10/2019

Decision issued 22/10/2019

Granted 21/10/2019

RMA/2019/2399

To Construct a Dwelling with Attached Garage - CT5780

Processing complete

Applied 18/10/2019

Decision issued 23/10/2019

Granted 23/10/2019

RMA/2019/361

Wastewater Capacity Certificate

Processing complete

Applied 22/02/2019

Certificate unable to be issued 25/03/2019

RMA/2019/593

New Dwelling with Detached Carport

Processing complete

Applied 20/03/2019

Decision issued 17/04/2019

Granted 17/04/2019

10 Koral Lane

RMA/1989/929

Consent to subdivide and develop land for residential purposes on land specifically identified in District scheme for horse training, racing and associated activities. - Historical Reference RES954071

Processing complete

Applied 27/10/1989

Decision issued 18/04/1990

Granted 18/04/1990

RMA/1999/1466

Consent to subdivide land which has been specifically identified within the Operative District Scheme. - Historical Reference RES954074

Processing complete

Applied 01/01/1999

Decision issued 12/05/1988

Granted 12/05/1988

RMA/2019/161

Construct a two storey dwelling with attached garage - Lot 237

Processing complete

Applied 29/01/2019

Decision issued 06/03/2019

Granted 05/03/2019

RMA/2019/2034

To Construct a Dwelling with Attached Garage (Lot 249)

Processing complete

Applied 05/09/2019

Decision issued 18/09/2019

Granted 18/09/2019

RMA/2019/2130

To Construct a Residential Dwelling with Attached Garage - CT5716 - Lot 233 Karamu

Not accepted for processing

Applied 16/09/2019

Not accepted for processing 23/09/2019

RMA/2019/2203

To Construct a Dwelling with Attached Garage - CT5716

Processing complete

Applied 25/09/2019

Decision issued 01/10/2019

Granted 30/09/2019

RMA/2019/2364

Construct dwelling with attached garage - Lot 242

Processing complete

Applied 15/10/2019

Decision issued 22/10/2019

Granted 21/10/2019

RMA/2019/2399

To Construct a Dwelling with Attached Garage - CT5780

Processing complete

Applied 18/10/2019

Decision issued 23/10/2019

Granted 23/10/2019

RMA/2019/361

Wastewater Capacity Certificate

Processing complete

Applied 22/02/2019

Certificate unable to be issued 25/03/2019

RMA/2019/593

New Dwelling with Detached Carport

Processing complete

Applied 20/03/2019

Decision issued 17/04/2019

Granted 17/04/2019

10 Miromiro Street

RMA/2020/2701

Construct 31 residential units across the two sites.

Processing complete

Applied 20/11/2020

Decision issued 15/01/2021

Granted 15/01/2021

Within scope amendment accepted 26/03/2021

Within scope amendment decision issued 26/03/2021

11 Koral Lane

RMA/2021/762

Subdivision - Fee simple - 16 Lots with land use - Reapplied under 2021-22 DC policy - RMA/2021/3104

Surrendered

Applied 26/03/2021

Decision issued 14/05/2021

Granted 14/05/2021

11 Musket Lane

RMA/1989/929

Consent to subdivide and develop land for residential purposes on land specifically identified in District scheme for horse trainin, racing and associated activities. - Historical Reference RES954071

Processing complete

Applied 27/10/1989

Decision issued 18/04/1990

Granted 18/04/1990

RMA/1999/1466

Consent to subdivide land which has been specifically identified within the Operative District Scheme. - Historical Reference RES954074

Processing complete

Applied 01/01/1999

Decision issued 12/05/1988

Granted 12/05/1988

RMA/2019/161

Construct a two storey dwelling with attached garage - Lot 237

Processing complete

Applied 29/01/2019

Decision issued 06/03/2019

Granted 05/03/2019

RMA/2019/2034

To Construct a Dwelling with Attached Garage (Lot 249)

Processing complete

Applied 05/09/2019

Decision issued 18/09/2019

Granted 18/09/2019

RMA/2019/2130

To Construct a Residential Dwelling with Attached Garage - CT5716 - Lot 233 Karamu

Not accepted for processing

Applied 16/09/2019

Not accepted for processing 23/09/2019

RMA/2019/2203

To Construct a Dwelling with Attached Garage - CT5716

Processing complete

Applied 25/09/2019

Decision issued 01/10/2019

Granted 30/09/2019

RMA/2019/2364

Construct dwelling with attached garage - Lot 242

Processing complete

Applied 15/10/2019

Decision issued 22/10/2019

Granted 21/10/2019

RMA/2019/2399

To Construct a Dwelling with Attached Garage - CT5780

Processing complete

Applied 18/10/2019

Decision issued 23/10/2019

Granted 23/10/2019

RMA/2019/361

Wastewater Capacity Certificate

Processing complete

Applied 22/02/2019

Certificate unable to be issued 25/03/2019

RMA/2019/593

New Dwelling with Detached Carport

Processing complete

Applied 20/03/2019

Decision issued 17/04/2019

Granted 17/04/2019

113 Racecourse Road

RMA/1989/929

Consent to subdivide and develop land for residential purposes on land specifically identified in District scheme for horse trainin, racing and associated activities. - Historical Reference RES954071

Processing complete

Applied 27/10/1989

Decision issued 18/04/1990

Granted 18/04/1990

RMA/1999/1466

Consent to subdivide land which has been specifically identified within the Operative District Scheme. - Historical Reference RES954074

Processing complete

Applied 01/01/1999

Decision issued 12/05/1988

Granted 12/05/1988

12 Koral Lane

RMA/1989/929

Consent to subdivide and develop land for residential purposes on land specifically identified in District scheme for horse training, racing and associated activities. - Historical Reference RES954071

Processing complete

Applied 27/10/1989

Decision issued 18/04/1990

Granted 18/04/1990

RMA/1999/1466

Consent to subdivide land which has been specifically identified within the Operative District Scheme. - Historical Reference RES954074

Processing complete

Applied 01/01/1999

Decision issued 12/05/1988

Granted 12/05/1988

RMA/2019/161

Construct a two storey dwelling with attached garage - Lot 237

Processing complete

Applied 29/01/2019

Decision issued 06/03/2019

Granted 05/03/2019

RMA/2019/2034

To Construct a Dwelling with Attached Garage (Lot 249)

Processing complete

Applied 05/09/2019

Decision issued 18/09/2019

Granted 18/09/2019

RMA/2019/2130

To Construct a Residential Dwelling with Attached Garage - CT5716 - Lot 233 Karamu

Not accepted for processing

Applied 16/09/2019

Not accepted for processing 23/09/2019

RMA/2019/2203

To Construct a Dwelling with Attached Garage - CT5716

Processing complete

Applied 25/09/2019

Decision issued 01/10/2019

Granted 30/09/2019

RMA/2019/2364

Construct dwelling with attached garage - Lot 242

Processing complete

Applied 15/10/2019

Decision issued 22/10/2019

Granted 21/10/2019

RMA/2019/2399

To Construct a Dwelling with Attached Garage - CT5780

Processing complete

Applied 18/10/2019

Decision issued 23/10/2019

Granted 23/10/2019

RMA/2019/361

Wastewater Capacity Certificate

Processing complete

Applied 22/02/2019

Certificate unable to be issued 25/03/2019

RMA/2019/593

New Dwelling with Detached Carport

Processing complete

Applied 20/03/2019

Decision issued 17/04/2019

Granted 17/04/2019

12 Miromiro Street

RMA/2020/2701

Construct 31 residential units across the two sites.

Processing complete

Applied 20/11/2020

Decision issued 15/01/2021

Granted 15/01/2021

Within scope amendment accepted 26/03/2021

Within scope amendment decision issued 26/03/2021

14 Koral Lane

RMA/1989/929

Consent to subdivide and develop land for residential purposes on land specifically identified in District scheme for horse trainin, racing and associated activities. - Historical Reference RES954071

Processing complete

Applied 27/10/1989

Decision issued 18/04/1990

Granted 18/04/1990

RMA/1999/1466

Consent to subdivide land which has been specifically identified within the Operative District Scheme. - Historical Reference RES954074

Processing complete

Applied 01/01/1999

Decision issued 12/05/1988

Granted 12/05/1988

RMA/2019/161

Construct a two storey dwelling with attached garage - Lot 237

Processing complete

Applied 29/01/2019

Decision issued 06/03/2019

Granted 05/03/2019

RMA/2019/2034

To Construct a Dwelling with Attached Garage (Lot 249)

Processing complete

Applied 05/09/2019

Decision issued 18/09/2019

Granted 18/09/2019

RMA/2019/2130

To Construct a Residential Dwelling with Attached Garage - CT5716 - Lot 233 Karamu

Not accepted for processing

Applied 16/09/2019

Not accepted for processing 23/09/2019

RMA/2019/2203

To Construct a Dwelling with Attached Garage - CT5716

Processing complete

Applied 25/09/2019

Decision issued 01/10/2019

Granted 30/09/2019

RMA/2019/2364

Construct dwelling with attached garage - Lot 242

Processing complete

Applied 15/10/2019

Decision issued 22/10/2019

Granted 21/10/2019

RMA/2019/2399

To Construct a Dwelling with Attached Garage - CT5780

Processing complete

Applied 18/10/2019

Decision issued 23/10/2019

Granted 23/10/2019

RMA/2019/361

Wastewater Capacity Certificate

Processing complete

Applied 22/02/2019

Certificate unable to be issued 25/03/2019

RMA/2019/593

New Dwelling with Detached Carport

Processing complete

Applied 20/03/2019

Decision issued 17/04/2019

Granted 17/04/2019

14 Miromiro Street

RMA/2020/2701

Construct 31 residential units across the two sites.

Processing complete

Applied 20/11/2020

Decision issued 15/01/2021

Granted 15/01/2021

Within scope amendment accepted 26/03/2021

Within scope amendment decision issued 26/03/2021

14E Miromiro Street

RMA/1989/929

Consent to subdivide and develop land for residential purposes on land specifically identified in District scheme for horse trainin, racing and associated activities. - Historical Reference RES954071

Processing complete

Applied 27/10/1989

Decision issued 18/04/1990

Granted 18/04/1990

RMA/1999/1466

Consent to subdivide land which has been specifically identified within the Operative District Scheme. - Historical Reference RES954074

Processing complete

Applied 01/01/1999

Decision issued 12/05/1988

Granted 12/05/1988

RMA/2019/161

Construct a two storey dwelling with attached garage - Lot 237

Processing complete

Applied 29/01/2019

Decision issued 06/03/2019

Granted 05/03/2019

RMA/2019/2034

To Construct a Dwelling with Attached Garage (Lot 249)

Processing complete

Applied 05/09/2019

Decision issued 18/09/2019

Granted 18/09/2019

RMA/2019/2130

To Construct a Residential Dwelling with Attached Garage - CT5716 - Lot 233 Karamu

Not accepted for processing

Applied 16/09/2019

Not accepted for processing 23/09/2019

RMA/2019/2203

To Construct a Dwelling with Attached Garage - CT5716

Processing complete

Applied 25/09/2019

Decision issued 01/10/2019

Granted 30/09/2019

RMA/2019/2364

Construct dwelling with attached garage - Lot 242

Processing complete

Applied 15/10/2019

Decision issued 22/10/2019

Granted 21/10/2019

RMA/2019/2399

To Construct a Dwelling with Attached Garage - CT5780

Processing complete

Applied 18/10/2019

Decision issued 23/10/2019

Granted 23/10/2019

RMA/2019/361

Wastewater Capacity Certificate

Processing complete

Applied 22/02/2019

Certificate unable to be issued 25/03/2019

RMA/2019/593

New Dwelling with Detached Carport

Processing complete

Applied 20/03/2019

Decision issued 17/04/2019

Granted 17/04/2019

16 Koral Lane

RMA/1989/929

Consent to subdivide and develop land for residential purposes on land specifically identified in District scheme for horse training, racing and associated activities. - Historical Reference RES954071

Processing complete

Applied 27/10/1989

Decision issued 18/04/1990

Granted 18/04/1990

RMA/1999/1466

Consent to subdivide land which has been specifically identified within the Operative District Scheme. - Historical Reference RES954074

Processing complete

Applied 01/01/1999

Decision issued 12/05/1988

Granted 12/05/1988

RMA/2019/161

Construct a two storey dwelling with attached garage - Lot 237

Processing complete

Applied 29/01/2019

Decision issued 06/03/2019

Granted 05/03/2019

RMA/2019/2034

To Construct a Dwelling with Attached Garage (Lot 249)

Processing complete

Applied 05/09/2019

Decision issued 18/09/2019

Granted 18/09/2019

RMA/2019/2130

To Construct a Residential Dwelling with Attached Garage - CT5716 - Lot 233 Karamu

Not accepted for processing

Applied 16/09/2019

Not accepted for processing 23/09/2019

RMA/2019/2203

To Construct a Dwelling with Attached Garage - CT5716

Processing complete

Applied 25/09/2019

Decision issued 01/10/2019

Granted 30/09/2019

RMA/2019/2364

Construct dwelling with attached garage - Lot 242

Processing complete

Applied 15/10/2019

Decision issued 22/10/2019

Granted 21/10/2019

RMA/2019/2399

To Construct a Dwelling with Attached Garage - CT5780

Processing complete

Applied 18/10/2019

Decision issued 23/10/2019

Granted 23/10/2019

RMA/2019/361

Wastewater Capacity Certificate

Processing complete

Applied 22/02/2019

Certificate unable to be issued 25/03/2019

RMA/2019/593

New Dwelling with Detached Carport

Processing complete

Applied 20/03/2019

Decision issued 17/04/2019

Granted 17/04/2019

16R Miromiro Street

RMA/1989/929

Consent to subdivide and develop land for residential purposes on land specifically identified in District scheme for horse training, racing and associated activities. - Historical Reference RES954071

Processing complete

Applied 27/10/1989

Decision issued 18/04/1990

Granted 18/04/1990

RMA/1999/1466

Consent to subdivide land which has been specifically identified within the Operative District Scheme. - Historical Reference RES954074

Processing complete

Applied 01/01/1999

Decision issued 12/05/1988

Granted 12/05/1988

RMA/2019/161

Construct a two storey dwelling with attached garage - Lot 237

Processing complete

Applied 29/01/2019

Decision issued 06/03/2019

Granted 05/03/2019

RMA/2019/2034

To Construct a Dwelling with Attached Garage (Lot 249)

Processing complete

Applied 05/09/2019

Decision issued 18/09/2019

Granted 18/09/2019

RMA/2019/2130

To Construct a Residential Dwelling with Attached Garage - CT5716 - Lot 233 Karamu

Not accepted for processing

Applied 16/09/2019

Not accepted for processing 23/09/2019

RMA/2019/2203

To Construct a Dwelling with Attached Garage - CT5716

Processing complete

Applied 25/09/2019

Decision issued 01/10/2019

Granted 30/09/2019

RMA/2019/2364

Construct dwelling with attached garage - Lot 242

Processing complete

Applied 15/10/2019

Decision issued 22/10/2019

Granted 21/10/2019

RMA/2019/2399

To Construct a Dwelling with Attached Garage - CT5780

Processing complete

Applied 18/10/2019

Decision issued 23/10/2019

Granted 23/10/2019

RMA/2019/361

Wastewater Capacity Certificate

Processing complete

Applied 22/02/2019

Certificate unable to be issued 25/03/2019

RMA/2019/593

New Dwelling with Detached Carport

Processing complete

Applied 20/03/2019

Decision issued 17/04/2019

Granted 17/04/2019

19 Miromiro Street

RMA/1989/929

Consent to subdivide and develop land for residential purposes on land specifically identified in District scheme for horse training, racing and associated activities. - Historical Reference RES954071

Processing complete

Applied 27/10/1989

Decision issued 18/04/1990

Granted 18/04/1990

RMA/1999/1466

Consent to subdivide land which has been specifically identified within the Operative District Scheme. - Historical Reference RES954074

Processing complete

Applied 01/01/1999

Decision issued 12/05/1988

Granted 12/05/1988

RMA/2019/161

Construct a two storey dwelling with attached garage - Lot 237

Processing complete

Applied 29/01/2019

Decision issued 06/03/2019

Granted 05/03/2019

RMA/2019/2034

To Construct a Dwelling with Attached Garage (Lot 249)

Processing complete

Applied 05/09/2019

Decision issued 18/09/2019

Granted 18/09/2019

RMA/2019/2130

To Construct a Residential Dwelling with Attached Garage - CT5716 - Lot 233 Karamu

Not accepted for processing

Applied 16/09/2019

Not accepted for processing 23/09/2019

RMA/2019/2203

To Construct a Dwelling with Attached Garage - CT5716

Processing complete

Applied 25/09/2019

Decision issued 01/10/2019

Granted 30/09/2019

RMA/2019/2364

Construct dwelling with attached garage - Lot 242

Processing complete

Applied 15/10/2019

Decision issued 22/10/2019

Granted 21/10/2019

RMA/2019/2399

To Construct a Dwelling with Attached Garage - CT5780

Processing complete

Applied 18/10/2019

Decision issued 23/10/2019

Granted 23/10/2019

RMA/2019/361

Wastewater Capacity Certificate

Processing complete

Applied 22/02/2019

Certificate unable to be issued 25/03/2019

RMA/2019/593

New Dwelling with Detached Carport

Processing complete

Applied 20/03/2019

Decision issued 17/04/2019

Granted 17/04/2019

RMA/2020/222

Residential dwelling with an attached garage - CT5680 - Lot 239 Karamu

Processing complete

Applied 05/02/2020

Decision issued 25/06/2020

Granted 24/06/2020

21 Miromiro Street

RMA/1989/929

Consent to subdivide and develop land for residential purposes on land specifically identified in District scheme for horse trainin, racing and associated activities. - Historical Reference RES954071

Processing complete

Applied 27/10/1989

Decision issued 18/04/1990

Granted 18/04/1990

RMA/1999/1466

Consent to subdivide land which has been specifically identified within the Operative District Scheme. - Historical Reference RES954074

Processing complete

Applied 01/01/1999

Decision issued 12/05/1988

Granted 12/05/1988

RMA/2019/161

Construct a two storey dwelling with attached garage - Lot 237

Processing complete

Applied 29/01/2019

Decision issued 06/03/2019

Granted 05/03/2019

RMA/2019/2034

To Construct a Dwelling with Attached Garage (Lot 249)

Processing complete

Applied 05/09/2019

Decision issued 18/09/2019

Granted 18/09/2019

RMA/2019/2130

To Construct a Residential Dwelling with Attached Garage - CT5716 - Lot 233 Karamu

Not accepted for processing

Applied 16/09/2019

Not accepted for processing 23/09/2019

RMA/2019/2203

To Construct a Dwelling with Attached Garage - CT5716

Processing complete

Applied 25/09/2019

Decision issued 01/10/2019

Granted 30/09/2019

RMA/2019/2364

Construct dwelling with attached garage - Lot 242

Processing complete

Applied 15/10/2019

Decision issued 22/10/2019

Granted 21/10/2019

RMA/2019/2399

To Construct a Dwelling with Attached Garage - CT5780

Processing complete

Applied 18/10/2019

Decision issued 23/10/2019

Granted 23/10/2019

RMA/2019/361

Wastewater Capacity Certificate

Processing complete

Applied 22/02/2019

Certificate unable to be issued 25/03/2019

RMA/2019/593

New Dwelling with Detached Carport

Processing complete

Applied 20/03/2019

Decision issued 17/04/2019

Granted 17/04/2019

RMA/2021/11

Construction of a single story residential dwelling with attached garage

Processing complete

Applied 07/01/2021

Decision issued 23/02/2021

Granted 23/02/2021

23 Miromiro Street

RMA/1989/929

Consent to subdivide and develop land for residential purposes on land specifically identified in District scheme for horse trainin, racing and associated activities. - Historical Reference RES954071

Processing complete

Applied 27/10/1989

Decision issued 18/04/1990

Granted 18/04/1990

RMA/1999/1466

Consent to subdivide land which has been specifically identified within the Operative District Scheme. - Historical Reference RES954074

Processing complete

Applied 01/01/1999

Decision issued 12/05/1988

Granted 12/05/1988

RMA/2019/161

Construct a two storey dwelling with attached garage - Lot 237

Processing complete

Applied 29/01/2019

Decision issued 06/03/2019

Granted 05/03/2019

RMA/2019/2034

To Construct a Dwelling with Attached Garage (Lot 249)

Processing complete

Applied 05/09/2019

Decision issued 18/09/2019

Granted 18/09/2019

RMA/2019/2130

To Construct a Residential Dwelling with Attached Garage - CT5716 - Lot 233 Karamu

Not accepted for processing

Applied 16/09/2019

Not accepted for processing 23/09/2019

RMA/2019/2203

To Construct a Dwelling with Attached Garage - CT5716

Processing complete

Applied 25/09/2019

Decision issued 01/10/2019

Granted 30/09/2019

RMA/2019/2364

Construct dwelling with attached garage - Lot 242

Processing complete

Applied 15/10/2019

Decision issued 22/10/2019

Granted 21/10/2019

RMA/2019/2399

To Construct a Dwelling with Attached Garage - CT5780

Processing complete

Applied 18/10/2019

Decision issued 23/10/2019

Granted 23/10/2019

RMA/2019/361

Wastewater Capacity Certificate

Processing complete

Applied 22/02/2019

Certificate unable to be issued 25/03/2019

RMA/2019/593

New Dwelling with Detached Carport

Processing complete

Applied 20/03/2019

Decision issued 17/04/2019

Granted 17/04/2019

25 Miromiro Street

RMA/1989/929

Consent to subdivide and develop land for residential purposes on land specifically identified in District scheme for horse trainin, racing and associated activities. - Historical Reference RES954071

Processing complete

Applied 27/10/1989

Decision issued 18/04/1990

Granted 18/04/1990

RMA/1999/1466

Consent to subdivide land which has been specifically identified within the Operative District Scheme. - Historical Reference RES954074

Processing complete

Applied 01/01/1999

Decision issued 12/05/1988

Granted 12/05/1988

RMA/2019/161

Construct a two storey dwelling with attached garage - Lot 237

Processing complete

Applied 29/01/2019

Decision issued 06/03/2019

Granted 05/03/2019

RMA/2019/2034

To Construct a Dwelling with Attached Garage (Lot 249)

Processing complete

Applied 05/09/2019

Decision issued 18/09/2019

Granted 18/09/2019

RMA/2019/2130

To Construct a Residential Dwelling with Attached Garage - CT5716 - Lot 233 Karamu

Not accepted for processing

Applied 16/09/2019

Not accepted for processing 23/09/2019

RMA/2019/2203

To Construct a Dwelling with Attached Garage - CT5716

Processing complete

Applied 25/09/2019

Decision issued 01/10/2019

Granted 30/09/2019

RMA/2019/2364

Construct dwelling with attached garage - Lot 242

Processing complete

Applied 15/10/2019

Decision issued 22/10/2019

Granted 21/10/2019

RMA/2019/2399

To Construct a Dwelling with Attached Garage - CT5780

Processing complete

Applied 18/10/2019

Decision issued 23/10/2019

Granted 23/10/2019

RMA/2019/361

Wastewater Capacity Certificate

Processing complete

Applied 22/02/2019

Certificate unable to be issued 25/03/2019

RMA/2019/593

New Dwelling with Detached Carport

Processing complete

Applied 20/03/2019

Decision issued 17/04/2019

Granted 17/04/2019

27 Miromiro Street

RMA/1989/929

Consent to subdivide and develop land for residential purposes on land specifically identified in District scheme for horse trainin, racing and associated activities. - Historical Reference RES954071

Processing complete

Applied 27/10/1989

Decision issued 18/04/1990

Granted 18/04/1990

RMA/1999/1466

Consent to subdivide land which has been specifically identified within the Operative District Scheme. - Historical Reference RES954074

Processing complete

Applied 01/01/1999

Decision issued 12/05/1988

Granted 12/05/1988

RMA/2019/161

Construct a two storey dwelling with attached garage - Lot 237

Processing complete

Applied 29/01/2019

Decision issued 06/03/2019

Granted 05/03/2019

RMA/2019/2034

To Construct a Dwelling with Attached Garage (Lot 249)

Processing complete

Applied 05/09/2019

Decision issued 18/09/2019

Granted 18/09/2019

RMA/2019/2130

To Construct a Residential Dwelling with Attached Garage - CT5716 - Lot 233 Karamu

Not accepted for processing

Applied 16/09/2019

Not accepted for processing 23/09/2019

RMA/2019/2203

To Construct a Dwelling with Attached Garage - CT5716

Processing complete

Applied 25/09/2019

Decision issued 01/10/2019

Granted 30/09/2019

RMA/2019/2364

Construct dwelling with attached garage - Lot 242

Processing complete

Applied 15/10/2019

Decision issued 22/10/2019

Granted 21/10/2019

RMA/2019/2399

To Construct a Dwelling with Attached Garage - CT5780

Processing complete

Applied 18/10/2019

Decision issued 23/10/2019

Granted 23/10/2019

RMA/2019/2438

To Construct a Dwelling with Attached Garage

Processing complete

Applied 23/10/2019

Decision issued 21/11/2019

Granted 21/11/2019

RMA/2019/361

Wastewater Capacity Certificate

Processing complete

Applied 22/02/2019

Certificate unable to be issued 25/03/2019

RMA/2019/593

New Dwelling with Detached Carport

Processing complete

Applied 20/03/2019

Decision issued 17/04/2019

Granted 17/04/2019

29 Miromiro Street

RMA/1989/929

Consent to subdivide and develop land for residential purposes on land specifically identified in District scheme for horse training, racing and associated activities. - Historical Reference RES954071

Processing complete

Applied 27/10/1989

Decision issued 18/04/1990

Granted 18/04/1990

RMA/1999/1466

Consent to subdivide land which has been specifically identified within the Operative District Scheme. - Historical Reference RES954074

Processing complete

Applied 01/01/1999

Decision issued 12/05/1988

Granted 12/05/1988

RMA/2019/161

Construct a two storey dwelling with attached garage - Lot 237

Processing complete

Applied 29/01/2019

Decision issued 06/03/2019

Granted 05/03/2019

RMA/2019/2034

To Construct a Dwelling with Attached Garage (Lot 249)

Processing complete

Applied 05/09/2019

Decision issued 18/09/2019

Granted 18/09/2019

RMA/2019/2130

To Construct a Residential Dwelling with Attached Garage - CT5716 - Lot 233 Karamu

Not accepted for processing

Applied 16/09/2019

Not accepted for processing 23/09/2019

RMA/2019/2203

To Construct a Dwelling with Attached Garage - CT5716

Processing complete

Applied 25/09/2019

Decision issued 01/10/2019

Granted 30/09/2019

RMA/2019/2364

Construct dwelling with attached garage - Lot 242

Processing complete

Applied 15/10/2019

Decision issued 22/10/2019

Granted 21/10/2019

RMA/2019/2399

To Construct a Dwelling with Attached Garage - CT5780

Processing complete

Applied 18/10/2019

Decision issued 23/10/2019

Granted 23/10/2019

RMA/2019/2711

Construction of a new dwelling with attached Garage

Processing complete

Applied 20/11/2019

Decision issued 13/12/2019

Granted 12/12/2019

RMA/2019/361

Wastewater Capacity Certificate

Processing complete

Applied 22/02/2019

Certificate unable to be issued 25/03/2019

RMA/2019/593

New Dwelling with Detached Carport

Processing complete

Applied 20/03/2019

Decision issued 17/04/2019

Granted 17/04/2019

3 Koral Lane

RMA/2021/762

Subdivision - Fee simple - 16 Lots with land use - Reapplied under 2021-22 DC policy - RMA/2021/3104

Surrendered

Applied 26/03/2021

Decision issued 14/05/2021

Granted 14/05/2021

31 Miromiro Street

RMA/1989/929

Consent to subdivide and develop land for residential purposes on land specifically identified in District scheme for horse trainin, racing and associated activities. - Historical Reference RES954071

Processing complete

Applied 27/10/1989

Decision issued 18/04/1990

Granted 18/04/1990

RMA/1999/1466

Consent to subdivide land which has been specifically identified within the Operative District Scheme. - Historical Reference RES954074

Processing complete

Applied 01/01/1999

Decision issued 12/05/1988

Granted 12/05/1988

RMA/2019/161

Construct a two storey dwelling with attached garage - Lot 237

Processing complete

Applied 29/01/2019

Decision issued 06/03/2019

Granted 05/03/2019

RMA/2019/2034

To Construct a Dwelling with Attached Garage (Lot 249)

Processing complete

Applied 05/09/2019

Decision issued 18/09/2019

Granted 18/09/2019

RMA/2019/2130

To Construct a Residential Dwelling with Attached Garage - CT5716 - Lot 233 Karamu

Not accepted for processing

Applied 16/09/2019

Not accepted for processing 23/09/2019

RMA/2019/2203

To Construct a Dwelling with Attached Garage - CT5716

Processing complete

Applied 25/09/2019

Decision issued 01/10/2019

Granted 30/09/2019

RMA/2019/2364

Construct dwelling with attached garage - Lot 242

Processing complete

Applied 15/10/2019

Decision issued 22/10/2019

Granted 21/10/2019

RMA/2019/2399

To Construct a Dwelling with Attached Garage - CT5780

Processing complete

Applied 18/10/2019

Decision issued 23/10/2019

Granted 23/10/2019

RMA/2019/2539

To Construct a Dwelling with Attached Garage - CT5717

Processing complete

Applied 04/11/2019

Permitted activity notice issued 14/11/2019

RMA/2019/361

Wastewater Capacity Certificate

Processing complete

Applied 22/02/2019

Certificate unable to be issued 25/03/2019

RMA/2019/593

New Dwelling with Detached Carport

Processing complete

Applied 20/03/2019

Decision issued 17/04/2019

Granted 17/04/2019

32 Miromiro Street

RMA/1989/929

Consent to subdivide and develop land for residential purposes on land specifically identified in District scheme for horse trainin, racing and associated activities. - Historical Reference RES954071

Processing complete

Applied 27/10/1989

Decision issued 18/04/1990

Granted 18/04/1990

RMA/1999/1466

Consent to subdivide land which has been specifically identified within the Operative District Scheme. - Historical Reference RES954074

Processing complete

Applied 01/01/1999

Decision issued 12/05/1988

Granted 12/05/1988

RMA/2019/161

Construct a two storey dwelling with attached garage - Lot 237

Processing complete

Applied 29/01/2019

Decision issued 06/03/2019

Granted 05/03/2019

RMA/2019/2034

To Construct a Dwelling with Attached Garage (Lot 249)

Processing complete

Applied 05/09/2019

Decision issued 18/09/2019

Granted 18/09/2019

RMA/2019/2130

To Construct a Residential Dwelling with Attached Garage - CT5716 - Lot 233 Karamu

Not accepted for processing

Applied 16/09/2019

Not accepted for processing 23/09/2019

RMA/2019/2203

To Construct a Dwelling with Attached Garage - CT5716

Processing complete

Applied 25/09/2019

Decision issued 01/10/2019

Granted 30/09/2019

RMA/2019/2364

Construct dwelling with attached garage - Lot 242

Processing complete

Applied 15/10/2019

Decision issued 22/10/2019

Granted 21/10/2019

RMA/2019/2399

To Construct a Dwelling with Attached Garage - CT5780

Processing complete

Applied 18/10/2019

Decision issued 23/10/2019

Granted 23/10/2019

RMA/2019/361

Wastewater Capacity Certificate

Processing complete

Applied 22/02/2019

Certificate unable to be issued 25/03/2019

RMA/2019/593

New Dwelling with Detached Carport

Processing complete

Applied 20/03/2019

Decision issued 17/04/2019

Granted 17/04/2019

320R Carmen Road

RMA/1985/1142

Consent to establish an outdoor market for the retailing of goods. - Historical Reference RES954785

Processing complete

Applied 25/01/1985

Decision issued 27/05/1985

Granted 27/05/1985

RMA/1992/1194

Consent granted to establish a greyhound racing track, grandstand and associated facilities. - Historical Reference RES94102184

Processing complete

Applied 15/07/1992

Decision issued 30/09/1992

Granted 30/09/1992

RMA/1992/1347

Consent to establish a Greyhound racing track with grandstand and associated facilities in the Residential 1 team. - Historical Reference RES954787

Processing complete

Applied 30/06/1992

Decision issued 29/09/1992

Granted 29/09/1992

RMA/1994/1155

Extension of clubrooms with a conservatory addition in a residential zone. - Historical Reference RES94102352

Processing complete

Applied 07/10/1994

Decision issued 25/10/1994

Granted 25/10/1994

RMA/1996/2458

Application to operate a market on the Sunday of each week for the sale of goods of all descriptions, both new and second hand, including Produ - Historical Reference RES962843

Processing complete

Applied 05/11/1996

Decision issued 08/04/1997

Granted 08/04/1997

RMA/1996/2796

Application to reshape the running tracks at Riccarton Racecourse.the proposal exceeds the permitted 500m3/ ha maximum volume of excavation or fil - Historical Reference RES963222

Processing complete

Applied 13/12/1996

Decision issued 30/01/1997

Granted 30/01/1997

RMA/1996/2847

Application for a renewal of the Resource Consent 232/92/ non complying activity granted September 1992. - Historical Reference RES963278

Processing complete

Applied 23/12/1996

Decision issued 01/01/1999

Declined 01/01/1999

RMA/1997/776

Application to reshape the running tracks at Riccarton Racecourse. this application is the second Stage of a two Stage development, the first Stag - Historical Reference RES970801

Processing complete

Applied 02/04/1997

Decision issued 15/04/1997

Granted 15/04/1997

RMA/1998/4098

Application to extend the existing Sunday Market by the following: (1) an extension to the summer market area; (2) an extension to the market carparking a - Historical Reference RMA788

Processing complete

Applied 15/12/1998

RMA/1999/2357

To install, operate and maintain a mobile phone site comprising 6 panel antennas mounted on a 20 m High free standing mast, and equipment container and as - Historical Reference RES991058

Processing complete

Applied 11/04/1999

Decision issued 04/06/1999

Granted 04/06/1999

RMA/1999/4574

Application for a 270m driving range; mini golf course; carparks; signage; facilities building and 10 hole golf course - Historical Reference RMA1333

Processing complete

Applied 19/11/1999

Decision issued 29/01/2001

Granted 26/01/2001

RMA/1999/4596

To establish and operate a telecommunications facility comprising a 22.03metre high mast including antennaes a aes and lightning rod, and an equipment shelter. - Historical Reference RMA1345

Processing complete

Applied 19/11/1999

Decision issued 15/12/1999

Granted 14/12/1999

RMA/2000/1374

Upgrade existing mobile phone insta provide Code Division Multiple Access (CDMA). - Historical Reference RMA20002084

Processing complete

Applied 24/05/2000

Decision issued 03/08/2000

Granted 03/08/2000

RMA/2000/1750

Application to construct a new greenkeeper's shed and committee room to replace an existing shed located 4.5m from the front boundary. - Historical Reference RMA20002475

Processing complete

Applied 12/07/2000

Decision issued 19/07/2000

Granted 19/07/2000

RMA/2000/1879

Application for the removal of a notable tree which has died of natural causes. The removal was necessary for health and safety reasons. - Historical Reference RMA20002611

Processing complete

Applied 26/07/2000

Decision issued 11/08/2000

Granted 10/08/2000

RMA/2001/2278

Application for retrospective consent for earthworks within and adjacent to a 270m golf driving range & facilities building - Historical Reference RMA20008189

Processing complete

Applied 19/09/2001

Decision issued 23/11/2001

Granted 23/11/2001

RMA/2002/2557

Application for signage - Historical Reference RMA20011600

Lapsed

Applied 09/10/2002

RMA/2002/328

Application for the installation and operation of an 18 hold "Mini Putt" mini golf course adjacent to golf driving range - Historical Reference RMA20009302

Processing complete

Applied 01/02/2002

Decision issued 06/05/2002

Granted 06/05/2002

RMA/2002/776

Application for the installation and operation of a further 20 bays & a grassed golf driving area adjacent to the green of the golf driving range - Historical Reference RMA20009757

Processing complete

Applied 05/04/2002

Decision issued 06/05/2002

Granted 03/05/2002

RMA/2002/991

Application for the installation & use of a synthetic surface bowling green adjacent to an existing bowling green. - Historical Reference RMA20009978

Processing complete

Applied 02/05/2002

Decision issued 18/07/2002

Granted 16/07/2002

RMA/2003/1672

Application to upgrade the existing telecommunications facility by providing replacement panel antenna - Historical Reference RMA20013972

Processing complete

Applied 01/07/2003

Decision issued 30/07/2003

Granted 28/07/2003

RMA/2006/58

Application to undertake the restoration of, and make alteration to, the Tea House , Riccarton Park Racecourse - Historical Reference RMA20021941

Processing complete

Applied 18/01/2006

Decision issued 17/02/2006

Granted 17/02/2006

RMA/2006/975

Application for the erection of a canopy over an existing balcony on the Public grandstand at Riccarton Racecourse - Historical Reference RMA92005011

Processing complete

Applied 04/05/2006

Decision issued 27/06/2006

Granted 27/06/2006

RMA/2007/2547

Upgrade an existing mobile phone site. - Historical Reference RMA92009877

Processing complete

Applied 17/09/2007

Decision issued 12/11/2007

Granted 12/11/2007

RMA/2007/827

removal of notable tree for health and safety reasons "cupressus macrocarpa", tree 45 on plan - Historical Reference RMA92008069

Withdrawn

Applied 12/04/2007

RMA/2008/890

Application for pruning of an English Elm - Historical Reference RMA92011704

Processing complete

Applied 01/05/2008

Decision issued 12/06/2008

Granted 11/06/2008

RMA/2011/405

Temporary business accommodation - Historical Reference RMA92017935

Expired

Applied 20/04/2011

Decision issued 26/04/2011

Granted 26/04/2011

RMA/2013/343

TEMPORARY ACCOMMODATION - OFFICE - Historical Reference RMA92021935

Processing complete

Applied 04/03/2013

Decision issued 11/03/2013

Granted 11/03/2013

RMA/2014/2050

Retrospective consent for two trailer billboards - Historical Reference RMA92026731

Processing complete

Applied 11/08/2014

Granted 01/10/2014

Decision issued 01/10/2014

RMA/2017/2099

55 Lot Fee Simple Subdivision - Stage 1

Processing complete

Applied 01/09/2017

Conditions changed/cancelled - s127 29/06/2018

Amended decision issued - s133A 19/12/2017

s223 Certificate issued stage 1 13/09/2018

s223 Certificate issued stage 2 18/09/2018

s224 Certificate issued stage 1 13/09/2018

s224 Certificate issued stage 2 13/06/2019

Decision issued 15/12/2017

Granted 15/12/2017

RMA/2017/2114

Earthworks related to Subdivision consent RMA/2017/2103

Withdrawn

Applied 04/09/2017

RMA/2017/2773

Replacement of two existing telecommunication facilities with a new co-locatable telecommunications facility that does not meet the permitted height requirements under the District Plan

Processing complete

Applied 08/11/2017

Decision issued 04/12/2017

Granted 04/12/2017

RMA/2017/3172

To provide for site coverage up to 50% for Lots 6, 8-16, 23-36 and 37-45 and 181-183 and for site coverage up to 45% for Lots 7, 46 – 51, 17 – 22 of approved subdivision RMA/2017/2099

Processing complete

Applied 18/12/2017

Decision issued 26/02/2018

Granted 26/02/2018

33 Miromiro Street

RMA/1989/929

Consent to subdivide and develop land for residential purposes on land specifically identified in District scheme for horse trainin, racing and associated activities. - Historical Reference RES954071

Processing complete

Applied 27/10/1989

Decision issued 18/04/1990

Granted 18/04/1990

RMA/1999/1466

Consent to subdivide land which has been specifically identified within the Operative District Scheme. - Historical Reference RES954074

Processing complete

Applied 01/01/1999

Decision issued 12/05/1988

Granted 12/05/1988

RMA/2019/161

Construct a two storey dwelling with attached garage - Lot 237

Processing complete

Applied 29/01/2019

Decision issued 06/03/2019

Granted 05/03/2019

RMA/2019/2034

To Construct a Dwelling with Attached Garage (Lot 249)

Processing complete

Applied 05/09/2019

Decision issued 18/09/2019

Granted 18/09/2019

RMA/2019/2130

To Construct a Residential Dwelling with Attached Garage - CT5716 - Lot 233 Karamu

Not accepted for processing

Applied 16/09/2019

Not accepted for processing 23/09/2019

RMA/2019/2203

To Construct a Dwelling with Attached Garage - CT5716

Processing complete

Applied 25/09/2019

Decision issued 01/10/2019

Granted 30/09/2019

RMA/2019/2364

Construct dwelling with attached garage - Lot 242

Processing complete

Applied 15/10/2019

Decision issued 22/10/2019

Granted 21/10/2019

RMA/2019/2399

To Construct a Dwelling with Attached Garage - CT5780

Processing complete

Applied 18/10/2019

Decision issued 23/10/2019

Granted 23/10/2019

RMA/2019/361

Wastewater Capacity Certificate

Processing complete

Applied 22/02/2019

Certificate unable to be issued 25/03/2019

RMA/2019/593

New Dwelling with Detached Carport

Processing complete

Applied 20/03/2019

Decision issued 17/04/2019

Granted 17/04/2019

RMA/2021/1855

Construct dwelling with attached garage

Processing complete

Applied 18/06/2021

Decision issued 15/07/2021

Granted 14/07/2021

34 Miromiro Street

RMA/2020/2701

Construct 31 residential units across the two sites.

Processing complete

Applied 20/11/2020

Decision issued 15/01/2021

Granted 15/01/2021

Within scope amendment accepted 26/03/2021

Within scope amendment decision issued 26/03/2021

RMA/2021/762

Subdivision - Fee simple - 16 Lots with land use - Reapplied under 2021-22 DC policy - RMA/2021/3104

Surrendered

Applied 26/03/2021

Decision issued 14/05/2021

Granted 14/05/2021

35 Miromiro Street

RMA/1989/929

Consent to subdivide and develop land for residential purposes on land specifically identified in District scheme for horse training, racing and associated activities. - Historical Reference RES954071

Processing complete

Applied 27/10/1989

Decision issued 18/04/1990

Granted 18/04/1990

RMA/1999/1466

Consent to subdivide land which has been specifically identified within the Operative District Scheme. - Historical Reference RES954074

Processing complete

Applied 01/01/1999

Decision issued 12/05/1988

Granted 12/05/1988

RMA/2019/161

Construct a two storey dwelling with attached garage - Lot 237

Processing complete

Applied 29/01/2019

Decision issued 06/03/2019

Granted 05/03/2019

RMA/2019/2034

To Construct a Dwelling with Attached Garage (Lot 249)

Processing complete

Applied 05/09/2019

Decision issued 18/09/2019

Granted 18/09/2019

RMA/2019/2130

To Construct a Residential Dwelling with Attached Garage - CT5716 - Lot 233 Karamu

Not accepted for processing

Applied 16/09/2019

Not accepted for processing 23/09/2019

RMA/2019/2203

To Construct a Dwelling with Attached Garage - CT5716

Processing complete

Applied 25/09/2019

Decision issued 01/10/2019

Granted 30/09/2019

RMA/2019/2364

Construct dwelling with attached garage - Lot 242

Processing complete

Applied 15/10/2019

Decision issued 22/10/2019

Granted 21/10/2019

RMA/2019/2399

To Construct a Dwelling with Attached Garage - CT5780

Processing complete

Applied 18/10/2019

Decision issued 23/10/2019

Granted 23/10/2019

RMA/2019/361

Wastewater Capacity Certificate

Processing complete

Applied 22/02/2019

Certificate unable to be issued 25/03/2019

RMA/2019/593

New Dwelling with Detached Carport

Processing complete

Applied 20/03/2019

Decision issued 17/04/2019

Granted 17/04/2019

RMA/2021/4241

Construct one new residential dwelling with attached double garage

Processing complete

Applied 16/12/2021

Decision issued 29/04/2022

Granted 29/04/2022

36 Miromiro Street

RMA/2021/762

Subdivision - Fee simple - 16 Lots with land use - Reapplied under 2021-22 DC policy - RMA/2021/3104

Surrendered

Applied 26/03/2021

Decision issued 14/05/2021

Granted 14/05/2021

37 Miromiro Street

RMA/1989/929

Consent to subdivide and develop land for residential purposes on land specifically identified in District scheme for horse trainin, racing and associated activities. - Historical Reference RES954071

Processing complete

Applied 27/10/1989

Decision issued 18/04/1990

Granted 18/04/1990

RMA/1999/1466

Consent to subdivide land which has been specifically identified within the Operative District Scheme. - Historical Reference RES954074

Processing complete

Applied 01/01/1999

Decision issued 12/05/1988

Granted 12/05/1988

RMA/2019/161

Construct a two storey dwelling with attached garage - Lot 237

Processing complete

Applied 29/01/2019

Decision issued 06/03/2019

Granted 05/03/2019

RMA/2019/2034

To Construct a Dwelling with Attached Garage (Lot 249)

Processing complete

Applied 05/09/2019

Decision issued 18/09/2019

Granted 18/09/2019

RMA/2019/2130

To Construct a Residential Dwelling with Attached Garage - CT5716 - Lot 233 Karamu

Not accepted for processing

Applied 16/09/2019

Not accepted for processing 23/09/2019

RMA/2019/2203

To Construct a Dwelling with Attached Garage - CT5716

Processing complete

Applied 25/09/2019

Decision issued 01/10/2019

Granted 30/09/2019

RMA/2019/2364

Construct dwelling with attached garage - Lot 242

Processing complete

Applied 15/10/2019

Decision issued 22/10/2019

Granted 21/10/2019

RMA/2019/2399

To Construct a Dwelling with Attached Garage - CT5780

Processing complete

Applied 18/10/2019

Decision issued 23/10/2019

Granted 23/10/2019

RMA/2019/361

Wastewater Capacity Certificate

Processing complete

Applied 22/02/2019

Certificate unable to be issued 25/03/2019

RMA/2019/593

New Dwelling with Detached Carport

Processing complete

Applied 20/03/2019

Decision issued 17/04/2019

Granted 17/04/2019

RMA/2020/1307

Construction of a Residential Dwelling with attached garage

Processing complete

Applied 25/06/2020

Decision issued 09/07/2020

Granted 09/07/2020

38 Miromiro Street

RMA/2021/762

Subdivision - Fee simple - 16 Lots with land use - Reapplied under 2021-22 DC policy - RMA/2021/3104

Surrendered

Applied 26/03/2021

Decision issued 14/05/2021

Granted 14/05/2021

39R Miromiro Street

RMA/1989/929

Consent to subdivide and develop land for residential purposes on land specifically identified in District scheme for horse trainin, racing and associated activities. - Historical Reference RES954071

Processing complete

Applied 27/10/1989

Decision issued 18/04/1990

Granted 18/04/1990

RMA/1999/1466

Consent to subdivide land which has been specifically identified within the Operative District Scheme. - Historical Reference RES954074

Processing complete

Applied 01/01/1999

Decision issued 12/05/1988

Granted 12/05/1988

RMA/2019/161

Construct a two storey dwelling with attached garage - Lot 237

Processing complete

Applied 29/01/2019

Decision issued 06/03/2019

Granted 05/03/2019

RMA/2019/2034

To Construct a Dwelling with Attached Garage (Lot 249)

Processing complete

Applied 05/09/2019

Decision issued 18/09/2019

Granted 18/09/2019

RMA/2019/2130

To Construct a Residential Dwelling with Attached Garage - CT5716 - Lot 233 Karamu

Not accepted for processing

Applied 16/09/2019

Not accepted for processing 23/09/2019

RMA/2019/2203

To Construct a Dwelling with Attached Garage - CT5716

Processing complete

Applied 25/09/2019

Decision issued 01/10/2019

Granted 30/09/2019

RMA/2019/2364

Construct dwelling with attached garage - Lot 242

Processing complete

Applied 15/10/2019

Decision issued 22/10/2019

Granted 21/10/2019

RMA/2019/2399

To Construct a Dwelling with Attached Garage - CT5780

Processing complete

Applied 18/10/2019

Decision issued 23/10/2019

Granted 23/10/2019

RMA/2019/361

Wastewater Capacity Certificate

Processing complete

Applied 22/02/2019

Certificate unable to be issued 25/03/2019

RMA/2019/593

New Dwelling with Detached Carport

Processing complete

Applied 20/03/2019

Granted 17/04/2019

Decision issued 17/04/2019

4 Koral Lane

RMA/1989/929

Consent to subdivide and develop land for residential purposes on land specifically identified in District scheme for horse trainin, racing and associated activities. - Historical Reference RES954071

Processing complete

Applied 27/10/1989

Decision issued 18/04/1990

Granted 18/04/1990

RMA/1999/1466

Consent to subdivide land which has been specifically identified within the Operative District Scheme. - Historical Reference RES954074

Processing complete

Applied 01/01/1999

Decision issued 12/05/1988

Granted 12/05/1988

RMA/2019/161

Construct a two storey dwelling with attached garage - Lot 237

Processing complete

Applied 29/01/2019

Decision issued 06/03/2019

Granted 05/03/2019

RMA/2019/2034

To Construct a Dwelling with Attached Garage (Lot 249)

Processing complete

Applied 05/09/2019

Decision issued 18/09/2019

Granted 18/09/2019

RMA/2019/2130

To Construct a Residential Dwelling with Attached Garage - CT5716 - Lot 233 Karamu

Not accepted for processing

Applied 16/09/2019

Not accepted for processing 23/09/2019

RMA/2019/2203

To Construct a Dwelling with Attached Garage - CT5716

Processing complete

Applied 25/09/2019

Decision issued 01/10/2019

Granted 30/09/2019

RMA/2019/2364

Construct dwelling with attached garage - Lot 242

Processing complete

Applied 15/10/2019

Decision issued 22/10/2019

Granted 21/10/2019

RMA/2019/2399

To Construct a Dwelling with Attached Garage - CT5780

Processing complete

Applied 18/10/2019

Decision issued 23/10/2019

Granted 23/10/2019

RMA/2019/361

Wastewater Capacity Certificate

Processing complete

Applied 22/02/2019

Certificate unable to be issued 25/03/2019

RMA/2019/593

New Dwelling with Detached Carport

Processing complete

Applied 20/03/2019

Decision issued 17/04/2019

Granted 17/04/2019

RMA/2020/404

To construct a dwelling with attached garage

Processing complete

Applied 27/02/2020

Decision issued 20/03/2020

Granted 19/03/2020

4 Musket Lane

RMA/1989/929

Consent to subdivide and develop land for residential purposes on land specifically identified in District scheme for horse training, racing and associated activities. - Historical Reference RES954071

Processing complete

Applied 27/10/1989

Decision issued 18/04/1990

Granted 18/04/1990

RMA/1999/1466

Consent to subdivide land which has been specifically identified within the Operative District Scheme. - Historical Reference RES954074

Processing complete

Applied 01/01/1999

Decision issued 12/05/1988

Granted 12/05/1988

RMA/2019/161

Construct a two storey dwelling with attached garage - Lot 237

Processing complete

Applied 29/01/2019

Decision issued 06/03/2019

Granted 05/03/2019

RMA/2019/2034

To Construct a Dwelling with Attached Garage (Lot 249)

Processing complete

Applied 05/09/2019

Decision issued 18/09/2019

Granted 18/09/2019

RMA/2019/2130

To Construct a Residential Dwelling with Attached Garage - CT5716 - Lot 233 Karamu

Not accepted for processing

Applied 16/09/2019

Not accepted for processing 23/09/2019

RMA/2019/2203

To Construct a Dwelling with Attached Garage - CT5716

Processing complete

Applied 25/09/2019

Decision issued 01/10/2019

Granted 30/09/2019

RMA/2019/2364

Construct dwelling with attached garage - Lot 242

Processing complete

Applied 15/10/2019

Decision issued 22/10/2019

Granted 21/10/2019

RMA/2019/2399

To Construct a Dwelling with Attached Garage - CT5780

Processing complete

Applied 18/10/2019

Decision issued 23/10/2019

Granted 23/10/2019

RMA/2019/361

Wastewater Capacity Certificate

Processing complete

Applied 22/02/2019

Certificate unable to be issued 25/03/2019

RMA/2019/593

New Dwelling with Detached Carport

Processing complete

Applied 20/03/2019

Decision issued 17/04/2019

Granted 17/04/2019

40 Miromiro Street

RMA/2021/762

Subdivision - Fee simple - 16 Lots with land use - Reapplied under 2021-22 DC policy - RMA/2021/3104

Surrendered

Applied 26/03/2021

Granted 14/05/2021

Decision issued 14/05/2021

41R Miromiro Street

RMA/1989/929

Consent to subdivide and develop land for residential purposes on land specifically identified in District scheme for horse trainin, racing and associated activities. - Historical Reference RES954071

Processing complete

Applied 27/10/1989

Decision issued 18/04/1990

Granted 18/04/1990

RMA/1999/1466

Consent to subdivide land which has been specifically identified within the Operative District Scheme. - Historical Reference RES954074

Processing complete

Applied 01/01/1999

Decision issued 12/05/1988

Granted 12/05/1988

RMA/2019/161

Construct a two storey dwelling with attached garage - Lot 237

Processing complete

Applied 29/01/2019

Decision issued 06/03/2019

Granted 05/03/2019

RMA/2019/2034

To Construct a Dwelling with Attached Garage (Lot 249)

Processing complete

Applied 05/09/2019

Decision issued 18/09/2019

Granted 18/09/2019

RMA/2019/2130

To Construct a Residential Dwelling with Attached Garage - CT5716 - Lot 233 Karamu

Not accepted for processing

Applied 16/09/2019

Not accepted for processing 23/09/2019

RMA/2019/2203

To Construct a Dwelling with Attached Garage - CT5716

Processing complete

Applied 25/09/2019

Decision issued 01/10/2019

Granted 30/09/2019

RMA/2019/2364

Construct dwelling with attached garage - Lot 242

Processing complete

Applied 15/10/2019

Decision issued 22/10/2019

Granted 21/10/2019

RMA/2019/2399

To Construct a Dwelling with Attached Garage - CT5780

Processing complete

Applied 18/10/2019

Decision issued 23/10/2019

Granted 23/10/2019

RMA/2019/361

Wastewater Capacity Certificate

Processing complete

Applied 22/02/2019

Certificate unable to be issued 25/03/2019

RMA/2019/593

New Dwelling with Detached Carport

Processing complete

Applied 20/03/2019

Decision issued 17/04/2019

Granted 17/04/2019

42 Miromiro Street

RMA/2021/762

Subdivision - Fee simple - 16 Lots with land use - Reapplied under 2021-22 DC policy - RMA/2021/3104

Surrendered

Applied 26/03/2021

Decision issued 14/05/2021

Granted 14/05/2021

44 Miromiro Street

RMA/2021/762

Subdivision - Fee simple - 16 Lots with land use - Reapplied under 2021-22 DC policy - RMA/2021/3104

Surrendered

Applied 26/03/2021

Decision issued 14/05/2021

Granted 14/05/2021

46 Miromiro Street

RMA/2021/762

Subdivision - Fee simple - 16 Lots with land use - Reapplied under 2021-22 DC policy - RMA/2021/3104

Surrendered

Applied 26/03/2021

Decision issued 14/05/2021

Granted 14/05/2021

48 Miromiro Street

RMA/2021/762

Subdivision - Fee simple - 16 Lots with land use - Reapplied under 2021-22 DC policy - RMA/2021/3104

Surrendered

Applied 26/03/2021

Decision issued 14/05/2021

Granted 14/05/2021

5 Koral Lane

RMA/2021/762

Subdivision - Fee simple - 16 Lots with land use - Reapplied under 2021-22 DC policy - RMA/2021/3104

Surrendered

Applied 26/03/2021

Decision issued 14/05/2021

Granted 14/05/2021

50 Miromiro Street

RMA/2021/762

Subdivision - Fee simple - 16 Lots with land use - Reapplied under 2021-22 DC policy - RMA/2021/3104

Surrendered

Applied 26/03/2021

Decision issued 14/05/2021

Granted 14/05/2021

52 Miromiro Street

RMA/2021/762

Subdivision - Fee simple - 16 Lots with land use - Reapplied under 2021-22 DC policy - RMA/2021/3104

Surrendered

Applied 26/03/2021

Decision issued 14/05/2021

Granted 14/05/2021

54 Miromiro Street

RMA/1989/929

Consent to subdivide and develop land for residential purposes on land specifically identified in District scheme for horse training, racing and associated activities. - Historical Reference RES954071

Processing complete

Applied 27/10/1989

Decision issued 18/04/1990

Granted 18/04/1990

Granted 18/04/1990

Decision issued 18/04/1990

RMA/1999/1466

Consent to subdivide land which has been specifically identified within the Operative District Scheme. - Historical Reference RES954074

Processing complete

Applied 01/01/1999

Decision issued 12/05/1988

Granted 12/05/1988

Granted 12/05/1988

Decision issued 12/05/1988

RMA/2019/161

Construct a two storey dwelling with attached garage - Lot 237

Processing complete

Applied 29/01/2019

Granted 05/03/2019

Decision issued 06/03/2019

Decision issued 06/03/2019

Granted 05/03/2019

RMA/2019/2034

To Construct a Dwelling with Attached Garage (Lot 249)

Processing complete

Applied 05/09/2019

Decision issued 18/09/2019

Granted 18/09/2019

Granted 18/09/2019

Decision issued 18/09/2019

RMA/2019/2130

To Construct a Residential Dwelling with Attached Garage - CT5716 - Lot 233 Karamu

Not accepted for processing

Applied 16/09/2019

Not accepted for processing 23/09/2019

Not accepted for processing 23/09/2019

RMA/2019/2203

To Construct a Dwelling with Attached Garage - CT5716

Processing complete

Applied 25/09/2019

Decision issued 01/10/2019

Granted 30/09/2019

Granted 30/09/2019

Decision issued 01/10/2019

RMA/2019/2364

Construct dwelling with attached garage - Lot 242

Processing complete

Applied 15/10/2019

Decision issued 22/10/2019

Granted 21/10/2019

Granted 21/10/2019

Decision issued 22/10/2019

RMA/2019/2399

To Construct a Dwelling with Attached Garage - CT5780

Processing complete

Applied 18/10/2019

Decision issued 23/10/2019

Granted 23/10/2019

Granted 23/10/2019

Decision issued 23/10/2019

RMA/2019/361

Wastewater Capacity Certificate

Processing complete

Applied 22/02/2019

Certificate unable to be issued 25/03/2019

Certificate unable to be issued 25/03/2019

RMA/2019/593

New Dwelling with Detached Carport

Processing complete

Applied 20/03/2019

Decision issued 17/04/2019

Granted 17/04/2019

Granted 17/04/2019

Decision issued 17/04/2019

RMA/2020/1585

Construction of a five unit comprehensive residential development

Processing complete

Applied 29/07/2020

Granted 15/09/2020

Decision issued 15/09/2020

Decision issued 15/09/2020

Granted 15/09/2020

6 Koral Lane

RMA/1989/929

Consent to subdivide and develop land for residential purposes on land specifically identified in District scheme for horse trainin, racing and associated activities. - Historical Reference RES954071

Processing complete

Applied 27/10/1989

Decision issued 18/04/1990

Granted 18/04/1990

RMA/1999/1466

Consent to subdivide land which has been specifically identified within the Operative District Scheme. - Historical Reference RES954074

Processing complete

Applied 01/01/1999

Decision issued 12/05/1988

Granted 12/05/1988

RMA/2019/161

Construct a two storey dwelling with attached garage - Lot 237

Processing complete

Applied 29/01/2019

Decision issued 06/03/2019

Granted 05/03/2019

RMA/2019/2034

To Construct a Dwelling with Attached Garage (Lot 249)

Processing complete

Applied 05/09/2019

Decision issued 18/09/2019

Granted 18/09/2019

RMA/2019/2130

To Construct a Residential Dwelling with Attached Garage - CT5716 - Lot 233 Karamu

Not accepted for processing

Applied 16/09/2019

Not accepted for processing 23/09/2019

RMA/2019/2203

To Construct a Dwelling with Attached Garage - CT5716

Processing complete

Applied 25/09/2019

Decision issued 01/10/2019

Granted 30/09/2019

RMA/2019/2364

Construct dwelling with attached garage - Lot 242

Processing complete

Applied 15/10/2019

Decision issued 22/10/2019

Granted 21/10/2019

RMA/2019/2399

To Construct a Dwelling with Attached Garage - CT5780

Processing complete

Applied 18/10/2019

Decision issued 23/10/2019

Granted 23/10/2019

RMA/2019/2965

To construct a dwelling

Processing complete

Applied 18/12/2019

Decision issued 25/02/2020

Granted 25/02/2020

RMA/2019/361

Wastewater Capacity Certificate

Processing complete

Applied 22/02/2019

Certificate unable to be issued 25/03/2019

RMA/2019/593

New Dwelling with Detached Carport

Processing complete

Applied 20/03/2019

Decision issued 17/04/2019

Granted 17/04/2019

6 Miromiro Street

RMA/2020/2701

Construct 31 residential units across the two sites.

Processing complete

Applied 20/11/2020

Decision issued 15/01/2021

Granted 15/01/2021

Within scope amendment accepted 26/03/2021

Within scope amendment decision issued 26/03/2021

62 Miromiro Street

RMA/2020/2701

Construct 31 residential units across the two sites.

Processing complete

Applied 20/11/2020

Decision issued 15/01/2021

Granted 15/01/2021

Within scope amendment accepted 26/03/2021

Within scope amendment decision issued 26/03/2021

64 Miromiro Street

RMA/2020/2701

Construct 31 residential units across the two sites.

Processing complete

Applied 20/11/2020

Granted 15/01/2021

Within scope amendment accepted 26/03/2021

Within scope amendment decision issued 26/03/2021

Decision issued 15/01/2021

66 Miromiro Street

RMA/2020/2701

Construct 31 residential units across the two sites.

Processing complete

Applied 20/11/2020

Decision issued 15/01/2021

Granted 15/01/2021

Within scope amendment accepted 26/03/2021

Within scope amendment decision issued 26/03/2021

68 Miromiro Street

RMA/2020/2701

Construct 31 residential units across the two sites.

Processing complete

Applied 20/11/2020

Decision issued 15/01/2021

Granted 15/01/2021

Within scope amendment accepted 26/03/2021

Within scope amendment decision issued 26/03/2021

7 Koral Lane

RMA/2021/762

Subdivision - Fee simple - 16 Lots with land use - Reapplied under 2021-22 DC policy - RMA/2021/3104

Surrendered

Applied 26/03/2021

Decision issued 14/05/2021

Granted 14/05/2021

70 Miromiro Street

RMA/2020/2701

Construct 31 residential units across the two sites.

Processing complete

Applied 20/11/2020

Decision issued 15/01/2021

Granted 15/01/2021

Within scope amendment accepted 26/03/2021

Within scope amendment decision issued 26/03/2021

72 Miromiro Street

RMA/2020/2701

Construct 31 residential units across the two sites.

Processing complete

Applied 20/11/2020

Decision issued 15/01/2021

Granted 15/01/2021

Within scope amendment accepted 26/03/2021

Within scope amendment decision issued 26/03/2021

74 Miromiro Street

RMA/2020/2701

Construct 31 residential units across the two sites.

Processing complete

Applied 20/11/2020

Decision issued 15/01/2021

Granted 15/01/2021

Within scope amendment accepted 26/03/2021

Within scope amendment decision issued 26/03/2021

76 Miromiro Street

RMA/2020/2701

Construct 31 residential units across the two sites.

Processing complete

Applied 20/11/2020

Granted 15/01/2021

Within scope amendment accepted 26/03/2021

Within scope amendment decision issued 26/03/2021

Decision issued 15/01/2021

78 Miromiro Street

RMA/2020/2701

Construct 31 residential units across the two sites.

Processing complete

Applied 20/11/2020

Decision issued 15/01/2021

Granted 15/01/2021

Within scope amendment accepted 26/03/2021

Within scope amendment decision issued 26/03/2021

8 Koral Lane

RMA/1989/929

Consent to subdivide and develop land for residential purposes on land specifically identified in District scheme for horse trainin, racing and associated activities. - Historical Reference RES954071

Processing complete

Applied 27/10/1989

Decision issued 18/04/1990

Granted 18/04/1990

RMA/1999/1466

Consent to subdivide land which has been specifically identified within the Operative District Scheme. - Historical Reference RES954074

Processing complete

Applied 01/01/1999

Decision issued 12/05/1988

Granted 12/05/1988

RMA/2019/161

Construct a two storey dwelling with attached garage - Lot 237

Processing complete

Applied 29/01/2019

Decision issued 06/03/2019

Granted 05/03/2019

RMA/2019/2034

To Construct a Dwelling with Attached Garage (Lot 249)

Processing complete

Applied 05/09/2019

Decision issued 18/09/2019

Granted 18/09/2019

RMA/2019/2130

To Construct a Residential Dwelling with Attached Garage - CT5716 - Lot 233 Karamu

Not accepted for processing

Applied 16/09/2019

Not accepted for processing 23/09/2019

RMA/2019/2203

To Construct a Dwelling with Attached Garage - CT5716

Processing complete

Applied 25/09/2019

Decision issued 01/10/2019

Granted 30/09/2019

RMA/2019/2364

Construct dwelling with attached garage - Lot 242

Processing complete

Applied 15/10/2019

Decision issued 22/10/2019

Granted 21/10/2019

RMA/2019/2399

To Construct a Dwelling with Attached Garage - CT5780

Processing complete

Applied 18/10/2019

Decision issued 23/10/2019

Granted 23/10/2019

RMA/2019/361

Wastewater Capacity Certificate

Processing complete

Applied 22/02/2019

Certificate unable to be issued 25/03/2019

RMA/2019/593

New Dwelling with Detached Carport

Processing complete

Applied 20/03/2019

Decision issued 17/04/2019

Granted 17/04/2019

8 Miromiro Street

RMA/2020/2701

Construct 31 residential units across the two sites.

Processing complete

Applied 20/11/2020

Decision issued 15/01/2021

Granted 15/01/2021

Within scope amendment accepted 26/03/2021

Within scope amendment decision issued 26/03/2021

9 Koral Lane

RMA/2021/762

Subdivision - Fee simple - 16 Lots with land use - Reapplied under 2021-22 DC policy - RMA/2021/3104

Surrendered

Applied 26/03/2021

Decision issued 14/05/2021

Granted 14/05/2021

Data Quality Statement

Land Use Consents

All resource consents are shown for sites that have been labelled with an address. For sites that have been labelled with a cross (+) no resource consents have been found. Sites that have no label have not been checked for resource consents. This will be particularly noticeable on the margins of the search radius. If there are such sites and you would like them included in the check, please ask for the LIM spatial query to be rerun accordingly. This will be done free of charge although there may be a short delay. Resource consents which are on land occupied by roads, railways or rivers are not, and currently cannot be displayed, either on the map or in the list. Resource consents that relate to land that has since been subdivided, will be shown in the list, but not on the map. They will be under the address of the land as it was at the time the resource consent was applied for. Resource consents that are listed as Non-notified and are current, may in fact be notified resource consents that have not yet been through the notification process. If in doubt. Please phone (03)941 8999.

The term “resource consents” in this context means land use consents. Subdivision consents and certificates of compliance are excluded.

Subdivision Consents

All subdivision consents are shown for the sites that have been labelled with consent details. For Sites that have been labelled with a cross (+) no records have been found. Sites that have no label have not been checked for subdivision consents. This will be particularly noticeable on the margins of the search radius. If there are such sites and you would like them included in the check, please ask for the LIM spatial query to be rerun accordingly. This will be done free of charge although there may be a short delay.

The term “subdivision consents” in this context means a resource consent application to subdivide land. Non subdivision land use resource consents and certificates of compliance are excluded.

This report will only record those subdivision applications which have not been completed i.e once a subdivision has been given effect to and the new lots/properties have been established the application which created those lots will not be shown

All subdivision consent information is contained on the map and no separate list is supplied