

Land Information Memorandum

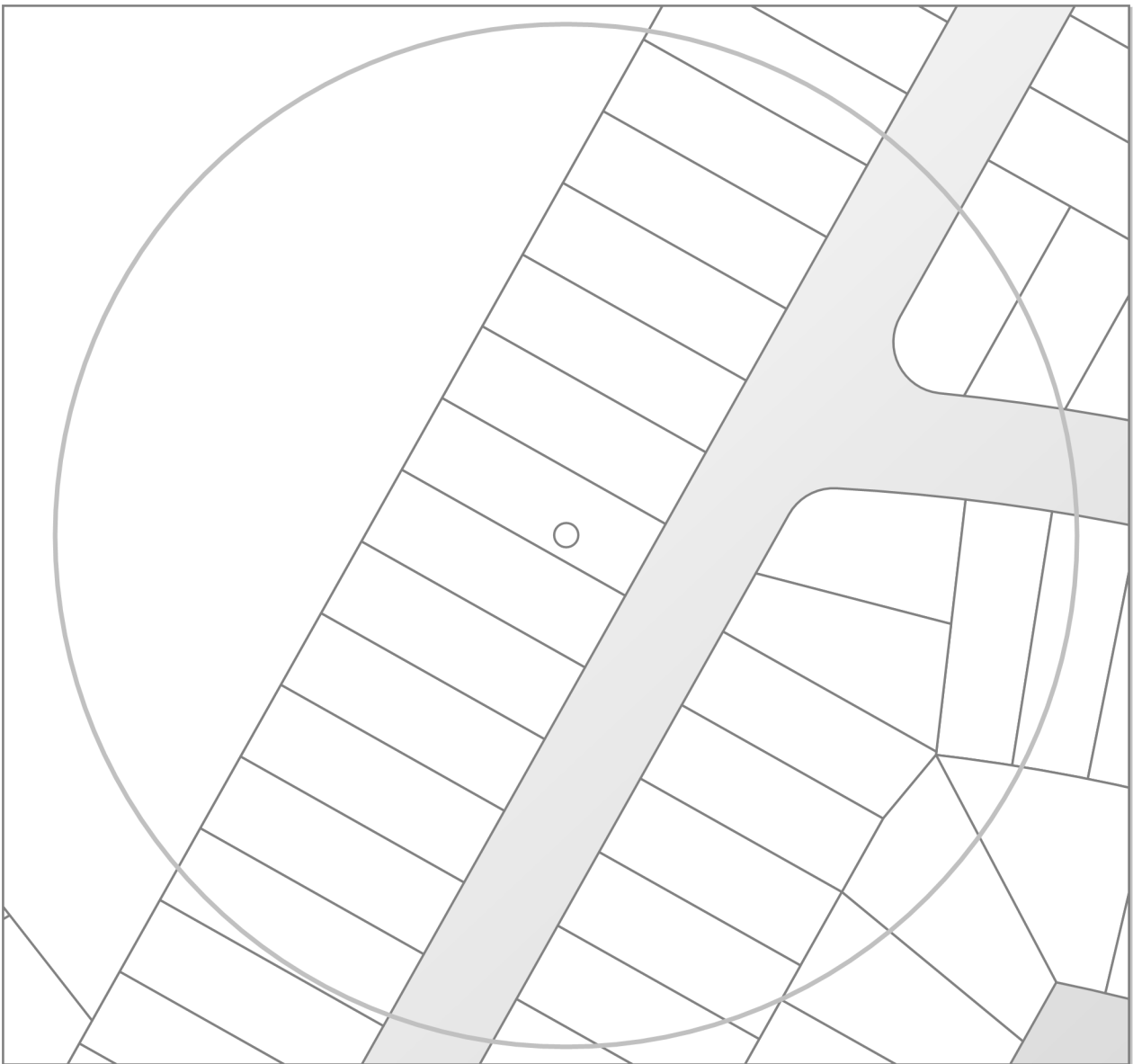

Property address:

125 Harris Crescent

LIM number: H09326627

Page 1

Christchurch City Council

53 Hereford Street, PO Box 73015
Christchurch 8154, New Zealand
Tel 64 3 941 8999
Fax 64 3 941 8984

www.ccc.govt.nz

Application details

Date issued 17 September 2025
Date received 12 September 2025

Property details

Property address 125 Harris Crescent, Papanui, Christchurch
Valuation roll number 22182 54800
Valuation information Capital Value: \$680,000
Land Value: \$440,000
Improvements Value: \$240,000
Please note: these values are intended for Rating purposes
Legal description Lot 50 DP 19712
Existing owner Cheryl Rose Stowers
Harry John Stowers
125 Harris Crescent
Christchurch 8053

Council references

Rate account ID 73123268
LIM number H09326627
Property ID 1105319

Property address:

125 Harris Crescent

LIM number: H09326627

Page 2

Christchurch City Council

53 Hereford Street, PO Box 73015
Christchurch 8154, New Zealand
Tel 64 3 941 8999
Fax 64 3 941 8984

www.ccc.govt.nz

Document information

This Land Information Memorandum (LIM) has been prepared for the purpose of section 44A of the Local Government Official Information and Meetings Act 1987 (LGOIMA). It is a summary of the information that we hold on the property. Each heading or "clause" in this LIM corresponds to a part of section 44A.

Sections 1 to 10 contain all of the information known to the Christchurch City Council that must be included under section 44A(2) LGOIMA. Any other information concerning the land as the Council considers, at its discretion, to be relevant is included at section 11 of this LIM (section 44A(3) LGOIMA). If there are no comments or information provided in these sections this means that the Council does not hold information on the property that corresponds to that part of section 44A.

The information included in this LIM is based on a search of Council records only and there may be other information relating to the land which is unknown to the Council. Please note that other agencies may also hold information relevant to the property, or administer legislation relevant to the use of the land, for example, the Regional Council (Ecan), Heritage New Zealand Pouhere Taonga, and Land Information New Zealand.

Council records may not show illegal or unauthorised building or works on the property. The applicant is solely responsible for ensuring that the land is suitable for a particular purpose.

A LIM is only valid at the date of issue as information is based only upon information the Council held at the time of that LIM request being made. It is essential that the applicant undertakes their own due diligence to verify the suitability of the property for their intended use.

Property file service

This Land Information Memorandum does not contain all information held on a property file. Customers may request property files by phoning the Council's Customer Call Centre on (03) 941 8999, or visiting any of the Council Service Centres. For further information please visit www.ccc.govt.nz.

To enable the Council to measure the accuracy of this LIM document based on our current records, we would appreciate your response should you find any information contained therein which may be considered to be incorrect or omitted. Please telephone the Customer Call Centre on (03) 941 8999.

Property address:

125 Harris Crescent

LIM number: H09326627

Page 3

Christchurch City Council

53 Hereford Street, PO Box 73015
Christchurch 8154, New Zealand
Tel 64 3 941 8999
Fax 64 3 941 8984

www.ccc.govt.nz

A search of records held by the Council has revealed the following information:

1. Special features and characteristics of the land

Section 44A(2)(a) LGOIMA. This is information known to the Council but not apparent from the district scheme under the Town and Country Planning Act 1977 or a district plan under the Resource Management Act 1991. It identifies each (if any) special feature or characteristic of the land concerned, including but not limited to potential erosion, avulsion, falling debris, subsidence, slippage, alluvion, or inundation, or likely presence of hazardous contaminants.

☎ For enquiries, please phone (03) 941 8999 or visit www.ccc.govt.nz.

Natural Hazards

(a) Coastal Hazards

As at the date of this LIM, Council research found no information under this heading.

(b) Earthquakes

- Consultant Report Available

The Tonkin & Taylor Darfield Earthquake 4 September 2010 Geotechnical Land Damage Assessment & Reinstatement Stage 1 Report indicates areas of observed surface manifestations of liquefaction resulting from the earthquake. This property is within one of the identified areas. The report can be viewed at www.eqc.govt.nz/our-publications/darfield-earthquake-geotechnical-land-damage-assessment-reinstatement-stage-1/

- Liquefaction Assessment

Christchurch City Council holds indicative information on liquefaction hazard for Christchurch. Information on liquefaction, including an interactive web tool, can be found on the Council website at ccc.govt.nz/liquefaction. Depending on the liquefaction potential of the area that the property is in, the Council may require site-specific investigations before granting future subdivision or building consent for the property.

(c) Flooding

- Flood Assessment

Council is currently updating the flood map database. For information relating to flooding at this address please email floorlevels@ccc.govt.nz.

(d) Landslides

As at the date of this LIM, Council research found no information under this heading.

(e) Subsidence

- Consultant Report Available

Land Information New Zealand (LINZ) engaged Tonkin and Taylor to provide a Geotechnical Report on Ground Movements that occurred as a result of the Canterbury Earthquake Sequence. The report indicates this property may have been effected by a degree of earthquake induced subsidence. The report obtained by LINZ can be accessed on their website at <https://www.linz.govt.nz> and search Information for Canterbury Surveyors.

(f) Tsunamis

As at the date of this LIM, Council research found no information under this heading.

(g) Volcanic and Geothermal Hazards

As at the date of this LIM, Council research found no information under this heading.

(h) Wind

As at the date of this LIM, Council research found no information under this heading.

(i) Any Other Natural Hazards

As at the date of this LIM, Council research found no information under this heading.

Property address:

125 Harris Crescent

LIM number: H09326627

Page 4

Christchurch City Council

53 Hereford Street, PO Box 73015
Christchurch 8154, New Zealand
Tel 64 3 941 8999
Fax 64 3 941 8984

www.ccc.govt.nz

(j) District Plan Natural Hazard Information

Please refer to *Section 8. Land use and conditions* of this report for District Plan related natural hazard information.

(k) Building Notices

Please refer to *Section 5. Consents, certificates, notices, orders, or requisitions affecting the land and buildings* of this report for Building Act notice information.

Other Special Features or Characteristics of the Land

As at the date of this LIM, Council research found no information under this heading.

2. Private and public stormwater and sewerage drains

Section 44A(2)(b) LGOIMA. This is information about private and public stormwater and sewerage drains as shown in the Council's records.

 For stormwater and sewerage enquiries, please phone (03) 941 8999 or visit www.ccc.govt.nz.

Related Information

- Attached are all drainage plans that Council hold for details of private and public drainage. Not all plans provided are verified by Council, and therefore Council cannot be liable for inaccuracies. Site investigation will be required by owners to determine exact layouts.
- This property is shown to be served by Christchurch City Council Sewer.
- The council plan shows no public stormwater lateral to this site.

Property address:

125 Harris Crescent

LIM number: H09326627

Page 6

Christchurch City Council

53 Hereford Street, PO Box 73015
Christchurch 8154, New Zealand
Tel 64 3 941 8999
Fax 64 3 941 8984

www.ccc.govt.nz

3. Drinking Water Supply

Section 44A(2)(ba) and (bb) LGOIMA. This is information notified to the Council about whether the land is supplied with drinking water, whether the supplier is the owner of the land or a networked supplier, any conditions that are applicable, and any information the Council has about the supply.

Please note the council does not guarantee a particular water quality to its customers. If you require information on current water quality at this property please contact the Three Waters & Waste Unit.

☎ For water supply queries, please phone (03) 941 8999 or visit www.ccc.govt.nz.

Water supply

Christchurch City Council is the networked supplier of water to this property. This property is connected to the Christchurch City Council Water Supply. The conditions of supply are set out in the Christchurch City Council Water Supply and Wastewater Bylaw (2022), refer to www.ccc.govt.nz.

Property address:

125 Harris Crescent

LIM number: H09326627

Page 7

Christchurch City Council

53 Hereford Street, PO Box 73015
Christchurch 8154, New Zealand
Tel 64 3 941 8999
Fax 64 3 941 8984

www.ccc.govt.nz

4. Rates

Section 44A(2)(c) LGOIMA. This is information on any rates owing in relation to the land.

☎ For rates enquiries, please phone (03) 941 8999 or visit www.ccc.govt.nz.

(a) Annual rates

Annual rates to 30/06/2026: \$4,151.99

	Instalment Amount	Date Due
Instalment 1	\$1,037.95	15/08/2025
Instalment 2	\$1,037.95	15/11/2025
Instalment 3	\$1,037.95	15/02/2026
Instalment 4	\$1,038.14	15/05/2026

Rates owing as at 17/09/2025: \$2,078.17

(b) Excess Water Rates

For excess water charge enquiries, please phone (03) 941 8999 or visit www.ccc.govt.nz/contact-us.

(c) Final water meter reading required at settlement?

Property settlements must ensure all water usage and outstanding debts are accurately accounted for.

To advise of a property settlement, please complete the request for settlement information form at www.ccc.govt.nz/services/rates-and-valuations/solicitors-request.

A settlement statement of accounts will be provided on the expected settlement date advised.

Property address:

125 Harris Crescent

LIM number: H09326627

Page 8

Christchurch City Council

53 Hereford Street, PO Box 73015
Christchurch 8154, New Zealand
Tel 64 3 941 8999
Fax 64 3 941 8984

www.ccc.govt.nz

5. Consents, certificates, notices, orders, or requisitions affecting the land and buildings

Section 44A(2)(d) LGOIMA. This is information concerning any consent, certificate, notice, order, or requisition, affecting the land or any building on the land, previously issued by the Council. The information in this section may also cover building consent and/or code compliance information issued by building certifiers under the Building Act 1991 and building consent authorities that are not the Council under the Building Act 2004.

You can check the property file to identify whether any consent or certificate was issued by a building certifier under the Building Act 1991.

Section 44A(2)(da) LGOIMA. The information required to be provided to a territorial authority under section 362T(2) of the Building Act 2004. There is currently no information required to be provided by a building contractor to a territorial authority under section 362T(2) of the Building Act 2004. The Building (Residential Consumer Rights and Remedies) Regulations 2014 only prescribed the information that must be given to the clients of a building contractor.

Sections 71 to 74 of the Building Act 2004 require the Building Consent Authority to consider natural hazards when it receives a building consent application for the construction or major alteration of a building on land that is subject to, or likely to be subject to, a natural hazard. A building consent for this property may have been issued subject to a section 72 or 73 notice. This means at the time of building consent the Building Consent Authority was not satisfied that adequate provision would be made to protect the building and land from the natural hazard and was subsequently required to notify the Registrar-General of Land to record the natural hazard on the Record of Title. The Building Act 2004 defines natural hazards as erosion (including coastal erosion, bank erosion, and sheet erosion), falling debris (including soil, rock, snow, and ice), subsidence, inundation (including flooding, overland flow, storm surge, tidal effects, and ponding), and slippage.

If your property contains a notice under s73 of the Building Act 2004, this will be identified on the building consent decision below (decision under s72 of the Building Act 2004) and on the properties' Record of Title. The Record of Title may also record this as a s36 notice under the Building Act 1991, or a s641A notice under the Local Government Act 1974.

 For building enquiries, please phone (03) 941 8999, email EPADutyBCO@ccc.govt.nz or visit www.ccc.govt.nz.

(a) Consents

- BCN/1958/3135 Applied: 18/07/1958 Status: Completed
125 Harris Crescent Papanui
Permit issued 15/08/1958
DWELLING- Historical Reference PER5859346 - No plans/information held on property file
- BCN/1960/5076 Applied: 10/10/1960 Status: Completed
125 Harris Crescent Papanui
Permit issued 17/10/1960
GARAGE- Historical Reference PER6061384 - No plans/information held on property file
- BCN/1966/5264 Applied: 13/09/1966 Status: Completed
125 Harris Crescent Papanui
Permit issued 22/09/1966
ADDITION TO DWELLING- Historical Reference PER66670919
- BCN/1977/3442 Applied: 04/07/1977 Status: Completed
125 Harris Crescent Papanui
Permit issued 08/07/1977
SPACE HEATER- Historical Reference PER77780333
- BCN/1978/2467 Applied: 26/05/1978 Status: Completed
125 Harris Crescent Papanui
Permit issued 06/06/1978
GARAGE- Historical Reference PER78790314

Property address:

125 Harris Crescent

LIM number: H09326627

Christchurch City Council

53 Hereford Street, PO Box 73015
Christchurch 8154, New Zealand
Tel 64 3 941 8999
Fax 64 3 941 8984

- BCN/1996/8169 Applied: 18/10/1996 Status: Completed
125 Harris Crescent Papanui
Accepted for processing 18/10/1996
Building consent granted 07/11/1996
Building consent issued 11/11/1996
Code Compliance Certificate Granted 02/08/1999
Code Compliance Certificate Issued 02/08/1999
Conservatory outbuilding/ conservatory- Historical Reference CON96009066
- BCN/2011/6798 Applied: 11/05/2011 Status: Completed
125 Harris Crescent Papanui
Exemption from building consent approved 01/06/2011
Application for exemption from Building Consent for urgent Log Burner/Metro Eco
Xtreme Rad (Wetback)/Freestanding/Dry/Woodburner/Clean Air Certificate No: 112026
- Historical Reference BAE35003957

(b) Certificates

Note: Code Compliance Certificates were only issued by the Christchurch City Council since January 1993.

(c) Notices

(d) Orders

(e) Requisitions

Property address:

125 Harris Crescent

LIM number: H09326627

Page 10

Christchurch City Council

53 Hereford Street, PO Box 73015
Christchurch 8154, New Zealand
Tel 64 3 941 8999
Fax 64 3 941 8984

www.ccc.govt.nz

6. Certificates issued by a building certifier

Section 44A(2)(e) LGOIMA. This is information notified to the Council concerning any certificate issued by a building certifier pursuant to the Building Act 1991 or the Building Act 2004.

 For building enquiries, please phone (03) 941 8999, email EPADutyBCO@ccc.govt.nz or visit www.ccc.govt.nz.

Property address:

125 Harris Crescent

LIM number: H09326627

Page 11

Christchurch City Council

53 Hereford Street, PO Box 73015
Christchurch 8154, New Zealand
Tel 64 3 941 8999
Fax 64 3 941 8984

www.ccc.govt.nz

7. Weathertightness

Section 44A(2)(ea) LGOIMA. This is information notified to the Council under section 124 of the Weathertight Homes Resolution Services Act 2006.

 For weathertight homes enquiries, please phone (03) 941 8999 or visit www.ccc.govt.nz.

If there is no information below this means Council is unaware of any formal Weathertight Homes Resolution Services claim lodged against this property.

Property address:

125 Harris Crescent

LIM number: H09326627

Page 12

Christchurch City Council

53 Hereford Street, PO Box 73015
Christchurch 8154, New Zealand
Tel 64 3 941 8999
Fax 64 3 941 8984

www.ccc.govt.nz

8. Land use and conditions

Section 44A(2)(f) LGOIMA. This is information relating to the use to which the land may be put and conditions attached to that use. The planning information provided below is not exhaustive and reference to the Christchurch District Plan and any notified proposed changes to that plan is recommended: <https://ccc.govt.nz/the-council/plans-strategies-policies-and-bylaws/plans/christchurch-district-plan/>.

There may be some provisions of the Christchurch City Plan or Banks Peninsula District Plan that affect this property that are still operative.

☎ For planning queries, please phone (03) 941 8999, email DutyPlanner@ccc.govt.nz or visit www.ccc.govt.nz.

- **Regional plan or bylaw**

There may be objectives, policies or rules in a regional plan or a regional bylaw that regulate land use and activities on this site. Please direct enquiries to Canterbury Regional Council (Environment Canterbury).

(a)(i) Christchurch City Plan & Banks Peninsula District Plan

(ii) Christchurch District Plan

- **Christchurch International Airport Protection Sfc.**

Property or part of property within the Christchurch International Airport Protection Surfaces overlay, which is operative.

- **Liquefaction Management Area (LMA)**

Property or part of property within the Liquefaction Management Area (LMA) Overlay, which is operative.

- **District Plan Zone**

Property or part of property within the Medium density residential zone, which is operative.

(b) Resource consents

If there are any land use resource consents issued for this property the Council recommends that you check those resource consents on the property file. There may be conditions attached to those resource consents for the property that are still required to be complied with.

Property address:

125 Harris Crescent

LIM number: H09326627

Page 13

Christchurch City Council

53 Hereford Street, PO Box 73015
Christchurch 8154, New Zealand
Tel 64 3 941 8999
Fax 64 3 941 8984

www.ccc.govt.nz

9. Other land and building classifications

Section 44A(2)(g) LGOIMA. This is information notified to the Council by any statutory organisation having the power to classify land or buildings for any purpose.

 For land and building enquiries, please phone (03) 941 8999 or visit www.ccc.govt.nz.

Please refer to Section 1 for details

Property address:

125 Harris Crescent

LIM number: H09326627

Page 14

Christchurch City Council

53 Hereford Street, PO Box 73015
Christchurch 8154, New Zealand
Tel 64 3 941 8999
Fax 64 3 941 8984

www.ccc.govt.nz

10. Network utility information

Section 44A(2)(h) LGOIMA. This is information notified to the Council by any network utility operator pursuant to the Building Act 1991 or the Building Act 2004.

 For network enquiries, please phone (03) 941 8999 or visit www.ccc.govt.nz.

- **None recorded for this property**

Property address:

125 Harris Crescent

LIM number: H09326627

Page 15

Christchurch City Council

53 Hereford Street, PO Box 73015
Christchurch 8154, New Zealand
Tel 64 3 941 8999
Fax 64 3 941 8984

www.ccc.govt.nz

11. Other information

Section 44A(3) LGOIMA. This is information concerning the land that the Council has the discretion to include if it considers it to be relevant.

☎ For any enquiries, please phone (03) 941 8999 or visit www.ccc.govt.nz.

(a) Kerbside waste collection

- Your organics are collected Weekly on Friday. Please leave your organics at the Kerbside by 6:00 a.m.
- Your recycling is collected Fortnightly on the Week 2 collection cycle on a Friday. Please leave your recycling at the Kerbside by 6:00 a.m. Your nearest recycling depot is the Styx Mill EcoDrop.
- Your refuse is collected Fortnightly on the Week 2 collection cycle on a Friday. Please leave your rubbish at the Kerbside by 6:00 a.m. Your nearest rubbish depot is the Styx Mill EcoDrop.

(b) Other

• Floor Levels Information

Council holds a variety of information on requirements for building or property development. This includes:

- required minimum finished floor levels, which need to be set to meet the surface water requirements in clause E1.3.2 of the Building Code (where this applies); and
- the requirements of the Christchurch District Plan (where a property is in the Flood Management Area).

Where this information has been processed for your property, you can view it online at <https://ccc.govt.nz/flooding-and-floor-levels>.

Otherwise, if you are building or developing on this land, you can request a calculation on required finished floor levels for your proposed building by emailing us at floorlevels@ccc.govt.nz.

• Guest Accommodation

Guest accommodation (including whole unit listings on Airbnb; BookaBach; etc.) generally requires a resource consent in this zone when the owner is not residing on the site. For more information, please refer to: <https://ccc.govt.nz/providing-guest-accommodation/>.

• Community Board

Property located in Papanui-Innes-Central Community Board.

• Tsunami Evacuation Zone

This property is not in a tsunami evacuation zone. It is not necessary to evacuate in a long or strong earthquake or during an official Civil Defence tsunami warning. Residents may wish to offer to open their home to family or friends who need to evacuate from a tsunami zone, and should plan with potential guests to do so in advance. More information can be found at <https://ccc.govt.nz/services/civil-defence/hazards/tsunami-evacuation-zones-and-routes/>

• Electoral Ward

Property located in Papanui Electoral Ward

• Listed Land Use Register

Hazardous activities and industries involve the use, storage or disposal of hazardous substances. These substances can sometimes contaminate the soil. Environment Canterbury identifies land that is used or has been used for hazardous activities and industries. This information is held on a publically available database called the Listed Land Use Register (LLUR). The Christchurch City Council may not hold information that is held on the LLUR. Therefore, it is recommended that you check Environment Canterbury's online database at www.llur.ecan.govt.nz

Property address:

125 Harris Crescent

LIM number: H09326627

Page 16

Christchurch City Council

53 Hereford Street, PO Box 73015
Christchurch 8154, New Zealand
Tel 64 3 941 8999
Fax 64 3 941 8984

www.ccc.govt.nz

- **Spatial Query Report**

A copy of the spatial query report is attached at the end of this LIM. The spatial query report lists land use resource consents that have been granted within 100 metres of this property.

Related Information

- The Council has received a third party work completion report/information relating to the building exemption application on this property. It has been placed on the property file. The Council does not accept any liability for the contents, or representations, made within the report/information. The report/information is not included in the Land Information Memorandum (LIM) because the Council has not verify the information/report supplied. If a copy of the property file is required you can request this through our online form by visiting ccc.govt.nz & search property file or visit a Council Service Centre.

Property address:

125 Harris Crescent

LIM number: H09326627

Page 17

Christchurch City Council

53 Hereford Street, PO Box 73015
Christchurch 8154, New Zealand
Tel 64 3 941 8999
Fax 64 3 941 8984

www.ccc.govt.nz

125 Harris Crescent

- | | |
|---|--|
| <ul style="list-style-type: none"> • WwPrivateDrainFieldNo ◻ WwPump WwAccess ◻ Flushing Point ◻ Trap ◻ Inspection Point ◻ Sealed Manhole ◻ Standard Manhole ◻ Vacuum Storage Manhole ◻ Ventd Manhole ◻ WwVent ◻ WwAirGapSeparator ◻ WwLocalPressureBoundaryK ◻ WwLocalPressureControlPa ◻ WwLocalPressureTankSystem ◻ WwOutlet ◻ WwPipeRestrict WwFitting Type • Change ◻ End Cap ◻ Junction ◻ Eye ◻ Eye (Vertical) ◻ WwLateralFitting Type ◻ Raised Inspection Point ◻ Lateral Fitting ◻ WwVacuumBreather WwVacuumChamber Type ◻ Collector ◻ Interceptor Tank ◻ Valve ◻ Riser ◻ WwVacuumBreatherPip ◻ WwPipeFlowDirection WwPipeBlockageCount NumberOfBlockages ◻ 2 or less Blockages ◻ 3 or more Blockages WwPipe NominalDiameter ◻ Diameter is 200mm or smaller ◻ Diameter is greater than 200mm, up to 450mm ◻ Diameter is greater than 450mm ◻ Other (non-circular pipes) WwPipe (non-gravily) NominalDiameter ◻ Diameter is 200mm or smaller ◻ Diameter is greater than 200mm, up to 450mm ◻ Diameter is greater than 450mm ◻ Other (non-circular pipes) WwLateral WwPipeProtection WwFlushTank WwStructure WwStation WwPumpStationCatchme WwPipe (non CCC) ◻ In Service ◻ Abandoned ◻ Removed | <ul style="list-style-type: none"> ◻ Out of Service ◻ WwLateral (non CCC) ◻ In Service ◻ Abandoned ◻ Removed ◻ Out of Service ◻ Proposed ◻ WwPump ◻ WwPrivateDrainFieldNot ◻ WwValve ◻ NormalPosition,Type ◻ Air Release ◻ Backflow Prevention ◻ Butterfly ◻ Gate ◻ Non Return ◻ Pressure Activated ◻ Sluice ◻ Sluice, Normally Closed ◻ Valve ◻ Washhydrant ◻ Washlet WwConnection Type ◻ Fire ◻ Restrictor ◻ Toby ◻ Meter ◻ WwOutlet ◻ WwPipeRestrict ◻ WwFieldNote WwFitting Type ◻ Single Sump ◻ Double Sump ◻ Triple Sump ◻ Inlet ◻ Pipe End ◻ Gross Debris Trap ◻ Silt Trap ◻ SwOutlet ◻ SwPipeRestrict SwFitting ◻ Change ◻ Bend ◻ Junction ◻ End Cap ◻ SwEye ◻ SwPipeFlowDirection SwLateralFitting Type ◻ Single Sump ◻ Double Sump ◻ Inspection Point ◻ Manhole ◻ Lateral Fitting ◻ Soak Pit SwPipe NominalDiameter ◻ Diameter is 450mm or smaller ◻ Diameter is greater than 450mm, up to 700mm ◻ Diameter is greater than 700mm ◻ Other (non-circular pipes) ◻ SwLateral ◻ SwPipeProtection ◻ SwFacility ◻ SwStructure ◻ SwStation ◻ WwPipe (non CCC) ◻ In Service ◻ Abandoned ◻ Removed ◻ Unknown ◻ WwLateral (non CCC) ◻ In Service ◻ Abandoned ◻ Removed ◻ Out of Service ◻ Proposed ◻ BCConnector ◻ BGCInCap ◻ BGVAlve ◻ BGPipe |
|---|--|



ph: 03 941 8999 web: ccc.govt.nz

Accuracy not guaranteed. Onsite verification required. Display of data scale dependent. Client selected legend.

Copyright © 2025. Reproduction prohibited.

Date: 17/09/2025 7:49 AM
 Scale: 1: 500 on A4

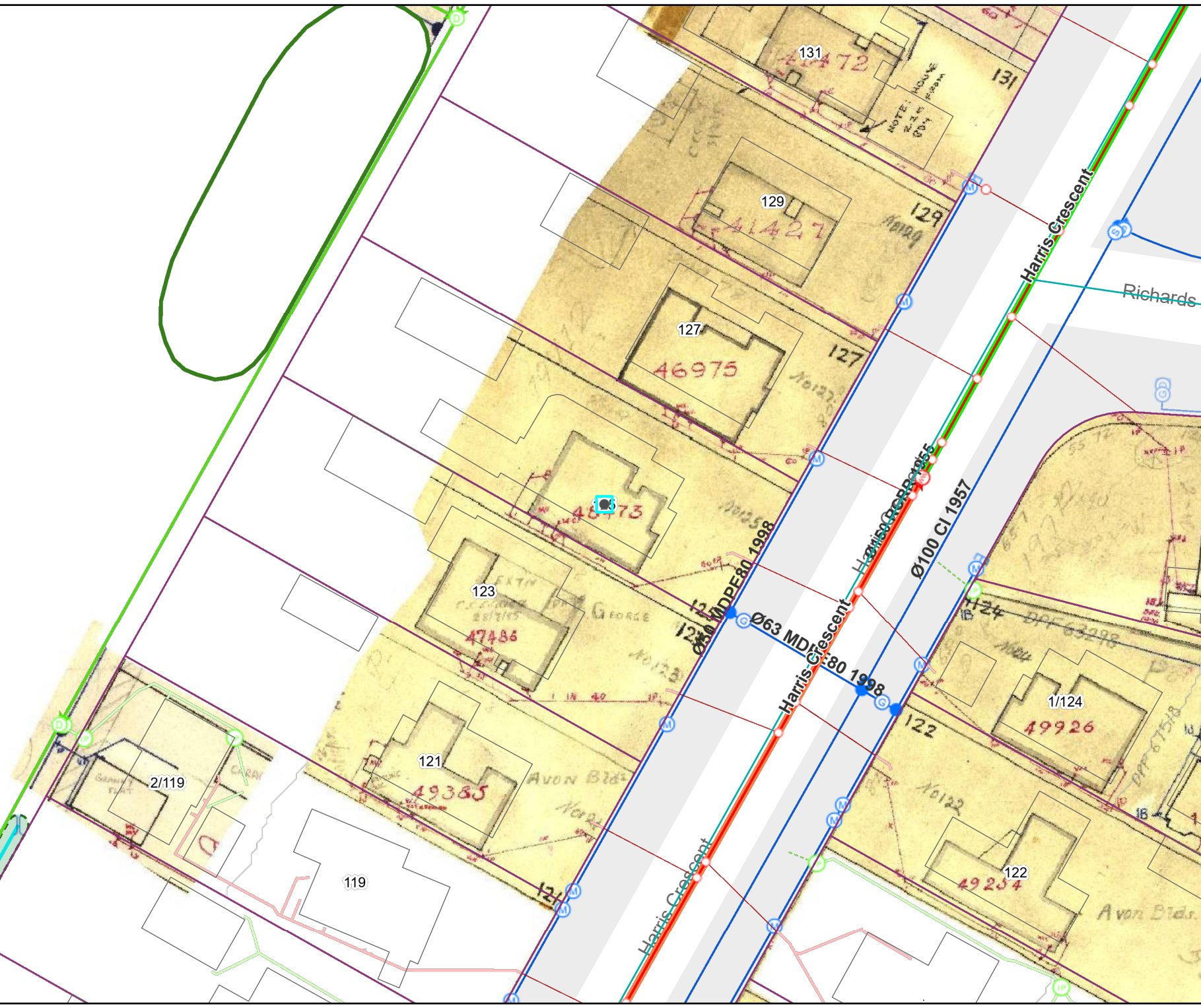

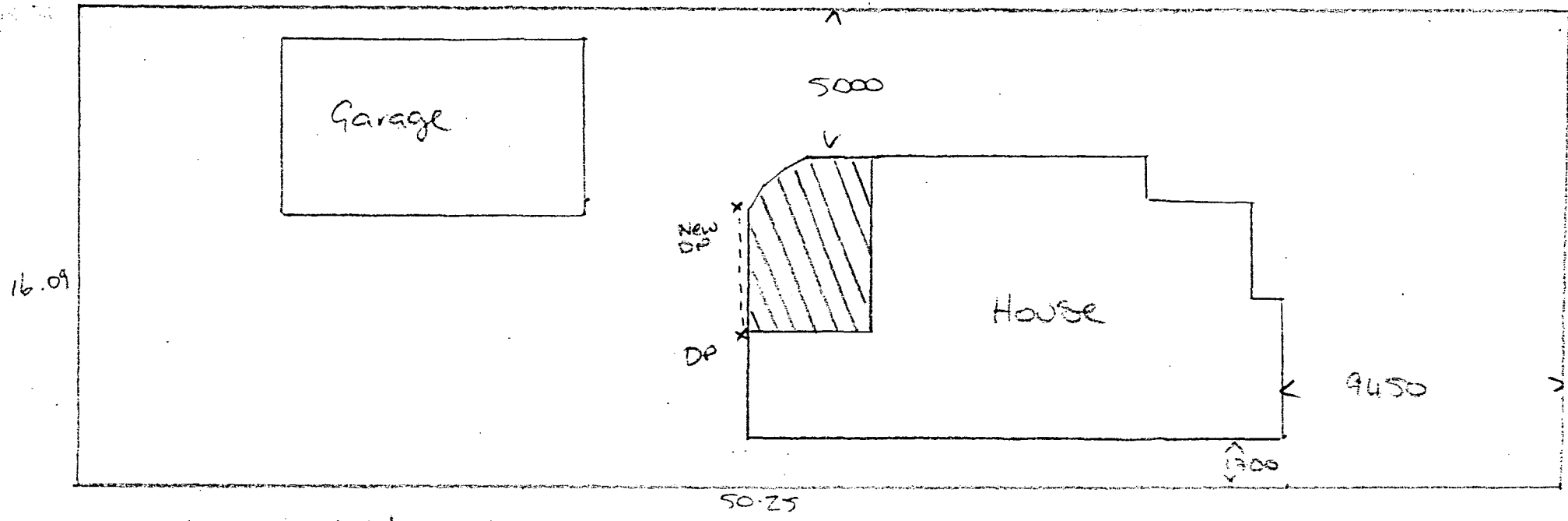

Site Area = 806 m²
 House = 135.6
 Garage = 69.6
 Conservatory = 23.0

 228.2

Site Coverage = 28.9%

CHRISTCHURCH CITY COUNCIL
 P.I.M. APPLICATION
 Rec'd 18 OCT 1996
 Linwood Service Centre
 PROJECT 96.0.0.9.0.6.6

Foundation: Not to Scale.
 Existing pad

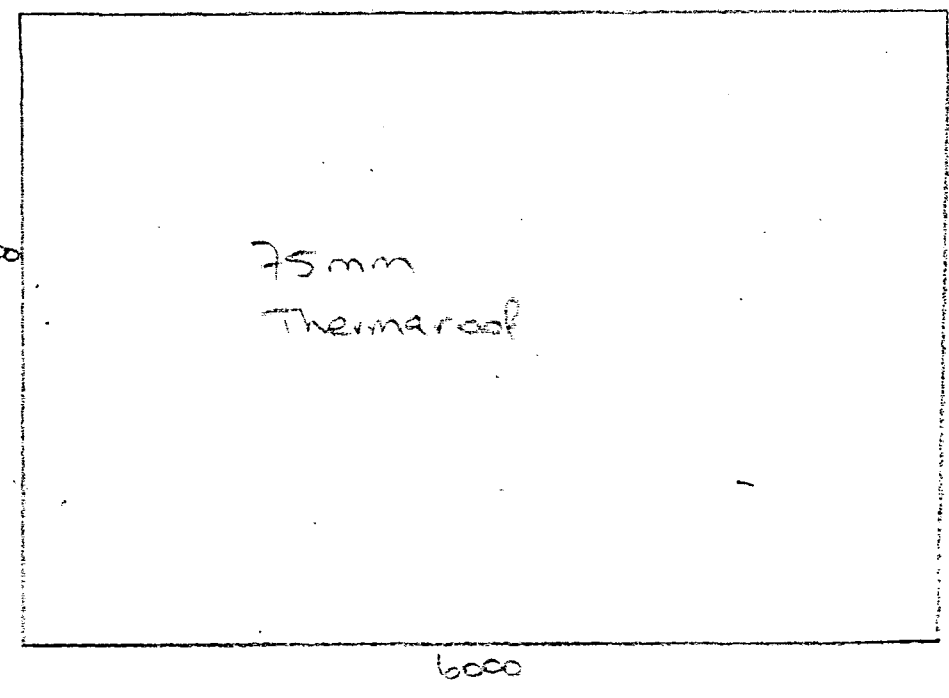
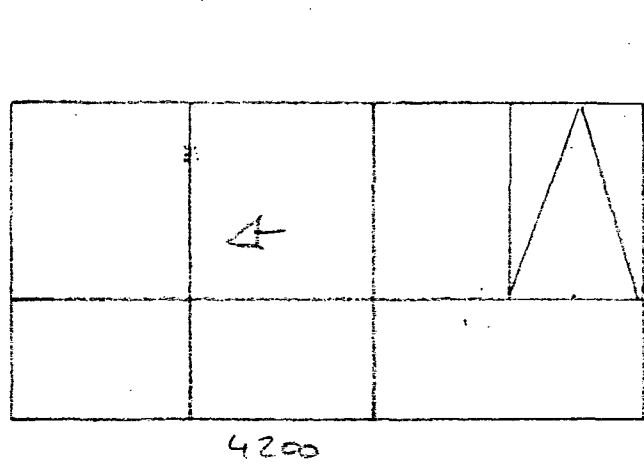
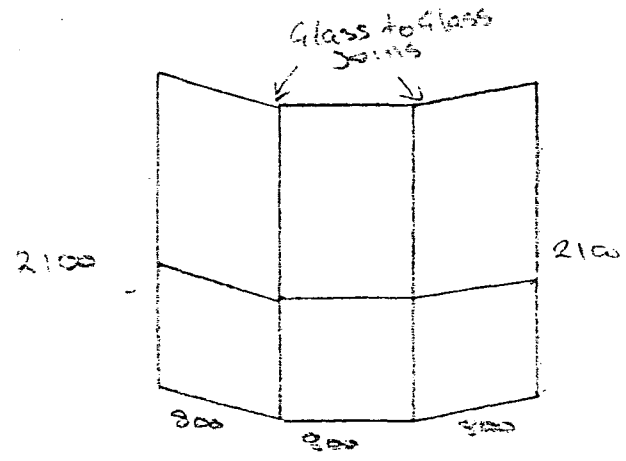
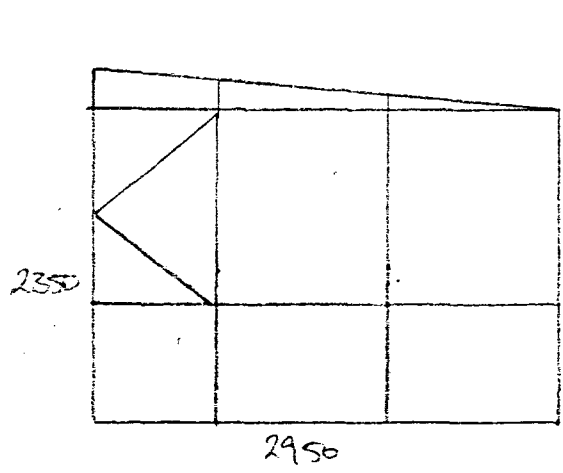
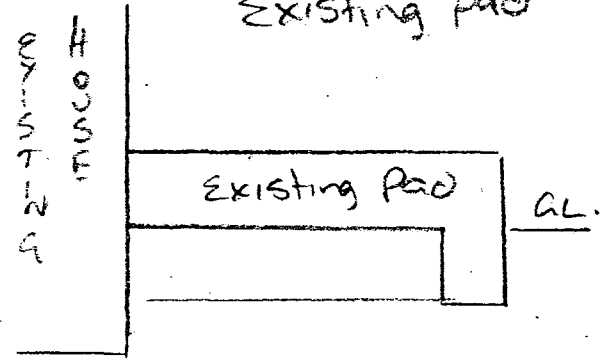

Vision Aluminium
 49 Te Rama Place
 Phone: 3811-315

Proposed Conservatory for Stowers
 125 Harris Crescent Ph 3522535 Lot 50 DP 19712

Contact Beth
 Phone 3811-315
 Scales 1:20 1:50

Sheet: 1
 Series of: 2

VERSATILE GARAGES

Garage at 125 Harris Cres for Mr Bryden. SITE PLAN

SCALE 1:200

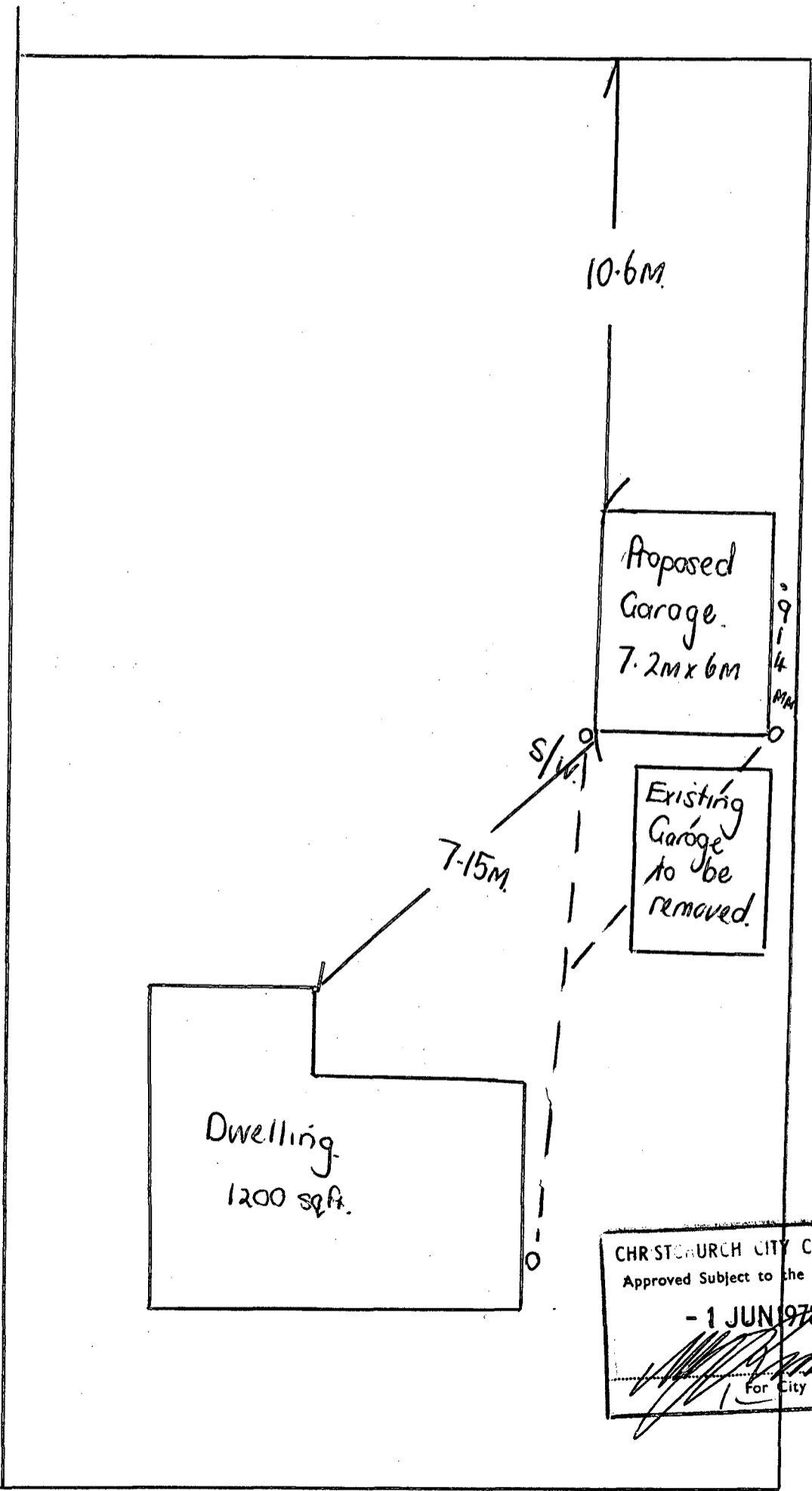

CHRISTCHURCH CITY COUNCIL
Approved Subject to the By-Laws
- 1 JUN 1978
[Signature]
For City Engineer

HARRIS CRES.

125 Harris Crescent Land Use Consents

388
Greers
Road

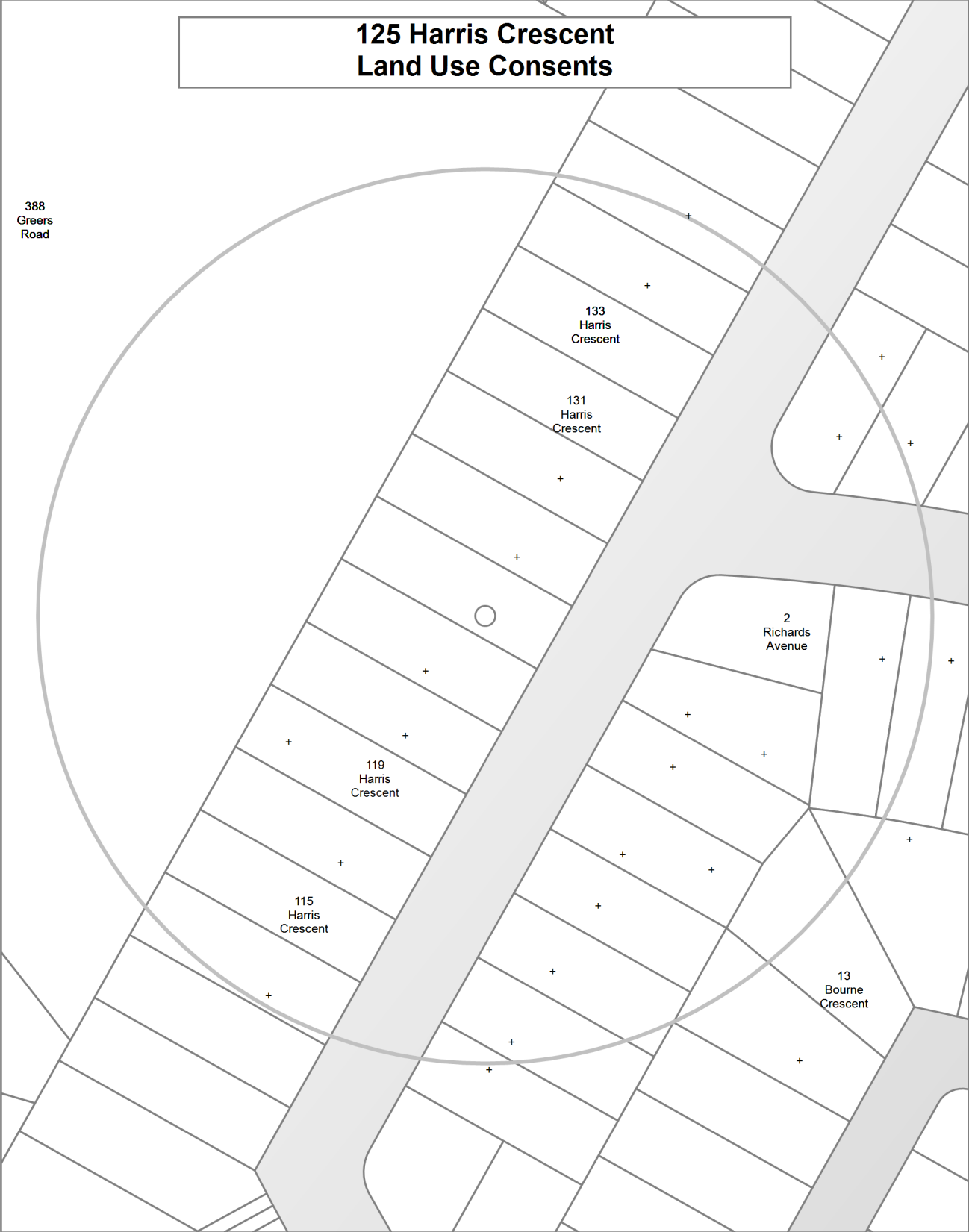

**125 Harris Crescent
Subdivision Consents**

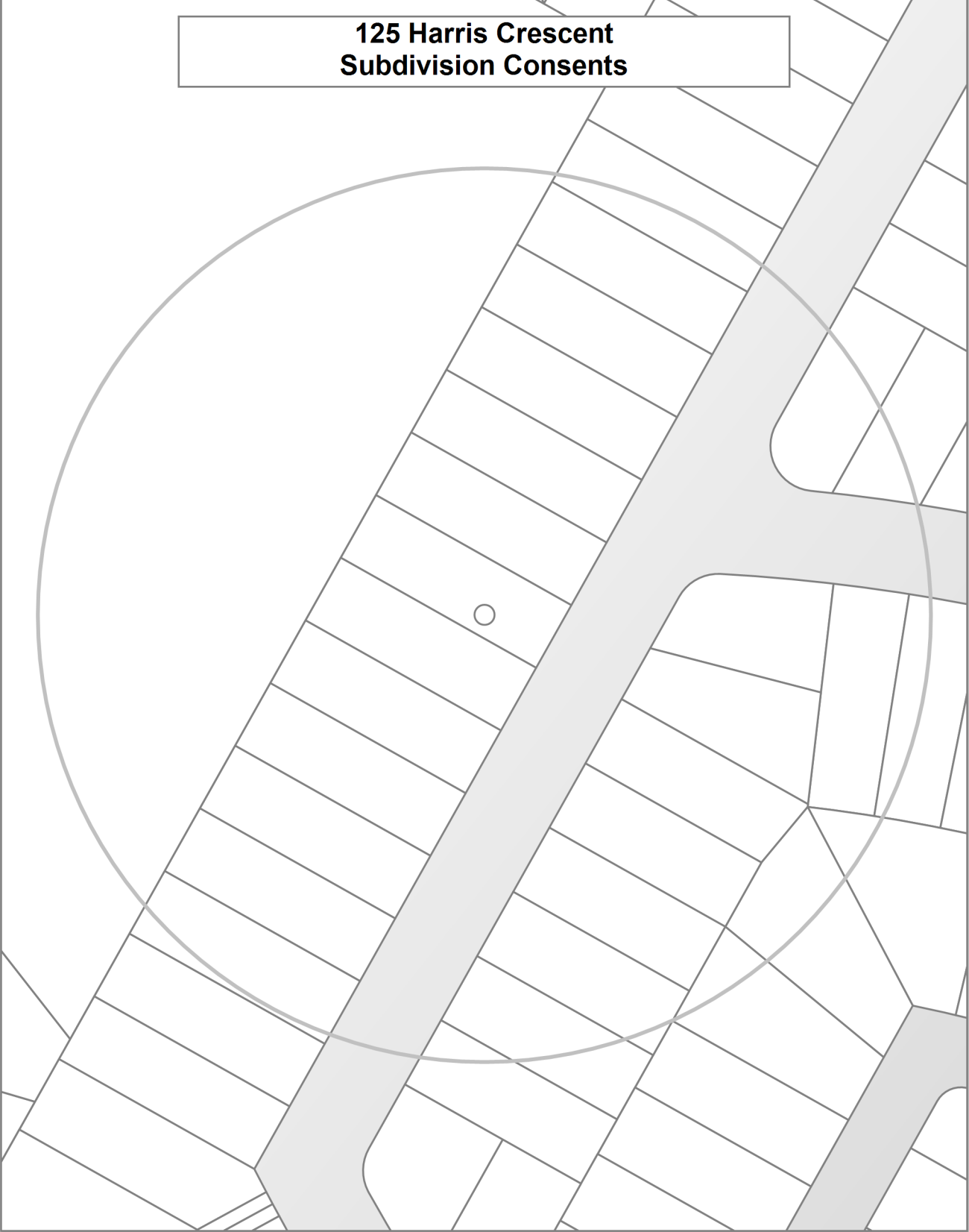

Land Use Resource Consents within 100 metres of 125 Harris Crescent

Note: This list does not include subdivision Consents and Certificates of Compliance issued under the Resource Management Act.

115 Harris Crescent

RMA/1990/592

Consent to erect a garage/ games room which exceeds the permitted floor area for an accessory building proposed floor area 81m². - Historical Reference RES9212435

Processing complete

Applied 20/09/1990

Decision issued 24/09/1990

Granted 24/09/1990

119 Harris Crescent

RMA/2000/232

Application for a garage which intrudes the front 4.5m road boundary setback and site coverage of 35% is exceeded. - Historical Reference RMA20000670

Withdrawn

Applied 24/01/2000

13 Bourne Crescent

RMA/1980/484

Consent to erect a garage total accessory building area 92.8m² in lieu of permitted 85m² - Historical Reference RES9213608

Processing complete

Applied 27/03/1980

Decision issued 11/04/1980

Granted 11/04/1980

131 Harris Crescent

RMA/2015/1995

Dwelling with attached garage - Historical Reference RMA92030289

Processing complete

Applied 22/07/2015

Decision issued 03/08/2015

Granted 03/08/2015

133 Harris Crescent

RMA/2003/1249

Extension of Harris District Substation to install ripple plan. - Historical Reference RMA20013539

Processing complete

Applied 13/05/2003

Decision issued 30/05/2003

Granted 30/05/2003

RMA/2013/2335

Site Development Earthworks - Historical Reference RMA92024055

Processing complete

Applied 05/11/2013

Decision issued 26/11/2013

Granted 26/11/2013

RMA/2013/2337

Alteration to Designation - Historical Reference RMA92024057

Processing complete

Applied 05/11/2013

Decision issued 19/12/2013

NOR accepted 11/12/2013

RMA/2018/1503

Outline Plan for various site works to existing Substation site including erection of storage building; installation of hard standing areas; addition and expansion of stormwater infrastructure and associated earthworks.

Processing complete

Applied 26/06/2018

Decision issued 05/09/2018

Outline plan accepted 05/09/2018

2 Richards Avenue

RMA/1969/215

Waiver rear court 25ft in favour of side court 58ft to permit an additional Bedroom for J.a.Kuryli - Historical Reference RES954976

Processing complete

Applied 07/11/1969

Decision issued 07/11/1969

Granted 07/11/1969

388 Greers Road

RMA/1988/743

Erect a substation 4.2m High in lieu of required 4m High - Historical Reference RES9217113

Processing complete

Applied 11/08/1988

Decision issued 23/08/1988

Granted 23/08/1988

RMA/2001/1963

To erect a new pole on the crane room roof and dismantle and remove the 45m steel lattice communications tower - Historical Reference RMA20007865

Processing complete

Applied 15/08/2001

Decision issued 03/09/2001

Outline plan accepted 31/08/2001

RMA/2002/747

To establish an air quality monitoring system that fails to comply with the height of any utility - Historical Reference RMA20009728

Processing complete

Applied 03/04/2002

Decision issued 31/05/2002

Granted 31/05/2002

RMA/2009/71

Construction of a new utility building - Historical Reference RMA92013470

Processing complete

Applied 21/01/2009

Decision issued 13/02/2009

Granted 12/02/2009

RMA/2013/2337

Alteration to Designation - Historical Reference RMA92024057

Processing complete

Applied 05/11/2013

Decision issued 19/12/2013

NOR accepted 11/12/2013

RMA/2013/514

Outline Plan - Historical Reference RMA92022116

Processing complete

Applied 26/03/2013

Decision issued 12/04/2013

Outline plan accepted 12/04/2013

RMA/2015/1029

Outline Plan Waiver Papanui substation transformer upgrade - Historical Reference RMA92029276

Processing complete

Applied 17/04/2015

Decision issued 20/05/2015

Outline plan accepted 19/05/2015

RMA/2015/2404

Excavation work for new foundations - Historical Reference RMA92030736

Processing complete

Applied 31/08/2015

Decision issued 30/09/2015

Granted 29/09/2015

RMA/2018/1503

Outline Plan for various site works to existing Substation site including erection of storage building; installation of hard standing areas; addition and expansion of stormwater infrastructure and associated earthworks.

Processing complete

Applied 26/06/2018

Decision issued 05/09/2018

Outline plan accepted 05/09/2018

RMA/2020/811

Use existing building as training facility

Processing complete

Applied 21/04/2020

Decision issued 23/06/2020

Granted 23/06/2020

Data Quality Statement

Land Use Consents

All resource consents are shown for sites that have been labelled with an address. For sites that have been labelled with a cross (+) no resource consents have been found. Sites that have no label have not been checked for resource consents. This will be particularly noticeable on the margins of the search radius. If there are such sites and you would like them included in the check, please ask for the LIM spatial query to be rerun accordingly. This will be done free of charge although there may be a short delay. Resource consents which are on land occupied by roads, railways or rivers are not, and currently cannot be displayed, either on the map or in the list. Resource consents that relate to land that has since been subdivided, will be shown in the list, but not on the map. They will be under the address of the land as it was at the time the resource consent was applied for. Resource consents that are listed as Non-notified and are current, may in fact be notified resource consents that have not yet been through the notification process. If in doubt. Please phone (03)941 8999.

The term "resource consents" in this context means land use consents. Subdivision consents and certificates of compliance are excluded.

Subdivision Consents

All subdivision consents are shown for the sites that have been labelled with consent details. For Sites that have been labelled with a cross (+) no records have been found. Sites that have no label have not been checked for subdivision consents. This will be particularly noticeable on the margins of the search radius. If there are such sites and you would like them included in the check, please ask for the LIM spatial query to be rerun accordingly. This will be done free of charge although there may be a short delay.

The term "subdivision consents" in this context means a resource consent application to subdivide land. Non subdivision land use resource consents and certificates of compliance are excluded.

This report will only record those subdivision applications which have not been completed i.e once a subdivision has been given effect to and the new lots/properties have been established the application which created those lots will not be shown

All subdivision consent information is contained on the map and no separate list is supplied