

CASH SETTLED CLAIM(S)

The following information contains documents relating to claim(s) that were cash settled for the property.

If you require sign off or repair completion documents, they may be obtainable from the contractors who completed the substantive repairs at the property.

Scope of Works



Document explanatory note:

This document provides a summary of the earthquake damage identified by the EQC assessment team. Land, building and room by room damage is listed along with an indication of how this damage is to be repaired. A glossary of terms describing the type of damage that may be listed on your Scope of Works is provided at the end of this document.

Customer: HEIKE MORITZEN

Assessment of Property at 25 FLEMINGTON AVENUE, NORTH NEW BRIGHTON, CHRISTCHURCH 8083 on 16/07/2011

Site

Element	Damage	Repair
Garden Shed (Garden - Steel - 9.07 m2)		
Land (Exposed - Soil - 855.00 m2)		
Land (Under dwelling - Soil - 1.00 m2)		

Services

Element	Damage	Repair
Sewerage (Town Connection - PVC Pipe - 25.00 l/m)	No Earthquake Damage	
Water Supply (Town Connection - Plastic - 25.00 l/m)	No Earthquake Damage	

Main Building

Exterior

Elevation (North wall ground and first floor)

Element	Damage	Repair
No Damage		

Elevation (East (ground and first floor))

Element	Damage	Repair
No Damage		

Elevation (South wall ground and first floor)

Element	Damage	Repair
Wall Cladding (Weatherboard - Cement sheet - 21.50 m2)	Damaged finish	Paint wall 7.92 m2
	Structural damage	Remove, dispose and replace weatherboard 0.99 m2
Wall framing (Timber Frame - Timber - 21.50 m2)	No Earthquake Damage	

Elevation (West wall (ground and first floor))

Element	Damage	Repair
Deck (Below 1m - Timber - 13.77 m2)	Structural damage	Relevel Deck 13.77 m2
Deck (Below 1m - Timber - 18.30 m2)	Structural damage	Relevel Deck 18.29 m2
Wall Cladding (Hardiplank - Cement sheet - 27.00 m2)	Cracking to paint	Gap fill and paint 21.19 m2
Wall framing (Timber Frame - Timber - 67.50 m2)	No Earthquake Damage	

Roof (Rolled metal tiles)

Element	Damage	Repair
---------	--------	--------

No Damage

Foundations (Piles only)

Element	Damage	Repair
---------	--------	--------

Piles (Ordinary - Timber - 1.00 item)	Floor has moved less than 100mm	Jack and pack piles	50.00	No of
---------------------------------------	---------------------------------	---------------------	-------	-------

Interior**Ground Floor - Internal Garage**

Room Size: 6.00 x 5.65 = 33.90 (length(m) x width(m) = Area Size(m2))

Stud Height: 2.40 m

Element	Damage	Repair
---------	--------	--------

Ceiling (Gib - Paint - 11.40 m2)	No Earthquake Damage		
Door (External) (Solid Door - Timber - 1.00 item)	No Earthquake Damage		
Door (Internal) (Single Solid Core - Timber - 1.00 No of)	No Earthquake Damage		
Floor (Concrete - Concrete - 33.90 m2)	No Earthquake Damage		
Garage door (Sectional Metal - Steel - 1.00 No of)	No Earthquake Damage		
Wall covering (Gib - Paint - 55.92 m2)	Cosmetic damage	Rake out, plaster and paint	55.92 m2
Window (Aluminium Awning - Pane single glazed - 1.00 No of)	No Earthquake Damage		
Window (Timber medium - Pane single glazed - 1.00 No of)	No Earthquake Damage		

Ground Floor - Entry

Room Size: 1.47 x 4.20 = 6.17 (length(m) x width(m) = Area Size(m2))

Stud Height: 2.40 m

Element	Damage	Repair
---------	--------	--------

Ceiling (Gib - Paint - 6.17 m2)	No Earthquake Damage		
Door (External) (SG Single - Timber - 1.00 item)	No Earthquake Damage		
Door (Internal) (Single Hollow Core - Timber - 1.00 No of)	No Earthquake Damage		
Floor (Concrete - Carpet - 6.17 m2)	No Earthquake Damage		
Wall covering (Gib - Paint - 27.22 m2)	Cosmetic damage	Rake out, plaster and paint	27.22 m2

Ground Floor - Hallway

Room Size: 0.89 x 8.35 = 7.46 (length(m) x width(m) = Area Size(m2))

Stud Height: 2.40 m

Element	Damage	Repair
---------	--------	--------

Built In Shelves (Wall unit - Other - .59 m2)	No Earthquake Damage		
Built In Shelves (Wall unit - Other - .50 m2)	No Earthquake Damage		
Ceiling (Gib - Stipple - 7.46 m2)	Cosmetic Damage	Scrape off, rake out, fill, restipple	7.46 m2
Floor (Chipboard - Carpet - 7.46 m2)	No Earthquake Damage		
Wall covering (Gib - Paint - 44.37 m2)	Cosmetic damage	Rake out, plaster and paint	44.37 m2

Ground Floor - Office/Study

Room Size: 2.80 x 1.99 = 5.57 (length(m) x width(m) = Area Size(m2))

Stud Height: 2.40 m

Element	Damage	Repair	
Ceiling (Gib - Paint - 5.57 m2)	Cosmetic Damage	Gap fill and paint	5.57 m2
Door (Internal) (Single Hollow Core - Timber - 1.00 No of)	No Earthquake Damage		
Floor (Chipboard - Carpet - 5.57 m2)	No Earthquake Damage		
Wall covering (Gib - Paint - 22.99 m2)	No Earthquake Damage		
Window (Aluminium Awning - Pane single glazed - 1.00 No of)	No Earthquake Damage		

Ground Floor - Bathroom

Room Size: 2.00 x 1.98 = 3.96 (length(m) x width(m) = Area Size(m2))

Stud Height: 2.40 m

Element	Damage	Repair	
Bathroom Sink (Basin - Standard specification - 1.00 item)	Fitment damage	Remove and re-silicon	1.00 l/m
Ceiling (Gib - Paint - 3.96 m2)	No Earthquake Damage		
Door (Internal) (Single Hollow Core - Timber - 1.00 No of)	No Earthquake Damage		
Fans (Extract - Manrose fan - 1.00 item)	No Earthquake Damage		
Floor (Chipboard - Tiles - 3.96 m2)	Cosmetic damage	Grind out and silicon tile perimeter	6.00 l/m
Mirror (Fixed) (Standard Spec - Mirror - .54 m2)	No Earthquake Damage		
Shower (Cubical shower unit - Acrylic shower - .81 m2)	No Earthquake Damage		
Toilet (Standard - Standard Spec - 1.00 item)	No Earthquake Damage		
Wall covering (Wood panelling - T&G - 19.10 m2)	No Earthquake Damage		
Window (Aluminium Awning - Pane single glazed - 1.00 No of)	No Earthquake Damage		

Ground Floor - Bedroom (room)

Room Size: 2.90 x 4.00 = 11.60 (length(m) x width(m) = Area Size(m2))

Stud Height: 2.40 m

Element	Damage	Repair	
Built In Shelves (Wall unit - MDF - .81 m2)	No Earthquake Damage		
Ceiling (Gib - Stipple - 11.60 m2)	Cosmetic Damage	Scrape off, rake out, fill, restipple	11.60 m2
Door (External) (SG Single - Aluminium - 1.00 item)	No Earthquake Damage		
Door (Internal) (Single Hollow Core - Timber - 1.00 No of)	Cosmetic damage	Refix door stopper	
Floor (Chipboard - Carpet - 11.60 m2)	No Earthquake Damage		
Wall covering (Gib - Paint - 33.12 m2)	Cosmetic damage	Rake out, plaster and paint	33.12 m2

Ground Floor - Bedroom (room)

Room Size: 3.30 x 3.40 = 11.22 (length(m) x width(m) = Area Size(m2))

Stud Height: 2.40 m

Element	Damage	Repair	
Built in wardrobe (Wardrobe - Laminate - .63 m2)	No Earthquake Damage		
Ceiling (Gib - Paint - 11.22 m2)	Cosmetic Damage	Gap fill and paint	11.22 m2
Door (Internal) (Single Hollow Core - Timber - 1.00 No of)	No Earthquake Damage		
Floor (Chipboard - Carpet - 11.22 m2)	No Earthquake Damage		
Wall covering (Gib - Paint - 32.16 m2)	Cosmetic damage	Rake out, plaster and paint	32.16 m2
Window (Aluminium Awning - Pane single glazed - 1.00 No of)	No Earthquake Damage		

Ground Floor - Laundry

Room Size: 1.69 x 1.99 = 3.36 (length(m) x width(m) = Area Size(m2))

Stud Height: 2.40 m

Element	Damage	Repair	
Ceiling (Gib - Stipple - 3.36 m2)	No Earthquake Damage		
Door (External) (SG Single - Timber - 1.00 item)	No Earthquake Damage		
Door (Internal) (Single Hollow Core - Timber - 1.00 No of)	No Earthquake Damage		
Floor (Chipboard - Tiles - 3.36 m2)	No Earthquake Damage		
Wall covering (Gib - Paint - 17.66 m2)	Cosmetic damage	Rake out, plaster and paint	17.66 m2
Wash tub (Single - Stainless Steel - 1.00 item)	No Earthquake Damage		
Window (Aluminium Awning - Pane single glazed - 1.00 No of)	No Earthquake Damage		

Ground Floor - Living

Room Size: 5.00 x 5.50 = 27.50 (length(m) x width(m) = Area Size(m2))

Stud Height: 2.40 m

Element	Damage	Repair	
Ceiling (Gib - Paint - 27.50 m2)	Cosmetic Damage	Gap fill and paint	27.50 m2
Door (External) (SG Single - Timber - 1.00 item)	No Earthquake Damage		
Door (Internal) (Double Solid Core - Timber - 1.00 No of)	No Earthquake Damage		
Floor (Chipboard - Carpet - 27.50 m2)	No Earthquake Damage		
Wall covering (Gib - Paint - 50.40 m2)	Cosmetic damage	Rake out, plaster and paint	50.40 m2
Wall framing (Timber Frame - Timber - 50.40 m2)	No Earthquake Damage		
Window (Aluminium Casement - Pane single glazed - 2.00 No of)	No Earthquake Damage		

Ground Floor - Kitchen

Room Size: 2.66 x 7.50 = 19.95 (length(m) x width(m) = Area Size(m2))

Stud Height: 2.40 m

Element	Damage	Repair	
Built In Shelves (Wall unit - MDF - .58 m2)	No Earthquake Damage		
Ceiling (Gib - Stipple - 19.95 m2)	Cosmetic Damage	Scrape off, rake out, fill, restipple	19.95 m2
Door (Internal) (Single Hollow Core - Timber - 1.00 No of)	No Earthquake Damage		
Floor (Chipboard - Laminate - 19.95 m2)			
Kitchen joinery (Medium Spec - MDF - 1.00 item)	No Earthquake Damage		
Range (Free standing oven) (Electric - Standard Electric - 1.00 item)	No Earthquake Damage		
Wall covering (Gib - Paint - 48.77 m2)	Cosmetic damage	Rake out, plaster and paint	48.77 m2
Window (Aluminium Awning - Pane double glazed - 1.00 No of)	No Earthquake Damage		
Work top (Kitchen work top - Laminate - 4.60 l/m)	No Earthquake Damage		

Ground Floor - Entry (Off dining)

Room Size: 1.80 x 3.40 = 6.12 (length(m) x width(m) = Area Size(m2))

Stud Height: 2.40 m

Element	Damage	Repair	
Ceiling (Gib - Paint - 6.12 m2)	Cosmetic Damage	Paint Ceiling	6.12 m2
Door (External) (SG Single - Timber - 1.00 item)	No Earthquake Damage		
Floor (Chipboard - Laminate - 6.12 m2)	Cosmetic damage	Re alignn floor boards	
Wall covering (Gib - Paint - 24.96 m2)	Cosmetic damage	Rake out, plaster and paint	24.96 m2

Ground Floor - Rumpus (Kids play room)

Room Size: 4.80 x 4.00 = 19.20 (length(m) x width(m) = Area Size(m2))

Stud Height: 2.40 m

Element	Damage	Repair	
Ceiling (Gib - Paint - 19.20 m2)	Cosmetic Damage	Gap fill and paint	19.20 m2
Door (External) (SG French - Aluminium - 1.00 item)	No Earthquake Damage		
Door (Internal) (Single Hollow Core - Timber - 3.00 No of)	No Earthquake Damage		
Floor (Chipboard - Carpet - 19.20 m2)	No Earthquake Damage		
Wall covering (Gib - Paint - 42.24 m2)	Cosmetic damage	Rake out, plaster and paint	42.24 m2
Window (Aluminium Awning - Pane single glazed - 2.00 No of)	No Earthquake Damage		

Ground Floor - En Suite (Off rumpus)

Room Size: 2.20 x 1.67 = 3.67 (length(m) x width(m) = Area Size(m2))

Stud Height: 2.40 m

Element	Damage	Repair	
Bath (Acrylic - Standard specification - 1.00 item)	No Earthquake Damage		
Bathroom Sink (Basin - Standard specification - 1.00 item)	No Earthquake Damage		
Ceiling (Gib - Stipple - 3.67 m2)	No Earthquake Damage		
Door (Internal) (Single Hollow Core - Timber - 1.00 No of)	No Earthquake Damage		
Fans (Extract - Manrose fan - 1.00 item)	No Earthquake Damage		
Floor (Chipboard - Tiles - 3.67 m2)	Cosmetic damage	Grind out and silicon tile perimeter	1.00 l/m
Hand basin (Free standing - PVC - 1.00 item)	Pulled off wall	Remove sealant	1.20 l/m
Heating (Electric - Skope - 1.00 item)	No Earthquake Damage		
Shower (shower Over bath with Door - Acrylic shower - 1.28 m2)	No Earthquake Damage		
Toilet (Standard - Standard Spec - 1.00 item)	No Earthquake Damage		
Wall covering (Gib - Paint - 18.58 m2)	Cosmetic damage	Rake out, plaster and paint	18.58 m2
Window (Aluminium Awning - Pane double glazed - 1.00 No of)	No Earthquake Damage		

Ground Floor - Walk In Wardrobe (In rumpus)

Room Size: 1.65 x 1.70 = 2.81 (length(m) x width(m) = Area Size(m2))

Stud Height: 2.40 m

Element	Damage	Repair	
Ceiling (Gib - Paint - 2.81 m2)	No Earthquake Damage		
Floor (Chipboard - Carpet - 2.81 m2)	No Earthquake Damage		
Wall covering (Gib - Paint - 16.08 m2)	Cosmetic damage	Rake out, plaster and paint	16.08 m2

Ground Floor - Stairwell

Room Size: 1.48 x 1.44 = 2.13 (length(m) x width(m) = Area Size(m2))

Stud Height: 4.20 m

Element	Damage	Repair	
Ceiling (Gib - Paint - 2.13 m2)	No Earthquake Damage		
Floor (Chipboard - Carpet - 2.13 m2)	No Earthquake Damage		
Handrails (Bar - Timber - .72 l/m)	No Earthquake Damage		
Stairs (Internal) (Box - MDF - 2.50 l/m)	No Earthquake Damage		
Wall covering (Gib - Paint - 24.53 m2)	Cosmetic damage	Rake out, plaster and paint	24.53 m2
Window (Aluminium Fixed - Pane double glazed - 1.00 No of)	No Earthquake Damage		

First Floor - Hallway (Upstairs)

Room Size: $0.83 \times 1.50 = 1.25$ (length(m) x width(m) = Area Size(m2))

Stud Height: 2.40 m

Element	Damage	Repair	
Ceiling (Gib - Paint - 1.25 m2)	No Earthquake Damage		
Floor (Chipboard - Carpet - 1.25 m2)	No Earthquake Damage		
Wall covering (Gib - Paint - 11.18 m2)	Cosmetic damage	Rake out, plaster and paint	11.18 m2

First Floor - Bedroom (Master)

Room Size: $4.00 \times 3.40 = 13.60$ (length(m) x width(m) = Area Size(m2))

Stud Height: 2.40 m

Element	Damage	Repair	
Built in wardrobe (Wardrobe - Laminate - 1.26 m2)	No Earthquake Damage		
Ceiling (Gib - Paint - 11.49 m2)	Cosmetic Damage	Rake out, plaster and paint	11.49 m2
Door (Internal) (Single Hollow Core - Timber - 1.00 No of)	No Earthquake Damage		
Floor (Chipboard - Carpet - 11.49 m2)	No Earthquake Damage		
Wall covering (Gib - Paint - 32.54 m2)	Cosmetic damage	Rake out, plaster and paint	32.54 m2
Window (Aluminium Awning - Pane single glazed - 2.00 No of)	No Earthquake Damage		

First Floor - Walk In Wardrobe (Master bed)

Room Size: $1.74 \times 2.70 = 4.70$ (length(m) x width(m) = Area Size(m2))

Stud Height: 2.00 m

Element	Damage	Repair	
Ceiling (Gib - Paint - 4.70 m2)	Cosmetic Damage	Rake out, plaster and paint	4.70 m2
Floor (Chipboard - Carpet - 4.70 m2)	No Earthquake Damage		
Wall covering (Gib - Paint - 17.76 m2)	Cosmetic damage	Rake out, plaster and paint	17.76 m2

Scope of Works - Glossary of Terms

Cosmetic Damage	Cosmetic damage is used to record repairs to an element that can be done in situ e.g. minor cracking to plasterboard. For example a repair strategy may state "rake, stop and paint" and this is carried out without needing to remove or replace the damaged element. Where the plasterboard for example needs to be removed and replaced, this will be recorded as 'structural damage'.
Impact Damage	Impact damage is where an element or part of a building sustains earthquake damage and then breaks away or collapses causing damage to another part of the building. An example is a chimney that has collapsed and caused damage to roof tiles.
Structural Damage	The term structural damage is used where a repair requires an element to be removed and replaced e.g. major cracking to plasterboard or external cladding that has been dislodged. This term does not relate to the structural integrity of the building as a whole, but to the individual element only.

Additional Information

Building Terms	The Department of Building and Housing website has a comprehensive list of common building terms: http://www.dbh.govt.nz/building-az-wxyz
-----------------------	---

EQC Full Assessment Report

Claim Number:	CLM/2011/210902	Assessment Date:	16/07/2011 14:32
Claimant:	HEIKE MORITZEN	Assessor:	Ingham, Rowan
Property Address:	25 FLEMINGTON AVENUE NORTH NEW BRIGHTON CHRISTCHURCH 8083	Estimator:	Borell, Kenneth
		Property Occupied By:	Owner Occupied

Claimant Setup

Type	Name	Home Number	Mobile Number	Work Number	Email Address
Owner	HEIKE, MORITZEN				

Insurance & Mortgage Details

Insurance Details - From Claim Centre

Insurer	Policy Type	Policy Number	Insurance Sighted	Insurance Valid
AMI Insurance	Dwelling		Yes	

Insurance Details - Added in COMET

Insurer	Policy Type	Policy Number	Insurance Sighted	Insurance Valid
---------	-------------	---------------	-------------------	-----------------

Insurance Details - Comments

Due Date - 24 April 2012

Mortgage Details - From Claim Centre

Bank

Mortgage Details - Added in COMET

Bank
No Mortgage

Mortgage Details - Comments

Opt Out

For repairs costing between \$10,000 and \$100,000 the claimant wishes to manage their own repairs? No

Hazards

Hazards: Nil

Property Sticker: No Sticker

Building Configurations

Leaky Home Syndrome? No

Building Name	Number of floors	Building Finish	Age of house	Footprint	Area (m2)
Main Building	2	Standard	Post 1980	Rectangular	189.77

Full Assessment

Site

Element	Type	Material	Damages	Measure	Rate	Cost
Garden Shed	Garden	Steel	No Earthquake Damage			
Land	Exposed	Soil	No Earthquake Damage			
Land	Under dwelling	Soil	No Earthquake Damage			

General Comments:

Services

Element	Type	Material	Damages	Measure	Rate	Cost
Sewerage	Town Connection	PVC Pipe	No Earthquake Damage			
Water Supply	Town Connection	Plastic	No Earthquake Damage			

General Comments:

Main Building

Exterior

Elevation (North wall ground and first floor)

Damage: No damage
Require Scaffolding? No
General Comments: James hardies w/boards painted
 Second story partialy in roof space

Elevation (East (ground and first floor))

Damage: No damage
Require Scaffolding? No
General Comments: James Hardie weatherboard painted
 Second story partialy in roof space

Elevation (South wall ground and first floor)

Damage: Earthquake damage
Require Scaffolding? No

Element	Type	Material	Damages	Measure	Rate	Cost
Wall Cladding	Weatherboard	Cement sheet	Damaged finish			
			Paint wall	7.92 m2	29.00	229.68
			Structural damage			
			Remove, dispose and replace weatherboard	0.99 m2	240.00	237.60
Wall framing	Timber Frame	Timber	No Earthquake Damage			
General Comments:		james hardie w/ boards painted. Broken w/board by front door and deck. Second story with in roof space				

Elevation (West wall (ground and first floor))

Damage: Earthquake damage
Require Scaffolding? No

Element	Type	Material	Damages	Measure	Rate	Cost
Deck	Below 1m	Timber	Structural damage			
			Relevel Deck	13.77 m2	65.00	895.05
			Structural damage			
			Relevel Deck	18.29 m2	65.00	1,188.85
Wall Cladding	Hardiplank	Cement sheet	Cracking to paint			
			Gap fill and paint	21.19 m2	38.00	805.22
Wall framing	Timber Frame	Timber	No Earthquake Damage			
General Comments:		Deck 1- 8.15 x 1.69 Deck 2 - 6.1 x 3.0 Second story with in roof space				

Roof (Rolled metal tiles)

Damage: No damage

Require Scaffolding? No

General Comments:

Foundations (Piles only)

Damage: Earthquake damage

Require Scaffolding? No

Element	Type	Material	Damages	Measure	Rate	Cost
Piles	Ordinary	Timber	Floor has moved less than 100mm			
			Jack and pack piles	50.00 No of	100.00	5,000.00

General Comments:

Ground Floor - Internal Garage

Damage: Earthquake damage

Require Scaffolding? No

Element	Type	Material	Damages	Measure	Rate	Cost
Ceiling	Gib	Paint	No Earthquake Damage			
Door (External)	Solid Door	Timber	No Earthquake Damage			
Door (Internal)	Single Solid Core	Timber	No Earthquake Damage			
Floor	Concrete	Concrete	No Earthquake Damage			
Garage door	Sectional Metal	Steel	No Earthquake Damage			
Wall covering	Gib	Paint	Cosmetic damage			
			Rake out, plaster and paint	55.92 m2	34.00	1,901.28
Window	Aluminium Awning	Pane single glazed	No Earthquake Damage			
Window	Timber medium	Pane single glazed	No Earthquake Damage			

General Comments: 0.6 LM of existing cracks

Ground Floor - Entry

Damage: Earthquake damage

Require Scaffolding? No

Element	Type	Material	Damages	Measure	Rate	Cost
Ceiling	Gib	Paint	No Earthquake Damage			
Door (External)	SG Single	Timber				
Door (Internal)	Single Hollow Core	Timber	No Earthquake Damage			
Floor	Concrete	Carpet	No Earthquake Damage			
Wall covering	Gib	Paint	Cosmetic damage			
			Rake out, plaster and paint	27.22 m2	34.00	925.48

General Comments:

Ground Floor - Hallway

Damage: Earthquake damage

Require Scaffolding? No

Element	Type	Material	Damages	Measure	Rate	Cost
Built In Shelves	Wall unit	Other	No Earthquake Damage			
			No Earthquake Damage			
Ceiling	Gib	Stipple	Cosmetic Damage			
			Scrape off, rake out, fill, restipple	7.46 m2	50.00	373.00
Floor	Chipboard	Carpet	No Earthquake Damage			
Wall covering	Gib	Paint	Cosmetic damage			
			Rake out, plaster and paint	44.37 m2	34.00	1,508.58

General Comments:

Ground Floor - Office/Study

Damage: Earthquake damage

Require Scaffolding? No

Element	Type	Material	Damages	Measure	Rate	Cost
Ceiling	Gib	Paint	Cosmetic Damage			
			Gap fill and paint	5.57 m2	34.00	189.38
Door (Internal)	Single Hollow Core	Timber	No Earthquake Damage			
Floor	Chipboard	Carpet	No Earthquake Damage			
Wall covering	Gib	Paint	No Earthquake Damage			
Window	Aluminium Awning	Pane single glazed	No Earthquake Damage			

General Comments:**Ground Floor - Bathroom****Damage:** Earthquake damage**Require Scaffolding?** No

Element	Type	Material	Damages	Measure	Rate	Cost
Bathroom Sink	Basin	Standard specification	Fitment damage			
			Remove and re-silicon	1.00 l/m	18.00	18.00
Ceiling	Gib	Paint	No Earthquake Damage			
Door (Internal)	Single Hollow Core	Timber	No Earthquake Damage			
Fans	Extract	Manrose fan	No Earthquake Damage			
Floor	Chipboard	Tiles	Cosmetic damage			
			Grind out and silicon tile perimeter	6.00 l/m	22.00	132.00
Mirror (Fixed)	Standard Spec	Mirror	No Earthquake Damage			
Shower	Cubical shower unit	Acrylic shower	No Earthquake Damage			
Toilet	Standard	Standard Spec	No Earthquake Damage			
Wall covering	Wood panelling	T&G	No Earthquake Damage			
Window	Aluminium Awning	Pane single glazed	No Earthquake Damage			

General Comments:**Ground Floor - Bedroom (████ room)****Damage:** Earthquake damage**Require Scaffolding?** No

Element	Type	Material	Damages	Measure	Rate	Cost
Built In Shelves	Wall unit	MDF	No Earthquake Damage			
Ceiling	Gib	Stipple	Cosmetic Damage			
			Scrape off, rake out, fill, restipple	11.60 m2	50.00	580.00
Door (External)	SG Single	Aluminium	No Earthquake Damage			
Door (Internal)	Single Hollow Core	Timber	Cosmetic damage			
			Refix door stopper	45.00 \$	0.00	45.00
Floor	Chipboard	Carpet	No Earthquake Damage			
Wall covering	Gib	Paint	Cosmetic damage			
			Rake out, plaster and paint	33.12 m2	34.00	1,126.08

General Comments:**Ground Floor - Bedroom (████ room)****Damage:** Earthquake damage**Require Scaffolding?** No

Element	Type	Material	Damages	Measure	Rate	Cost
Built in wardrobe	Wardrobe	Laminate	No Earthquake Damage			
Ceiling	Gib	Paint	Cosmetic Damage			
			Gap fill and paint	11.22 m2	34.00	381.48
Door (Internal)	Single Hollow Core	Timber	No Earthquake Damage			
Floor	Chipboard	Carpet	No Earthquake Damage			
Wall covering	Gib	Paint	Cosmetic damage			
			Rake out, plaster and paint	32.16 m2	34.00	1,093.44
Window	Aluminium Awning	Pane single glazed	No Earthquake Damage			

General Comments:

Ground Floor - Laundry**Damage:** Earthquake damage**Require Scaffolding?** No

Element	Type	Material	Damages	Measure	Rate	Cost
Ceiling	Gib	Stipple	No Earthquake Damage			
Door (External)	SG Single	Timber	No Earthquake Damage			
Door (Internal)	Single Hollow Core	Timber	No Earthquake Damage			
Floor	Chipboard	Tiles	No Earthquake Damage			
Wall covering	Gib	Paint	Cosmetic damage			
			Rake out, plaster and paint	17.66 m2	34.00	600.44
Wash tub	Single	Stainless Steel	No Earthquake Damage			
Window	Aluminium Awning	Pane single glazed	No Earthquake Damage			

General Comments: Existing plaster patch on ceiling**Ground Floor - Living****Damage:** Earthquake damage**Require Scaffolding?** No

Element	Type	Material	Damages	Measure	Rate	Cost
Ceiling	Gib	Paint	Cosmetic Damage			
			Gap fill and paint	27.50 m2	34.00	935.00
Door (External)	SG Single	Timber	No Earthquake Damage			
Door (Internal)	Double Solid Core	Timber	No Earthquake Damage			
Floor	Chipboard	Carpet	No Earthquake Damage			
Wall covering	Gib	Paint	Cosmetic damage			
			Rake out, plaster and paint	50.40 m2	34.00	1,713.60
Wall framing	Timber Frame	Timber	No Earthquake Damage			
Window	Aluminium Casement	Pane single glazed	No Earthquake Damage			

General Comments:**Ground Floor - Kitchen****Damage:** Earthquake damage**Require Scaffolding?** No

Element	Type	Material	Damages	Measure	Rate	Cost
Built In Shelves	Wall unit	MDF	No Earthquake Damage			
Ceiling	Gib	Stipple	Cosmetic Damage			
			Scrape off, rake out, fill, restipple	19.95 m2	50.00	997.50
Door (Internal)	Single Hollow Core	Timber	No Earthquake Damage			
Floor	Chipboard	Laminate				
Kitchen joinery	Medium Spec	MDF	No Earthquake Damage			
Range (Free standing oven)	Electric	Standard Electric	No Earthquake Damage			
Wall covering	Gib	Paint	Cosmetic damage			
			Rake out, plaster and paint	48.77 m2	34.00	1,658.18
Window	Aluminium Awning	Pane double glazed	No Earthquake Damage			
Work top	Kitchen work top	Laminate	No Earthquake Damage			

General Comments:**Ground Floor - Entry (Off dining)****Damage:** Earthquake damage**Require Scaffolding?** No

Element	Type	Material	Damages	Measure	Rate	Cost
Ceiling	Gib	Paint	Cosmetic Damage			
			Paint Ceiling	6.12 m2	24.00	146.88
Door (External)	SG Single	Timber	No Earthquake Damage			

Floor	Chipboard	Laminate	Cosmetic damage			
			Re alignn floor boards	100.00 \$	0.00	100.00
Wall covering	Gib	Paint	Cosmetic damage			
			Rake out, plaster and paint	24.96 m2	34.00	848.64

General Comments:**Ground Floor - Rumpus (Kids play room)****Damage:** Earthquake damage**Require Scaffolding?** No

Element	Type	Material	Damages	Measure	Rate	Cost
Ceiling	Gib	Paint	Cosmetic Damage			
			Gap fill and paint	19.20 m2	34.00	652.80
Door (External)	SG French	Aluminium	No Earthquake Damage			
Door (Internal)	Single Hollow Core	Timber	No Earthquake Damage			
Floor	Chipboard	Carpet	No Earthquake Damage			
Wall covering	Gib	Paint	Cosmetic damage			
			Rake out, plaster and paint	42.24 m2	34.00	1,436.16
Window	Aluminium Awning	Pane single glazed	No Earthquake Damage			

General Comments:**Ground Floor - En Suite (Off rumpus)****Damage:** Earthquake damage**Require Scaffolding?** No

Element	Type	Material	Damages	Measure	Rate	Cost
Bath	Acrylic	Standard specification	No Earthquake Damage			
Bathroom Sink	Basin	Standard specification	No Earthquake Damage			
Ceiling	Gib	Stipple	No Earthquake Damage			
Door (Internal)	Single Hollow Core	Timber	No Earthquake Damage			
Fans	Extract	Manrose fan	No Earthquake Damage			
Floor	Chipboard	Tiles	Cosmetic damage			
			Grind out and silicon tile perimeter	1.00 l/m	22.00	22.00
Hand basin	Free standing	PVC	Pulled off wall			
			Remove sealant	1.20 l/m	12.00	14.40
Heating	Electric	Skope	No Earthquake Damage			
Shower	shower Over bath with Door	Acrylic shower	No Earthquake Damage			
Toilet	Standard	Standard Spec	No Earthquake Damage			
Wall covering	Gib	Paint	Cosmetic damage			
			Rake out, plaster and paint	18.58 m2	34.00	631.72
Window	Aluminium Awning	Pane double glazed	No Earthquake Damage			

General Comments:**Ground Floor - Walk In Wardrobe (In rumpus)****Damage:** Earthquake damage**Require Scaffolding?** No

Element	Type	Material	Damages	Measure	Rate	Cost
Ceiling	Gib	Paint	No Earthquake Damage			
Floor	Chipboard	Carpet	No Earthquake Damage			
Wall covering	Gib	Paint	Cosmetic damage			
			Rake out, plaster and paint	16.08 m2	34.00	546.72

General Comments:**Ground Floor - Stairwell****Damage:** Earthquake damage**Require Scaffolding?** No

Element	Type	Material	Damages	Measure	Rate	Cost
Ceiling	Gib	Paint	No Earthquake Damage			
Floor	Chipboard	Carpet	No Earthquake Damage			
Handrails	Bar	Timber	No Earthquake Damage			
Stairs (Internal)	Box	MDF	No Earthquake Damage			
Wall covering	Gib	Paint	Cosmetic damage			
			Rake out, plaster and paint	24.53 m2	34.00	834.02
Window	Aluminium Fixed	Pane double glazed	No Earthquake Damage			

General Comments:**First Floor - Hallway (Upstairs)****Damage:** Earthquake damage**Require Scaffolding?** No

Element	Type	Material	Damages	Measure	Rate	Cost
Ceiling	Gib	Paint	No Earthquake Damage			
Floor	Chipboard	Carpet	No Earthquake Damage			
Wall covering	Gib	Paint	Cosmetic damage			
			Rake out, plaster and paint	11.18 m2	34.00	380.12

General Comments:**First Floor - Bedroom (Master)****Damage:** Earthquake damage**Require Scaffolding?** No

Element	Type	Material	Damages	Measure	Rate	Cost
Built in wardrobe	Wardrobe	Laminate	No Earthquake Damage			
Ceiling	Gib	Paint	Cosmetic Damage			
			Rake out, plaster and paint	11.49 m2	34.00	390.66
Door (Internal)	Single Hollow Core	Timber	No Earthquake Damage			
Floor	Chipboard	Carpet	No Earthquake Damage			
Wall covering	Gib	Paint	Cosmetic damage			
			Rake out, plaster and paint	32.54 m2	34.00	1,106.36
Window	Aluminium Awning	Pane single glazed	No Earthquake Damage			

General Comments: size includes alcove**First Floor - Walk In Wardrobe (Master bed)****Damage:** Earthquake damage**Require Scaffolding?** No

Element	Type	Material	Damages	Measure	Rate	Cost
Ceiling	Gib	Paint	Cosmetic Damage			
			Rake out, plaster and paint	4.70 m2	34.00	159.80
Floor	Chipboard	Carpet	No Earthquake Damage			
Wall covering	Gib	Paint	Cosmetic damage			
			Rake out, plaster and paint	17.76 m2	34.00	603.84

General Comments:**Fees****Fees**

Name	Duration	Estimate
Council fees - External alterations & additions	1.00	1,300.00
Small Job Fee	1.00	180.00
Engineers report	1.00	3,555.00
Engineers report	1.00	3,555.00

Overheads

Name	Estimate
Preliminary and general	2,432.72
Margin	4,143.17

GST

6,836.23

Scope Of Works Estimate

Property

Description	Estimate
Site	0.00
Services	0.00
	0.00

Main Building

Name	Description	Estimate
Exterior	Elevation (East (ground and first floor))	0.00
	Elevation (North wall ground and first floor)	0.00
	Foundations (Piles only)	5,000.00
	Roof (Rolled metal tiles)	0.00
	Elevation (South wall ground and first floor)	467.28
	Elevation (West wall (ground and first floor))	2,889.12
		8,356.40

Floor	Description	Estimate
First Floor	Bedroom (Master)	1,497.02
	Hallway (Upstairs)	380.12
	Walk In Wardrobe (Master bed)	763.64
		2,640.78
Ground Floor	Bathroom	150.00
	Bedroom (room)	1,474.92
	Bedroom (room)	1,751.08
	En Suite (Off rumpus)	668.12
	Entry	925.48
	Entry (Off dining)	1,095.52
	Hallway	1,881.58
	Internal Garage	1,901.28
	Kitchen	2,655.68
	Laundry	600.44
	Living	2,648.60
	Office/Study	189.38
	Rumpus (Kids play room)	2,088.96
	Stairwell	834.02
	Walk In Wardrobe (In rumpus)	546.72
		19,411.78

22,052.56

Fees

Description	Estimate
Council fees - External alterations & additions	1,300.00
Small Job Fee	180.00
Engineers report	3,555.00
Engineers report	3,555.00
	8,590.00

Overheads

Description	Estimate
Preliminary and general	2,432.72
Margin	4,143.17
GST	6,836.23
	13,412.11

Total Estimate

52,411.07

Inspection Sign Off

Description	Answer	comments
Land Damage		
Is there land damage?	No	
Contents Damage		
Has the contents schedule been left with claimant?	No	
Have the contents been sighted?	No	
Was a full inspection done?		
In roof space	Yes	
On roof?	Yes	
Under sub floor?	Yes	
Decline Claim		
Recommend Declining Claim	No	
Next Action:		

Previous Claim Numbers (recorded manually in field)

- 2100/063773
- 2010/082686

File Notes

Date Created: 08/08/2011 21:50
Created : Administrator, Alchemy
Subject: COMET sent to EQR on 08/08/2011
Note: COMET sent to EQR on 08/08/2011
Next Action:

Urgent Works Items



Scope of Works

Completed By: General Williams

Date: 30/11/20

Page 1 of 1

CLM/2010/082686

H. MORITZEN
25 FLEMINGTON AVENUE
NORTH NEW BRIGHTON
CHRISTCHURCH 8083

W:

M:

Element Details:

Land	Building	Bridges/culverts	Retaining walls	Other	
Lounge	Dining	Kitchen	Family Room	Bedroom	
Office/Study	Rumpus	Hallway	Stairwell	Toilet	
Laundry	Bathroom	Ensuite	Chimney	Foundations	
Piling	Services	Kitchen Ovens	Hot Water Cylinders	Header Tanks	
Glazing/windows	Fireplace/woodburner	Floor	External Walls	Roof	
Outbuildings	Other				

DESCRIPTION: Bench to tile splash back crack

REPAIR STRATEGY: Repair damage to Dining / kitchen

LINE ITEMS:

[illegible]

* Unit Categories to be used as follows:

Each, Sheet, Kilogram, Linear metre, Square metre, Cubic metre, Per Hour, Per Day, Per Week. Cubic metre calculations must include length, breadth and depth figures. Square metre calculations must include length and breadth figures.

Subtotal	55
----------	----

+ P&C, Margin & GST Figure 20-14

TOTAL	75.14
-------	-------



Scope of Works

Completed By: Gerard Williams

Date: 30/11/20

Page 1 of 1

CLM/2010/082686

H. MORITZEN
25 FLEMINGTON AVENUE
NORTH NEW BRIGHTON
CHRISTCHURCH 8083

W:

M:

Element Details:

Land	Building	Bridges/culverts	Retaining walls	Other
Lounge	Dining	Kitchen	Family Room	Bedroom
Office/Study	Rumpus	Hallway	Stairwell	Toilet
Laundry	Bathroom	Ensuite	Chimney	Foundations
Piling	Services	Kitchen Ovens	Hot Water Cylinders	Header Tanks
Glazing/windows	Fireplace/woodburner	Floor	External Walls	Roof
Outbuildings	Other			

DESCRIPTION: Multiple cracks to walls and ceilings

REPAIR STRATEGY: Repair damage to Bedroom one

LINE ITEMS:

[illegible]

* Unit Categories to be used as follows:

Each, Sheet, Kilogram, Linear metre, Square metre, Cubic metre, Per Hour, Per Day, Per Week. Cubic metre calculations must include length, breadth and depth figures. Square metre calculations must include length and breadth figures.

Subtotal	965.40
----------	--------

+ P&G, Margin & GST Figure	353.57
----------------------------	--------

TOTAL	1318.92
-------	---------



Scope of Works

Completed By: Gerald Williams

Date: 30/11/20

Page 1 of 1

CLM/2010/082686

H. MORITZEN
25 FLEMINGTON AVENUE
NORTH NEW BRIGHTON
CHRISTCHURCH 8083

M:

Element Details:

Land	Building	Bridges/culverts	Retaining walls	Other
Lounge	Dining	Kitchen	Family Room	Bedroom
Office/Study	Rumpus	Hallway	Stairwell	Toilet
Laundry	Bathroom	Ensuite	Chimney	Foundations
Piling	Services	Kitchen Ovens	Hot Water Cylinders	Header Tanks
Glazing/windows	Fireplace/woodburner	Floor	External Walls	Roof
Outbuildings	Other			

DESCRIPTION: 1x200mm crack to east wall & multiple cracks to gROUT in tie floor.

REPAIR STRATEGY: Repair damage to ensuite

LINE ITEMS:

[illegible]

* Unit Categories to be used as follows:

Each, Sheet, Kilogram, Linear metre, Square metre, Cubic metre, Per Hour, Per Day, Per Week. Cubic metre calculations must include length, breadth and depth figures. Square metre calculations must include length and breadth figures.

Subtotal	584.80
----------	--------

+ P&G, Margin & GST Figure	214.15
----------------------------	--------

TOTAL	798.95
-------	--------



Scope of Works

Completed By: Genavol Williams

Date: 30/11/20

Page 1 of 1

CLM/2010/082686

H. MORITZEN
25 FLEMINGTON AVENUE
NORTH NEW BRIGHTON
CHRISTCHURCH 8083

M:

Element Details:

Land	Building	Bridges/culverts	Retaining walls	Other	
Lounge	Dining	Kitchen	Family Room	Bedroom 4	✓
Office/Study	Rumpus	Halfway	Stairwell	Toilet	
Laundry	Bathroom	Ensuite	Chimney	Foundations	
Piling	Services	Kitchen Ovens	Hot Water Cylinders	Header Tanks	
Glazing/windows	Fireplace/woodburner	Floor	External Walls	Roof	
Outbuildings	Other				

DESCRIPTION: Multiple well cracks

REPAIR STRATEGY: Repair damage to Bedroom Four

LINE ITEMS:

[illegible]

* Unit Categories to be used as follows:

Each, Sheet, Kilogram, Linear metre, Square metre, Cubic metre, Per Hour, Per Day, Per Week. Cubic metre calculations must include length, breadth and depth figures. Square metre calculations must include length and breadth figures.

Subtotal	964.80
----------	--------

+ P&G, Margin & GST Figure	353.30
----------------------------	--------

TOTAL	1318.10
-------	---------

Completed By: Genard Williams

Date: 30/11/20

Page 1 of 1

H. MORITZEN
25 FLEMINGTON AVENUE
NORTH NEW BRIGHTON
CHRISTCHURCH 8083

M:

Land	Building	Bridges/culverts	Retaining walls	Other
Lounge	Dining	Kitchen	Family Room	Bedroom
Office/Study	Rumpus	Hallway	Stairwell	Toilet
Laundry	Bathroom	Ensuite	Chimney	Foundations
Piling	Services	Kitchen Ovens	Hot Water Cylinders	Header Tanks
Glazing/windows	Fireplace/woodburner	Floor	External Walls	Roof
Outbuildings	Other			

Subbuildings	Other
DESCRIPTION: 2 x 70mm cracks to girth cover (fill only)	

REPAIR STRATEGY: Repair damage to office/study

LINE ITEMS:

[illegible]

Each, Sheet, Kilogram, Linear metre, Square metre, Cubic metre, Per Hour, Per Day, Per Week. Cubic metre calculations must include length, breadth and depth figures. Square metre calculations must include length and breadth figures.

Subtotal	55
----------	----

+ P&G, Margin & GST Figure 20.14

TOTAL	75.14
-------	-------



Scope of Works

Completed By: Genavol Williams

Date: 30/11/20

Page 1 of 1

CLM/2010/082686

H. MORITZEN
25 FLEMINGTON AVENUE
NORTH NEW BRIGHTON
CHRISTCHURCH 8083

M:

Element Details:

Land	Building	Bridges/culverts	Retaining walls	Other
Lounge	Dining	Kitchen	Family Room	Bedroom
Office/Study	Rumpus	Hallway	Stairwell	Toilet
Laundry	Bathroom	Ensuite	Chimney	Foundations
Piling	Services	Kitchen Ovens	Hot Water Cylinders	Header Tanks
Glazing/windows	Fireplace/woodburner	Floor	External Walls	Roof
Outbuildings	Other			

DESCRIPTION: Minor architrave crack to back door

REPAIR STRATEGY: Repair damage to south wall

LINE ITEMS:

[illegible]

* Unit Categories to be used as follows:

Each, Sheet, Kilogram, Linear metre, Square metre, Cubic metre, Per Hour, Per Day, Per Week. Cubic metre calculations must include length, breadth and depth figures. Square metre calculations must include length and breadth figures.

Subtotal	170
----------	-----

+ P&G, Margin & GST Figure 43.94

TOTAL	163.91
-------	--------

Completed By: Gerald Williams

Date: 30/11/20

Page 1 of 1

CLM/2010/082686

H. MORITZEN
25 FLEMINGTON AVENUE
NORTH NEW BRIGHTON
CHRISTCHURCH 8083

W:

M:

Element Details:

Land	Building	Bridges/culverts	Retaining walls	Other	
Lounge	Dining	Kitchen	Family Room	Bedroom	
Office/Study	Rumpus	Hallway	Stairwell	Toilet	
Laundry	Bathroom	Ensuite	Chimney	Foundations	
Piling	Services	Kitchen Ovens	Hot Water Cylinders	Header Tanks	
Glazing/windows	Fireplace/woodburner	Floor	External Walls	Roof	
Outbuildings	Other				

DESCRIPTION: 1 broken floor joist under bedroom

REPAIR STRATEGY: Repair damage to sub floor

LINE ITEMS:

[illegible]

* Unit Categories to be used as follows:

Each, Sheet, Kilogram, Linear metre, Square metre, Cubic metre, Per Hour, Per Day, Per Week. Cubic metre calculations must include length, breadth and depth figures. Square metre calculations must include length and breadth figures.

Subtotal	240
----------	-----

+ P&G, Margin & GST Figure	87.88
----------------------------	-------

TOTAL	327.88
-------	--------

total = \$4606.51



Statement of Claim Checklist

Date: 30 NOVEMBER, 2010.

Author: DOUG HANNAN

CLM/2010/082686

H. MORITZEN
25 FLEMINGTON AVENUE
NORTH NEW BRIGHTON
CHRISTCHURCH 8003

M: _____

LA: DOUG HANNAN

Estimator: GERARD WILLIAMS

Room	Damage	Walls	Ceiling	Floor	Description of Damage
	Y/N	✓	✓	✓	
Lounge	N				
Dining Room	Y	✓			COMBINED - SINK BENCH TO TILES CRACK.
Kitchen	Y	✓			
Family Room	N/A				
UPSTAIRS. Bedroom 1	Y	✓	✓		MULTIPLE CRACKS TO CEILING & WALLS
En Suite	Y	✓		✓	200mm EAST WALL NEAR WINDOW - MULTIPLE GROUT FLOOR TILE CRACKS
Bedroom 2	N				
Bedroom 3	N				
Bedroom 4	Y	✓			MULTIPLE CRACKS - EAST WALL
Bathroom	N				
Toilet 1	N				
Toilet 2	N/A				
Office/Study	Y	✓	✓		10mm X 2 TO GYPRO - WALL/CEILING
WALK IN HARVEST Rampus	Y				PERIMETER CRACK TO CEILING.
Entry/Hall(s)	N				HISTORIC DOOR FRAME TO WALL GAP.
Stairwell	Y	✓			MULTIPLE CRACKS TO STRINGERS
Laundry	N				
Other	N				INTERNAL GARAGE - HISTORIC WALL CRACKS.

Item		Event Damage	Description of Damage	Appoint Engineer
		Y / N	Y / N	
Roof		N	INTERNAL ROOF INSPECTION CARRIED OUT - NO DAMAGE DETECTED - ABOVE NO DAMAGE	N
External Walls	North	N		
	South	Y	MINOR ARCITRAVE CRACK - SOUTH	
	East	N		
	West	N		
Decks		N		
Chimney	Base	N		
	Ceiling Cavity	N		
	Above Roof	N		
	Fireplace	NA		
Foundations		Y	INTERNAL SUB-FLOOR - ONE BROKEN FLOOR JOYCE UNDER BEDROOM 4 (1500MM LONG)	
Piling		N	CONCRETE PILES	
Services		N		
Other Dwelling Items		N		
Outbuildings		N		
Land & Retaining Walls		N		
(Discuss with Supervisor)				

I confirm the rooms and areas listed above have been inspected by an EQC representative.

Damage caused by the event has been noted and to my knowledge there are no other areas of damage resulting from the event.

Signature of Claimant:

[Handwritten Signature]

Dated: 30/11/10

Date: 30/11/10Claim Number: 2010/082686Estimator's Name: General Williams

Dwelling is two storey.

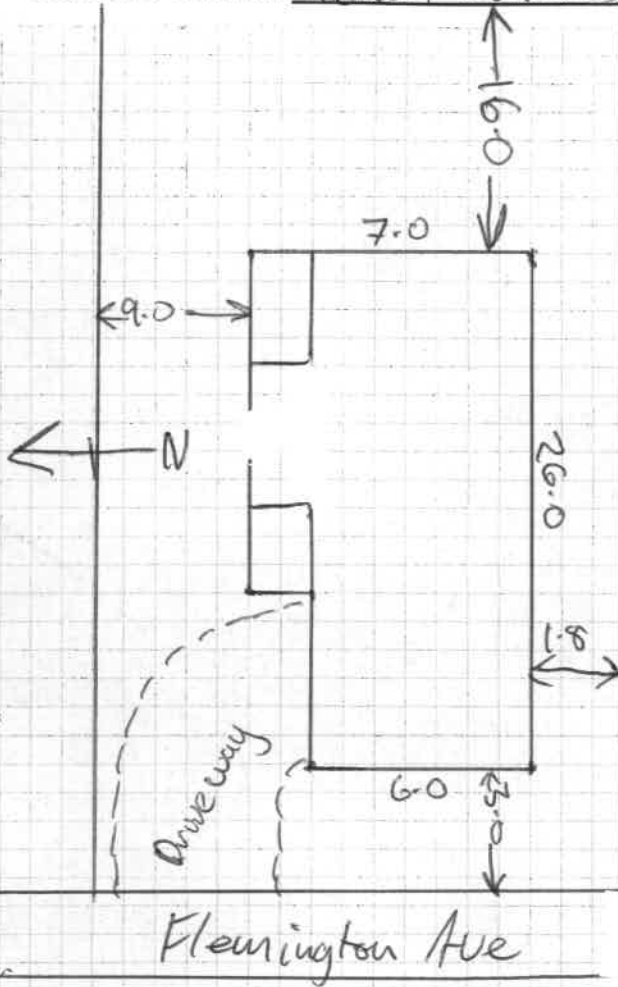

Area m ² :	<u>200</u>			
Stud Heights:	<u>2.4</u>			
Wall Finish:	Wallpaper	Plastered	<u>Paint finish</u>	
Other:				
Services:	Specify damage:			
Chimneys:	Construction type:			
<u>N/A</u>	Height:			
	Damage description: Above Roof Below Roof Total Repair			
Foundations Damage:	<u>Timber</u>	Concrete Ring	<u>Concrete Slab</u>	Other (specify):
	Minor	Moderate	Severe	
	House moved off foundations?:			
	Concrete slab cracked? Crack width Crack length			
Roof:	Framed	Trussed		
	Type: Clay Tiles	Concrete tiles	<u>Metal tiles</u>	Rolled Metal Other (specify):
	Damage:			
Cladding Type:	Weatherboard	Brick Veneer	<u>Hardi Plank</u>	Other

Additional Information

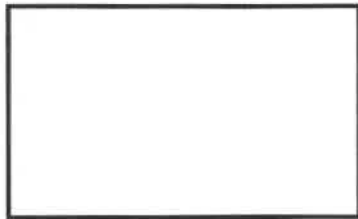
Date: 30/11/10Claim No: 2010/082686Estimator's Name: Gerard WilliamsDwelling Inspection Checklist: Show measurements, indicate damage

Lounge

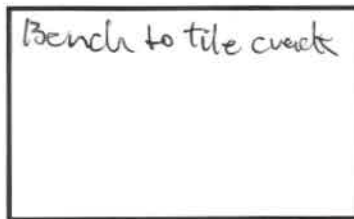

Dining Room/Kitchen

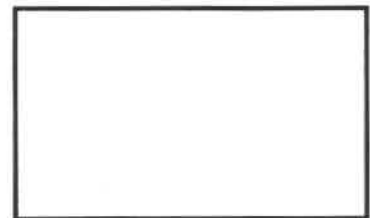

Kitchen

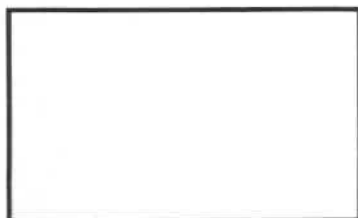

Family Room

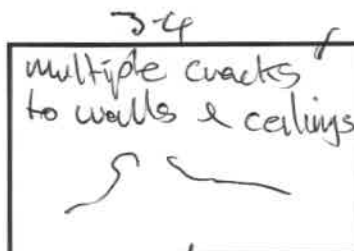

Bed 1

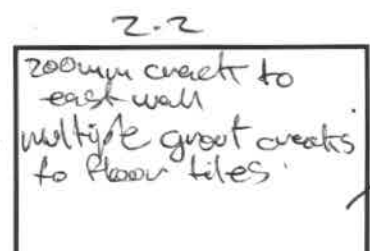

Ensuite

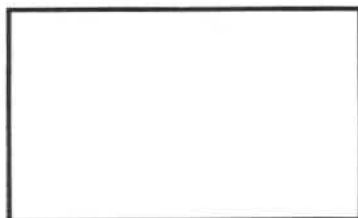

Bed 2

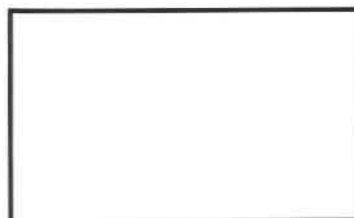

Bed 3

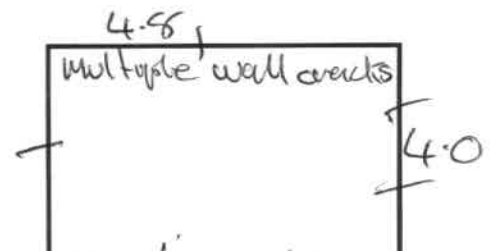

Bed 4

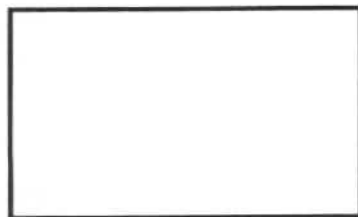

Bathroom

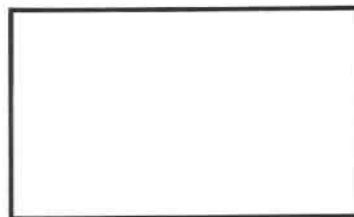

Toilet 1



Toilet 2

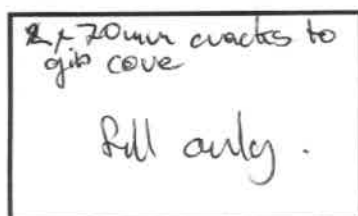

Office/Study

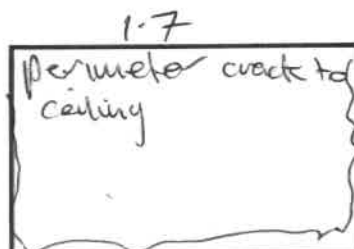

walk in wardrobe



Entry/Halls

Date: 30/11/10Claim No: 2010/ 082686Estimator's Name: Gerrard Williamsmultiple cracks to
stringers

Stairwell

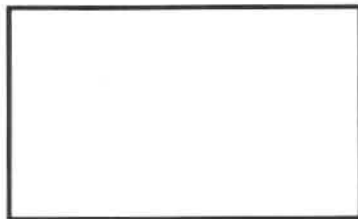

Laundry

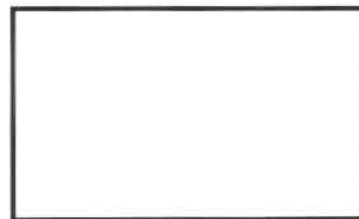

Outbuildings/Garage

minor architrave
crack Back door

South wall

1 Broken Floor
Joist to bedroom
floor.

Sub Floor

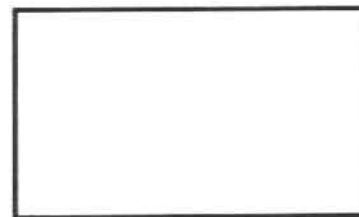
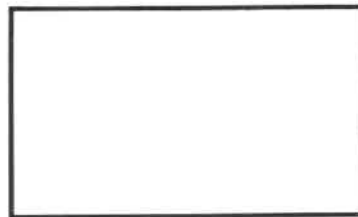
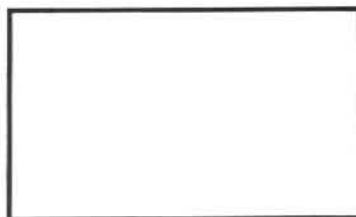
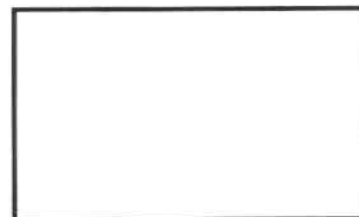
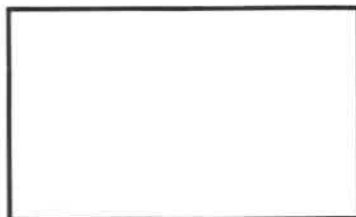

Legend

/ =	wall cracks
~ =	ceiling cracks

HUB FILE NOTE:

Completed By:	Jeremy Cosgrove	Claim Number:	2011 / 063773
Date:	5/06/2015	Customer Name:	Mrs Heike Moritzen
Role:	ESTIMATOR	Address:	25 flemington Ave North New Brighton Christchurch
Hub:	Blenheim		
Type(tick one)	<input type="checkbox"/> SCOPE/COST VARIATION	<input type="checkbox"/> PARTIAL /FULL CASH SETTLEMENT	
	<input type="checkbox"/> NEW/ADDITIONAL DAMAGE	<input type="checkbox"/> REPORT/CLAIM INFORMATION	
	<input type="checkbox"/> POSSIBLE OVERCAP	<input checked="" type="checkbox"/> OTHER	
ASSOCIATED CLAIMS:	2010/082686	2011/210902	

NOTES/ DESCRIPTIONS:

PLEASE PROCESS AS SOON AS POSSIBLE AS THE CUSTOMER HAS BEEN WAITING AN EXTENDED PERIOD OF TIME .

Site Meeting 03/06/15

Attendees Jeremy Cosgrove EQC , Chris Lawrence EQC , Mr & Mrs Moritzen

The purpose of the site meeting was to meet with the home owners to view the home in conjunction with the home owner supplied engineers report . We undertook an inspection of the entire home room by room referencing and checking the heights and repair strategy's for the home . We can confirm that the heights noted on the engineering report are correct . The property has settled along the south west side of the home this is confirmed by walls being out of plumb , doors closing/self-opening and the exterior weatherboard also sloping in the same direction . The engineering report has suggested that the home would require lifting and a new foundation be installed " A Waffle slab " the reasoning for this is that the ground conditions are very poor and would not support the same type of foundation that the home currently has (concrete ring and pile) . The assumption that the ground is of poor quality has been made by the engineer from the bore holes that were done in close proximity to the home within 20 meters in either direction as part of the drilling programme the home is located more or less in between the bore holes we believe that this assumption is fair and reasonable given the bore hole results and the general geographic location of the home . The existing EQC foundation repair(jack & pack 50 piles) would not be adequate nor would a conventional " underpinning " of the existing ring foundation be adequate due to the assumed ground conditions

EQC in general is in agreement with the repairs outlined in the report . While the actual repair may differ from what has been suggested in the report as some assumptions have had to be made but with good supporting evidence it would be fair and reasonable to expect that any repair would place this claim over cap as it has done with the costs associated with the intended repair outlined by the engineer that I have based my costs on .

Possible Over cap.

Please refer to settlement team for urgent settlement.

Construction budget of \$249,119.88 inc GST.

Jeremy Cosgrove | EQC Estimator Blenheim Hub | earthquake Commission (EQC)

Mob +64 275042473 | jcosgrove@eqc.govt.nz

NEXT ACTION/ RECOMMENDATION FOR HUB SUPPORT

APPROVED
Jeremy Cosgrove
EQC Riccarton Hub

8 / 6 / 15



gcosgrove

HUB FILE NOTE:

Scope of Works



Completed By:	Jeremy Cosgrove	Claim Number:	2011 / 063773
Date:	3/06/2015	Customer Name:	Mrs Heike moritzen
Page	1 OF 4	Address:	25 flemington Ave North New Brighton Christchurch

Description

This SOW is for only the elements being cash settled

Line Items:

Element :		Units	Qty	Rate	Cost
External Element	Foundation				
Ring Foundation	Relocate / lift dwelling	No	1.00	\$22,925.00	\$22,925.00
Ring Foundation	Remove dispose broken ring foundation	m	56.00	\$50.00	\$2,800.00
Slab Foundation	Type 2a - 150mm reinforced concrete slab with 600mm reinforced gravel raft (excluding piles)	m2	33.90	\$314.50	\$10,661.55
Slab Foundation	Type 2b - 150mm reinforced concrete slab with 600mm reinforced gravel raft (excluding piles)	m2	148.00	\$434.70	\$64,335.60
Slab Foundation	Piles for type 2b slab	No	74.00	\$266.63	\$19,730.62
External Element	South Wall				
Wall Cladding	Remove and dispose fibre cement sheet	m2	1.00	\$59.50	\$59.50
Wall Cladding	Paint Textured wall	m2	7.92	\$27.25	\$215.82
External Element	West Wall				
Wall Cladding	Paint Textured wall	m2	21.19	\$27.25	\$577.43
Deck	remove deck	m2	13.77	\$22.00	\$302.94
Deck	Supply install deck subframe and deck surface	m2	13.77	\$245.66	\$3,382.74
Deck	remove deck	m2	18.29	\$22.00	\$402.38
Deck	Supply install deck subframe and deck surface	m2	18.29	\$245.66	\$4,493.12
Interior Room	Internal Garage				
Wall Covering	Rake out & stop plasterboard joint cracks & paint	m2	55.92	\$32.90	\$1,839.77
Interior Room	Entry				
Wall Covering	Rake out & stop plasterboard joint cracks & paint	m2	27.22	\$32.90	\$895.54
Floor	Remove set aside and relay carpet	m2	6.17	\$13.75	\$84.84
Ceiling	Rake out and stop plasterboard joint cracks and paint	m2	6.17	\$36.40	\$224.59
Interior Room	Hallway				
Ceiling	Scrape off rake out fill and restipple	m2	7.46	\$50.25	\$374.87
Wall Covering	Rake out & stop plasterboard joint cracks & paint	m2	44.37	\$32.90	\$1,459.77
Floor	Remove set aside and relay carpet	m2	7.46	\$13.75	\$102.58
Floor	Remove dispose supply install particle board	m2	3.00	\$95.07	\$285.21
Interior Room	Office / Study				
Ceiling	Paint ceiling	m2	5.57	\$23.60	\$131.45
Floor	Remove set aside and relay carpet	m2	5.57	\$13.75	\$76.59
Interior Room	Bathroom				
Shower	Remove and reinstall acrylic shower enclosure for other trades	No	1.00	\$530.00	\$530.00
Bathroom Sink	Remove and reinstall - 2 trips	No	1.00	\$290.00	\$290.00
Toilet	Remove and reinstall for other trades	No	1.00	\$120.00	\$120.00

* Unit categories to be used as follows:

Each, Sheet, Kilogram, Linear metre, Square metre, Cubic metre, Per hour, Per day, Per week, Cubic metre calculations must include length, breadth and depth figures. Square metre calculations must include length and breadth figures.

Sub Total \$136,301.89

Preliminaries & General \$10,904.15

Margin \$14,720.60

SUB TOTAL (Excluding GST) \$161,926.65



Scope of Works



Completed By:	Jeremy Cosgrove	Claim Number:	2011 / 063773
Date:	3/06/2015	Customer Name:	Mrs Heike moritzen
Page	2 OF 4	Address:	25 flemington Ave North New Brighton Christchurch

Description

This SOW is for only the elements being cash settled

Line Items:

Element :		Units	Qty	Rate	Cost
Interior Room	Bedroom 2nd on right				
Ceiling	Scrape off rake out fill restipple and paint	m2	11.60	\$73.10	\$847.96
Wall Covering	Rake out & stop plasterboard joint cracks & paint	m2	33.12	\$32.90	\$1,089.65
Floor	Remove set aside and relay carpet	m2	11.60	\$13.75	\$159.50
Floor	Remove dispose supply install particle board	m2	3.00	\$95.07	\$285.21
Door Internal	Re-align Door	No	1.00	\$98.75	\$98.75
Door External	Re-align Door	No	1.00	\$98.75	\$98.75
Interior Room	Bedroom 1st on right				
Ceiling	Gap fill sand and paint - ceiling	m2	11.20	\$35.60	\$398.72
Wall Covering	Rake out & stop plasterboard joint cracks & paint	m2	32.16	\$32.90	\$1,058.06
Floor	Remove set aside and relay carpet	m2	11.20	\$13.75	\$154.00
Floor	Remove dispose supply install particle board	m2	3.00	\$95.07	\$285.21
Interior Room	Laundry				
Wall Covering	Rake out & stop plasterboard joint cracks & paint	m2	17.66	\$32.90	\$581.01
Interior Room	Living Room				
Ceiling	Gap fill sand and paint - ceiling	m2	27.50	\$35.60	\$979.00
Wall Covering	Rake out & stop plasterboard joint cracks & paint	m2	50.40	\$32.90	\$1,658.16
Floor	Remove set aside and relay carpet	m2	27.50	\$13.75	\$378.13
Floor	Remove dispose supply install particle board	m2	3.00	\$95.07	\$285.21
Interior Room	Kitchen				
Ceiling	Scrape off rake out fill restipple and paint	m2	19.95	\$73.10	\$1,458.35
Wall Covering	Rake out & stop plasterboard joint cracks & paint	m2	48.77	\$32.90	\$1,604.53
Floor	Remove dispose supply install vinyl planking	m2	19.95	\$114.50	\$2,284.28
Floor	Remove dispose supply install particle board	m2	3.00	\$95.07	\$285.21
Kitchen Joinery	Remove and reinstall kitchen	No	1.00	\$1,365.00	\$1,365.00
Interior Room	Entry				
Ceiling	Scrape off rake out fill restipple and paint	m2	6.12	\$73.10	\$447.37
Wall Covering	Rake out & stop plasterboard joint cracks & paint	m2	24.96	\$32.90	\$821.18
Floor	Remove dispose supply install vinyl planking	m2	6.12	\$114.50	\$700.74
Interior Room	Rumpus				
Ceiling	Gap fill sand and paint - ceiling	m2	19.20	\$35.60	\$683.52
Wall Covering	Remove dispose supply install plasterboard & stop	m2	2.88	\$102.40	\$294.91
Wall Framing	Remove dispose supply and install framing - 100mm x 50mm	m	3.00	\$20.50	\$61.50
Wall Covering	Rake out & stop plasterboard joint cracks & paint	m2	42.24	\$32.90	\$1,389.70
Floor	Remove set aside and relay carpet	m2	19.20	\$13.75	\$264.00
Floor	Remove dispose supply install particle board	m2	3.00	\$95.07	\$285.21

* Unit categories to be used as follows:

Each, Sheet, Kilogram, Linear metre, Square metre, Cubic metre, Per hour, Per day, Per week, Cubic metre calculations must include length, breadth and depth figures. Square metre calculations must include length and breadth figures.

Sub Total \$20,302.82

Preliminaries & General \$1,624.23

Margin \$2,192.70

SUB TOTAL (Excluding GST) \$24,119.75



Scope of Works



Completed By:		Claim Number:	2011 / 063773
Date:	3/06/2015	Customer Name:	Mrs Heike moritzen
Page	4 OF 4	Address:	25 flemington Ave North New Brighton Christchurch

TOTALS PAGE :

P & G's Page:

P & G's Page - Sub Total

Building Damage Page:

Scope Of Works Page	1	\$161,926.65
Scope Of Works Page	2	\$24,119.75
Scope Of Works Page	3	\$30,579.59

Scope Of Works Pages - Sub Total \$216,625.99

* Unit categories to be used as follows:

Each, Sheet, Kilogram, Linear metre, Square metre, Cubic metre, Per hour, Per day, Per week. Cubic metre calculations must include length, breadth and depth figures. Square metre calculations must include length and breadth figures.

Sub Total \$216,625.99

GST \$32,493.90

TOTAL \$249,119.88



ESTIMATOR'S FILE NOTE

CA Name: _____

Customer Contact _____

DATE: 27-3-12AUTHOR: Peter TaylorClaim Number: 2011/210902Customer: Heike MortzenSituation of Loss: 25 Flemington Ave
North New BrightonCONFIDENTIAL: ☐YES ☒NO ☐Subject: **EMERGENCY WORK****REVIEW CUSTOMER COSTINGS**M.C. Tipene Plumbing LtdEQC Estimate\$1,743.40\$1,606.65 incl

The labour rate is high but access into the
Header Tank is not easy. M.C. Tipene Price is
within 10% of EQC. Approval is given for this
Invoice to be paid to M.C. Tipene Plumbing Ltd

☐ REPAIRS SIGHTED☐ FURTHER INVOICES REQUIRED

APPROVAL HAS BEEN GIVEN FOR PAYMENT OF REPAIRER INVOICES TO

☒ THE VALUE OF \$ 1,743.40SIGNED: ESTIMATOR: P. Taylor

48

Km-2011-210902 EU
PG1

COPY

TAX INVOICE/STATEMENT

Date

2011/7/11

917878

To HETKE MORTZEN
Address 25 FLEMINGTON AVEFrom M. C. TIERNE PLUMBING LTD
Address 374 ENGLEFIELD RD
PELFAST CH-CH
03 323 8525

CLM = 2011/210 902

Qty	Unit	Description	Unit Price	\$	c
*		REPLACE HEADER TANK + PIPEWORK DUE TO E-Q DAMAGES			
1		HEADER TANK + OVERFLOW TRAY + FLOAT VALVE		416	00
4		P.V.C. CONNECTORS + GELVE		48	00
6		BRASS FITTINGS		78	00
8		SECURA FITTINGS + PIPE		122	00
2		LAPPING		42	00
1 m		4x2, NAILS, SCREWS		18	00
1		HEMP + GRAPHITE		12	00
1		TRAVEL + CARTAGE		30	00
1		LABOUR KIRE \$75 x 5h		375	00
1		LABOUR WICK \$75 x 5h		375	00



GST Reg No.

49941986

Ref. O/N

E-Q-C FLEMINGTON

SUB TOTAL

1516 00

PLUS GST

227 40

TOTAL

1743 40

2011/210 902

LAND DOCUMENTS

The following information contains documents relating to the land assessments that were either cash settled or declined:

The attached land document(s) help NHC Toka Tū Ake identify information that may be relevant to its assessment of your residential land claims. They are not intended to form a complete technical report on land damage to your land. The land information, including valuations, repair costs and estimates, do not necessarily reflect the final land settlement received

Scope of Works

EQC

Completed by: Mary Matheson

CLM / 2011 / 063773
 HEIKE MORITZEN
 25 FLEMINGTON AVENUE
 NORTH NEW BRIGHTON
 CHRISTCHURCH

Date:

6/3/13
 dd / mm / yy

Page: 1 of 1

Description: **Damage to Land**

Repair Strategy: Removal and/or import materials and labour to repair land

93 m²

Description - Removal of Debris/Minor Works	Units	Length	Breadth	Depth	Quantity	Rate	Cost
Transporter- machine	each					\$160	
Machine Hire	hrs					\$110	
Truck Hire	hrs					\$100	
Labour	hrs					\$45	
Contaminated Spoil Removal	m ³					\$100	
Spoil Removal/Tip Fees (clean)	m ³					\$20	
Skip (4m ³)	each					\$190	
Materials	each						

NB A Small/Minor Works cost may only be applied when there is only land repair to the site/property; a total area of damage under 15m²; no further works required

Description - Supply and level hard fill	Units	Length	Breadth	Depth	Quantity	Rate	Cost
Land Under Residential Buildings (Type 'A') - Supply and level hard fill	m ²					\$12	
Land Under Access way (Type 'B') - Supply and level hard fill	B1 m ²	12	4	-	48m ²	\$12	576.00
Land Under Pavers/Patio/Concrete (Type 'C') - Supply and level hard fill	C3 m ²	2	2	-	4m ²	\$12	96.00
	C4	2	2	-	4m ²		
Undulating Lawn Areas (Type 'C') - Level and Seed	C1 m ²	5	5	-	25m ²	\$10	310.00
	C2	6	2	-	12m ²		
Lateral Spread Cracks under 10mm but greater than 5mm	Lm					\$25	
Lateral Spread Cracks greater than 10mm	Lm					\$90	
					Sub-total		1042.00
					P&G, Margin & GST (Figure x 1.3662)		381.58
					Total		1423.58

* Unit categories to be used as follows:

Each, Sheet, Kilogram, Linear metre, Square metre, Cubic metre,
 Per hour, Per day, Per week.

Cubic metre calculations must include length, breadth and depth
 figures.

Square metre calculations must include length and breadth figures.



V1.33, FEB 2013

CHECKED

Inspection Summary

Completed by: Mary Matheson

CLM / 2011 / 063773

 HEIKE MORITZEN
 25 FLEMINGTON AVENUE
 NORTH NEW BRIGHTON
 CHRISTCHURCH
Date: 6/3/13
dd / mm / yy

Page: 1 of 1

 Time arrived at site: 2 : 00 Time left site: 3 : 30 Was an inspection carried out? ☒ Yes ☐ No
Customer present: ☒ Yes ☐ NoCustomer Name: Heike MoritzenAccess denied ☐ Loose dogs ☐ Other ☐ If other, please provide reasonIf No inspection carried out, why not? ☐ ☐ ☐

Where an inspection has been conducted:

Yes No

Notes

- | Where an inspection has been conducted: | Yes | No | Notes |
|---|-------------------------------------|-------------------------------------|-----------------------------|
| - Any land damage under the main access way or other hard surfaces? | <input checked="" type="checkbox"/> | <input type="checkbox"/> | B1 undulations under pavers |
| - Were any bridges or culverts damaged within EQC Cover? | <input type="checkbox"/> | <input checked="" type="checkbox"/> | |
| - Were any retaining walls damaged within EQC Cover? | <input type="checkbox"/> | <input checked="" type="checkbox"/> | |
| - Is an engineer required? | <input type="checkbox"/> | <input checked="" type="checkbox"/> | |
| - Is a valuation required? | <input type="checkbox"/> | <input checked="" type="checkbox"/> | |
| - Is a resource consent required for any remediation work? (proximity to protected trees and waterways) | <input type="checkbox"/> | <input checked="" type="checkbox"/> | |
| - Has anything in this pack been escalated? | <input type="checkbox"/> | <input checked="" type="checkbox"/> | |
| - Customer has advised of invoices for emergency work? | <input type="checkbox"/> | <input checked="" type="checkbox"/> | |
| - Customer advised of next action? | <input checked="" type="checkbox"/> | <input type="checkbox"/> | |
| - Was any silt found under the dwelling? | <input type="checkbox"/> | <input checked="" type="checkbox"/> | |

 - If there was nil damage, why was that? Building removed ☐ Building repairs have fixed ☐ No visible damage ☐

 - If a potential or actual 8/9 property, was the dwelling present? Building removed ☐ Building present ☐

Land Damage to Area A? If Yes, add details

Yes ☐ No ☒

Land Damage to Area B? If Yes, add details

Yes ☒ No ☐B1 - undulating causing ponding

Land Damage to Area C? If Yes, add details

Yes ☒ No ☐
C1 + C2 - undulating lawn areas
C3 + C4 - undulating under pavers.
Total m² of Damaged Land: 93 m²Notional Land Damage Value @\$300/m² (Incl GST):\$27,900.00

Fence/gate over pavers at C3 out of line + costed to remove + replace 3Lm.

Next action Refer to settlement
CHECKED

V1.32, FEB 2013



HEIKE MORITZEN

25 FLEMINGTON AVENUE

NORTH NEW BRIGHTON

CHRISTCHURCH

Legend Sheet

Complex Flat Land Claims



EARTHQUAKE COMMISSION

Kōmihana Rūwhenua

Claimant:

Date: 6/3/13

Author: may madesa

Item N°	Description/Construction	Length	Height/Width	Depth	Damage	Damaged Area	Evacuated m ²	Inundated m ²	Debris m ³	Access E D
B1	Pavers - Drive Accessway	12	4	.100	undulating + Ponding	48m ²	48m ²	-	-	E
c1	Lawn Area.	5	5	.100	undulating.	25m ²	25m ²	-	-	E
c2	Lawn Area.	6	2	.100	undulating	12m ²	12m ²	-	-	E
c3	Pavers - Path	2	2	.100	Pavers not damaged undulating	4m ²	4m ²	-	-	E
c4	Pavers - Path.	2	2	.100	Pavers not damaged undulating	4m ²	4m ²	-	-	E

CHECKED



NAME: ALLAN BROOKS

DATE: 6/3/2013



HEIKE MORITZEN
25 FLEMINGTON AVENUE
NORTH NEW BRIGHTON
CHRISTCHURCH

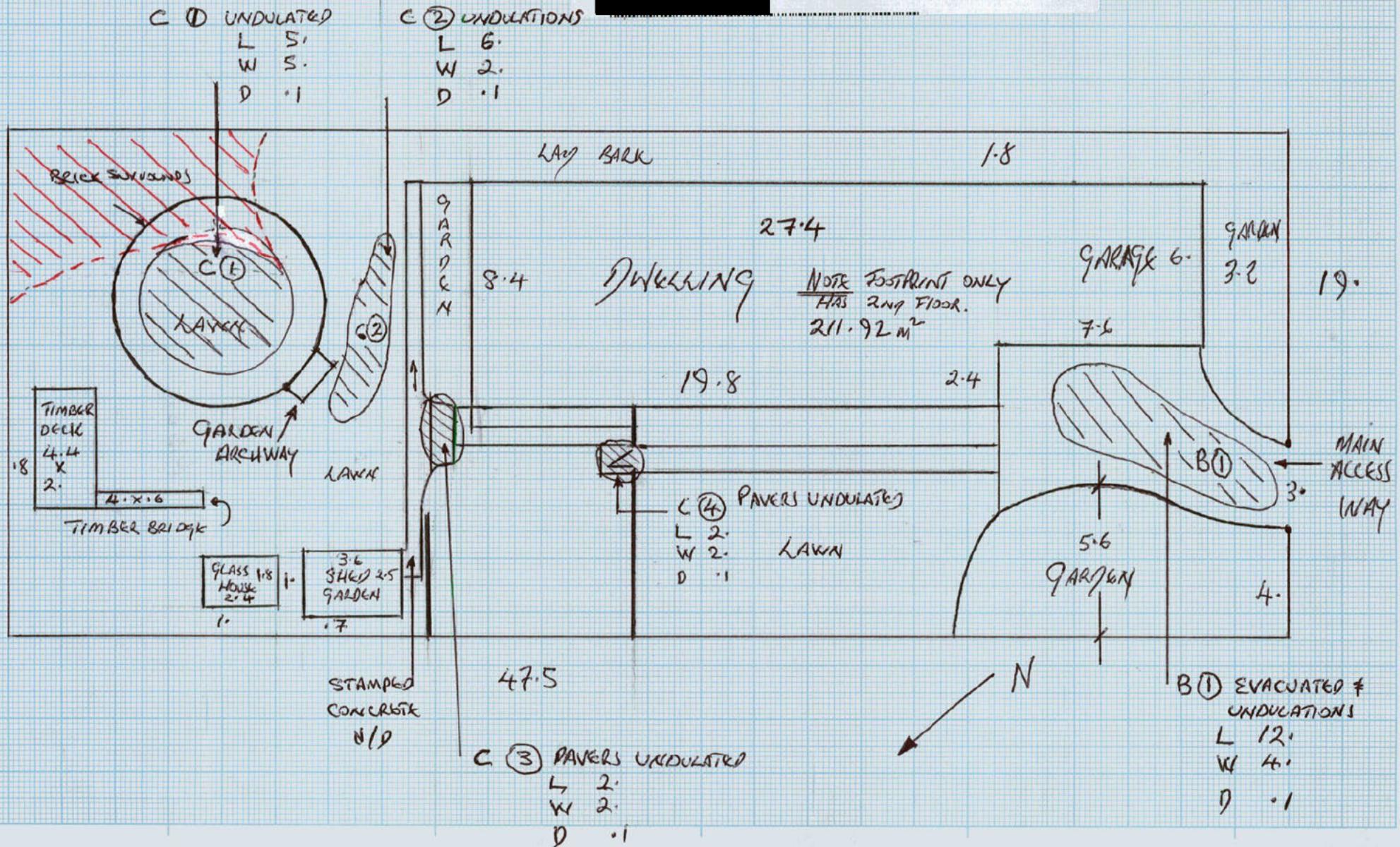

CHECKED

Path: L:\52000\Working\GIS\MapDocs\Fld\AKL\CHCH-C120 NorthNewBrighton.mxd Date: 19/05/2011 Time: 5:33:45 p.m.

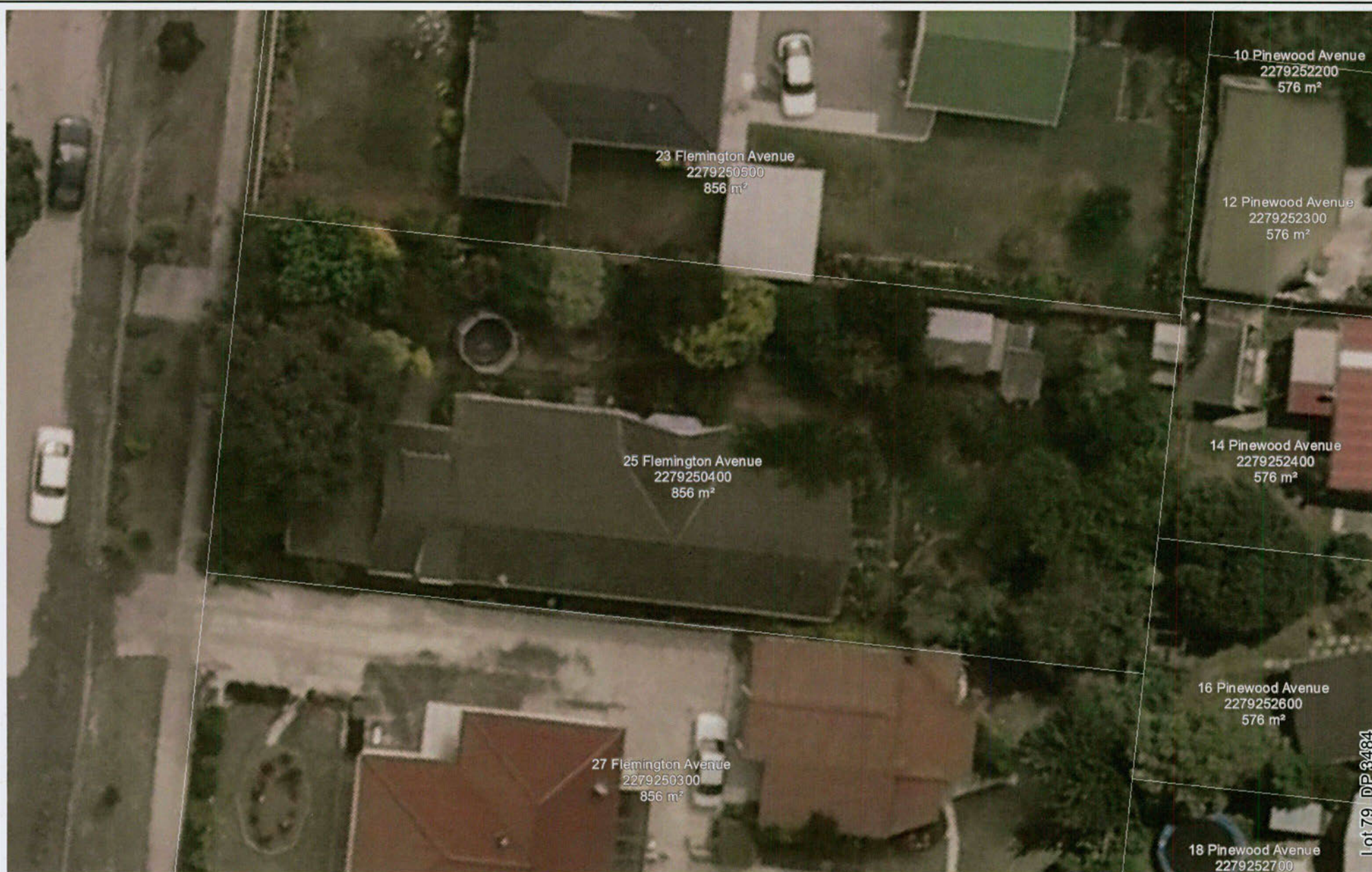

Notes:

A4 SCALE 1:250

0 2 4 6 8 10 (m)



Drawn by:

Date:



22 FEB 2011 - EARTHQUAKE
NORTH NEW BRIGHTON, CHRISTCHURCH
(C120-049838) - 25 Flemington Avenue

EQC Claim No: 201 _ /

Lot 79 DP 3484