

GRIFFIOEN.

RECORD OF TITLE

Statement of Passing Over: This information has been supplied by the vendor or the vendor's agents. GRIFFIOEN. (Powered by Ownly Limited, Licensed REAA 2008) is merely passing over this information as supplied to us.

We cannot guarantee its accuracy as we have not checked, audited, or reviewed the information and all intending purchasers are advised to seek your own advice as to the information contained in this document.

To the maximum extent permitted by law we do not accept any responsibility to any party for the accuracy or use of the information herein.



**RECORD OF TITLE
UNDER LAND TRANSFER ACT 2017
UNIT TITLE**

**Guaranteed Search Copy issued under Section 60 of the Land
Transfer Act 2017**



R.W. Muir
Registrar-General
of Land

Identifier **806359**
Land Registration District **Canterbury**
Date Issued 15 June 2018

Prior References
818317

Supplementary Record Sheet
845022

Estate Stratum in Freehold
Legal Description Principal Unit 5 and Accessory Unit 5A
Deposited Plan 516817
Registered Owners
JP & JK Investments Limited

**The above estates are subject to the reservations, restrictions, encumbrances, liens and interests noted below and
on the relevant unit plan and supplementary record sheet**

11172444.3 Mortgage to Westpac New Zealand Limited - 19.7.2018 at 3:47 pm



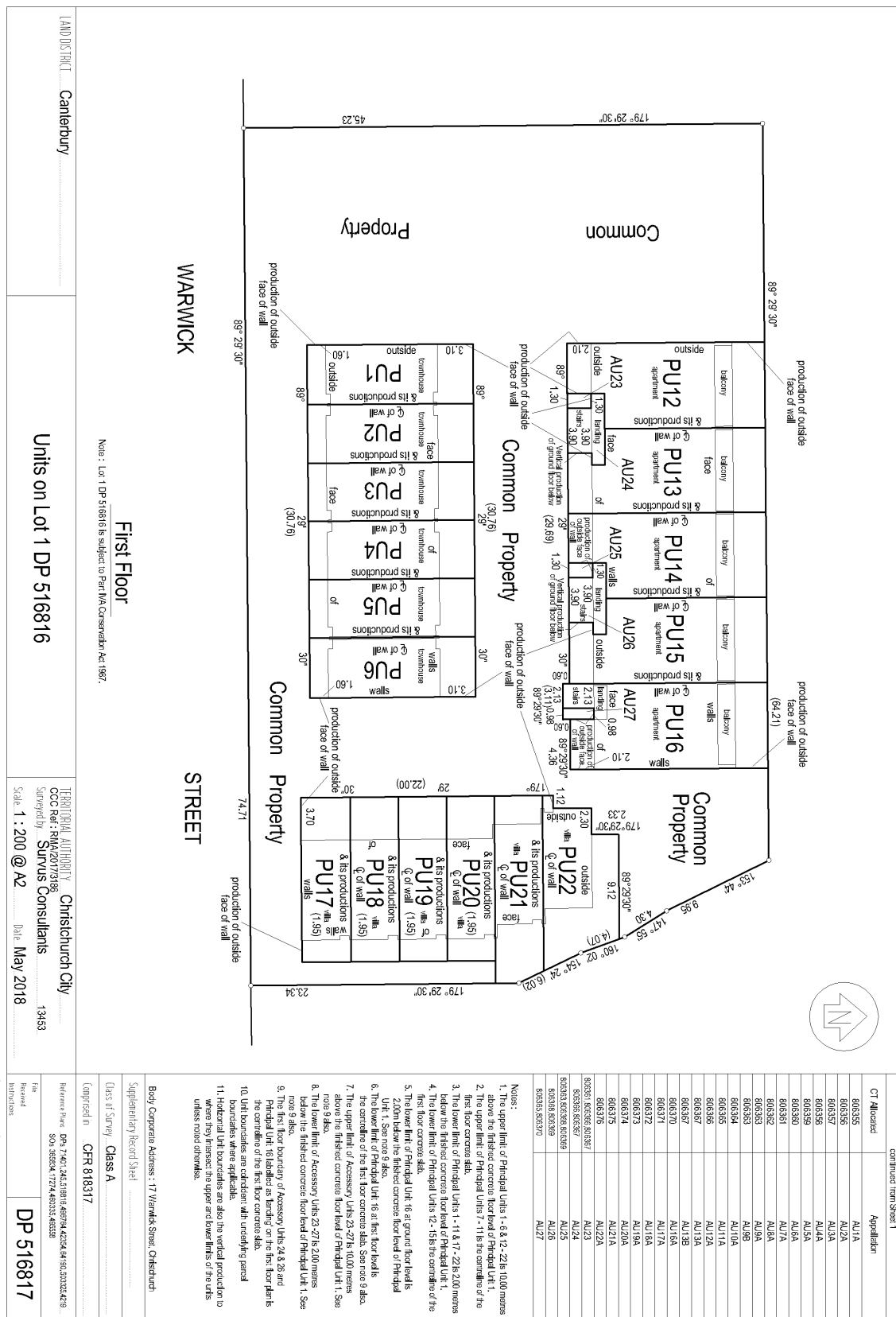



SUPPLEMENTARY RECORD SHEET UNDER UNIT TITLES ACT 2010

**Guaranteed Search Copy issued under Section 60 of the Land
Transfer Act 2017**

Identifier

845022

Land Registration District **Canterbury**

Date Issued 15 June 2018

Plan Number DP 516817

Subdivision of

Lot 1 Deposited Plan 516816

Prior References

818317

Unit Titles Issued

806355	806356	806357	806358
806359	806360	806361	806362
806363	806364	806365	806366
806367	806368	806369	806370
806371	806372	806373	806374
806375	806376		

Interests

OWNERSHIP OF COMMON PROPERTY

Pursuant to Section 47 Unit Titles Act 2010 -

(a) the body corporate owns the common property and

(b) the owners of all the units are beneficially entitled to the common property as tenants in common in shares proportional to the ownership interest (or proposed ownership interest) in respect of their respective units.

752 Order in Council imposing a Building Line Restriction - 21.9.1920 at 10:00 am

Subject to Part IVA Conservation Act 1987

Subject to Section 11 Crown Minerals Act 1991

Subject to a right (in gross) to a right of way over parts marked A & B on DP 516816 in favour of Christchurch City Council created by Easement Instrument 7731881.9 - 28.2.2008 at 9:00 am

The easements created by Easement Instrument 7731881.9 are subject to Section 243 (a) Resource Management Act 1991

Subject to a right (in gross) to convey electricity easement over parts marked B & C on DP 516816 in favour of Orion New Zealand Limited created by Transfer 7731881.10 - 28.2.2008 at 9:00 am

The easements created by Transfer 7731881.10 are subject to Section 243 (a) Resource Management Act 1991

Subject to a right (in gross) to convey electricity over part marked D on DP 516816 in favour of Orion New Zealand Limited created by Easement Instrument 11091591.10 - 15.6.2018 at 4:29 pm

11091591.11 Notice of body corporate operational rules pursuant to Section 105 Unit Titles Act 2010 - 15.6.2018 at 4:29 pm

11091591.12 Certificate of assessment of ownership interest pursuant to Section 32 Unit Titles Act 2010 - 15.6.2018 at 4:29 pm

12895270.1 Notice of change of body corporate operational rules pursuant to Section 106 Unit Titles Act 2010 - 5.12.2023

at 7:00 am