

# Comparative Market Analysis



## 20 HARWARD STREET THE GAP QLD 4061

Prepared on 29th September 2025

**Parth Virmani**  
**ONE PERCENT PROPERTY**

shop 7/359 Gympie Road  
Kedron QLD 4031

m: 31740000

[parth@onepercentproperty.com.au](mailto:parth@onepercentproperty.com.au)

# Floor Plan

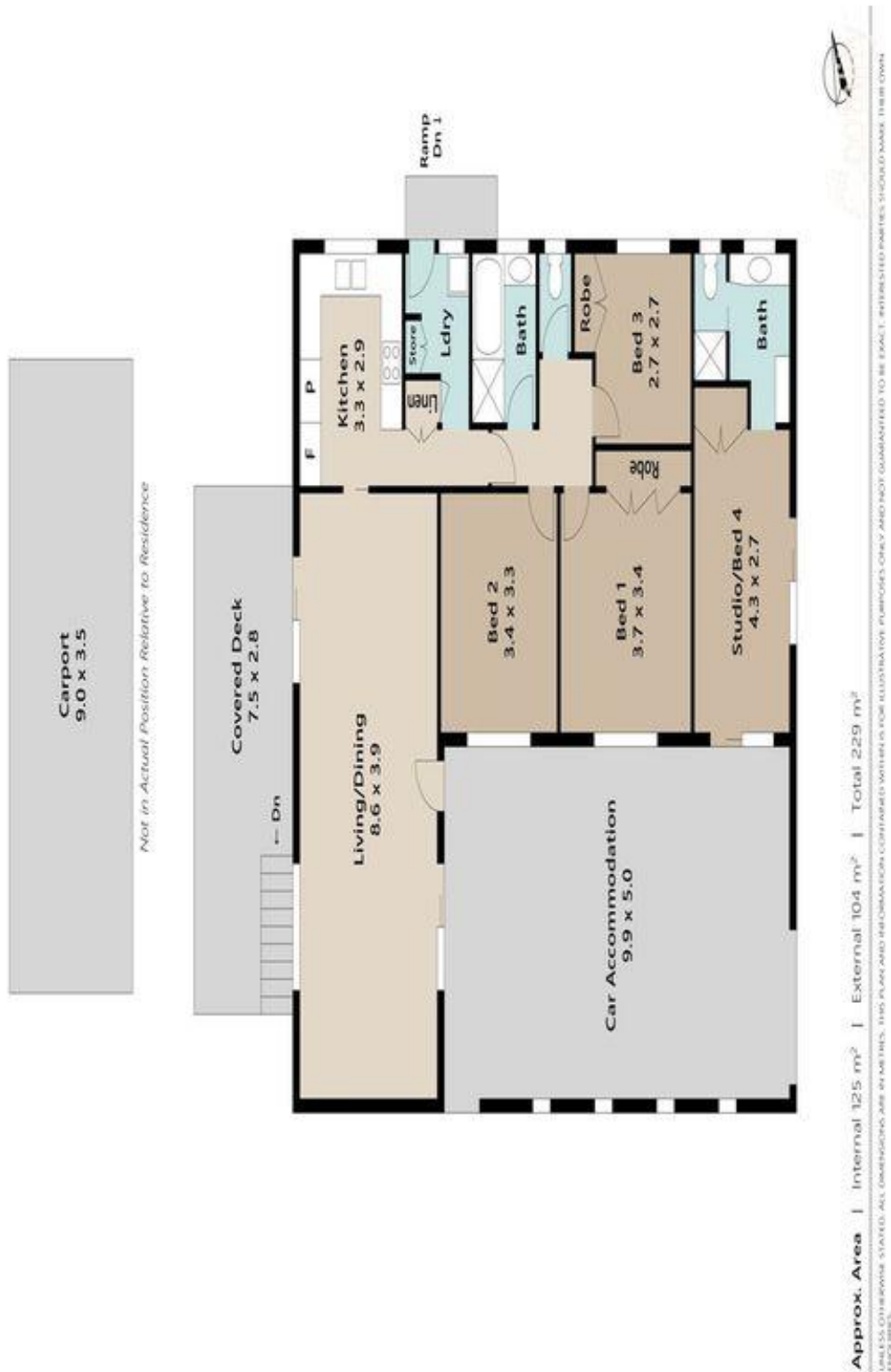



# Comparables Map: Sales

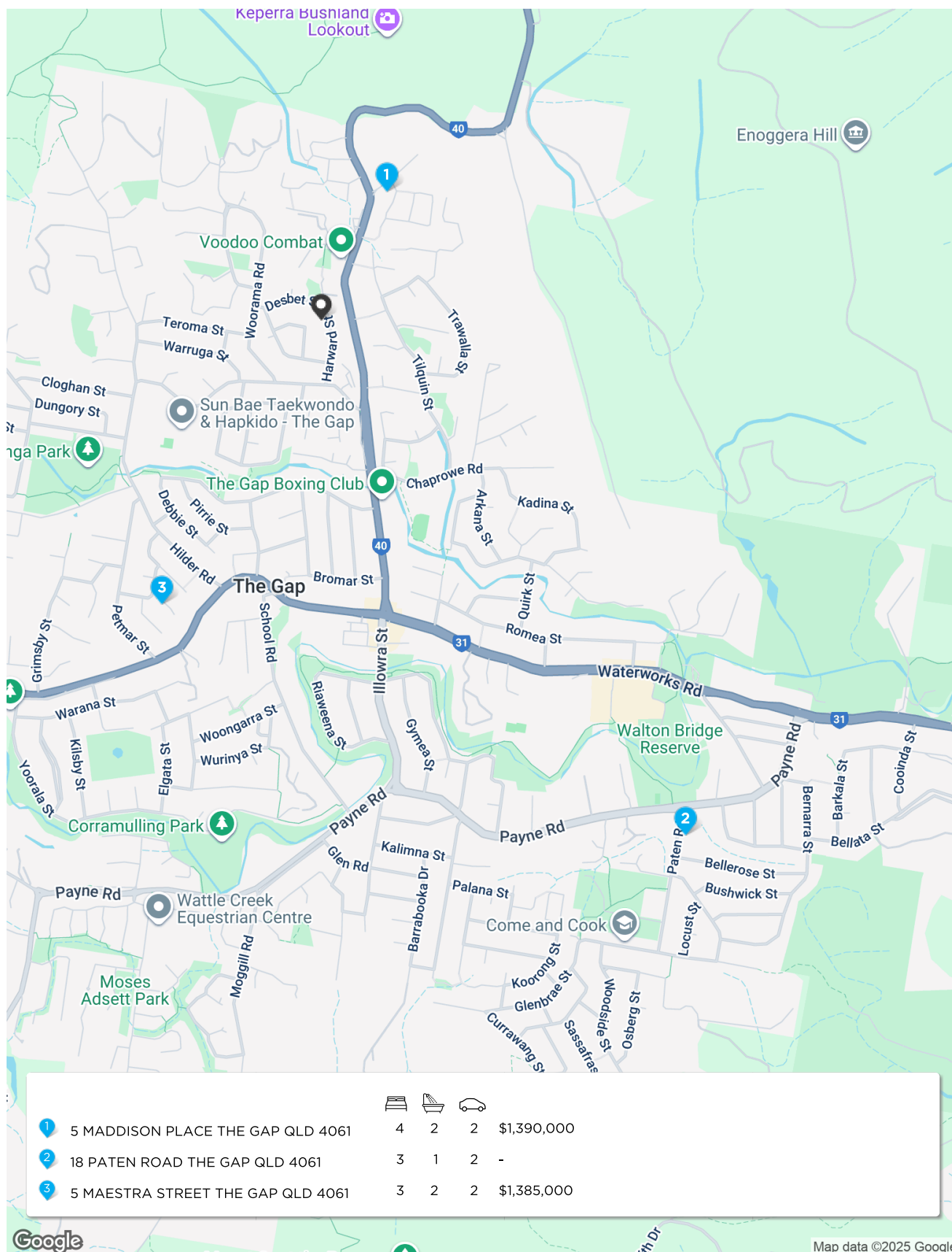





\* This data point was edited by the author of this CMA and has not been verified by Cotality

## Comparable Sales

1 5 MADDISON PLACE THE GAP QLD 4061





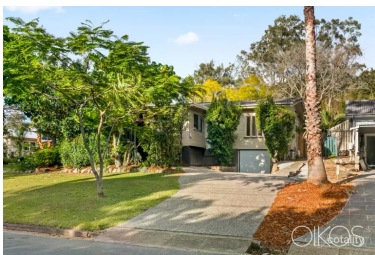

 4  2  2  605m <sup>2</sup>  168m <sup>2</sup>			
Year Built	2007	DOM	69
Sold Date	30-Jun-25	Distance	0.5km
First Listing	For Sale		
Last Listing	For Sale		

Sold	\$1,390,000
------	-------------

2 18 PATEN ROAD THE GAP QLD 4061







 3  1  2  607m <sup>2</sup>  120m <sup>2</sup>			
Year Built	1950	DOM	36
Sold Date	18-Sep-25	Distance	2.2km
First Listing	FOR SALE		
Last Listing	-		

Sold	RS	UN
	-	

3 5 MAESTRA STREET THE GAP QLD 4061



 3	 2	 2	 601m <sup>2</sup>	 134m <sup>2</sup>
Year Built	-		DOM	15
Sold Date	17-Sep-25		Distance	1.14km
First Listing	-*			
Last Listing	-*			

Sold	RS \$1,385,000
------	----------------

DOM = Days on market    RS = Recent sale    UN = Undisclosed Sale    \* This data point was edited by the author of this CMA and has not been verified by Cotality

## Disclaimer

---

Based on or contains data provided by the State of Queensland (Department of Resources) 2025. In consideration of the State permitting use of this data you acknowledge and agree that the State gives no warranty in relation to the data (including accuracy, reliability, completeness, currency or suitability) and accepts no liability (including without limitation, liability in negligence) for any loss, damage or costs (including consequential damage) relating to any use of the data. Data must not be used for direct marketing or be used in breach of the privacy laws; more information at [www.propertydatacodeofconduct.com.au](http://www.propertydatacodeofconduct.com.au)

The Appraisal Amount contained in the report may have been manually provided by the Agent; or may be based on an automated valuation model estimate provided by Cotality ('AVM Estimated Value'). AVM Estimated Values are current at the date of the publication only. It is computer generated and is not a professional appraisal of the subject property and should not be relied upon in lieu of appropriate professional advice. The accuracy of the methodology used to develop the AVM Estimated Value, the existence of the subject property, and the accuracy of the AVM Estimated Value and all rule sets provided are estimates based on available data and are not guaranteed or warranted. Cotality excludes all liability for any loss or damage arising in connection with the Appraisal Amount and/or AVM Estimated Value.

A floor plan of a property is indicative only and may not be complete or accurate. Any floor plan that is produced is not intended or designed to replace the certificate of title or land survey.

The Cotality Data provided in this publication is of a general nature and should not be construed as specific advice or relied upon in lieu of appropriate professional advice. While Cotality uses commercially reasonable efforts to ensure the Cotality Data is current, Cotality does not warrant the accuracy, currency or completeness of the Cotality Data and to the full extent permitted by law excludes all loss or damage howsoever arising (including through negligence) in connection with the Cotality Data.