



CONS

SOUTH TARANAKI DISTRICT COUNCIL

PRIVATE BAG 902

HAWERA

TELEPHONE (06) 278 8010

FACSIMILE (06) 278 8757

All correspondence to be addressed to the General Manager

Reference:

Building Consent

Section 35, Building Act 1991

FILE COPY

Application

ALPHA TRAINING CENTRE
P O BOX 682
NEDW PLYMOUTH

No. 970227
Issue date 12/08/97
Application date 1/04/97
Overseer HAWERA

Project

Description	ALTERATIONS, REPAIRS or EXTENSIONS BEING STAGE 1 OF AN INTENDED 1 STAGE DISABLED TOILET/ACCESS
Intended Life	INDEFINITE, BUT NOT LESS THAN 50 YEARS
Intended Use	TRAINING CENTRE
Estimated Value	\$5,000
Location	20 PRINCES ST, HAWERA
Legal Description	PTS LOT 3 DP 2 LOT 1 DP 206 LOT 3 DP 3 364
Valuation No.	1234062600

Drainlayer: JOHN DODUNSKI 1 MILMOE STREET HAWERA
Plumber: JOHN DODUNSKI 1 MILMOE STREET HAWERA

This building consent is a consent under the Building Act 1991 to undertake building work in accordance with the attached plans and specifications so as to comply with the provisions of the building code. It is not a consent under the Resource Management Act and does not affect any duty or responsibility under any other Act nor permit any breach of any other Act.

This building consent is issued subject to the conditions specified in the attached page(s) headed Conditions of Building Consent 970227.

Signed for and on behalf of the Council:

Name:

Date:

1. **COMMENCEMENT OF WORK:** The owner or person undertaking the building work shall give at least 2 working day's notice of the intended commencement of building work.
2. This building consent confirms compliance with the New Zealand Building Code. It does not give approval to commence building work until all other approvals have been obtained. The approvals required for this project are listed on the Project Information Memorandum.
3. The owner shall as soon as practical after completion of the building work, notify the Consents Officer at any South Taranaki District Council Service Centre that the building work has been completed in accordance with this Building Consent.
4. This Consent shall lapse and be of no effect if the building work has not started within 6 months or reasonable progress made after 12 months.
5. Notification can be made by completing the attached Notice of Completion Form and returning it to any S.T.D.C Centre.
6. **NOTIFICATION:** The Consents Department is to be notified at least 24 hours BEFORE any inspection is due.
7. **FOOTINGS:** The owner or person undertaking the building work shall give at least 1 working day's notice to cover up or close in the excavation and reinforcing for a foundation.
8. **FOOTING/BLOCKWORK:** A Consents Officer is to be notified 24 hours minimum prior to pouring any concrete.
9. **PRELINE:** The owner or person undertaking the building work shall give at least 1 working day's notice before placing any insulation and interior linings.
10. **PRELINE:** The owner or person undertaking the building work shall give at least 1 working day's notice to enable specified moisture content of the timber to be checked.
11. **PLUMBING:** The owner or person undertaking the building work shall give at least one working days notice to cover up or close in any Plumbing.
12. **DRAINAGE:** The owner or person undertaking the building work shall give at least 1 working day's notice to cover up or close in any Drainage.
13. **DRAINAGE:** The owner or person undertaking the building work shall give at least 1 working day's notice to cover up or close in any Drainage.
14. **PLUMBING:** Hot water to sanitary fixtures for personal hygiene is to be limited to 55 degrees C.



SOUTH TARANAKI DISTRICT COUNCIL

PRIVATE BAG 902

HAWERA

TELEPHONE (06) 278 8010

FACSIMILE (06) 278 8757

All correspondence to be addressed to the General Manager

Reference:

Project Information Memorandum 970227

Section 31, Building Act 1991

Issued in accordance with Building Consent No. 970227

This project information memorandum is confirmation that the proposed building work may be undertaken, subject to the provisions of the Building Act 1991, and any requirements of the building consent attached.

This project information memorandum includes:

NO OTHER RELEVANT INFORMATION WAS LOCATED FOR THIS PROPERTY.

Signed by or for and on behalf of the Council:

Name:

Date:

Advice of Completion of Building Work

Section 43(1), Building Act 1991

To: SOUTH TARANAKI DISTRICT COUNCIL

Consent Details

ALPHA TRAINING CENTRE	No.	970227
P O BOX 682	Issue date	12/08/97
NEDW PLYMOUTH	Application date	1/04/97
	Overseer	HAWERA

Project

Description	ALTERATIONS, REPAIRS or EXTENSIONS BEING STAGE 1 OF AN INTENDED 1 STAGE DISABLED TOILET/ACCESS
Intended Life	INDEFINITE, BUT NOT LESS THAN 50 YEARS
Intended Use	TRAINING CENTRE
Estimated Value	\$5,000
Location	20 PRINCES ST, HAWERA
Legal Description	PTS LOT 3 DP 2 LOT 1 DP 206 LOT 3 DP 3 364
Valuation No.	1234062600

You are hereby advised that

☐ All

☐ Part only as specified in the attached particulars

of the building work under the above building consent is believed to have been completed to the extent required by that building consent.

You are requested to issue

☐ A final

☐ An interim

code compliance certificate accordingly (except where a code compliance certificate has been issued by a building certifier as stated below).

The attached particulars include:

☐ Building certificates

☐ A code compliance certificate issued by a building certifier

☐ Producer statements

Signed by or for and on behalf of the owner:

Name:

Position:

Date:

Business hours contact phone no.:

PIM NOTES

OWNER:

Neil Levings

ADDRESS OF WORK: 20 princes st

VALUATION NO:

12345/626/00

BUILDER:

Alpha Training Centre Hawke

LEGAL DESC: Lot No:

DP:

Sec: Survey District

Blk: _____

DESCRIPTION OF WORK:

PROPOSED USE:

Blk: _____

Disabled
Access / Toilet

DATE	ACTIVITY	OFFICER	HOURS	RATE	AMOUNT
2/4/97	P.M. Abs.	P.M.	15m	\$6	21.50
				TOTAL	
				PAID	
				BALANCE	

TOWN PLANNING

Compliance Check

Complies: Yes/No Date: 2/4/97

Authorisations Required

Designations/Protected Trees/Historic Sites etc

APPLICATION NO: BC. 97221

APPLICANT: Theresa Wainwright

Keth
2
p11

970227

Alpha Training Centre

SERVICES

WATER MAIN

APPLICATION FORM SENT

SIZEmm LOCATION

CONNECTION REQUIRED YES/NO FEE PAYABLE \$..... SIZEmm

SEWER MAIN

APPLICATION FORM SENT

SIZEmm LOCATION

CONNECTION REQUIRED YES/NO FEE PAYABLE \$..... SIZEmm

STORMWATER

MAIN SIZE mm LOCATION

CONNECTION REQUIRED YES/NO FEE PAYABLE \$..... SIZE mm

DISCONNECTION AND RECONNECTION FEES (DEMOLITION'S & REMOVALS)

WATER

SEWER

SIGNATURE

DATE

2/4/97

VEHICLE CROSSING

NEW CROSSING REQUIRED YES/NO

FEE PAYABLE \$.....

INSPECTION FEE YES/NO

FEE PAYABLE \$.....

SIGNATURE

DATE

OTHER (e.g. HEALTH/FIRE/STRUCTURAL etc)

LICENCES REQUIRED (Health/Dangerous Goods etc)

SIGNATURE

DATE

BUILDING (Checked against the requirements of
Section 31 of the Building Act 1991)

HAZARDOUS SECTION ☐

PROPERTY INFORMATION MEMORANDUM PROCESSING

	Date Placed in Tray	Date Completed
Planning	2.4.97	2/4/97
Water and Sewer	2/4/97	2/4
Vehicle Crossing	2/4	

SIGNATURE

DATE



APP 30970227

SOUTH TARANAKI DISTRICT COUNCIL

PRIVATE BAG 902 HAWERA
APPLICATION FOR:TELEPHONE (06) 278 8010 FACSIMILE (06) 278 8757
BUILDING CONSENT
PROJECT INFORMATION MEMORANDUM

1. OWNER		2. SITE ADDRESS	
NAME: <u>NEIL LEVINGS</u>		STREET NO: <u>30</u> KIWI NO: <u> </u>	
ADDRESS: <u>2 SODDSON PLACE</u>		STREET/ROAD NAME: <u>PRINCES ST</u>	
<u>HAWERA</u>		TOWN: <u>HAWERA</u>	
PHONE BUS: <u>06 278 4753</u>		3. WORK VALUE: (MATERIALS/LABOUR/GST)	
PHONE HME: <u>06 278 4426</u>		\$ <u>5000-00</u>	
FAX: <u> </u>			
4. DESCRIPTION OF PROPOSED WORK		5. INTENDED USE OF BUILDING	
<u>DISABLED ACCESS - WHEEL</u>		<input type="checkbox"/> Residential	
<u>CHAIR TOILET</u>		<input type="checkbox"/> Farm Building	
		<input type="checkbox"/> Commercial	
		<input type="checkbox"/> Industrial	
		<input type="checkbox"/> Accessory	
		<input type="checkbox"/> Other <u>TR. A. N. I. O. S.</u>	
6. LEGAL DESCRIPTION		7. STATISTIC DETAILS	
VALUATION NO: <u>12340 / 60800</u>		INTENDED LIFE OF BUILDING	
<u>625/00</u>		<input type="checkbox"/> 50 Years Minimum <input type="checkbox"/> <u> </u> Years	
LOT NO: <u> </u> D.P. <u> </u>		AREA OF WORK <u> </u>	
SEC: <u> </u> BLOCK <u> </u>		No of STOREYS <u> </u> BEING STAGE <u> </u> of <u> </u>	
SURVEY DISTRICT: <u> </u>			
BUILDER		DESIGNER	
NAME: <u>ALPHA TRAINING CENTRE</u>		NAME: <u>SEE BUILDER</u>	
ADDRESS: <u>PO BOX 682 NEW</u>		ADDRESS: <u> </u>	
<u>PLYMOUTH</u>			
PHONE BUS: <u>06 7520635</u>		PHONE BUS: <u> </u>	
CELL PH: <u> </u>		CELL PH: <u> </u>	
FAX: <u>06 7520632</u>		FAX: <u> </u>	
PLUMBER/DRAINLAYER		CONTACT PERSON	
NAME: <u>J DO DUNSKI</u> REG: <u>04502</u>		NAME: <u>JIM COPLAND</u>	
ADDRESS: <u>1 MILMOE STREET</u>		ADDRESS: <u>PO BOX 682</u>	
<u>HAWERA</u>		<u>NEW PLYMOUTH</u>	
PHONE BUS: <u>06 278 4483</u>		PHONE BUS: <u>06 7520635</u>	
CELL PH: <u>025 4411 99</u>		CELL PH: <u> </u>	
FAX: <u> </u>		FAX: <u>06 7520632</u>	
SEND INVOICES TO:		SEND CORRESPONDENCE/ENQUIRIES TO:	
<input type="checkbox"/> Owner		<input type="checkbox"/> Owner	
<input checked="" type="checkbox"/> Builder		<input type="checkbox"/> Designer	
<input type="checkbox"/> Designer		<input checked="" type="checkbox"/> Contact Person	
<input type="checkbox"/> Contact Person			
INFORMATION INCLUDED IN THIS APPLICATION IS AVAILABLE TO BE SOLD/GIVEN TO PARTIES FOR MARKETING PUPOSES UNLESS OTHERWISE ADVISED IN WRITING		SIGNED <u> </u> DATE <u> </u>	

INFORMATION TO ACCOMPANY YOUR BUILDING CONSENT APPLICATION

The Building Act 1991 states that every application for a building consent shall be accompanied by such plans, specifications and other information as required to show compliance with the New Zealand Building Code.

To ensure that adequate information is provided with the application it is suggested that the plans and specifications include:

Site Plan showing the proposed building in relation to other buildings on the site and all boundaries. (Please show existing or proposed vehicle access). This may be included on the site plan.

Drainage Plan showing the position of drains, location of fittings and method of stormwater disposal.

Floor Plan showing the shape of the building, room sizes and the overall layout with the location of doors, windows and fittings.

Elevations showing the view of each side of the proposed building indicating heights, windows, doors exterior cladding and the general appearance of the building.

Cross Section through the building, showing the foundation and sub-floor details, wall framing and roof construction, insulation, wall and roof cladding.

Details that will show specific parts of construction which require further clarification.

Wall Bracing Calculations showing how the location and type of brace has been worked out to comply with NZS 3604.

Specification describing the construction, the quality of materials and workmanship, sizes and spacings of piles, bearers, joists, studs, rafters, purlins, etc. Specifications should be concise and describe the work for which the consent is being sought.

NOTE: Information required will vary depending on the size and type of your project

The plans and specifications should be submitted in duplicate on good quality paper and drawn in ink to scale. (Pencil drawings are not acceptable)

The drawings, specifications and other documents according to which the building is proposed to be constructed to comply with the provisions of the New Zealand Building Code.

Building certificates issued by a Building Certifier approved by the Building Industry Authority

References to determinations issued by the Building Industry Authority.

References to accreditation certificates issued by the Building Industry Authority

Reference to Approved Documents

Producer Statements issued by the producer of a product or system or by a Registered Engineer or Architect

Note: A producer statement will be accepted when the South Taranaki District Council is convinced that it covers the job applied for and is issued by a reputable person or organisation.

Please indicate the proposed procedures for inspection of building work during the construction period.

Note: A minimum of one working day's notice is required for all inspections carried out by the South Taranaki District Council Building Control Officers.

Request for inspections and appointments with Building Inspectors are to be made at any Council Service Centre

PLEASE NOTE THAT THIS IS A GUIDE ONLY. PLEASE CONTACT YOUR LOCAL SERVICE CENTRE FOR ANY ADDITIONAL INFORMATION

proposed New disabled toilet and egress for:-
ALPHA TRAINING CENTRE
 not to scale, check and confirm all measurements on site.

updated March 6th '97

existing inter tennancy wall.

15.00m approx

15.20m approx

12.100m

16.000m

14.000m

16.600m approx

.760

Entry

2.000m

1.800m

.910

3.500m

5.400m

new open out 810mm door

Lunch room
existing

.760

1.200m

.760

reline for office

4.300m

to existing sewer line

new 810 open out

17.300m approx

1xØ12 r/steel horizontal

.750 x 50 joist at .600 c/s
with Ø20mm part board

2.400m

.100mm existing concrete floor on hard fill

new concrete floor to outside level

.200mm bond beam

.150mm concrete blocks, solid filled.

.200 series bond beam

100 x 50 plate bolt fixed to top bond beam

Detail of block wall construction

new concrete floor to outside level

new concrete block walls
for disabled toilet

2.200m

2.400m

.450mm

.750mm

.760

existing door
to open out

2.400m

existing Rolla Door



12 100m

proposed New disabled toilet and egress for:-
ALPHA TRAINING CENTRE
but to be used, which had been in all measurements to on site.

updated March 04th '97

existing inter tenancy wall

15.00m approx

15.20m approx

5.400m

Lunch room
existing

.760

Entry

2.000m

new open out 810mm door

3.500m

.910

.760

1.200m

celline for office

3.300m

.760

2.400m

2.200m

16 000m

100 x 50 joist at 800 c/c
with 625mm part board

1:012 ratio of horizontal

17.300m approx

2.400m

Detail of block wall construction

100 x 50 plate bolt fixed to top bond beam

.200 series bond beam

100mm concrete blocks, solid fill

100mm bond beam

new concrete floor to outside level

100mm existing concrete floor on hard fill

new concrete floor to outside level

new concrete block walls
for disabled toilet

16.600m approx

14.000m

2.400m
existing Rolla Door

existing door
to open cell

12.100m

proposed New disabled toilet and egress for:-
ALPHA TRAINING CENTRE
not to scale, check and confirm all measurements on site.

updated March 04: '97

existing inter tenancy wall.

15.00m approx

15.20m approx

5.400m

Lunch room
existing

.760

Entry

1.800m

2.000m

new open out 810mm door

3.500m

.910

.760

1.200m

.760

reline for office

3.300m

2.200m

2.400m

new concrete block walls
for disabled toilet

1 to existing sewer line
new 810 open out

16.000m

.150 x 50 joist at .800 c/s
with 920mm part board

1x12 r/s at horizontal

17.300m approx

2.400m

Detail of block wall construction

100 x 50 plate bolt fixed to top bond beam

.200 series bond beam

.150mm concrete blocks, solid filled

.200mm bond beam

new concrete floor to outside level

.100mm existing concrete floor on hard fill

new concrete floor to outside level

16.600m approx

14.000m

2.400m
existing Rolla Door

existing door
to open out



CONSENT PROCESSING SHEET

DATE	ACTIVITY	OFF	HRS	AMT	DATE		INSP REQ	INSP COM	HRS	AMT
11/4	Admin	jm	25	155		FOOTING				
8/1	Letter	JF	30			EXCAVATIONS				
8/8	Invoice	J	30			FOUNDATION WALLS				
						CONCRETE FLOOR SLAB				
						TIMBER SUBFLOOR				
						CONCRETE BRICKWORK				
						PRELINE - BUILDING MOISTURE/STRUCTURE				
						PRELINE - BUILDING INSULATION				
						PRELINE - PLUMBING PIPEWORK				
						DRAINAGE				
						FIRES FREESTANDING/ INBUILT				
						FIRE CODES				
						COMPLETION BUILDING/ PLUMBING				
						SITE				
						OTHER				
			SUB					SUB		
						TOTAL SUB TOTALS				
						AMOUNT PAID				
						REFUND/PAY				

FEES (INCLUSIVE OF G.S.T.)		RECEIPT NO: R 350995	INVOICE <input checked="" type="checkbox"/>
ADMINISTRATION CHARGE	\$ 50 -	DATE 01/04/97	LETTER <input type="checkbox"/>
PIM FEE	\$	RECEIPT NO: R 369757	PIM <input type="checkbox"/>
BRANZ LEVY	\$	DATE 10/8/97	CONSENT <input checked="" type="checkbox"/>
DAMAGE DEPOSIT	\$	RECEIPT NO: R	CCC <input type="checkbox"/>
CODE COMPLIANCE CERTIFICATE	\$ 30 -	DATE	NTR <input type="checkbox"/>
RURAL/RESIDENTIAL INSPECTIONS	\$		
PROCESSING COSTS	\$ 90.40		
VEHICLE CROSSING FEE	\$		
COMMERCIAL/INDUSTRIAL INSPEC.	\$ 180.00		
UTILITY CHECK	\$		
STRUCTURAL CHECK	\$		
PHOTOCOPYING	\$		
WATER CONNECTION	\$		
SEWER CONNECTION	\$		
BIA LEVY	\$		
INITIAL CASH RECEIVED	\$ 150 -		

OWNER: NEIL LEVINGS	VALUATION NO: 12340/626/00
SITE ADDRESS: 20 Princess St. Hwa	VALUE OF WORK \$ 5000 -
BUILDER: Alpha Training Centre	
DESCRIPTION OF PROPOSED WORK: Disabled Access / Toilet	

Keith
2
PL:1

CANCELLED

APPLICATION NO: BC 970227
APPLICANT: ALPHA TRAINING CENTRE

BUILDING:

Feb

NOT APPROVED

DATE

APPROVED *[Signature]*

DATE *5/1/97*

HEALTH SECTION

NOT APPROVED

DATE

APPROVED

DATE

PLAN CHECK

Site	<input type="checkbox"/>
Area of Building	<input type="checkbox"/>
Concrete Floor Slabs Height From Finished Ground Line	<input type="checkbox"/>
Bracing Units (Roof)	<input type="checkbox"/>
Reinforcing Steel (Sizes Spacing etc)	<input type="checkbox"/>
Vents	<input type="checkbox"/>
Holdings Down Bolts	<input type="checkbox"/>
Foil Floor Insulation	<input type="checkbox"/>
Under Floor Access	<input type="checkbox"/>
Field Tile Drains	<input type="checkbox"/>
Footings	<input type="checkbox"/>
Pile Types & Spacings	<input type="checkbox"/>
D.P.M.	<input type="checkbox"/>
Sub Floor Framing	<input type="checkbox"/>
Framing General	<input type="checkbox"/>
Lintel Sizes	<input type="checkbox"/>
Roof Framing & Fixing	<input type="checkbox"/>
Wall & Ceiling Insulation	<input type="checkbox"/>
External Sheathing	<input type="checkbox"/>
Breather Paper	<input type="checkbox"/>
Bracing (Wall)	<input type="checkbox"/>
External Joinery Fixing & Weathering	<input type="checkbox"/>
Internal Linings	<input type="checkbox"/>
Laundry Facilities	<input type="checkbox"/>
Chimney & Fireplace Installation	<input type="checkbox"/>
Drains (Soil, Silage)	<input type="checkbox"/>
Ventilation	<input type="checkbox"/>
Bathroom Fittings	<input type="checkbox"/>
WC's Disabled If Applicable	<input type="checkbox"/>
Truss Spacing & Fixing	<input type="checkbox"/>
Disabled Access	<input type="checkbox"/>
Fire Code Requirements	<input type="checkbox"/>
Plumbing	<input type="checkbox"/>



4 June 1998

The Supervisor
Building Consents
South Taranaki District Council
Private Bag 902
HAWERA

Dear Sir/madam

BUILDING CONSENT NO 970227

We wish to make an alteration to the design of the wheel-chair toilet to provide for internal access and uni-sex usage for up to 12 persons . Please see attached plan.

The wall and ceiling construction will be of 100 x 50 mm timber at 600 mm centres, nogged and lined internally with 10 mm Gibraltar Board, stopped and painted. External lining will be 12 mm Chip Board. Hot and cold water supply installed.

There will be no increase in costs.

Advice that we may proceed on the basis of the new design would be appreciated.

Yours faithfully

J W J COPLAND
Managing Director.

FILE REF	S20/20	DATE FILED			
FOR INFORMATION	DES	TIME			
SOUTH TARANAKI DISTRICT COUNCIL					
- 5 JUN 1998					
ACTION/NEA		DATE REPLIED			
NAME	INITIAL	DATE	NAME	INITIAL	DATE
DES					
cm					

Head Office
1 Smith Street
Lepperton
Phone: 06) 752 0635
Fax: 06) 752 0632

Engineering North
1 Smith Street
Lepperton
Phone: 06) 752 0635
Fax: 06) 752 0632

Engineering South
24 Princess Street
Hawera
Phone: 06) 278 9162
Fax: 06) 752 0632

Training Farm
Lincoln Road
Inglewood
Phone: 06) 756 8607
Fax: 06) 752 0632

98065017



Bank of New Zealand

HAWERA BRANCH
73 Princes Street, Hawera

SOUTH TARANAKI DISTRICT COUNCIL

Cheque Duty Paid
Lic No. 9

DATE 13-8-97

PAY THE SUM OF	HUND THOUS	TEN THOUS	THOUSANDS	HUNDREDS	TENS	UNITS	CENTS	AMOUNT IN FIGURES
					2	5	00	\$25-00

TO THE ORDER OF

Alpha Training Foundation
P.O. Box 680
NEW PLYMOUTH

NOT NEGOTIABLE
ACCOUNT PAYEE ONLY

FOR SOUTH TARANAKI DISTRICT COUNCIL GENERAL A/C

[Signature]

⑈051395 ⑈020648⑈ 0070079⑈00 ⑈

Please detach before banking cheque

DATE	REFERENCE	DISCOUNT	NET AMOUNT	DATE	REFERENCE	DISCOUNT	NET AMOUNT
------	-----------	----------	------------	------	-----------	----------	------------

Refund overpaid application fee
\$25-00

FILE COPY

SOUTH TARANAKI DISTRICT COUNCIL PRIVATE BAG HAWERA

FILE COPY

MEMO TO: Creditors Clerk - Judy Stockdill

FROM: Administration Manager - Environmental Services

SUBJECT: Cheque Request

DATE: 12 August 1997

Judy ,

Could you please arrange for a cheque to the following

Alpha Training Foundation
P O Box 682
NEW PLYMOUTH \$25.00

being a refund of overpaid application fee for building consent number BC970227. The \$175.00 payment was made on the 1 April 1997 - receipt number 350995.

Please debit Debtor Number BC970227 and return cheque to Lea.

Thank you

Lea

* * * COPY ONLY * * *

1-04-97 14:14 Receipt no.350995
DR BC970227
ALPHA TRAINING CENTR 175.00-
ALPHA TRAINING CENTRE::P O BOX 682:NEDW
CQ ANZ NEW PLYMOUT
TARANAKI ALPHA FOUND 175.00
TOTAL RECEIPTED 175.00

NCX2F: END



ALPHA TRAINING CENTRE

of the TARANAKI ALPHA FOUNDATION TRUST

P.O. Box 682

New Plymouth

Telephone: 0-6 752 0635

Fax: 0-6 752 0632

7 August 1997

Mr K Scott
Consents Officer
South Taranaki District Council
Private Bag
HAWERA

Dear Keith

CONSENT NUMBER 970227

Thank you for your letter dated 4 April.

The landlord has supplied a copy of the Certificate of Title showing that all his properties at 20 Princes Street are under one title. A copy of the Certificate is enclosed.

Also enclosed is an amended drawing showing the proposed office reduced to 2 meters in length enabling the wheel chair toilet to be located 1 meter closer to Princes Street.

Please note that hot water will be supplied to a hand basin to be sited on the work shop side of the back wall of the toilet. The hot water cylinder will be locate above.

We trust that the proposals are now in order and that the amended consent can be issued.

Thank you for your assistance in this matter.

Yours sincerely

A handwritten signature in blue ink, appearing to read 'J W J Copland', is written over the typed name.

J W J COPLAND
Manager.

References:

Prior C/T E1/180, E1/181 and E1/182

Document No. 441825



RECEIVED
16 JUL 1997

LT 69

No. K4 / 193

CERTIFICATE OF TITLE UNDER LAND TRANSFER ACT

This Certificate dated the 5th day of June one thousand nine hundred and ninety-seven under the seal of the District Land Registrar of the Land Registration District of TARANAKI

WITNESSETH that NEIL HENRY LEVINGS and GLENDA MARY LEVINGS both of Hawera company directors are -

seised of an estate in fee-simple (subject to such reservations, restrictions, encumbrances, liens, and interests as are notified by memorial underwritten or endorsed hereon) in the land hereinafter described, delineated with bold black lines on the plan hereon. be the several admeasurements a little more or less, that is to say: All that parcel of land containing 1254 square metres more or less situate in Block IX Hawera Survey District being Lot 24 and part Lot 6 on Deposited Plan 3791 and Lots 1 and 2 on Deposited Plan 4825 -

Assistant Land Registrar

Existing Interests at Date of Issue:

1. Transfer 42803 creating the right to keep laid and maintained the footings at all times of the piers of the concrete wall on part of the within land adjacent to Lot 24 DP 3791 herein - 25.8.1921 at 2.45 o'c
2. Transfer 42803 creating the right of user in common with the registered proprietor of Lots 1 and 2 DP 4825 (herein) at all times of the piers of the concrete wall on part of the within land adjacent to Lot 24 DP 3791 herein - 25.8.1921 at 2.45 o'c
3. Transfer 48557 Grant of Party Wall Rights over part of the within land appurtenant to the land in 110/227 - 11.2.1925 at 10.30 o'c

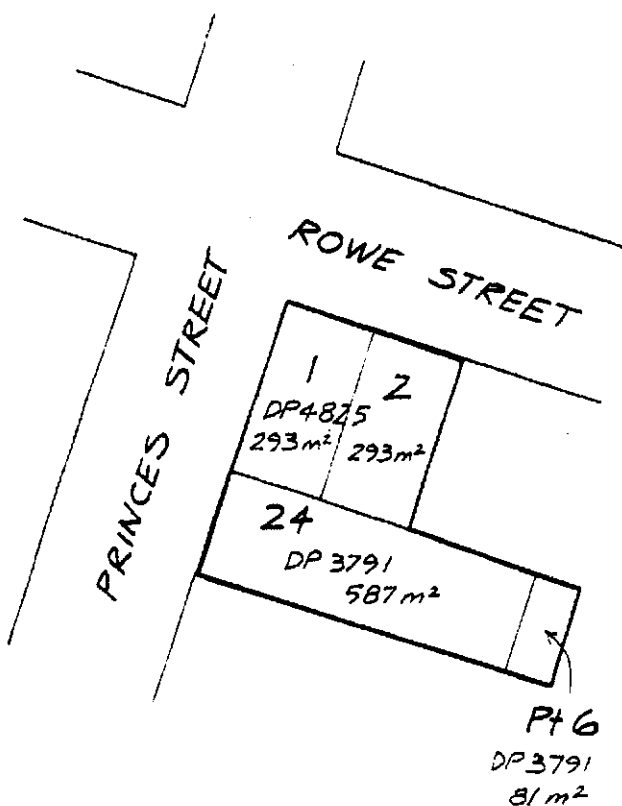

Total Area: 1254 m²

over ...

A.E.R.

No. K4 / 193

CERTIFICATE OF TITLE No. K4/193

4. Transfer 48557 Grant of Party
Wall Rights over part of the
land in 110/227 appurtenant to
Lot 2 DP 4825 herein - 11.2.1925
at 10.30 o'clock
5. Transfer 52362 Grant of Party
Wall Rights over part of Lot 2
DP 4825 herein appurtenant to
Lot 1 DP 4825 herein - 20.8.1927
at 11.15 o'clock
6. Transfer 52362 Grant of Party
Wall and Drainage Rights over
parts of Lot 1 DP 4825 herein
appurtenant to Lot 2 DP 4825
herein - 20.8.1927 at 11.15 o'clock
7. Mortgage 358056.3 to The
National Bank of New Zealand
Limited - 17.2.1989 at 11.13 o'clock

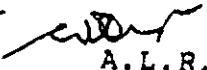
A.L.R.

FILE COPY

KS:MH32

4 April, 1997

Alpha Training Centre
PO Box 682
NEW PLYMOUTH

ATTENTION: Jim Copland

Dear Jim

RE: CONSENT NUMBER 970227

Confirmation is required that the properties owned by Mr Levings at 20 Princes Street, Hawera, are all held under one title. If so, this will alleviate the need for fire rating between all premises.

Yours sincerely

Keith Scott
CONSENTS OFFICER



SOUTH TARANAKI DISTRICT COUNCIL

PRIVATE BAG 902 HAWERA TELEPHONE (06) 278-8010 FACSIMILE (06) 278-8757

SERVICE CENTRES:

P.O. Box 142 ELTHAM

P.O. Box 15 MANAIA

P.O. Box 19 OPUNAKE

P.O. Box 28 PATEA

AGENCIES

57 Victoria St. KAPONGA

87 Weraroa Rd. WAVERLEY

ALPHA TRAINING CENTRE

P O BOX 682

NEDW PLYMOUTH

GST REG No. 52-769-477

CUST No. BC970227

8/08/97

TAX INVOICE 36668

970227 : 20 PRINCES ST, HAWERA
DISABLED TOILET/ACCESS

QTY	DESCRIPTION	RATE	AMOUNT
	ADMINISTRATION CHARGE (\$50.00)		50.00 *
	CODE COMPLIANCE CERTIFICATE		30.00 *
	CONSENT/PIM PROCESSING COSTS		99.50 *
	COMMERCIAL/INDUSTRIAL INSPECTION FEE		180.00 *
(* INCL GST	\$39.95)	TOTAL	\$359.50
		CASH RECEIVED	150.00CK
		NET DUE	209.50 =====

WE LOOK FORWARD TO
RECEIVING YOUR
PAYMENT TO ENABLE
COMPLETION OF YOUR
CONSENT.

Please detach here and send this portion with your remittance

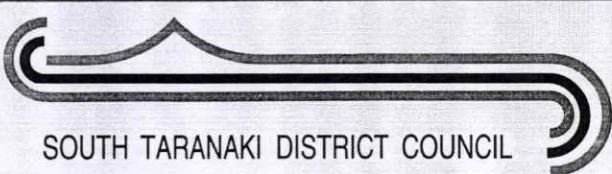

SOUTH TARANAKI DISTRICT COUNCIL

ALPHA TRAINING CENTR 8/08/97

BC970227 /36668

209.50

Receipts for mail remittances issued on request only



ALPHA TRAINING CENTRE

of the TARANAKI ALPHA FOUNDATION TRUST

P.O. Box 682

New Plymouth

Telephone: 0-6 752 0635

Fax: 0-6 752 0632

20 March 1997

Mr K Scott
Consents Officer
South Taranaki District Council
Private bag 902
HAWERA

Dear Keith

ALPHA TRAINING CENTRE - PRINCES STREET, HAWERA

Thank you for your assistance late last year and for your letter dated 26 November.

To provide for the continuing development of the training programme we have arranged with the landlord to take over the adjoining portion of his premises in which the lunch room is located. It is thus not now necessary to complete the internal fire wall which was built with provision for access between the two sections. Please see attached plan showing both sections.

The plan also shows how we propose to provide wheel chair toilet and internal access facilities along with outward opening egress doors.

Enclosed is an application for a building consent for the doors and wheel chair toilet, specification and our cheque for the fee of \$175.00.

It is urgent that we make a start on the work in the immediate future to meet the requirements of the New Zealand Qualifications Authority. For this reason I would value the provision of the consent as soon as this can be managed.

Yours sincerely

J W J COPLAND
Manager.

FILE REF	DATE FILED				
FOR INFORMATION	TIME				
SOUTH TARANAKI DISTRICT COUNCIL					
- 1 APR 1997					
ACTION/NFA					
NAME	INITIAL	DATE	NAME	INITIAL	DATE



Carpenter.

1. Install new concrete block toilet, as per plan supplied, complete with new opening out door of 810 mm with weather proof air vents, concrete floor and fina floor ceiling. Provide that the door can always be opened from the inside.
2. Install new outward opening doors of 810 mm in workshop and entry foyer and equip with locksets with horizontal handles. Ensure compliance with NZS 4121 or New Zealand Building Code.
3. Raise floor in entry foyer by forming concrete ramp to cover all entry area.
4. Reline existing store with 9mm Gibraltar board for office, install door and ensure ventilation.
5. Ramp all entries with concrete to provide fall of 1 in 12.

Plumber.

1. Fit one toilet pan, cistern and hand basin and install piping to connect all to existing cold water and sewer line with one gully trap and terminal vent.